

OWNER'S GUIDE

OUTDOOR POWER EQUIPMENT
for all seasons

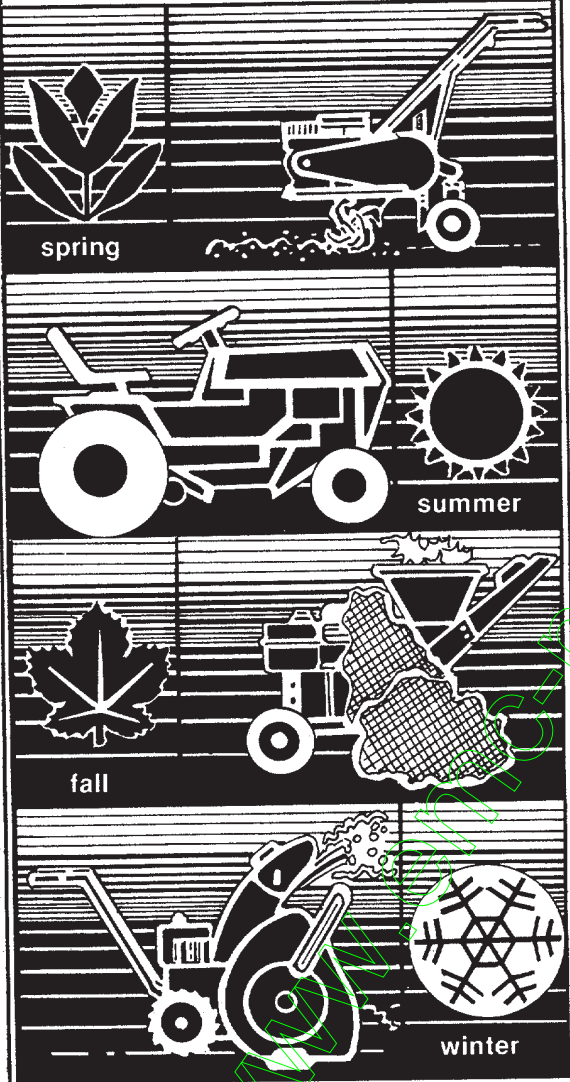

700 SERIES TRANSMATIC LAWN TRACTORS

Model Numbers

135-704-000

135-705-000

135-714-000

135-715-000

Important:
Read Safety Rules and
Instructions Carefully

Thank you for purchasing
an American-built product.

INDEX

Safe Operation Practices	3	Off-Season Storage	19
Assembly Instructions	4	Trouble Shooting Chart	20, 21
Controls	10	Illustrated Parts for Rider	22-35
Operation	11	Electrical System	31
Adjustments	13	Illustrated Parts for Transaxle	36, 37
Lubrication	15	Parts Information	Back Cover
Maintenance	16		



Instructions given with this symbol are for personal safety. Be sure to follow them.

LIMITED WARRANTY

For one year from the date of original retail purchase, MTD PRODUCTS INC will either repair or replace, at its option, free of charge, F.O.B. factory or authorized service firm, any part or parts found to be defective in material or workmanship. Transportation charges for the movement of any power equipment unit or attachment are the responsibility of the purchaser. Transportation charges for any parts submitted for replacement under this warranty must be paid by the purchaser unless such return is requested by MTD PRODUCTS INC.

This warranty will not apply to any part which has become inoperative due to misuse, excessive use, accident, neglect, improper maintenance, alterations, or unless the unit has been operated and maintained in accordance with the instructions furnished. This warranty does not apply to the engine, motor, battery, battery charger or component parts thereof. Please refer to the applicable manufacturer's warranty on these items.

This warranty will not apply where the unit has been used commercially.

Warranty service is available through your local authorized service dealer or distributor. If you do not know the dealer or distributor in your area, please write to the Customer Service Department of MTD.

The return of a complete unit will not be accepted by the factory unless prior written permission has been extended by MTD.

This warranty gives you specific legal rights. You may also have other rights which vary from state to state.



WARNING

This unit is equipped with an internal combustion engine and should not be used on or near any unimproved forest-covered, brush-covered or grass-covered land unless the engine's exhaust system is equipped with a spark arrester meeting applicable local or state laws (if any). If a spark arrester is used, it should be maintained in effective working order by the operator.

In the State of California the above is required by law (Section 4442 of the California Public Resources Code). Other states may have similar laws. Federal laws apply on federal lands. A spark arrester muffler is available at your nearest engine authorized service center.

**WARNING**

To reduce the potential for any injury, comply with the following safety instructions. Failure to comply with the instructions may result in personal injury.

SAFE OPERATION PRACTICES FOR RIDING VEHICLES

1. Read this owner's manual carefully in its entirety before attempting to assemble or operate this unit. Keep this manual in a safe place for future and regular reference and for ordering replacement parts.
2. This unit is a precision piece of power equipment, not a plaything. Therefore exercise extreme caution at all times.
3. Know the controls and how to stop quickly—**READ THIS OWNER'S MANUAL.**
4. Do not allow children to operate vehicle. Do not allow adults to operate it without proper instruction. Only persons well acquainted with these rules of safe operation should be allowed to use your mower.
5. No one should operate this unit while intoxicated or while taking medication that impairs the senses or reactions.
6. Wear sturdy, rough-soled work shoes and close-fitting slacks and shirts to avoid entanglement in the moving parts. Never operate a unit in bare feet, sandals, or sneakers.
7. To prevent injury, do not carry passengers or give rides. Keep children, pets and bystanders out of the area while mowing. Only the operator should ride on the unit and only ride in the seat.
8. Check overhead clearance carefully before driving under power lines, guy wires, bridges or low hanging tree branches, before entering or leaving buildings, or in any other situation where the operator may be struck or pulled from the unit, which could result in serious injury.
9. To maintain control of the unit and reduce the possibility of upset or collision, operate the tractor smoothly. Avoid erratic operation and excessive speed.
10. Keep the area of operation clear of all persons, particularly small children and pets. Stop engine when they are in the vicinity of your mower. Although the area of operation should be completely cleared of foreign objects, a small object may have been overlooked and could be accidentally thrown by the mower in any direction and cause injury.
11. Clear work area of objects which might be picked up and thrown by the mower in any direction and cause injury.
12. Stop the blade(s) when crossing gravel drives, walks or roads.
13. Disengage all attachment clutches and shift into neutral before attempting to start engine.
14. Disengage power to attachment(s) and stop engine before leaving operating position.
15. Do not put hands or feet near or under rotating parts. Keep clear of the discharge opening at all times as the rotating blade(s) can cause injury.
16. Disengage power to attachment(s) and stop engine before making any repairs or adjustments. Disconnect the spark plug wire and keep the wire away from the plug to prevent accidental starting.
17. Before attempting to unclog the mower or discharge chute, stop the engine. The mower blade(s) may continue to rotate for a few seconds after the engine is shut off. Therefore, be sure the blade(s) have stopped completely. Disconnect the spark plug wire and keep the wire away from the plug to prevent accidental starting.
18. Disengage power to attachment(s) when transporting or not in use.
19. Take all possible precautions when leaving vehicle unattended such as disengaging power-take-off, lowering attachments, shifting into neutral, setting parking brake, stopping engine and removing key.
20. Do not stop or start suddenly when going uphill or downhill. Mow up and down face of steep slopes; never across the face. Use extreme caution if it is necessary to drive the tractor up an incline or back the tractor down an incline because the front of the tractor could lift and rapidly flip over backward which could cause serious injury.
21. Reduce speed on slopes and in sharp turns to prevent tipping or loss of control. Always keep the tractor in gear when going down steep hills to take advantage of engine braking action.
22. Stay alert for holes in terrain and other hidden hazards.
23. Use care when pulling loads or using heavy equipment.
 - A. Use only approved drawbar hitch points.
 - B. Limit loads to those you can safely control.
 - C. Do not turn sharply. Use care when backing.
 - D. Use counterweight(s) or wheel weights when suggested in owner's manual.
24. Watch out for traffic when crossing or near roadways.
25. When using any attachments, never direct discharge of material toward bystanders nor allow anyone near vehicle while in operation.
26. Handle gasoline with care. It is highly flammable.
 - A. Use approved gasoline container.
 - B. Never remove cap or add gasoline to a running or hot engine or fill fuel tank indoors. Wipe up spilled gasoline.
 - C. Open doors if engine is run in garage. Exhaust fumes are dangerous. Do not run engine indoors.

27. Keep the vehicle and attachments in good operating condition, and keep safety devices in place. Use guards as instructed in operator's manual.
28. Keep all nuts, bolts, and screws tight to be sure the equipment is in safe working condition.
29. Never store the equipment with gasoline in the tank inside a building where fumes may reach an open flame or spark. Allow engine to cool before storing in any enclosure.
30. To reduce fire hazard, keep engine free of grass, leaves or excessive grease.
31. The vehicle and attachments should be stopped and inspected for damage after striking a foreign object. The damage should be repaired before restarting and operating the equipment.
32. Do not change the engine governor settings or overspeed the engine.
33. When using the vehicle with mower, proceed as follows:
 - (1) Mow only in daylight or in good artificial light.
 - (2) Never make a cutting height adjustment while engine is running if operator must dismount to do so.
 - (3) Shut the engine off and wait until the blade comes to a complete stop before removing the grass catcher.
 - (4) Check blade mounting bolts for proper tightness at frequent intervals.
34. Check grass catcher bags frequently for wear or deterioration. For safety protection, replace only with new bag meeting original equipment specifications.
35. Look behind to make sure the area is clear before placing the transmission in reverse and continue looking behind while backing up. Disengage blades before shifting into reverse and backing up.
36. This unit should not be driven up a ramp onto a trailer or truck under power, because the unit could tip over, causing serious personal injury. The unit must be pushed manually to load properly.

This owner's manual covers various models of lawn tractors. The units illustrated may vary slightly from your unit. Follow the instructions which pertain to your unit.

NOTE

This unit is shipped WITHOUT GASOLINE or OIL. After assembly, see separate engine manual for proper fuel and engine oil recommendations.

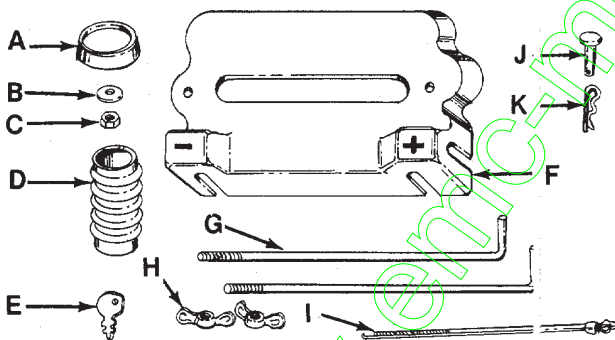

FIGURE 1.

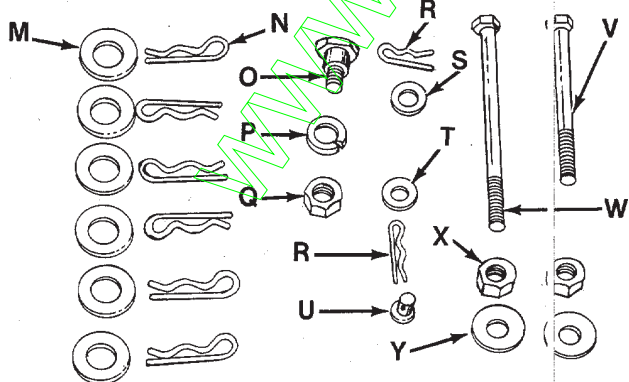

FIGURE 2.

ASSEMBLY

Contents of Hardware Pack:
(See Figures 1 and 2)

- A (1) Steering Wheel Cap
- B (1) Belleville Washer
- C (1) Hex Nut 5/16-18 Thread
- D (1) Steering Bellow
- E (2) Ignition Keys
- F (1) Battery Cover
- G (2) Battery Hold-Down Rods
- H (2) Wing Nuts
- I (1) Cable Tie
- J (1) Clevis Pin 1" Long
- K (1) Hairpin Cotter 1/4" Diameter

Hardware for Attaching the Deck

- M (6) Flat Washers 1/2" I.D.
- N (6) Hairpin Cotters 1/2" Diameter
- O (1) Shoulder Bolt
- P (1) Lock Washer 3/8" I.D.
- Q (1) Hex Nut 3/8-16 Thread
- R (2) Hairpin Cotters 5/16" Diameter
- S (1) Flat Washer
- T (1) Flat Washer
- U (1) Clevis Pin 1/2" Long
- V (1) Hex Bolt 4" Long
- W (1) Hex Bolt 4 1/2" Long
- X (2) Hex Nuts 5/16-18 Thread
- Y (2) Belleville Washers 5/16" I.D.

Hardware for Mounting the Seat (Not Shown)

- (2) Hex Bolts and Lock Washers
- or
- (1) Hex Nut and Lock Washer

Loose Parts in Carton:

- (1) Battery Pack
- (1) Steering Wheel
- (1) Seat
- (1) Deck

BATTERY INFORMATION



WARNING

- A. Battery acid must be handled with great care as contact with it can burn and blister the skin. It is also advisable to wear protective clothing (goggles, rubber gloves and apron) when working with it.*
- B. Should battery acid accidentally splatter into the eyes or onto the face, rinse the affected area immediately with clean, cold water. If there is any further discomfort, seek prompt medical attention.
- C. If acid spills on clothing, first dilute it with clean water, then neutralize with a solution of ammonia/water or baking soda/water.
- D. Since battery acid is corrosive, do not pour it into any sink or drain. Before discarding empty electrolyte containers, rinse them with a neutralizing solution.
- E. NEVER connect or disconnect charger clips to battery while charger is turned on as it can cause sparks.
- F. Keep all lighted materials (cigarettes, matches, lighters) away from the battery as the hydrogen gas generated during charging can be combustible.
- G. As a further precaution, only charge the battery in a well-ventilated area.

***Always shield eyes, protect skin and clothing when working near batteries.**



DANGER

Battery contains sulfuric acid. Refer to warning on page 5. Antidote: EXTERNAL—Flush with water. INTERNAL—Drink large quantities of water or milk. Follow with milk of magnesia, beaten egg or vegetable oil. Seek prompt medical attention. EYES: Flush with cool water for at least 15 minutes, then seek immediate medical attention.

Since batteries produce explosive gases, keep all lighted materials (cigarettes, lighters, matches, etc.) away. Be sure to charge battery only in well-ventilated areas.

**KEEP BATTERIES
OUT OF THE REACH OF CHILDREN!**

ACTIVATING THE BATTERY

1. Place the battery to be filled on a workbench. Never activate a battery in the unit.
2. Slip one end of battery drain tube on the battery manifold.

3. Remove the fill caps from all cells.
4. Fill each cell carefully using 1.265 specific gravity electrolyte. Fill each cell to the top of the separators. Do not overfill.
5. Let the battery sit for 20 minutes to allow the chemical reaction to take place.
6. Charge the battery at a **MAXIMUM RATE OF 5 AMPS**, until the specific gravity reads 1.265. Use a hydrometer to check the specific gravity.



NOTE

An excessive rate of charge will damage the battery.

7. Check the level of electrolyte. Adjust level to bottom of split ring if necessary with electrolyte.
8. Replace fill caps.



NOTE

Charging rate after battery has been put into operation: The battery is to be charged for a period of 14-16 hours. **NO LONGER THAN 30 HOURS.**

After battery has been in service, add only distilled water. Do not add acid.



NOTE

This engine is equipped with an alternator. The current for the battery charger alternator is unregulated. During normal operation, it is only necessary to charge the battery:

1. When it is activated for the first time.
2. Before winter storage.
3. Before using the lawn tractor after winter storage.

INSTALLING THE BATTERY

1. Open the hood of the lawn tractor by lifting up on both sides of the hood.

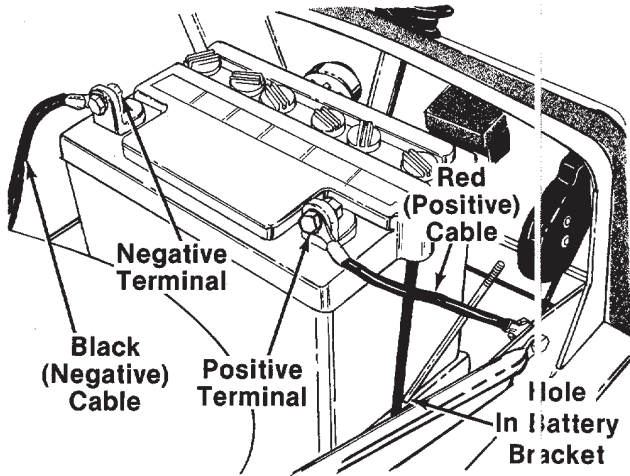

FIGURE 3.

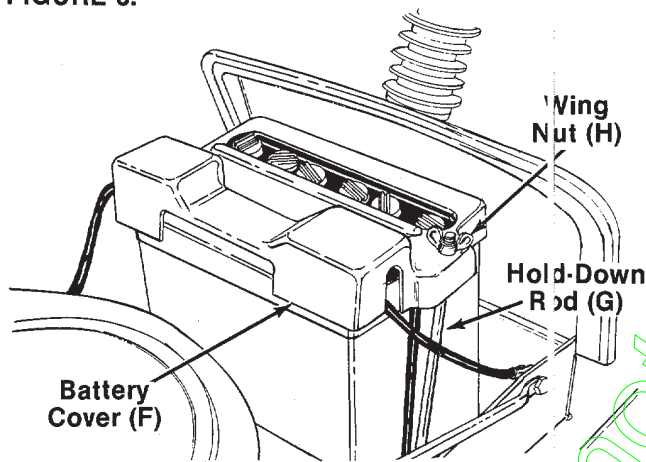

FIGURE 4.

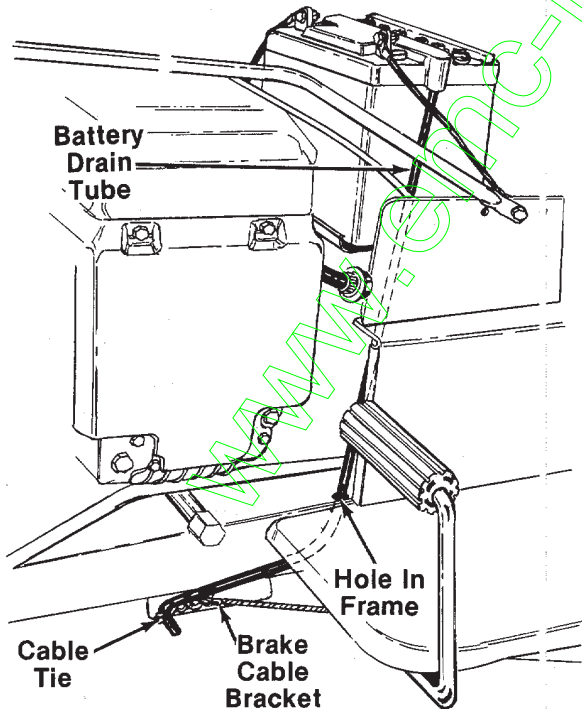

FIGURE 5.

2. Place the battery in the lawn tractor so that the positive terminal is facing the right side of the unit. See figure 3.



Right and left hand sides of the unit are determined from the operating position, facing forward.

3. Slide the square nut (provided with battery hardware) into the positive (+) terminal. Place the positive (heavy red wire) cable on the positive terminal. Secure with screw provided. See figure 3.
4. Slide the square nut (provided with battery hardware) into the negative (-) terminal. Place the negative (heavy black wire) cable on the negative terminal. Secure with screw provided.
5. Hook one hold-down rod (G) into the hole in the edge of the battery bracket beside the battery. See figure 3. Place the battery cover (F) in position over the hold-down rod. Secure with wing nut (H). Attach other hold-down rod to the other side of battery cover in the same manner. See figure 4.

6. Route the battery drain tube down through the hole in the frame, then forward to the brake cable bracket. See figure 5.

7. Secure drain tube to brake cable bracket with cable tie (H) as shown in figure 5. Cut off excess end of cable tie.

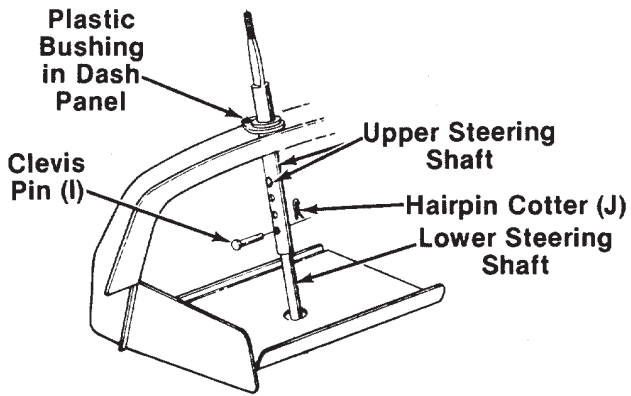

STEERING WHEEL INSTALLATION

1. For shipping purposes, the upper steering shaft is pushed all the way down over the lower steering shaft. Pull the upper steering shaft up. The four holes in the shaft provide four steering wheel heights. Select desired hole and secure with clevis pin (I) and hairpin cotter (J). See figure 6.

FIGURE 6.— Models 704 and 714 Shown

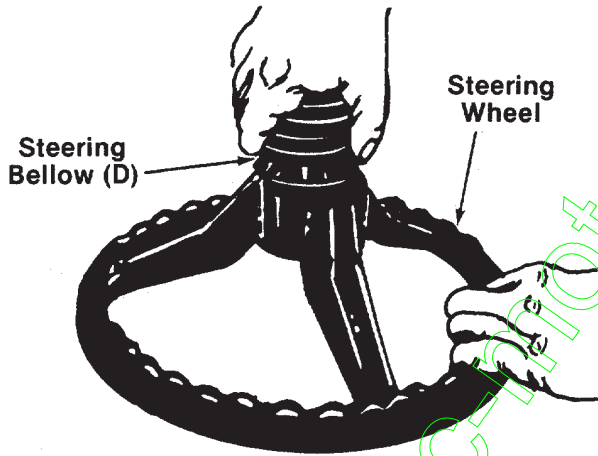

2. Attach steering bellow (D) to the steering wheel as shown in figure 7.

NOTE

One end of the steering bellow is slightly larger than the other. The larger end must be assembled to the steering wheel.

FIGURE 7.

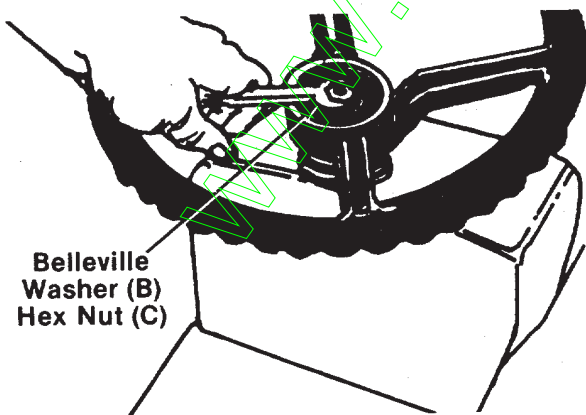

3. Place steering wheel and bellow on the steering shaft, lining up the flats in the wheel with the flats on the shaft.
4. Secure with belleville washer (B) (cupped side against the steering wheel) and hex nut (C). See figure 8.
5. Press the steering wheel cap (A) on the steering wheel by hand.

FIGURE 8.

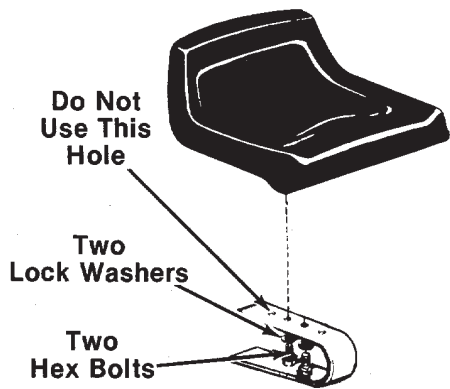

FIGURE 9.

SEAT INSTALLATION

The seat may be adjusted to two different positions. Select desired position and secure to seat spring with two hex bolts and lock washers. See figure 9.



IMPORTANT

Do not use the last hole in the seat spring as shown in figure 9 to avoid interfering with the fuel tank.

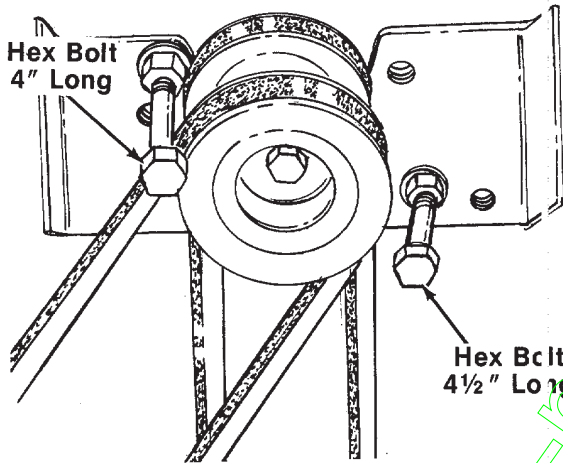

FIGURE 10.

ATTACHING THE DECK (See figures 10 through 13)

1. Slide the deck underneath the tractor from the right hand side.
2. Lower the lift lever to the lowest position.
3. Place the deck engagement lever in the disengaged position. Roll the belt onto the engine pulley.
4. Thread hex nuts (X) onto hex bolts 4" and 4 1/2" long. Place belleville washers (Y) on hex bolts (crown side of washers go against the nuts).
5. Attach hex bolts 4" and 4 1/2" long to the engine pulley belt guard bracket to act as belt keepers. Assemble in the locations shown in figure 10.

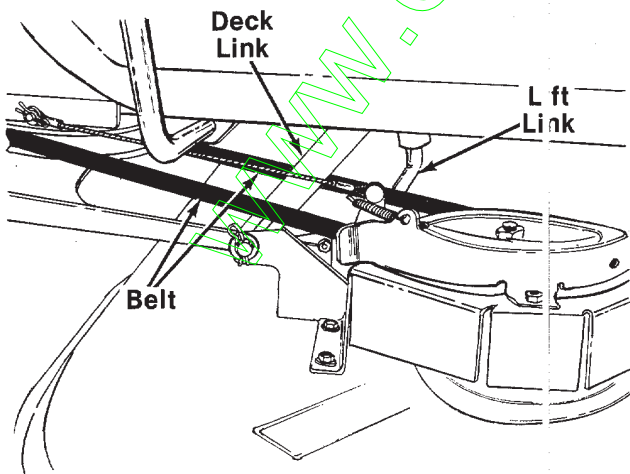

FIGURE 11.

6. Attach the two lift links, and then the four deck links to the deck as shown in figure 12 using six flat washers (M) and hairpin cotters (N). Be certain to route one side of the belt between the left hand lift link and deck link, and the other side outside of the deck link, as shown in figure 11.
7. Place the deck engagement lever in the engaged (forward) position. Attach the stabilizer rod to the deck using flat washer (S) and hairpin cotter (R). See figure 12.
8. Move the deck engagement lever to the disengaged position. Attach the diagonal brace to the deck as shown using shoulder bolt (O), lock washer (P) and hex nut (Q). See figure 12.



WARNING

The deck blade brake cable must be attached as described on page 10 before the mower is operated.

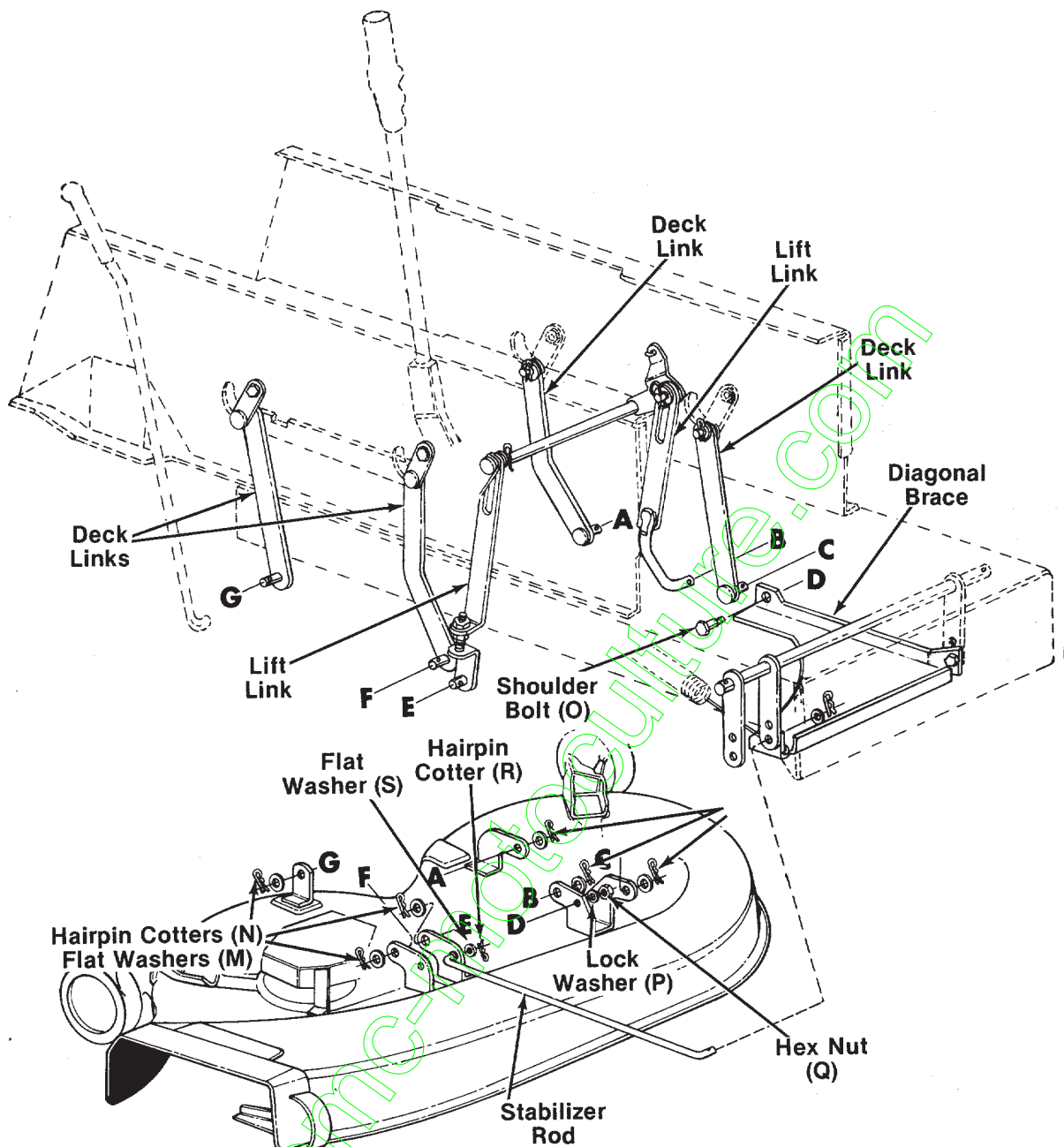

FIGURE 12.

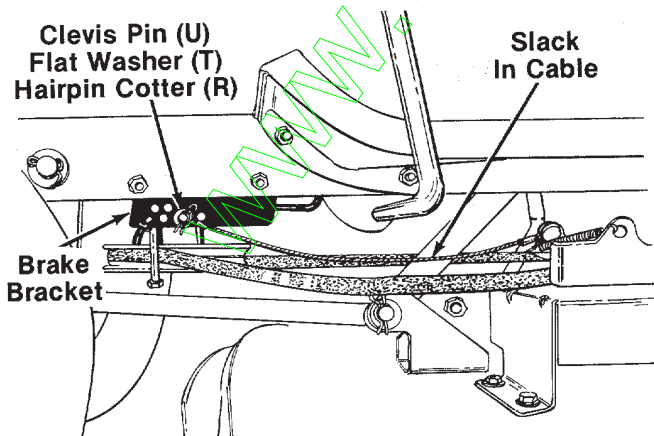

FIGURE 13.

9. Adjust the deck blade brake cable as follows (make certain engine is off).
 - a. Place the deck engagement lever in the disengaged position.
 - b. Pull the cable toward the front of the tractor and line it up with a hole in the brake bracket. Attach it to the bracket with clevis pin (U), flat washer (T) and hairpin cotter (R). There should be some slack in the cable as shown in figure 13.
 - c. Place the deck engagement lever in the engaged position. The brake cable should now be straight, and the brake pad should be pulled approximately 3/16" away from the deck pulley groove.

CONTROLS

THROTTLE CONTROL

The throttle control is used to regulate the engine speed and to activate the choke on the engine. To get maximum efficiency from cutting, the throttle should be in the FAST position when operating the mower. Pushing the throttle all the way forward past FAST, will choke the engine. See figure 14.

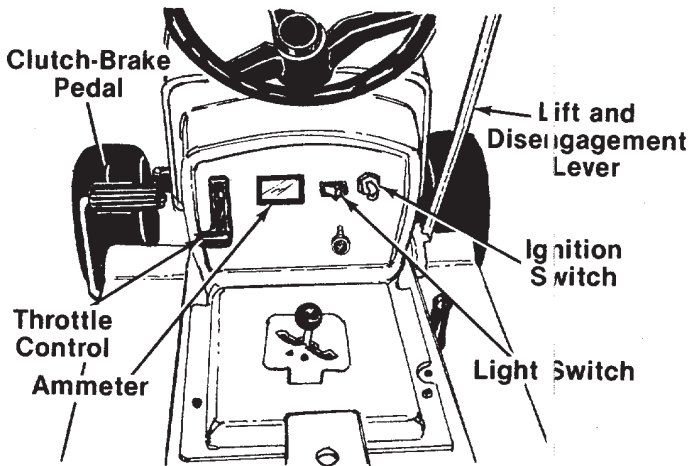

FIGURE 14.—Models 704 and 714 Shown

CHOKE CONTROL

The choke control is located on the dashboard and is operated manually. Details for the choke operation are covered in the separate engine manual packed with your unit. See figure 14.

GEAR SHIFT LEVER

The shift lever is located on the left side of the console and has three positions: "FORWARD," "NEUTRAL" and "REVERSE." See figure 14. The clutch-brake pedal must be depressed and the lawn tractor must not be moving when shifting gears. Do not force the shift lever. Release the clutch-brake pedal slightly to line up the shifting collar in the transmission. Then try to shift gears.

SPEED CONTROL LEVER

The speed control lever is located on the right fender. It allows you to regulate the ground speed of the lawn tractor. See figure 15. To select the ground speed, depress clutch pedal. Push speed control lever outward and move backward to slow lawn tractor, move forward to increase speed. When desired speed has been obtained, release lever in that position. Whenever clutch is engaged, unit will automatically go to the pre-set speed.

IGNITION SWITCH

Turn the key to the "START" position to start the engine. When the engine is running, let the key return to the "ON" position. To stop the engine, turn the key to the left to the "OFF" position and remove it to prevent accidental starting. See figure 14.

LIGHT SWITCH

Push the light switch to turn on the lights. The lights will only operate when the engine is running. See figure 14.

AMMETER

The ammeter registers the rate of battery charge or discharge. The ammeter will register on the discharging side when starting the engine. It should register on the opposite side (charging) when the engine is running in the fast position until the battery is completely charged. With a fully charged battery or with the engine idling, the ammeter will not show a charge. See figure 14.

CLUTCH-BRAKE PEDAL

The clutch-brake pedal is located on the left side of the lawn tractor. Depressing the clutch-brake pedal part way disengages the clutch. Pressing the pedal all the way down disengages the clutch and engages the disc brake. See figure 14.



The clutch-brake pedal must be depressed to start the engine.

PARKING BRAKE

The speed control lever is used to set the parking brake. To set the parking brake, depress the clutch-brake pedal. Press the speed control lever outward and all the way to the rear of the unit. Release the speed control lever and the clutch-brake pedal.

To release the parking brake, depress the clutch-brake pedal, press the speed control lever outward and move to desired position. Release the speed control lever and the clutch-brake pedal.

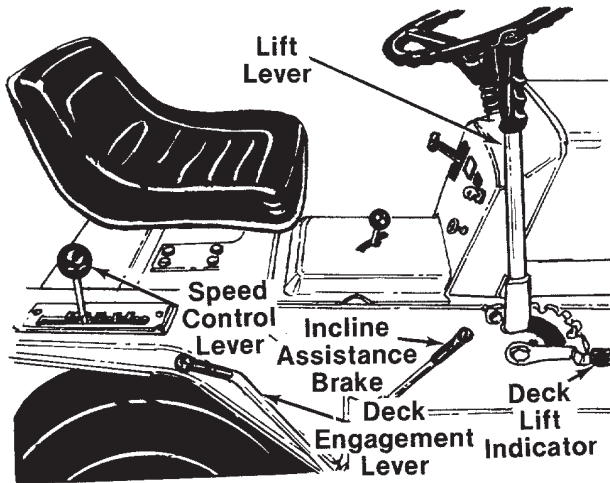

FIGURE 15.

INCLINE ASSISTANCE BRAKE

When stopping on a hill, hold the incline assistance brake lever back while you release the clutch-brake pedal until the lawn tractor begins to move, then release the lever. This lever permits smoother starts and clutch engagement by holding the tractor during the brake release/clutch engagement operation. See figure 15.

INTERLOCKS (Not Shown)

Interlock safety switches are located on the clutch-brake pedal, the blade engagement lever and gear shift lever.

Before the engine will start, the clutch-brake pedal must be depressed all the way and the blade engagement lever must be in the disengaged position.

Before the unit can be shifted into reverse, the blade engagement lever must be in the disengaged position.

LIFT LEVER

The lift lever is located on the right side of the unit. It is used to raise and lower the cutting deck and other attachments. Move the lever to the right, then forward or backward to the desired position and release. See figure 15.



When using the snow thrower attachment, the lift lever is also used to engage and disengage the spirals.

DECK LIFT INDICATOR

The deck lift indicator marks the position being used for the lift lever. Select the lift lever position desired, press the indicator lever outward, move it to the position immediately below the lift lever and release the indicator lever. See figure 15.

BLADE ENGAGEMENT LEVER

The blade engagement lever is located beside the right fender. Move the lever forward to engage the blades. Move it toward the rear of the unit to stop the blades from turning.

The blade engagement lever must be in the disengaged position before the engine can be started.

WHEEL HEIGHT ADJUSTER

Move the lever towards the wheel and set it in the desired height. See figure 16.

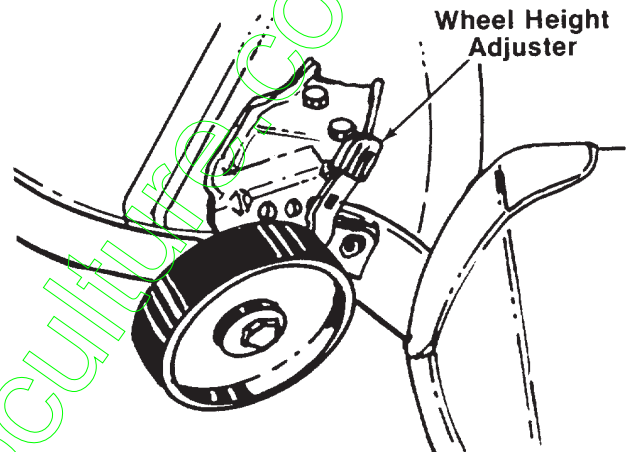

FIGURE 16.

SETTING THE CUTTING HEIGHT

1. Select the position for the lift lever which gives the desired cutting height. Move the deck lift indicator so that the lift lever can be returned to the same position after it is raised.
2. Set the wheel height adjusters on the deck so that the wheels are $\frac{1}{4}$ to $\frac{1}{2}$ inch above the ground.

OPERATION



1. Keep all shields in place.
2. Before leaving operator's position:
 - a. Shift transmission to neutral
 - b. Set parking brake
 - c. Disengage attachment clutch
 - d. Shut off engine
 - e. Remove ignition key
3. Wait for all movement to stop before servicing machine.
4. Keep people and pets a safe distance away from machine.
5. Look to the rear before backing up.

TIRE PRESSURE

For shipping purposes, the tires on your unit may be over-inflated. Tire pressure should be reduced before unit is put into operation. Recommended operating tire pressure should be 10 p.s.i.

Check sidewall of tire for manufacturer's maximum tire pressure. If this information does not appear on your tire, maximum tire pressure under any circumstances is 30 p.s.i. Equal tire pressure should be maintained on all tires.

STARTING THE ENGINE



To open the hood, simply lift up on both sides of the hood.

1. Service the engine with oil and gasoline as described in the engine manual.
2. Depress the clutch-brake pedal and set the parking brake.
3. Place the blade engagement lever in the DISENGAGED position. See figure 15.



This unit is equipped with a safety interlock system for your protection. The purpose of the safety interlock system is to prevent the engine from cranking or starting unless the clutch-brake pedal is depressed and the blade engagement lever is in the disengaged position. In addition, the blade engagement lever must be in the disengaged position when the unit is put into reverse or the engine will shut off.



WARNING

Do not operate the lawn tractor if the interlock system is malfunctioning because it is a safety device, designed for protection.

4. Set the throttle control in the "CHOKE" position. See figure 14.
5. Turn the ignition key to the "START" position. When the engine is running, let the key return to the "ON" position. See figure 14.
6. Move the throttle control to desired engine speed.

STOPPING THE ENGINE

Turn the ignition key to the left to the "OFF" position. Remove the key to prevent accidental starting.



A brief break-in period is essential to ensure maximum engine and mower life. The break-in consists of running the engine at half speed for a period of time required to use one tank of gasoline. It is also recommended to change crankcase oil after the first 5 hours of operation.

Be sure that the lawn is clear of stones, sticks, wire, or other objects which could damage lawn tractor or engine. For best results and to insure more even grass distribution, do not mow when lawn is excessively wet.



If you strike a foreign object, stop the engine. Remove wire from spark plug, thoroughly inspect the unit for any damage, and repair the damage before restarting and operating the mower.

OPERATING THE LAWN TRACTOR

1. Set the desired cutting height.
2. Start the engine as instructed in previous column.
3. Move throttle control to $\frac{3}{4}$ or full throttle to prevent strain on the engine and to operate the cutting blades.
4. Place the shift lever in either the "FORWARD" or "REVERSE" position.



CAUTION

Look to the rear before backing up.

5. Release the parking brake by depressing the clutch-brake pedal, pressing outward on the speed control lever and moving to desired position.



Use first speed position when operating the lawn tractor for the first time.

6. Release clutch-brake pedal slowly to put unit into motion.
7. The lawn tractor is brought to a stop by depressing the clutch-brake pedal.



CAUTION

If the unit is not to be used for a long period, place the gear shift lever in NEUTRAL, stop the engine, set the parking brake and remove the key. **DO NOT** leave the machine on an incline.

OPERATING THE CUTTING BLADES

The cutting blades may be engaged while the lawn tractor is moving or standing still. **DO NOT** engage the cutting blades abruptly as the sudden belt tension on the pulley may cause the engine to stall.



WARNING

When the blade drive is engaged, keep feet and hands away from the discharge opening, the blades or any part of the deck.

Move the blade engagement lever into the DISENGAGED position to disengage the blades.



NOTE

When the machine is used for other than mowing operations, the blade drive should be disengaged.

GRASS CATCHER Model 015 is available as optional equipment for the lawn tractor shown in this manual.



WARNING

The mower should not be operated without the entire grass catcher or chute deflector in place.



NOTE

Under normal usage bag material is subject to wear, and should be checked periodically. Be sure any replacement bag complies with the mower manufacturer's recommendations.

For replacement bags, use only factory authorized replacement bag.

ADJUSTMENTS

SEAT ADJUSTMENT

The seat may be adjusted to one of two positions. Refer to seat installation section of assembly instructions.



IMPORTANT

Do not use the last hole in the seat spring to avoid interfering with the fuel tank.

STEERING WHEEL ADJUSTMENT

There are four height positions for the steering wheel. To adjust the height of the steering wheel, remove the hairpin cotter and clevis pin on the steering shaft. Place the steering wheel in the position desired and secure with hairpin cotter and clevis pin. Refer to figure 6.

SPEED CONTROL ADJUSTMENT (See figure 17)

First, adjust the speed control lever by pushing the clutch-brake pedal forward until the stop on the speed control rod is against the running board rod. See figure 17. Have another person hold the pedal in this position as you make the following adjustment. Place the speed control lever in parking brake position. Remove the hairpin cotter and flat washer, and adjust the ferrule on the rod so it is against the back end of the slot. See figure 17. Replace the flat washer and hairpin cotter.

Next, adjust the speed control link as follows to obtain the correct neutral adjustment.

1. Start the engine.
2. Place the shift lever in Neutral position.
3. Place the speed control lever in high speed position.
4. Release the clutch-brake pedal completely, then slowly depress the pedal all the way (to park position). Hold the pedal in this position.
5. Turn the engine off.
6. After engine stops completely, release the clutch-brake pedal.
7. Position speed control lever as follows.
 - A. 7-speed units—Place speed control lever in second position.
 - B. 6-speed units—Place speed control lever between first and second position (hold in this position).

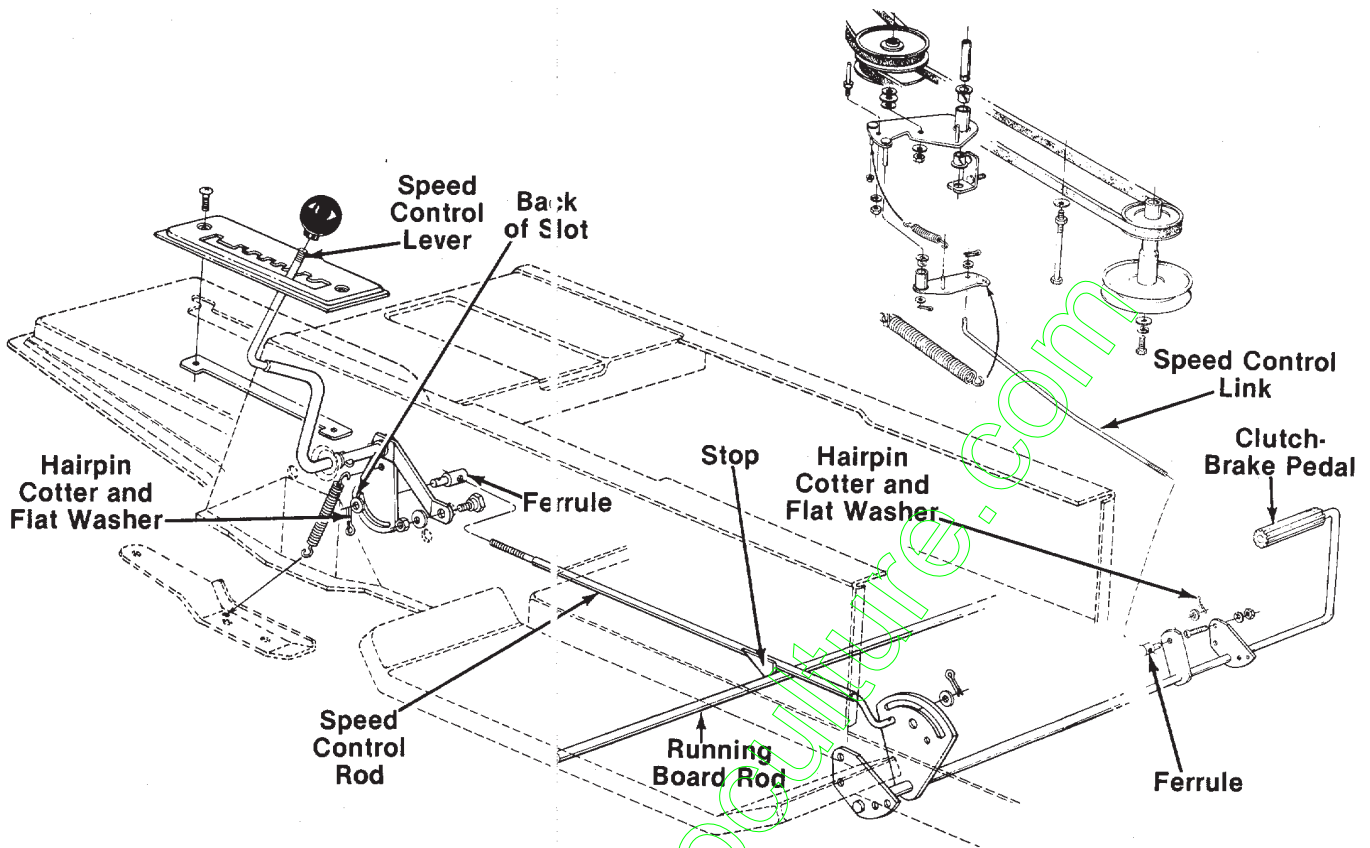

FIGURE 17.

- C. 4 and 5-speed units—Place speed control lever in first position.
8. Remove the hairpin cotter and flat washer from the ferrule on the speed control link.
9. Push the clutch-brake pedal backward by hand as far as it will go using light pressure and hold it in this position as you adjust the ferrule on speed control link to line up with the hole in clutch-brake pedal.
10. Secure with flat washer and hairpin cotter.

WHEEL ADJUSTMENT

The caster (forward slant of the king pin) and the camber (tilt of the wheels out at the top) require no adjustment. Automotive steering principles have been used to determine the caster and camber on the tractor. The front wheels should toe in 1/8 inch.

To adjust the toe-in, follow these steps.

1. Remove the hex nut and lock washer, and drop the tie rod end from the wheel bucket. See figure 18.

2. Loosen the hex jam nut on tie rod.
3. Adjust the tie rod assembly for correct toe-in.

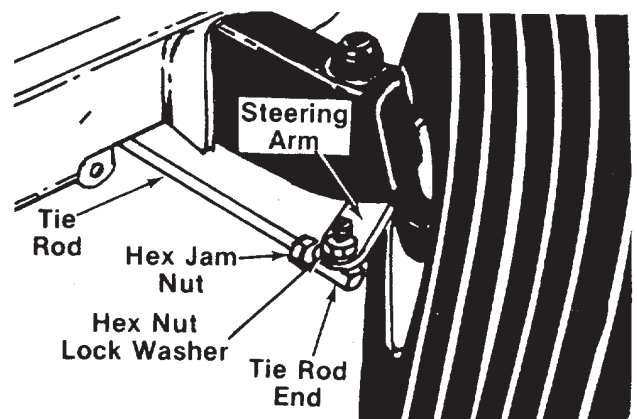

FIGURE 18.

Dimension "B" should be approximately 1/8" less than Dimension "A." See figure 19.

- A.) To increase Dimension "B," screw tie rod into tie rod end.

- B.) To decrease Dimension "B," unscrew tie rod from tie rod end.
- C.) Reassemble tie rod. Check dimensions. Readjust if necessary.

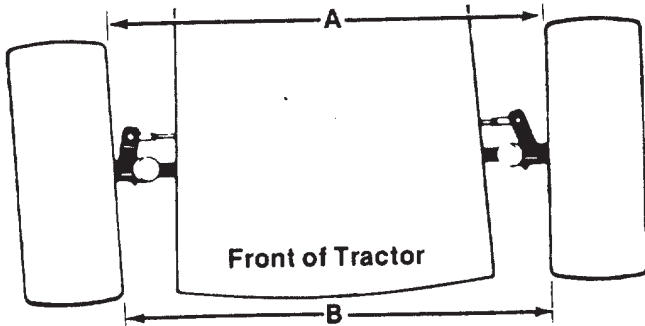

FIGURE 19. TOE-IN DIAGRAM

CARBURETOR ADJUSTMENT



If any adjustments are made to the engine while the engine is running (e.g. carburetor), disengage all clutches, and blades. Keep clear of all moving parts. Be careful of heated surfaces and muffler.

Minor carburetor adjustment may be required to compensate for differences in fuel, temperature, altitude and load. To adjust the carburetor, refer to the separate engine manual packed with your unit.

BRAKE ADJUSTMENT (See figure 20)

The brake is located by the right rear wheel inside the frame. During normal operation of this machine, the brake is subject to wear and will require periodic examination and adjustment.



Do not have the engine running when you adjust the brake.

To adjust the brake, remove the cotter pin. Adjust the castle nut so the brake starts to engage when the brake lever is $\frac{1}{4}$ " to $\frac{5}{16}$ " away from the axle housing.



Figure 20 is shown with the unit tipped up on rear wheels for clarity only.

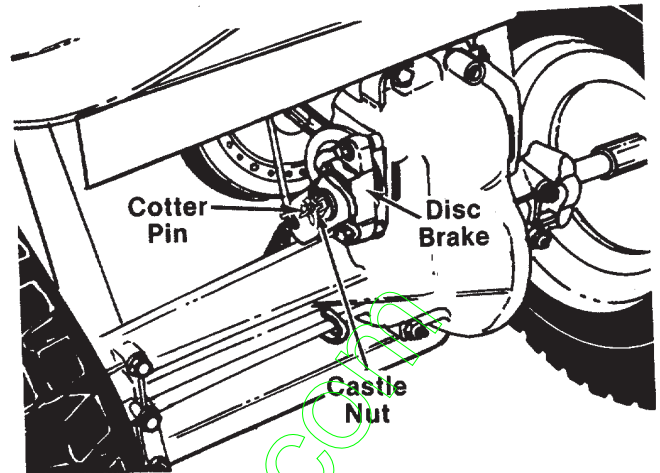

FIGURE 20. DECK ADJUSTMENT LINK

If an uneven cut is obtained, the deck may be adjusted. An adjustable lift link assembly is located on the left side of the unit. Refer to Ref. Nos. 20, 21 and 22 on page 32.

To adjust the deck, loosen the two hex nuts on the adjustable link lift assembly. Thread the hex nuts up or down the adjustable link lift assembly as necessary. Retighten the hex nuts.

LUBRICATION



Always stop engine and disconnect spark plug wire before cleaning, lubricating or doing any kind of work on lawn tractor.

STEERING GEARS

Lubricate teeth of steering gears with automotive multi-purpose grease after every 25 hours of operation or once a season. See figure 21.

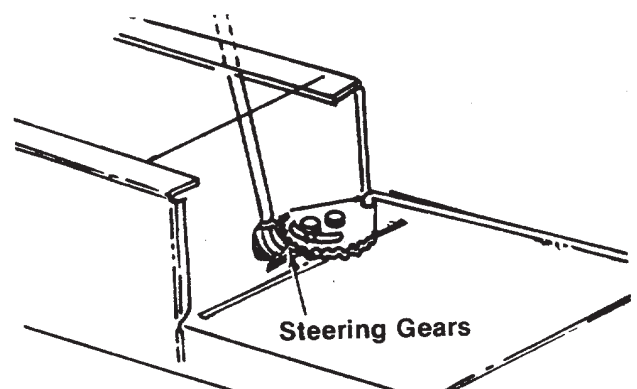

FIGURE 21. STEERING SHAFT

Lubricate steering shaft at least once a season with light oil.

TRANSAXLE

The transaxle is lubricated and sealed at the factory and does not require checking. If disassembled for any reason, lubricate with 10 oz. of grease, part number 737-0148.

FRONT WHEELS

The front wheels are provided with grease fittings. Lubricate at least once a season with automotive multi-purpose grease.

PIVOT POINTS

Lubricate all pivot points with light oil at least once a season.

MAINTENANCE



WARNING

Disconnect the spark plug wire and ground against the engine before performing any repairs or maintenance.

CRANKCASE OIL

Check the oil level in the crankcase before each use of the machine and after every five hours of operation. Oil level should be maintained as instructed in the separate engine manual.

After the first five hours of operating a new engine, drain the oil from the crankcase while engine is still hot and refill crankcase with new oil; thereafter change the oil every 25 hours of operation. Refer to the engine manual.

AIR CLEANER

Under normal operating conditions, the air cleaner, located on top of the carburetor, must be serviced after every ten hours of use. Under extremely dusty operating conditions, the air cleaner must be serviced after every hour of operation. To service the air cleaner, refer to the separate engine manual packed with your unit.

CLEANING ENGINE AND BLADE HOUSING

Any fuel or oil spilled on the machine should be wiped off promptly. Grass, leaves, and other dirt must not be left to accumulate around the cooling fins of the engine or on any part of the machine.

Clean the underside of the blade housing after each mowing.

SPARK PLUG

The spark plug should be cleaned and the gap reset once a season. Spark plug replacement is recommended at the start of each mowing season; check engine manual for correct plug type and gap specification.

CUTTING BLADES

A. Removal for Sharpening or Replacement



WARNING

Be sure to disconnect and ground the spark plug wire and remove ignition key before working on the cutting blades to prevent accidental engine starting.

1. Remove the large bolt and lock washer which holds the blade and adapter to the blade spindle.
2. Remove the blade and adapter from the spindle. Be careful not to lose the key on the spindle.
3. If the blade or blade adapter needs replacing, remove the two small bolts, lock washers and nuts which hold the blade to the adapter.

B. Sharpening

Remove the cutting blade by following the directions of the preceding section.

When sharpening the blade, follow the original angle of grind as a guide. It is **extremely important** that each cutting edge receives an equal amount of grinding to prevent an unbalanced blade. An unbalanced blade will cause excessive vibration when rotating at high speeds, may cause damage to the mower and could break, causing personal injury.

The blade can be tested for balance by balancing it on a round shaft screwdriver. Remove metal from the heavy side until it balances evenly.



NOTE

It is recommended that the blade always be removed from the adapter for the best test of balance.

C. Reassembly

Before reassembling the blade and the blade adapter to the unit, lubricate the spindle and the inner surface of the blade adapter with light oil. Lubricating the bolt holes, bolts and inner surface of the nuts with light oil is also recommended. A 4 oz. plastic bottle of light oil lubricant is available. Order part number 737-0170. Engine oil may also be used.

When replacing the blade, be sure to install the blade with the side of the blade marked "Bottom" (or with part number) facing the ground when the mower is in the operating position. Make certain key is in place on the blade spindles.

Blade Mounting Torque

3/8" Dia. Bolt 375 in. lb. min., 450 in. lb. max.

5/16" Dia. Bolt 150 in. lb. min., 250 in. lb. max.

To insure safe operation of your unit, ALL nuts and bolts must be checked periodically for correct tightness.

Blade Spindle Nuts

If disassembled for any reason, tighten the blade spindle nuts for the 22" blades to between 80 and 100 foot pounds. Tighten the blade spindle nut for the smaller center blade to between 40 and 45 foot pounds.

FUEL FILTER

Your unit is equipped with a replaceable in-line fuel filter. Replace filter whenever contamination or discoloration is noticed. Order replacement filter through your engine authorized service dealer.

BELT REMOVAL AND REPLACEMENT



WARNING

Disconnect the spark plug wire and ground it against the engine. Block the wheels of the unit.



NOTE

Figures 24 through 25 are shown with the unit tipped up for clarity. It is not necessary to tip the unit to remove the belts.

Deck Belts

1. Remove the deck. Refer to Attaching the Deck section of Assembly Instructions, and follow instructions in reverse order.
2. Remove the belt guard by unhooking the spring and removing two self-tapping screws. See figure 22.
3. Remove the first drive belt.
4. Remove both the right and left hand pulley covers by removing the self-tapping screws.
5. Pivot the spring-loaded idler, and lift belt off.
6. Remove the belt from around the three deck pulleys.
7. Reassemble in reverse order.

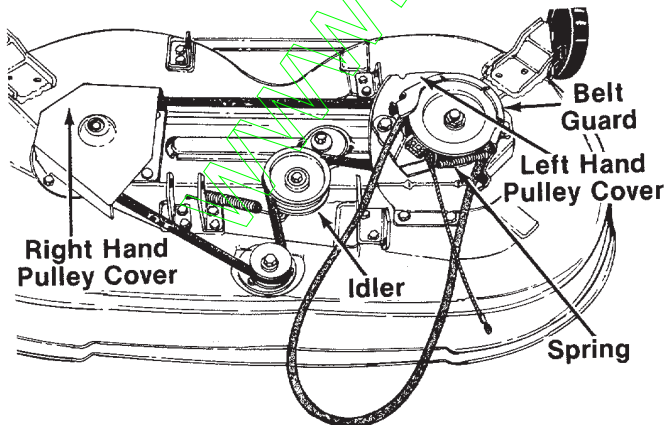

FIGURE 22.

Rear Drive Belt

1. Remove the two truss head screws which secure the transmission cover.
2. Lift the transmission cover. Unplug the green safety wire from beneath the transmission cover. Remove transmission cover.
3. Push the idler pulley toward the right side of the unit. Lift the belt over the idler pulley. See figure 23.
4. Remove the belt from the variable speed pulley.
5. Remove the two bolts which hold the shift lever bracket to the frame on the left side of the unit. Swing the bracket toward the right so the belt can be removed from the transmission pulley. See figure 23.
6. Replace belt, and reassemble in reverse order.

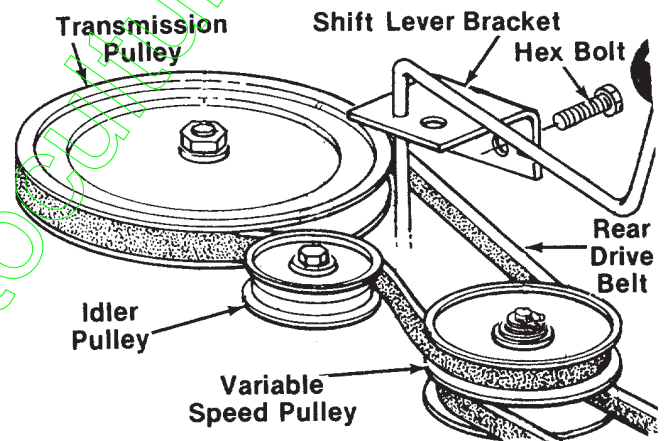

FIGURE 23.

Front Drive Belt

1. To remove the front drive belt, first remove the rear drive belt from the idler pulley and variable speed pulley.
2. Place the lift lever in the disengaged position.
3. Remove the two hex bolts (belt keepers) from the engine pulley, belt guard. Refer to figure 10.



NOTE

Make certain hex bolts are reassembled as shown in figure 10.

4. Unhook the deck belt from the engine pulley.
5. Remove the two bolts, lock washers and nuts on each side of the frame which hold the engine pulley belt guard to the frame. See figure 24.

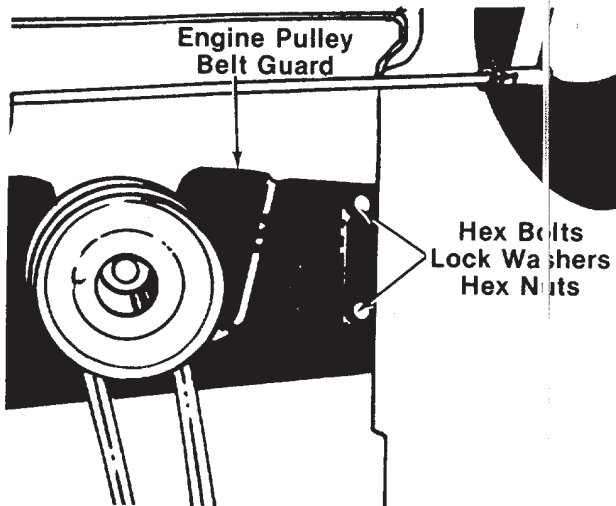

FIGURE 24.

6. Remove the engine pulley belt guard by slipping it back and to the right. See figure 25.

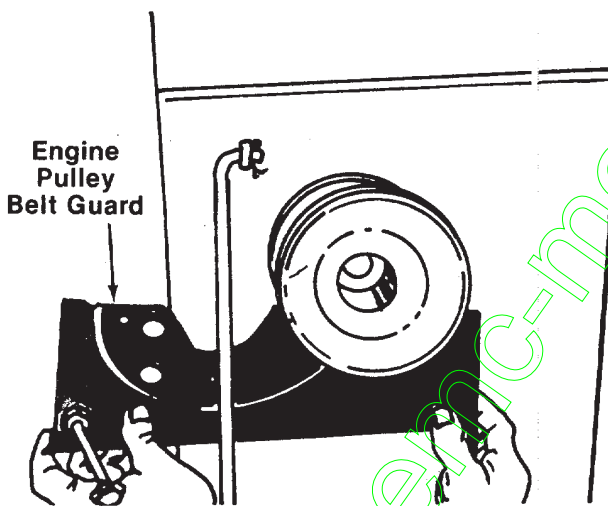

FIGURE 25.

7. Place the clutch-brake pedal in park position.
8. Push forward on the variable speed pulley, and lift the belt off the engine and remove the belt from the engine pulley.
9. Release the clutch-brake pedal. Using the pedal to move the variable speed pulley as necessary, lift the belt up and off the variable speed pulley.



When reassembling, make certain belt is inside the pins. See figure 26.

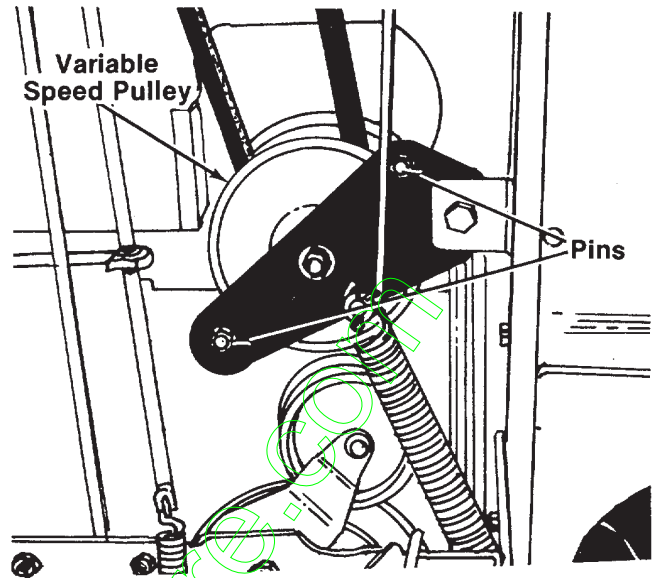

FIGURE 26.

10. Reassemble with a new belt, following instructions in reverse order.

BATTERY REMOVAL OR INSTALLATION



WARNING

When removing the battery, follow this order of disassembly to prevent the screwdriver from shorting against the frame.

1. Remove the Negative cable.
2. Remove the Positive cable.

To install a battery:

1. Attach the Positive cable.
2. Attach the Negative cable.

JUMP STARTING

1. Attach the first jumper cable from the Positive terminal of the good battery to the Positive terminal of the dead battery.
2. Attach the second jumper cable from the Negative terminal of the good battery to the **FRAME OF THE UNIT WITH THE DEAD BATTERY.**



WARNING

Failure to use this starting procedure could cause sparking, and the gas in either battery could explode.

BATTERY MAINTENANCE

1. Check periodically (every two weeks or before and after charging) to be sure electrolyte level is above the lowest line on battery. Add only distilled water or a good quality drinking water. NEVER add additional acid or other chemicals to battery after initial activation.
2. The battery should be checked with a hydrometer after every 25 hours of operation. If the specific gravity is less than 1.225, remove battery and recharge.
3. Coat the terminals and exposed wiring with a thin coat of grease or petroleum jelly for longer service and protection against electrolyte corrosion.
4. The battery should be kept clean. Any deposits of acid should be neutralized with soda and water. Be careful not to get this solution in the cells.

BATTERY STORAGE

1. Charge battery using normal methods. NEVER store discharged battery as it will not recover.
2. When storing battery for extended periods, disconnect battery cables. Removing battery from unit is recommended.
3. Store in cold, dry place.
4. Recharge battery whenever the specific gravity is less than 1.225, before returning to service, or every two months, whichever occurs first.

COMMON CAUSES FOR BATTERY FAILURE ARE:

1. Overcharging
2. Undercharging
3. Lack of water
4. Loose holds downs and/or corroded connections
5. Excessive loads
6. Battery electrolyte substitutes
7. Freezing of electrolyte



NOTE

THESE FAILURES DO NOT CONSTITUTE WARRANTY.

INSTALLATION OF TIRE TO RIM



The following procedure must be followed when removing or installing a tire to the rim.

1. Be sure rim is clean and rust free.
2. Lubricate both the tire and rim generously.
3. Never inflate to over 30 p.s.i. to seat beads. Excessive inflation pressure when seating beads may cause tire/rim assembly to burst with force sufficient to cause serious injury.

OFF-SEASON STORAGE

If the machine is to be inoperative for a period longer than 30 days, prepare for storage as follows.

1. Clean the engine and the entire unit thoroughly.
2. Lubricate all lubrication points. Wipe the entire machine with an oiled rag to protect the surfaces.
3. Refer to the engine manual for correct engine storage instructions. The engine must be completely drained of fuel to prevent gum deposits from forming on essential carburetor parts, fuel lines and fuel tanks.
4. Refer to battery storage instructions in previous column.
5. Store unit in a clean, dry area.



NOTE

When storing any type of power equipment in an unventilated or metal storage shed, care should be taken to rustproof the equipment. Using a light oil or silicone, coat the equipment, especially any chains, springs, bearings and cables.

TROUBLE SHOOTING CHART FOR ELECTRIC START MODELS

TROUBLE	LOOK FOR	REMEDY
Engine will not crank	Battery installed incorrectly	The battery must be installed with the negative, identified at the terminal post by (Neg, N or -), grounded. The positive (Pos, P or +) attaches to the large cable from the solenoid. The small red wire from the fuse holder or circuit breaker is also attached to the positive terminal.
	Blown fuse or circuit breaker	Replace fuse with 7½ amp. fuse ¼ x 1¼" lg. Circuit breaker will reset itself when it cools off. Fuses or circuit breakers seldom open or fail without a reason. The problem must be corrected. Check for loose connections in the fuse holder. Replace fuse holder if necessary. A dead short may be in the cranking or charging circuit where the insulation may have rubbed through and exposed the bare wire. Replace the wire or repair with electrician's tape if the wire strands have not been damaged. Note: Look for a wire pinched between body panels, burned by the exhaust pipe or muffler or rubbed against a moving part.
	Battery is dead or weak	<p>Use a hydrometer to check the condition of the battery. The Specific Gravity (s.g.) should be 1.265 at 80° F. (1.215 s.g. minimum needed for cranking engine). The reason for the battery failing must be determined. (1) Defective battery. Battery will not accept or hold a full charge. (2) Short circuit. Check for grounded wire. (3) Charging system not working, either engine alternator or trickle charger.</p> <p>Trickle Charger. Check with multimeter. Charger 725-0578—input 120 V A.C., no load output 13.5 V D.C., rated load current 1 amp. Charger 725-0507—input 120 V A.C., no load output 17.4 V D.C., rated load current 1/2 amp.</p> <p>Alternator (dual or single circuit) The charging system is an alternator located under the flywheel. It is unregulated and rated 3 amp. at 3600 r.p.m. A diode (rectifier) is located in the output lead just before the wire harness plug on the engine side.</p> <div style="text-align: center;"> <p>The diagram illustrates the electrical connection between the alternator and the battery/lights. A red wire runs from the alternator through a diode and a shrink tube to a polarized plug. The plug has two terminals: a 3 AMP DC terminal for the battery and a 7 AMP AC terminal for the lamps. A black wire is also connected to the alternator.</p> </div> <p>The diode changes A.C. to D.C. to charge the battery. A bad diode can either fail to charge the battery or discharge the battery if the alternator is shorted as well as the diode. To test: (1) Disconnect charger lead from the battery (small red wire). (2) Connect 12 V small test lamp between the 3 amp. D.C. charge lead and the positive terminal of the battery. (3) With the engine off, the lamp should not light. If it does, the diode and possibly the alternator should be replaced. (4) Start the engine. The lamp should light. If it does not, the alternator (stator) or lead wire is bad and should be replaced.</p>
Mechanical failure. (Wires and switches)	The interlock system includes two mechanical activated switches which are wired in series in the circuit used to energize the starter solenoid. While testing the interlock system, you will make the mower temporarily unsafe by permitting the engine to be started with the blade and clutch engaged. WARNING: While testing, disengage the clutch, shut off the blade control, set the parking brake and place the gear shift lever in neutral. Attach a wire (minimum 18 gauge) to the positive terminal of the battery and touch the other end to the small terminal on the solenoid. If the engine does not crank: (1) There is a loose connection or poor ground. (2) The solenoid may be bad. The solenoid can be checked by using a heavy wire (#8 gauge minimum) and jumping between the two large terminals. If the engine cranks, the solenoid is bad. (3) If the engine does not crank when you jump the solenoid, have the starter motor tested by an authorized engine dealer. If the engine does crank, the problem is with one of the safety switches, ignition switch or the wire between the fuse holder (or circuit breaker) and the small terminal on the solenoid. Note: Look for a poor connection at the switches or a defective switch. Replace if necessary.	
Engine cranks but will not start	Throttle or choke not in starting position	Check owner's guide for correct position for throttle control and choke (if separate control) for starting.

TROUBLE SHOOTING CHART FOR ELECTRIC START MODELS

TROUBLE	LOOK FOR	REMEDY
	No spark to spark plug	Spark plug lead disconnected. Connect lead. Hold spark plug lead away from engine block about 1/8". Crank engine. There should be a spark. If not, have engine repaired at authorized engine service dealer. Faulty spark plug. To test, remove spark plug. Attach spark plug lead to spark plug. Ground the spark plug body against the engine block. Crank the engine. The spark plug should fire at the electrode. Replace if it does not.
	No fuel to the carburetor	Gasoline tank empty. Fill. Fuel valve shut off. Open valve. Valve is located either at the bottom of the fuel tank or on the carburetor. Fuel line plugged. Remove and clean.
	Air filter dirty	If the air cleaner is dirty, the engine may not start. Clean or replace as recommended by the engine manufacturer.
Engine smokes	Engine loses crankcase vacuum	Dipstick not seated or broken. Replace defective part. Engine breather defective. Replace.
Excessive vibration	Bent or damaged blade spindle	Stop engine immediately. Check all pulleys, blade adapters, keys and bolts for tightness and damage. Tighten or replace any damaged parts.
	Bent blade	Stop engine immediately. Replace damaged blade. Only use original equipment blades.
Mower will not discharge grass or leaves uncut strips	Engine speed low Transmission selection Blades short or dull	Throttle must be set between 3/4 and full throttle. Use lower transmission gear. The slower your ground speed, the better the quality of cut. Sharpen or replace blades (uncut strip problem only).

Models 704 and 714

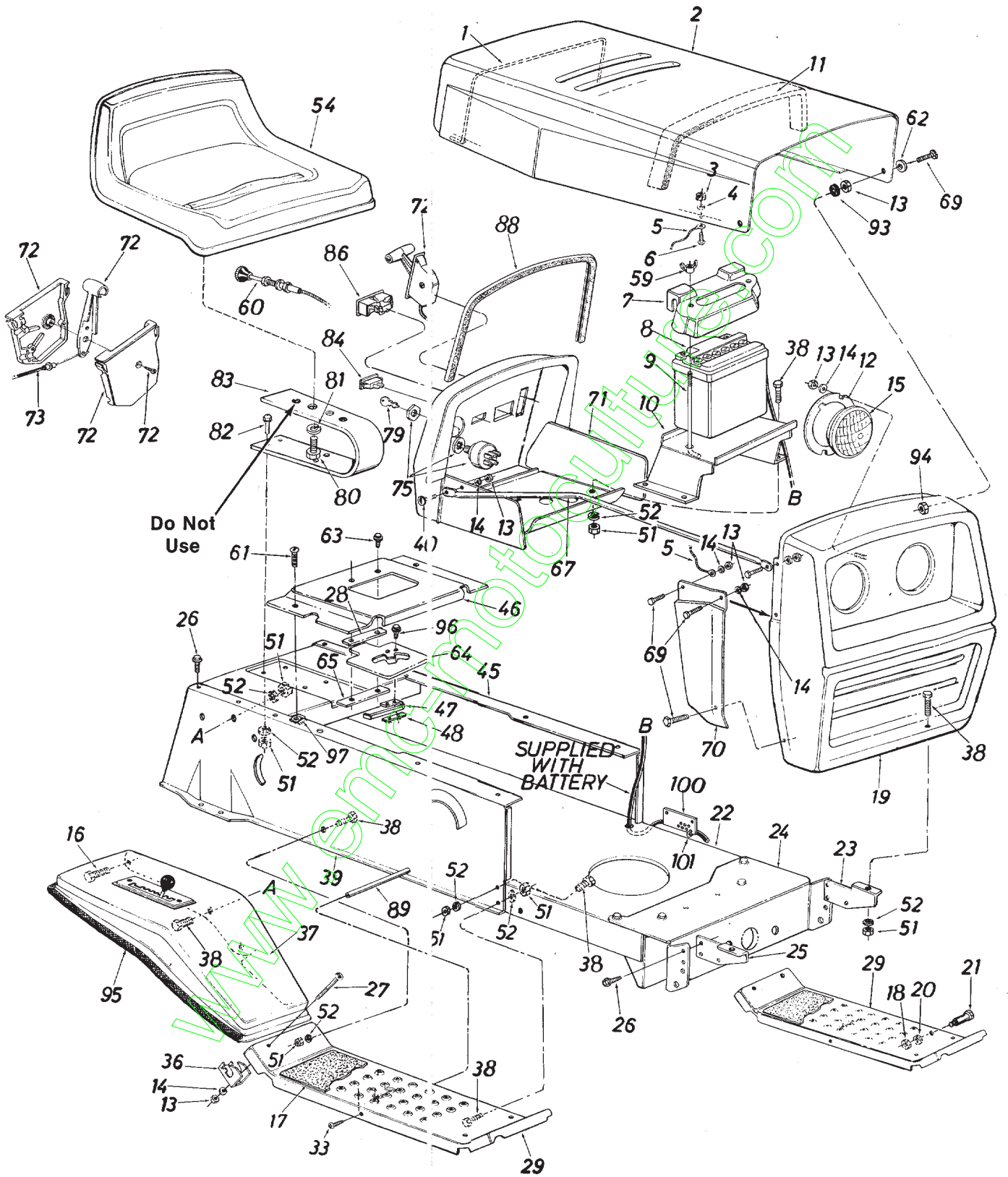

Models 704 and 714

PARTS LIST FOR MODELS 704 AND 714 LAWN TRACTORS

REF. NO.	PART NO.	COLOR CODE	DESCRIPTION	NEW PART	REF. NO.	PART NO.	COLOR CODE	DESCRIPTION	NEW PART
1	732-0477		Hood Spring		47	725-0759		Reverse Safety Switch	
2	16207		Hood		48	726-0222		Insulator Nut Plate	
3	712-0272		Hex Sems Nut #10-24 Thd.*		50	14607		Hitch Plate	
4	736-0463		FI-Wash. .281" I.D. x .62" O.D. x .051		51	712-0267		Hex Nut 5/16-18 Thd.*	
5	723-0302		Hood Stop 7" Lg.		52	736-0119		L-Wash. 5/16" I.D.*	
6	710-0473		Truss Hd. Scr. #10-24 x 1/2"*		54	757-0309		Seat Ass'y.	N
7	731-0707		Battery Cover		59	712-0113		Wing Nut 1/4-20 Thd.—Plastic	
8	725-0453		12 Volt Battery		60	746-0394		Choke Control	
9	711-0222		Battery Hold Down Rod		61	710-0351		Truss Mach. Tap Scr. #10 x .50" Lg.	
10	12747		Battery Bracket		62	736-0463		FI-Wash. .296 I.D. x .62 O.D.	
11	722-0138		PVC Foam—Strip		63	710-0924		Truss Mach. Scr. 1/4-20 x .75" Lg.	
12	09960		Headlight Retainer		64	16908		Gear Selection Plate	N
13	712-0287		Hex Nut 1/4-20 Thd.*		65	16190		Clamping Plate	N
14	736-0329		L-Wash. 1/4" I.D.*		66	16190		Grille Support Rod—L.H.	N
15	725-0222		Headlight		67	749-0673		Grille Support Rod—R.H.	N
16	710-0653		Hex Wash. Hd. Tap Scr. 1/4 x 3/8" Lg.		69	710-0255		Truss Hd. Scr. 1/4-20 x .75" Lg.*	N
17	723-0360		Foot Pad		70	14748		R.H.—Grille Side Panel	
18	712-0798		Hex Nut 3/8-16 Thd.*		71	14749		L.H.—Grille Side Panel	
19	14781		Grille Ass'y.		72	15933		Dash Panel Ass'y.	
20	736-0169		L-Wash. 3/8" I.D.*		73	831-0692		Throttle Control Box Ass'y.	
21	738-0145		Shld. Bolt .50" Dia. x .84		74	746-0504		Throttle Control Wire	716-0503
22	14606		Lower Frame		75	725-0267		Ignition Switch	38" Lg.
23	13863		Grille Mount Brkt.—L.H.		79	725-0201		Ignition Key	
24	14619		Front Pivot Brkt.		80	710-0493		Hex Bolt 1/2-13 x 1.00" Lg. (2-Req'd.)	
25	13862		Grille Mount Brkt.—R.H.		81	736-0921		L-Wash. 1/2" I.D.*	
26	710-0726		Hex Wash. Hd. AB-Tap Scr. 5/16 x .75" Lg.		82	710-0376		Hex Bolt 5/16-18 x 1.00" Lg.*	
27	710-0524		Truss Hd. Scr. 1/4-20 x 1.75" Lg.*		83	732-0458		Seat Spring 5.5" High	
28	16407		Spacer Plate	N	84	725-0634		Light Switch	
29	14604		Running Board (R.H. & L.H.)		86	725-0925		Ammeter	
33	710-0323		Truss Mach. Scr. 5/16-18 x .75" Lg.*		88	731-0511		Molding Strip 27" Lg.	
36	14671		Fender Clamp		89	738-0526		Running Board Rod	
37	16197		Fender (R.H.)—Used w/Side Discharge Deck	N	92	710-0599		Thread Rolling Scr. 1/4-20 x .50" Lg.	
	14666		Fender (L.H.)—Used w/Side Discharge Deck		93	735-0144		Rubber Wash. 1/2" I.D. x 1.0 O.D. x .25"	
	16198		Fender (R.H.)—Used w/Rear Discharge Deck	N	94	712-0324		Hex Sems Ins. L-Nut 1/4-20 Thd.	
	15350		Fender (L.H.)—Used w/Rear Discharge Deck		95	731-0516		Trim Strip	
38	710-0118		Hex Bolt 5/16-18 x .75" Lg.*		96	710-0227		Hex Wash. Hd. AB-Tap Scr. #8 x .50" Lg.	
39	14602		R.H. Side Frame		97	726-0139		Speed Nut #10Z	
40	710-0258		Hex Bolt 1/4-20 x .62" Lg.*		100	16371		Brake Cable Bracket	
45	14603		L.H. Side Frame		101	726-0197		Cable Tie	
46	16188		Shift Cover	N					

†Used with Grille Assembly Ref. No. 18

††Used with Grille Assembly Ref. No. 19

(462—Red Flake)

*For faster service obtain standard nuts, bolts and washers locally. If these items cannot be obtained locally, order by part number and size as shown on parts list.

When ordering parts, if color or finish is important use the appropriate color code shown above. (e.g. Red Flake Finish—11836 (462).)

Models 705 and 715

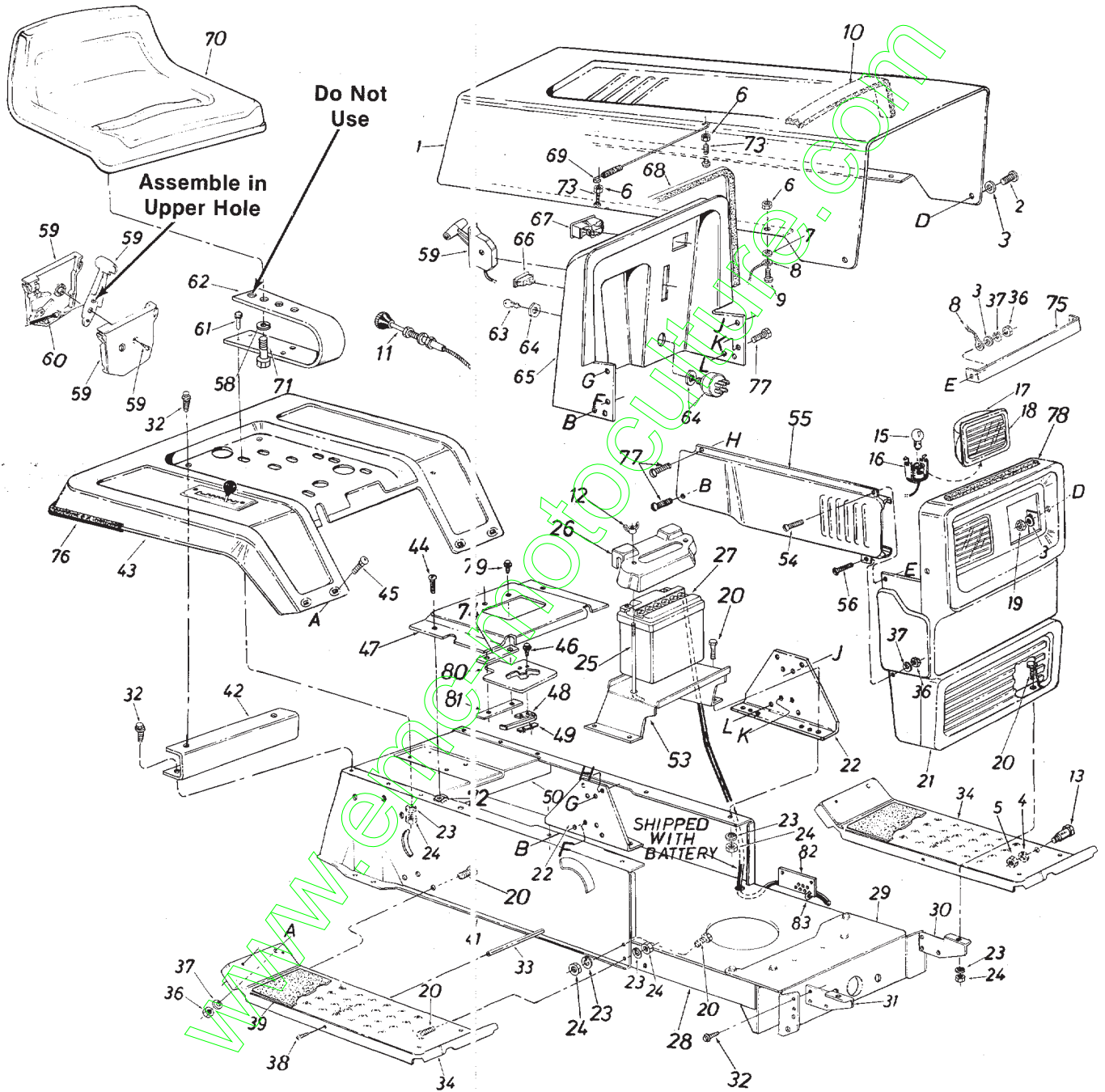

Models 705 and 715

PARTS LIST FOR MODELS 705 AND 715 LAWN TRACTORS

REF. NO.	PART NO.	COLOR CODE	DESCRIPTION	NEW PART	REF. NO.	PART NO.	COLOR CODE	DESCRIPTION	NEW PART
1	15808		Hood		45	710-0167		Carriage Bolt 1/4-20 x .50" Lg.*	
2	710-0258		Hex Scr. 1/4-20 x .62" Lg.*		46	710-0473		Truss Hd. Scr. #10-24 x .50" Lg.*	
3	736-0463		Fl-Wash. .296" I.D. x .62" O.D.		47	16188		Transmission Panel	N
4	736-0169		L-Wash. 3/8" I.D.*		48	725-0759		Reverse Safety Switch	
5	712-0798		Hex Nut 3/8-16 Thd.*		49	726-0222		Insulator Nut Plate	
6	712-0272		Hex Sems Nut #10-24 Thd.*		50	14607		Hitch Plate	
7	736-0931		Fl-Wash. .203" I.D. x .41" O.D. x .040		51	14603		L.H. Side Frame	
8	727-0290		Hood Stop		53	12747		Battery Bracket	
9	710-0473		Truss Hd. Scr. #10-24 x 1/2" Lg.*		54	710-0255		Truss Hd. Scr. 1/4-20 x .75" Lg.*	
10	722-0138		PVC Foam		55	15814		Side Cover—R.H.	
11	746-0394		Choke Control			15815		Side Cover—L.H. (Not Shown)	
12	712-0113		Wing Nut 1/4-20 Thd.—Plastic		56	710-0286		Truss Mach. Scr. 1/4-20 x .50" Lg.*	
13	738-0145		Shld. Bolt .50" Dia. x .84		58	736-0921		L-Wash. 1/2" I.D.*	
15	725-0963		Lamp		59	831-0692		Throttle Control Box Ass'y.	
16	725-0964		Socket		60	746-0500	26"	Throttle Control Wire	746-0503-38
17	731-0705		Headlight Housing		61	710-0376		Hex Bolt 5/16-18 x 1.00" Lg.*	
18	731-0706		Lens		62	732-0458		Seat Spring 5.5" High	
19	712-0107		Hex L-Nut 1/4-20 Thd.		63	725-0201		Ignition Key	
20	710-0118		Hex Bolt 5/16-18 x .75" Lg.*		64	725-0267		Ignition Switch	
21	15804		Grille		65	15810		Dash Panel	
22	15818		Dash Support Bracket		66	725-0634		Light Switch	
23	736-0119		L-Wash. 5/16" I.D.*		67	725-0925		Ammeter	
24	712-0267		Hex Nut 5/16-18 Thd.*		68	731-0511		Trim Strip—27"	
25	711-0222		Battery Hold Down Rod		69	732-0462		Hood Spring	
26	731-0707		Battery Cover		70	757-0309		Seat Ass'y.	N
27	725-0453		12 Volt Battery		71	710-0493		Hex Bolt 1/2-13 x 1.0" Lg. (2 Req'd.)	
28	14606		Lower Frame		72	726-0139		Speed Nut #10Z	
29	14619		Front Pivot Brk't.		73	710-0749		Hex Scr. #10-24 x 1.0" Lg.	
30	15821		Grille Mount Brk't.—L.H.		74	16407		Spacer Plate	N
31	15822		Grille Mount Brk't.—R.H.		75	15931		Tie Strap—Grille/Side Panel	
32	710-0726		Hex Wash. Hd. AB Tap Scr. 5/16 x .75" Lg.		76	731-0511		Trim Strip—81"	
33	738-0526		Running Board Rod		77	710-0642		Hex Wash. Hd. Tap Scr. 1/4 x .75" Lg.	
34	14604		Running Board (R.H. & L.H.)		78	722-0155		Foam Strip 3/8 x 1 x 14" Lg.	
36	712-0287		Hex Nut 1/4-20 Thd.*		79	710-0924		Truss Mach. Scr. 1/4-20 x .75" Lg.	
37	736-0329		L-Wash. 1/4" I.D.*		80	16408		Gear Selection Plate	N
38	710-0323		Truss Mach. Scr. 5/16-18 x .75" Lg.*		81	16190		Clamping Plate	N
39	723-0360		Foot Pad		82	16371		Brake Cable Bracket	
41	14602		R.H. Side Frame		83	726-0157		Cable Tie	
42	15848		Fender Mount Brace						
43	16221		Rear Fender						
44	710-0351		Truss Mach. Tap Scr. #10 x .50" Lg.						

*For faster service obtain standard nuts, bolts and washers locally. If these items cannot be obtained locally, order by part number and size as shown on parts list.

(462—Red Flake)

When ordering parts, if color or finish is important use the appropriate color code shown above. (e.g. Red Flake Finish—11836 (462).)



This instruction manual covers various models, and all specifications shown do not necessarily apply to your model. Specifications subject to change without notice or obligation.

Models 704, 705, 714 and 715

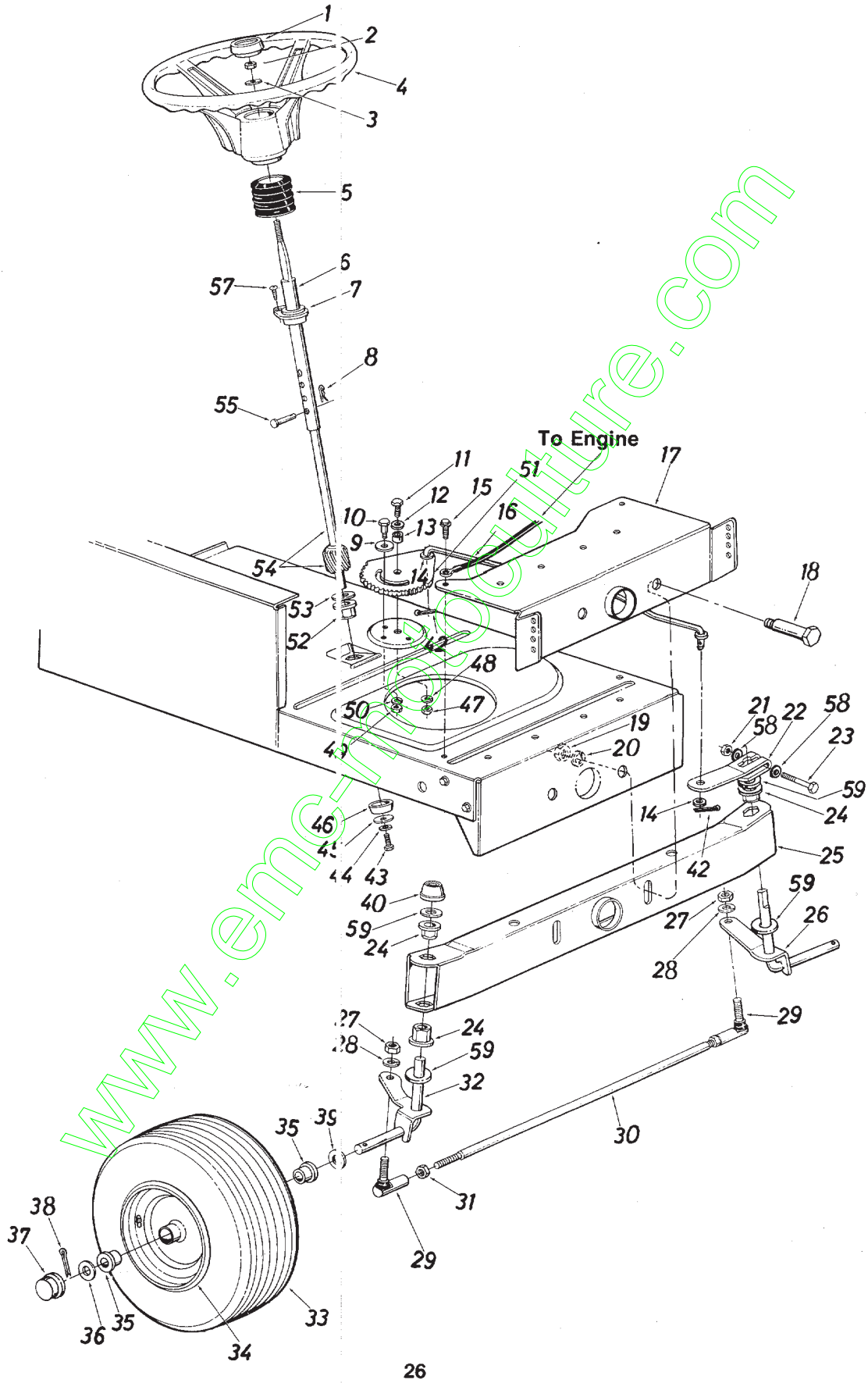

Models 704, 705, 714 and 715

PARTS LIST FOR MODELS 704, 705, 714 AND 715 LAWN TRACTORS

REF. NO.	PART NO.	COLOR CODE	DESCRIPTION	NEW PART	REF. NO.	PART NO.	COLOR CODE	DESCRIPTION	NEW PART
1	731-0220		Steering Wheel Cap		30	711-0613		Tie Rod	
2	712-0267		Hex Nut 5/16-18 Thd.*		31	712-0711		Hex Jam Nut 3/8-24 Thd.*	
3	736-0242		Belleville Wash. .345" I.D.		32	15840		Front Axle Ass'y.—R.H.	
4	731-0219		Steering Wheel 12" Dia.		33	**		Wheel Ass'y. Comp.	
	731-0356		Steering Wheel 13.5" Dia.		34	**		Front Wheel Rim Only	
5	731-0559		Steering Bellow		35	741-0313		Bearing	
6	14775		Steering Column Ass'y.		36	736-0285		FI-Wash. .635 I.D. x 1.59"	
7	741-0356		Flange Bearing .890 I.D. x 1.36 O.D.		37	731-0484		O.D.	
						734-0541		Front Wheel Hub Cap	
8	714-0147		Internal Cotter Pin 1/4" Dia.					Front Wheel Hub Cap	
9	736-0319		FI-Wash. .438" I.D. x 1.37" O.D.					(Chrome—Not Shown)	
								(Optional)	
10	738-0141		Shoulder Bolt .437" Dia. x .35 Lg. 5/16-18 Thd.		38	714-0470		Cotter Pin 1/8" Dia. x 1.25" Lg.*	
11	710-0152		Hex Bolt 3/8-24 x 1.0" Lg. (Grade 5)		39	736-0156		FI-Wash. .635" I.D. x 1.20" O.D.	
12	736-0206		FI-Wash. .38" I.D. x 1.0" O.D.		40	726-0214		Push Cap 5/8" Dia. Rod	
					42	714-0115		Cotter Pin 1/8" Dia. x 1.0" Lg.	
13	750-0535		Spacer .380" I.D. x .625" O.D. x .227		43	710-0538		Hex L-Bolt 5/16-18 x .62" Lg.*	
14	736-0355		Flat Washer .56 I.D. x 1.0 O.D.		44	736-0119		L-Wash. 5/16" I.D.*	
15	710-0726		Hex Wash. Hd. Self-Tap Scr.		45	736-0231		FI-Wash. .344" I.D. x 1.25" O.D.	
16	711-0782		Steering Drag Link	N	46	750-0532		Spacer (Plastic)	
17	14619		Front Pivot Brkt.		47	712-0241		Hex Nut 3/8-24 Thd.*	
18	738-0527		Shoulder Bolt .498" Dia. x 2.04 Lg. 3/8-16 Thd.		48	736-0169		L-Wash. 3/8" I.D.*	
					49	712-0267		Hex Nut 5/16-18 Thd.*	
19	712-0798		Hex Nut 3/8-16 Thd.*		50	736-0119		L-Wash. 5/16" I.D.*	
20	736-0169		L-Wash. 3/8" I.D.*		51	717-0468		Steering Gear Segment	
21	712-0237		Hex Cent. L-Nut 5/16-24 Thd.		52	741-0225		Hex Flg. Brg. .634 I.D.	
22	14611		Steering Arm Front Axle		53	736-0187		FI-Wash. (Hardened)	
23	710-0772		Hex Bolt 5/16-24 x 2.00" Lg. (Grade 5)		54	738-0522		Steering Shaft Lower	
					55	711-0684		Clevis Pin 1/4" Dia. x 1.00" Lg.	
24	741-0225		Hex Flg. Brg. .634 I.D.		57	710-0837		Oval Hd. Cr.—Sunk Scr. #10 x 5/8" Lg.	
25	14608		Pivot Bar Ass'y.		58	736-0242		Bell-Wash.	
26	15841		Front Axle Ass'y.—L.H.		59	736-0187		FI-Wash. (Hardened)	
27	712-0241		Hex Nut 3/8-24 Thd.*						
28	736-0169		L-Wash. 3/8" I.D.*						
29	723-0156		Ball Joint 3/8-24 Thd.						

(462—Red Flake)

*For faster service obtain standard nuts, bolts and washers locally. If these items cannot be obtained locally, order by part number and size as shown on parts list.

When ordering parts, if color or finish is important use the appropriate color code shown above. (e.g. Red Flake Finish—11836 (462).)

**FRONT WHEEL CHART

Description	15 x 6.00 (Rib Tread)	15 x 6.00 (Turf Tread)
Wheel Assembly Comp.	734-0998	734-1136
Tire Only	734-0498	734-0427
Rim Only	734-0997	734-0997
Bearing	741-0313	741-0313
Air Valve	734-0255	734-0255
Grease Fitting	737-0146	737-0146

Models 704, 705, 714 and 715

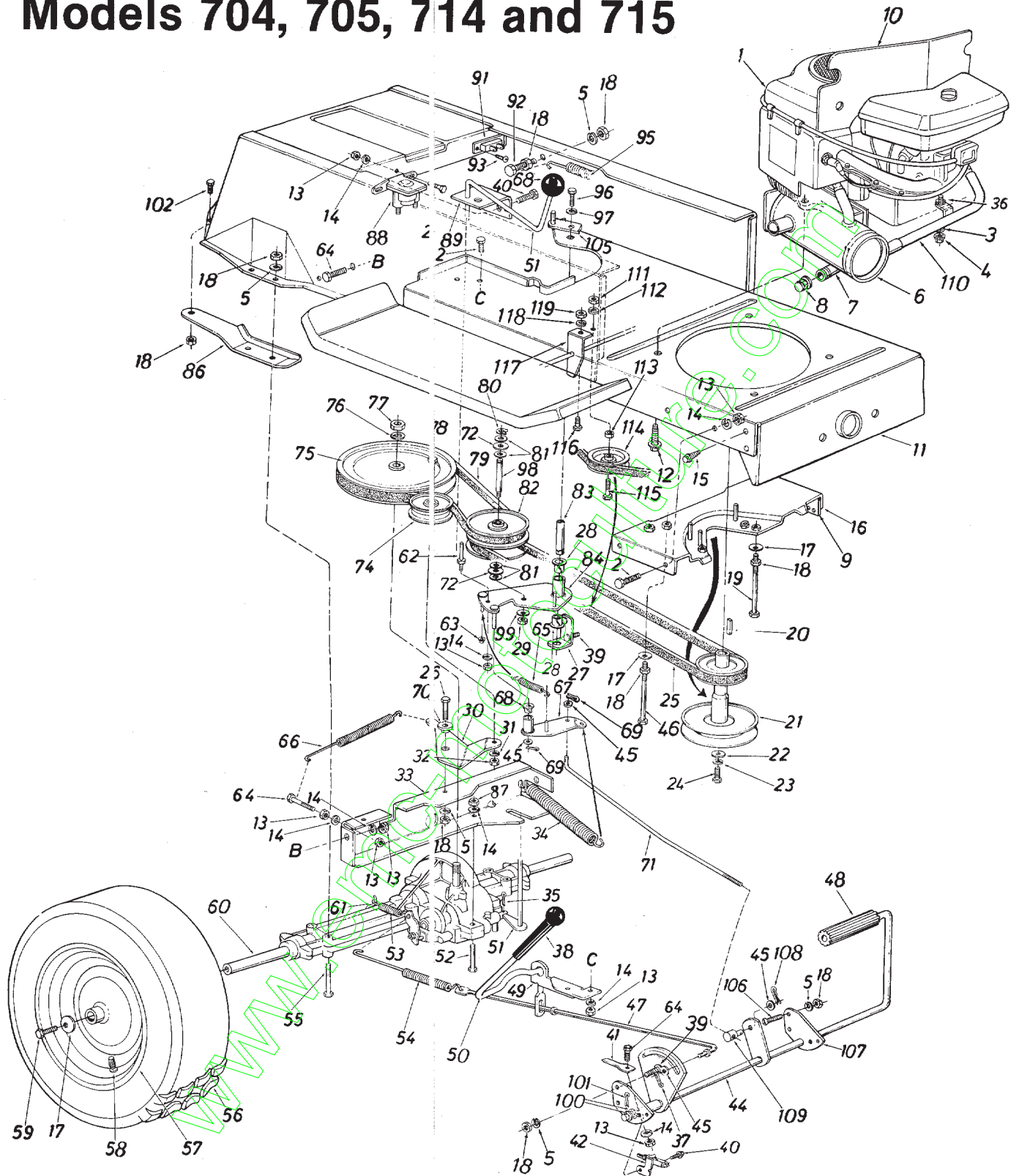

****REAR WHEEL CHART**

Description	18 x 9.50	18 x 8.50	18 x 6.50	16 x 6.50	18 x 5.5
Wheel Assembly Comp.	734-0817	734-0601	734-1132	734-0591	734-1190
Tire Only	734-0448	734-0516	734-0294	734-0275	734-1197
Rim Only	734-0603	734-0603	734-1133	734-0594	734-1191

Models 704, 705, 714 and 715

PARTS LIST FOR MODELS 704, 705, 714 AND 715 LAWN TRACTORS

REF. NO.	PART NO.	COLOR CODE	DESCRIPTION	NEW PART	REF. NO.	PART NO.	COLOR CODE	DESCRIPTION	NEW PART
1	—		Engine		53	732-0264		Ext. Spring .38" O.D. x 2.5"	
2	710-0258		Hex Bolt 1/4-20 x .62" Lg.*		54	732-0413		Ext. Spring .59" O.D. x 7.08"	
3	736-0170		Special L-Wash. 5/16" I.D.		55	710-0378		Hex Bolt 5/16-18 x 2.50"*	
4	712-0267		Hex Nut 5/16-18 Thd.*		56	**		Wheel Ass'y. Comp.	
5	736-0119		L-Wash. 5/16" I.D.*		57	**		Wheel Rim Only	
6	751-0421		Exhaust Muffler		58	734-0255		Air Valve (Service Only)	
7	737-0164		Pipe Nipple		59	710-0627		Hex Bolt 5/16-24 x .75" Lg.*	
8	737-0143		Cap Oil Drain		60	717-0750		Transaxle Complete	
9	16371		Brake Cable Brk't.	N	61	732-0454		Brake Return Spring Anchor	
10	16215		Heat Shield (704 and 714)		62	711-0768		Belt Guard Pin 1/4-20 Thd.	
	16224		Heat Shield (705 and 715)	N	63	726-0106		Cap Speed Nut 1/4" Dia.	
	15930		Lower Frame Ass'y.		64	710-0597		Hex Bolt 1/4-20 x 1.0" Lg.*	
12	710-0502		Hex Wash. Hd. TT-Tap Scr. 3/8-16 x 1.25" Lg.		65	732-0387		Ext. Spring .50" Dia.	
					66	732-0455		Ext. Spring .56" O.D. x 5.96"	
13	712-0287		Hex Nut 1/4-20 Thd.*		67	16352		Variable Speed Torque Brkt. Ass'y.	N
14	736-0329		L-Wash. 1/4" I.D.*		68	741-0419		Flanged Bearing	
15	710-0726		Hex Wash. Hd. AB-Tap Scr. 5/16" x .75" Lg.		69	714-0507		Cotter Pin 3/32" Dia.*	
					70	748-0234		Shoulder Spacer .500" Dia. x .27" Lg.	
16	15898		Belt Guard Brkt. Ass'y.		71	747-0518		Speed Control Link	N
17	736-0242		Bell-Wash. .345" I.D. x .88"		72	741-0405		Truss Bearing .56 Dia. x 1.25"	
18	712-0267		Hex Nut 5/16-18 Thd.*		73	720-0165		Ball Knob	
19	710-0190		Hex Bolt 5/16-18 x 4.00"*		74	756-0437		FI-Idler Pulley 3.25" x 1.0"	
20	714-0114		Sq. Key 1/4" x 1/4" x 2.00"		75	756-0408		11/16" "V"-Pulley 8.0" O.D. x .501" I.D.	
21	756-0424		Engine Pulley		76	736-0921		L-Wash. 1/2" I.D.*	
22	736-0322		FI-Wash. 7/16" I.D. x 1.25"		77	712-0922		Hex Jam Nut 1/2-20 Thd.*	
23	736-0171		L-Wash. 7/16" I.D.*		78	710-0459		Hex Bolt 3/8-24 x 1.50" Lg.*	
24	710-0757		Hex Bolt 7/16-20 x 1.50" Lg.		79	754-0281		Variable Speed Belt .715 x 44" Lg.	
25	754-0280		Variable-Speed Belt .715 x 53" Lg.		80	716-0114		Snap Ring .56" Dia.	
26	710-0118		Hex Bolt 5/16-18 x .75" Lg.*		81	736-0355		FI-Wash.	
27	15890		Bearing Shaft Bracket		82	717-0800		Variable Speed Pulley Ass'y. 5" O.D.	
28	741-0295		Flanged Nylon Brg. 5/8" I.D. x .88" Lg.		83	711-0766		Bearing Shaft	
					84	16354		Variable Speed Brkt. Ass'y.	N
29	712-0241		Hex Nut 3/8-24 Thd.*		85	711-0474		Belt Guard Pin 1/4" Dia. x 1.68" Lg.	
30	15891		Idler Bracket		86	14770		Transaxle Support Brkt.— R.H.	
31	736-0169		L-Wash. 3/8" I.D.*			14769		Transaxle Support Brkt.— L.H. (Not Shown)	
32	712-0241		Hex Nut 3/8-24 Thd.*		87	712-0138		Hex Nut 1/4-28 Thd.	
33	15945		Transaxle Support Brkt.		88	725-0771		Solenoid	
34	732-0459		Ext. Spring .94" O.D. x 6.7		89	16031		Shift Lever Bracket	
35	714-0115		Cotter Pin 1/8" Dia. x 1.0"*		91	725-0459		Circuit Breaker	
36	736-0204		FI-Wash. .34" I.D. x .62" O.D. x .033		92	710-0528		Hex Bolt 5/16-18 x 1.25" Lg.	
37	714-0111		Cotter Pin 3/32" Dia. x 1.0"*		93	710-0351		Truss Hd. Phil. Scr. #10 x 1/2" Lg.	
38	720-0143		Grip—Black		95	732-0307		Ext. Spring .99" O.D. x 11.0"	
39	710-0323		Truss Mach. Scr. 5/16-18 x .75" Lg.		96	710-0180		Hex Bolt 3/8-24 x .75" Lg.*	
40	710-0599		Hex Wash. Hd. Self-Tap Scr. 1/4-20 x .50" Lg.		97	736-0105		Bell-Wash. .38" I.D. x .88"	
41	732-0435		Switch Actuator		98	738-0569		Shaft .56" Dia. x 3.875" Lg.	
42	725-0268		Safety Switch		99	736-0331		Bell-Wash. .39" I.D. x 1.12"	
44	16191		Clutch & Brake Pedal Ass'y.	N	100	736-0256		FI-Wash.	
45	736-0117		FI-Wash.		101	714-0470		Cotter Pin	
46	710-0402		Hex Bolt 5/16-18 x 4.5"*						
47	747-0472		Brake Rod						
48	735-0196		Foot Pad						
49	15889		Brake Lever Bracket						
50	15888		Hill Holder Brake Handle						
51	15838		Shift Lever Ass'y.						
52	710-0559		Hex Bolt 1/4-28 x 1.75" Lg.*						

Models 704, 705, 714 and 715

PARTS LIST FOR MODELS 704, 705, 714 AND 715 LAWN TRACTORS (CONTINUED)

REF. NO.	PART NO.	COLOR CODE	DESCRIPTION	NEW PART	REF. NO.	PART NO.	COLOR CODE	DESCRIPTION	NEW PART
102	710-0604		Hex Wash. Hd. Scr. 5/16-18 x .62" Lg.		111	712-0798		Hex Nut 3/8"-16 Thd.*	
104	736-0362		FI-Wash. .32" I.D. x 1.25		112	736-0169		L-Wash. 3/8" I.D.*	
105	16067		Belt Guard		113	736-0280		FI-Wash. .390" I.D. x 1.12" O.D. x .187	
106	710-0323		Truss Mach. Scr. 5/16-18 x .75" Lg.*		114	756-0217		FI-Idler w/Flanges 2.750	
107	15835		Pedal Bracket		115	710-0427		Hex Bolt 3/8-16 x 2.00" Lg.*	
108	714-0104		Hairpin Cotter 1/8" Dia.		116	710-0258		Hex Bolt 1/4-20 x .62" Lg.*	
109	711-0198		Ferrule		117	16181		Spring Hanger Bracket	
110	751-0422		Inlet Tube Ass'y.		118	736-0329		L-Wash. 1/4" I.D.*	
					119	712-0287		Hex Nut 1/4-20 Thd.*	

Models 704, 705, 714 and 715

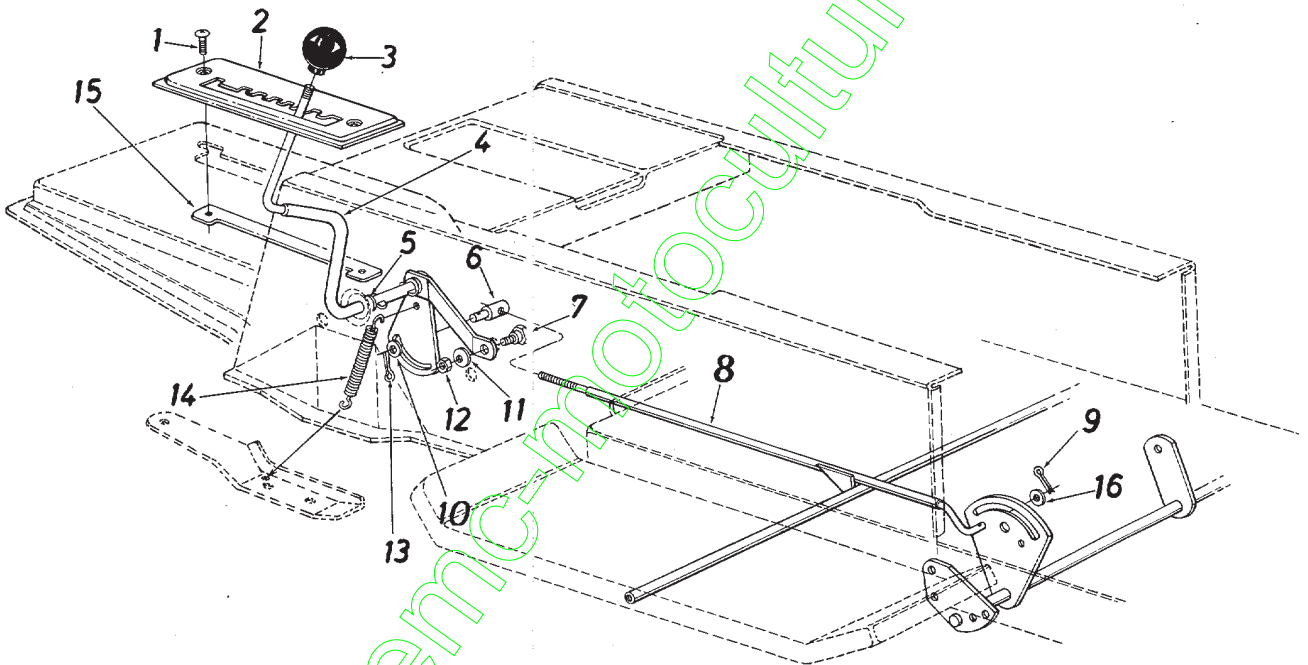

PARTS LIST FOR MODELS 704, 705, 714 AND 715

REF. NO.	PART NO.	COLOR CODE	DESCRIPTION	NEW PART	REF. NO.	PART NO.	COLOR CODE	DESCRIPTION	NEW PART
1	710-0924		Truss Mach. Scr. 1/4-20 x .75" Lg.		6	711-0198		Ferrule 3/8-24 x .37" Dia.	
2	16237		Speed Selector Plate 4-Speed		7	738-0155		Shoulder Bolt .435" Dia. x .160	
	16195		Speed Selector Plate 5-Speed	N	8	16355		Speed Control Rod Ass'y.	N
	16236		Speed Selector Plate 6-Speed	N	9	714-0507		Cotter Pin 3/32" Dia. x .75" Lg.*	
	16194		Speed Selector Plate 7-Speed	N	10	736-0117		FI-Wash. .39" I.D.	
3	720-0175		Gear Shift Knob		11	736-0119		L-Wash. 5/16" I.D.*	
4	16192		Speed Selector Cam Ass'y.		12	712-0267		Hex Nut 5/16-18 Thd.*	
5	736-0192		Flat Washer .53" I.D. x .93" O.D.		13	714-0104		Hairpin Cotter 1/8" Dia.	
					14	732-0303		Spring	N
					15	16196		Clamping Plate	N
					16	736-0226		FI-Wash. .47" I.D. x .88" O.D. x .063	

Models 704 and 714

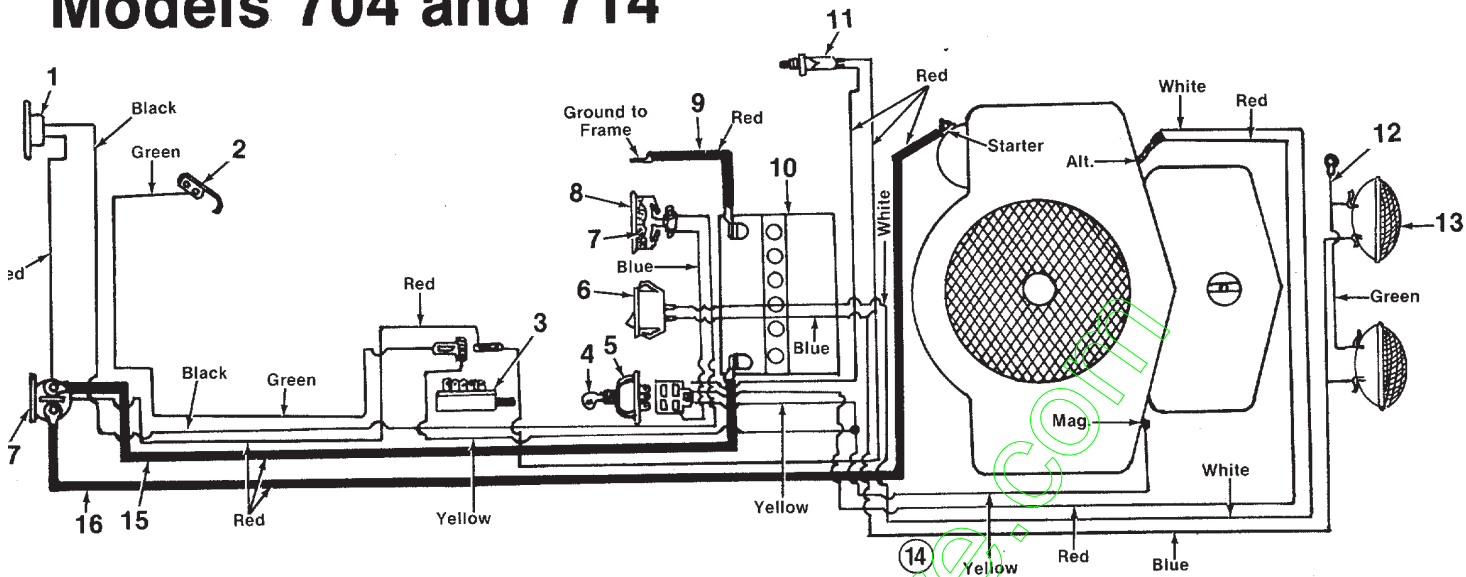

PARTS LIST FOR ELECTRICAL SYSTEM MODELS 704 AND 714

REF. NO.	PART NO.	DESCRIPTION	REF. NO.	PART NO.	DESCRIPTION
1	725-0459	Circuit Breaker	10	725-0453	12 Volt Battery
2	725-0759	Spring Switch	11	725-0577	Safety Switch
3	725-0819	Safety Switch Dpst.	12	725-0916	Ground Wire
4	725-0201	Ignition Key	13	725-0222	Headlight
5	725-0267	Ignition Switch	14	725-1076	Wire Harness
6	725-0634	Headlight Switch	15	725-1080	Electric Wire 27.0" Lg.
7	722-0135	Foam Strip	16	725-0562	Electric Wire 32.5" Lg.
8	725-0925	Ammeter	17	725-0771	Solenoid
9	725-0994	Grounding Wire 14.0" Lg.			

Models 705 and 715

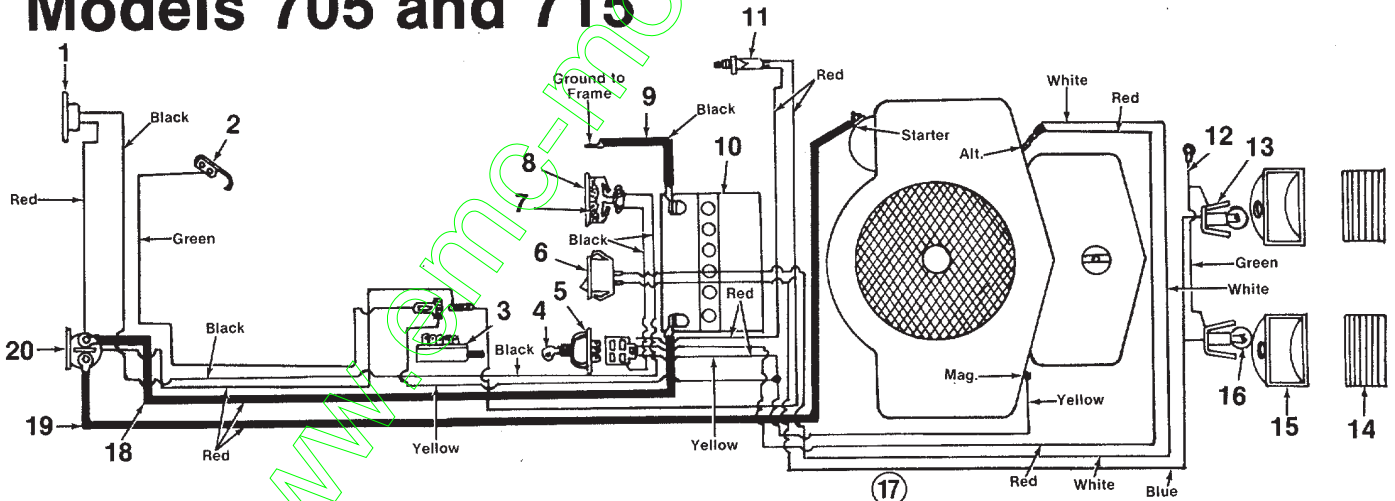

PARTS LIST FOR ELECTRICAL SYSTEM MODELS 705 AND 715

REF. NO.	PART NO.	DESCRIPTION	REF. NO.	PART NO.	DESCRIPTION
1	725-0459	Circuit Breaker	11	725-0577	Safety Switch
2	725-0759	Spring Switch	12	725-0916	Ground Wire
3	725-0819	Safety Switch Dpst.	13	725-1058	Socket
4	725-0201	Ignition Key	14	731-0706	Lens
5	725-0267	Ignition Switch	15	731-0705	Headlight Housing
6	725-0634	Headlight Switch	16	725-0963	Lamp
7	722-0135	Foam Strip	17	725-1079	Wire Harness
8	725-0925	Ammeter	18	725-1080	Electric Wire 27.0" Lg.
9	725-0994	Ground Wire 14.0" Lg.	19	725-0562	Electric Wire 32.5" Lg.
10	725-0453	12 Volt Battery	20	725-0771	Solenoid

Models 704, 705, 714 and 715

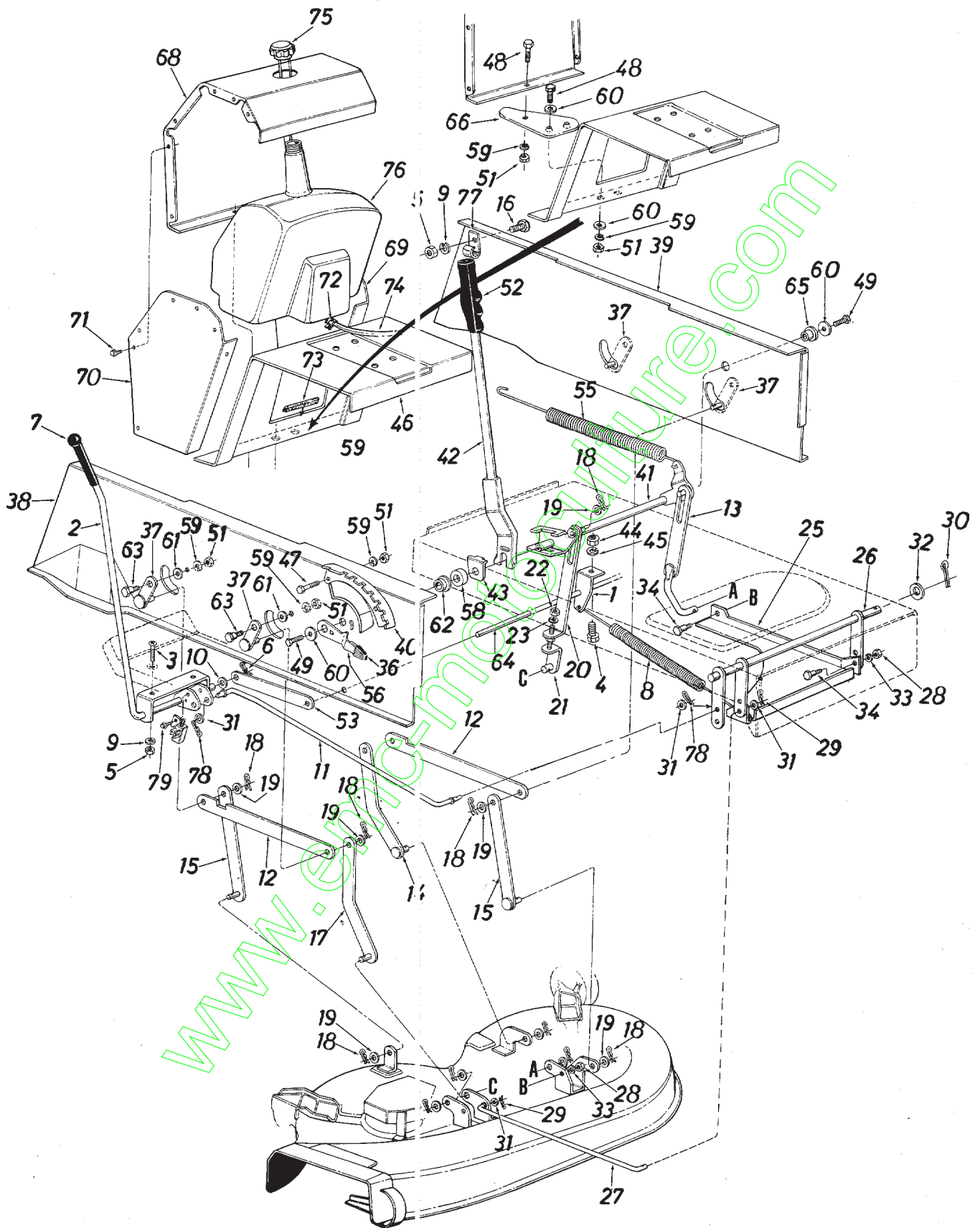

Models 704, 705, 714 and 715

PARTS LIST FOR MODELS 704, 705, 714 AND 715 LAWN TRACTORS

REF. NO.	PART NO.	COLOR CODE	DESCRIPTION	NEW PART	REF. NO.	PART NO.	COLOR CODE	DESCRIPTION	NEW PART
1	16181		Spring Hanger Bracket	N	40	14633		Index Brkt. (Deck Lift)	
2	16212		Deck Engagement Lever Ass'y.	N	41	14641		Lift Shaft Ass'y.	
3	710-0323		Truss Mach. Scr. 5/16-18 x .75" Lg.*		42	14645		Lift Handle Brkt. Ass'y.	
4	710-0258		Hex Bolt 1/4-20 x .62" Lg.*		43	14654		Retainer Wash. Lift Handle	
5	712-0267		Hex Nut 5/16-18 Thd.*		44	712-0287		Hex Nut 1/4-20 Thd.*	
6	714-0111		Cotter Pin 3/32" Dia. x 1.00" Lg.*		45	736-0329		L-Wash. 1/4" I.D.*	
7	720-0143		Grip		46	16223		Hitch Plate	N
8	732-0410		Ext. Spring .99" O.D. x 13.25" Lg.		48	710-0376		Hex Bolt 5/16-18 x 1.00" Lg. (Grade 5)	
9	736-0119		L-Wash. 5/16" I.D.*		49	710-0604		Hex Wash. TT-Tap Scr. 5/16-18 x .62" Lg.	
10	736-0272		FI-Wash. .510" I.D. x 1.0" O.D.		51	712-0267		Hex Nut 5/16-18 Thd.*	
11	747-0491		Drive Deck Control Rod		52	720-0157		Grip	
12	09735		Connecting Rod 3/16 x 1 x 12.5		53	16369		Link 1.0" x 7.5" x .19	N
13	16178		Deck Lift Link Ass'y.	N	54	726-0197		Cable Tie	
14	16209		Deck Hanger Link Ass'y.—Rear L.H.	N	55	732-0307		Ext. Spring .99" Dia. x 11.00" Lg.	
15	16216		Deck Hanger Link Ass'y.		56	732-0412		Deck Lift—Down Stop	
16	710-0118		Hex Bolt 5/16-18 x .75" Lg.*		58	735-0216		Rubber Wash. 1 1/2" O.D. x .63" I.D. x .6 Lg.	
17	16345		Deck Hanger Link Ass'y.—Front R.H.	N	59	736-0119		L-Wash. 5/16" I.D.*	
18	714-0101		Inter. Cotter Pin 1/2" Dia.		60	736-0231		FI-Wash. .344" I.D. x 1.125" O.D. x .125	
19	736-0192		FI-Wash. .531 I.D. x .93" O.D.		61	736-0264		FI-Wash. .344" I.D. x .62" O.D. x .063	
20	16063		Adj. Link Deck Lifting		62	736-0341		Flange Wash. .628" I.D. x 1.25" O.D.	
21	16342		Adj. Lower Link Ass'y.	N	63	738-0140		Shld. Bolt .437" Dia. x .180	
22	712-0342	248	Hex Jam Nut 3/8-16 Thd.		64	738-0526		Running Board Rod	
23	736-0169		L-Wash. 3/8" I.D.*		65	741-0313		Flange Brg. .632" I.D.	
25	16214		Diagonal Brace	N	66	16315		Hitch Bar	
26	16234		Stabilizer Shaft Ass'y.	N	68	16238		Gas Tank Housing—Main Panel	N
27	711-0777		Stabilizer Rod	N	69	16239		Side Panel—L.H.—Gas Tank	N
28	712-0798		Hex Nut 3/8-16 Thd.*		70	16240		Side Panel—R.H.—Gas Tank	N
29	714-0104		Inter. Cotter Pin 5/16" Dia.		71	710-0351		Truss Mach. B-Tapp Scr. #10 x .50" Lg.	
30	714-0470		Cotter Pin 1/8" Dia. x 1.25" Lg.*		72	726-0207		Hose Clamp—.406" Dia.	
31	736-0117		FI-Wash. .385" I.D. x .620" O.D.		73	731-0511		Trim Strip—5" Lg.	
32	736-0156		FI-Wash. .635" I.D. x 1.12" O.D.		74	751-0173		Gas Line—44" Lg.	
33	736-0169		L-Wash. 3/8" I.D.*		75	751-0226		Gas Tank Cap	
34	738-0258		Shoulder Bolt 3/8-16		76	751-0403		Gas Tank	N
36	08540		Knob—Height Adj.		77	726-0175		Hose Clamp	
37	09721		Pivot Link Ass'y.		78	714-0507		Cotter Pin 3/32" Dia. x .75" Lg.	
38	14602		Side Panel Upper Frame—R.H.		79	710-0599		Hex Wash. Hd. Tap Scr. 1/4 x .50" Lg.	
39	14603		Side Panel Upper Frame—L.H.						

Models 704, 705, 714 and 715

801-6231
DECK ASSY
comp.

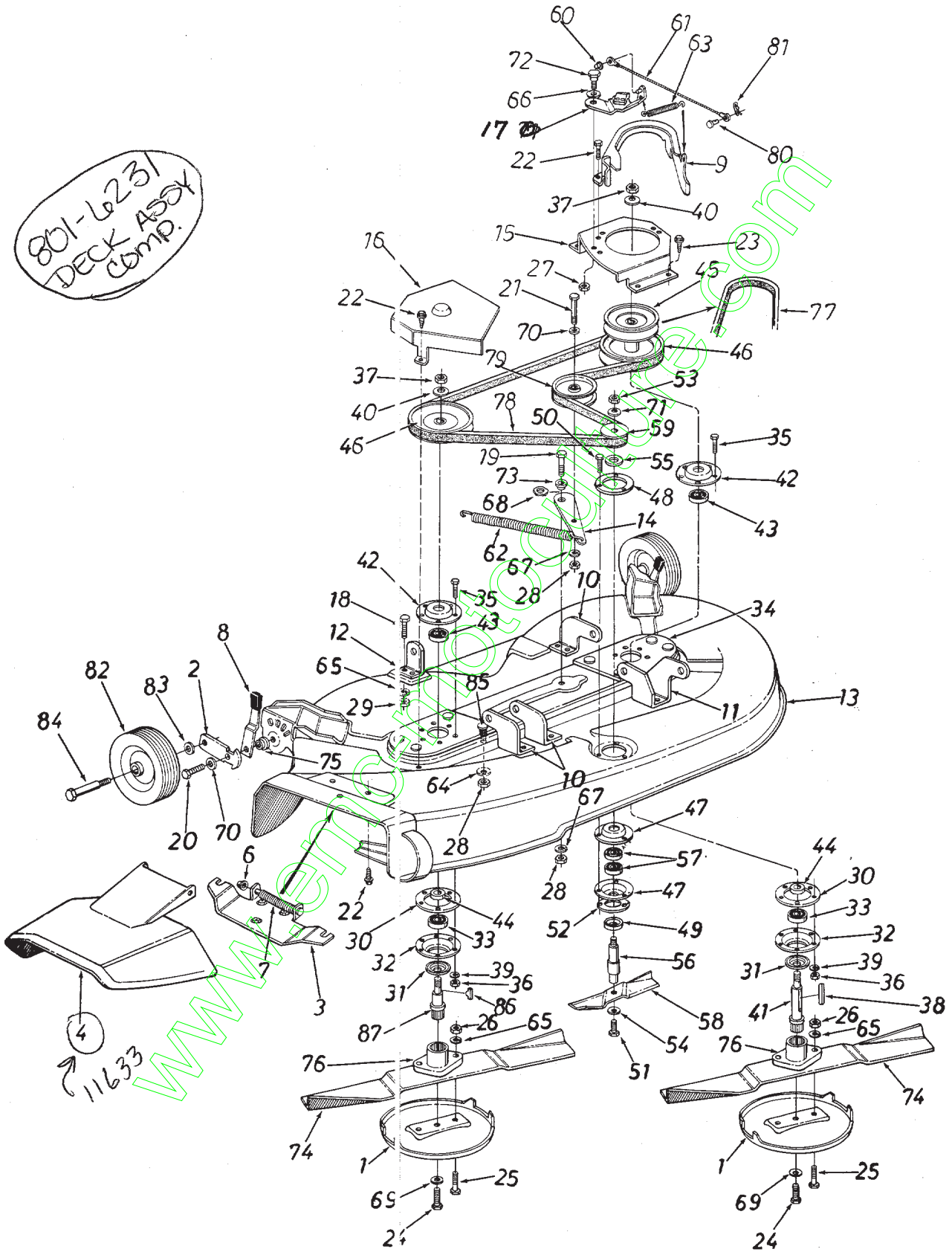

Models 704, 705, 714 and 715

PARTS LIST FOR MODELS 704, 705, 714 AND 715 LAWN TRACTORS

REF. NO.	PART NO.	COLOR CODE	DESCRIPTION	NEW PART	REF. NO.	PART NO.	COLOR CODE	DESCRIPTION	NEW PART
1	07919		Anti-Scalp Plate		47	15319		1-3/8" I.D.—Bearing Housing	
2	10937		Bar-Wheel Pivot		48	16348		Reinforcement Plate	N
3	11396		Adapter Plate		49	16400		Bearing Shield	N
4	11574		Chute Cover Ass'y.		50	710-0567		Hex Sems Scr. 1/4-28 x .625" Lg.	
5	711-0571		Hinge Pin					Hex Cent. L-Bolt 3/8-24 x .88" Lg.	
6	726-0106		Cap Speed Nut 1/4" Rod		51	710-0877		Ring Nut 1/4-28 Thd.	
7	732-0261		Torsion Spring					Hex Jam Nut 1/2-20 Thd.*	
8	14082		Spring Lever Ass'y.		52	16406		Bell-Wash. .400" I.D. x .88" O.D.	
9	14258		Belt Guard		53	712-0922		FI-Wash. .635" I.D. x 1.04" O.D.	
10	16175		Deck Hanger Bracket	N	54	736-0105		6.5" Blade Spindle	
11	16176		Butterfly-Bracket	N				Ball Brg. .62" I.D. x 1.38" O.D. x .44	
12	16180		Deck Hanger Bracket—1.91	N	55	736-0162		6.50" Blade	
13	16231		44" Deck Ass'y.	N				1/2" "V"-Pulley Half .625" I.D. x 2.25" O.D.	
14	16331		Idler Bracket		56	738-0627		Cap Speed Nut 1/4" Rod	
15	16333		Pulley Cover—L.H.	N	57	741-0155		Brake Cable 11.75" Lg.	
16	16334		Pulley Cover—R.H.	N				Extension Spring .73" O.D. x 4.31" Lg.	
17	16337		Spindle Brake Arm Ass'y.	N	58	742-0252		Ext. Spring .36" x 2.41" Lg.	
18	710-0118		Hex Bolt 5/16-18 x .75" Lg.*		59	756-0468		Bell-Wash. .400" I.D. x .88" O.D.	
19	710-0152		Hex Bolt 3/8-24 x 1.00" Lg.*					L-Wash. 5/16" I.D.*	
20	710-0191		Hex Bolt 3/8-24 x 1.25" Lg.*		60	726-0106		Spring Wash. .445" I.D. x .75" O.D.	
21	710-0459		Hex Bolt 3/8-24 x 1.50" Lg.*		61	727-0290		L-Wash. 3/8" I.D.*	
22	710-0599		Hex Wash. S-Tapp Scr. 1/4-20 x .50		62	732-0121		Spring Wash. .625" I.D. x .885" O.D.	
23	710-0726		Hex Wash. Hd. Tapp Scr. 5/16-18 x .75" Lg.		63	732-0118		L-Wash. 3/8" I.D.	
24	710-0877		Hex Cent. L-Bolt 3/8-24 x .88" Lg.		64	736-0105		(Heavy Duty)	
25	710-0888		Hex Bolt Special 5/16-24 x 1.0" Lg.		65	736-0119		Bell-Wash. .400" I.D. x 1.13" O.D.	
26	712-0123		Hex Nut 5/16-24 Thd.*		66	736-0141		Bell-Wash. .505" I.D. x 1.00" O.D.	
27	712-0158		Hex Cent. L-Nut 5/16-18 Thd.		67	736-0169		Shld. Bolt .437" Dia. x .180	
28	712-0241		Hex Nut 3/8-24 Thd.*		68	736-0174		Shld. Spacer .625" I.D.	
29	712-0267		Hex Nut 5/16-18 Thd.*		69	736-0217		21" Blade	
30	09164		Reinforcement Plate		70	736-0219		Shld. Spacer	
31	13703		Bearing Shield		71	736-0253		Blade Adapter	
32	15296		Open Brg. Housing 1.85 I.D.		72	738-0140		"V"-Belt 1/2" x 52.0" Lg.	
33	741-0919		Ball Brg. .787" I.D. x 1.85" O.D. x .551		73	738-0347		"V"-Belt 1/2" x 74.0" Lg.	
34	16349		Spindle Mounting Plate Ass'y.	N	74	742-0295		(Drive Belt)	
35	710-0888		Hex Bolt Special 5/16-24 x 1.0" Lg.		75	748-0279		FI-Idler w/Flanges 3.50" O.D.	
36	712-0123		Hex Nut 5/16-24 Thd.*		76	748-0300		Clevis Pin 1/4" Dia. x .53" Lg.	
37	712-0318		Hex Jam Nut 5/8-18 Thd.*		77	754-0229		Intern. Cotter Pin 5/16" Dia.	
38	714-0168		Sq. Key 3/16" x 3/16 x 2.25" Lg.		78	754-0293		Deck Wheel 6.0" x 1.38	
39	736-0119		L-Wash. 5/16" I.D.*		79	756-0365		Bell-Wash. .400" I.D. x .88" O.D.	
40	736-0317		Bell-Wash. .630" I.D. x 1.25" O.D.		80	711-0701		Shld. Bolt 3/8-16 x 1.41	
41	738-0632		44" Deck Blade Spindle	N	81	714-0104		Rib Neck Bolt (Service Only)	
42	08253		Bearing Housing 1.85" I.D.		82	734-0974		Sq. Key 3/16" x 3/16" x .75" Lg.	
43	741-0919		Ball Brg. .787" I.D. x 1.85" O.D. x .551		83	736-0105		44" Deck Blade Spindle	N
44	750-0456		Spacer 1.0" O.D. x .790" I.D.		84	738-0455			
45	756-0329		5/8 "V"-Pulley .79" I.D. x 5.75" O.D.		85	710-0617			
46	756-0470		"V"-Pulley .79" I.D. x 6.50" O.D.		86	714-0122			
					87	738-0633			

Models 704, 705, 714 and 715

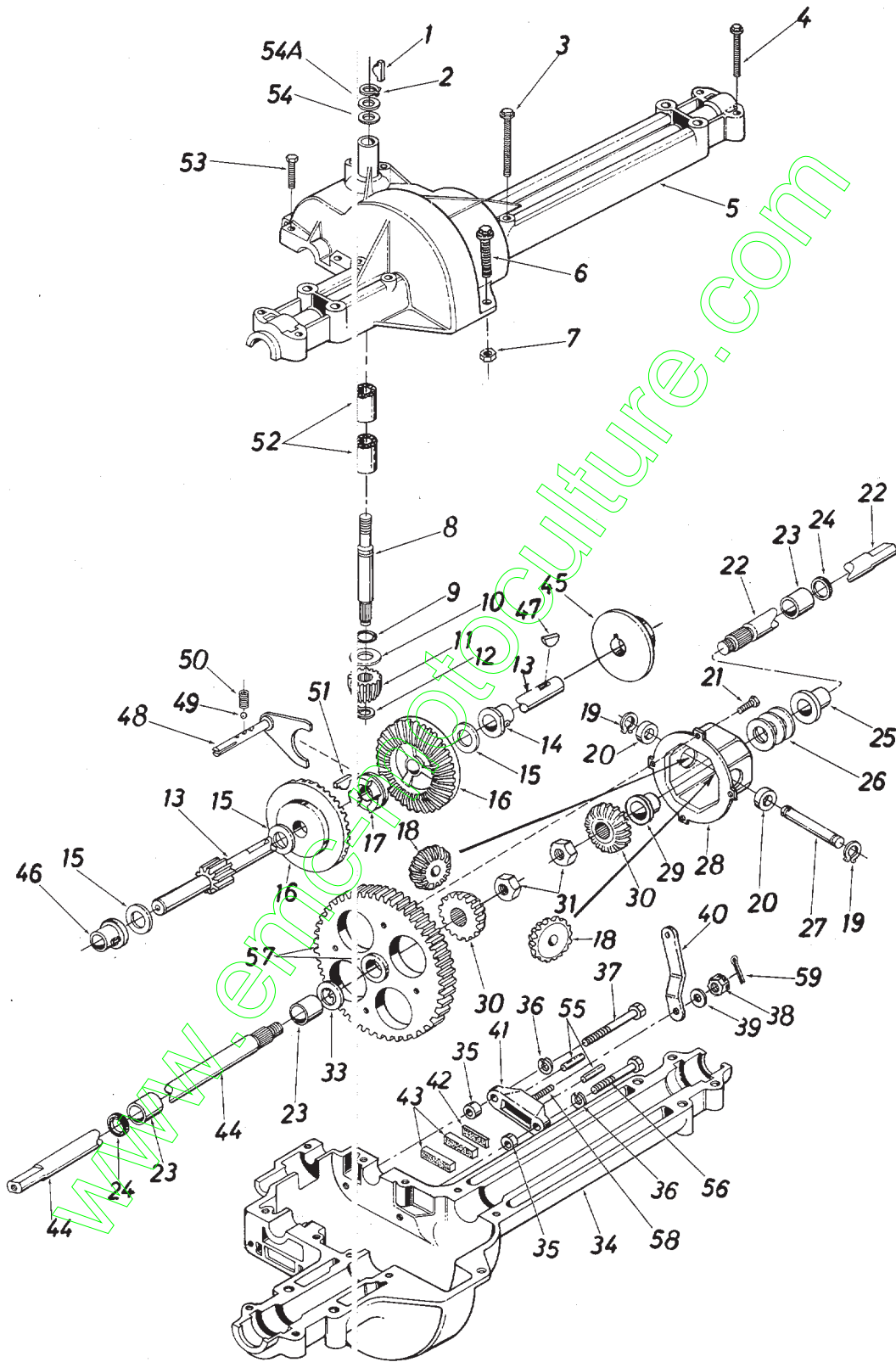

SINGLE SPEED TRANSAXLE
MODEL 717-0750A

Models 704, 705, 714 and 715

PARTS LIST FOR SINGLE SPEED TRANSAXLE 717-0750A

EF. IO.	PART NO.	COLOR CODE	DESCRIPTION	NEW PART	REF. NO.	PART NO.	COLOR CODE	DESCRIPTION	NEW PART
1	714-0129		#4 Hi-Pro Key 3/32 x 5/8" Dia.		33	736-0188		FI-Wash. .760" I.D. x 1.49" O.D.	
2	716-0115		Snap Ring .625" Shaft					Lower Housing	
3	710-0854		Hex Bolt 1/4-20 x 1.75" Lg.*		34	717-0761		Spacer .53" O.D. x 3/8" Lg.	
4	710-0809		Hex Bolt 1/4-20 x 1.25" Lg.*		35	750-0555		L-Wash. 1/4" I.D.*	
5	717-0764		Upper Housing		36	736-0329		Hex Bolt 1/4-20 x 1.50" Lg. (Grade 5)	
6	710-0889		Hex FI-Bolt 1/4-20 x .88" Lg.*		37	710-0886		Castle Nut 5/16-24 Thd.*	
7	712-0287		Hex Nut 1/4-20 Thd.*					FI-Wash. .344" I.D. x .875" O.D.	
8	717-0634		Input Shaft		38	712-0335		Actuating Arm—R.H.	
9	721-0178		Square Seal 5/8" I.D.		39	736-0159		Brake Yoke	
10	736-0335		Thrust Washer 5/8" I.D. x 1.25" O.D.		40	717-0700		Puck Plate	
11	717-0633		Pinion Input 14T		41	717-0679		Brake Puck	
12	716-0108		Retaining Ring 7/16" Ext.		42	717-0682		Axle L.H.	N
13	717-0758		Drive Shaft—R.H.		43	717-0678		Brake Disc	
14	741-0336		Flange Brg. 5/8" I.D. x 3/4" Lg.*		44	717-1011		Flange Bearing 5/8" I.D. x 15/16" Lg.	
15	**		FI-Wash. (See Below)		45	717-0677		Woodruff Key 3/16 x 5/8 HT	
16	717-0757		Bevel Gear 42T		46	741-0337		Shift Fork Ass'y.	
17	717-0667		Clutch Collar		47	714-0161		Ball Detent .250" Dia.	
18	717-1010		Miter Gear 15T	N	48	717-0754		Spring Detent	
19	716-0142		Snap Ring		49	741-0862		#9 Hi-Pro Key 3/16" x 3/4" Dia. HT	
20	717-0690		Thrust Bearing 1/2" I.D. x 1.0" O.D.		50	732-0863		Needle Brg. 5/8" I.D. x 1/2" Lg.	
21	710-0862		Pan Head Scr. 1/4-20 x .50" Lg. w/Patch		51	714-0169		Hex Bolt 1/4-20 x 1.00" Lg.	
22	717-1012		Axle R.H.	N	52	741-0335		FI-Wash. 5/8" I.D. x .030	
23	741-0340		Sleeve Bearing 3/4" I.D. x 1.0" Lg.		53	710-0855		FI-Wash. 5/8" I.D. x .040	
24	721-0179		Oil Seal 3/4" I.D.		54	736-0336		Actuating Pin 5/16" Dia.	
25	741-0339		Flange Bearing 3/4" I.D. x 15/16" Lg.		54A	736-0337		Hex Bolt 1/4-20 x 1.50" Lg. (Grade 5)	
26	736-0188		FI-Wash. .760" I.D. x 1.49" O.D.		55	741-0343		Differential Gear 72T Ass'y. w/Bearing	
27	717-0673		Cross Shaft		56	710-0886		Sq. Hd. Bolt 5/16-24 Thd.	N
28	717-0777		Differential Housing Ass'y.		57	717-0767		Cotter Pin 3/32" Dia. x .50" Lg.	
29	—		Comes with Ref. 28		58	717-0681		Grease—Shell (10 oz.)	
30	717-1009		Miter Gear	N	59	1544-013			
31	712-0200		Hex Ins. L-Nut 1/2-20 Thd.		—	737-0148			

**Ref. No. 15 736-0349 FI-Wash. 5/8" I.D. x 1.0" O.D. x .020 Thk.
 736-0336 FI-Wash. 5/8" I.D. x 1.0" O.D. x .030 Thk.
 736-0337 FI-Wash. 5/8" I.D. x 1.0" O.D. x .040 Thk.

www.emc-motoculture.com

www.emc-motoculture.com

PARTS INFORMATION

POWER EQUIPMENT PARTS AND SERVICE

Parts and service are available through the authorized service firms listed below. All orders should specify the model number of your unit, part numbers, description of parts and the quantity of each part required.

BRIGGS AND STRATTON, TECUMSEH AND PEERLESS PARTS AND SERVICE

Briggs & Stratton, Tecumseh and Peerless parts and service should be handled by your nearest authorized engine service firm. Check the yellow pages of your telephone directory under the listing **Engines—Gasoline**, Briggs & Stratton or Tecumseh Lauson.

NOTE: If any parts are found to be missing or defective upon assembly of this unit, write to advise the factory so that immediate replacement can be made.

ALABAMA	BIRMINGHAM		OHIO	CARROLL
Auto Electric & Carburetor Co.	2625 4th Ave. S.	35233	Stebe's Mid-State Mower Supply	Box 366, 71 High St.
ARKANSAS	NORTH LITTLE ROCK		Bleckrie, Inc.	CLEVELAND
Sutton's Lawn Mower Shop	5301 Roundtop Drive			7900 Lorain Ave.
	Box 368, Rt. 4	72117	National Central	WADSWORTH
CALIFORNIA	PORTERVILLE			687 Seville Rd.
Billious	75 North D Street	93257	Burton Supply Co.	YOUNGSTOWN
COLORADO	DENVER			1301 Logan Ave.
Spitzer Industrial Products Co.	6601 N. Washington St.	80229	OKLAHOMA	Box 929
			Victory Motors, Inc.	MUSKOGEE
FLORIDA	JACKSONVILLE		Kenton Supply Co.	605 S. Cherokee
Radco Distributors	4909 Victor St.	32207	OREGON	PORTLAND
				8216 N. Denver Ave.
Small Eng. Dist.	HIALEAH		PENNSYLVANIA	HARRISBURG
	7995 W. 26th Court ...	33016	EECO Inc.	4021 N. 6th St.
GEORGIA	EAST POINT		Thompson Rubber Co.	PHILADELPHIA
East Point Cycle & Key Inc.	2834 Church St.	30344	Bluemont Co.	5222-24 N. Fifth St.
ILLINOIS	LYONS			PITTSBURGH
Keen Edge Co.	8615 Ogden Ave.	60534	Frank Roberts & Sons	11125 Frankstown Rd. ...
INDIANA	ELKHART			PUNXSUTAWNEY
Parts & Sales Inc.	2101 Industrial Pkwy. ...	46516	Scranton Auto Ignition Co.	R.D. 2
IOWA	DUBUQUE			SCRANTON
Power Lawn & Garden Equip.	2551 J.F. Kennedy ...	52001	Master Repair Service	1133-35 Wyoming Ave. ...
LOUISIANA	NEW ORLEANS		American Sales & Service, Inc.	KNOXVILLE
Suhren Engine Co.	8330 Earhart Blvd.	70118		2000 Western Ave.
MARYLAND	TAKOMA PARK		TEXAS	MEMPHIS
Center Supply Co.	6867 New Hampshire	20912	Marr Brothers, Inc.	3035-43 Bellbrook
	Ave.			DALLAS
MASSACHUSETTS	SPRINGFIELD		Woodson Sales Corp.	423 E. Jefferson
Morton B. Collins Co.	300 Birnie Ave.	01107		FORT WORTH
MICHIGAN	LANSING		Bullard Supply Co.	6733 Baker Blvd.
Lorenz Service Co.	2500 S. Pennsylvania ...	48910		Hwy. 10
			Engine House Inc.	HOUSTON
Power Equipment Dist.	MOUNT CLEMENS	48043		2409 Commerce St.
MINNESOTA	HOPKINS		UTAH	SAN ANTONIO
Hance Distributing Inc.	420 Excelsior Ave. W. ...	55343	Powered Products	8610 Botts Lane
MISSISSIPPI	BILOXI		VIRGINIA	P.O. Box 17867
Biloxi Sales & Service, Inc.	506 Caillavet St.	39533	RBI Corp.	BOUNTIFUL
MISSOURI	KANSAS CITY		Equip. Northwest	485 N 500 W.
Automotive Equip. Service	3117 Holmes St.	64109	WASHINGTON	ASHLAND
			Horst Dist. Inc.	101 Cedar Ridge Dr. ...
Ross-Frazier Supply Co.	ST. JOSEPH	64503	WISCONSIN	SEATTLE
	8th and Monterey			1410 14th Ave.
Henzler, Inc.	ST. LOUIS	63125	NORTH CAROLINA	CHILTON
	2015 Lemay Ferry Rd. ...		Smith Hardware Co.	444 N. Madison St.
NEW JERSEY	BELLMAWR			GOLDSBORO
Lawnmower Parts Inc.	717 Creek Rd.	08030	Dixie Sales Company	515 N. George St.
NEW MEXICO	ALBUQUERQUE			GREENSBORO
Spitzer Eng. & Parts Co.	1023 Third Ave. N.W. ...	87103		335 N. Green
NEW YORK	CARTHAGE			
Gamble Dist., Inc.	West End Ave.	13619		

WARRANTY PARTS AND SERVICE POLICY

(0484)

The purpose of warranty is to protect the customer from defects in workmanship and materials, defects which are NOT detected at the time of manufacture. It does not provide for the unlimited and unrestricted replacement of parts. Use and maintenance are the responsibility of the customer. The manufacturer cannot assume responsibility for conditions over which it has no control. Simply put, if it's the manufacturer's fault, it's the manufacturer's responsibility; if it's the customer's fault, it's the customer's responsibility.

CLAIMS AGAINST THE MANUFACTURER'S WARRANTY INCLUDES:

1. Replacement of Missing Parts on new equipment.
2. Replacement of Defective Parts within the warranty period.
3. Repair of Defects within the warranty period.

All claims MUST be substantiated with the following information:

1. Model Number of unit involved.
2. Date unit was purchased or first put into service.
3. Date of failure.
4. Nature of failure.