

GRUPPO AVVIAMENTO / STARTER ASSY
GROUPE DEMARRAGE / PUESTA EN MARCHA
 mod. 350AF SUPER - 350S - 264 F DELUXE

DATA DATE
03 1979

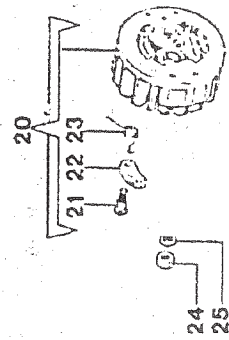
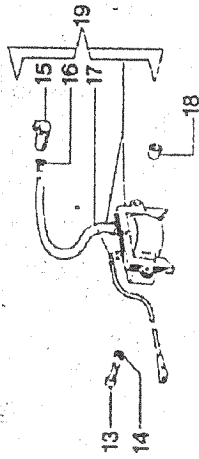
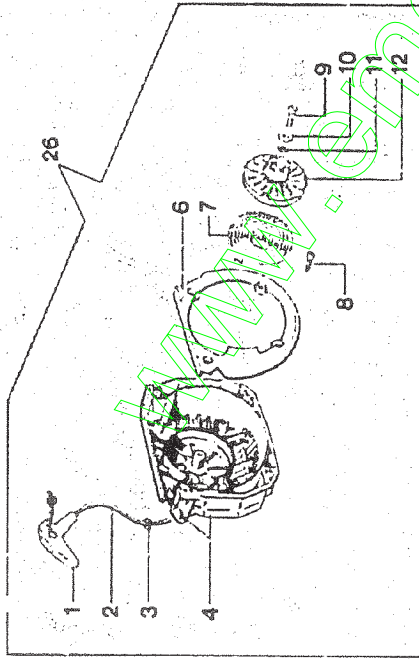

7

GRUPPO AVVIAMENTO / STARTER ASSY
GROUPE DEMARRAGE / PUESTA EN MARCHA
 mod. 350AF SUPER - 350S - 264 F DELUXE

DATA DATE
03 1979



REF.	PART. NO.	DESCRIZIONE ITALIANO	DESCRIPTION ENGLISH	DESCRIPTION FRANCAIS	DESCRIPCION ESPAÑOL
1	0050.00122	MANIGLIA	HANDLE	POIGNÉE	EMPUNAJURA
2	0355.00008	CORDA	CORD	CORDE	CUERDA
3	0050.00829	RODIZZOLA	WASHER	PONDELLE	ARANZUELA
4	0350.00103	COV. OGL. ARANCIO	STARTER CASE CR	CARTER ORANGE	CARTER AMAR
5	0350.00138	COV. OGL. ROSSO	STARTER CASE RED	CARTER ROUGE	CARTER ROJO
6	0350.00105	COV. OGL. GALLO	STARTER CASE YELLOW	CARTER JAUNE	CARTER AVFALLO
7	0999.00296	VITE	SCREW	VIS	TORNILLO
8	0050.00342	FLANGIA	FLANGE	FLANGE	ALACA
9	0040.00132	MOLLA	SPRING	RESSORT	RESORTE
10	0054.00785	VITE	SCREW	VIS	TORNILLO
11	0350.00055	RODIZZOLA	WASHER	RODIZZOLA	ARANZUELA
12	0050.00315	RODIZZOLA	WASHER	RODIZZOLA	ARANZUELA
13	0049.00022	PULEGGIA	PULLEY	POULE	POLEA
14	3801035	VITE	SCREW	VIS	TORNILLO
15	0945.00049	RODIZZOLA	WASHER	RODIZZOLA	ARANZUELA
16	0061.00189	P. FRETTA	CAF	CAFUCHON	CLUBRE BUIJ
17	0154.01117	MOLLA	SPRING	RESSORT	RESORTE
18	0054.00071	CAVO	CABLE	CABLE	CABLE
19	0350.00032	DISTANZIALE	SPACER	ENTRETOISE	SEPARADOR
20	0049.00052	BOBINA	COIL	BOBINE	BOBINA
21	0040.00436	VOLANO COMFL	FLYWHEEL ASSY	VOLANT COMFL	VOLANTE COMFL
22	0040.00140	FERRIO	PAWL PIN	EQUILIB	FERRIO
23	0049.00048	CRACCHETTO	PAWL	CUSCLET	LHA
24	0060.00142	MOLLA	SPRING	RESSORT	RESORTE
25	0050.00343	DADO	NUT	ECCOU	TUOCCA
26	0786.00008	RODIZZOLA	WASHER	RODIZZOLA	ARANZUELA
	0355.00118	MAN. COMFL. ARANCIO	STARTER ASSY CR	MAN. COMFL. ROUGE	MAN. COMFL. AMAR
	0355.00107	MAN. COMFL. ROSSO	STARTER ASSY RED	MAN. COMFL. JAUNE	MAN. COMFL. AVFALLO

8

Non più disponibile dal 1/1/81. Not available anymore from 1/1/81. / No se fabrica más desde el 1/1/81.

MOTORE / ENGINE
MOTEUR / MOTOR
mod. 350 AF SUPER - 350 S - 264 F DELUXE

DATA DATE
03/1978

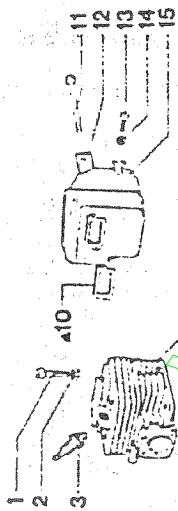

mod. 350 AF SUPER
350 S

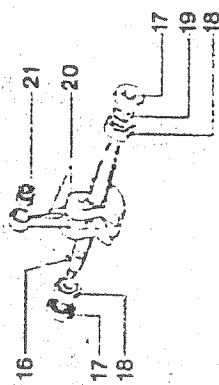

▲ 28

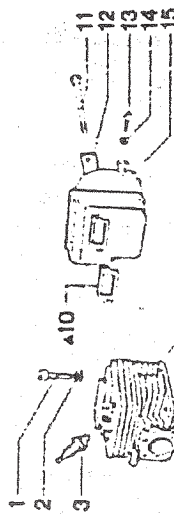

mod. 264 F DELUXE

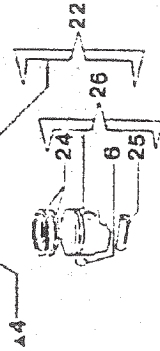

28A

MOTORE / ENGINE
MOTEUR / MOTOR
mod. 350 AF SUPER - 350 S - 264 F DELUXE

DATA DATE
03/1978

REF.	PART. NO.	DESCRIZIONE ITALIANO	DESCRIPTION ENGLISH	DESCRIPTION FRANCAIS	DESCRIPCION ESPAÑOL
1	0050.00050	VITE	SCREW	VIS	TORNILLO
2	3833076	RODDELLA	WASHER	FRIGIETTE	ARROJUELA
3	0050.00019	CANDOLA	SPARK PLUG	BOUCHE	BUEJA
4	0050.00302	QUADRANTE	SPARK CAP	BOUCHE	BUEJA
5	0054.00015	SEGMENTO DI F. ARIELLO	PISTON RING	SEGMENT D'ANNEAU	ANILLO
6	0072.01198	AF. MOTTO	SLIP RING	PISTON RING	PISTON RING
7	0945.00007	CH. MARCHIAV. DI F. ARIELLO	CH. MARCHIAV. DI F. ARIELLO	CH. MARCHIAV. DI F. ARIELLO	CH. MARCHIAV. DI F. ARIELLO
8	0355.00130	PISTONE CON FL. DI F. ARIELLO	PISTON RING	PISTON RING	PISTON RING
9	0335.00129	QUADRANTE	SPARK PLUG	BOUCHE	BUEJA
10	0060.00331	VITE	SCREW	VIS	TORNILLO
11	0054.00303	LAPERELLO	WASHER	FRIGIETTE	ARROJUELA
12	0060.00312	VITE	SCREW	VIS	TORNILLO
13	0060.00624	L. DADO	NUT	ECCHEU	TUERCA
14	3933100	MARINETTA	WASHER	FRIGIETTE	ARROJUELA
15	0054.00076	L. QUERTE	KEY	C. QUERTE	CHAVETA
16	3028014	A. VELLO DI TESTA	SEAL RING	BAGUE	BOUCHE
17	3050015A	CUSCINETTO	BEARING	BOUCHE	BUEJA
18	0050.00016	ECCHEU	WASHER	FRIGIETTE	ARROJUELA
19	0060.00018	ECCHEU	WASHER	FRIGIETTE	ARROJUELA
20	0054.01112	ALBERO MOTORE	SHAFT	ARBRE	BIELBA
21	3037014	CUSCINETTO	BEARING	BOUCHE	BUEJA
22	0264.00052	CILINDRO CON FL. DI F. ARIELLO	CYLINDER	CILINDRE	CILINDRO
23	0266.00001	ALBERO MOTORE	SHAFT	ARBRE	BIELBA
24	0061.00015	SEGMENTO DI F. ARIELLO	PISTON RING	SEGMENT D'ANNEAU	ANILLO
25	0060.00012	AF. MOTTO	SLIP RING	PISTON RING	PISTON RING
26	0264.00056	PISTONE CON FL. DI F. ARIELLO	PISTON RING	PISTON RING	PISTON RING
27	0264.00017	CUSCINETTO	BEARING	BOUCHE	BUEJA
28	0050.00330	SERIE QUADRANTE	SPARK PLUG	BOUCHE	BUEJA

Non può essere ristampato senza permesso scritto dalla EMC S.p.A. - Via S. Felice a Marsa di 61

**BASAMENTO / CRANKCASE
CARTER MOTEUR / CARTER MOTOR**
mod. 350AF SUPER - 350S - 264F DELUXE

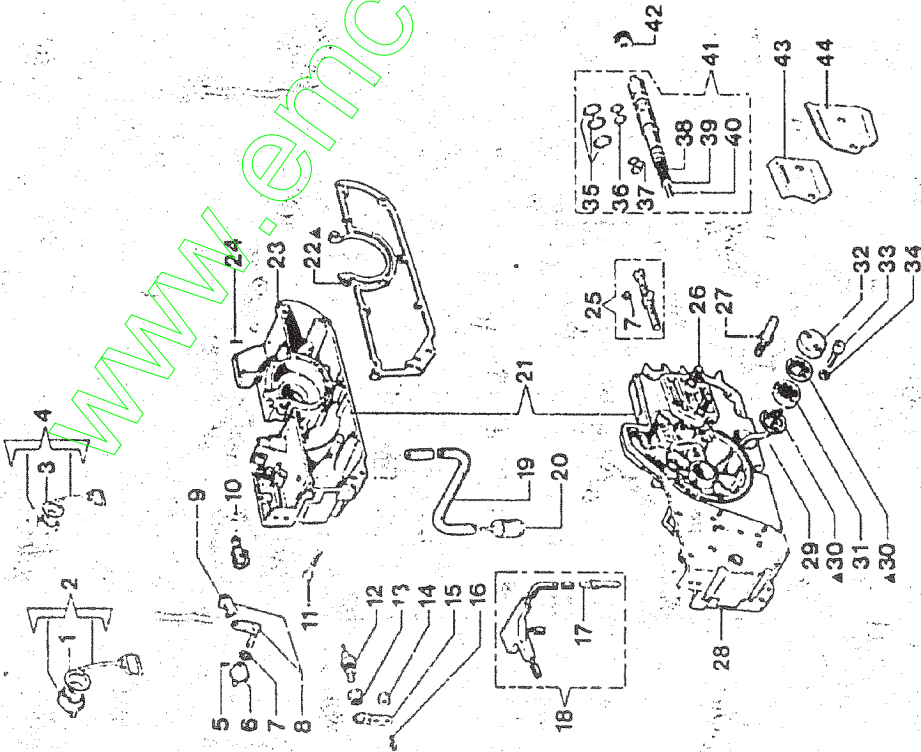

▲ 45

**BASAMENTO / CRANKCASE
CARTER MOTEUR / CARTER MOTOR**
mod. 350AF SUPER - 350S - 264F DELUXE



REF.	PART. NO.	DESCRIZIONE ITALIANO	DESCRIPTION ENGLISH	DESCRIPTION FRANCAIS	DESCRIPCION ESPAÑOL
1	3049019	O-RING	O-RING	O-RING	O-RING
2	0061.01033	TAPPO MIX	FUEL CAP	BOUCHON MIX	TAPÓN GASC. MIX
3	0945.00054	GUARNIZIONE	GASKET	BOUCHON DE MULE	JUNTA
4	0945.00570	TAFFO OLIO	OIL CAP	BOUCHON DE MULE	TAPÓN DE ACEITE
5	0060.00054	SPINA	PH.	AXE	PERNO
6	0050.00053	LEVA STARTER	STARTER LEVER	LEVER STARTER	PALANCA STARTER
7	3026004	AVELLO	SNAP RING	LEVER COUPL	AVILLO
8	0264.00181	LEVA COUPL	LEVER ASSY	LEVER COUPL	PALANCA COUPL
9	0181.00165	BELLA STARTER	CONNECTING ROD	BELLE	BELA STARTER
10	0081.01003	GUIDA VITI	SCREWS GUIDE	GUIDE VIS	GUÍA DE TORNELO
11	0355.00229	VITE	SCREW	VIS	TORNELO
12	0945.00497	INTERRUTTORE	SWITCH	INTERRUPTEUR	INTERRUPTOR
13	2317005A	DADO	WASHER	ECROU	LLERCA
14	3933100	DADO	WASHER	ECROU	LLERCA
15	0052.00954	SUPPORTO	SUPPORT	SUPPORT	ALBERCA
16	0240.00049	AVITE	SCREW	SUPPORT	SOPORTE
17	0350.00081	SPILTO COUPL	TANK BREATHER	VIS	TORNELO
18	0264.00134	SERBATOIO COUPL	FUEL TANK	RESERVOIR COUPL	VALVOLA COUPL
19	0350.00047	TUBO MIX	FUEL LINE	TUYAU	TANQUE COUPL
20	0945.00207	FILTRO MIX	FUEL FILTER	FILTRO	TUBO
21	0355.00101	BASAMENTO ROSSO	CRANKCASE ORANGE	CARTER MOTEUR ORANGE	MOTRO GASOLINA
22	0355.00208	BASAMENTO GIALLO	CRANKCASE YELLOW	CARTER MOTEUR JAUNE	CARTER COUPL ROJO
23	0355.00207	GUARNIZIONE	GASKET	CARTER MOTEUR JAUNE	CARTER COUPL AMARILLO
24	0355.00100	SEMICARTER ARANCIO	CRANKCASE ORANGE	JOINT	JUNTA
25	0355.00205	SEMICARTER ROSSO	CRANKCASE RED	DEMI-CARTER ORANGE	CARTER ANARANCA
26	0060.00102	COPPIA	CRANKCASE YELLOW	DEMI-CARTER ROUGE	CARTER ROJO
27	0049.00091	PIED. MATERIA	SPLIT PIN	BOUCHON	CLAVISA
28	0054.00436	FRIGHERO	ADJUST COUPL	TEIGEUR CE CHAÎNE	TORNELO TENSOR
29	0049.00088	PROTEZ CATERA	BOX	BOUCHON	TORNELO
30	0049.00165	SEMICARTER ARANCIO	CRANKCASE ORANGE	BOUCHON	PERNO
31	0049.00166	SEMICARTER ROSSO	CRANKCASE RED	DEMI-CARTER ORANGE	CARTER ANARANCA
32	0060.00080	TUBO OLIO	CRANKCASE YELLOW	DEMI-CARTER ROUGE	CARTER ROJO
33	0350.00081	GUARNIZIONE	OIL LINE	DEMI-CARTER JAUNE	CARTER AMARILLO
34	0060.00084	FILTRO OLIO	GASKET	TUYAU HUILE	TUBO DE ACEITE
35	0060.00117	COPELCO	OIL FILTER	FILTRE HUILE	JUNTA
36	0060.00118	VITE	COVER	COUVERCLE	FILTRO DE ACEITE
37	3045002	O-RING	SCREW	VIS	TORNELO
38	0060.00107	MOLLA	O-RING	O-RING	O-RING
39	0060.00106	PILLOLO	SPRING	RESSORT	RESORTE
40	0060.00105	PISTONCINO	PLATE	ENTRETOISE	ARANDELA
41	0060.00104	POMPA OLIO	PISTON PUMP	PISTON POMPE	PISTON DE BOMBA
42	0050.00119	TAPPO	OIL PUMP	POMPE	BOMBA
43	0050.00087	LAMIERINO INTERNO	PLATE	BOUCHON	TAPON
44	0050.00088	LAMIERINO ESTERNO	PLATE	TOLE	PLACA
45	0050.00330	SERIE GUARNIZIONI	GASKET SET	JEU DE JOINTS	JUEGO DE JUNTAS

Non puo' disponibile dal / Not available anymore since / Resti di usi disponibile a part. da / No se fabrica más desde el

GRUPPO FRIZIONE / CLUTCH ASSY
GROUPE EMBRAYAGE / GRUPO EMBRAGUE
 mod. 350AF SUPER - 350S - 264F DELUXE



GRUPPO FRIZIONE / CLUTCH ASSY
GROUPE EMBRAYAGE / GRUPO EMBRAGUE
 mod. 350AF SUPER - 350S - 264F DELUXE

REF.	PART. NO.	DESCRIZIONE (ITALIANO)	DESCRIPTION (ENGLISH)	DESCRIPTION (FRANCAIS)	DESCRIPTION
1	0060.00352	PERNELLIA	WASHER	ROUELETTE	ARABIELLA
2	0049.00137	NOXIA	SPRING	RESSORT	RESSORTE
3	0049.00068	FRIZIONE CCMPL	CLUTCH ASSY	L'EMBRAYAGE CCMPL	EMBRAYAGE CCMPL
4	0044.00165	CUSCINETTO	BEARING	ROUEMENT	COUINETE
5	0049.00159	FRIZIONE CCMPL	SPRING CCMPL	ROUEMENT CCMPL	P. M. C. CCMPL
6	0050.00329	RICAMPELLA	WASHER	ROUELETTE	ARABIELLA
7	0050.00355	DADO	NUT	ECHOU	TIERRELLA
8	0050.00165	CUSCINETTO	BEARING	ROUEMENT	COUINETE
9	0051.00260	PERNO	PIN	ALL	PERON
10	0264.00108	COFERNO	COVER	COUVERCLE	TAPP
11	0054.00568	VITE	SCREW	COSIFFRAGE	TORNILLO
12	0060.00141	ANILLO	SHAPING	COROLPS	TORNILLO
13	0054.00555	MASTRO FRENO	ROAKE BAND	COLLIERE FRENO	C. M. FRENO
14	0054.00552	NOXIA	SPRING	RESSORT	RESSORTE
15	0054.00549	LEVA	LEVER	LEVIER	PALANCA
16	0054.00597	MALLA	SPRING	RESSORT	RESSORTE
17	0054.00553	LAVIERO	PLATE	PLAQUETTE	PLACA
18	0054.00157	CUFERNO	COVER	COUVERCLE	TAPP
19	0054.00564	VITE	SCREW	ALL	TORNILLO
20	0054.01082	LEVA	LEVER	LEVIER	PALANCA
21	0054.00550	BOCCOGIA	BUSHING	BAGUE	CASQUILLO
22	0060.00300	SPINA	PIN	GRANCH	PERON
23	0055.00001	COPRIGATELLA BRACCIO	CHAM. COVER BRACE	COUVERCLE BRACE	CUBRECAPIA BRACCIO
24	0355.00044	COPRIGATELLA ROSO	CHAM. COVER RED	COUVERCLE ROUGE	CUBRECAPIA ROSO
25	0054.00598	DISTANZIALE	SPACER	ESPACIANT	CUBRECAPIA AMBILLO
26	0945.00155	CADO	NUT	ECHOU	SEPARADOR
27	0264.00001	PROTEZIONE	PROTECT VAS	PROTECTOR	PROTECTOR
28	0054.00599	RICAMPELLA	WASHER	ROUELETTE	ARABIELLA
29	0054.00600	RICAMPELLA	WASHER	ROUELETTE	ARABIELLA
30	0054.00601	VITE	SCREW	ALL	TORNILLO
31	3833.100	DADO	NUT	ECHOU	TIERRELLA
32	0054.00093	ANILLO	SHAPING	COROLPS	TORNILLO
33	3814.003	DADO	NUT	ECHOU	TIERRELLA
34	0060.00369	VITE	SCREW	GRIFFE	PIERRELLA
35	0054.00544	ANILLO	SHAPING	COROLPS	TORNILLO
36	0264.00109	CUSCINETTO	BEARING	ROUEMENT	COUINETE
37	0264.00128	COPRIGATELLA BRACCIO	CHAM. COVER BRACE	COUVERCLE BRACE	CUBRECAPIA BRACCIO
38	0264.00108	COPRIGATELLA ROSO	CHAM. COVER RED	COUVERCLE ROUGE	CUBRECAPIA ROSO
39	0050.00918	PERNELLIA	WASHER	ROUELETTE	ARABIELLA

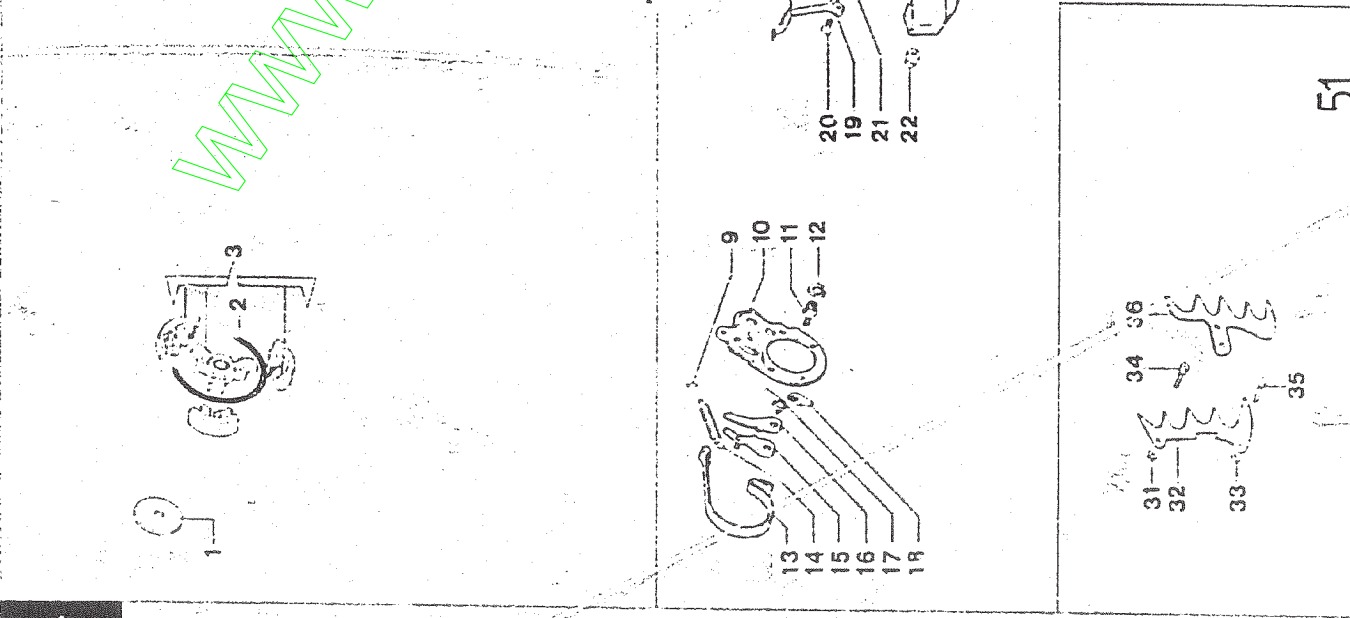
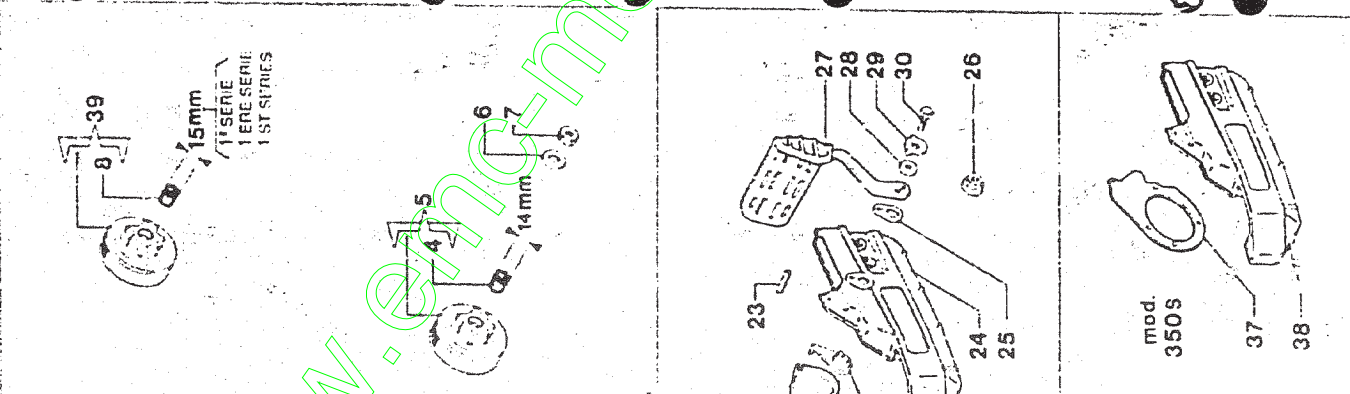
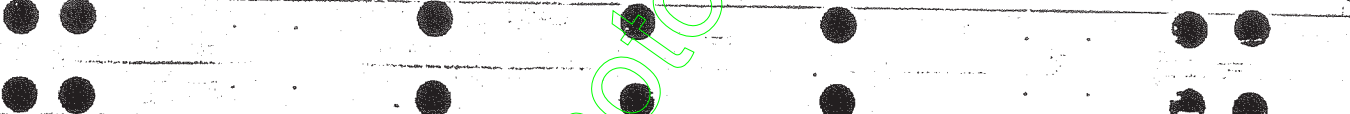

Non più disponibile dal 1978. Non più disponibile da parte di ...

FILTRO ARIA E CARBURATORE / AIR FILTER AND CARBURATOR
 FILTRE AIR ET CARBURATEUR / FILTRO AIRE Y CARBURADOR
 mod. 350AF SUPER - 350S - 264F DELUXE



DATA DATE
03 / 1973

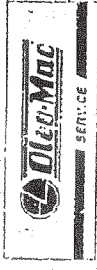

FILTRO ARIA E CARBURATORE / AIR FILTER AND CARBURATOR
 FILTRE AIR ET CARBURATEUR / FILTRO AIRE Y CARBURADOR
 mod. 350AF SUPER - 350S - 264F DELUXE

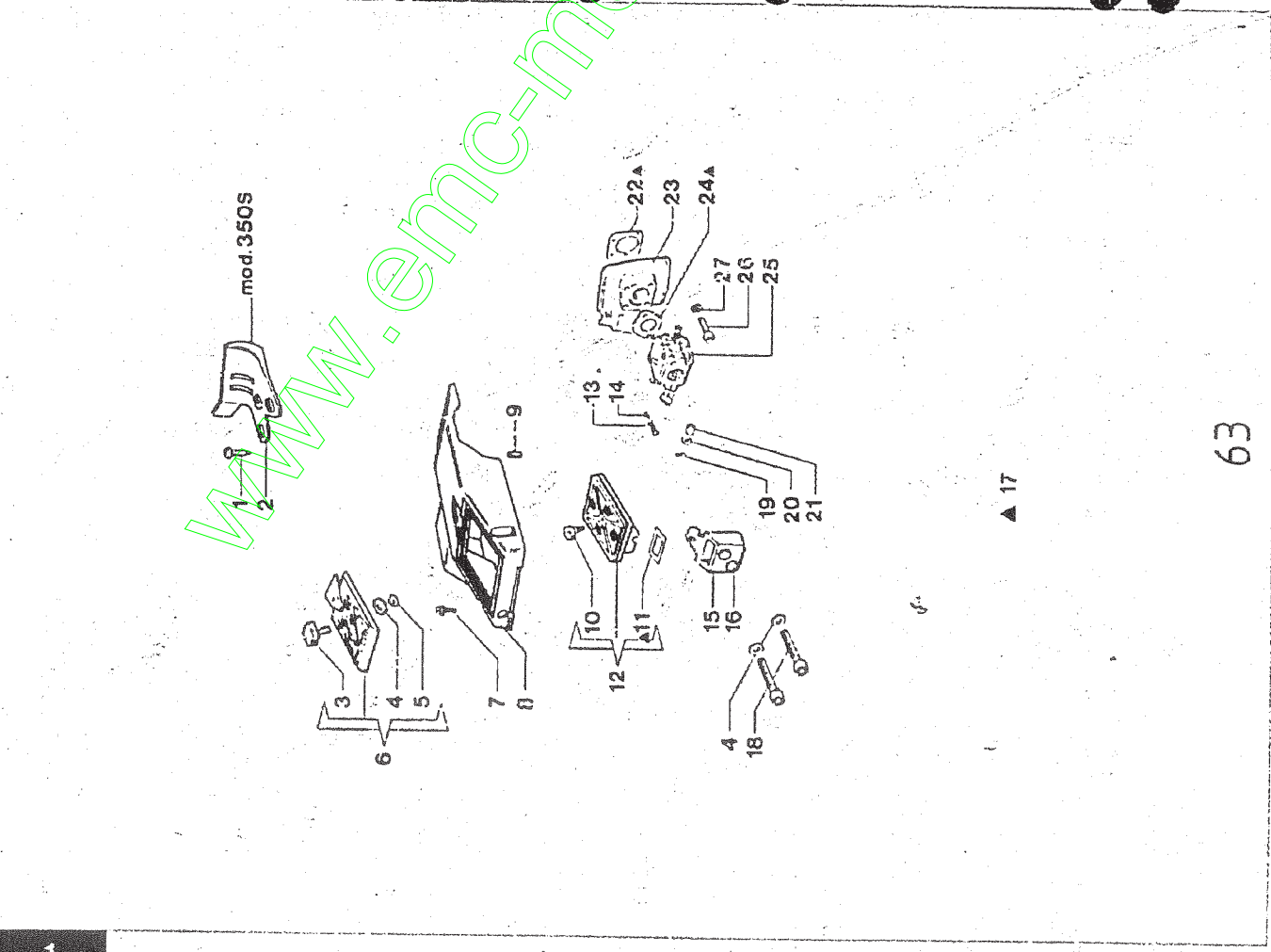

▲ 17

63

REF.	PART. NO.	DESCRIZIONE ITALIANO	DESCRIPTION ENGLISH	DESCRIPTION FRANÇAIS	DESCRIPCION ESPAÑA
1	0264.00038	VITE	SCREW	VIS	TORNILLO
2	0264.00018	PROTEZIONE	HAND GUARD	PROTECTOR	PROTECTOR
3	0355.00199	PCNIELLO	WASHER	POINTEAU	FETILLA
4	3833073	BOCCIELLA	WASHER	BOUCHELE	ARANGELA
5	3049005	OR	ORING	ORING	ORING
6	0052.00968	COPRIFRANZA	A.F. FILTER COVER	COUVERTOLE	TAPA
7	0999.00296	VITE	SCREW	VIS	TORNILLO
8	0355.00053	CUFFIA	COVER	COUVERTOLE	TAPA
9	0945.00183	TUBETTO	TUBE	TUYAU	TUBO
10	0054.00953	FOVELLO	WASHER	POINTEAU	PERILLA
11	0350.00131	GUARNIZIONE	GASKET	JOINT	UNTA
12	0350.00188	FILTRO ARIA	AIR FILTER	FILTRE A R	FILTRO ARIA
13	0060.00056	VITE	SCREW	VIS	TORNILLO
14	0050.00057	MOLLA	SPRING	RESSORT	RESORTE
15	0150.00001	SUPPORTO	SUPPORT	SUPPORT	SOPORTE
16	0061.00030	TAPPO	CAP	CAPUCHON	TAPUCHI
17	0050.00030	KIT GUARNIZIONI	GASKETS SET	KIT DE JOINTS	JUNTO DE JUNTA
18	0061.00030	VITE	SCREW	VIS	TORNILLO
19	0040.00059	CCPAGLIA	SPLIT PIN	COUPLLE	CLAVIA
20	3916003	BOCCIELLA	WASHER	BOUCHELE	ARANGELA
21	0060.00258	BOCCIELLA	BUSHING	BAGUE	CASQUILLO
22	0050.00020	GUARNIZIONE	GASKET	JOINT	UNTA
23	0264.00073	FLANGIA TERMICA	INSULAT.	ECRAN THERMIQUE	PLACA TERMICA
24	0060.00025	GUARNIZIONE	GASKET	JOINT	UNTA
25	0049.00188	CARBURATORE	CARBURETOR	CARBURETEUR	CARBURADOR
26	0080.00024	VITE	SCREW	VIS	TORNILLO
27	0060.00315	BOCCIELLA	WASHER	BOUCHELE	ARANGELA

64

Non pu' disponere di ... / Not possible to provide ... / No se puede disponer de ...

DATA DATE
03 / 1973

mod. 350 AF SUPER
264 F DELUXE

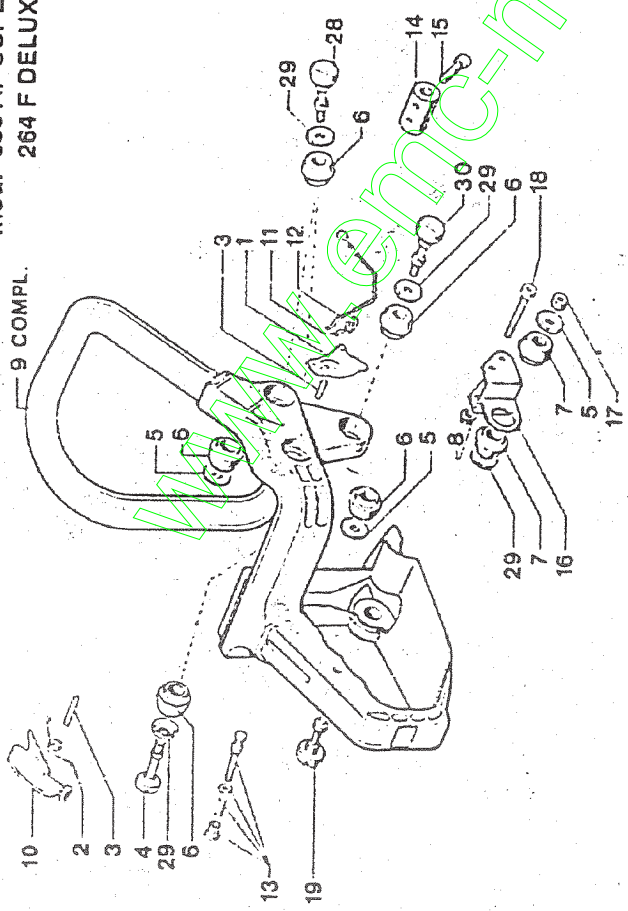

mod. 350 S

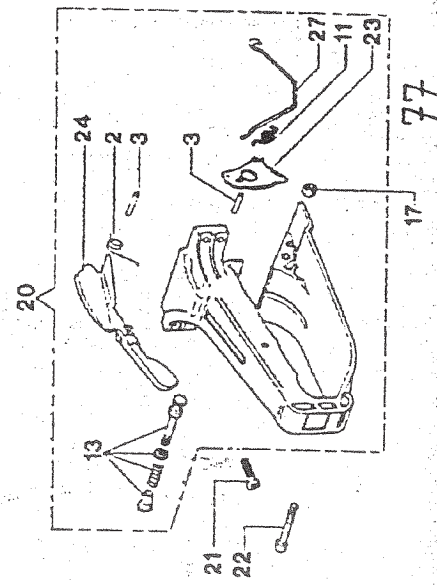

DATA DATE
03 / 1973

REF.	PART. NO.	DESCRIZIONE ITALIANO	DESCRIPTION ENGLISH	DESCRIPTION FRANCAIS	DESCRIPCION ESPAÑOL
1	0050.00072	ACCELERATORE	THROTTLE LEVER	ACCELERATEUR	ACCELERADOR
2	0050.00360	MOLLA	SPRING	RESSORT	RESORTE
3	0061.00364	PERNO	PIVOT	AXE	PERNO
4	0264.00084	VITE	SCREW	VS	TORNILLO
5	0054.00562	RODDELLA O6	WASHER O6	RODILLE O6	ARANDELA O6
6	0052.00228	ARTIBRANTE	SHOCK ABSORBER	AMORTISSEUR	AMORTIGUADOR
7	0054.00227	ARTIBRANTE	SHOCK ABSORBER	AMORTISSEUR	AMORTIGUADOR
8	3933.100	CADO	NUT	ECCROU	FRANCA
9	0360.00079	IMPUGNATURA COMPLETA	HANDLE ASSY	POIGNEE COMPLETE	EMPUNADURA COMPLETA
10	0050.00358	LEVA FERMO ACCEL.	LEVER	LEVIER	PALANCA
11	0050.00359	MOLLA	SPRING	RESSORT	RESORTE
12	0264.00110	ASTA ACCEL.	THROTTLE LEVER	LEVIER ACCEL.	PALANCA ACCELERADOR
13	0061.00881	MIT PULSANTE	BOOTHALSY	BOITON	BOITON
14	0264.00085	ATTACCO PER MANICO	HANDLE ATTACHMENT	ATTACHE POIGNEE	CONEXION EMPUNADURA
15	0060.00101	VITE	SCREW	VS	TORNILLO
16	0052.00545	ATTACCO PER MANICO	HANDLE ATTACHMENT	ATTACHE POIGNEE	CONEXION EMPUNADURA
17	3914.003	DADO	NUT	ECCROU	FRANCA
18	3801.014	VITE	SCREW	VS	TORNILLO
19	0044.00596	VITE	SCREW	VS	TORNILLO
20	0053.00065	IMPUGNATURA COMPLETA	HANDLE ASSY	POIGNEE COMPLETE	EMPUNADURA COMPLETA
21	0062.00397	VITE	SCREW	VS	TORNILLO
22	0050.00363	VITE	SCREW	VS	TORNILLO
23	0054.00072	ACCELERATORE	THROTTLE LEVER	ACCELERATEUR	ACCELERADOR
24	0054.00358	LEVA FERMO ACCEL.	LEVER	LEVIER	PALANCA
25	0061.00318	IMPUGNATURA	HANDLE	POIGNEE	EMPUNADURA
26	3833.073	RODDELLA	WASHER	RODILLE	ARANDELA
27	0050.00074	ASTA ACCEL.	THROTTLE LEVER	LEVIER ACCEL.	PALANCA ACCEL.
28	0044.00567	VITE	SCREW	VS	TORNILLO
29	0054.00563	RODDELLA O9	WASHER O9	RODILLE O9	ARANDELA O9
30	0054.00567	VITE	SCREW	VS	TORNILLO

CARBURATORE / CARBURETOR
CARBURATEUR / CARBURADOR

DATA DATE
03 / 1993

mod. ZAMA C2 - L1



per } mod. 350 AF SUPER - 350 S
for } mod. 264 F DELUXE

1

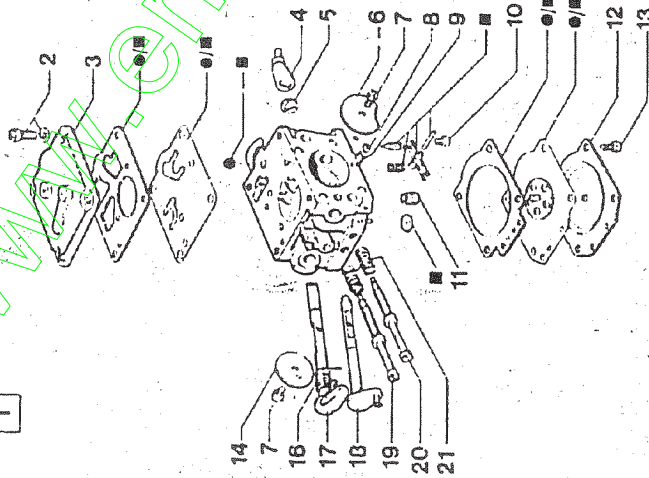

22 ■ KIT RIPARAZIONE
REPAIR KIT

15 ● KIT MEMBRANE & GUARNIZIONI
DIAPHRAGM & GASKET SET

101

CARBURATORE / CARBURETOR
CARBURATEUR / CARBURADOR

DATA DATE
03 / 1998

mod. ZAMA C2 - L1



REF.	PART. NO.	DESCRIZIONE ITALIANO	DESCRIPTION ENGLISH	DESCRIPTION FRANÇAIS	DESCRIPCION ESPAÑOL
1	0049.00188	CARBURATORE COMPLETO	COMPL. CARBURETOR	CARBURATEUR COMPLET	CARBURADOR COMPLETO
2	0049.00200	VITE	SCREW	VIS	TORNILLO
3	0049.00199	COPERCHIO	COVER	COUVERCLE	TAPA
4	0049.00195	LEVA	LEVER	LEVIER	PALANCA
5	2318387	ANELLO	SNAP RING	CIRCLIPS	ANILLO
6	0049.00216	PARVALLA	VALVE CHOKE	PAPILLO	VALVULA
7	2318388	VITE	SCREW	VIS	TORNILLO
8	0049.00217	SFERA	BALL	BILLE	BOLA
9	0049.00218	MOLLA	SPRING	RESSORT	RESORTE
10	2318527	VITE	SCREW	VIS	TORNILLO
11	0049.00189	GETTO	VALVE	SOUPAPE	VALVULA
12	0049.00208	COPERCHIO	COVER	COUVERCLE	TAPA
13	0049.00209	VITE	SCREW	VIS	TORNILLO
14	0049.00192	PARFALIA	VALVE THROTTLE	SOUPAPE ACCEL	VALVULA ACEL
15	0049.00220	PISTONE E GUARNIZIONE	DIAPHR. AND GASKET	PISTON	JUEGO DE PARTAS
16	0049.00191	MOLLA	SPRING	RESSORT	RESORTE
17	0049.00190	ALBERO ACCEL	SHAFT THROTTLE	ARBRE ACCEL	EJE
18	0049.00215	ALBERO STARTER	SHAFT CHOKE	ARBRE STARTER	EJE
19	0049.00210	VITE "L"	SCREW "L"	VIS "L"	TORNILLO "L"
20	0049.00211	VITE "H"	SCREW "H"	VIS "H"	TORNILLO "H"
21	2318532	MOLLA	SPRING	RESSORT	JUEGO DE REPARACION
22	0049.00219	KIT RIPARAZIONE	REPAIR KIT	KIT REPARATION	JUEGO DE REPARACION

102

Non più disponibile dal / Not available anymore since / Non più disponibile a partir du / No se fabrica más desde el