

www.emc-motoculture.com

Position	Numéro de pièce	#	Appellation I	Appellation II
1	683-04474	1	NOIR	SCHWEISSTEIL:LACKIERT MTD QUAL
2	710-1690	2	VIS	MTD SPEC-100015 21.1441.46
3	711-1017	1	BOULON	FINISH:MTD SPEC-100015
4	712-0691	2	ECROU HEXAGONAL	MTD SPEC-100015 24.1426.14
5	714-0104	1	GOUPILLE	FINISH:PHOS AND OIL
6	723-0383	1	SANGLE POUR GOULOTTE D'EJECTI	FINISH:
7	731-06408	1	BOUCHON MULCHING	FINISH:SCHWARZ
8	736-0343	2	RONDELLE .330 ID X 1.25 X .12	FINISH:MTD 701-100015
9	747-05127	1	TRINGLE SUPPORT GOILOTTTE	KIT:FINISH:SPEC-100015
10	749-04231B	1	ROHR:MULCH PLUG:Ø22x1.0x483mm	DIN 2394 ST 35 LACKIERT
11	783-04581	1	ARRÉT	FINISH:LACKIERT

www.emc-motoculture.com

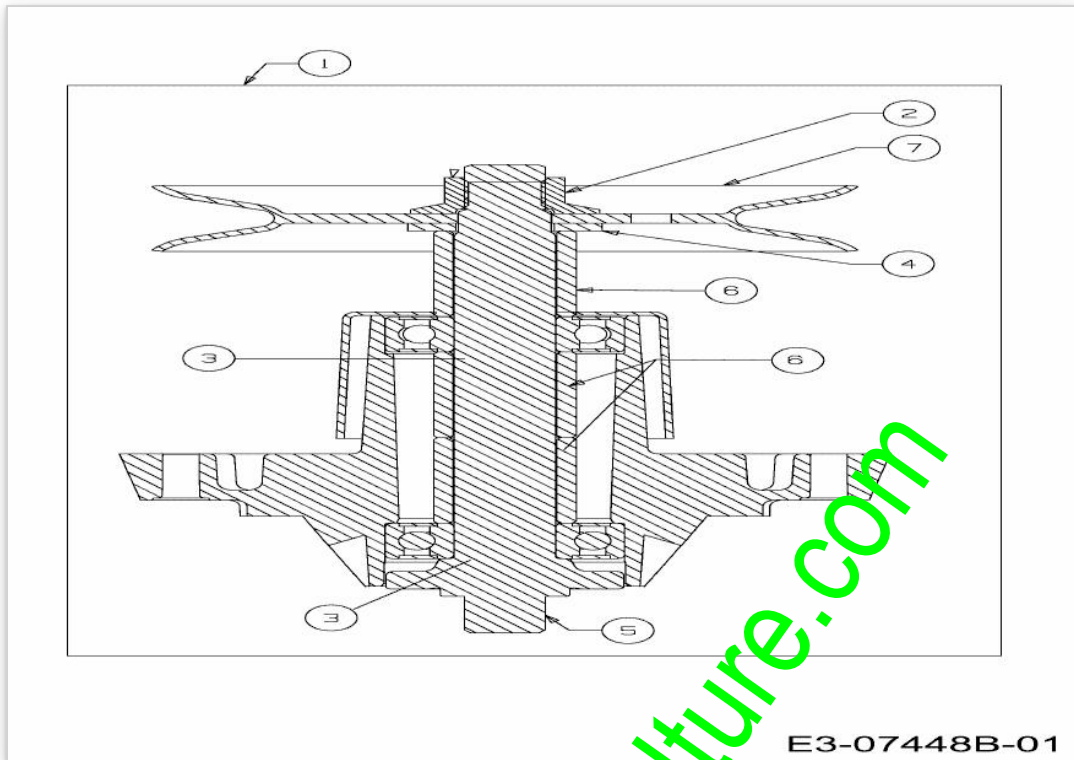

E3-07448B-01

www.emc-motoculture.com

Position	Numéro de lapièce	#	Appellation I	Appellation II
1	618-0409C	1	PALIER DE LAME COMPLET	
2	712-0417A	1	ÜCROU HEX. AV. FLANC: 5/8- 18	FINISH:MTD STD 701-01000
3	741-0919A	2	ROULEMENT A BILLES	FINISH:
4	736-0315	1	RONDELLE FL	FINISH:STD SPEC-100015
5	738-1128	1	AXE DE PALIER DE LAMES:6.58"	FINISH:GEÖLT
6	750-1000	3	ENTRETOISE:.80x1.10x1.330	FINISH:GEÖLT
7	756-04216	1	POULIE DE PALIER DE LAME G	FINISH:SPEC-100015

www.emc-motoculture.com

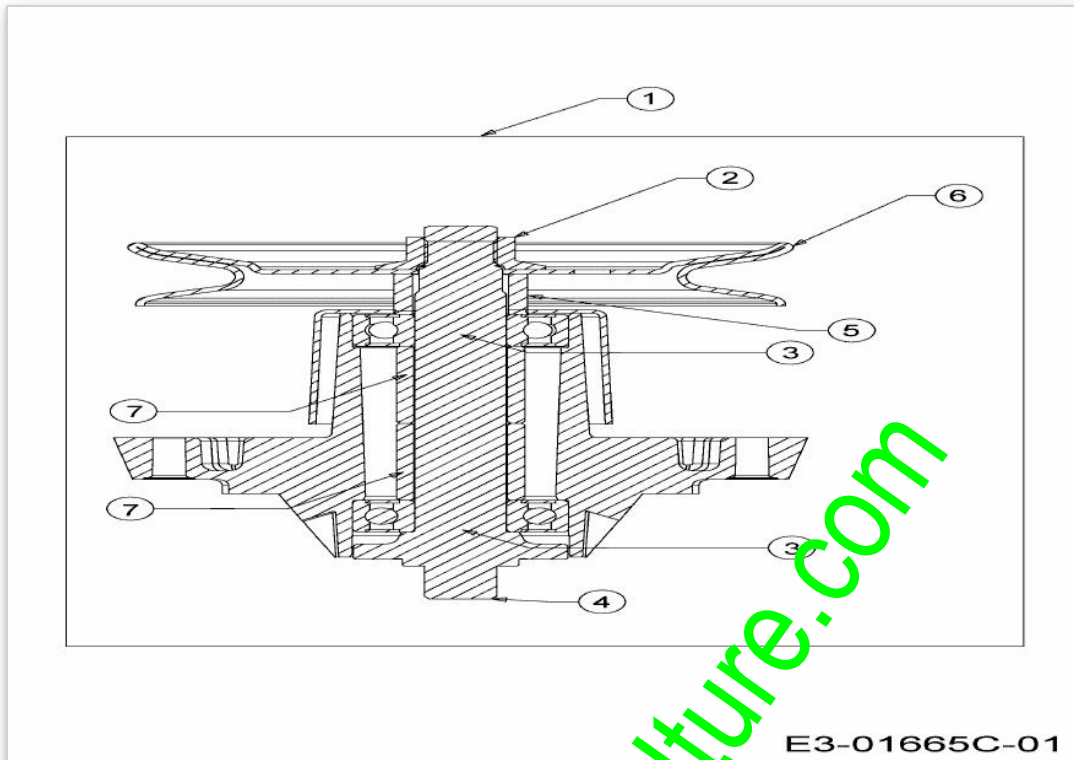

www.emc-motoculture.com

Position	Numéro de lapièce	#	Appellation I	Appellation II
1	918-0324D	1	PALIER DE LAME CPL.D :	RIEMENSCHIEBE 5.75 DIA
2	712-0417A	1	ÜCROU HEX. AV. FLANC: 5/8-18	FINISH:MTD STD 701-01000
3	741-0919A	2	ROULEMENT A BILLES	FINISH:
4	738-1010A	1	AXE DE PALIER 5.75 LG	FINISH:GEÖLT 618-0324A
5	748-04302	1	ENTRETOISE	FINISH:GEÖLT
6	756-1188	1	POULIE DE COURROIE TRAPEZ.	SPEC-100015 or AUTOPHORETIC C.
7	750-1000	2	ENTRETOISE:.80x1.10x1.330	FINISH:GEÖLT

www.emc-motoculture.com

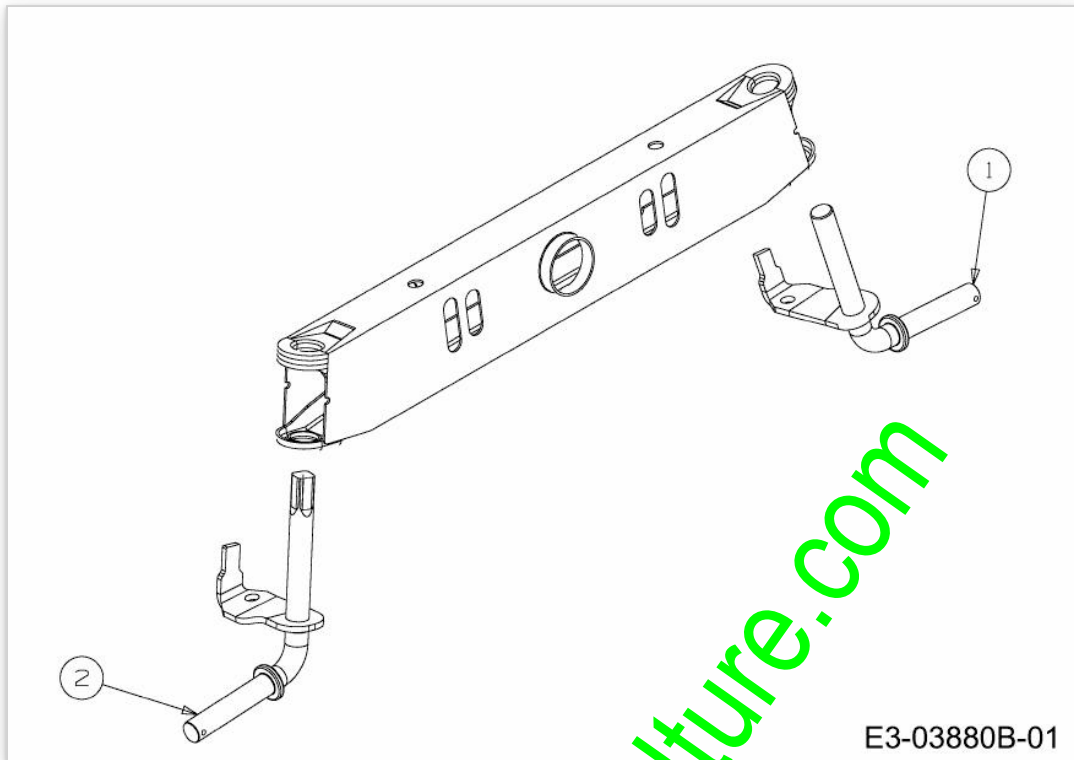

E3-03880B-01

www.emc-motoculture.com

Position	Numéro de lapièce	#	Appellation I	Appellation II
1	638-04014A-S	1	FUSEE GAUCHE	SCHWARZ
2	638-04013637	1	FUSEE DROITE	SCHWEISSTEIL:LACKIERT

www.emc-motoculture.com

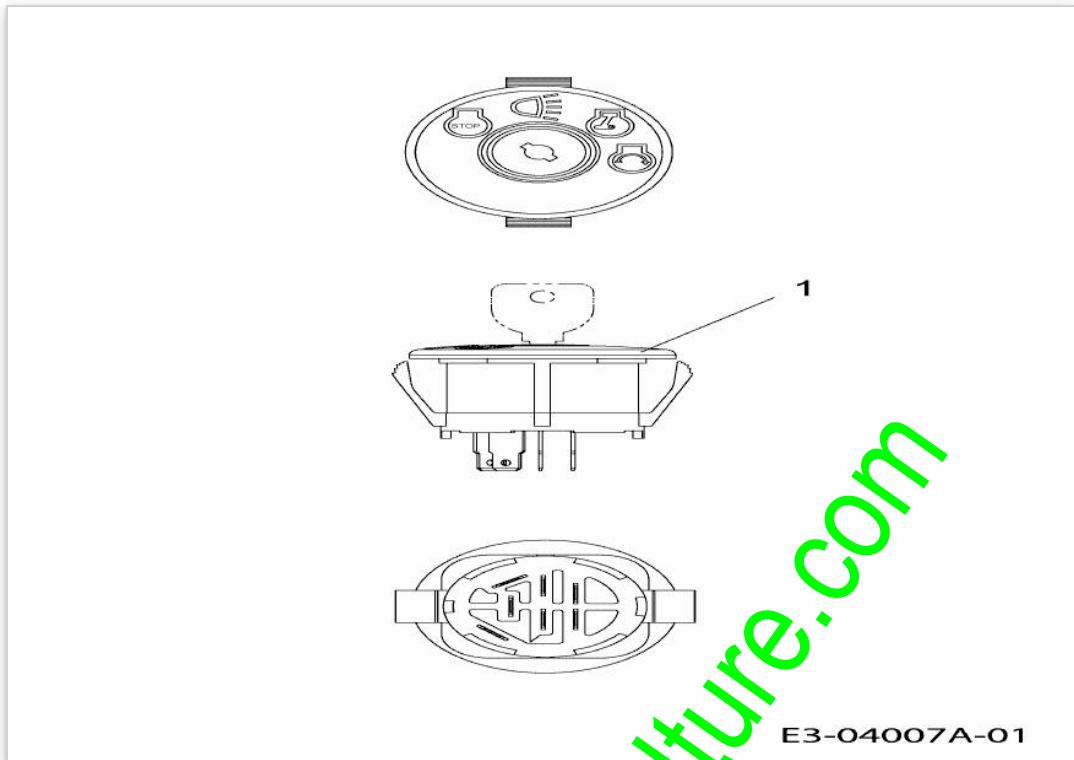

E3-04007A-01

www.emc-motoculture.com

Position	Numéro de lapièce	#	Appellation I	Appellation II
1	725-1741	1	CONTACTEUR A CLE	FINISH: 925-1741

www.emc-motoculture.com

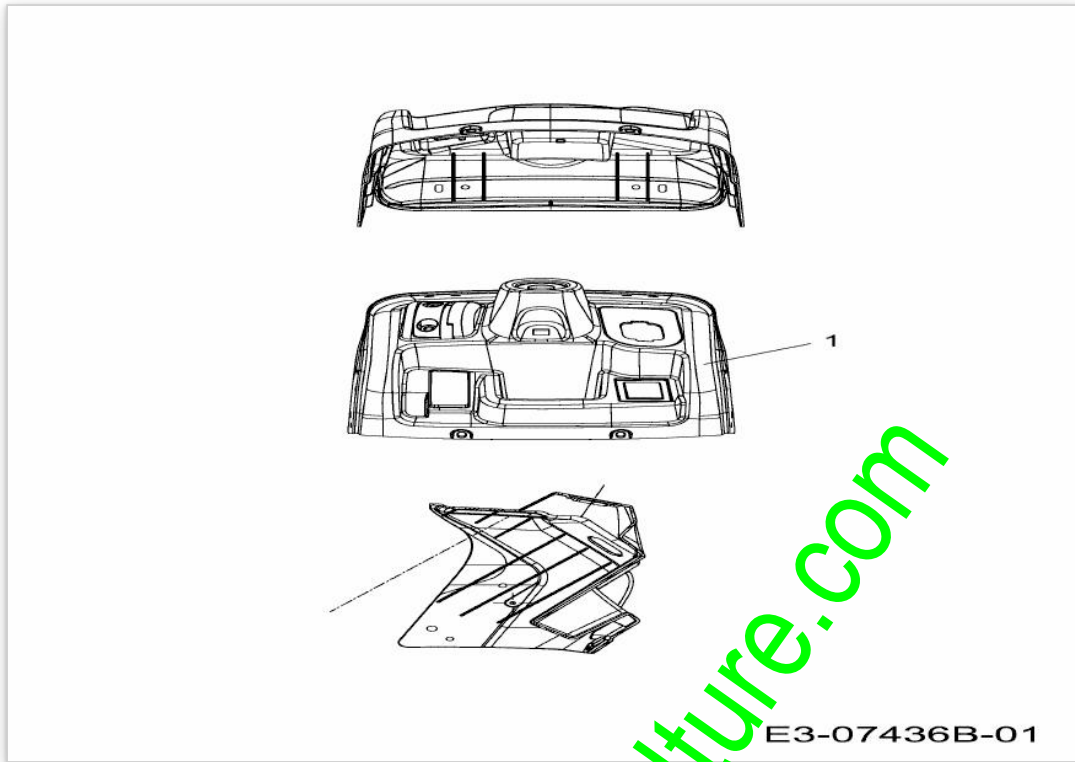

www.emc-motoculture.com

Position	Numéro de lapièce	#	Appellation I	Appellation II
1	731-08542A	1	DASH:UPR:3/6/7/8/D/R/W:w/o AMP	NRMC:FINISH KUNSTSTOFF SCHWARZ

www.emc-motoculture.com

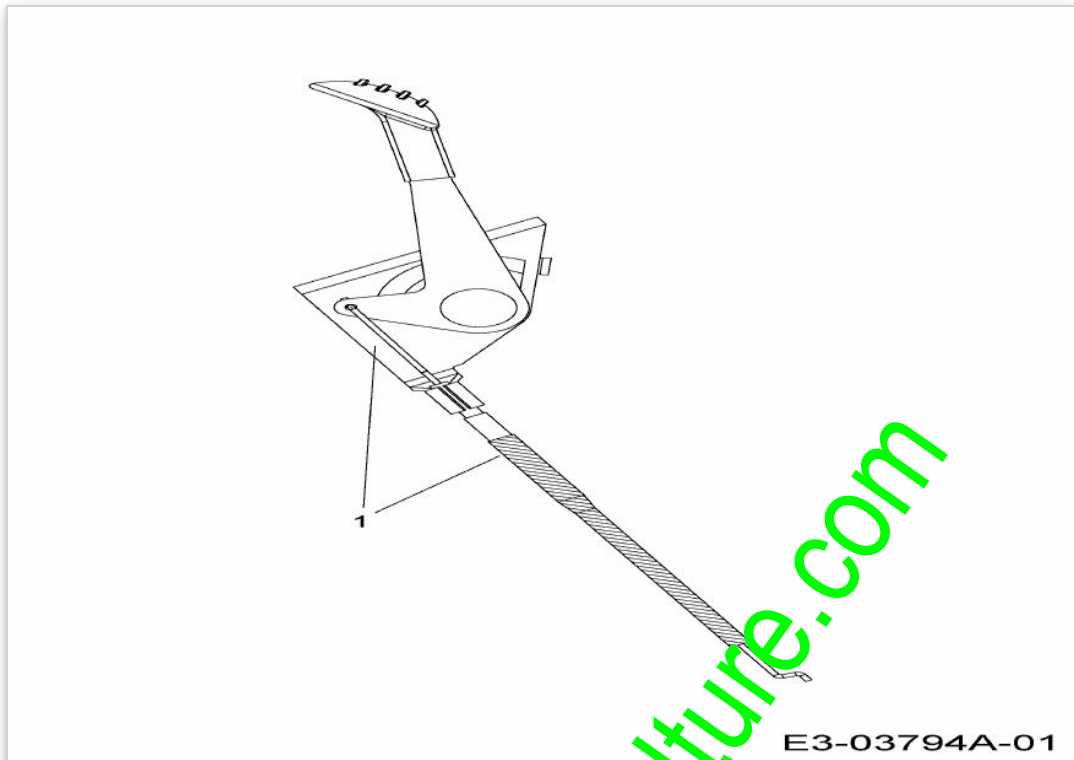

www.emc-motoculture.com

Position	Numéro de lapièce	#	Appellation I	Appellation II
1	746-04406	1	CABLE ACCELERATEUR	FINISH:

www.emc-motoculture.com

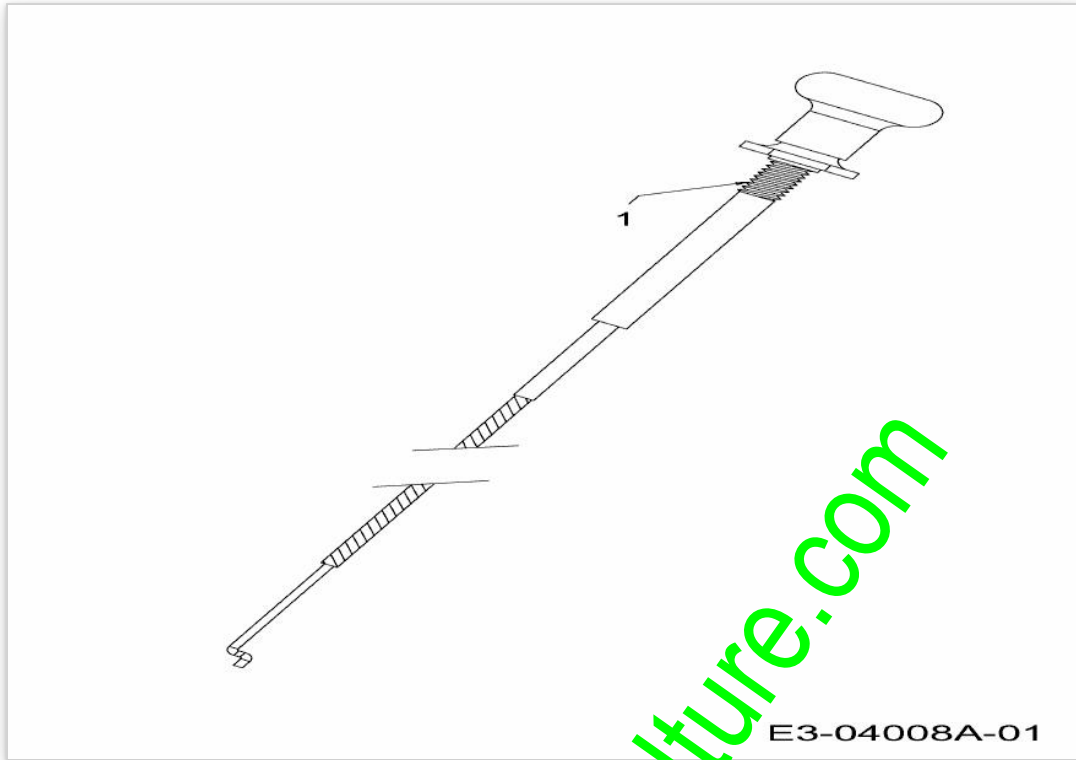

E3-04008A-01

www.emc-motoculture.com

Position	Numéro de lapièce	#	Appellation I	Appellation II
1	746-1089	1	CABLE STARTER	29.0" LG x 1.50 EXT

www.emc-motoculture.com

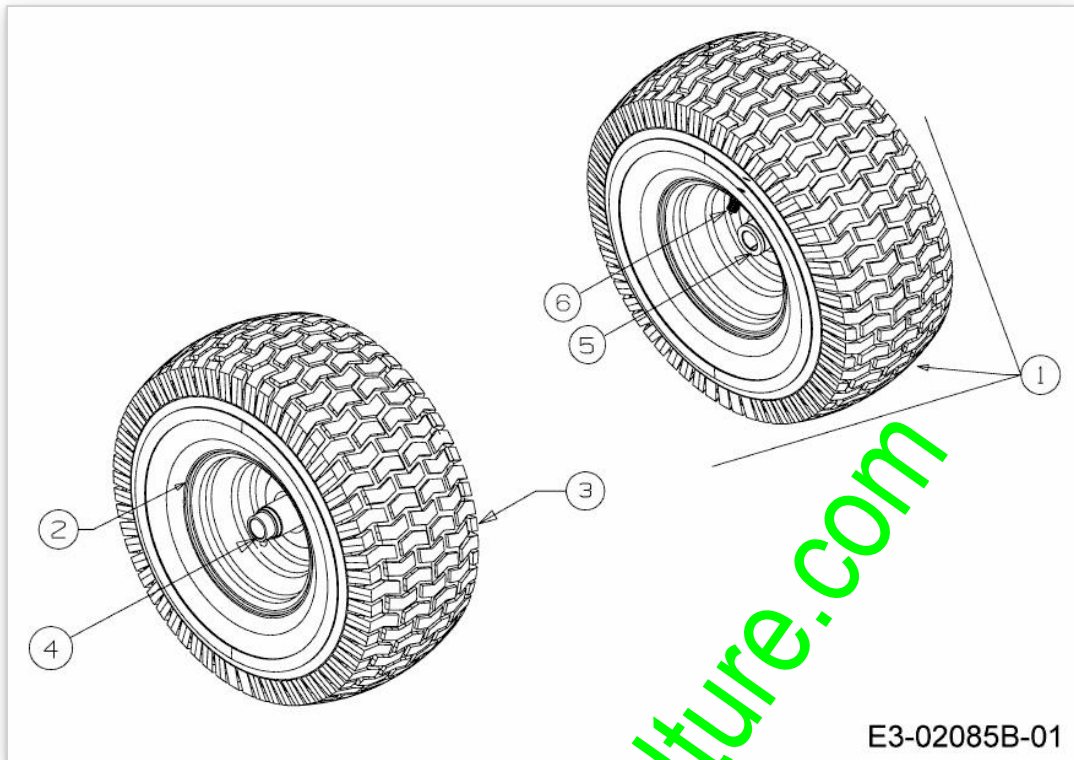

www.emc-motoculture.com

E3-02085B-01

Position	Numéro de lapièce	#	Appellation I	Appellation II
1	634-04086	2	ROUE CPLT	SHL
2	634-04081	1	JANTE CPLT	GLEITLAGER SCHWEIßTEIL
3	734-1731	1	PNEU 15X600X6 DICO MULTI-TRAC	SQ SHOULDER:TURF SAVER
4	741-0990B	1	BAGUE DE ROUE AVEC GRAISSEUR	m.SCHMIERNIPPEL:FINISH SCHWARZ
5	741-0516B	1	BAGUE DE ROUE .760x1.00x1.20	FINISH:SCHWARZ
6	734-0255	1	VALVE:PNEU	TR 412-P / 32.6mm / 934-0255

www.emc-motoculture.com

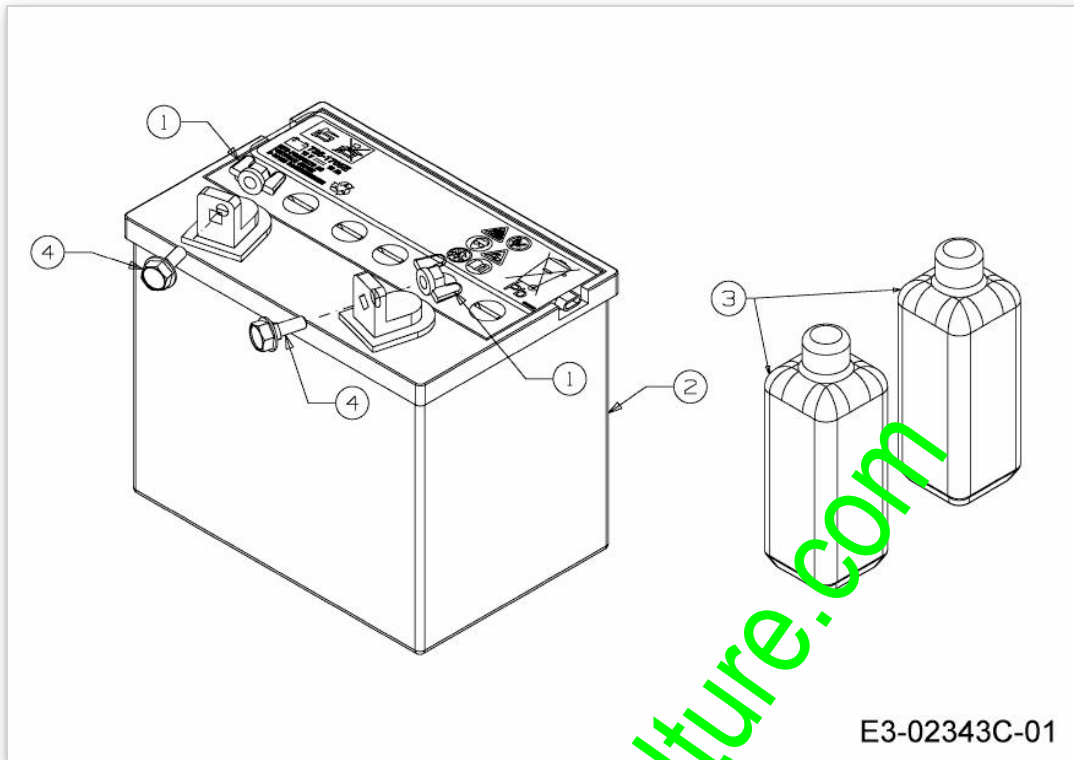

E3-02343C-01

www.emc-motoculture.com

Position	Numéro de lapièce	#	Appellation I	Appellation II
1	712-3087	2	ECROU PAPILLON	FINISH:KUNSTSTOFF SCHWARZ
2	725-1705E	1	BATTERIE:U1:150 CCA TROCKEN	BELÜFTUNG OBEN
3	725-2064	2	BIDON ACIDE 1 LITRE	725-2064
4	738-1132	2	AXE	FINISH:SPEC-100015

www.emc-motoculture.com

ab 01.03.2013
from 01.03.2013
à partir du 01.03.2013

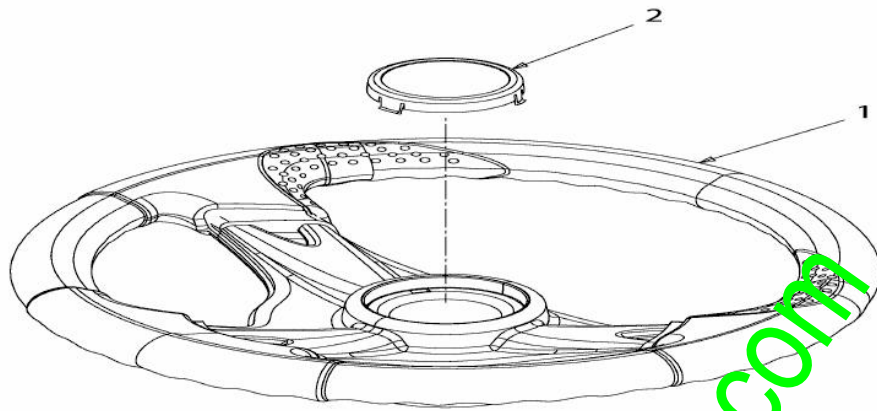

E3-02341A-02

www.emc-motoculture.com

Position	Numéro de lapièce	#	Appellation I	Appellation II
1	631-04008A	1	VOLANT CPL.:3 RAYONS:12"	SOFTGRIP
2	731-04039	1	CAPUCHON DE VOLANT SANS LOGO	FINISH:KUNSTSTOFF SCHWARZ

www.emc-motoculture.com

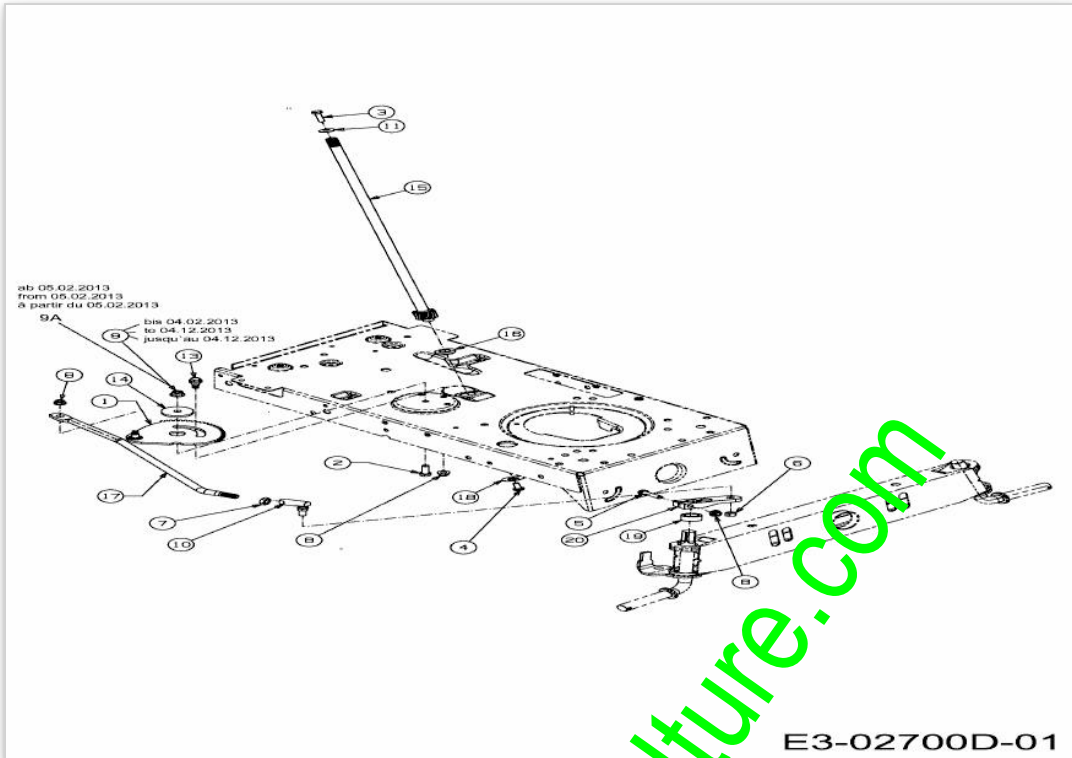

www.emc-motoculture.com

Position	Numéro de pièce	#	Appellation I	Appellation II
1	617-04094	1	SEGMENT DE DIRECTION	SCHWEISSTEIL:PHOS & OIL
2	710-0514	1	VIS HEX.:3/8-16:1.00:GR5:STD	FINISH:MTD SPEC-100015
3	710-0643	1	VIS HEX.: 5/16-18:1.00:GR5	FINISH:MTD SPEC-100015
4	710-1309	1	VIS	FINISH:MTD SPEC-100015
5	710-3180	1	VIS HEX. 5/16-18:1.75:GR5:STD	FINISH:SPEC-100015
6	712-0214	1	ECROU	FINISH:SPEC-100015
7	712-0240	1	ECROU HEX.: 7/16-20:GR2	FINISH:MTD SPEC-100015
8	712-04063	3	ECROU HEX. AVEC FLANC	FINISH:MTD SPEC-100015
9	712-04065	1	ECROU HEXAGONAL	FINISH:SPEC-100015 912-04065
9A	712-0431	1	ECROU STOP 3/8-16:GRF	FINISH:MTD SPEC-100015
10	723-0448A	1	ROTULE DE DIRECTION 7/16-20	FINISH:MTD SPEC-100015
11	736-0242	1	RONDELLE CONIQUE.340X.872X.060	FINISH:MTD SPEC-100016
13	738-04141	1	AXE	FINISH:SPEC-100015
14	738-04162C	1	RONDELLE EPAULEE	FINISH:DAMPFBEHANDELT
15	738-0919A	1	COLONNE DE DIRECTION	FINISH:PHOS & OIL
16	741-04124	1	PALIER DE BRIDE	FINISH:PLAIN
17	747-05385	1	TRINGLE DE DIRECTION	FINISH:701-01007
18	748-0389	1	BAGUE	FINISH:GEÖLT
19	748-04068	1	DOUILLE .71IDX.125 ODX.56 LG	FINISH:SPEC-100015
20	748-04278ZW	1	BELLETTTE DE DIRRECTION	FINISH:BLAU CHROMATIEREN

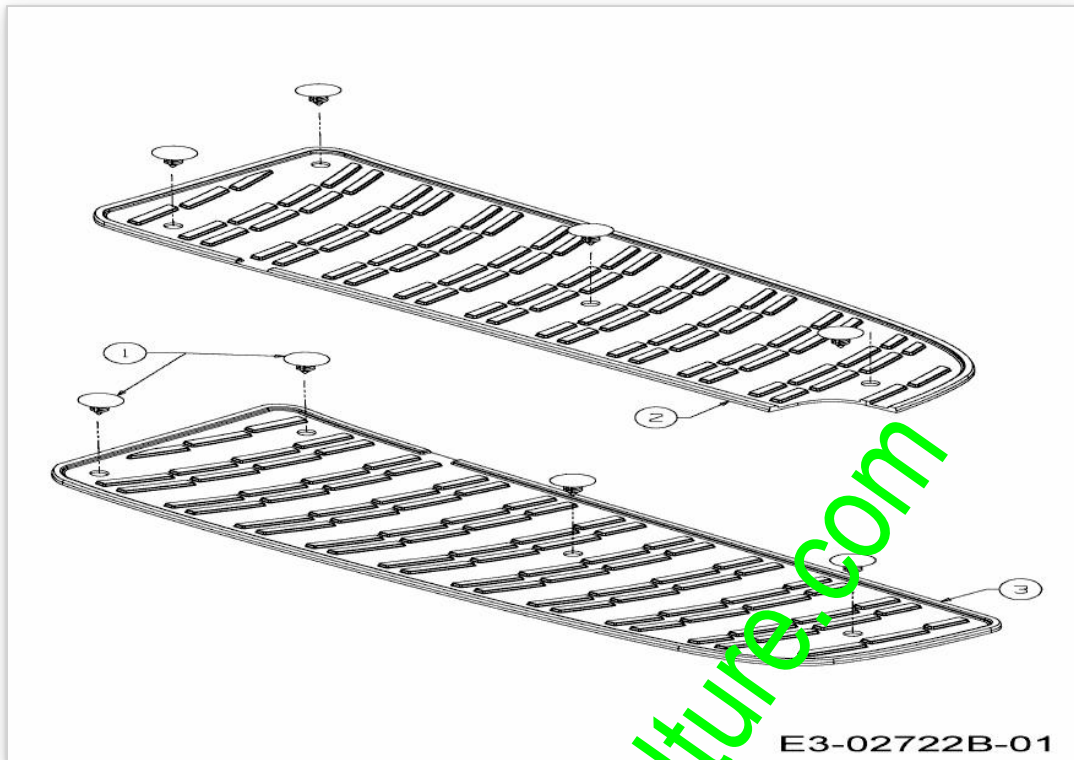

E3-02722B-01

www.emc-motoculture.com

Position	Numéro de lapièce	#	Appellation I	Appellation II
1	726-3046	8	CLIP DE FIXATION:.250 DIA	FINISH:KUNSTSTOFF SCHWARZ
2	735-04047	1	MARCHE PIED GAUCHE	FINISH:SCHWARZ
3	735-04048	1	MARCHE PIED DROITE	FINISH:SCHWARZ

www.emc-motoculture.com

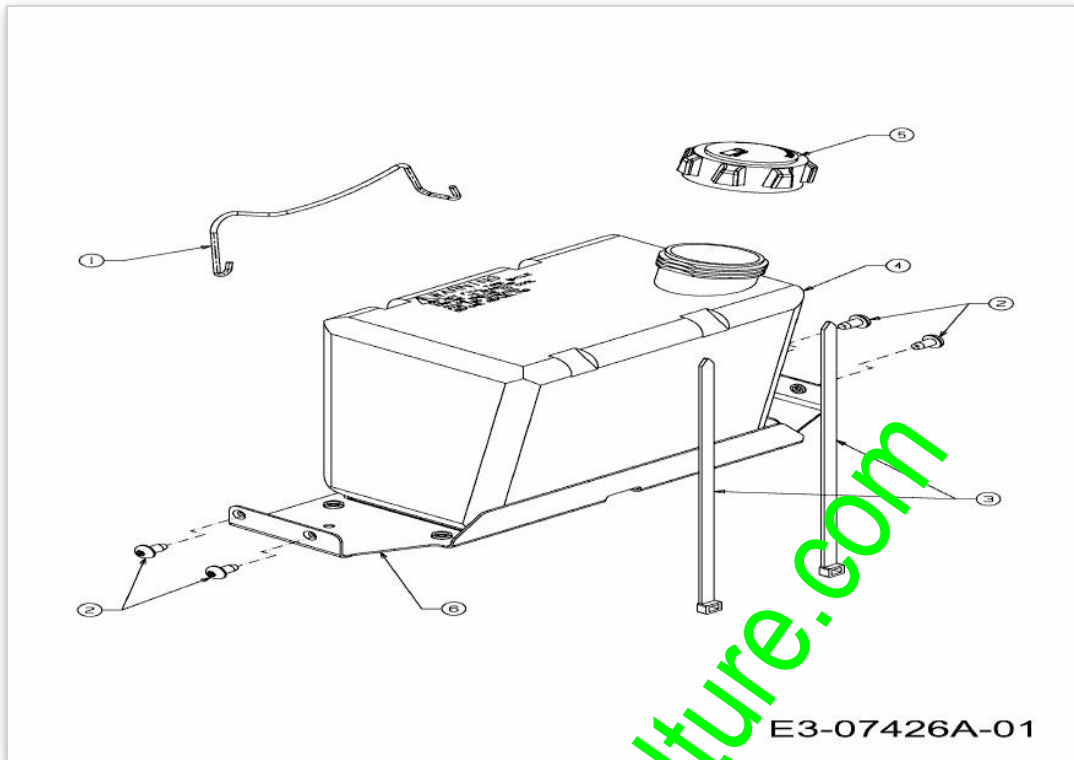

www.emc-motoculture.com

Position	Numéro de pièce	#	Appellation I	Appellation II
1	683-04448637	1	TRINGLE SUPPORT BATTERIE	683-04448-0637
2	710-05070	4	VIS	FINISH: SCHWARZ SPEC 701-01010
3	726-0230	2	COLLIER	FINISH: SCHWARZ
4	751-0553	1	RESERVOIR 5 L ENV.	FINISH: NATUR SIEHE ZG.
5	751-0603A	1	BOUCHON ESSENCE	KUNSTSTOFF SCHWARZ -OBSOLETE-
6	783-07083637	1	SUPPORT DE RESERVOIR ESSENCE	FINISH: LACKIERT MTD QUALITÄT

www.emc-motoculture.com

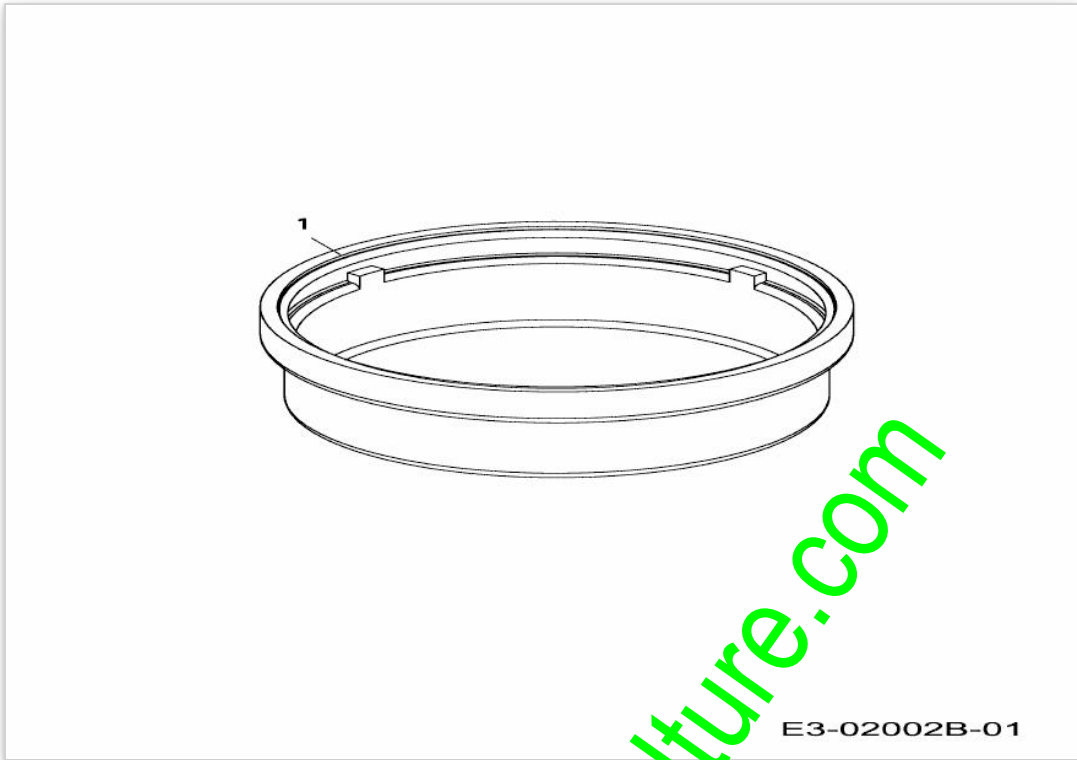

E3-02002B-01

www.emc-motoculture.com

Position	Numéro de lapièce	#	Appellation I	Appellation II
1	731-0484A	2	ENJOLIVEUR DEVANT	KUNSTSTOFF SCHWARZ 931-0484A

www.emc-motoculture.com

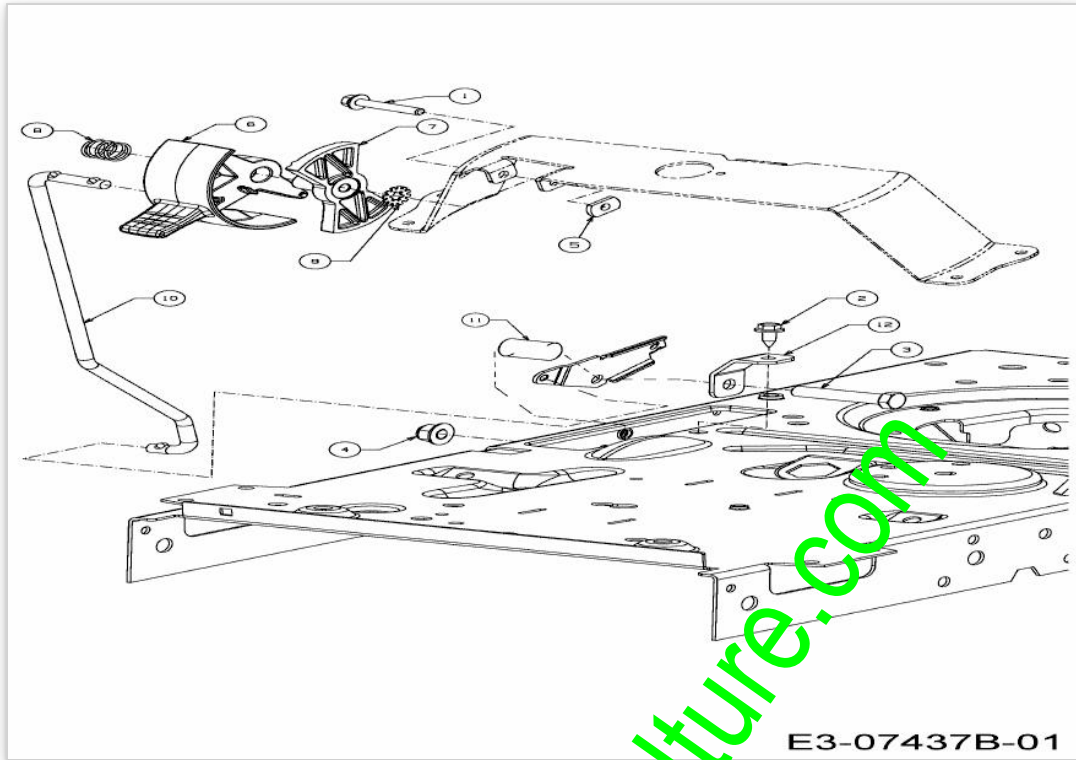

www.emc-motoculture.com

Position	Numéro de pièce	#	Appellation I	Appellation II
1	710-05237	1	VIS	FINISH:MTD SPEC-100015
2	710-1652	1	VIS HEX. TT:1/4-20:.625:HXINDW	FINISH:MTD-SPEC-100016 TYPE 1
3	710-3144	1	VIS HEX.: 3/8-16:2.00:GR5:STD	FINISH:SPEC-100015 910-3144
4	712-04065	1	ECROU HEXAGONAL	FINISH:SPEC-100015 912-04065
5	712-0414	1	ECROU 1/4-20	FINISH:PLAIN
6	731-07885B	1	POIGNEE DE VITESSE	FINISH:KUNSTSTOFF GELB
7	731-07966A	1	SELECTEUR	FINISH PLAIN: (SCHWARZ)
8	732-04877	1	RESSORT	FINISH:MTD SPEC-100015
9	736-3006	1	RONDELLE 1/4 X -75	FINISH:SPEC-100016
10	747-05398	1	TRINGLE DE VITESSE	FINISH:SPEC-100015
11	750-04465C	1	ENTRETOISE	FINISH:GEÖLT
12	783-06823	1	SUPPORT	KONTROLLHEBEL:VERZ.SIEHE ZG.

www.emc-motoculture.com

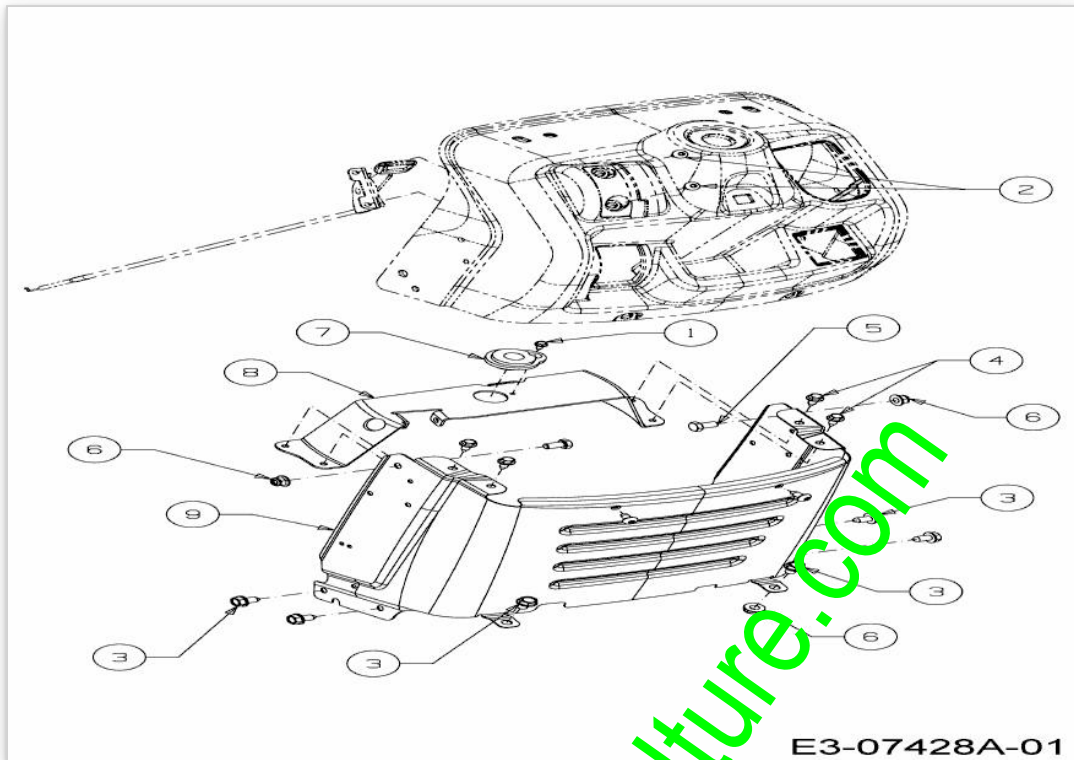

www.emc-motoculture.com

Position	Numéro de lapièce	#	Appellation I	Appellation II
1	710-0224	1	VIS PARK:#10- 16:0.500:HXINDWSH	FINISH:MTD SPEC-100016 TYPE 1
2	710-05070	4	VIS	FINISH:SCHWARZ SPEC 701-01010
3	710-0604A	6	VIS 5/16-18:0.625	FINISH:MTD SPEC-100016 TYPE 1
4	710-1652	4	VIS HEX. TT:1/4- 20:.625:HXINDW	FINISH:MTD-SPEC-100016 TYPE 1
5	710-3025	2	VIS	FINISH:MTD SPEC-100015
6	712-04063	3	ECROU HEX. AVEC FLANC	FINISH:MTD SPEC-100015
7	741-0587	1	SUPPORT	FINISH:NAT UR
8	783-06785A	1		
9	783-06811	1		

www.emc-motoculture.com

ab 04.02.2013
from 04.02.2013
à partir du 04.02.2013

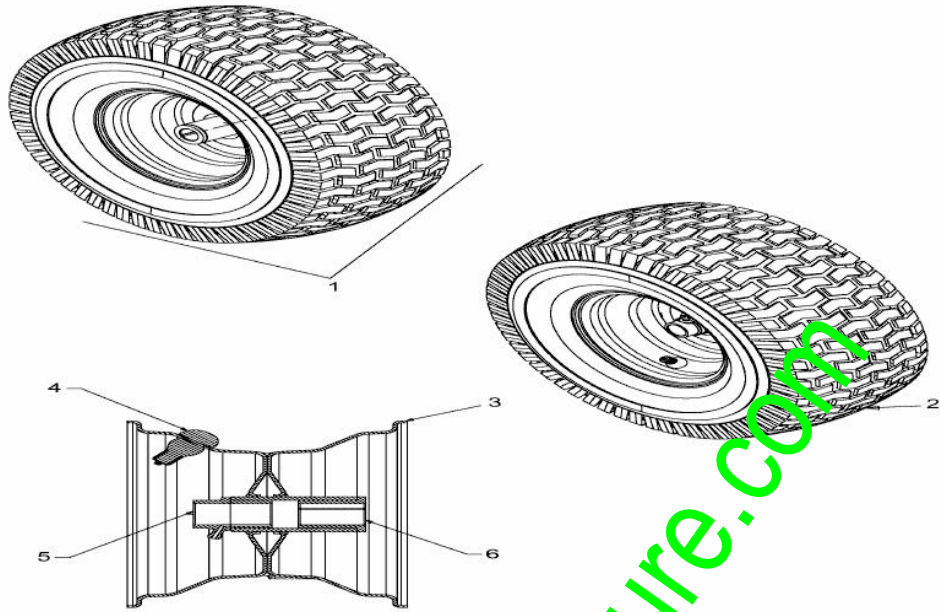

E3-08077A-01

www.emc-motoculture.com

Position	Numéro de pièce	#	Appellation I	Appellation II
1	634-05067-G	2	VORDERRAD KPL. 15x6x6	634-05067-G
2	734-1731	2	PNEU 15X600X6 DICO MULTI-TRAC	SQ SHOULDER:TURF SAVER
3	634-05066-G	2	FELGE VST:6.0x4.5:GLEITL.Ø 1.0	FINISH:OYSTER GRAY 788-0662
4	734-0255	2	VALVE:PNEU	TR 412-P / 32.6mm / 934-0255
5	741-0990B	2	BAGUE DE ROUE AVEC GRAISSEUR	m.SCHMIERNIPPEL:FINISH SCHWARZ
6	741-0516B	2	BAGUE DE ROUE .760x1.00x1.20	FINISH:SCHWARZ

www.emc-motoculture.com

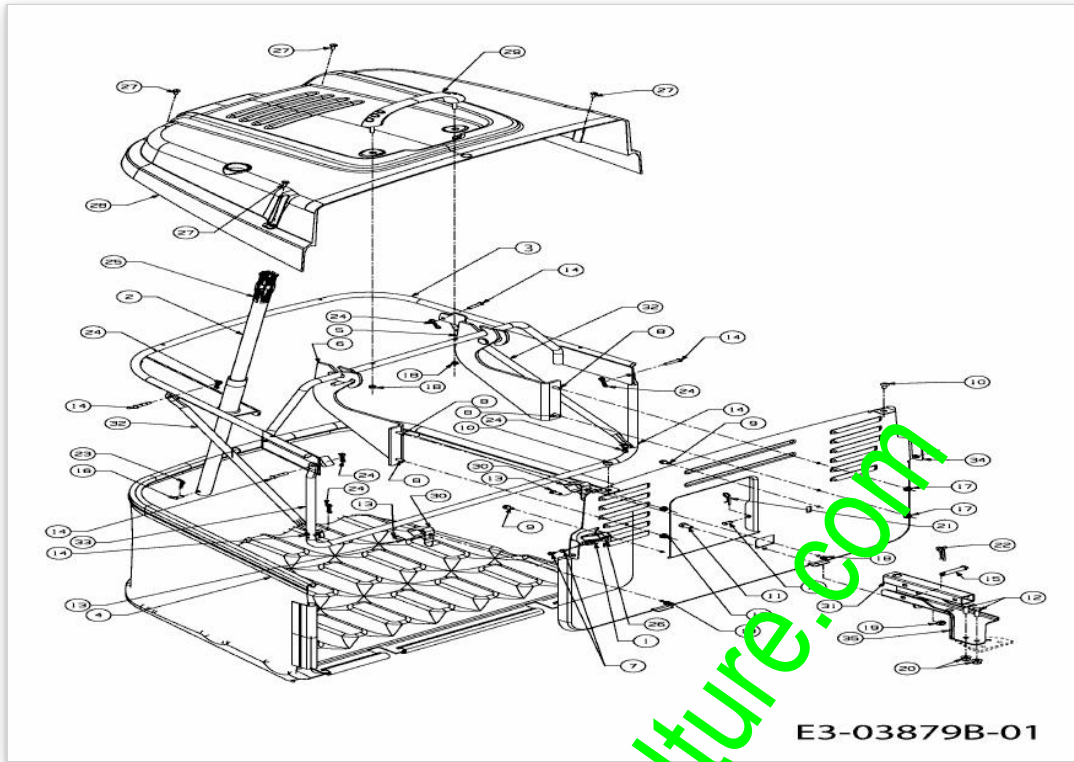

www.emc-motoculture.com

Position	Numéro de lapièce	#	Appellation I	Appellation II
1	17962	1	PLAQUE DE SUPP. P. COMMUTATEUR	FINISH:WIE GESTANZT
2	649-04052	1	STAHLROHR VST:HEBEL:GRSBG:500	SCHWEISSTEIL:FINISH:LACKIERT
3	649-04076637	1	ARMATURE DE BAC	SCHWARZ
4	664-04085	1	TISSU BAC DE RAMASSAGE	700:FINISH SCHWARZ
5	683-04421	1	EINHÄNGEKONSOLE VOLLST:LINKS	SCHWEISSTEIL:FINISH:LACKIERT
6	683-04422	1	EINHÄNGEKONSOLE VOLLST:RECHTS	SCHWEISSTEIL:FINISH:LACKIERT
7	710-0224	2	VIS PARK:#10- 16:0.500:HXINDWSH	FINISH:MTD SPEC-100016 TYPE 1
8	710-04666	4	VIS HEXAGONALE	FINISH:MTD SPEC-100015
9	710-0599	2	VIS A SIX PANS CREUX	FINISH:MTD SPEC-101617
10	710-1017	2	VIS	FINISH:MTD SPEC-100016
11	710-1376	1	VIS A SIX PANS CREUX	FINISH:SPEC-100015 21.1441.68
12	710-1682	2	VIS	FINISH:SPEC-100015 21.1441.72
13	710-1690	2	VIS	MTD SPEC-100015 21.1441.46
14	711-04138	6	GOUJON ; ÜPINGLER .25DIAx1.25L	FINISH:MTD SPEC-100015
15	711-0679A	1	GOUJON ; ÜPINGLER	GR5:FINISH MTD SPEC-100015
16	711-0701	3	GOUJON	FINISH:MTD SPEC-100015
17	712-04064	4	ECROU HEXAGONAL	FINISH:SPEC-100015 912-04064
18	712-0691	4	ECROU HEXAGONAL	MTD SPEC-100015 24.1426.14
19	712-0692	1	ECROU HEXAGONAL 24.1426.18	FINISH:SPEC-100015 24.1426.18
20	712-0714	2	ECROU	FINISH:MTD SPEC-100015
21	714-0145	2	GOUPILLE	FINISH:SPEC-701-01006
22	714-0147	1	GOUPILLE ; RESSORT:.125 x 1.75	FINISH:MTD SPEC-701-01006
23	714-04033	1	GOUPILLE FENDUE .072 x.92 LG	FINISH: MTD SPEC-100016
24	714-04040	6	GOUPILLE	FINISH:ASTM F1941 FE/ZN 3AN
25	720-0204	1	POIGNEE:1.0 ID x 4.7 LG	FINISH:SCHWARZ
26	725-04039	1	SECURITE	FINISH:GRAY/BLACK 925-04039
27	728-04044	4	RIVET	WÜRTH #093614816
28	731-06106	1	COUVERCLE DE BAC	FINISH:KUNSTSTOFF SCHWARZ
29	731-06163	1	POIGNEE	FINISH:SCHWARZ
30	732-0838A	2	RESSORT CLIPS DE BAC	VERSCHLUSS:FINISH SPEC-100015
31	749-04013A	1	4KT- ROHR:ANHÄNGEKUPPLUNG	30x30mmx179.39mm LG ST37:LACK

Position	Numéro de lapièce	#	Appellation I	Appellation II
32	749-04108	2	KREUZ- VERBINDUNGSROHR:BAG 250L	FINISH:LACKIERT 500 MR
33	749-04418	1	ROHRRAHMEN:VORN:200L	FINISH:LACKIERT
34	783-05731	1	HECKPLATTE:E/N-DECK:LT5	FINISH:LACKIERT MTD QUALITÄT
35	783-05801A	1	SUPPORT	FINISH:LACKIERT MTD QUALITÄT

www.emc-motoculture.com

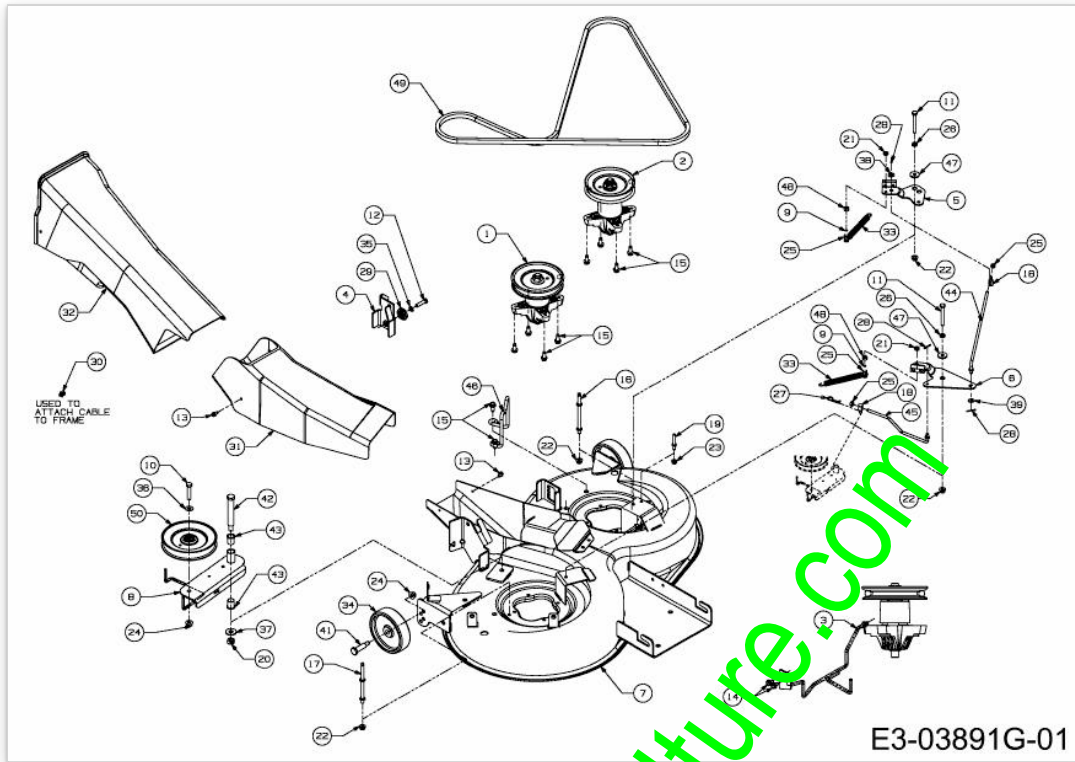

www.emc-motoculture.com

E3-03891G-01

Position	Numéro de lapièce	#	Appellation I	Appellation II
1	918-0324D	1	PALIER DE LAME CPL.D :	RIEMENSCHLEIBE 5.75 DIA
2	618-0409C	1	PALIER DE LAME COMPLET	
3	647-04144-Z	1	TRINGLE SUPPORT PLATEAU	FINISH:GELBVERZINKT (101616)
4	683-04396	1	SUPPORT PLATEAU	SCHWEISSTEIL:LACKIERT LT-5
5	983-04409	1	FREIN DE LAME	LT5: NIETTEIL
6	683-04417	1	FREIN DE LAME	LT5: NIETTEIL
7	683-04418	1	CARTER DE COUPE 92 CM	SCHWEISSTEIL:FINISH:LACKIERT
8	683-04420	1	SPANNROLLENTRÄGER VOLLST.	SCHWEISSTEIL:FINISH:LACKIERT
9	710-0106	2	VIS HEX. 1/4-20:1.25:GR5:SPEC	FINISH:MTD SPEC-100015
10	710-0347	1	VIS HEX. 3/8-16:1.75:GR5:STD	FINISH:MTD SPEC-100015
11	710-0378	2	VIS HEX.:5/16-18:2.50:GR5:STD	FINISH:MTD SPEC-100015
12	710-0528	1	VIS HEX. 5/16-18:1.25:GR5:STD	FINISH:SPEC-100015 910-0528
13	710-0599	2	VIS A SIX PANS CREUX	FINISH:MTD SPEC-101617
14	710-0607	2	VIS HEX.TT5/16-18:.500HXINDWSh	FINISH:MTD SPEC-100016 TYPE 1
15	710-1260A	10	VIS TT:5/16-18:.750	FINISH:SPEC-100016 TYPE 1
16	711-05319	1	GUIDE COURROIE	SCHWEISSTEIL:FINISH:PHOS & OIL
17	711-05320	1	GUIDE COURROIE	SCHWEISSTEIL:FINISH:PHOS & OIL
18	711-0736	2	AXE	FINISH:MTD SPEC-100015
19	711-0993	1	GUIDE COURROIE	FINISH:701-01006 911-0993
20	712-0290	1	ECROU 7/16-14	FINISH:MTD SPEC-100015
21	712-0291	2	ECROU EX AF-43013	FINISH:ASTM F1941 FE/ZN 3AN
22	712-04063	4	ECROU HEX. AVEC FLANC	FINISH:MTD SPEC-100015
23	712-04064	1	ECROU HEXAGONAL	FINISH:SPEC-100015 912-04064
24	712-04065	3	ECROU HEXAGONAL	FINISH:SPEC-100015 912-04065
25	712-3006	4	ECROU HEXAGONAL	FINISH:SPEC-100015
26	712-3007	2	ECROU HEX. 5/16-18 GR5	FINISH:MTD SPEC-100015
27	714-0145	1	GOUPILLE	FINISH:SPEC-701-01006
28	714-0507	3	GOUPILLE FENDUE 3/32 X .750	FINISH:MTD SPEC-100015
29	717-04074	1	PIGNON HAUTEUR PLATEAU	PHOS & SPEC-100015 917-04074
30	729-04033	1	CLIPS SERRE CABLE	729-04033
31	731-06251	1	CANAL D'EJECTION INFERIEUR	FINISH:SCHWARZ
32	731-06252	1	CANAL D'EJECTION SUPERIEUR	FINISH:SCHWARZ
33	732-0604A	2	RESSORT	FINISH:PHOS AND OIL
34	734-0973	2	ROULETTE DE PLATEAU	FINISH:KUNSTSTOFF SCHWARZ
35	736-0119	1	RONDELLE	FINISH:MTD SPEC-100016
36	736-0300	1	RONDELLE	FINISH:MTD SPEC-100015
37	736-04097A	1	RONDELLE:PLATE:11.65x28.75x3mm	FINISH:MTD SPEC-100015
38	736-0700	1	RONDELLE A8.4 DIN 125	MTD SPEC-100015 24.6481.18
39	736-3020	1	RONDELLE	FINISH:MTD SPEC-100015
41	738-0373	2	VIS A EPAULE .496x1.525:3/8-16	FINISH:MTD SPEC-100015
42	738-0476	1	VIS A EPAULE .625x3.50:7/16-14	FINISH:SPEC-100015

Position	Numéro de lapièce	#	Appellation I	Appellation II
43	741-0591	2	BAGUE	FINISH:NATUR 941-0591
44	747-04781	1	TIGE DE FREIN	FINISH:SPEC-100015
45	747-04782B	1	TIGE DE FREIN	FINISH:SPEC-100015
46	747-04840	1	GUIDE COURROIE	FINISH:SPEC-100015
47	748-0234	2	RONDELLE EPAULEE	FINISH:ROSTPREVENTION
48	750-05381	2	ENTRETOISE	FINISH:IN ÖL SAE 30 GEDIPPT
49	754-04175	1	COURROIE DE COUPE 92 CM	FINISH:
50	756-04050	1	POULIE DE COURR. TR. Ø 6.0"DIA	KUGELGELAGERT:SCHWARZ LACKIERT

www.emc-motoculture.com

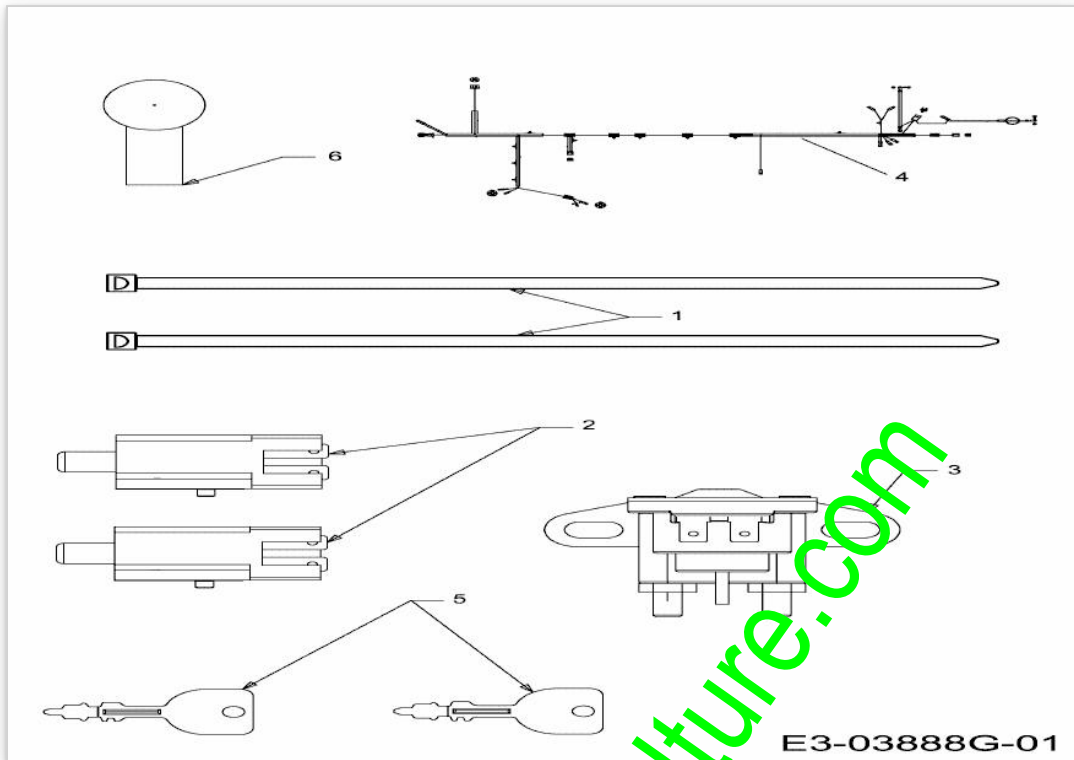

E3-03888G-01

Position	Numéro de lapièce	#	Appellation I	Appellation II
1	725-0157	2	COLLIER DE SERRAGE3/16X0.5X7.4	MATERIAL:NYLON-SCHWARZ
2	725-04363	2	SECURITE EMBRAYAGE	FINISH:SIEHE ZG.
3	725-04439	1	COMMUTATEUR MAGNÜTIQUE	12V:100 AMP
4	725-05502	1	FAISCEAU ELECTRIQUE	RR BAG
5	725-1744A	2	CLE DE CONTACT	FINISH:
6	725-3237	1	COUVERCLE POLE / ROUGE	BATTERIE FINISH:ROT

www.emc-motoculture.com

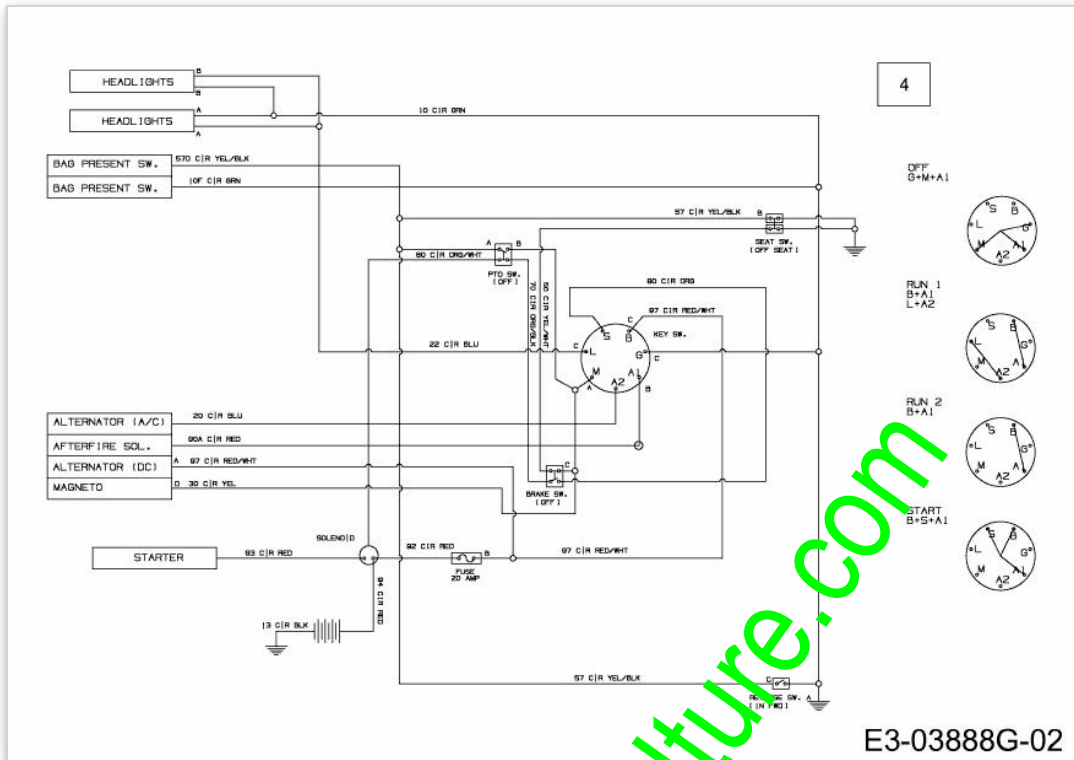

www.emc-motoculture.com

Position	Numéro de lapièce	#	Appellation I	Appellation II
4	725-05502	1	FAISCEAU ELECTRIQUE	RR BAG

www.emc-motoculture.com

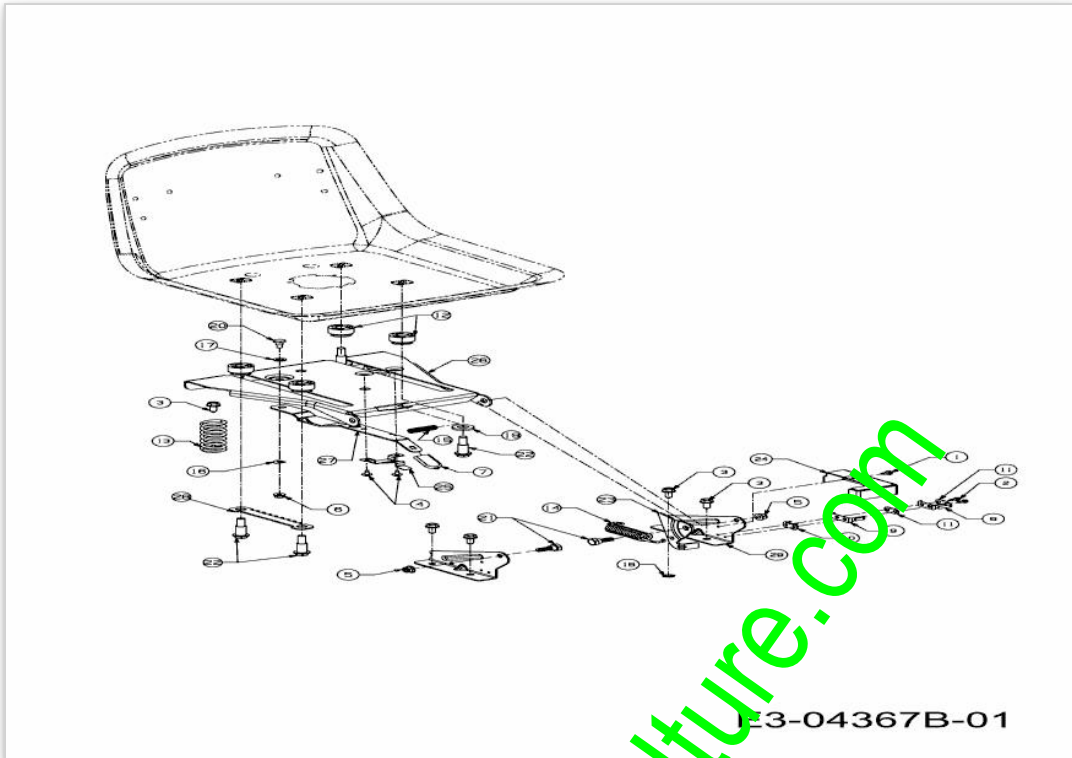

www.emc-motoculture.com

Position	Numéro de lapièce	#	Appellation I	Appellation II
1	710-0224	1	VIS PARK:#10- 16:0.500:HXINDWSH	FINISH:MTD SPEC-100016 TYPE 1
2	710-0227	2	VIS	FINISH:MTD SPEC-100016 TYPE 1
3	710-04484	6	VIS HEX. TT:5/16- 18:.750:HXIND	FINISH:MTD SPEC-100016 TYPE 1
4	710-1268	2	VIS HEX.:B#10-16:0.375	HXINDWSH:SP FINISH:701-01002
5	712-04063	2	ECROU HEX. AVEC FLANC	FINISH:MTD SPEC-100015
6	712-04064	1	ECROU HEXAGONAL	FINISH:SPEC-100015 912-04064
7	720-0309A	1	POIGNÛE PLASTIQUE	FINISH:SCHWARZ
8	725-1303	1	RESSORT DE SURETE SIËGE	SI.-SCHALTER SITZ:SPEC-100015
9	725-1439	1	RESSORT SURETE DE SIEGE	SI.-SCHALTER SITZ:SPEC-100015
10	726-0278	1	PLAQUE D'ISOLATION	FINISH:NATUR ODER SCHWARZ
11	726-0279	2	PLAQUE D'ISOLATION	FINISH:NATUR ODER SCHWARZ
12	731-04074	4	ENTRETOISE PLASTIQUE DE SIEGE	FINISH:SCHWARZ
13	732-04035	2	RESSORT DE SIEGE	FINISH:SPEC-100015
14	732-04309	1	RESSORT	FINISH:MTD STD 701-01006
15	732-0499	1	RESSORT	FINISH:SPEC-100015
16	736-0175	1	RONDELLE GROWER:.265x.562x.025	FINISH:701-01001
17	736-0204	1	RONDELLE .344 X 62 X.03	FINISH:MTD SPEC-100015
18	736-0607	1	RONDELLE	FINISH:MTD SPEC-100016
19	736-3019	2	RONDELLE .531x1.062x.134:HT	FINISH:MTD SPEC-100016
20	738-0137A	1	VIS A EPAULE .340 X .285:1/4-2	FINISH:GM4435M CODE A
21	738-0296	2	AXE EPAULE	FINISH:SPEC-100015
22	738-0966A	1	VIS EPAULEE	FINISH:MTD SPEC 701-01006
23	783-0209D	1	SUPP. SIËGE	FINISH:SPEC-100016
24	783-04877A	1	783-06279	FINISH:LACKIERT
25	783-0611	1	ARRET AJUSTAGE DE SIEGE	FINISH:PHOS & OIL
26	783-0738D	1	SUPPORT DE SIËGE	FINISH:LACKIERT
27	783-0739A	1	LEVIER DE RÜGLAGE	FINISH:LACKIERT
28	783-0753	1	CREMAILLERE REGLAGE SIEGE	FINISH:SPEC-100015
29	783-1489D	2	783-1489B-4015 / FEUERROTQ	

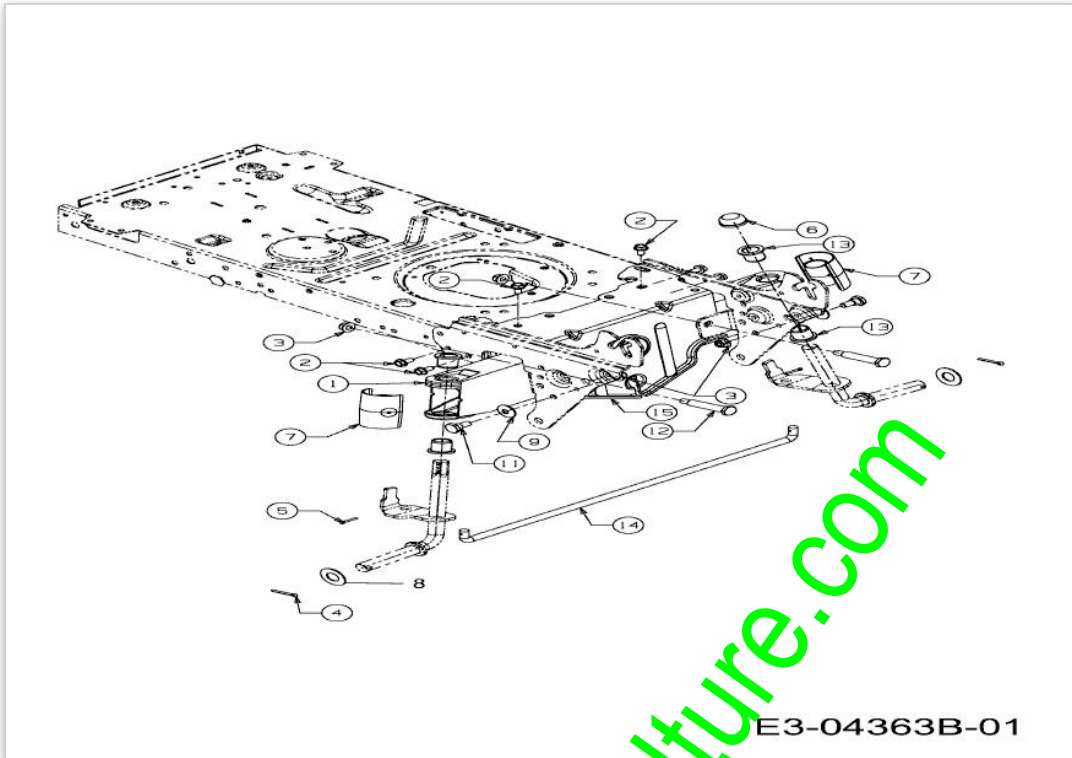

www.emc-motoculture.com

Position	Numéro de pièce	#	Appellation I	Appellation II
1	683-0128B637	1	ESSIEU AVANT	SCHWARZ GEPULVERT
2	710-04484	6	VIS HEX. TT:5/16-18:.750:HXIND	FINISH:MTD SPEC-100016 TYPE 1
3	712-04065	4	ECROU HEXAGONAL	FINISH:SPEC-100015 912-04065
4	714-0162	2	GOUPILLE FENDUE 5/32:1.25	FINISH:MTD SPEC-100015
5	714-0474	2	GOUPILLE	FINISH:MTD SPEC-100015
6	726-0341	1	CAPUCHON CLIPS	FINISH:SCHWARZ
7	731-1291A	2	CARTER PLASTIQUE	MATERIAL:PP SCHWARZ:LT5
8	736-0316	2	RONDELLE 1.78XA1.59"	FINISH:MTD SPEC-100015
9	736-0331	2	RONDELLE CONIQUE	FINISH:MTD SPEC-100016
11	738-0143	2	VIS EPAULEE	FINISH:MTD SPEC 100015 (EU)
12	738-04128	2	VIS A EPAULE .500x2.38:3/8-16	FINISH:MTD SPEC-100015
13	741-0660A	4	BAGUE ESSIEU DE ROUE	FINISH:KUNSTSTOFF SCHWARZ
14	747-04299A	1	TRINGLE DE DIRECTION	FINISH:SPEC-100015 or E-Coat
15	783-05326B-S	1	SUPPORT AVANT	FINISH:LACKIERT MTD QUALITÄT

www.emc-motoculture.com

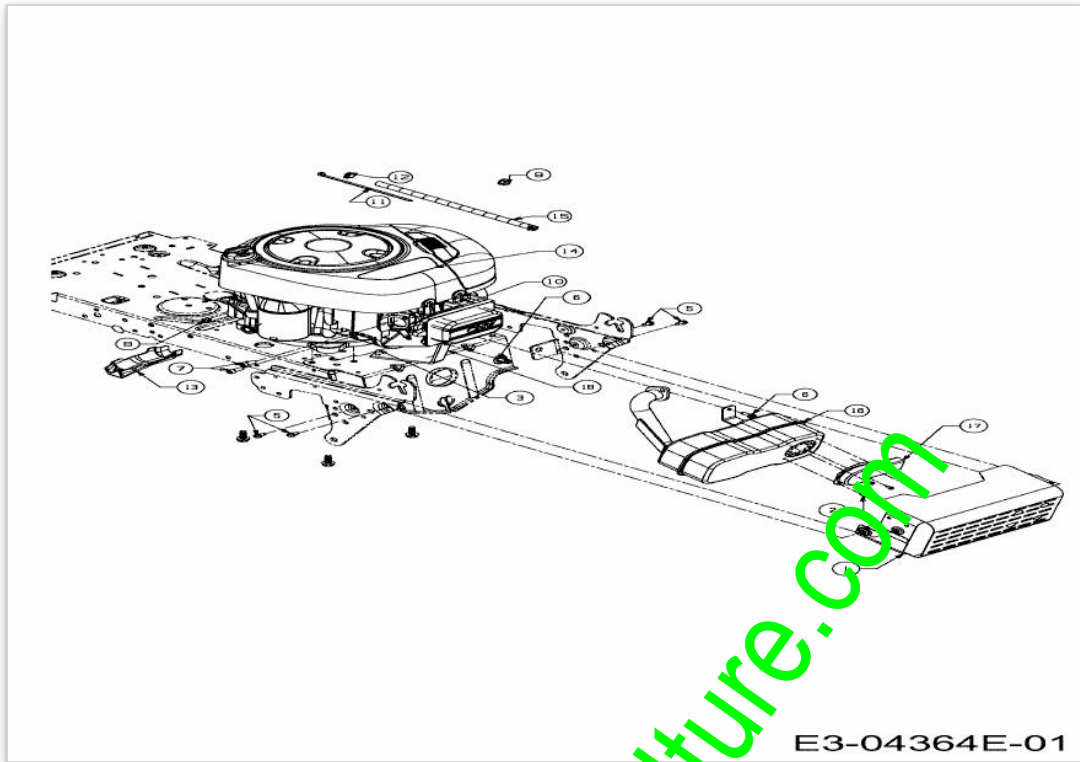

E3-04364E-01

www.emc-motoculture.com

Position	Numéro de lapièce	#	Appellation I	Appellation II
1	683-04549	1	PROTECTION D ECHAPPEMENT	SCHWEISSTEIL:FINISH LACKIERT
2	710-0227	4	VIS	FINISH:MTD SPEC-100016 TYPE 1
3	710-04484	1	VIS HEX. TT:5/16-18.:.750:HXIND	FINISH:MTD SPEC-100016 TYPE 1
4	710-04683A	4	VIS	FINISH:MTD SPEC-701-01002
5	710-0599	4	VIS A SIX PANS CREUX	FINISH:MTD SPEC-101617
6	710-0642	2	VIS1/4-20:0.750	SPEC-100016 TYPE 1 910-0642
7	710-1314A	2	VIS HEX. INT. 5/16-18.:.75:GR8	FINISH: GM4435M CODE A
8	712-0271	1	ECROU 1/4-20"+ DISQUE DENTE	FINISH:MTD SPEC-100016 GR5
9	712-3005	1	ECROU AVEC FLANC:3/8-16:GR5	FINISH:SPEC-100015 912-3005
10	721-0208	1	JOINT ECHAP B/S MONO CYLINDRE	FINISH:R&S #272293
11	725-0157	1	COLLIER DE SERRAGE3/16X0.5X7.4	MATERIAL:NYLON-SCHWARZ
12	726-0205	2	COLLIER DE SERRAGE DE BOYAU	FINISH:PHOS UND GELB LACKIERT
13	731-05628	1	GOUTIERE VIDANGE D HUILE	FINISH:Schwarz
15	751-0535	13	TUYAU ESSENCE NOIR	Ø12,7+/-5.84 / Ø6,35+/-0,41
16	751-10536A	1	SILENCIEUX	MATERIAL:ALUMINIERTER STAHL
17	751-11053A	1	DEFLECTEUR D ECHAPPEMENT	LANGER ABGASKANAL:ALUMINIZED
18	783-06509	1	KONSOLE:MOTORBEFESTIGUNG.R&S	MODELL 21:FINISH LACKIERT *

www.emc-motoculture.com

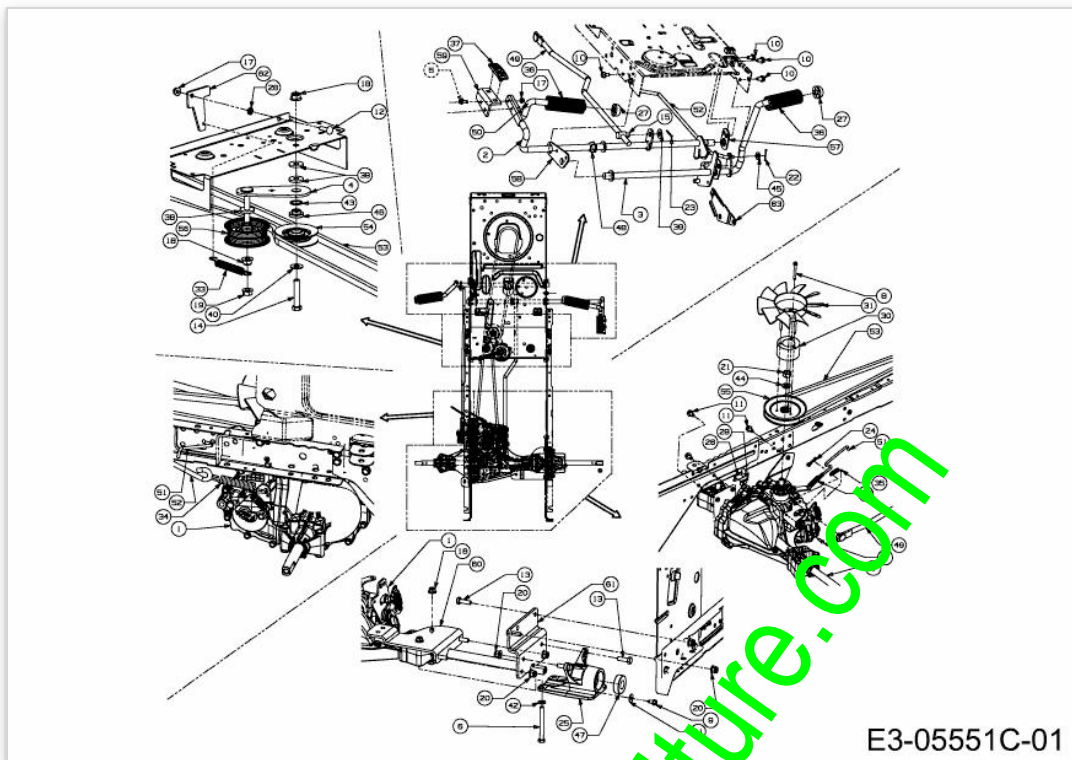

www.emc-motoculture.com

Position	Numéro de lapièce	#	Appellation I	Appellation II
1	618-04911	1	PONT HYDRO HG T2	FINISH: N/A
2	647-04198-Z	1	LEVIER D AVANCEMENT	SCHWEISSTEIL:SPEC-100015
3	647-04215	1	LEVIER DE FREIN	SCHWEISSTEIL:LACKIERT
4	683-0604A-Z	1	SUPPORT POULIE TENDEUR	FINISH:MTD SPEC-100015
5	710-0111	2	VIS 1/4-20X1,25"	FINISH:MTD SPEC-100015
6	710-0189	2	VIS HEX.:5/16-18x3.00:GR5:STD	FINISH:SPEC-100015 910-0189
7	710-0436	1	VIS	FINISH:MTD STANDARD 701-01002
8	710-05067	3	VIS	FINISH:MTD SPEC-100016 TYPE 1
9	710-0599	1	VIS A SIX PANS CREUX	FINISH:MTD SPEC-101617
10	710-0604A	5	VIS 5/16-18:0.625	FINISH:MTD SPEC-100016 TYPE 1
11	710-0607	4	VIS HEX.TT5/16-18:.500HXINDWSh	FINISH:MTD SPEC-100016 TYPE 1
12	710-0932A	1	VIS	FINISH:MTD SPEC-100015
13	710-1682	6	VIS	FINISH:SPEC-100015 21.1441.72
14	710-3144	1	VIS HEX.: 3/8-16:2.00:GR5:STD	FINISH:SPEC-100015 910-3144
15	711-04036	1	AXE	FINISH:SPEC-100015 911-04036
16	712-04063	2	ECROU HEX. AVEC FLANC	FINISH:MTD SPEC-100015
17	712-04064	3	ECROU HEXAGONAL	FINISH:SPEC-100015 912-04064
18	712-04065	2	ECROU HEXAGONAL	FINISH:SPEC-100015 912-04065
19	712-0431	1	ECROU STOP 3/8-16:GRF	FINISH:MTD SPEC-100015
20	712-0714	6	ECROU	FINISH:MTD SPEC-100015
21	712-3066	1	ECROU HEXAGONAL 1/2-20 GR5	FINISH:MTD SPEC-100015
22	714-0111	1	GOUPILLE FENDUE 5/32:1.0"	FINISH:MTD SPEC-100015
23	714-0115	1	GOUPILLE FENDUE 1/8 x 1.0	FINISH:MTD SPEC-100015
24	714-04040	1	GOUPILLE	FINISH:ASTM F1941 FE/ZN 3AN
25	719-0534	1	BLOC EMBASE	FINISH:PLAIN
26	725-05050	1	SUPPORT DE SECURITE	FINISH:SPEC-100015
27	726-0214	2	BOUCHON	FINISH:SCHWARZ
28	726-0233	1	RONDELLE	MECHANISCH KLAR VERZINKT
29	726-04089	1	PLAQUE ISOLANTE	FINISH:NATUR ODER SCHWARZ
30	731-07514	1	ENTRETOISE PLASTIQUE	FINISH:KUNSTSTOFF SCHWARZ (DÖ)
31	731-1449A	1	HELICE DE REFROIDISSEMENT	FINISH:WEISS
32	732-0209	1	RESSORT DE TRACT.	FINISH:MTD 701-01006 932-0209
33	732-0429A	1	RESSORT	FINISH:PHOSPHATE AND OIL
34	732-0716D	1	RESSORT	FINISH:MTD STD 701-01006
35	732-3118	1	RESSORT	FINISH:SPEC-100015
36	735-0239	2	CAOUTCHOUC/PEDALE 4;0 LG	FINISH:SCHWARZ
37	735-04113	1	CAOUTCHOUC DE PEDALE	FINISH:SCHWARZ
38	736-0258	3	RONDELLE PLATE .385x1.0x.135	FINISH:SPEC-100015 936-0258
39	736-0272	1	RONDELLE .510x1.00X.060	SPEC 100015 oder SPEC-101616
40	736-0300	1	RONDELLE	FINISH:MTD SPEC-100015
41	736-0685	1	RONDELLE	MTD SPEC-100015 24.6486.16

Position	Numéro de lapièce	#	Appellation I	Appellation II
42	736-0700	2	RONDELLE A8.4 DIN 125	MTD SPEC-100015 24.6481.18
43	736-0773	1	RONDELLE	24.6273.68
44	736-0921	1	RONDELLE GROWER	FINISH:MTD SPEC-100016
45	736-3008	1	RONDELLE	FINISH:MTD SPEC-100015
46	738-0372B	1	RONDELLE EPAULEE	FINISH:GEÖLT
47	741-0998	1	ROULEM. i BIL. .75IDX40ODX12	400er HYDRO GETRIEBE
48	741-3065B	1	BAGUE HEXAGONALE RAINUREE	GESCHLITZT:FINISH SCHWARZ
49	747-05253	1	TRINGLE COMMANDE DE BOITE	FINISH:SPEC 100015/ E-TEIL-SET
50	747-05265	1	LEVIER	FINISH:LACKIERT
51	747-05298	1	TRINGLE	FINISH:SPEC-100015
52	747-05313	1	TRINGLE DE FREIN	FINISH:SPEC-100015 or ECOAT
53	754-04258	1	COURROIE DE TRANSMISSION	POLY
54	756-0236	1	GALET TENDEUR	SCHWARZ LACKIERT ODER VERZINKT
55	756-1052	1	POULIE PLATE BOITE DE V	FINISH:SPEC-100015
56	756-3054A	1	POULIE TENDEUR	FINISH:VERZINKT SPEC-100015
57	783-04536B	1	STÜTZBLECH:PEDAL:LT-5	FINISH:LACKIERT MTD QUALITÄT
58	783-05809B	1	FINISH:LACKIERT 783-05809B*	FINISH:LACKIERT 783-05809B*
59	783-05867	1	WINKELBLECH:REV:PEDAL:AUTOMATI	FINISH:LACKIERT
60	783-06563	1	SUPPORT	FINISH:LACKIERT 783-06563*
61	783-06577	1	SUPPORT	FINISH:LACKIERT
62	783-06582	1	PATTE	FINISH:LACKIERT
63	783-07369	1		

www.emc-motoculture.com

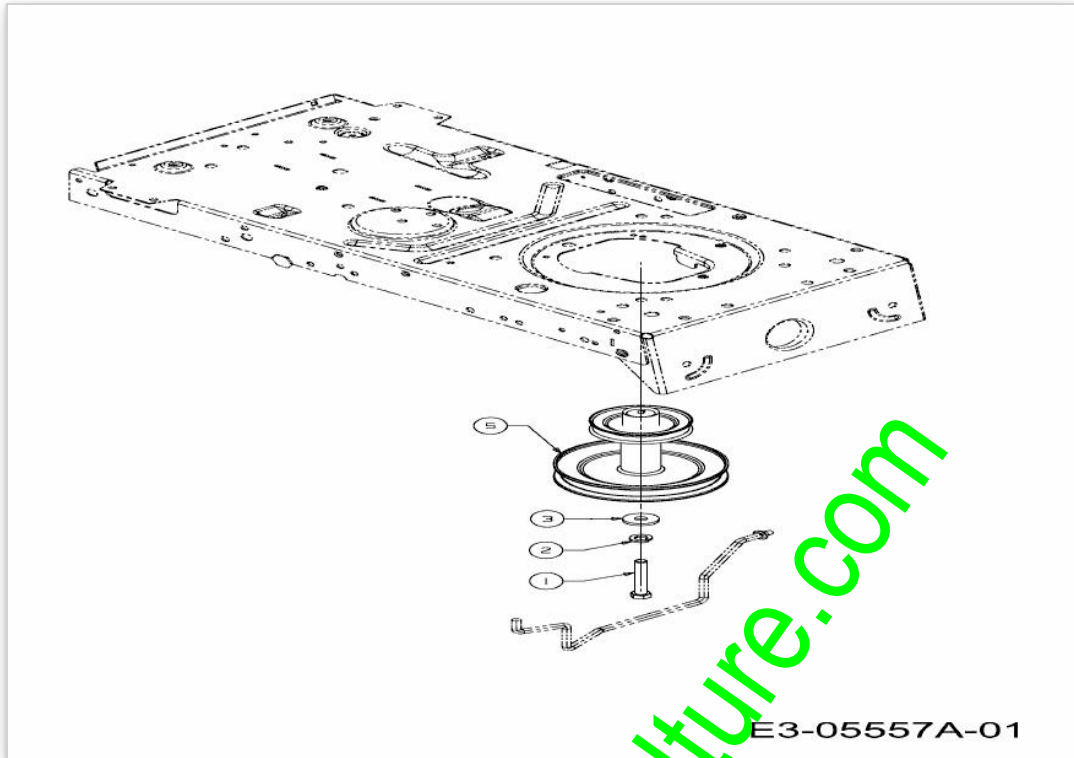

www.emc-motoculture.com

E3-05557A-01

Position	Numéro de lapièce	#	Appellation I	Appellation II
1	710-04607	1	VIS POULIE MOTEUR	FINISH:MTD SPEC-100015
2	736-0171	1	RONDELLE GROWER	FINISH:MTD SPEC-100016
3	736-0322	1	RONDELLE .450 X 1.250 X .164	FINISH:SPEC-100016 936-0322
5	756-04427	1	POULIE MOTEUR	HYDRO:FINISH SPEC 100015

www.emc-motoculture.com

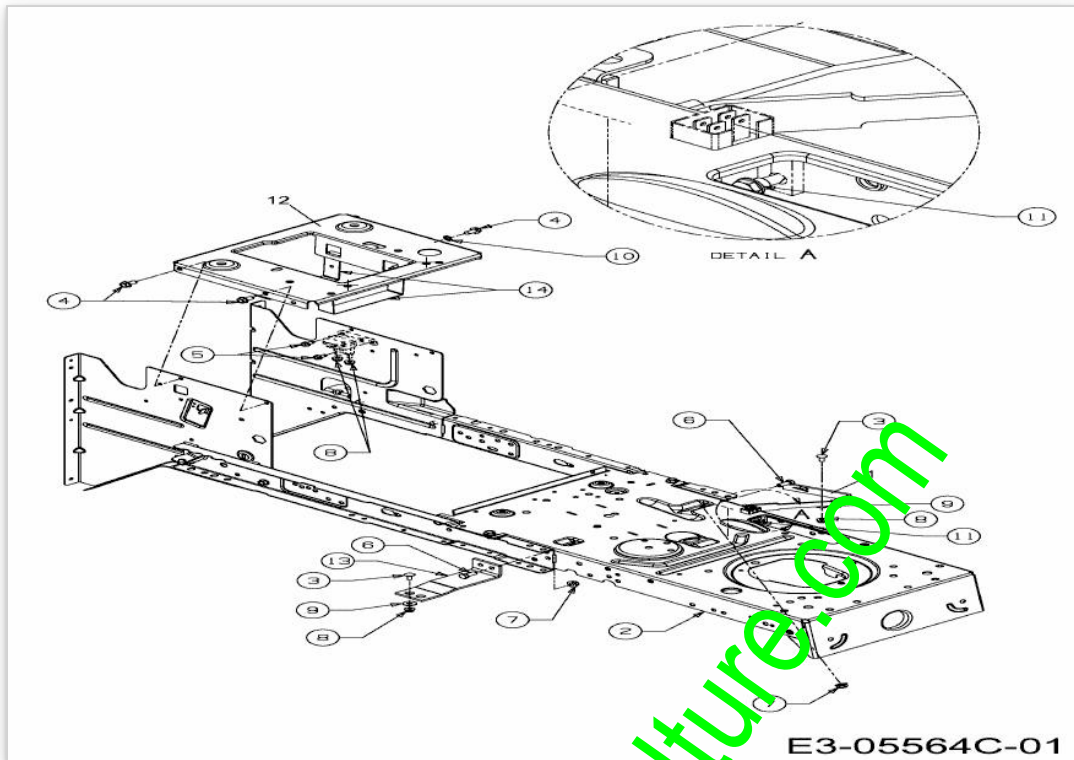

E3-05564C-01

www.emc-motoculture.com

Position	Numéro de pièce	#	Appellation I	Appellation II
1	683-04195	1	STÜTZKONSOLE-LI.SITZWANNE LT5	SCHWEISSTEIL
2	683-04681A-S	1		
3	710-0134	2	VIS ; Tête PLATE	FINISH:MTD SPEC-100015
4	710-04484	4	VIS HEX. TT:5/16-18:750:HXIND	FINISH:MTD SPEC-100016 TYPE 1
5	710-0599	2	VIS A SIX PANS CREUX	FINISH:MTD SPEC-101617
6	710-3008	2	VIS 5/16-18:75:GR5:STD	SPEC-701-01006 or.SPEC-100015
7	712-04063	3	ECROU HEX. AVEC FLANC	FINISH:MTD SPEC-100015
8	712-04064	4	ECROU HEXAGONAL	FINISH:SPEC-100015 912-04064
9	736-0173	2	RONDELLE 281DX 74ODX.063	FINISH:MTD SPEC-100015
10	736-0607	1	RONDELLE	FINISH:MTD SPEC-100016
11	738-04237A	1	AXE EPAULE	FINISH:MTD SPEC-100016
12	783-04548D-S	1	SUPPORT DE SIEGE	SCHWARZ
13	783-04637637	1	SUPPORT	SCHWARZ LACKIERT
14	783-04869A-S	2	SUPPORT BATTERIE	SCHWARZ

www.emc-motoculture.com

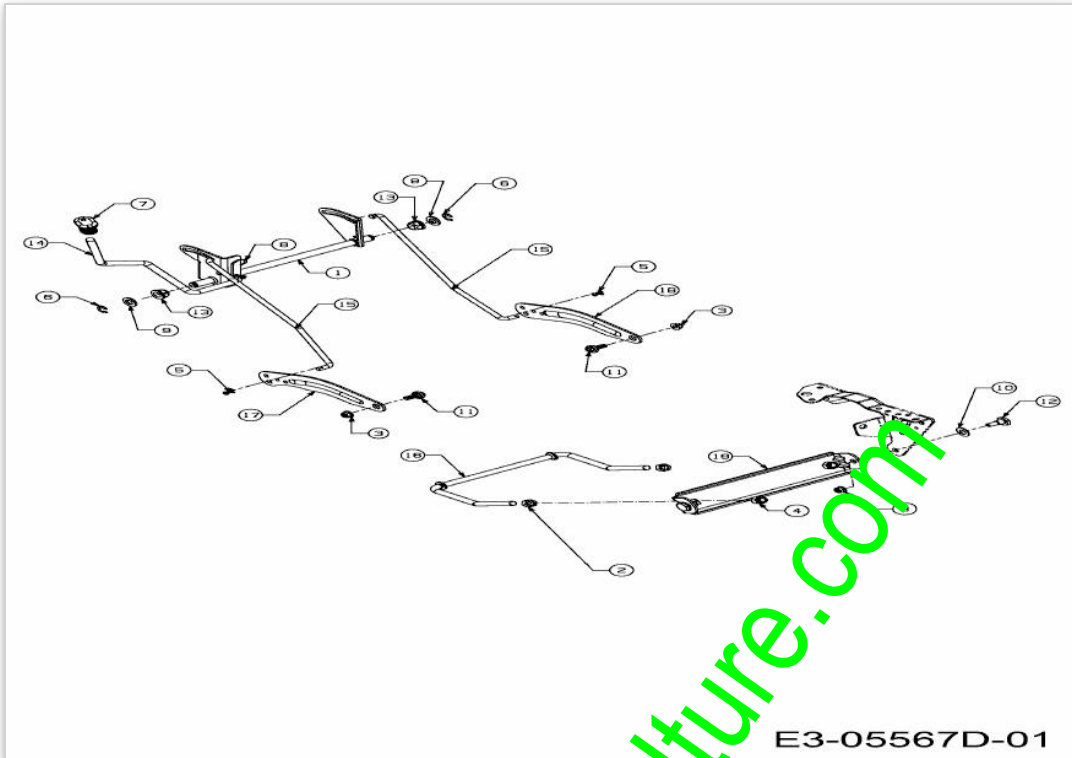

www.emc-motoculture.com

E3-05567D-01

Position	Numéro de pièce	#	Appellation I	Appellation II
1	683-04466	1	LEVIER COMPLET	SCHWEISSTEIL:FINISH LACKIERT
2	712-0206	2	ECROU HEX. 1/2-13:GR.5	FINISH:MTD SPEC-100015
3	712-04065	4	ECROU HEXAGONAL	FINISH:SPEC-100015 912-04065
4	712-3083	2	ECROU HEX. 1/2-13:GRB:NYLON	FINISH:MTD SPEC-100015
5	714-04040	2	GOUPILLE	FINISH:ASTM F1941 FE/ZN 3AN
6	716-0106A	2	CIRCLIPS	FINISH:PHOSPHATIERT
7	720-0311	1	POIGNÜE LEVIER COUPE : 1/2	FARBE:Schwarz VINYL
8	732-04225	1	RESSORT	FINISH:MTD STD 701-01006
9	736-0366	2	RONDELLE 5/8 ID X 1.0 OD	FINISH:MTD SPEC-100015
10	736-0414	2	RONDELLE TÜFLON	FINISH:WEISS: 936-0414
11	738-04130	2	VIS .625X.175:3/8-16	FINISH:701-01002
12	738-0507B	2	VIS	FINISH:MTD SPEC-701-01006
13	741-0225	2	BAGUE HEXAGONALE TEFLON 6 PANS	FINISH:KUNSTSTOFF SCHWARZ
14	747-04282	1	LEVIER DE RELEVAGE :LT-5	FINISH:SPEC-100015
15	747-05257	2	TRINGLE DE RELEVAGE	A/C/E/N-Deck:MTD SPEC-101616
16	747-1324	1	TRINGLE	FINISH:SPEC-100015
17	783-04494C	1	NOIR	FINISH:LACKIERT MTD QUALITÄT
18	783-04711C	1	NOIR	FINISH:LACKIERT MTD QUALITÄT
19	783-0720C	1	SUPPORT DE RELEVAGE	FINISH:LACKIERT

www.emc-motoculture.com

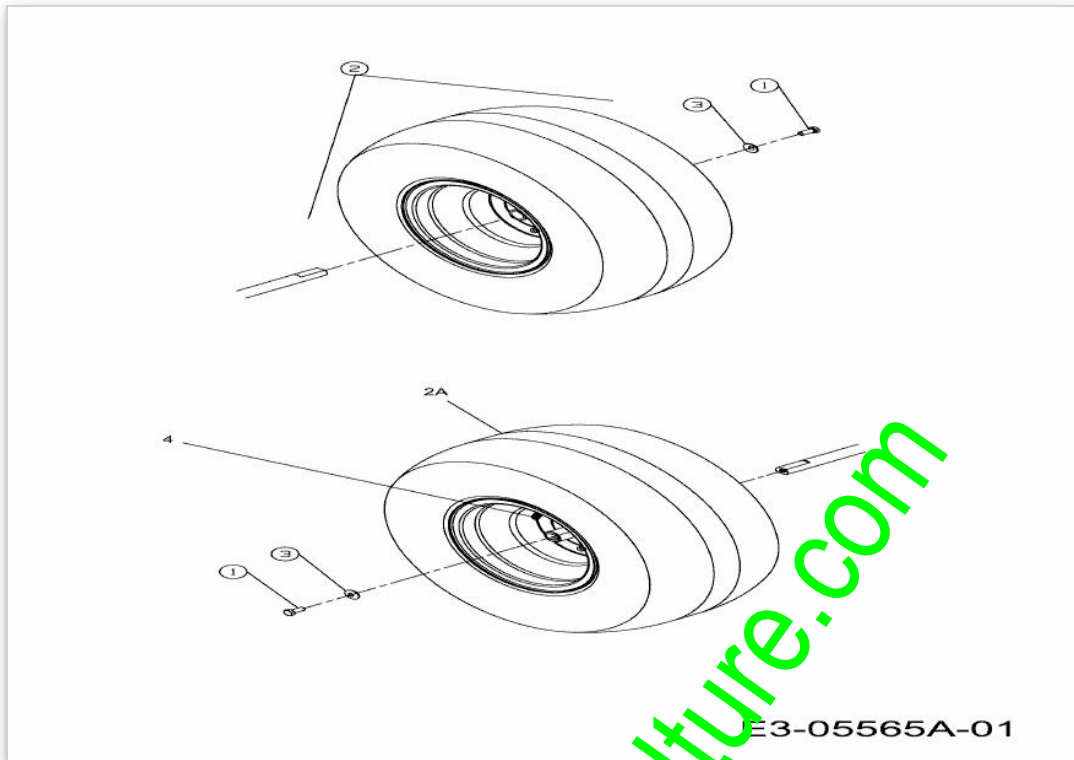

E3-05565A-01

www.emc-motoculture.com

Position	Numéro de lapièce	#	Appellation I	Appellation II
1	710-0627	2	VIS HEX. 5/16-24:.750 GR5:LOCK	FINISH:MTD SPEC-100015
2	734-04523	2		
2A	734-0448	2	PNEU 18*950*8	TURF SAVER 734-0448-0901
3	736-0242	2	RONDELLE CONIQUE.340X.872X.060	FINISH:MTD SPEC-100016
4	734-0255	2	VALVE:PNEU	TR 412-P / 32.6mm / 934-0255

www.emc-motoculture.com

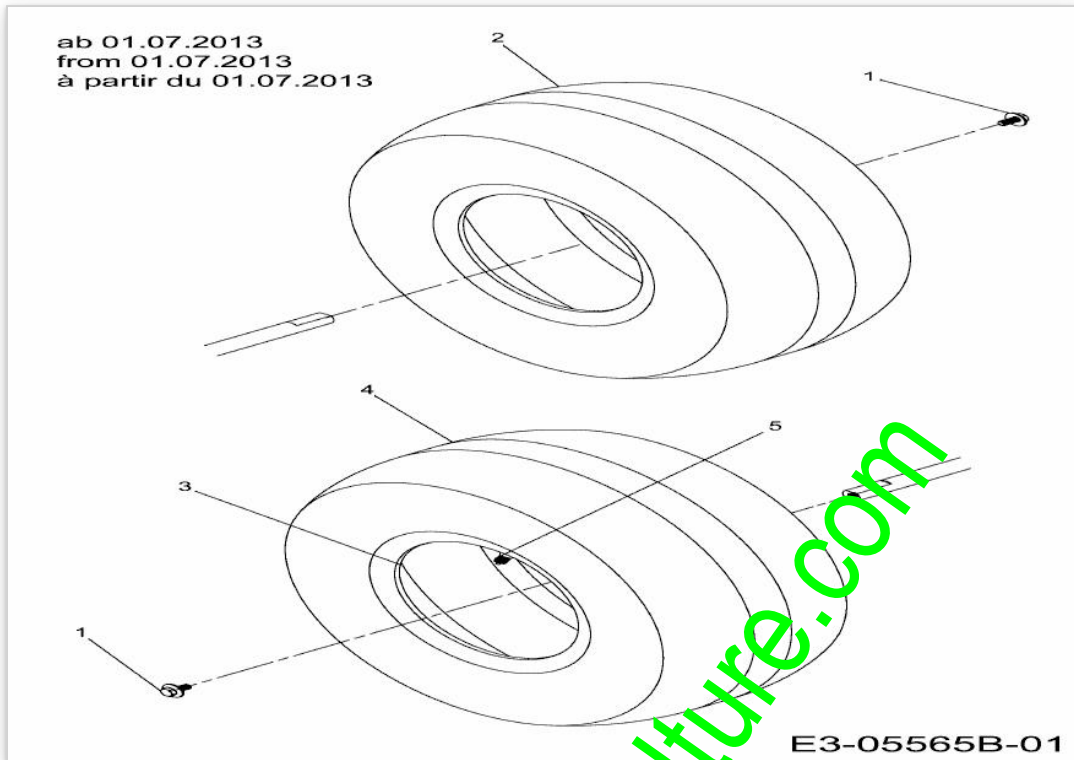

www.emc-motoculture.com

Position	Numéro de lapièce	#	Appellation I	Appellation II
1	710-05339	2	VIS	GR5 E-TEIL-SET
2	734-04523	2		
3	634-04631	2	JANTE AR GRISE	FINISH
4	734-0448	2	PNEU 18*950*8	TURF SAVER 734-0448-0901
5	734-0255	2	VALVE:PNEU	TR 412-P / 32.6mm / 934-0255

www.emc-motoculture.com

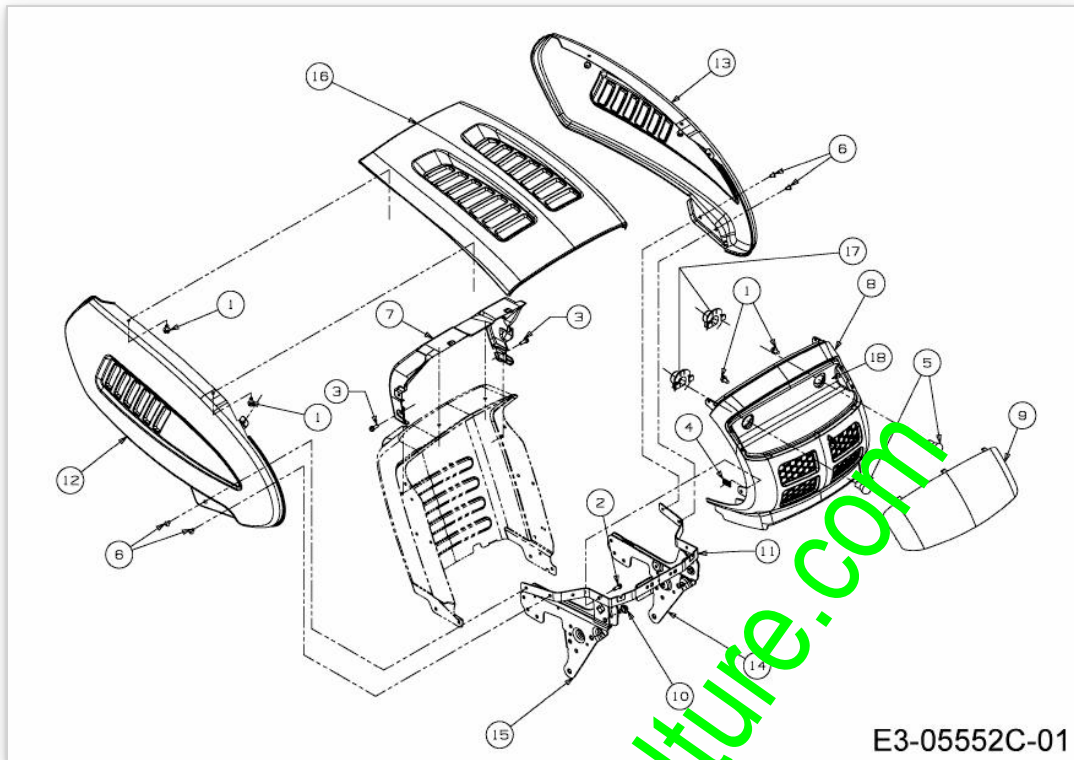

E3-05552C-01

Position	Numéro de pièce	#	Appellation I	Appellation II
1	710-0604A	6	VIS 5/16-18:0.625	FINISH:MTD SPEC-100016 TYPE 1
2	710-0642	2	VIS1/4-20:0.750	SPEC-100016 TYPE 1 910-0642
3	710-0895	2	VIS A SIX PANS CREUX	FINISH:MTD SPEC-100016 TYPE 1
4	712-0292	2	ECROU A CAGE 1/4-20	FINISH:PHOSPHATIERT & GEÖLT
5	725-0963	2	AMPOULE ELECTRIQUE	FINISH:
6	728-04063	4	RIVET	FINISH:ASTM F1941 FE/ZN 3AN
7	731-05078C	1	CACHE TABLEAU DE BORD	FINISH:SCHWARZ LT-5
8	731-05442A	1	CALANDRE PLASTIQUE NOIRE	FINISH:SCHWARZ
9	731-2118A	1	OPTIQUE DE PHARE	NEUTRAL
10	738-04091A	2	VIS EPAULEE	FINISH:SPEC-100016
11	783-04606C	1	GRAPHIT GRIS	FINISH:LACKIERT
12	783-04921	1	PIECE LATÉRALE ; DROIT 3 STY	FINISH:LACKIERT
13	783-04924	1	PIECE LATÉRALE ; GAUCHE 3 STY	FINISH:LACKIERT
14	783-05417	1	ÜTRIER DE CHARN.; DR. CAPOT	FINISH:LACKIERT
15	783-05418	1	ÜTRIER DE CHARN.; DR. CAPOT	FINISH:LACKIERT
16	783-0783	1	CAPOT 3/9 STYLE	FINISH:LACKIERT
17	725-1649	2	DOUILLE DE LAMPE: 1/4 ROTATION	GRAU KUNSTSTOFF
18	731-2430	1	FILM DE RÜFLECTEUR 9 STYLE	400/700

www.ems-motoculture.com

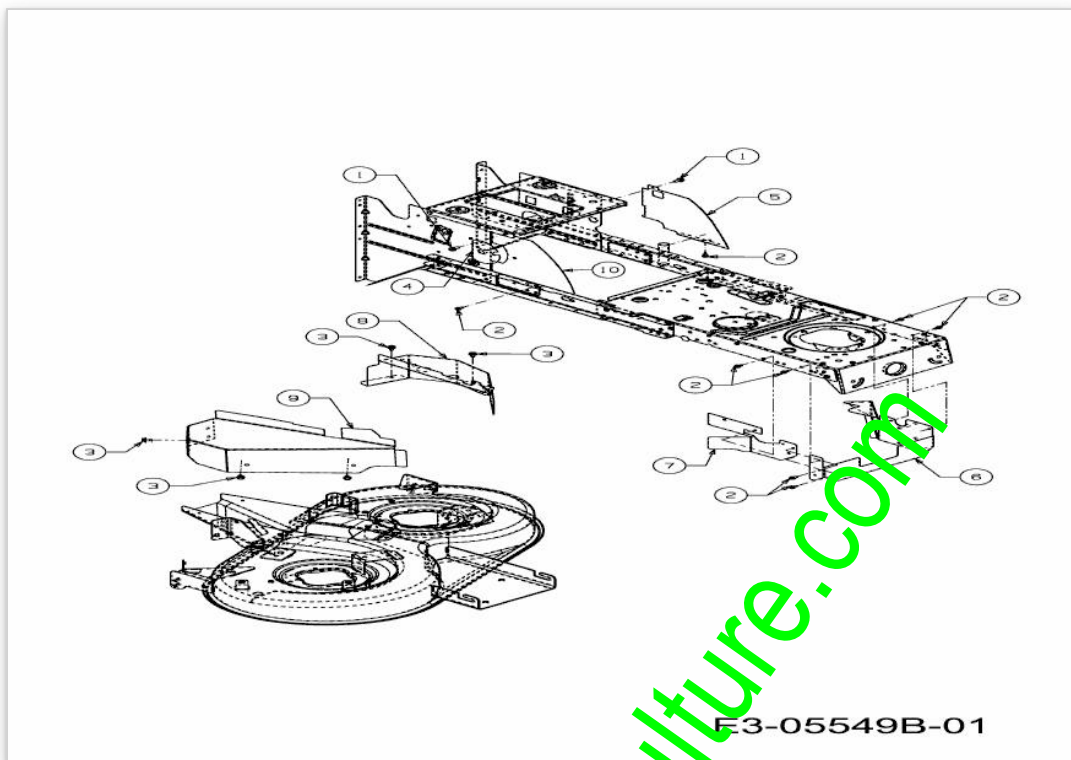

www.emc-motoculture.com

Position	Numéro de pièce	#	Appellation I	Appellation II
1	710-04484	2	VIS HEX. TT:5/16-18:.750:HXIND	FINISH:MTD SPEC-100016 TYPE 1
2	710-0599	8	VIS A SIX PANS CREUX	FINISH:MTD SPEC-101617
3	710-0607	5	VIS HEX.TT5/16-18:.500HXINDWSh	FINISH:MTD SPEC-100016 TYPE 1
4	731-05586	1	COUVERCLE PLASTIQUE	KUNSTSTOFFSCHEIBE Ø115mm (DÖ)
5	783-05085A	1		
6	783-05998	1	ABDECKUNG1 FRANCE:LT-5:E-DECK	FINISH:LACKIERT MTD QUALITÄT
7	783-05999	1	ABDECKUNG2 FRANCE:LT-5:E-DECK	FINISH:LACKIERT MTD QUALITÄT
8	783-06000	1	ABDECKUNG3 FRANCE:LT-5:E-DECK	FINISH:LACKIERT MTD QUALITÄT
9	783-06001A	1	FINISH:LACKIERT MTD QUALITÄT	FINISH:LACKIERT MTD QUALITÄT
10	783-06676	1	PROTECTION DROITE	FINISH:LACKIERT MTD QUALITÄT

www.emc-motoculture.com

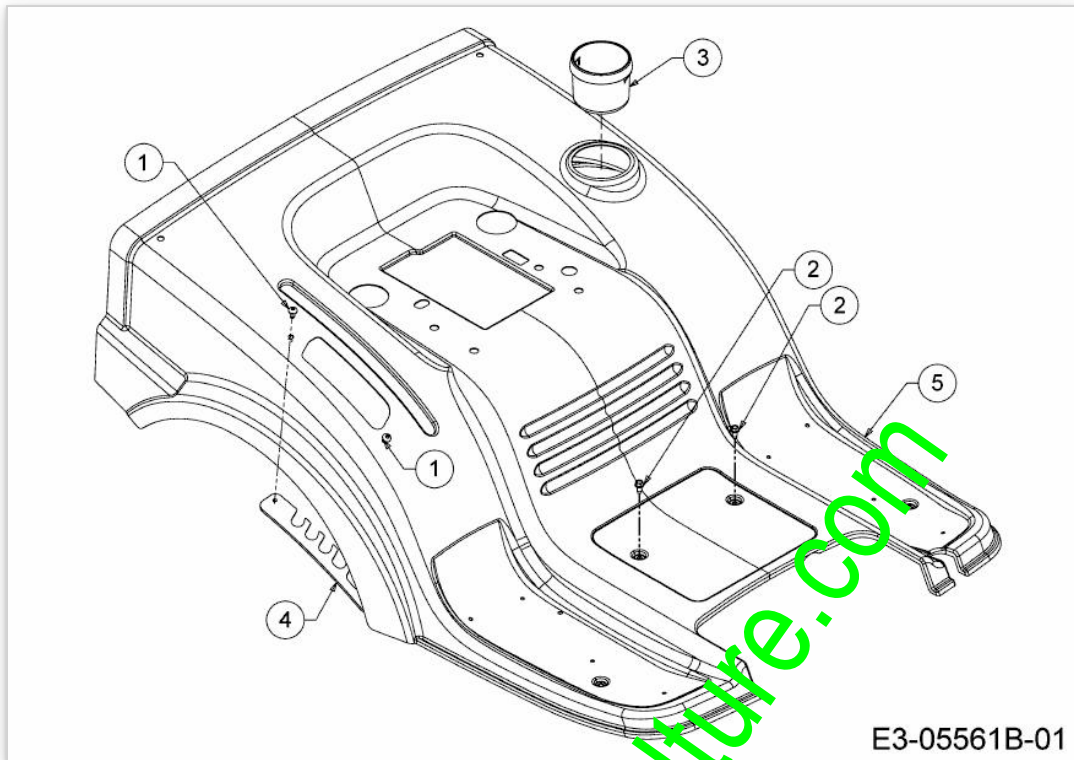

www.emc-motoculture.com

Position	Numéro de lapièce	#	Appellation I	Appellation II
1	710-05070	2	VIS	FINISH: SCHWARZ SPEC 701-01010
2	710-0599	2	VIS A SIX PANS CREUX	FINISH: MTD SPEC-101617
3	731-04591A	1	PORTE GOBELET	FINISH: KUNSTSTOFF SCHWARZ
4	783-05875A	1	SELECTEUR HAUTEUR DE COUPE	FINISH: 783-05875A-Z 5 POS
5	783-06580	1	JUPE	FINISH: LACKIERT

www.emc-motoculture.com

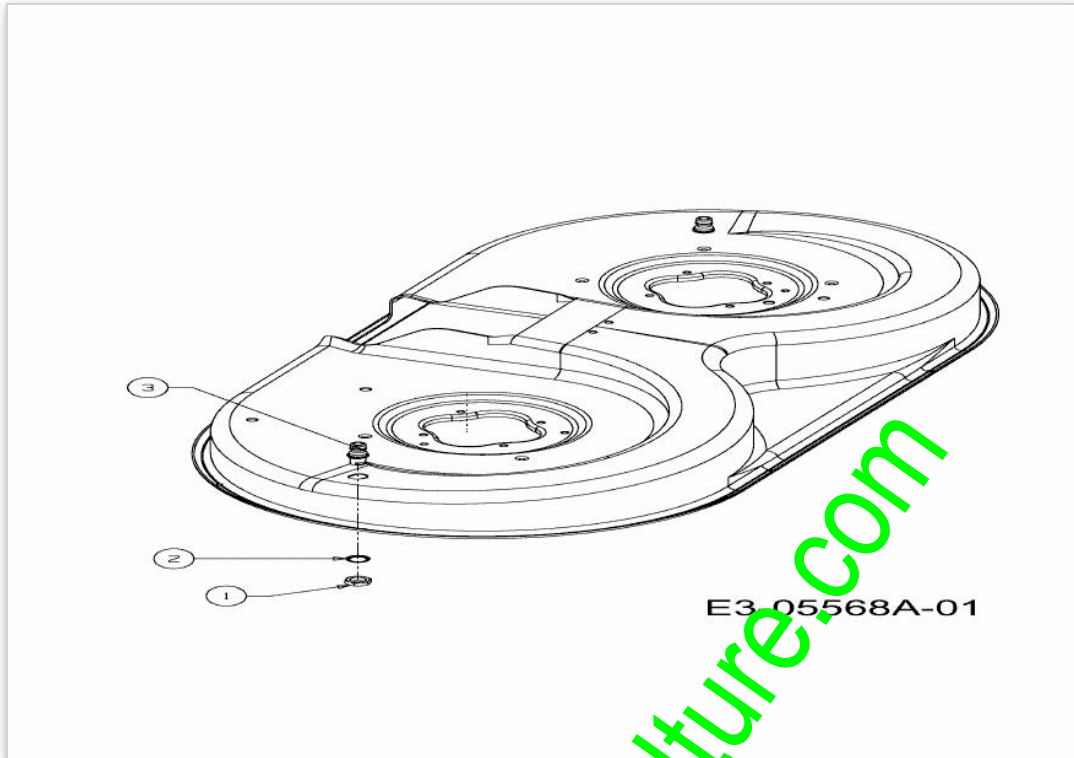

E3_05568A-01

www.emc-motoculture.com

Position	Numéro de lapièce	#	Appellation I	Appellation II
1	712-0641	2	ECROU HEX. M16-1.5 DIN 936	FINISH:SPEC-100015 24.1424.31
2	736-0760	2	RONDELLE 17X23.8X1.95	FINISH:MTD SPEC-100016
3	737-04003D	2	BUSE NETTOYAGE PLATEAU	FINISH:MTD SPEC-100015

www.emc-motoculture.com

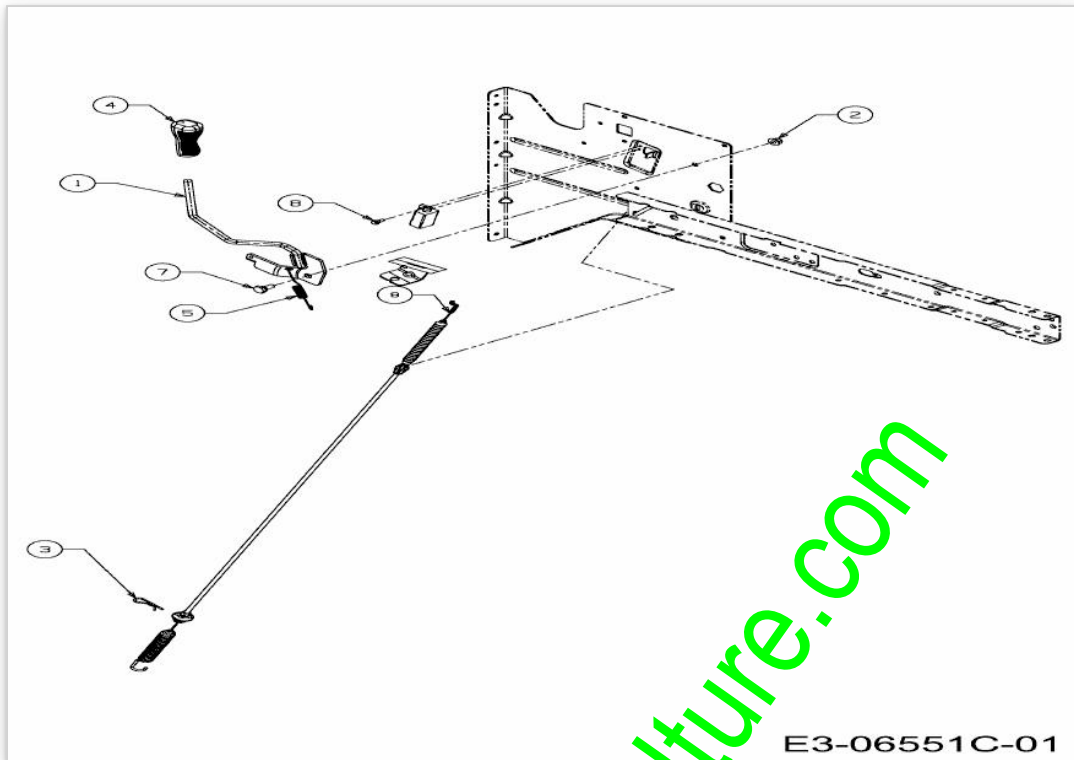

E3-06551C-01

www.emc-motoculture.com

Position	Numéro de pièce	#	Appellation I	Appellation II
1	647-04239	1	LEVIER ENCLenchement	SCHWEISSTEIL:647-04239 SCHWARZ
2	712-04063	1	ECROU HEX. AVEC FLANC	FINISH:MTD SPEC-100015
3	714-0145	1	GOUPILLE	FINISH:SPEC-701-01006
4	720-04049A	1	POIGNEE PLASTIQUE	FINISH:SCHWARZ
5	732-04276A	1	RESSORT	FINISH:MTD SPEC-701-01006
7	738-0140	1	VIS A EP.:.435 x.178-5/16 x.56	FINISH:MTD SPEC-100015
8	738-04237A	1	AXE EPAULE	FINISH:MTD SPEC-100016
9	746-04173E	1	CABLE D EMBRAYAGE	VERKAPSELTE TEIL-SET

www.emc-motoculture.com

bis 02.12.2012
to 02.12.2012
jusqu'au 02.12.2012

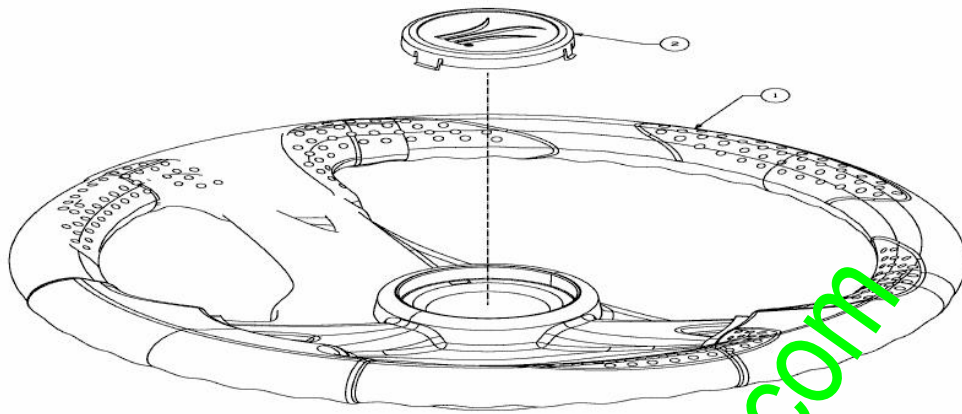

E3-08107A-01

www.emc-motoculture.com

Position	Numéro de lapièce	#	Appellation I	Appellation II
1	631-04532	1	ROUE CPL	FINISH:
2	731-04040	1	COUVERCLE DE VOLANT	Ø 60mm:KUNSTSTOFF SCHWARZ

www.emc-motoculture.com

ab 03.12.2012 bis 28.02.2013
from 03.12.2012 to 28.02.2013
à partir du 03.12.2012 jusqu'au 28.02.2013

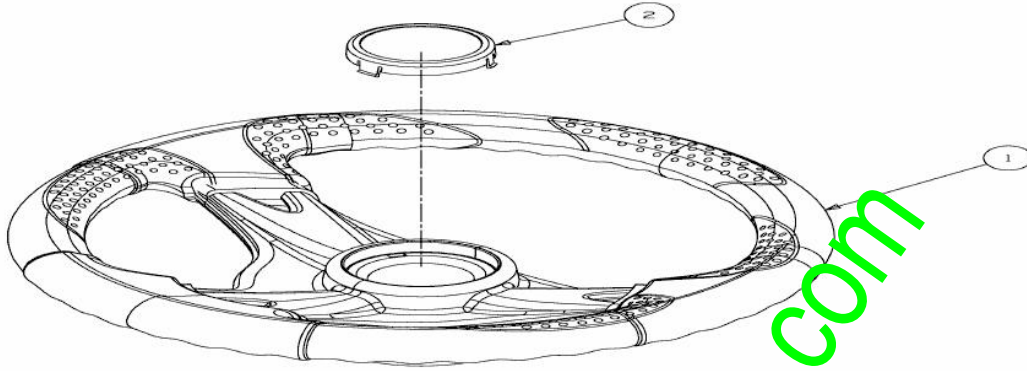

E3-08108A-01

www.emc-motoculture.com

Position	Numéro de lapièce	#	Appellation I	Appellation II
1	631-04532	1	ROUE CPL	FINISH:
2	731-04039	1	CAPUCHON DE VOLANT SANS LOGO	FINISH:KUNSTSTOFF SCHWARZ

www.emc-motoculture.com

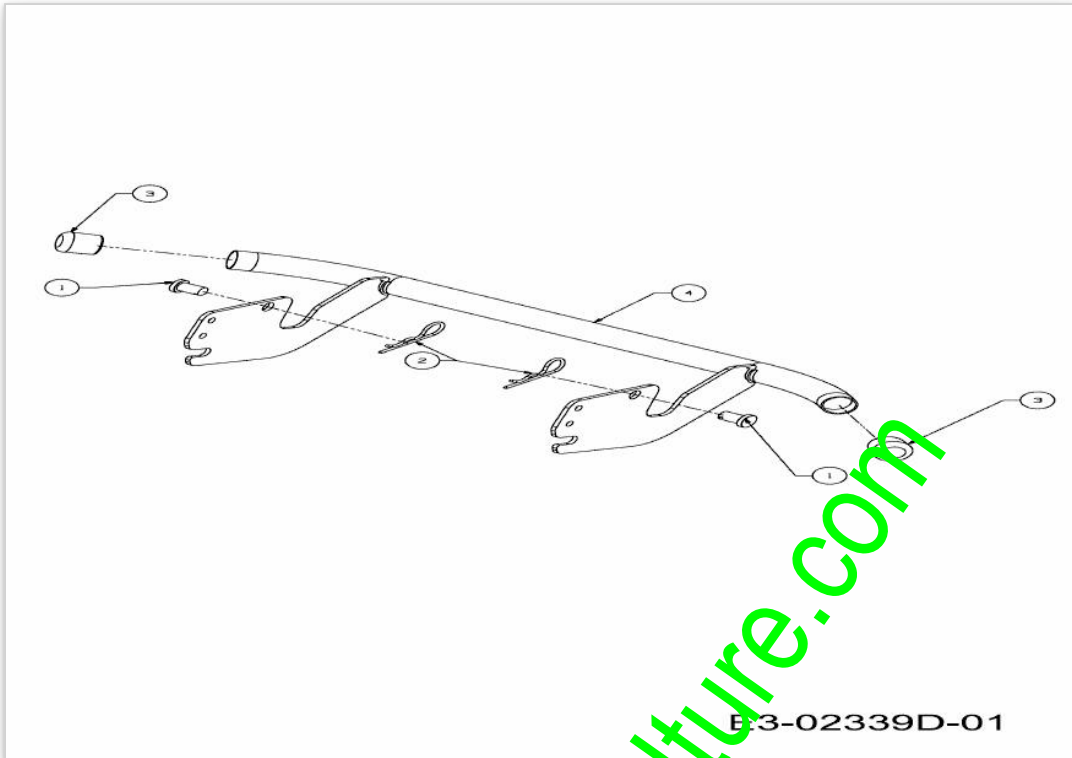

www.emc-motoculture.com

Position	Numéro de lapièce	#	Appellation I	Appellation II
1	711-0332	2	GOUJON ; ÜPINGLER .50X.78 LG	FINISH:MTD SPEC-100015
2	714-04075	2	EPINGLE	FINISH:ZINC SPEC-100015
3	731-04500	2	BOUCHON	500 SERIES:K 28 S:SCHWARZ
4	683-04236A	1	PARE-CHOCS DE FR. SÛRIE 500	SCHWEISSTEIL:FINISH LACKIERT

www.emc-motoculture.com

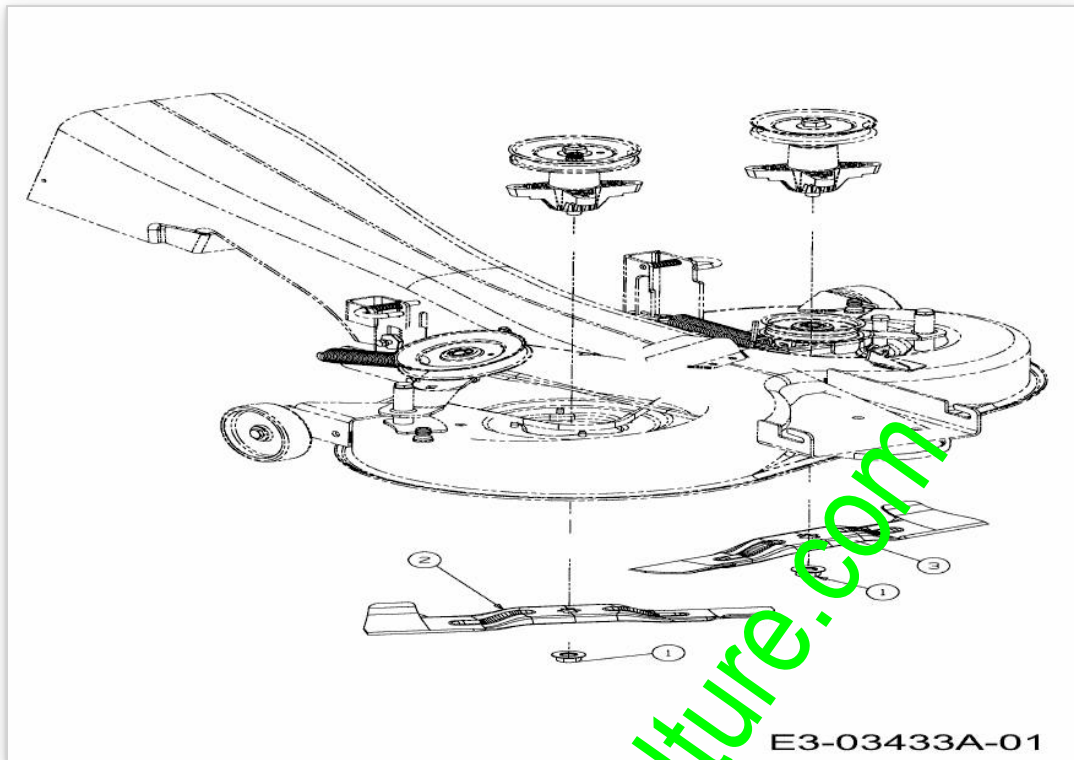

E3-03433A-01

www.emc-motoculture.com

Position	Numéro de lapièce	#	Appellation I	Appellation II
1	712-0417A	2	ÜCROU HEX. AV. FLANC: 5/8-18	FINISH:MTD STD 701-01000
2	742-04020A	1	LAME j DROITE 18.40 LG	STAR BAG:WÄRMEBEHANDELT
3	742-04021A	1	LAME j GAUCHE 18.40 LG	STAR BAG:WÄRMEBEHANDELT

www.emc-motoculture.com

bis 31.10.2012
to 31.10.2012
jusqu'au 31.10.2012

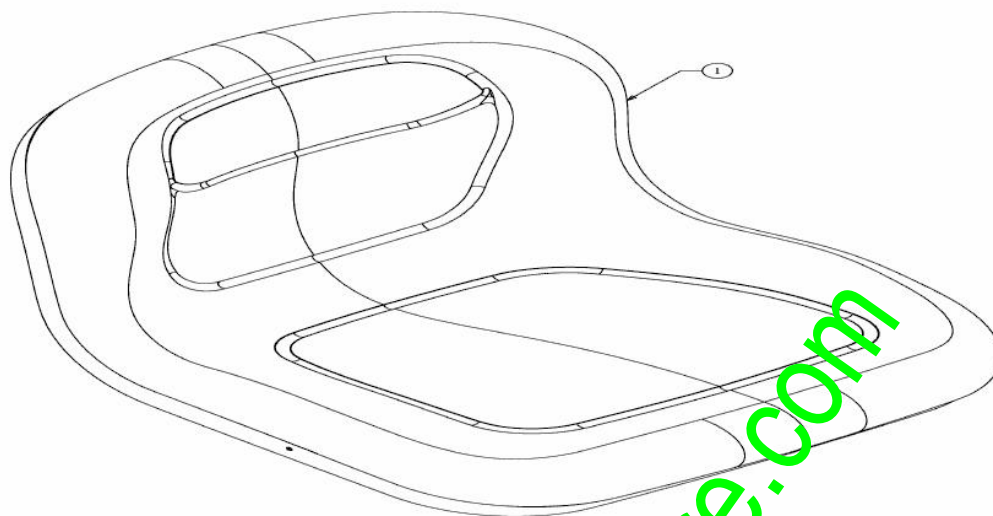

E3-05060A-02

www.emc-motoculture.com

Position	Numéro de lapièce	#	Appellation I	Appellation II
1	757-04109	1	SIEGE NOIR HAUT	FINISH:SCHWARZ

www.emc-motoculture.com

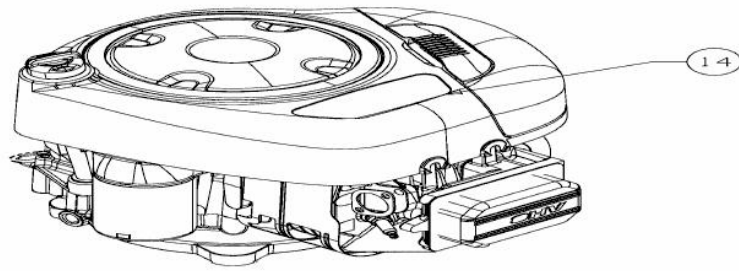

Briggs & Stratton
Model: 21B807
Type: 0141-H1

E3-08302A-01

www.emc-motoculture.com

Position	Numéro de lapièce	#	Appellation I	Appellation II
14	752B0141B1	1	MOTEUR B&S 3130 SERIES	21B807-0141-H1 344CC

www.emc-motoculture.com

www.emc-motoculture.com