

www.emc-motoculture.com

Position	Numéro de pièce	#	Appellation I	Appellation II
1	683-04726	1		
2	683-04727	1		
3	683-04763	1		
4	710-0643	1	VIS HEX.: 5/16-18:1.00:GR5	FINISH:MTD SPEC-100015
5	710-0703	2	VIS	FINISH:MTD SPEC-100015
6	712-04063	1	ECROU HEX. AVEC FLANC	FINISH:MTD SPEC-100015
7	712-04064	3	ECROU HEXAGONAL	FINISH:SPEC-100015 912-04064
8	714-04040	4	GOUPILLE	FINISH:ASTM F1941 FE/ZN 3AN
9	717-1554	1	PIGNON DE DIRECTION	FINISH:GEOLT
10	723-04095A	1	PROTECTION DE COLONNE	723-04095A
11	726-0341	2	CAPUCHON CLIPS	FINISH: SCHWARZ
12	736-0242	1	RONDELLE CONIQUE.340X.872X.060	FINISH:MTD SPEC-100016
14	738-04537	1	COLONNE DE DIRECTION	738-04537
15	738-05000	1	VIS EPAULEE	FINISH:MTD SPEC-100015
16	741-04542A	1	BAGUE	FINISH:PLAIN
17	741-0660A	4	BAGUE ESSIEU DE ROUE	FINISH:KUNSTSTOFF SCHWARZ
18	747-05514	1	TIGE DE DIRECTION GAUCHE	747-05514
19	747-05585	1	TIGE DE DIRECTION DROITE	747-05585
20	747-06027	1	TRINGLE DE DIRECTION	BLACK E-COAT o.SPEC-701-01000
21	783-06988A	1	CREMAILLE DE DIRECTION	783-06988A
22	783-07239A	1	SUPPORT DE DIRECTION	783-07239A

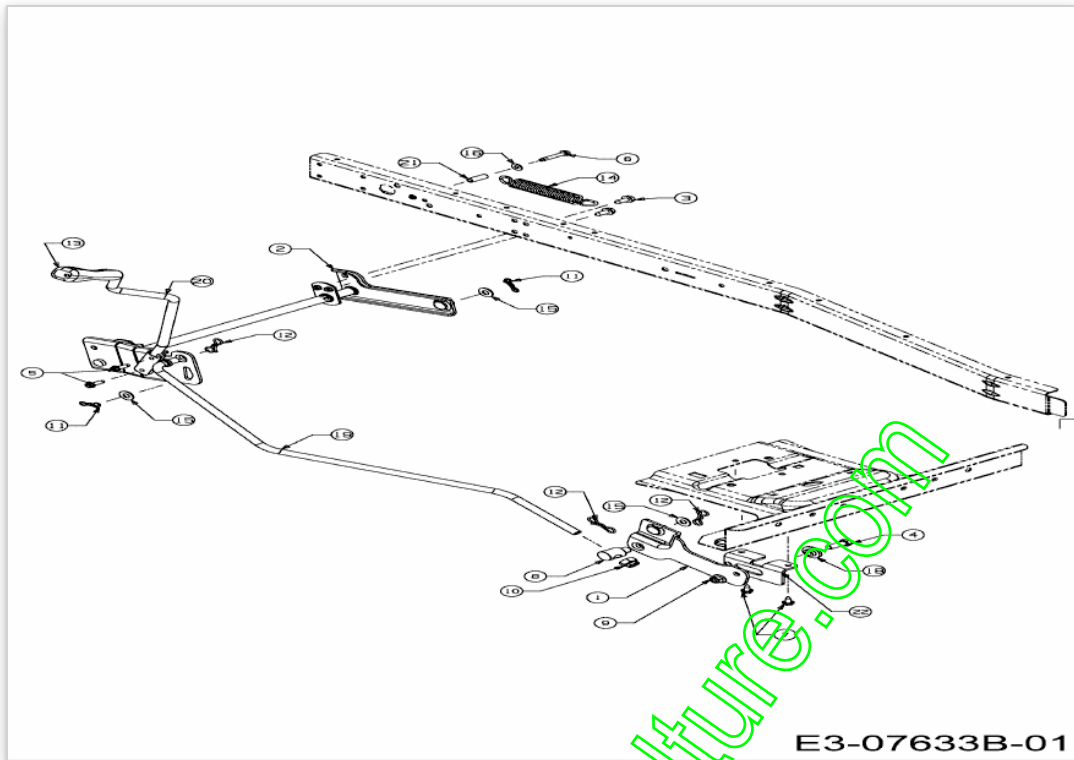

www.emc-motoculture.com

Position	Numéro de pièce	#	Appellation I	Appellation II
1	683-04757	1		
2	683-05060	1		
3	710-04484	4	VIS HEX. TT:5/16-18:.750:HXIND	FINISH:MTD SPEC-100016 TYPE 1
4	710-0514	1	VIS HEX.:3/8-16:1.00:GR5:STD	FINISH:MTD SPEC-100015
5	710-0642	2	VIS1/4-20:0.750	SPEC-100016 TYPE 1 910-0642
6	710-0778	1	VIS HEX. TT:1/4-20:1.500	FINISH:MTD SPEC-100016 TYPE 1
7	710-1652	2	VIS HEX. TT:1/4-20:.625:HXINDW	FINISH:MTD SPEC-100016 TYPE 1
8	711-05690	1	AXE	711-05690
9	712-04065	1	ECROU HEXAGONAL	FINISH:SPEC-100015 912-04065
10	712-04243	1	ECROU	FINISH:MTD SPEC-100015
11	714-04040	2	GOUPILLE	FINISH:ASTM F1941 FE/ZN 3AN
12	714-04043	3	GOUPILLE	FINISH:VERZINKT
13	720-0311	1	POIGNÉE LEVIER COUPE : 1/2	FARBE:SCHWARZ VINYL
14	732-04692	1	RESSORT	FINISH:PHOS & OIL
15	736-0300	3	RONDELLE	FINISH:MTD SPEC-100015
16	736-0463	1	RONDELLE	FINISH:MTD SPEC-100015
18	738-0347	1	RONDELLE EMB. .625IDx.169	FINISH:
19	747-05511	1	TRINGLE DE RELEVAGE	747-05511
20	747-05576	1		
21	750-0566A	1	ENTRETOISE	FINISH:MTD SPEC-100015
22	783-07129	1		

www.emc-motoculture.com

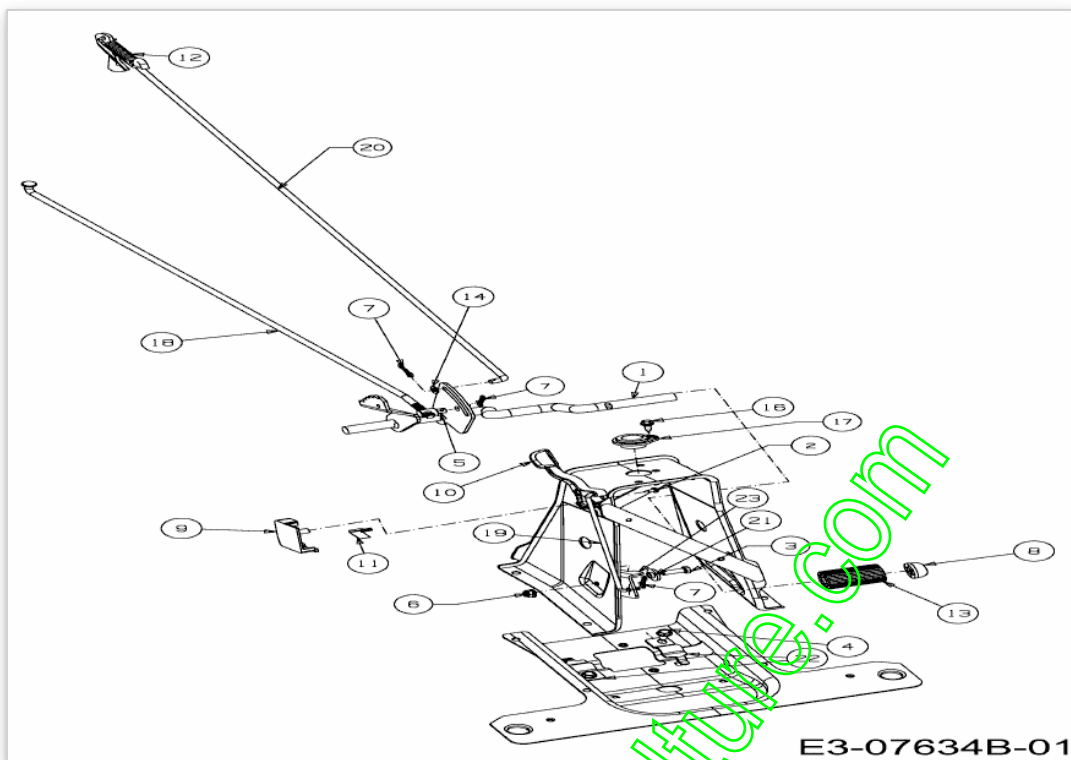

www.emc-motoculture.com

Position	Numéro de pièce	#	Appellation I	Appellation II
1	683-05017	1		
2	710-0224	1	VIS PARK:#10-16:0.500:HXINDWSH	FINISH:MTD SPEC-100016 TYPE 1
3	710-0376	1	VIS HEX.:5/16-18:1.00:GR5:STD	FINISH:MTD SPEC-100015
4	710-0371	2	VIS	710-0371
5	711-06103	1	FERRURE	FINISH:MTD SPEC-100015
6	712-04063	1	ECROU HEX. AVEC FLANC	FINISH:MTD SPEC-100015
7	714-04040	3	GOUPILLE	FINISH:ASTM F1941 FE/ZN 3AN
8	726-0214	1	BOUCHON	FINISH: SCHWARZ
9	731-08656A	1	COUVERCLE POIGNEE DE VITESSE	731-08656A
10	731-08743B	1	LEVIER SELECTEUR	731-08743B
11	732-04937	1	RESSORT DE VERROUILLAGE	FINISH:SPEC-100015
12	732-0716D	1	RESSORT	FINISH:MTD STD 701-01006
13	735-04279	1	CAOUTCHOUC DE PEDALE	735-04279
14	736-0264	1	RONDELLE: .330 x.630 x.0635	FINISH:SPEC-100015 936-0264
16	738-04184A	1	VIS A EPAULE:.368x.113:TT:1/4-	:1/4-20 / FINISH:701-01002
17	741-0356A	1	BAGUE DE VOLANT	FINISH:KUNSTSTOFF SCHWARZ
18	747-05506	1	TRINGLE	747-05506
19	747-06015	1	TRINGLE SELECTION DE VITESSE	747-06015
20	747-06033A	1	TRINGLE DE FREIN	747-06033A
21	748-0234	1	RONDELLE EPAULEE	FINISH:ROSTPREVENTION
22	783-05940	2	SUPPORT	FINISH:MTD SPEC-100015
23	783-08116A	1		

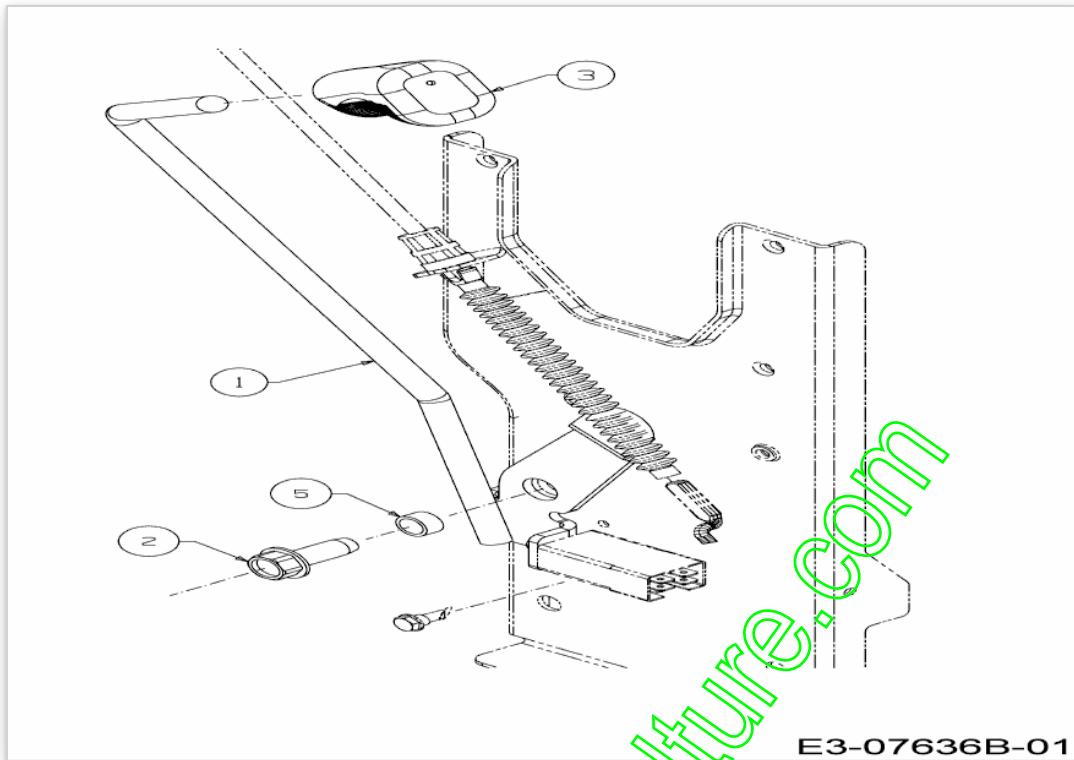

E3-07636B-01

www.emc-motoculture.com

Position	Numéro de lapièce	#	Appellation I	Appellation II
1	683-04754	1		
2	710-04683	1	VIS HEX.:3/8-16:1.000	FINISH:MTD SPEC-701-01002
3	720-04049A	1	POIGNEE PLASTIQUE	FINISH:SCHWARZ
5	750-0526	1	ENTRETOISE 380 IDX 50 ODX 265	FINISH: MTD SPEC-100015

www.emc-motoculture.com

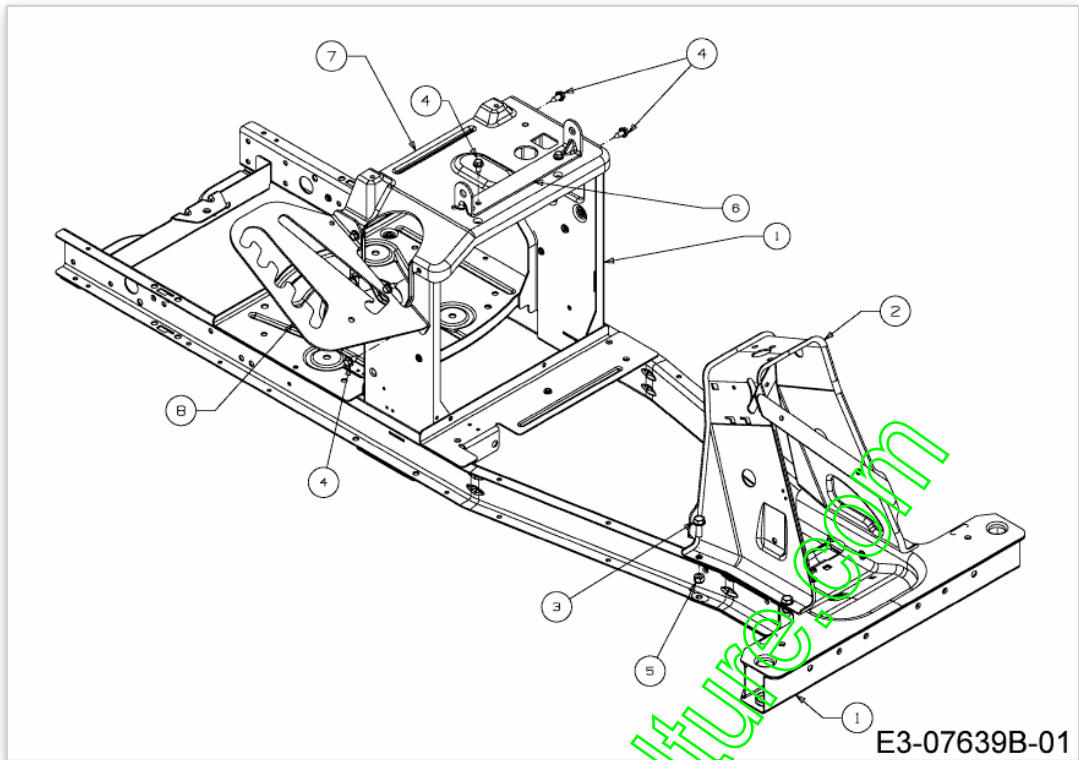

www.emc-motocultures.com

Position	Numéro de pièce	#	Appellation I	Appellation II
1	683-05015637	1	CHASSIS	683-05015637
2	683-05019637	1	LENKSTÜTZE	683-05019637
3	710-1238	4	VIS HHWSH:5/16-18:.875:GR5:STD	FINISH:MTD SPEC-100015
4	710-1652	9	VIS HEX. TT:1/4-20:.625:HXINDW	FINISH:MTD-SPEC-100016 TYPE 1
5	712-0429	4	ECROU	FINISH:SPEC-100015
6	783-07168637	1	SUPPORT	783-07168637 *
7	783-08197	1	SUPPORT SIEGE	783-08197
8	783-08260637	1	PLAQUE SELECTEUR HAUTEUR DE	783-08260637
9	710-1652	2	VIS HEX. TT:1/4-20:.625:HXINDW	FINISH:MTD-SPEC-100016 TYPE 1

www.emc-motoculture.com

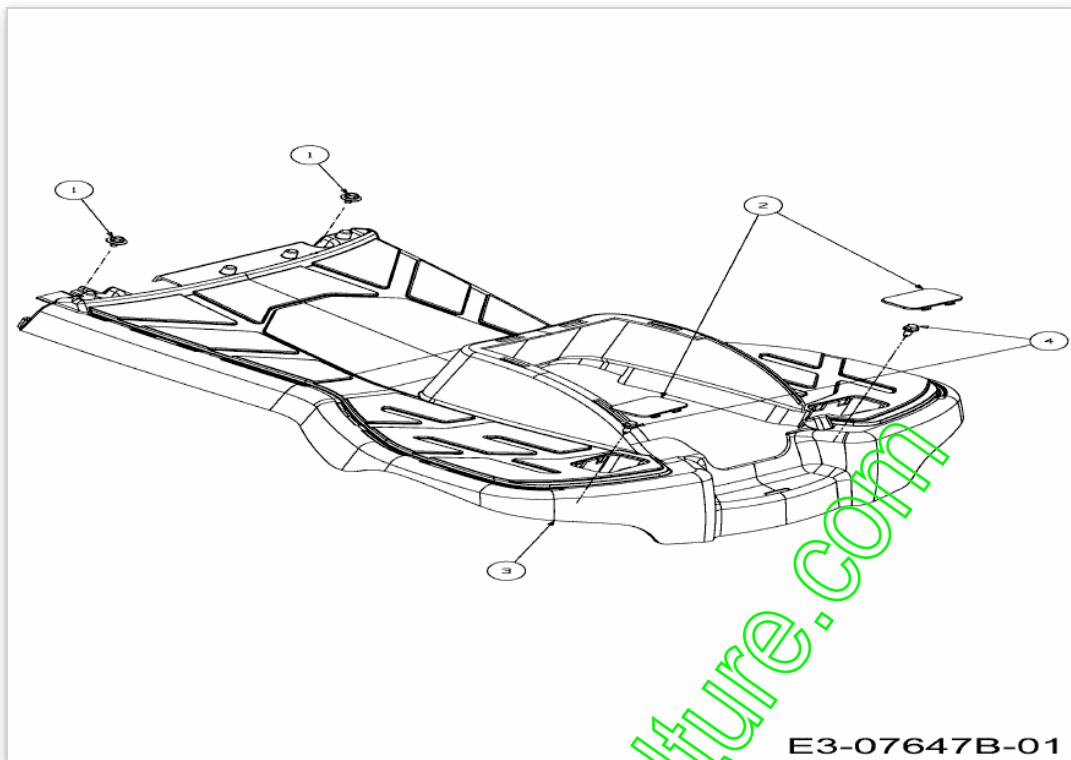

www.emc-motoculture.com

Position	Numéro de lapièce	#	Appellation I	Appellation II
1	710-05073	2	VIS 1/4-20X.50	710-05073
2	731-08753A	2	BOUCHON A CLIPS	731-08753A
3	731-08910A	1	PLATE FORME	731-08910A
4	738-04184A	2	VIS A EPAULE:.368x.113:TT:1/4- :1/4-20 / FINISH:701-01002	

www.emc-motoculture.com

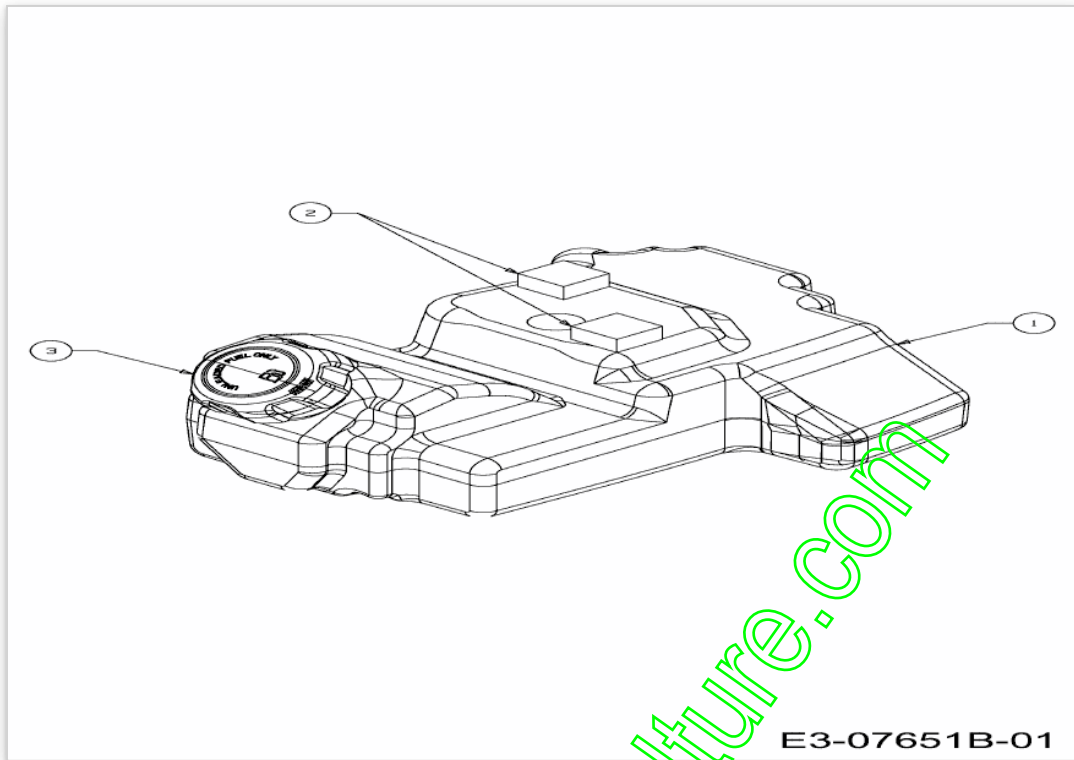

E3-07651B-01

www.emc-motoculture.com

Position	Numéro de pièce	#	Appellation I	Appellation II
1	651-04385B	1	RESERVOIR	FINISH:N/A
2	722-3020	2	KANTENSCHUTZ:1.25 SQ x .62 THK	FINISH:SIEHE ZG.
3	751-12179B	1	BOUCHON DE RESERVOIR ESSENCE	FINISH:SIEHE ZG.

www.emc-motoculture.com

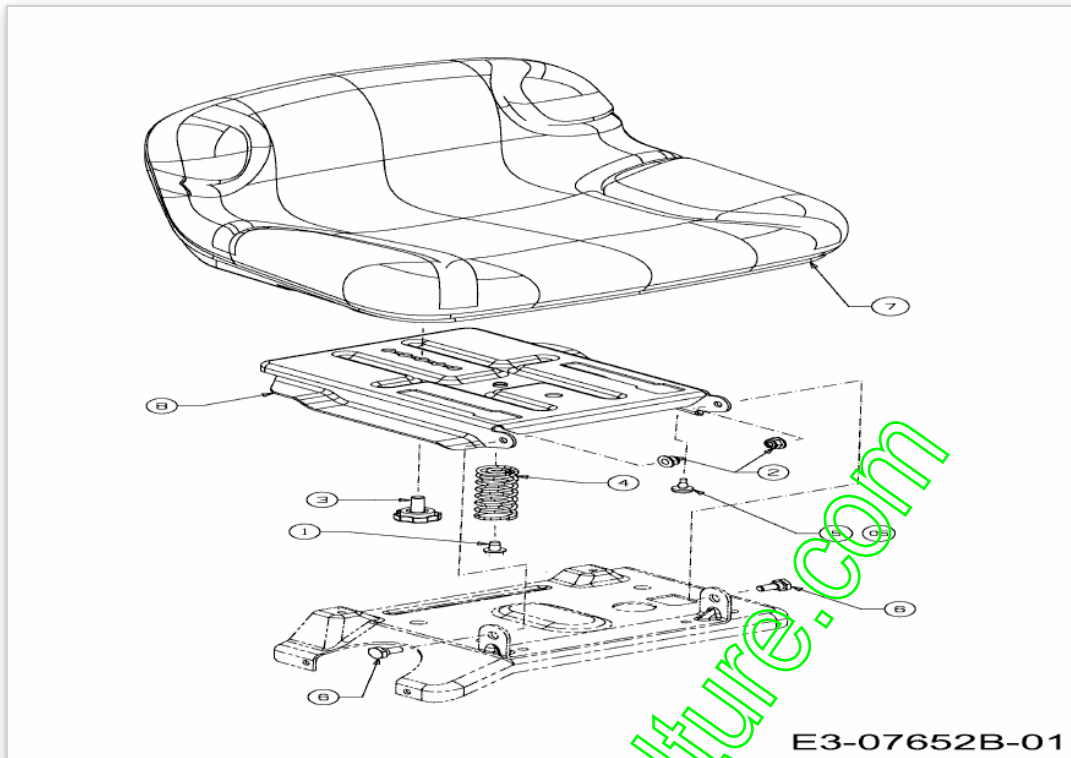

www.emc-motoculture.com

E3-07652B-01

Position	Numéro de pièce	#	Appellation I	Appellation II
1	710-0607	1	VIS HEX.TT5/16-18:.500HXINDWSh	FINISH:MTD SPEC-100016 TYPE 1
2	712-04063	2	ECROU HEX. AVEC FLANC	FINISH:MTD SPEC-100015
3	720-04009A	1	MOLETTE DE SIEGE	FINISH:SCHWARZ *
4	732-04905	1	RESSORT DE SIEGE	FINISH:SPEC-100015
5	735-0199A	1	BOUCHON EN CAOUTCH.:.62ODx.22	FINISH:SCHWARZ 935-0199A
6	738-0140	2	VIS A EP.:.435 x.178-5/16 x.56	FINISH:MTD SPEC-100015
7	757-04099	1	SIEGE	LT-5
8	783-07213A	1		

www.emc-motoculture.com

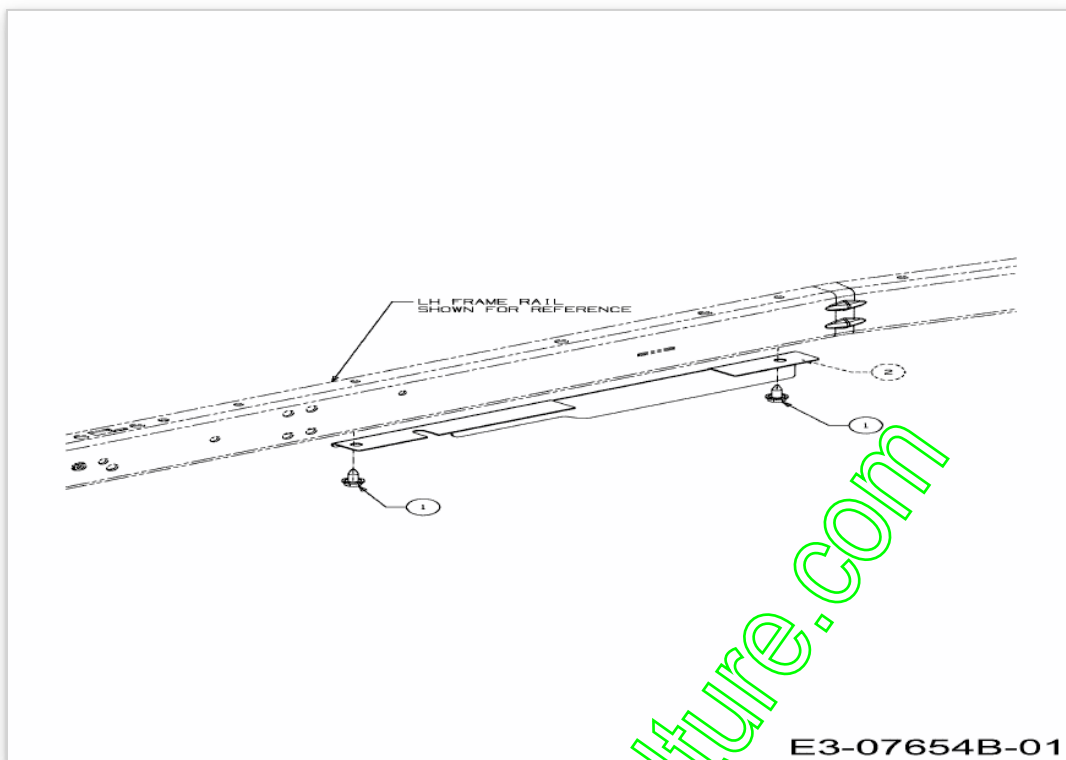

Position	Numéro de lapièce	#	Appellation I	Appellation II
1	710-1652	2	VIS HEX. TT:1/4- 20:.625:HXINDW	FINISH:MTD-SPEC-100016 TYPE 1
2	783-08208	1		

www.emc-motoculture.com

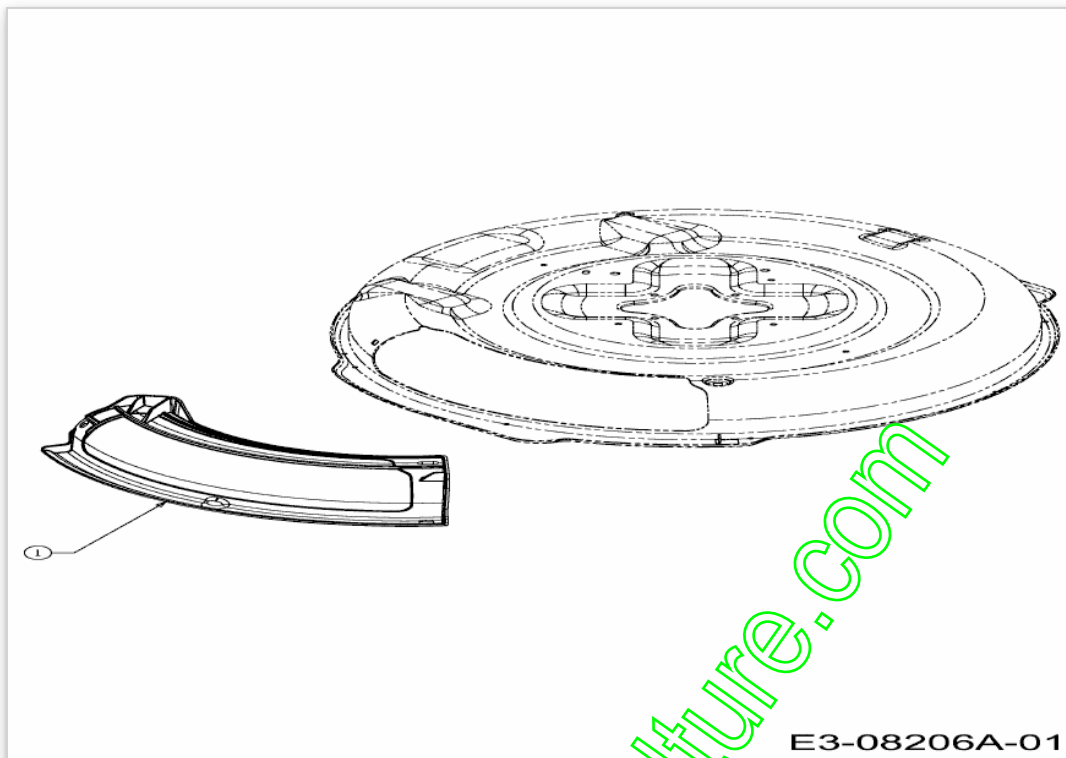

E3-08206A-01

www.emc-motoculture.com

Position	Numéro de pièce	#	Appellation I	Appellation II
1	731-09312	1	BOUCHON MULCHING	731-09312

www.emc-motoculture.com

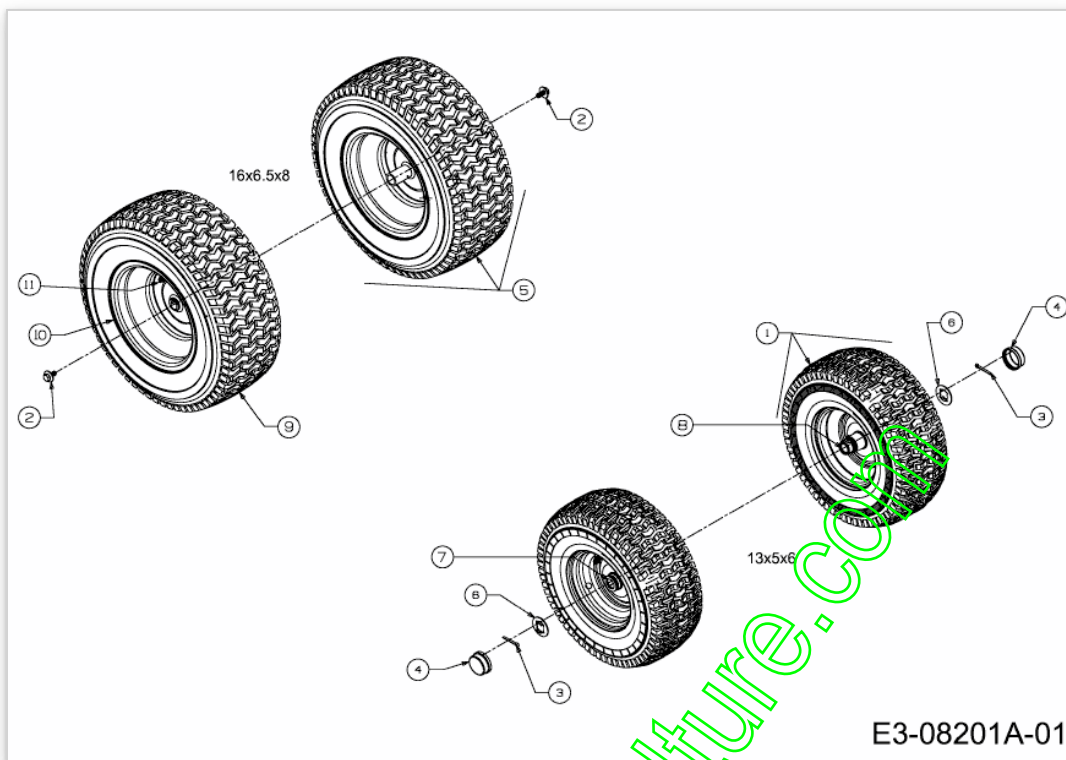

E3-08201A-01

Position	Numéro de pièce	#	Appellation I	Appellation II
1	634-04732	2	ROUE COMPLETE GRISE 13X5X6	634-04732
2	710-05339A	2	VIS	FINISH:MTD STD SPEC-101617
3	714-0162	2	GOUPILLE FENDUE 5/32:1.25	FINISH:MTD SPEC-100015
4	731-0484A	2	ENJOLIVEUR DEVANT	KUNSTSTOFF SCHWARZ 931-0484A
5	734-0591662	2	ROUE CPL 16X6.5-8 GRISE	734-0591662
6	736-04228A	2	RONDELLE	FINISH:MTD SPEC-100015
7	741-0516B	2	BAGUE DE ROUE .760x1.00x1.20	FINISH:SCHWARZ
8	741-0990B	2	BAGUE DE ROUE AVEC GRAISSEUR	m.SCHMIERNIPPEL:FINISH SCHWARZ
9	734-04641	2	PNEU 16.00X6.50X8.00	FINISH:
10	634-04174662	2	JANTE ARRIERE GRISE	OYSTER GRAU 788-0662
11	734-0255	2	VALVE:PNEU	TR 412-P / 32.6mm / 934-0255

www.emc-motoculture.com

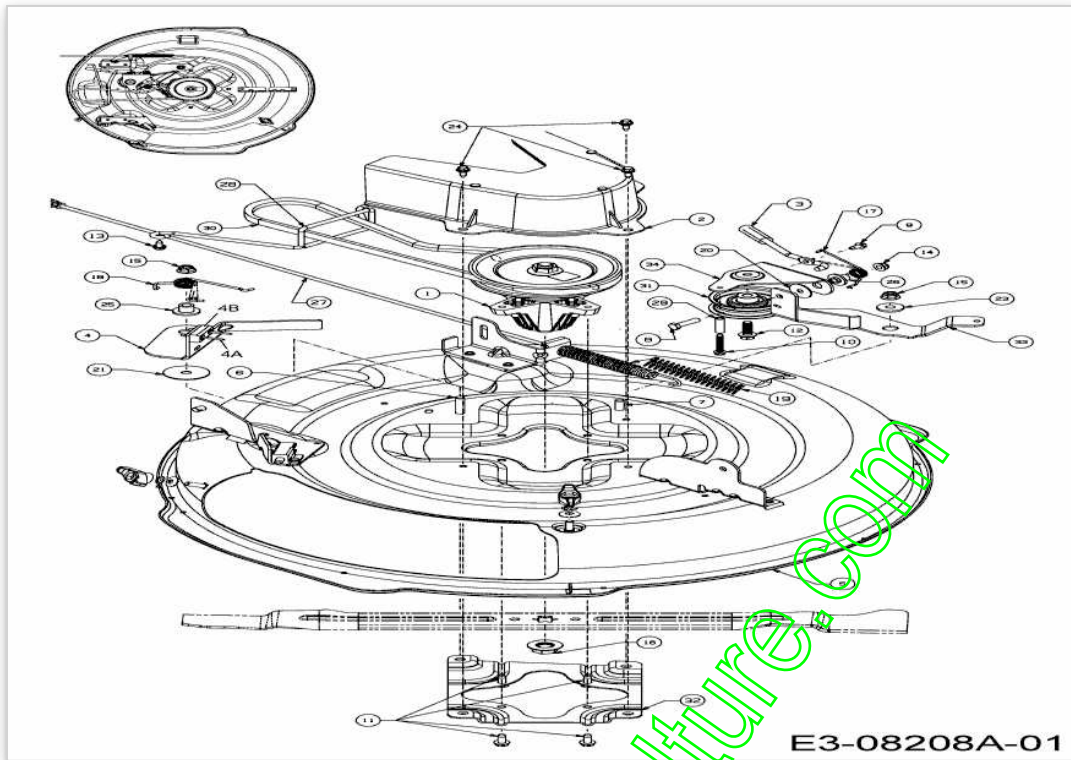

Position	Numéro de pièce	#	Appellation I	Appellation II
1	618-04822A	1	PALIER DE LAME COMPLET	FINISH: SIEHE BOM 918-04822A
2	631-05024	1	CARTER PROTECTION DE COURROIE	631-05024
3	647-05028	1	LEVIER	647-05028
4	683-05034	1	FREIN DE LAME	UND NIETEN
4A	728-0173	2	RIVET 1880 X 6520 LG	FINISH:ASTM F1941 FE/ZN 3AN
4B	761-04017	1	GARNITURE FREIN DE LAME	FINISH:
5	683-05040637	1	CARTER DE COUPE 76 CM	683-05040637
6	710-0347	1	VIS HEX. 3/8-16:1.75:GR5:STD	FINISH:MTD SPEC-100015
7	710-0514	1	VIS HEX.:3/8-16:1.00:GR5:STD	FINISH:MTD SPEC-100015
8	710-0528	1	VIS HEX. 5/16-18:1.25:GR5:STD	FINISH:SPEC-100015 910-0528
9	710-0599	1	VIS A SIX PANS CREUX	FINISH:MTD SPEC-101617
10	710-1026	1	VIS HEX:TT:1/4-20:1.750	FINISH:MTD-SPEC-100016
11	710-1260A	4	VIS TT:5/16-18:.750	FINISH:SPEC-100016 TYPE 1
12	710-1315	1	VIS HEX.TT:3/8-16:1.25:HXIN:5	FINISH:SPEC-100016 TYPE 1
13	710-1652	1	VIS HEX. TT:1/4-20:.625:HXINDW	FINISH:MTD-SPEC-100016 TYPE 1
14	712-04063	1	ECROU HEX. AVEC FLANC	FINISH:MTD SPEC-100015
15	712-04065	2	ECROU HEXAGONAL	FINISH:SPEC-100015 912-04065
16	712-0417A	1	ECROU HEX. AV. FLANC: 5/8-18	FINISH:MTD STD 701-01000
17	732-05045	1	RESSORT	FINISH:SPEC-100015
18	732-05046	1	RESSORT	FINISH:SPEC-701-01006
19	732-0583	1	RESSORT	FINISH:PHOS & OIL
20	736-0362	1	RONDELLE .320ID X 1.25 ODX .0	FINISH:SPEC-100016
21	736-3040	1	RONDELLE	FINISH:MTD STD 701-01000
23	738-0347	1	RONDELLE j EMB. .625IDx.169	FINISH:
24	738-04184A	3	VIS A EPAULE:.368x.113:TT:1/4-	:1/4-20 / FINISH:701-01002
25	738-05021	1	ENTRETOISE	FINISH:DAMPF BEHANDELT
26	738-05022	1	ENTRETOISE	FINISH:DAMPF BEHANDELT

Position	Numéro de lapièce	#	Appellation I	Appellation II
27	746-04802A	1	CABLE PTO	FINISH: SIEHE ZG.
28	747-06126A	1	GUIDE COURROIE	747-06126A
29	750-04456	1	ENTRETOISE	FINISH:MTD SPEC-100015
30	754-05001	1	COURROIE DE LAME MINIRIDER	FINISH: N/A
31	756-04224	1	POULIE TENDEUR	BLK ECOAT,PAINT OR SPEC-100015
32	783-08047A	1	RENFORT CARTER DE COUPE	783-08047A
33	783-08128	1	SUPPORT	FINISH:SPEC-100015 CR-12
34	783-08226637	1	SUPPORT POULIE TENDEUR	783-08226637

www.emc-motoculture.com

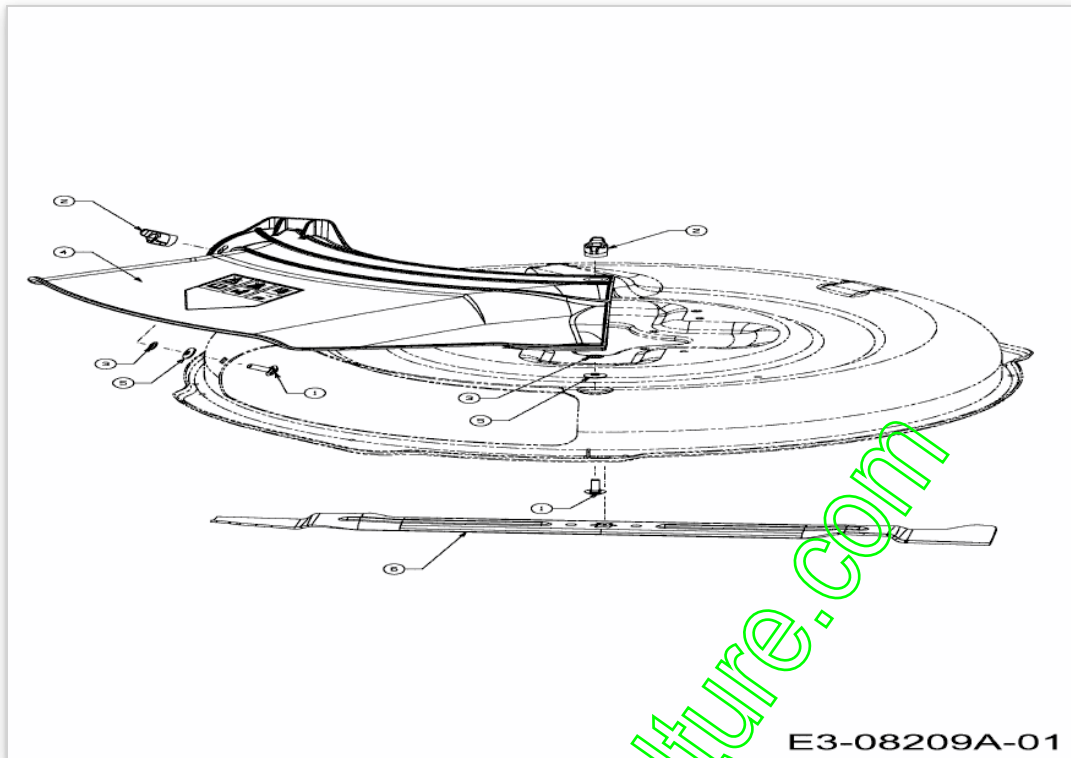

E3-08209A-01

Position	Numéro de lapièce	#	Appellation I	Appellation II
1	710-04998	2	VIS A TETE PLATE	FINISH:MTD STD 701-01000
2	720-04122	2	ECROU PAPILLON	FINISH: SIEHE ZG.
3	726-0201	2	RONDELLE .3125 ID	MECHANISCH VERZINKT:SIEHE ZG.
4	731-09357	1	DEFLECTEUR	731-09357
5	736-0242	2	RONDELLE CONIQUE.340X.872X.060	FINISH:MTD SPEC-100016
6	742-04385	1	LAME 76CM 3 EN 1	FINISH:ROSTVORSORGE EINGEÖLT

www.emc-motoculture.com

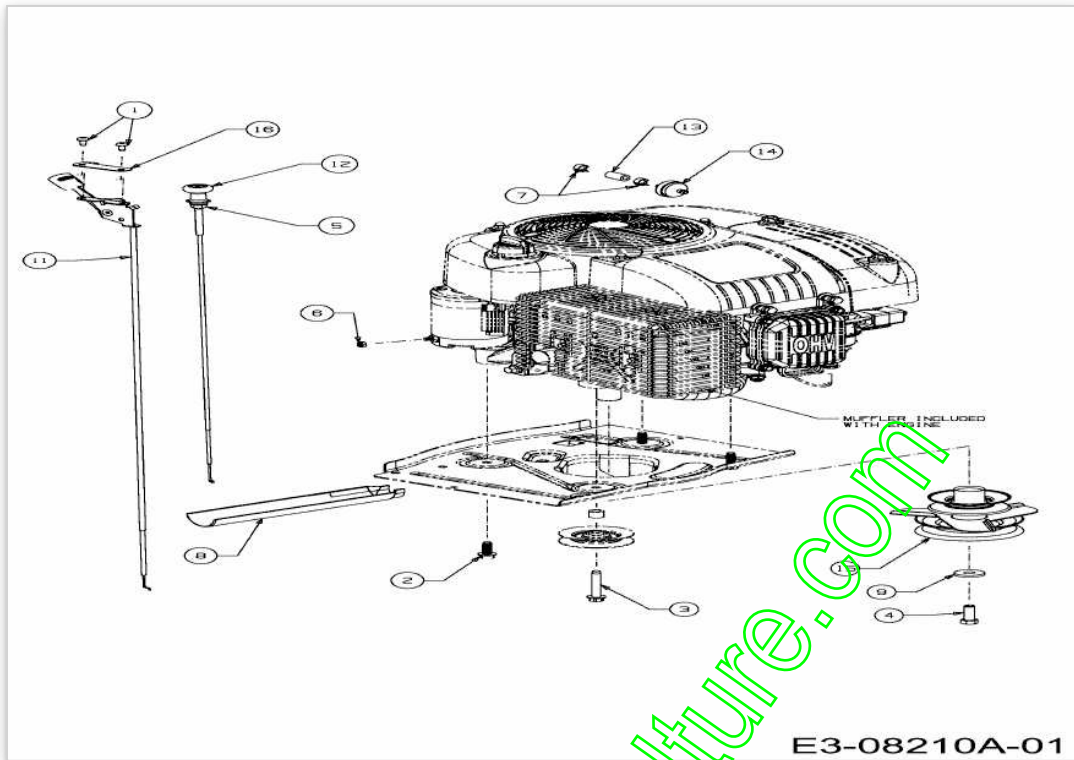

Position	Numéro de lapièce	#	Appellation I	Appellation II
1	710-0483	2	VIS	710-0483
2	710-04683A	3	VIS	FINISH:MTD SPEC-701-01002
3	710-05446	1	VIS	FINISH:MTD SPEC-701-01002
4	710-06067	1	VIS	FINISH:MTD SPEC-100015
5	712-04242	1	ECROU	FINISH:MTD SPEC-100015
6	712-0691	1	ECROU HEXAGONAL	MTD SPEC-100015 24.1426.14
7	726-0205	2	COLLIER DE SERRAGE DE BOYAU	FINISH:PHOS UND GELB LACKIERT
8	731-1682A	1	DRAINAGE HUILE	FINISH:KUNSTSTOFF SCHWARZ
9	736-0322	1	RONDELLE .450 X 1.250 X .164	FINISH:SPEC-100016 936-0322
11	746-05049	1	CABLE GAZ	MIT BEDIENUNGSHEBEL
12	746-1088	1	CABLE STARTER 23.0"LGX1.50E	EXT.MIT ZUGKNOPF
13	751-10349-22	1	TUYAU ESSENCE	751-10349-22
14	BS-298090S	1	FILTRE A ESSENCE	BS-298090S
15	756-04479A	1	POULIE MOTEUR	Ø4.46"/Ø3.39":SPEC-701-01000
16	783-08221A	1	SUPPORT CABLE GAZ	746-08221A

www.emc-motoculture.com

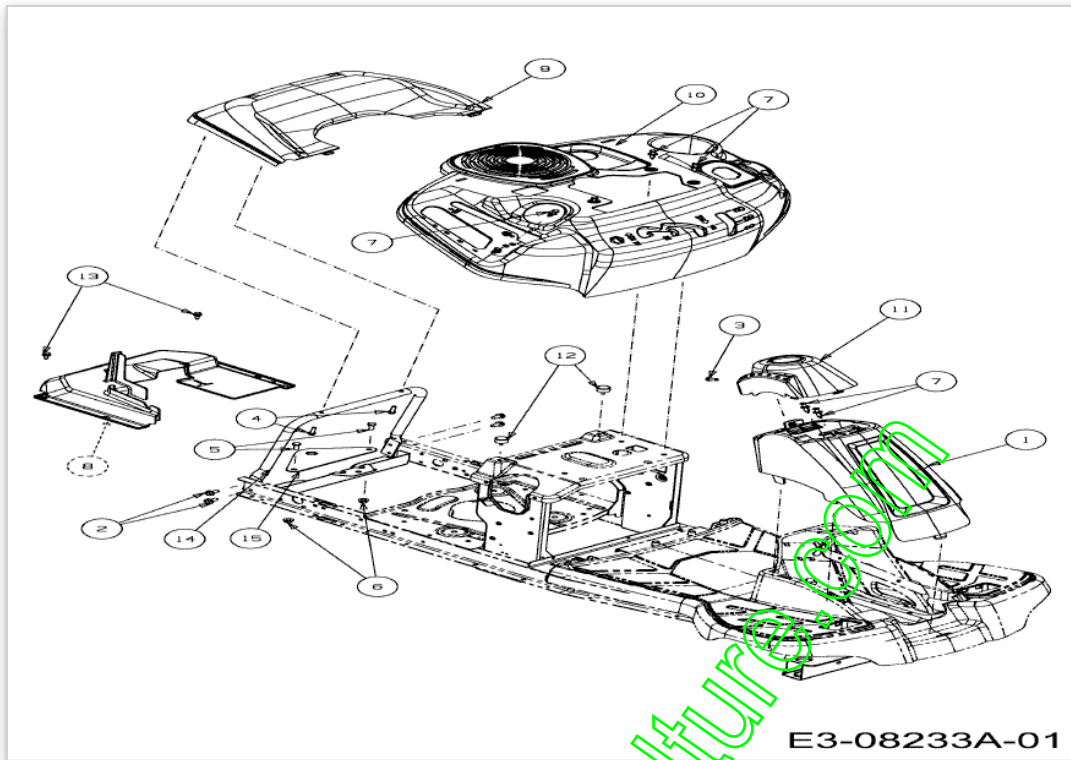

www.emc-motoculture.com

Position	Numéro de pièce	#	Appellation I	Appellation II
1	631-05064	1	CACHE DE COLONNE INFERIEUR	631-05064
2	710-04484	4	VIS HEX. TT:5/16- 18:.750:HXIND	FINISH:MTD SPEC-100016 TYPE 1
3	710-0924	1	VIS EN TÊTE PLATE 1/4- 20X;75"	FINISH:MTD STD 701-01000
4	710-1241	2	VIS	FINISH:SPEC-100016 TYPE 1
5	710-3008	2	VIS 5/16-18:.75:GR5:STD	FINISH:MTD SPEC-701-01006
6	712-04063	2	ECROU HEX. AVEC FLANC	FINISH:MTD SPEC-100015
7	728-0199	6	RIVET PLASTIQUE	PLASTIK SCHWARZ
8	731-09185	1	TOLE DE PROTECTION	731-09185
9	731-09499	1	CARTER PASTIQUE	731-09499
10	731-09500	1	CARTER DE COMMANDE	731-09500
11	731-09501	1	CACHE DE COLONNE SUPERIEUR	731-09501
12	735-05006	2	TAMPON DE SIEGE	FINISH:BLACK
13	738-04184A	2	VIS A EPAULE:.368x.113:TT:1/4-	:1/4-20 / FINISH:701-01002
14	749-04932	1		
15	783-07208	1		

www.emc-motoculture.com

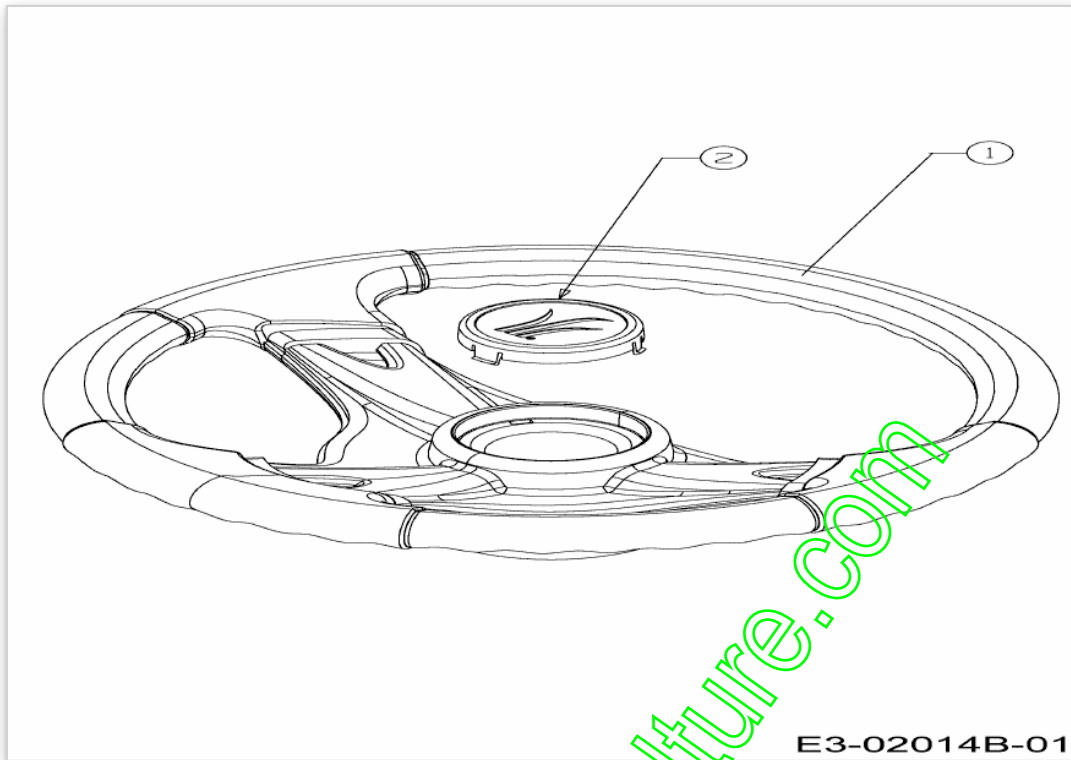

E3-02014B-01

www.emc-motoculture.com

Position	Numéro de lapièce	#	Appellation I	Appellation II
1	631-04028	1	VOLANT	STD GRIP:FINISH SCHWARZ
2	731-04040	1	COUVERCLE DE VOLANT	Ò 60mm:KUNSTSTOFF SCHWARZ

www.emc-motoculture.com

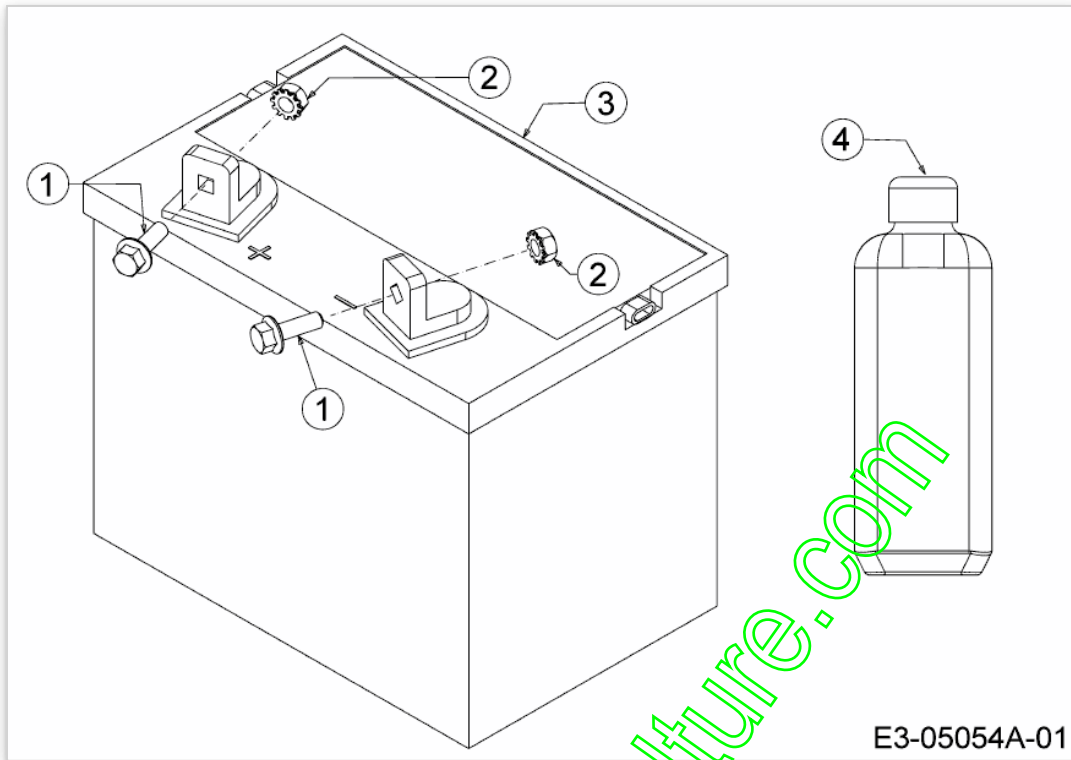

www.emc-motoculture.com

E3-05054A-01

Position	Numéro de lapièce	#	Appellation I	Appellation II
1	710-04666	2	VIS HEXAGONALE	FINISH:MTD SPEC-701-010015
2	712-0271	2	ECROU 1/4-20"+ DISQUE DENTE	FINISH:MTD SPEC-100016 GR5
3	725-1704A	1	BATTERIE:U1: 150 CCA WET	FINISH:
4	725-2064	2	BIDON ACIDE 1 LITRE	725-2064

www.emc-motoculture.com

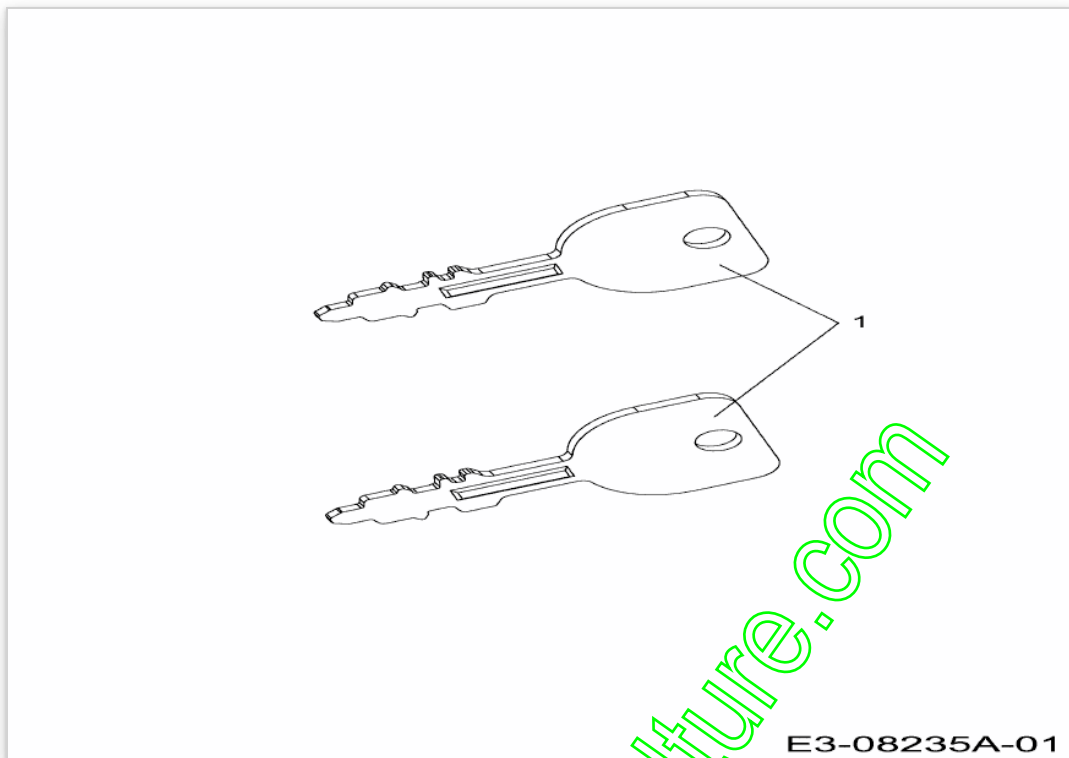

E3-08235A-01

www.emc-motoculture.com

Position	Numéro de pièce	#	Appellation I	Appellation II
1	725-1744A	2	CLE DE CONTACT	FINISH:

www.emc-motoculture.com

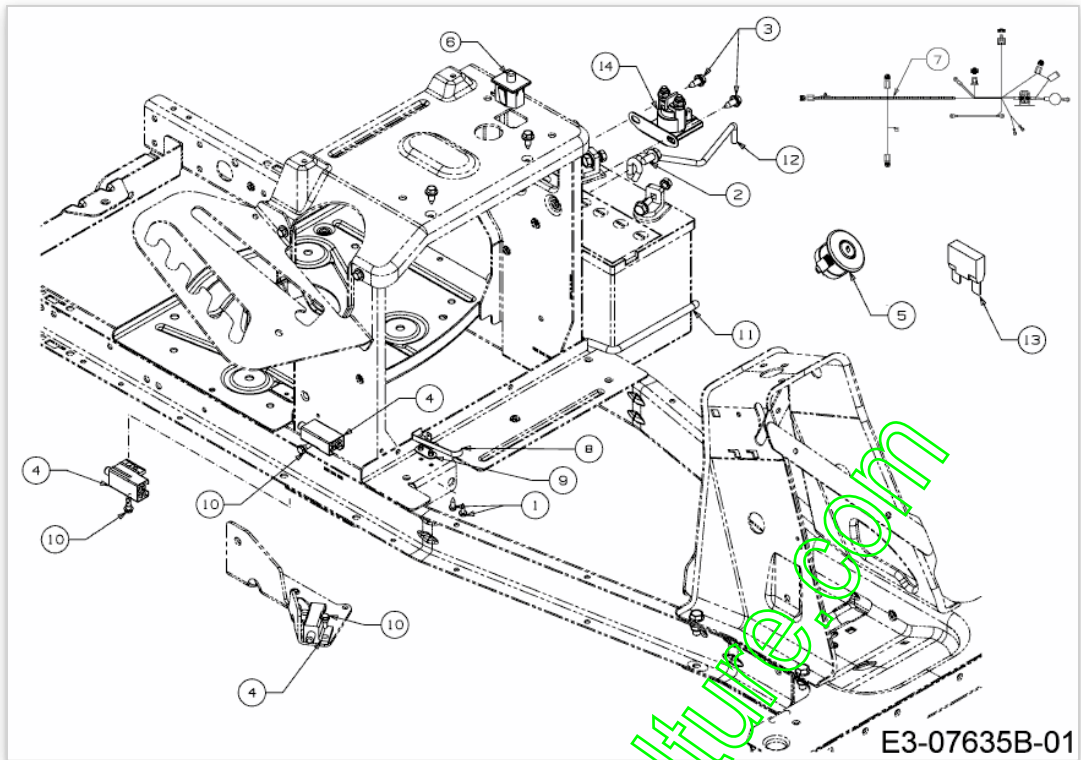

www.emc-motoculture.com

Position	Numéro de pièce	#	Appellation I	Appellation II
1	710-0227	2	VIS	FINISH:MTD SPEC-100016 TYPE 1
2	710-04484	1	VIS HEX. TT:5/16-18:.750:HXIND	FINISH:MTD SPEC-100016 TYPE 1
3	710-1652	2	VIS HEX. TT:1/4-20:.625:HXINDW	FINISH:MTD-SPEC-100016 TYPE 1
4	725-04363	3	SECURITE EMBRAYAGE	FINISH:SIEHE ZG.
5	725-04659	1	CONTACTEUR A CLEF	FINISH:
6	725-05013	1	SECURITE DE SIEGE	FINISH:GRAU
7	725-06041	1	FAISCEAU COMPLET	725-06041
8	725-1643	1	CONTACTEUR SECURITE	LANG:FINISH:SPEC-100016
9	726-0320	1	PLAQUE D'ISOLATION	FINISH:NATUR ODER SCHWARZ
10	738-04237A	3	AXE EPAULE	FINISH:MTD SPEC-100016
11	747-06131A	1	TRINGLE SUPPORT BATTERIE	747-06131A
12	747-06148	1	TRINGLE SUPPORT BATTERIE SUP	747-06148
13	725-04009	1	FUSIBLE 15A	725-04009
14	725-06153	1	SOLENOIDE	FINISH:

www.emc-motoculture.com

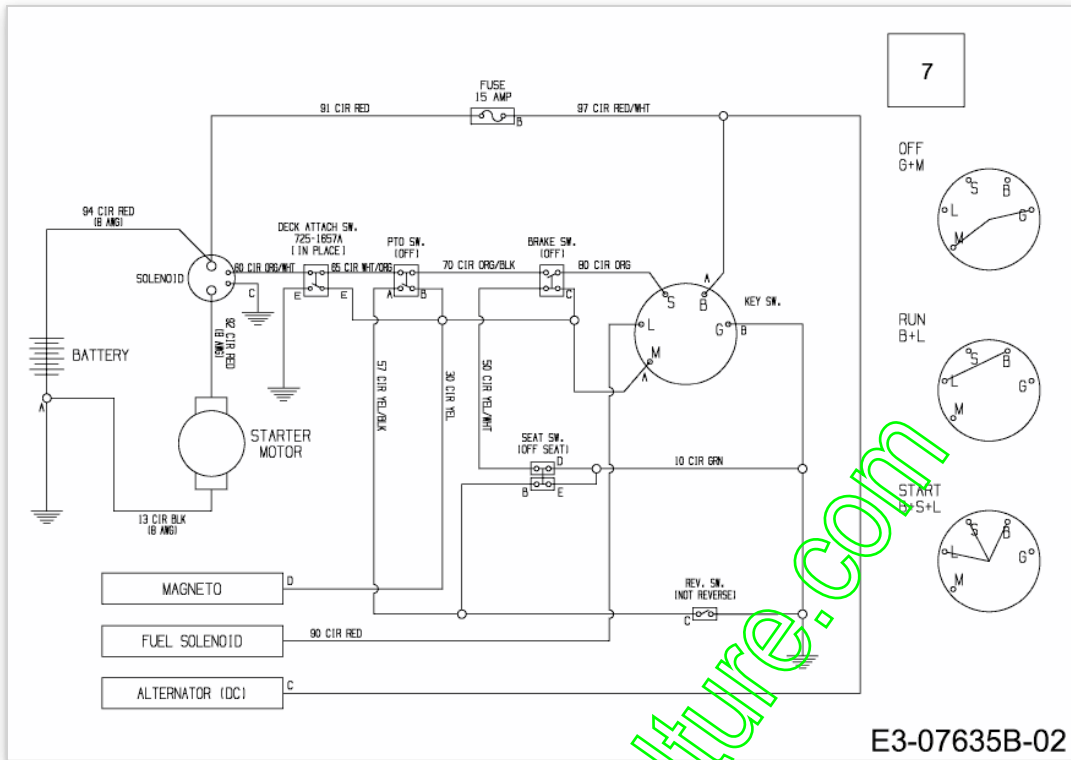

www.emc-motoculture.com

Position	Numéro de pièce	#	Appellation I	Appellation II
7	725-06041	1	FAISCEAU COMPLET	725-06041

www.emc-motoculture.com

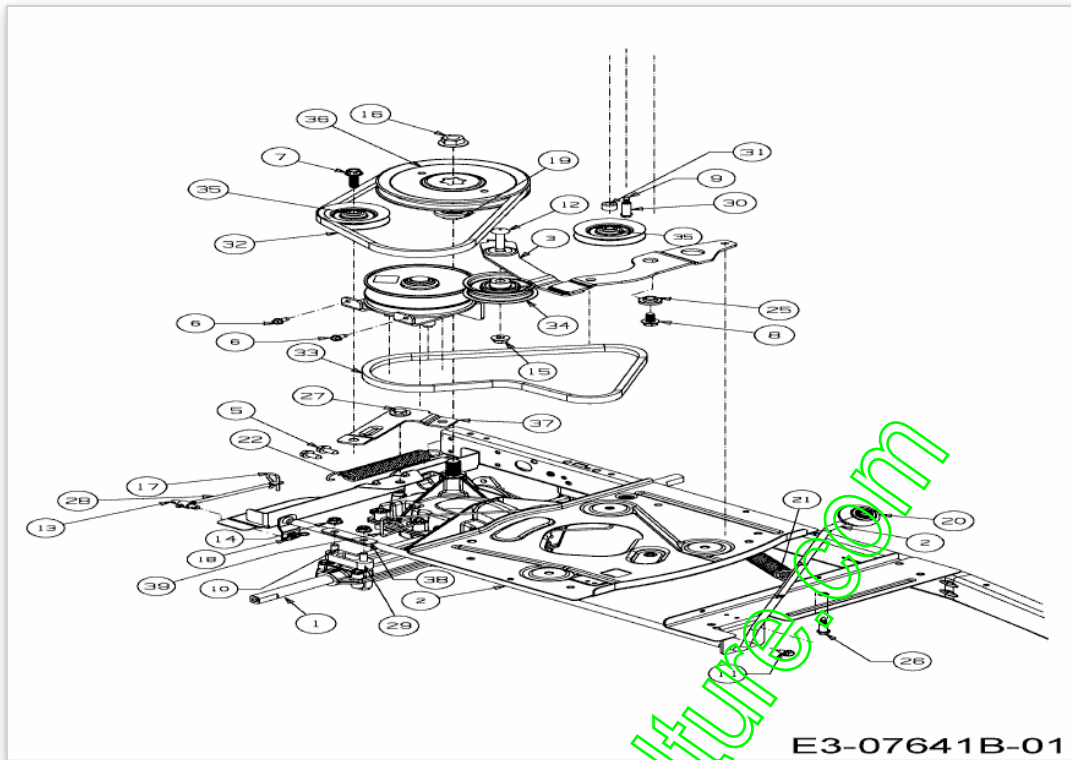

www.emc-motoculture.com

Position	Numéro de lapièce	#	Appellation I	Appellation II
1	618-05056A	1	PONT COMPLET	618-05056A
2	647-04262C	1	LEVIER INVERSEUR	647-04262C
3	683-04768A-S	1	SUPPORT POULIES	683-04768A-S
5	710-04484	2	VIS HEX. TT:5/16- 18:.750:HXIND	FINISH:MTD SPEC-100016 TYPE 1
6	710-0599	2	VIS A SIX PANS CREUX	FINISH:MTD SPEC-101617
7	710-06016	1	VIS	FINISH:SPEC-100016 TYPE 1
8	710-0623	1	VIS PARK. HEX.:TT:3/8- 16:0.750	FINISH:MTD SPEC-100016 TYPE 1
9	710-1026	1	VIS HEX:TT:1/4-20:1.750	FINISH:MTD-SPEC-100016
10	710-1266	4	VIS HHCS:5/16- 18:3.5:GR5:STD	FINISH:MTD SPEC-100015
11	710-1652	1	VIS HEX. TT:1/4- 20:.625:HXINDW	FINISH:MTD-SPEC-100016 TYPE 1
12	710-0560	1	VIS	FINISH:701-01000
13	711-06141	1	FERRURE	FINISH:MTD SPEC-100015
14	712-04063	4	ECROU HEX. AVEC FLANC	FINISH:MTD SPEC-100015
15	712-04065	1	ECROU HEXAGONAL	FINISH:SPEC-100015 912-04065
16	712-0700	1	ECROU HEXAGONAL	SPEC-100015+WAX 912-0700
17	714-0209	1	GOUPILLE FENDUE	SPEC-701-100016 914-0209
18	714-04040	1	GOUPILLE	FINISH:ASTM F1941 FE/ZN 3AN
19	718-04407	1	MOYEU. POULIE:5/8 DENTELURE	VERZAHNUNG
20	720-04028	1	POIGNEE INVERSEUR	FINISH:SCHWARZ
21	732-0459C	1	RESSORT	FINISH:MTD SPEC-100015
22	732-04934	1	RESSORT	732-04934
25	738-0372B	1	RONDELLE EPAULEE	FINISH:GEÖLT
26	738-05016	1	VIS EPAULEE	738-05016
27	738-05019	1	VIS EPAULEE	FINISH MTD SPEC-100016
28	747-05593	1	TRINGLE	747-05593
29	748-0334	2	ENTRETOISE	FINISH:GEÖLT
30	750-04456	1	ENTRETOISE	FINISH:MTD SPEC-100015
31	750-05563	1	ENTRETOISE	FINISH:MTD SPEC-100015
32	754-0241A	1	COURROIE VARIATEUR/BOITE	FINISH:SIEHE ZG. 954-0241A
33	754-04331	1	COURROIE	FINISH: SIEHE CHART
34	756-04224	1	POULIE TENDEUR	BLK ECOAT,PAINT OR SPEC-100015

Position	Numéro de lapièce	#	Appellation I	Appellation II
35	756-04325	2	POULIE TENDEUR	FINISH: SCHWARZ LACKIERT
36	756-04464	1	POULIE DE PONT	FINISH: SIEHE ZG.
37	783-07248A	1	SUPPORT	783-07248A
38	783-08131637	2	SUPPORT DE PONT	783-08131637
39	732-05060	1	GUIDE COURROIE	732-05060

www.emc-motoculture.com

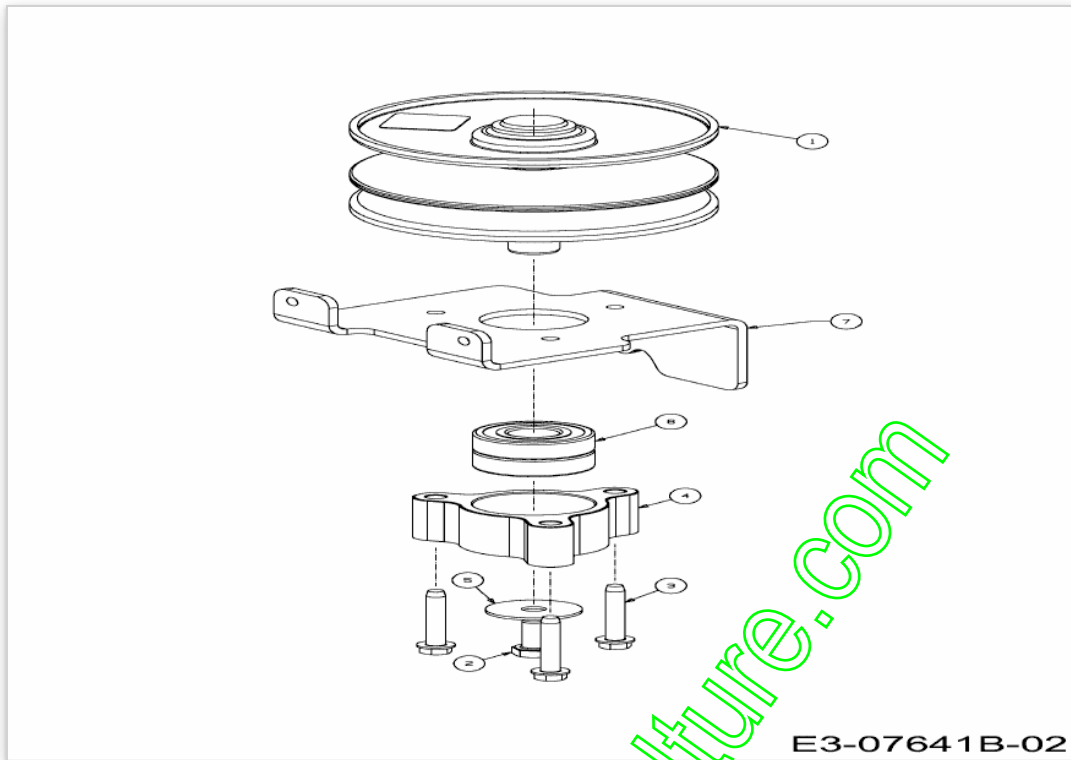

E3-07641B-02

www.emc-motoculture.com

Position	Numéro de lapièce	#	Appellation I	Appellation II
1	656-04015A	1	POULIE VARIATEUR	FINISH:
2	710-0627	1	VIS HEX. 5/16-24:.750 GR5:LOCK	FINISH:MTD SPEC-100015
3	710-0778	3	VIS HEX. TT:1/4-20:1.500	FINISH:MTD SPEC-100016 TYPE 1
4	718-04261	1	CAGE DE ROULEMENT	FINISH:ROTSCHUTZ SIEHE ZG.
5	736-0362	1	RONDELLE .320ID X 1.25 ODX .0	FINISH:SPEC-100016
6	741-0124A	2	ROULEMENT A BILLE	FINISH:
7	783-08210	1		

www.emc-motoculture.com

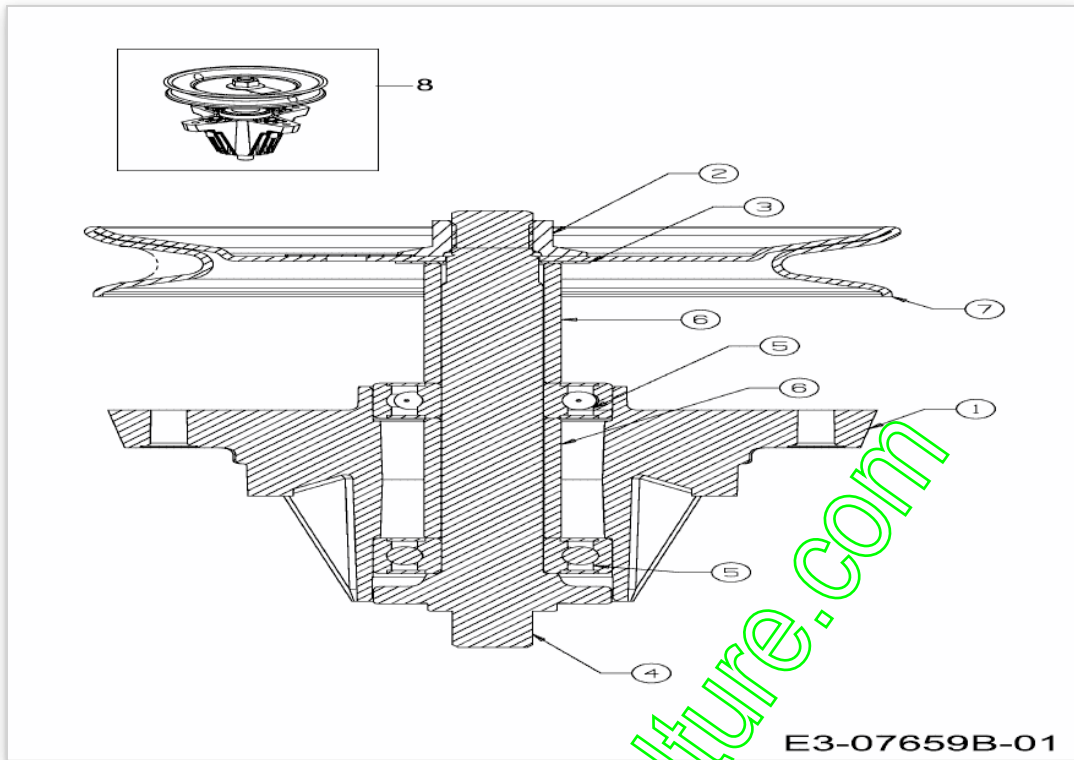

www.emc-motoculture.com

Position	Numéro de pièce	#	Appellation I	Appellation II
1	619-04183B	1	CORPS DE PALIER	FINISH:WIE GEGOSSEN
2	712-0417A	1	ÜCROU HEX. AV. FLANC: 5/8-18	FINISH:MTD STD 701-01000
3	736-0351	1	RONDELLE .75x1.50"	FINISH:MTD SPEC-100016
4	738-1186A	1	AXE DE PALIER DE LAME	FINISH:GEÖLT
5	741-0919A	2	ROULEMENT A BILLES	FINISH:
6	750-04936	2	ENTRETOISE	FINISH:GEÖLT
7	756-1227	1	POULIE DE PALIER DE LAME	FINISH:SIEHE ZG.
8	618-04822A	1	PALIER DE LAME COMPLET	FINISH SIEHE BOM 918-04822A

www.emc-motoculture.com

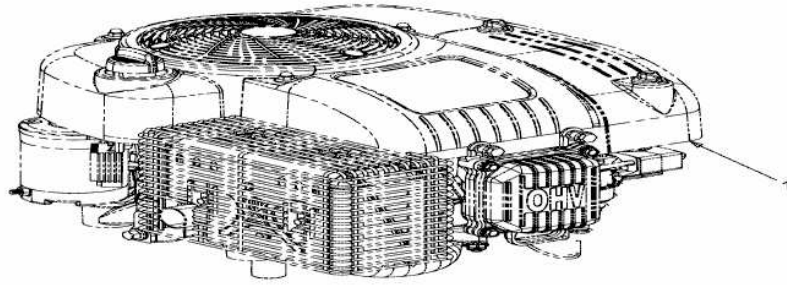

MTD
Model: 4 P 90 JHB

E3-08294B-01

www.emc-motoculture.com

Position	Numéro de lapièce	#	Appellation I	Appellation II
1	752Z4P90JHD	1	MOTEUR COMPLET	752Z4P90JHD
2	6012-X1-0033	X	HUILE MULTRIGRADE	6012-X1-0033

www.emc-motoculture.com

www.emc-motoculture.com