

Quik

WHITE



OUTDOOR PRODUCTS OWNER'S GUIDE

LT-120/LT-140

Model Numbers

137-666-190

137-686-190

Motor 14 CV IC Serie 401700 à 401799

Models 666 and 686

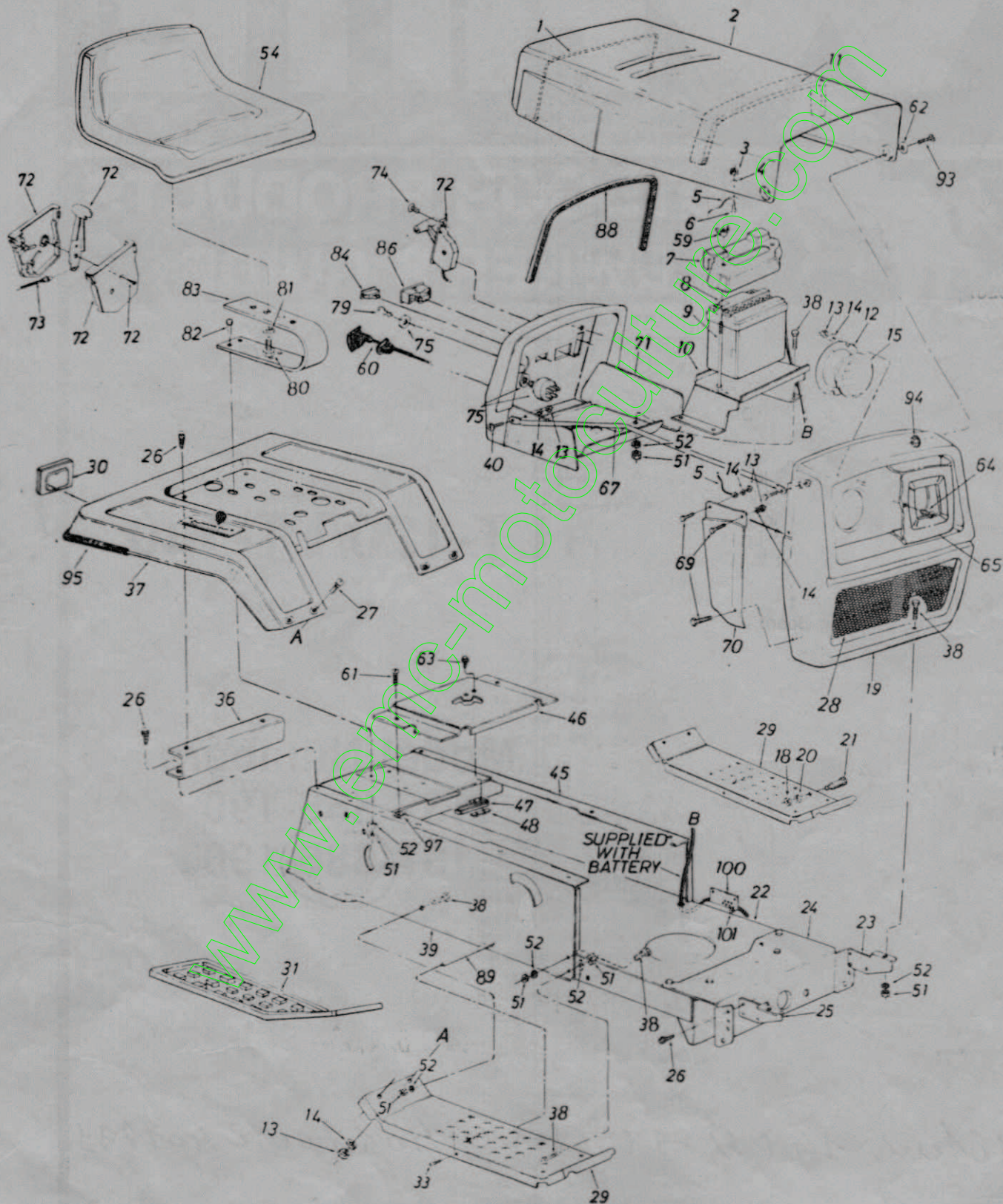

Models 666 and 686

PARTS LIST FOR MODELS 666 AND 686 LAWN TRACTORS

REF. NO.	PART NO.	COLOR CODE	DESCRIPTION	NEW PART	REF. NO.	PART NO.	COLOR CODE	DESCRIPTION	NEW PART
1	732-0477	447	Hood Spring		51	712-0267		Hex Nut 5/16-18 Thd.*	
2	16646		Hood		52	736-0119		L-Wash. 5/16" I.D.*	
3	712-0272		Hex Sems Nut #10-24 Thd.*		54	757-0318		Seat Ass'y.	
4	726-0154		Push Mount Tie		59	712-0113		Wing Nut 1/4-20 Thd.—Plastic	
5	723-0302		Hood Stop 7" Lg.		60	746-0613		Choke Control 44" Lg.	
6	710-0473		Truss Hd. Scr. #10-24 x 1/2" *		61	710-0351		Truss Mach. Tap Scr. #10 x .50" Lg.	
7	731-0707		Battery Cover					Washer .39" I.D. x .62" O.D.	
8	725-0453		12 Volt Battery		62	736-0413		Hex Wash. Hd. AB-Tap Scr. #8 x .50	
9	711-0222		Battery Hold Down Rod		63	710-0227		Truss Hd. Scr. #10-24 x .38" Lg.	
10	12747		Battery Bracket					Bezel	
11	722-0138		PVC Foam—Strip		64	710-0148		Grille Support Rod—L.H.	
12	09960		Headlight Retainer					Grille Support Rod—R.H.	
13	712-0287		Hex Nut 1/4-20 Thd.*		65	731-0465		Truss Hd. Scr. 1/4-20 x .75" Lg.*	
14	736-0329		L-Wash. 1/4" I.D.*		67	749-0673		R.H.—Grille Side Panel	
15	725-0222		Headlight			749-0674		L.H.—Grille Side Panel	
18	712-0798		Hex Nut 3/8-16 Thd.*		69	710-0255		Dash Panel Ass'y.	
19	14781		Grille Ass'y.					Throttle Control Box Ass'y.	
20	736-0169		L-Wash. 3/8" I.D.*		70	14748		Throttle Control Wire—35"	
21	738-0145		Shld. Bolt .50" Dia. x .84			14749		Truss Mach. AB-Tap Scr. #10 x .5" Lg.	
22	14606		Lower Frame		71	16184		Ignition Switch	
23	13863		Grille Mount Brkt.—L.H.		72	831-0823		Ignition Key	
24	14619		Front Pivot Brkt.		73	746-0634		Hex Bolt 1/2-13 x 1.00" Lg. (Grade 5) (2-Req'd.)	
25	13862		Grille Mount Brkt.—R.H.		74	710-0779		L-Wash. 1/2" I.D.*	
26	710-0726		Hex Wash. Hd. AB-Tap Scr. 5/16 x .75" Lg.					Hex Bolt 5/16-18 x 1.00" Lg.*	
27	710-0495		Carriage Bolt 1/4-20 x 2.00" Lg.*		75	725-0267		Seat Spring 5.5" High	
28	731-0881		Grille Insert		79	725-0201		Light Switch	
29	14604	Running Board (R.H. & L.H.)		80	710-0865		Ammeter		
30	730-0116	Reflector					Molding Strip 27" Lg.		
31	731-0753	Foot Pad		81	736-0921		Running Board Rod		
33	710-0323	Truss Mach. Scr. 5/16-18 x .75" Lg.*		82	710-0376		Shld. Bolt .375 Dia. x .125		
36	15848	Fender Mount Brace		83	732-0458		L-Nut 1/4-28 Thd.		
37	16221	Fender		84	725-0634		Trim Strip 31.0" Lg.		
38	710-0118	Hex Bolt 5/16-18 x .75" Lg.*		86	725-0925		Speed Nut #10Z		
39	14602	R.H. Side Frame		88	731-0511		Brake Cable Bracket		
40	710-0258	Hex Bolt 1/4-20 x .62" Lg.*		89	738-0526		Cable Tie		
41	722-0157	Foam Strip		93	738-0724				
45	14603	L.H. Side Frame		94	712-0380				
46	16433	Shift Cover		95	731-0511				
47	725-0759	Reverse Safety Switch		97	726-0139				
48	726-0222	Insulator Nut Plate		100	16371				
				101	726-0197				

(447—Patina Silver)
(483—Charcoal Grey)

*For faster service obtain standard nuts, bolts and washers locally.
If these items cannot be obtained locally, order by part number and size as shown on parts list.

If color or finish is important when ordering parts, use the appropriate color code shown above [i.e. (part no.)-483 for Charcoal Grey Finish].

Models 666 and 686

PARTS LIST FOR MODELS 666 AND 686 LAWN TRACTORS

REF. NO.	PART NO.	COLOR CODE	DESCRIPTION	NEW PART	REF. NO.	PART NO.	COLOR CODE	DESCRIPTION	NEW PART
1	731-0220		Steering Wheel Cap		30	711-0613		Tie Rod	
2	712-0237		Hex L-Nut 5/16-24 Thd.		31	712-0711		Hex Jam Nut 3/8-24 Thd.*	
3	736-0242		Belleville Wash. .345" I.D.		32	14650		Front Axle Ass'y.—R.H.	
4	731-0806		Steering Wheel		33	**		Wheel Ass'y. Comp.	
5	731-0559		Steering Bellow		34	**		Front Wheel Rim Only	
6	16512		Steering Column Ass'y.		35	741-0487		Bearing	
7	741-0356		Flange Bearing .890 I.D. x 1.36 O.D.		36	736-0187		FI-Wash. .640" I.D. x 1.54" O.D.	
8	712-324		Hex L-Nut 1/4-20 Thd.		37	731-0541		Front Wheel Hub Cap	
9	736-0319		FI-Wash. .438" I.D. x 1.37"		38	714-0470		Cotter Pin 1/8" Dia. x 1.25" Lg.	
10	738-0141		Shoulder Bolt .437" Dia. x .35 Lg. 5/16-18 Thd.		39	736-0187		FI-Wash. .640" I.D. x .24" O.D.	
11	710-0152		Hex Bolt 3/8-24 x 1.0" Lg. (Grade 5)		40	726-0214		Push Cap 5/8" Dia. Rod	
12	736-0258		FI-Wash. .38" I.D. x 1.0"		42	712-0241		Hex Nut 3/8-24 Thd.*	
13	750-0535		Spacer .380" I.D. x .625" O.D. x .227		43	710-0538		Hex L-Bolt 5/16-18 x .62"*	
14	736-0169		L-Wash. 3/8" I.D.*		44	736-0119		L-Wash. 5/16" I.D.*	
15	710-0726		Hex Wash. Hd. Self-Tap Scr.		45	736-0231		FI-Wash. .344" I.D. x 1.25" O.D.	
16	711-0788		Steering Drag Link		46	750-0532		Spacer (Plastic)	
17	14619		Front Pivot Brkt.		47	712-0241		Hex Nut 3/8-24 Thd.*	
18	738-0527		Shoulder Bolt .498" Dia. x 2.04 Lg. 3/8-16 Thd.		48	736-0169		L-Wash. 3/8" I.D.*	
19	712-0798		Hex Nut 3/8-16 Thd.*		49	712-0267		Hex Nut 5/16-18 Thd.*	
20	736-0169		L-Wash. 3/8" I.D.*		50	736-0119		L-Wash. 5/16" I.D.*	
21	712-0237		Hex Cent. L-Nut 5/16-24 Thd.		51	717-0622		Steering Gear Segment	
22	16481		Steering Arm Front Axle		52	741-0225		Hex Flg. Brg. .634 I.D.	
23	710-0772		Hex Bolt 5/16-24 x 2.00" Lg. (Grade 5)		53	736-0187		FI-Wash. (Hardened)	
24	741-0225		Hex Flg. Brg. .634 I.D.		54	738-0522		Steering Shaft Lower	
25	14608		Pivot Bar Ass'y.		55	710-0958		Hex Bolt 1/4-20 x 1.31" Lg.	
26	16479		Front Axle Ass'y.—L.H.		57	710-0837		Oval Hd. Cr.—Sunk Scr. #10 x 5/8" Lg.	
27	712-0241		Hex Nut 3/8-24 Thd.*		58	736-0271		Wave Wash. .32" I.D. x .62"	
28	736-0169		L-Wash. 3/8" I.D.*		59	736-0187		FI-Wash. (Hardened)	
29	723-0156		Ball Joint 3/8-24 Thd.		60	723-3018		Drag Link Ball Joint 3/8-24 Thd.	

*For faster service obtain standard nuts, bolts, and washers locally. If these items cannot be obtained locally, order by part number and size as shown on parts list.

**FRONT WHEEL CHART

Description	15 x 6.00
Wheel Assembly Comp.	734-0863
Tire Only	734-0864
Rim Only	734-0997
Bearing	741-0313
Air Valve	734-0255
Grease Fitting	737-0146

Models 666 and 686

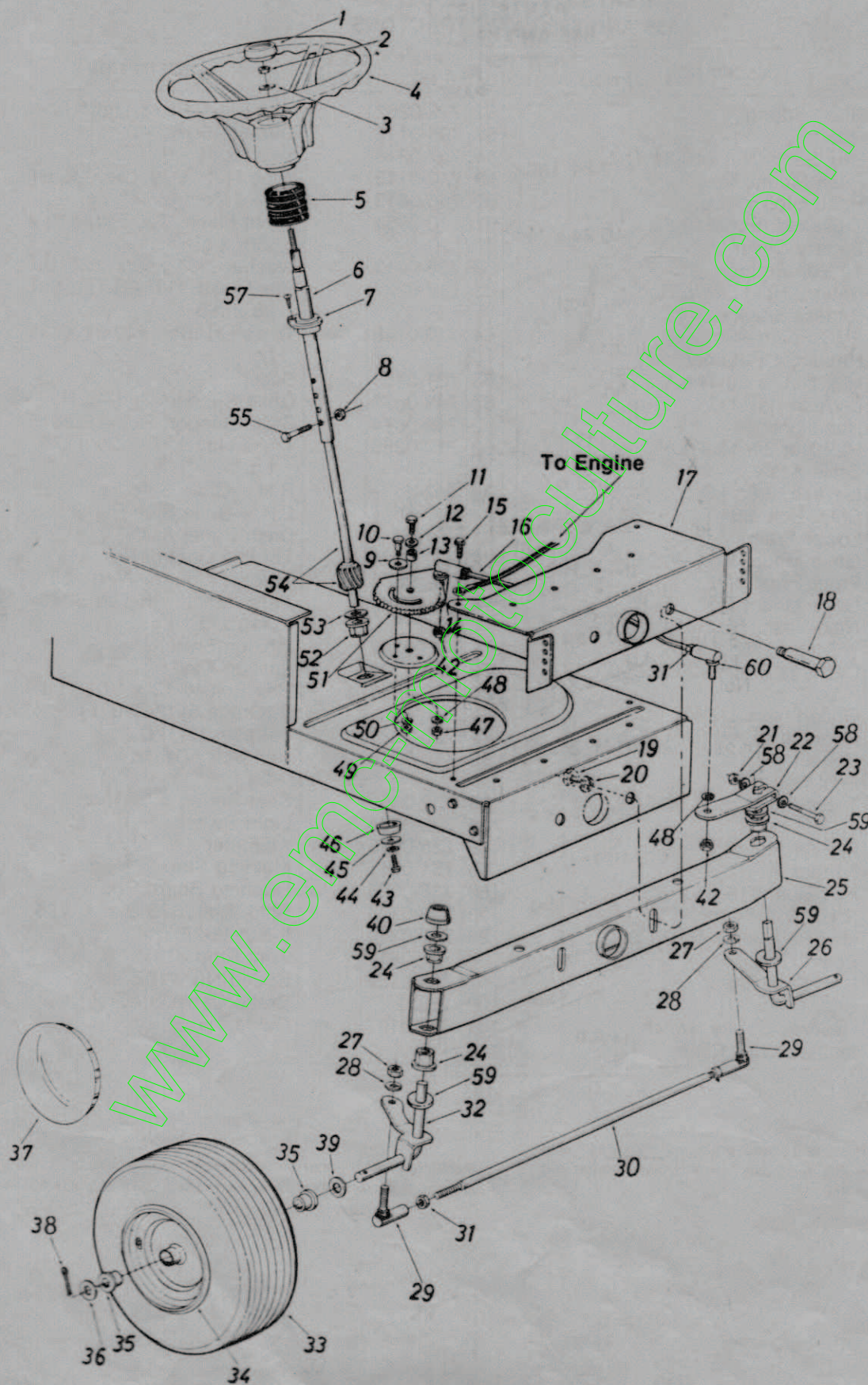

Models 666 and 686

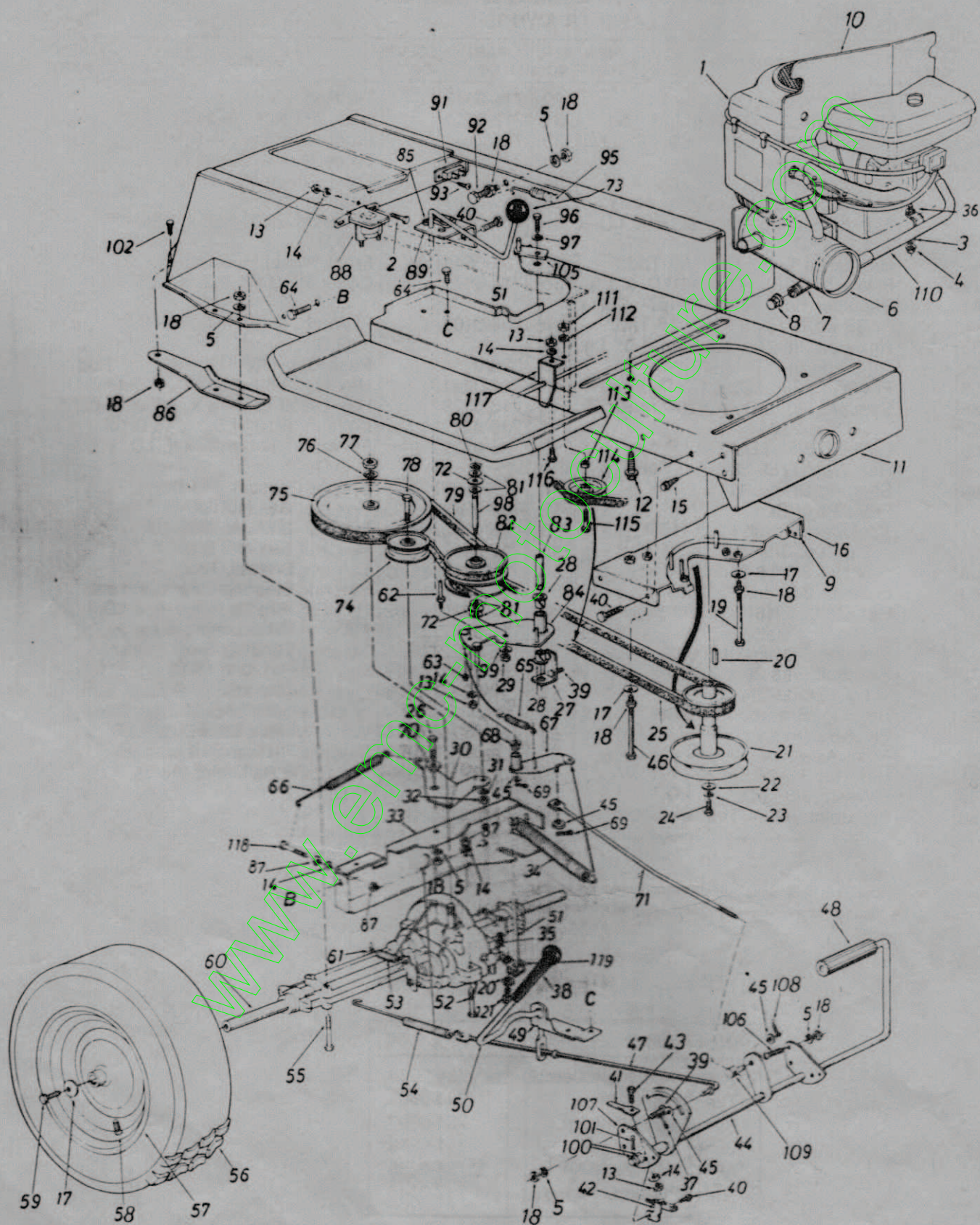

Models 666 and 686

PARTS LIST FOR MODELS 666 AND 686 LAWN TRACTORS

REF. NO.	PART NO.	COLOR CODE	DESCRIPTION	NEW PART	REF. NO.	PART NO.	COLOR CODE	DESCRIPTION	NEW PART
1	—		Engine		53	732-0264		Ext. Spring .38" O.D. x 2.5"	
2	710-0258		Hex Bolt 1/4-20 x .62" Lg.*		54	732-0413		Ext. Spring .59" O.D. x 7.08"	
3	736-0170		Special L-Wash. 5/16" I.D.		55	710-0176		Hex Bolt 5/16-18 x 2.75"*	
4	712-0267		Hex Nut 5/16-18 Thd.*		56	734-0817		Wheel Ass'y. Comp.	
5	736-0119		L-Wash. 5/16" I.D.*			734-0448		Tire Only	
6	751-0444		Exhaust Muffler		57	734-0603		Wheel Rim Only	
7	737-0164		Pipe Nipple		58	734-0255		Air Valve (Service Only)	
8	737-0143		Cap Oil Drain		59	710-0627		Hex Bolt 5/16-24 x .75" Lg.*	
9	16371		Brake Cable Brk't.		60	717-1050		Transaxle Complete—R.H.	
10	16215		Heat Shield		61	732-0454		Brake Return Spring Anchor	
11	15930		Lower Frame Ass'y.		62	711-0768		Belt Guard Pin 1/4-20 Thd.	
12	710-0502		Hex Wash. Hd. TT-Tap Scr. 3/8-16 x 1.25" Lg.		63	726-0106		Cap Speed Nut 1/4" Dia.	
13	712-0287		Hex Nut 1/4-20 Thd.*		64	710-0604		Hex Wash. TT-Tap Scr. 5/16 x .62" Lg.	
14	736-0329		L-Wash. 1/4" I.D.*		65	732-0387		Ext. Spring .50" Dia.	
15	710-0726		Hex Wash. Hd. AB-Tap Scr. 5/16" x .75" Lg.		66	732-0384		Ext. Spring .62" O.D. x 6.12"	
16	16219		Belt Guard Brkt. Ass'y.		67	16554		Variable Speed Torque Brkt. Ass'y.	
17	736-0242		Bell-Wash. .345" I.D. x .88"		68	741-0419		Flanged Bearing	
18	712-0267		Hex Nut 5/16-18 Thd.*		69	714-0507		Cotter Pin 3/32" Dia.*	
19	710-0190		Hex Bolt 5/16-18 x 4.00"*		70	748-0234		Shoulder Spacer .500" Dia. x .27" Lg.	
20	714-0114		Sq. Key 1/4" x 1/4" x 2.00"		71	747-0530		Speed Control Link	
21	756-0424		Engine Pulley		72	741-0405		Truss Bearing .56 Dia. x 1.25"	
22	736-0322		FI-Wash. 7/16" I.D. x 1.25"		73	720-0165		Ball Knob	
23	736-0171		L-Wash. 7/16" I.D.*		74	756-0437		FI-Idler Pulley 3.25" x 1.0"	
24	710-0757		Hex Bolt 7/16-20 x 1.50" Lg.		75	756-0374		1/2" "V"-Pulley 8.0" O.D. x .501" I.D.	
25	754-0280		Variable-Speed Belt		76	736-0921		L-Wash. 1/2" I.D.*	
26	710-0118		Hex Bolt 5/16-18 x .75" Lg.*		77	712-0922		Hex Jam Nut 1/2-20 Thd.*	
27	16553		Bearing Shaft Bracket Ass'y.		78	710-0539		Hex Bolt 3/8-24 x .75" Lg.*	
28	741-0295		Flanged Nylon Brg. 5/8" I.D. x .88" Lg.		79	754-0281		Variable Speed Belt	
29	712-0241		Hex Nut 3/8-24 Thd.*		80	716-0114		Snap Ring .56" Dia.	
30	15891		Idler Bracket		81	736-0355		FI-Wash.	
31	736-0169		L-Wash. 3/8" I.D.*		82	717-0800		Variable Speed Pulley Ass'y. 5" O.D.	
32	712-0241		Hex Nut 3/8-24 Thd.*		83	711-0766		Bearing Shaft	
33	15945		Transaxle Support Brkt.		84	16354		Variable Speed Brkt. Ass'y.	
34	732-0459		Ext. Spring .94" O.D. x 6.7		85	732-0525		Comp. Spring Clip	
35	714-0149		Inter. Cotter Pin		86	14770		Transaxle Support Brkt.— R.H.	
36	736-0204		FI-Wash. .34" I.D. x .62" O.D. x .033			14769		Transaxle Support Brkt.— L.H. (Not Shown)	
37	714-0507		Cotter Pin 3/32" Dia. x .75"*		87	712-0138		Hex Nut 1/4-28 Thd.	
38	720-0143		Grip—Black		88	725-0771		Solenoid	
39	710-0323		Truss Mach. Scr. 5/16-18 x .75" Lg.		89	16429		Shift Lever Bracket	
40	710-0599		Hex Wash. Hd. Self-Tap Scr. 1/4-20 x .50" Lg.		91	725-0459		Circuit Breaker	
41	732-0435		Switch Actuator		92	710-0959		Hex Bolt 5/16-18 x 1.50"	
42	725-0577		Safety Switch		93	710-0351		Truss Hd. Phil. Scr. #10 x 1/2" Lg.	
43	710-0597		Hex Bolt 1/4-20 x 1.0" Lg.*		95	732-0307		Ext. Spring .99" O.D. x 11.0"	
44	16235		Clutch & Brake Pedal Ass'y.		96	710-0180		Hex Bolt 3/8-24 x .75" Lg.*	
45	736-0117		FI-Wash.		97	736-0105		Bell-Wash. .38" I.D. x .88"	
46	710-0402		Hex Bolt 5/16-18 x 4.5"*		98	738-0569		Shaft .56" Dia. x 3.875" Lg.	
47	747-0519		Brake Rod 20.9" Lg.						
48	735-0196		Foot Pad						
	15889		Brake Lever Bracket						
	15888		Hill Holder Brake Handle						
51	16430		Shift Lever Ass'y.						
	710-0559		Hex Bolt 1/4-28 x 1.75" Lg.*						

Models 666 and 686

PARTS LIST FOR MODELS 666 AND 686 LAWN TRACTORS (CONTINUED)

REF. NO.	PART NO.	COLOR CODE	DESCRIPTION	NEW PART	REF. NO.	PART NO.	COLOR CODE	DESCRIPTION	NEW PART
99	736-0331		Bell-Wash. .39" I.D. x 1.12"		112	736-0169		L-Wash. 3/8" I.D.*	
100	736-0256		FI-Wash.		113	736-0280		FI-Wash. .390" I.D. x 1.12"	
101	714-0507		Cotter Pin 3/32" Dia. x .75"*		114	756-0217		FI-Idler w/Flanges 2.750	
102	710-0604		Hex Wash. Hd. Scr. 5/16-18 x .62" Lg.		115	710-0427		Hex Bolt 3/8-16 x 2.00" Lg.*	
105	16067		Belt Guard		116	710-0258		Hex Bolt 1/4-20 x .62" Lg.*	
106	710-0118		Hex Bolt 5/16-18 x .75" Lg.*		117	16181		Spring Hanger Bracket	
107	15835		Pedal Bracket		118	710-0428		Hex Bolt 1/4-28 x 1.25" Lg.*	
108	714-0507		Cotter Pin 3/32 x .75"*		119	16437		Shift Lever Link Ass'y.	
109	711-0198		Ferrule		120	736-0270		Bell-Wash. .265 I.D. x .75 O.D.	
110	751-0446		Inlet Tube Ass'y.		121	710-0195		Hex Bolt 1/4-28 x .62" Lg.	
111	712-0798		Hex Nut 3/8"-16 Thd.*						

Models 666 and 686

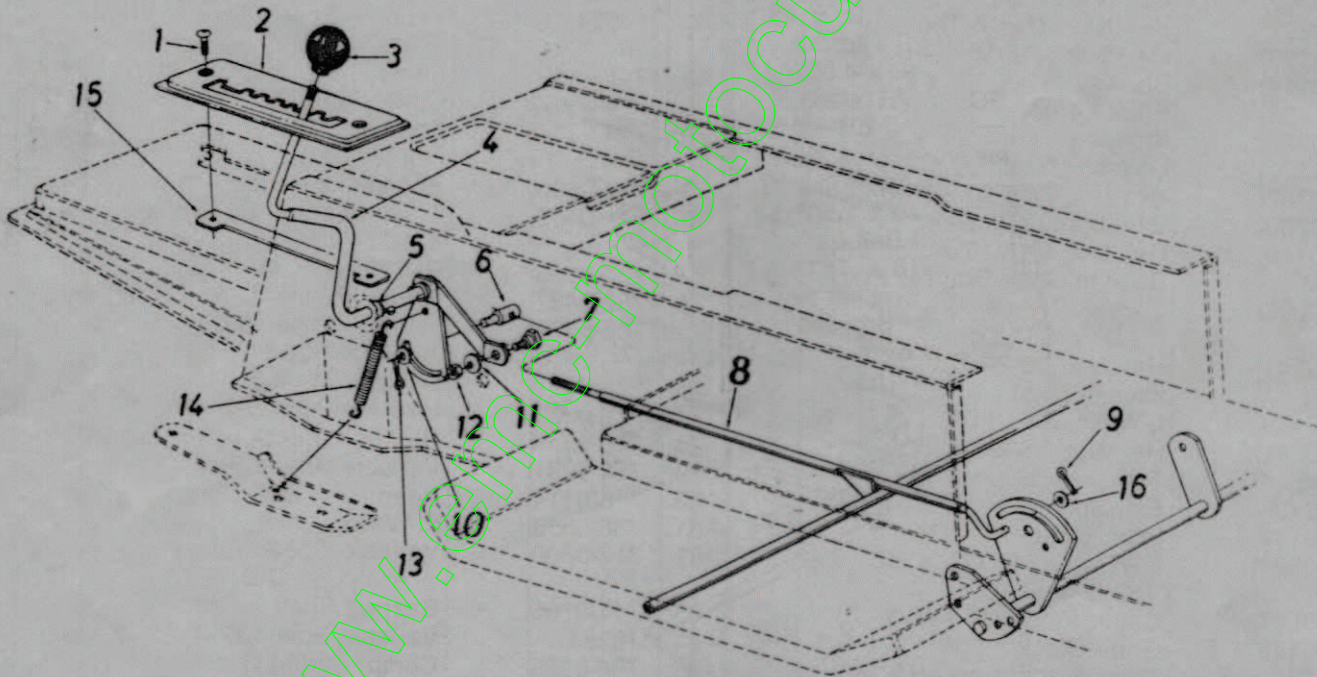

PARTS LIST FOR MODELS 666 AND 686 LAWN TRACTORS

REF. NO.	PART NO.	COLOR CODE	DESCRIPTION	NEW PART	REF. NO.	PART NO.	COLOR CODE	DESCRIPTION	NEW PART
1	710-0924		Truss Mach. Scr. 1/4-20 x .75" Lg.		8	16355		Speed Control Rod Ass'y.	
2	16194		Speed Selector Plate 7-Speed		9	714-0507		Cotter Pin 3/32" Dia. x .75"*	
3	720-0175		Gear Shift Knob		10	736-0140		FI-Wash. .385" I.D. x .62" O.D.	
4	16192		Speed Selector Cam Ass'y.		11	736-0119		L-Wash. 5/16" I.D.*	
5	736-0192		Flat Washer .53" I.D. x .93"		12	712-0267		Hex Nut 5/16-18 Thd.*	
6	711-0198		Ferrule 3/8-24 x .37" Dia.		13	714-0507		Cotter Pin 3/32 Dia. x .75"*	
7	738-0155		Shoulder Bolt .435" Dia. x .160		14	732-0303		Spring	
					15	16196		Clamping Plate	
					16	736-0226		FI-Wash. .47" I.D. x .88" O.D.	

Models 666 and 686

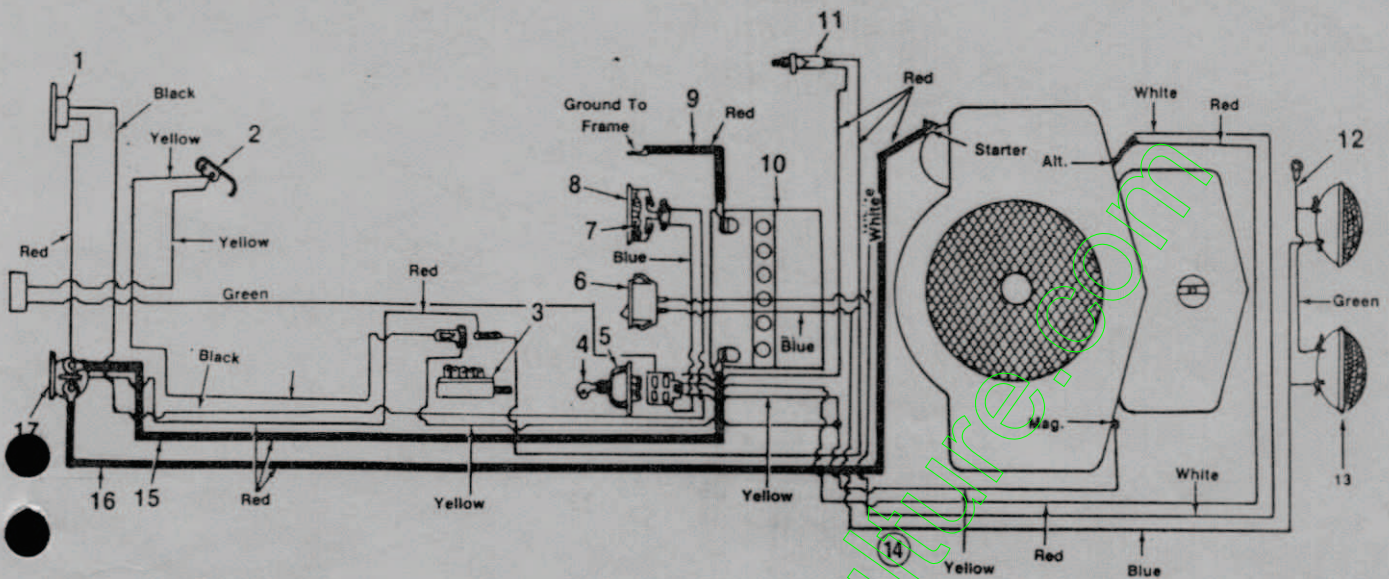

PARTS LIST FOR ELECTRICAL SYSTEM FOR MODELS 666 AND 686

REF. NO.	PART NO.	COLOR CODE	DESCRIPTION	NEW PART NO.	REF. NO.	PART NO.	COLOR CODE	DESCRIPTION	NEW PART NO.
1	725-0459		Circuit Breaker		10	725-0453		12 Volt Battery	
2	725-0759		Spring Switch		11	725-0577		Safety Switch	
3	725-0819		Safety Switch Dpst.		12	725-0916		Ground Wire	
4	725-0201		Ignition Key		13	725-0222		Headlight	
5	725-0267		Ignition Switch		14	725-1179		Wire Harness	
6	725-0634		Headlight Switch		15	725-1080		Electric Wire 27.0" Lg.	
7	722-0135		Foam Strip		16	725-0562		Electric Wire 32.5" Lg.	
8	725-0925		Ammeter		17	725-0771		Solenoid	
9	725-0994		Grounding Wire 14.0" Lg.						

Part No.	Description
777-6549	"WHITE" Plastic Logo—On Hood Side Labels
777-6580	"LAWN BOSS LT-140" Label— Hood (686)
777-6581	"LAWN BOSS LT-120" Label— Hood (666)
777-4777	Reflective Label—Seat
777-6655	"CRUISE-MATIC" Label—Fender

Model 666 (With 38" Deck)

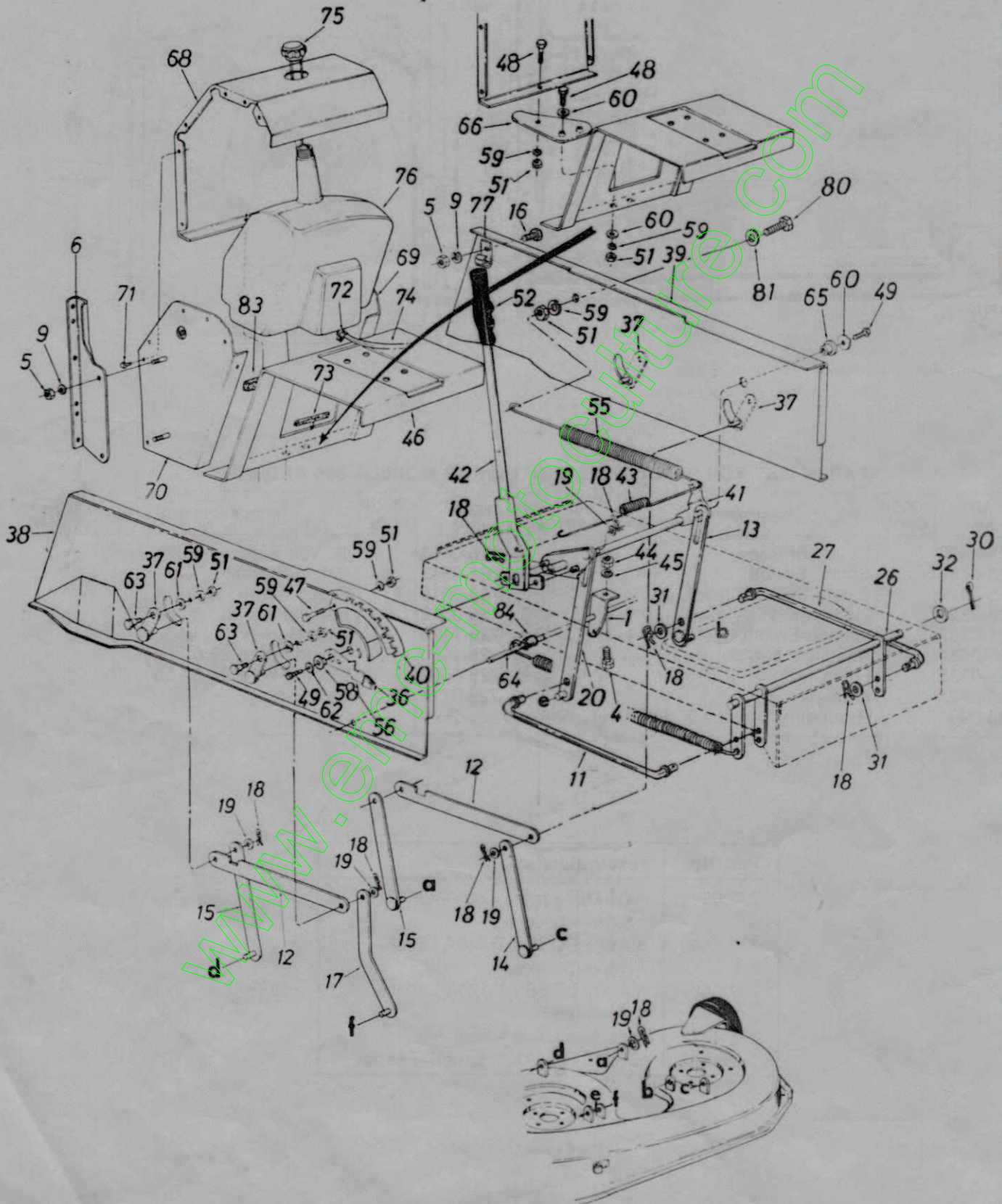

Model 666 (With 38" Deck)

PARTS LIST FOR MODEL 666 LAWN TRACTOR WITH 38" DECK

REF. NO.	PART NO.	COLOR CODE	DESCRIPTION	NEW PART	REF. NO.	PART NO.	COLOR CODE	DESCRIPTION	NEW PART
1	16181		Spring Hanger Bracket		45	736-0329		L-Wash. 1/4" I.D.*	
4	710-0258		Hex Bolt 1/4-20 x .62" Lg.*		46	16223		Hitch Plate	
5	712-0267		Hex Nut 5/16-18 Thd.*		47	710-0118		Hex Bolt 5/16-18 x .75" Lg.*	
6	17078		Mounting Bracket—R.H.**		48	710-0376		Hex Bolt 5/16-18 x 1" Lg. (Grade 5)	
	17077		Mounting Bracket—L.H. (Not Shown)**		49	710-0604		Hex Wash. TT Tap Scr. 5/16-18 x .62" Lg.	
8	732-0410		Ext. Spring .99" O.D. x 13.25" Lg.		51	712-0267		Hex Nut 5/16-18 Thd.*	
9	736-0119		L-Wash. 5/16" I.D.*		52	720-0157		Grip	
11	711-0790		Stabilizer Rod		55	732-0307		Ext. Spring .99" Dia. x 11.00" Lg.	
12	09735		Connecting Rod 3/16 x 1 x 12.5		56	732-0412		Deck Lift—Down Stop	
13	14802		Deck Lift Link Ass'y.		58	748-0176		Flange Brg. .630" I.D.	
14	14804		Deck Hanger Link Ass'y.— Rear L.H.		59	736-0119		L-Wash. 5/16" I.D.*	
15	15373		Deck Hanger Link Ass'y.		60	736-0231		FI-Wash. .344" I.D. x 1.125" O.D.	
16	710-0118		Hex Bolt 5/16-18 x .75" Lg.*		61	736-0264		FI-Wash. .344" I.D. x .62" O.D. x .063	
17	14800		Deck Hanger Link Ass'y.— (Dog Leg)		62	736-0231		FI-Wash. .344" I.D. x 1.125" O.D.	
18	714-0101		Inter. Cotter Pin 1/2" Dia.					Shld. Bolt .437" Dia. x .180	
19	736-0160		FI-Wash. .531 I.D. x .93" O.D.		63	738-0140		Running Board Rod	
20	14802		Deck Lift Link Ass'y.		64	738-0526		Flange Brg. .632" I.D.	
26	16234		Stabilizer Shaft Ass'y.		65	741-0313		Hitch Bar	
27	711-0790		Stabilizer Rod		66	16315		Gas Tank Housing—Main Panel	
30	714-0470		Cotter Pin 1/8" Dia. x 1.25" Lg.*		68	16238		Side Panel—L.H. Gas Tank	N
31	736-0117		FI-Wash. .385" I.D. x .620" O.D.		69	17083		Side Panel—R.H. Gas Tank	N
32	736-0156		FI-Wash. .635" I.D. x 1.12" O.D.		70	17082		Truss. Mach. B-Tap Scr. #10 x .50" Lg.	
36	08540		Knob—Height Adj.		71	710-0351		Hose Clamp—.406" Dia.	
37	09721		Pivot Link Ass'y.		72	726-0207		Trim Strip—5" Lg.	
38	14602		Side Panel Upper Frame— R.H.		73	731-0511		Gas Line—44" Lg.	
39	14603		Side Panel Upper Frame— L.H.		74	751-0173		Gas Tank Cap	
40	16462		Index Brkt. (Deck Lift)		75	751-0226		Gas Tank	
41	16463		Lift Shaft Ass'y.		76	751-0403		Hose Clamp	
42	16465		Lift Handle Brkt. Ass'y.		77	726-0175		Hex Bolt 5/16-18 x 1.50" Lg.*	
43	732-0498		Ext. Spring .56" I.D. x 32 Coils		80	710-0959		FI-Wash. .344" I.D. x .875" O.D.	
44	712-0287		Hex Nut 1/4-20 Thd.*		81	736-0159		Foam Strip 3/8" x 1-1/8" x 1 1/2" Lg. (2 Req'd.)	
					83	722-0157		Spacer .523" I.D. x .640" O.D. x 1.95" Lg.	
					84	711-0425			

*For use with optional Rear Bagging Kit, Model 064.

Model 686 (With 44" Deck)

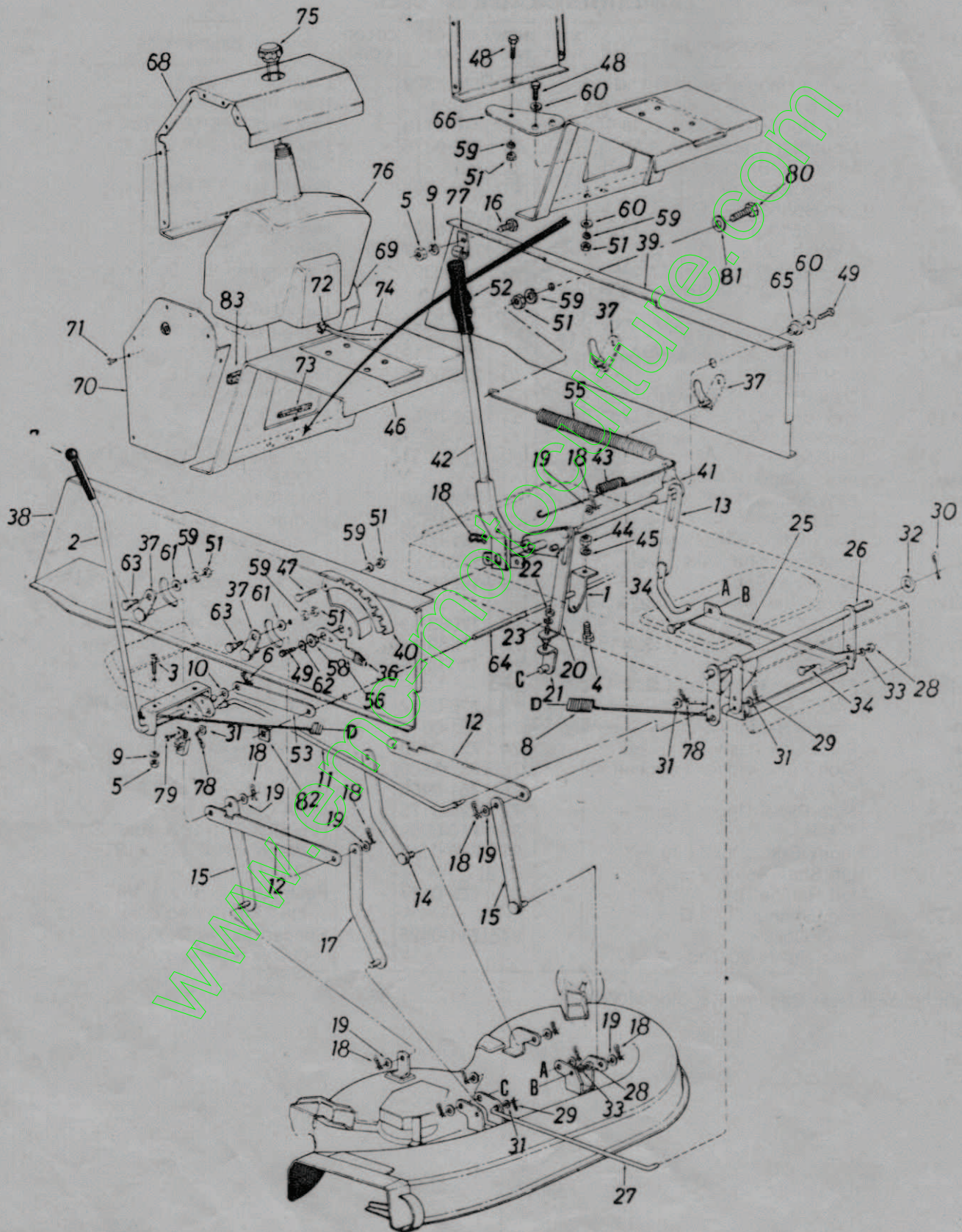

Model 686 (With 44" Deck)

PARTS LIST FOR MODEL 686 LAWN TRACTOR WITH 44" DECK

REF. NO.	PART NO.	COLOR CODE	DESCRIPTION	NEW PART	REF. NO.	PART NO.	COLOR CODE	DESCRIPTION	NEW PART
1	16181		Spring Hanger Bracket		41	16463		Lift Shaft Ass'y.	
2	16212		Deck Engagement Lever Ass'y.		42	16465		Lift Handle Brkt. Ass'y.	
3	710-0323		Truss Mach. Scr. 5/16-18 x .75" Lg.*		43	732-0498		Ext. Spring .56" I.D. x 32 Coils	
4	710-0258		Hex Bolt 1/4-20 x .62" Lg.*		44	712-0287		Hex Nut 1/4-20 Thd.*	
5	712-0267		Hex Nut 5/16-18 Thd.*		45	736-0329		L-Wash. 1/4" I.D.*	
6	714-0111		Cotter Pin 3/32" Dia. x 1.00" Lg.*		46	16223		Hitch Plate	
7	720-0143		Grip		47	710-0118		Hex Bolt 5/16-18 x .75" Lg.*	
8	732-0531		Ext. Spring .99" O.D. x 22" Lg.		48	710-0376		Hex Bolt 5/16-18 x 1.00" Lg. (Grade 5)	
9	736-0119		L-Wash. 5/16" I.D.*		49	710-0604		Hex Wash. TT-Tap Scr. 5/16-18 x .62" Lg.	
10	736-0272		FI-Wash. .510" I.D. x 1.0" O.D.		51	712-0267		Hex Nut 5/16-18 Thd.*	
11	747-0491		Drive Deck Control Rod		52	720-0157		Grip	
12	09735		Connecting Rod 3/16 x 1 x 12.5		53	16369		Link 1.0" x 7.5" x .19	
13	16178		Deck Lift Link Ass'y.		55	732-0307		Ext. Spring .99" Dia. x 11.00" Lg.	
14	16209		Deck Hanger Link Ass'y.—Rear L.H.		56	732-0412		Deck Lift—Down Stop	
15	16216		Deck Hanger Link Ass'y.		58	748-0176		Flange Brg. .630" I.D.	
16	710-0118		Hex Bolt 5/16-18 x .75" Lg.*		59	736-0119		L-Wash. 5/16" I.D.*	
17	16345		Deck Hanger Link Ass'y.—Front R.H.		60	736-0231		FI-Wash. .344" I.D. x 1.125" O.D. x .125	
18	714-0101		Inter. Cotter Pin 1/2" Dia.		61	736-0264		FI-Wash. .344" I.D. x .62" O.D. x .063	
19	736-0160		FI-Wash. .531 I.D. x .93" O.D.		62	736-0231		FI-Wash. .344" I.D. x 1.125" O.D.	
20	16063		Adj. Link Deck Lifting		63	738-0140		Shld. Bolt .437" Dia. x .180	
21	16342		Adj. Lower Link Ass'y.		64	738-0526		Running Board Rod	
22	712-0241		Hex Jam Nut 3/8-24 Thd.		65	741-0313		Flange Brg. .632" I.D.	
23	736-0169		L-Wash. 3/8" I.D.*		66	16315		Hitch Bar	
25	16214		Diagonal Brace		68	16238		Gas Tank Housing—Main Panel	
26	16234		Stabilizer Shaft Ass'y.		69	16239		Side Panel—L.H.—Gas Tank	
27	711-0777		Stabilizer Rod		70	16240		Side Panel—R.H.—Gas Tank	
28	712-0798		Hex Nut 3/8-16 Thd.*		71	710-0351		Truss Mach. B-Tapp Scr. #10 x .50" Lg.	
29	714-0111		Cotter Pin 3/32" Dia. x 1.0" Lg.		72	726-0207		Hose Clamp—.406" Dia.	
30	714-0470		Cotter Pin 1/8" Dia. x 1.25" Lg.*		73	731-0511		Trim Strip—5" Lg.	
31	736-0117		FI-Wash. .385" I.D. x .620" O.D.		74	751-0173		Gas Line—44" Lg.	
32	736-0156		FI-Wash. .635" I.D. x 1.12" O.D.		75	751-0226		Gas Tank Cap	
33	736-0169		L-Wash. 3/8" I.D.*		76	751-0403		Gas Tank	
34	738-0258		Shoulder Bolt 3/8-16		77	726-0175		Hose Clamp	
36	08540		Knob—Height Adj.		78	714-0507		Cotter Pin 3/32" Dia. x .75" Lg.*	
37	09721		Pivot Link Ass'y.		79	710-0599		Hex Wash. Hd. Tap Scr. 1/4 x .50" Lg.	
38	14602		Side Panel Upper Frame—R.H.		80	710-0959		Hex Bolt 5/16-18 x 1.50" Lg.*	
39	14603		Side Panel Upper Frame—L.H.		81	736-0159		FI-Wash. .344" I.D. x .875" O.D.	
40	16462		Index Brkt. (Deck Lift)	N	82	712-0247		Speed Nut for .500" Dia. Stud	
					83	722-0157		Foam Strip 3/8" x 1-1/8" x 1 1/2" Lg. (2 Req'd.)	

Models 666 and 686

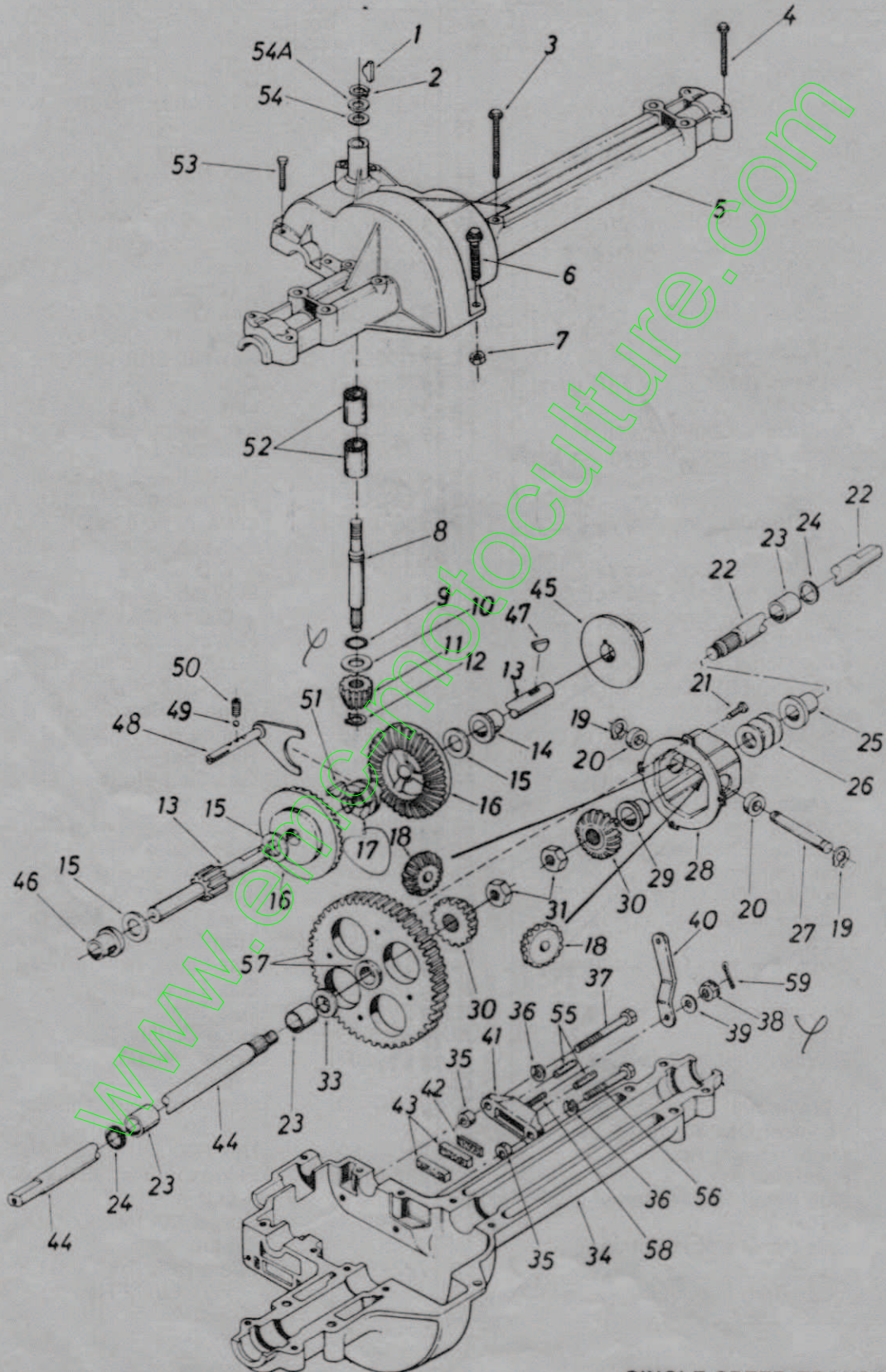

SINGLE SPEED TRANSAXLE—R.H.
MODEL 717-1050

Models 666 and 686

PARTS LIST FOR SINGLE SPEED TRANSAXLE RIGHT HAND 717-1050

REF. NO.	PART NO.	DESCRIPTION	NEW PART	REF. NO.	PART NO.	DESCRIPTION	NEW PART
1	714-0129	#4 Hi-Pro Key 3/32 x 5/8" Dia.		33	736-0351	FI-Wash. .75" I.D. x 1.5" O.D.	
2	716-0115	Snap Ring .625" Shaft		34	717-0761	Lower Housing	
3	710-0854	Hex Bolt 1/4-20 x 1.75" Lg.*		35	750-0555	Spacer .53" O.D. x 3/8" Lg.	
4	710-0809	Hex Bolt 1/4-20 x 1.25" Lg.*		36	736-0329	L-Wash. 1/4" I.D.*	
5	717-0764	Upper Housing		37	710-0886	Hex Bolt 1/4-20 x 1.50" Lg. (Grade 5)	
6	710-0642	Hex FI-Bolt 1/4-20 x .75" Lg.*		38	712-0335	Castle Nut 5/16-24 Thd.*	
7	712-0287	Hex Nut 1/4-20 Thd.*		39	736-0371	FI-Wash. .34" I.D. x .875" O.D.	
8	717-0634	Input Shaft		40	717-0700	Actuating Arm—R.H.	
9	721-0178	Square Seal 5/8" I.D.		41	717-0679	Brake Yoke	
10	736-0335	Thrust Washer 5/8" I.D. x 1.25" O.D.		42	717-0682	Puck Plate	
11	717-0633	Pinion Input 14T		43	717-0678	Brake Puck	
12	716-0108	Retaining Ring 7/16" Ext.		44	717-1011	Axle L.H.	
13	717-0758	Drive Shaft—R.H.		45	717-0677	Brake Disc	
14	717-0336	Flange Brg. 5/8" I.D. x 3/4" Lg.*		46	741-0337	Flange Bearing 5/8" I.D. x 15/16" Lg.	
15	**	FI-Wash. (See Below)		47	714-0161	Woodruff Key 3/16 x 5/8 HT	
16	717-0757	Bevel Gear 42T		48	717-0754	Shift Fork Ass'y.	
17	717-0667	Clutch Collar		49	741-0862	Ball Detent .250" Dia.	
18	717-1020	Miter Gear 15T		50	732-0863	Spring Detent	
19	716-0142	Snap Ring		51	714-0169	#9 Hi-Pro Key 3/16" x 3/4" Dia. HT	
20	717-0690	Thrust Bearing 1/2" I.D. x 1.0" O.D.		52	741-0335	Needle Brg. 5/8" I.D. x 1/2" Lg.	
21	710-0862	Pan Head Scr. 1/4-20 x .50" Lg. w/Patch		53	710-0855	Hex Bolt 1/4-20 x 1.00" Lg.	
22	717-1012	Axle R.H.		54	736-0336	FI-Wash. 5/8" I.D. x .030	
23	741-0340	Sleeve Bearing 3/4" I.D. x 1.0" Lg.		54A	736-0337	FI-Wash. 5/8" I.D. x .040	
24	721-0179	Oil Seal 3/4" I.D.		54B	736-0349	FI-Wash. 5/8" I.D. x .020	
25	741-0339	Flange Bearing 3/4" I.D. x 15/16" Lg.		55	741-0343	Actuating Pin 5/16" Dia.	
26	736-0188	FI-Wash. .760" I.D. x 1.49" O.D.		56	710-0886	Hex Bolt 1/4-20 x 1.50" Lg. (Grade 5)	
27	717-0673	Cross Shaft		57	717-1059	Differential Gear 72T Ass'y. w/Bearing	
28	717-0777	Differential Housing Ass'y. Comes with Ref. 28		58	717-0796	Sq. Hd. Bolt 5/16-24 Thd.	
29	—			59	1544-013	Cotter Pin 3/32" Dia. x .50" Lg.	
30	717-1019	Miter Gear—H.D.		—	737-0148	Grease—Shell (10 oz.)	
31	712-0200	Hex Ins. L-Nut 1/2-20 Thd.					

*Ref. No. 15 736-0349 FI-Wash. 5/8" I.D. x 1.0" O.D. x .020 Thk.
 736-0336 FI-Wash. 5/8" I.D. x 1.0" O.D. x .030 Thk.
 736-0337 FI-Wash. 5/8" I.D. x 1.0" O.D. x .040 Thk.

OWNER'S GUIDE

OUTDOOR POWER EQUIPMENT
for all seasons

Spring

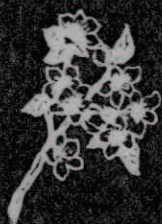

Summer

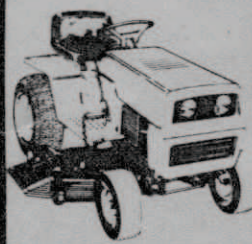

Fall

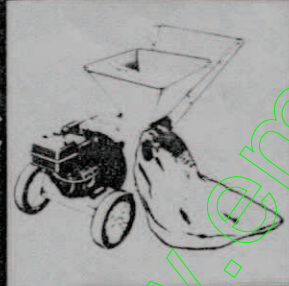

Winter

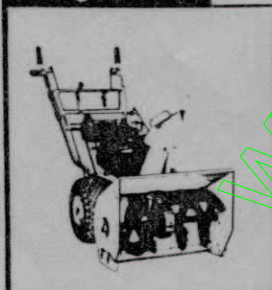

44" SIDE DISCHARGE MOWING DECK

for
Models 700 Thru 705
and 710 Thru 715
Lawn Tractors

Model Number
196-803-000

Important:
Read Safety Rules and
Instructions Carefully

Thank you for purchasing
an American-built product.

Model 803 Deck

44" Side Discharge Mowing Deck Models 700 Thru 705, 710 Thru 715 Series Lawn Tractors



IMPORTANT

Belts listed by Part Number are of special construction and should be used when replacement is necessary. The dimensions and description given are for general reference only and belts purchased by description and dimension generally will only provide a temporary service.



NOTE

Specifications subject to change without notice or obligation.

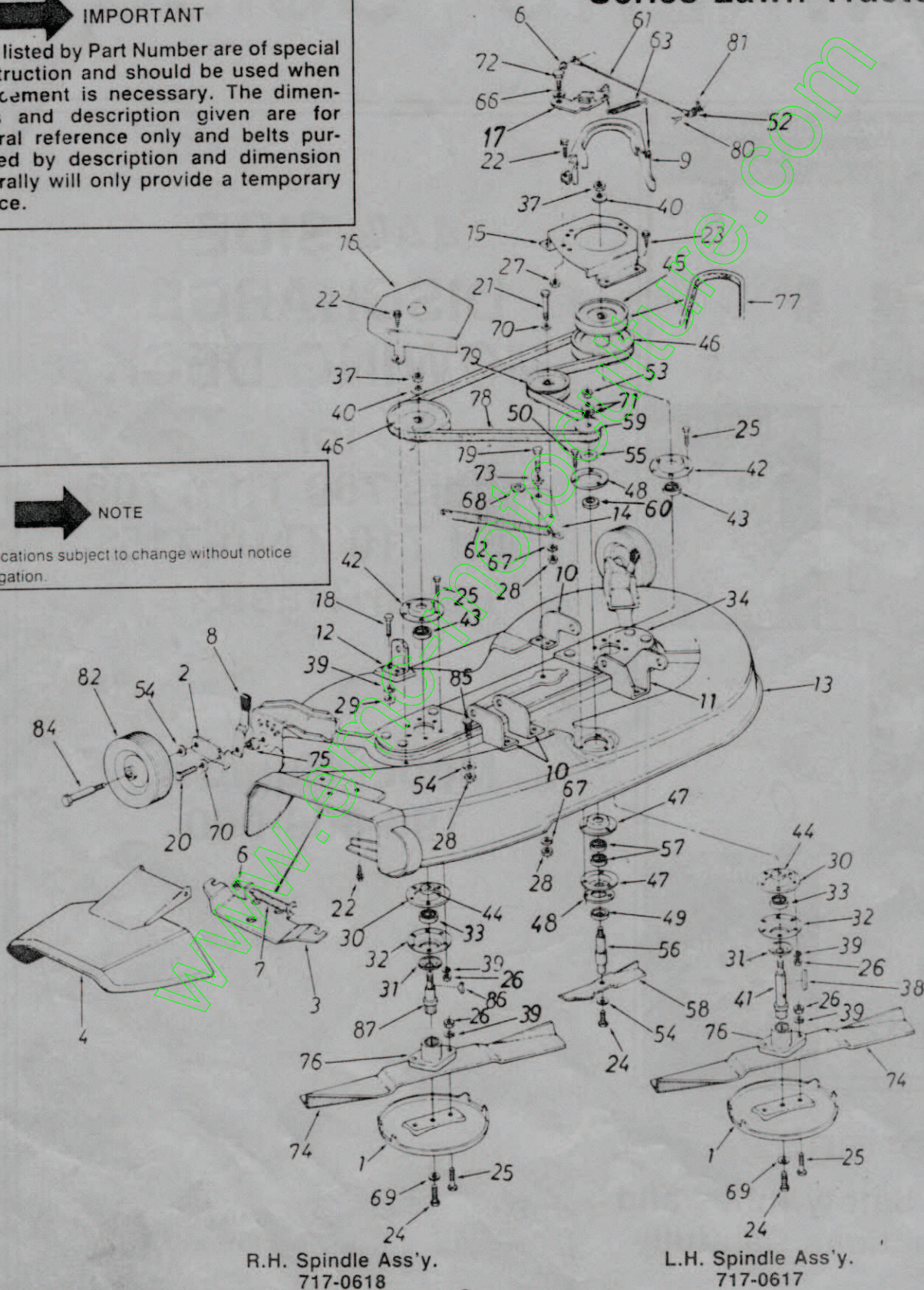

Model 803 Deck

PARTS LIST FOR 44" SIDE DISCHARGE MOWING DECK

REF. NO.	PART NO.	COLOR CODE	DESCRIPTION	NEW PART	REF. NO.	PART NO.	COLOR CODE	DESCRIPTION	NEW PART
1	07919		Anti-Scalp Plate		47	15319		Bearing Housing 1-3/8" I.D.	
2	10937		Bar-Wheel Pivot		48	16348		Reinforcement Plate	
3	11396		Adapter Plate		49	16400		Bearing Shield	
4	11574		Chute Cover Ass'y.		50	710-0947		Hex Wash. Hd. B-Tap Scr. 1/4 x .75" Lg.	
5	711-0571		Hinge Pin					FI-Wash. .20" I.D. x .62" O.D.	
6	726-0106		Cap Speed Nut 1/4" Rod		52	736-0463		Hex Jam Nut 1/2-20 Thd.*	
7	732-0261		Torsion Spring		53	712-0922		Bell-Wash. .400" I.D. x .88" O.D.	
8	14082		Spring Lever Ass'y.		54	736-0105		FI-Wash. .635" I.D. x 1.04" O.D.	
9	14258		Belt Guard		55	736-0162		6.5" Blade Spindle	
10	16175		Deck Hanger Bracket		56	738-0627		Ball Brg. .62" I.D. x 1.38" O.D. x .44	
11	16176		Butterfly-Bracket		57	741-0155		6.5" Blade	
12	16180		Deck Hanger Bracket		58	742-0252		1/2" "V"-Pulley Half .625" I.D. x 2.25" O.D.	
	16231		44" Deck Ass'y.		59	756-0468		FI-Wash. 5/8" I.D. x 15/16" O.D.	
	16331		Idler Bracket		60	736-0302		Brake Cable 11.75" Lg.	
15	16333		Pulley Cover—L.H.		61	727-0290		Extension Spring .73" O.D. x 4.31" Lg.	
	16334		Pulley Cover—R.H.		62	732-0121		Ext. Spring .50" x 2.51" Lg.	
17	16337		Spindle Brake Arm Ass'y.		63	732-0395		Spring Wash. .445" I.D. x .75" O.D.	
18	710-0118		Hex Bolt 5/16-18 x .75" Lg.*		64	736-0141		L-Wash. 3/8" I.D.*	
19	710-0152		Hex Bolt 3/8-24 x 1.00" Lg.*		65	736-0169		Spring Wash. .625" I.D. x .885" O.D.	
20	710-0191		Hex Bolt 3/8-24 x 1.25" Lg.*		66	736-0174		L-Wash. 3/8" I.D. (Heavy Duty)	
21	710-0459		Hex Bolt 3/8-24 x 1.50" Lg.*		67	736-0219		Bell-Wash. .400" I.D. x 1.13" O.D.	
22	710-0599		Hex Wash. S-Tapp Scr. 1/4-20 x .50		68	736-0253		Bell-Wash. .505" I.D. x 1.00" O.D.	
23	710-0726		Hex Wash. Hd. Tapp Scr. 5/16-18 x .75" Lg.		69	736-0217		Shld. Bolt .437" Dia. x .180	
24	710-0877		Hex Cent. L-Bolt 3/8-24 x .88" Lg.		70	736-0219		Shld. Spacer .625" I.D.	
25	710-0888		Hex Bolt Special 5/16-24 x 1.0" Lg.		71	736-0253		21" Blade	
26	712-0123		Hex Nut 5/16-24 Thd.*		72	738-0140		Shld. Spacer	
27	712-0158		Hex Cent. L-Nut 5/16-18 Thd.		73	738-0347		Blade Adapter	
28	712-0241		Hex Nut 3/8-24 Thd.*		74	742-0295		"V"-Belt 1/2" x 52.0" Lg.	
29	712-0267		Hex Nut 5/16-18 Thd.*		75	748-0279		"V"-Belt 1/2" x 74.0" Lg. (Drive Belt)	
30	09164		Reinforcement Plate		76	748-0300		FI-Idler w/Flanges 3.50" O.D.	
31	13703		Bearing Shield		77	754-0229		Clevis Pin 1/4" Dia. x .53" Lg.	
32	15296		Open Brg. Housing 1.85 I.D.		78	754-0293		Intern. Cotter Pin 5/16" Dia.	
	741-0919		Ball Brg. .787" I.D. x 1.85" O.D. x .551		79	756-0365		Deck Wheel 6.0" x 1.38	
34	16349		Spindle Mounting Plate Ass'y.		80	711-0701		Shld. Bolt 3/8-16 x 1.41	
37	712-0318		Hex Jam Nut 5/8-18 Thd.*		81	714-0104		Rib Neck Bolt (Service Only)	
38	714-0168		Sq. Key 3/16" x 2.25" Lg.		82	734-0974		Sq. Key 3/16" x 3/16" x .75" Lg.	
39	736-0119		L-Wash. 5/16" I.D.*		83	738-0455		44" Deck Blade Spindle	
40	736-0317		Bell-Wash. .630" I.D. x 1.25" O.D.		84	710-0617			
41	738-0632		44" Deck Blade Spindle		85	714-0122			
42	08253		Bearing Housing 1.85" I.D.		86				
43	741-0919		Ball Brg. .787" I.D. x 1.85" O.D. x .551		87	738-0633			
44	750-0456		Spacer 1.0" O.D. x .790" I.D.						
45	756-0329		5/8 "V"-Pulley .79" I.D. x 5.75" O.D.						
46	756-0470		"V"-Pulley .79" I.D. x 6.50" O.D.						

For faster service obtain standard nuts, bolts and washers locally.
If these items cannot be obtained locally, order by part number and
size as shown on parts list.