

Position	Numéro de pièce	#	Appellation I	Appellation II
1	710-04593	6	VIS 5/16-18:0.375:PANTRXI	FINISH:MTD SPEC-100016 TYPE 1
2	710-0726	2	VIS 5/16-12:0.750:HXINDWS	FINISH:MTD STD 701-01002
3	710-0751	6	VIS HEX.: 1/4-20:.620:GR5:STD	FINISH:SPEC-100015
4	712-04064	6	ECROU HEXAGONAL	FINISH:SPEC-100015 912-04064
5	725-0157	1	COLLIER DE SERRAGE3/16X0.5X7.4	MATERIAL:NYLON-SCHWARZ
6	731-05078C	1	CACHE TABLEAU DE BORD	FINISH:SCHWARZ LT-5
7	731-06757	1	OPTIQUE DE PHARE NOIR	FINISH:SCHWARZ
8	738-04091A	2	VIS EPAULEE	FINISH:SPEC-100016
9	783-05417	1	ÜTRIER DE CHARN.:j DR. CAPOT	FINISH:LACKIERT
10	783-05418	1	ÜTRIER DE CHARN.:j DR. CAPOT	FINISH:LACKIERT
11	783-05454	1	MTD NOIR	FINISH:LACKIERT MTD QUALITÄT
12	783-05684	1	PERLEISS	FINISH:LACKIERT MTD QUALITÄT
13	783-05685	1	CALANDRE VERTE VERTS LOISIRS	FINISH:LACKIERT MTD QUALITÄT

www.emc-motoculture.com

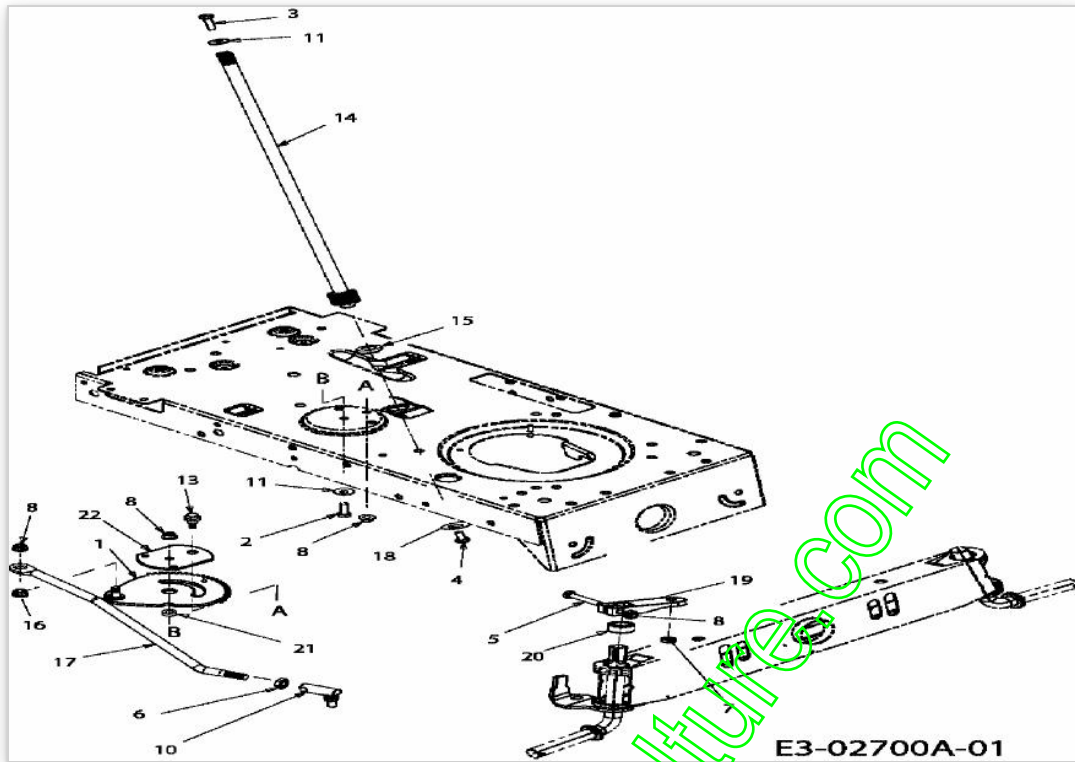

www.emc-motoculture.com

Position	Numéro de pièce	#	Appellation I	Appellation II
1	617-04024	1	SEGMENT DE DIRECTION CPL	FINISH:PHOS & OIL
2	710-0376	1	VIS HEX.:5/16- 18:1.00:GR5:STD	FINISH:MTD SPEC 701-01006
3	710-0643	1	VIS HEX.: 5/16-18:1.00:GR5	FINISH:MTD SPEC-100015
4	710-1309	1	VIS	FINISH:MTD SPEC-100015
5	710-3180	1	VIS HEX. 5/16- 18:1.75:GR5:STD	FINISH:SPEC-100015
6	712-0240	1	ECROU HEX.: 7/16-20:GR2	FINISH:MTD SPEC-100015
7	712-0262	1	ECROU	FINISH:MTD SPEC-100015
8	712-04063	4	ECROU HEX. AVEC FLANC	FINISH:MTD SPEC-100015
10	723-0448A	1	ROTULE DE DIRECTION 7/16-20	FINISH:MTD SPEC-100015
11	736-0242	1	RONDELLE CONIQUE.340X.872X.060	FINISH:MTD SPEC-100016
13	738-04141	1	AXE	FINISH:SPEC-100015
14	738-0919	1	ARBRE DE DIRECTION 21,57 LG	FINISH:SIEHE ZG.
15	741-04124	1	PALIER DE BRIDE	FINISH:PLAIN
16	741-0475	1	DOUILLE PLASTIQUE.385 ID	NATUR ODER SCHWARZ 941-0475
17	747-04298	1	TRINGLE DE DIRECTION	FINISH:701-01007
18	748-0389	1	BAGUE	FINISH:GEÖLT
19	748-04065	1	PATTE DE DIRECTION	FINISH:748-04065ZW
20	748-04068	1	DOUILLE.71IDX.125 ODX.56 LG	FINISH:SPEC-100015
21	750-04418	1	DOUILLE .322ID.625ODX.21LG	FINISH:GEÖLT
22	783-04644	1	PLAQUE	FINISH:PHOS & OIL OR 701-01000

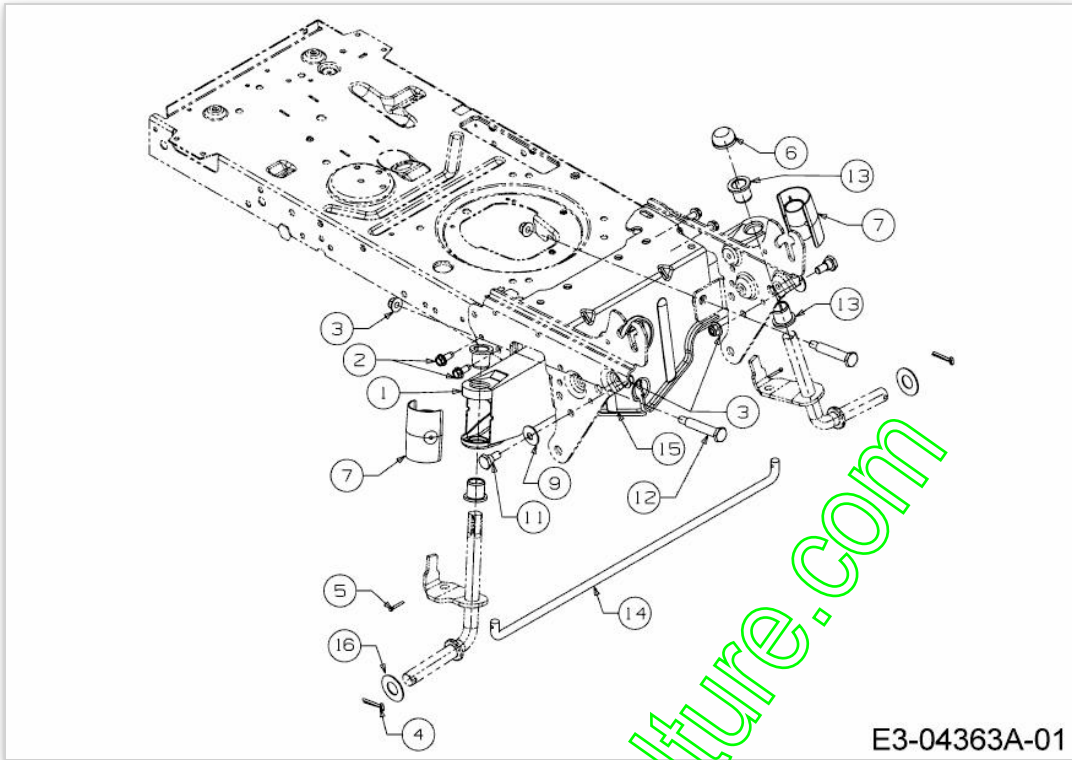

E3-04363A-01

www.emc-motoculture.com

Position	Numéro de pièce	#	Appellation I	Appellation II
1	683-0128B637	1	ESSIEU AVANT	SCHWARZ GEPULVERT
2	710-1260A	4	VIS TT:5/16-18:.750	FINISH:SPEC-100016 TYPE 1
3	712-04065	4	ECROU HEXAGONAL	FINISH:SPEC-100015 912-04065
4	714-04039	2	EPINGLE	FINISH:PHOS & OIL
5	714-0474	2	GOUPILLE	FINISH:MTD SPEC-100015
6	726-0341	1	CAPUCHON CLIPS	FINISH:SCHWARZ
7	731-1291A	2	CARTER PLASTIQUE	MATERIAL:PP SCHWARZ:LT5
8	736-0316	2	RONDELLE 1.78XA1.59"	FINISH:MTD SPEC-100015
9	736-0331	2	RONDELLE CONIQUE	FINISH:MTD SPEC-100016
11	738-0143	2	VIS EPAULEE	FINISH:MTD SPEC 100015 (EU)
12	738-04128	2	VIS A EPAULE .500x2.38:3/8-16	FINISH:MTD SPEC-100015
13	741-0660A	4	BAGUE ESSIEU DE ROUE	FINISH:KUNSTSTOFF SCHWARZ
14	747-04299A	1	TRINGLE DE DIRECTION	FINISH:SPEC-100015 or E-Coat
15	783-05326637	1	PLAQUE SUPPORT AVANT	783-05326-0637
16	736-0316	2	RONDELLE 1.78XA1.59"	FINISH:MTD SPEC-100015

www.emc-motoculture.com

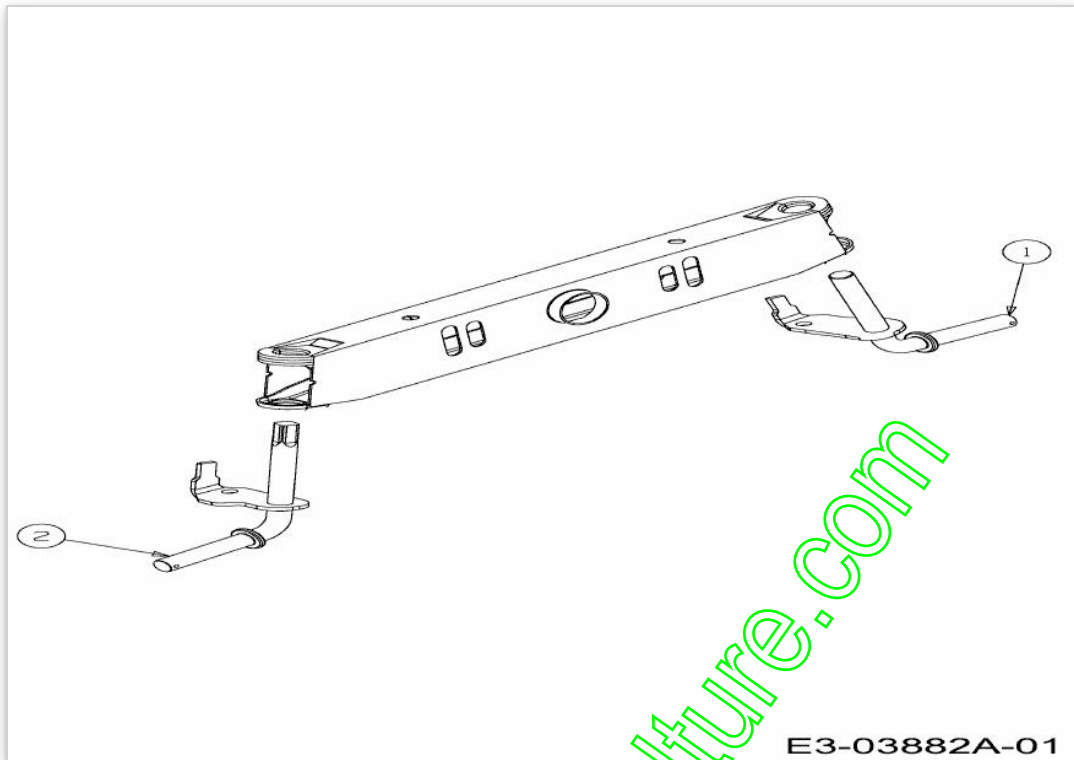

www.emc-motoculture.com

Position	Numéro de pièce	#	Appellation I	Appellation II
1	638-04016637	1	FUSEE GAUCHE	SCHWARZ
2	638-04017637	1	FUSEE DROITE	SCHWARZ

www.emc-motoculture.com

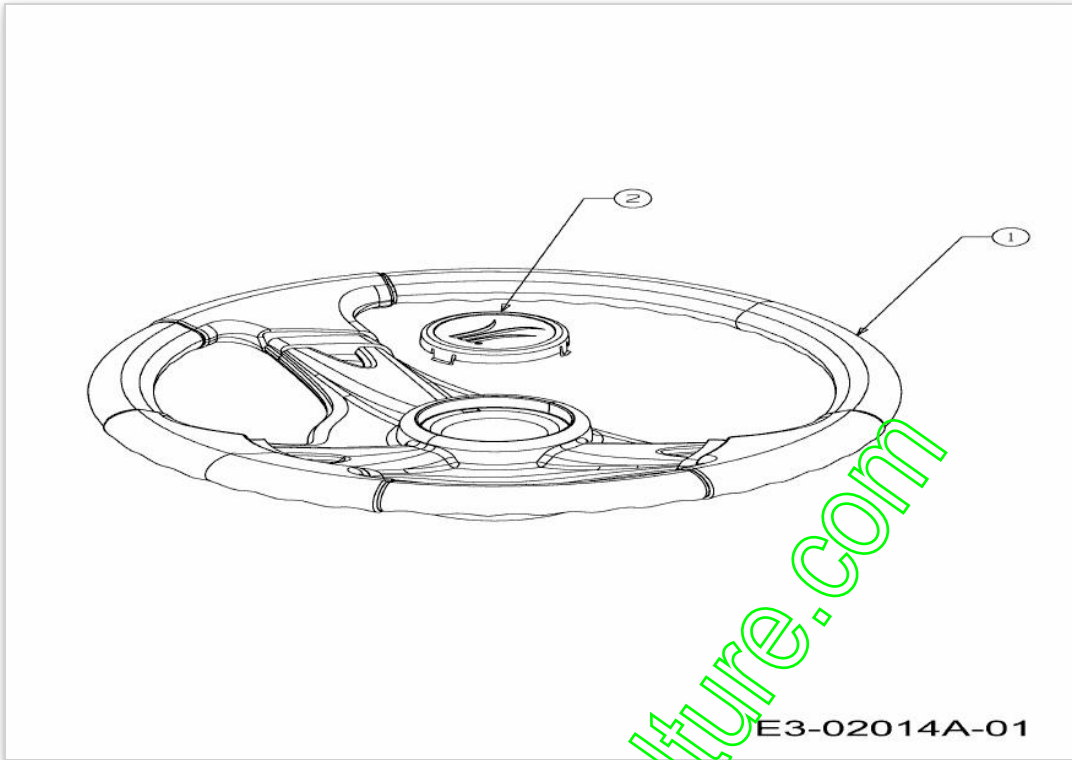

E3-02014A-01

www.emc-motoculture.com

Position	Numéro de lapièce	#	Appellation I	Appellation II
1	631-04028	1	VOLANT	FINISH SCHWARZ
2	731-04040	1	COUVERCLE DE VOLANT	Ò 60mm:KUNSTSTOFF SCHWARZ

www.emc-motoculture.com

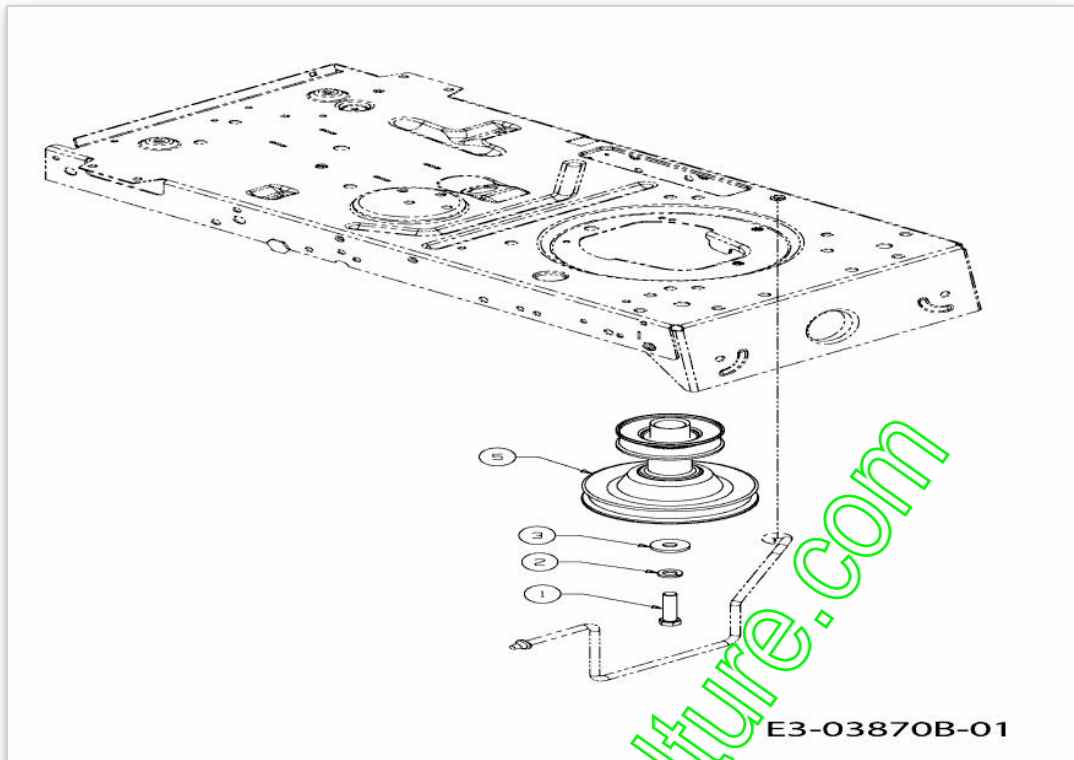

www.emc-motoculture.com

Position	Numéro de lapièce	#	Appellation I	Appellation II
1	710-1002	1	VIS	FINISH:SPEC-100015
2	736-0171	1	RONDELLE GROWER	FINISH:MTD SPEC-100016
3	736-0322	1	RONDELLE .450 X 1.250 X .164	FINISH:SPEC-100016 936-0322
5	756-04330A	1	POULIE MOTEUR	TRANSMATIK:FINISH SPEC-100015

www.emc-motoculture.com

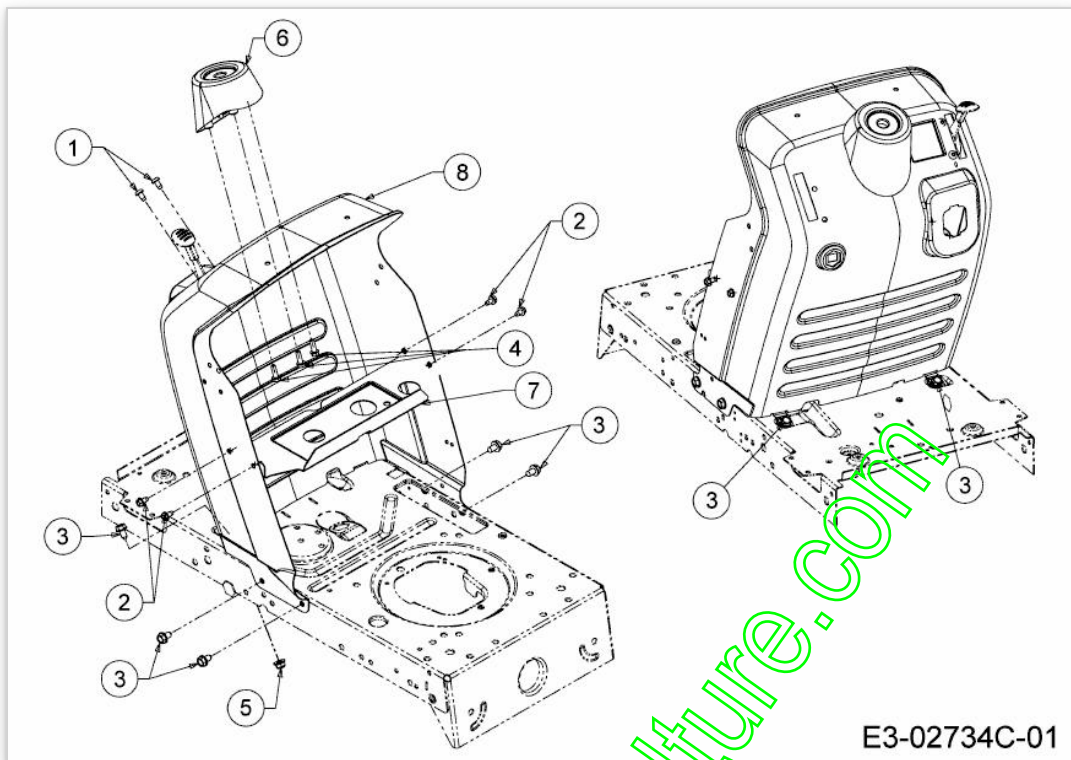

E3-02734C-01

www.emc-motoculture.com

Position	Numéro de lapièce	#	Appellation I	Appellation II
1	710-04483	2	VIS:TT:1/4- 20:500:TRUSTRXI	FINISH:GELB SPEC-701-01002
2	710-0599	4	VIS A SIX PANS CREUX	FINISH:MTD SPEC-101617
3	710-0604A	6	VIS 5/16-18:0.625	FINISH:MTD SPEC-100016 TYPE 1
4	710-0895	3	VIS A SIX PANS CREUX	FINISH:MTD SPEC-100016 TYPE 1
5	712-04063	1	ECROU HEX. AVEC FLANC	FINISH:MTD SPEC-100015
6	731-04945	1	SUPPORT VOLANT	FINISH:SIEHE ZG.
7	783-04584	1	SUPPORT	
8	783-04873	1	TABLEAU DE BORD	FINISH:LACKIERT

www.emc-motoculture.com

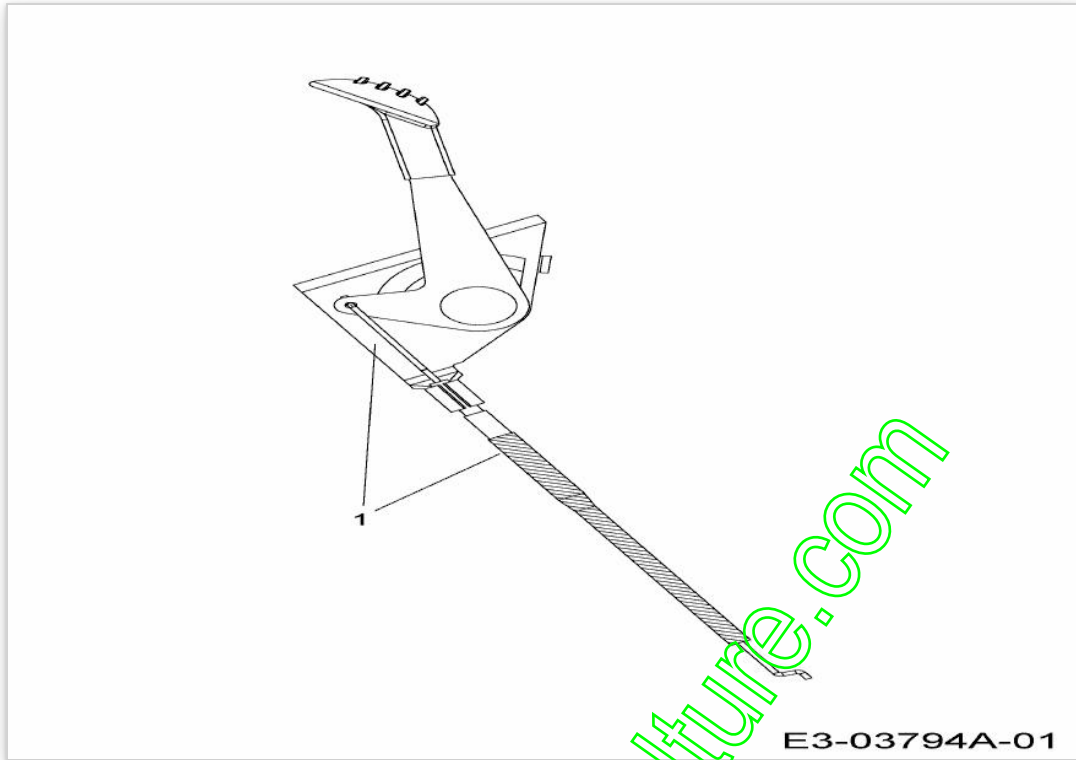

www.emc-motoculture.com

Position	Numéro de lapièce	#	Appellation I	Appellation II
1	746-04406	1	CABLE ACCELERATEUR	FINISH:

www.emc-motoculture.com

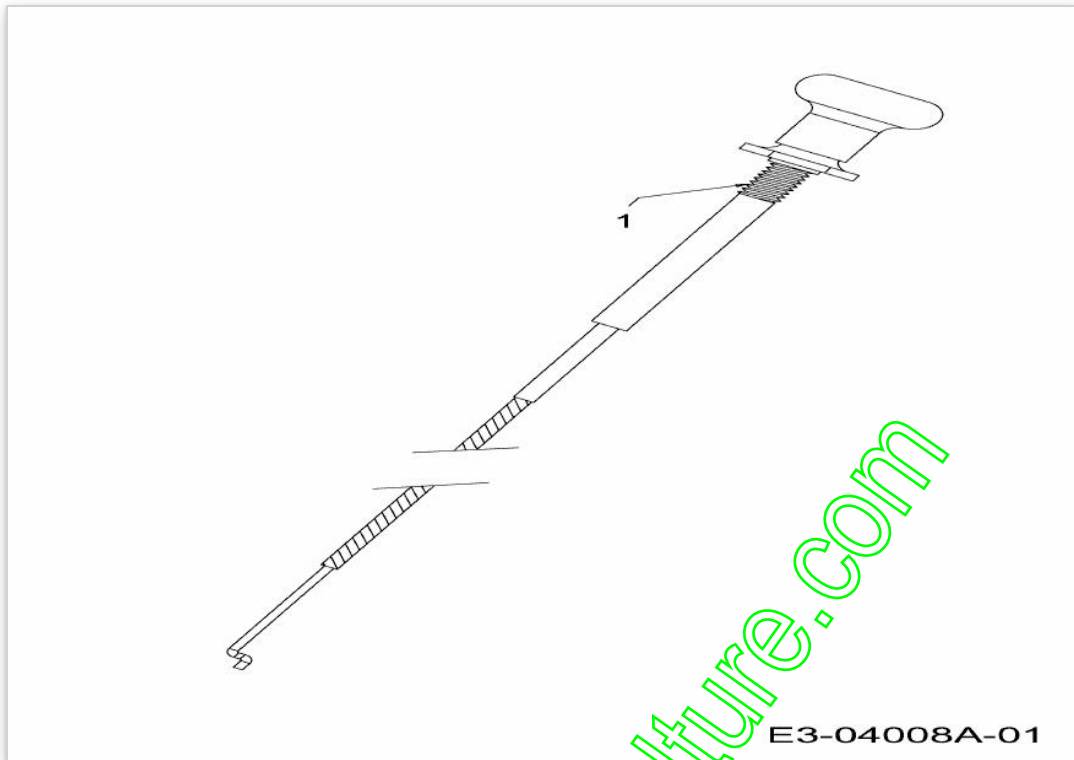

E3-04008A-01

www.emc-motoculture.com

Position	Numéro de lapièce	#	Appellation I	Appellation II
1	746-1089	1	CABLE STARTER	29.0" LG x 1.50 EXT

www.emc-motoculture.com

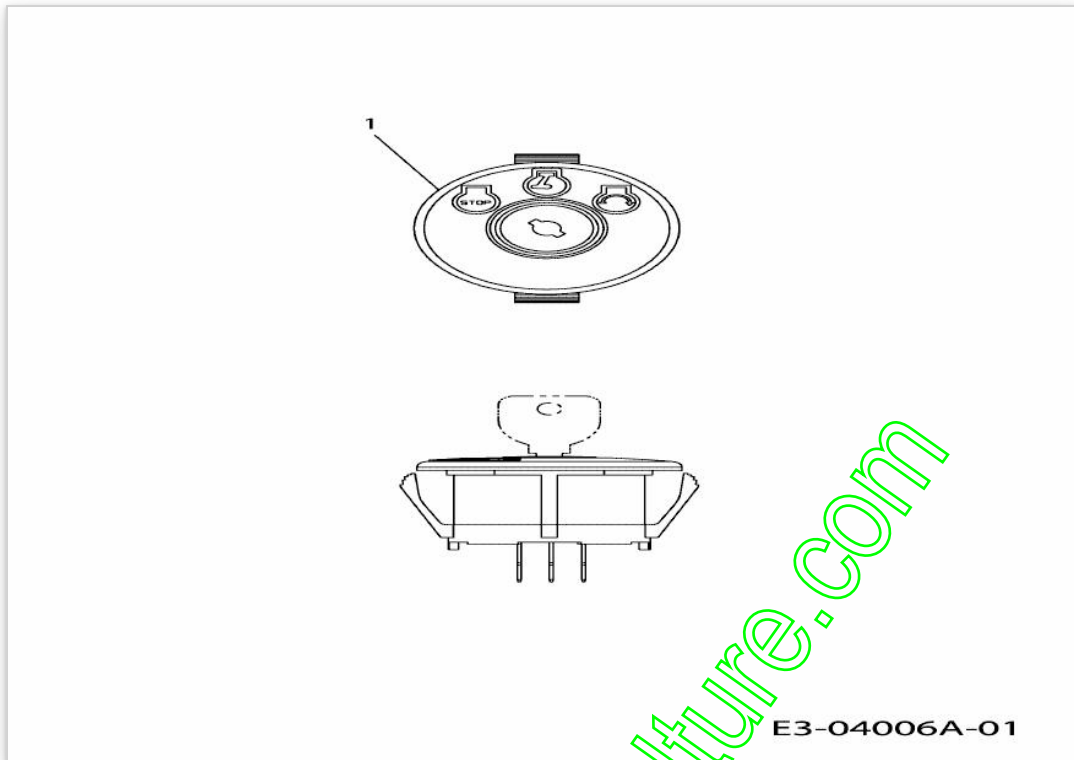

www.emc-motoculture.com

Position	Numéro de pièce	#	Appellation I	Appellation II
1	725-04659	1	CONTACTEUR A CLEF	FINISH:

www.emc-motoculture.com

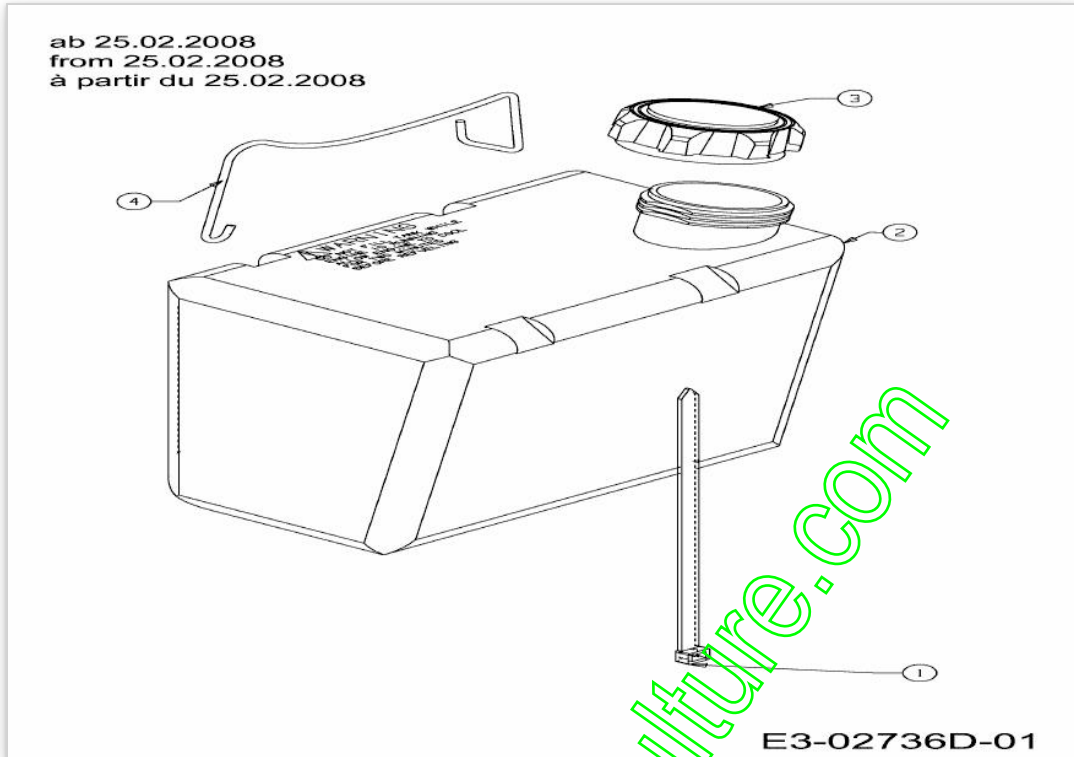

Position	Numéro de lapièce	#	Appellation I	Appellation II
1	726-0209	1	COLLIER	FINISH: SCHWARZ
2	751-0553	1	RESERVOIR 5 L ENV.	FINISH: NATUR SIEHE ZG.
3	751-0603	1	BOUCHON RESERVOIR ESSENCE	FINISH: SCHWARZ
4	747-04744A	1	NIEDERHALTER: BATTERIE: LT-5	FINISH: PLAIN

www.emc-motoculture.com

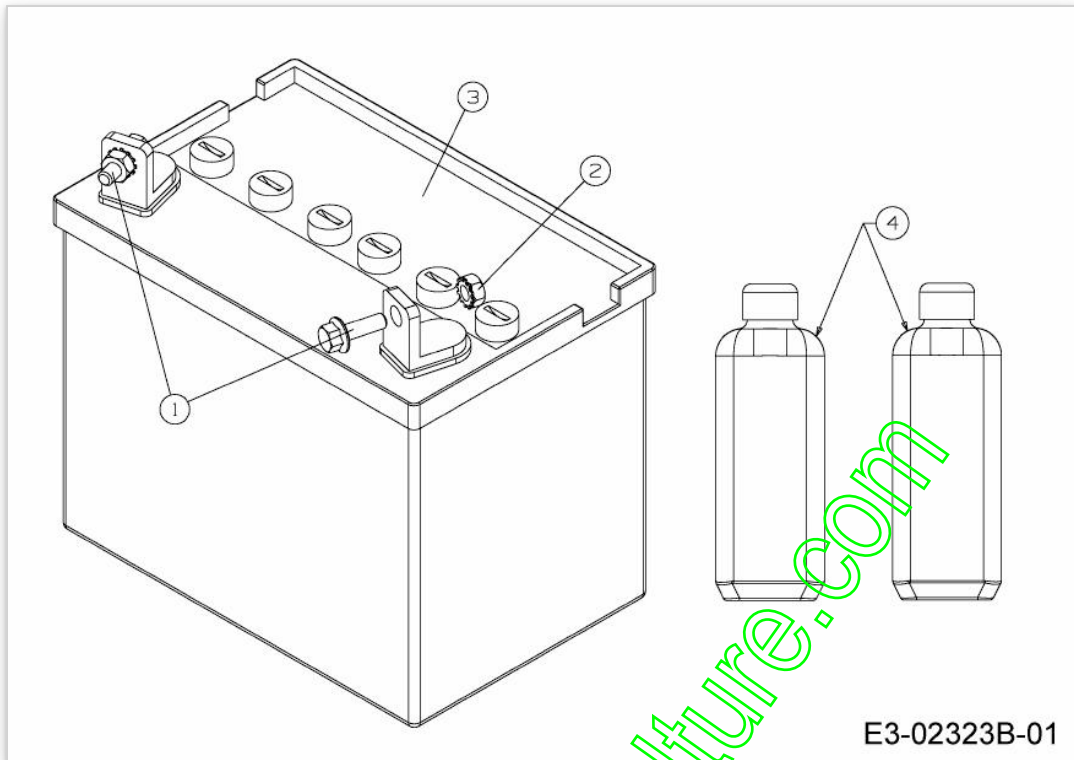

E3-02323B-01

Position	Numéro de lapièce	#	Appellation I	Appellation II
1	710-04666	2	VIS HEXAGONALE	FINISH:MTD SPEC-100015
2	712-0271	2	ECROU 1/4-20"+ DISQUE DENTE	FINISH:MTD SPEC-100016 GR5
3	725-1751	1	BATTERIE SECHE 220CCA	12V 16Ah
4	725-2064	2	BIDON ACIDE 1 LITRE	725-2064

www.emc-motoculture.com

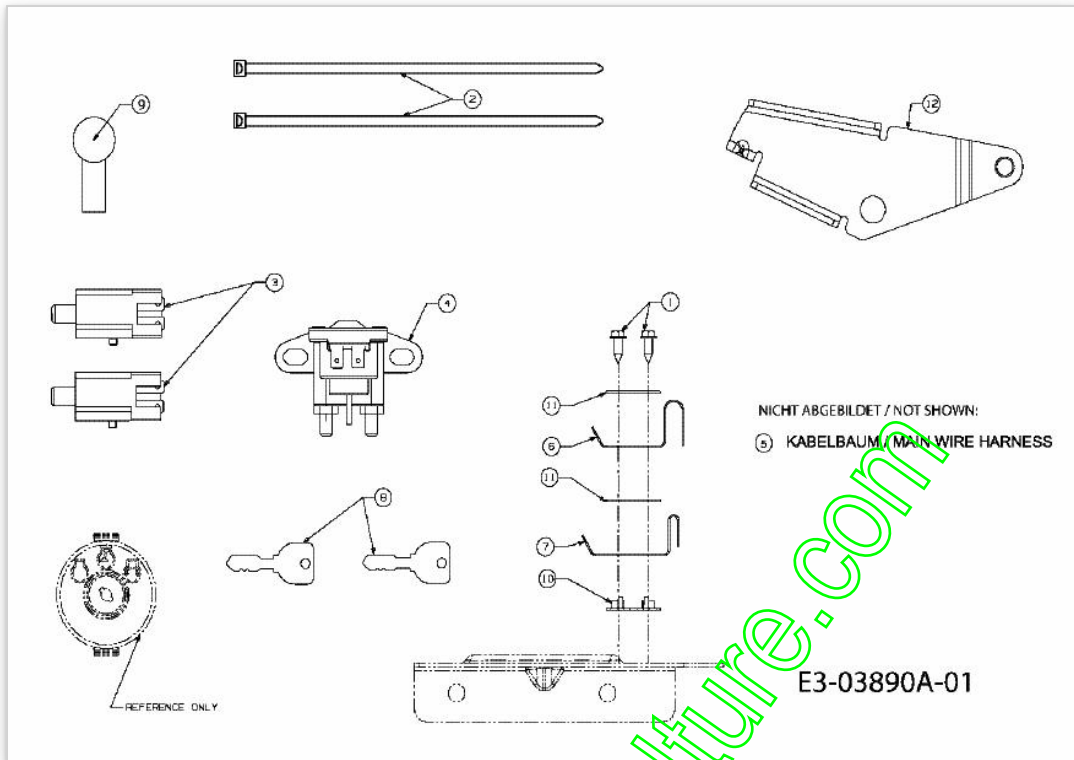

Position	Numéro de pièce	#	Appellation I	Appellation II
1	710-0227	2	VIS	FINISH:MTD SPEC-100016 TYPE 1
2	725-0157	2	COLLIER DE SERRAGE3/16X0.5X7.4	MATERIAL:NYLON-SCHWARZ
3	725-04363	2	SECURITE EMBRAYAGE	FINISH:SIEHE ZG.
4	725-04439	1	COMMUTATEUR MAGNÛTIQUE	12V:100 AMP
5	725-04647	1	725-05503	GRASFANGSACK HECKSEITIG
6	725-1303	1	RESSORT DE SURETE SIËGE	SI.-SCHALTER SITZ:SPEC-100015
7	725-1439	1	RESSORT SURETE DE SIEGE	SI.-SCHALTER SITZ:SPEC-100015
8	725-1744	2	CLÛ DE CONTACT:DELTA	725-1744
9	725-3237	1	COUVERCLE POLE / ROUGE	BATTERIE FINISH:ROT
10	726-0278	1	PLAQUE D'ISOLATION	FINISH:NATUR ODER SCHWARZ
11	726-0279	2	PLAQUE D'ISOLATION	FINISH:NATUR ODER SCHWARZ
12	783-04903	1	HALTEBLECH:SPEED:NO RMC	

www.emc-motoculture.com

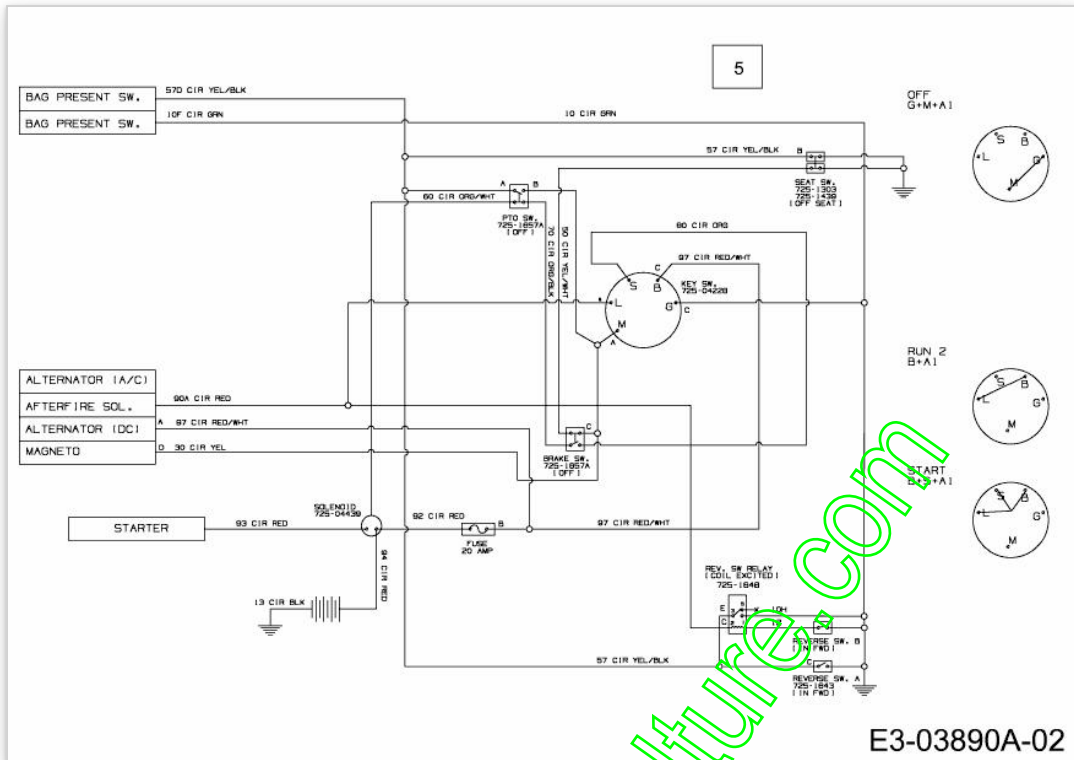

www.emc-motoculture.com

Position	Numéro de pièce	#	Appellation I	Appellation II
5	725-04647	1	725-05503	GRASFANGSACK HECKSEITIG

www.emc-motoculture.com

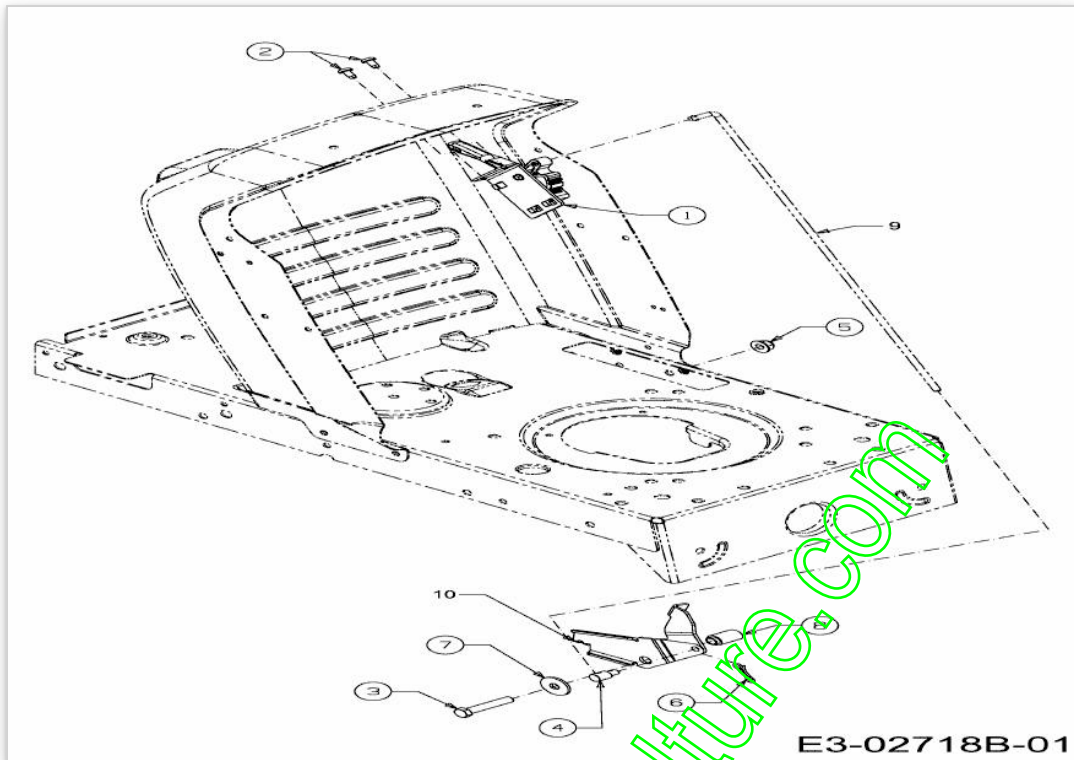

www.emc-motoculture.com

Position	Numéro de pièce	#	Appellation I	Appellation II
1	683-04225	1	SCHALTHEBEL VOLLST:6-SPEED:LT5	
2	710-04483	2	VIS:TT:1/4-20:.500:TRUSTRXI	FINISH:GELB SPEC-701-01002
3	710-3144	1	VIS HEX.: 3/8-16:2.00:GR5:STD	FINISH:SPEC-100015 910-3144
4	711-0736	1	AXE	FINISH:MTD SPEC-100015
5	712-04065	1	ECROU HEXAGONAL	FINISH:SPEC-100015 912-04065
6	714-04040	1	GOUPILLE	FINISH:ASTM F1941 FE/ZN 3AN
7	736-0133	1	RONDELLE .411X1.25X1.00	FINISH:MTD SPEC-100015
8	750-04465	1	ENTRETOISE	
9	747-04430	1	TRINGLE	FINISH:701-01000 OR 701-010007
10	783-04903	1	HALTEBLECH:SPEED:NO RMC	

www.emc-motoculture.com

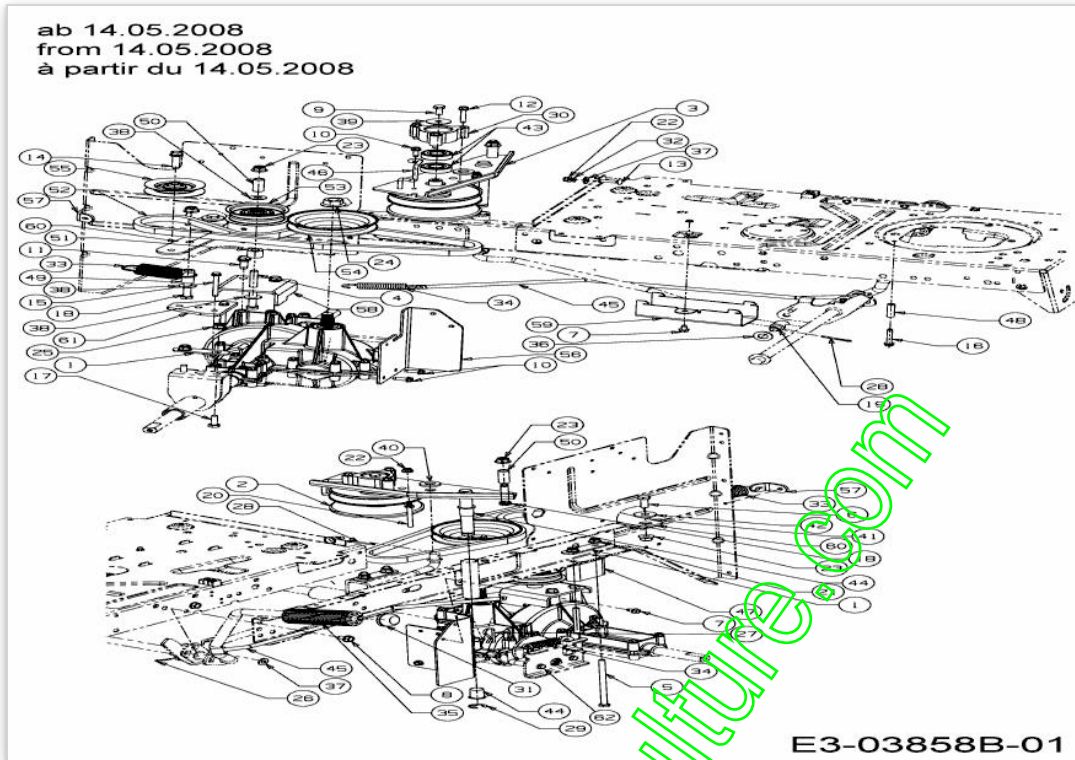

Position	Numéro de lapièce	#	Appellation I	Appellation II
1	17840-Z	2	SUPPORT	FINISH:MTD SPEC-100015
2	656-04015	1	POULIE DE VARIATEUR	4.75 OD
3	683-04429637	1	SUPPORT VARIATEUR	HECKAUSWURF: SCHWARZ LACKIERT
4	710-0411	1	VIS HHCS:3/8- 16:4.00:GR5:STD	FINISH:SPEC-100015
5	710-04469	2	VIS HEX. 5/16- 18X5.00:GR5:STD	FINISH:MTD SPEC-100015
6	710-0514	1	VIS HEX.:3/8- 16:1.00:GR5:STD	FINISH:MTD SPEC-100015
7	710-0599	3	VIS A SIX PANS CREUX	FINISH:MTD SPEC-101617
8	710-0604A	2	VIS 5/16-18:0.625	FINISH:MTD SPEC-100016 TYPE 1
9	710-0627	1	VIS HEX. 5/16-24:.750 GR5:LOCK	FINISH:MTD SPEC-100015
10	710-0642	3	VIS1/4-20:0.750	SPEC-100016 TYPE 1 910-0642
11	710-0654A	2	VIS A SIX PANS CREUX	FINISH:GEOMET XL
12	710-0778	3	VIS HEX. TT:1/4-20:1.500	FINISH:MTD SPEC-100016 TYPE 1
13	710-0932	1	VIS	FINISH:701-01000
14	710-1007	1	VIS HEX.TTSEMS3/8- 16:1,500	FINISH:STD SPEC-100016
15	710-1206	2	VIS HEX. TT:1/4-20:2.375	FINISH:MTD SPEC-100016 TYPE 1
16	710-1325	1	VIS HEXAGONALE	FINISH:SPEC-100016 TYPE 1
17	710-1682	2	VIS	FINISH:SPEC-100015 21.1441.72
18	710-3144	2	VIS HEX.: 3/8- 16:2.00:GR5:STD	FINISH:SPEC-100015 910-3144
19	711-04036	1	AXE	FINISH:SPEC-100015 911-04036
20	711-04826	1	GUIDE COURROIE	BLACK OXIDE ODER PHOS & OIL
21	712-04063	2	ECROU HEX. AVEC FLANC	FINISH:MTD SPEC-100015
22	712-04064	2	ECROU HEXAGONAL	FINISH:SPEC-100015 912-04064
23	712-04065	4	ECROU HEXAGONAL	FINISH:SPEC-100015 912-04065
24	712-0700	1	ECROU HEXAGONAL	SPEC-100015+WAX 912-0700
25	712-0714	2	ECROU	FINISH:MTD SPEC-100015
26	714-0111	1	GOUPILLE FENDUE 3/32:1.0"	FINISH:MTD SPEC-100015
27	714-0209	1	GOUPILLE FENDUE	FINISH:SPEC 701-01006 914-0209
28	714-0470	2	EPINGLE EX AF-43010	FINISH:SPEC-100015 470 32 32
29	716-0106A	1	CIRCLIPS	FINISH:PHOSPHATIERT
30	718-04261	1	CAGE DE ROULEMENT	FINISH:ROSTSCHUTZ SIEHE ZG.
31	726-0214	1	BOUCHON	FINISH: SCHWARZ
32	726-0233	1	RONDELLE	MECHANISCH KLAR VERZINKT
33	732-04505	1	RESSORT 1.00 DIA X 3.925 LG	FINISH:PHOS AND OIL

Position	Numéro de pièce	#	Appellation I	Appellation II
34	732-0716D	1	RESSORT	FINISH:MTD STD 701-01006
35	735-0239	1	CAOUTCHOUC/PEDALE 4;0 LG	FINISH:SCHWARZ
36	736-0272	1	RONDELLE .510x1.00X.060	SPEC 100015 oder SPEC-101616
37	736-0275	2	RONDELLE	FINISH:MTD SPEC-100015
38	736-0300	3	RONDELLE	FINISH:MTD SPEC-100015
39	736-0362	1	RONDELLE .320ID X 1.25 ODX .0	FINISH:SPEC-100016
40	736-3019	1	RONDELLE .531x1.062x.134:HT	FINISH:MTD SPEC-100016
42	738-0347	1	RONDELLE j EMB. .625IDx.169	FINISH:
43	741-0124	2	PALIER j BILLES	FINISH
44	741-0591	2	BAGUE	FINISH:NATUR 941-0591
45	747-04815B	1	TRINGLE DE FREIN	FINISH:SPEC-100015
46	747-04897	1	RIEMENFÜHRUNG:FWD:LT-5 RR-DIS	FINISH:LACKIERT
47	748-04175	1	SUPPORT ENTRETOISE	FINISH:GEÖLT
48	750-04456	1	ENTRETOISE	FINISH:MTD SPEC-100015
49	750-04584	1	DOUILLE .375IDx.625ODx 1.34 LG	FINISH:SPEC-100015
50	750-04962	2	ENTRETOISE	FINISH:GEÖLT
51	750-04988	1	ENTRETOISE	FINISH:ÖL GEDIPPT
52	754-04171	1	COURROIE DE PONT	POLY
53	756-04224	1	POULIE TENDEUR	BLK ECOAT,PAINT OR SPEC-100015
54	756-04298	1	POULIE DE PONT	PINS:FINISH:SIEHE ZG.656-04044
55	756-04241	1	POULIE TENDEUR	FINISH:GRAU LACKIERT
56	783-05705637	1	SUPPORT DE PONT	FINISH:LACKIERT
57	783-05844-Z	1	EQUERE	FINISH:SPEC-101642
58	783-05855637	1	SUPPORT	SCHWARZ
59	783-05882637	1	SUPPORT	FINISH:LACKIERT
60	783-06165	1	SUPPORT	LT-5:FINISH:SPEC-100015
61	783-1363	1	PLAQUE SUPPORT	FINISH:BLAU CHROMATIEREN *
62	710-1206	2	VIS HEX. TT:1/4-20:2.375	FINISH:MTD SPEC-100016 TYPE 1

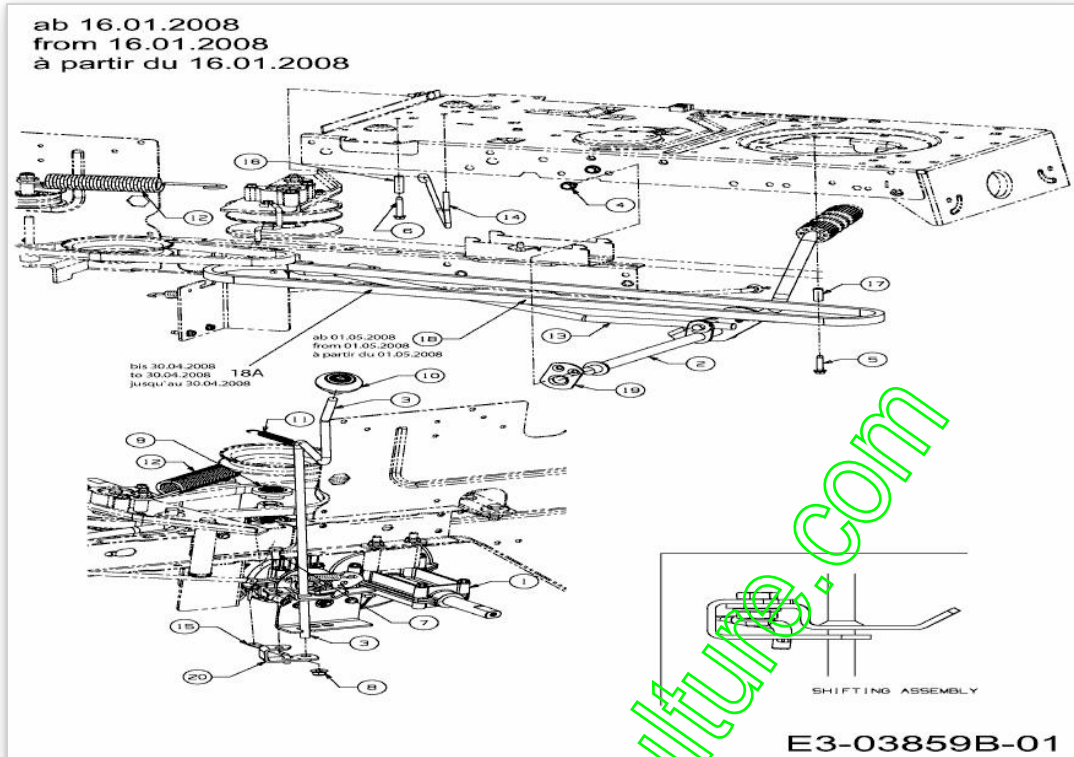

www.emc-motoculture.com

Position	Numéro de pièce	#	Appellation I	Appellation II
1	092.60.138	1	SERVICE KIT LT-5 BOÎTE	E-TEIL-SET
2	647-04132	1	PEDAL VST:TRANSM.:RD:LT-5	SCHWEISSTEIL:LACKIERT
3	647-04140-Z	1	LEVIER INVERSEUR	FINISH:VERZINKT MTD 701-01000
4	710-0604A	2	VIS 5/16-18:0.625	FINISH:MTD SPEC-100016 TYPE 1
5	710-0809	1	VIS HEX. TT:1/4- 20:1.250:HXIND	FINISH:MTD SPEC-100016 TYPE 1
6	710-1325	1	VIS HEXAGONALE	FINISH:SPEC-100016 TYPE 1
7	710-3008	1	VIS 5/16-18:.75:GR5:STD	SPEC-701-01006 or.SPEC-100015
8	712-04063	1	ECROU HEX. AVEC FLANC	FINISH:MTD SPEC-100015
9	718-04407	1	MOYEU: POULIE:5/8 DENTELURE	VERZÄHNUNG
10	720-04028	1	POIGNEE INVERSEUR	FINISH:SCHWARZ
11	732-04488	1	RESSORT DE TRACTION	FINISH:701-01006
12	732-04517	1	RESSORT	FINISH:PHOS AND OIL
13	747-04780	1	TRINGLE	LT-5 FINISH:MTD STD 100015
14	747-04803	1	TIGE	FINISH:LACKIERT
15	747-04850	1	TIGE	LT-5 HECKAUSWURF:701-01000
16	750-04456	1	ENTRETOISE	FINISH:MTD SPEC-100015
17	750-0566A	1	ENTRETOISE	FINISH:MTD SPEC-100015
18	754-04211	1	COURROIE MOTEUR VARIATEUR	POLY
18A	754-04170	1	COURROIE MOTEUR	POLY
19	783-04536B	1	STÜTZBLECH:PEDAL:LT-5	FINISH:LACKIERT MTD QUALITÄT
20	783-05853A	1	SUPPORT	FINISH:MTD STD SPEC-100015

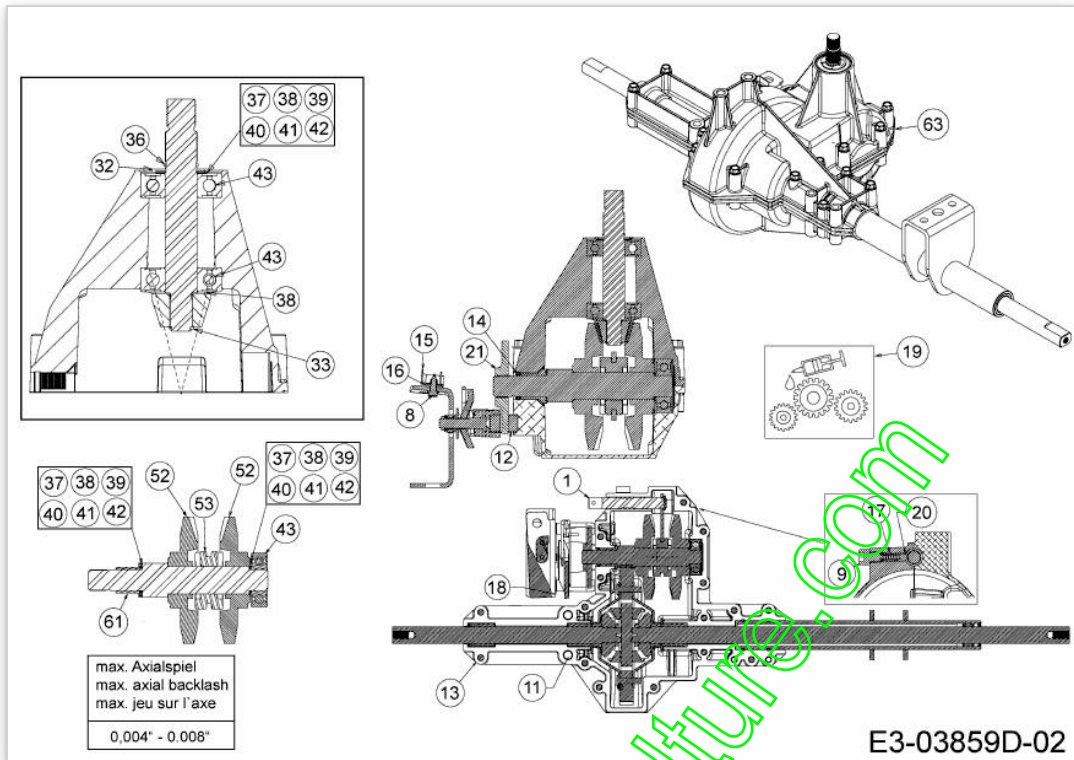

www.emc-motoculture.com

Position	Numéro de pièce	#	Appellation I	Appellation II
1	611-04096	1	FOURCHETTE	PRESSTEIL:FINISH:
8	710-0227	2	VIS	FINISH:MTD SPEC-100016 TYPE 1
9	710-04731	1	VIS	FINISH:MTD SPEC-100016
11	710-1325	17	VIS HEXAGONALE	FINISH:SPEC-100016 TYPE 1
12	717-0678	1	PLAQUETTE DE FREIN	FINISH:
13	719-04358	1	CARTER INFERIEUR	FINISH:WIE GEGOSSEN
14	721-0213	1	JOINT SPI .625x.812x.094	FINISH:
15	725-1644	1	INTERRUPTEUR DE SÛCURITÛ	FINISH:MTD SPEC-100015
16	726-0320	1	PLAQUE D'ISOLATION	FINISH:NATUR ODER SCHWARZ
17	732-04485A	1	RESSORT	FINISH:PHOS AND OIL SIEHE ZG.
18	736-0342	1	RONDELLE PLATE .283 x.75 x.030	FINISH:MTD STD 701-01000
19	6021-U1-1073	X	GRAISSE (400G)	+LY12 HYDROXYSTEARAT
20	741-1134	1	BILLE	FINISH:SIEHE ZG.
21	761-0202	1	DISQUE DE FREIN	FINISH:ÖL UND FETTFREI
32	716-0231	1	CIRCLIPS	FINISH:SPEC-100016
33	716-0385	1	CIRCLIPS	SHR-39:FINISH PHOS & OIL
36	732-0614	1	CIRCLIPS	FINISH:ZINC PHOSPHATE
37	736-0336	1	RONDELLE 5/8X1.00X.030	FINISH:MTD SPEC-100016
38	736-0337	2	RONDELLE 5/8 IDX1.0 ODX.040	MTD STD 701-01001 936-0337
39	736-0349	1	RONDELLE 5/8 IDX10 OD X.020	FINISH:SIEHE ZG.
40	736-04337	1	RONDELLE	FINISH:GEÖLT
41	736-0494	1	RONDELLE	FINISH:MTD SPEC-100016
42	736-0495	1	RONDELLE	FINISH:SIEHE ZG. 936-0495
43	741-0524A	3	ROULEMENT	FINISH:SIEHE CHART *
52	717-04537	2	PIGNON 55 DENTS	FINISH:ÖL GEDIPPT
53	718-04045	1	PIGNON BALADEUR	FINISH:SIEHE ZG.
61	741-04458	1	BAGUE	FINISH:ÖL-IMPRÄGNIERT
63	092.60.138	1	SERVICE KIT LT-5 BOÏTE	E-TEIL-SET

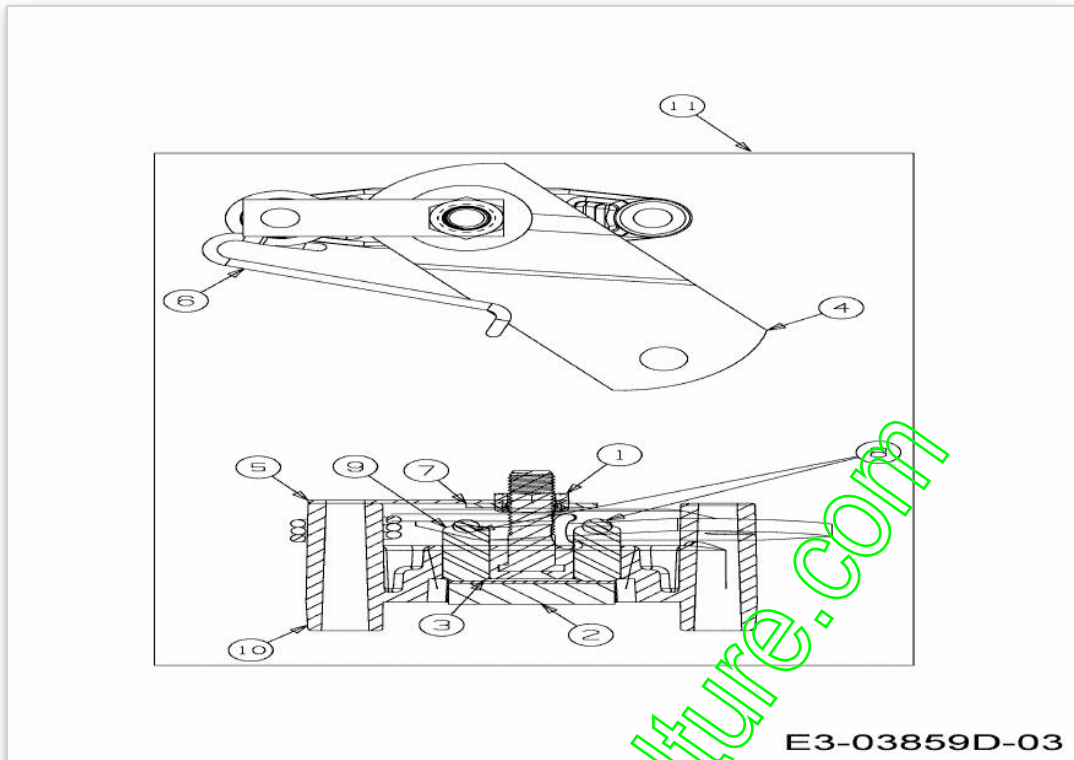

E3-03859D-03

www.emc-motoculture.com

Position	Numéro de pièce	#	Appellation I	Appellation II
1	712-0273	1	ECROU HEXAGONAL 5/16-24"	FINISH:MTD SPEC-100015
2	717-0678	1	PLAQUETTE DE FREIN	FINISH:
3	717-0682	1	INSERT DE FREIN	FINISH:NONE 917-0682
4	717-0700	1	LEVIER DE FREIN, j DROITE	FINISH:PHOSPHATE & OIL
5	718-0150	1	LANG. DE SUPP.: ANTI ROTATION	FINISH:SPEC-100015
6	732-0743	1	RESSORT	FINISH:ZINC PHOS&OIL 932-0743
7	736-0371	1	RONDELLE 1.344XA .875"	FINISH:MTD SPEC-100016
9	741-0343	2	GOUJON DE PRESSION 5/16"	FINISH:SIHE ZG. 941-0343
10	761-0198A	1	APPUI DE FREIN	FINISH:NONE 961-0198A
11	661-0006	1	SUPPORT PLAQUETTE FREIN	FINISH:

www.emc-motoculture.com

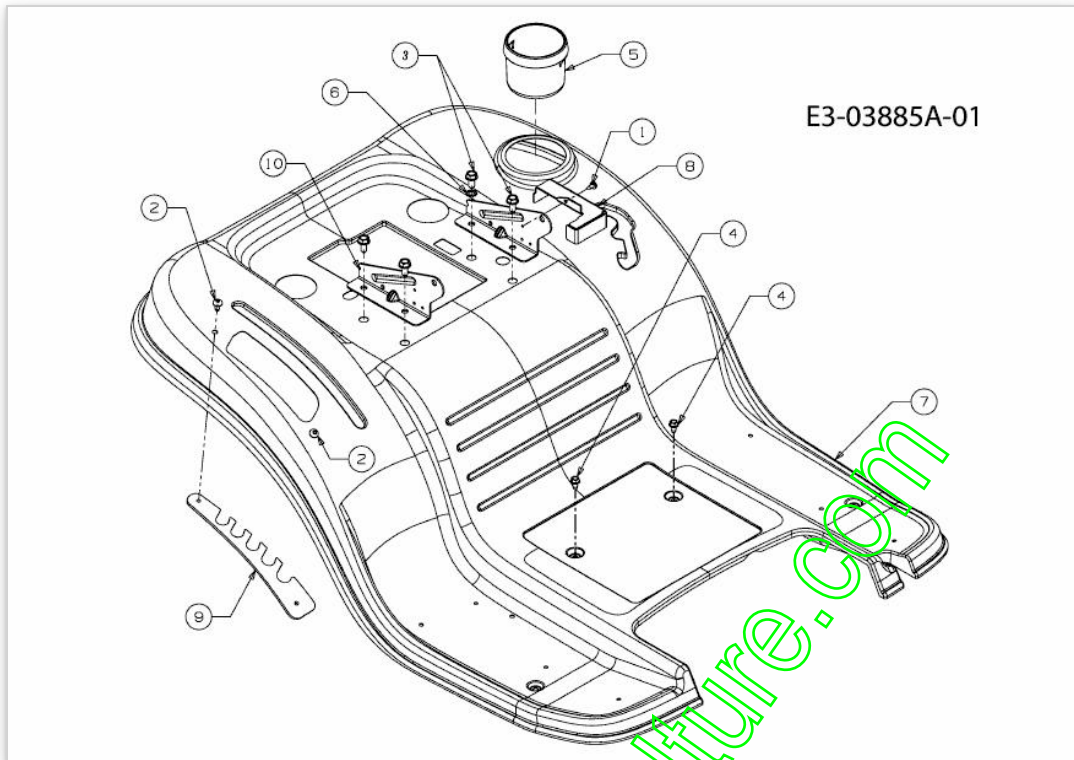

Position	Numéro de pièce	#	Appellation I	Appellation II
1	710-0224	1	VIS PARK:#10-16:0.500:HXINDWSH	FINISH:MTD SPEC-100016 TYPE 1
2	710-04483	2	VIS:TT:1/4-20:.500:TRUSTRXI	FINISH:GELB SPEC-701-01002
3	710-04484	4	VIS HEX. TT:5/16-18:.750:HXIND	FINISH:MTD SPEC-100016 TYPE 1
4	710-0599	2	VIS A SIX PANS CREUX	FINISH:MTD SPEC-101617
5	731-04591A	1	PORTE GOBELET	FINISH:KUNSTSTOFF SCHWARZ
6	736-0607	1	RONDELLE	FINISH:MTD SPEC-100016
7	783-04587A	1	JUPE ARRIERE VERT MASTERCUT	FINISH:LACKIERT
8	783-04877A	1	783-06279	FINISH:LACKIERT
9	783-05881	1	SELECTEUR	FINISH:LACKIERT
10	783-1489C	2	SUPPORT:SIËGE	FINISH:LACKIERT

www.emc-motoculture.com

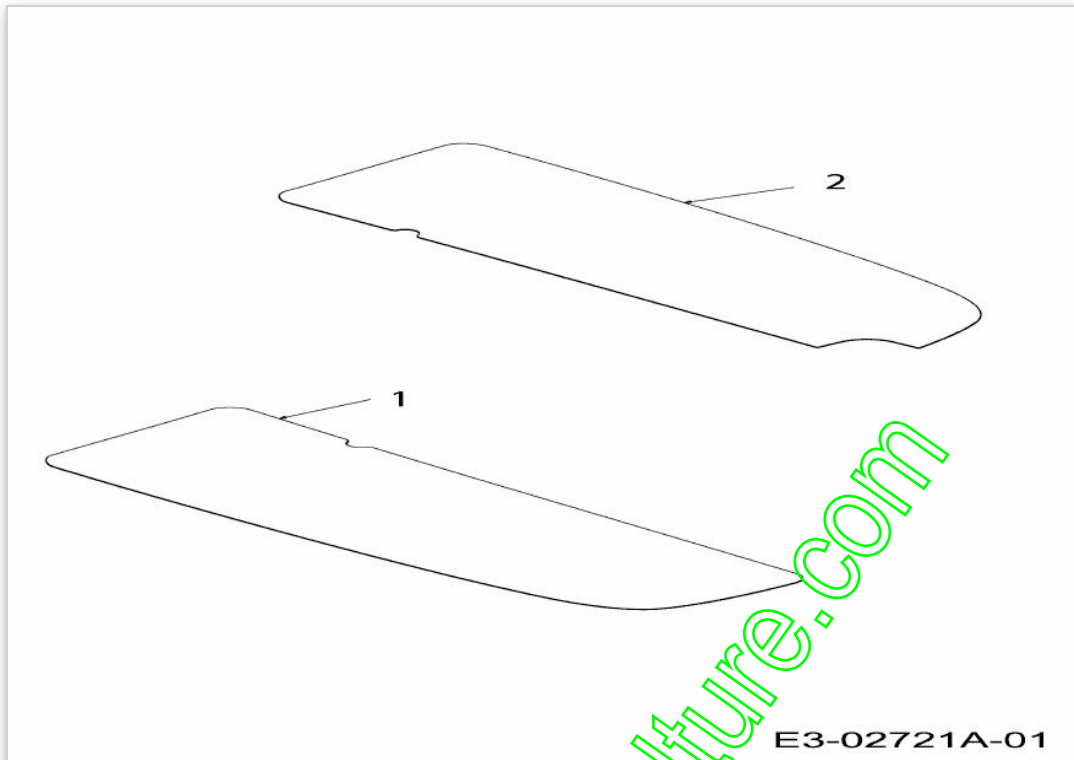

E3-02721A-01

Position	Numéro de pièce	#	Appellation I	Appellation II
1	723-04025	1	MARCHE PIED DROITE	FARBE: SCHWARZ
2	723-04026	1	MARCHE PIED GAUCHE	FARBE: SCHWARZ

www.emc-motoculture.com

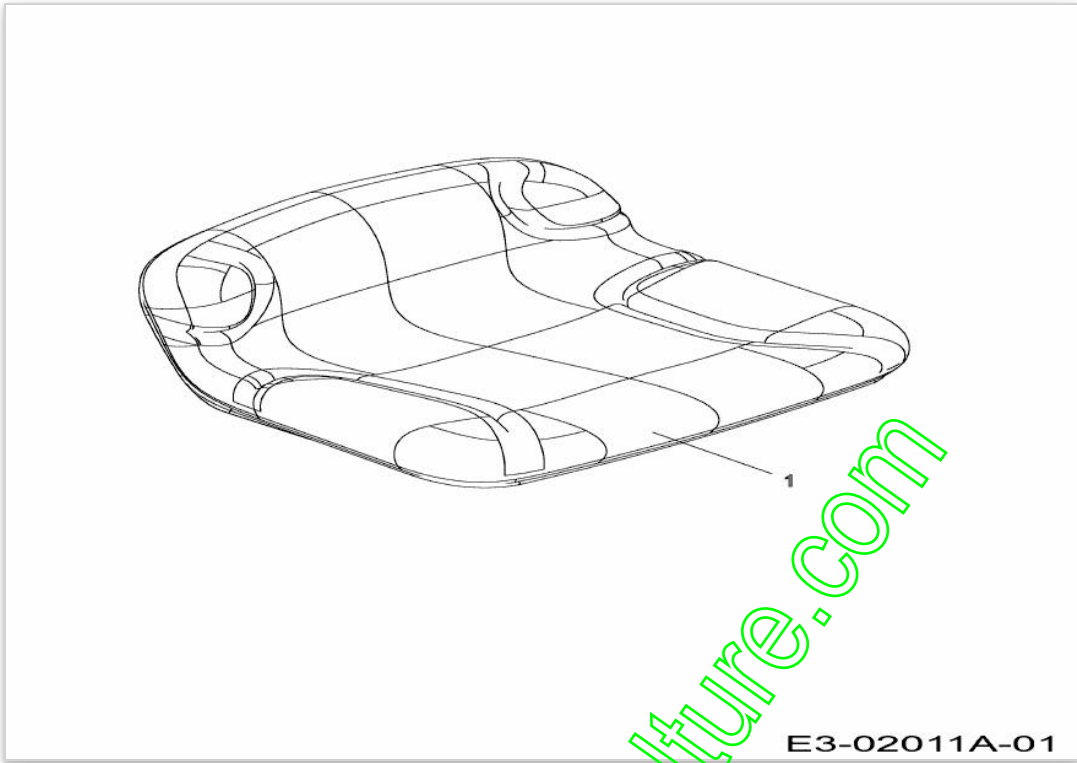

E3-02011A-01

www.emc-motoculture.com

Position	Numéro de pièce	#	Appellation I	Appellation II
1	757-04001	1	SIEGE BAS	757-04001

www.emc-motoculture.com

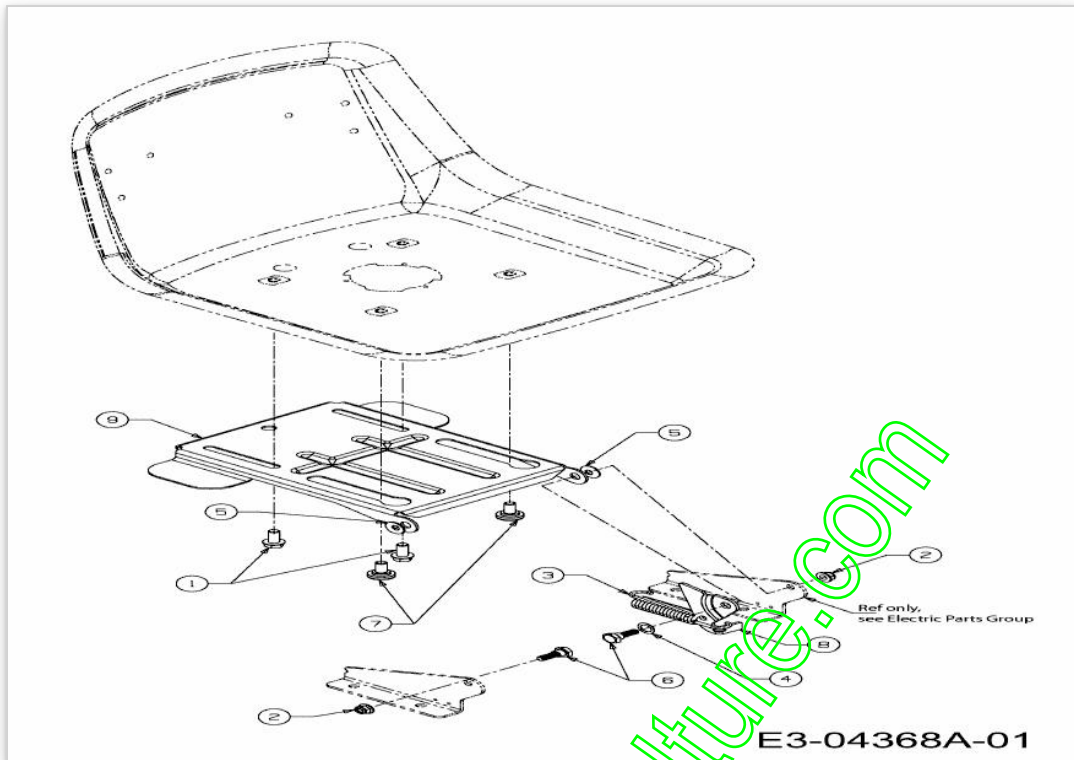

www.emc-motoculture.com

Position	Numéro de lapièce	#	Appellation I	Appellation II
1	710-04482	2	VIS:3/8-16:.875:GR5:STD	FINISH:MTD SPEC-100015
2	712-04063	2	ECROU HEX. AVEC FLANC	FINISH:MTD SPEC-100015
3	732-1184	1	RESSORT	500er:FINISH:MTD STD 701-01000
4	736-0108	1	RONDELLE	FINISH:MTD SPEC-100015
5	736-0242	2	RONDELLE CONIQUE.340X.872X.060	FINISH:MTD SPEC-100016
6	738-0296	2	AXE EPAULE	FINISH:SPEC-100015
7	738-04012A	2	VIS EPAULEE	FINISH:SIEHE ZG.
8	783-0209D	1	SUPP. SIËGE	FINISH:SPEC-100016
9	783-04081B	1	PLAQUE DE SIËGE: NOIR	FINISH:LACKIERT

www.emc-motoculture.com

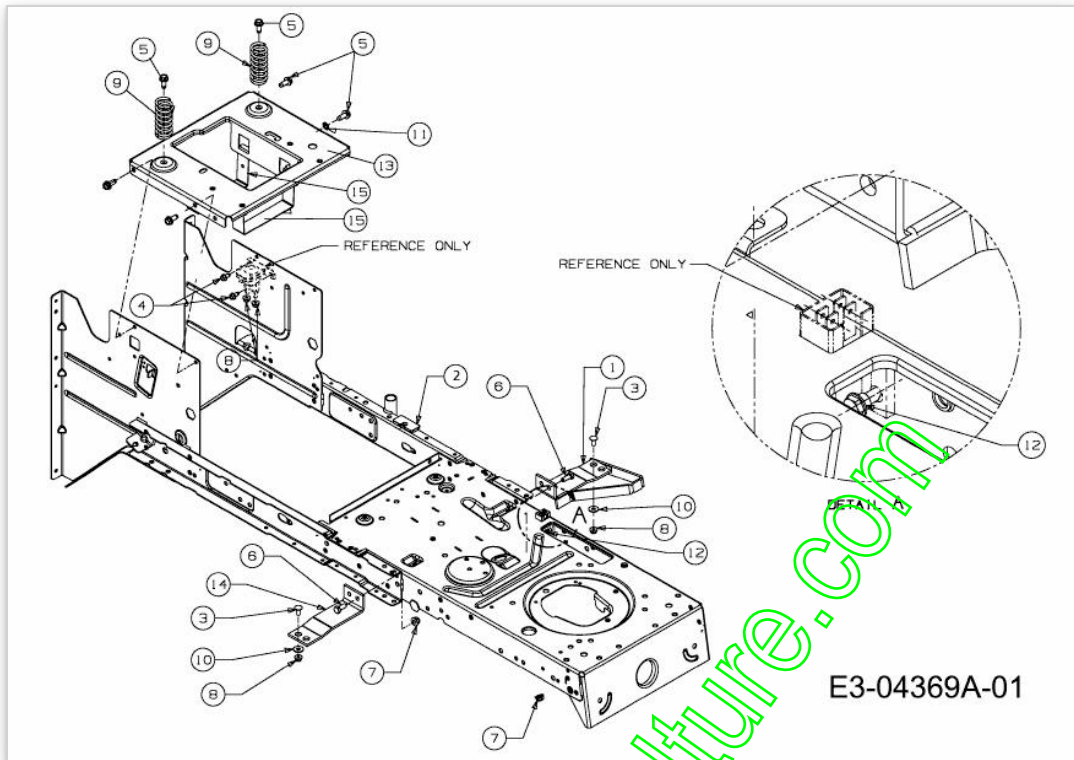

E3-04369A-01

Position	Numéro de pièce	#	Appellation I	Appellation II
1	683-04195637	1	SUPPORT	SCHWEIßTEIL / SCHWARZ LACKIERT
2	683-04408	1	CHASSIS	SCHWEISSTEIL:FINISH:LACKIERT
3	710-0134	2	VIS j TαTE PLATE	FINISH:MTD SPEC-100015
4	710-0599	2	VIS A SIX PANS CREUX	FINISH:MTD SPEC-101617
5	710-04484	6	VIS HEX. TT:5/16- 18:.750:HXIND	FINISH:MTD SPEC-100016 TYPE 1
6	710-3008	2	VIS 5/16- 18:.75:GR5:STD	SPEC-701-01006 or.SPEC-100015
7	712-04063	3	ECROU HEX. AVEC FLANC	FINISH:MTD SPEC-100015
8	712-04064	4	ECROU HEXAGONAL	FINISH:SPEC-100015 912-04064
9	732-04035	2	RESSORT DE SIEGE	FINISH:SPEC-100015
10	736-0173	2	RONDELLE 281DX 74ODX.063	FINISH:MTD SPEC-100015
11	736-0607	1	RONDELLE	FINISH:MTD SPEC-100016
12	738-04237A	1	AXE EPAULE	FINISH:MTD SPEC-100016
13	783-04548C-S	1	SUPPORT DE SIEGE	SCHWARZ
14	783-04637637	1	SUPPORT	SCHWARZ LACKIERT
15	783-04869A-S	2	SUPPORT BATTERIE	SCHWARZ

www.emc-motoculture.com

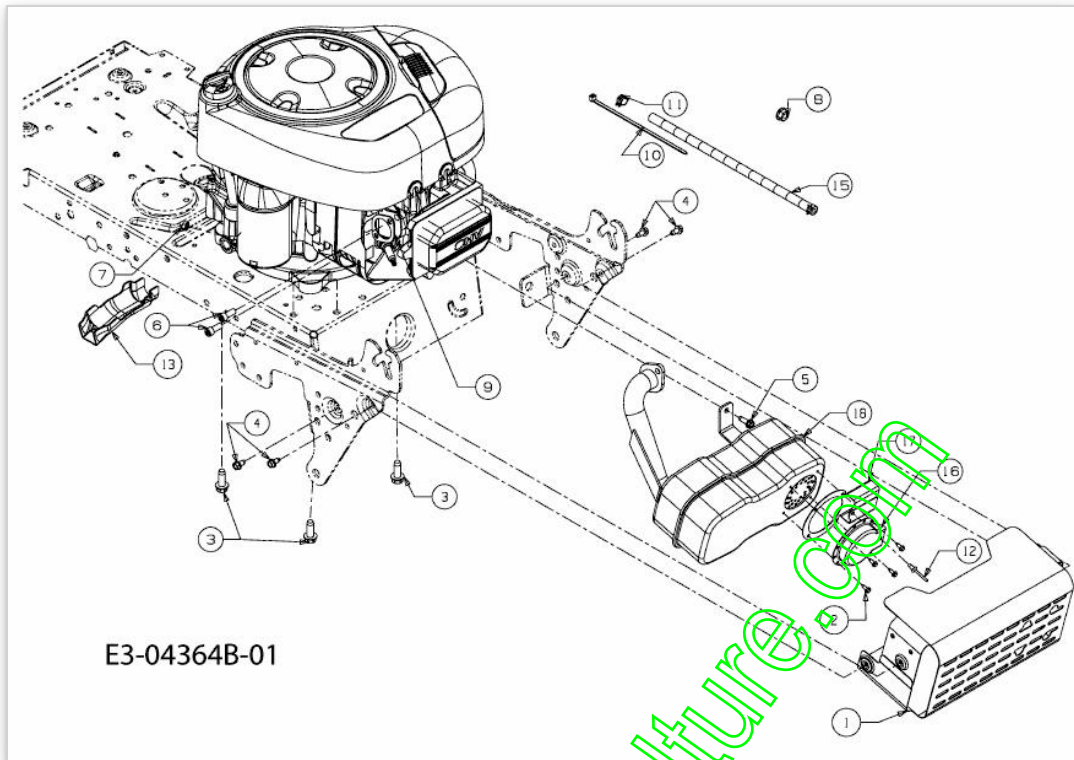

E3-04364B-01

Position	Numéro de pièce	#	Appellation I	Appellation II
1	683-04549	1	PROTECTION D ECHAPPEMENT	SCHWEISSTEIL:FINISH LACKIERT
2	710-0227	4	VIS	FINISH:MTD SPEC-100016 TYPE 1
3	710-04683	4	VIS HEX.:3/8-16:1.000	FINISH:MTD SPEC-701-01002
4	710-0599	4	VIS A SIX PANS CREUX	FINISH:MTD SPEC-101617
5	710-0642	1	VIS1/4-20:0.750	SPEC-100016 TYPE 1 910-0642
6	710-1314A	2	VIS HEX. INT. 5/16-18:.75:GR8	FINISH: GM4435M CODE A
7	712-0271	1	ECROU 1/4-20"+ DISQUE DENTE	FINISH:MTD SPEC-100016 GR5
8	712-3005	1	ECROU AVEC FLANC:3/8-16:GR5	FINISH:SPEC-100015 912-3005
9	721-0208	1	JOINT ECHAP B/S MONO CYLINDRE	FINISH:B&S #272293
10	725-0157	1	COLLIER DE SERRAGE3/16X0.5X7.4	MATERIAL:NYLON-SCHWARZ
11	726-0205	2	COLLIER DE SERRAGE DE BOYAU	FINISH:PHOS UND GELB LACKIERT
12	728-04000	1	RIVET POP	FINISH:SIEHE ZG.
13	731-05628	1	GOUTIERE VIDANGE D HUILE	FINISH:SCHWARZ
15	751-0535	1	TUYAU ESSENCE NOIR	Ø12,7+/-5.84 / Ø6,35+/-0,41
16	751-0564B	1	DEFLECTEUR ECHAPPEMENT	MATERIAL:ALUMINIERTER STAHL
17	751-10353	1	RALLONGE D'DEFLECTEUR	FINISH:ALUMINISIERT
18	751-10536A	1	SILENCIEUX	MATERIAL:ALUMINIERTER STAHL

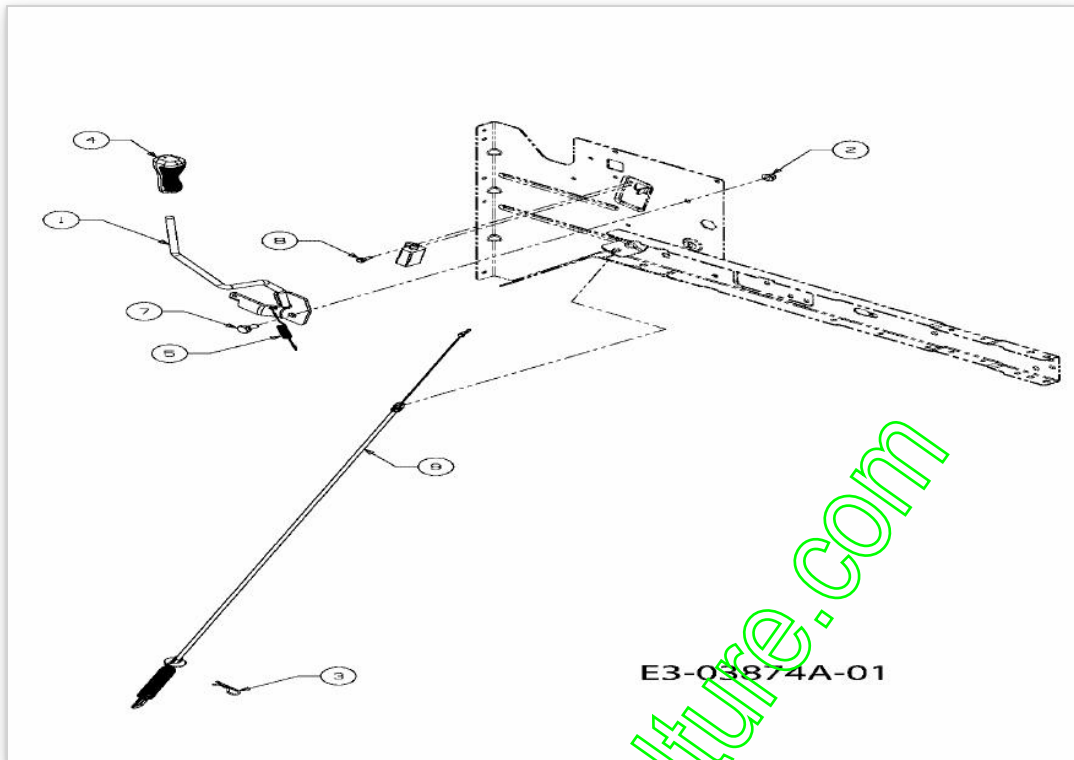

Position	Numéro de pièce	#	Appellation I	Appellation II
1	647-04137	1	LEVIER D EMBRAYAGE	SCHWEISSTEIL:FINISH LACKIERT
2	712-04063	1	ECROU HEX. AVEC FLANC	FINISH:MTD SPEC-100015
3	714-0145	1	GOUPILLE	FINISH:SPEC-701-01006
4	720-04049A	1	POIGNEE PLASTIQUE	FINISH:SCHWARZ
5	732-04276A	1	RESSORT	FINISH:MTD SPEC-701-01006
7	738-0140	1	VIS A EP.:.435 x.178-5/16 x.56	FINISH:MTD SPEC-100015
8	738-04237A	1	AXE EPAULE	FINISH:MTD SPEC-100016
9	746-04488	1	CABLE ENCLenchement LAME LT-5	MIT DICHTRING

www.emc-motoculture.com

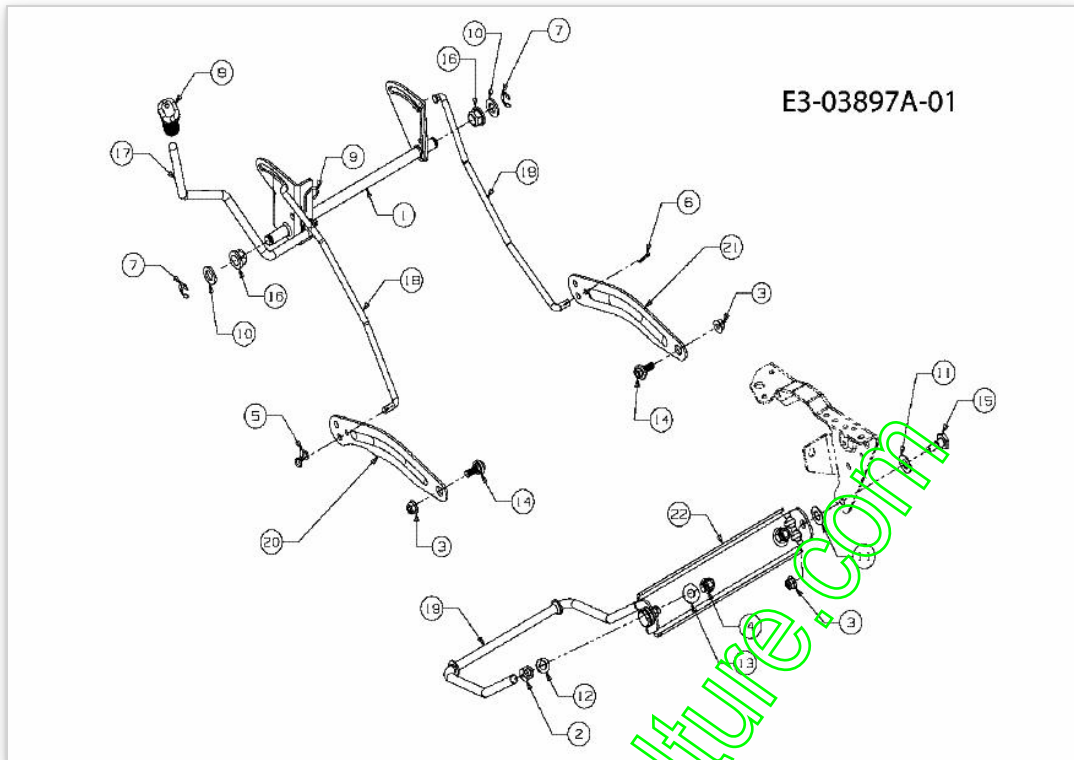

Position	Numéro de pièce	#	Appellation I	Appellation II
1	683-04466	1	LEVIER COMPLET	SCHWEISSTEIL:FINISH LACKIERT
2	712-0206	2	ECROU HEX. 1/2-13:GR.5	FINISH:MTD SPEC-100015
3	712-04065	4	ECROU HEXAGONAL	FINISH:SPEC-100015 912-04065
4	712-3083	2	ECROU HEX. 1/2-13:GRB:NYLON	FINISH:MTD SPEC-100015
5	714-04043	1	GOUPILLE	FINISH:VERZINKT
6	714-0470	1	EPINGLE EX AF-43010	FINISH:SPEC-100015 470 32 32
7	716-0106A	2	CIRCLIPS	FINISH:PHOSPHATIERT
8	720-0311	1	POIGNÛE LEVIER COUPE : 1/2	FARBE:SCHWARZ VINYL
9	732-04225	1	RESSORT	FINISH:MTD STD 701-01006
10	736-0366	2	RONDELLE 5/8 ID X 1.0 OD	FINISH:MTD SPEC-100015
11	736-0414	4	RONDELLE TÜFLON	FINISH:WEISS: 936-0414
12	736-0921	2	RONDELLE GROWER	FINISH:MTD SPEC-100016
13	736-3084	2	RONDELLE	FINISH:MTD STD 701-01001
14	738-04130	2	VIS .625X.175:3/8-16	FINISH:701-01002
15	738-0507B	2	VIS	FINISH:MTD SPEC-701-01006
16	741-0225	2	BAGUE HEXAGONALE TEFLON 6 PANS	FINISH:KUNSTSTOFF SCHWARZ
17	747-04282	1	LEVIER DE RELEVAGE :LT-5	FINISH:SPEC-100015
18	747-04842	2	TRINGLE DE RELEVAGE	A/C/E/N-Deck:747-04842-Z
19	747-1324	1	TRINGLE	FINISH:SPEC-100015
20	783-04494B	1	AUSHEBEARM:DECK 42" RECHTS LT5	FINISH:LACKIERT MTD QUALITÄT
21	783-04711B	1	AUSHEBEARM:DECK 42" LINKS LT5	FINISH:LACKIERT MTD QUALITÄT
22	783-0720C	1	SUPPORT DE RELEVAGE	FINISH:LACKIERT

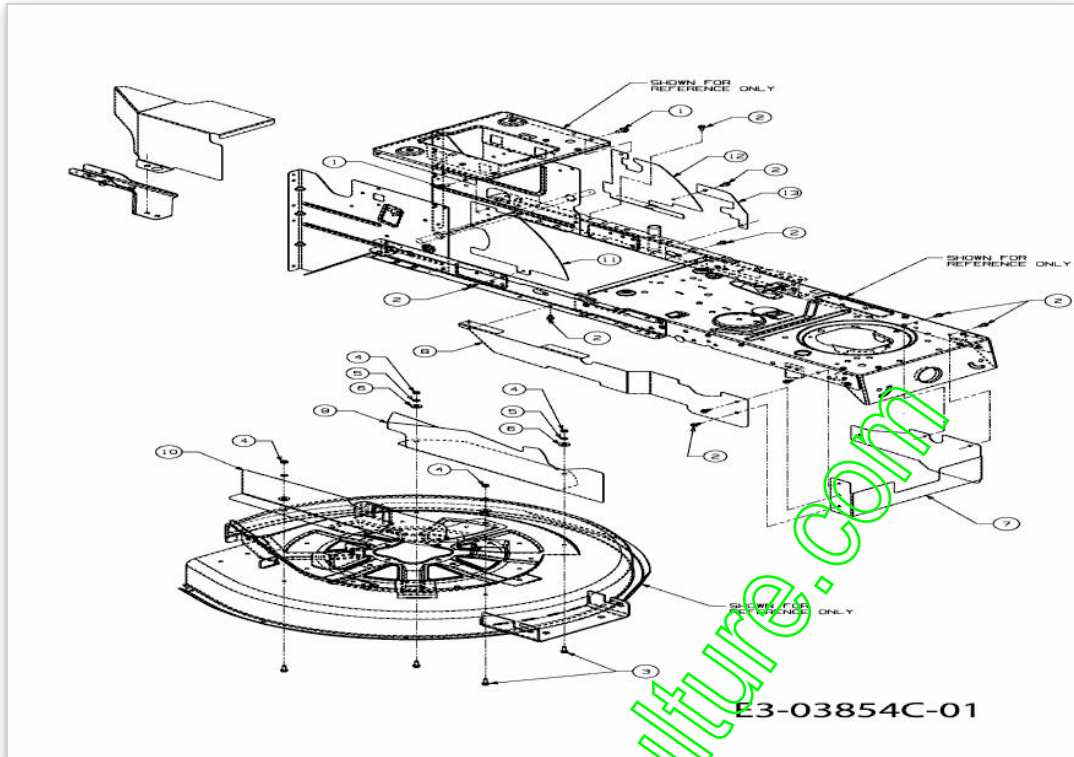

www.emc-motoculture.com

Position	Numéro de pièce	#	Appellation I	Appellation II
1	710-04484	2	VIS HEX. TT:5/16-18:.750:HXIND	FINISH:MTD SPEC-100016 TYPE 1
2	710-0599	10	VIS A SIX PANS CREUX	FINISH:MTD SPEC-101617
3	710-0642	4	VIS1/4-20:0.750	SPEC-100016 TYPE 1 910-0642
4	712-3006	4	ECROU HEXAGONAL	FINISH:SPEC-100015
5	736-0329	4	RONDELLE GROWER	FINISH:SPEC-100016 24.8195.16
6	736-3008	4	RONDELLE	FINISH:MTD SPEC-100015
7	783-05988	1	PROTECTION AVANT	FINISH:LACKIERT MTD QUALITÄT
8	783-05989	1	PROTECTION DROITE	FINISH:LACKIERT MTD QUALITÄT
9	783-05990	1	PROTECTION GAUCHE	FINISH:LACKIERT MTD QUALITÄT
10	783-05991	1	PROTECTION DROITE	FINISH:LACKIERT MTD QUALITÄT
11	783-05992637	1	PROTECTION ARRIERE DROITE	SCHWARZ
12	783-05994	1	ABDECKUNG RE.HINTEN:LT-5	FINISH:LACKIERT MTD QUALITÄT
13	783-06084637	1	PROTECTION	SCHWARZ

www.emc-motoculture.com

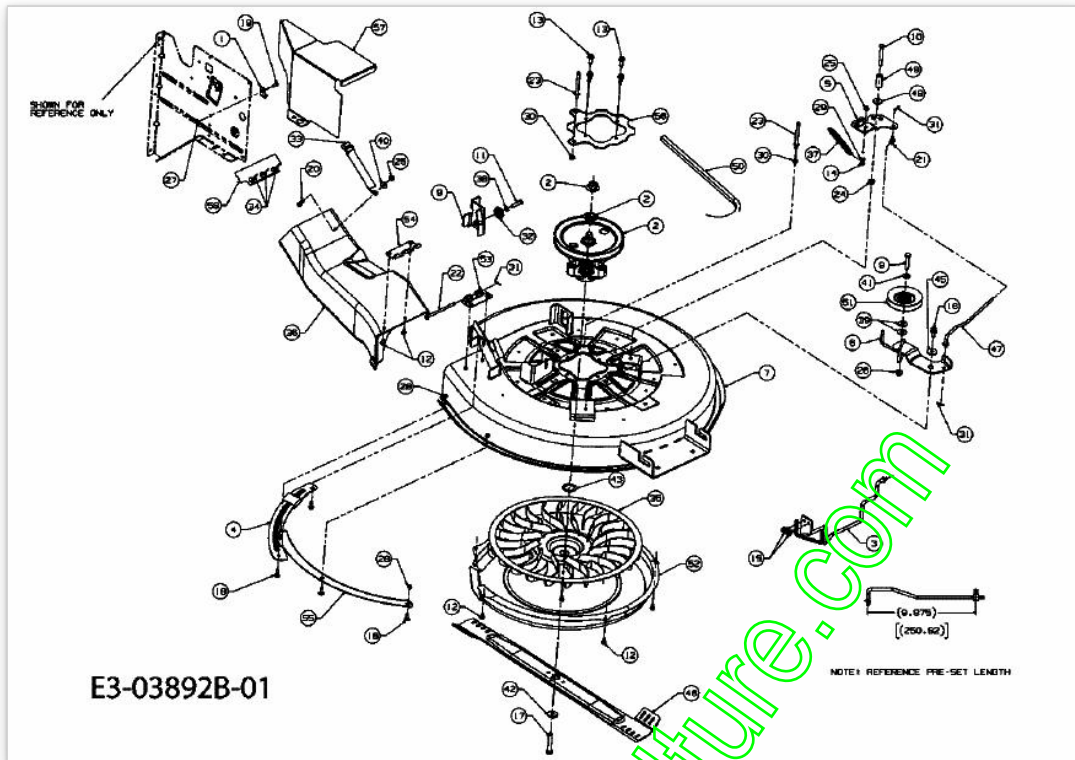

www.emc-motoculture.com

Position	Numéro de lapièce	#	Appellation I	Appellation II
1	16606	1	ÜTRIER D'ACCROCHAGE	FINISH:BLAU CHROMATIERT *
2	618-0139B	1	PALIER LAME COMPLET COUPE 76CM	KEILRIEMENSCHLEIFE 918-0139B
3	647-04148A	1	KEILRIEMENFÜHRUNG:RAHMEN:30"	SCHWEISSTEIL:647-04148A-Z
4	683-0215A	1	NOIR	SCHWEISSTEIL:LACKIERT
5	683-04409	1	BREMSE VOLLST:DECK:A/C/N-DECK	LT5: NIETTEIL
6	683-04446B-Z	1	TENDEUR	FINISH:PEC-100015
7	683-04459	1	CARTER DE COUPE 76 CM NOIR	SCHWEISSTEIL:FINISH LACKIERT
8	683-04460	1	SUPPORT	SCHWEISSTEIL:LACKIERT MTD STD
9	710-0347	1	VIS HEX. 3/8-16:1.75:GR5:STD	FINISH:MTD SPEC-100015
10	710-0378	1	VIS HEX.:5/16-18:2.50:GR5:STD	FINISH:MTD SPEC-100015
11	710-0528	1	VIS HEX. 5/16-18:1.25:GR5:STD	FINISH:SPEC-100015 910-0528
12	710-0599	9	VIS A SIX PANS CREUX	FINISH:MTD SPEC-101617
13	710-0602	4	VIS	FINISH:MTD SPEC-100016 TYPE 1
14	710-0606	1	VIS A SIX PANS CREUX	FINISH:SPEC-100015
15	710-0607	2	VIS HEX.TT5/16-18:.500HXINDWSH	FINISH:MTD SPEC-100016 TYPE 1
16	710-0623	1	VIS PARK. HEX.:TT:3/8-16:0.750	FINISH:MTD SPEC-100016 TYPE 1
17	710-1382	1	VIS HEX. M10X1X60LG. DIN 960	10.9 "SCHWARZ"
18	710-1687	4	VIS A TETE PLATE	FINISH:Zn5glcB 22.3419.12
19	710-1691	1	VIS A SIX PANS CREUX	FINISH:Zn5glcB 21.1441.45
20	710-3015	1	VIS:1/4-20:.75:GR5:STD	FINISH:MTD SPEC-100015
21	711-0736	1	AXE	FINISH:MTD SPEC-100015
22	711-1054	1	BOULON ,250 X 4,42	GR2:FINISH:MTD SPEC-100015
23	711-1065	2	AXE	FINISH:PHOS & OIL SIEHE ZG.
24	712-04063	1	ECROU HEX. AVEC FLANC	FINISH:MTD SPEC-100015
25	712-04064	2	ECROU HEXAGONAL	FINISH:SPEC-100015 912-04064
26	712-04065	1	ECROU HEXAGONAL	FINISH:SPEC-100015 912-04065
27	712-0633	1	ECROU	(METALLKLEMMUNG) 24.1426.15
28	712-0691	4	ECROU HEXAGONAL	MTD SPEC-100015 24.1426.14
29	712-3006	1	ECROU HEXAGONAL	FINISH:SPEC-100015
30	712-3046	2	ECROU	FINISH:MTD SPEC-100015
31	714-0507	3	GOUPILLE FENDUE 3/32 X .750	FINISH:MTD SPEC-100015
32	717-04074	1	PIGNON HAUTEUR PLATEAU	PHOS & SPEC-100015 917-04074
33	723-0383	1	SANGLE POUR GOULOTTE D'EJECTI	FINISH:
34	728-0287	3	RIVET NOIR 4.8x10.0	ART.NR 915904864
35	731-1583	1	TURBINE DE VENTILATION	21 1000 000 820 FARBE:SCHWARZ
36	731-1605E	1	CANAL D'EJECTION	30"DECK FINISH:SCHWARZ
37	732-0604A	1	RESSORT	FINISH:PHOS AND OIL
38	736-0119	1	RONDELLE	FINISH:MTD SPEC-100016
39	736-0258	2	RONDELLE PLATE .385x1.0x.135	FINISH:SPEC-100015 936-0258

Position	Numéro de lapièce	#	Appellation I	Appellation II
40	736-0270	1	RONDELLE GROWER	FINISH:MTD SPEC-100016
41	736-0300	1	RONDELLE	FINISH:MTD SPEC-100015
42	736-0684	1	RONDELLE	VERGÜTET-BLANK-GEÖLT
43	736-0693	1	RONDELLE	28X40X0.3 24.6271.51 ST
45	738-0347	1	RONDELLE ; EMB. .625IDx.169	FINISH:
46	742-04058	1	LAME EXTRA SOUFFLANTE 76CM	FINISH:WÄRMEBEHANDELT
47	747-04912	1	TIGE DE FREIN	FINISH:SPEC-100015
48	748-0234	1	RONDELLE EPAULEE	FINISH:ROSTPREVENTION
49	750-04993	1	ENTRETOISE	FINISH:SPEC-100015
50	754-04190	1	COURROIE DE LAME 76CM	FINISH:
51	756-0487	1	GALET TENDEUR	FINISH: SCHWARZ LACKIERT
52	783-0289	1	COUVERTURE SOUFFLANTE	F564.000.00 FINISH:LACKIERT
53	783-0291	1	SUPPORT CONDUIT EJECTION	FINISH:BLAU CHROMATIERT
54	783-0292	1	SUPPORT CONDUIT EJECTION	FINISH:GELBVERZINKT
55	783-0301	1	PLATEAU REINFORCE	783-0301-0637 783-0301*
56	783-0571	1	RENFORT	SCHWARZ GEPULVERT 783-0571*
57	783-05993	1	PROTECTION ARRIERE	FINISH:LACKIERT MTD QUALITÄT
58	783-06154	1	SUPPORT DE GOULOTTE	LT-5

www.emc-motoculture.com

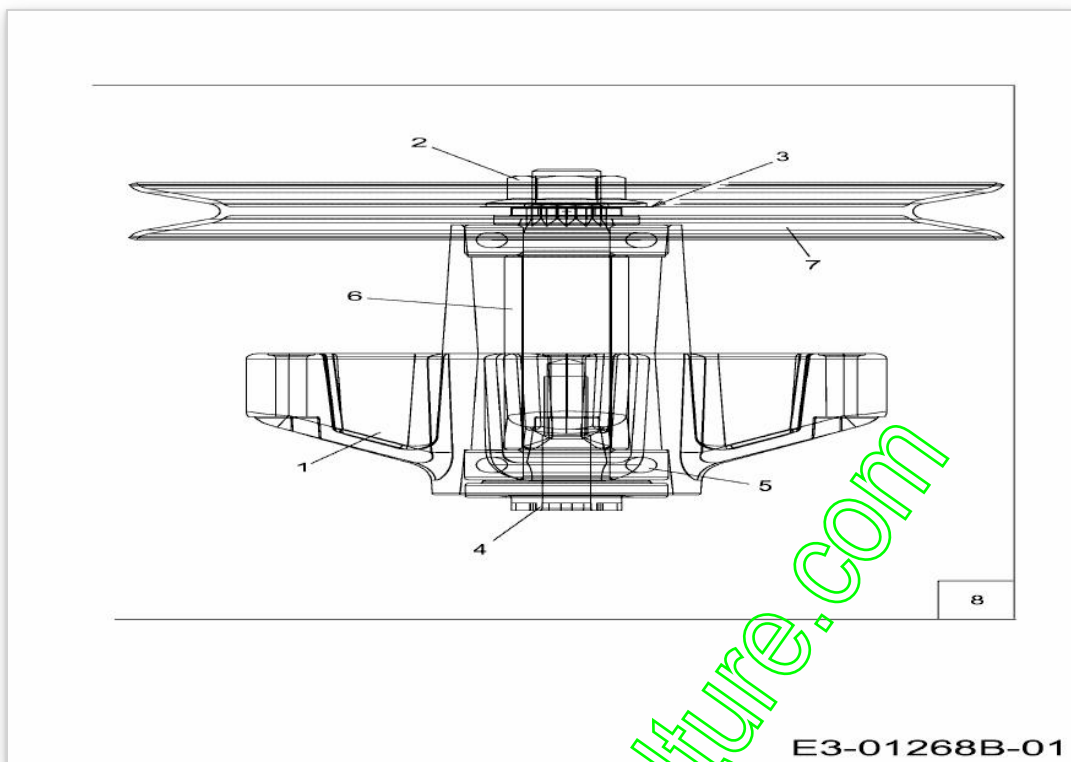

E3-01268B-01

www.emc-motoculture.com

Position	Numéro de pièce	#	Appellation I	Appellation II
1	619-0016	1	CORPS DE PALIER DE LAME	FINISH:NONE
2	712-0417A	1	ÜCROU HEX. AV. FLANC: 5/8-18	FINISH:MTD STD 701-01000
3	736-0693	1	RONDELLE	28X40X0.3 24.6271.51 ST
4	738-1043	1	AXE DE PALIER DE LAME	FINISH:EINGEÖLT
5	741-0919	2	ROULEMENT ; BILLES	FINISH:SIEHE SPEC.
6	750-0990	1	ENTRETOISE D'ECARTEMENT	FINISH:EINGEÖLT
7	756-0623	1	POULIE DE COURROIE TRAPÜZOID.	FINISH:MTD SPEC-100015
8	618-0139B	1	PALIER LAME COMPLET COUPE 76CM	KEILRIEMENSCHLEIBE 918-0139B

www.emc-motoculture.com

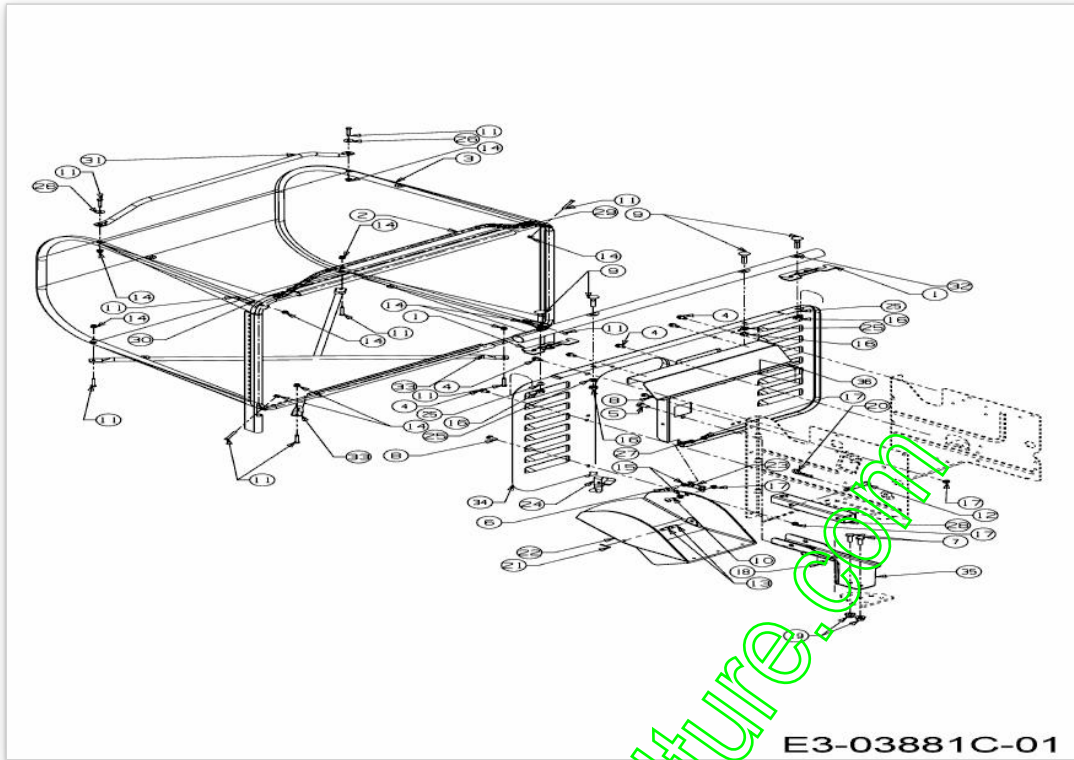

www.emc-motoculture.com

Position	Numéro de pièce	#	Appellation I	Appellation II
1	15995A	2	SUPPORT	15995A-0637
2	649-0011637	1	CADRE BAC DE RAMASSAGE	649-0011-0637
3	664-0073B	1	TOILE DE BAC 200 LITRES "C"	NUR GEWEBESAC: SCHWARZ
4	710-0599	6	VIS A SIX PANS CREUX	FINISH: MTD SPEC-101617
5	710-1376	1	VIS A SIX PANS CREUX	FINISH: SPEC-100015 21.1441.68
6	710-1399	1	VIS HEX. M6X25 DIN 933-8.8	Zn5gIcB 21.1441.50
7	710-1682	2	VIS	FINISH: SPEC-100015 21.1441.72
8	710-1690	2	VIS	MTD SPEC-100015 21.1441.46
9	710-1700	4	VIS	FINISH: SPEC-100015 22.3419.30
10	710-1759	1	VIS	MTD SPEC-100015 (000.02.242)
11	710-1798	10	VIS	FINISH: SPEC-100015 21.1441.29
12	711-0679A	1	GOUJON j ÜPINGLER	GR5: FINISH MTD SPEC-100015
13	711-0701	2	GOUJON	FINISH: MTD SPEC-100015
14	712-0642	10	ECROU DE SECURITE: M5-0.8	FINISH: DIN 6926
15	712-0689	2	ECROU HEXAGONAL	MTD SPEC-100015 24.1421.14
16	712-0690	4	ECROU HEXAGONAL	FINISH: SPEC-100015 24.1421.18
17	712-0691	4	ECROU HEXAGONAL	MTD SPEC-100015 24.1426.14
18	712-0692	1	ECROU HEXAGONAL 24.1426.18	FINISH: SPEC-100015 24.1426.18
19	712-0714	2	ECROU	FINISH: MTD SPEC-100015
20	714-0147	1	GOUPILLE j RESSORT: 1.25 X 1.75	FINISH: MTD SPEC-701-01006
21	714-0507	2	GOUPILLE FENDUE 3/32 X .750	FINISH: MTD SPEC-100015
22	731-1606B	1	VOLET D'EJECTION	FINISH: FARBE SCHWARZ
23	732-0755	1	RESSORT .595 x 2.105 LG	FINISH: PHOS & OIL
24	732-0838A	2	RESSORT CLIPS DE BAC	VERSCHLUSS: FINISH SPEC-100015
25	736-0119	4	RONDELLE	FINISH: MTD SPEC-100016
26	736-0400	2	RONDELLE PLATE .194x.62x.063	FINISH: MTD SPEC-100015
27	736-0648	1	RONDELLE GROWER	FINISH: SPEC-100016 24.8195.14
28	749-04013A-S	1	CARRE D'ACCROCHAGE	30x30mmx179.39mm LG ST37: LACK
29	749-04226637	1	ARCEAU GAUCHE	FINISH: SCHWARZ 788-0637
30	749-04227637	1	ARCEAU DROITE	FINISH: SCHWARZ 788-0637
31	749-0962A637	1	POIGNEE DE BAC	MTD-SCHWARZ
32	749-0963637	1	TUBE: 1.25 DIA X 29.4 LG	SCHWARZ GEPULVERT
33	749-0964637	2	TUBE	SCHWARZ GEPULVERT 749-0964
34	783-0278A	1	GUTBROD ROUGE	FINISH: LACKIERT F564.001.02
35	783-05801	1	HALTEPLATTE: ANHÄNGEVORRICHTUNG	FINISH: LACKIERT MTD QUALITÄT
36	783-05831	1	PLAQUE COUVERCLE	FINISH: LACKIERT MTD QUALITÄT

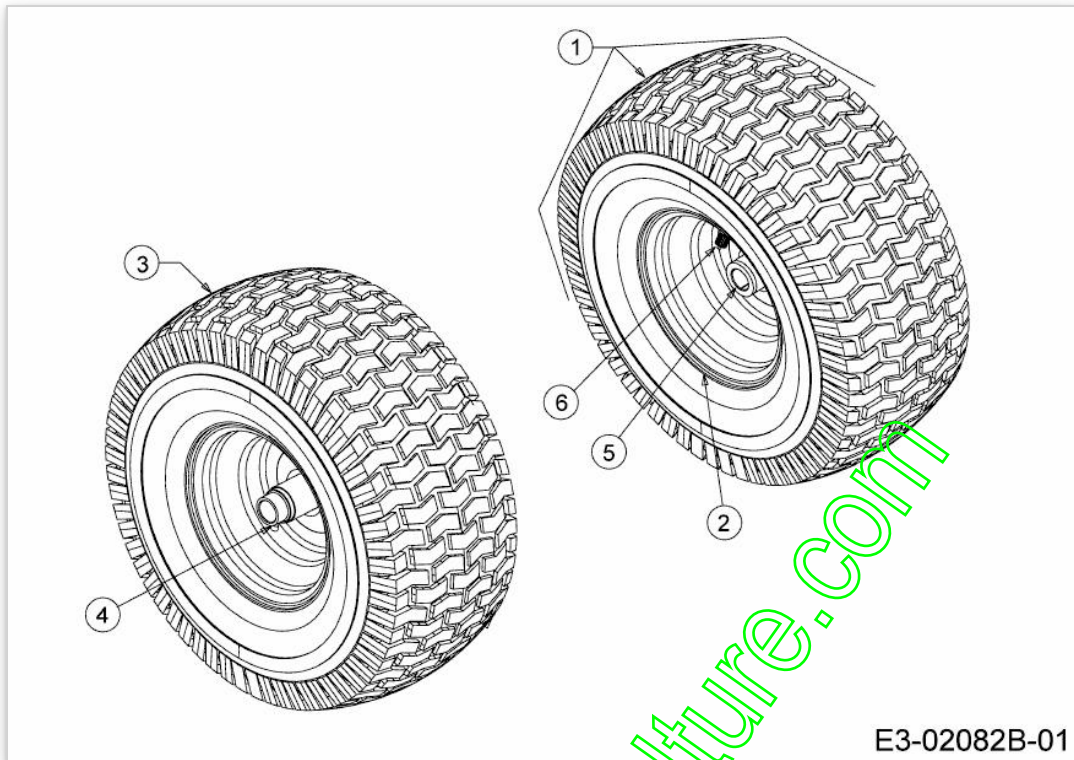

www.emc-motoculture.com

E3-02082B-01

Position	Numéro de pièce	#	Appellation I	Appellation II
1	634-04101	2	ROUE AV COMPLETE	GLEITLAGER
2	634-04098A	2	FELGE VOLLST:6x4:PLS BRG:1.0ID	SCHWEIßTEIL
3	734-0298	2	PNEU 13*500*6	734-0298-0901/-0902 000.75.551
4	741-0990A	2	PALIER DE BRIDE	MIT SCHMIERNIPPEL
5	741-0516A	2	PALIER DE BRIDE	.757 ID x 1.00 OD x 1.2 LG
6	734-0255	2	VALVE:PNEU	TR 412-P / 32.6mm / 934-0255

www.emc-motoculture.com

bis 30.06.2013
to 30.06.2013
jusqu'au 30.06.2013

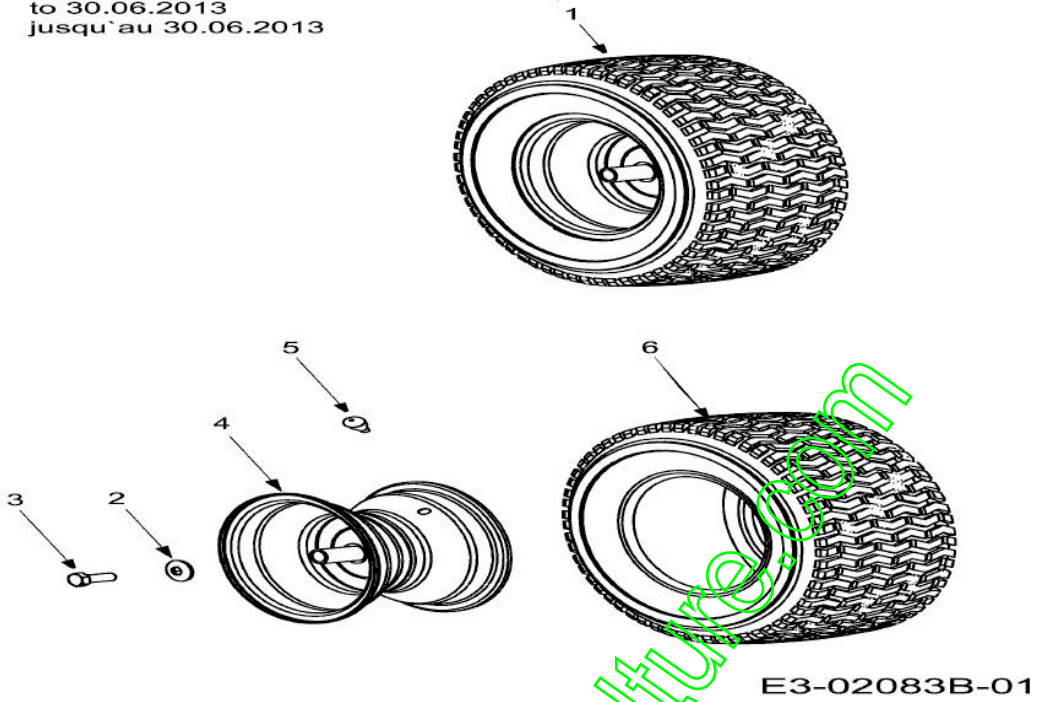

www.emc-motoculture.com

Position	Numéro de pièce	#	Appellation I	Appellation II
1	734-0592	2	ROUE COMPL 18X6.50-8 ST	FINISH:SIEHE FARBVARIANTEN
2	736-0242	1	RONDELLE CONIQUE.340X.872X.060	FINISH:MTD SPEC-100016
3	710-0627	1	VIS HEX. 5/16-24:.750 GR5:LOCK	FINISH:MTD SPEC-100015
4	634-0069	1	JANTE 8.0 x 5.38 x 750 ID	634-0069-0662
5	734-0255	1	VALVE:PNEU	TR 412-P / 32.6mm / 934-0255
6	734-0294	1	PNEU 18*650 *8	SQ:SH:TS 734-0294-0901/902

www.emc-motoculture.com

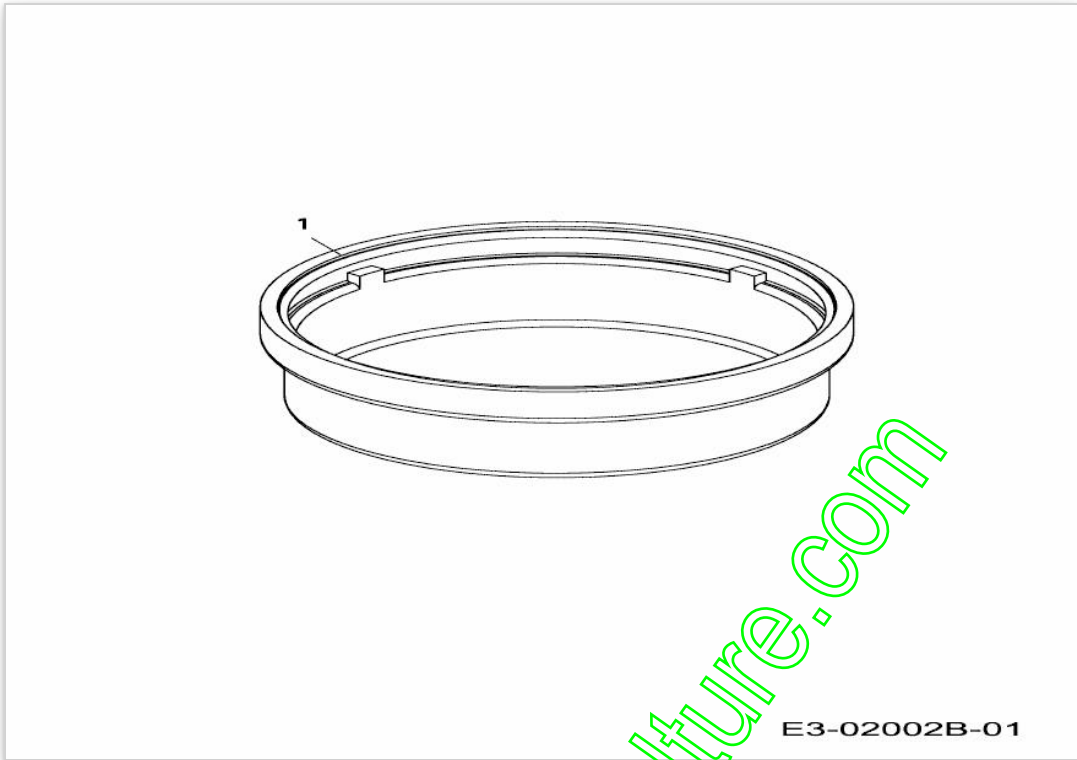

www.emc-motoculture.com

Position	Numéro de lapièce	#	Appellation I	Appellation II
1	731-0484A	2	ENJOLIVEUR DEVANT	KUNSTSTOFF SCHWARZ 931-0484A

www.emc-motoculture.com

www.emc-motoculture.com