

www.emc-motoculture.com

Position	Numéro de lapièce	#	Appellation I	Appellation II
1	918-0609D	1	PALIER DE LAME COMPLET	RIEMENSCHIEBE
2	712-0417A	1	ÜCROU HEX. AV. FLANC: 5/8-18	FINISH:MTD STD 701-01000
3	741-0919A	2	ROULEMENT A BILLES	FINISH:
4	736-0315	1	RONDELLE FL	FINISH:STD SPEC-100015
5	738-1128	1	AXE DE PALIER DE LAMES:6.58"	FINISH:GEÖLT
6	750-1000	3	ENTRETOISE:.80x1.10x1.330	FINISH:GEÖLT
7	756-1218	1	POULIE DE PALIER DE LAME	Ø6.482xØ 5625:FINISH SIEHE ZG.

www.emc-motoculture.com

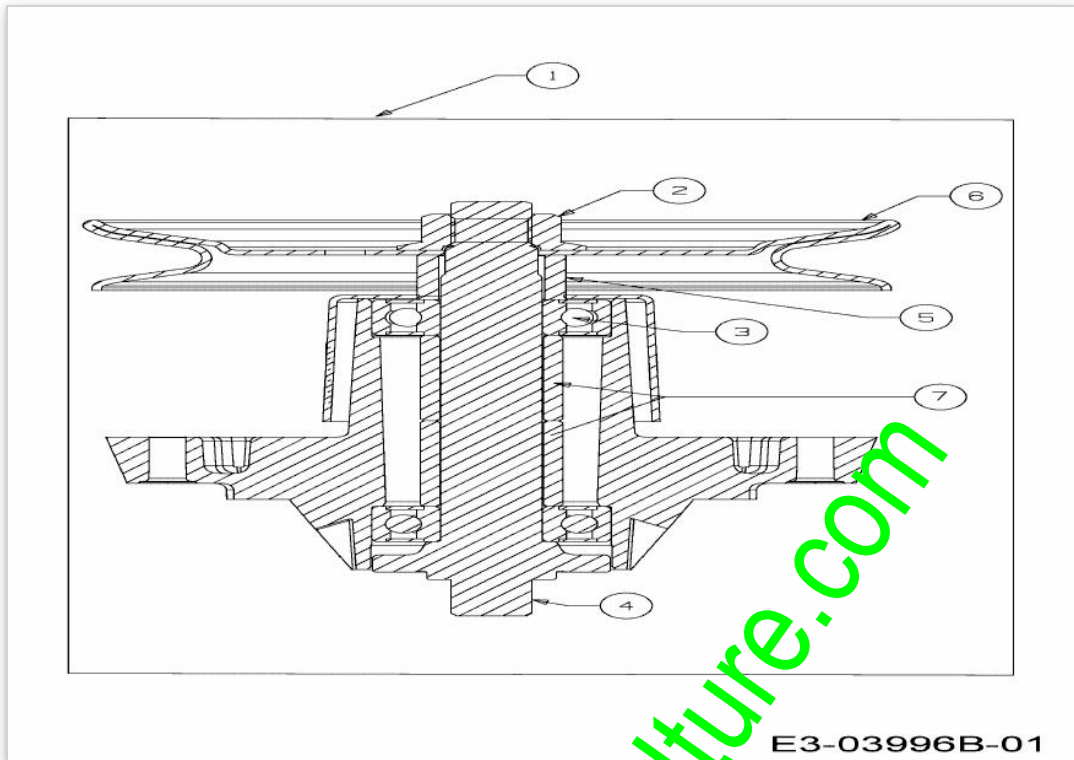

E3-03996B-01

www.emc-motoculture.com

Position	Numéro de pièce	#	Appellation I	Appellation II
1	918-04657A	1	PALIER DE LAME COMPLET	KEILRIEMENSCHLEIBE 6.3 DIA
2	712-0417A	1	ÜCROU HEX. AV. FLANC: 5/8-18	FINISH:MTD STD 701-01000
3	741-0919A	2	ROULEMENT A BILLES	FINISH:
4	738-1010A	1	AXE DE PALIER 5.75 LG	FINISH:GEÖLT 618-0324A
5	748-04302	1	ENTRETOISE	FINISH:GEÖLT
6	756-1227	1	POULIE DE PALIER DE LAME	FINISH:SIEHE ZG.
7	750-1000	2	ENTRETOISE:.80x1.10x1.330	FINISH:GEÖLT

www.emc-motoculture.com

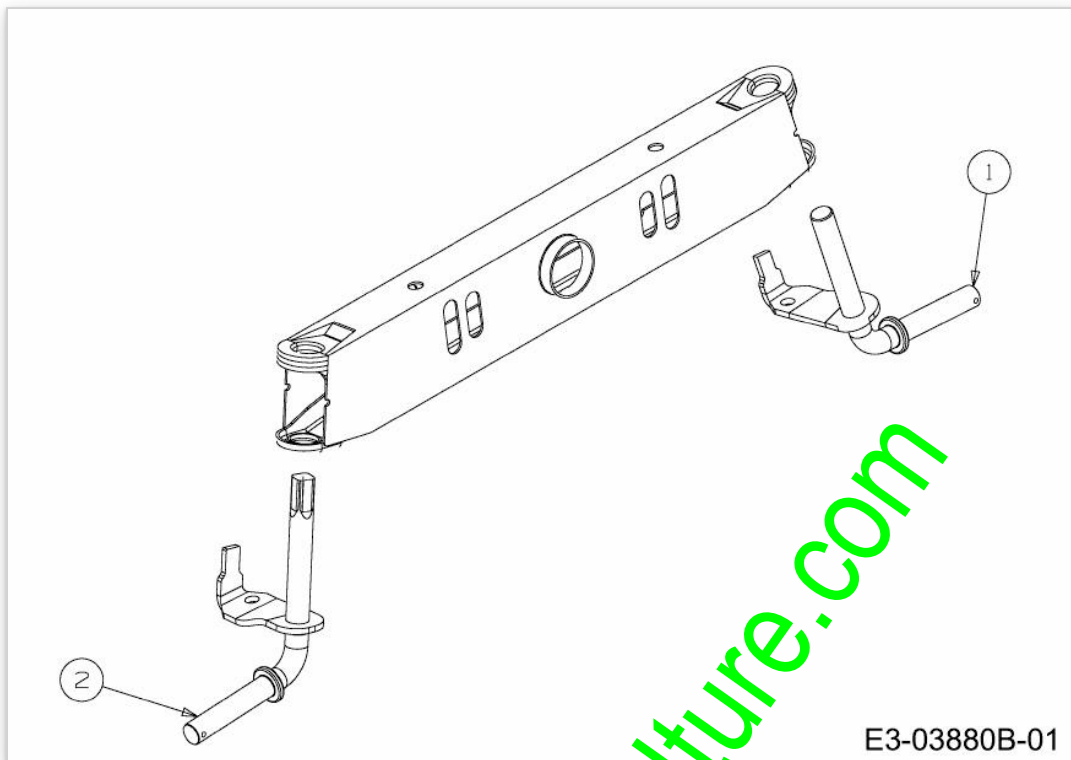

E3-03880B-01

www.emc-motoculture.com

Position	Numéro de lapièce	#	Appellation I	Appellation II
1	638-04014A-S	1	FUSEE GAUCHE	SCHWARZ
2	638-04013637	1	FUSEE DROITE	SCHWEISSTEIL:LACKIERT

www.emc-motoculture.com

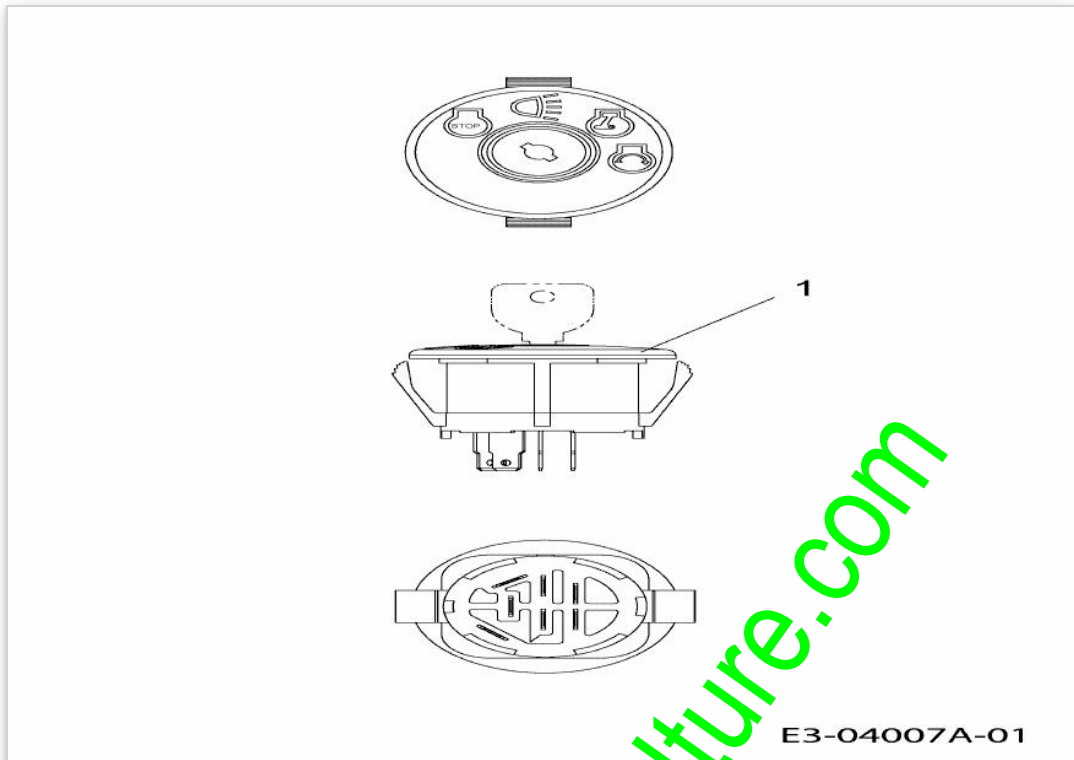

www.emc-motoculture.com

Position	Numéro de lapièce	#	Appellation I	Appellation II
1	725-1741	1	CONTACTEUR A CLE	FINISH: 925-1741

www.emc-motoculture.com

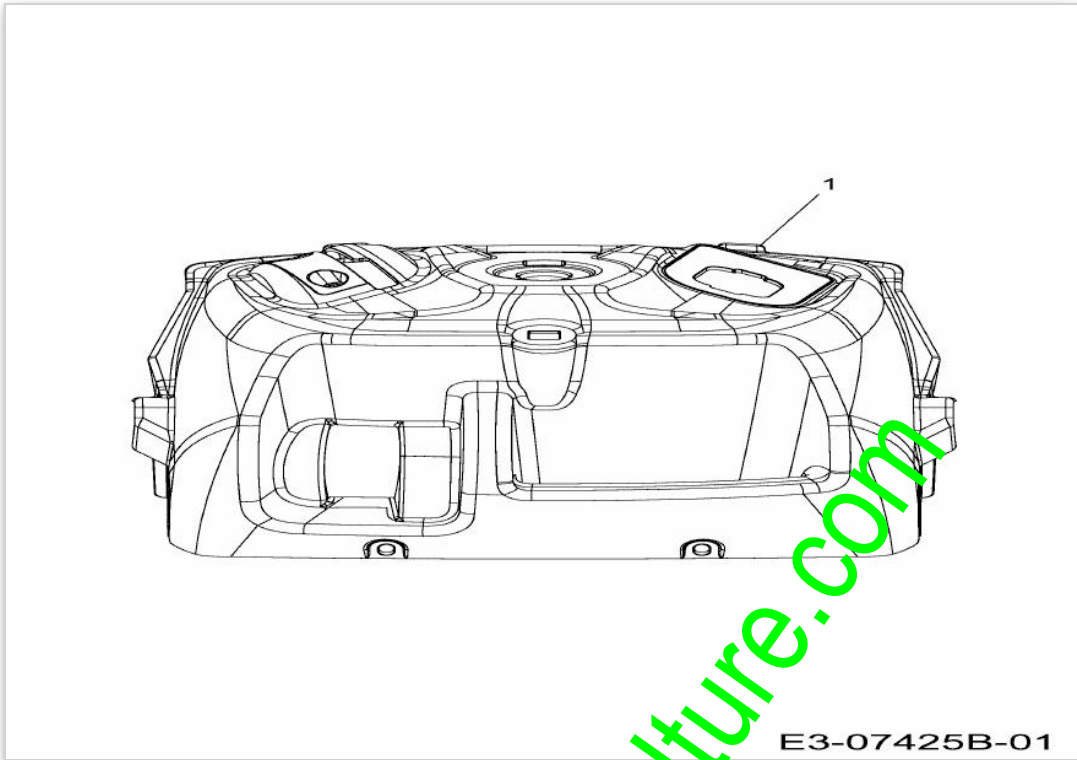

www.emc-motoculture.com

Position	Numéro de lapièce	#	Appellation I	Appellation II
1	731-08054A	1	TABLEAU DE BORD	FINISH:KUNSTSTOFF SCHWARZ

www.emc-motoculture.com

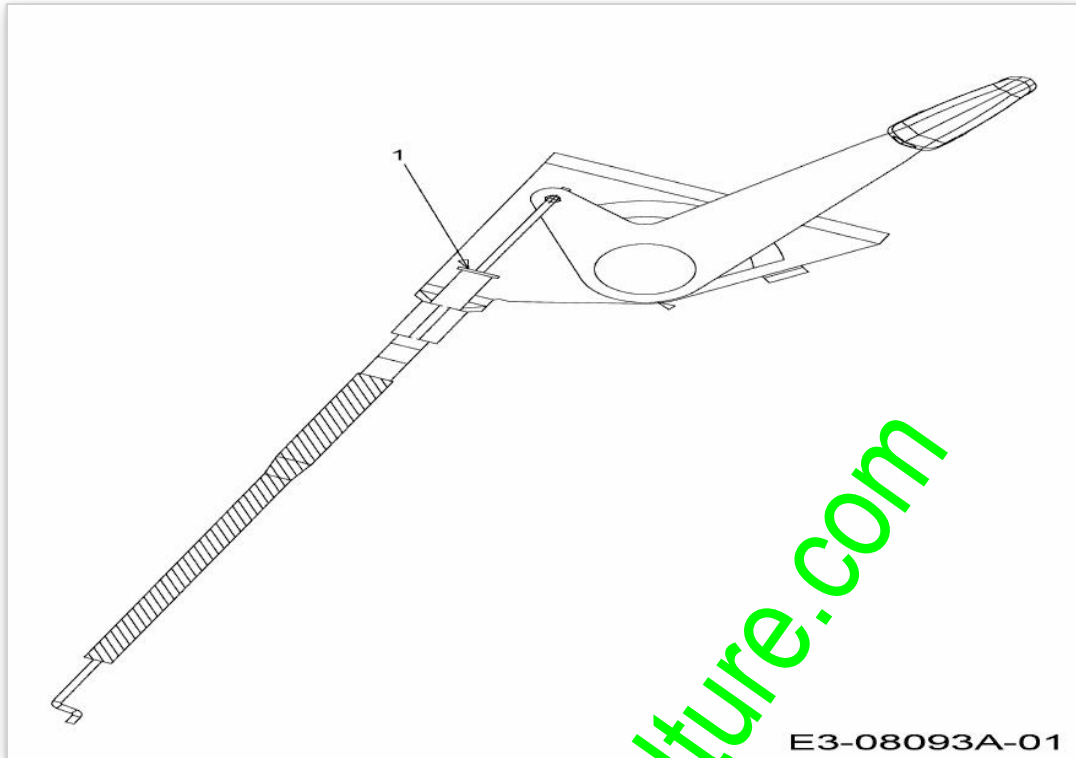

E3-08093A-01

www.emc-motoculture.com

Position	Numéro de lapièce	#	Appellation I	Appellation II
1	746-04591	1	CABLE GAZ	MIT BEDIENUNGSHEBEL

www.emc-motoculture.com

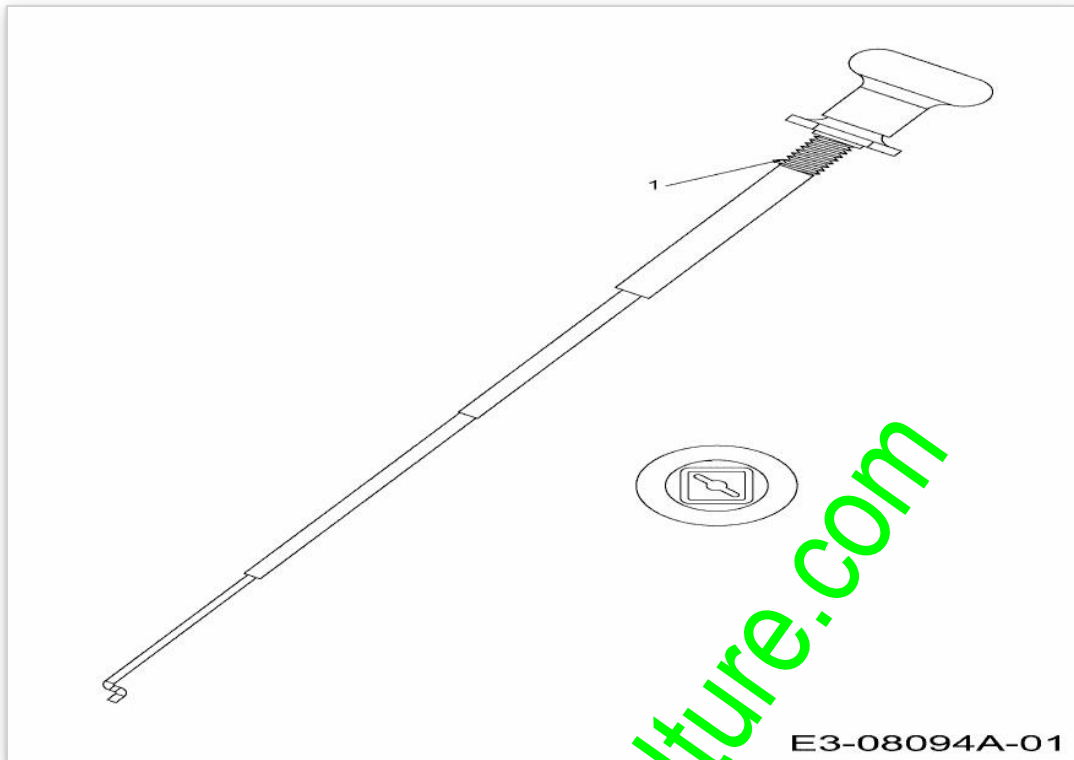

E3-08094A-01

www.emc-motoculture.com

Position	Numéro de lapièce	#	Appellation I	Appellation II
1	746-04847	1	CABLE STARTER	FINISH:ZUGKNOPF SCHWARZ

www.emc-motoculture.com

ab 01.06.2013
from 01.06.2013
à partir du 01.06.2013

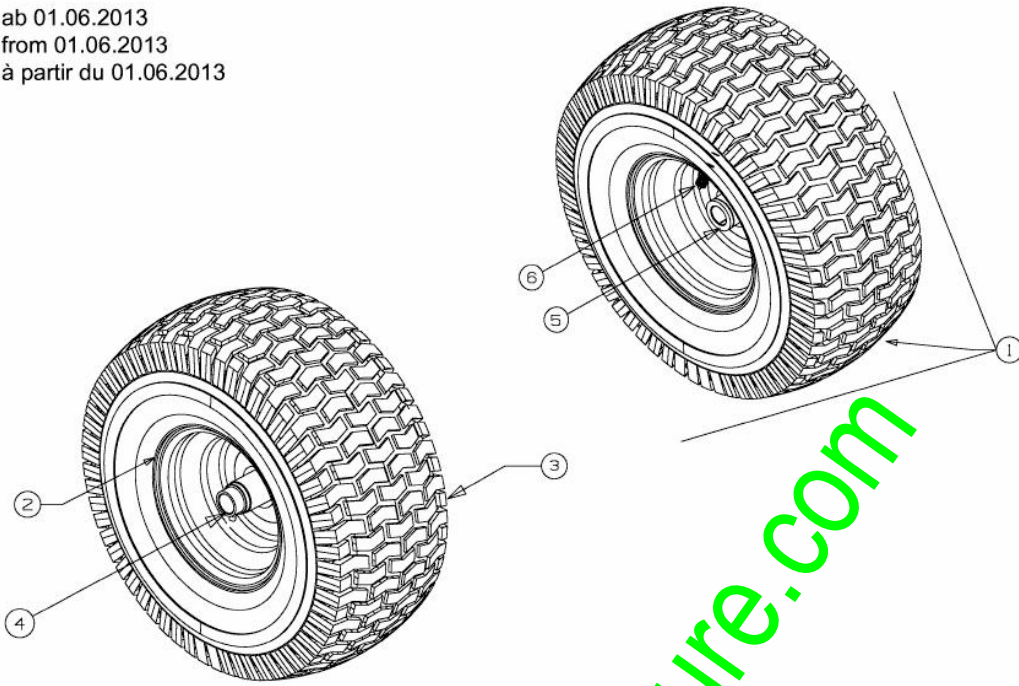

E3-02085C-01

www.emc-motoculture.com

Position	Numéro de lapièce	#	Appellation I	Appellation II
1	634-04086	2	ROUE CPLT	SHL
2	634-04081	2	JANTE CPLT	GLEITLAGER SCHWEIßTEIL
3	734-1731	2	PNEU 15X600X6 DICO MULTI-TRAC	SQ SHOULDER:TURF SAVER
4	741-0990B	2	BAGUE DE ROUE AVEC GRAISSEUR	m.SCHMIERNIPPEL:FINISH SCHWARZ
5	741-0516B	2	BAGUE DE ROUE .760x1.00x1.20	FINISH:SCHWARZ
6	734-0255	2	VALVE:PNEU	TR 412-P / 32.6mm / 934-0255

www.emc-motoculture.com

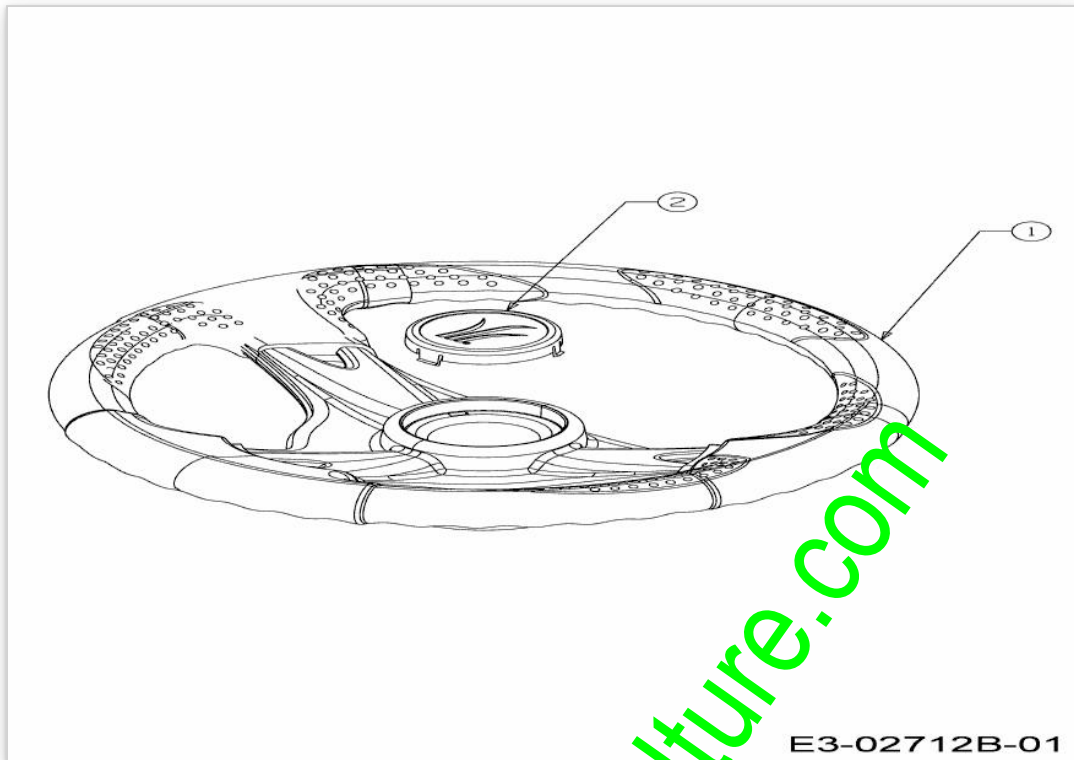

E3-02712B-01

www.emc-motoculture.com

Position	Numéro de lapièce	#	Appellation I	Appellation II
1	631-04008B	1	VOLANT CPL.:3 RAYONS:12"	SOFTGRIP
2	731-04040	1	COUVERCLE DE VOLANT	Ø 60mm:KUNSTSTOFF SCHWARZ

www.emc-motoculture.com

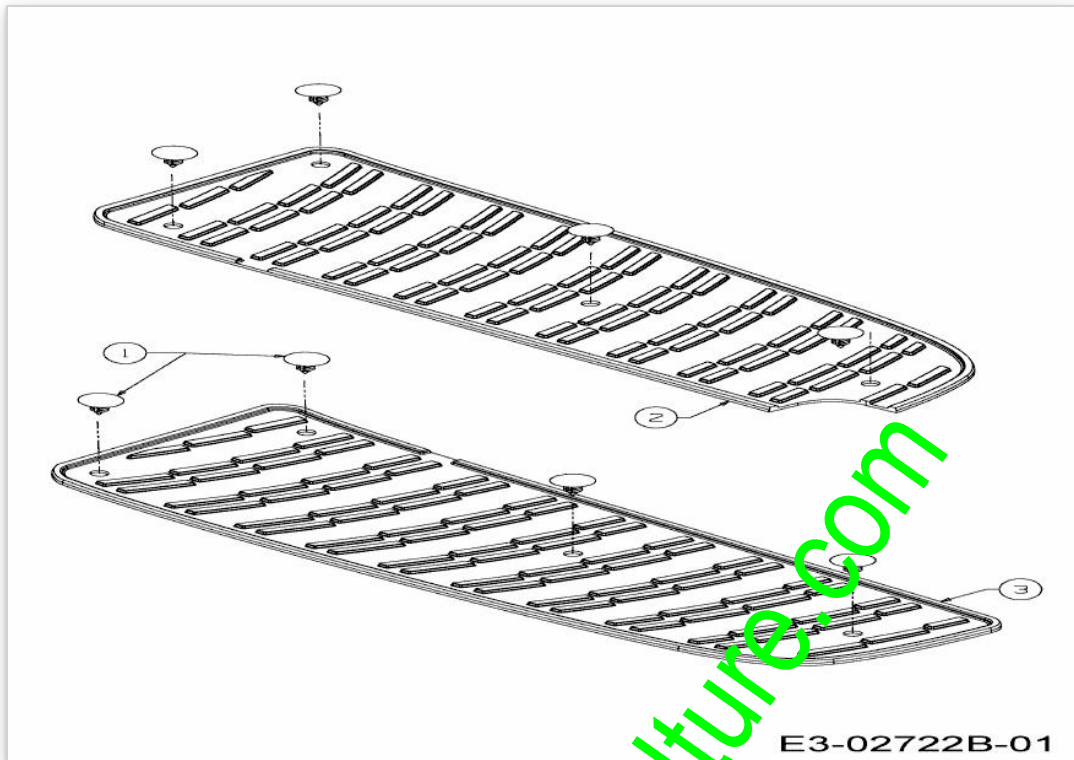

www.emc-motoculture.com

Position	Numéro de lapièce	#	Appellation I	Appellation II
1	726-3046	8	CLIP DE FIXATION:.250 DIA	FINISH:KUNSTSTOFF SCHWARZ
2	735-04047	1	MARCHE PIED GAUCHE	FINISH:SCHWARZ
3	735-04048	1	MARCHE PIED DROITE	FINISH:SCHWARZ

www.emc-motoculture.com

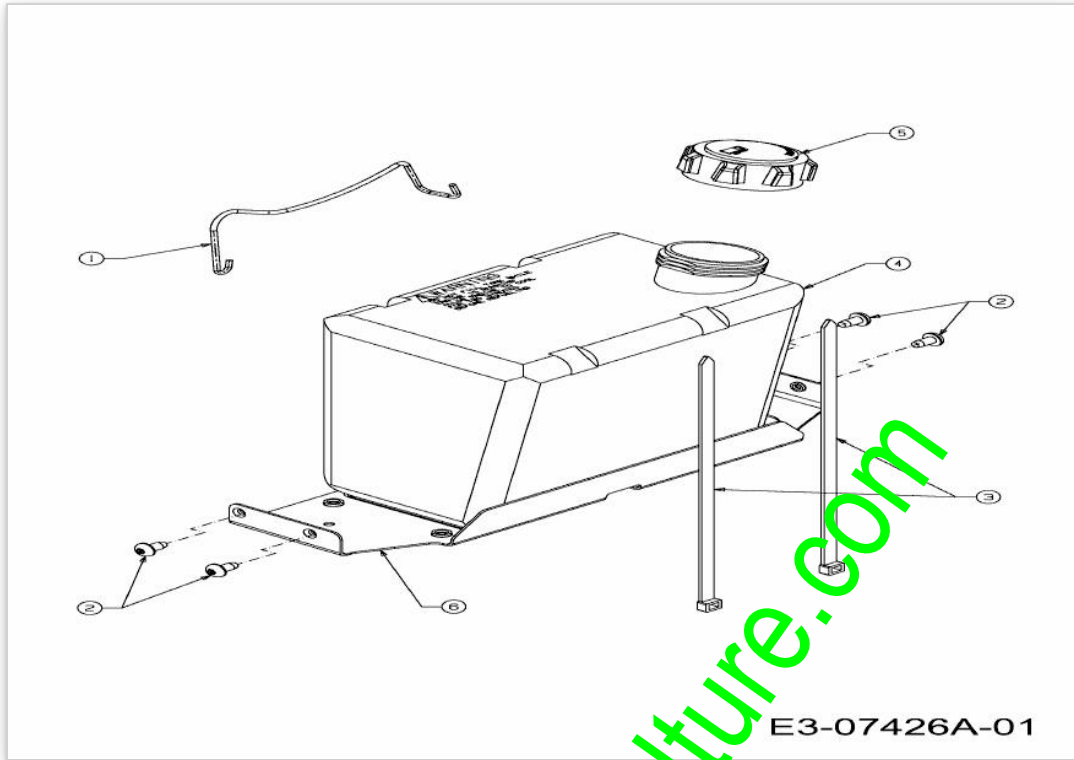

www.emc-motoculture.com

Position	Numéro de pièce	#	Appellation I	Appellation II
1	683-04448637	1	TRINGLE SUPPORT BATTERIE	683-04448-0637
2	710-05070	4	VIS	FINISH: SCHWARZ SPEC 701-01010
3	726-0230	2	COLLIER	FINISH: SCHWARZ
4	751-0553	1	RESERVOIR 5 L ENV.	FINISH: NATUR SIEHE ZG.
5	751-0603A	1	BOUCHON ESSENCE	KUNSTSTOFF SCHWARZ -OBSOLETE-
6	783-07083637	1	SUPPORT DE RESERVOIR ESSENCE	FINISH: LACKIERT MTD QUALITÄT

www.emc-motoculture.com

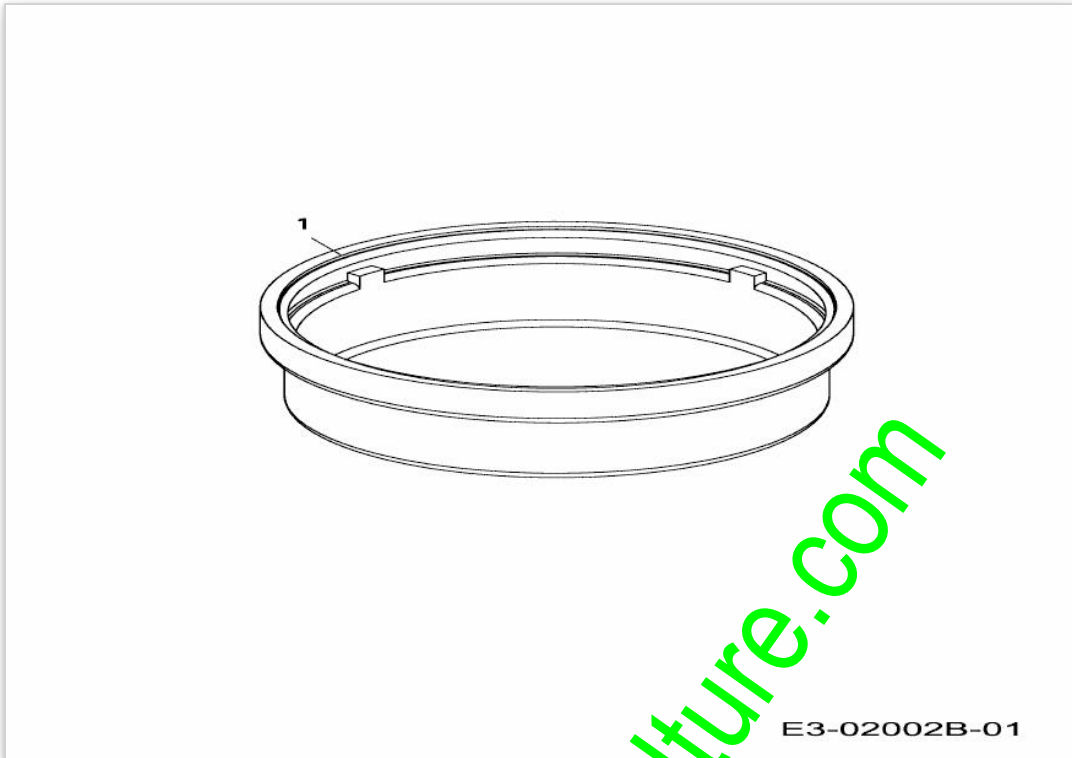

E3-02002B-01

www.emc-motoculture.com

Position	Numéro de lapièce	#	Appellation I	Appellation II
1	731-0484A	2	ENJOLIVEUR DEVANT	KUNSTSTOFF SCHWARZ 931-0484A

www.emc-motoculture.com

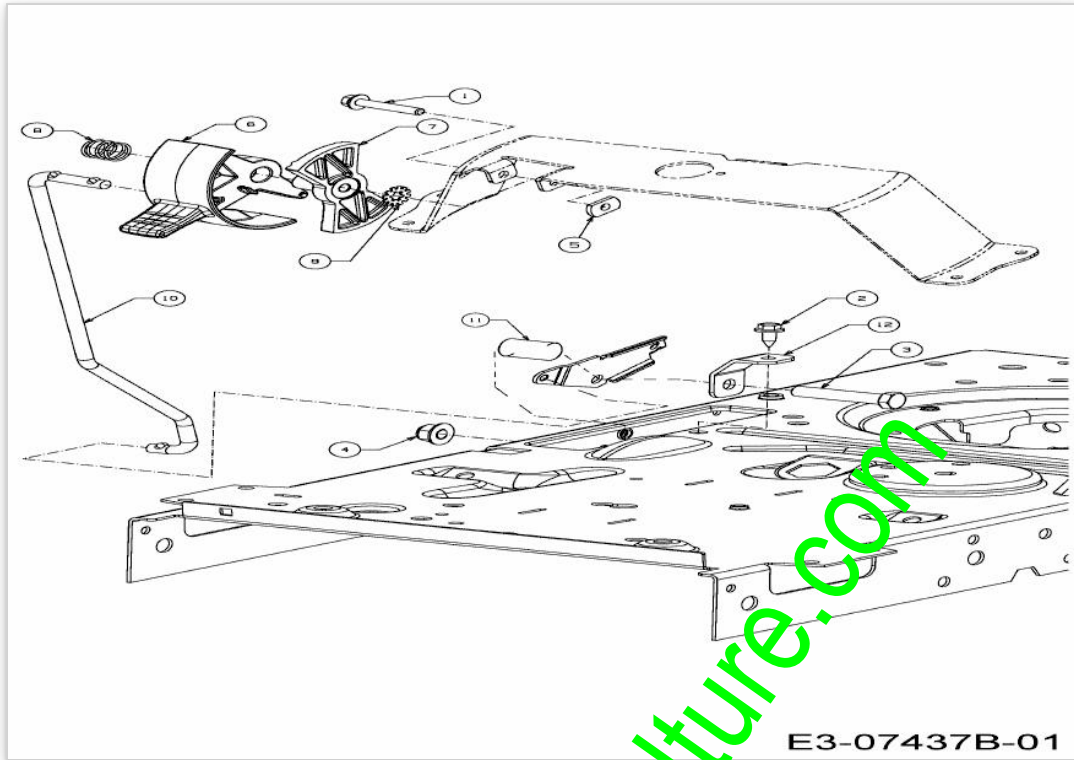

www.emc-motoculture.com

Position	Numéro de pièce	#	Appellation I	Appellation II
1	710-05237	1	VIS	FINISH:MTD SPEC-100015
2	710-1652	1	VIS HEX. TT:1/4-20:.625:HXINDW	FINISH:MTD-SPEC-100016 TYPE 1
3	710-3144	1	VIS HEX.: 3/8-16:2.00:GR5:STD	FINISH:SPEC-100015 910-3144
4	712-04065	1	ECROU HEXAGONAL	FINISH:SPEC-100015 912-04065
5	712-0414	1	ECROU 1/4-20	FINISH:PLAIN
6	731-07885B	1	POIGNEE DE VITESSE	FINISH:KUNSTSTOFF GELB
7	731-07966A	1	SELECTEUR	FINISH PLAIN: (SCHWARZ)
8	732-04877	1	RESSORT	FINISH:MTD SPEC-100015
9	736-3006	1	RONDELLE 1/4 X -75	FINISH:SPEC-100016
10	747-05398	1	TRINGLE DE VITESSE	FINISH:SPEC-100015
11	750-04465C	1	ENTRETOISE	FINISH:GEÖLT
12	783-06823	1	SUPPORT	KONTROLLHEBEL:VERZ.SIEHE ZG.

www.emc-motoculture.com

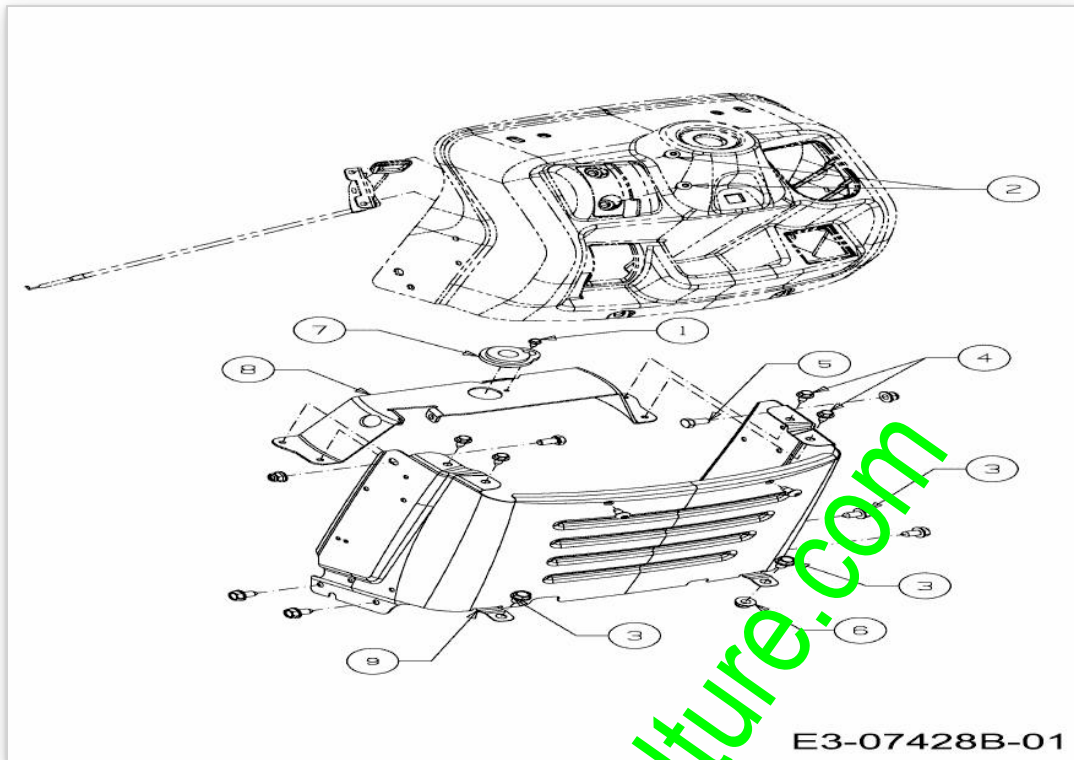

www.emc-motoculture.com

Position	Numéro de lapièce	#	Appellation I	Appellation II
1	710-0224	1	VIS PARK:#10- 16:0.500:HXINDWSH	FINISH:MTD SPEC-100016 TYPE 1
2	710-05070	2	VIS	FINISH:SCHWARZ SPEC 701-01010
3	710-0604A	6	VIS 5/16-18:0.625	FINISH:MTD SPEC-100016 TYPE 1
4	710-1652	4	VIS HEX. TT:1/4- 20:.625:HXINDW	FINISH:MTD-SPEC-100016 TYPE 1
5	710-3025	2	VIS	FINISH:MTD SPEC-100015
6	712-04063	2	ECROU HEX. AVEC FLANC	FINISH:MTD SPEC-100015
7	741-0587	1	SUPPORT	FINISH:NAT UR
8	783-06785A	1		
9	783-06811B	1		

www.emc-motoculture.com

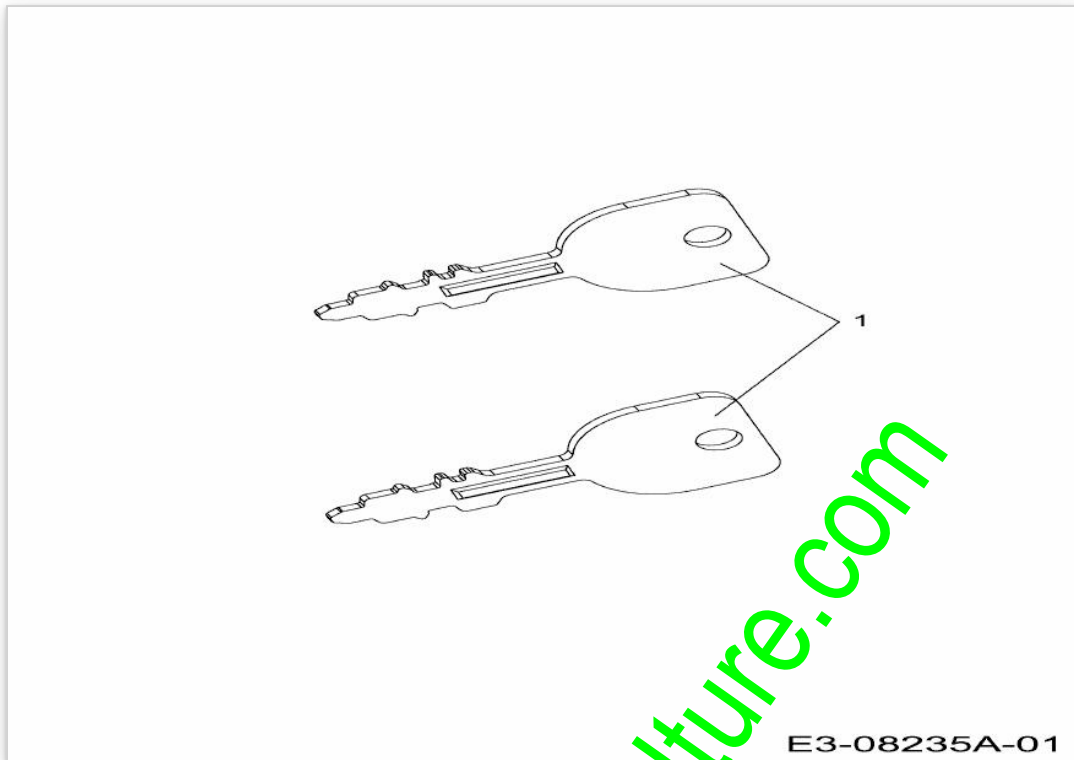

E3-08235A-01

www.emc-motoculture.com

Position	Numéro de pièce	#	Appellation I	Appellation II
1	725-1744A	2	CLE DE CONTACT	FINISH:

www.emc-motoculture.com

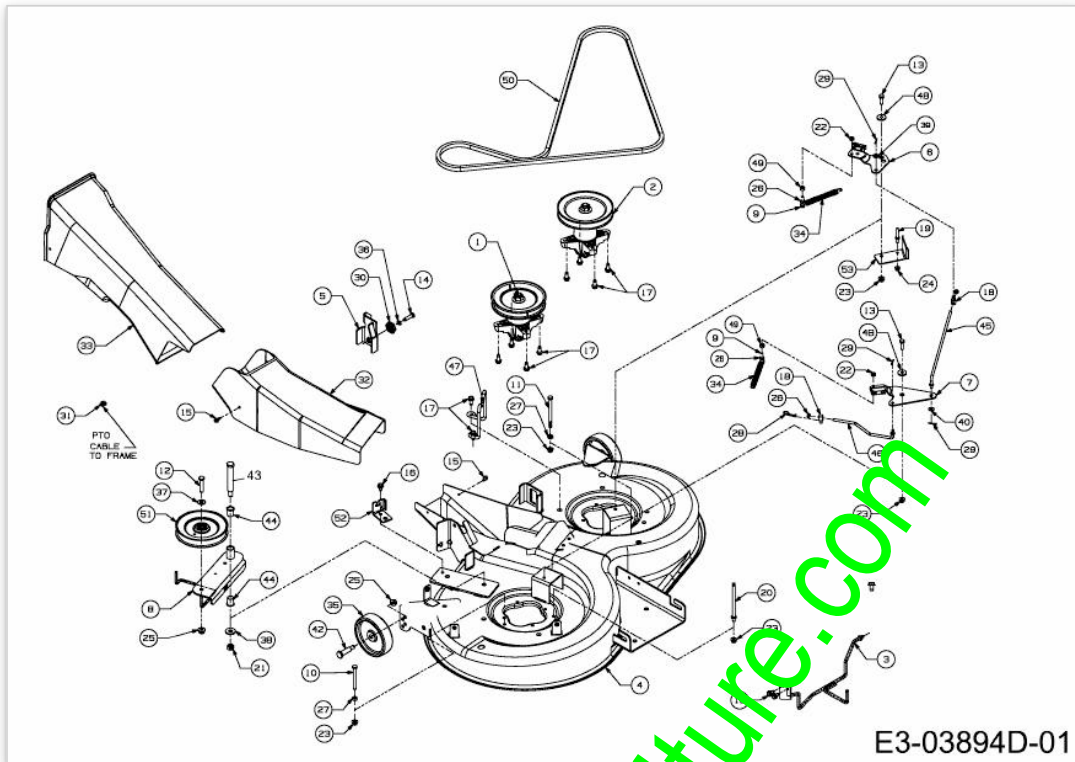

Position	Numéro de pièce	#	Appellation I	Appellation II
1	618-04657A	1		
2	618-0609D	1		
3	647-04143	1	TRINGLE DE PLATEAU	SCHWEISSTEIL:647-04143-Z
4	683-04390	1	DECK VOLLST:105cm:LT-5	SCHWEISSTEIL:FINISH:LACKIERT
5	683-04396	1	SUPPORT PLATEAU	SCHWEISSTEIL:LACKIERT LT-5
6	983-04409	1	FREIN DE LAME	LT5: NIETTEIL
7	683-04417	1	FREIN DE LAME	LT5: NIETTEIL
8	683-04420	1	SPANNROLLENTÄGER VOLLST.	SCHWEISSTEIL:FINISH:LACKIERT
9	710-0106	2	VIS HEX. 1/4-20:1.25:GR5:SPEC	FINISH:MTD SPEC-100015
10	710-0189	1	VIS HEX.:5/16-18x3.00:GR5:STD	FINISH:SPEC-100015 910-0189
11	710-0190	1	VIS	FINISH:SPEC-100015
12	710-0347	1	VIS HEX. 3/8-16:1.75:GR5:STD	FINISH:MTD SPEC-100015
13	710-0376	2	VIS HEX.:5/16-18:1.00:GR5:STD	FINISH:MTD SPEC 701-01006
14	710-0528	1	VIS HEX. 5/16-18:1.25:GR5:STD	FINISH:SPEC-100015 910-0528
15	710-0599	2	VIS A SIX PANS CREUX	FINISH:MTD SPEC-101617
16	710-0607	4	VIS HEX.TT5/16-18:.500HXINDWSh	FINISH:MTD SPEC-100016 TYPE 1
17	710-1260A	10	VIS TT:5/16-18:.750	FINISH:SPEC-100016 TYPE 1
18	711-0736	2	AXE	FINISH:MTD SPEC-100015
19	711-0993	1	GUIDE COURROIE	FINISH:701-01006 911-0993
20	711-1044A	1	GUIDE COURROIE	FINISH:PHOS AND OIL
21	712-0290	1	ECROU 7/16-14	FINISH:MTD SPEC-100015
22	712-0291	2	ECROU EX AF-43013	FINISH:ASTM F1941 FE/ZN 3AN
23	712-04063	5	ECROU HEX. AVEC FLANIC	FINISH:MTD SPEC-100015
24	712-04064	1	ECROU HEXAGONAL	FINISH:SPEC-100015 912-04064
25	712-04065	3	ECROU HEXAGONAL	FINISH:SPEC-100015 912-04065
26	712-3006	4	ECROU HEXAGONAL	FINISH:SPEC-100015
27	712-3010	2	ECROU HEX. 5/16-18:GR5	FINISH:MTD SPEC-100015
28	714-0145	1	GOUPILLE	FINISH:SPEC-701-01006
29	714-0507	3	GOUPILLE FENDUE 3/32 X .750	FINISH:MTD SPEC-100015
30	717-04074	1	PIGNON HAUTEUR PLATEAU	PHOS & SPEC-100015 917-04074
31	729-04033	1	CLIP SERRE CABLE	729-04033
32	731-06251	1	CANAL D'EJECTION INFERIEUR	FINISH:SCHWARZ
33	731-06252	1	CANAL D'EJECTION SUPERIEUR	FINISH:SCHWARZ
34	732-0604A	2	RESSORT	FINISH:PHOS AND OIL
35	734-0973	4	ROULETTE DE PLATEAU	FINISH:KUNSTSTOFF SCHWARZ
36	736-0119	2	RONDELLE	FINISH:MTD SPEC-100016
37	736-0300	1	RONDELLE	FINISH:MTD SPEC-100015
38	736-04097A	1	RONDELLE:PLATE:11.65x28.75x3mm	FINISH:MTD SPEC-100015
39	736-0700	1	RONDELLE A8.4 DIN 125	MTD SPEC-100015 24.6481.18
40	736-3020	1	RONDELLE	FINISH:MTD SPEC-100015
42	738-0373	2	VIS A EPAULE .496x1.525:3/8-16	FINISH:MTD SPEC-100015
43	738-0476	1	VIS A EPAULE .625x3.50:7/16-14	FINISH:SPEC-100015
44	741-0591	2	BAGUE	FINISH:NATUR 941-0591

Position	Numéro de lapièce	#	Appellation I	Appellation II
45	747-04775	1	TIGE DE FREIN	FINISH:SPEC-100015
46	747-04776	1	TIGE DE FREIN	FINISH:MTD SPEC-100015
47	747-04840	1	GUIDE COURROIE	FINISH:SPEC-100015
48	748-0234	2	RONDELLE EPAULEE	FINISH:ROSTPREVENTION
49	750-05381	2	ENTRETOISE	FINISH:IN ÖL SAE 30 GEDIPPT
50	754-04174	1	COURROIE DE COUPE	FINISH:
51	756-04050	1	POULIE DE COURR. TR. Ø 6.0"DIA	KUGELGELAGERT:SCHWARZ LACKIERT
52	783-04740	1	FÜHRUNGSBL:BOWDENZUG:DECKBETÄT	FINISH:LACKIERT
53	783-05868	1	CARTER COURROIE	FINISH:LACKIERT MTD STD

www.emc-motoculture.com

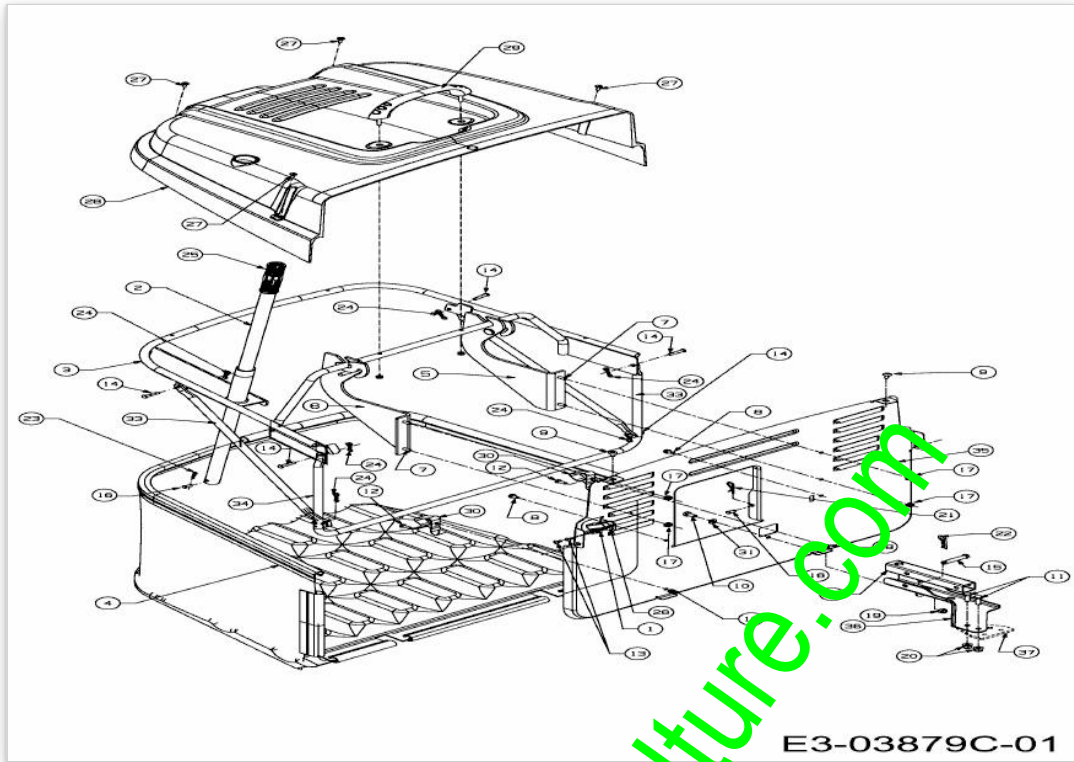

www.emc-motoculture.com

Position	Numéro de pièce	#	Appellation I	Appellation II
1	17962	1	PLAQUE DE SUPP. P. COMMUTATEUR	FINISH:WIE GESTANZT
2	649-04052	1	STAHLROHR VST:HEBEL:GRSBG:500	SCHWEISSTEIL:FINISH:LACKIERT
3	649-04076A-S	1	ARMATURE DE BAC	SCHWEISSTEIL:FINISH LACKIERT
4	664-04085	1	TISSU BAC DE RAMASSAGE	700:FINISH SCHWARZ
5	683-04421	1	EINHÄNGEKONSOLE VOLLST:LINKS	SCHWEISSTEIL:FINISH:LACKIERT
6	683-04422	1	EINHÄNGEKONSOLE VOLLST:RECHTS	SCHWEISSTEIL:FINISH:LACKIERT
7	710-04666	4	VIS HEXAGONALE	FINISH:MTD SPEC-100015
8	710-0599	2	VIS A SIX PANS CREUX	FINISH:MTD SPEC-101617
9	710-1017	2	VIS	FINISH:MTD SPEC-100016
10	710-1376	1	VIS A SIX PANS CREUX	FINISH:SPEC-100015 21.1441.68
11	710-1682	2	VIS	FINISH:SPEC-100015 21.1441.72
12	710-1690	2	VIS	MTD SPEC-100015 21.1441.46
13	710-1760	2	VIS	PHOS & OIL (ähnlich 710-0779A)
14	711-04138	6	GOUJON ; ÜPINGLER .25DIAX1.25L	FINISH:MTD SPEC-100015
15	711-0679A	1	GOUJON ; ÜPINGLER	GR5:FINISH MTD SPEC-100015
16	711-0701	3	GOUJON	FINISH:MTD SPEC-100015
17	712-04064	4	ECROU HEXAGONAL	FINISH:SPEC-100015 912-04064
18	712-0691	4	ECROU HEXAGONAL	MTD SPEC-100015 24.1426.14
19	712-0692	1	ECROU HEXAGONAL 24.1426.18	FINISH:SPEC-100015 24.1426.18
20	712-0714	2	ECROU	FINISH:MTD SPEC-100015
21	714-0145	2	GOUPILLE	FINISH:SPEC-701-01006
22	714-0147	1	GOUPILLE ; RESSORT:.125 X 1.75	FINISH:MTD SPEC-701-01006
23	714-04033	1	GOUPILLE FENDUE .072 x.92 LG	FINISH: MTD SPEC-100016
24	714-04040	6	GOUPILLE	FINISH:ASTM F1941 FE/ZN 3AN
25	720-0204	1	POIGNEE:1.0 ID x 4.7 LG	FINISH:SCHWARZ
26	725-04039	1	SECURITE	FINISH:GRAY/BLACK 925-04039
27	728-04044	4	RIVET	WÜRTH #093614816
28	731-06106	1	COUVERCLE DE BAC	FINISH:KUNSTSTOFF SCHWARZ
29	731-06163	1	POIGNEE	FINISH:SCHWARZ
30	732-0838A	2	RESSORT CLIPS DE BAC	VERSCHLUSS:FINISH SPEC-100015
31	736-0700	1	RONDELLE A8.4 DIN 125	MTD SPEC-100015 24.6481.18

Position	Numéro de lapièce	#	Appellation I	Appellation II
32	749-04013A	1	4KT- ROHR:ANHÄNGEKUPPLUNG	30x30mmx179.39mm LG ST37:LACK
33	749-04108	2	KREUZ- VERBINDUNGSROHR:BAG 250L	FINISH:LACKIERT 500 MR
34	749-04418	1	ROHRRAHMEN:VORN:200L	FINISH:LACKIERT
35	783-05731	1	HECKPLATTE:E/N-DECK:LT5	FINISH:LACKIERT MTD QUALITÄT
36	783-05801A	1	SUPPORT	FINISH:LACKIERT MTD QUALITÄT
37	783-1363	1	PLAQUE SUPPORT	FINISH:BLAU CHROMATIEREN *

www.emc-motoculture.com

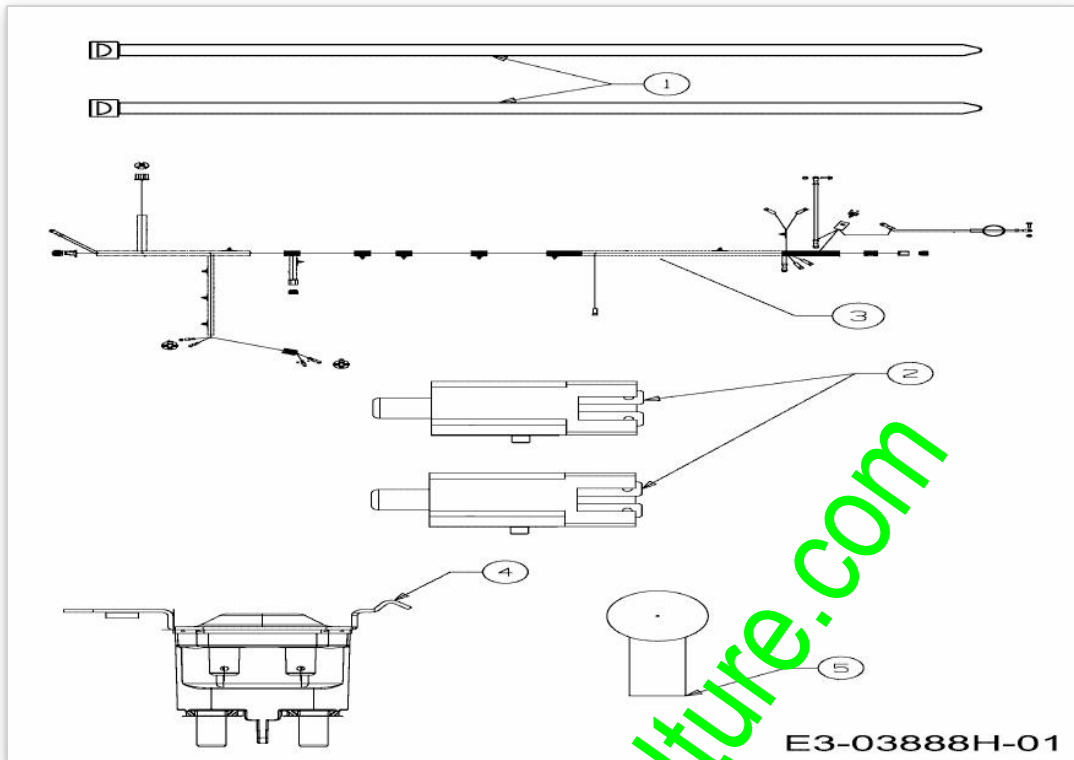

www.emc-motoculture.com

Position	Numéro de pièce	#	Appellation I	Appellation II
1	725-0157	2	COLLIER DE SERRAGE3/16X0.5X7.4	MATERIAL:NYLON-SCHWARZ
2	725-04363	2	SECURITE EMBRAYAGE	FINISH:SIEHE ZG.
3	725-05502	1	FAISCEAU ELECTRIQUE	RR BAG
4	725-06153	1	SOLENOIDE	FINISH:
5	725-3237	1	COUVERCLE POLE / ROUGE	BATTERIE FINISH:ROT

www.emc-motoculture.com

Position	Numéro de lapièce	#	Appellation I	Appellation II
4	725-05502	1	FAISCEAU ELECTRIQUE	RR BAG

www.emc-motoculture.com

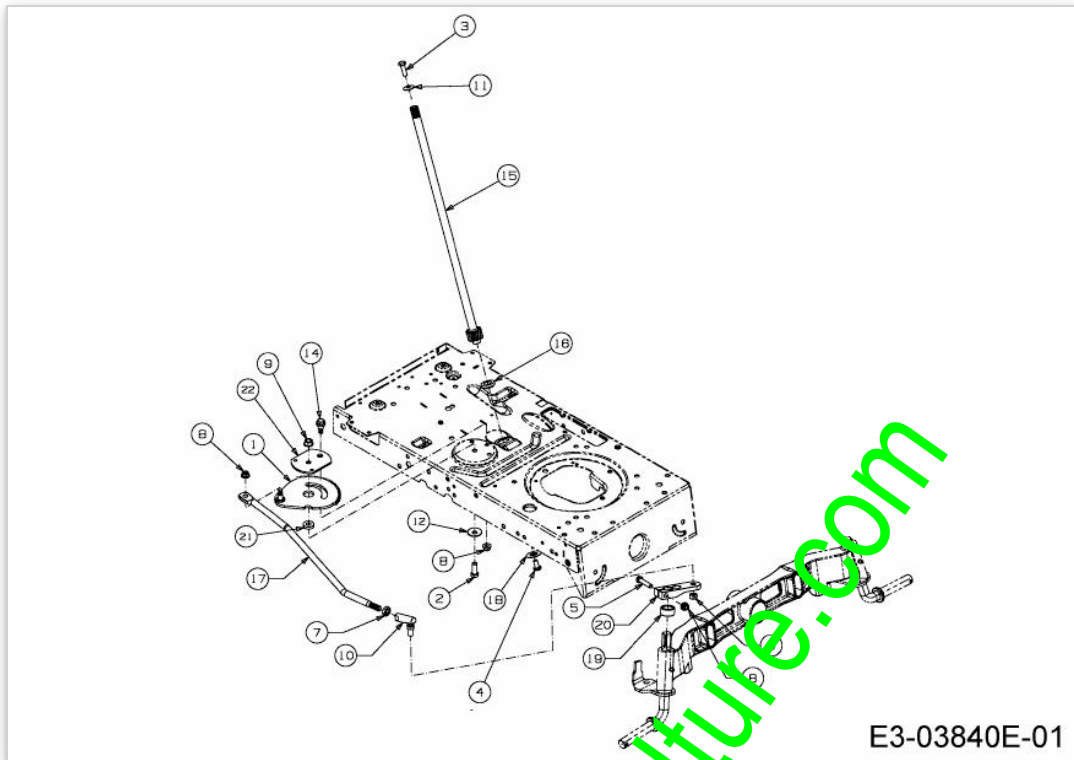

www.emc-motoculture.com

Position	Numéro de pièce	#	Appellation I	Appellation II
1	617-04094	1	SEGMENT DE DIRECTION	SCHWEISSTEIL:PHOS & OIL
2	710-0514	1	VIS HEX.:3/8-16:1.00:GR5:STD	FINISH:MTD SPEC-100015
3	710-0643	1	VIS HEX.: 5/16-18:1.00:GR5	FINISH:MTD SPEC-100015
4	710-1309	1	VIS	FINISH:MTD SPEC-100015
5	710-3180	1	VIS HEX. 5/16-18:1.75:GR5:STD	FINISH:SPEC-100015
6	712-0214	1	ECROU	FINISH:SPEC-100015
7	712-0240	1	ECROU HEX.: 7/16-20:GR2	FINISH:MTD SPEC-100015
8	712-04063	3	ECROU HEX. AVEC FLANC	FINISH:MTD SPEC-100015
9	712-0431	1	ECROU STOP 3/8-16:GRF	FINISH:MTD SPEC-100015
10	723-0448A	1	ROTULE DE DIRECTION 7/16-20	FINISH:MTD SPEC-100015
11	736-0242	1	RONDELLE CONIQUE.340X.872X.060	FINISH:MTD SPEC-100016
12	736-0331	1	RONDELLE CONIQUE	FINISH:MTD SPEC-100016
14	738-04141	1	AXE	FINISH:SPEC-100015
15	738-05078	1	ARBRE DE DIRECTION	FINISH:PHOS & OIL
16	741-04124	1	PALIER DE BRIDE	FINISH:PLAIN
17	747-05464	1	TRINGLE DE DIRECTION	FINISH:MTD SPEC-100015
18	748-0389	1	BAGUE	FINISH:GEÖLT
19	748-04068	1	DOUILLE .71 ODX.125 ODX.56 LG	FINISH:SPEC-100015
20	748-04278-Z	1	BIELETTE DE DIRECTION	FINISH:MTD-SPEC-100015
21	750-06192	1	ENTRETOISE	FINISH:DAMPFBEHANDELT
22	783-08577	1	PLAQUE STABILISATEUR DE SEGMENT	FINISH:PHOS & OIL

www.enj-motoculture.com

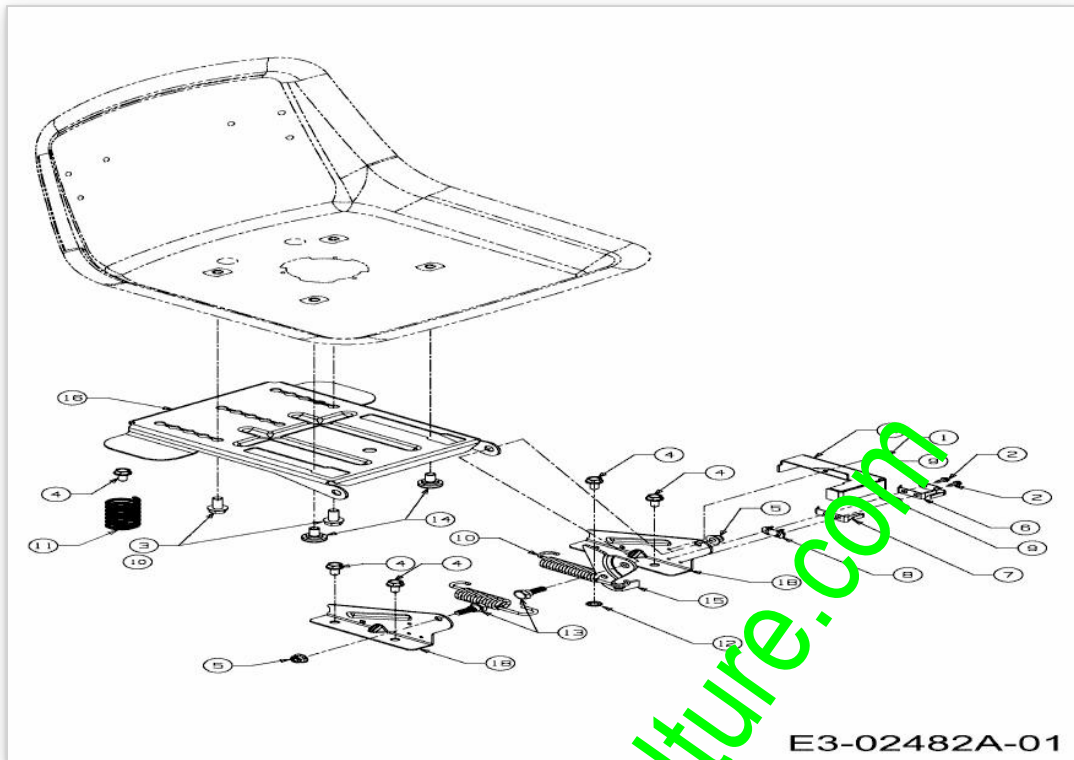

www.emc-motoculture.com

E3-02482A-01

Position	Numéro de pièce	#	Appellation I	Appellation II
1	710-0224	1	VIS PARK:#10-16:0.500:HXINDWSH	FINISH:MTD SPEC-100016 TYPE 1
2	710-0227	2	VIS	FINISH:MTD SPEC-100016 TYPE 1
3	710-04482	2	VIS:3/8-16: .875:GR5:STD	FINISH:MTD SPEC-100015
4	710-04484	6	VIS HEX. TT:5/16-18:.750:HXIND	FINISH:MTD SPEC-100016 TYPE 1
5	712-04063	2	ECROU HEX. AVEC FLANC	FINISH:MTD SPEC-100015
6	725-1303	1	RESSORT DE SURETE SIEGE	SI.-SCHALTER SITZ:SPEC-100015
7	725-1439	1	RESSORT SURETE DE SIEGE	SI.-SCHALTER SITZ:SPEC-100015
8	726-0278	1	PLAQUE D'ISOLATION	FINISH:NATUR ODER SCHWARZ
9	726-0279	2	PLAQUE D'ISOLATION	FINISH:NATUR ODER SCHWARZ
10	732-04309	1	RESSORT	FINISH:MTD STD 701-01006
11	732-0735A	2	RESSORT DE SIEGE	FINISH:MTD SPEC 101616
12	736-0607	1	RONDELLE	FINISH:MTD SPEC-100016
13	738-0296	2	AXE EPAULE	FINISH:SPEC-100015
14	738-04012B	2	SCHULTERSCHIFTE .625x.145:3/8-16	FINISH:GELBVERZINKT 701-01000
15	783-0209D	1	SUPP. SIEGE	FINISH:SPEC-100016
16	783-04081D-S	1	PLAQUE DE SIEGE NOIRE	SCHWARZ
17	783-04877A	1	783-06279	FINISH:LACKIERT
18	783-1489D	2	783-1489B-4015 / FEUERROTQ	

www.emc-motoculture.com

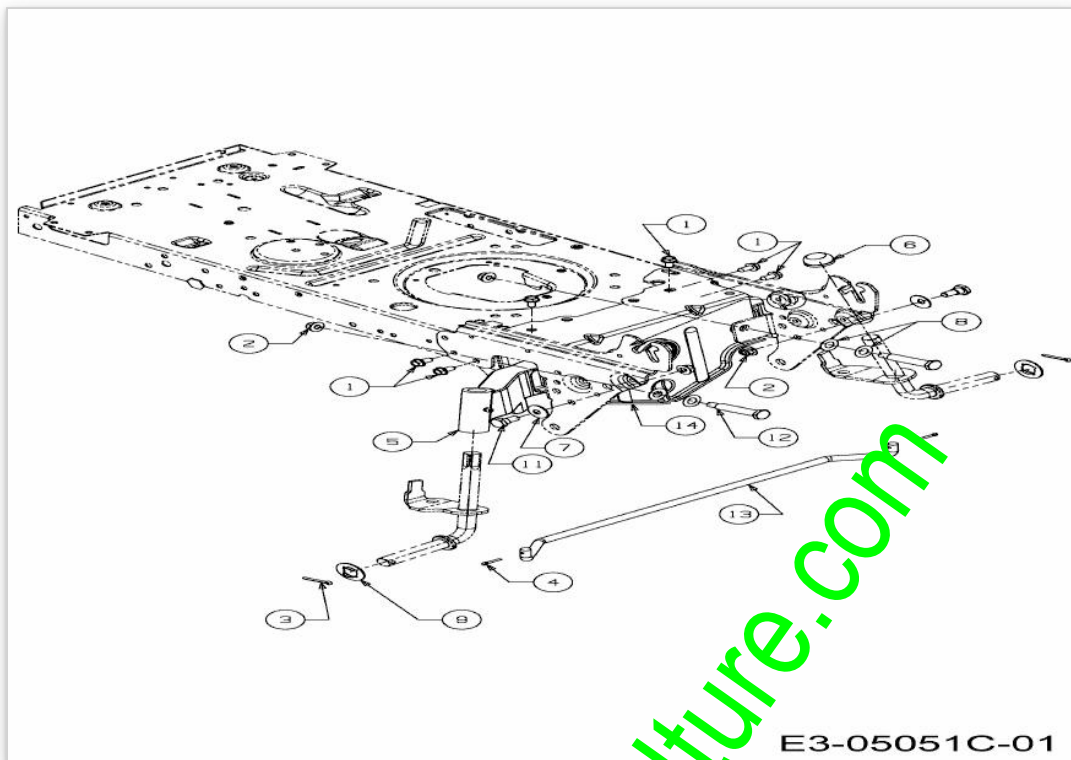

www.emc-motoculture.com

Position	Numéro de pièce	#	Appellation I	Appellation II
1	710-04484	6	VIS HEX. TT:5/16-18:.750:HXIND	FINISH:MTD SPEC-100016 TYPE 1
2	712-04065	4	ECROU HEXAGONAL	FINISH:SPEC-100015 912-04065
3	714-0162	2	GOUPILLE FENDUE 5/32:1.25	FINISH:MTD SPEC-100015
4	714-0474	2	GOUPILLE	FINISH:MTD SPEC-100015
5	719-04350	1	ESSIEU FONTE	FINISH:SCHWARZ LACKIERT
6	726-0341	1	CAPUCHON CLIPS	FINISH:SCHWARZ
7	736-0331	2	RONDELLE CONIQUE	FINISH:MTD SPEC-100016
8	736-0369	4	RONDELLE	FINISH:SEHE ZG. 936-0369
9	736-04228A	2	RONDELLE	FINISH:MTD SPEC-100015
11	738-0143	2	VIS EPAULEE	FINISH:MTD SPEC 100015 (EU)
12	738-04128	2	VIS A EPAULE .500x2.38:3/8-16	FINISH:MTD SPEC-100015
13	747-04772	1	TRINGLE DE ROUE:LT5	FINISH:SPEC-100015
14	783-05326B-S	1	SUPPORT AVANT	FINISH:LACKIERT MTD QUALITÄT

www.emc-motoculture.com

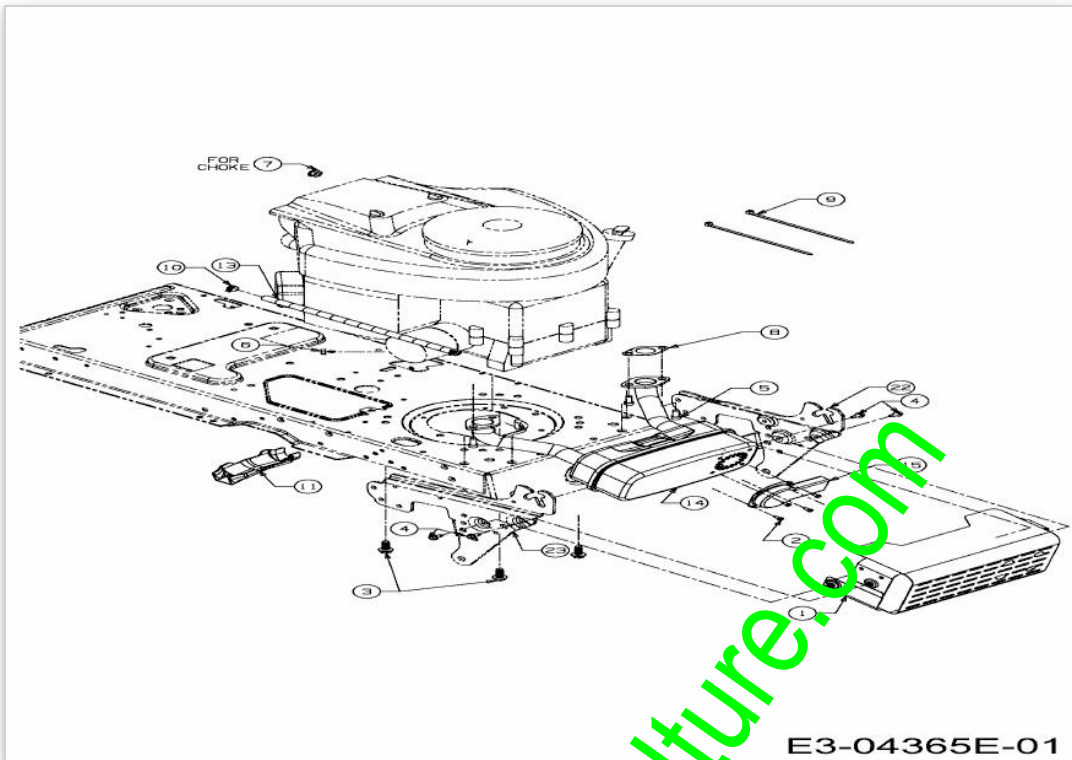

www.emc-motoculture.com

Position	Numéro de pièce	#	Appellation I	Appellation II
1	710-0227	4	VIS	FINISH:MTD SPEC-100016 TYPE 1
2	710-04683B	4	VIS	FINISH:MTD SPEC 701-01002
3	710-0599	4	VIS A SIX PANS CREUX	FINISH:MTD SPEC-101617
4	710-0604A	2	VIS 5/16-18:0.625	FINISH:MTD SPEC-100016 TYPE 1
5	710-1314A	2	VIS HEX. INT. 5/16-18:.75:GR8	FINISH: GM4435M CODE A
6	712-0271	1	ECROU 1/4-20"+ DISQUE DENTE	FINISH:MTD SPEC-100016 GR5
7	712-3005	1	ECROU AVEC FLANC:3/8-16:GR5	FINISH:SPEC 100015 912-3005
8	721-0208	1	JOINT ECHAP B/S MONO CYLINDRE	FINISH:E&S #272293
9	725-0157	1	COLLIER DE SERRAGE3/16X0.5X7.4	MATERIAL:NYLON-SCHWARZ
10	726-0205	2	COLLIER DE SERRAGE DE BOYAU	FINISH:PHOS UND GELB LACKIERT
11	731-05628	1	GOUTIERE VIDANGE D HUILE	FINISH:SCHWARZ
13	751-0535	1	TUYAU ESSENCE NOIR	Ø12,7+/-0,13 / Ø6,35+/-0,13
14	751-0564B	1	DEFLECTEUR ECHAPPEMENT	MATERIAL:ALUMINIERTER STAHL
15	751-0617B	1	POT D'ÜCHAPPEMENT	
16	751-0619B	1	PIPE D ECHAPPEMENT	MIT FLANSCH:FINISH PLAIN
17	783-0615E	1	783-0615E-RG	FINISH:LACKIERT

www.emc-motoculture.com

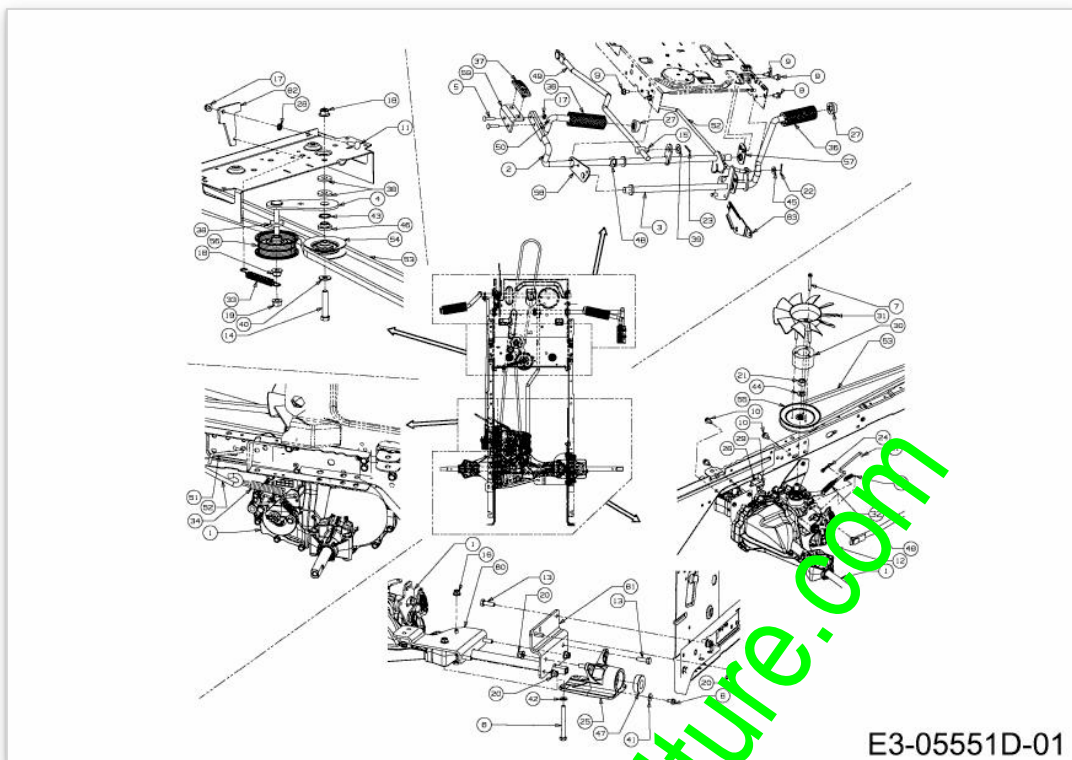

www.emc-motoculture.com

Position	Numéro de lapièce	#	Appellation I	Appellation II
1	618-04911	1	PONT HYDRO HG T2	FINISH: N/A
2	647-04198	1	PEDALWELLE VST:HYDRO HG TS LT5	SCHWEISSTEIL:647-04198-Z
3	647-04215	1	LEVIER DE FREIN	SCHWEISSTEIL:LACKIERT
4	683-0604A	1	CADRE SUPP. CPL.:GAL. TEND. DB	SCHWEISSTEIL:683-0604A-Z
5	710-0111	2	VIS 1/4-20X1,25"	FINISH:MTD SPEC-100015
6	710-0189	2	VIS HEX.:5/16-18x3.00:GR5:STD	FINISH:SPEC-100015 910-0189
7	710-05067	3	VIS	FINISH:MTD SPEC-100016 TYPE 1
8	710-0599	1	VIS A SIX PANS CREUX	FINISH:MTD SPEC-101617
9	710-0604A	5	VIS 5/16-18:0.625	FINISH:MTD SPEC-100016 TYPE 1
10	710-0607	4	VIS HEX.TT5/16-18:.500HXINDWSh	FINISH:MTD SPEC-100016 TYPE 1
11	710-0932A	1	VIS	FINISH:MTD SPEC-100015
12	710-1003	1	VIS HEX.:B:#10-16:0.625:HX:SP	SPEC-100016 TYPE 1 910-1003
13	710-1682	6	VIS	FINISH:SPEC-100015 21.1441.72
14	710-3144	1	VIS HEX.: 3/8-16:2.00:GR5:STD	FINISH:SPEC-100015 910-3144
15	711-04036	1	AXE	FINISH:SPEC-100015 911-04036
16	712-04063	2	ECROU HEX. AVEC FLANC	FINISH:MTD SPEC-100015
17	712-04064	3	ECROU HEXAGONAL	FINISH:SPEC-100015 912-04064
18	712-04065	2	ECROU HEXAGONAL	FINISH:SPEC-100015 912-04065
19	712-0431	1	ECROU STOP 3/8-16:GRF	FINISH:MTD SPEC-100015
20	712-0714	6	ECROU	FINISH:MTD SPEC-100015
21	712-3066	1	ECROU HEXAGONAL 1/2-20 GR5	FINISH:MTD SPEC-100015
22	714-0111	1	GOUPILLE FENDUE 7/32x1.0"	FINISH:MTD SPEC-100015
23	714-0115	1	GOUPILLE FENDUE 1/8 x 1.0	FINISH:MTD SPEC-100015
24	714-04040	1	GOUPILLE	FINISH:ASTM F1941 FE/ZN 3AN
25	719-0534	1	BLOC EMBASE	FINISH:PLAIN
26	725-05050	1	SUPPORT DE SECURITE	FINISH:SPEC-100015
27	726-0214	2	BOUCHON	FINISH:SCHWARZ
28	726-0233	1	RONDELLE	MECHANISCH KLAR VERZINKT
29	726-04089	1	PLAQUE ISOLANTE	FINISH:NATUR ODER SCHWARZ
30	731-07514	1	ENTRETOISE PLASTIQUE	FINISH:KUNSTSTOFF SCHWARZ (DÖ)
31	731-1449A	1	HELICE DE REFROIDISSEMENT	FINISH:WEISS
32	732-0209	1	RESSORT DE TRACT.	FINISH:MTD 701-01006 932-0209
33	732-0429A	1	RESSORT	FINISH:PHOSPHATE AND OIL
34	732-0716D	1	RESSORT	FINISH:MTD STD 701-01006
35	732-3118	1	RESSORT	FINISH:SPEC-100015
36	735-0239	2	CAOUTCHOUC/PEDALE 4;0 LG	FINISH:SCHWARZ
37	735-04113	1	CAOUTCHOUC DE PEDALE	FINISH:SCHWARZ
38	736-0258	3	RONDELLE PLATE .385x1.0x.135	FINISH:SPEC-100015 936-0258
39	736-0272	1	RONDELLE .510x1.00X.060	SPEC 100015 oder SPEC-101616
40	736-0300	1	RONDELLE	FINISH:MTD SPEC-100015
41	736-0685	1	RONDELLE	MTD SPEC-100015 24.6486.16

Position	Numéro de pièce	#	Appellation I	Appellation II
42	736-0700	2	RONDELLE A8.4 DIN 125	MTD SPEC-100015 24.6481.18
43	736-0773	1	RONDELLE	24.6273.68
44	736-0921	1	RONDELLE GROWER	FINISH:MTD SPEC-100016
45	736-3008	1	RONDELLE	FINISH:MTD SPEC-100015
46	738-0372B	1	RONDELLE EPAULEE	FINISH:GEÖLT
47	741-0998	1	ROULEM. j BIL. .75IDX40ODX12	400er HYDRO GETRIEBE
48	741-3065B	1	BAGUE HEXAGONALE RAINUREE	GESCHLITZT:FINISH SCHWARZ
49	747-05253	1	TRINGLE COMMANDE DE BOITE	FINISH:SPEC 100015/ E-TEIL-SET
50	747-05265	1	LEVIER	FINISH:LACKIERT
51	747-05298	1	TRINGLE	FINISH:SPEC-100015
52	747-05313	1	TRINGLE DE FREIN	FINISH:SPEC-100015 or ECOAT
53	754-04258	1	COURROIE DE TRANSMISSION	POLY
54	756-0236	1	GALET TENDEUR	SCHWARZ LACKIERT ODER VERZINKT
55	756-1052	1	POULIE PLATE BOITE DE V	FINISH:SPEC-100015
56	756-3054A	1	POULIE TENDEUR	FINISH:VERZINKT SPEC-100015
57	783-04536B	1	STÜTZBLECH:PEDAL:LT-5	FINISH:LACKIERT MTD QUALITÄT
58	783-05809B	1	FINISH:LACKIERT 783-05809B*	FINISH:LACKIERT 783-05809B*
59	783-05867	1	WINKELBLECH:REV:PEDAL:AUTOMATI	FINISH:LACKIERT
60	783-06563	1	SUPPORT	FINISH:LACKIERT 783-06563*
61	783-06577	1	SUPPORT	FINISH:LACKIERT
62	783-06582	1	PATTE	FINISH:LACKIERT
63	783-07369	1		

www.emc-motoculture.com

Position	Numéro de lapièce	#	Appellation I	Appellation II
1	710-04607	1	VIS POULIE MOTEUR	FINISH:MTD SPEC-100015
2	736-0171	1	RONDELLE GROWER	FINISH:MTD SPEC-100016
3	736-0322	1	RONDELLE .450 X 1.250 X .164	FINISH:SPEC-100016 936-0322
5	756-04427	1	POULIE MOTEUR	HYDRO:FINISH SPEC 100015

www.emc-motoculture.com

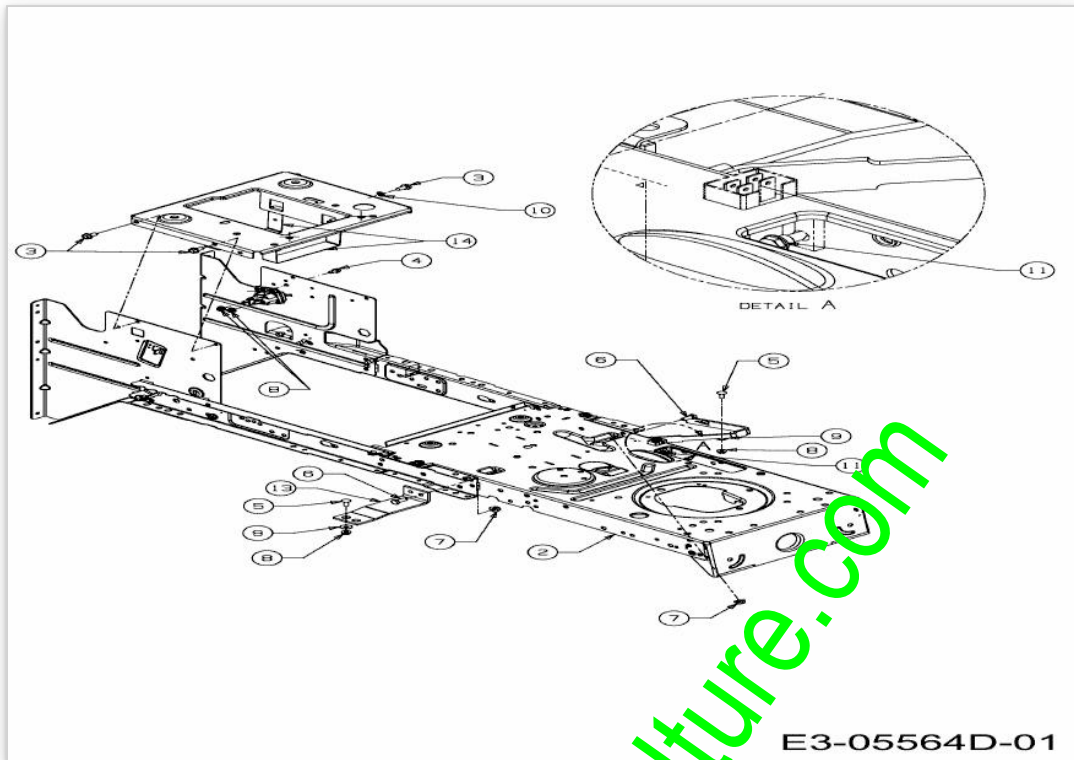

E3-05564D-01

Position	Numéro de pièce	#	Appellation I	Appellation II
1	683-04195	1	STÜTZKONSOLE-LI.SITZWANNE LT5	SCHWEISSTEIL
2	683-04681B-S	1	RAHMEN VOLLST:LT-5:HYDRO	SCHWEISSTEIL:FINISH:LACKIERT
3	710-04484	4	VIS HEX. TT:5/16-18:.750:HXIND	FINISH:MTD SPEC-100016 TYPE 1
4	710-0599	1	VIS A SIX PANS CREUX	FINISH:MTD SPEC-101617
5	710-0703	2	VIS	FINISH:MTD SPEC-100015
6	710-3008	2	VIS 5/16-18:.75:GR5:STD	SPEC-701-01006 or.SPEC-100015
7	712-04063	3	ECROU HEX. AVEC FLANC	FINISH:MTD SPEC-100015
8	712-04064	4	ECROU HEXAGONAL	FINISH:SPEC-100015 912-04064
9	736-0173	2	RONDELLE 281DX 74ODX.063	FINISH:MTD SPEC-100015
10	736-0607	1	RONDELLE	FINISH:MTD SPEC-100016
11	738-04237A	1	AXE EPAULE	FINISH:MTD SPEC-100016
12	783-04548D-S	1	SUPPORT DE SIEGE	SCHWARZ
13	783-04637637	1	SUPPORT	SCHWARZ LACKIERT
14	783-04869A-S	1	SUPPORT BATTERIE	SCHWARZ

www.emc-motoculture.com

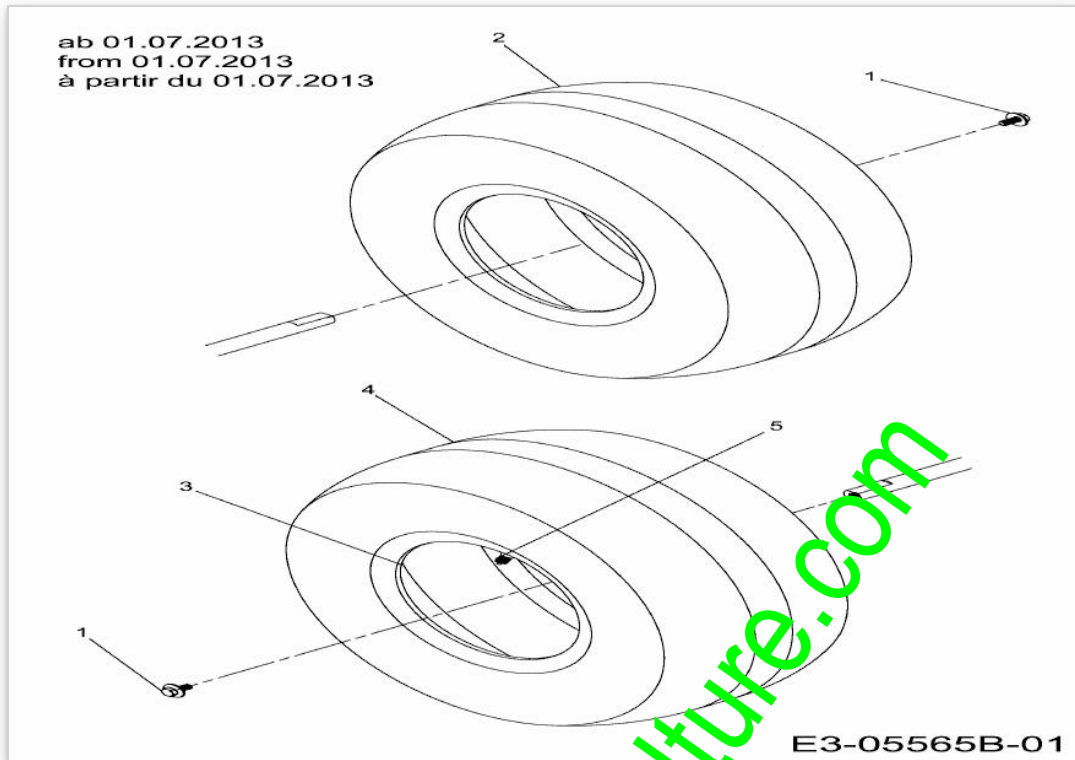

www.emc-motoculture.com

Position	Numéro de lapièce	#	Appellation I	Appellation II
1	710-05339	2	VIS	GR5 E-TEIL-SET
2	734-04523	2		
3	634-04631	2	JANTE AR GRISE	FINISH
4	734-0448	2	PNEU 18*950*8	TURF SAVER 734-0448-0901
5	734-0255	2	VALVE:PNEU	TR 412-P / 32.6mm / 934-0255

www.emc-motoculture.com

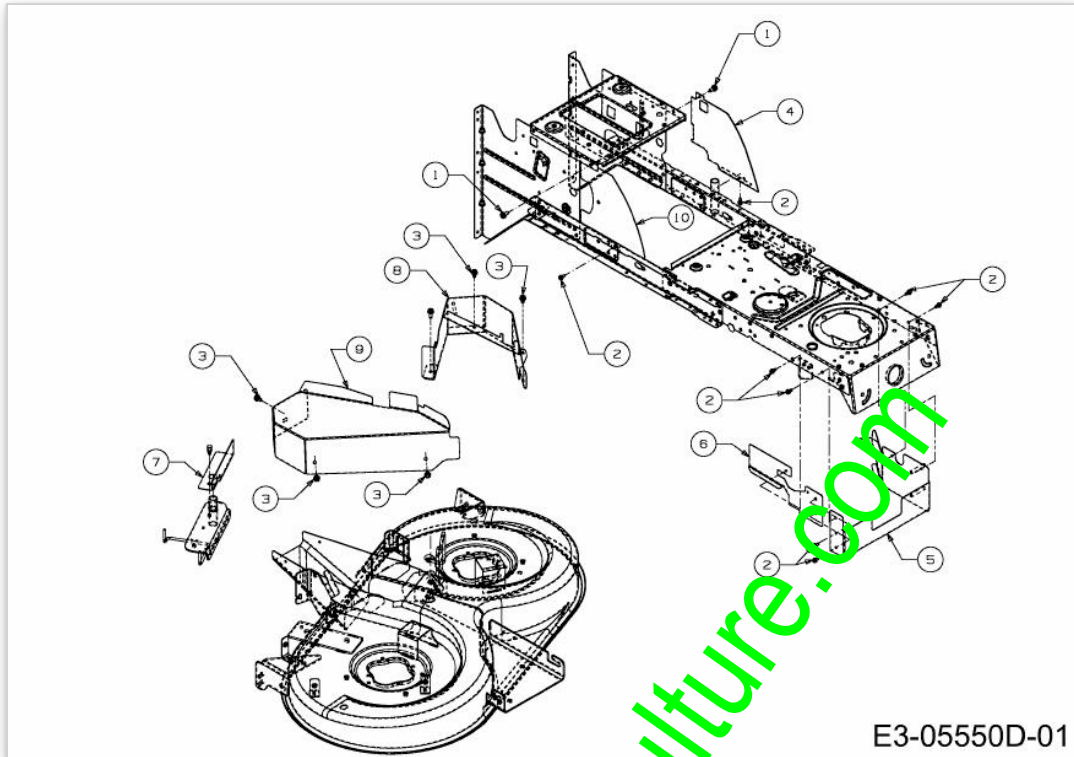

www.emc-motoculture.com

Position	Numéro de pièce	#	Appellation I	Appellation II
1	710-04484	2	VIS HEX. TT:5/16-18.:750:HXIND	FINISH:MTD SPEC-100016 TYPE 1
2	710-0599	8	VIS A SIX PANS CREUX	FINISH:MTD SPEC-101617
3	710-0607	5	VIS HEX.TT5/16-18.:500HXINDWSh	FINISH:MTD SPEC-100016 TYPE 1
4	783-05085A	1		
5	783-06002	1	PROTECTION DE POULIE PTO	FINISH:LACKIERT MTD QUALITÄT
6	783-06003	1	PROTECTION DE POULIE DROITE	FINISH:LACKIERT MTD QUALITÄT
7	783-06004	1	PROTECTION DE POULIE DROITE	FINISH:LACKIERT MTD QUALITÄT
8	783-06005	1	ABDECKUNG4 FRANCE:LT-5:N-DECK	FINISH:LACKIERT MTD QUALITÄT
9	783-06006A	1		
10	783-06676	1	PROTECTION DROITE	FINISH:LACKIERT MTD QUALITÄT

www.emc-motoculture.com

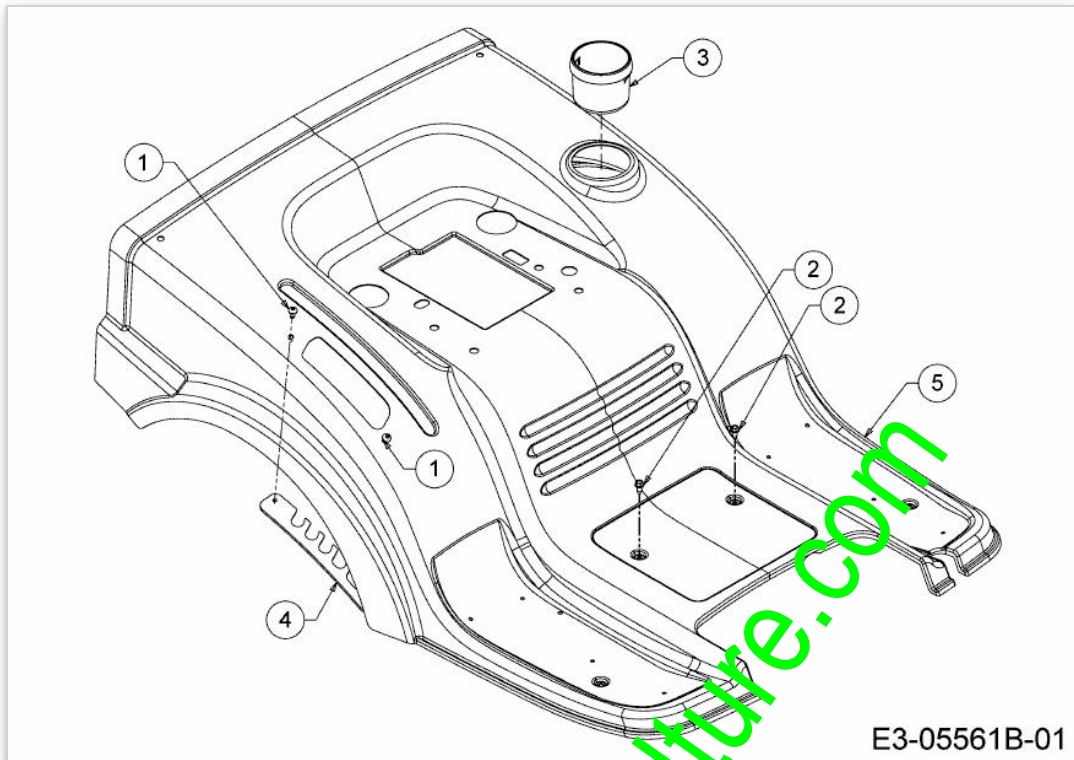

www.emc-motoculture.com

Position	Numéro de lapièce	#	Appellation I	Appellation II
1	710-05070	2	VIS	FINISH: SCHWARZ SPEC 701-01010
2	710-0599	2	VIS A SIX PANS CREUX	FINISH: MTD SPEC-101617
3	731-04591A	1	PORTE GOBELET	FINISH: KUNSTSTOFF SCHWARZ
4	783-05875A	1	SELECTEUR HAUTEUR DE COUPE	FINISH: 783-05875A-Z 5 POS
5	783-06580	1	JUPE	FINISH: LACKIERT

www.emc-motoculture.com

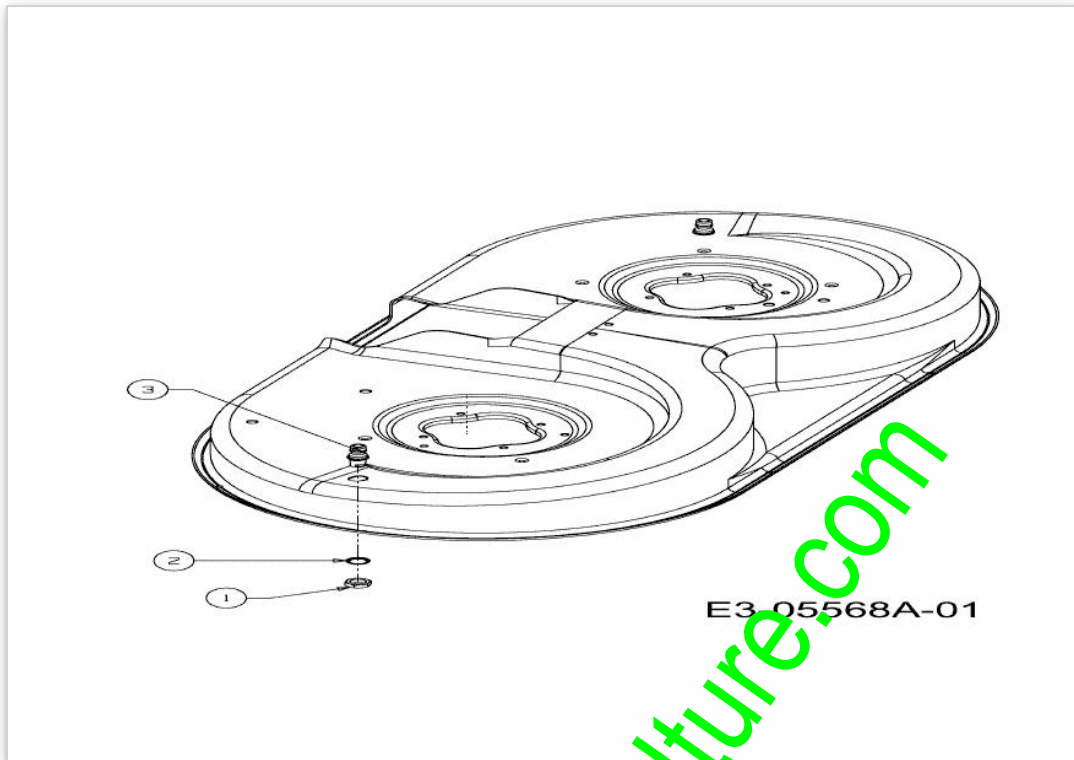

www.emc-motoculture.com

Position	Numéro de lapièce	#	Appellation I	Appellation II
1	712-0641	2	ECROU HEX. M16-1.5 DIN 936	FINISH:SPEC-100015 24.1424.31
2	736-0760	2	RONDELLE 17X23.8X1.95	FINISH:MTD SPEC-100016
3	737-04003D	2	BUSE NETTOYAGE PLATEAU	FINISH:MTD SPEC-100015

www.emc-motoculture.com

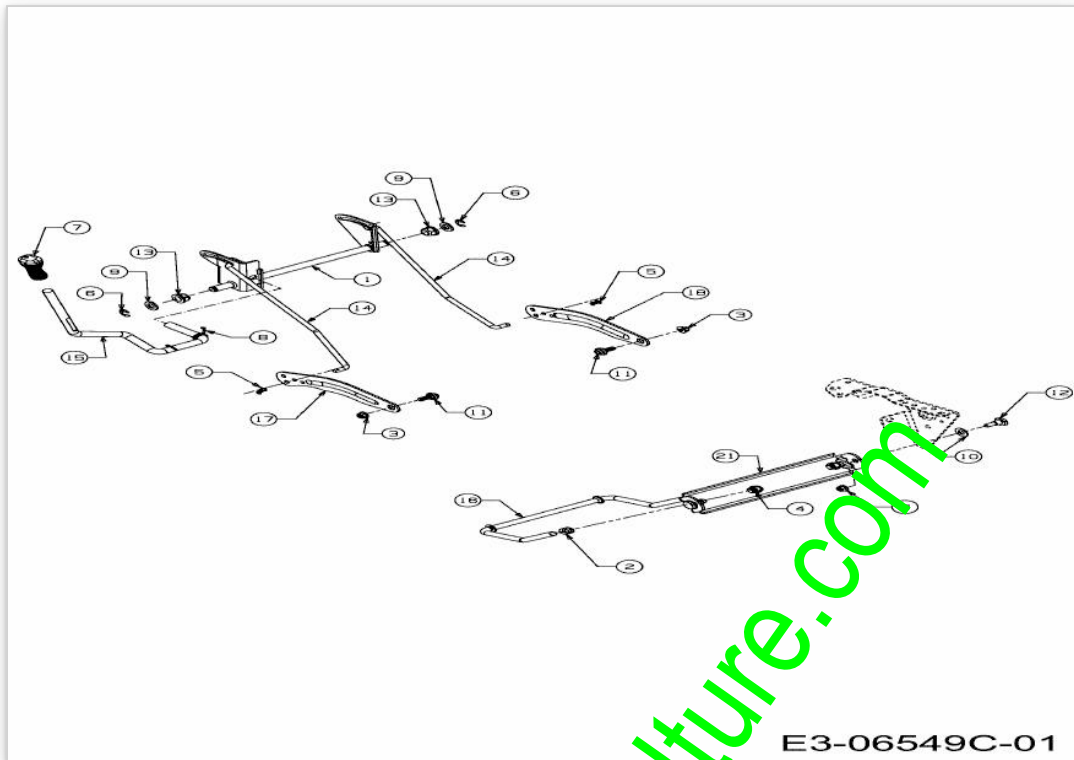

www.emc-motoculture.com

Position	Numéro de pièce	#	Appellation I	Appellation II
1	683-04679637	1	LEVIER DE RELEVAGE	SCHWEISSTEIL:FINISH LACKIERT
2	712-0206	2	ECROU HEX. 1/2-13:GR.5	FINISH:MTD SPEC-100015
3	712-04065	4	ECROU HEXAGONAL	FINISH:SPEC-100015 912-04065
4	712-3083	2	ECROU HEX. 1/2-13:GRB:NYLON	FINISH:MTD SPEC-100015
5	714-04040	2	GOUPILLE	FINISH:ASTM F1941 FE/ZN 3AN
6	716-0106A	2	CIRCLIPS	FINISH:PHOSPHATIERT
7	720-0298	1	POIGNEE	FARBE:KUNSTSTOFF SCHWARZ
8	732-04438	1	RESSORT	FINISH:701-01006
9	736-0366	2	RONDELLE 5/8 ID X 1.0 OD	FINISH:MTD SPEC-100015
10	736-0414	2	RONDELLE TÜFLON	FINISH:WEISS: 936-0414
11	738-04130	2	VIS .625X.175:3/8-16	FINISH:701-01002
12	738-0507B	2	VIS	FINISH:MTD SPEC-701-01006
13	741-0225	2	BAGUE HEXAGONALE TEFLON 6 PANS	FINISH:KUNSTSTOFF SCHWARZ
14	747-05257	2	TRINGLE DE RELEVAGE	A/C/E/N-Deck:MTD SPEC-101616
15	747-05292	1	BRAS DE RELEVAGE	FINISH:SCHWARZ E-COAT
16	747-1324	1	TRINGLE	FINISH:SPEC-100015
17	783-04494C-S	1	LEVIER DE RELEVAGE DROITE	SCHWARZ
18	783-04711C-S	1	BRAS DE RELEVAGE GAUCHE	SCHWARZ
19	783-0720C637	1	SUPPORT DE RELEVAGE	SCHWARZ

www.emc-motoculture.com

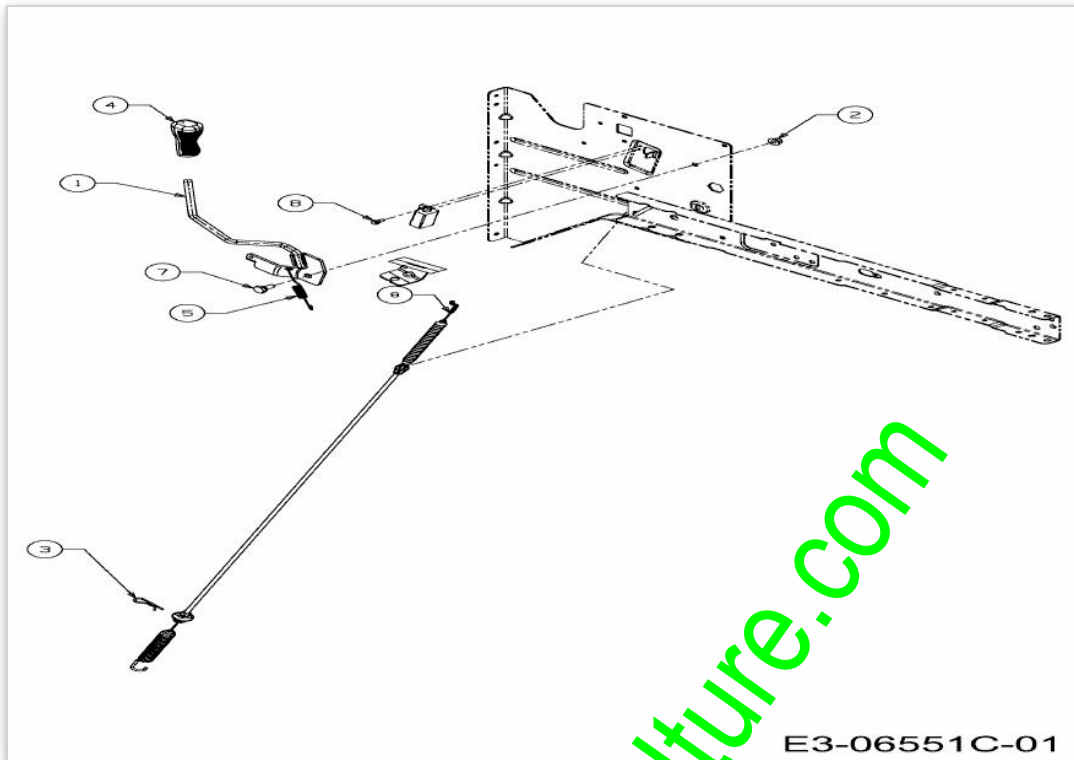

E3-06551C-01

www.emc-motoculture.com

Position	Numéro de pièce	#	Appellation I	Appellation II
1	647-04239	1	LEVIER ENCLenchement	SCHWEISSTEIL:647-04239 SCHWARZ
2	712-04063	1	ECROU HEX. AVEC FLANC	FINISH:MTD SPEC-100015
3	714-0145	1	GOUPILLE	FINISH:SPEC-701-01006
4	720-04049A	1	POIGNEE PLASTIQUE	FINISH:SCHWARZ
5	732-04276A	1	RESSORT	FINISH:MTD SPEC-701-01006
7	738-0140	1	VIS A EP.:.435 x.178-5/16 x.56	FINISH:MTD SPEC-100015
8	738-04237A	1	AXE EPAULE	FINISH:MTD SPEC-100016
9	746-04173E	1	CABLE D EMBRAYAGE	VERKAPSELTE TEIL-SET

www.emc-motoculture.com

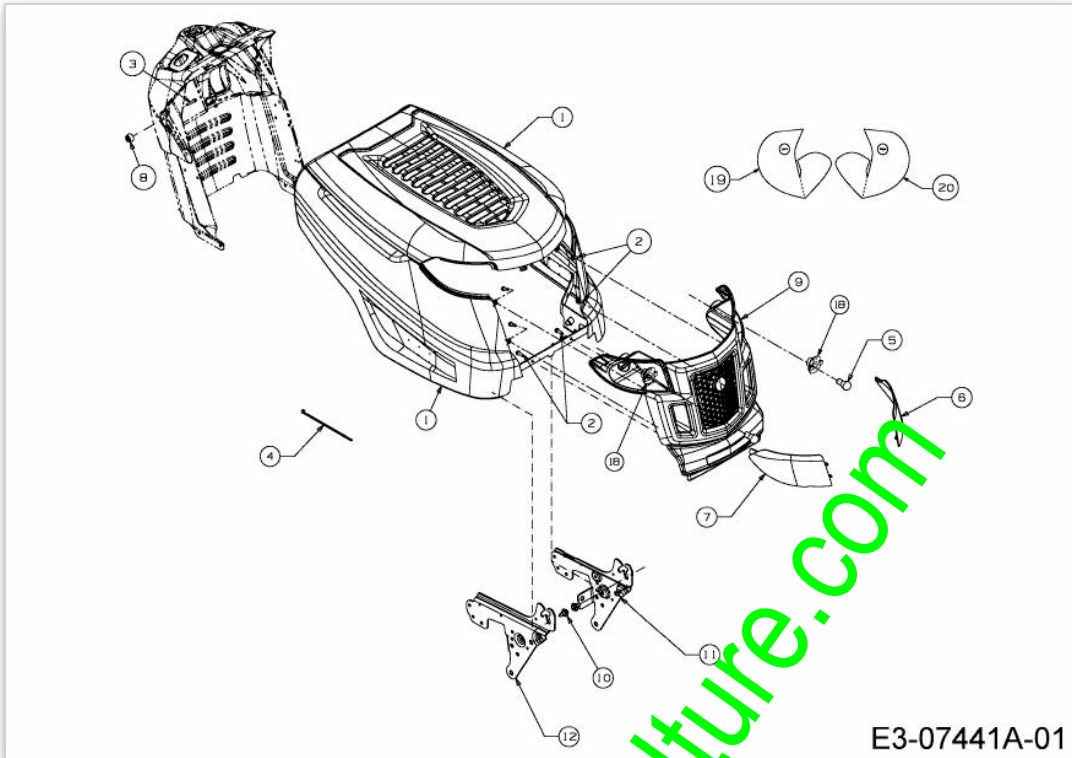

E3-07441A-01

www.emc-motoculture.com

Position	Numéro de pièce	#	Appellation I	Appellation II
1	683-04441A	1		
2	710-05108	6	VIS	FINISH:SPEC-701-01006
3	710-05281	2	VIS	FINISH:MTD SPEC-100016 TYPE 1
4	725-0157	1	COLLIER DE SERRAGE3/16X0.5X7.4	MATERIAL:NYLON-SCHWARZ
5	725-0963	2	AMPOULE ELECTRIQUE	FINISH:
6	731-06095	1	OPTIQUE GAUCHE	FINISH:KLAR
7	731-06096	1	OPTIQUE DROITE	FINISH:KLAR
8	731-06404	2	SILENBLOCK:CAPOT STYLE-K	ARMATURENBRETT:K-STYLE
9	731-06796	1	CALANDRE STYLE K	KUNSTSTOFF SCHWARZ
10	738-04091A	2	VIS EPAULEE	FINISH:SPEC-100016
11	783-05417	1	ÛTRIER DE CHARN.:j DR. CAPOT	FINISH:LACKIERT
12	783-05418	1	ÛTRIER DE CHARN.:j DR. CAPOT	FINISH:LACKIERT
18	725-1649	2	DOUILLE DE LAMPE: 1/4 ROTATION	GRAU KUNSTSTOFF
19	777X43039	1	REFLECTEUR DROITE	FINISH:
20	777X43038	1	REFLECTEUR GAUCHE	FINISH:

www.emc-motoculture.com

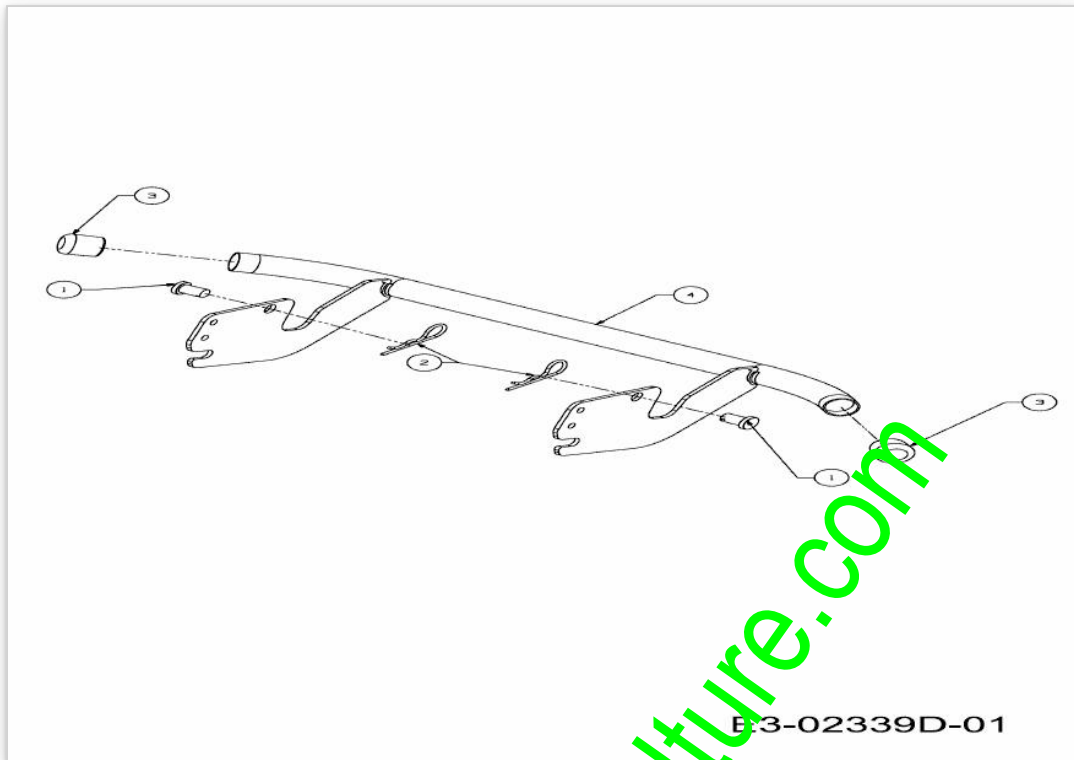

www.emc-motoculture.com

Position	Numéro de lapièce	#	Appellation I	Appellation II
1	711-0332	2	GOUJON ; ÜPINGLER .50X.78 LG	FINISH:MTD SPEC-100015
2	714-04075	2	EPINGLE	FINISH:ZINC SPEC-100015
3	731-04500	2	BOUCHON	500 SERIES:K 28 S:SCHWARZ
4	683-04236A	1	PARE-CHOCS DE FR. SÛRIE 500	SCHWEISSTEIL:FINISH LACKIERT

www.emc-motoculture.com

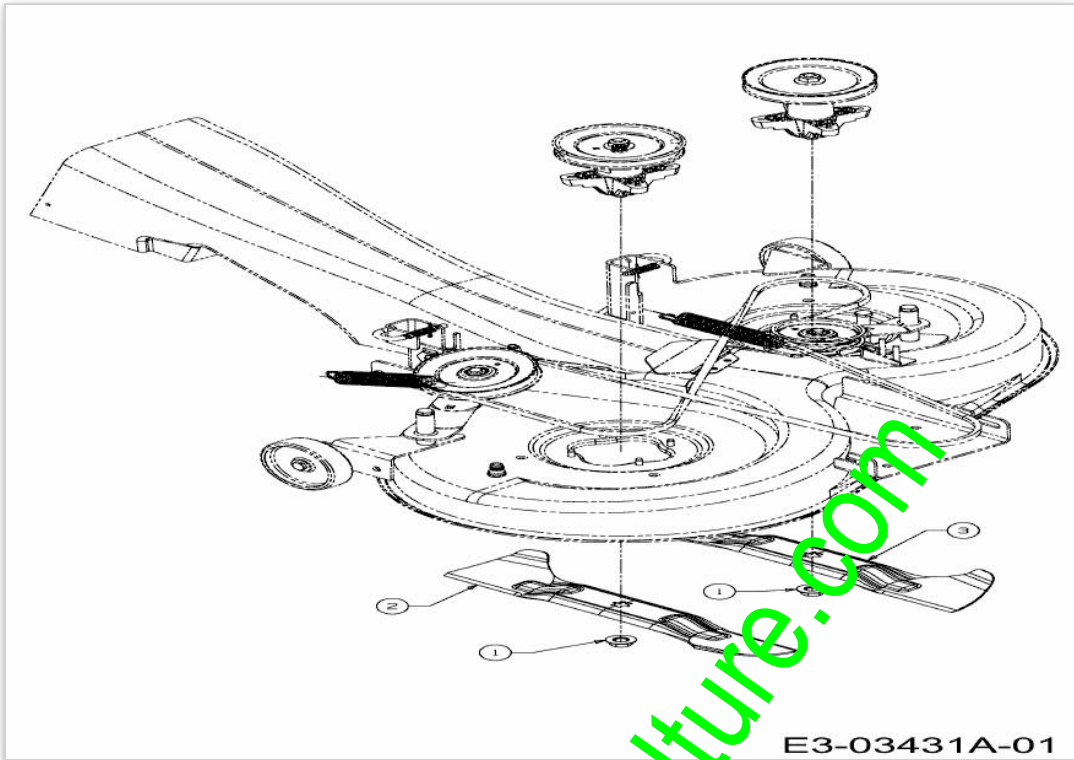

www.emc-motoculture.com

Position	Numéro de lapièce	#	Appellation I	Appellation II
1	712-0417A	2	ÜCROU HEX. AV. FLANC: 5/8-18	FINISH:MTD STD 701-01000
2	742-04080	1	LAME DROITE	STAR BAG:WÄRMEBEHANDELT
3	742-04081	1	LAME GAUCHE	STAR BAG:WÄRMEBEHANDELT

www.emc-motoculture.com

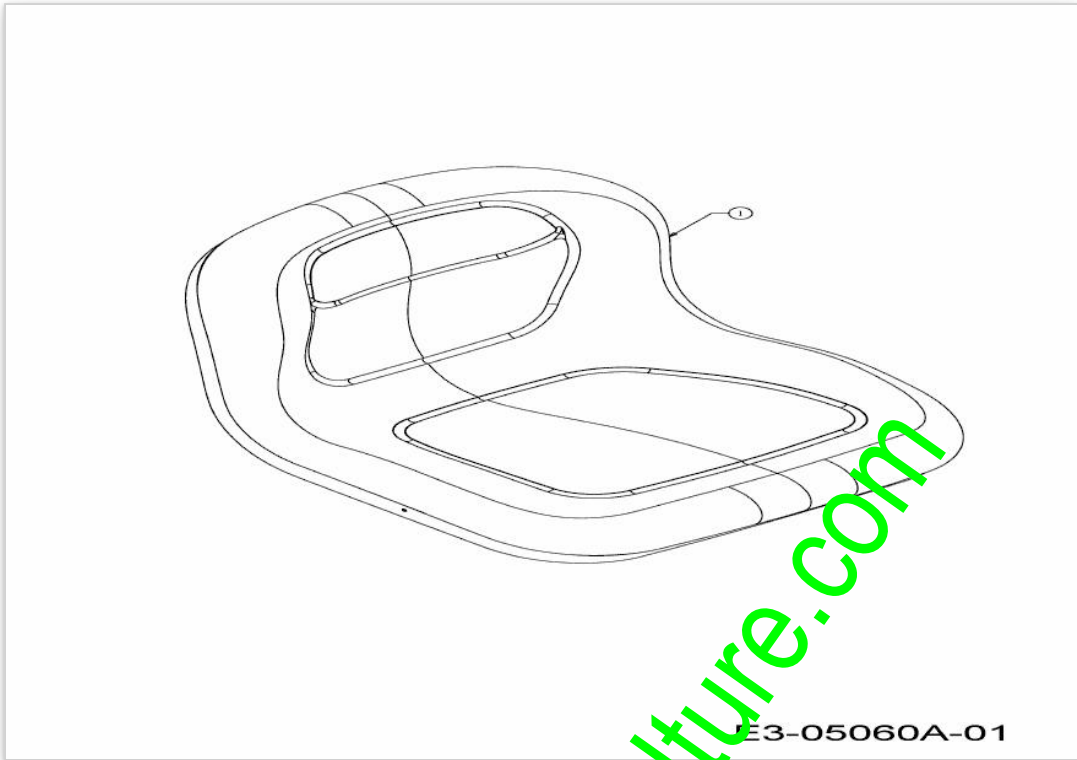

www.emc-motoculture.com

Position	Numéro de lapièce	#	Appellation I	Appellation II
1	757-04109	1	SIEGE NOIR HAUT	FINISH:SCHWARZ

www.emc-motoculture.com

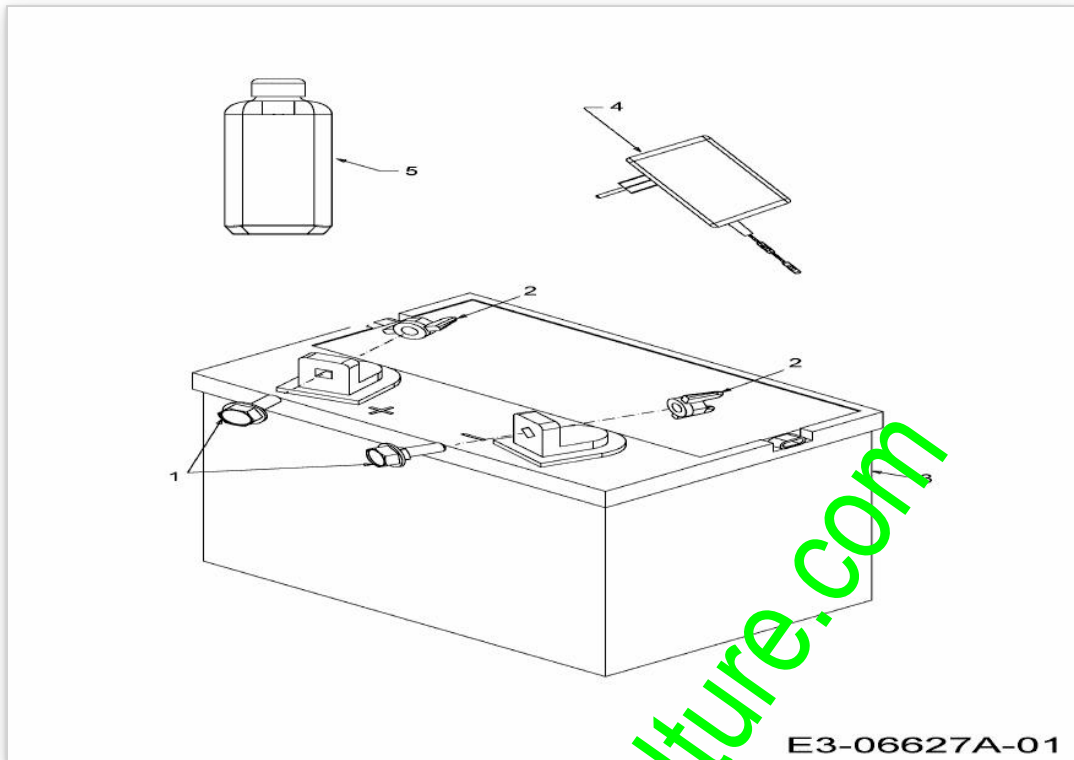

www.emc-motoculture.com

E3-06627A-01

Position	Numéro de pièce	#	Appellation I	Appellation II
1	738-1132	2	AXE	FINISH:SPEC-100015
2	712-3087	2	ECROU PAPILLON	FINISH:KUNSTSTOFF SCHWARZ
3	725-05035	1	BATTERIE 12V 16 A	FINISH:
4	725-04098	1	CHARGEUR DE BATTERIE	*CE*

www.emc-motoculture.com

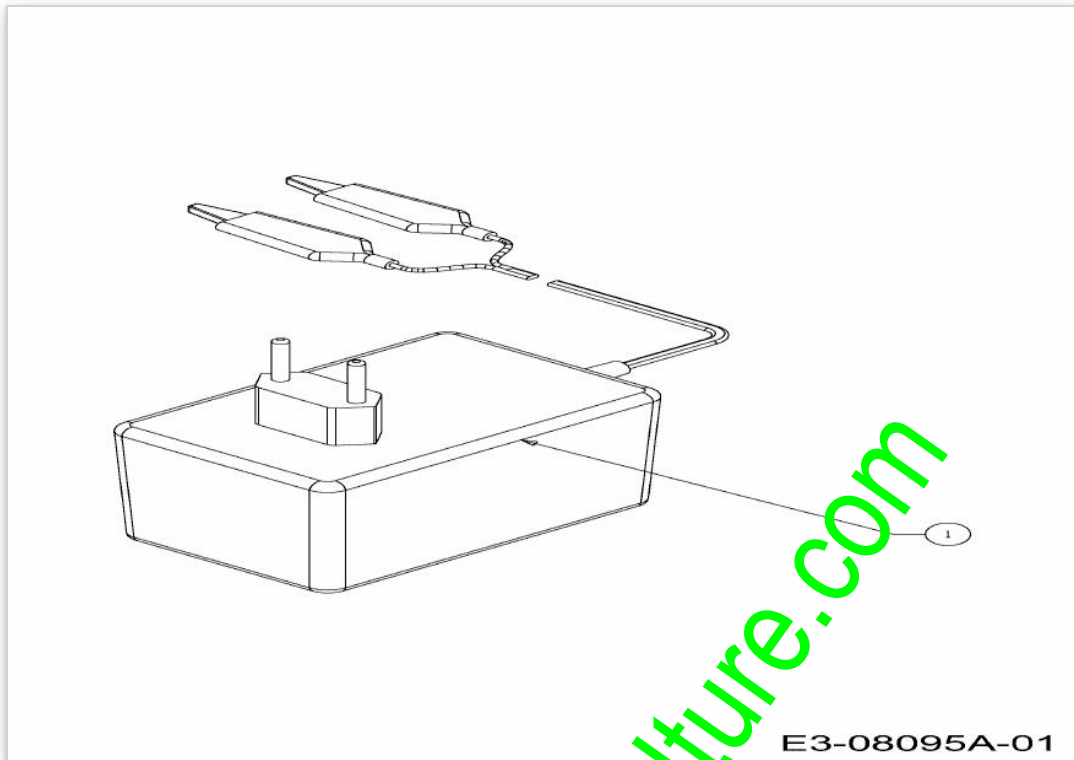

E3-08095A-01

www.emc-motoculture.com

Position	Numéro de pièce	#	Appellation I	Appellation II
1	725-04098	1	CHARGEUR DE BATTERIE	*CE*

www.emc-motoculture.com

ab 17.02.2014
from 17.02.2014
à partir du 17.02.2014

27

Briggs & Stratton

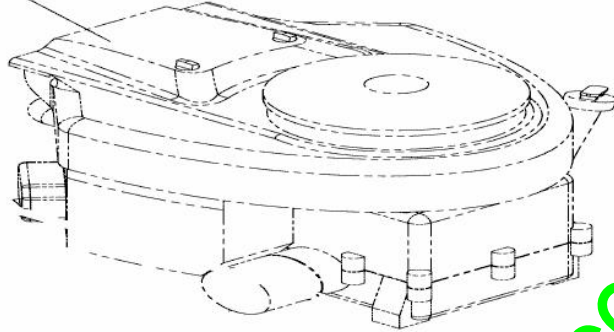

Model: 40R777
Type: 0008B1

E3-02471A-04

www.emc-motoculture.com

Position	Numéro de lapièce	#	Appellation I	Appellation II
27	752B0008B1	1	B-MOTOR: B&S INTEK 7200 SERIES	40R777-0008-B1

www.emc-motoculture.com

bis 16.02.2014
to 16.02.2014
jusqu'au 16.02.2014

Briggs & Stratton

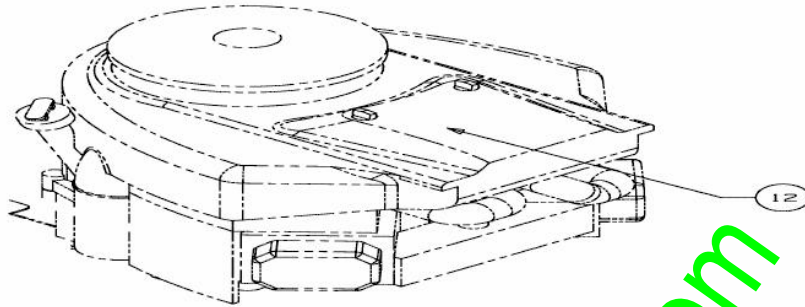

Model: 406777
Type: 6888-B1

E3-08323A-07

www.emc-motoculture.com

Position	Numéro de pièce	#	Appellation I	Appellation II
12	752B6888B1	1	MOTEUR B&s INTEK 7200 SERIES	4067776888B1

www.emc-motoculture.com

www.emc-motoculture.com