

E3-07447A-01

[www.emc-motoculture.com](http://www.emc-motoculture.com)

Position	Numéro de pièce	#	Appellation I	Appellation II
1	618-04456A	1	PALIER COMPLET	VOLLST.
2	712-0417A	1	ÜCROU HEX. AV. FLANC: 5/8-18	FINISH:MTD STD 701-01000
3	738-04241	1	AXE DE LAME	FINISH:GEÖLT
4	741-0919A	2	ROULEMENT A BILLES	FINISH:
5	750-04739	1	DOUILLE	FINISH:GEÖLT
6	750-1000	2	ENTRETOISE:.80x1.10x1.330	FINISH:GEÖLT
7	756-1227	1	POULIE DE PALIER DE LAME	FINISH:SIEHE ZG.

[www.emc-motoculture.com](http://www.emc-motoculture.com)

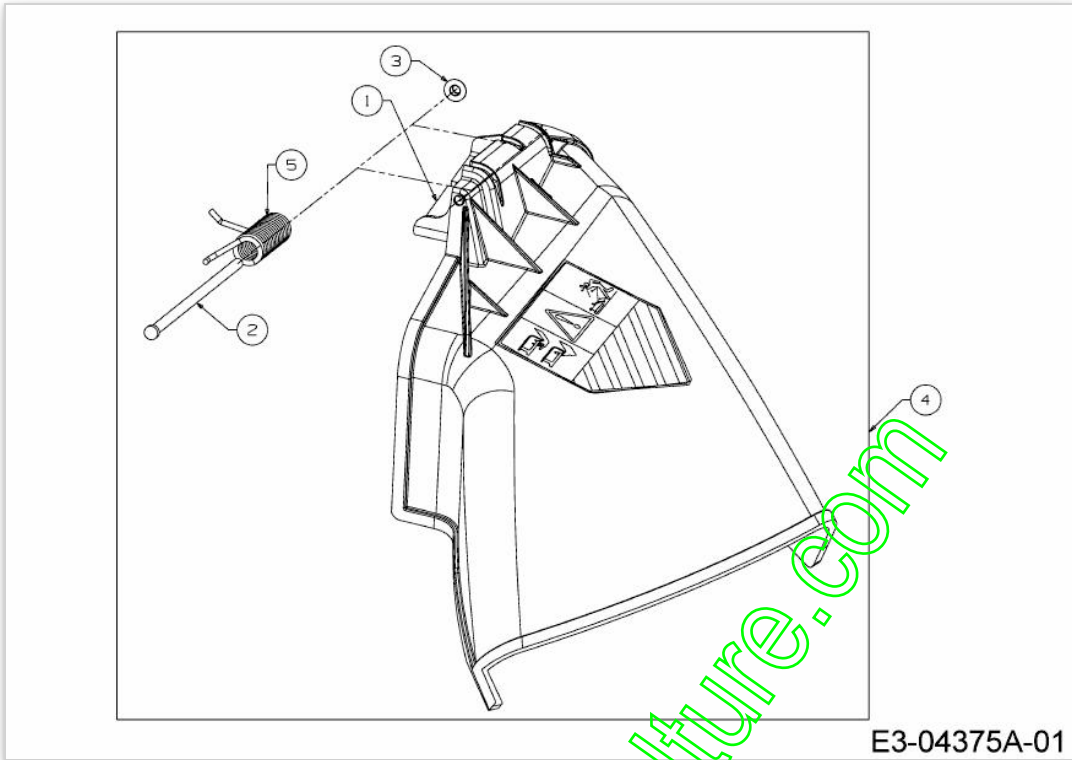

E3-04375A-01

Position	Numéro de pièce	#	Appellation I	Appellation II
1	703-1693A	1	SUPPORT DE DEFLECTEUR	FINISH:BLAU CHROMATIERT *
2	711-0792	1	GOUJON	MTD SPEC-100015 911-0792
3	726-0106	1	COUVERCLE 1/4 "	FINISH:MTD SPEC-100016
4	731-2541A	1	DEFLEKTOR- SEITENAUSWURF	EXPORT
5	732-04537	1	RESSORT	FINISH:MTD SPEC-100015

[www.emc-motoculture.com](http://www.emc-motoculture.com)

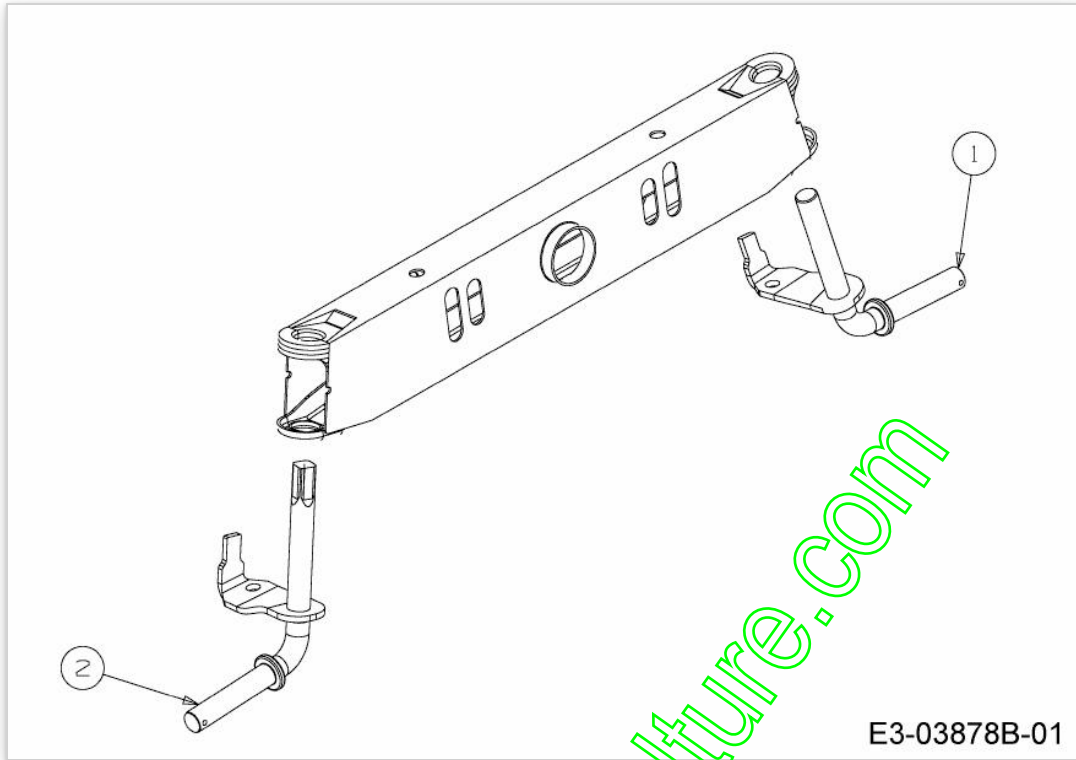

E3-03878B-01

[www.emc-motoculture.com](http://www.emc-motoculture.com)

Position	Numéro de lapièce	#	Appellation I	Appellation II
1	638-04007A-S	1	FUSEE GAUCHE	FINISH:LACKIERT MTD QUALITÄT
2	638-04008637	1	FUSEE DROITE	SCHWARZ LACKIERT

[www.emc-motoculture.com](http://www.emc-motoculture.com)

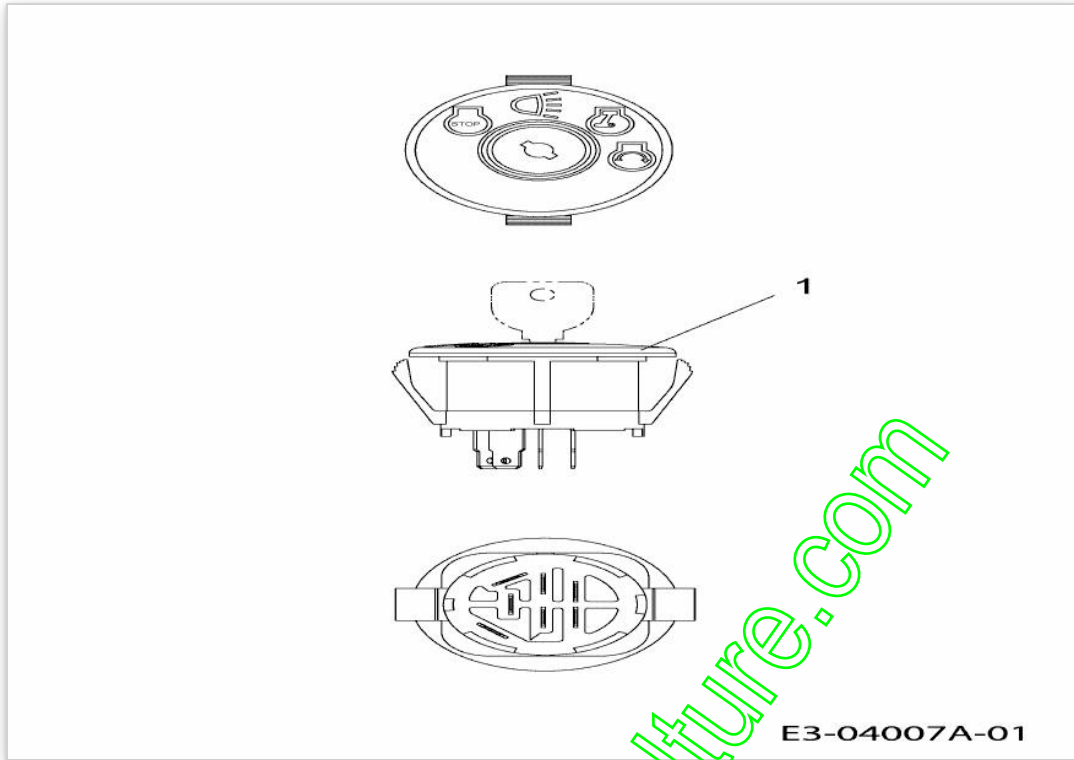

[www.emc-motoculture.com](http://www.emc-motoculture.com)

Position	Numéro de lapièce	#	Appellation I	Appellation II
1	725-1741	1	CONTACTEUR A CLE	FINISH: 925-1741

[www.emc-motoculture.com](http://www.emc-motoculture.com)



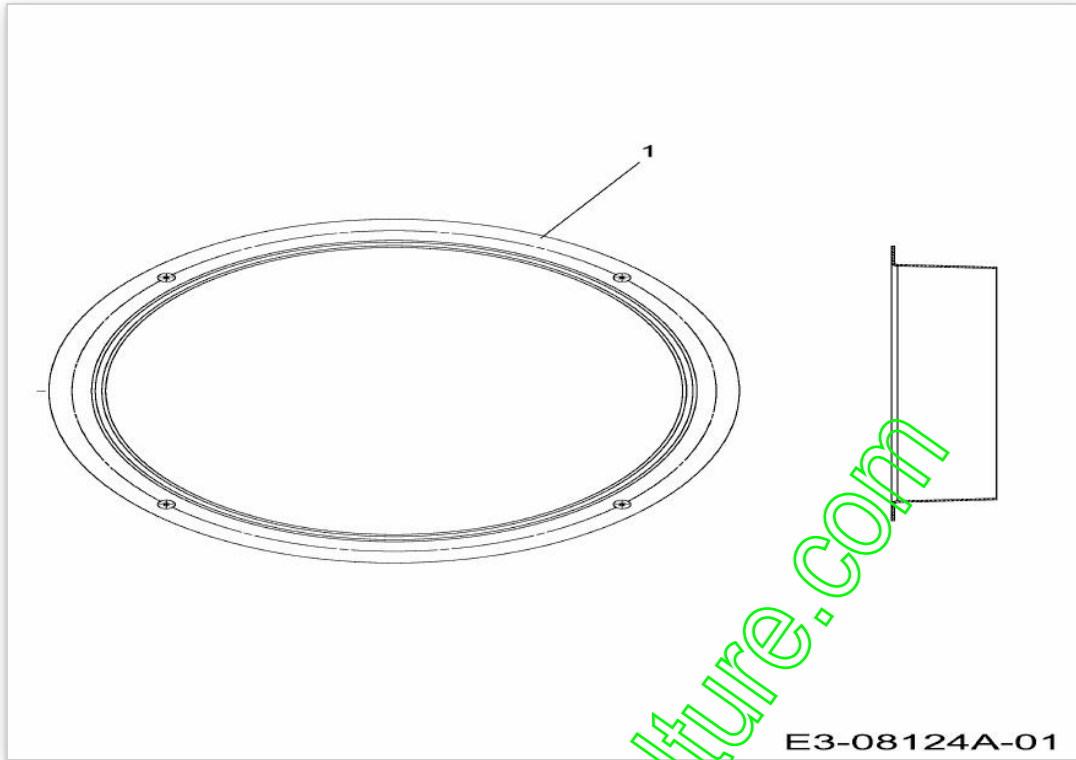

[www.emc-motoculture.com](http://www.emc-motoculture.com)

Position	Numéro de lapièce	#	Appellation I	Appellation II
1	731-06272	1	LUFTLEITRING:KAW 22/25:2,1"LG	FINISH:SCHWARZ

[www.emc-motoculture.com](http://www.emc-motoculture.com)

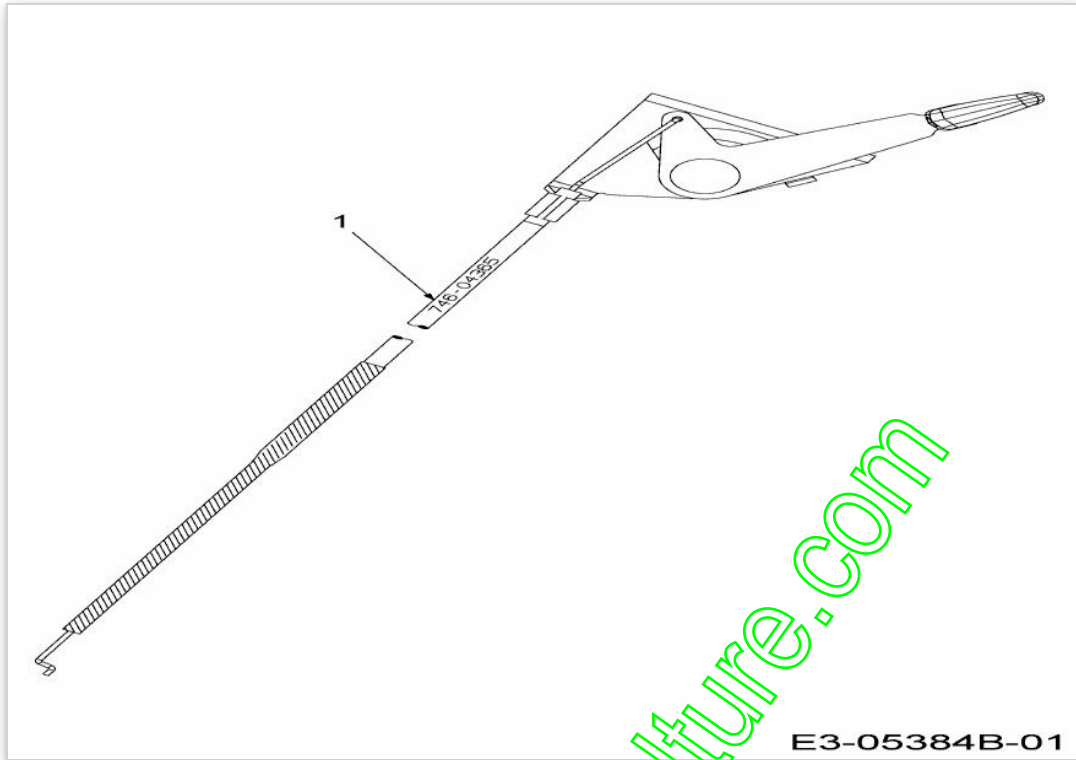

E3-05384B-01

[www.emc-motoculture.com](http://www.emc-motoculture.com)

Position	Numéro de pièce	#	Appellation I	Appellation II
1	746-04365	1	COMMANDE GAZ	746-04365

[www.emc-motoculture.com](http://www.emc-motoculture.com)

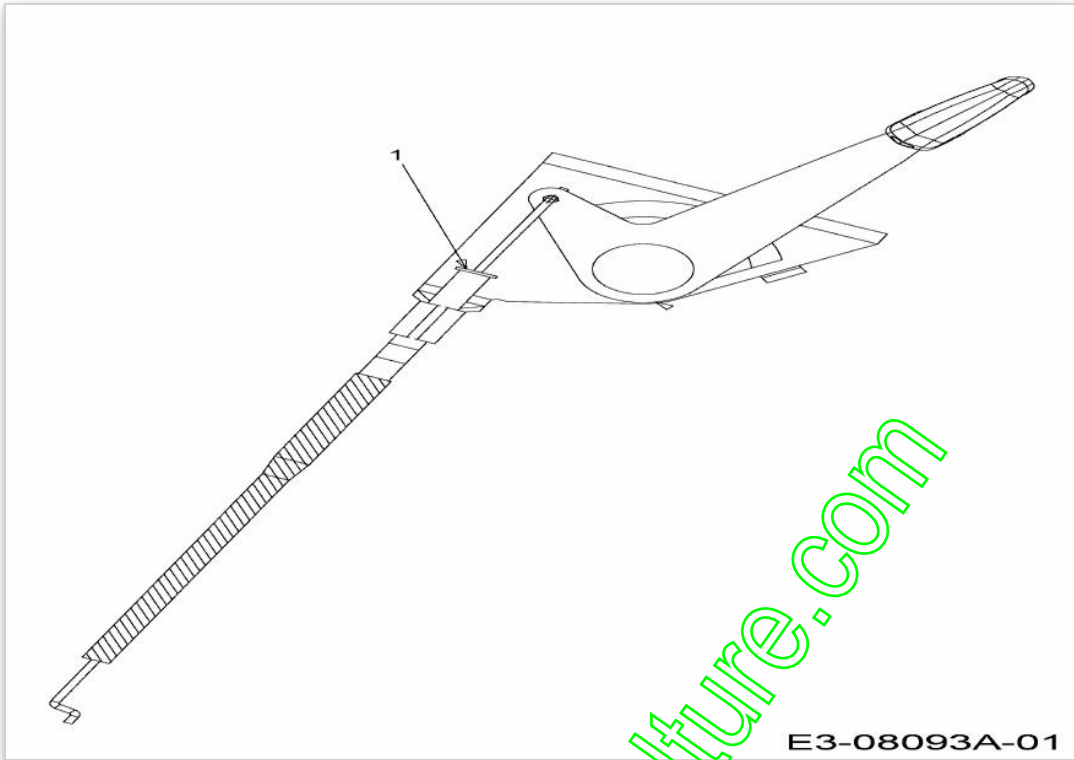

E3-08093A-01

[www.emc-motoculture.com](http://www.emc-motoculture.com)

Position	Numéro de lapièce	#	Appellation I	Appellation II
1	746-04591	1	CABLE GAZ	MIT BEDIENUNGSHEBEL

[www.emc-motoculture.com](http://www.emc-motoculture.com)

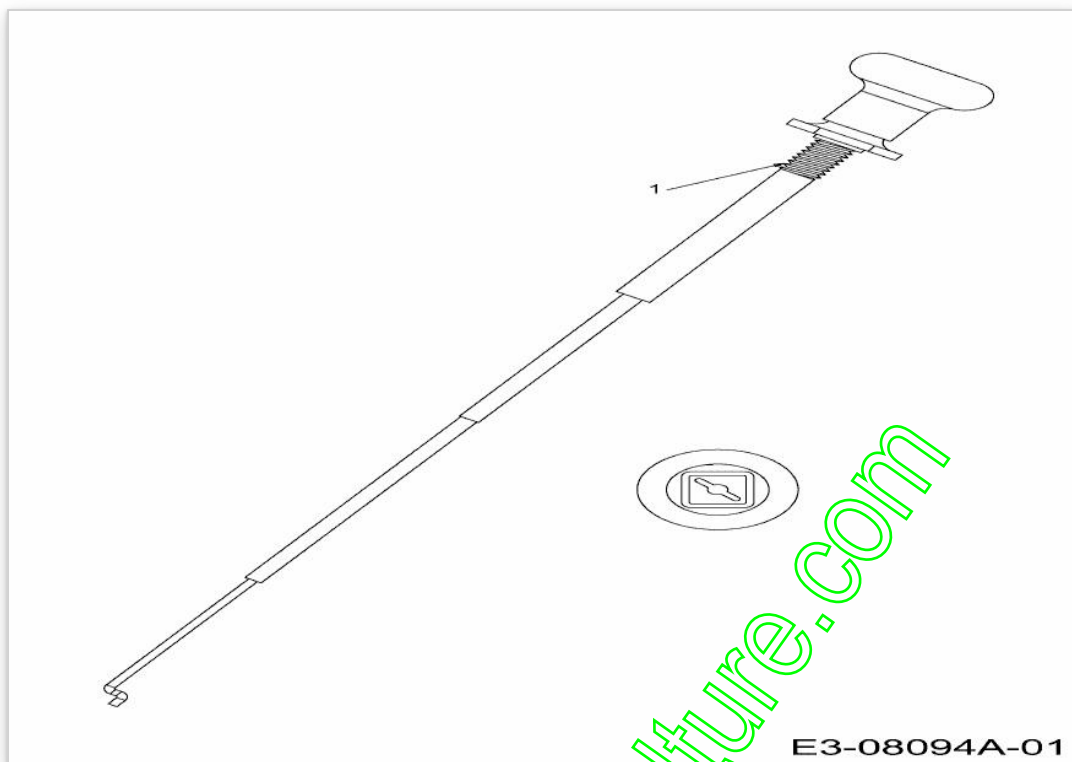

E3-08094A-01

[www.emc-motoculture.com](http://www.emc-motoculture.com)

Position	Numéro de pièce	#	Appellation I	Appellation II
1	746-04847	1	CABLE STARTER	FINISH:ZUGKNOPF SCHWARZ

[www.emc-motoculture.com](http://www.emc-motoculture.com)



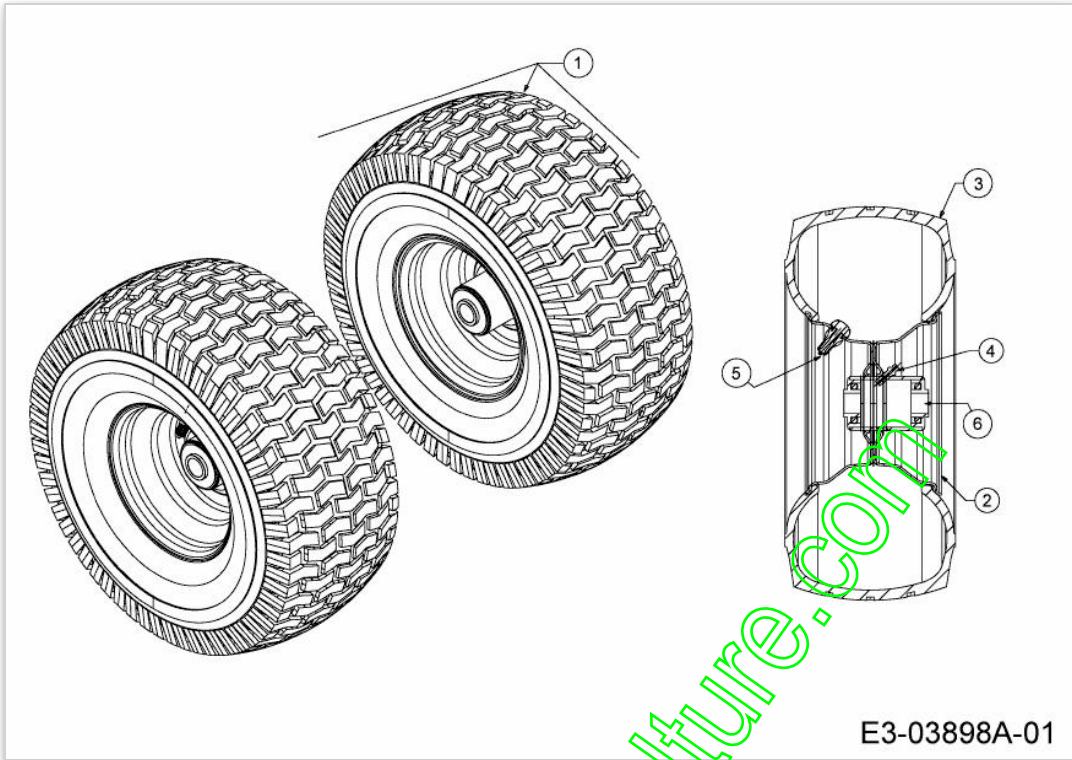

E3-03898A-01

Position	Numéro de pièce	#	Appellation I	Appellation II
1	634-04199	2	RAD KOMPL:15x6x6:BB KUGELLAGER	FINISH:NONE
2	634-04091A	2	788-0717	KUGELLAGER FINISH:PAINT
3	734-1731	2	PNEU 15X600X6 DICO MULTI- TRAC	SQ SHOULDER:TURF SAVER
4	737-0224	2	GRAISSEUR JANTE DE ROUE	FINISH:ZINC
5	734-0255	2	VALVE:PNEU	TR 412-P / 32.6mm / 934-0255
6	741-04137	4	ROULEMENT DE ROUE	941-04137 *

[www.emc-motoculture.com](http://www.emc-motoculture.com)

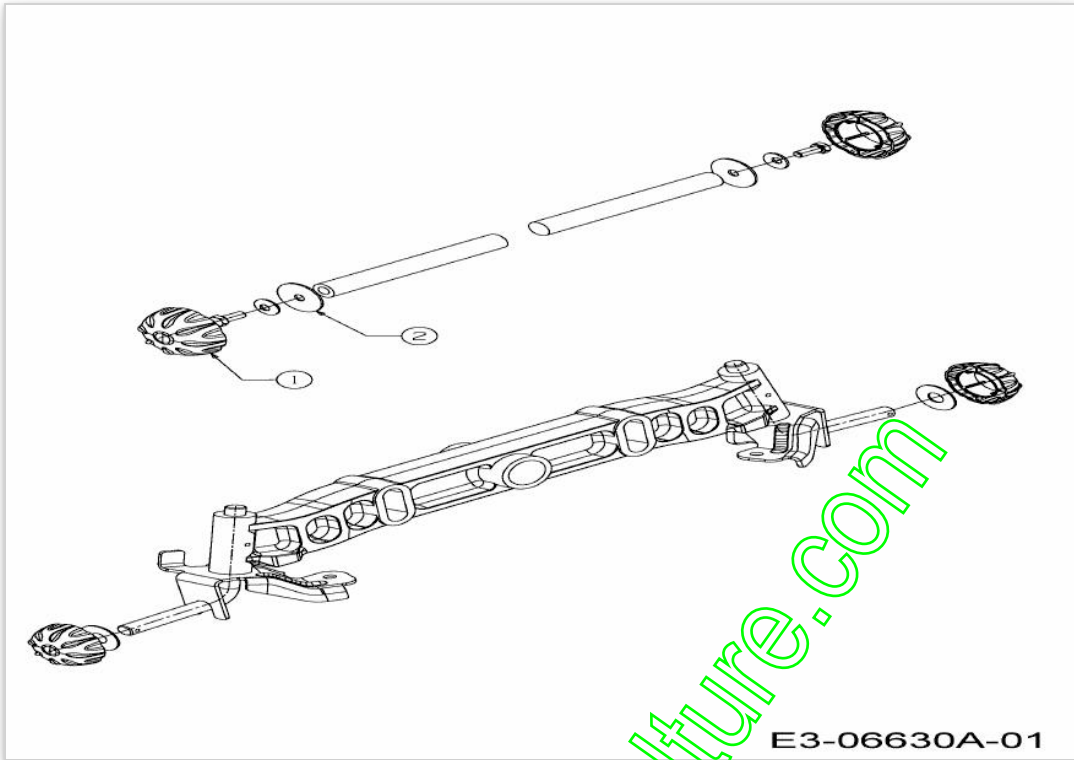

E3-06630A-01

[www.emc-motoculture.com](http://www.emc-motoculture.com)

Position	Numéro de lapièce	#	Appellation I	Appellation II
1	731-2290A	4	CAPUCHON DE ROUE	FINISH:KUNSTSTOFF SCHWARZ
2	736-0430	2	RONDELLE .350X.1.59X.062	FINISH:MTD SPEC-100015

[www.emc-motoculture.com](http://www.emc-motoculture.com)

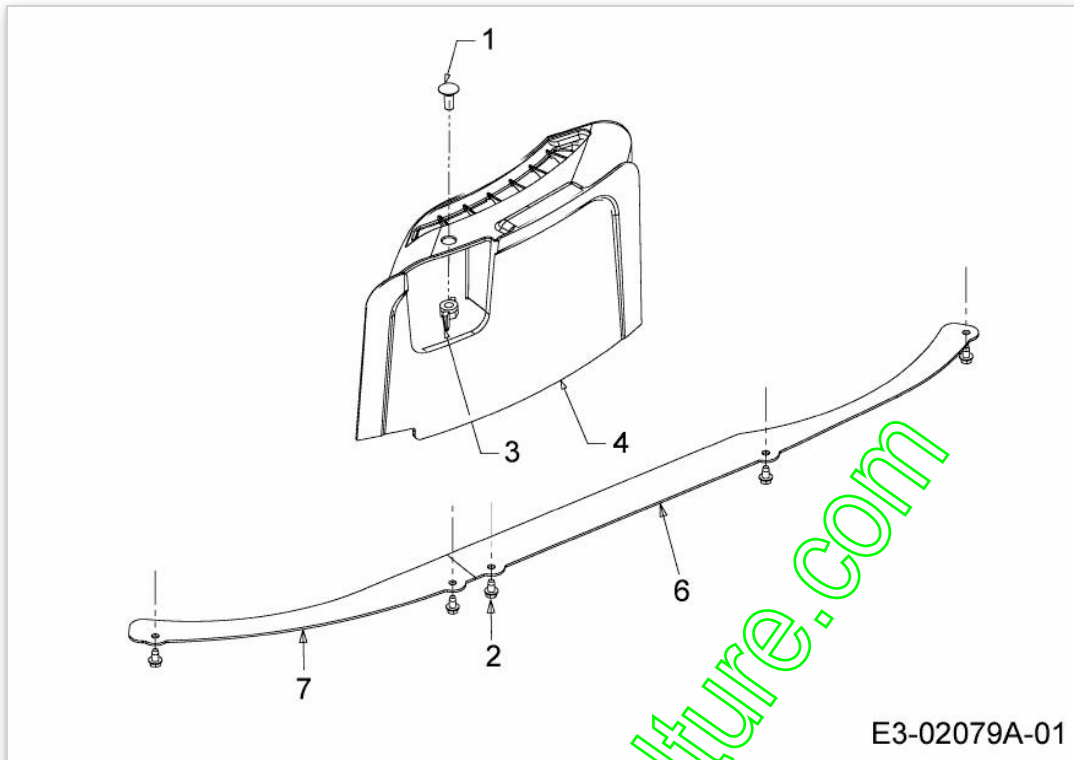

E3-02079A-01

Position	Numéro de pièce	#	Appellation I	Appellation II
1	710-0134	1	VIS à TÊTE PLATE	FINISH:MTD SPEC-100015
2	710-0599	6	VIS A SIX PANS CREUX	FINISH:MTD SPEC-101617
3	712-3087	1	ECROU PAPILLON	FINISH:KUNSTSTOFF SCHWARZ
4	731-2363	1	BOUCHON MULCHING	FINISH:KUNSTSTOFF SCHWARZ
6	783-1258A637	1	BORD GAUCHE DE PLATEAU 42"	SCHWARZ LACKIERT
7	783-1259A637	1	BORD DROIT DE PLATEAU 42"	SCHWARZ

[www.emc-motoculture.com](http://www.emc-motoculture.com)

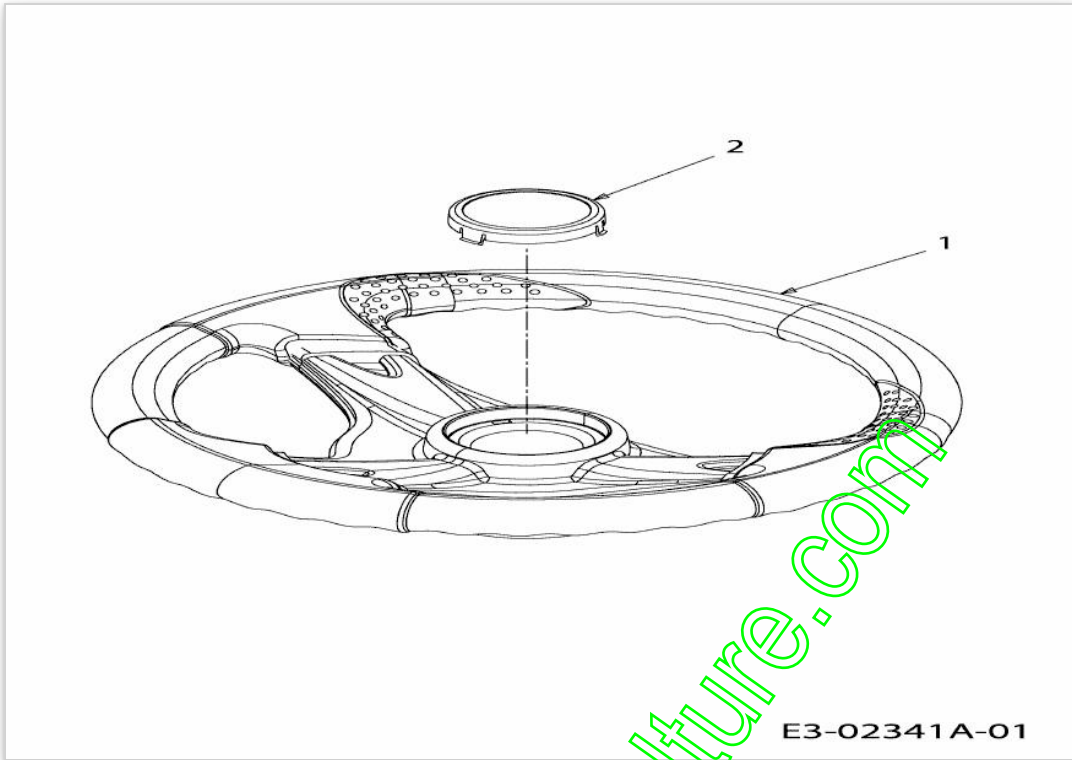

E3-02341A-01

[www.emc-motoculture.com](http://www.emc-motoculture.com)

Position	Numéro de lapièce	#	Appellation I	Appellation II
1	631-04008	1	VOLANT	SOFTGRIP
2	731-04039	1	CAPUCHON DE VOLANT SANS LOGO	FINISH:KUNSTSTOFF SCHWARZ

[www.emc-motoculture.com](http://www.emc-motoculture.com)



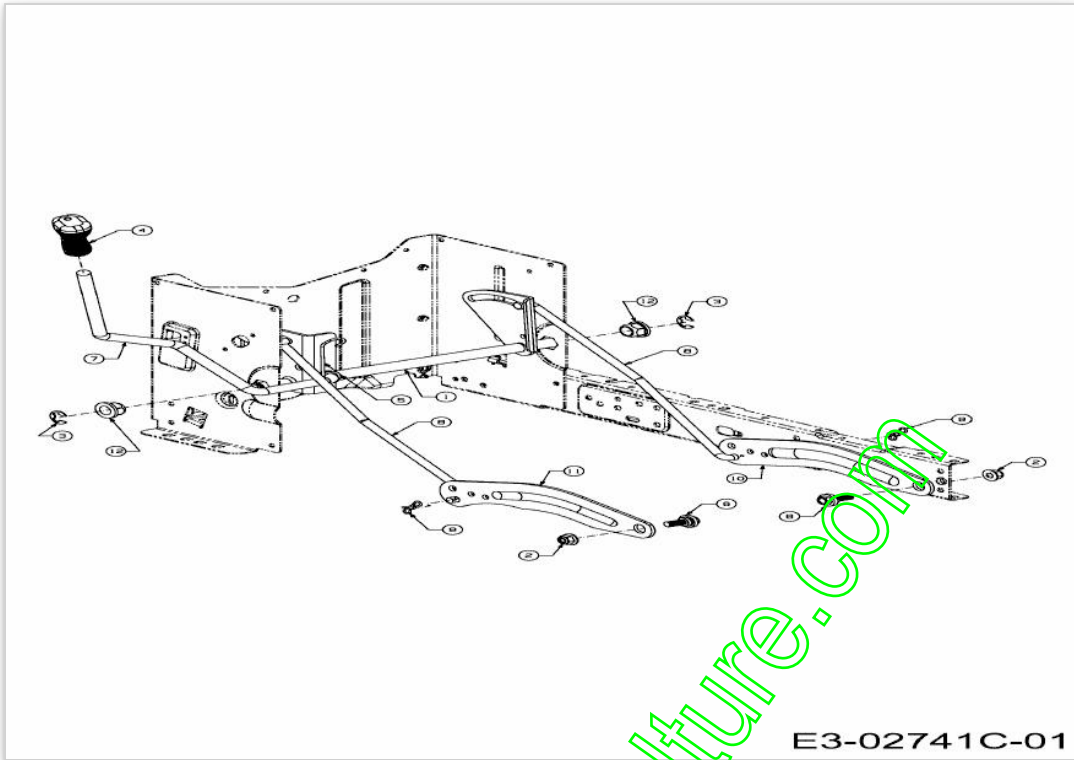

www.emc-motoculture.com

E3-02741C-01

Position	Numéro de pièce	#	Appellation I	Appellation II
1	683-04155A-S	1	ARBRE CPL.:LEVÉE LT-5	SCHWARZ
2	712-04065	2	ECROU HEXAGONAL	FINISH:SPEC-100015 912-04065
3	716-0106A	2	CIRCLIPS	FINISH:PHOSPHATIERT
4	720-0311	1	POIGNÛE LEVIER COUPE : 1/2	FARBE:SCHWARZ VINYL
5	732-04225	1	RESSORT	FINISH:MTD STD 701-01006
6	738-04130	2	VIS .625X.175:3/8-16	FINISH:701-01002
7	747-04282	1	LEVIER DE RELEVAGE :LT-5	FINISH:SPEC-100015
8	747-04393	2	TRINGLE DE RELEVAGE	FINISH:MTD SPEC-100015
9	714-04040	2	GOUPILLE	FINISH:ASTM F1941 FE/ZN 3AN
10	783-04711C-S	1	BRAS DE RELEVAGE GAUCHE	SCHWARZ
11	783-04494C-S	1	LEVIER DE RELEVAGE DROITE	SCHWARZ
12	741-0225	2	BAGUE HEXAGONALE TEFLON 6 PANS	FINISH:KUNSTSTOFF SCHWARZ

www.emc-motoculture.com

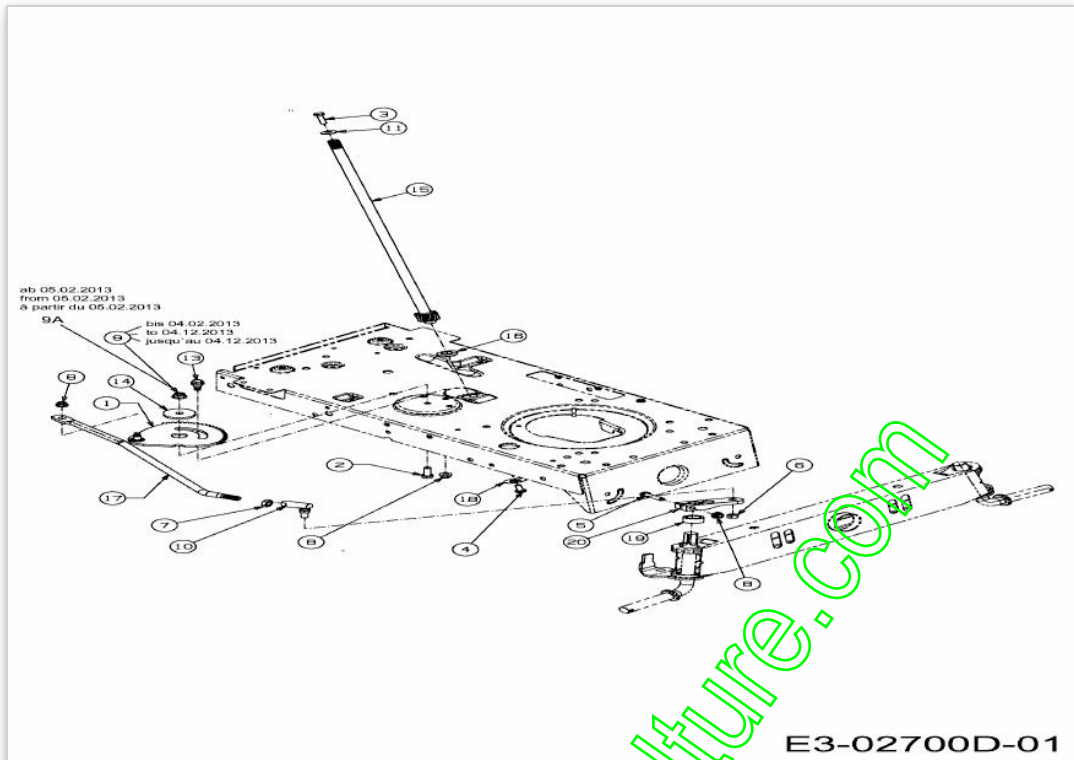

[www.emc-motoculture.com](http://www.emc-motoculture.com)

Position	Numéro de pièce	#	Appellation I	Appellation II
1	617-04094	1	SEGMENT DE DIRECTION	SCHWEISSTEIL:PHOS & OIL
2	710-0514	1	VIS HEX.:3/8-16:1.00:GR5:STD	FINISH:MTD SPEC-100015
3	710-0643	1	VIS HEX.: 5/16-18:1.00:GR5	FINISH:MTD SPEC-100015
4	710-1309	1	VIS	FINISH:MTD SPEC-100015
5	710-3180	1	VIS HEX. 5/16-18:1.75:GR5:STD	FINISH:SPEC-100015
6	712-0214	1	ECROU	FINISH:SPEC-100015
7	712-0240	1	ECROU HEX.: 7/16-20:GR2	FINISH:MTD SPEC-100015
8	712-04063	3	ECROU HEX. AVEC FLANC	FINISH:MTD SPEC-100015
9	712-04065	1	ECROU HEXAGONAL	FINISH:SPEC-100015 912-04065
9A	712-0431	1	ECROU STOP 3/8-16:GRF	FINISH:MTD SPEC-100015
10	723-0448A	1	ROTULE DE DIRECTION 7/16-20	FINISH:MTD SPEC-100015
11	736-0242	1	RONDELLE CONIQUE.340X.872X.060	FINISH:MTD SPEC-100016
13	738-04141	1	AXE	FINISH:SPEC-100015
14	738-04162C	1	RONDELLE EPAULEE	FINISH:DAMPFBEBANDELT
15	738-0919A	1	COLONNE DE DIRECTION	FINISH:PHOS & OIL
16	741-04124	1	PALIER DE BRIDE	FINISH:PLAIN
17	747-05385	1	TRINGLE DE DIRECTION	FINISH:701-01007
18	748-0389	1	BAGUE	FINISH:GEÖLT
19	748-04068	1	DOUBLE .71IDX.125 ODX.56 LG	FINISH:SPEC-100015
20	748-04278ZW	1	BIELLE DE DIRECTION	FINISH:BLAU CHROMATIEREN

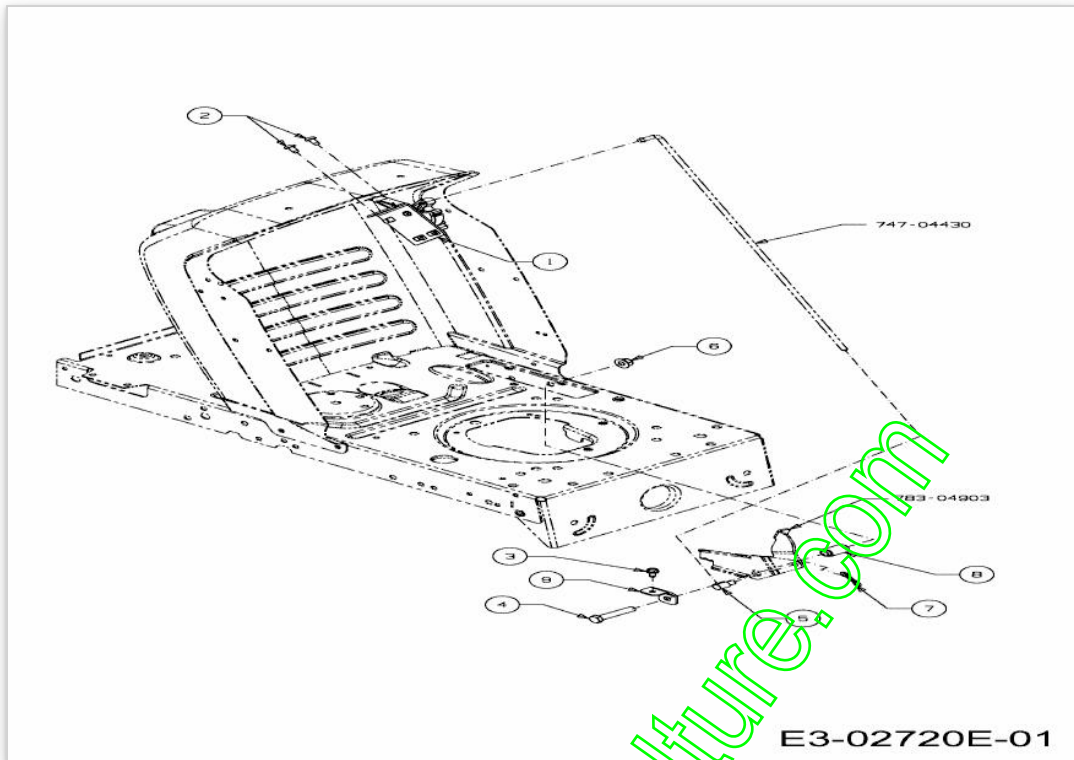

[www.emc-motoculture.com](http://www.emc-motoculture.com)

Position	Numéro de lapièce	#	Appellation I	Appellation II
1	683-04226	1	STEUERUNG VST:HYDRO:LT-5	
2	710-05070	2	VIS	FINISH:SCHWARZ SPEC 701-01010
3	710-0599	1	VIS A SIX PANS CREUX	FINISH:MTD SPEC-101617
4	710-3144	1	VIS HEX.: 3/8- 16:2.00:GR5:STD	FINISH:SPEC-100015 910-3144
5	711-0736	1	AXE	FINISH:MTD SPEC-100015
6	712-04065	1	ECROU HEXAGONAL	FINISH:SPEC-100015 912-04065
7	714-04040	1	GOUPILLE	FINISH:ASTM F1941 FE/ZN 3AN
8	750-04465C	1	ENTRETOISE	FINISH:GEÖLT
9	783-06823	1	SUPPORT	KONTROLLHEBEL:VERZ.SIEHE ZG.

[www.emc-motoculture.com](http://www.emc-motoculture.com)

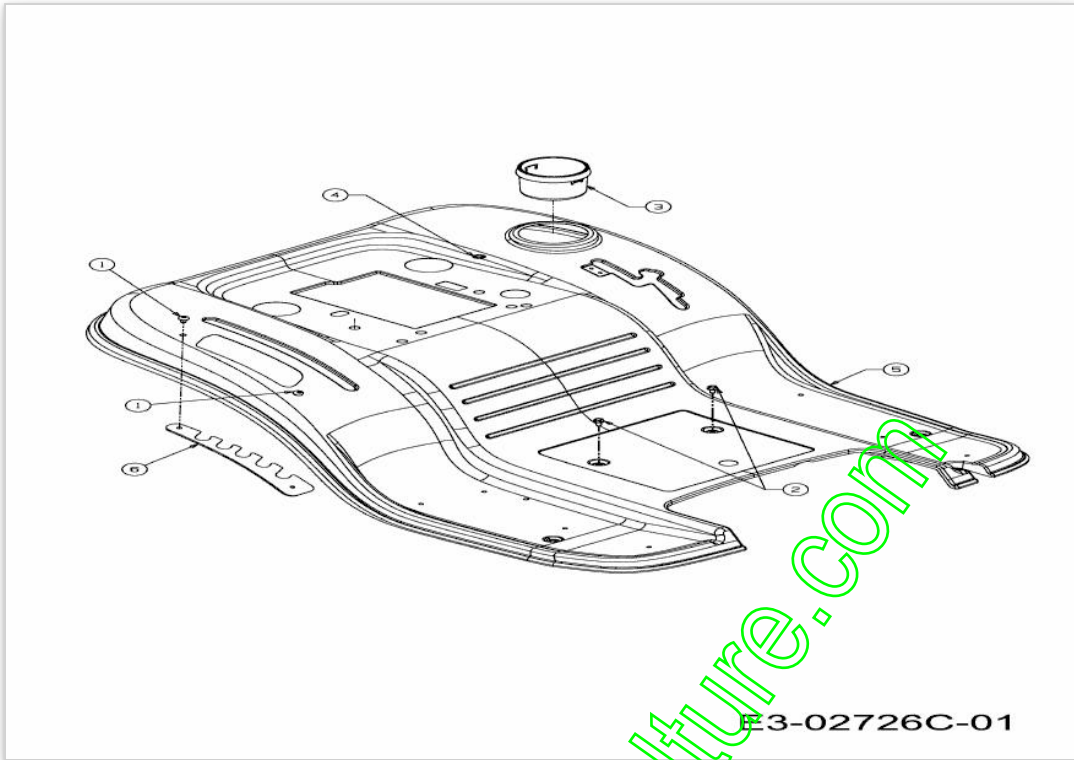

[www.emc-motoculture.com](http://www.emc-motoculture.com)

Position	Numéro de lapièce	#	Appellation I	Appellation II
1	710-05070A	2	VIS	FINISH:SCHWARZ SPEC-000087
2	710-0599	2	VIS A SIX PANS CREUX	FINISH:MTD SPEC-101617
3	731-04591A	1	PORTE GOBELET	FINISH:KUNSTSTOFF SCHWARZ
4	736-0607	1	RONDELLE	FINISH:MTD SPEC-100016
5	783-04593E	1		
6	783-04843	1	RASTPLATTE:5- FACH:DECK:LT-5	FINISH LACKIERT

[www.emc-motoculture.com](http://www.emc-motoculture.com)



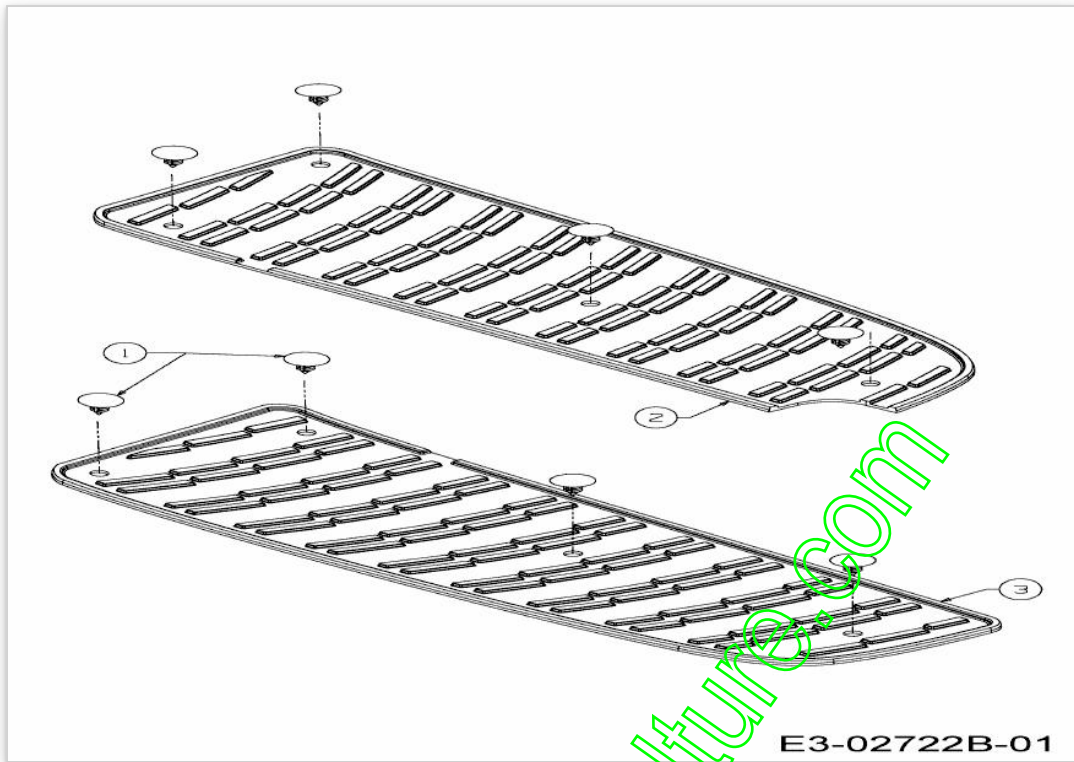

E3-02722B-01

[www.emc-motoculture.com](http://www.emc-motoculture.com)

Position	Numéro de lapièce	#	Appellation I	Appellation II
1	726-3046	8	CLIP DE FIXATION:.250 DIA	FINISH:KUNSTSTOFF SCHWARZ
2	735-04047	1	MARCHE PIED GAUCHE	FINISH:SCHWARZ
3	735-04048	1	MARCHE PIED DROITE	FINISH:SCHWARZ

[www.emc-motoculture.com](http://www.emc-motoculture.com)

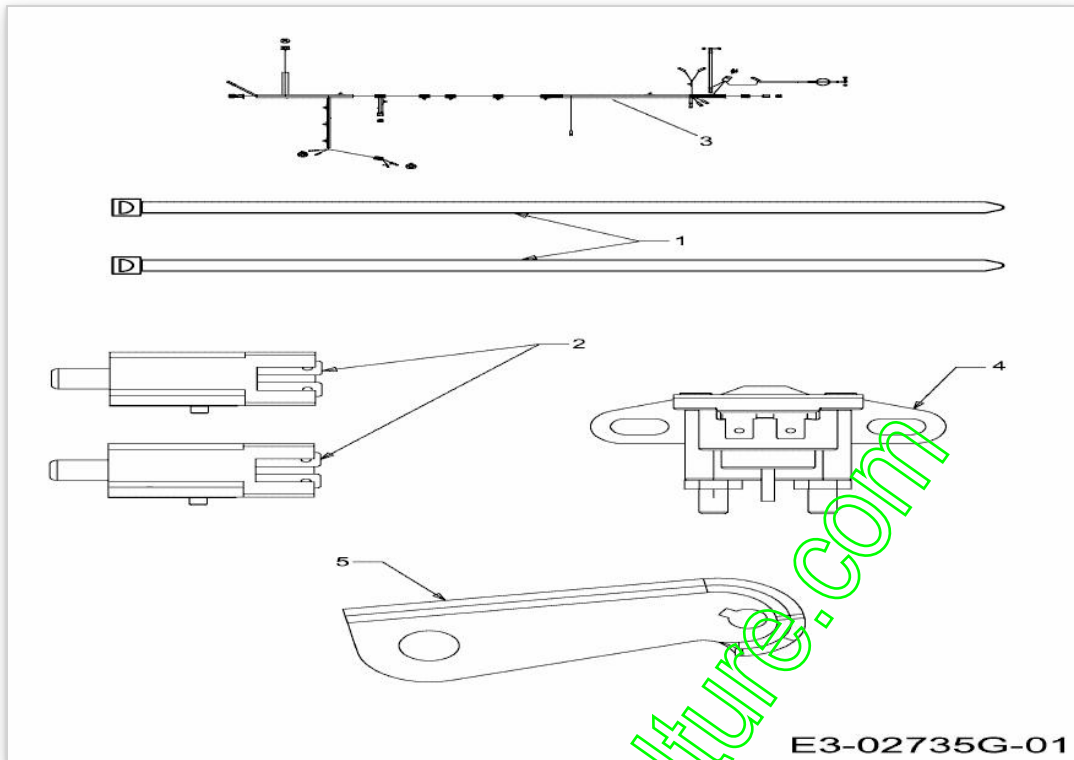

Position	Numéro de lapièce	#	Appellation I	Appellation II
1	725-0157	2	COLLIER DE SERRAGE3/16X0.5X7.4	MATERIAL:NYLON-SCHWARZ
2	725-04363	2	SECURITE EMBRAYAGE	FINISH:SIEHE ZG.
3	725-04433F	1	FAISCEAU COMPLET	
4	725-04439	1	COMMUTATEUR MAGNÛTIQUE	12V:100 AMP
5	783-06991	1	SUPPORT	SD-TR./HYDRO:783-06991-Z

[www.emc-motoculture.com](http://www.emc-motoculture.com)

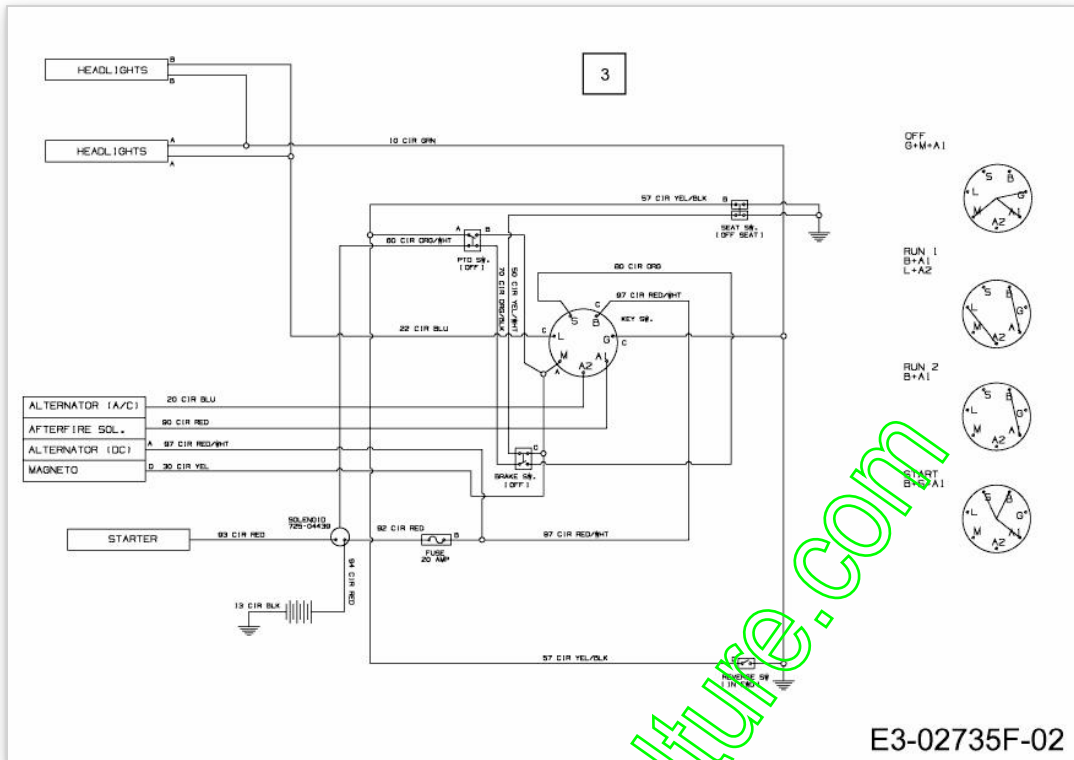

E3-02735F-02

Position	Numéro de pièce	#	Appellation I
3	725-04433F	1	FAISCEAU COMPLET

[www.emc-motoculture.com](http://www.emc-motoculture.com)

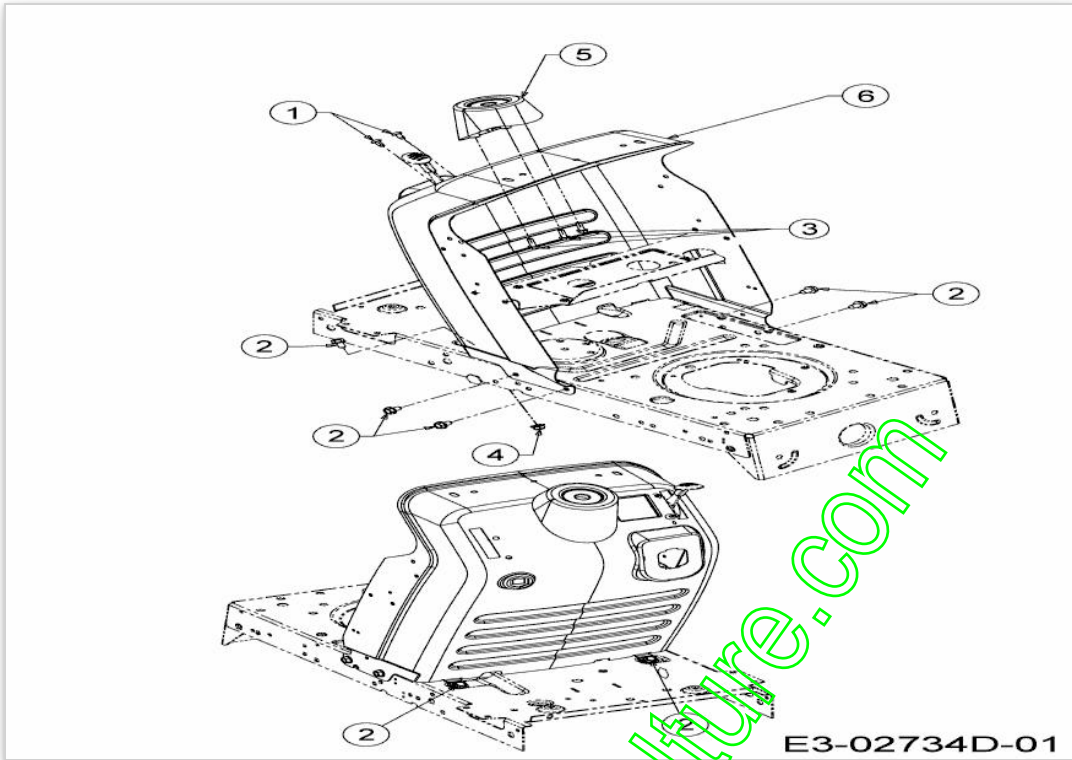

E3-02734D-01

[www.emc-motoculture.com](http://www.emc-motoculture.com)

Position	Numéro de lapièce	#	Appellation I	Appellation II
1	710-04483	2	VIS:TT:1/4- 20.:500:TRUSTRXI	FINISH:GELB SPEC-701-01002
2	710-0604A	6	VIS 5/16-18:0.625	FINISH:MTD SPEC-100016 TYPE 1
3	710-0895	3	VIS A SIX PANS CREUX	FINISH:MTD SPEC-100016 TYPE 1
4	712-04063	1	ECROU HEX. AVEC FLANC	FINISH:MTD SPEC-100015
5	731-04945	1	SUPPORT VOLANT	FINISH:SIEHE ZG.
6	783-04873B	1	ANTRAZITE GRIS	FINISH:LACKIERT

[www.emc-motoculture.com](http://www.emc-motoculture.com)



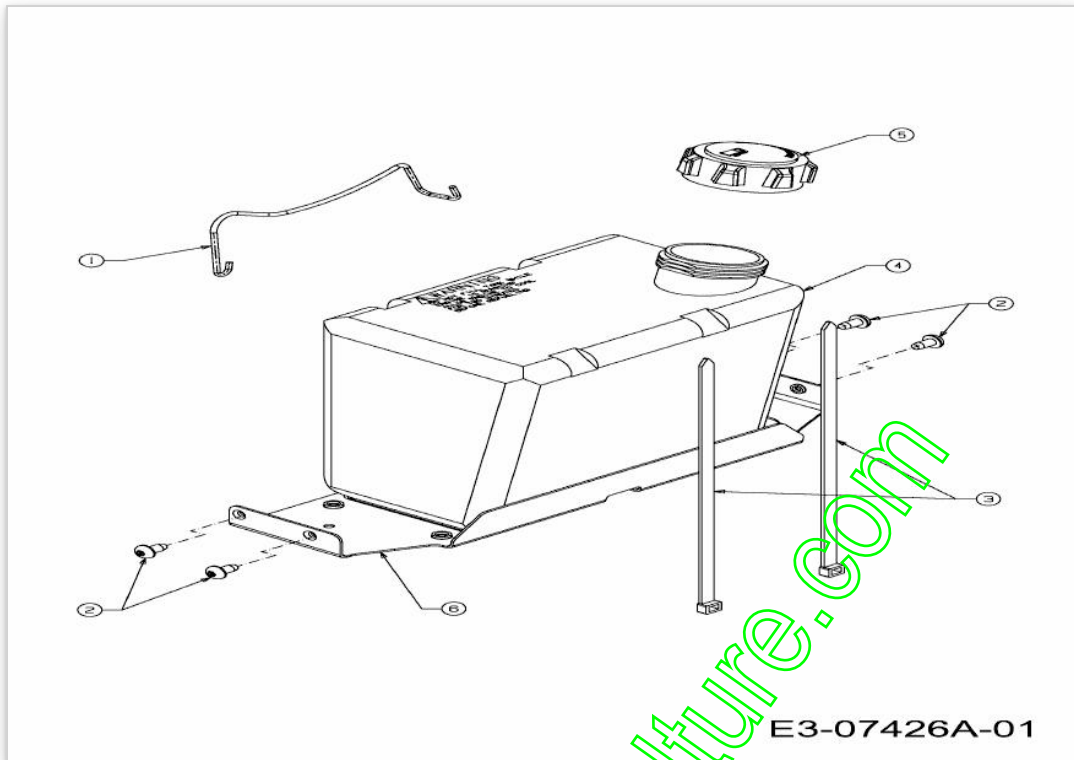

Position	Numéro de pièce	#	Appellation I	Appellation II
1	683-04448637	1	TRINGLE SUPPORT BATTERIE	683-04448-0637
2	710-05070	4	VIS	FINISH: SCHWARZ SPEC 701-01010
3	726-0230	2	COLLIER	FINISH: SCHWARZ
4	751-0553	1	RESERVOIR 5 L ENV.	FINISH: NATUR SIEHE ZG.
5	751-0603A	1	BOUCHON ESSENCE	KUNSTSTOFF SCHWARZ -OBSOLETE-
6	783-07083637	1	SUPPORT DE RESERVOIR ESSENCE	FINISH: LACKIERT MTD QUALITÄT

[www.emc-motoculture.com](http://www.emc-motoculture.com)

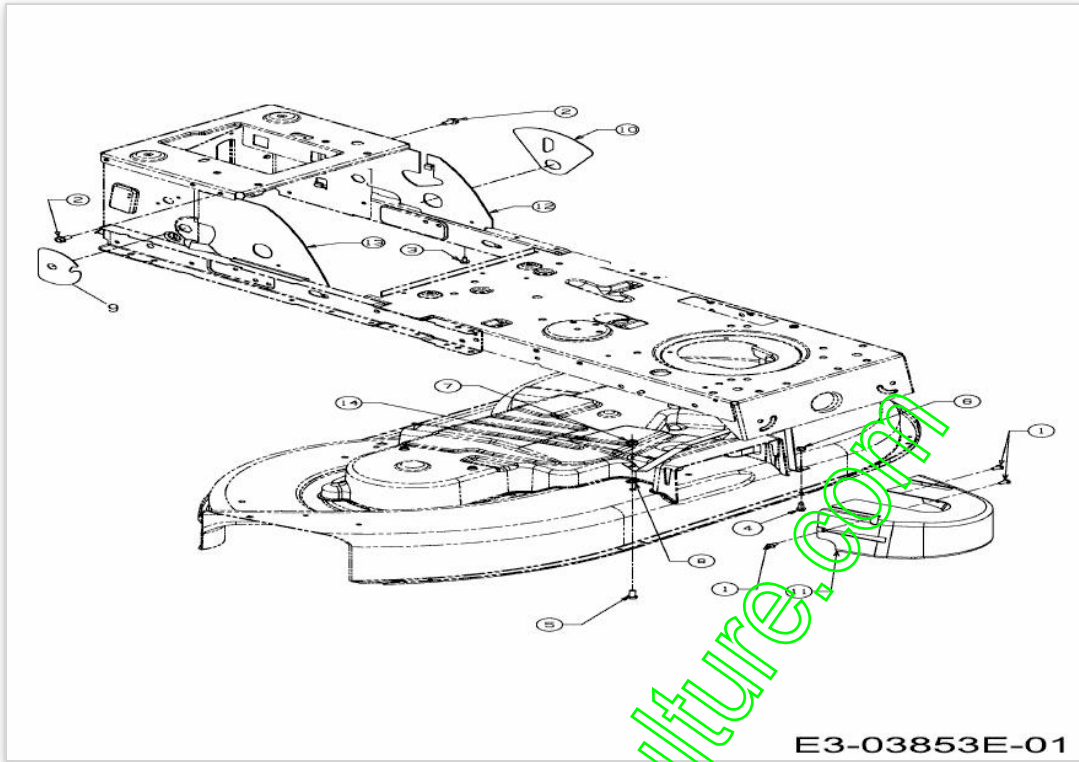

www.emc-motoculture.com

Position	Numéro de pièce	#	Appellation I	Appellation II
1	710-04030	3	VIS	FINISH:MTD SPEC-100016
2	710-04484	2	VIS HEX. TT:5/16-18:.750:HXIND	FINISH:MTD SPEC-100016 TYPE 1
3	710-0599	1	VIS A SIX PANS CREUX	FINISH:MTD SPEC-101617
4	710-0642	1	VIS1/4-20:0.750	SPEC-100016 TYPE 1 910-0642
5	710-3008	1	VIS 5/16-18:.75:GR5:STD	SPEC-701-01006 or.SPEC-100015
6	712-0271	1	ECROU 1/4-20"+ DISQUE DENTE	FINISH:MTD SPEC-100016 GR5
7	712-04063	1	ECROU HEX. AVEC FLANC	FINISH:MTD SPEC-100015
8	726-0201	1	RONDELLE .3125 ID	MECHANISCH VERZINKT:SIEHE ZG.
9	731-05586	1	COUVERCLE PLASTIQUE	KUNSTSTOFFSCHEIBE Ø115mm (DÖ)
10	731-05587	1	COUVERCLE	731-05587 (DÖ)
11	731-05658A	1	PROTEGE COURROIE DECK G	FINISH: SCHWARZ (DÖ)
12	783-05087A-S	1	RAHMENABDECKUNG LI.:LT-5:HYDRO	FINISH:LACKIERT
13	783-05088A-S	1	RAHMENABDECKUNG:RE:LT-5 HYDRO	FINISH:LACKIERT
14	783-05314A-S	1	TIGE DE MAINTIEN CARTER	SCHWARZ

www.emc-motoculture.com

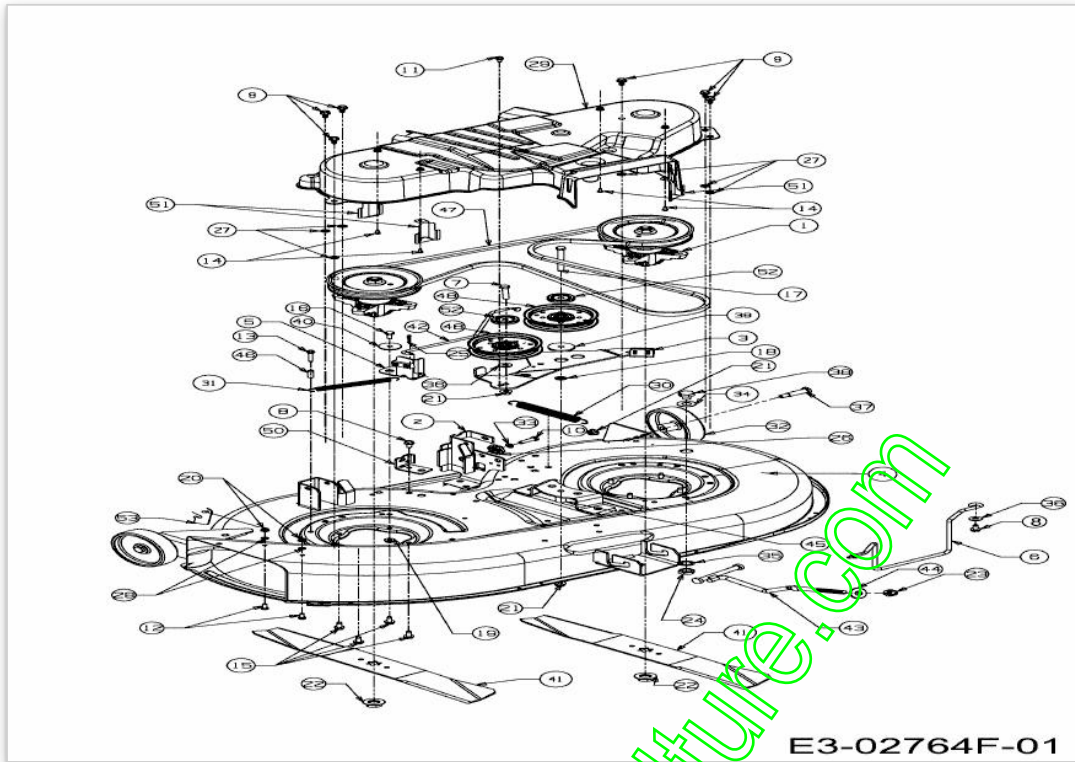

Position	Numéro de lapièce	#	Appellation I	Appellation II
1	618-04456A	2	PALIER COMPLET	VOLLST.
2	683-0254B	1	SUPPORT	SCHWEISSTEIL FINISH:LACKIERT
3	683-04138B	1	983-04138B	NIET-TEIL
4	683-04162A	1	CARTER DE COUPE 107 CM ROUGE	SCHWEISSTEIL FINISH:LACKIERT
5	983-04167	1	FREIN DE LAME DROITE	GENIETET
6	683-04443	1	KEILRIEMENFÜHRUNG VOLLST:42"	FINISH:LACKIERT
7	710-0347	1	VIS HEX. 3/8-16:1.75:GR5:STD	FINISH:MTD SPEC-100015
8	710-04484	2	VIS HEX. TT:5/16-18:.750:HXIND	FINISH:MTD SPEC-100016 TYPE 1
9	710-05045A	6	VIS	FINISH:SPEC-100016 TYPE 1
10	710-0528	1	VIS HEX. 5/16-18:1.25:GR5:STD	FINISH:SPEC-100015 910-0528
11	710-0599	1	VIS A SIX PANS CREUX	FINISH:MTD SPEC-101617
12	710-0751	2	VIS HEX.: 1/4-20:.620:GR5:STD	FINISH:SPEC-100015
13	710-0778	1	VIS HEX. TT:1/4-20:1.500	FINISH:MTD SPEC-100016 TYPE 1
14	710-0919	4	VIS HEX. B:#10-16:0440:HEX	FINISH:MTD SPEC-100016 TYPE 1
15	710-1260A	8	VIS TT:5/16-18:.750	FINISH:SPEC-100016 TYPE 1
16	710-3008	1	VIS 5/16-18:.75:GR5:STD	SPEC-701-01006 or.SPEC-100015
17	710-3085	1	VIS	FINISH:MTD SPEC-100015
18	712-0229	1	ECROU	FINISH:SPEC-100016
19	712-04063	1	ECROU HEX. AVEC FLANC	FINISH:MTD SPEC-100015
20	712-04064	2	ECROU HEXAGONAL	FINISH:SPEC-100015 912-04064
21	712-04065	4	ECROU HEXAGONAL	FINISH:SPEC-100015 912-04065
22	712-0417A	2	ÜCROU HEX. AV. FLANC: 5/8-18	FINISH:MTD STD 701-01000
23	712-04243	1	ECROU	FINISH:MTD SPEC-100015
24	712-0641	1	ECROU HEX. M16-1.5 DIN 936	FINISH:SPEC-100015 24.1424.31
25	714-04040	1	GOUPILLE	FINISH:ASTM F1941 FE/ZN 3AN
26	717-04074	1	PIGNON HAUTEUR PLATEAU	PHOS & SPEC-100015 917-04074
27	726-0201	6	RONDELLE 3125 ID	MECHANISCH VERZINKT:SIEHE ZG.
28	726-0233	2	RONDELLE	MECHANISCH KLAR VERZINKT
29	731-05657B	1	CARTER PLASTIQUE COUPE 107CM	FINISH:SCHWARZ (ZW)
30	732-04280B	1	RESSORT .75 OD X 6.375LG	FINISH:MTD STD 701-01006
31	732-04287	1	RESSORT	SPEC 701-01006 OR SPEC-100015
32	734-0973	2	ROULETTE DE PLATEAU	FINISH:KUNSTSTOFF SCHWARZ
33	736-0119	1	RONDELLE	FINISH:MTD SPEC-100016
34	736-0187	1	RONDELLE .64X1.24X.06	FINISH:MTD SPEC-100016
35	736-0225	1	RONDELLE	FINISH:MTD SPEC-100016
36	736-0300	2	RONDELLE	FINISH:MTD SPEC-100015
37	738-0373	2	VIS A EPAULE .496x1.525:3/8-16	FINISH:MTD SPEC-100015
38	738-04146	1	VIS BOUCHON	DECKWASCHDÜSE:SPEC-100015
39	738-04162C	1	RONDELLE EPAULEE	FINISH:DAMPFBEHANDELT
40	738-04166	1	ENTRETOISE .5000 X .1475	FINISH: IN ÖL GETAUCHT
41	742-0674	2	LAME PLATE COUPE 107CM	FINISH:SIEHE ZG. 942-0674

Position	Numéro de lapièce	#	Appellation I	Appellation II
42	747-04379A	1	TIGE DE FREIN	FINISH:SPEC-100015
43	747-04882	1	TRINGLE MAINTIEN CARTER	.4480" DIA:FINISH 747-04882-Z
44	748-04069	1	RONDELLE	FINISH:701-01001 LT-5/NX15
45	750-04446	1	DOUILLE 3/8 ID X.68 OD X 1.46	FINISH:EINGEÖLT
46	750-0566A	1	ENTRETOISE	FINISH:MTD SPEC-100015
47	754-04060B	1	COURROIE DE COUPE 107 CM	954-04060B
48	756-04129B	2	POULIE DE TENSION	KUGELGELAGERT:FINISH
49	771-11725A	1	AUTOCOLLANT PLATEAU RT99	RT 99:ENGLISCH/FRANZÖSISCH
50	783-04740	1	FÜHRUNGSBL:BOWDENZUG:DECKBETÄT	FINISH:LACKIERT
51	783-05497-Z	4	SUPPORT	FINISH:TROMMELVERZINKT
52	783-07236	2	CAPUCHON DE POULIE	FINISH:PLAIN
53	783-1025	1	PLAQUE ACCROCHE DEFLECTEUR	FINISH:VERZINKT

[www.emc-motoculture.com](http://www.emc-motoculture.com)

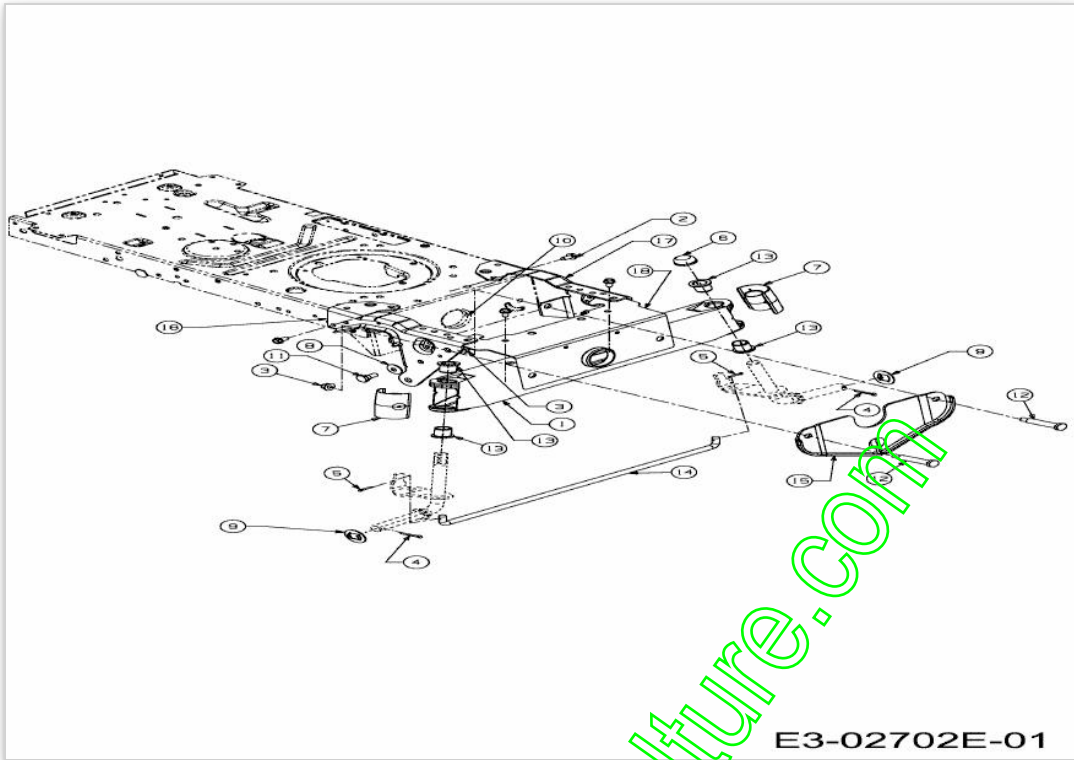

[www.emc-motoculture.com](http://www.emc-motoculture.com)



Position	Numéro de pièce	#	Appellation I	Appellation II
1	683-0128B	1	BLECH-VORDERACHSE VOLLST:	SCHWEISSTEIL: 683-0128B-0637
2	710-04484	4	VIS HEX. TT:5/16-18:.750:HXIND	FINISH:MTD SPEC-100016 TYPE 1
3	712-04065	4	ECROU HEXAGONAL	FINISH:SPEC-100015 912-04065
4	714-0162	2	GOUPILLE FENDUE 5/32:1.25	FINISH:MTD SPEC-100015
5	714-0474	2	GOUPILLE	FINISH:MTD SPEC-100015
6	726-0341	1	CAPUCHON CLIPS	FINISH:SCHWARZ
7	731-1291A	2	CARTER PLASTIQUE	MATERIAL:PP-SCHWARZ:LT5
8	736-0331	2	RONDELLE CONIQUE	FINISH:MTD SPEC-100016
9	736-04228A	2	RONDELLE	FINISH:MTD SPEC-100015
11	738-0143	2	VIS EPAULEE	FINISH:MTD SPEC 100015 (EU)
12	738-04128	2	VIS A EPAULE .500x2.38:3/8-16	FINISH:MTD SPEC-100015
13	741-0660A	4	BAGUE ESSIEU DE ROUE	FINISH:KUNSTSTOFF SCHWARZ
14	747-04299A	1	TRINGLE DE DIRECTION	FINISH:SPEC-100015 or E-Coat
15	783-04568	1	PLAQUE AVANT	FINISH:LACKIERT
16	783-0726E	1	VORDERACHSHALTER RECHTS	FINISH:LACKIERT
17	783-0727D	1	VORDERACHSHALTER LINKS	FINISH:LACKIERT
18	783-0728B	1	VORDERACHSTRÄGER	FINISH:LACKIERT

www.emc-motoculture.com

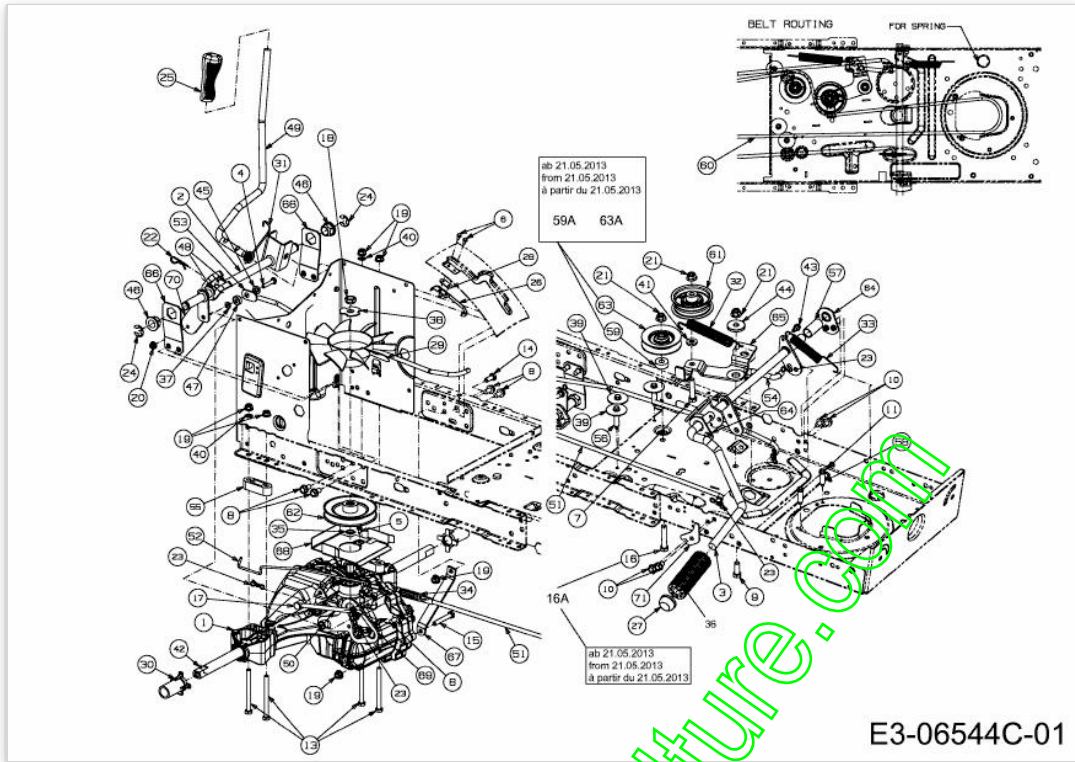

www.emc-motoculture.com

Position	Numéro de lapièce	#	Appellation I	Appellation II
1	618-04892B	1	SE RENSEIGNER MTD FRANCE	FINISH:
2	647-04200A-Z	1	KONTROLLHEBEL GESCHW.LT-5 HYDR	FINISH:SPEC-100015
3	647-04261A	1		
4	710-0106	1	VIS HEX. 1/4-20:1.25:GR5:SPEC	FINISH:MTD SPEC-100015
5	710-0224	1	VIS PARK:#10-16:0.500:HXINDWSH	FINISH:MTD SPEC-100016 TYPE 1
6	710-0227	2	VIS	FINISH:MTD SPEC-100016 TYPE 1
7	710-0347	1	VIS HEX. 3/8-16:1.75:GR5:STD	FINISH:MTD SPEC-100015
8	710-04484	5	VIS HEX. TT:5/16-18.:750:HXIND	FINISH:MTD SPEC-100016 TYPE 1
9	710-0514	1	VIS HEX.:3/8-16:1.00:GR5:STD	FINISH:MTD SPEC-100015
10	710-0604A	4	VIS 5/16-18:0.625	FINISH:MTD SPEC-100016 TYPE 1
11	710-0809	2	VIS HEX. TT:1/4-20:1.250:HXIND	FINISH:MTD SPEC-100016 TYPE 1
12	710-1026	3	VIS HEX:TT:1/4-20:1.750	FINISH:MTD-SPEC-100016
13	710-1266	4	VIS HHCS:5/16-18:3.5:GR5:STD	FINISH:MTD SPEC-100015
14	710-3008	1	VIS 5/16-18.:75:GR5:STD	SPEC-701-01006 or.SPEC-100015
15	710-3103	1	VIS HEX.:5/16-18:2.00:GR5:STD	FINISH:MTD SPEC-100015
16	710-3144	1	VIS HEX.: 3/8-16:2.00:GR5:STD	FINISH:SPEC-100015 910-3144
16A	710-0347	1	VIS HEX. 3/8-16:1.75:GR5:STD	FINISH:MTD SPEC-100015
17	711-04448	1	FERRURE	FINISH:ASTM F1941 FE/ZN 3AN
18	712-0346	1	ECROU HEX. 1/2-20:GR5:NYL ON	FINISH:SPEC-100015 912-0346
19	712-04063	6	ECROU HEX. AVEC FLANG	FINISH:MTD SPEC-100015
20	712-04064	1	ECROU HEXAGONAL	FINISH:SPEC-100015 912-04064
21	712-04065	3	ECROU HEXAGONAL	FINISH:SPEC-100015 912-04065
22	714-0145	1	GOUPILLE	FINISH:SPEC-701-01006
23	714-04040	5	GOUPILLE	FINISH:ASTM F1941 FE/ZN 3AN
24	716-0106A	2	CIRCLIPS	FINISH:PHOSPHATIERT
25	720-0311	1	POIGNÉE LEVIER COUPE : 1/2	FARBE: SCHWARZ VINYL
26	725-04249	1	INTERRUPTEUR ; RESSORT	FINISH:MTD SPEC-100015
27	726-0214	1	BOUCHON	FINISH: SCHWARZ
28	726-0320	1	PLAQUE D'ISOLATION	FINISH:NATUR ODER SCHWARZ
29	731-06098	1	HELICE DE REFROIDISSEMENT	FINISH:NATUR
30	731-08237	2	MANCHON	FINISH:KUNSTSTOFF SCHWARZ
31	732-04225	1	RESSORT	FINISH:MTD STD 701-01006
32	732-04229	1	RESSORT	FINISH:SPEC-100015
33	732-04587	1	RESSORT	SPEC-701-01006 or SPEC-100015
34	732-0716D	1	RESSORT	FINISH:MTD STD 701-01006
35	732-0729	1	CIRCLIP	FINISH:SIEHE ZG.
36	735-0239	1	CAOUTCHOUC/PEDALE 4;0 LG	FINISH: SCHWARZ
37	736-0142	1	RONDELLE PLATE 1/4X.500X . 063	FINISH:MTD SPEC-100015
38	736-04263	1	RONDELLE	736-04263
39	736-0430	3	RONDELLE .350X.1.59X.062	FINISH:MTD SPEC-100015
40	736-0607	2	RONDELLE	FINISH:MTD SPEC-100016
41	736-3010	1	RONDELLE	FINISH:MTD SPEC-100016

Position	Numéro de pièce	#	Appellation I	Appellation II
43	738-04278	1	VIS	FINISH:MTD STD SPEC-100016
44	738-04430	1	RONDELLE GALET TENDEUR	FINISH:GEÖLT
45	738-04483	1	ENTRETOISE	FINISH:ÖL GEDIPPT
46	741-0225	2	BAGUE HEXAGONALE TEFLON 6 PANS	FINISH:KUNSTSTOFF SCHWARZ
47	741-04280	1	ROULEMENT	FINISH:GEÖLT
48	741-3065B	2	BAGUE HEXAGONALE RAINUREE	GESCHLITZT:FINISH SCHWARZ
49	747-04296A	1	SCHALTHEBEL:HYDRO	FINISH:SPEC-100015
50	747-04407A	1	TRINGLE	FINISH:701-01006/SPEC-100015
51	747-05242	1	BREMSSTANGE:LT-5:HYDRO T2	FINISH:SPEC-101616
52	747-05245	1	tige de bypass	FINISH:SPEC-100015
53	747-05598637	1	STANGE:BETÄTIGUNG:HYDRO	FINISH:LACKIERT MTD QUALITÄT
54	747-05603	1	TIGE DE SUPPORT COUPLAGE HYDRO	FINISH:SPEC-100015
55	748-0334	2	ENTRETOISE	FINISH:GEÖLT
56	750-04456	3	ENTRETOISE	FINISH:MTD SPEC-100015
57	750-05593	1	DISTANZROHR:.635 x.775 x 1.580	FINISH:KUNSTSTOFF SCHWARZ
58	750-0566A	2	ENTRETOISE	FINISH:MTD SPEC-100015
59	750-3119	1	ENTRETOISE MANCHON	750-3119
59A	736-3010	1	RONDELLE	FINISH:MTD SPEC-100016
60	754-04252	1	COURROIE DE TRANSMISSION	FINISH:
61	756-04224	1	POULIE TENDEUR	BLK ECOAT,PAINT OR SPEC-100015
62	756-04308	1	POULIE DE PONT	FINISH:SPEC-100015
63	756-04325	1	POULIE TENDEUR	FINISH:SCHWARZ LACKIERT
63A	756-04224	1	POULIE TENDEUR	BLK ECOAT,PAINT OR SPEC-100015
64	783-04536B-S	2	SUPPORT	SCHWARZ LACKIERT
65	783-04570B	1	SUPPORT POULIE TENDEUR	FINISH:SPEC-100015
66	783-04585A-S	2	PLAQUE DE FIXATION	SCHWARZ LACKIERT
67	783-06551	1	783-06551/637	4.2":FINISH:SIEHE ZG.
68	783-06558	1	783-06558/637	FINISH:LACKIERT
69	783-06750A-S	1	KURVENBLECH:CONTR:SCHALTNOCKEN	FINISH:LACKIERT MTD QUALITÄT
70	783-06756	1		
71	783-06807A-S	1	PLATTE:ANSCHLAG:PEDAL	FINISH:LACKIERT MTD QUALITÄT

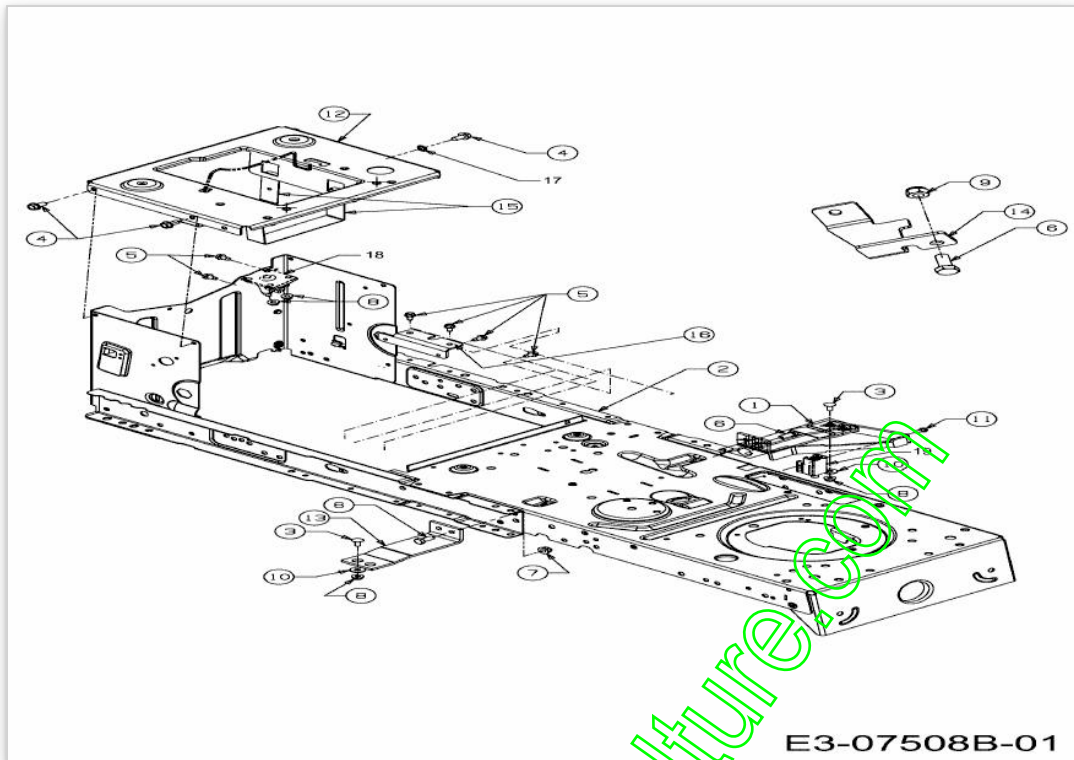

Position	Numéro de pièce	#	Appellation I	Appellation II
1	683-04195	1	STÜTZKONSOLE-LI.SITZWANNE LT5	SCHWEISSTEIL
2	683-04649A	1		
3	710-0134	2	VIS ; Tête PLATE	FINISH:MTD SPEC-100015
4	710-04484	4	VIS HEX. TT:5/16-18:.750:HXIND	FINISH:MTD SPEC-100016 TYPE 1
5	710-0599	6	VIS A SIX PANS CREUX	FINISH:MTD SPEC-101617
6	710-3008	3	VIS 5/16-18:.75:GR5:STD	SPEC-701-01006 or.SPEC-100015
7	712-04063	2	ECROU HEX. AVEC FLANC	FINISH:MTD SPEC-100015
8	712-04064	4	ECROU HEXAGONAL	FINISH:SPEC-100015 912-04064
9	712-0429	1	ECROU	FINISH:SPEC-100015
10	736-0173	2	RONDELLE 281DX 74ODX.063	FINISH:MTD SPEC-100015
11	738-04237A	1	AXE EPAULE	FINISH:MTD SPEC-100016
12	783-04548D	1		
13	783-04637	1	STÜTZKONSOLE SITZWANNE LT5	FINISH:NONE
14	783-04753	1	STÜTZBLECH RAHMEN	FINISH:NONE
15	783-04869A	2	HALTEBLECH:BATTERIE:LT-5	FINISH:LACKIERT
16	783-05389A	1	ABSTANDHALTER:RAHMEN	FINISH:LACKIERT MTD QUALITÄT
17	736-0670	1	RONDELLE	Zn 5glcB 24.6487.18
18	725-1426A	1	RELAIS DE DEMARRAGE	12V:100 AMP
19	725-04363	1	SECURITE EMBRAYAGE	FINISH:SIEHE ZG.

www.emc-motoculture.com

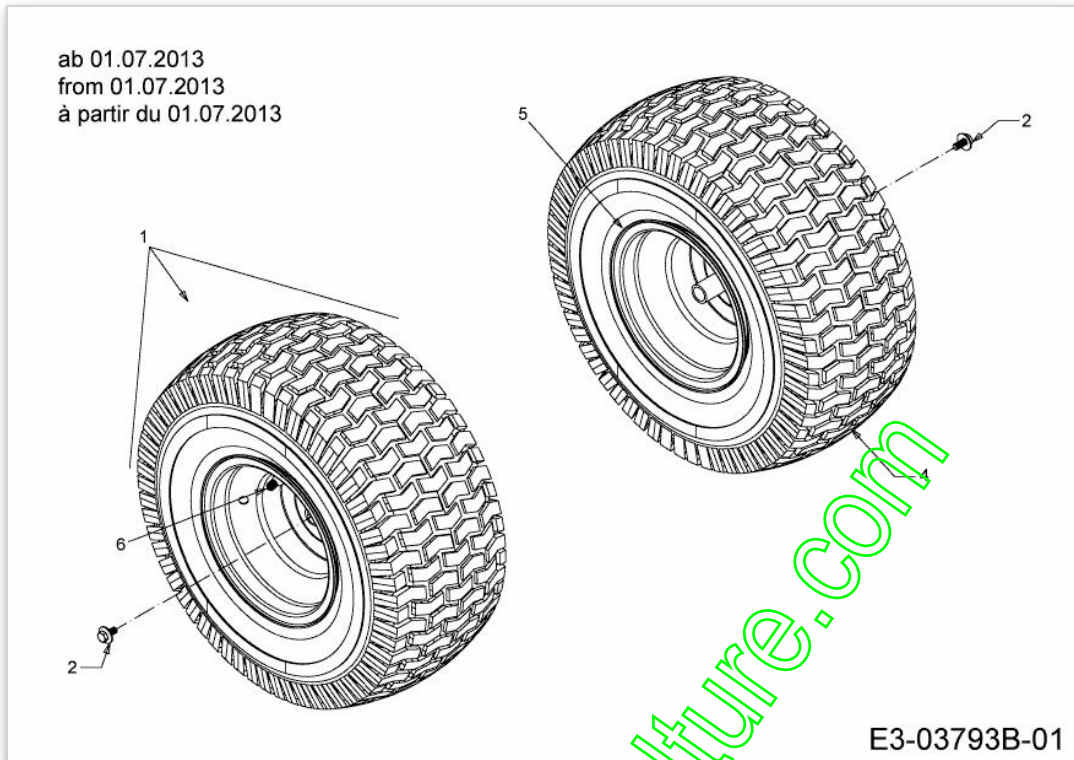

Position	Numéro de lapièce	#	Appellation I	Appellation II
1	634-0104	2	ROUE COMPL 20" x 8" BEIGE	FINISH:SIEHE FARBVARIANTEN
2	710-05339	2	VIS	GR5 E-TEIL-SET
4	734-1730	2	PNEU 20X800	SQ:SH:TURF SAVER 734-1730-0902
5	634-04369	2	JANTE 8.0x7.0x .750 ID	FINISH:LACKIERT
6	734-0255	2	VALVE:PNEU	TR 412-P / 32.6mm / 934-0255

[www.emc-motoculture.com](http://www.emc-motoculture.com)



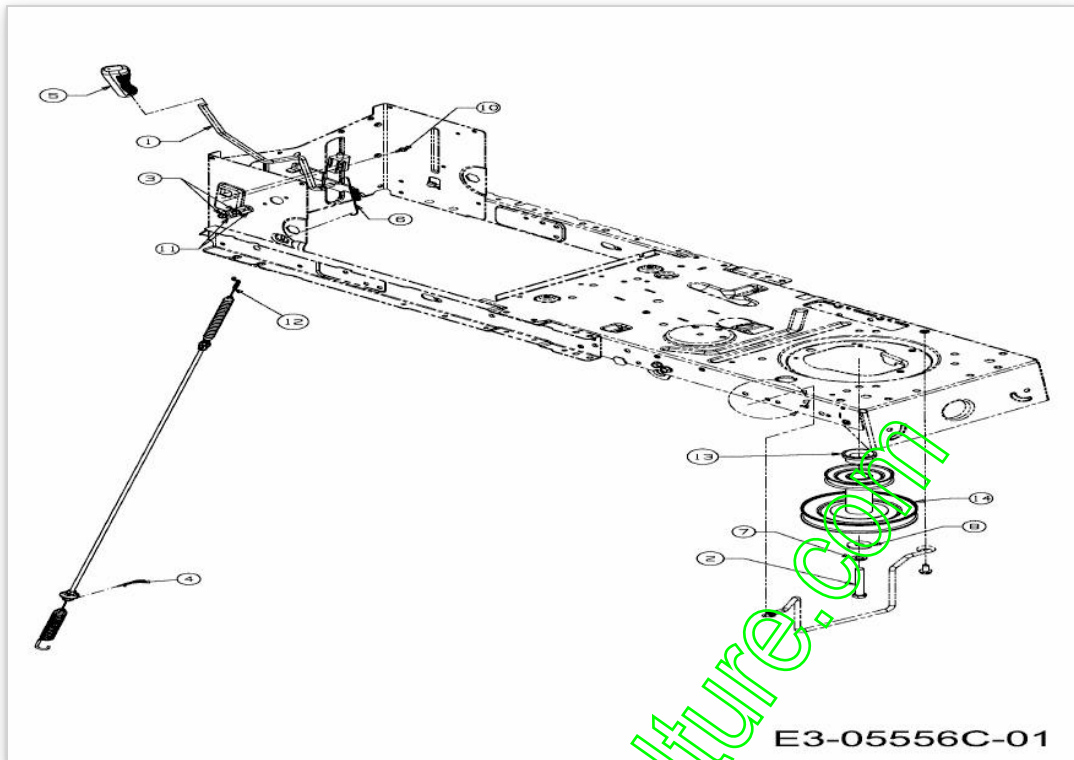

www.emc-motoculture.com

E3-05556C-01

Position	Numéro de pièce	#	Appellation I	Appellation II
1	647-04096A-S	1	LEVIER EMBRAYAGE	SCHWEISSTEIL:FINISH LACKIERT
2	710-04608	1	VIS HEX. HHCS:7/16-20:3.25:GR5	FINISH:MTD SPEC-100015
3	710-0599	2	VIS A SIX PANS CREUX	FINISH:MTD SPEC-101617
4	714-0145	1	GOUPILLE	FINISH:SPEC-701-01006
5	720-04049A	1	POIGNEE PLASTIQUE	FINISH:SCHWARZ
6	732-04276A	1	RESSORT	FINISH:MTD SPEC-701-01006
7	736-0171	1	RONDELLE GROWER	FINISH:MTD SPEC-100016
8	736-0322	1	RONDELLE .450 X 1.250 X .164	FINISH:SPEC-100016 936-0322
10	738-04237A	1	AXE EPAULE	FINISH:MTD SPEC-100016
11	741-04119A	2	SUPPORT PLASTIQUE	KUNSTSTOFF:SCHWARZ
12	746-04173E	1	CABLE D EMBRAYAGE	VERKAPSELT E-TEIL-SET
13	750-0956	1	ENTRETOISE	FINISH:PLAIN
14	756-04067A	1	POULIE MOTEUR HYDRO	HYDRO:FINISH:SPEC-701-01000

www.emc-motoculture.com

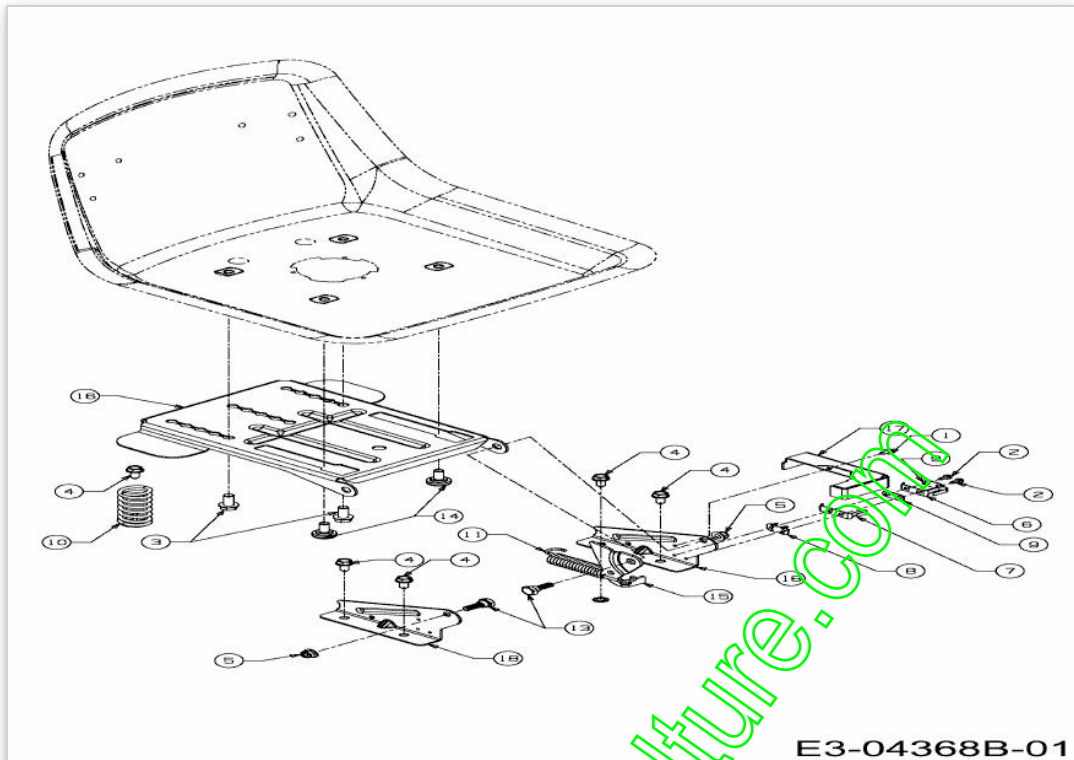

[www.emc-motoculture.com](http://www.emc-motoculture.com)

Position	Numéro de pièce	#	Appellation I	Appellation II
1	710-0224	1	VIS PARK:#10-16:0.500:HXINDWSH	FINISH:MTD SPEC-100016 TYPE 1
2	710-0227	2	VIS	FINISH:MTD SPEC-100016 TYPE 1
3	710-04482	2	VIS:3/8-16:.875:GR5:STD	FINISH:MTD SPEC-100015
4	710-04484	6	VIS HEX. TT:5/16-18:.750:HXIND	FINISH:MTD SPEC-100016 TYPE 1
5	712-04063	2	ECROU HEX. AVEC FLANC	FINISH:MTD SPEC-100015
6	725-1303	1	RESSORT DE SURETE SIËGE	SI.-SCHALTER SITZ:SPEC-100015
7	725-1439	1	RESSORT SURETE DE SIEGE	SI.-SCHALTER SITZ:SPEC-100015
8	726-0278	1	PLAQUE D'ISOLATION	FINISH:NATUR ODER SCHWARZ
9	726-0279	2	PLAQUE D'ISOLATION	FINISH:NATUR ODER SCHWARZ
10	732-04035	2	RESSORT DE SIEGE	FINISH:SPEC-100015
11	732-04309	1	RESSORT	FINISH:MTD STD 701-01006
12	736-0607	1	RONDELLE	FINISH:MTD SPEC-100016
13	738-0296	2	AXE EPAULE	FINISH:SPEC-100015
14	738-04012A	2	VIS EPAULEE	FINISH:SIEHE ZG.
15	783-0209D	1	SUPP. SIËGE	FINISH:SPEC-100016
16	783-04081D	1	783-06352637	FINISH:LACKIERT MTD QUALITÄT
17	783-04877A	1	783-06279	FINISH:LACKIERT
18	783-1489D	2	783-1489B-4015 / FEUERROTQ	

www.emc-motoculture.com

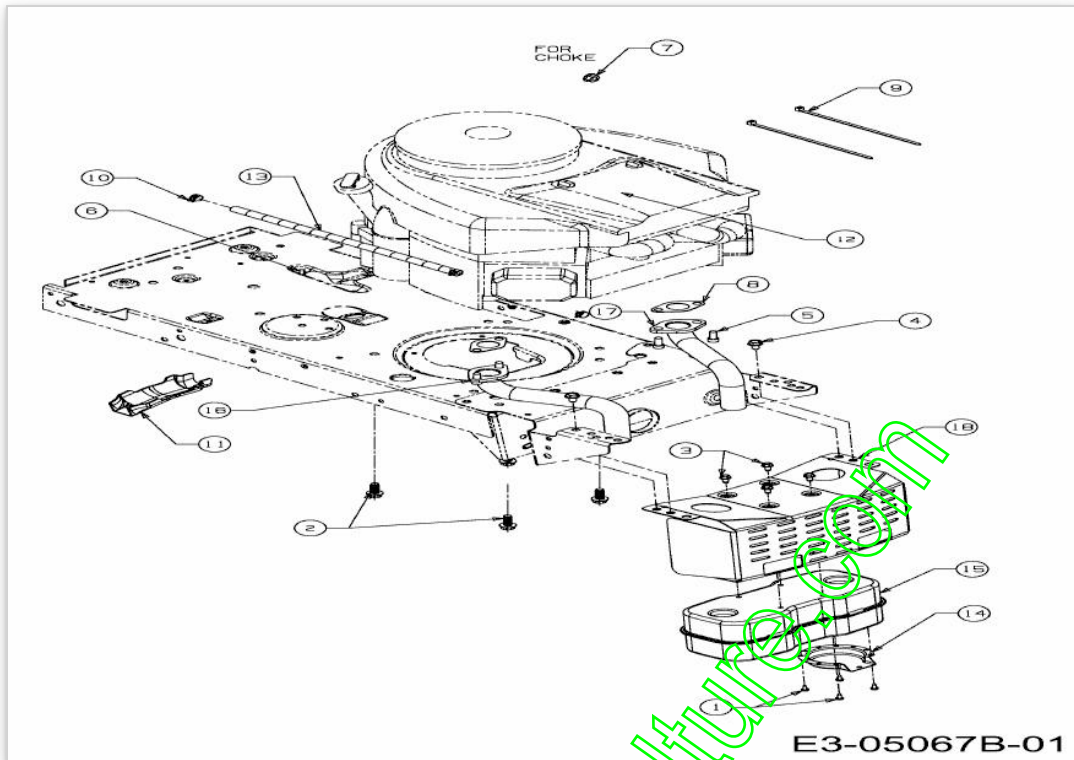

Position	Numéro de pièce	#	Appellation I	Appellation II
1	710-0227	4	VIS	FINISH:MTD SPEC-100016 TYPE 1
2	710-04683A	4	VIS	FINISH:MTD SPEC-701-01002
3	710-0599	4	VIS A SIX PANS CREUX	FINISH:MTD SPEC-101617
4	710-0604A	2	VIS 5/16-18:0.625	FINISH:MTD SPEC-100016 TYPE 1
5	710-1314A	4	VIS HEX. INT. 5/16-18:.75:GR8	FINISH: GM4435M CODE A
6	712-0271	1	ECROU 1/4-20"+ DISQUE DENTE	FINISH:MTD SPEC-100016 GR5
7	712-3005	1	ECROU AVEC FLANC:3/8-16:GR5	FINISH:SPEC 100015 912-3005
8	721-0460	2	JOINT D'ECHAPPEMT. INTEK TWIN	B&S P273485
9	725-0157	2	COLLIER DE SERRAGE3/16X0.5X7.4	MATERIAL:NYLON-SCHWARZ
10	726-0205	2	COLLIER DE SERRAGE DE BOYAU	FINISH:PHOS UND GELB LACKIERT
11	731-05628	1	GOUTIERE VIDANGE D HUILE	FINISH:SCHWARZ
13	751-0535	1	TUYAU ESSENCE NOIR	Ø12,7+/-5.84 / Ø6,35+/-0,41
14	751-0564B	1	DEFLECTEUR ECHAPPEMENT	MATERIAL:ALUMINIERTER STAHL
15	751-0616B	1	POT D'ECHAPPEMENT	MATERIAL:ALUMINIERTER STAHL
16	751-0650B	1	TUYAU D'ECHAPPEMENT DROIT	FINISH:NONE
17	751-0651B	1	TUYAU D'ECHAPPEMENT GAUCHE	
18	783-0615E	1	783-0615E-RG	FINISH:LACKIERT

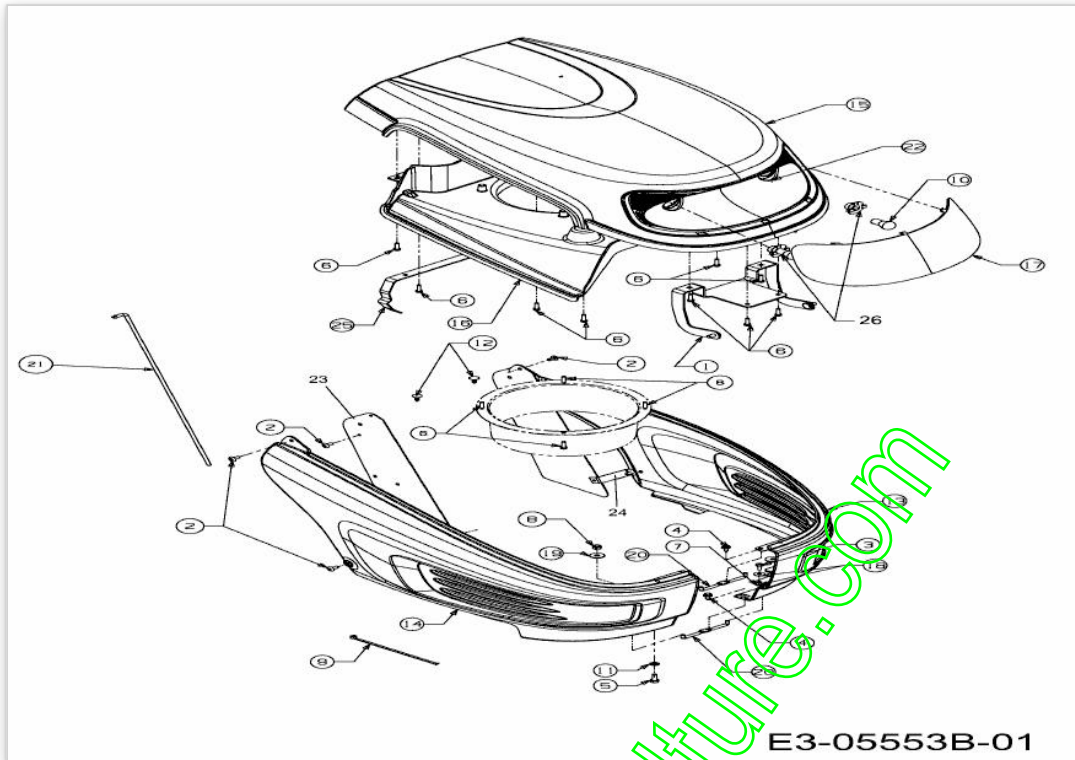

[www.emc-motoculture.com](http://www.emc-motoculture.com)

Position	Numéro de pièce	#	Appellation I	Appellation II
1	683-0305	1	SUPPORT CPL	SCHWEISSTEIL /0650
2	710-1017	6	VIS	FINISH:MTD SPEC-100016
3	710-1389	1	VIS	ZN5GL CB 23.5422.13
4	710-1652	2	VIS HEX. TT:1/4-20:.625:HXINDW	FINISH:MTD-SPEC-100016 TYPE 1
5	710-1681	2	VIS j SIX PANS CREUX	MTD SPEC-100015 21.1441.70
6	710-1704	14	VIS 6 TORX M6X20 WN 1452	FINISH:MTD SPEC-100016 TYPE 1
7	712-0633	1	ECROU	(METALLKLEMMUNG) 24.1426.15
8	712-0692	2	ECROU HEXAGONAL 24.1426.18	FINISH:SPEC-100015 24.1426.18
9	725-0157	1	COLLIER DE SERRAGE3/16X0.5X7.4	MATERIAL-NYLON-SCHWARZ
10	725-0963	2	AMPOULE ELECTRIQUE	FINISH:
11	726-0201	2	RONDELLE .3125 ID	MECHANISCH VERZINKT:SIEHE ZG.
12	726-3046	2	CLIP DE FIXATION:.250 DIA	FINISH:KUNSTSTOFF SCHWARZ
13	731-04062	1	AILE GAUCHE ROUGE M-F	MIT AUSSCHNITT:FINISH MF ROT
14	731-04063	1	AILE DROITE ROUGE M-F	MIT AUSSCHNITT:FINISH MF ROT
15	731-07579	1	CAPOT ROUGE STYLE 6 M-F	21 1000 011 840
16	731-07610	1	LUFTFÜHRUNG:6 STYLE GRAY:LT-5	500
17	731-2286A	1	OPTIQUE DE PHARE	
18	736-0685	2	RONDELLE	MTD SPEC-100015 24.6486.16
19	736-0701	2	RONDELLE	MTD SPEC-100015 24.6486.18
20	747-04301	2	TIGE DE RACCORD AILES	FINISH:701-01000
21	747-04430	1	TRINGLE	FINISH:701-01000 OR 701-010007
22	777X40219	1	REFLECTEUR STYLE 6	SCHEINWERFER
23	783-05377	2	PLATTE:SEITENAUSWURF:4STY:LT-5	FINISH:LACKIERT
24	783-05379	2	MONTAGEWINKEL:4 STYLE:LT-5	FINISH:LACKIERT
25	783-0980	1	ETRIER	6 STYLE 400/700 RIDER



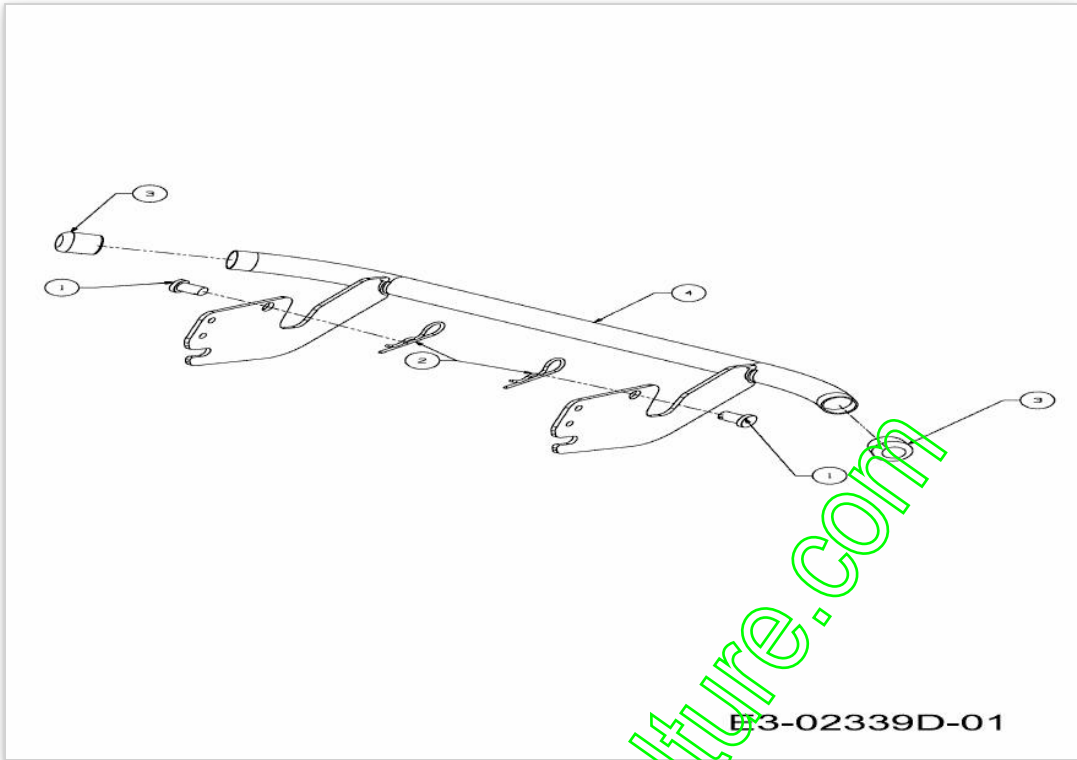

[www.emc-motoculture.com](http://www.emc-motoculture.com)

Position	Numéro de lapièce	#	Appellation I	Appellation II
1	711-0332	2	GOUJON ; ÜPINGLER .50X.78 LG	FINISH:MTD SPEC-100015
2	714-04075	2	EPINGLE	FINISH:ZINC SPEC-100015
3	731-04500	2	BOUCHON	500 SERIES:K 28 S:SCHWARZ
4	683-04236A	1	PARE-CHOCS DE FR. SÛRIE 500	SCHWEISSTEIL:FINISH LACKIERT

[www.emc-motoculture.com](http://www.emc-motoculture.com)

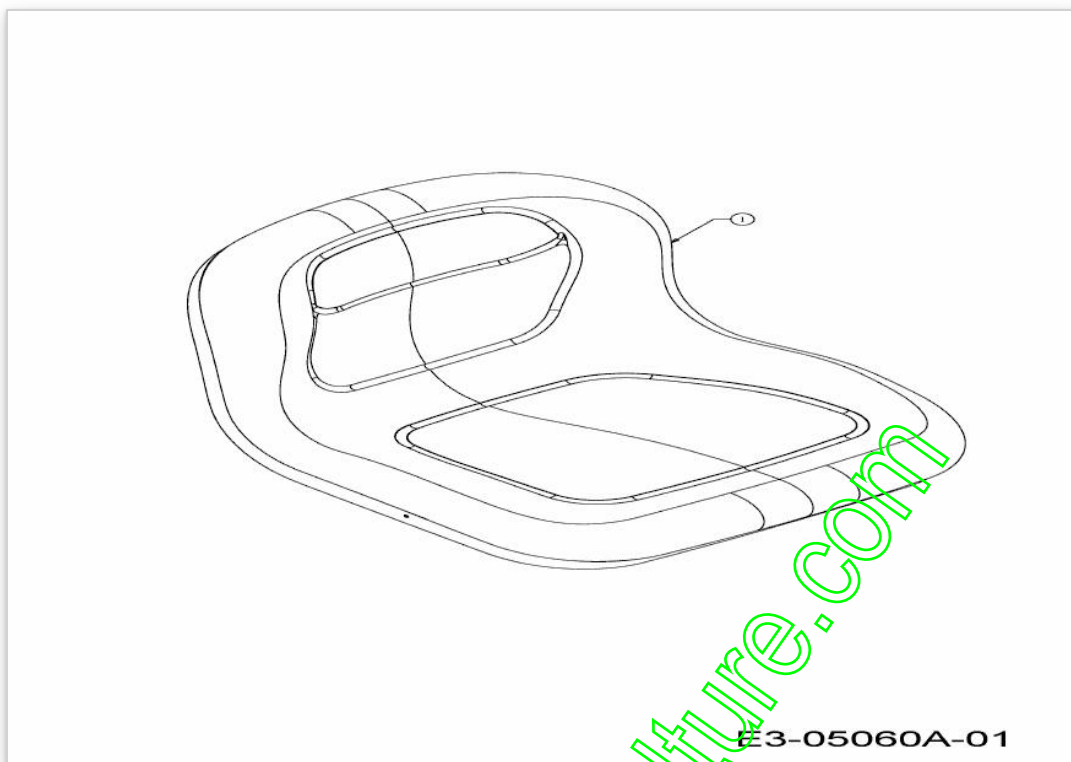

[www.emc-motoculture.com](http://www.emc-motoculture.com)

Position	Numéro de lapièce	#	Appellation I	Appellation II
1	757-04109	1	SIEGE NOIR HAUT	FINISH:SCHWARZ

[www.emc-motoculture.com](http://www.emc-motoculture.com)

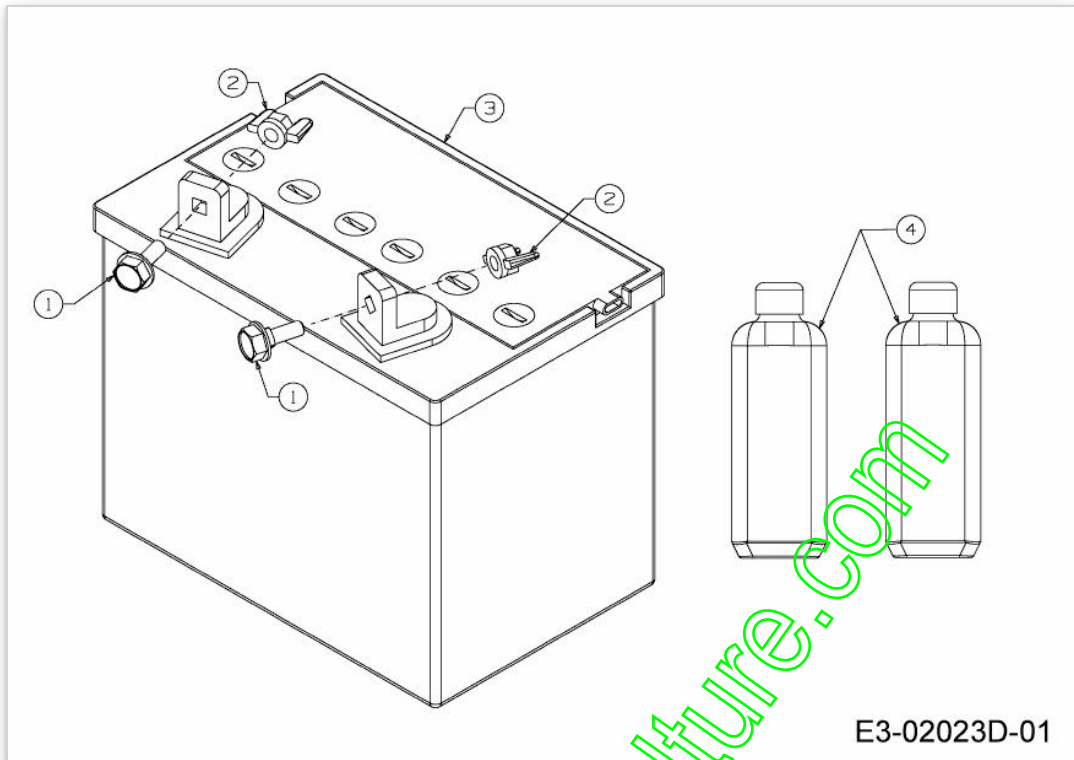

E3-02023D-01

Position	Numéro de lapièce	#	Appellation I	Appellation II
1	738-1132	2	AXE	FINISH:SPEC-100015
2	712-3087	2	ECROU PAPILLON	FINISH:KUNSTSTOFF SCHWARZ
3	725-1751	1	BATTERIE SECHE 220CCA	12V 16Ah
4	725-2064	2	BIDON ACIDE 1 LITRE	725-2064

[www.emc-motoculture.com](http://www.emc-motoculture.com)

bis 13.01.2013  
to 13.01.2013  
jusqu'au 13.01.2013

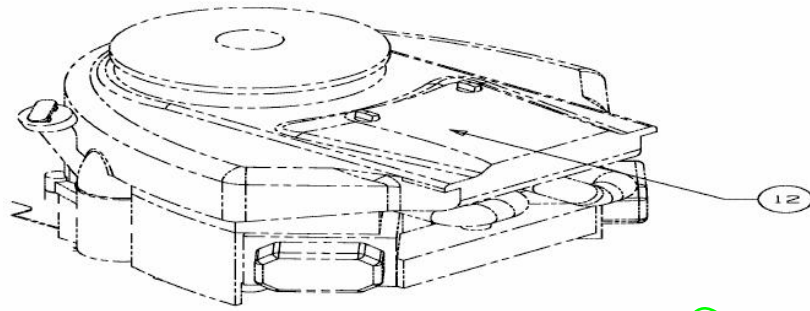

Briggs & Stratton  
Model: 406777  
Type: 0887-B1

E3-08308A-02

[www.emc-motoculture.com](http://www.emc-motoculture.com)

Position	Numéro de pièce	#	Appellation I	Appellation II
12	752B0888B1	1	MOTOR B&S 7200 SERIES	406777-0887-B1 (DUAL)

[www.emc-motoculture.com](http://www.emc-motoculture.com)



ab 14.01.2013  
from 14.01.2013  
à partir du 14.01.2013

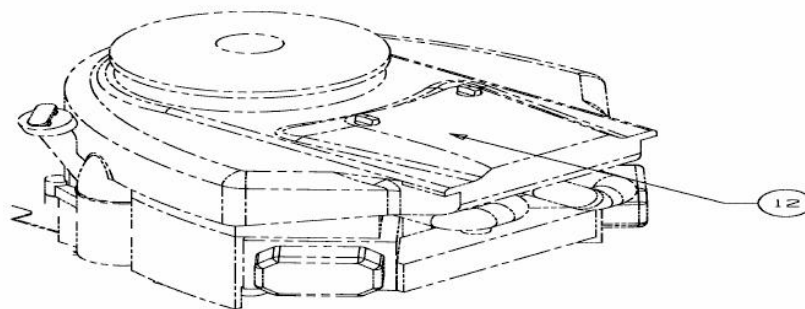

Briggs & Stratton  
Model: 406777  
Type: 6888-B1

E3-08323A-02

[www.emc-motoculture.com](http://www.emc-motoculture.com)

Position	Numéro de pièce	#	Appellation I	Appellation II
12	752B6888B1	1	MOTEUR B&s INTEK 7200 SERIES	4067776888B1

[www.emc-motoculture.com](http://www.emc-motoculture.com)

[www.emc-motoculture.com](http://www.emc-motoculture.com)