



REPAIR PARTS MANUAL
MODEL NO. 254193
Lawn Tractor



HOW TO USE THIS MANUAL

This manual is designed to provide the customer with a means to identify the parts on his/her tractor when ordering repair parts. The illustrations may or may not represent the actual assemblies; therefore, it is not recommended to use this manual as a guide to assemble or disassemble the tractor. Some hardware and parts are drawn larger in order to more readily identify them.

Each tractor has its own model number.

The model number for your tractor can be found on the fender under the seat.

When ordering parts, always give the following information:

- Product - "Tractor"
- Model Number - "254193"
- Part Number
- Part Description

TABLE OF CONTENTS

SCHEMATIC	3
ELECTRICAL.....	4-5
CHASSIS AND ENCLOSURES.....	6-7
DRIVE.....	8-9
ENGINE.....	10-11
STEERING ASSEMBLY.....	12-13
MOWER DECK	14-15
MOWER LIFT.....	16-17
SEAT ASSEMBLY.....	18
DECALS.....	19
TRANSAXLE.....	20-21
ENGINE BREAKDOWN.....	22-27
WARRANTY.....	BACK COVER

TRACTOR- -MODEL NO. 917. 254193

SCHEMATIC

SCH03

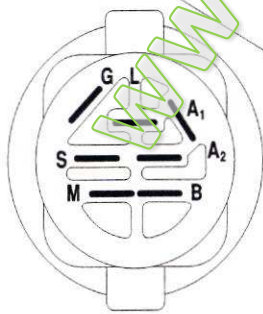
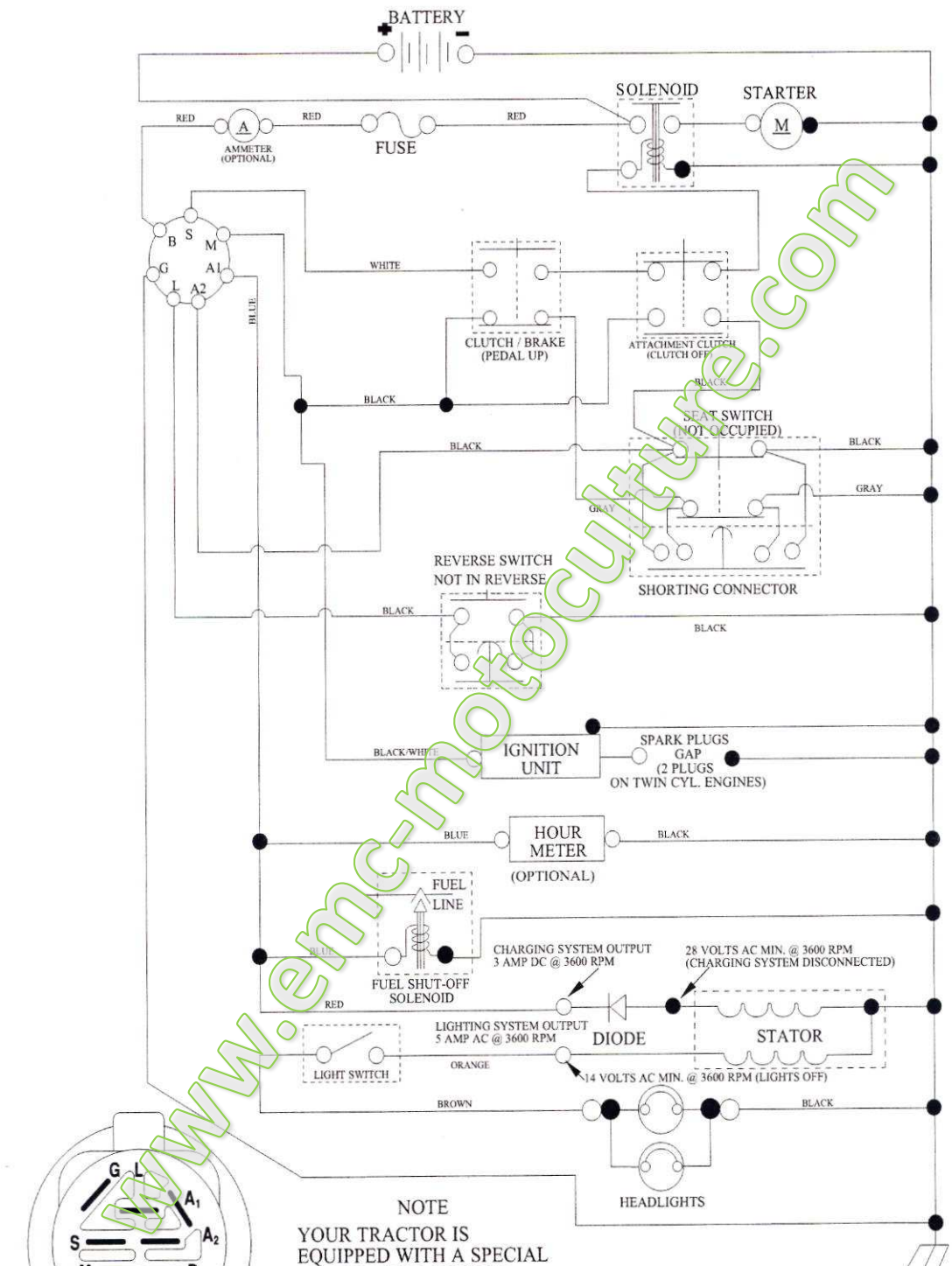

IGNITION SWITCH

POSITION	CIRCUIT "MAKE"
OFF	M+G+A1
RUN/OVERRIDE	B+A1
RUN	B+A1 L+A2
START	B + S + A1

NOTE
 YOUR TRACTOR IS EQUIPPED WITH A SPECIAL ALTERNATOR SYSTEM. THE LIGHTS ARE NOT CONNECTED TO THE BATTERY, BUT HAVE THEIR OWN ELECTRICAL SOURCE. BECAUSE OF THIS, THE BRIGHTNESS OF THE LIGHTS WILL CHANGE WITH ENGINE SPEED. AT IDLE THE LIGHTS WILL DIM. AS THE ENGINE IS SPEEDED UP, THE LIGHTS WILL BECOME THEIR BRIGHTEST.



WIRING INSULATED CLIPS
 NOTE: IF WIRING INSULATED CLIPS WERE REMOVED FOR SERVICING OF UNIT, THEY SHOULD BE RE-INSTALLED TO PROPERLY SECURE YOUR WIRING.

TRACTOR- -MODEL NO. 917. 254193

ELECTRICAL

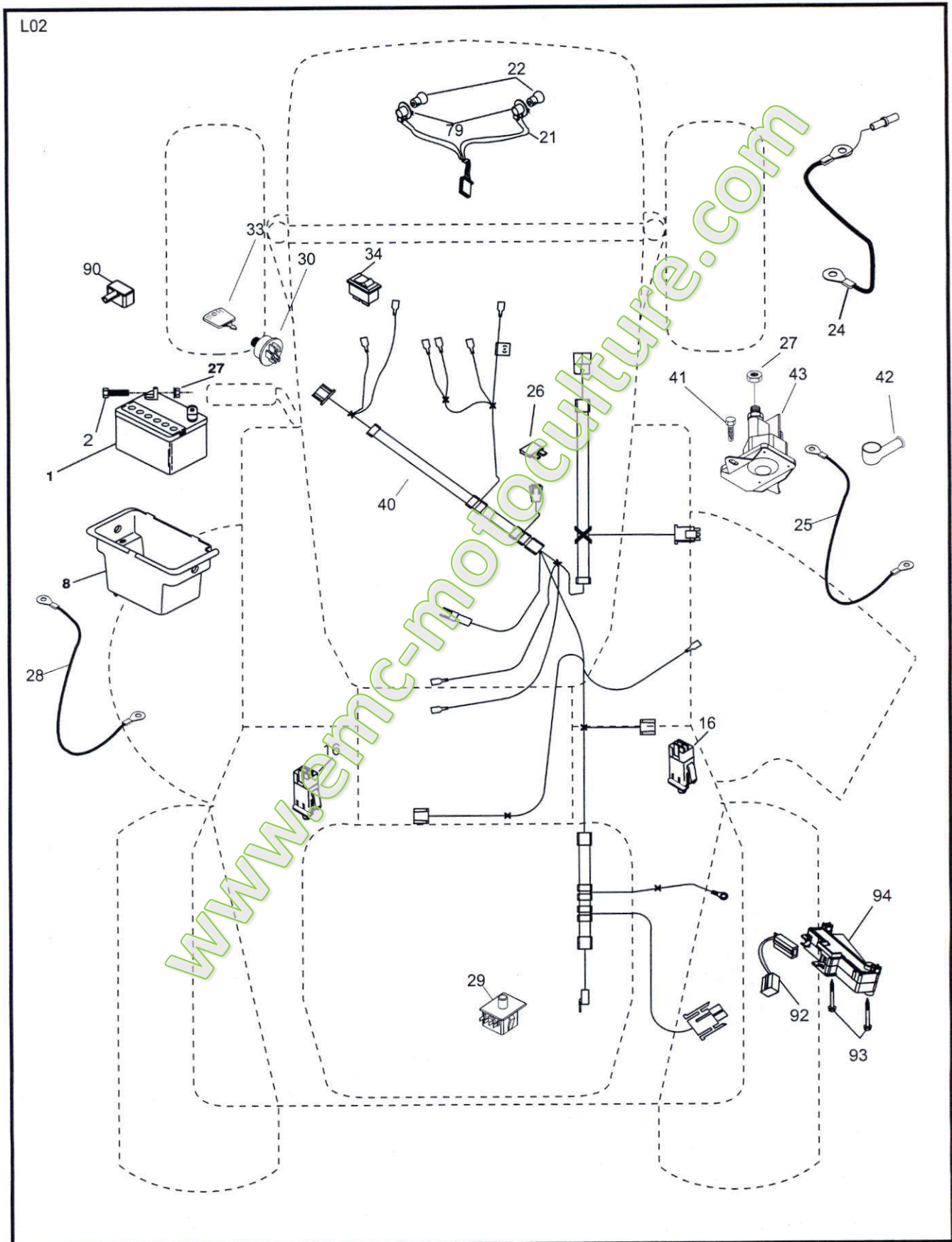

TRACTOR- -MODEL NO. 917. 254193

ELECTRICAL

KEY NO.	PART NO.	DESCRIPTION
1	163465	Battery
2	74760412	Bolt Hex Hd 1/4-20 unc x 3/4
8	176689	Box Battery Fender
16	176138	Switch, Interlock
21	175688	Harness Asm Light w/4152j
22	4152J	Bulb Light #1156
24	421299	Cable Battery 6 Ga. 11" Red
25	421297	Cable Battery 6 Ga. w/16 Wire Red
26	175158	Fuse 20 AMP
27	73510400	Nut, Keps Hex 1/4-20 unc
28	421298	Cable Ground 6 Ga. 12" Black
29	192749	Switch Seat
30	193350	Switch Ign
33	411934	Key/Chain
34	110712X	Switch Light
40	197428	Harness Ign
41	71110408	Bolt Blk. Fin Hex 1/4-20 unc x 1/2
42	131563	Cover Terminal Red
43	192507	Solenoid
79	175242	Socket Asm Bulb Twistlock
90	435395	Cover Battery Terminal
92	196615	Harness Pigtail
93	192540	Screw Plastic 10-14 x 2.0
94	191834	Module Reverse ROS

NOTE: All component dimensions give in U.S. inches
1 inch = 25.4 mm

TRACTOR- -MODEL NO. 917. 254193

CHASSIS AND ENCLOSURES

KEY NO.	PART NO.	DESCRIPTION
1	174619	Chassis Stamping
2	176554	Drawbar
5	155272	Bumper Hood/Dash
9	193510	Dash
10	STD533710	Bolt, Carriage 3/8-16 x 1
11	174996	Panel, Dash, LH
13	172105	Panel, Dash, RH
17	187559X613	Hood Assembly Alpha
18	184921	Bumper Hood Large 175
24	STD523710	Bolt Fin Hex 3/8-16 unc x 1 Gr. 5
25	19131312	Washer 13/32 x 13/16 x 12 Ga.
26	73800600	Nut Lock Hex w/INS 3/8-16 unc
28	187565X428	Grille
29	187567X599	Lens, Alpha
30	192528X613	Fender
31	136619	Bracket, Fender Support
33	179716X613	Footrest LH
34	179717X613	Footrest RH
35	72110606	Bolt Rhhd Sht Sqnk 3/8-16 x 3/4
37	17490508	Screw Thdrol 5/16-18 x 1/2 Tyt
38	175710	Bracket Asm. Pivot Mower Rear
39	187568	Bracket Pivot Alpha
64	154798	Dash Lower
141	73900600	Nut Lock Flg 3/8-16 unc
145	409167	Rod Pivot Chassis/Hood
152	17720408	Screw THD Cut 1/4-20 x 1/2
159	169473X428	Cupholder
205	17490608	Screw Thdrol 3/8-16 x 1/2
207	17670508	Screw 5/16-18 x 1/2
208	17670608	Screw Thdrol 3/8-16 x 1/2
209	17000612	Screw Hex Wsh Thdr 3/8-16 x 3/4
212	187569	Insert Lens Reflective
278	416358	Screw #10 x 0.750 BOS THREAD
310	422766	Shield Lower RH
311	422767	Shield Lower LH
313	196688	Clip Threaded
314	137729	Screw Thd Roll 1/4-20 x 5/8
315	422866	Shield Upper RH
316	422868	Shield Upper LH
317	422860	Shield Rear
326	430227	Shield Deck LH
327	430225	Shield Deck RH
--	5479J	Plug, Button

NOTE: All component dimensions given in U.S. inches
1 inch = 25.4 mm

TRACTOR- -MODEL NO. 917. 254193

DRIVE

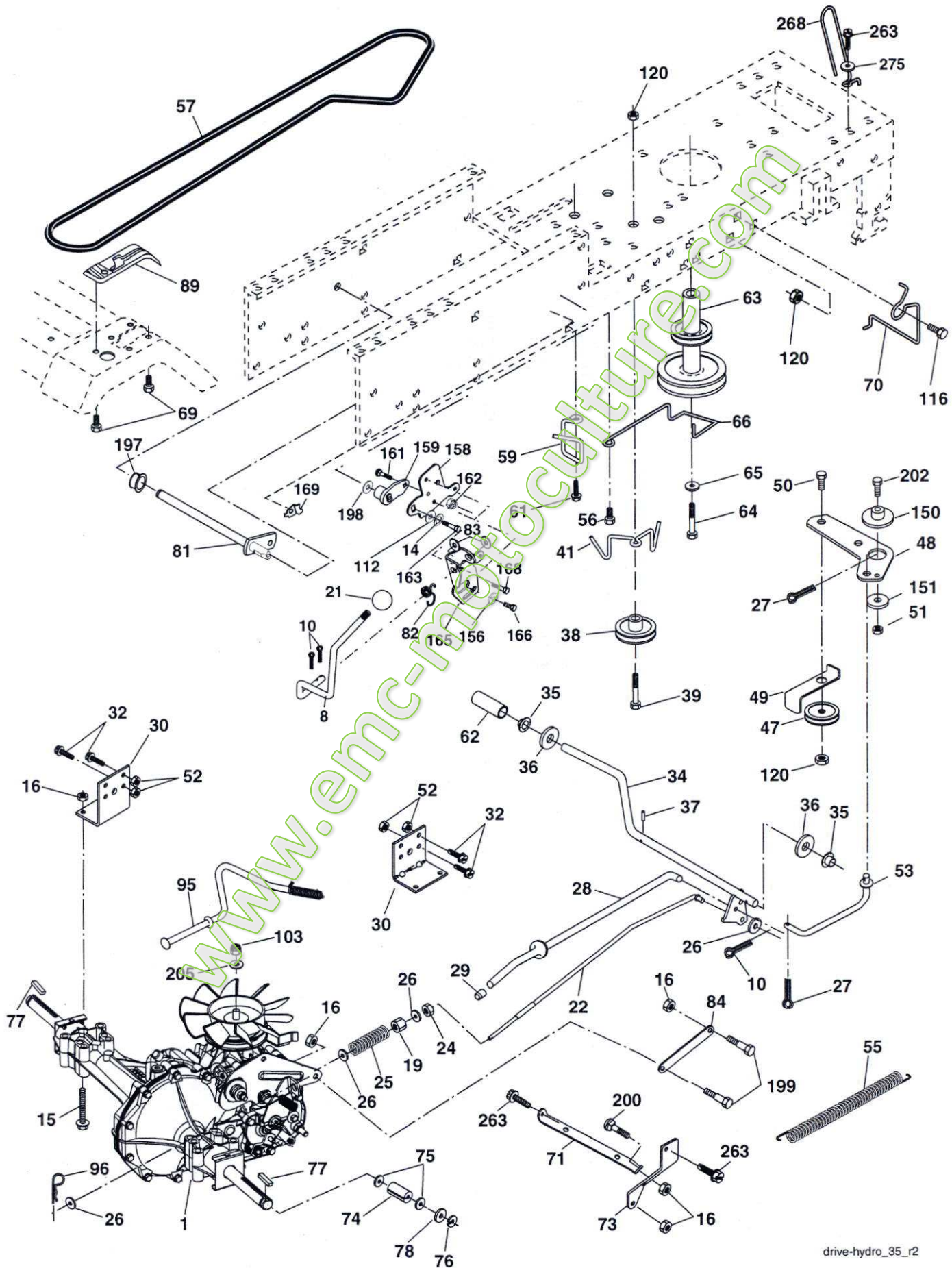

TRACTOR- -MODEL NO. 917. 254193

DRIVE

KEY NO.	PART NO.	DESCRIPTION	KEY NO.	PART NO.	DESCRIPTION
1	171613	Transaxle Hydro 322-0510 (See Breakdown)	76	STD581075	E-Ring
8	192706	Rod Shift Fender Adjust	77	123583X	Key, Square
10	STD561210	Pin Cotter 1/8 x 1 CAD	78	121748X	Washer 25/32 x 1-5/8 x 16 Ga.
14	10040400	Washer Lock Hvy Helical	81	165596	Shaft Asm Cross Tapered
15	74490544	Bolt Hex FLGHD 5/16-18 Gr. 5	82	165711	Spring Torsion
16	STD541431	Nut Lock Hex W/Ins. 5/16-18 unc	83	19171216	Washer 17/32 x 3/4 x 16 Ga.
19	STD541437	Nut Lock Hex W/Wsh 3/8-16 unc	84	169843	Link Transaxle
21	106933X	Knob	89	192056X425	Console, Shift
22	16948498	Rod, Brake	95	170201	Control Asm. Bypass 0510.2000
24	73350600	Nut, Hex Jam 3/8-16 unc	96	4497H	Retainer Spring 1"
25	106888X	Spring, Brake Rod	103	73940800	Nut Hex Jam Toplock 1/2-20 UNF
26	19131316	Washer 13/32 x 13/16 x 16 Ga.	112	19091210	Washer 9/32 x 3/4 x 10 Ga.
27	STD561210	Pin Cotter 1/8 x 3/4 CAD	116	72140608	Bolt Rdhd Sqneck 3/8-16 x 1
28	175765	Rod, Parking Brake	120	73900600	Nut Lock Flg 3/8-16
29	71673	Cap, Parking Brake	150	175456	Spacer Retainer
30	174973	Bracket, Transaxle	151	19133210	Washer 13/32 x 2 x 10 Ga.
32	74760512	Bolt Hex Hd 5/16-18 unc x 3/4	155	166002	Washer Srrted 5/16 ID x 1.125
34	175578	Shaft, Foot Pedal	158	437458	Bracket Shift Mount
35	120183X	Bearing, Nylon	159	183900	Hub Shift
36	19211616	Washer	161	72140406	Bolt Rdhd Sqnk 1/4-20 x 3/4 Gr. 5
37	1572H	Pin, Roll	162	73680400	Nut Crownlock 1/4-20 unc
38	179114	Pulley, Composite	163	74780416	Bolt Hex Fin 1/4-20 unc x 1 Gr. 5
39	72110622	Bolt Rdhd 3/8-16 unc x 2-3/4 Gr. 5	165	438250	Bracket Pivot Lever
41	175556	Keeper, Belt Idler	166	17490510	Screw 5/16-18 x 5/8
47	127783	Pulley, Idler, V-Groove	168	165492	Bolt Shoulder 5/16-18 x .561
48	154407	Bellcrank, Clutch	169	165580	Plate Fastening
49	123205X	Retainer, Belt	197	169613	Nyliner Snap-In 5/8"ID
50	72110612	Bolt Carr Sh 3/8-16 x 1-1/2 Gr. 5	198	169593	Washer Nyl 7/8 ID x .105" Hyd
51	STD541437	Nut Crownlock 3/8-16 unc	199	169612	Bolt Shoulder 5/16-18
52	STD541431	Nut, Crownlock 5/16-18 unc	200	72140508	Bolt Carr 5/16-18 x1
53	199652	Link, Clutch	202	72110614	Bolt Carr Sh 3/8-16 x 1-3/4 Gr. 5
55	105709X	Spring, Return, Clutch	205	19171616	Washer 17/32 x 1 x 16 Ga.
56	17060620	Screw 3/8-16 x 1-1/4	263	17000612	Screw Hex Wsh Thdr 3/8-16 x 3/4
57	140294	V-Belt	268	182402	Guard Muffler RH
62	8883R	Cover, Pedal	275	19131614	Washer 13/32 x 1 x 14 Ga.
63	175410	Pulley, Engine			
64	173937	Bolt Hex 7/16-20 x 4 Gr. 5			
65	STD551143	Washer			
66	154778	Keeper Belt Engine Hydro			
69	142432	Screw Hex Wsh Hi-Lo 1/4-1/2 unc			
70	134683	Keeper Belt Engine			
71	169183	Strap Torque LH			
73	169182	Strap Torque RH			
74	137057	Spacer			
75	121749X	Washer 25/32 x 1-1/4 x 16 Ga.			

NOTE: All component dimensions give in U.S. inches
1 inch = 25.4 mm

TRACTOR- -MODEL NO. 917. 254193

ENGINE

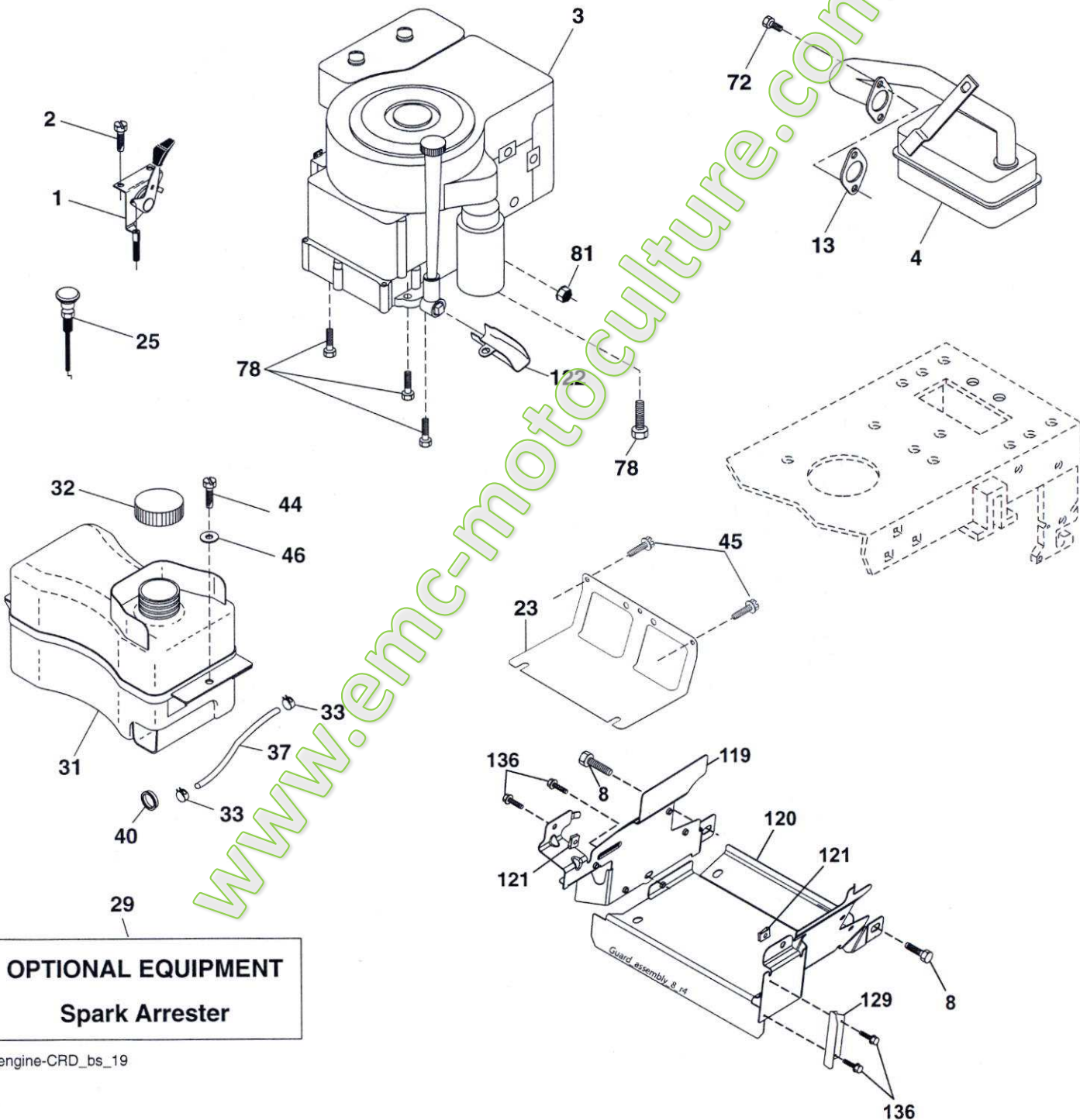

engine-CRD_bs_19

TRACTOR- -MODEL NO. 917. 254193

ENGINE

KEY NO.	PART NO.	DESCRIPTION
1	170545	Control, Throttle/Choke
2	17720408	Screw, Hex Head, Thread Cutting 1/4-20 x 1/2
3	438155	Engine, Briggs Model No. 31A607-2392-B1
4	137352	Muffler
8	171877	Bolt 5/16-18 x 3/4
13	165291	Gasket
23	169837	Shield Brn/Dbr Guard
25	187770X428	Control Choke
29	137180	Arrestor, Spark
31	407516	Tank, Fuel
32	430220	Cap Fuel
33	123487X	Clamp, Hose
37	137040	Line, Fuel
40	124028X	Bushing Snap
44	17670412	Screw, Hex Washer Head, Thd., Roll. 1/4-20 x 3/4
45	17000612	Screw Hex Wsh Thdr 3/8-16 x 3/4
46	19091416	Washer 9/32 x 7/8 x 16 Ga.
72	192334	Screw Socket 5/16-18 x .75
78	17060620	Screw 3/8-16 x 1-1/4
81	73510400	Nut Keps Hex 1/4-20 unc
119	197949	Guard Asm Engine LH
120	197948	Guard Asm Engine RH
121	196688	Clip Threaded
122	421922	Extension Drain Oil
129	400329	Guard Pulley Engine Adapter
136	137729	Screw 1/4-20 x 5/8

NOTE: All component dimensions given in U.S. inches
1 inch = 25.4 mm

Engine Power Rating Information

The gross power rating for individual gas engine models is labeled in accordance with SAE (Society of Automotive Engineers) code J1940 (Small Engine Power & Torque Rating Procedure), and rating performance has been obtained and corrected in accordance with SAE J1995 (Revision 2002-05). Torque values are derived at 3060 RPM; horsepower values are derived at 3600 RPM. Actual gross engine power will be lower and is affected by, among other things, ambient operating conditions and engine-to-engine variability. Given both the wide array of products on which engines are placed and the variety of environmental issues applicable to operating the equipment, the gas engine will not develop the rated gross power when used in a given piece of power equipment (actual "on-site" or net power). This difference is due to a variety of factors including, but not limited to, accessories (air cleaner, exhaust, charging, cooling, carburetor, fuel pump, etc.), application limitations, ambient operating conditions (temperature, humidity, altitude), and engine-to-engine variability. Due to manufacturing and capacity limitations, Briggs & Stratton may substitute an engine of higher rated power for this Series engine.

TRACTOR- -MODEL NO. 917. 254193

STEERING ASSEMBLY

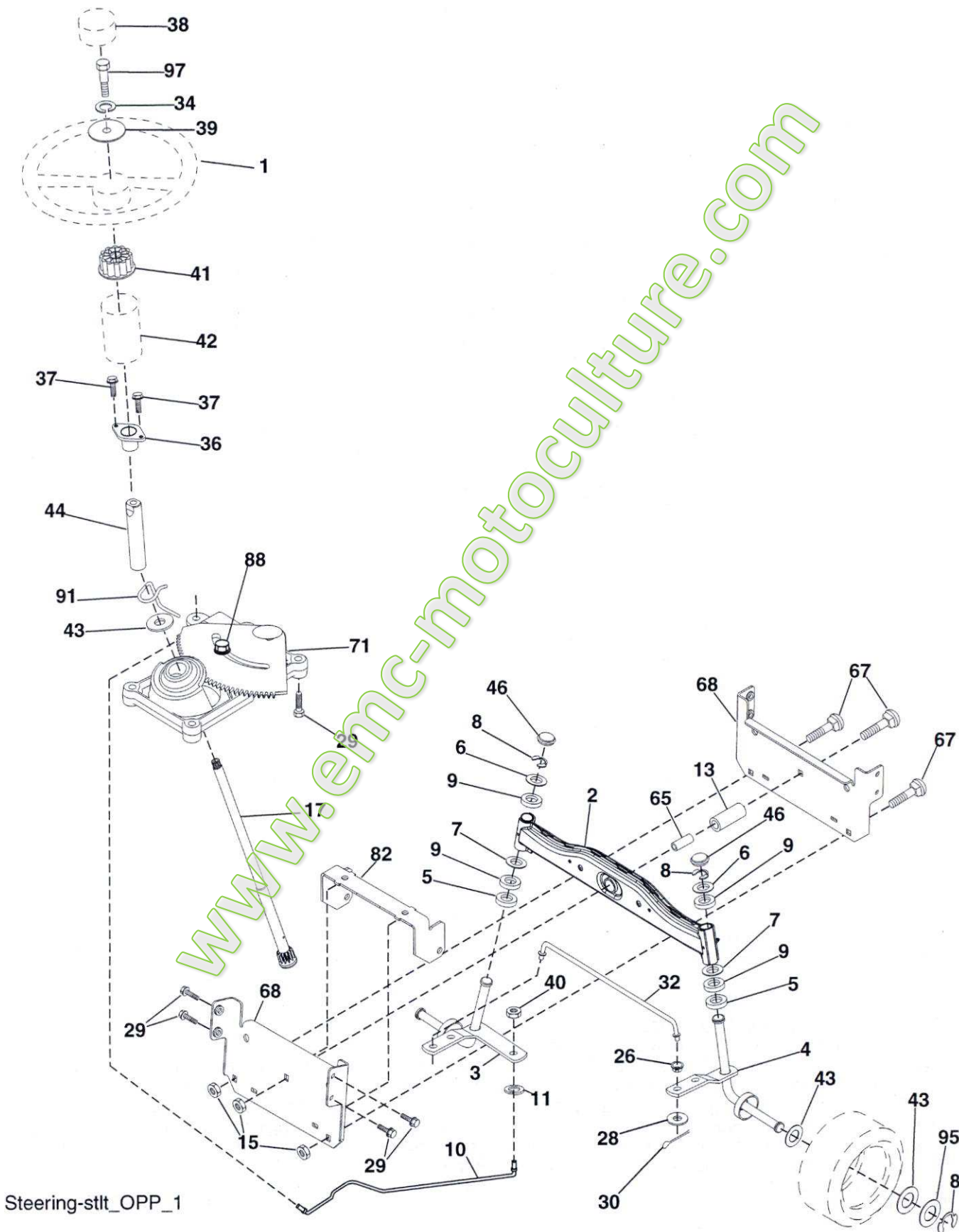

Steering-stlt OPP_1

TRACTOR- -MODEL NO. 917. 254193

STEERING ASSEMBLY

KEY NO.	PART NO.	DESCRIPTION
1	186780	Steering Wheel
2	418168	Axle Assembly
3	169840	Spindle Assembly, LH
4	169839	Spindle Assembly, RH
5	6266H	Bearing, Race, Thrust, Hardened
6	121748X	Washer 27/32 x 1-1-1/4 x 16 Ga.
7	19272016	Washer 25/32 x 1-1/2 x 14 Ga.
8	12000029	Ring, Klip
9	3366R	Bearing Col. Strg.
10	175121	Draglink
11	STD551137	Washer, Lock
13	136518	Spacer Brg Axle Front
15	73900600	Nut Lock Flg. 3/8-16 Unc
17	190753	Shaft, Steering
26	126847X	Bushing, Link, Drag
28	19131416	Washer 13/32 x 7/8 x 16 Ga.
29	17000612	Screw 3/8-16 x 3/4
30	STD561210	Pin
32	192757	Rod, Tie
34	10040500	Washer, Lock Hvy Hicl Spr. 5/16
36	155099	Bushing, Steering
37	152927	Screw
38	186781	Insert, Steering Wheel
39	19113812	Washer 11/32 x 2-3/8 x 12 Ga.
40	73540600	Nut Crownlock 3/8-24
41	186737	Adaptor, Steering Wheel
42	145054x428	Boot, Steering Shaft
43	121749X	Washer 25/32 x 1-1/4 x 16 Ga.
44	190752	Extension Shaft Steering
46	121232X	Cap, Spindle
65	414736	Spacer Brace Axle
67	72110618	Bolt Rdhd Sqnk 3/8-16 x 2-1/4
68	169827	Axle, Brace
71	175146	Steering Asm
82	199978	Bracket Susp Chassis Front
88	175118	Bolt Shoulder 7/16-20
91	175553	Clip Steering
95	188967	Washer Hardened .793 x 1.637 x .060
97	428982	Bolt Fin Hex 5/16-18 x 4 w/Patch

NOTE: All component dimensions given in U.S. inches
1 inch = 25.4 mm

TRACTOR- -MODEL NO. 917. 254193

MOWER DECK

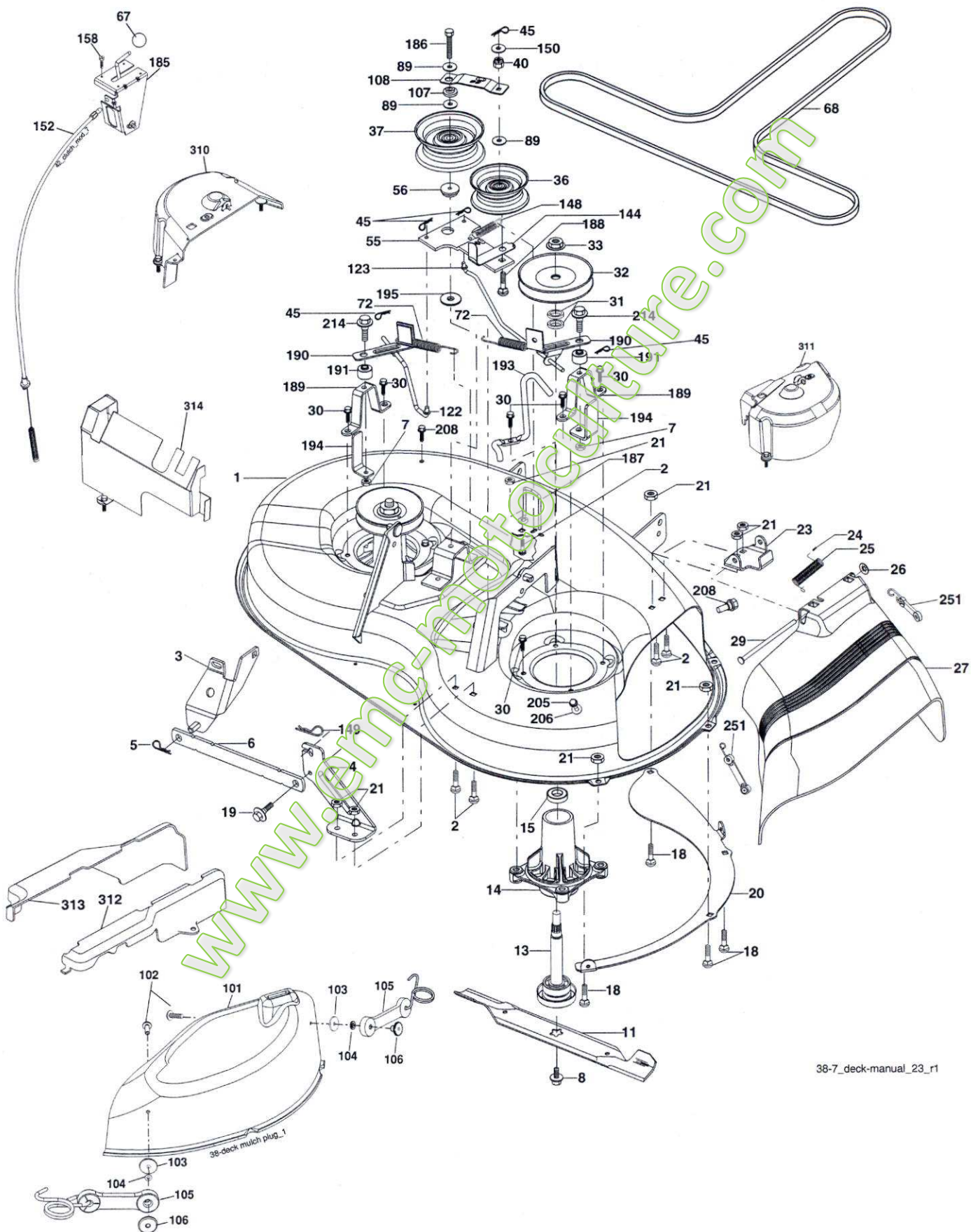

38-7_deck-manual_23_r1

TRACTOR- -MODEL NO. 917. 254193

MOWER DECK

KEY NO.	PART NO.	DESCRIPTION	KEY NO.	PART NO.	DESCRIPTION
1	192556	Mower Housing Assembly	108	133503	Stiffener Idler Arm
2	72140506	Bolt Carriage 5/16-18 x 3/4	122	410189	Link, Brake LH
3	138017	Bracket Asm Fr. Sway Bar	123	410190	Link, Brake RH
4	192568	Bracket Deck Sway Bar 38"/42"	144	193414	Keeper Belt Idler Tension
5	STD624008	Retainer Spring	148	169022	Spring Return Idler
6	178024	Bar Sway Deck	149	165898	Retainer Spring Yellow
7	73800500	Nut Lock Hx w/INs. 5/16-18 unc	150	19091210	Washer 9/32 x 3/4 x 10 Ga.
8	193003	Bolt 3/8-24 x 1.25 Gr. 8	152	193235	Clutch Cable 38"/46"
11	193957	Blade Mower	158	17720408	Screw Hex Thd Cut 1/4-20 x 1/2
13	192872	Shaft Assembly, Mandrel, Vented	185	188234	Head Asm Cable Clutch
14	187281	Housing, Mandrel, Vented	186	17490644	Screw Hex Wsh Thdrol 3/8-16 x 2-3/4
15	110485X	Bearing, Ball, Mandrel	187	193412	Keeper Belt
18	72140505	Bolt Rdhd Sqnk 5/16-18 x 5/8	188	165891	Bolt Carriage Idler
19	132827	Bolt, Shoulder	189	192559	Stand, Brake
20	400095	Baffle Vortex Front	190	192560	Arm, Brake
21	73680500	Nut	191	192561	Spacer, Brake
23	192557	Bracket, Mower Deflector	193	193413	Keeper Belt RH Mandrel
24	105304X	Cap, Sleeve	194	194105	Guard Brake
25	197026	Spring, Torsion, Deflector	195	19133210	Washer
26	110452X	Nut, Push	205	17490416	Screw 1/4-20 x 1.00 77
27	400809X428	Shield, Deflector	206	19091416	Washer 9/32 x 7/8 x 16 Ga.
29	131491	Rod, Hinge	208	17670608	Screw Thdrol 3/8-16 x 1/2
30	173984	Screw Thdrol.	214	193782	Bolt/Washer Asm 5/16-18
31	187690	Washer, Spacer	251	436087	Kit Bungee (Includes Phillips head screw, weld nut, screw, bungee latch, and bungee strap)
32	153532	Pulley, Mandrel	310	432356	Cover Assy LH
33	400234	Nut, Toplock	311	432357	Cover Assy RH
36	131494	Pulley, Idler, Flat	312	432359	Shield Assy RH
37	193198	Pulley Idler Flat	313	432358	Shield Assy Side LH
40	73680600	Nut, Crownlock 3/8-16 unc	314	432355	Assy Shield Rear
45	STD624003	Retainer	--	192558	Brake Assembly (Includes Stand, Arm and Guard Components)
55	133840	Idler Arm Assembly	--	192870	Mandrel Assembly (Includes housing, shaft assembly, and bearing only - pulley/nut/washer and blade bolt/washers not included)
56	165723	Spacer, Retainer	--	431841	Replacement Mower, Complete
67	149846	Knob			
68	193214	V-Belt			
72	193216	Spring Brake Return			
89	19131311	Washer 13/32 x 13/16 x 11 Ga.			
101	192573	Cover Mulching			
102	71081010	Screw Pan Hd Phillip 10-24 x 5/8			
103	19061216	Washer #10			
104	10071000	Washer Lock			
105	160793	Latch Asm.			
106	2029J	Nut Weld .327/.304 #10-24			
107	133502	Spacer Retainer			

NOTE: All component dimensions given in U.S. inches
1 inch = 25.4 mm

TRACTOR- -MODEL NO. 917. 254193

MOWER LIFT

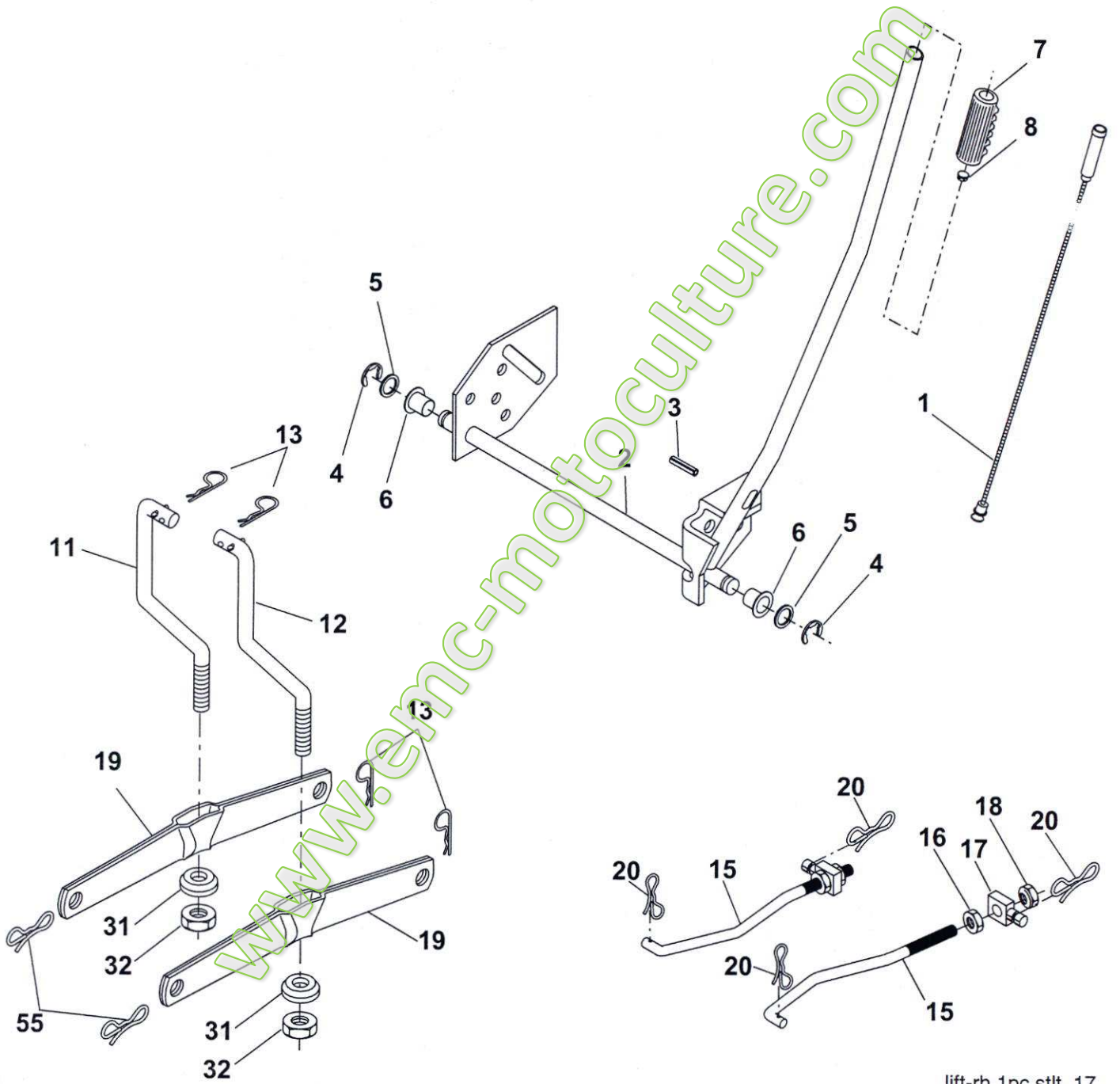

lift-rh.1pc.stlt_17

TRACTOR- -MODEL NO. 917. 254193

MOWER LIFT

KEY NO.	PART NO.	DESCRIPTION
1	404981	Plunger Asm. Lift Lvr
2	159471	Shaft Assembly, Lift
3	105767X	Pin, Groove
4	12000002	E-Ring
5	19211621	Washer 21/32 x 1 x 21 Ga.
6	120183X	Bearing, Nylon
7	125631X	Grip, Handle, Fluted
8	122365X	Button, Plunger, Red
11	139865	Link, Lift, LH
12	139866	Link, Lift, RH
13	STD624008	Retainer Spring
15	173288	Link, Front
16	73350800	Nut, Hex, Jam 1/2-13 unc
17	175689	Trunnion
18	73800800	Locknut, Hex, w/Washer Insert 1/2-13 unc
19	139868	Arm, Suspension, Rear
20	194209	Pin Cotter 7/16 Bow Tie Lock
31	169865	Bearing, Pvt, Lift
32	73540600	Nut, Crownlock 3/8-24
55	194208	Pin Cotter 5/16 Bow Tie Lock

NOTE: All component dimensions given in U.S. inches
1 inch = 25.4 mm

TRACTOR- -MODEL NO. 917. 254193

SEAT ASSEMBLY

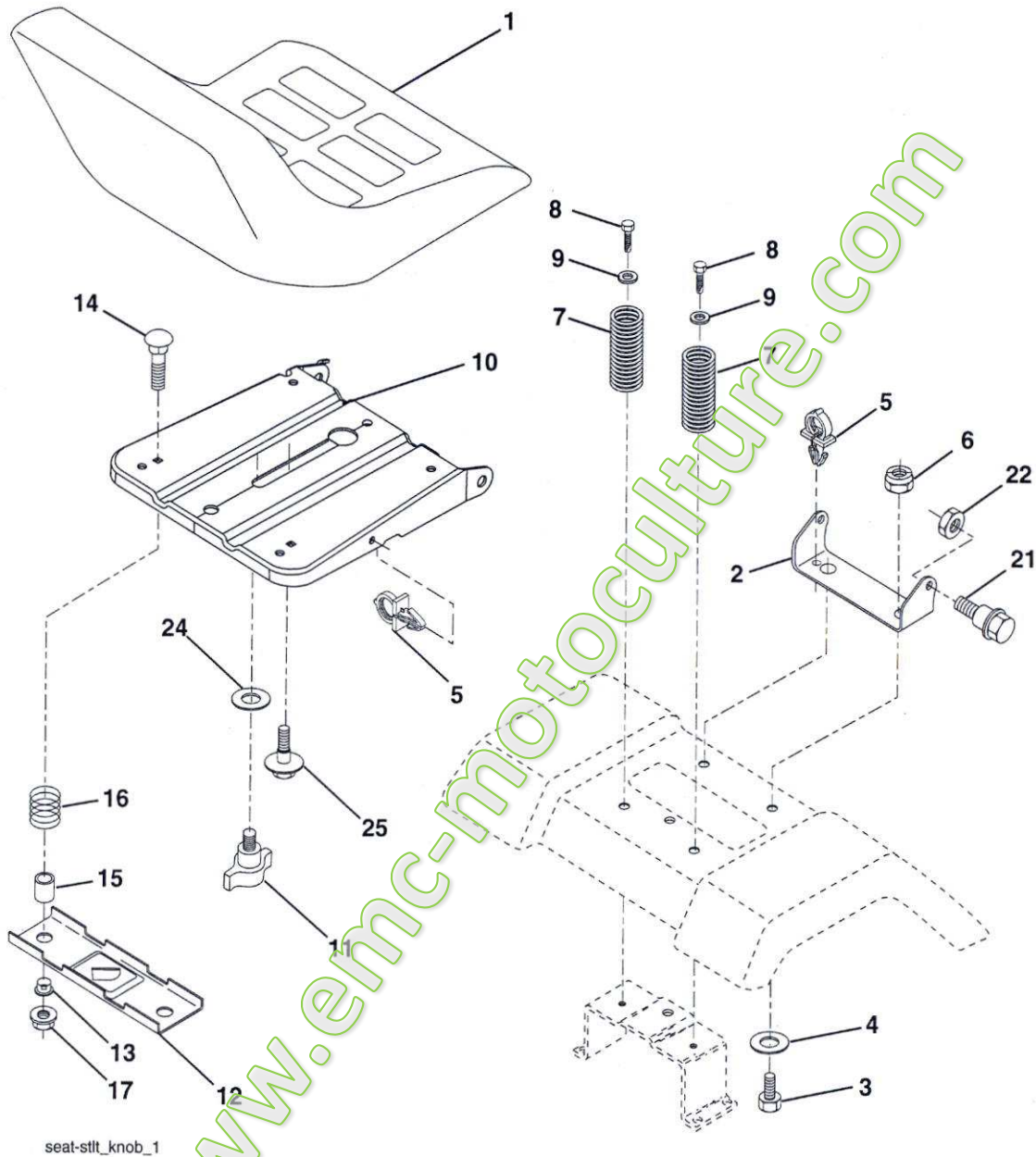

seat-stlt_knob_1

KEY NO.	PART NO.	DESCRIPTION
1	188939	Seat
2	140551	Bracket, Pivot, Seat
3	71110616	Bolt
4	19131610	Washer 13/32 x 1 x 10 Ga.
5	145006	Clip, Push-In Hinged
6	STD541437	Nut
7	124181X	Spring, Seat
8	17000616	Screw 3/8-16 x 1-1/2
9	19131614	Washer 13/32 x 1 x 14 Ga.
10	195530	Pan, Seat
11	166369	Knob Seat
12	174648	Bracket, Switch Mounting

KEY NO.	PART NO.	DESCRIPTION
13	121248X	Bushing, Snap
14	72050412	Bolt, Carriage 1/4-20 x 1-1/2
15	134300	Spacer, Split .28 x .88
16	121250X	Spring
17	123976X	Locknut, Flange 1/4 Gr. 5
21	171852	Bolt, Shoulder 5/16-18 unc
22	STD541431	Nut
24	19171912	Washer 17/32 x 1-3/16 x 12 Ga.
25	127018X	Washer 17/32 x 1-3/16 x 12 Ga.

NOTE: All component dimensions given in U.S. inches
1 inch = 25.4 mm

TRACTOR- -MODEL NO. 917. 254193

DECALS

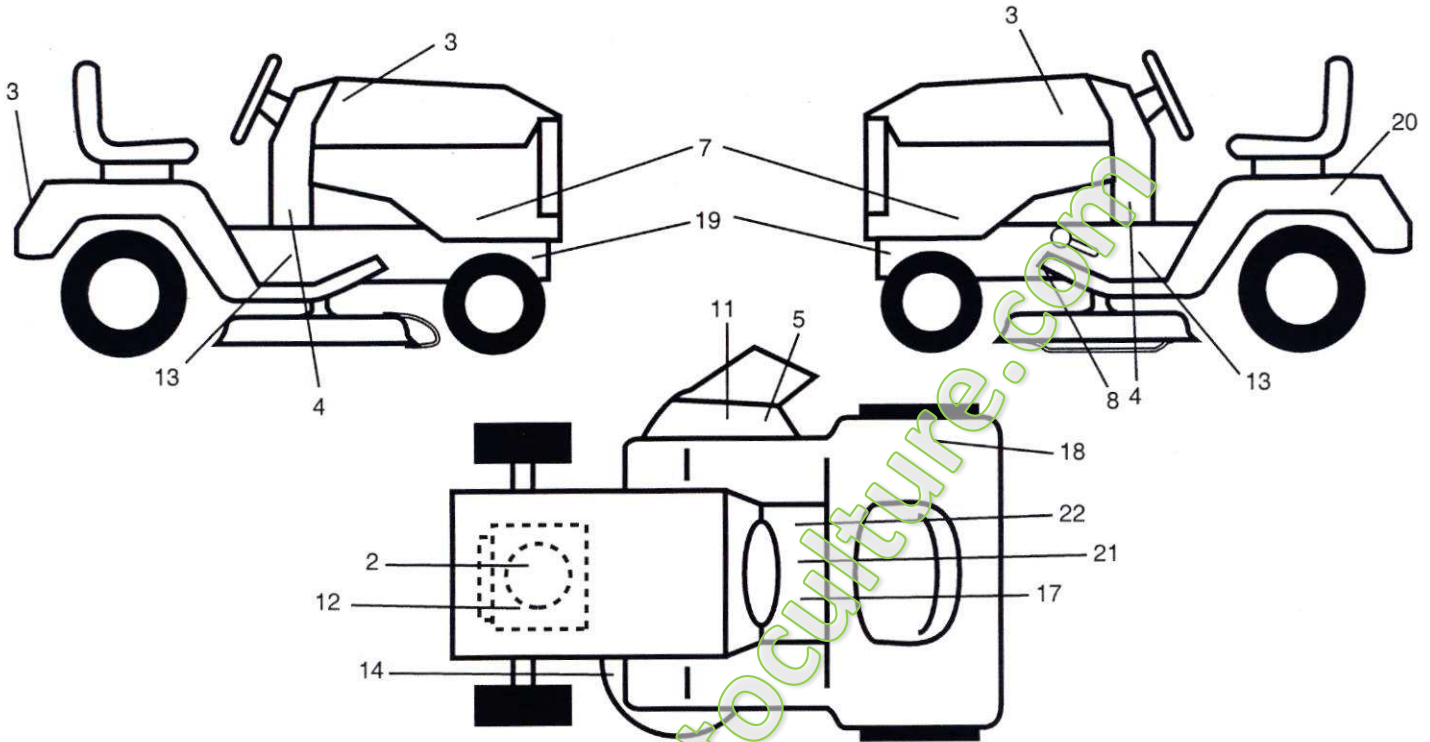

KEY NO.	PART NO.	DESCRIPTION	KEY NO.	PART NO.	DESCRIPTION
2	437413	Decal, HP Engine	19	159736	Decal, Hot Muffler
3	425123	Decal, Hood/Fender	20	145005	Decal, Battery Dngr/Psn Eng
4	426962	Decal, Lower Dash	21	159737	Decal, Brake/Clutch Sym
5	196357	Decal, Warning	22	140837	Decal, Saddle Brake/Parking
7	426989	Decal, Hood Side Panels	--	138311	Decal, Lift Handle
8	197490	Decal, V-Belt Schematic	--	162598	Decal, Load Limit
11	182166	Decal, Cutfinger CE	--	166960	Decal, Bypass
12	196841	Decal, Warning. Sym.	--	580339440	Manual, Operator's (Euro)
13	401146	Decal, Warning Service/Fire	--	580339450	Manual, Operator's (Scand)
14	194302	Decal, V-Belt Schematic	--	580339430	Manual, Operator's (E-Bloc)
17	400389	Decal, Warning Sym. CE	--	580339420	Manual, Operator's (Baltic)
18	180432	Decal, Fender DE/CE	--	580339426	Manual, Parts

WHEELS & TIRES

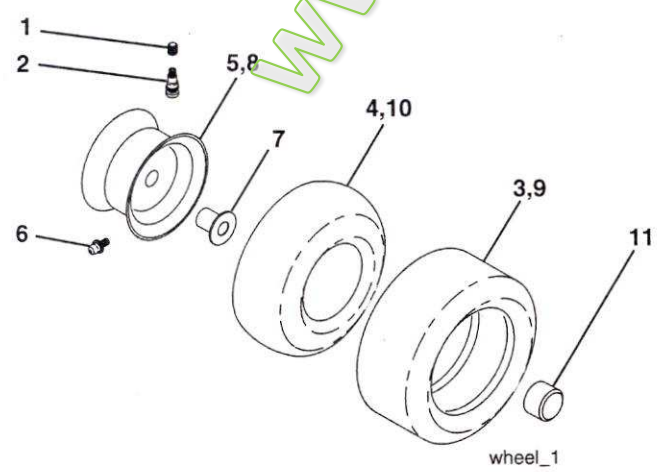

KEY NO.	PART NO.	DESCRIPTION
1	59192	Valve Cap, Tire
2	65139	Stem, Valve
3	106222X	Tire, Front
4	59904	Tube, Front Tire (Not Provided, Service Item Only)
5	106732X613	Rim, Front
6	278H	Fitting, Grease (Front Wheel Only)
7	9040H	Bearing, Flange (Front Wheel Only)
8	106108X613	Rim, Rear
9	420531	Tire, Rear
10	7152J	Tube, Rear Tire (Not Provided, Service Item Only)
11	104757X428	Cap, Axle
--	144334	Sealant, Tire 10 oz.

NOTE: All component dimensions given in U.S. inches
1 inch = 25.4 mm

TRACTOR - - MODEL NUMBER 917.254193

HYDRO TRANSAXLE - - MODEL NUMBER 322-0510

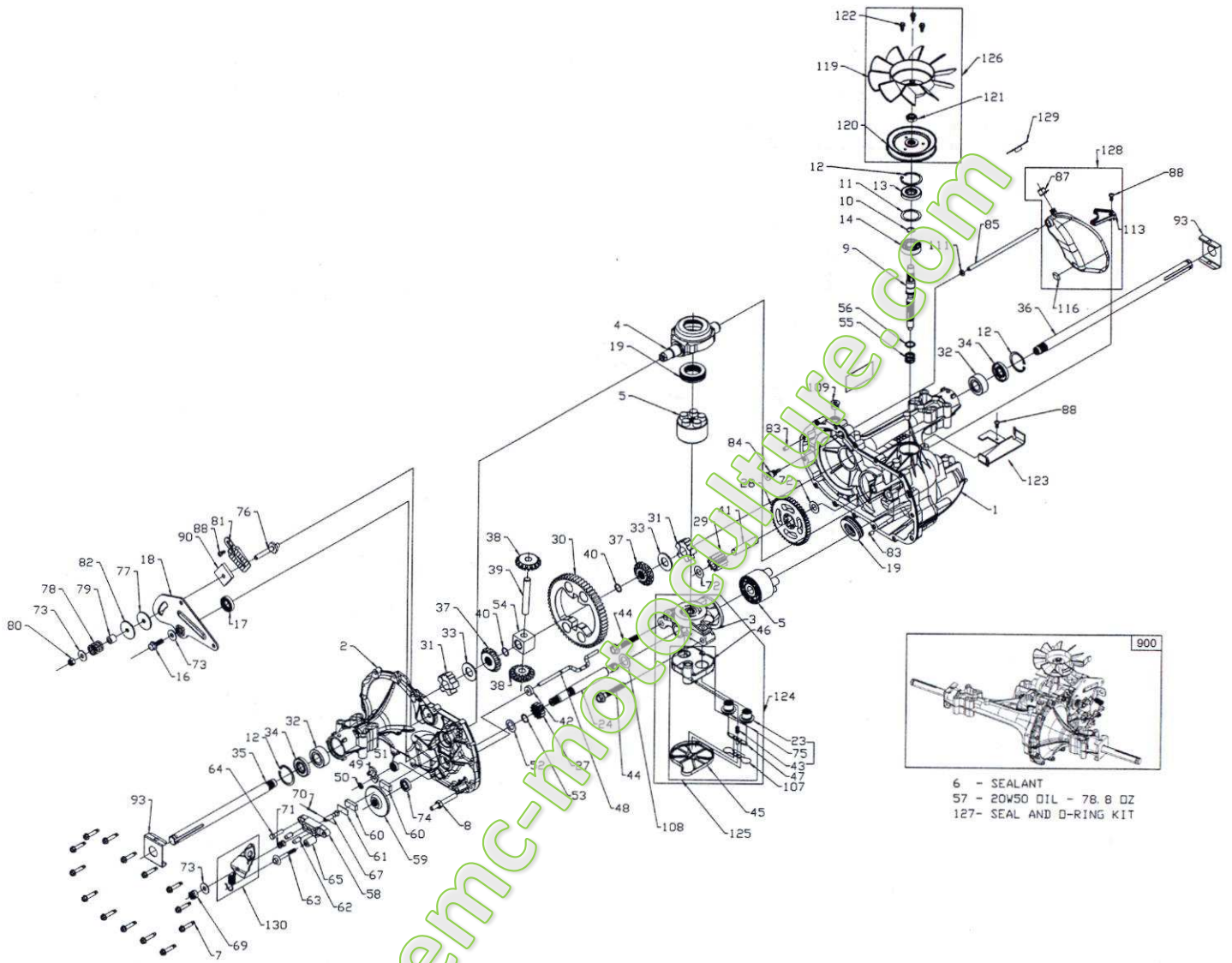

KEY NO.	PART NO.	DESCRIPTION	KEY NO.	PART NO.	DESCRIPTION
1	170351	Kit, Main Housing	10	170359	Retaining Ring
		Main Housing, Machined	11	170360	Spacer
		Bushing .865 X .985 X .790	12	169870	Retaining Ring
2	170352	Kit, Side Housing	13	170361	Seal, Lip .67 X 1.58 X .276
		Side Housing, Machined	14	173158	Bearing, Ball 6203 (BDR)
		Bushing .865 X .985 X .790	16	170362	Hex Flange Head Screw 1/4-20 X 1.25
		Bushing .624 X .719 X .562			
3	170353	Kit, Center Section	17	170363	Seal, Lip 18 X 32 X 7
		Center Section, Machined	18	170364	Arm, Control
		Bushing .707 X .788 X .591	19	173159	Bearing, Thrust (10cc)
4	170354	Swashplate, Trunnion Machined	23	170365	Check Plug Assembly
5	169898	Kit, Cylinder Block (10cc)	24	170366	Shaft Motor
		Block - Cylinder	27	170367	Gear, Pinion, 13t
		Piston	28	170368	10t / 48t Gear
		Spring, Compression	29	170369	Gear, 10t Jackshaft
		Washer - Thrust	30	170370	60t Bullgear
6	178322	Sealant Tube	31	170371	Sleeve Bearing .75 X 1.75 X .625
7	170356	Hexflange Screw 1/4-20 X 1.25	32	170389	Sleeve Bearing (Outboard) .75 X 1.575 X .625
8	170357	Stud, 5/16-24 Hex Double End			
9	170358	Shaft, Input	33	142991	Washer

TRACTOR - - MODEL NUMBER 917.254193

HYDRO TRANSAXLE - - MODEL NUMBER 322-0510

KEY NO.	PART NO.	DESCRIPTION	KEY NO.	PART NO.	DESCRIPTION
34	170390	Lip Seal, Axle Shaft	109	170434	Plug, Straight Thread 9/16-18
35	170391	Shaft, Axle (Keyed, R.h.)	111	170435	O-ring .7 X .301 ID
36	170392	Shaft, Axle (Keyed, L.h.)	113	170437	Bracket, Support Expansion Tank
37	150792	Gear, Splined Diff. (210-1000 & 310-0750)	119	173161	Fan (310-3000)
38	150793	Gear, Miter Diff. (210-1000 & 310-0750)	120	170440	Pulley
39	150809	Differential Shaft (310-0750)	121	170441	Hex Nut Locking
40	170393	Retaining Ring	122	173162	Screw, #12-24 Hx Hd Self Tapping (310-3000)
41	170394	Pin, Jackshaft	123	173163	Bracket, Belt Keeper
42	170395	Magnet, Ring	124	170444	Kit, Center Section Filter Bypass Center Section Machining
43	170396	Spring, Bypass			Base Filter W/ Poppet
44	150797	Bolt 3/8-24 X 2-1/2			Check Plug Assembly, 027 Washer
45	170397	Filter			Check Plug Assembly, Washer
46	170398	Base, Filter			Spring, Bypass
47	170399	Actuator, Bypass			Actuator, Bypass
48	170400	Rod, Bypass Actuator			Deflector
49	170401	Arm, Bypass			Bottom, Filter
50	170402	Retaining Ring .25 External			Bushing .707 X .788 X .591
51	170403	Seal, Lip .741 X .25 X .25	125	170445	Kit, Filter
52	170404	Washer, Flat 0.050" (210-1000)			Bottom, Filter
53	170405	Retaining Ring			Spring, Bypass
54	170406	Bearing, Center Block			Actuator, Bypass
55	142977	Spring, Helical Compression			Deflector
56	142978	Washer, Block Thrust			Base, Filter W/ Poppet
57	---	20w-50 Oil 78.8 Oz	126	173164	Kit, Fan / Pulley
58	142929	Kit, Brake Yoke			#12 T.f. Screw - Indented Hex Washer Head
59	170408	Rotor, Brake			Fan
60	142883	Brake Puck			Pulley 4.315 X .801
61	142882	Brake Puck Plate	127	170447	Kit, Seal
62	170409	Pin, Brake Actuating			Lip Seal .67 X 1.58 X .276
63	170410	HFHCS 1/4-20 X 2 W/patch, Special Flange			Lip Seal 18 X 32 X 7
64	142892	Bolt, Nylok			Lip Seal .706 X 1.584 X .25
65	170411	Spacer, Brake Torsion Spring			Lip Seal .741 X .250 X .250 TC
67	170413	Bolt, Square Head - Brake			Oil Seal 625 X 1.0 X .25
69	170415	Nut, Castle 5/16-24	128	173165	O-ring .07 X .301 ID
70	170416	Pin, Cotter 3/32X3/4			Kit, Expansion Tank
71	170417	Brake Spring			Tank, Expansion
72	170418	Washer (310-0750)			Cap, Vent
73	142884	Washer, Flat			Bolt, Self Tapping 10-32 X 1/2
74	170419	Seal, Oil			Bracket, Support Expansion Tank
75	170420	Assy Check Plug			Silicon Sponge 1/2 X 1/2 X 3/16
76	170421	Bolt, Stud 5/16-24	129	191032	Cap, Expansion Tank Shipping
77	170422	Puck, Friction	130	186352	Kit, Brake Arm And Spring
78	142969	Spring			Arm, Brake
79	142980	Spacer			Spring, Brake Arm Bias
80	150778	Nut, Nylon Insert Hex Lock 5/16-24			Instruction Sheet
81	170423	Wedge, Friction	900	171613	Transaxle
82	170424	Clip, Washer			
83	161168	Pin			
84	170425	Fitting, 5/16 X Sae 5/32 Tube			
85	170426	Hose, Expansion Tank			
87	173160	Cap, Vent			
88	178334	Bolt, Self Tapping (BDR)			
90	170430	Puck, Inner Wedge			
93	170431	Spring Clip, Housing			
107	170432	Deflector			
108	170433	Washer, Motor Shaft .71ID X 1.15OD X .03 Thick			

Note: All Component Dimensions Given In U.s. Inches 1 Inch = 25.4 MM

NOTE: All component dimensions given in U.S. inches 1 inch = 25.4 mm

TRACTOR- -MODEL NO. 917. 254193

BRIGGS AND STRATTON ENGINE - MODEL NO. 31A607-2392-B1

48 SHORT BLOCK

1036 EMISSIONS LABEL

1058 OPERATOR'S MANUAL

1329 REPLACEMENT ENGINE

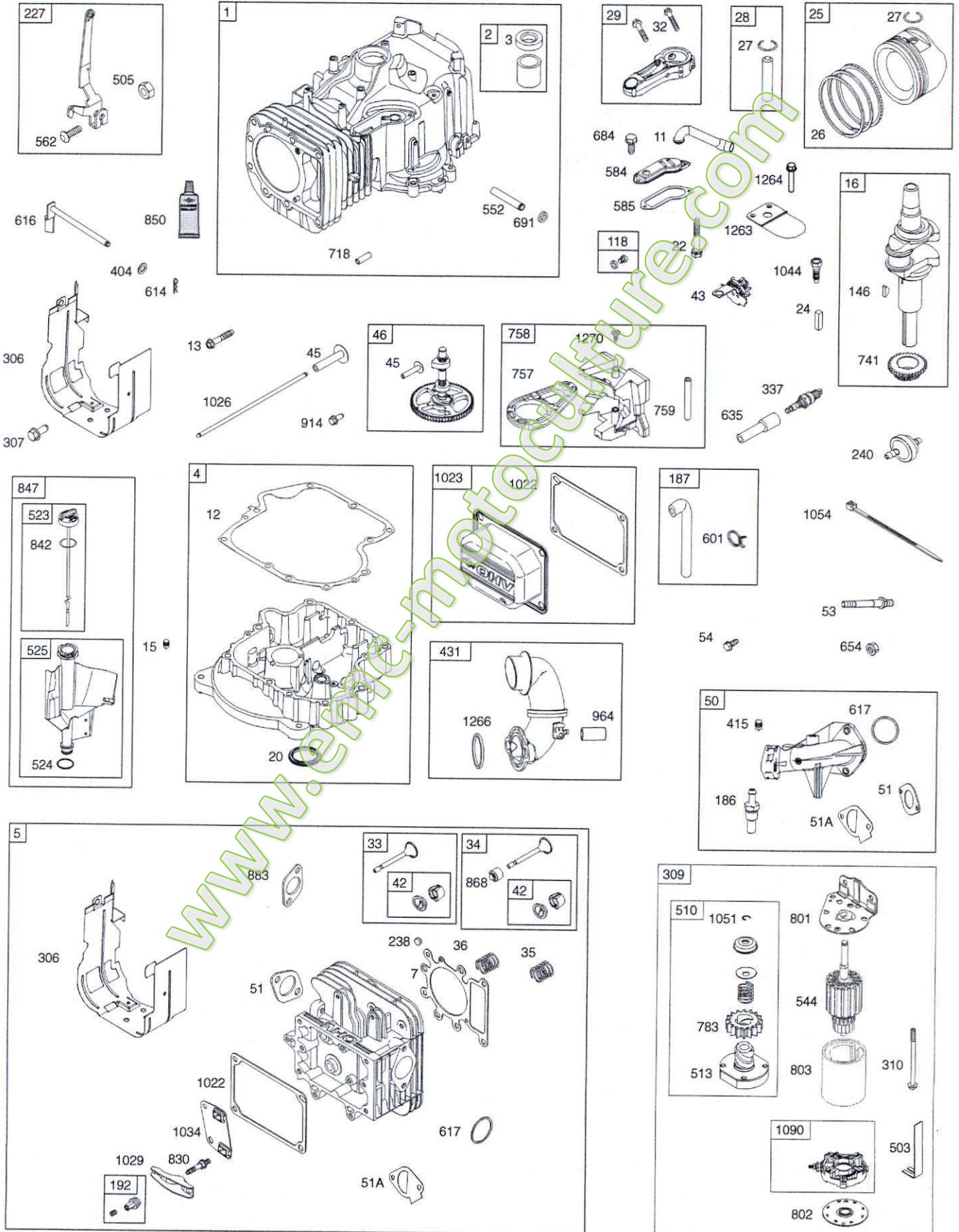

TRACTOR- -MODEL NO. 917. 254193
BRIGGS AND STRATTON ENGINE - MODEL NO. 31A607-2392-B1

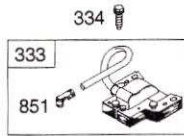
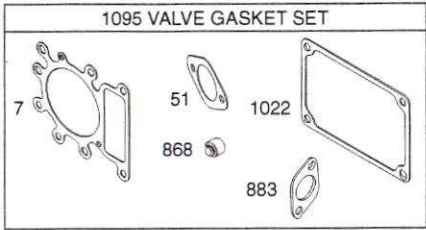
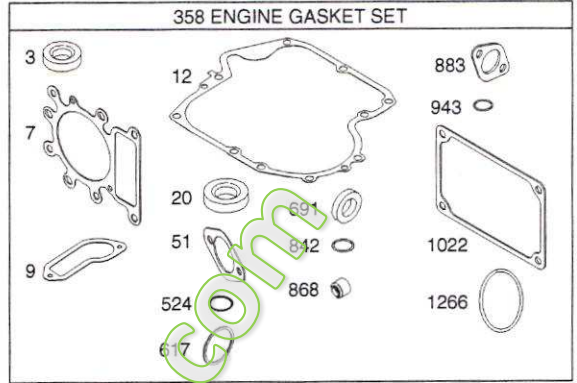
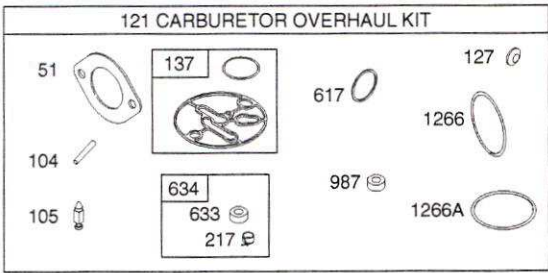

1036 EMISSIONS LABEL

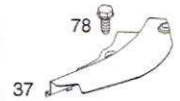
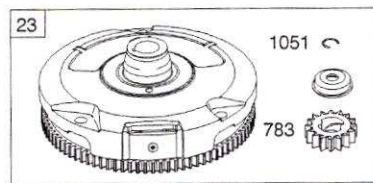
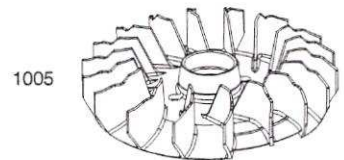
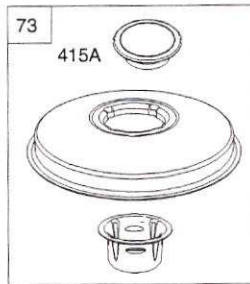
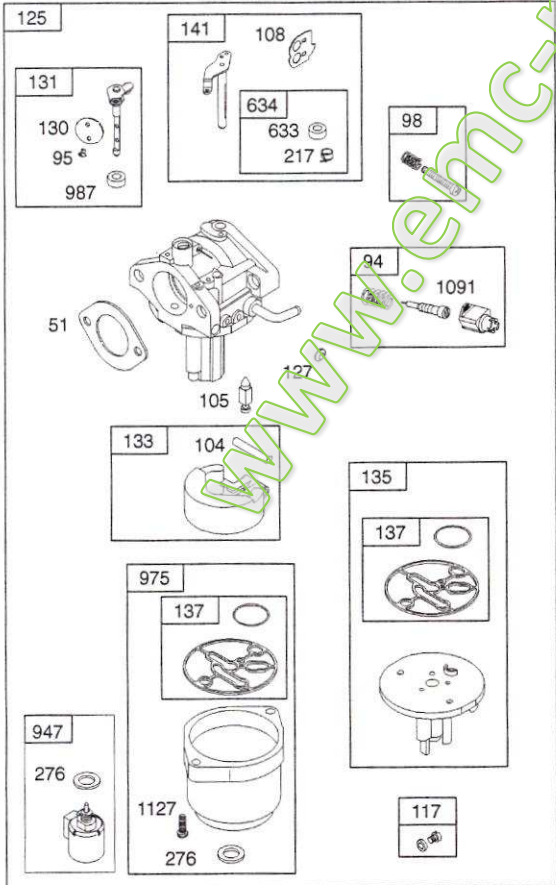
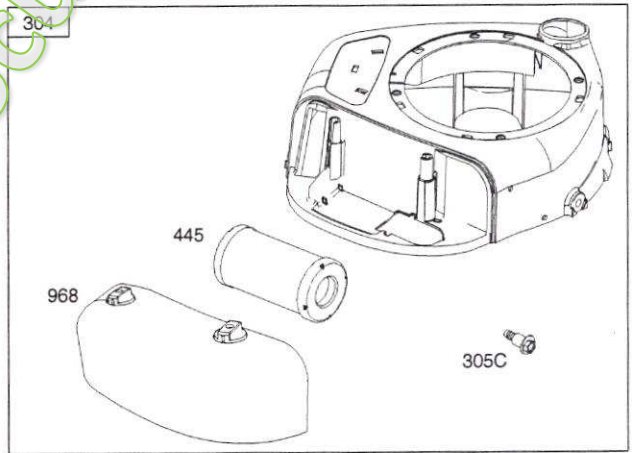
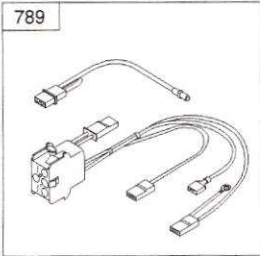

TRACTOR- -MODEL NO. 917. 254193

BRIGGS AND STRATTON ENGINE - MODEL NO. 31A607-2392-B1

KEY NO.	PART NO.	DESCRIPTION	KEY NO.	PART NO.	DESCRIPTION
1	796010	Cylinder Assembly	209	692208	Spring-Governor (Green)
2	399265	Bushing/Seal Kit (Magneto Side)	217	695409	Spring-Choke Return
3	391086s	Seal-Oil (Magneto Side)	222	694042	Bracket-Control
4	697106	Sump-Engine	227	691374	Lever-Governor Control
5	796026	Head-Cylinder	232	691842	Spring-Governor Link
7	796584	Gasket-Cylinder Head	238	691843	Cap-Valve
11	794683	Tube-Breather	240	394358s	Filter-Fuel
12	697110	Gasket-Crankcase	265	691024	Clamp-Casing
13	793988	Screw (Cylinder Head)	267	794904	Screw (Casing Clamp)
15	690946	Plug-Oil Drain	276	695410	Washer Sealing
16	797579	Crankshaft	304	797900	Blower Housing
20	795387	Seal-Oil (PTO Side)	305	697102	Screw (Blower Housing) (1/4-20x1.14)
22	692125	Screw (Crankcase Cover/Sump)	305A	793376	Screw (Blower Housing) (1/4-20x.82)
23	698281	Flywheel	305B	795891	Screw (Blower Housing) (10-16x.43)
24	796335	Key-Flywheel (Steel)	305C	799370	Screw (Blower Housing) (1/4-20x.90)
25	796172	Piston Assembly (Standard)	306	796006	Shield-Cylinder
	796173	Piston Assembly (.020" Oversize)	307	691693	Screw (Cylinder Shield)
26	791936	Ring Set (Standard)	309	693551	Motor-Starter
	792649	Ring Set (.020" Oversize)	310	690323	Screw (Starter Motor)
27	698469	Lock-Piston Pin	324	796308	Screen/Cup Assembly
28	796007	Pin-Piston	333	795315	Armature-Magneto
29	794122	Rod-Connecting	334	691061	Screw (Magneto Armature)
32	791118	Screw (Connecting Rod)	337	691043	Plug-Spark
33	792868	Valve-Exhaust	358	796187	Gasket Set-Engine
34	791935	Valve-Intake	404	691691	Washer (Governor Crank)
35	691279	Spring-Valve (Intake)	415	794903	Plug (Intake Manifold)
36	691279	Spring-Valve (Exhaust)	415A	794129	Plug (Cover/Retainer)
37	697352	Guard-Flywheel	431	797901	Elbow-Intake
42	499586	Keeper-Valve	445	796031	Filter-Air Cleaner Cartridge
43	691968	Slinger-Governor/Oil	474	696459	Alternator
45	690564	Tappet-Valve	503	691532	Strap-Starter
46	793880	Gear-Cam	505	691251	Nut (Governor Control Lever)
48	697761	Short Block	510	693699	Drive-Starter
50	796180	Manifold-Intake	513	692024	Clutch-Drive
51	692137	Gasket-Intake	523	699908	Dipstick
51A	796081	Gasket-Intake	524	691032	Seal-Dipstick Tube
53	690227	Stud (Carburetor)	525	697184	Tube-Dipstick
54	691148	Screw (Intake Manifold)	552	697144	Bushing-Governor Crank
78	691693	Screw (Flywheel Guard)	559	697561	Screw (Remote Choke Stop) (#8-32x.37) (Control Bracket)
94	793610	Kit-Idle Mixture	559A	693675	Screw (Remote Choke Stop) (T-25x.4) (Control Bracket)
95	690718	Screw (Throttle Valve)	559B	699881	Screw (Remote Choke Stop) (T20 #8-32x.5) (Control Bracket)
98	695408	Kit-Idle Speed	562	691119	Screw (Governor Control Lever)
104	694918	Pin-Float Hinge	584	794682	Cover-Breather Passage
105	696136	Valve-Float Needle	585	697109	Gasket-Breather Passage
108	695419	Valve-Choke	601	791850	Hose-Clamp (Green)
117	843099	Jet-Main (Standard)	614	691620	Pin-Cotter
118	790890	Jet-Main (High Altitude)	616	692012	Crank-Governor
121	796184	Kit-Carburetor Overhaul	617	692138	Seal-O Ring (Intake Manifold) (Red)
125	796109	Carburetor	633	699813	Seal-Choke/Throttle Shaft (Choke Shaft)
127	690727	Plug-Welch	634	698779	Spring/Seal Assembly (Choke Shaft)
130	699500	Valve-Throttle	635	691909	Boot-Spark Plug
131	699501	Kit-Throttle Shaft	654	690958	Nut (Carburetor)
133	694914	Float-Carburetor	684	697157	Screw (Breather Assembly)
135	698780	Tube-Fuel Transfer	691	692407	Seal-Governor Shaft
137	698781	Gasket-Float Bowl			
141	792777	Kit-Choke Shaft			
146	691639	Key-Timing			
186	794873	Connector-Hose (Intake Manifold)			
187	791805	Line-Fuel (Formed) (Cut to Required Length)			
188	691693	Screw (Control Bracket)			
192	691986	Adjuster-Rocker Arm			
202	691841	Link-Mechanical Governor			

TRACTOR- -MODEL NO. 917. 254193

BRIGGS AND STRATTON ENGINE - MODEL NO. 31A607-2392-B1

KEY NO.	PART NO.	DESCRIPTION
697	791680	Screw (Drive Cap)
718	690959	Pin-Locating
729	691224	Clip-Wire
741	697128	Gear-Timing
757	793242	Link-Counterweight
758	793763	Counterweight
759	697392	Pin-Counterweight
783	693713	Gear-Pinion
789	698329	Harness-Wiring
801	691283	Cap-Drive
802	691286	Cap-End
830	691095	Stud-Rocker Arm
842	691031	Seal-O Ring (Dipstick Tube)
847	790442	Dipstick/Tube Assembly
850	100106	Sealant-Liquid
851	692424	Terminal-Spark Plug
868	690968	Seal-Valve
883	692236	Gasket-Exhaust
914	697551	Screw (Rocker Cover)
947	699915	Solenoid-Fuel
964	799159	Cap-Connector
968	797902	Cover-Air Cleaner
975	699502	Bowl-Fuel
987	698777	Seal-Throttle Shaft
1005	796201	Fan-Flywheel
1022	272475s	Gasket-Rocker Cover
1023	797421	Cover-Rocker
1026	692003	Rod-Push (Intake)
	692011	Rod-Push (Exhaust)
1029	691751	Arm-Rocker
1034	690822	Guide-Push Rod
1036		Label-Emissions (Available from a Briggs & Stratton Authorized Dealer)
1040	698368	Plate-Trim
1044	698139	Screw (Flywheel)
1051	691265	Ring-Retaining
1054	280275	Tie-Cable
1058	276344TRI	Operator's Manual
1059	698516	Kit-Screw/Washer
1090	691293	Retainer-Brush
1091	691333	Cap-Limiter
1095	794152	Gasket Set-Valve
1119	691183	Screw (Alternator)
1127	695407	Screw (Float Bowl)
1263	697124	Reed-Breather
1264	697104	Screw (Breather Reed)
1266	691917	Seal-O Ring (Intake Elbow) (Red)
1266A	697123	Seal-O Ring (Intake Elbow)
1270	793243	Plug-AVS Counterweight
1329	31A607-3026-G5	Replacement Engine
1330	272147	Repair Manual

Engine Gasket Set Key No. 358
 Valve Gasket Set Key No. 1095
 Carburetor Overhaul Kit Key No. 121

NOTE: All component dimensions given in U.S. inches
 1 inch = 25.4 mm

SERVICE NOTES

www.emc-motoculture.com

SERVICE NOTES

www.emc-motoculture.com

LIMITED WARRANTY ON CRAFTSMAN RIDING EQUIPMENT

For two (2) years from the date of purchase, if this Craftsman Riding Equipment is maintained, lubricated and tuned up according to the instructions in the owner's manual, Sears will repair or replace free of charge any parts that are found to be defective in material or workmanship according to the guidelines of coverage listed below. Sears will also provide free labor for these applicable warranted parts for the two full years. During the first 30 days of purchase, there will be no charges to service the product at your home for issues covered by this warranty. (See exclusions below). For your convenience, IN HOME warranty service will still be available after the first 30 days of purchase, but a trip charge will apply. This charge will be waived if the Craftsman product is dropped off at an authorized Sears location. For the nearest authorized Sears location, please call 1-800-4-MY-HOME®. This warranty applies only while this product is within the United States.

This Warranty does not cover:

- Expendable items which become worn during normal use, including but not limited to blades, spark plugs, air cleaners, belts, and oil filters.
- Standard Maintenance Servicing, oil changes, or tune-ups
- Tire replacement or repair caused by punctures from outside objects, such as nails, thorns, stumps, or glass.
- Repairs necessary because of operator abuse, including but not limited to, damage caused by towing objects beyond the capability of the riding equipment, impacting objects that bend the frame or crankshaft, or over-speeding the engine.
- Repairs necessary because of operator negligence, including but not limited to, electrical and mechanical damage caused by improper storage, failure to use the proper grade and amount of engine oil, failure to keep the deck clear of flammable debris, or failure to maintain the equipment according to the instructions contained in the owner's manual.
- Engine (fuel system) cleaning or repairs caused by fuel determined to be contaminated or oxidized (stale). In general, fuel should be used within 30 days of its purchase date.
- Normal deterioration and wear of the exterior finishes, or product label replacement.
- Riding equipment used for commercial or rental purposes.

LIMITED WARRANTY ON BATTERY

For ninety (90) days from date of purchase, if any battery included with this riding equipment proves defective in material or workmanship and our testing determines the battery will not hold a charge, Sears will replace the battery at no charge. During the first 30 days of purchase, there will be no charges to replace the battery at your HOME. After the first 30 days, for your convenience, IN-HOME warranty service will still be available but a trip charge will apply. This charge will be waived if the Craftsman product is dropped off at an authorized Sears location. For the nearest authorized Sears location, please call 1-800-4-MY-HOME®.

This battery warranty applies only while this product is within the United States.

This warranty gives you specific legal rights, and you may also have other rights, which vary, from state to state.

Sears, Roebuck and Co., Dept. 817WA, Hoffman Estates, IL 60179

CRAFTSMAN®