

REPAIR PARTS MANUAL

MODEL NO. 259040

Lawn Tractor

CRAFTSMAN®

173669 1.5.00 TR
PRINTED IN U.S.A.

HOW TO USE THIS MANUAL

This manual is designed to provide the customer with a means to identify the parts on his/her tractor when ordering repair parts. The illustrations may or may not represent the actual assemblies; therefore, it is not recommended to use this manual as a guide to assemble or disassemble the tractor. Some hardware and parts are drawn larger in order to more readily identify them.

Each tractor has its own model number.

The model number for your tractor can be found on the fender under the seat.

When ordering parts, always give the following information:

- Product - "Tractor"
- Model Number - "259040"
- Part Number
- Part Description

TABLE OF CONTENTS

| | |
|-----------------------|-------|
| SCHEMATIC..... | 3 |
| ELECTRICAL..... | 4-5 |
| CHASSIS..... | 6-7 |
| DRIVE..... | 8-9 |
| STEERING..... | 10-11 |
| SEAT..... | 12 |
| DECALS..... | 13 |
| ENGINE..... | 14-15 |
| MOWER LIFT..... | 16-17 |
| MOWER DECK..... | 18-19 |
| TRANSAXLE..... | 20-21 |
| ENGINE BREAKDOWN..... | 22-27 |

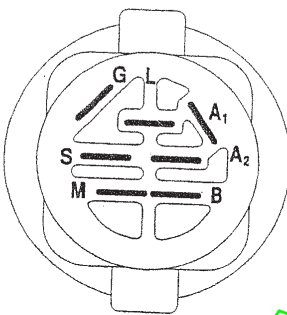
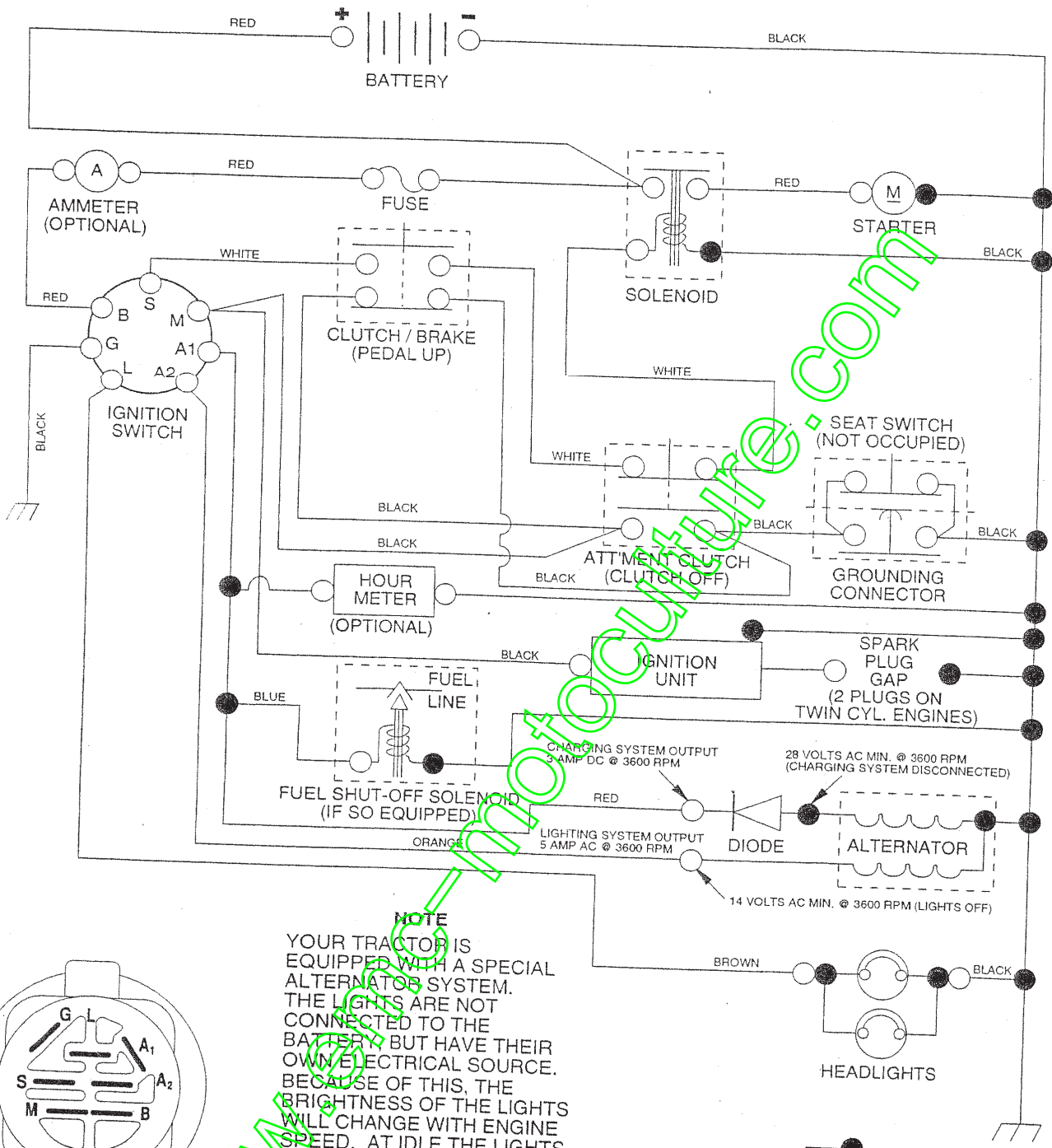

IGNITION SWITCH

| POSITION | CIRCUIT | "MAKE" |
|-----------|------------|--------|
| OFF | M+G+A1 | NONE |
| RUN/LIGHT | B+A1 | A2+L |
| RUN | B+A1 | NONE |
| START | B + S + A1 | NONE |

NOTE
 YOUR TRACTOR IS EQUIPPED WITH A SPECIAL ALTERNATOR SYSTEM. THE LIGHTS ARE NOT CONNECTED TO THE BATTERY BUT HAVE THEIR OWN ELECTRICAL SOURCE. BECAUSE OF THIS, THE BRIGHTNESS OF THE LIGHTS WILL CHANGE WITH ENGINE SPEED. AT IDLE THE LIGHTS WILL DIM. AS THE ENGINE IS SPEEDED UP, THE LIGHTS WILL BECOME THEIR BRIGHTEST.

WIRING INSULATED CLIPS
NOTE: IF WIRING INSULATED CLIPS WERE REMOVED FOR SERVICING OF UNIT, THEY SHOULD BE REPLACED TO PROPERLY SECURE YOUR WIRING.

ELECTRICAL

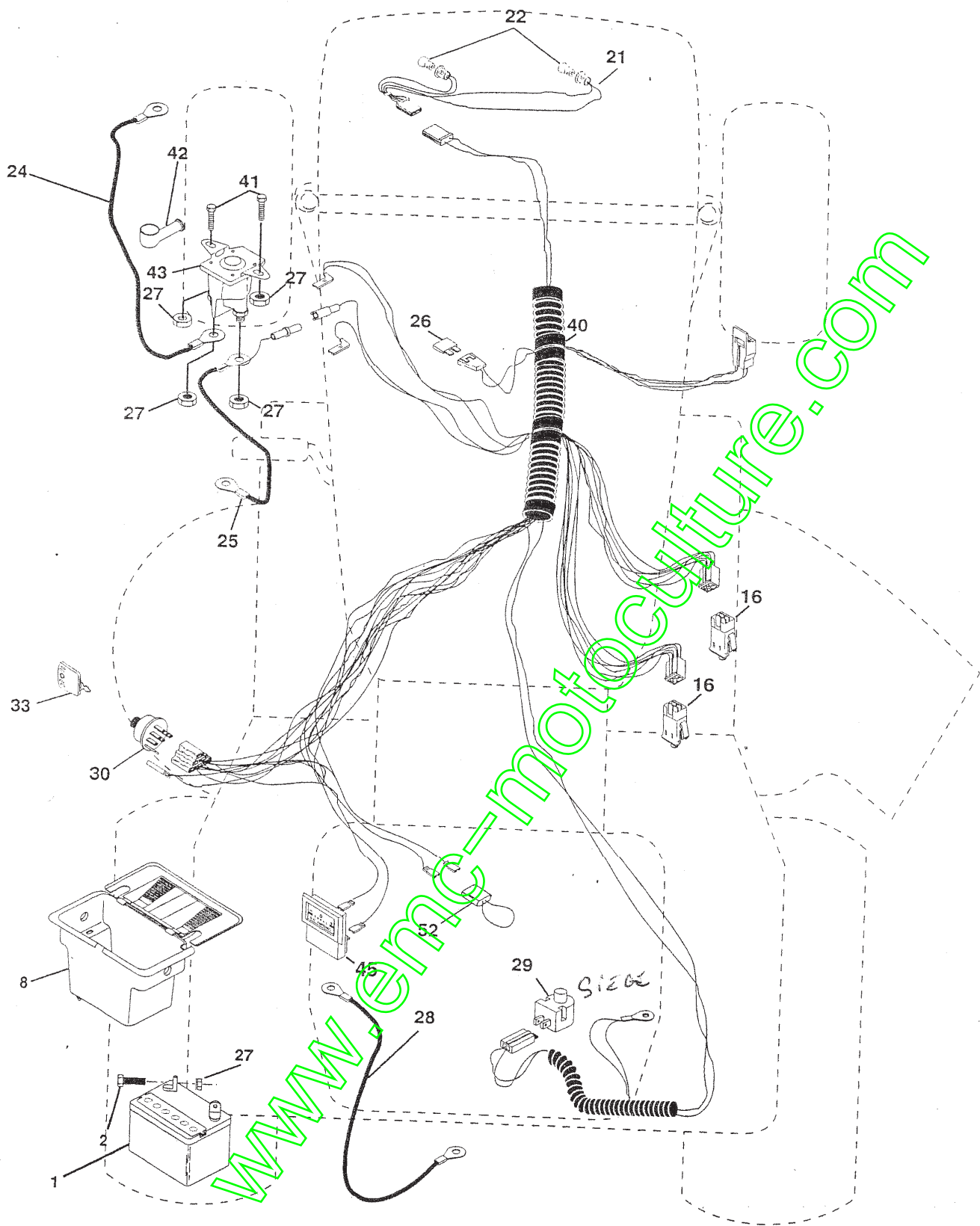

| KEY NO. | PART NO. | DESCRIPTION |
|---------|----------|---------------------------------|
| 1 | 144925 | Battery |
| 2 | 74760412 | Bolt Hex Hd 1/4-20unc X 3/4 |
| 8 | 156417 | Case Battery |
| 16 | 153664 | Switch Interlock Push-In |
| 21 | 166181 | Harness Socket Light W/4152J |
| 22 | 4152J | Bulb Light #1156 |
| 24 | 4799J | Cable Battery 6ga 11" red |
| 25 | 146147 | Cable Battery 6 Ga W/16 Wir red |
| 26 | 166180 | Fuse 15 AMP |
| 27 | 73510400 | Nut Keps Hex 1/4-20 Unc |
| 28 | 4207J | Cable Ground 6ga 12" black |
| 29 | 121305X | Switch Plunger Mc Gray |
| 30 | 163968 | Switch Ign |
| 33 | 140403 | Key Ign |
| 40 | 170217 | Harness Ign |
| 41 | 71110408 | Bolt Blk Hex 1/4-20unc x 1/2 |
| 42 | 131563 | Cover Terminal Red |
| 43 | 145673 | Solenoid |
| 48 | 140844 | Adapter Ammeter Rectangular |
| 52 | 141940 | Protection Wire Loop |

NOTE: All component dimensions given in U.S. inches
1 inch = 25.4 mm

REPAIR PARTS

TRACTOR- -MODEL NO. 917. 259040

CHASSIS AND ENCLOSURES

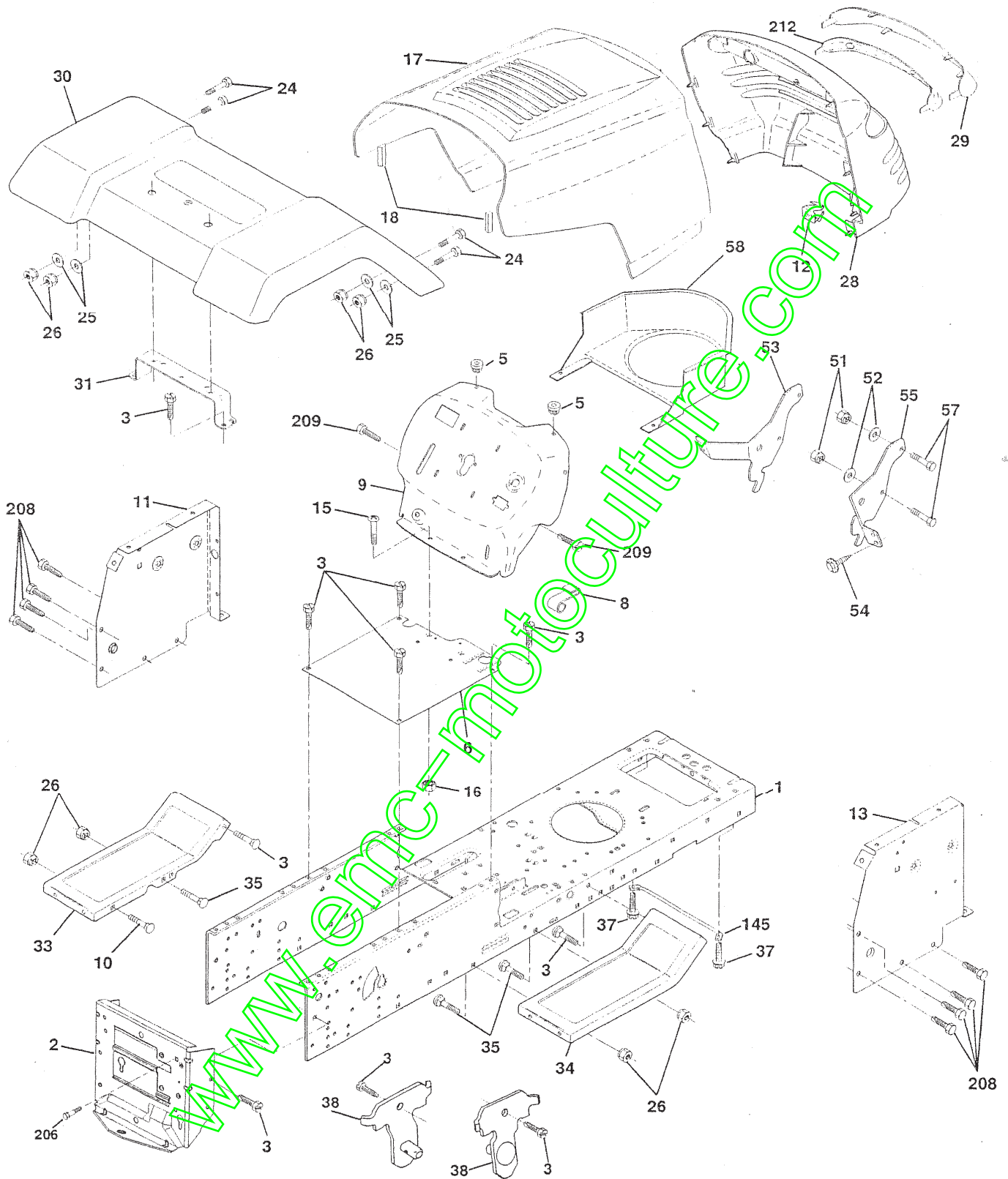

| KEY NO. | PART NO. | DESCRIPTION |
|---------|------------|-----------------------------------|
| 1 | 169831 | Chassis Lt Stamping |
| 2 | 169061 | Drawbar |
| 3 | 17060612 | Screw 3/8-16 x 3/4 |
| 5 | 155272 | BumperHood/Dash |
| 6 | 155924X011 | Saddle SLKSCRE FLT SDL |
| 8 | 155138 | Clip Retainer Slide-on |
| 9 | 168347X011 | Dash Sikschr Plm Mech Sym |
| 10 | 72140608 | Bolt RdHd Sqnk. 3/8-16 x 1 |
| 11 | 155927 | Panel Asm. Dash Lh |
| 12 | 145660 | Clip Tinnerman Grille P/L |
| 13 | 172107X010 | Panel Dash Rh |
| 15 | 74180512 | Screw Mach Trhd 5/16-18unc x 3/4 |
| 16 | 73510500 | Nu Keps 5/16-18unc |
| 17 | 159639X558 | Hood Pnt Steel Private Label |
| 18 | 126938X | BumperHood |
| 24 | 74780616 | Bolt Fin Hex 3/8-16 Unc x 1 Gr. 5 |
| 25 | 19131312 | Washer 13/32 x 13/16 x 12 Ga. |
| 26 | 73800600 | Nut Lock Hex w/Ins. 3/8-16 Unc |
| 28 | 150407 | Grill |
| 29 | 150209X599 | Lens Grille |
| 30 | 169465X558 | Fender Pnt |
| 31 | 136619 | Bracket Fender Support |
| 33 | 105476X558 | Footrest Pnt. Lh |
| 34 | 105475X558 | Footrest Pnt. Rh |
| 35 | 72110606 | Bolt RdHd Sht. Sqnk. 3/8-16 x 3/4 |
| 37 | 17490508 | Screw Thdrol 5/16-18 x 1/2 Tyt |
| 38 | 169834 | Bracket Asm. Pivot Mower Rear |
| 51 | 73800400 | Nut Lock Hex W/Ins. 1/4-20 |
| 52 | 19091416 | Washer 9/32 x 7/8 x 16 Ga. |
| 53 | 144697 | Bracket Grille LH |
| 54 | 161464 | Screw Hex Wshd #8-18 x 7/8 |
| 55 | 144696 | Bracket, Grille RH |
| 57 | 74780412 | Bolt Fin Hex 1/4-20 x 3/4 |
| 58 | 150127 | Duct Air Engine |
| 145 | 156324 | Rod Pivot Chassis /Hood |
| 206 | 170165 | Bolt Shoulder 5/16-18 TT |
| 208 | 17670608 | Screw Thdrol 3/8-16 x 1/2 |
| 209 | 17000612 | Screw Hex Wsh Thdrol 3/8-16 BL |
| 212 | 156494 | Insert Lens |
| 7 | 8479J | Plug Button Blk .359 Dia. Choke |

NOTE: All component dimensions given in U.S. inches
1 inch = 25.4 mm

REPAIR PARTS

TRACTOR- -MODEL NO. 917.259040

DRIVE

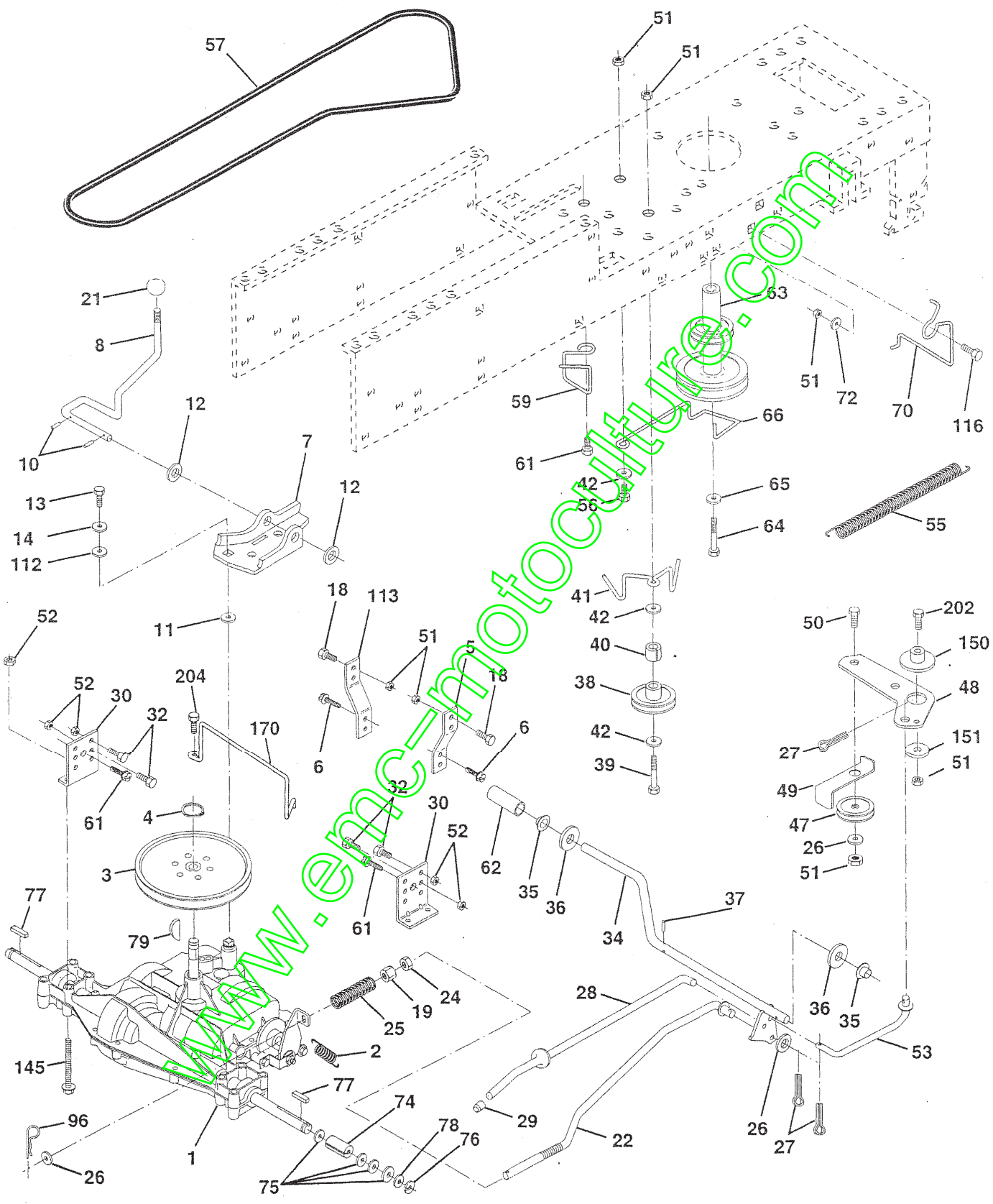

DRIVE

| KEY NO. | PART NO. | DESCRIPTION | KEY NO. | PART NO. | DESCRIPTION |
|---------|----------|--|---------|----------|-----------------------------------|
| 1 | ----- | Transaxle Peerless 205-544C (See Breakdown) | 49 | 123205X | Retainer Belt Style Spring |
| 2 | 146682 | Spring Return Brake T/a Zinc | 50 | 74760624 | Bolt Hex Hd 3/8-16uncx1-1/2 |
| 3 | 123666X | Pulley Transaxle 18/20" tires | 51 | 73680600 | Nut Crownlock 3/8-16 UNC |
| 4 | 12000028 | Ring Retainer # 5100-62 | 52 | 73680500 | Nut Lock 5/16-18 |
| 5 | 121520X | Strap Torque 30 Degrees | 53 | 105710X | Link Clutch 7 66 |
| 6 | 17060512 | Screw 5/16-18 x 3/4 | 55 | 105709X | Spring Return Clutch 6 75 |
| 7 | 162240 | Bracket Saddle Shift T/a | 56 | 74760620 | Bolt Fin Hex 3/8-16 uncx1-1/4 |
| 8 | 131679 | Rod Shf Sdl LY/YT Str Blk | 57 | 130801 | V-Belt Cd Drive |
| 10 | 76020416 | Pin Cotter 1/8 x 1 Cad | 59 | 169691 | Keeper Belt Center Span |
| 11 | 105701X | Washer Plate Shf | 61 | 17060612 | Screw 3/8-16 x 3/4 |
| 12 | 19151216 | Washer 15/32 x 3/4 x 16ga | 62 | 8883R | Cover Pedal Blk Round |
| 13 | 74550412 | Bolt 1/4-28unf Gr8 W/Patch | 63 | 140186 | Pulley Engine |
| 14 | 10040400 | Washer Lock Hvy Helical 1/4 | 64 | 71170764 | Bolt Hex 7/16-20 x 4 Gr 5 |
| 18 | 74780616 | Bolt Fin Hex 3/8-16 x 1 Gr.5 | 65 | 10040700 | Washer Lock Hvy Hlcl Spr 7/16 |
| 19 | 73800600 | Nut Lock 3/8-16 Unc | 66 | 154778 | Keeper Belt Engine |
| 21 | 106933X | Knob Rd 1/2-13 Plstc Thds | 70 | 134683 | Guide Belt Mower Drive RH |
| 22 | 130804 | Rod Brake Blk Zinc | 72 | 19132012 | Washer 13/32 x1-1/4 x 12 Ga |
| 24 | 73350600 | Nut Hex Jam 3/8-16 Unc | 74 | 137057 | Spacer Axle |
| 25 | 106888X | Spring Rod Brake 2 00 Zinc | 75 | 121749X | Washer 25/32 x1 1/4 x 16 Ga |
| 26 | 19131316 | Washer 13/32 x 13/16x16 Ga | 76 | 12000001 | E-ring #5133-75 |
| 27 | 76020412 | Pin Cotter 1/8 x 3/4 Cad | 77 | 123583X | Key Square 2 0 x 1845/ 1865 |
| 28 | 145204 | Rod Brake Parking Lt/Yt | 78 | 121748X | Washer 25/32 x 1-5/8 x 16ga |
| 29 | 71673 | Cap Brake Parking | 79 | 2228M | Key Woodruff #9 3/16 x 3/4 |
| 30 | 130807 | Bracket Mtg Transaxle | 96 | 4497H | Retainer Spring |
| 32 | 74760512 | Bolt Fin Hex 5/16-18 x 3/4 | 112 | 19091210 | Washer 9/32 x 3/4 x 10 Ga |
| 34 | 155071 | Shaft Asm Pedal Foot | 113 | 127285X | Strap Torque |
| 35 | 120183X | Bearing Nylon Blk 629 Id | 116 | 72110610 | Bolt Rdhd Sq Neck 3/8-16 x 1.25 |
| 36 | 19211616 | Washer 21/32 x 1 x 16 Ga | 145 | 74490540 | Bolt Hex Flghd 5/16-18 Gr. 5 |
| 37 | 1572H | Pin Roll 3/16 x 1" | 150 | 165850 | Bushing Bellcrank Grd. Drive |
| 38 | 131494 | Pulley Idler Flat | 151 | 19133210 | Washer 13/32 x 2 x 10 Ga |
| 39 | 74760644 | Bolt Rdhd 3/8-16unc x 2-3/4 Gr. 5 | 170 | 165849 | Keeper Belt Transaxle Gear |
| 40 | 4470J | Spacer Split 395 x 59 Bzp | 202 | 72110612 | Bolt Carr Sh 3/8-16 x 1-1/2 Gr. 5 |
| 41 | 165838 | Keeper Belt Idler | 204 | 17060516 | Screw 5/16-18 x 1 |
| 42 | 19131312 | Washer 13/32 x 13/16x12 Ga | | | |
| 47 | 127783 | Pulley Idler V Groove Plastic | | | |
| 48 | 154407 | Bellcrank Clutch Grn Drv Stl | | | |

NOTE: All component dimensions given in U.S. inches
1 inch = 25.4 mm

www.emc-motocycle.com

REPAIR PARTS

TRACTOR- -MODEL NO. 917.259040

STEERING ASSEMBLY

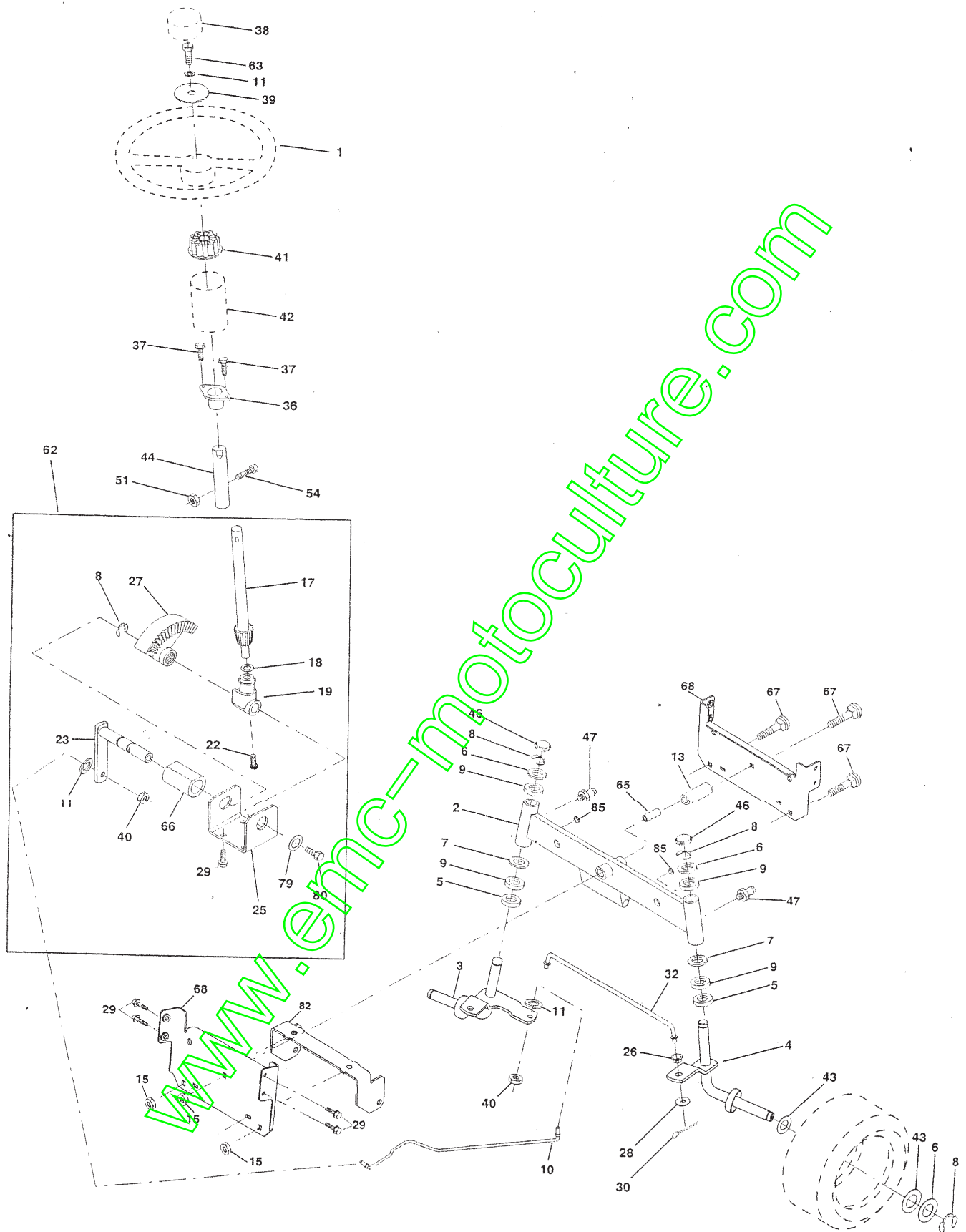

STEERING ASSEMBLY

| KEY NO. | PART NO. | DESCRIPTION |
|---------|------------|----------------------------------|
| 1 | 140044 | Steering Wheel |
| 2 | 154427 | Front Axle Asm |
| 3 | 156483 | Spindle Asm Lh |
| 4 | 157473 | Spindle Asm Rh |
| 5 | 6266H | Washer Thrust .75 x 1.230 |
| 6 | 121748X | Washer 25/32 x 1-5/8 x 16 Ga. |
| 7 | 19272016 | Washer 27/32 x 1-1/4 x 16 Ga. |
| 8 | 12000029 | RingKlip #T5304-75 |
| 9 | 3366R | Bearing Col Strg Blk |
| 10 | 169832 | Draglink |
| 11 | 10040600 | Washer Lock Hvy Hlcl Spr 3/8 |
| 13 | 136518 | Spacer Brg Axle Front |
| 15 | 145212 | Nut Hexflange Lock |
| 17 | 156546 | Shaft Asm Strg |
| 18 | 57079 | Washer Thrust 3/16 x .750 x .033 |
| 19 | 160395 | Support Shaft |
| 22 | 165857 | Screw Hex Wash Hd Torx |
| 23 | 165851 | Shaft Asm Pittman |
| 25 | 154406 | Bracket Steering |
| 26 | 126847X | Bushing Link Drag Blk LR |
| 27 | 136874 | Gear Sector 22 Teeth |
| 28 | 19131416 | Washer 13/32 x 7/8 x 16 Ga. |
| 29 | 17060612 | Screw 3/8-16 x 3/4 |
| 30 | 76020412 | Pin |
| 32 | 130465 | Rod Tie Wire Form 19.75 Mech |
| 36 | 155099 | Bushing Strg. 5/8 ID Dash |
| 37 | 152927 | Screw |
| 38 | 140045 | Insert, Steering Wheel |
| 39 | 19133812 | Washer 13/32 x 2-3/8 x 12 Ga. |
| 40 | 7810H | Nut Lock Center 3/8-24 |
| 41 | 100711L | Adaptor Wheel Strg. |
| 42 | 145054X428 | Boot Steering Dash P/L MTL Blk |
| 43 | 121749X | Washer 25/32 x 1-1/4 x 16 Ga. |
| 44 | 753720 | Extension Steering Non-adjust |
| 46 | 121232X | Cap Spindle Fr Top Blk |
| 47 | 6855M | Fitting Grease |
| 51 | 73800500 | Nut Lock Hx W/Ins 5/16-18unc |
| 54 | 74780520 | Bolt Fin Hex 5/16-18unc |
| 62 | 167902 | Steering Assembly |
| 63 | 74780616 | Bolt Fin Hex 3/8-16unc x 1 Gr. 5 |
| 65 | 160367 | Spacer Axle |
| 66 | 154404 | Bearing Arm Pittman |
| 67 | 72140618 | Bolt Rdhd Sqnk 3/8-16 x 2-1/4 |
| 68 | 169827 | Brace Axle |
| 79 | 19132012 | Washer 13/32 x 1-1/4 x 12 Ga |
| 80 | 74950612 | Bolt Hex Nylon 3/8-16 x 3/4 |
| 82 | 169835 | Bracket Susp Chasis Front |
| 85 | 133835 | Fastner Christmas Tree |

NOTE: All component dimensions given in U.S. inches
1 inch = 25.4 mm

REPAIR PARTS

TRACTOR- -MODEL NO. 917.259040

SEAT ASSEMBLY

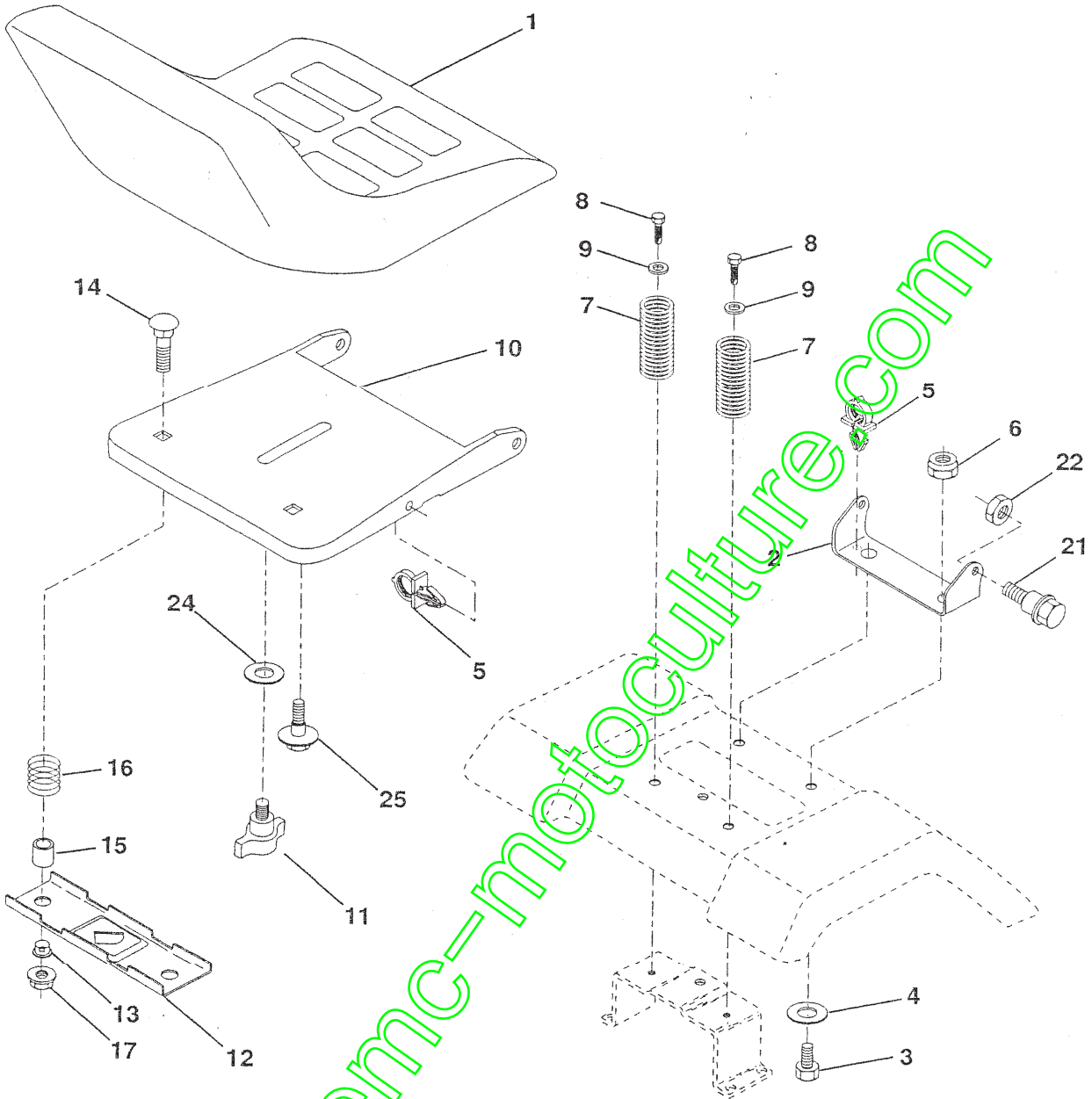

| KEY NO. | PART NO. | DESCRIPTION |
|---------|----------|-----------------------------|
| 1 | 127427 | Seat |
| 2 | 140551 | Bracket Pvt St |
| 3 | 71110616 | Bolt Fin Hex 3/8-16unc X 1 |
| 4 | 19131610 | Washer Flat 13/32 X 1X10 Ga |
| 5 | 145006 | Clip Push-In Hinged |
| 6 | 73800600 | Nut Crownlock 3/8-16 UNC |
| 7 | 124181X | Spring Seat Cprsn 2 250 Blk |
| 8 | 17000616 | Screw 3/8-16 X 1-1/2 |
| 9 | 19131614 | Washer 13/32 X 1 X 14 Ga |
| 10 | 155925 | Pan Seat |
| 11 | 166369 | Knob Seat |
| 12 | 121246X | Bracket Mounting Switch |

| KEY NO. | PART NO. | DESCRIPTION |
|---------|----------|------------------------------|
| 13 | 121248X | Bushing Snap Blk Nyl 50 Id |
| 14 | 72050412 | Bolt Rdhd Sht 1/4-20x1-1/2 |
| 15 | 134300 | Spacer Split 28x 96 Yel Zinc |
| 16 | 121250X | Spring Cprsn 1 27 Blk Pnt |
| 17 | 123976X | Nut Lock 1/4 Lge Flg Gr 5 |
| 21 | 171852 | Bolt Shld 5/16-18 Unc-2A |
| 22 | 73800500 | Nut Crown Lock Hex 5/16-18 |
| 24 | 19171912 | Washer 17/32 X1-3/16X12 Ga |
| 25 | 127018 | Bolt Shoulder |

NOTE: All component dimensions given in U.S. inches
1 inch = 25.4 mm

DECALS

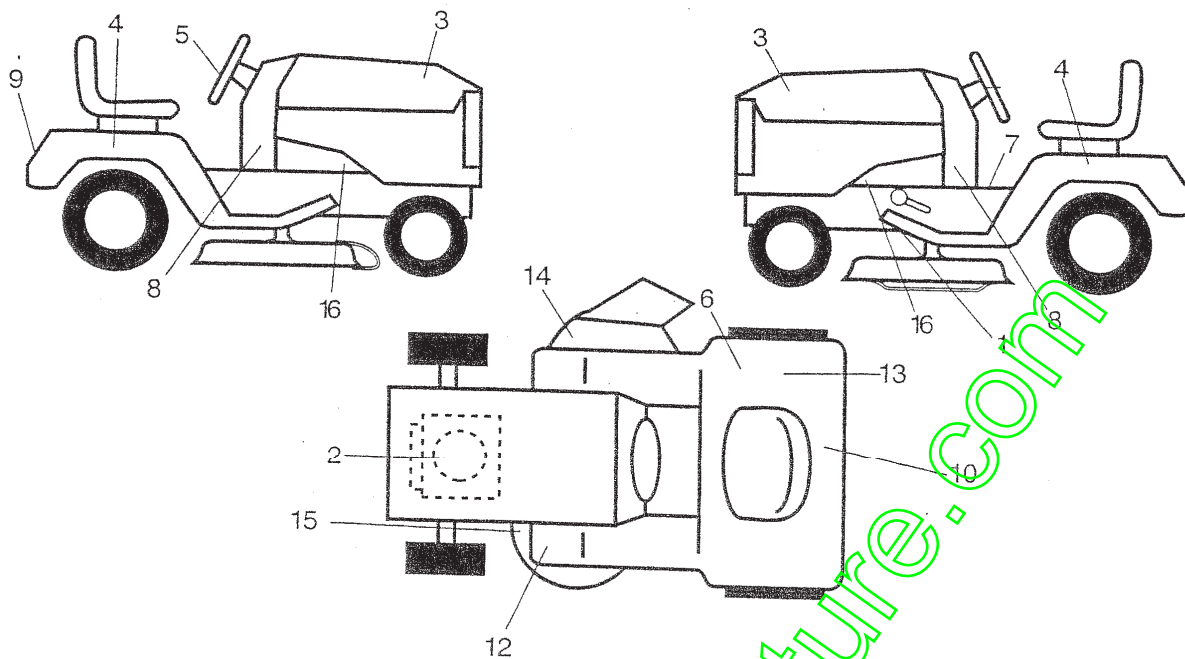

| KEY NO. | PART NO. | DESCRIPTION |
|---------|----------|------------------------|
| 1 | 146046 | Decal V-Belt Drive Sch |
| 2 | 165387 | Decal Engine HP |
| 3 | 171704 | Decal Hood |
| 4 | 172276 | Decal Fender |
| 5 | 172275 | Decal Ins Strg Whl |
| 6 | 126187X | Decal Certification |
| 7 | 140837 | Decal Brake Parking |
| 8 | 163248 | Decal Panel Dash |
| 9 | 163204 | Decal Fender Logo |
| 10 | 145005 | Decal Battery Dngr/Psn |

| KEY NO. | PART NO. | DESCRIPTION |
|---------|----------|-------------------------------|
| 12 | 159737 | Decal Clutch/Brake |
| 13 | 145437 | Decal Europ. Stand CE |
| 14 | 145494 | Decal International Cutfinger |
| 15 | 136832 | Decal Mower Drive Schem 38 |
| 16 | 159736 | Decal Chassis Hot Muffler |
| -- | 138311 | Decal Lift Handle |
| -- | 162598 | Decal Drawbar Load Limit |
| -- | 173667 | Manual Owners (Euro) |
| -- | 173668 | Manual Owners (Scan) |
| -- | 173669 | Manual Repair Parts |

WHEELS & TIRES

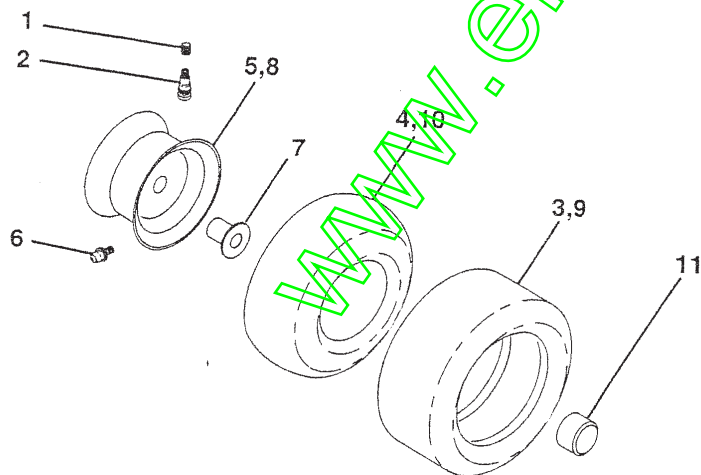

| KEY NO. | PART NO. | DESCRIPTION |
|---------|------------|--------------------------------|
| 1 | 59192 | Cap Value Tire |
| 2 | 65139 | Stem Value |
| 3 | 106222X | Tire F Ts 15 X 6 0 - 6 Service |
| 4 | 59904 | Tube Inner Front #35060 |
| 5 | 106732X427 | Rim Asm 6"front White Service |
| 6 | 278H | Fitting Grease |
| 7 | 9040H | Bearing Flange |
| 8 | 106108X427 | Rim Asm 8"rear White Service |
| 9 | 124635X | Tire R Ts 18x8 5-8 Service |
| 10 | 7152J | Tube Rear 9 5 X 8 Service |
| 11 | 104757X | Cap Axle Blk 1 50 X 1 00 |
| -- | 144334 | Sealant, Tire (10 oz. tube) |

NOTE: All component dimensions given in U.S. inches
1 inch = 25.4 mm

REPAIR PARTS

TRACTOR- -MODEL NO. 917.259040

ENGINE

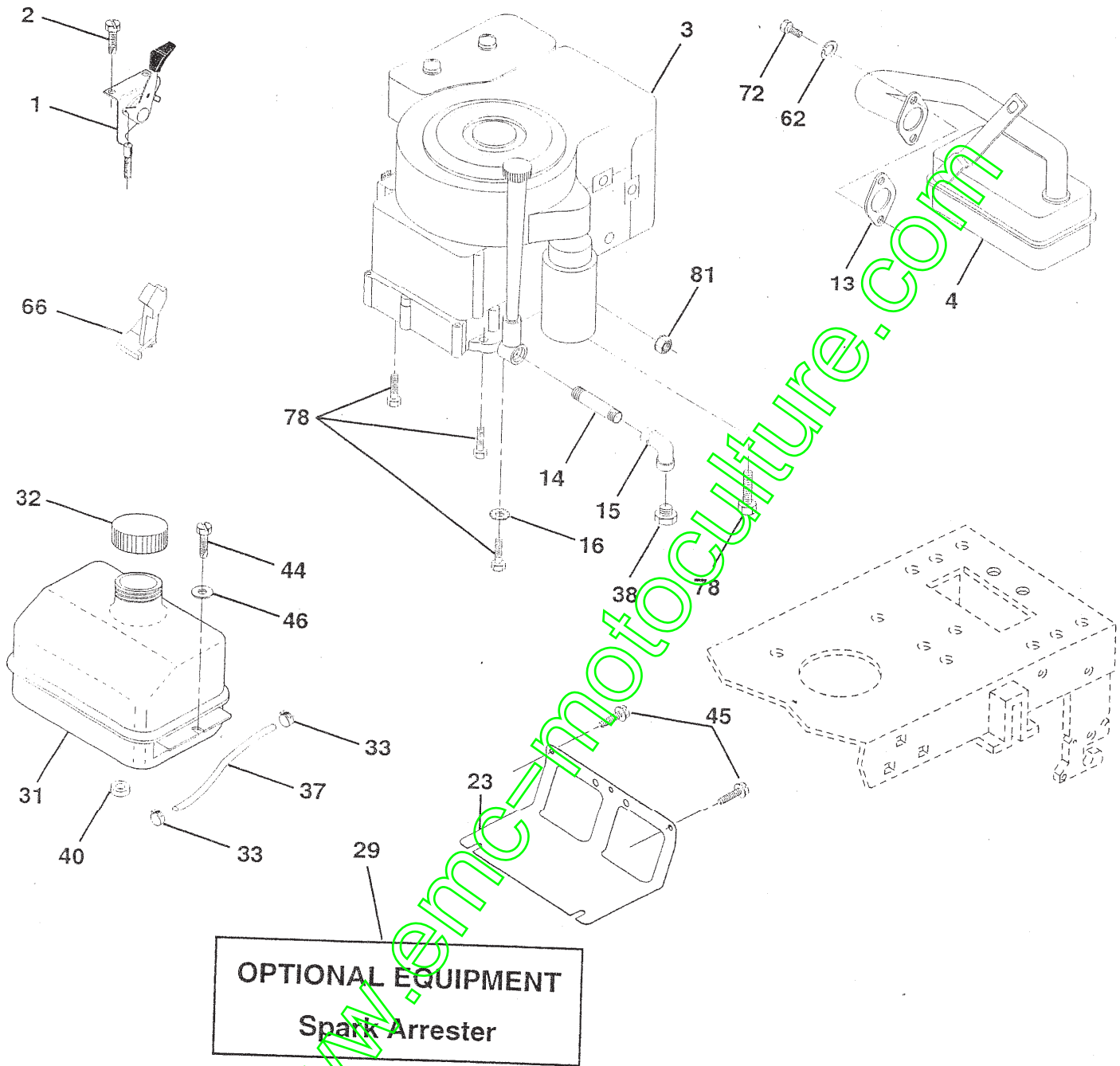

ENGINE

| KEY NO. | PART NO. | DESCRIPTION |
|---------|----------|---|
| 1 | 141359 | Control Th/ch LH IV 1 80 20 22 |
| 2 | 17720410 | Screw Hex Thd Cut 1/4-20x5/8 T |
| 3 | ----- | Engine (See Breakdown) |
| 4 | 137348 | Briggs, Model No 28R707-1140-E3 Muffler Exh LT B&S |
| 13 | 165291 | Gasket Eng 1 313 Id Tin Plated |
| 14 | 13280324 | Nipple Pipe 3/8 Npt x 3" |
| 15 | 13200300 | Elbow Std 90 Degree 3/8-18 Npt |
| 16 | 11050600 | Washer Lock Ext Tooth 3/8 |
| 23 | 169837 | Shield Browning/Debris Guard |
| 29 | 137180 | Kit Spark Arrestor (Flat Scr) |
| 31 | 109202X | Tank Fuel Front 1 25 |
| 32 | 158990 | Cap Asm Fuel Sears Vented |
| 33 | 123487X | Clamp Hose Blk |
| 37 | 137040 | Line Fuel 20" |
| 38 | ----- | Plug Oil Drain (See Engine Breakdown) |
| 40 | 124028X | Bushing Snap Nyl Blk Fuel Line |
| 44 | 17670412 | Screw Hex wsh Thdrol 1/4-20 x 3/4 |
| 45 | 17000612 | Screw 3/8-16 x 3/4 |
| 46 | 19091416 | Washer 9/32 x 7/8 x 16 ga |
| 62 | 10040500 | Washer Lock Hvy Hlcl Spr 5/16 |
| 66 | 127951 | Stop Throttle |
| 72 | 71070512 | Screw Hex Hd Cap 5/16-18 X 3/4 |
| 78 | 17060620 | Screw 3/8-16 x 1-1/4 |
| 81 | 73510400 | Nut Flange 1/4-20 Starter Nut |

NOTE: All component dimensions given in U.S. inches
1 inch = 25.4 mm

REPAIR PARTS

TRACTOR- -MODEL NO. 917.259040

MOWER LIFT

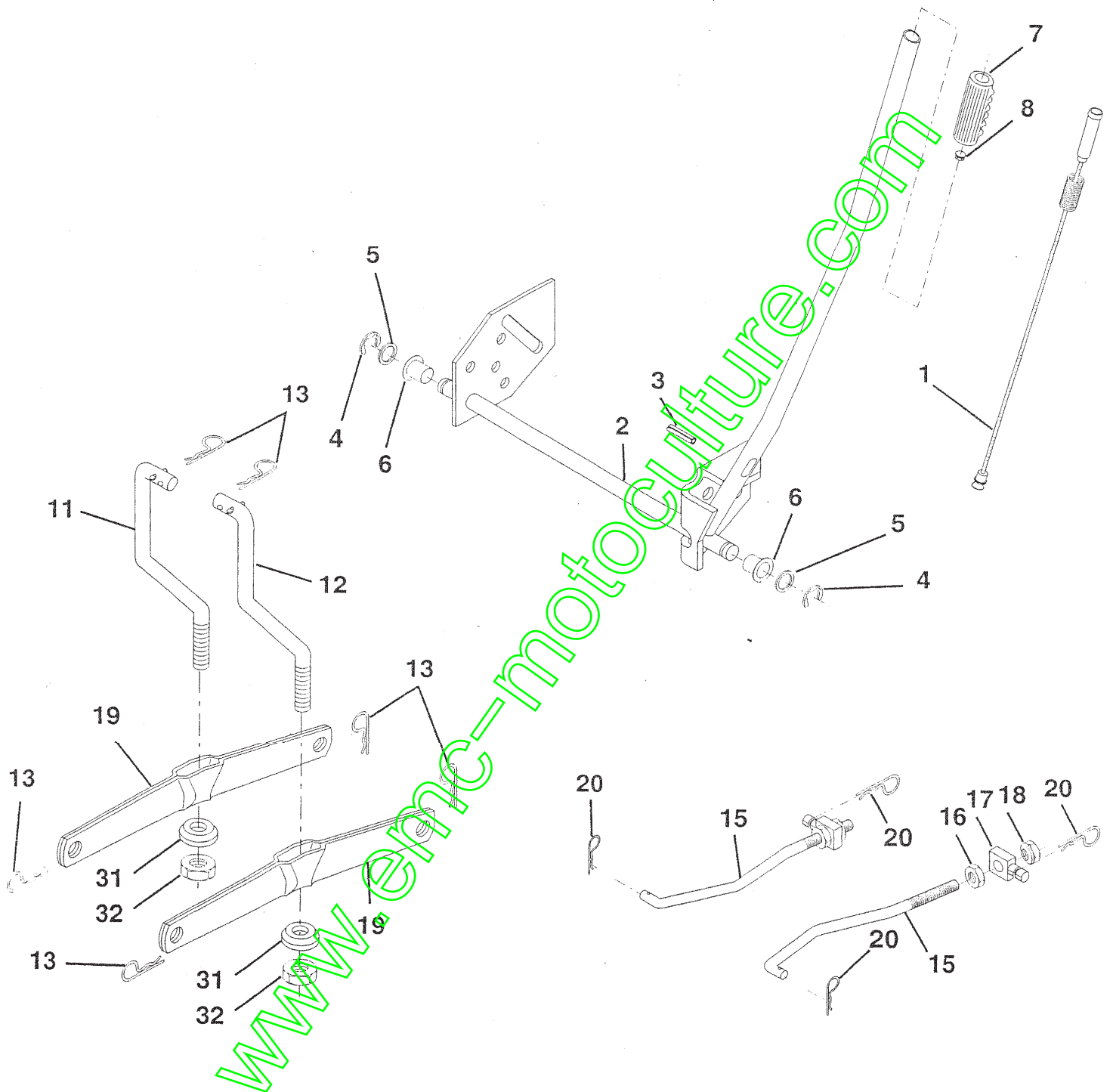

MOWER LIFT

| KEY NO. | PART NO. | DESCRIPTION |
|---------|----------|---|
| 1 | 159460 | Lift Lever Inner Wire Assembly |
| 2 | 159471 | Shaft Assembly, Lift |
| 3 | 105767X | Pin, Groove |
| 4 | 12000002 | E-Ring |
| 5 | 19211621 | Washer 21/32 x 1 x 21 Gauge |
| 6 | 120183X | Bearing, Nylon |
| 7 | 125631X | Grip, Handle, Fluted |
| 8 | 122365X | Button, Plunger, Red |
| 11 | 139865 | Link, Lift, L.H. |
| 12 | 139866 | Link, Lift, R.H. |
| 13 | 4939M | Retainer Spring |
| 15 | 173288 | Link, Front |
| 16 | 73350800 | Nut, Hex, Jam 1/2-13 UNC |
| 17 | 130171 | Trunnion |
| 18 | 73800800 | Locknut, Hex, with Washer Insert 1/2-13 UNC |
| 19 | 139868 | Arm, Suspension, Rear |
| 20 | 163552 | Retainer Spring |
| 31 | 140302 | Bearing, Pvt, Lift Spherical |
| 32 | 73540600 | Nut, Crownlock 3/8-24 |

NOTE: All component dimensions given in U.S. inches
1 inch = 25.4 mm

REPAIR PARTS

TRACTOR- -MODEL NO. 917.259040

MOWER

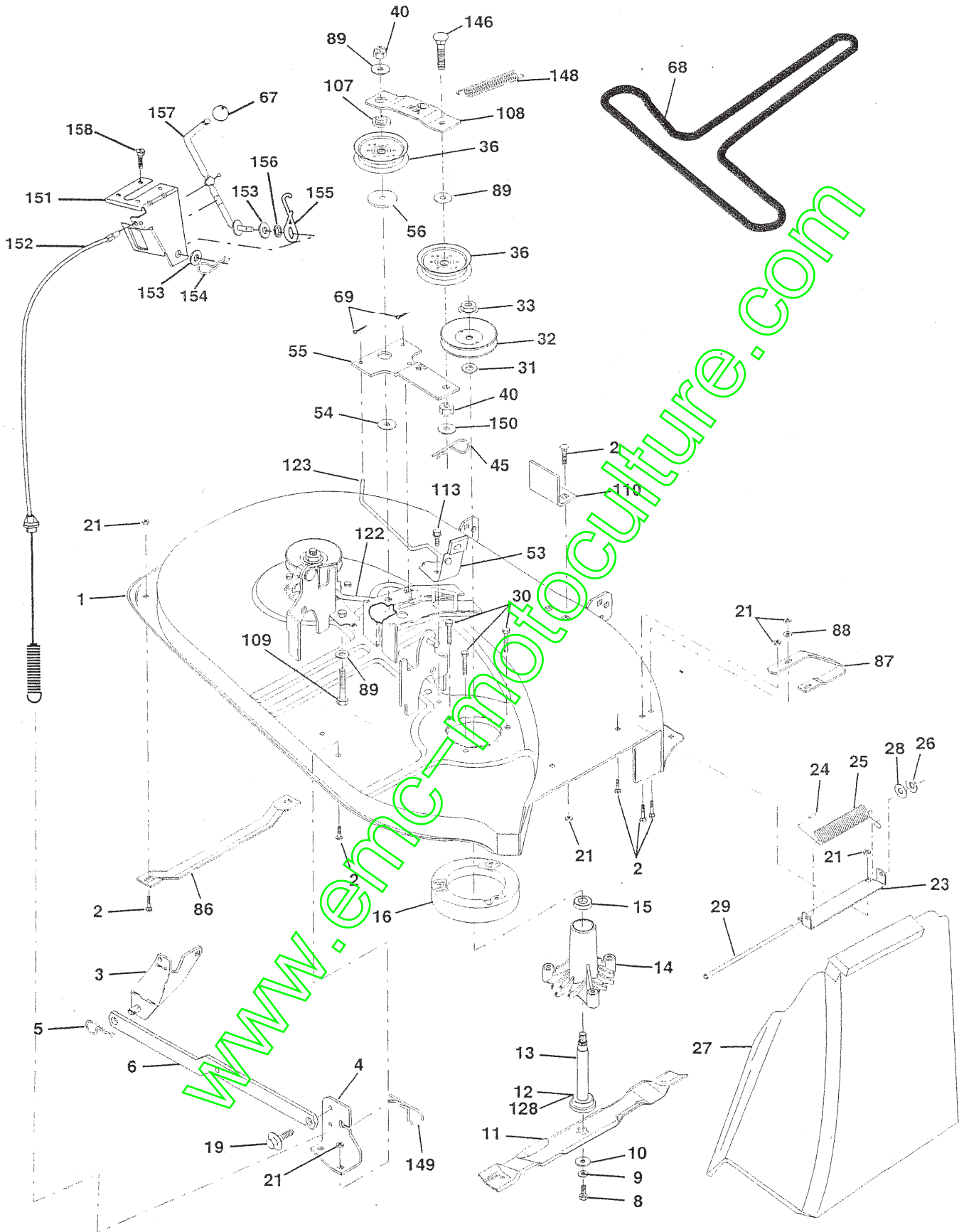

| KEY NO. | PART NO. | DESCRIPTION | KEY NO. | PART NO. | DESCRIPTION |
|---------|------------|---|---------|----------|---|
| 1 | 170280 | Mower Deck Assembly | 67 | 149846 | Knob RD 3/8-16 Plstc Thd |
| 2 | 72140506 | Bolt | 68 | 144200 | Belt |
| 3 | 138017 | Bracket Assembly, Sway Bar | 69 | 76020312 | Pin, Cotter 3/32 x 3/4 |
| 4 | 169970 | Bracket Sway Bar Deck | 86 | 7631J | Runner, LH |
| 5 | 4939M | Retainer Spring | 87 | 128772 | Runner, RH |
| 6 | 130832 | Arm, Suspension, Rear | 88 | 19111216 | Washer 11/32 x 3/4 x 16 Ga |
| 8 | 850857 | Bolt, Hex 3/8-24 x 1.25 Gr. 8 | 89 | 19131612 | Washer 13/32 x 1 x 12 Ga |
| 9 | 10030600 | Washer, Lock Hvy Hlcl 3/8 | 107 | 133502 | Spacer, Retainer |
| 10 | 140296 | Washer, Hardened | 108 | 133503 | Stiffener, Idler Arm |
| 11 | 134148 | Blade, Mower 38 | 109 | 74760640 | Bolt, Hex Head 3/8-16 x 2-1/2 |
| 12 | 129895 | Bearing, Ball | 110 | 142587 | Upstop Deck Front 38 |
| 13 | 137645 | Shaft Assembly, Mandrel, Vented (Includes Key #12) | 113 | 17060512 | Screw 5/16-18 x 3/8 |
| 14 | 128774 | Housing, Mandrel, Vented | 122 | 131289 | Rod, Brake, LH |
| 15 | 110485X | Bearing, Ball, Mandrel | 123 | 169971 | Rod, Brake, RH |
| 16 | 140329 | Stripper, Vented Mower Deck | 128 | 153390 | Washer Felt |
| 19 | 132827 | Bolt, Shoulder | 146 | 165891 | Bolt Carriage Idler |
| 21 | 73680500 | Nut Crownlock 5/16-18 | 148 | 169022 | Spring Return Idler |
| 23 | 137607 | Bracket, Mower Deflector | 149 | 165898 | Retainer Spring Yellow Zinc |
| 24 | 105304X | Cap, Sleeve | 150 | 19091216 | Washer 9/32 x 3/4 x 16 Ga. |
| 25 | 123713X | Spring, Torsion, Deflector | 151 | 169670 | Bracket Clutch |
| 26 | 110452X | Nut, Push | 152 | 172758 | Cable Clutch 38 In |
| 27 | 106736X428 | Shield, Deflector | 153 | 169674 | Washer Flat 3/8" Type B |
| 28 | 19111016 | Washer 11/32 x 5/8 x 16 Ga. | 154 | 169675 | Spring Retainer |
| 29 | 106735X | Rod, Hinge | 155 | 169671 | Spring Retention Lever |
| 30 | 157722 | Screw Thdrol Washer Head | 156 | 169672 | Spacer |
| 31 | 129963 | Washer, Spacer | 157 | 169669 | Rod Clutch |
| 32 | 153532 | Pulley, Mandrel | 158 | 17720410 | Screw Hex Thd Cut 1/4-20x5/8 |
| 33 | 137266 | Nut, Toplock, Flanged | -- | 130794 | Mandrel Assembly (Includes Key Numbers 12-15, 17-19, 31 and 33) |
| 36 | 131494 | Pulley, Idler, Flat | -- | 171665 | Mower Deck, Complete |
| 40 | 73680600 | Nut Crownlock 3/8-16 | | | |
| 45 | 4497H | Retainer, Spring | | | |
| 53 | 130840 | Brake Assembly | | | |
| 54 | 133943 | Washer, Hardened | | | |
| 55 | 133840 | Idler Arm Assembly | | | |
| 56 | 165723 | Spacer, Retainer | | | |

NOTE: All component dimensions given in U.S. inches
1 inch = 25.4 mm

REPAIR PARTS

TRACTOR - - MODEL NUMBER 917.259040

PEERLESS TRANSAXLE MODEL NUMBER -- 205-544C

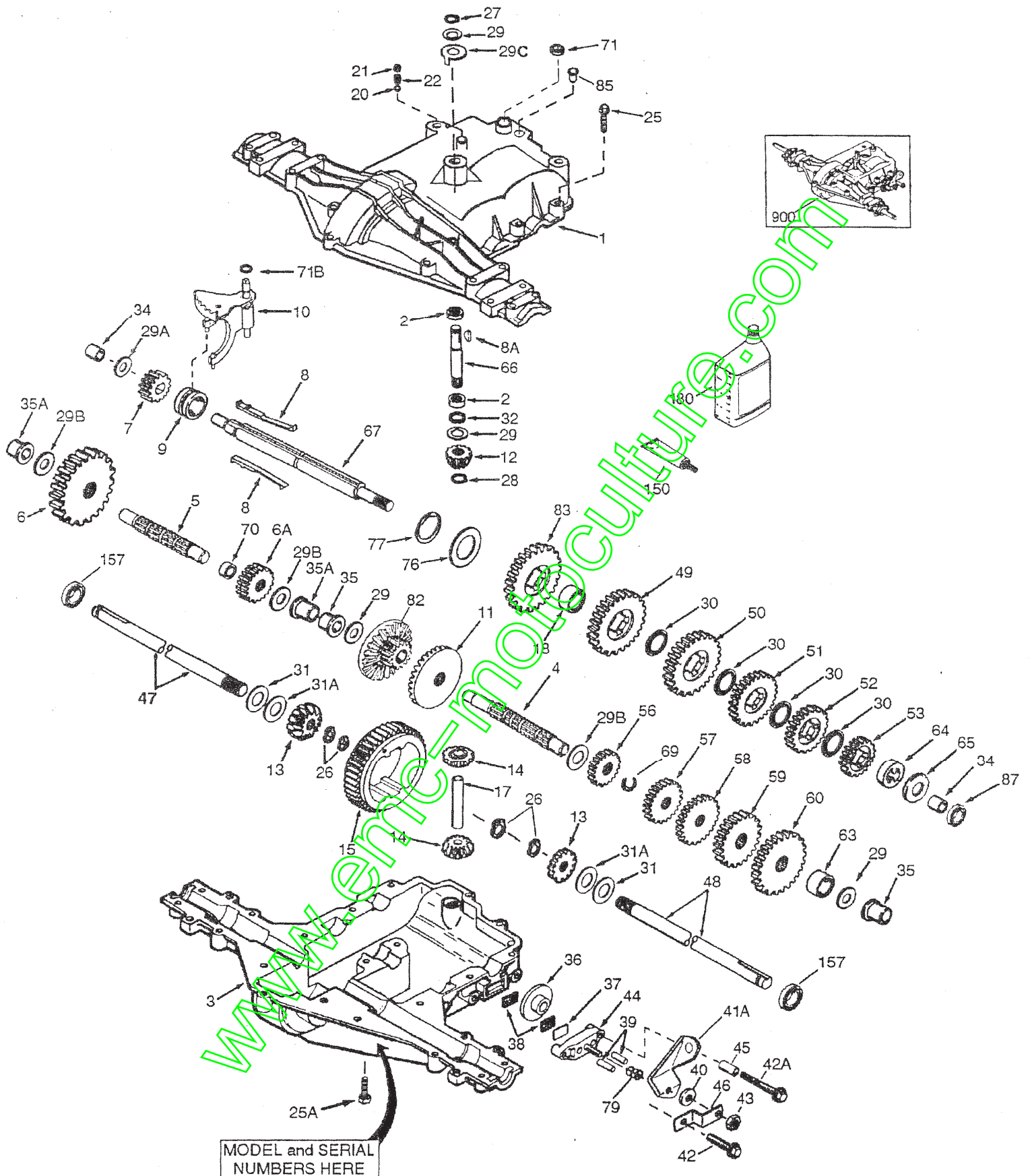

TRACTOR - - MODEL NUMBER 917.259040

PEERLESS TRANSAXLE MODEL NUMBER --.205-544C

| KEY NO. | PART NO. | DESCRIPTION | KEY NO. | PART NO. | DESCRIPTION |
|---------|----------|--|---------|----------|---|
| 1 | 772147 | Transaxle Cover | 39 | 786026 | Dowel Pin |
| 2 | 780086A | Needle Bearing 5 / 8" | 40 | 792076A | Flat Washer .312 ID x .059W |
| 3 | 770128 | Transaxle Case | 41A | 790079 | Brake Lever |
| 4 | 776395 | Countershaft | 42 | 792073A | Screw 1 / 4 - 20 x 1 - 1 / 4" |
| 5 | 776409 | Output Shaft | 42A | 792085A | Screw 1 / 4 - 20 x 2 - 1 / 4" |
| 6 | 778364 | Spur Gear (38 teeth) | 43 | 792075 | Locknut 5 / 16 - 24 |
| 6A | 778369 | Spur Gear (15 teeth) | 44 | 790025 | Brake Pad Holder |
| 7 | 778330 | Spur Gear (11 teeth) | 45 | 786066 | Spacer .2625 x 1.0 |
| 8 | 792180 | Shift Key | 46 | 786086 | Brake Lever Bracket |
| 8A | 792047 | Woodruff Key #9 | 47 | 774690 | Axle (16 - 15 / 16 " long) |
| 9 | 784352 | Shift Collar | 48 | 774691 | Axle (16 - 1 / 2" long) |
| 10 | 784378 | Shift Rod & Fork | 49 | 778356 | Spur Gear (29 teeth) |
| 11 | 778334 | Bevel Gear (30 teeth) | 50 | 778354 | Spur Gear (23 teeth) |
| 12 | 778309 | Input Bevel Pinion (13 teeth) | 51 | 778352 | Spur Gear (19 teeth) |
| 13 | 778368 | Bevel Gear (13 teeth) (Include. 14) | 52 | 778350 | Spur Gear (16 teeth) |
| 14 | 778368 | Bevel Pinion (13 teeth) (Include 13) | 53 | 778346 | Spur Gear (15 teeth) |
| 15 | 778370 | Ring Gear (43 teeth) | 53 | 778346 | Spur Gear (15 teeth - steel) |
| 17 | 786188 | Drive Pin | 56 | 778355 | Spur Gear (11 teeth) |
| 18 | 786102 | Spacer 1.130 x .695 | 57 | 778353 | Spur Gear (17 teeth) |
| 20 | 792077A | Ball 5 / 6" dia | 58 | 778351 | Spur Gear (21 teeth) |
| 21 | 792078 | Set Screw 3 / 8-16 x 3 / 8" | 59 | 778349 | Spur Gear (24 teeth) |
| 22 | 792079 | Spring .310 OD x .625 L | 60 | 778345 | Spur Gear (25 teeth) |
| 25 | 792073A | Screw 1/4 - 20 x 1-1 / 4" | 63 | 786071 | Countershaft Spacer 1 - 1 / 8" x 3 / 8" |
| 25A | 792177 | Screw 1 / 4 - 20 x 1 - 3 / 8" | 64 | 786072 | Brake Shaft Spacer 1 - 3 / 8" x 3 / 8" |
| 26 | 792125 | Retaining Ring (pkg of 2) | 65 | 780189 | Flat Washer .563 ID x .062W |
| 27 | 792035 | Retaining Ring | 66 | 776422 | Input shaft |
| 28 | 788040 | Retaining Ring | 67 | 776396 | Shifter & Brake shaft |
| 29 | 780072 | Thrust Washer .627 ID x .031W | 69 | 792170 | Retaining Ring |
| 29A | 780160 | Thrust Washer .563 ID x .031W | 70 | 786187 | Spacer .890 |
| 29B | 780051 | Thrust Washer .762 ID x .031W | 71 | 788069 | Square Cut Ring |
| 29C | 780199 | Anti -Rotation Washer .632 | 71B | 788092 | "O" Ring |
| 30 | 780108 | Cup Washer 1.127 ID x .032W | 76 | 780090 | Flat Washer 1.128 ID x .058W |
| 31 | 780001 | Flat Washer .750 ID x .056 (Use as Needed) | 77 | 788078A | Inverted Retaining Ring |
| 31A | 780195 | Flat Washer .750 ID x .062W | 79 | 792144 | Spring .430 OD x .5000 L |
| 32 | 788083 | Oil Seal 5 / 8" | 82 | 778333 | Bevel & Spur Gear (30 & 13 teeth) |
| 34 | 780194 | Bushing .563 | 83 | 778338 | Spur Gear (27 teeth) |
| 35 | 780193 | Flanged Bushing 5 / 8" ID | 85 | 792154 | Oil Fill Plug |
| 35A | 780197 | Flanged Bushing .751 | 87 | 788089A | Oil Seal 9 / 16" |
| 36 | 790075 | Brake Disk | 150 | 788093A | Liquid Gasket RTV Silicone |
| 37 | 790007 | Brake Pad Plate | 157 | 788088A | Oil Seal 3 / 4" |
| 38 | 799021 | Brake Pad (pkg of 2) | 180 | 730229A | Gear Oil 80W90 |
| | | | 900 | 794711 | Replacement MST-205-544C Transaxle |

NOTE: All component dimensions given in U.S. inches
1 inch = 25.4 mm

www.emc-motocycle.com