

REPAIR PARTS MANUAL
MODEL NO. 259461
Lawn Tractor

CRAFTSMAN®

HOW TO USE THIS MANUAL

This manual is designed to provide the customer with a means to identify the parts on his/her tractor when ordering repair parts. The illustrations may or may not represent the actual assemblies; therefore, it is not recommended to use this manual as a guide to assemble or disassemble the tractor. Some hardware and parts are drawn larger in order to more readily identify them.

Each tractor has its own model number.

The model number for your tractor can be found on the fender under the seat.

When ordering parts, always give the following information:

- Product - "Tractor"
- Model Number - "259461"
- Part Number
- Part Description

TABLE OF CONTENTS

SCHEMATIC.....	3
ELECTRICAL.....	4-5
CHASSIS.....	6-7
DRIVE.....	8-9
STEERING.....	10-11
SEAT.....	12
DECALS.....	13
ENGINE.....	14-15
MOWER LIFT.....	16-17
MOWER DECK.....	18-19
BAGGER.....	20-21
TRANSAXLE.....	22-23
ENGINE BREAKDOWN.....	24-28

SCHEMATIC

TRACTOR- -MODEL NO. 917. 259461

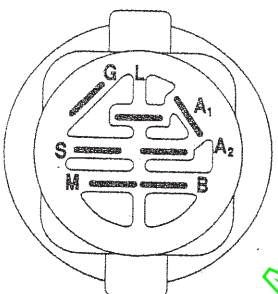
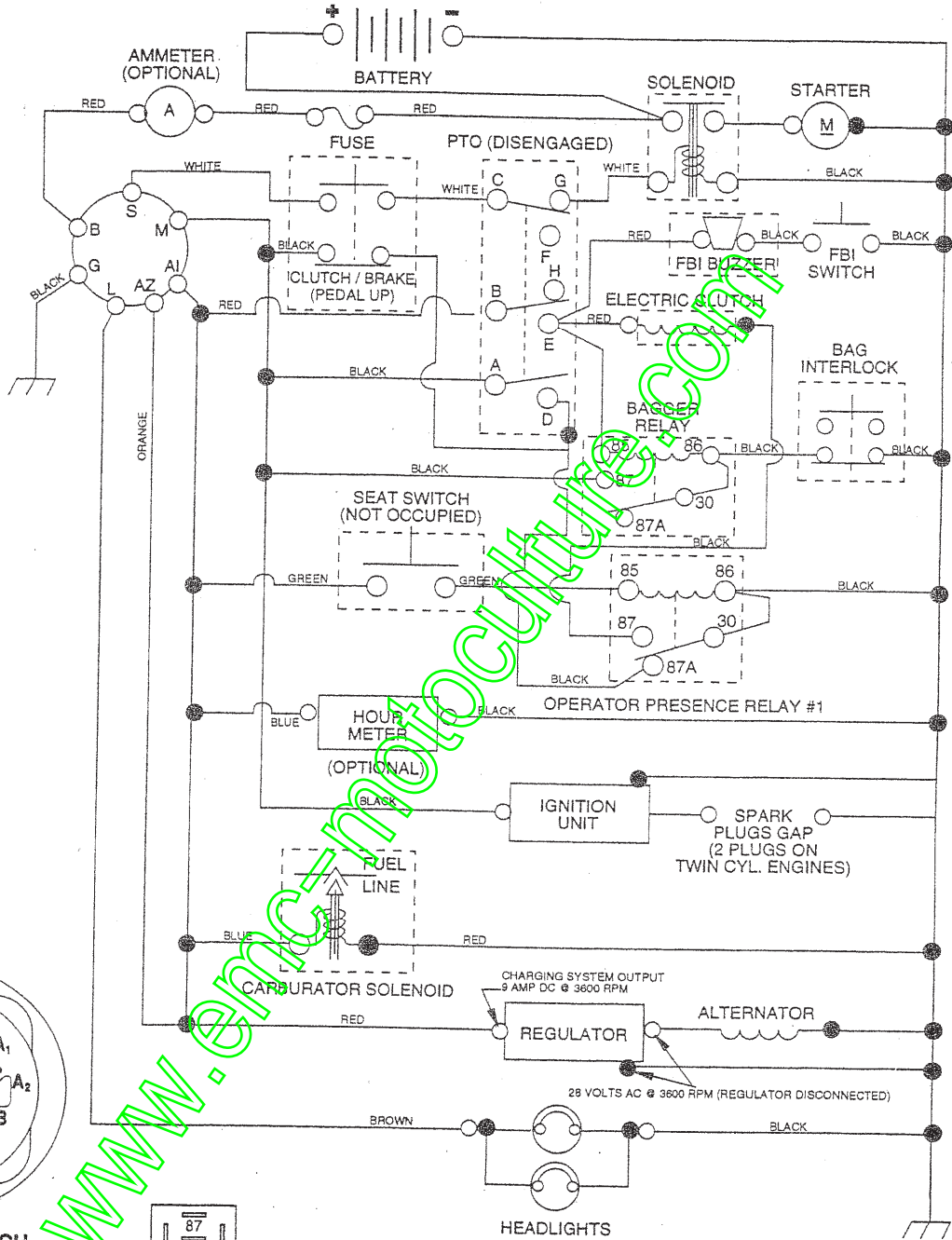

IGNITION SWITCH

POSITION	CIRCUIT	"MAKE"
OFF	M+G+A1	NONE
RUN/LIGHT	B+A1	A2+L
RUN	B+A1	NONE
START	B + S + A1	NONE

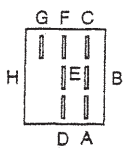
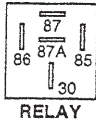

POSITION	CIRCUIT
OFF	C + G, B + H
ON	C + F, B + E, A + D

NON-REMOVABLE CONNECTIONS

REMOVABLE CONNECTIONS

WIRING INSULATED CLIPS
 NOTE: IF WIRING INSULATED CLIPS WERE REMOVED FOR SERVICING OF UNIT, THEY SHOULD BE REPLACED TO PROPERLY SECURE YOUR WIRING.

REPAIR PARTS

TRACTOR- -MODEL NO. 917. 259461

ELECTRICAL

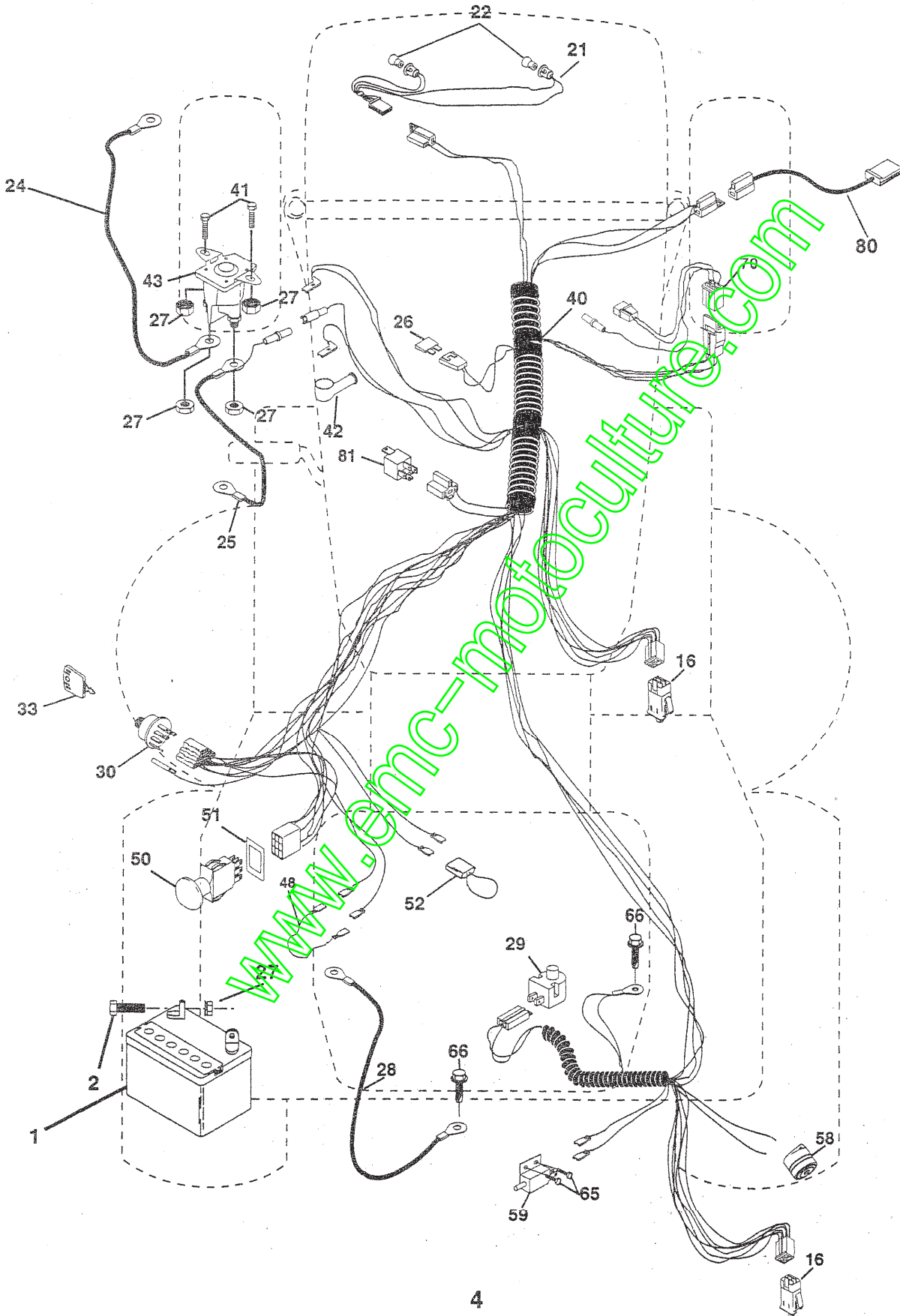

REPAIR PARTS

TRACTOR- -MODEL NO. 917. 259461

ELECTRICAL

KEY NO.	PART NO.	DESCRIPTION
1	144925	Battery 12 Volt 25 AMP Wet
2	74760412	Bolt Hex Hd 1/4-20 Unc X 3/4
16	153664	Switch Interlock Push-In
21	166182	Harness Asm Light W/4152J
22	4152J	Bulb Light #1156
24	4799J	Cable Starter 6Ga 11" Red
25	165987	Cable Battery Crd 56" Red
26	166180	Fuse 15 Amp
27	73510400	Nut Keps Hex 1/4-20 Unc
28	127725X	Cable Ground 6Ga 18" Black
29	160784	Switch Plunger Normal Op Olive
30	163968	Switch Ignition
33	109310X	Key Ign
40	170214	Harness Ign Crd Elect
41	71110408	Bolt Flk Fin Hex 1/4-20 Unc X 1/2
42	131563	Cover Terminal Red
43	145673	Solenoid
48	140844	Adapter Ammeter Rectangular
50	169416	Switch PTO 3PDT Red Delta
51	140405	Ring Retainer PTO
52	141940	Protection Wire Loop
58	169419	Buzzer Crd
59	166299	Switch FBI CRD
65	17211008	Screw Slftp #10-16 x 1/2 Ty-Ab
66	17490608	Screw Thdrol 3/8-16 x 1/2 Ty-Tt
70	170247	Harness Engine B&S Reg W/AFTS0
80	146685	Harness Clutch EVX
81	109748X	Relay Asm

NOTE: All component dimensions given in U.S. inches.
1 inch = 25.4 mm.

REPAIR PARTS

TRACTOR- -MODEL NO. 917.259461

CHASSIS AND ENCLOSURES

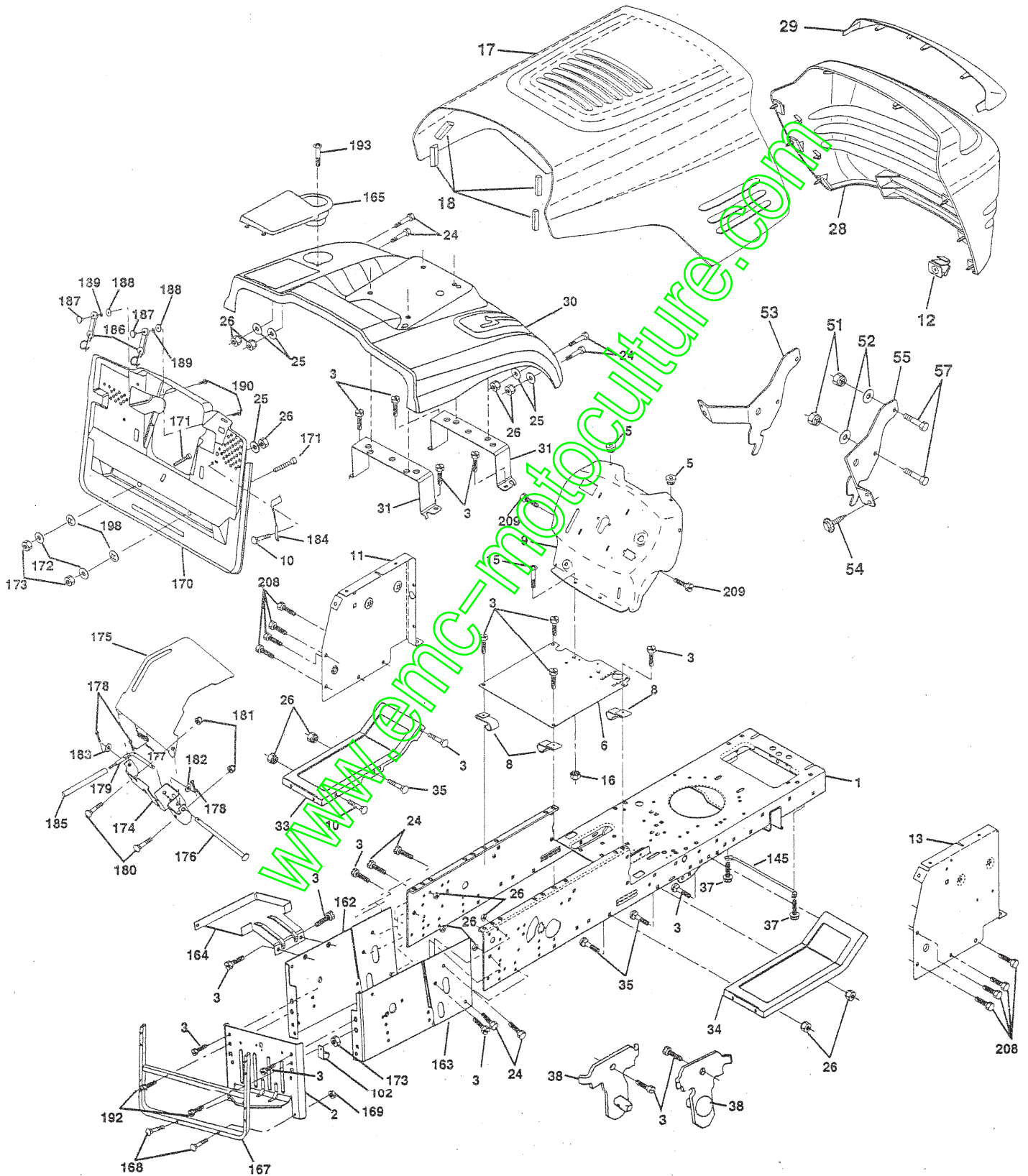

REPAIR PARTS

TRACTOR- -MODEL NO. 917.259461

CHASSIS AND ENCLOSURES

KEY NO.	PART NO.	DESCRIPTION	KEY NO.	PART NO.	DESCRIPTION
1	169831	Chassis	162	165672	Bracket Exten Chassis Lh CRD
2	165606	Drawbar	163	165673	Bracket Exten Chassis Rh CRD
3	17060612	Screw 3/8-16 x 3/4	164	165605	Support Battery CRD
5	155272	BumperHood/Dash	165	165742X428	Cover Battery CRD Lt
6	155923	Saddle	167	165779	Support Asm. Backplate WLDMNT
8	126471X	Clip Insulator 13/32 Mtg. Hole	168	72050412	Bolt, RDHD SHT NK 1/4-20 x 1-1/2
9	168350X011	Dash	169	123976X	Nut, Lock 1/4 LGE FLG Gr. 5 Zinc
10	72140608	Bolt, Carriage 3/8-16 x 3/4	171	74520640	Bolt Hex 3/8-16 x 2-1/2 Gr 5
11	155927	Panel, Dash, L.H.	170	165607	Cover, Backplate Plastic Black
12	145660	Clip, Tinnerman Grille P/L	172	19132016	Washer 13/32 x 1-1/4 x 16 Ga.
13	169118	Panel, Asm. Dash R.H.	173	73510600	Nut, Keps Hex 3/8-16 UNC
15	74180512	Screw, Machine, Truss Head 5/16-18 UNC x 3/4	174	165939	Bracket Switch FBI CRD
16	73510500	Nut	175	166612	Guard Door Rear CRD
17	1449891558	Hood Assembly	176	128600	Pin Hinge Pivot
18	126938	BumperHood	177	192795	Spring Bagger Top LH Black
24	74780616	Bolt	178	76020312	Pin Cotter 3/32 x 3/4 Cad Zinc
25	19131312	Washer 13/32 x 13/16 x 12 Gauge	179	165942	Rod Pivot FBI CRD
26	73800600	Nut	180	74760516	Bolt Hex HD 5/16-18 UNC x 1
28	1662711558	Grille PL	181	73680500	Nut Crownlock 5/16-18
29	1552171599	Lens, Grille	182	138200	Washer .385 x .625 x 11 Ga.
30	1657131558	Fender	183	19131316	Washer 13/32 x 13/16 x 16 Ga.
31	165156	Bracket, Fender Support	184	166139	Bracket Actuator Bagger CRD
33	1452441558	Footrest, L.H.	185	165940	Tube Lever Switch FBI CRD
34	1452431558	Footrest, R.H.	186	160793	Latch Asm Mulch/Bagger
35	72110605	Bolt	187	2029J	Nut Weld .327/.304 #10-24
37	17490506	Screw Thdrol 5/16-18 x 1/2 TYT	188	19061216	Washer #10
38	169834	Bracket Asm Pivot Mower Rear	189	10071000	Washer Lock #10
51	73800400	Nut Lock w/Insert 1/4-20 UNC	190	71161010	Screw Truss Hd Phil 10-24 x 5/8
52	19091416	Washer 9/32 x 7/8 x 16 Ga.	193	17070412	Screw Truss 1/4-20 x 3/4
53	145201	Bracket, Grille LH	192	17490624	Screw Thdrol 3/8-16 x 1-1/2
54	161464	Screw Hex WSHD 8-18 x 7/8	198	168937	Nut, Push
55	145202	Bracket, Grille RH	208	17670608	Screw Thdrol 3/8-16 x 1/2
57	74780412	Bolt, Fin Hex 1/4-20 UNC x .75	209	17000612	Screw Hex Wsh Thdrol 3/8-16
102	2751R	Clip line Fule 13/32 Mtg Hole	--	5479J	Plug, Button
145	156524	Rod Pivot Chassis/Hood			

NOTE: All component dimensions given in U.S. inches.
1 inch = 25.4 mm.

REPAIR PARTS

TRACTOR- -MODEL NO. 917.259461

DRIVE

KEY NO.	PART NO.	DESCRIPTION	KEY NO.	PART NO.	DESCRIPTION
1	-----	Transaxle Hydro Gear 331-0650 (See transaxle breakdown)	81	165585	Asm, Shaft
3	143995	Pulley Hydro 0650 Lt/CRD	82	123782X	Spring, Torsion
8	165619	Rod, Shift Fender Adjust Lt	83	19171216	Washer 17/32 x 3/4 x 16 Ga.
9	167162	Clutch Ele EVX 80 W/Hard Brake	84	165629	Link, Transaxle
10	76020416	Pin, Cotter 1/8 x 1	94	140462	Fan 7"
14	10040400	Washer, Lock Hvy Helical	95	165935	Control Asm Bypass Hydro
16	73800500	Nut, Lock Hex w/Ins 5/16-18 UNC	96	4497H	Spring, Retainer 1"
18	74780616	Bolt Hex 3/8-16 UNC x 1 Gr.5	102	141322	Washer, Bellville .50ID x 1.50D
20	150280	Bolt, Hex 7/16-20 x 4-1/4 5 Ga 1.38	103	73940800	Nut, Hex Jam Toplock 1/2-20 UNF
21	130564	Knob Deluxe 1/2-13 UNC	104	140156	Arm, Control Hydro
22	165688	Rod, Brake CRD 0650	105	71070516	Screw Cap Hex 5/16 x 18 Unc-1
23	171258	Bracket asm Anti-Rust Evx	144	19111016	Washer 11/32 x 5/8 x 16 Ga
24	73350600	Nut	145	74490549	Bolt Hex FGHD 5/16-18 x Gr 5
25	106888X	Spring, Rod, Brake	146	74490536	Bolt Hex FLGHD 5/16-18 x 2-1/4
26	19131316	Washer 13/32 x 13/16 x 16 Ga.	147	74490524	Bolt Hex FLGHD 5/16-18 x 1-1/2
27	76020412	Pin, Cotter 1/8 x 3/4	150	165850	Bushing, Bellcrank Grnd Dr
28	145204	Rod, Parking Brake	151	19133210	Washer 13/32 x 2 x 10 Ga.
29	71673	Cap, Parking Brake	153	74760516	Bolt Hex Hd 5/16-18 Unc x 1
30	130807	Bracket, Mfg. Transaxle	156	166002	Washer Srted 5/16ID x 1.125
32	74760512	Bolt Hex 5/16-18 UNC x 3/4	157	153236	Bolt Shoulder 5/16-18 Unc 2A
33	72140506	Bolt Rdhd Sqnk 5/16-18 Unc x 3/4	158	165589	Bracket Shift Mount
34	165496	Shaft, Asm Pedal Foot CRD	159	165494	Hub Tapered Flange Shift Lt
35	120183X	Bearing, Nylon	160	19292016	Washer 29/32 x 1-1/4 x 16 Ga.
36	19211616	Washer 21/32 x 1 x 16 Ga.	161	72140406	Bolt Rdhd Sqnk 1/4-20 x 3/4 Gr 5
37	1572H	Pin, Roll 3/16 x 1"	162	73680400	Nut Crownlock 1/4-20 Unc
38	165936	Pulley Flat Composite 3.06"	163	74780416	Bolt Hex Fin 1/4-20 Unc x 1 Gr 5
39	72110622	Bolt Rdhd 3/8-16 x 2-3/4 Gr 5	164	19091010	Washer 5/8 x .281 x 10 Ga.
40	4470J	Spacer, Split 395 x 59 Bzp	165	165623	Bracket Pivot Lever
42	19131312	Washer 13/32 x 13/16 x 12 Ga.	166	166880	Screw 5/16-18 x 5/8
47	127783	Pulley, Idler, V Groove Plastic	167	165588	Bracket Support Shift CRD
48	154407	Bellcrank Clutch Grnd Dr	168	165492	Bolt Shoulder 5/16-18 x .561
49	123205X	Retainer, Belt Style Spring	169	165580	Plate Fastening Lt
50	74760624	Bolt Hex Hd 3/8-16 UNC x 1-1/2	171	17490608	Screw Thdrol 3/8-16 x 1/2 Ty-Tt
51	73680600	Nut, Crownlock 3/8-16 UNC	172	165587	Shaft Asm Shifter Frt CRD 0650
52	73680500	Nut Crownlock 5/16-18	173	165934	Bracket Hydro Bypass CRD
53	105710X	Link, Clutch 7.66	174	10090400	Washer Lock 1/4
55	105709X	Spring, Return Clutch	175	165931	Spring Bypass CRD
56	74760620	Bolt, Hex 3/8-16 UNC x 1-1/4	176	19070816	Washer 7/32 x 1/2 x 16 Ga.
57	165632	V-Belt Key 112 0650 CRD	177	165932	Keeper Flat Idler 3.06" CRD
61	17060612	Screw, 3/8-16 x 3/4	178	165933	Keeper Belt Idler 1.88" CRD
62	8883R	Cover, Pedal	179	120958X	Washer Sintered
63	145868	Pulley, Clutch elect EVX 1"	180	165630	Pulley, Idler, Flat 1.88" CRD
65	10040700	Washer	181	165797	Bracket Idler Ground Drive CRD
66	154778	Keeper, Belt Engine F-Proof	182	165634	Keeper Belt 2.5" Od V-Idler CRD
71	140158	Strap, Torque, Lh	183	165626	Pulley V-Idler 2.50" Od CRD
73	156347	Strap, Torque, Rh	184	17490644	Screw Hexwsh Thdrol 3/8-16 x 2-3/4
74	121199X	Spacer, Split	185	165541	Link Shift CRD Hydro 0650
75	121749X	Washer 25/32 x 1-1/4 x 16 Ga.	186	165614	Hub Tapered Round CRD
76	12000001	Ring, E	187	17490620	Screw Thdrol 3/8-16 x 1-1/4 TT
77	123583X	Key, Square	188	110436X	Bushing Snap Split
78	121748X	Washer 25/32 x 1-5/8 x 16 Ga.	202	72110612	Bolt Carr Sh 3/8-16 x 1-1/2 Gr 5

NOTE: All component dimensions given in U.S. inches
1 inch = 25.4 mm

REPAIR PARTS

TRACTOR- -MODEL NO. 917.259461

STEERING ASSEMBLY

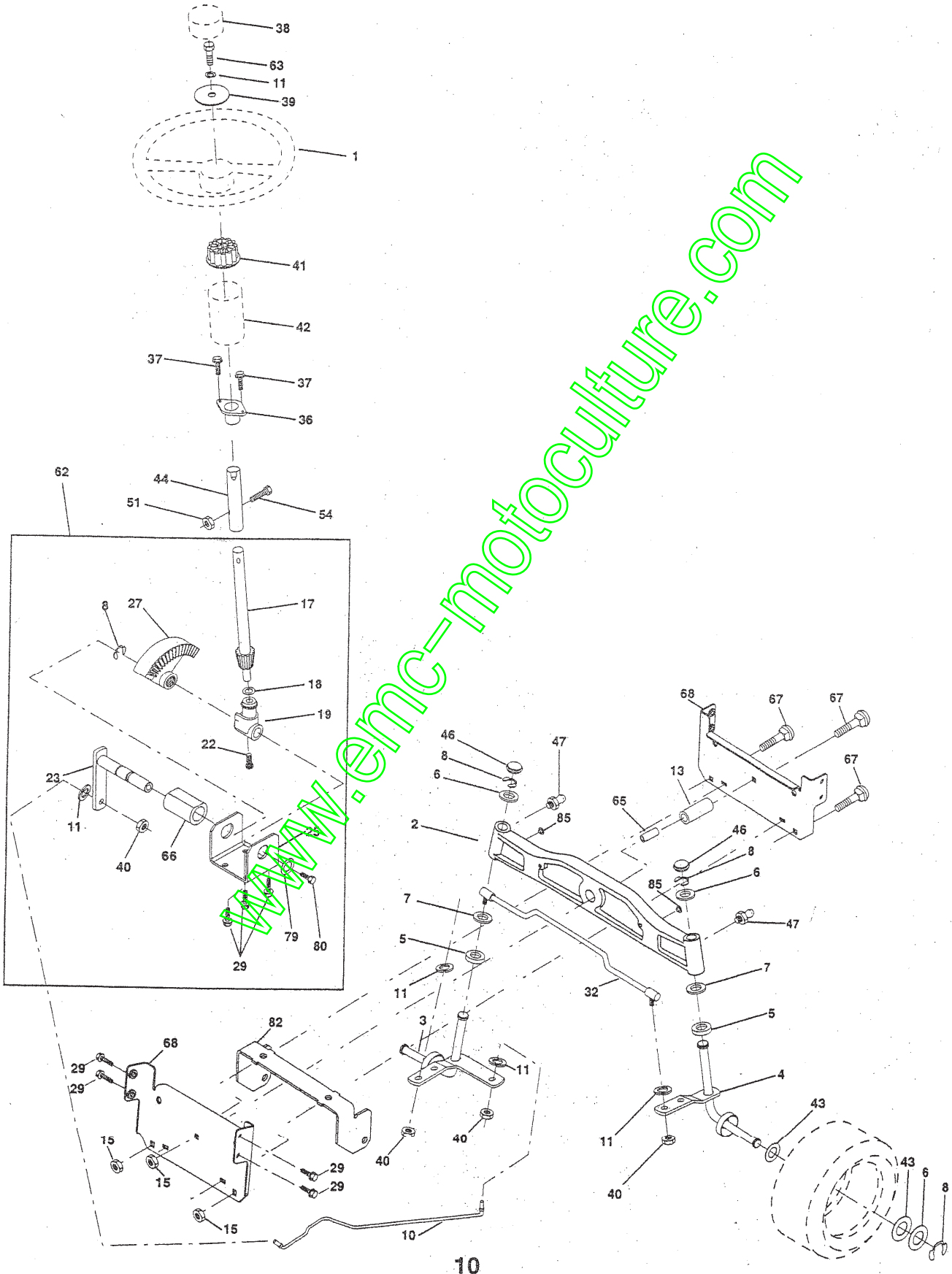

www.enc-motoculture.com

REPAIR PARTS

TRACTOR- -MODEL NO. 917.259461

STEERING ASSEMBLY

KEY NO.	PART NO.	DESCRIPTION
1	139768	Steering Wheel
2	165854	Axle Cast Lt Machined
3	169840	Spindle Assembly, L.H.
4	169839	Spindle Assembly, R.H.
5	6266H	Bearing, Race, Thrust, Hardened
6	121748X	Washer 25/32 x 1-5/8 x 16 Gauge
7	19272016	Washer 27/32 x 1-1/4 x 16 Gauge
8	12000029	Ring, Klip
10	169832	Link, Drag
11	10040600	Washer, Lock
13	136518	Spacer Brg Axle Front
15	145212	Nut, Hex Flange Lock
17	156546	Shaft Assembly, Steering
18	57079	Washer, Thrust .515 x .750 x .033
19	160395	Support, Shaft
22	165857	Screw Hex Wshhd Torx
23	165851	Pittman Shaft Assembly
25	154406	Bracket, Steering
27	136874	Gear, Sector
29	17060612	Screw, 3/8-16 x 3/4
32	170162	Rod, Tie
36	155099	Bushing, Steering
37	152927	Screw, J.T. #10-32 x 5 x 3/8 Flange
38	139769	Cap Wheel Steering
39	19133812	Washer 13/32 x 2-3/8 x 12 Gauge
40	7810H	Nut Lock Center 3/8-24 Unf
41	100711L	Adaptor, Steering Wheel
42	145054X428	Boot, Steering Dash P/L Mtl
43	121749X	Washer 25/32 x 1-1/4 x 16 Gauge
44	153720	Extension Steering Non-Adjust
46	121232X	Cap, Spindle
47	6855M	Fitting, Grease
51	73800500	Nut Lock Hx W/Ins 5/16-18 UNC
54	74780520	Bolt Fin Hex 5/16-18 UNC x 1-1/4
62	167962	Kit, Steering Assembly, Service
63	74780516	Bolt Fin Hex 3/8-16 unc. x 1 Gr. 5
65	160367	Spacer Brace Axle
66	154404	Bearing Arm Pittman
67	22110618	Bolt Rdhd Sqnk 3/8-16 x 2-1/4
68	169827	Brace Axle
79	19132012	Washer 13/32 x 1-1/4 x 12 Ga
80	74950612	Bolt Hex Nylon 3/8-16 x 3/4
82	169635	Bracket Susp Chassis Front
85	133835	Fastner Christmas Tree

NOTE: All component dimensions given in U.S. inches.
1 inch = 25.4 mm.

REPAIR PARTS

TRACTOR- -MODEL NO. 917.259461

EAT ASSEMBLY

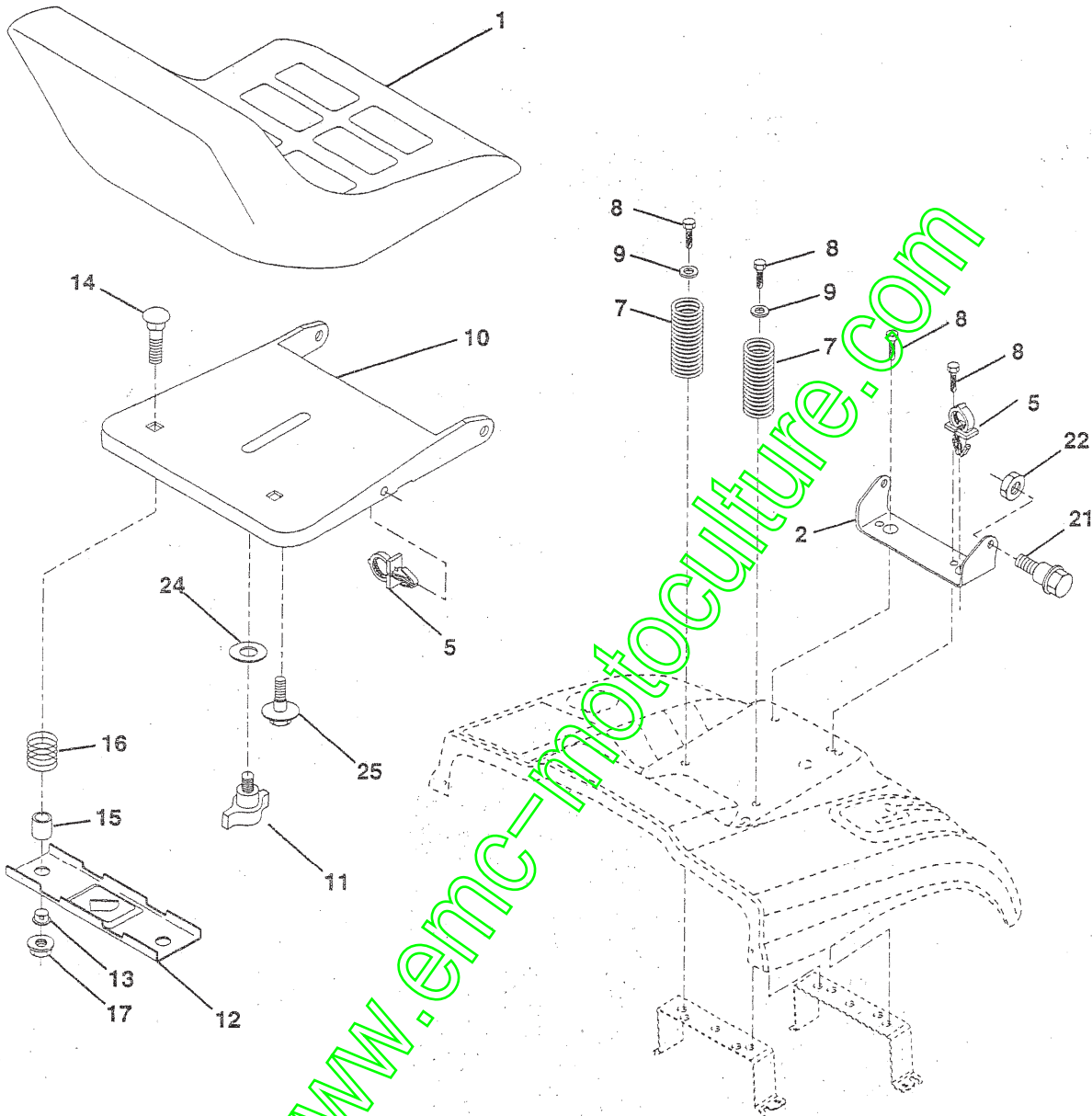

KEY NO.	PART NO.	DESCRIPTION
1	140123	Seat
2	140551	Bracket Pnt Pivot Seat (blk)
3	145006	Clip Push In Hinged
4	124181X	Spring Seat Cprsn 2 250 Blk Zi
5	17000616	Screw 3/8-16 X 1-1/2
6	19131614	Washer 13/32 X 1 X 14 Ga
7	155925	Pan Pnt Seat (blk)
8	166369	Knob Seat Adj Wingnut
9	121246X	Bracket Pnt Mounting Switch
10	121248X	Bushing Snap Blk Nyl 50 Id

KEY NO.	PART NO.	DESCRIPTION
14	72050412	Bolt Rdhd Sht Nk 1/4-20x1-1/2
15	134300	Spacer Split .28 X .96 Zinc
16	121250X	Spring Cprsn
17	123976X	Nut Lock 1/4 Lge Flg Gr 5 Zinc
21	171852	Bolt Shoulder 5/16-18 Unc-2A
22	73800500	Nut Hex Lock w/Ins 5/16-18
24	19171912	Washer 17/32 X 1-3/16 X 12 Ga.
25	127018X	Bolt Shoulder 5/16-18 X 62

NOTE: All component dimensions given in U.S. inches.
1 inch = 25.4 mm

REPAIR PARTS

TRACTOR- -MODEL NO. 917.259461

DECALS

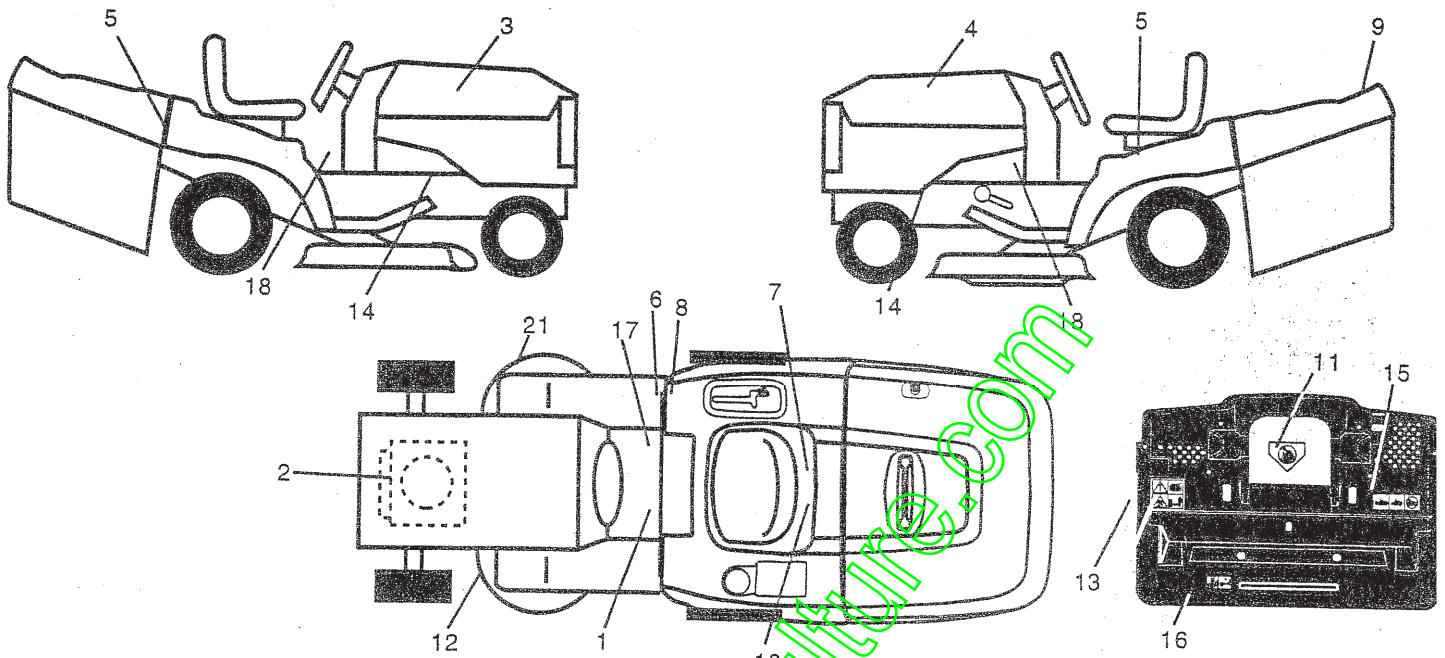

KEY NO.	PART NO.	DESCRIPTION	KEY NO.	PART NO.	DESCRIPTION
1	145498	Decal Read Owner's Manual Sym	12	159737	Decal Brake/Clutch Symbol Lt
2	165404	Decal Hp Engine	13	166959	Decal Warn Back Plate CRD
3	171696	Decal Hood Rh	14	159736	Decal Chassis Hot Muffler
4	171697	Decal Hood Lh	15	166961	Decal Oper Bag Presence CRD
5	168322	Decal Fender Auto	16	162598	Decal Drawbar Load Limit
6	126187X	Decal 100 DBA	17	140837	Decal Saddle Brake Parking
7	166960	Decal Bypass Fender	18	163252	Decal, Dash Panel
8	145437	Decal Europe Stand Ce	21	166286	Decal Deck Sch 92 CRD
9	163204	Decal Fender	--	138311	Decal Lift Handle
10	145005	Decal Bat Dan/Poi P/L Sym Wpn	--	157199X428	Pad, Footrest
11	145494	Decal Mower Cut Finger Symbol	--	172046	Manual Operator's (Euro)
			--	172047	Manual Operator's (Scand)
			--	172048	Manual Parts

WHEELS & TIRES

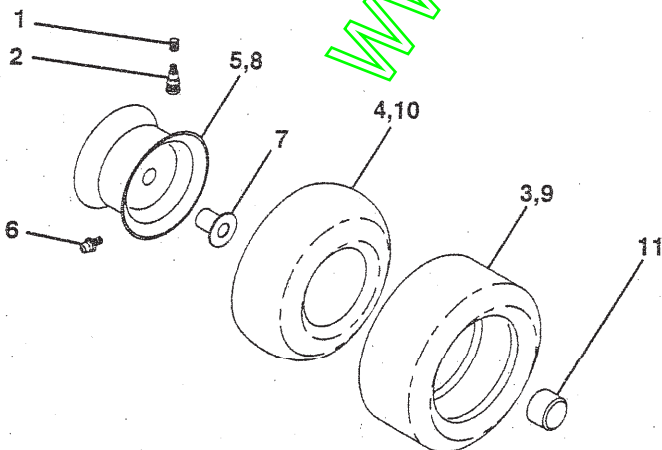

KEY NO.	PART NO.	DESCRIPTION
1	59192	Cap Valve Tire
2	65139	Stem Valve
3	106222X	Tire F Ts 15 X 6 0 - 6 Service
4	59904	Tube Inner Front #35060
5	106732X427	Rim Asm 6" front White Service
6	278H	Fitting Grease
7	9040H	Bearing Flange
8	106108X427	Rim Asm 8" rear White Service
9	138468	Tire R Ts 20 x 8-8 Service
10	7152J	Tube Rear 9 5 X 8 Service
11	104757X	Cap Axle Blk 1 50 X 1 00
--	144334	Sealant, Tire (10 oz. tube)

NOTE: All component dimensions given in U.S. inches
1 inch = 25.4 mm

REPAIR PARTS

TRACTOR- -MODEL NO. 917.259461

ENGINE

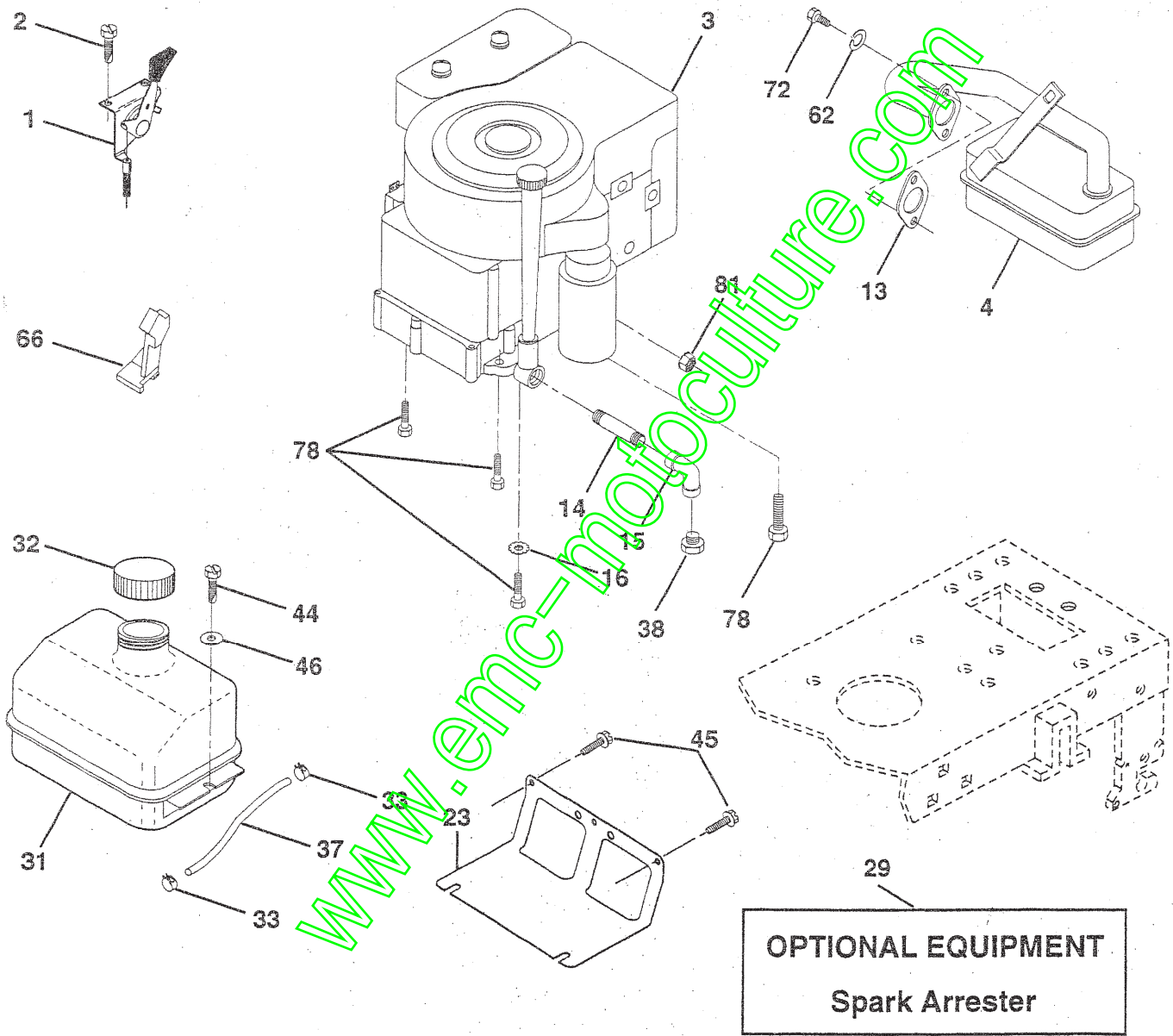

REPAIR PARTS

TRACTOR- -MODEL NO. 917.259461

ENGINE

KEY NO.	PART NO.	DESCRIPTION
1	162158	Control Throt/Ch Lh
2	17720410	Screw Hex Thd Cut 1/4-20x5/8 T
3	-----	Engine (See Breakdown)
		Briggs Model 28U707-1175-E1
4	137352	Muffler Exhaust B&S Lt
13	165291	Gasket 1 313 Id Tin Plated
14	13280324	Nipple Pipe 3/8 Npt X 3"
15	13200300	Elbow Std 90 Degree 3/8-18 Npt
16	11050600	Washer Lock Ext Tooth 3/8
23	169837	Shield Browning/Debris Guard
29	137180	Arrestor Spark
31	109202X	Tank Fuel 1.25 Fr
32	158990	Cap Asm Fuel
33	123487X	Clamp Hose Blk
37	137040	Line Fuel 20"
38	-----	Plug Oil Drain (See engine breakdown)
44	17490412	Screw Hex wsh Thdrol 1/4-20x3/4
45	170606012	Srew 3/8-16 x 3/4
46	19091416	Washer 9/32 X 7/8 X 16ga
62	10040500	Washer Lock Hvy Hlcl Spr 5/16
66	127951	Stop Throttle 3000 Rpm
72	71070512	Screw Hexhd Cap 5/16-18x3/4
78	17060620	Screw 3/8-16x1-1/4
81	128861	Nut Flange 1/4-20 Starter Nut

NOTE: All component dimensions given in U.S. inches
1 inch = 25.4 mm

REPAIR PARTS

MOWER LIFT

TRACTOR- -MODEL NO. 917.259461

KEY NO.	PART NO.	DESCRIPTION
1	159460	Washer Asm Inner Spring W/Plunger
2	159471	Shaft Asm. Lift
3	105767X	Pin Groove
4	12000002	E Ring #5133-62
5	19211621	Washer 21/32 x 1 x 21 Ga.
6	120183X	Bearing Nylon
7	125631X	Grip Handle Fluted
8	122365X	Button Plunger Black
11	165829	Link Asm Lift L.H.
12	165831	Link Asm Lift R.H.
13	4939M	Retainer Spring
15	167253	Link Front
16	73350800	Nut Jam Hex 1/2-13 Unc
17	130171	Trunnion Blk Zinc
18	73800800	Nut Lock W/wsh 1/2-13 Unc
19	139868	Arm Suspension Mower
20	163552	Retainer Spring
23	110807X	Nut Special
24	19131016	Washer 13/32 x 5/8 x 16 Ga.
25	2876H	Spring 2-1/8"
26	169484	Retainer Clip
27	126971X	Rod Adj Lift Zinc 7.49 Wrk Lg
28	73350600	Nut Hex Jam 3/8-16 Unc
29	138057	Knop Inf 3/8-16 Unc Blk w/sym
30	150233	Trunnion Infin Height
31	140302	Bearing, Pvt. Lift. Spherical
32	73540600	Nut Crownlock 3/8-24
36	155097	Pointer Height Indicator
37	123935X	Plug Hole Blk 1.485/1.515 Dia
38	17060516	Screw 5/16-18 x 1
40	19112410	Washer 11/32 x 1-1/2 x 10 Ga.
41	123934X	Scale Ind Height Blk
49	45212	Nut hex Flange Lock
50	10452X	Nut Push Phos & Oil

NOTE: All component dimensions given in U.S. inches
1 inch = 25.4 mm

REPAIR PARTS

TRACTOR- -MODEL NO. 917.259461

LOWER

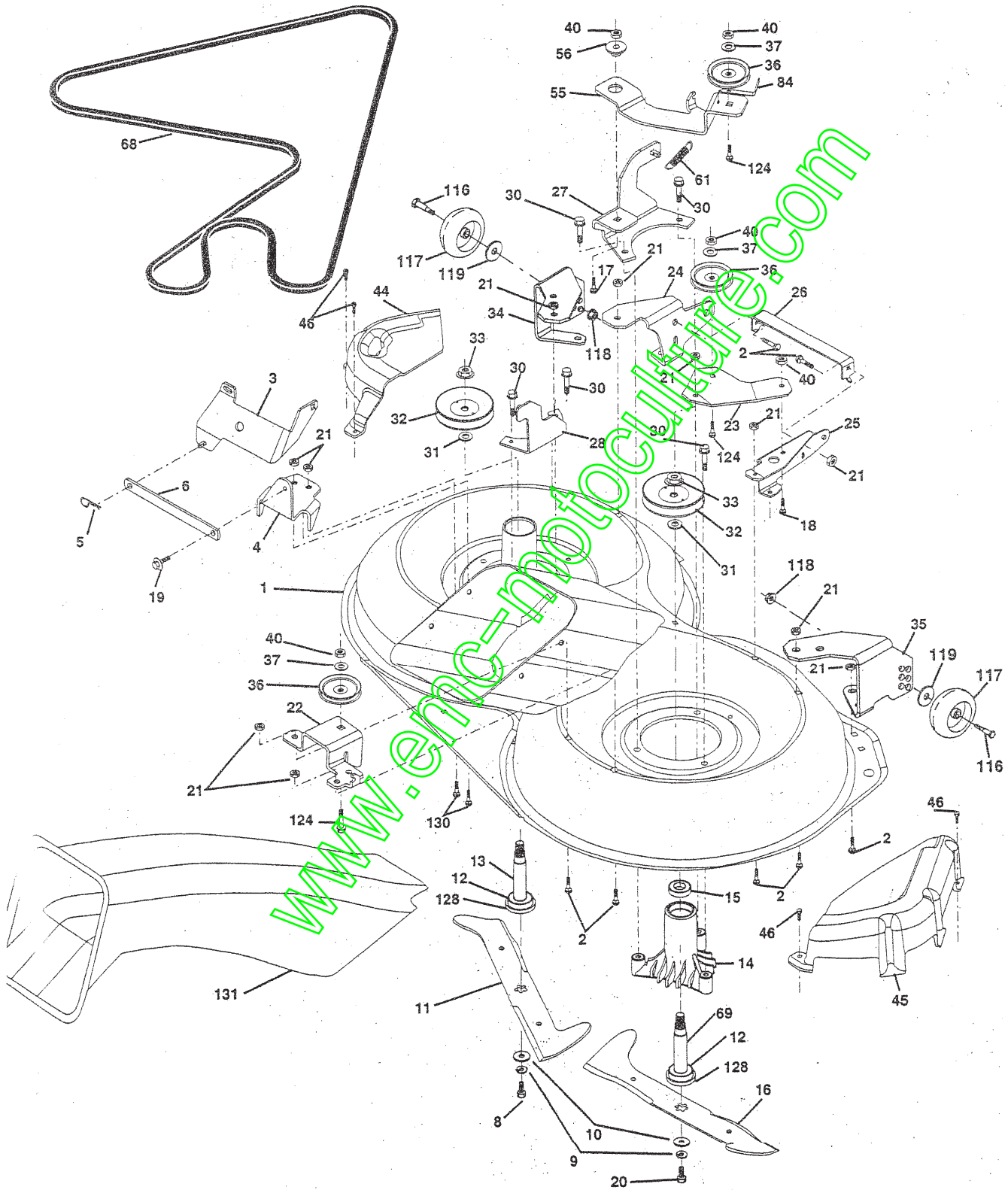

REPAIR PARTS

TRACTOR- -MODEL NO. 917.259461

MOWER

KEY NO.	PART NO.	DESCRIPTION	KEY NO.	PART NO.	DESCRIPTION
1	165552	Housing Asm. Mower 92 CRD	32	153531	Mandrel Pulleys 36 & 46
2	72140506	Bolt Rdhd Sqnk 5/16-18 Unc x 3/4	33	137266	Nut Flg Top Lock Cntr B 9/16
3	165569	Bracket Asm. S-Bar Chass 92 CRD	34	165239	Bracket Gauge Wheel Lf 92 CRD
4	165558	Bracket Bar Sway Deck 92 CRD	35	165238	Bracket Gauge Wheel Rf 92 CRD
5	4939M	Retainer Spring	36	146763	Pulley Idler V-Groove Dim.4.25
6	165557	Bar Sway 92 CRD	37	19131316	Washer 11/32 x 13/16 x 16 Ga
8	850857	Bolt 3/8-24 x 1.25 Gr8 Patched	40	73680600	Nut Crownlock 3/8-16 Unc
9	10030600	Washer Lock Hvy 3/8 Unplated	44	165724	Cover Mandrel Lh 92 CRD
10	140296	Washer Hard Blade Mower vented	45	165556	Cover Mandrel Rh 92 CRD
11	170037	Blade 3-1 Lh	46	137729	Screw Thd Roll 1/4-20 x 5/8
12	129895	Bearing Ball #6204 (Mandrel)	55	165445	Arm Idler 92 CRD
13	137645	Shaft Asm. W/Lower Bearing	56	165723	Spacer Retainer Mower
14	128774	Housing Mandrel Vented (Machd)	61	165945	Spring Tension Belt
15	110485X	Bearing Ball Mandrel	68	165555	Hex-Belt 92 Mower 105AA
16	170038	Blade 3-1 Rh	69	165482	Shaft Asm W/Lwr Brg Rh Thd CRD
17	72140610	Bolt Carriage 3/8-16 x 1-1/4	84	158085	Keeper Belt Idler
18	72110608	Bolt Rdhd Sqnk 3/8-16 x 1 Gr5	116	137644	Bolt Shoulder
19	132827	Bolt Shoulder 5/16-18 Thd Form	117	133957	Wheel Gage
20	165484	Bolt 3/8-24 x 1.25 Gr8 Ptch Lhthd	118	73930600	Nut Centerlock 3/8-16 Unc
21	73680500	Nut Crown Lock 5/16-18	119	19121414	Washer 3/8 x 7/8 x 14 Ga.
22	165243	Bracket Idler Sprt RR 92 CRD	124	72110612	Bolt Carr Sh 3/8-16 x 1-1/2 Gr5
23	165446	Bracket Idler Sprt RF 92 CRD	128	153390	Washer Felt
24	165242	Bracket Suspension LF 92 CRD	130	72110506	Bolt Rdhdsqnk 5/16-18 Unc x 3/4
25	165244	Bracket Suspension RF 92 CRD	131	165661	Chute Bagger CRD 92cm
26	165237	Brace Support Susp Frt CRD	-	130794	Mandrel Asm Service
27	165568	Bracket Asm. Susp RR 92 CRD	-	165579	Mandrel Asm CRD Lh Threads SVC
28	165567	Bracket Asm. Susp LR 92 CRD	-	165578	Deck Mower Complete
30	157722	Screw Thd Rolling Washer Head			
31	129963	Washer Spacer Mower Vented			

NOTE: All component dimensions given in U.S. inches
1 inch = 25.4 mm

REPAIR PARTS

TRACTOR- -MODEL NO. 917.259461

BAGGER

KEY NO.	PART NO.	DESCRIPTION
1	165249	Tube Handle Bagger CRD
2	72140416	Bolt Carriage 1/4-20 x 2.0 Gr.5
3	123976X	Nut Lock 1/4 Lge Flg Gr. 5 Zinc
4	169916	Handle Bagger W/Lvrs
5	74981024	Screw Pan Head #10-24 x 1.50 Blk
6	74981032	Screw Pan Hd
7	73401000	Nut Wiz Lock Hex Serr/Hd 10-24
8	165715X558	Cover Bagger Plastic CRD
9	72140418	Bolt Carriage 1/4-20 x 2.25d x Gr.5
10	169688	Tube Support Bagger CRD
11	165719	Bracket Support Upper Bag CRD
12	169685	Bracket Horiz Adj Bggr Lh CRD
13	72110606	Bolt Rdhd Sht Sqpk 3/8-16 x 3/4
14	74520640	Bolt Hex 3/8-16 x 2-1/2 Gr.5
15	493M	Retainer Spring
16	73900600	Nut Lock Flg 3/8-16 Unc
17	72140506	Bolt Rdhd Sht Sqpk 5/16 -18 Unc x 3/4
18	19111216	Washer 13/32 x 3/4 x 16 Ga.
19	73800500	Nut Lock Hex W/Ins 5/16-18 Unc Pl
20	169684	Bracke Horiz Adj Bggr RH CRD
21	165780	Bag Asm CRD
22	165781	Bracket Side Bagger CRD
23	165782	Tube Upper Bagger CRD
24	165783	Tube Pivot Bagger CRD
25	165784	Tube Front Bagger CRD
26	165785	Tube Lower Bagger CRD
27	169692	Bushing Snap Bagger CRD
28	165787	Grip Handle Black
29	165839	Plate Stop Bagger handle CRD
30	72140410	Bolt Carriage 1/4-20 x 1 Gr.5
31	4497H	Retainer Spring 1" Zinc/Cad
32	126875X	Rivet Rd Hd Drilled 3/8 Dia
33	165571	Plug Mulcher
34	165570	Handle Mulcher
35	165572	Pin Mulcher
36	19192016	Washer 13/32 x 1-1/4 x 16 Ga.
38	72010520	Bolt 5/16-18 x 2-1/2
41	169683	Bracket Vert Adj Bagger CRD

NOTE: All component dimensions given in U.S. inches
1 inch = 25.4 mm

REPAIR PARTS

TRACTOR - - MODEL NUMBER 917.259461

HYDRO GEAR TRANSAXLE - MODEL NUMBER 331-0650

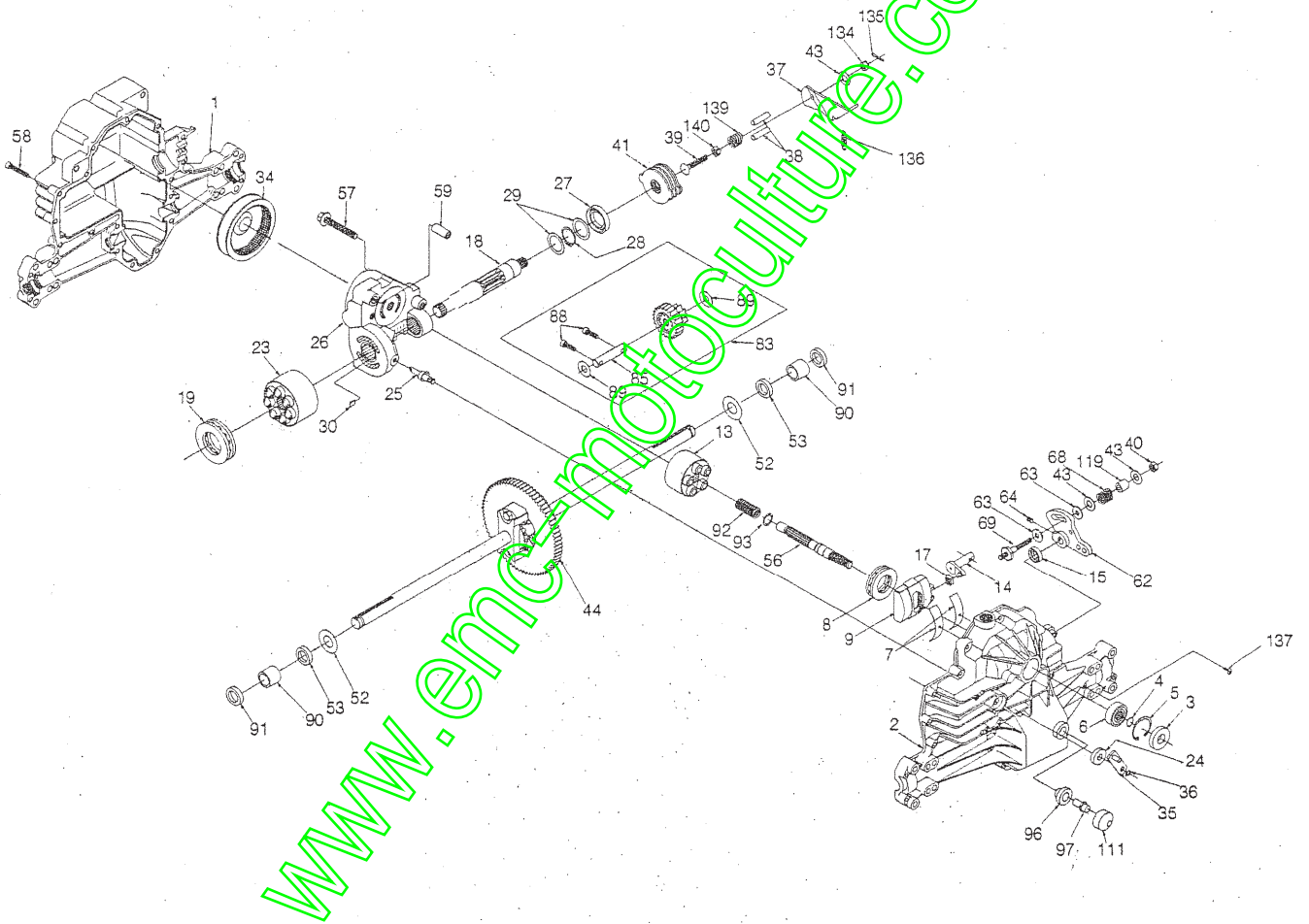

REPAIR PARTS

TRACTOR - - MODEL NUMBER 917.259461

HYDRO GEAR TRANSAXLE - MODEL NUMBER 331-0650

KEY PART NO. NO.	DESCRIPTION	KEY PART NO. NO.	DESCRIPTION
1 142930	RMHOUSING, LOWER	43 142884	WASHER - 7/16X7/8X0.060
2 169049	ASSEMBLY, UPPER HOUSING	44 150829	DIFFERENTIAL ASS'Y
3 142932	SEAL - LIP	52 142991	WASHER - 3/4X1.5X0.13
4 142928	RING - WIRE RETAINING	53 142961	SEAL - 0.75X1.25X0.250
5 142933	RING - RETAINING	56 142963	SHAFT - INPUT
6 142934	BEARING - SHAFT BALL	57 150797	BOLT - 3/8-24X2.5
7 142935	BEARING - CRADLE	58 142964	BOLT - 1/4-20X1.38
8 150771	BEARING - THRUST 30X52X13	59 142965	PIN - 0.5 ODX 0.43 IDX 0.750
9 142937	SWASHPLATE - VARIABLE	62 142966	ARM - CONTROL
13 169050	BLOCK - CYLINDER ASS'Y	63 142967	ROCK - DAMPENER
14 149939	ARM - TRUNNION	64 142920	SET SCREW
15 142940	SEAL - LIP	68 142969	SPRING
17 142941	GUIDE - SLOT	69 161134	5/16-24 STUD
18 150772	SHAFT - MOTOR	83 169053	JACK SHAFT/PINION GEAR
19 150773	BEARING - THRUST 42X68X16	85 150806	JACK SHAFT
23 142944	BLOCK - CYLINDER (MOTOR)	88 142973	CAPSCREW 6MX20 LG
24 142945	SEAL - LIP 10X25X7	89 142974	WASHER 7/16X1X0.5
25 142946	ACTUATOR - BYPASS	90 142975	SLEEVE BEARING
26 169051	CENTERSECTION ASS'Y	91 169054	SEAL - LIP 0.75X1.00X0.158
27 142948	SEAL - LIP 26X42X8	92 142977	SPRING - BLOCK
28 142949	RING - RETAINING	93 142978	WASHER - BLOCK THRUST
29 142950	WASHER - 26X35X1	96 169055	BUSHING - VENT
30 150787	BYPASS PLATE	97 169056	VENT
34 142951	OIL FILTER ELEMENT	111 169057	VENT
35 142952	ARM - BYPASS	119 142980	SPACER
36 142953	RING - RETAINING	134 142885	CASTLE NUT - 5/16-24
37 169052	ARM - BRAKE	135 142886	COTTER PIN
38 142955	PIN - ACTUATING	136 169058	EXTENSION SPRING
39 150777	BOLT - 5/16-18X1-3/4	137 161175	SCREW - 10-32X1/2
40 150778	NUT - HEX LOCK 5/16-24 UNJC	139 150775	COMPRESSION SPRING
41 142958	BRAKE ROTOR/STATOR KIT	140 150776	NUT - HEX 5/16-18

NOTE: All component dimensions given in U.S. inches
1 inch = 25.4 mm

www.emc-motoculture.com