

REPAIR PARTS MANUAL
MODEL NO. 259462
Lawn Tractor



HOW TO USE THIS MANUAL

This manual is designed to provide the customer with a means to identify the parts on his/her tractor when ordering repair parts. The illustrations may or may not represent the actual assemblies; therefore, it is not recommended to use this manual as a guide to assemble or disassemble the tractor. Some hardware and parts are drawn larger in order to more readily identify them.

Each tractor has its own model number.

The model number for your tractor can be found on the fender under the seat.

When ordering parts, always give the following information:

- Product - "Tractor"
- Model Number - "259462"
- Part Number
- Part Description

TABLE OF CONTENTS

SCHEMATIC.....	3
ELECTRICAL.....	4-5
CHASSIS.....	6-7
DRIVE.....	8-9
STEERING.....	10-11
SEAT.....	12
METALS.....	13
ENGINE.....	14-15
POWER LIFT.....	16-17
POWER DECK.....	18-19
MOWER.....	20-21
TRANSAXLE.....	22-23
WARRANTY.....	24

TRACTOR- -MODEL NO. 917. 259462

SCHEMATIC

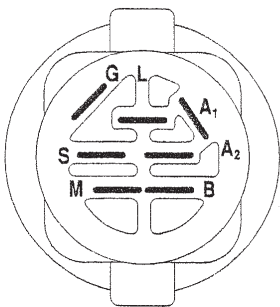
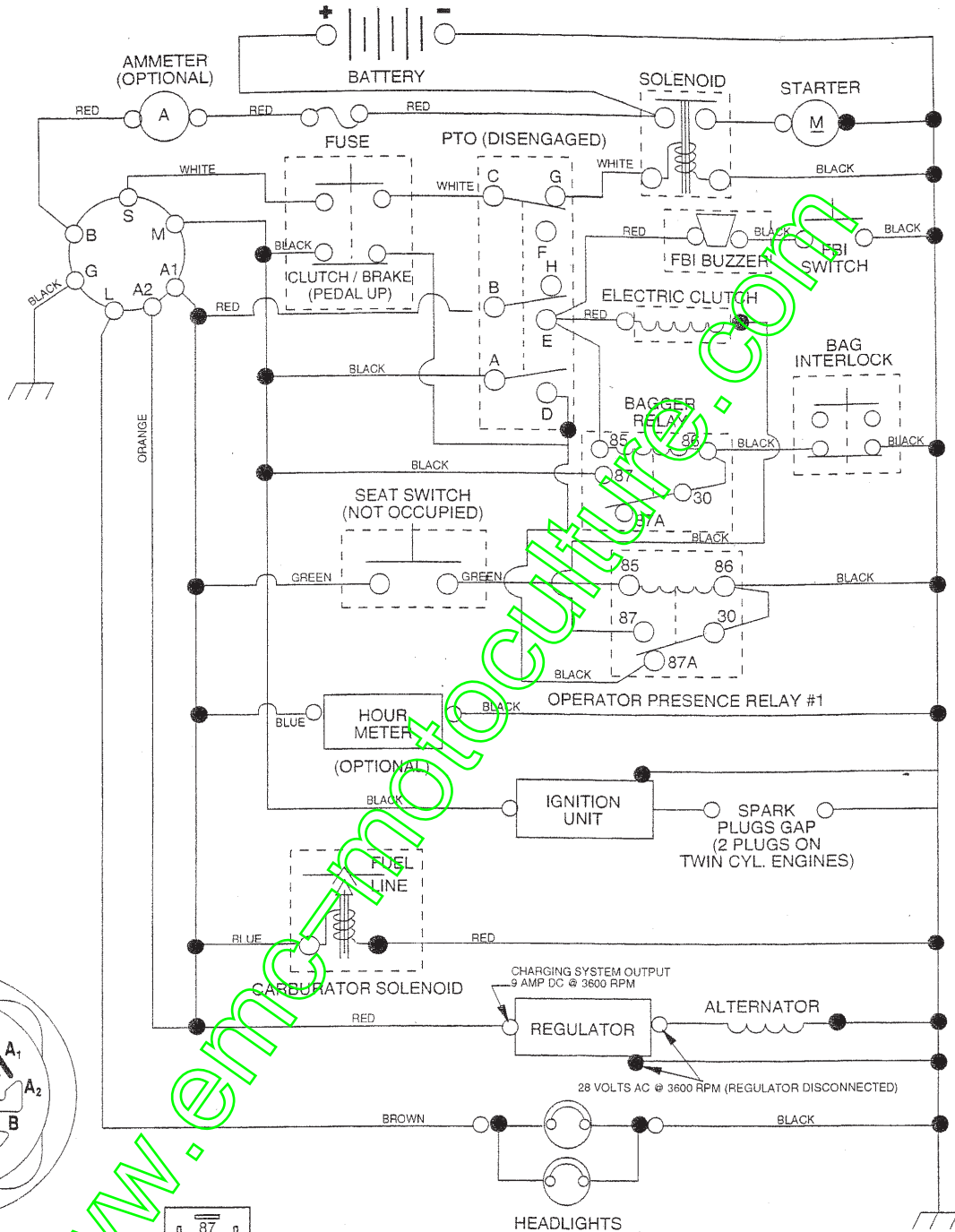

IGNITION SWITCH

POSITION	CIRCUIT	"MAKE"
OFF	M+G+A1	NONE
RUN/LIGHT	B+A1	A2+L
RUN	B+A1	NONE
START	B+S+A1	NONE

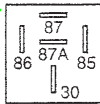

RELAY

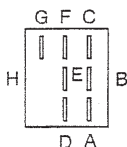

PTO SWITCH

POSITION	CIRCUIT
OFF	G+G, B+H
ON	C+F, B+E, A+D

NON-REMOVABLE CONNECTIONS

REMOVABLE CONNECTIONS

WIRING INSULATED CLIPS
NOTE: IF WIRING INSULATED CLIPS WERE REMOVED FOR SERVICING OF UNIT, THEY SHOULD BE REPLACED TO PROPERLY SECURE YOUR WIRING.

REPAIR PARTS

TRACTOR- -MODEL NO. 917. 259462

ELECTRICAL

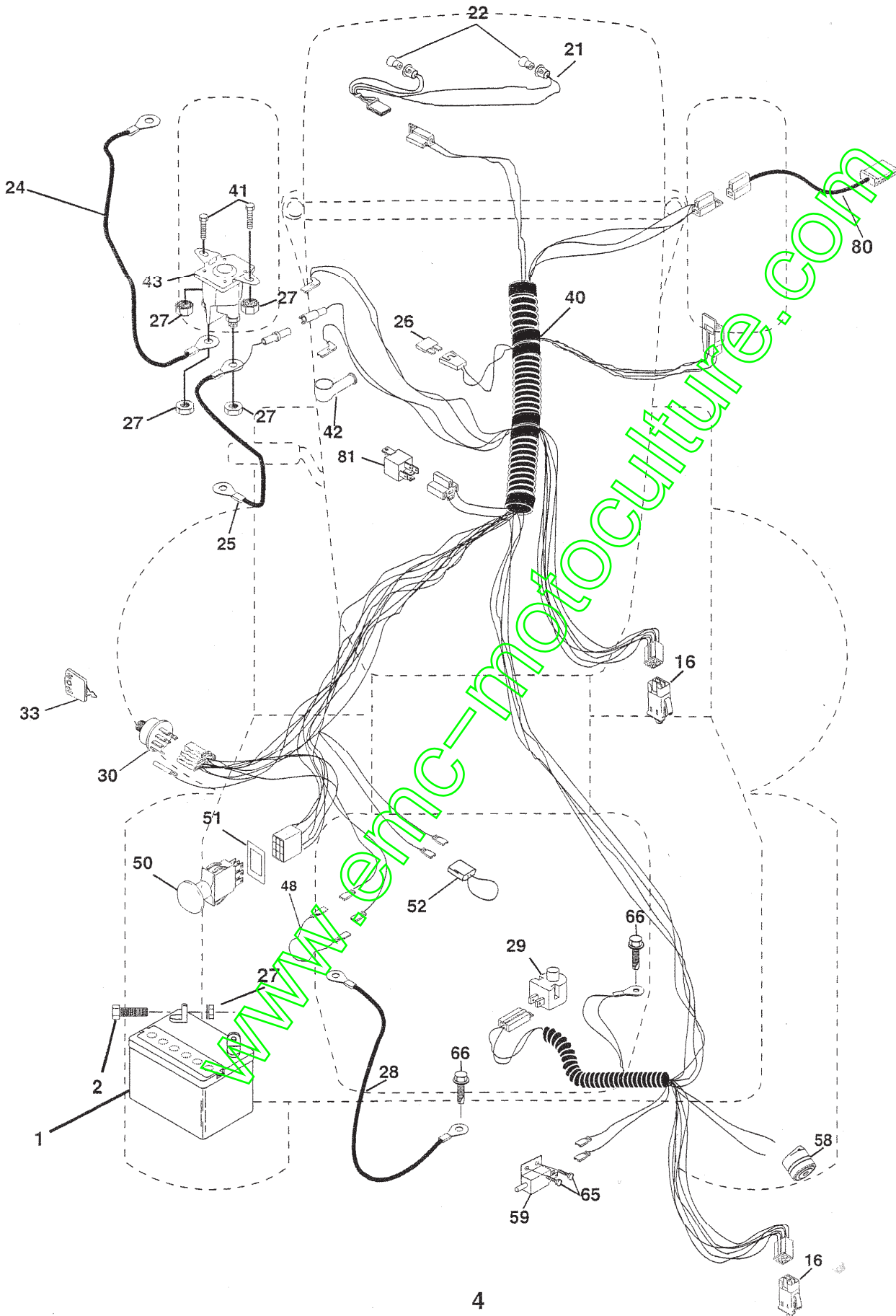

REPAIR PARTS

TRACTOR- -MODEL NO. 917. 259462

ELECTRICAL

KEY NO.	PART NO.	DESCRIPTION
1	144925	Battery 12 Volt 25 AMP Wet
2	74760412	Bolt Hex Hd 1/4-20 Unc X 3/4
16	153664	Switch Interlock Push-In
21	166182	Harness Asm Light W/4152J
22	4152J	Bulb Light #1156
24	4799J	Cable Starter 6Ga 11" Red
25	165987	Cable Battery Crd 56" Red
26	175158	Fuse 20 Amp
27	73510400	Nut Keps Hex 1/4-20 Unc
28	127725X	Cable Ground 6Ga 18" Black
29	160784	Switch Plunger Normal Op Olive
30	175566	Switch Ignition
33	140403	Key Ign
40	170214	Harness Ign Crd Elect
41	71110408	Bolt Flk Fin Hex 1/4-20 Unc X 1/2
42	131563	Cover Terminal Red
43	175141	Solenoid
48	140844	Adapter Ammeter Rectangular
50	174652	Switch PTO
51	140405	Ring Retainer PTO
52	141940	Protection Wire Loop
58	169419	Buzzer Crd
59	166299	Switch FBI CRD
65	17211008	Screw Sltp #10-16 x 1/2 Ty-Ab
66	17490608	Screw Thdrol 3/8-16 x 1/2 Ty-Tt
80	146685	Harness Clutch EVX
81	109748X	Relay Asm

NOTE: All component dimensions given in U.S. inches.
1 inch = 25.4 mm.

REPAIR PARTS

TRACTOR- -MODEL NO. 917.259462

SEAT AND ENCLOSURES

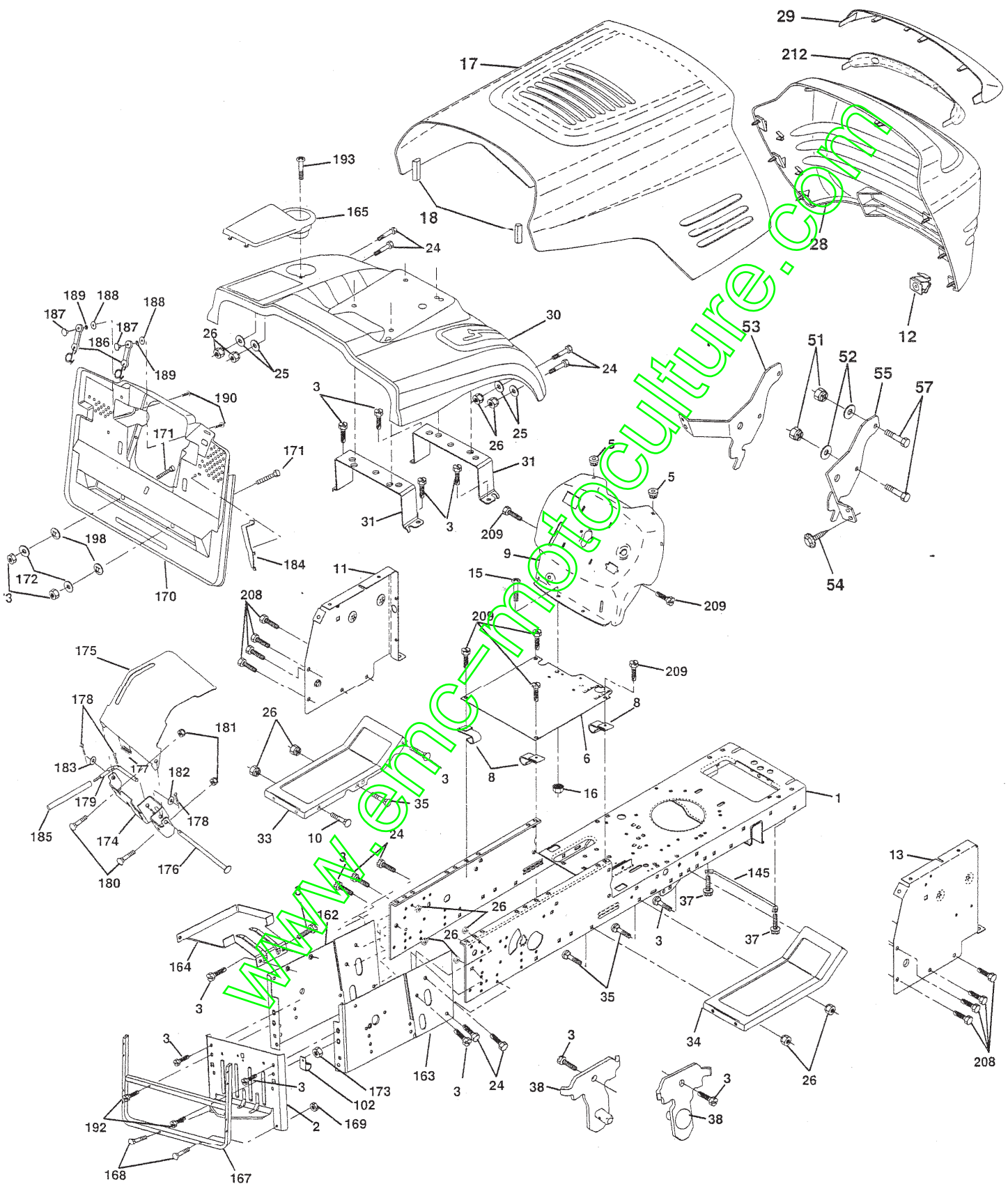

REPAIR PARTS

TRACTOR- -MODEL NO. 917.259462

CHASSIS AND ENCLOSURES

KEY NO.	PART NO.	DESCRIPTION	KEY NO.	PART NO.	DESCRIPTION
1	169831	Chassis	162	170256	Bracket Exten Chassis Lh CRD
2	165606	Drawbar	163	175770	Bracket Exten Chassis Rh CRD
3	17060612	Screw 3/8-16 x 3/4	164	165605	Support Battery CRD
5	155272	Bumper Hood/Dash	165	165742X428	Cover Battery CRD Lt
6	155923	Saddle	167	165779	Support Asm. Backplate WLDMNT
8	126471X	Clip Insulator 13/32 Mtg. Hole	168	72050412	Bolt RDHD SHT NK 1/4-20 x 1-1/2
9	168350X011	Dash	169	123976X	Nut Lock 1/4 LGE FLG Gr. 5 Zinc
10	72140608	Bolt, Carriage 3/8-16 x 3/4	171	72140620	Bolt Hex 3/8-16 x 2-1/2 Gr 5
11	155927	Panel, Dash, L.H.	170	175264	Cover, Backplate Plastic Black
12	145660	Clip, Tinnerman Grille P/L	172	19132016	Washer 13/32 x 1-1/4 x 16 Ga.
13	172108	Panel, Asm. Dash R.H.	173	73510600	Nut, Keps Hex 3/8-16 UNC
15	74180512	Screw, Machine, Truss Head 5/16-18 UNC x 3/4	174	165939	Bracket Switch FBI CRD
16	73510500	Nut	175	166212	Guard Door Rear CRD
17	144983X558	Hood Assembly	176	128600	Pin Hinge Pivot
18	126938X	Bumper Hood	177	132796	Spring Bagger Top LH Black
24	74780616	Bolt	178	76920312	Pin Cotter 3/32 x 3/4 Cad Zinc
25	19131312	Washer 13/32 x 13/16 x 12 Gauge	179	165942	Rod Pivot FBI CRD
26	73800600	Nut	180	74760516	Bolt Hex HD 5/16-18 UNC x 1
28	156725X558	Grille PL	181	73680500	Nut Crownlock 5/16-18
29	155217X599	Lens, Grille	182	138200	Washer .385 x .625 x 11 Ga.
30	170139X558	Fender	183	19131316	Washer 13/32 x 13/16 x 16 Ga.
31	165156	Bracket, Fender Support	184	174662	Bracket Actuator Bagger CRD
33	145244X558	Footrest, L.H.	185	165940	Tube Lever Switch FBI CRD
34	145243X558	Footrest, R.H.	186	160793	Latch Asm Mulch/Bagger
35	72110606	Bolt	187	2029J	Nut Weld .327/.304 #10-24
37	17490508	Screw Thdrol 5/16-18 x 1/2 TYT	188	19061216	Washer #10
38	169834	Bracket Asm Pivot Mower Rear	189	10071000	Washer Lock #10
51	73800400	Nut Lock w/Insert 1/4-20 UNC	190	71081010	Screw Truss Hd Phil 10-24 x 5/8
52	19091416	Washer 9/32 x 7/8 x 16 Ga.	193	17070412	Screw Truss 1/4-20 x 3/4
53	145201	Bracket, Grille LH	192	17060624	Screw Thdrol 3/8-16 x 1-1/2
54	161464	Screw Hex WSHD 8-18 x 7/8	198	168937	Nut, Push
55	145202	Bracket, Grille RH	208	17670608	Screw Thdrol 3/8-16 x 1/2
57	74780412	Bolt, Fin Hex 1/4-20 UNC x .75	209	17000612	Screw Hex Wsh Thdrol 3/8-16
102	2751R	Clip line Fule 13/32 Mtg Hole	212	165919	Insert Lens Reflect
145	156524	Rod Pivot Chassis Hood	--	5479J	Plug, Button

NOTE: All component dimensions given in U.S. inches.
1 inch = 25.4 mm.

REPAIR PARTS

TRACTOR- -MODEL NO. 917.259462

RIVE

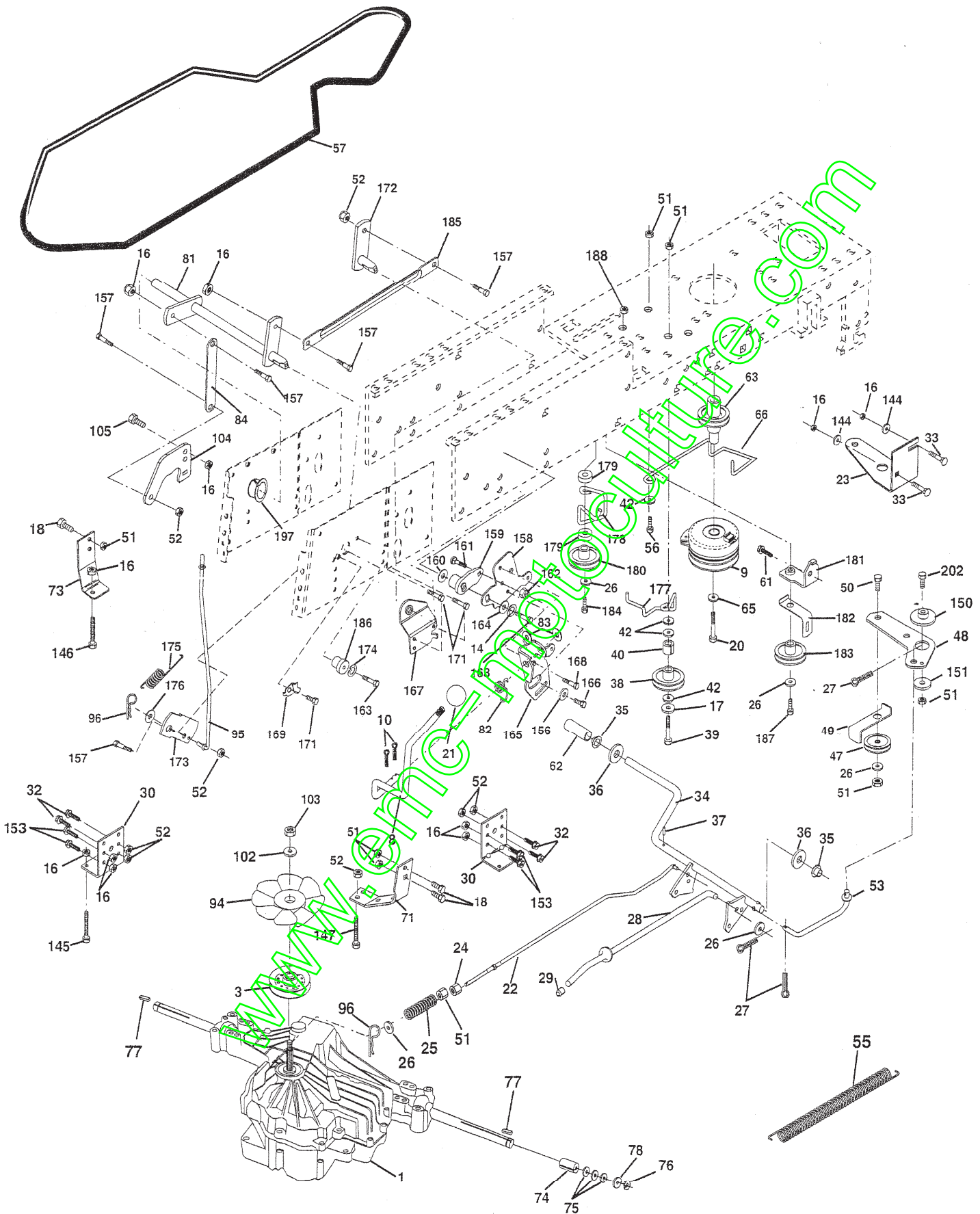

REPAIR PARTS

TRACTOR- -MODEL NO. 917.259462

DRIVE

KEY NO.	PART NO.	DESCRIPTION	KEY NO.	PART NO.	DESCRIPTION
1	-----	Transaxle Hydro Gear 331-0650 (See transaxle breakdown)	82	123782X	Spring, Torsion
3	143995	Pulley Hydro 0650 Lt/CRD	83	19171216	Washer 17/32 x 3/4 x 16 Ga.
8	165619	Rod, Shift Fender Adjust Lt	84	165629	Link, Transaxle
9	167162	Clutch Ele EVX 80 W/Hard Brake	94	140462	Fan 7"
10	76020416	Pin, Cotter 1/8 x 1	95	165935	Control Asm Bypass Hydro
14	10040400	Washer, Lock Hvy Helical	96	4497H	Spring, Retainer 1"
16	73800500	Nut, Lock Hex w/Ins 5/16-18 UNC	102	141322	Washer, Belleville .50ID x 1.50D
18	74780616	Bolt Hex 3/8-16 UNC x 1 Gr.5	103	73940800	Nut, Hex Jam Toplock 1/2-20 UNF
20	150280	Bolt, Hex 7/16-20 x 4-1/4 5 Ga 1.38	104	140156	Arm, Control Hydro
21	130564	Knob Deluxe 1/2-13 UNC	105	71070516	Screw Cap Hex 5/16 x 18 Unc-1
22	165688	Rod, Brake CRD 0650	144	19111016	Washer 11/32 x 5/8 x 16 Ga
23	171258	Bracket asm Anti-Rust Evx	145	74490540	Bolt Hex FGHD 5/16-18 x Gr 5
24	73350600	Nut	146	74490536	Bolt Hex FLGHD 5/16-18 x 2-1/4
25	106888X	Spring, Rod, Brake	147	74490524	Bolt Hex FLGHD 5/16-18 x 1-1/2
26	19131316	Washer 13/32 x 13/16 x 16 Ga.	150	165850	Bushing, Bellcrank Grnd Dr
27	76020412	Pin, Cotter 1/8 x 3/4	151	19133210	Washer 13/32 x 2 x 10 Ga.
28	145204	Rod, Parking Brake	153	74750516	Bolt Hex Hd 5/16-18 Unc x 1
29	71673	Cap, Parking Brake	156	166002	Washer Srrted 5/16ID x 1.125
30	169592	Bracket, Mfg. Transaxle	157	168236	Bolt Shoulder 5/16-18 Unc 2A
32	74760512	Bolt Hex 5/16-18 UNC x 3/4	158	165589	Bracket Shift Mount
33	72140506	Bolt Rdhd Sqnk 5/16-18 Unc x 3/4	159	165494	Hub Tapered Flange Shift Lt
34	165496	Shaft, Asm Pedal Foot CRD	160	19292016	Washer 29/32 x 1-1/4 x 16 Ga.
35	120183X	Bearing, Nylon	161	72140406	Bolt Rdhd Sqnk 1/4-20 x 3/4 Gr 5
36	19211616	Washer 21/32 x 1 x 16 Ga.	162	73680400	Nut Crownlock 1/4-20 Unc
37	1572H	Pin, Roll 3/16 x 1"	163	74780416	Bolt Hex Fin 1/4-20 Unc x 1 Gr 5
38	165936	Pulley Flat Composite 3.06"	164	19091010	Washer 5/8 x .281 x 10 Ga.
39	74760644	Bolt Fin Hex 3/8-16 x 2-3/4	165	165623	Bracket Pivot Lever
40	4470J	Spacer, Split 395 x 59 Bzp	166	166880	Screw 5/16-18 x 5/8
42	19131312	Washer 13/32 x 13/16 x 12 Ga.	167	165588	Bracket Support Shift CRD
47	127783	Pulley, Idler, V Groove Plasic	168	165492	Bolt Shoulder 5/16-18 x .561
48	154407	Bellcrank Clutch Grnd Drv	169	165580	Plate Fastening Lt
49	123205X	Retainer, Belt Style Spring	171	17490608	Screw Thdrol 3/8-16 x 1/2 Ty-Tt
50	74760624	Bolt Hex Hd 3/8-16 UNC x 1-1/2	172	165587	Shaft Asm Shifter Frt CRD 0650
51	73680600	Nut, Crownlock 3/8-16 UNC	173	165934	Bracket Hydro Bypass CRD
52	73680500	Nut Crownlock 5/16-18	174	10090400	Washer Lock 1/4
53	105710X	Link, Clutch 7.66	175	165931	Spring Bypass CRD
55	105709X	Spring, Return, Clutch	176	19070816	Washer 7/32 x 1/2 x 16 Ga.
56	74760620	Bolt, Hex 3/8-16 UNC x 1-1/4	177	165932	Keeper Flat Idler 3.06" CRD
57	165632	V-Belt Kev 112" 0650 CRD	178	165933	Keeper Belt Idler 1.88" CRD
61	17060612	Screw, 3/8-16 x 3/4	179	120958X	Washer Sintered
62	8883R	Cover, Pedal	180	165630	Pulley, Idler, Flat 1.88"CRD
63	145868	Pulley, Clutch elect EVX 1"	181	165797	Bracket Idler Ground Drive CRD
65	10040700	Washer	182	165634	Keeper Belt 2.5" Od V-Idler CRD
66	154778	Keeper, Belt Engine F-Proof	183	165626	Pulley V-Idler 2.50" Od CRD
71	140158	Strap, Torque, Lh	184	17490644	Screw Hexwsh Thdrol 3/8-16 x 2-3/4
73	156347	Strap, Torque, Rh	185	165541	Link Shift CRD Hydro 0650
74	121199X	Spacer, Split	186	165614	Hub Tapered Round CRD
75	121749X	Washer 25/32 x 1-1/4 x 16 Ga.	187	17490620	Screw Thdrol 3/8-16 x 1-1/4 TT
76	12000001	Ring, E	188	110436X	Bushing Snap Split
77	123583X	Key, Square	197	169613	Nyliner Snap In 5/8
78	121748X	Washer 25/32 x 1-5/8 x 16 Ga.	202	72110612	Bolt Carr Sh 3/8-16 x 1-1/2 Gr 5
81	165585	Asm, Shaft			

NOTE: All component dimensions given in U.S. inches
1 inch = 25.4 mm

REPAIR PARTS

TRACTOR- -MODEL NO. 917.259462

BEARING ASSEMBLY

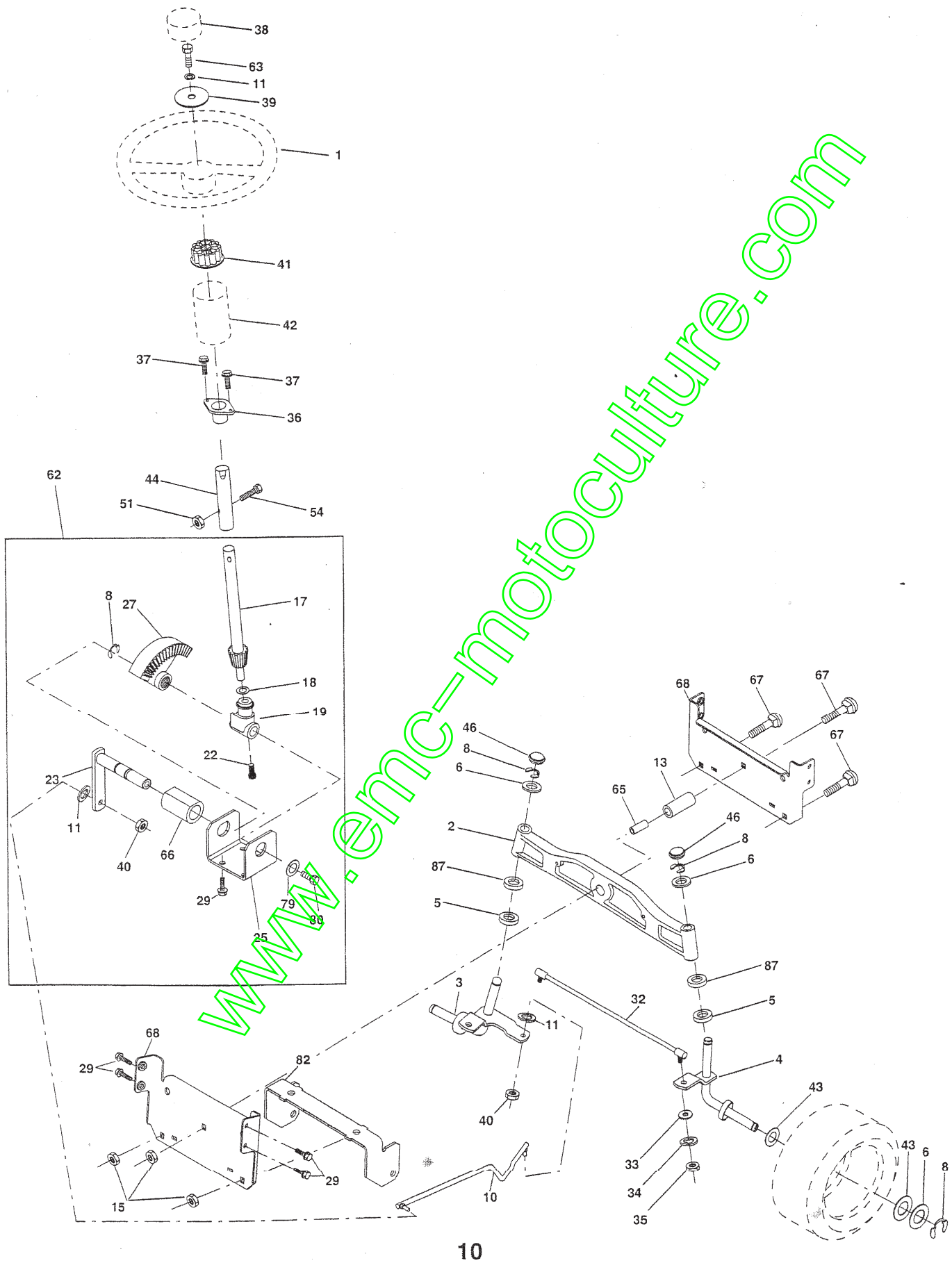

REPAIR PARTS

TRACTOR- -MODEL NO. 917.259462

STEERING ASSEMBLY

KEY NO.	PART NO.	DESCRIPTION
1	139768	Steering Wheel
2	172393	Axle Cast Lt Machined
3	169840	Spindle Assembly, L.H.
4	169839	Spindle Assembly, R.H.
5	6266H	Bearing, Race, Thrust, Hardened
6	121748X	Washer 25/32 x 1-5/8 x 16 Gauge
8	12000029	Ring, Klip
10	169832	Link, Drag
11	10040600	Washer, Lock
13	136518	Spacer Brg Axle Front
15	145212	Nut, Hex Flange Lock
17	156546	Shaft Assembly, Steering
18	57079	Washer, Thrust .515 x .750 x .053
19	160395	Support, Shaft
22	165857	Screw Hex Wshhd Torx
23	165851	Pittman Shaft Assembly
25	154406	Bracket, Steering
27	136874	Gear, Sector
29	17060612	Screw, 3/8-16 x 3/4
32	171888	Rod, Tie
33	19111216	Washer 11/32 x 3/4 x 16
34	10040500	Washer Lock Hvy HLCL SPR 5/16
35	73540500	Crownlock Nut 5/16-24
36	155099	Bushings, Steering
37	152927	Screw TT #10-32 x 5 x 3/8 Flange
38	139769	Cap Wheel Steering
39	19133812	Washer 13/32 x 2-3/8 x 12 Gauge
40	7810H	Nut Lock Center 3/8-24 Unf
41	100711L	Adaptor, Steering Wheel
42	145054X428	Boot, Steering Dash P/L Mtl
43	121749X	Washer 25/32 x 1-1/4 x 16 Gauge
44	153720	Extension Steering Non-Adjust
46	121232X	Cap, Spindle
51	73800500	Nut Lock Hx W/Ins 5/16-18 UNC
54	74780520	Bolt Fin Hex 5/16-18 UNC x 1-1/4
62	167962	Kit, Steering Assembly, Service
63	74780616	Bolt Fin Hex 3/8-16 unc. x 1 Gr. 5
65	166367	Spacer Brace Axle
66	154404	Bearing Arm Pittman
67	72140618	Bolt Rdhd Sqnk 3/8-16 x 2-1/4
68	169827	Brace Axle
79	19132012	Washer 13/32 x 1-1/4 x 12 Ga
80	74950612	Bolt Hex Nylon 3/8-16 x 3/4
82	169635	Bracket Susp Chassis Front
87	173966	Washer Flat .781 x 1-1/2 x .14

NOTE: All component dimensions given in U.S. inches.
1 inch = 25.4 mm.

REPAIR PARTS

TRACTOR- -MODEL NO. 917.259462

SEAT ASSEMBLY

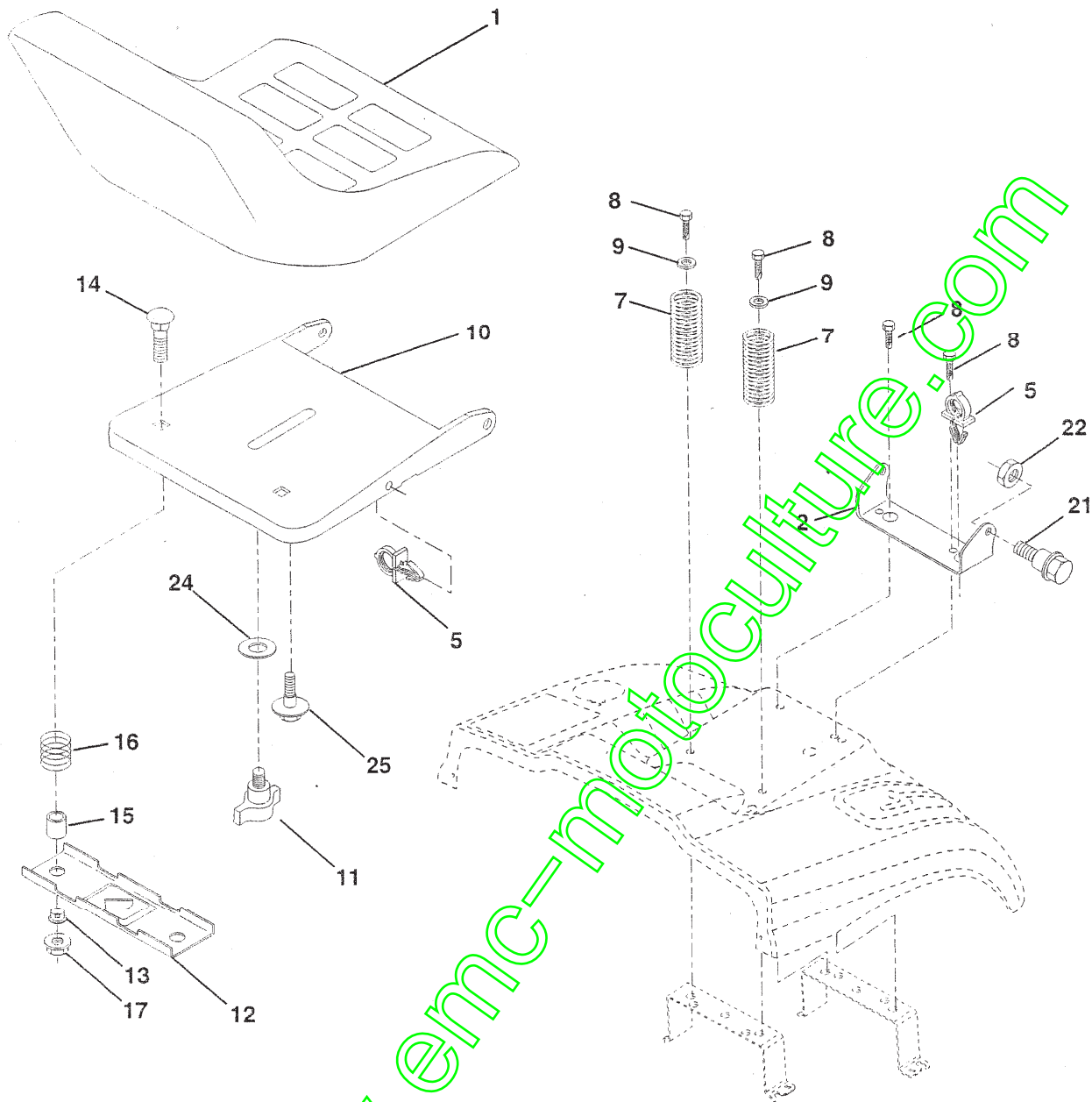

KEY NO.	PART NO.	DESCRIPTION
	140123	Seat
	140551	Bracket Pnt Pivot Seat (blk)
	145006	Clip Push In Hinged
	124181X	Spring Seat Cprsn 2 250 Blk Zi
	17000616	Screw 3/8-16 X 1-1/2
	19131614	Washer 13/32 X 1 X 14 Ga
	155925	Pan Pnt Seat (blk)
	166369	Knob Seat Adj Wingnut
	121246X	Bracket Pnt Mounting Switch
	121248X	Bushing Snap Blk Nyl 50 Id

KEY NO.	PART NO.	DESCRIPTION
14	72050412	Bolt Rdhd Sht Nk 1/4-20x1-1/2
15	134300	Spacer Split .28 X .96 Zinc
16	121250X	Spring Cprsn
17	123976X	Nut Lock 1/4 Lge Flg Gr 5 Zinc
21	171852	Bolt Shoulder 5/16-18 Unc-2A
22	73800500	Nut Hex Lock w/Ins 5/16-18
24	19171912	Washer 17/32 X 1-3/16 X 12 Ga.
25	127018X	Bolt Shoulder 5/16-18 X 62

NOTE: All component dimensions given in U.S. inches.
1 inch = 25.4 mm

REPAIR PARTS

TRACTOR- -MODEL NO. 917.259462

DECALS

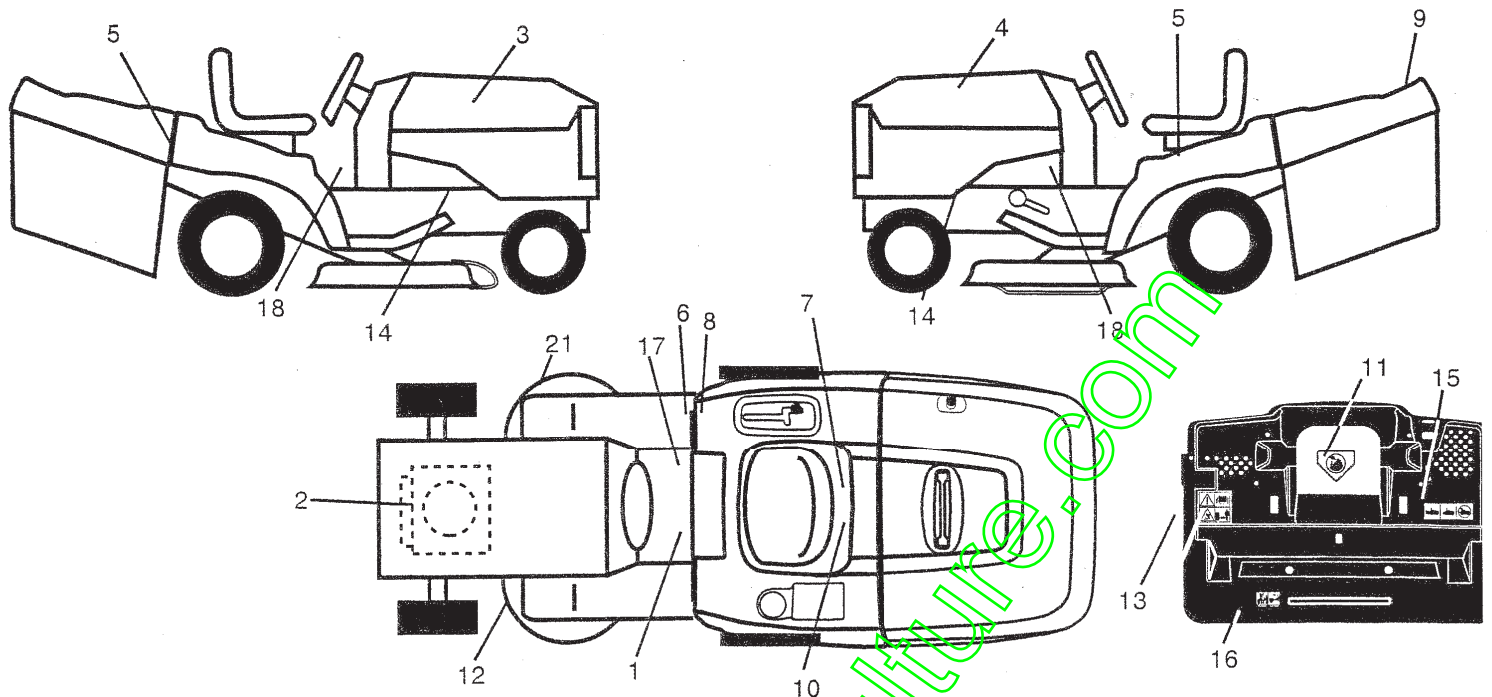

KEY NO.	PART NO.	DESCRIPTION
1	145498	Decal Read Owner's Manual Sym
2	165404	Decal Hp Engine
3	171696	Decal Hood Rh
4	171697	Decal Hood Lh
5	168322	Decal Fender Auto
6	126187X	Decal 100 DBA
7	166960	Decal Bypass Fender
8	145437	Decal Europe Stand Ce
9	163204	Decal Fender
10	145005	Decal Bat Dan/Poi P/L Sym Wpn
11	145494	Decal Mower Cut Finger Symbol

KEY NO.	PART NO.	DESCRIPTION
12	159737	Decal Brake/Clutch Symbol Lt
13	166959	Decal Warn Back Plate CRD
14	159736	Decal Chassis Hot Muffler
15	166961	Decal Oper Bag Presence CRD
16	162598	Decal Drawbar Load Limit
17	140837	Decal Saddle Brake Parking
18	163252	Decal, Dash Panel
21	166286	Decal Deck Sch 92 CRD
--	138311	Decal Lift Handle
--	157199X428	Pad, Footrest
--	172046	Manual Operator's (Euro)
--	172047	Manual Operator's (Scand)
--	176695	Manual Parts

WHEELS & TIRES

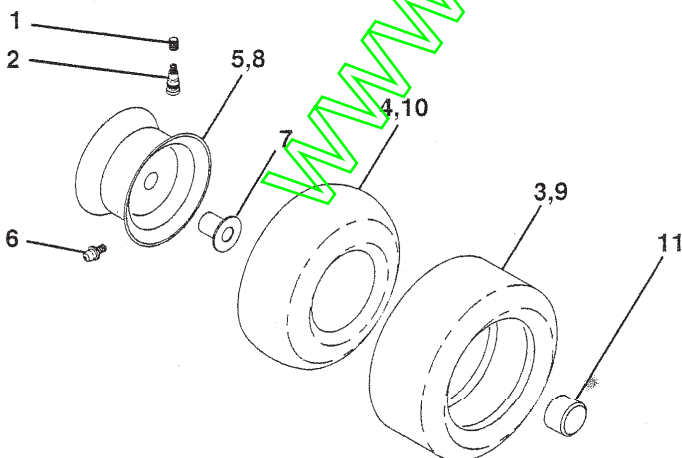

KEY NO.	PART NO.	DESCRIPTION
1	59192	Cap Value Tire
2	65139	Stem Value
3	106222X	Tire F Ts 15 X 6 0 - 6 Service
4	59904	Tube Inner Front #35060
5	106732X427	Rim Asm 6" front White Service
6	278H	Fitting Grease
7	9040H	Bearing Flange
8	106108X427	Rim Asm 8" rear White Service
9	138468	Tire R Ts 20 x 8-8 Service
10	7152J	Tube Rear 9 5 X 8 Service
11	104757X428	Cap Axle Blk 1 50 X 1 00
--	144334	Sealant, Tire (10 oz. tube)

NOTE: All component dimensions given in U.S. inches
1 inch = 25.4 mm

REPAIR PARTS

TRACTOR- -MODEL NO. 917.259462

ENGINE

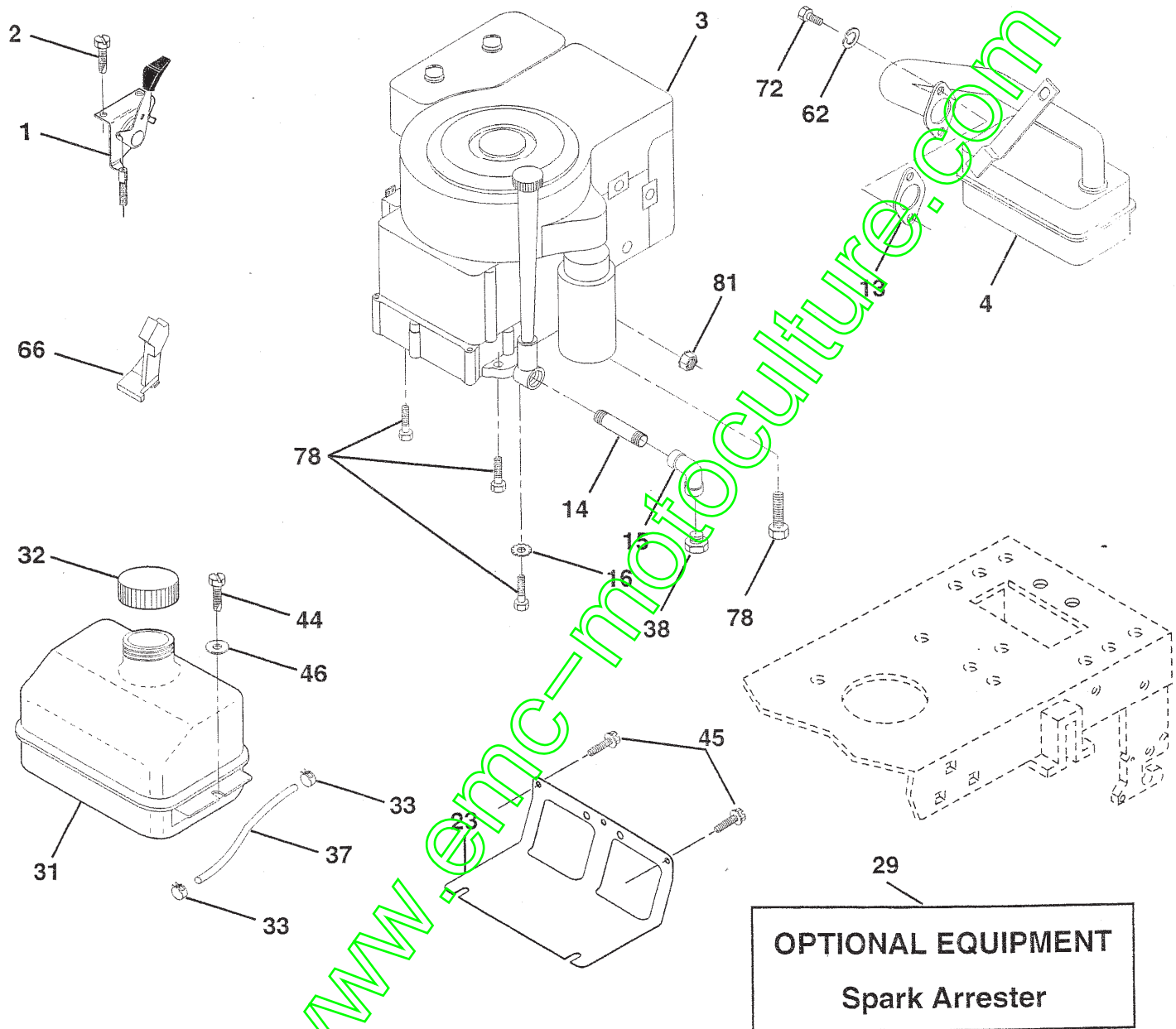

REPAIR PARTS

TRACTOR- -MODEL NO. 917.259462

ENGINE

KEY NO.	PART NO.	DESCRIPTION
1	170549	Control Throt/Ch Lh
2	17720410	Screw Hex Thd Cut 1/4-20x5/8 T
3	-----	Engine Briggs Model 28U707-1175-E3
4	137352	Muffler Exhaust B&S Lt
13	165291	Gasket 1 313 Id Tin Plated
14	13280324	Nipple Pipe 3/8 Npt X 3"
15	13200300	Elbow Std 90 Degree 3/8-18 Npt
16	11050600	Washer Lock Ext Tooth 3/8
23	169837	Shield Browning/Debris Guard
29	137180	Arrestor Spark
31	109202X	Tank Fuel 1.25 Fr
32	158990	Cap Asm Fuel
33	123487X	Clamp Hose Blk
37	137040	Line Fuel 20"
38	-----	Plug Oil Drain (See engine breakdown)
44	17670412	Screw Hexwsh Thdrol 1/4-20x3/4
45	17000612	Srew 3/8-16 x 3/4
46	19091416	Washer 9/32 X 7/8 X 16ga
62	10040500	Washer Lock Hwv Hlcl Spr 5/16
66	127951	Stop Throttle 3000 Rpm
72	71070512	Screw Hexhd Cap 5/16-18x3/4
78	17060620	Screw 3/8-16x1-1/4
81	73510400	Nut Flange 1/4-20 Starter Nut

NOTE: All component dimensions given in U.S. inches
1 inch = 25.4 mm

REPAIR PARTS

TRACTOR- -MODEL NO. 917.259462

POWER LIFT

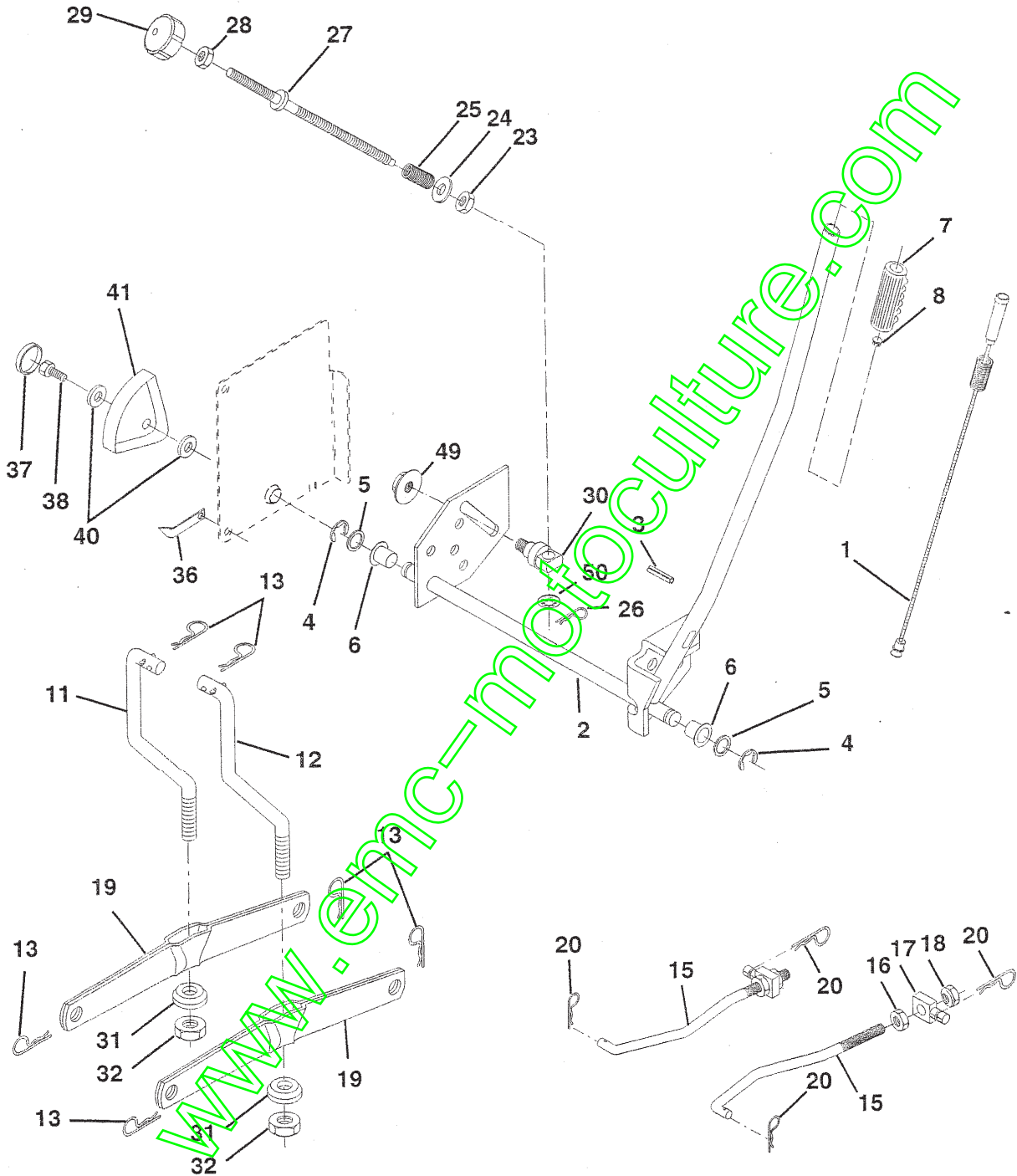

REPAIR PARTS

TRACTOR- -MODEL NO. 917.259462

MOWER LIFT

KEY NO.	PART NO.	DESCRIPTION
1	159460	Washer Asm Inner Spring W/Plunger
2	159471	Shaft Asm. Lift
3	105767X	Pin Groove
4	12000002	E Ring #5133-62
5	19211621	Washer 21/32 x 1 x 21 Ga.
6	120183X	Bearing Nylon
7	125631X	Grip Handle Fluted
8	122365X	Button Plunger Black
11	165829	Link Asm Lift L.H.
12	165831	Link Asm Lift R.H.
13	4939M	Retainer Spring
15	173288	Link Front
16	73350800	Nut Jam Hex 1/2-13 Unc
17	130171	Trunnion Blk Zinc
18	73800800	Nut Lock W/wsh 1/2-13 Unc
19	139868	Arm Suspension Mower
20	163552	Retainer Spring
23	110807X	Nut Special
24	19131016	Washer 13/32 x 5/8 x 16 Ga.
25	2876H	Spring 2 1/8"
26	169484	Retainer Clip
27	126971X	Rod Adj Lift Zinc 7.49 Wrk Lg
28	73350600	Nut Hex Jam 3/8-16 Unc
29	138057	Knob Inf 3/8-16 Unc Blk w/sym
30	150233	Trunnion Infin Height
31	169865	Bearing, Pvt. Lift.
32	73540600	Nut Crownlock 3/8-24
36	155097	Pointer Height Indicator
37	123935X	Plug Hole Blk 1.485/1.515 Dia
38	17060516	Screw 5/16-18 x 1
40	19112410	Washer 11/32 x 1-1/2 x 10 Ga.
41	123934X	Scale Ind Height Blk
49	145212	Nut hex Flange Lock
50	110452X	Nut Push Phos & Oil

NOTE: All component dimensions given in U.S. inches
1 inch = 25.4 mm

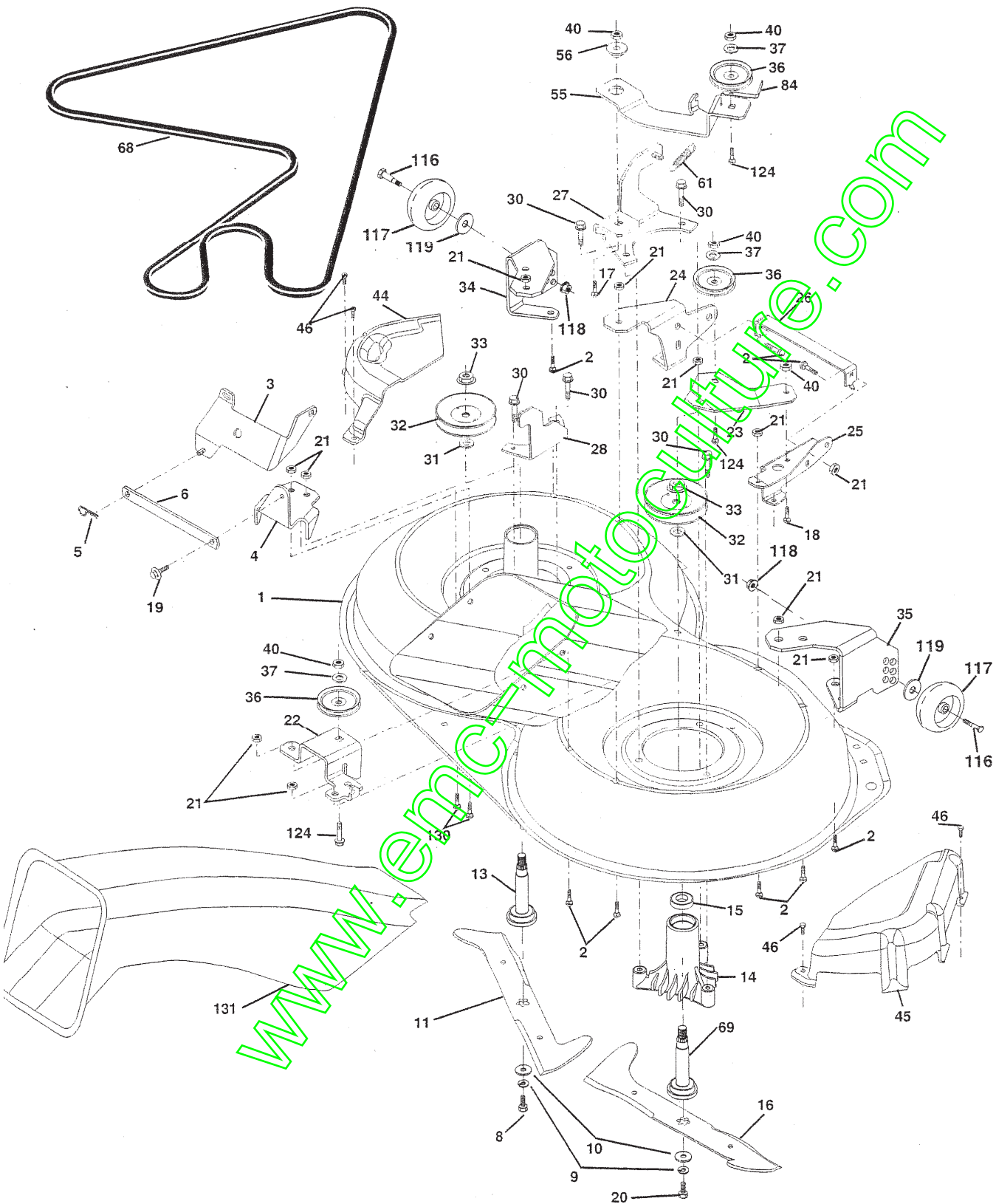

REPAIR PARTS

TRACTOR- -MODEL NO. 917.259462

MOWER

KEY NO.	PART NO.	DESCRIPTION	KEY NO.	PART NO.	DESCRIPTION
1	165552	Housing Asm. Mower 92 CRD	32	153531	Mandrel Pulleys 36 & 46
2	72140506	Bolt Rdhd Sqnk 5/16-18 Unc x 3/4	33	137266	Nut Flg Top Lock Cntr B 9/16
3	165569	Bracket Asm. S-Bar Chass 92 CRD	34	165239	Bracket Gauge Wheel Lf 92 CRD
4	165558	Bracket Bar Sway Deck 92 CRD	35	165238	Bracket Gauge Wheel Rf 92 CRD
5	4939M	Retainer Spring	36	146763	Pulley Idler V-Groove Dim 4.25
6	165557	Bar Sway 92 CRD	37	19131316	Washer 11/32 x 13/16 x 16 Ga
8	850857	Bolt 3/8-24 x 1.25 Gr8 Patched	40	73680600	Nut Crownlock 3/8-16 Unc
9	10030600	Washer Lock Hvy 3/8 Unplated	44	165724	Cover Mandrel Lh 92 CRD
10	140296	Washer Hard Blade Mower vented	45	165556	Cover Mandrel Rh 92 CRD
11	170037	Blade 3-1 Lh	46	137729	Screw Thd Roll 1/4-20 x 5/8
13	137645	Shaft Asm. W/Lower Bearing	55	165445	Arm Idler 92 CRD
14	128774	Housing Mandrel Vented (Machd)	56	165723	Spacer Retainer Mower
15	110485X	Bearing Ball Mandrel	61	165945	Spring Tension Belt
16	170038	Blade 3-1 Rh	68	165555	Hex-Belt 92 Mower 105AA
17	72140610	Bolt Carriage 3/8-16 x 1-1/4	69	165482	Shaft Asm W/Lwr Brg Rh Thd CRD
18	72110608	Bolt Rdhd Sqnk 3/8-16 x 1 Gr5	84	156085	Keeper Belt Idler
19	132827	Bolt Shoulder 5/16-18 Thd Form	116	137644	Bolt Shoulder
20	165484	Bolt 3/8-24 x 1.25 Gr8 Ptch Lhthd	117	133957	Wheel Gage
21	73680500	Nut Crown Lock 5/16-18	118	73930600	Nut Centerlock 3/8-16 Unc
22	165243	Bracket Idler Sprt RR 92 CRD	119	19121414	Washer 3/8 x 7/8 x 14 Ga.
23	165446	Bracket Idler Sprt RF 92 CRD	124	72110612	Bolt Carr Sh 3/8-16 x 1-1/2 Gr5
24	165242	Bracket Suspension LF 92 CRD	130	72110506	Bolt Rdhdsqnk 5/16-18 Unc x 3/4
25	165244	Bracket Suspension RF 92 CRD	131	165661	Chute Bagger CRD 92cm
26	165237	Brace Support Susp Frt CRD	--	130794	Mandrel Asm Service
27	165568	Bracket Asm. Susp RR 92 CRD	--	165579	Mandrel Asm CRD Lh Threads SVC
28	165567	Bracket Asm. Susp LR 92 CRD	--	173549	Deck Mower Complete
30	157722	Screw Thd Rolling Washer Head			
31	129963	Washer Spacer Mower Vented			

NOTE: All component dimensions given in U.S. inches
1 inch = 25.4 mm

REPAIR PARTS

TRACTOR- -MODEL NO. 917.259462

SEAT

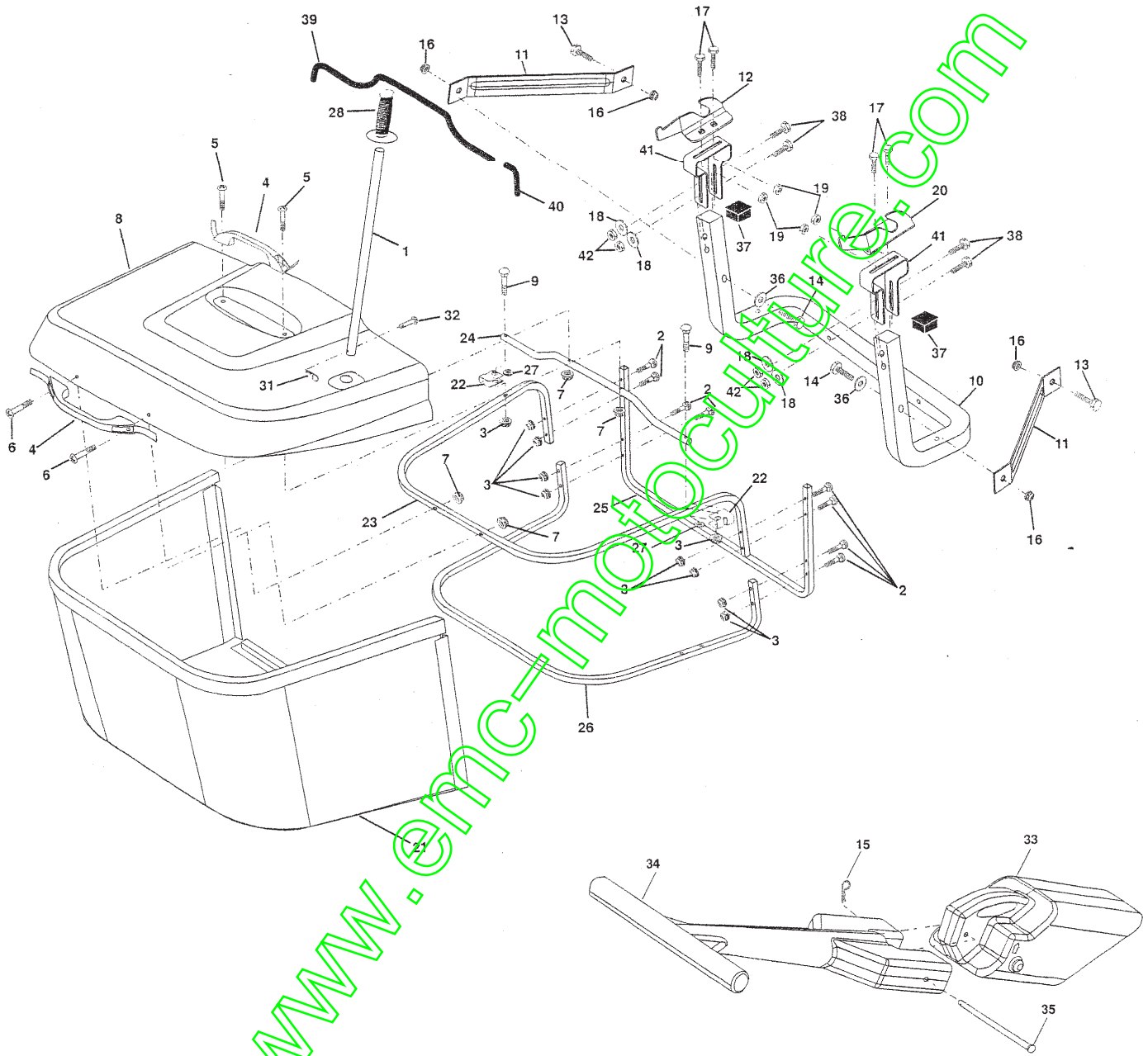

REPAIR PARTS

TRACTOR- -MODEL NO. 917.259462

BAGGER

KEY NO.	PART NO.	DESCRIPTION
1	170690	Tube Handle Bagger CRD
2	72140416	Bolt Carriage 1/4-20 x 2.0 Gr.5
3	123976X	Nut Lock 1/4 Lge Flg Gr. 5 Zinc
4	169916	Handle Bagger W/Lvrs
5	74981024	Screw Pan Head #10-24 x 1.50 Blk
6	74981032	Screw Pan Hd
7	73401000	Nut Wiz Lock Hex Serr/Hd 10-24
8	165715X558	Cover Bagger Plastic CRD
9	72140418	Bolt Carriage 1/4-20 x 2.250 x Gr.5
10	169688	Tube Support Bagger CRD
11	165719	Bracket Support Upper Bag CRD
12	169685	Bracket Horiz Adj Bggr LH CRD
13	72110606	Bolt Rdhd Sht Sqnk 3/8-16 x 3/4
14	74520640	Bolt Hex 3/8-16 x 2-1/2 Gr.5
15	493M	Retainer Spring
16	73900600	Nut Lock Flg 3/8-16 Unc
17	72140506	Bolt Rdhd Sht Sqnk 5/16 -18 Unc x 3/4
18	19111216	Washer 11/32 x 3/4 x 16 Ga.
19	73900500	Nut Lock Hex Flange 5/16-18
20	169684	Bracket Horiz Adj Bggr RH CRD
21	165780	Bag Asm CRD
22	165781	Bracket Side Bagger CRD
23	165782	Tube Upper Bagger CRD
24	165783	Tube Pivot Bagger CRD
25	165784	Tube Front Bagger CRD
26	165785	Tube Lower Bagger CRD
27	169692	Bushing Snap Bagger CRD
28	170696	Grip Handle Black
31	4497H	Retainer Spring 1" Zinc/Cad
32	126875X	Rivet Rd Hd Drilled 3/8 Dia
33	165571	Plug Mulcher
34	165570	Handle Mulcher
35	165572	Pin Mulcher
36	19132016	Washer 13/32 x 1-1/4 x 16 Ga.
37	175401	Plug Support
38	72010520	Bolt 5/16-18 x 2-1/2
39	169999	Seal 2.16600
40	170000	Seal .58300
41	169683	Bracket Vert Adj Bagger CRD
42	73800500	Nut Lock Hex W/Ins 5/16-18 Unc Pl

NOTE: All component dimensions given in U.S. inches
1 inch = 25.4 mm

REPAIR PARTS

TRACTOR - - MODEL NUMBER 917.259462

PRO GEAR TRANSAXLE - MODEL NUMBER 331-0650

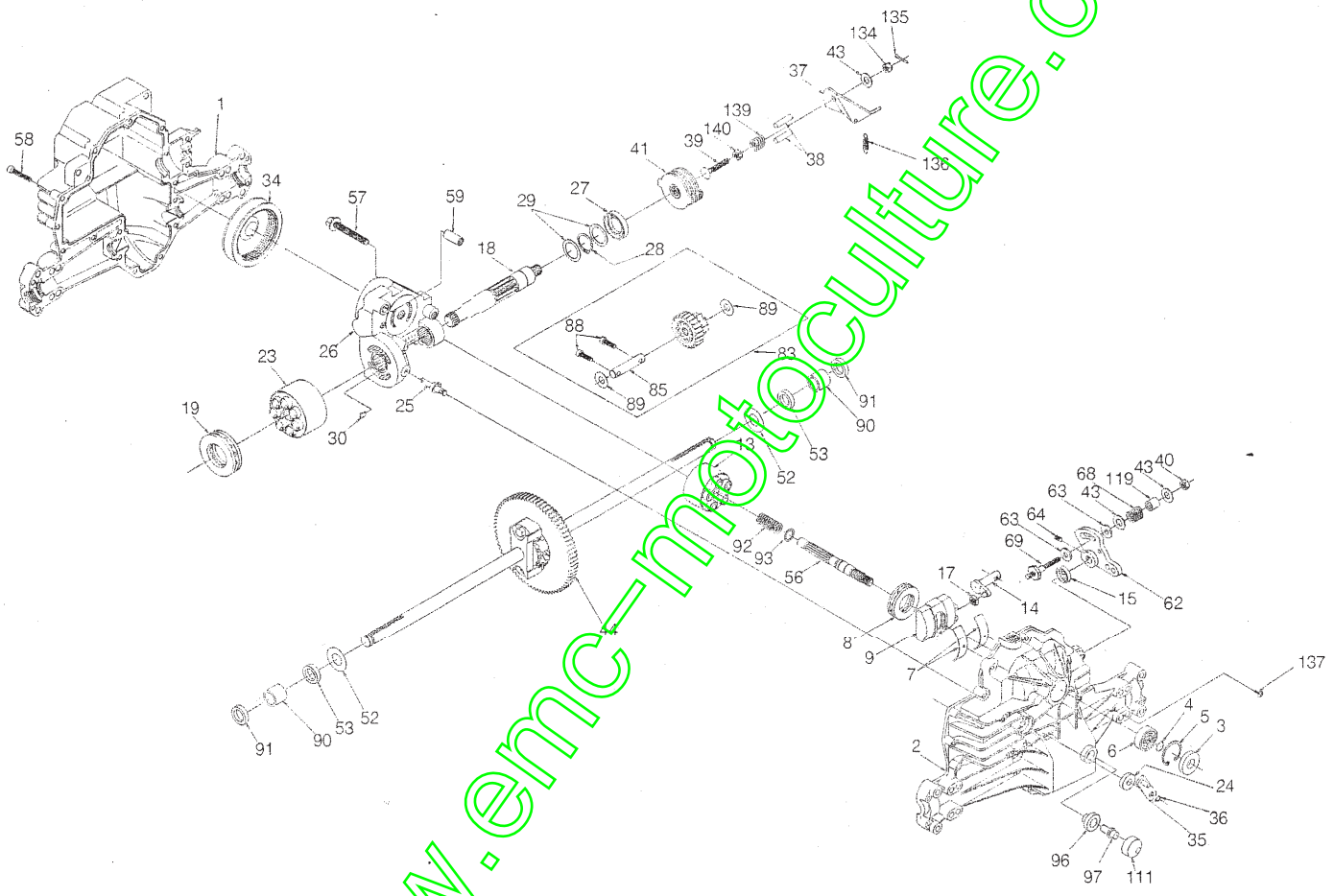

REPAIR PARTS

TRACTOR - - MODEL NUMBER 917.259462

HYDRO GEAR TRANSAXLE - MODEL NUMBER 331-0650

KEY PART NO. NO.	DESCRIPTION	KEY PART NO. NO.	DESCRIPTION
1 142930	RMHOUSING, LOWER	43 142884	WASHER - 7/16X7/8X0.060
2 169049	ASSEMBLY, UPPER HOUSING	44 150829	DIFFERENTIAL ASS'Y
3 142932	SEAL - LIP	52 142991	WASHER - 3/4X1.5X0.13
4 142928	RING - WIRE RETAINING	53 142961	SEAL - 0.75X1.25X0.250
5 142933	RING - RETAINING	56 142963	SHAFT - INPUT
6 142934	BEARING - SHAFT BALL	57 150797	BOLT - 3/8-24X2.5
7 142935	BEARING - CRADLE	58 142964	BOLT - 1/4-20X1.38
8 150771	BEARING - THRUST 30X52X13	59 142965	PIN - 0.5 ODX 0.43 IDX 0.750
9 142937	SWASHPLATE - VARIABLE	62 142966	ARM - CONTROL
13 169050	BLOCK - CYLINDER ASS'Y	63 142967	PLUCK - DAMPENER
14 149939	ARM - TRUNNION	64 142920	SET SCREW
15 142940	SEAL - LIP	68 142969	SPRING
17 142941	GUIDE - SLOT	69 161134	5/16-24 STUD
18 150772	SHAFT - MOTOR	83 169053	JACK SHAFT/PINION GEAR
19 150773	BEARING - THRUST 42X68X16	85 150806	JACK SHAFT
23 142944	BLOCK - CYLINDER (MOTOR)	88 142973	CAPSCREW 6MX20 LG
24 142945	SEAL - LIP 10X25X7	89 142974	WASHER 7/16X1X0.5
25 142946	ACTUATOR - BYPASS	90 142975	SLEEVE BEARING
26 169051	CENTERSECTION ASS'Y	91 169054	SEAL - LIP 0.75X1.00X0.158
27 142948	SEAL - LIP 26X42X8	92 142977	SPRING - BLOCK
28 142949	RING - RETAINING	93 142978	WASHER - BLOCK THRUST
29 142950	WASHER - 26X35X1	96 169055	BUSHING - VENT
30 150787	BYPASS PLATE	97 169056	VENT
34 142951	OIL FILTER ELEMENT	111 169057	VENT
35 142952	ARM - BYPASS	119 142980	SPACER
36 142953	RING - RETAINING	134 142885	CASTLE NUT - 5/16-24
37 169052	ARM - BRAKE	135 142886	COTTER PIN
38 142955	PIN - ACTUATING	136 169058	EXTENSION SPRING
39 150777	BOLT - 5/16-18X1-3/4	137 161175	SCREW - 10-32X1/2
40 150778	NUT - HEX LOCK 5/16-24 UNIC	139 150775	COMPRESSION SPRING
41 142958	BRAKE ROTOR/STATOR KIT	140 150776	NUT - HEX 5/16-18

NOTE: All component dimensions given in U.S. inches
1 inch = 25.4 mm