

www.emc-motoculture.com

Item	Part number	#	Description I	Description II
1	918-0609D	1	SPDL ASM:PUL:6.482 DIA x.5625	RIEMENSCHIEBE
2	712-0417A	1	NUT:FLG:5/8-18	FINISH:MTD STD 701-01000
3	741-0919A	2	BRG:BALL:.787IDx1.85ODx.551	FINISH:
4	736-0315	1	WASH:FLAT:0.755x1.515x0.120	FINISH:STD SPEC-100015
5	738-1128	1	SHFT:SPDL: 6.58" LG	FINISH:GEÖLT
6	750-1000	3	SPCR:0.797 X 1.100 X 1.330	FINISH:GEÖLT
7	756-1218	1	PUL:DECK:6.482 DIA X .5625 DIA	Ø6.482xØ.5625:FINISH SIEHE ZG.

www.emc-motoculture.com

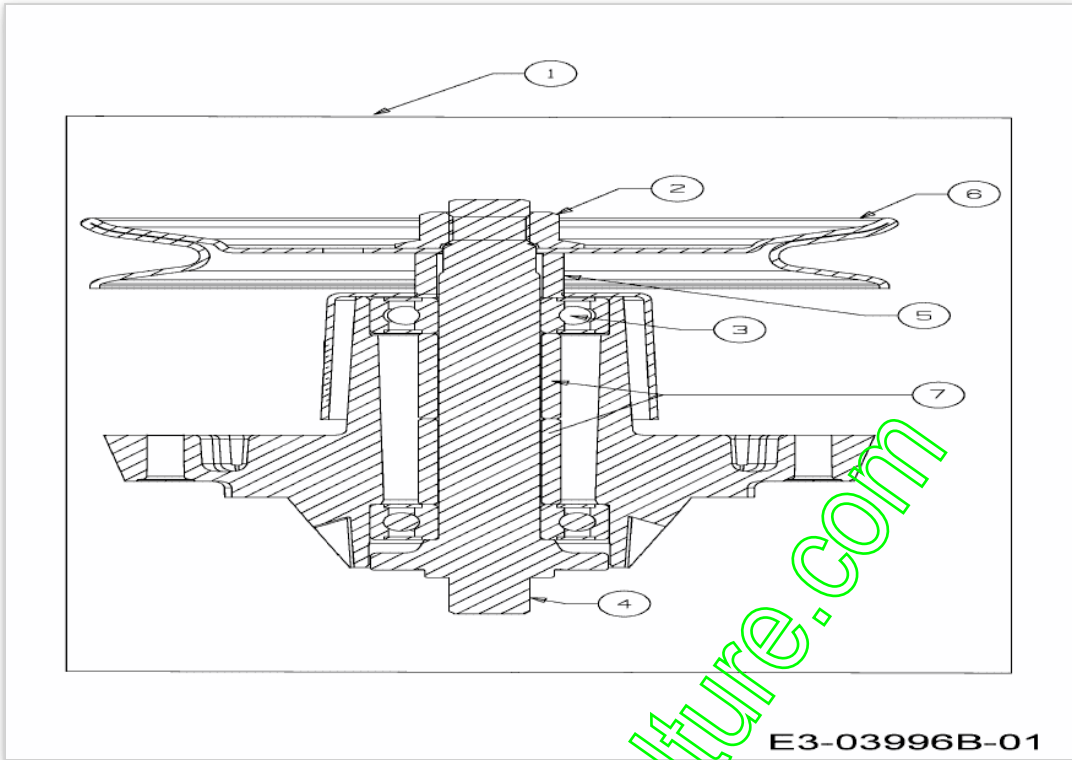

www.emc-motoculture.com

Item	Part number	#	Description I	Description II
1	918-04657A	1	SPDL ASM:PUL:5.37 DIA	KEILRIEMENSCHLEIBE 6.3 DIA
2	712-0417A	1	NUT:FLG:5/8-18	FINISH:MTD STD 701-01000
3	741-0919A	2	BRG:BALL: .787IDx1.85ODx.551	FINISH:
4	738-1010A	1	SHFT:SPDL:5.75 LG	FINISH:GEÖLT 618-0324A
5	748-04302	1	SPCR: .820 x 1.150 x .690 LG	FINISH:GEÖLT
6	756-1227	1	PUL:DECK:6.3 DIA	FINISH:SIEHE ZG.
7	750-1000	2	SPCR:0.797 X 1.100 X 1.330	FINISH:GEÖLT

www.emc-motoculture.com

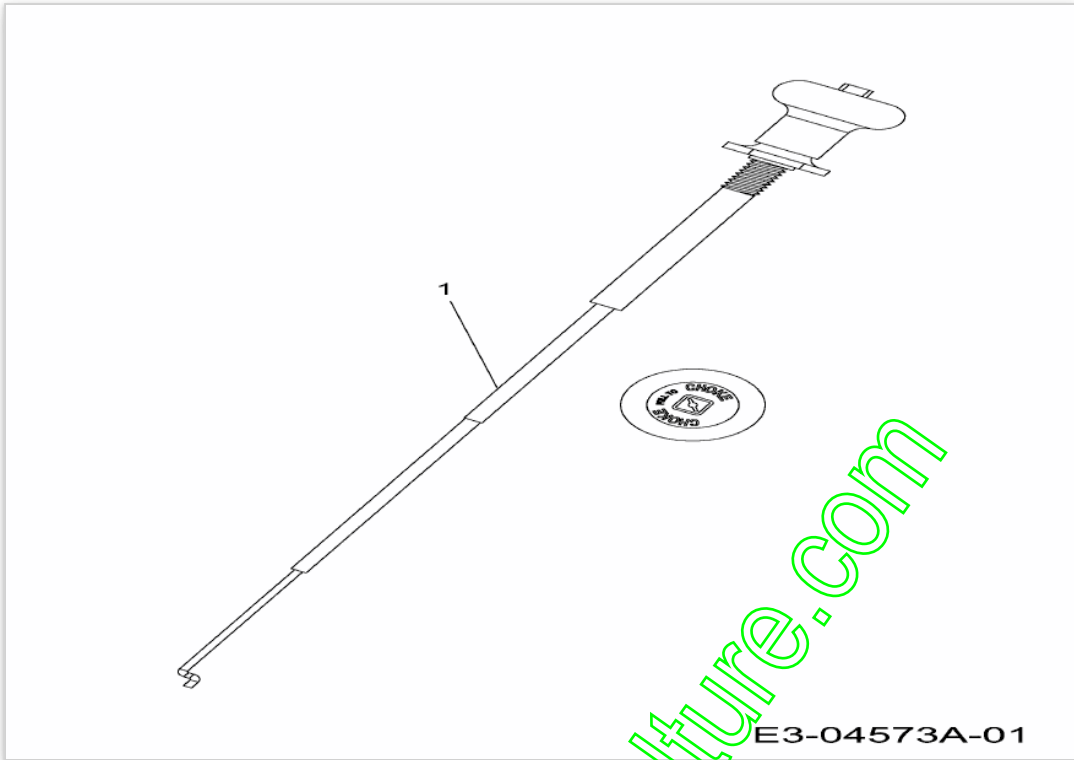

E3-04573A-01

www.emc-motoculture.com

Item	Part number	#	Description I	Description II
1	746-04120	1	KNOPF:CUB YELLOW	KNOPF:CUB YELLOW

www.emc-motoculture.com

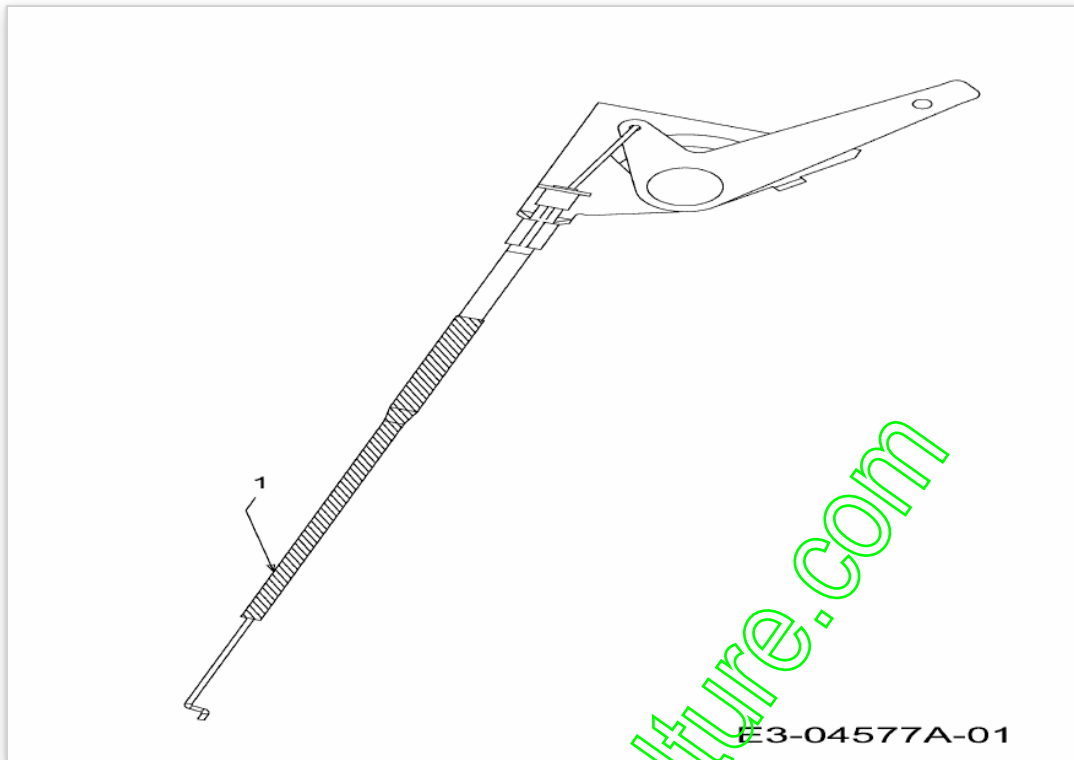

E3-04577A-01

www.emc-motoculture.com

Item	Part number	#	Description I	Description II
1	746-1100	1	CBL:THROT:38,0" LG x 1,62 EXT	MIT HEBEL

www.emc-motoculture.com

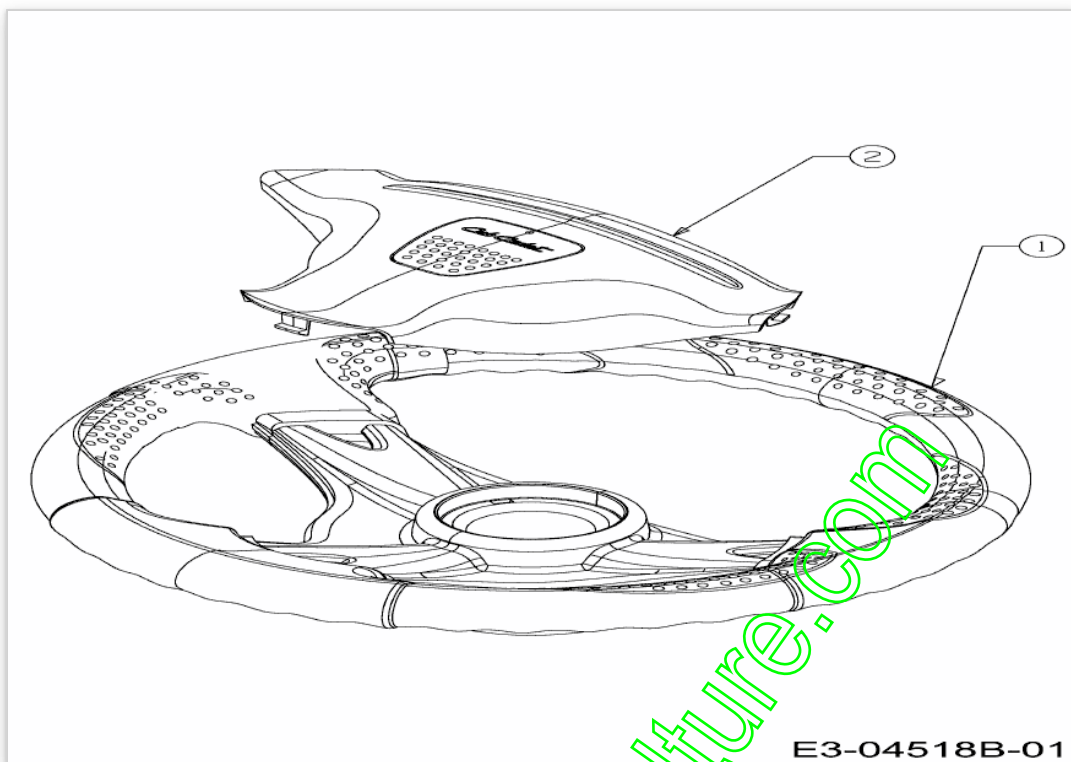

www.emc-motoculture.com

E3-04518B-01

Item	Part number	#	Description I	Description II
1	631-04008A	1	WHL ASM:STRG:3 SPOKE:SOFTGRIP	SOFTGRIP
2	731-04532B	1	COVER STEERING WHEEL	FINISH:

www.emc-motoculture.com

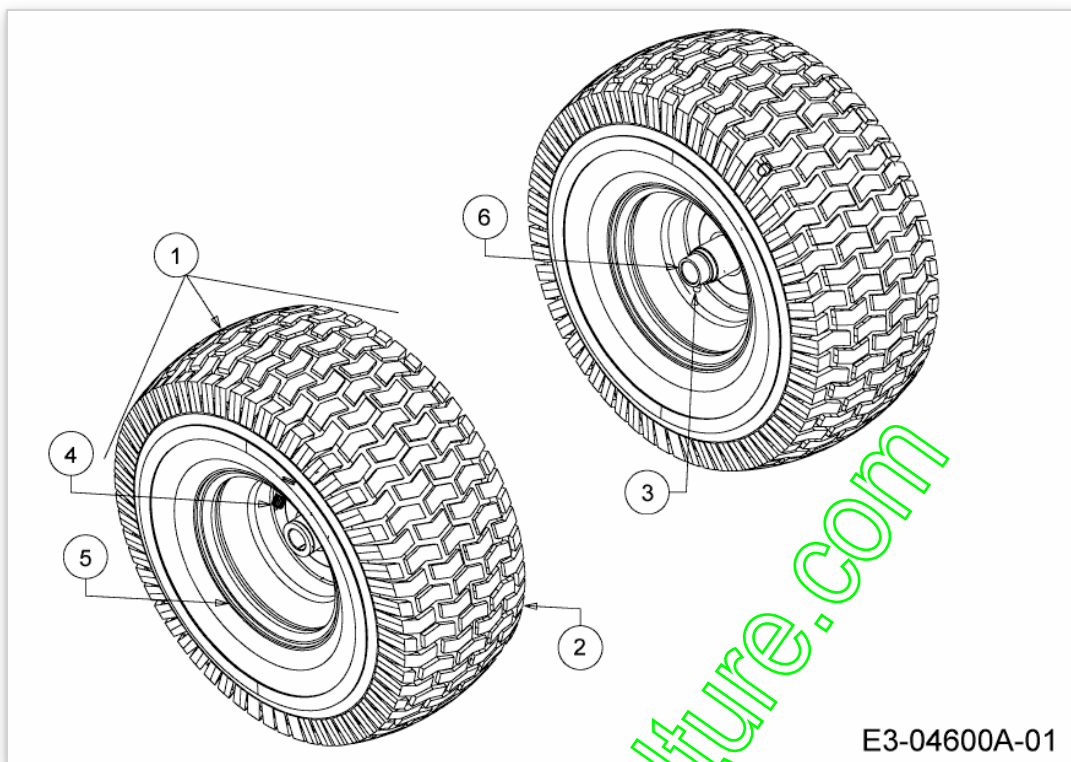

E3-04600A-01

www.emc-motoculture.com

Item	Part number	#	Description I	Description II
1	634-04199	2	WHL:COMP:15x6x6:BB	FINISH:NONE
2	734-1731	2	TIRE:15X6X6 SQ SHOULDER	FINISH:
3	737-0224	2	GREASE NIPPEL	FINISH:ZINC
4	734-0255	2	VALVE - TUBELESS AIR	TR 412-P / 32.6mm / 934-0255
5	634-04091	2	RIM ASM:6.0 x 4.5:BB	
6	741-04137	4	BALL BRG.	941-04137 *

www.emc-motoculture.com

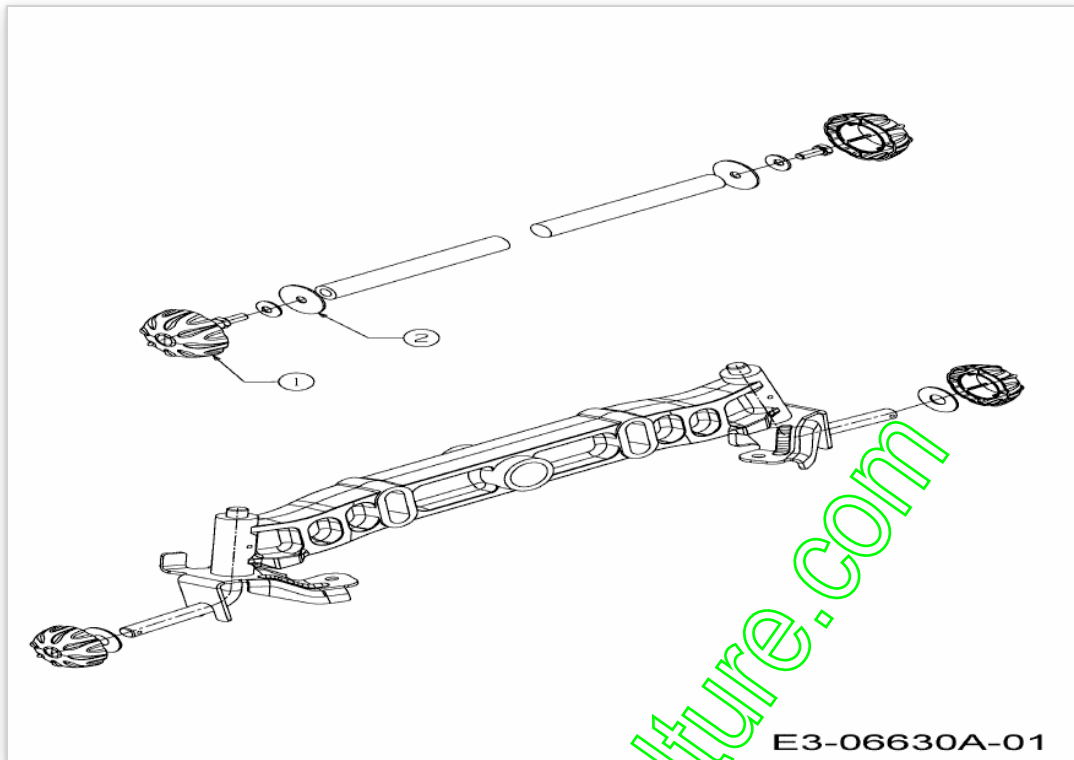

E3-06630A-01

www.emc-motoculture.com

Item	Part number	#	Description I	Description II
1	731-2290A	4	CAP:HUB	FINISH:KUNSTSTOFF SCHWARZ
2	736-0430	2	WASH:FLAT:0.345X1.595X0.062	FINISH:MTD SPEC-100015

www.emc-motoculture.com

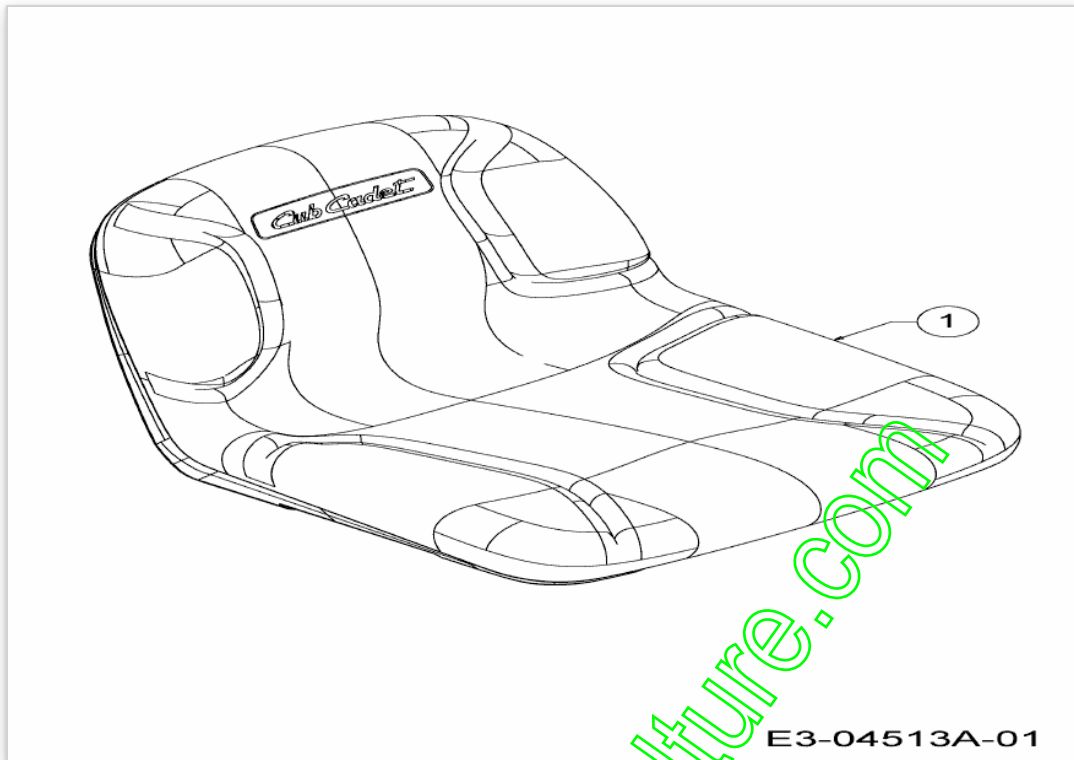

E3-04513A-01

www.emc-motoculture.com

Item	Part number	#	Description I	Description II
1	757-04091	1	SEAT:HIGH BACK:CUB:w/OPS	CUB CADET:FARBE SCHWARZ

www.emc-motoculture.com

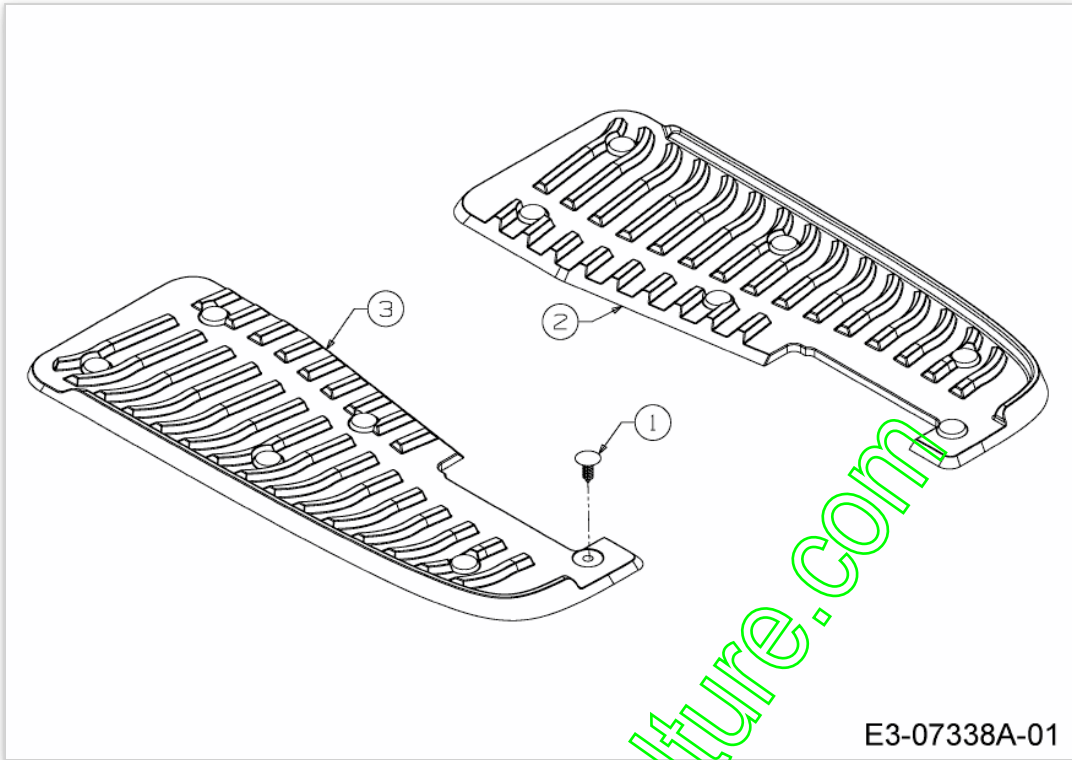

E3-07338A-01

www.emc-motoculture.com

Item	Part number	#	Description I	Description II
1	726-3046	12	MOUNTING CLIP:..250 DIA	FINISH:KUNSTSTOFF SCHWARZ
2	735-04137	1	PAD:FOOT:LH NX-9	FINISH:KUNSTSTOFF SCHWARZ
3	735-04157	1	PAD:FOOT:RH:NX-9 TRMNT	FINISH:KUNSTSTOFF SCHWARZ

www.emc-motoculture.com

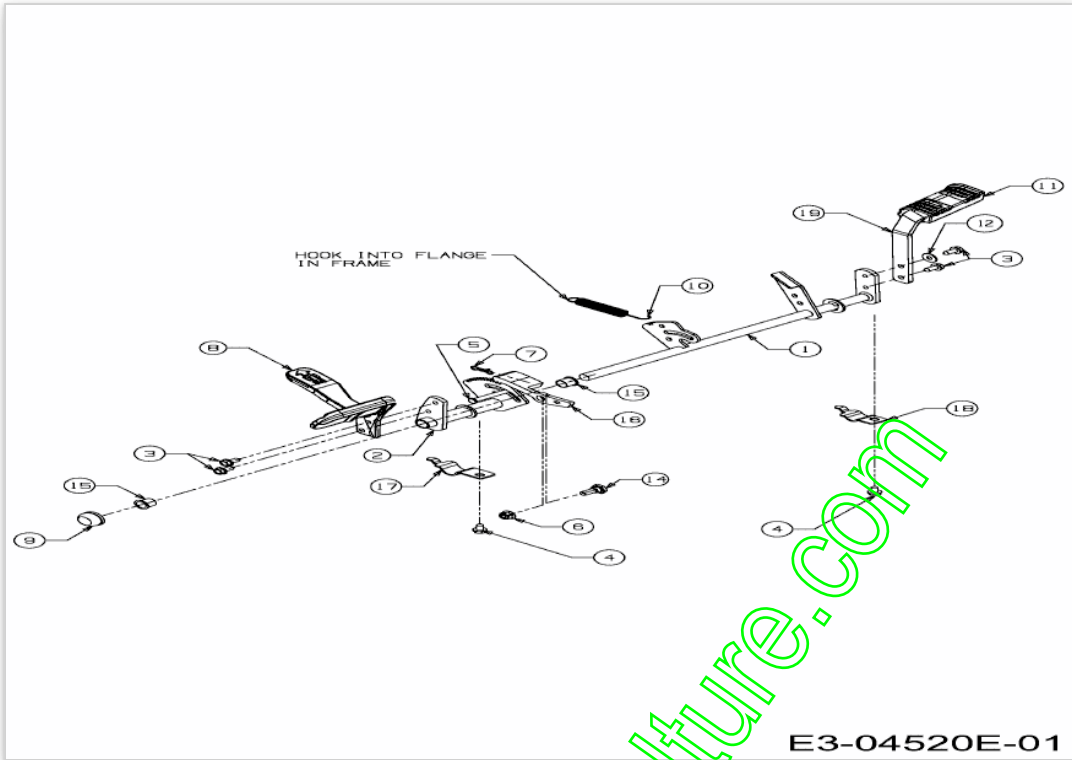

Item	Part number	#	Description I	Description II
1	647-04152D-Z	1	SHF ASM:NX9:PEDAL CVT TO BE	FINISH:GELB VERZINKT 701-01000
2	683-04537	1	BRKT ASM:PEDAL:HYDRO NON-CUB	SCHWEISSTEIL:683-04537-Z
3	710-04484	4	SCR:TT:5/16-9:0.75:HXINDWSH	FINISH:MTD SPEC-100016 TYPE 1
4	710-0604A	2	SCR:TT:5/16-18:0.63:HXINDWSH	FINISH:MTD SPEC-100016 TYPE 1
5	711-05068	1	PIN-CLEVIS:5/16 x 3.985	FINISH:MTD SPEC-701-01000
6	712-04065	1	NUT:FLGLK:3/8-16:GRF:NYLON	FINISH:SPEC-100015 912-04065
7	714-04040	1	PIN-COTTER	FINISH:ASTM F1941 FE/ZN 3AN
8	719-0584B	1	PED:CONT:HYDRO CUB 1500	FINISH:719-0584B-TW
9	726-0214	1	CAP:PUSH 5/8	FINISH:SCHWARZ
10	732-04587	1	SPR:EXTN:.63 DIA x 4.95 LG	SPEC-701-01006 or SPEC-100015
11	735-04136	1	PAD:PEDAL:BRAKE	FINISH:SCHWARZ:GUMMI
12	736-0242	1	WASH:BLVL:0.336 x 0.872 x0.060	FINISH:MTD SPEC-100016
14	738-0380	1	SCR:SHLDR:0.500 X 0.267:3/8-16	FINISH:SPEC-100015 938-0380
15	741-0495	2	BRG:FLG:.630 ID X .695 OD x.60	FINISH:KUNSTSTOFF WEISS
16	748-04203	1	LATCH:CRUS	FINISH:GEÖLT
17	783-05914	1	BRKT:SUPT:PEDAL STRAP	FINISH:BLAU CHROMATIERT *
18	783-05940	1	BRKT:SUPT:PEDAL STRAP 5/8	FINISH:MTD SPEC-100015
19	783-06103A	1	BRKT:PED BRAKE	FINISH:LACKIERT MTD QUALITÄT *

www.ems-motoculture.com

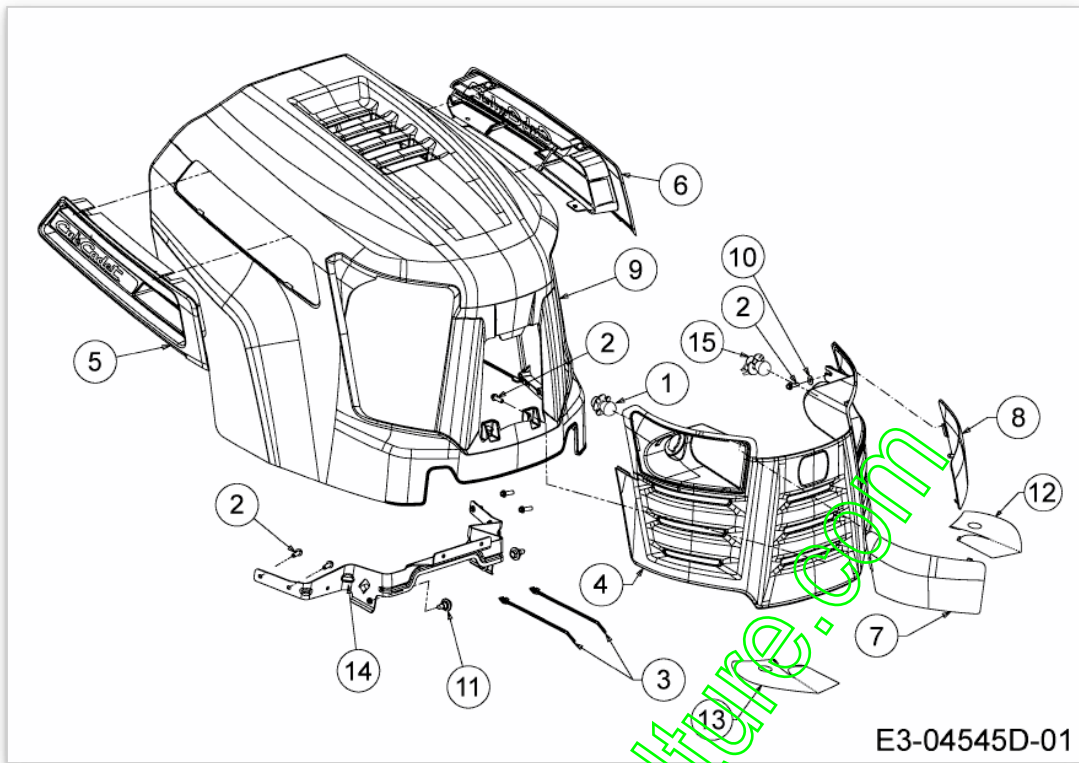

www.emc-motoculture.com

Item	Part number	#	Description I	Description II
1	725-0963	2	LAMP:#1156	FINISH:
2	710-05108	8	SCR:BOS:M6.3x2.2:0.75:HXINDWSH	FINISH:SPEC-000087
3	726-0154	2	TIE:CABLE:PUSH MOUNT 7.5 LG	FINISH:SCHWARZ
4	731-06541A	1	GRILL:A-STYLE	FINISH:SIEHE ZG.
5	731-06542B	1	SCP:HOOD:RH A-STYLE	KUNSTSTOFF SCHWARZ:500 CC
6	731-06543B	1	SCP:HOOD:LH A-STYLE	KUNSTSTOFF SCHWARZ:500 CC
7	731-06558	1	LENS:HOOD:RH A-STYLE	FINISH:KLAR
8	731-06559	1	LENS:HOOD:LH A-STYLE	FINISH:KLAR
9	731-06634	1	HOOD:A-STYLE	FINISH:SIEHE ZG. 931-06634
10	736-3020	2	SCHEIBE:FL:0.261 x0.640 x0.050	FINISH:MTD SPEC-100015
11	738-04091A	2	SCR:SHLDR:.43 x.29:TT:5/16-18	FINISH:SPEC-100016
12	777X44055	1	LBL:RDR:CUB A STY EMBSD REFL L	LINKE SEITE:CUB CADET A-STYLE
13	777X44056	1	LBL:RDR:CUB A STY EMBSD REFL R	RECHTE SEITE:CUB CADET A-STYLE
14	783-06114	1	BRKT:HOOD:PIVOT A-STYLE	FINISH:783-06114-0637
15	725-1649	2	SOC:LAM: 1/4 TURN	GRAU KUNSTSTOFF

www.emc-motoculture.com

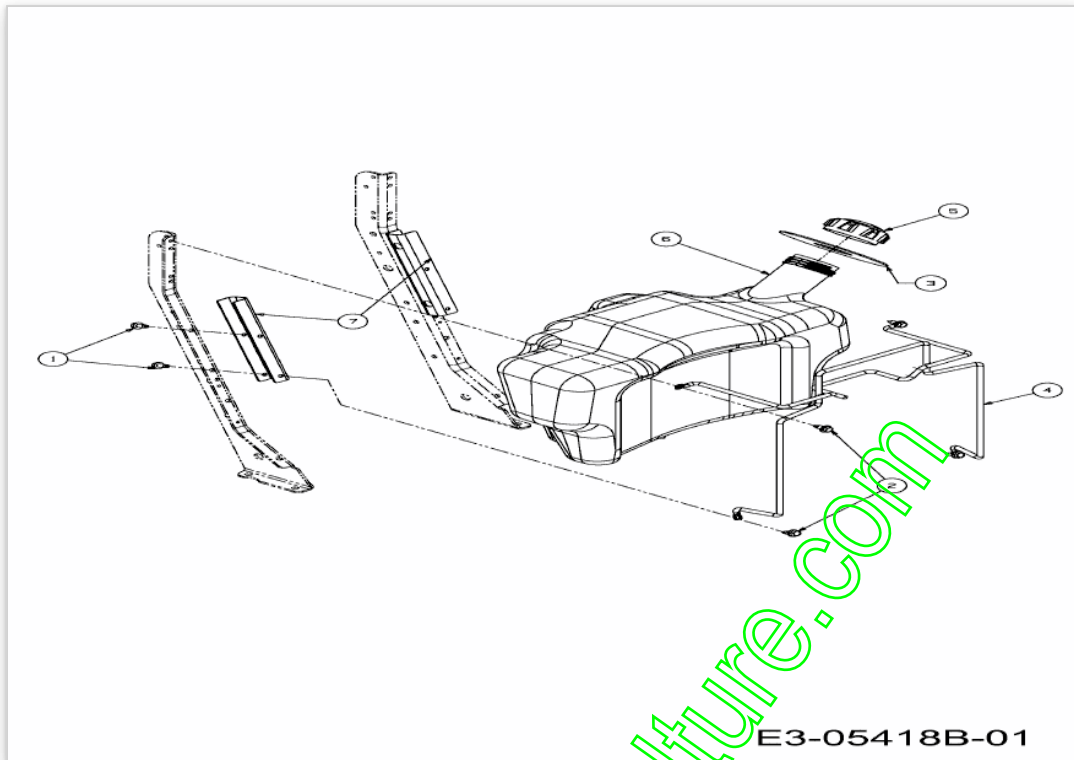

www.emc-motoculture.com

Item	Part number	#	Description I	Description II
1	710-0599	4	SCREW:TT:1/4-20:0.500:HXINDWSH	FINISH:SPEC-100016 TYPE 1
2	710-1652	4	SCR:TT:1/4-20:0.62:HXINDWSH	FINISH:MTD-SPEC-100016 TYPE 1
3	735-04170	1	GASKET:FUEL TANK 3.75 GAL	FINISH:SCHWARZ
4	747-05042	1	ROD:SUPT:FUEL TANK 2.60	FINISH:LACKIERT
5	751-0603A	1	CAP:FUEL	FINISH:KUNSTSTOFF SCHWARZ
6	751-10573	1	TANK:FUEL:2,75 GAL	FINISH:NATUR
7	783-06116A	2	BRKT:TANK:2.75 GAL	FINISH:LACKIERT

www.emc-motoculture.com

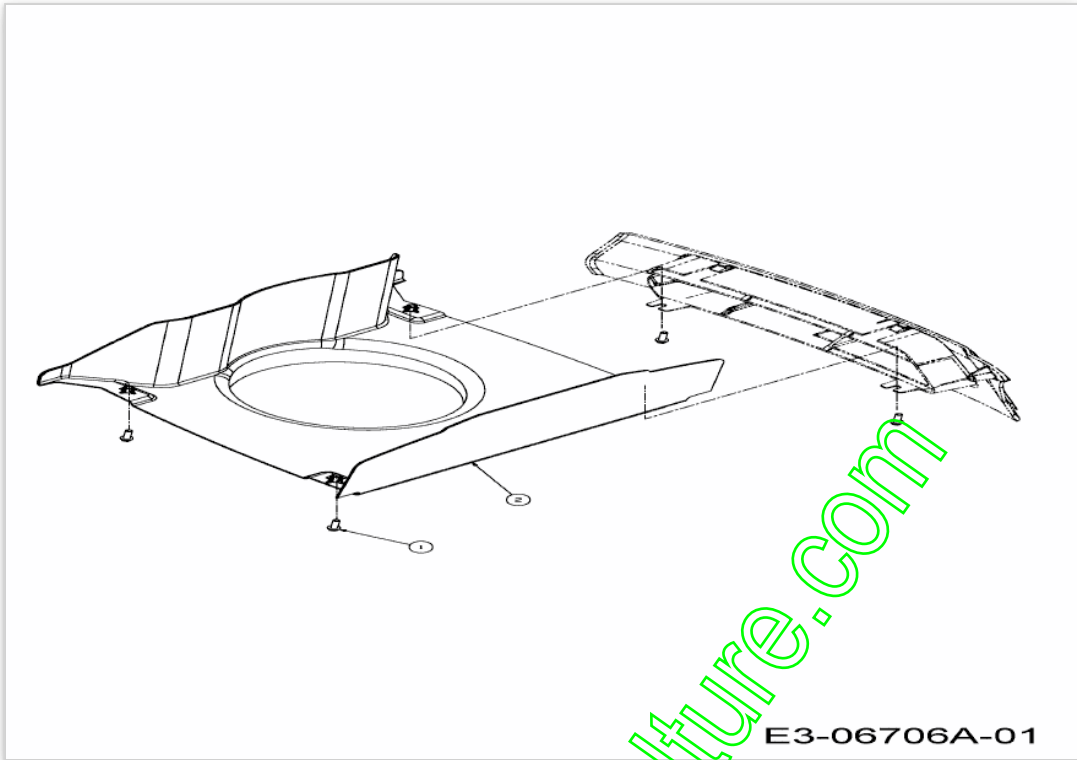

www.emc-motoculture.com

Item	Part number	#	Description I	Description II
1	710-05108	4	SCR:BOS:M6.3x2.2:0.75:HXINDWSH	FINISH:SPEC-000087
2	731-06936	1	PLEN:A-STYLE:KAWA BRIGGS TWIN	FINISH:SCHWARZ

www.emc-motoculture.com

bis 30.06.2013
to 30.06.2013
jusqu'au 30.06.2013

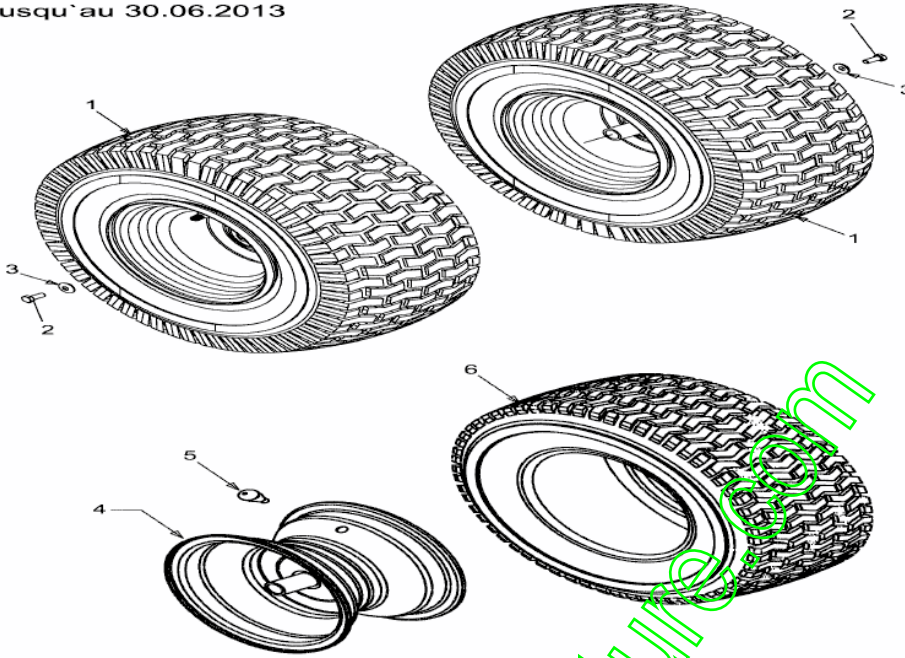

E3-03793A-01

www.emc-motoculture.com

Item	Part number	#	Description I	Description II
1	634-0104	2	WHL:COMP:20.0x8.0x8.0:SQSH	SIEHE FARBVARIANTEN
2	710-0627	2	HHCS:5/16-24:0.75:GR5:LOCK	FINISH:MTD SPEC-100015
3	736-0242	2	WASH:BLVL:0.336 x 0.872 x0.060	FINISH:MTD SPEC-100016
4	634-04369	2	RIM ASM:8.0 x 7.0 x.750 ID	FINISH:LACKIERT
5	734-0255	2	VALVE - TUBELESS AIR	TR 412-P / 32.6mm / 934-0255
6	734-1596	2	TIRE-TUBELESS 2	BLOCK TURF PRO: RND SHL

www.emc-motoculture.com

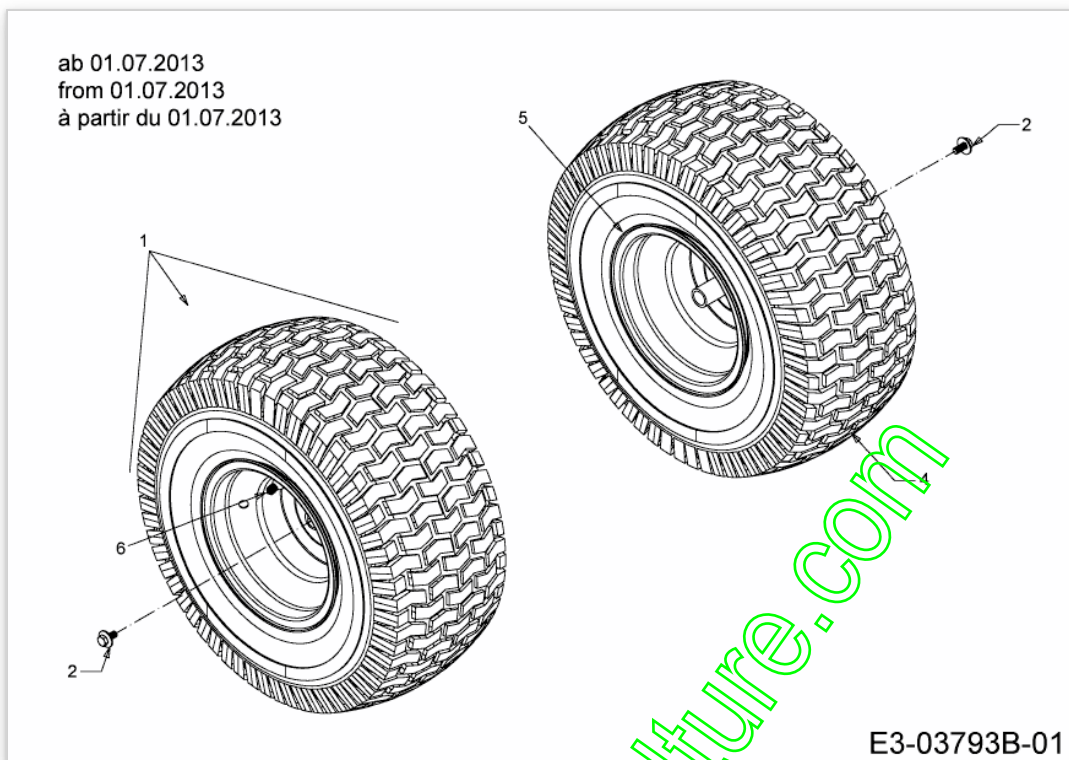

Item	Part number	#	Description I	Description II
1	634-0104	2	WHL:COMP:20.0x8.0x8.0:SQSH	SIEHE FARBVARIANTEN
2	710-05339	2	SCR:SEMS:5/16-24:.750:GR5	GR5 E-TEIL-SET
4	734-1730	2	TIRE:20x8x8 SQ SH	734-1730-0902, Profil:ST50
5	634-04369	2	RIM ASM:8.0 x 7.0 x.750 ID	FINISH:LACKIERT
6	734-0255	2	VALVE - TUBELESS AIR	TR 412-P / 32.6mm / 934-0255

www.emc-motoculture.com

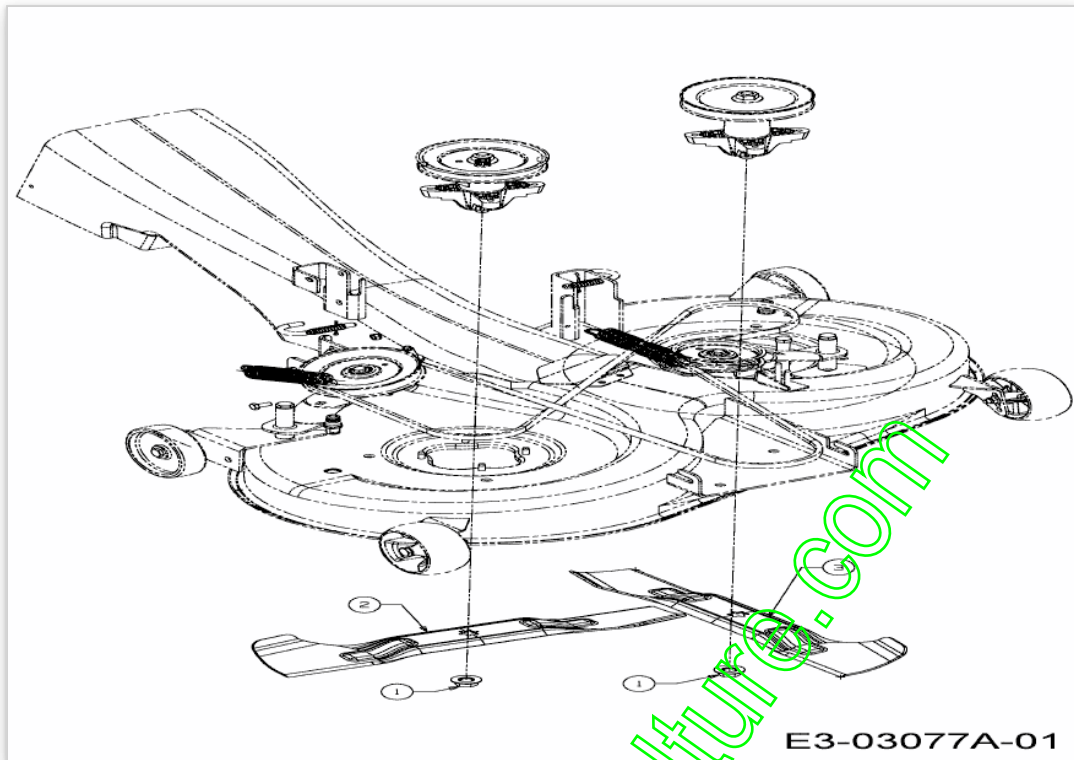

E3-03077A-01

www.emc-motoculture.com

Item	Part number	#	Description I	Description II
1	712-0417A	2	NUT:FLG:5/8-18	FINISH:MTD STD 701-01000
2	742-0670A	1	BLADE:RH:21.240 LG:STAR BAG	STAR BAG:FINISH HITZEBEHANDELT
3	742-0671A	1	BLADE:LH:21.240 LG:STAR BAG	STAR BAG:FINISH HITZEBEHANDELT

www.emc-motoculture.com

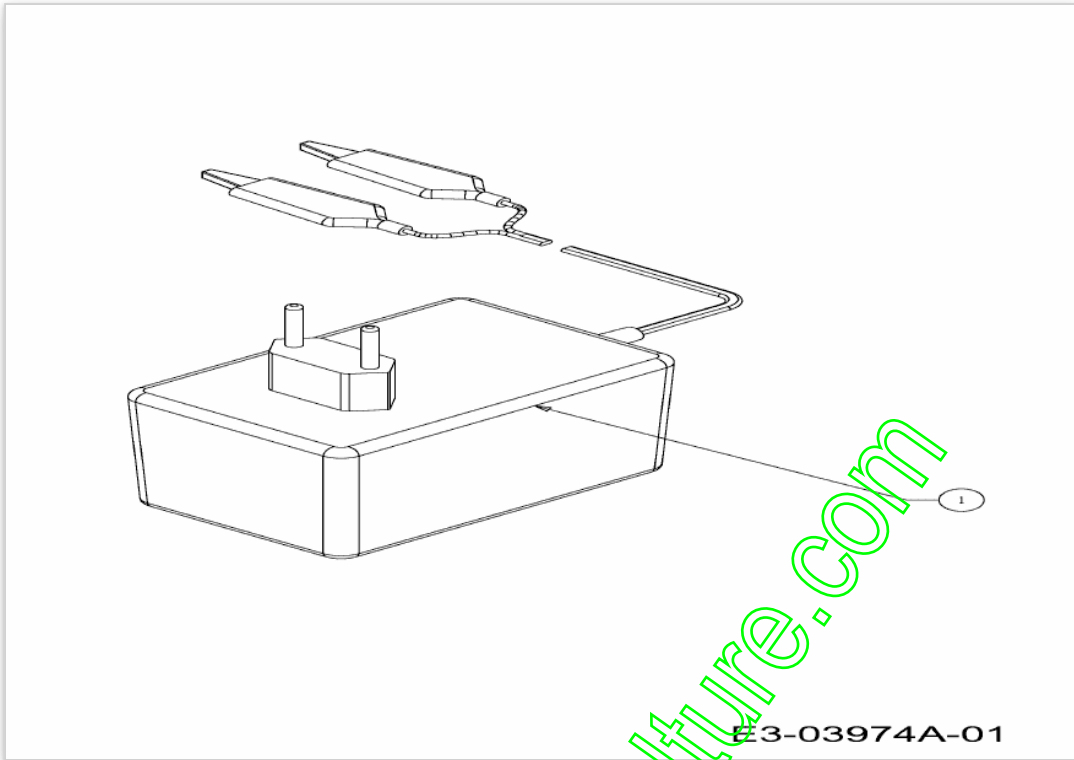

E3-03974A-01

www.emc-motoculture.com

Item	Part number	#	Description I	Description II
1	725-04683	1	CHRGR:BAT	TECHNISCHES DATENBLATT

www.emc-motoculture.com

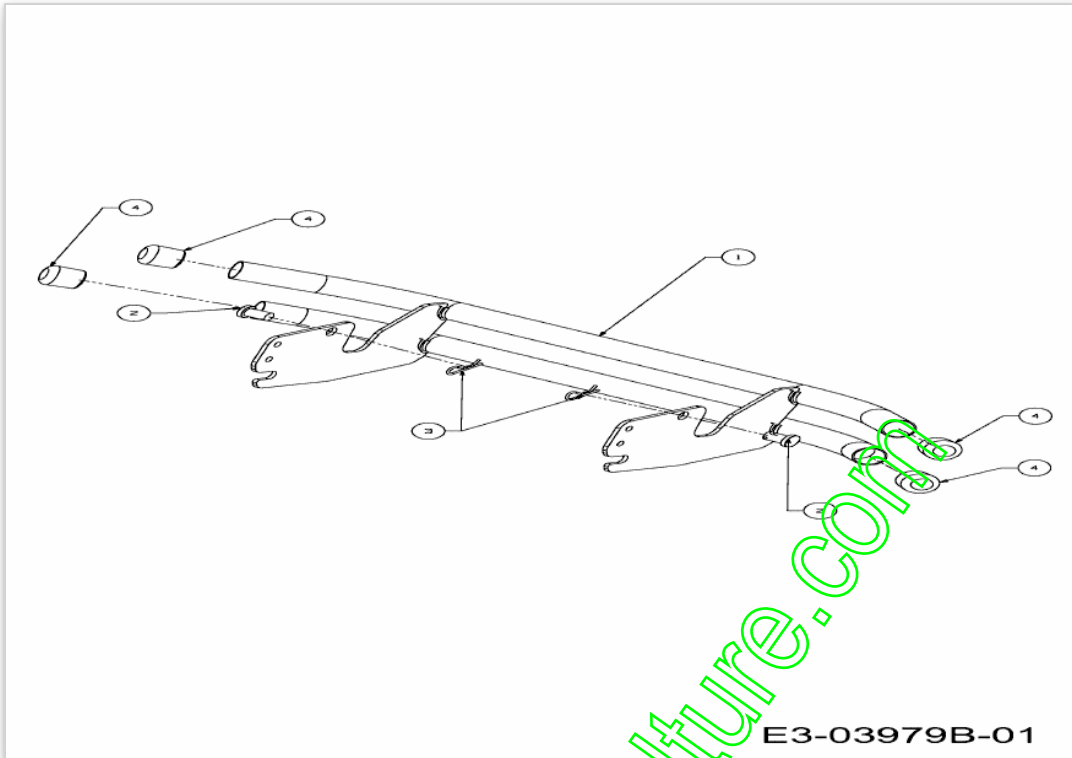

E3-03979B-01

Item	Part number	#	Description I	Description II
1	683-04457	1	BMPR ASM:FRT:500 DBL TUBE	SCHWEISSTEIL:LACKIERT
2	711-0332	2	PIN:CLV:.50 DIA x.78 LG	FINISH:701-01000
2	714-0145	2	PIN:CLICK:.092 x 1.64 LG	FINISH:SPEC-100016
4	731-04500	4	CAP BUMPER	500 SERIES:K 28 S:SCHWARZ

www.emc-motoculture.com

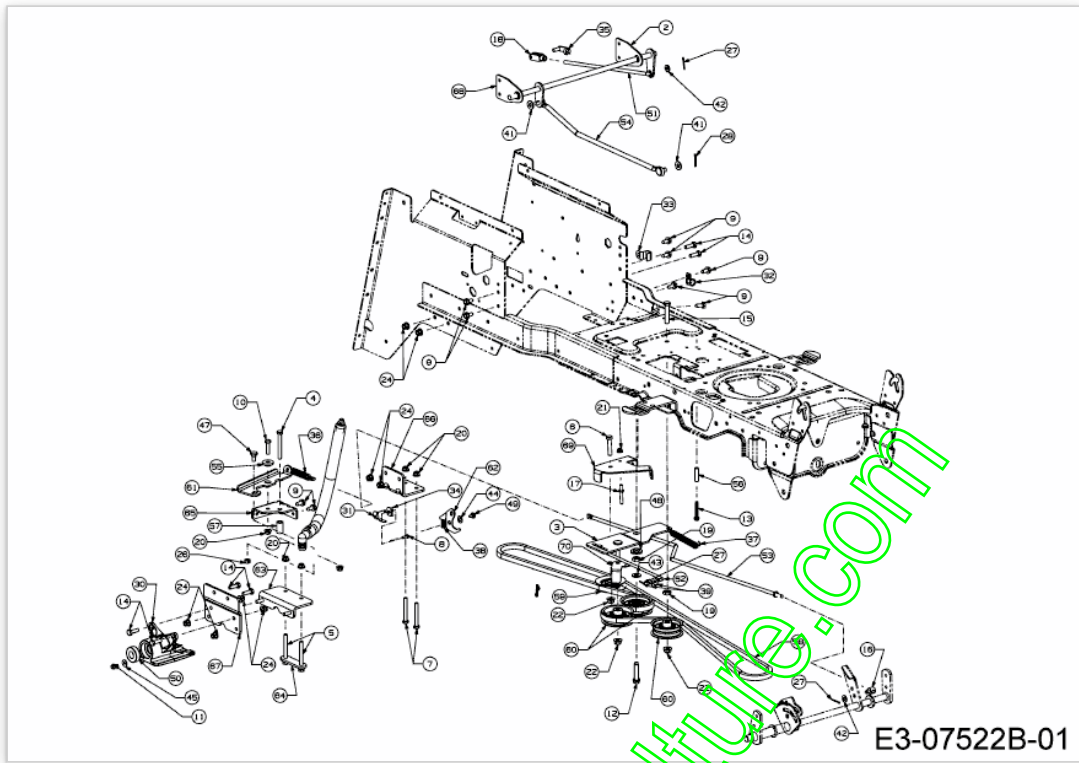

www.emc-motoculture.com

Item	Part number	#	Description I	Description II
2	647-04183	1	ROD ASM:CONT:HYDRO	FINISH:SPEC-100015 *
3	683-04586	1	BRKT ASM:IDLER:HYDRO	FINISH:SPEC-100015/683-04586-Z
4	710-0176	1	HHCS:5/16-18:2.75:GR5:STD	(21.1441.82)FINISH:SPEC-100015
5	710-0189	2	HHCS:5/16-18:3.00:GR5:STD	FINISH:SPEC-100015 910-0189
6	710-0347	1	HHCS:3/8-16:1.75:GR5:STD	FINISH:MTD SPEC-100015
7	710-0378	2	HHCS:5/16-18:2.50:GR5:STD	FINISH:MTD SPEC-100015
8	710-0436	1	SCR:B:#10-16:0.625:HEX	FINISH:MTD STANDARD 701-01002
9	710-04484	9	SCR:TT:5/16-9:0.75:HXINDWSH	FINISH:MTD SPEC-100016 TYPE 1
10	710-0528	1	HHCS:5/16-18:1.25:GR5:STD	FINISH:SPEC-100015 910-0528
11	710-0599	1	SCREW:TT:1/4-20:0.500:HXINDWSH	FINISH:SPEC-100016 TYPE 1
12	710-1008	1	SCR:TTSEMS:3/8-16:1.875:HXLWSH	FINISH:MTD STD 701-01002
13	710-1026	1	SCREW:TT:1/4-20:1.750:HXINDWSH	FINISH:MTD-SPEC-100016
14	710-1682	8	SCR:M8-1:25.00 LG:DIN 933	FINISH:SPEC-100015 21.1441.72
15	710-3144	1	HHCS:3/8-16:2.00:GR5:STD	FINISH:SPEC-100015 910-3144
16	711-0677	1	FERRULE:5/16-18 x.312 DIA	FINISH:GELBVERZINKT SIEHE ZG.
17	711-0993	1	PIN:BELT GUARD:1/4 x 1.43	FINISH:701-01006 911-0993
18	711-1407	1	FRL:M8-32 x 18 DIA DIN 71752	Zn5glcB 9S20K 28.6218.17
19	712-0240	2	NUT:JAM:7/16-20:GR2	FINISH:MTD SPEC-100015
20	712-04063	6	NUT:HEXFLGLK:5/16-18:GRN5:NYL	FINISH:SPEC-100015
21	712-04064	1	NUT:FLGLK:1/4-20:GRN5:NYLON	FINISH:SPEC-100015 912-04064
22	712-04065	3	NUT:FLGLK:3/8-16:GRF:NYLON	FINISH:SPEC-100015 912-04065
23	712-0690	1	NUT:HEX:M8-1.25:CL8:DIN 934	FINISH:SPEC-100015 24.1421.18
24	712-0714	8	NUT:FLGLK:M8-1.25 DIN 6926	FINISH:MTD SPEC-100015
25	712-3007	1	NUT:JAM:5/16-18:GR5	FINISH:MTD SPEC-100015
26	712-3009	1	NUT:HEXLK:5/16-18:GRB:CTRLK	FINISH:STD 701-01000 912-3009
27	714-0111	3	COTTER PIN 3/32 DIA X 1.00	FINISH:MTD SPEC-100015
28	714-0115	1	PIN:COT:SPLIT:1/8 X 1.0	FINISH:MTD SPEC-100015
29	714-04040	1	PIN-COTTER	FINISH:ASTM F1941 FE/ZN 3AN
30	719-0534	1	SUPT:CSTG	FINISH:PLAIN
31	725-04834	1	SPRING SWITCH	FINISH:SPEC-100015
32	726-0272	1	CLAMP 9/16 DIA (FUEL HOSE)	FINISH:VERZINKT
33	726-0354	1	CLAMP 16mm	FINISH:GLANZVERZINKT
34	726-04089	1	PLT:INSL:SW	FINISH:NATUR ODER SCHWARZ
35	726-0457	1	S-BOLT: M8-32 DIN 71752	9S20K 25.9425.12
36	732-0716D	1	SPR:EXTN: .59 OD x 4.00 LG	FINISH:MTD STD 701-01006
37	732-0814	1	SPR:EXTN: .56 DIA x 5.52 LG	FINISH:SIEHE ZG.

Item	Part number	#	Description I	Description II
38	732-0891A	1	SPRING: BRAKE	RDF 2020 ROSTFREI
39	736-0173	2	WASH:FLAT:0.276x0.749x0.063	FINISH:MTD SPEC-100015
40	736-0258	1	WASHER:FLAT:.385 x 1.0 x.135	FINISH:MTD 701-01000 936-0258
41	736-0262	2	WASK:FLAT:.385 x.870 x.092	FINISH:MTD STD 701-01000
42	736-0275	2	WASH:FLAT:0.339 x0.703 x0.065	FINISH:MTD SPEC-100015
43	736-0300	1	WASH:FLAT:0.396X0.885X0.060	FINISH:MTD SPEC-100015
44	736-0314	1	WASH:THRST:0.378x0.700x0.030	FINISH:MTD SPEC-100016
45	736-0685	1	WASH:FLAT:6.4 IDX18OD DIN 9021	MTD SPEC 100015 24.6486.16
47	738-0140	1	SCR:SHLD:.435 X.178-5/16X.56	FINISH:VERZINKT
48	738-0347	1	SPCR:SHLDR:0.381X0.625X0.169	FINISH:
49	738-04375	1	SCR:SHLDR:.375 x.25 AB 1/4-14	FINISH:SIEHE ZG.
50	741-0998	1	BRG:BALL:19mm x 40mm OD x 12mm	400er HYDRO GETRIEBE
51	747-05148	1	ROD:CONT:HYDRO	FINISH:SPEC-100015
52	747-05376	1	ROD:CONT:HYDRO	FINISH:MTD SPEC-100015
53	747-05541	1	ROD:BRAKE:HYDRO	FINISH:MTD SPEC-100015
54	747-05543	1	ROD:LINK:HYDRO DR	FINISH:MTD SPEC-100015
55	748-0331	1	SPCR:SHLDR:.625 DIA x.324 DIA	FINISH:GEÖLT
56	750-04456	1	SPACER:0.255 x 0.376 x 1.420	FINISH:MTD SPEC-100015
57	750-05141	1	SPCR:16mm OD x 10mm ID x29mm	FINISH:MTD STD SPEC-101616
58	754-04304	1	BELT:V TYP:A x 106.0 LG POLY	POLY
59	756-0236	1	PUL:IDLER:V TYPE 3.06 OD	SCHWARZ LACKIERT ODER VERZINKT
60	756-04224	3	PUL:IDLR:FLAT 2.75 OD	BLK ECOAT,PAINT OR SPEC-100015
61	783-06218	1	BRKT:BRAKE:HYDRO:TT	FINISH:783-06218-Z
62	783-06228	1	BRKT:SW:HYDRO:TT 500	FINISH:783-06228-Z
63	783-06317	1	BRKT:MT:TRANS:HYDRO TT	HYDRO TT:FINISH LACKIERT
64	783-06318637	1	PLT:MT:TRANS:HYDRO:TT	FINISH:LACKIERT
65	783-06470	1	BRKT:MT:TORQUE:HYDRO:TT	FINISH:LACKIERT
66	783-06727	1	BRKT:MT:TRANS	FINISH:LACKIERT
67	783-06728	1	BRKT:MT:TRANS	FINISH:LACKIERT
68	783-06729	1	BRKT:MT:CONT	FINISH:MTD SPEC-100015 *
69	783-06736	1	BRKT:MT:IDLER	FINISH:LACKIERT MTD QUALITÄT
70	783-07422	1	BRKT:KEEPR:DR	FINISH:783-07422-Z

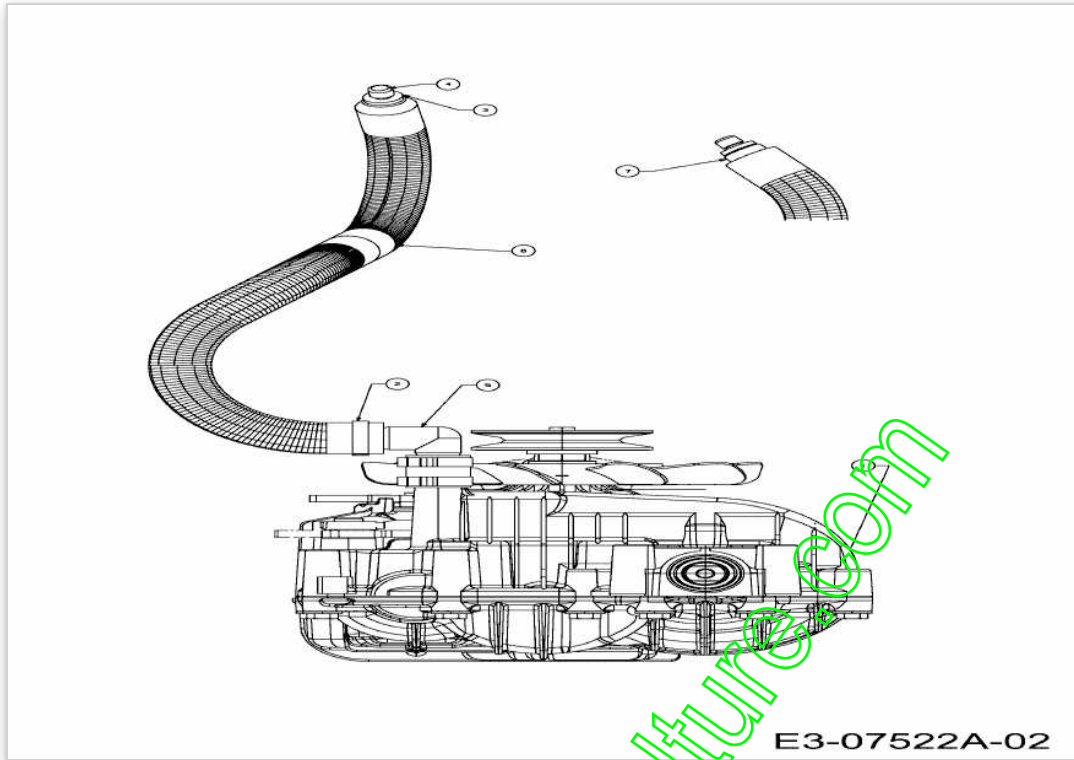

www.emc-motoculture.com

Item	Part number	#	Description I	Description II
1	918-04905	1	TRANS ASM:HYDRO w/EXPAN TUBE	MIT AUSDEHNUNGSSCHLAUCH
2	726-04112	1	CLAMP:HOSE:1.0625" DIA	FINISH:NO
3	731-1480	1	PLASTIC VENT FOR .50 ID HOSE	FINISH:
4	731-1481	1	PLASTIC VENT CAP	FINISH:ROT
5	737-04280	1	FTG:ELBOW:3/4 BARB	FINISH:PP SCHWARZ
6	751-11252	1	HOSE:EXPANSION	FINISH:KLAR INCHES
7	751-3141	1	HOSE:EXTN:OIL DRAIN	13 X 3:FINISH KLAR METERWARE

www.emc-motoculture.com

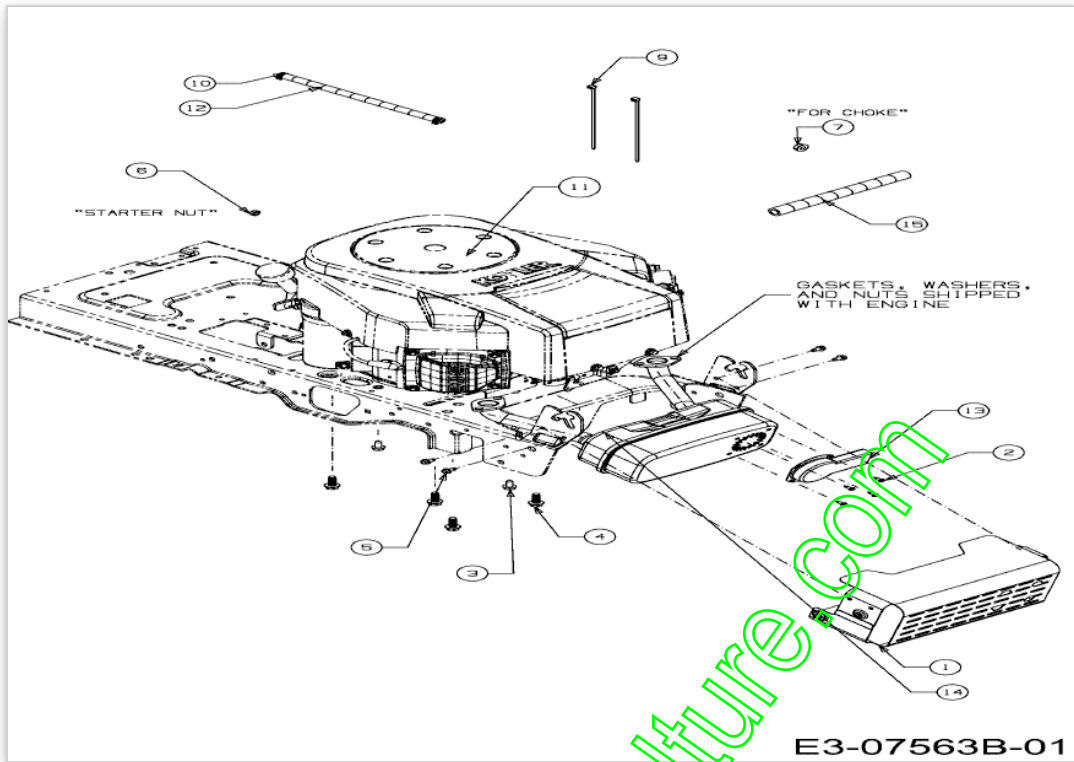

Item	Part number	#	Description I	Description II
1	683-04549	1	SHLD ASM:MFLR w/WELD	SCHWEISSTEIL:FINISH LACKIERT
2	710-0227	4	SCR:AB:#8-18:0.50:HXINDWH	FINISH:MTD SPEC-100016 TYPE 1
3	710-04484	2	SCR:TT:5/16-9:0.75:HXINDWSH	FINISH:MTD SPEC-100016 TYPE 1
4	710-1007	4	SCR:TT:SEMS:3/8-16:1.63:HXLWSH	FINISH:STD SPEC-100016
5	710-0599	4	SCREW:TT:1/4-20:0.500:HXINDWSH	FINISH:SPEC-100016 TYPE 1
6	712-0271	1	NUT:HEXKEPS:1/4-20:GR5	FINISH:MTD SPEC-100016 GR5
7	712-3005	1	NUT:HEXFLGLK:3/8-16:GR5:SERR	FINISH:SPEC-100015 912-3005
9	725-0157	2	CBL:TIE: 3/16 X .05 X 7.4	MATERIAL:NYLON-SCHWARZ
10	726-0205	2	CLAMP HOSE: .490 DIA	FINISH:PHOS UND GELB LACKIERT
12	751-0535	1	FUEL LINE HOSE BLACK	Ø12,7+/-5.84 / Ø6,35+/-0,41
13	751-11053A	1	DFL:MFLR:LONG EXHAUST	LANGER ABGASKANAL:ALUMINIZED
14	751-11471A	1	MFLR:TWIN:KAWASAKI 730CC	FINISH:
15	751-3141	1	HOSE:EXTN:OIL DRAIN	13 X 3:FINISH KLAR METERWARE

www.emc-motoculture.com

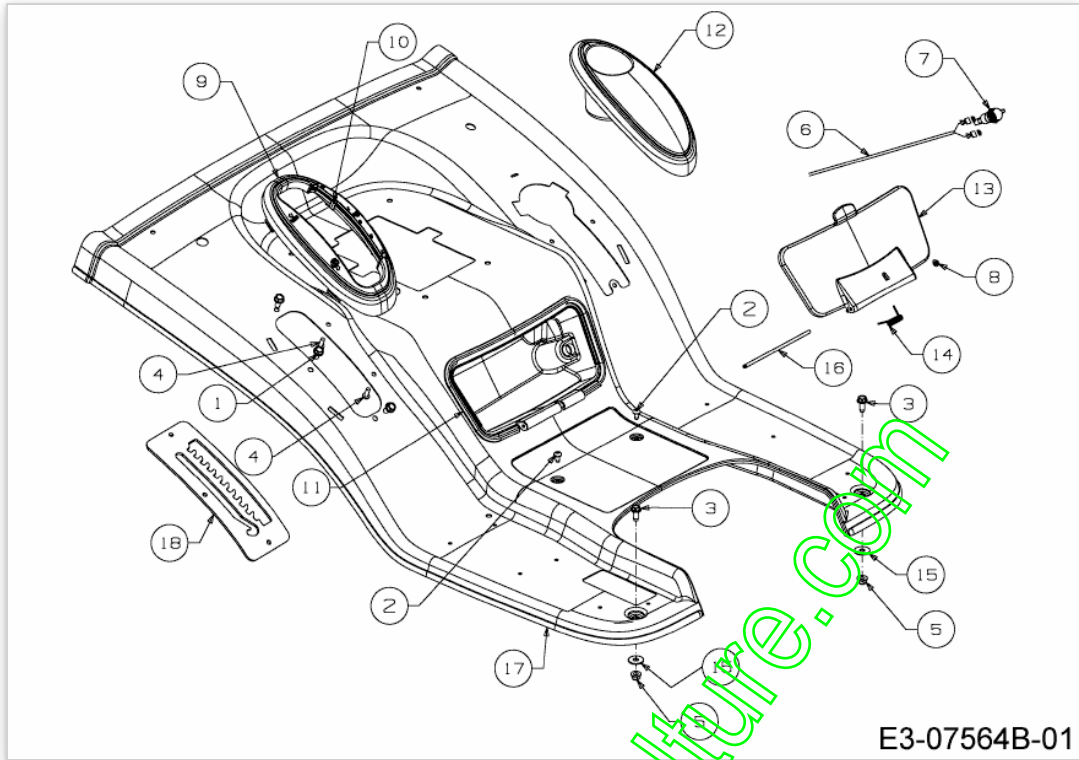

www.emc-motoculture.com

Item	Part number	#	Description I	Description II
1	710-04484	3	SCR:TT:5/16-9:0.75:HXINDWSH	FINISH:MTD SPEC-100016 TYPE 1
2	710-05070	2	SCR:TT:1/4-20:.5:PANTRXI:BLK	FINISH:SCHWARZ SPEC 701-01010
3	710-1260A	2	SCR:TT:5/16-18:0.750:HXINDWSH	FINISH:SPEC-100016 TYPE 1
4	710-1394	2	SREW:PLASTITE:KB 60X16 WN 1451	WN 1451 000.02.497
5	712-04063	2	NUT:HEXFLGLK:5/16-18:GRN5:NYL	FINISH:SPEC-100015
6	725-04518	1	HARN:500:PWR OUTL:FUSE BOX	SICHERUNGSKASTEN
7	725-2015	1	ELEC:POWER OUTLET	FINISH:
8	726-0111	1	CAP	FINISH:
9	731-07978	1	CVR:LIFT LEVER:500	FINISH:KUNSTSTOFF SCHWARZ
10	731-08707	1	CLIP:IND:DECK HT	FINISH:ROT *
11	731-2547	1	BOX TOOL	FINISH:KUNSTSTOFF SCHWARZ
12	731-2549	1	CVR:W/CUP HOLDER	FINISH:SCHWARZ
13	731-2561	1	COVER:TOOLBOX	FINISH:KUNSTSTOFF SCHWARZ
14	732-3150A	1	SPR:TORSN:.23 ID	FINISH:SIEHE ZG.
15	736-3078	2	WASH:FLAT:.344 x 1.00 x 063:HD	FINISH:701-01001
16	747-1307	1	ROD:PIVOT:TOOLBOX	FINISH:747-1307-Z
17	783-06405A	1		
18	783-07055A	1		

www.emc-motoculture.com

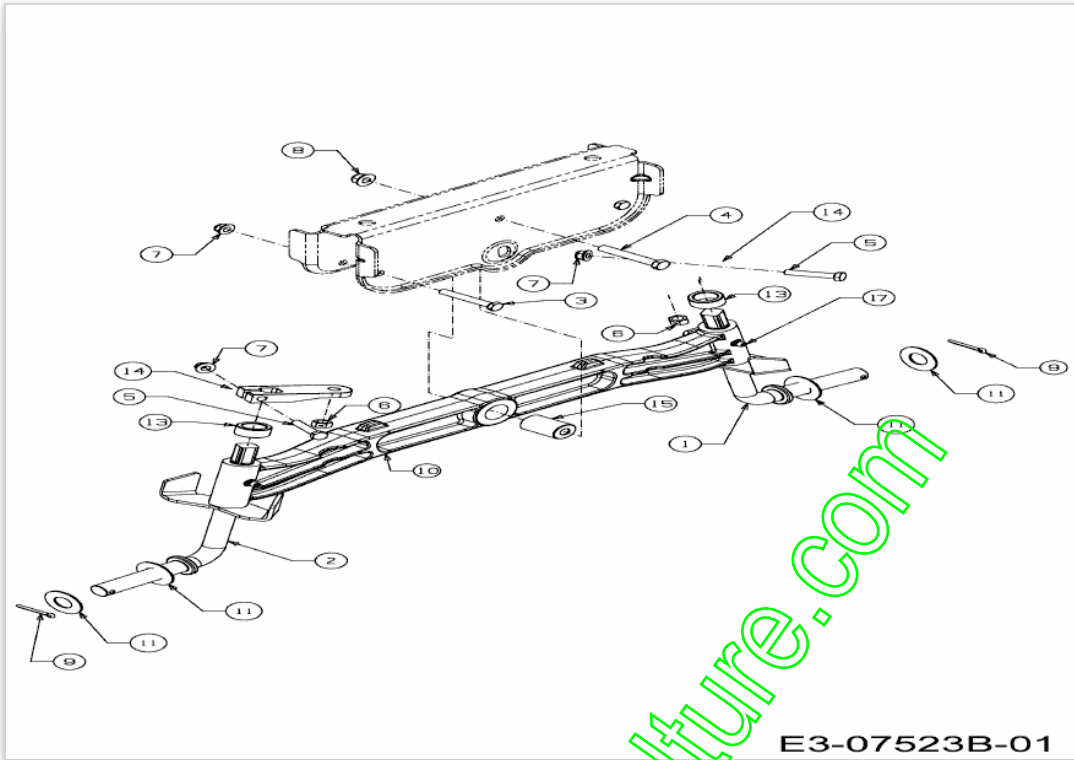

E3-07523B-01

www.emc-motoculture.com

Item	Part number	#	Description I	Description II
1	638-04042	1	AXLE ASM:LH:500	SCHWEISSTEIL:FINISH:LACKIERT
2	638-04043	1	AXLE ASM:RH:500	SCHWEISSTEIL:FINISH:LACKIERT
3	710-0395	2	SCRE.HHCS:5/16-18:2.25:GR2:STD	FINISH:MTD STD 701-01000
4	710-0859	1	SCREW HHCS:3/8-16:2.50:GR5:STD	FINISH:MTD STD 701-01000
5	710-3180	2	HHCS:5/16-18:1.75:GR5:STD	FINISH:SPEC-100015
6	712-0214	2	NUT:HEXLK:3/8-24:GRB:CTRLK	FINISH:SPEC-100015
7	712-04063	4	NUT:HEXFLGLK:5/16-18:GRN5:NYL	FINISH:SPEC-100015
8	712-04065	1	NUT:FLGLK:3/8-16:GRF:NYLON	FINISH:SPEC-100015 912-04065
9	714-0162	2	PIN-COTTER:5/32:1.25	FINISH:MTD SPEC-100015
10	719-04413A	1	AXLE:PIVOT:BAR:CAST	FINISH: SCHWARZ LACKIERT
11	736-0316	4	WASH:FLAT:0.761x1.595x0.060	FINISH:MTD SPEC-100015
13	748-04068	2	SPCR:.765X1.145X0.560	FINISH:SPEC-100015
14	748-04278ZW	2	STRG:BLOCK	FINISH:BLAU CHROMATIEREN
15	750-05280	1	SPCR:.385x1.00x1.5075	FINISH:ÖL IMPRÄGNIERT EXXON
17	737-3000	2	FTG:3/16:LNC:#70:DRIVE LUBE	GLEITMITTEL

www.emc-motoculture.com

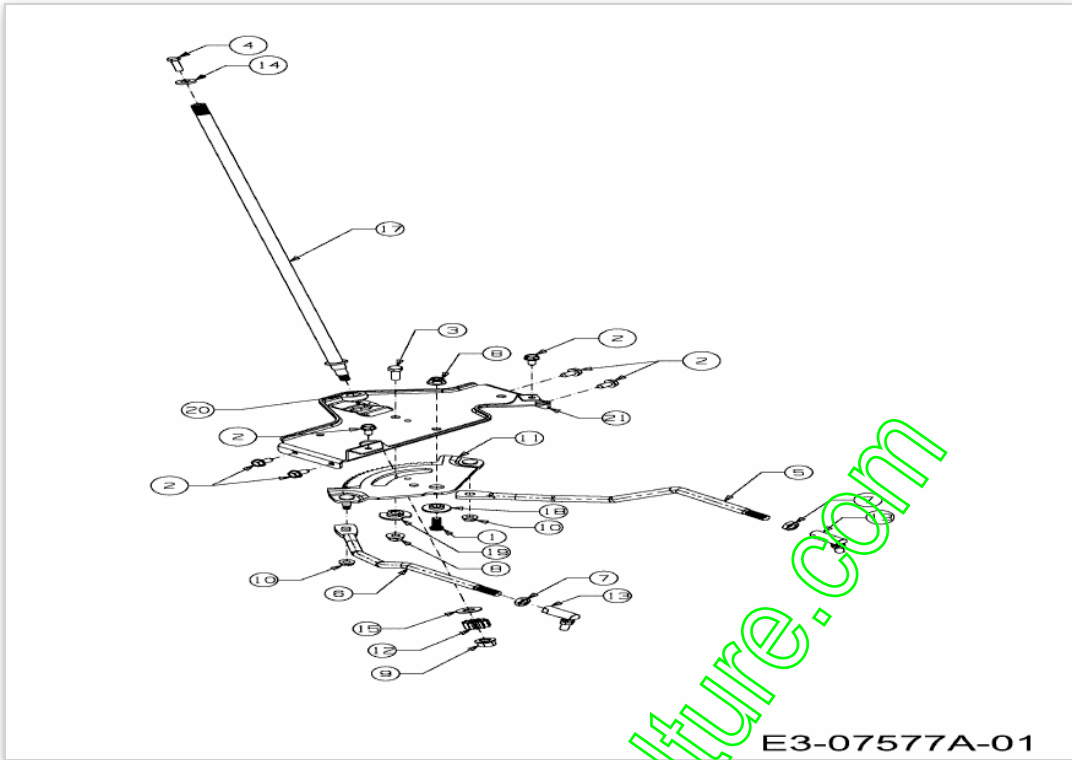

Item	Part number	#	Description I	Description II
1	710-04095	1	HHCS:3/8-16.1.00:GR5:SPEC	FINISH:MTD STD 701-01000
2	710-04484	6	SCR:TT:5/16-9:0.75:HXINDWSH	FINISH:MTD SPEC-100016 TYPE 1
3	710-0514	1	HHCS:3/8-16:1.00:GR5:STD	FINISH:MTD SPEC-100015
4	710-0643	1	HHCS:5/16-18:1.00:GR5:LOCK	FINISH:MTD SPEC-100015
5	711-04998	1	LINK-STRG DRAG LH	FINISH:MTD SPEC 701-01010 BLCK
6	711-04999	1	LINK-STRG DRAG RH	FINISH:MTD SPEC 701-01010 BLCK
7	712-0240	2	NUT:JAM:7/16-20:GR2	FINISH:MTD SPEC-100015
8	712-04065	2	NUT:FLGLK:3/8-16:GRF:NYLON	FINISH:SPEC-100015 912-04065
9	712-0459	1	NUT:FLGLK:7/16-20:GRB:LOCK	FINISH:MTD SPEC-101616
10	712-3004A	2	NUT:FLGLK:5/16-18:GR5:SD LK	FINISH:701-01000
11	717-1550F	1	GEAR:STRG:11/90 RATIO	FINISH:WIE ZUSAMMENGEBAUT
12	717-1554	1	GEAR:PINION:STRG	FINISH:GEÖLT
13	723-0448A	2	B/JNT:7/16-20:LOCK	FINISH:GELB VERZINKT
14	736-3004	1	WASH:FLAT:.406 x.875 x.105	FINISH:MTD STD 701-01000
15	736-3084	1	WASH:THRST:.510 X 1.120 X .060	FINISH:MTD STD 701-01001
17	738-04264	1	SHF:STRG:CUB 500 .625 x 24.8	FINISH:701-01006
18	738-04363	1	SPCR:SHLDR:.385x1.25x.3025	FINISH:GEÖLT
19	738-04364B	1	SPCR:.38 x 1.375:SPECIAL	FINISH:SPEC 701-01000
20	741-04237B	1	BRG:FLG:HEX 5/8 PM	FINISH:PLAIN
21	783-06043	1	BRKT:SUPPORT:STRG	FINISH:LACKIERT

www.emc-motoculture.com

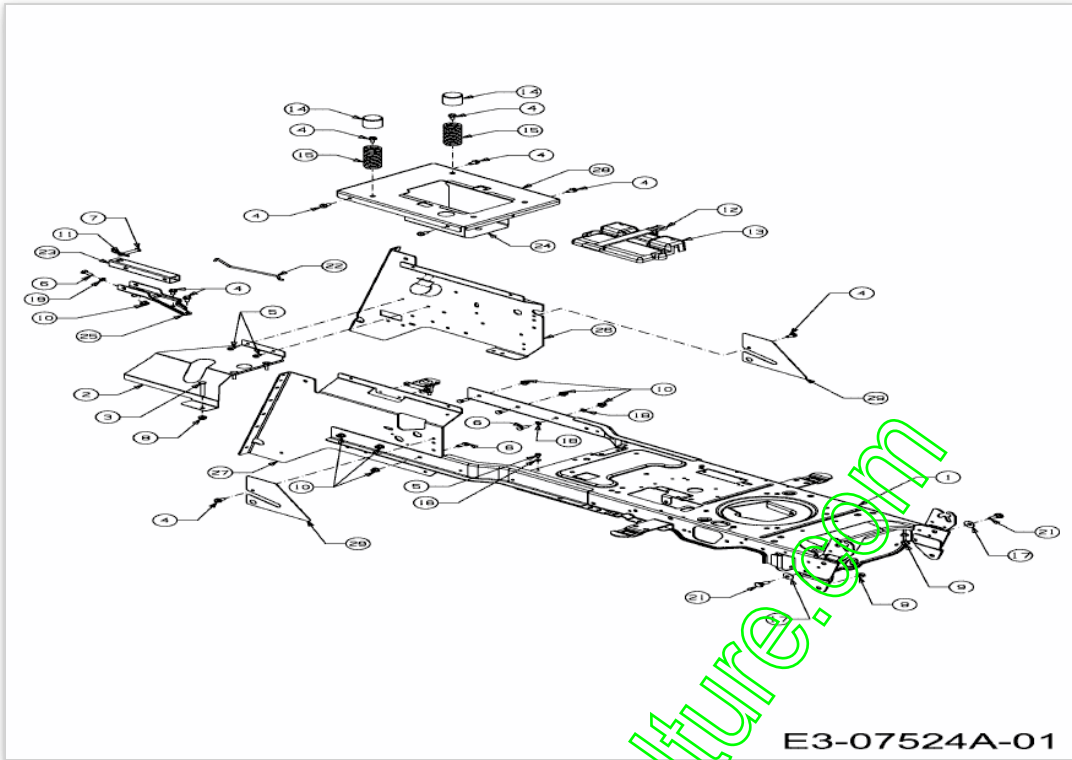

Item	Part number	#	Description I	Description II
1	683-04642	1	FRM ASM:500	SCHWEISSTEIL:FINISH LACKIERT
2	683-04709	1		
3	710-0378	1	HHCS:5/16-18:2.50:GR5:STD	FINISH:MTD SPEC-100015
4	710-04484	10	SCR:TT:5/16-9:0.75:HXINDWSH	FINISH:MTD SPEC-100016 TYPE 1
5	710-0599	3	SCREW:TT:1/4-20:0.500:HXINDWSH	FINISH:SPEC-100016 TYPE 1
6	710-1681	7	HHCS:M8-1.25:20.00:GR8.8:STD	MTD SPEC-100015 21.1441.70
7	711-0679A		PIN:CLEVIS:3/8 DIA x 2.015	FINISH:SIEHE ZG.
8	712-04063	1	NUT:HEXFLGLK:5/16-18:GRN5:NYL	FINISH:SPEC-100015
9	712-0431	2	NUT:FLGLK:3/8-16:GRF:TOP LK	FINISH:MTD SPEC-100015
10	712-0714	7	NUT:FLGLK:M8-1.25 DIN 6926	FINISH:MTD SPEC-100015
11	714-0147	1	PIN:COT.:125 x 1.75 INTERNAL	FINISH:SIEHE ZG.
12	723-0444	1	STRAP:BAT 400	FINISH:SCHWARZ
13	731-0707A	1	BATTERY COVER	FARBE:KUNSTSTOFF SCHWARZ
14	731-08616	2	CAP:SEAT SPR:1.5 ID	FINISH:KUNSTSTOFF SCHWARZ
15	732-04849	2	SPR:COMPRS:1.50 x 3.90 x.200	FINISH:701-01000(GELBVERZ.5óm)
16	736-0222	1	WASH:LOCK:1/4:EXTRN	FINISH:MTD STD 701-01001
17	736-0331	2	WASH:BELL:390 x 1.130 x.062	FINISH:MTD SPEC-100016
18	736-0607	2	WASH:LOCK:5/16 EXT	FINISH:MTD SPEC-100016
19	736-0700	1	WASH:FLAT:8.4 x 16 x 1.60	MTD SPEC-100015 24.6481.18
21	738-0380	2	SCR:SHLDR:0.500 X 0.267:3/8-16	FINISH:SPEC-100015 938-0380
22	747-05022A	1	POD:CONT:BY-PASS:HYDRO:TT	FINISH:VERZINKT SPEC-100015
23	749-04013A	1	TUBE:SQ 1 1/4x13 GA.x8.5 LG	30x30mmx179.39mm LG ST37:LACK
24	783-0349	1	TRAY:BATT:400	FINISH:LACKIERT SCHWARZ *
25	783-06180	1	BRKT:MT:HITCH:HYDRO:TT	FINISH:LACKIERT
26	783-06717	1	FRM:SIDE:RH 500	FINISH:PLAIN
27	783-06718	1	FRM:SIDE:RH 500	FINISH:PLAIN
28	783-07042	1		
29	783-07281	2		

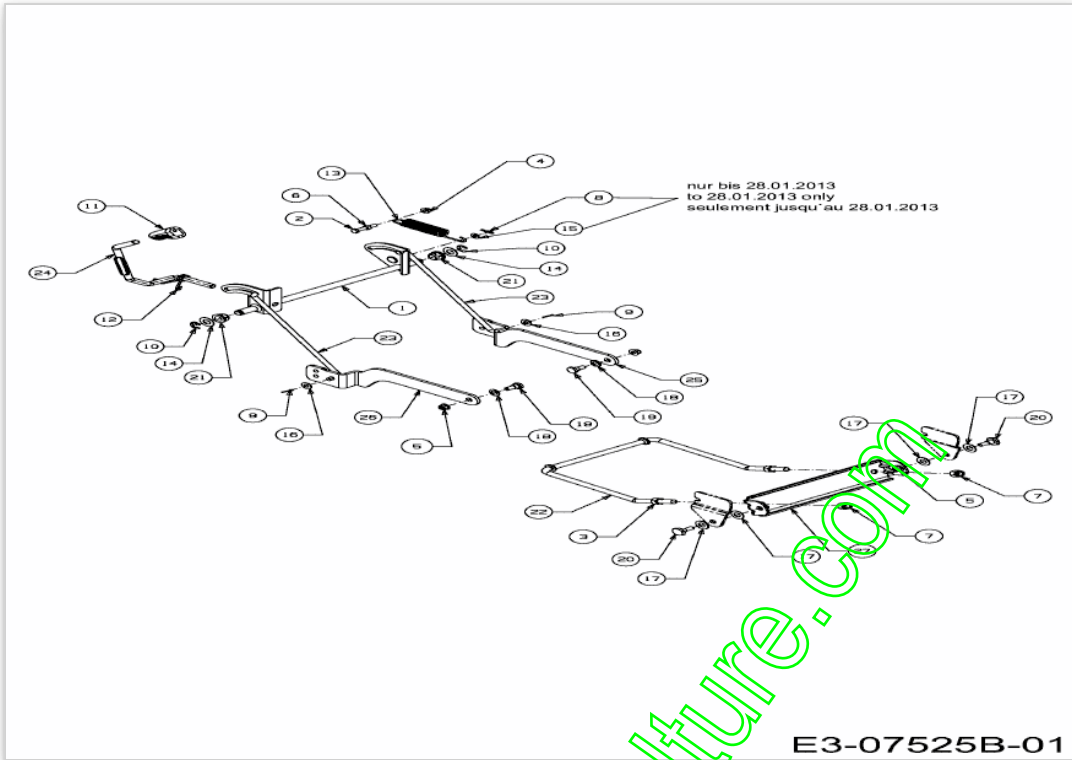

www.emc-motoculture.com

Item	Part number	#	Description I	Description II
1	683-04597	1	SHF ASM:LIFT	SCHWEISSTEIL:SPEC-100015
2	710-3180	1	HHCS:5/16-18:1.75:GR5:STD	FINISH:SPEC-100015
3	712-0206	2	NUT:HEX:1/2-13:GR5	FINISH:MTD SPEC-100015
4	712-04063	1	NUT:HEXFLGLK:5/16-18:GRN5:NYL	FINISH:SPEC-100015
5	712-04065	4	NUT:FLGLK:3/8-16:GRF:NYLON	FINISH:SPEC-100015 912-04065
6	712-3010	1	NUT:HEX:5/16-18:GR5	FINISH:MTD SPEC-100015
7	712-3083	2	NUT:HEXLK:1/2-13:GRC:NYLON	FINISH:MTD SPEC-100015
8	714-0104	1	PIN:COT:.072 DIA x 1.13 LG	FINISH:PHOS AND OIL
9	714-0111	2	COTTER PIN 3/32 DIA X 1.00	FINISH:MTD SPEC-100015
10	716-0106A	2	RING:E-TYPE:.625 DIA. SHAFT	FINISH:MTD SPEC-100016
11	720-0311	1	GRIP-HANDLE:1/2	FARBE: SCHWARZ VINYL
12	732-04884	1	SPR:TORSION:500 LIFT	FINISH:SPEC-100015
13	732-0971	1	SPR:EXTN:1.010 OD x 6.500 LG	FINISH:OIL & PHOSPHATE
14	736-0187	2	WASH:FLAT:0.630X1.250X0.060 HD	FINISH:MTD SPEC-100016
15	736-0275	1	WASH:FLAT:0.339 x0.703 x0.065	FINISH:MTD SPEC-100015
16	736-0300	2	WASH:FLAT:0.396X0.885X0.060	FINISH:MTD SPEC-100015
17	736-0414	4	WASH:FLAT:0.565X1.135X0.062:TE	FINISH:WEISS: 936-0414
18	736-3068	2	WASH:FLAT:.531 x .875 x .060	FINISH:MTD STD 701-01000
19	738-0143	2	SCR:SHLDR:.496 x .336:3/8-16	FINISH:MTD SPEC 100015 (EU)
20	738-0507B	2	SCR:SHLDR:0.500X0.424:3/8-16	FINISH MTD SPEC-100015
21	741-0225	2	HEX FLANGE BEARING	FINISH:KUNSTSTOFF SCHWARZ
22	747-05356	1	ROD:DECK:FRT: ADJ .5" DIA	FINISH:SPEC-100015
23	747-05523	1	ROD:LIFT:DECK	FINISH:SPEC-100015
24	747-05538	1	HNDL:LIFT:500	FINISH:MTD SPEC 100015
25	783-07006	1	ARM:LIFT:LH	
26	783-07007	1	ARM:LIFT:RH	
27	783-0720C	1	BRKT:ADJ:FRT DECK ROD	FINISH:LACKIERT

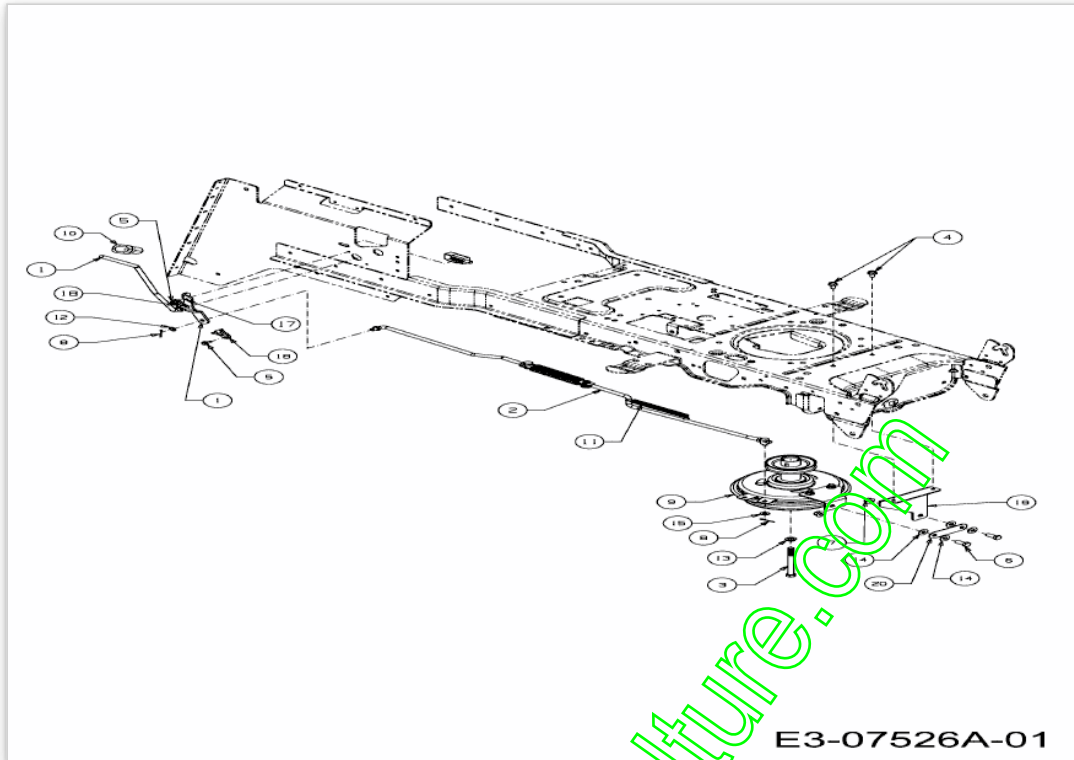

www.emc-motoculture.com

Item	Part number	#	Description I	Description II
1	647-04252-Z	1	LVR ASM:PTO:500:TO BE ZINC	FINISH:MTD SPEC-100015
2	947-04253	1	LINK ASM:PTO:500	FEDERELEMENT
3	710-04002	1	HHCS:7/16-20:4.50:GR5:STD	FINISH:MTD STD 701-01000
4	710-0371	2	SCREW-HEX	710-0371
5	710-0599	2	SCREW:TT:1/4-20:0.500:HXINDWSH	FINISH:SPEC-100016 TYPE 1
6	710-3001	2	SCREW HHCS:3/8-16:.880:GR5:STD	FINISH:SPEC-701-01000 910-3001
7	712-04065	2	NUT:FLGLK:3/8-16:GRF:NYLON	FINISH:SPEC-100015 912-04065
8	714-0111	2	COTTER PIN 3/32 DIA X 1.00	FINISH:MTD SPEC-100015
9	717-04947	1	CLU:BRC:HYDRO	FINISH:GELB VERZINKT
10	720-04049A	1	GRIP:HNDL:3/8	FINISH:SCHWARZ
11	732-0963	1	SPRING:EXTN: .50 DIA x 6.37 LG	SPEC 701-01006 OR 701-01000
12	736-0117	1	WASH:FLAT:.385 x.620 x.033	FINISH:MTD STD 701-01000
13	736-0171	1	WASHER:LOCK:7/16:REGULAR DUTY	FINISH:MTD SPEC-100016
14	736-0267	4	WASH:FLAT:.385 x.87 x.06:HT	701-01001 OPTIONAL SPEC-100015
15	736-0275	1	WASH:FLAT:0.339 x0.703 x0.065	FINISH:MTD SPEC-100015
18	741-04119A	2	BRG:PTO:LT-5	KUNSTSTOFF SCHWARZ
19	783-06428A	1	BRKT:STOP:CLUTCH	
20	783-06560	1	BRKT:LINK:PTO	FINISH:VERZ. MTD SPEC-100015

www.emc-motoculture.com

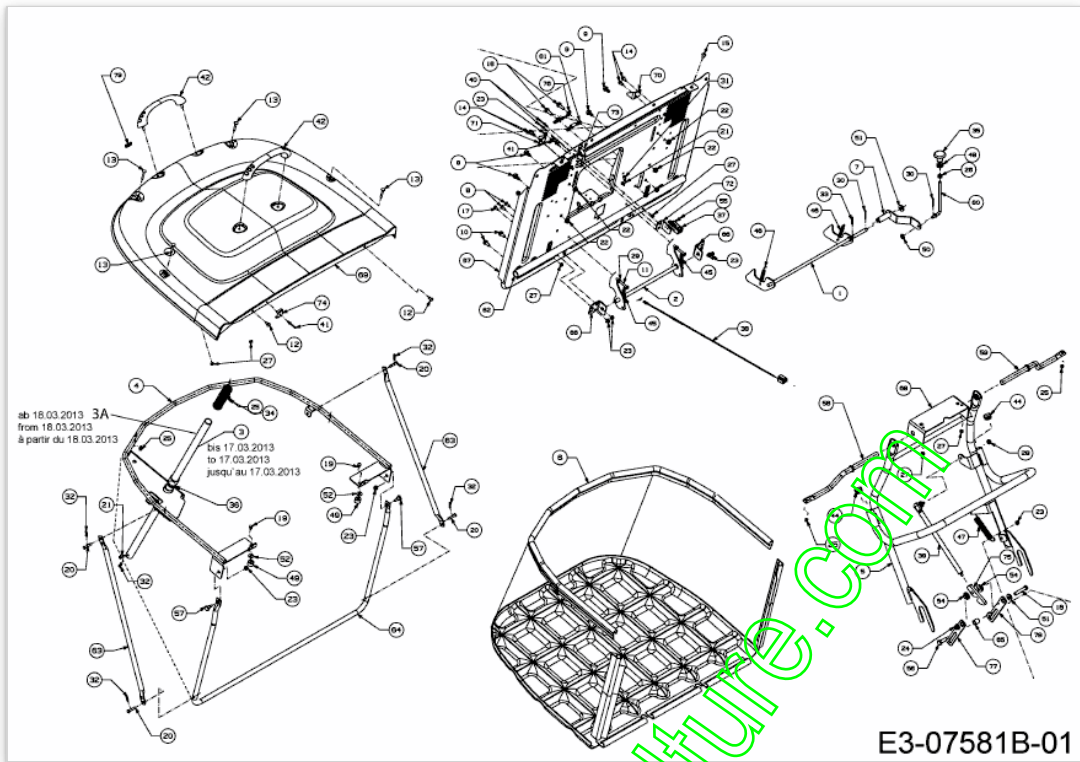

Item	Part number	#	Description I	Description II
1	647-04219	1	LATCH ASM:BAG 250L/350L	SCHWEISSTEIL:FINISH LACKIERT
2	647-04277A	1	LATCH ASM:GRSBG:ACTR	SCHWEISSTEIL:BLAU CHROMATIERT*
3	649-0138B	1		
3A	649-04052	1	TUBE ASM:LVR:GRSBG 500 MR	SCHWEISSTEIL:FINISH:LACKIERT
4	649-04090A	1		
5	649-04108	1		
6	664-04148A	1	GRSBG ASM:RR DIS:300 L 500	FINISH:SCHWARZ
7	683-04669	1		
8	710-0134	4	BOLT:CRG:1/4-20:0.62:GR2:STD	FINISH:MTD SPEC-100015
9	710-04049	4	HHFLG:5/16-18:.625:GR5:WHIZLK	FINISH:MTD STD 701-01000
10	710-04484	4	SCR:TT:5/16-9:0.75:HXINDWSH	FINISH:MTD SPEC-100016 TYPE 1
11	710-0501	2	HHCS:1/4-20:2.0:GR5:STD	FINISH:701-01000
12	710-05070	2	SCR:TT:1/4-20:.5:PANTRXI:BLK	FINISH: SCHWARZ SPEC 701-01010
13	710-05448	4	BOLT:CRG:5mm x 40.0 LG	FINISH:MTD SPEC 100015
14	710-0599	4	SCREW:TT:1/4-20:0.500:HXINDWSH	FINISH:SPEC-100016 TYPE 1
15	710-1017	2	TAP SCREW:1/4-14:.625:TRUSTRXI	FINISH:MTD SPEC-100016
16	710-1238	2	SCR.HHWSH:5/16-18:.875:GR5:STD	FINISH:MTD STD 701-01000
17	710-1691	2	HEX. SCREW:M6X12 DIN 933 8.8	FINISH:Zn5gIcB 21.1441.45
18	710-3144	1	HHCS:3/8-16:2.00:GR5:STD	FINISH:SPEC-100015 910-3144
19	710-3209	2	HHCS:M6-1.0:10MM:GR8.8:STD	FINISH:MTD STANDARD 701-01000
20	711-04138	4	PIN:CLV:.25 DIA x 1.25 LG	FINISH:SIEHE ZG.
21	711-0701	3	PIN:CLVS-.25 DIA x.50	FINISH:SIEHE ZG.
22	712-04063	6	NUT:HEX:FLGLK:5/16-18:GRN5:NYL	FINISH:SPEC-100015
23	712-04064	9	NUT:FLGLK:1/4-20:GRN5:NYLON	FINISH:SPEC-100015 912-04064
24	712-04065	1	NUT:FLGLK:3/8-16:GRF:NYLON	FINISH:SPEC-100015 912-04065
25	712-0642	4	NUT:FLGLK:M5-0.8	FINISH:DIN 6926
26	712-0690	1	NUT:HEX:M8-1.25:CL8:DIN 934	FINISH:SPEC-100015 24.1421.18
27	712-0691	6	NUT:HEXLK:M6-1:NYLON:DIN 985	MTD SPEC-100015 24.1426.14
28	712-0692	1	NUT:HEXLK:M8-1.25 NYLON DIN985	FINISH:SPEC-100015 24.1426.18
29	712-3006	2	NUT:HEX:1/4-20:GR5	FINISH:SPEC-100015
30	714-0115	2	PIN:COT:SPLIT:1/8 X 1.0	FINISH:MTD SPEC-100015
31	714-0145	2	PIN:CLICK:.092 x 1.64 LG	FINISH:SPEC-100016
32	714-04033	5	PIN:COT:INT .072 x.92 LG	FINISH:PHOS & OIL
33	715-0150	1	PIN:ROLL:3/16 DIA x 1.1 LG	FINISH:GEÖLT
34	720-0204	1	GRIP:1.0 ID x 4.7 LG	FINISH:SCHWARZ

Item	Part number	#	Description I	Description II
35	720-04164	1	KNOB:SHFT	FINISH:SCHWARZ
36	721-04491	1	O-RING: .9375 ID x .139 DIA	FINISH:SCHWARZ
37	725-04363	1	SW:INTLK:NO/NC	FINISH:SIEHE ZG.
38	725-05260	1	HARN ASM:500:BAG PRESENT	STAND
39	727-04370	1	CYL:DAMPER:8.0 STROKE	FINISH SCHWARZ SIEHE ZG.
40	728-0123	2	POP RIVET 3/16 DIA x .450:STY1	FINISH:VERZINKT SIEHE ZG
41	728-04000	3	RIV:POP: .188 DIA x .300 L	FINISH:SIEHE ZG.
42	731-04578	2	HNDL:BAG:W-SCR:500/500 MR	FINISH:SCHWARZ
43	731-0511	20	FAOM	FINISH:SCHWARZ, SIEHE ZG.
44	731-07972	2	CAP:TUBE:SUPT 300L/250L BAG	FINISH:SCHWARZ
45	732-0264	2	SPR:EXTN: .380 OD x 2.500 LG	FINISH:SPEC-701-01006 932-0264
46	732-04488	2	SPRING:EXT: .38 OD x 3.25 LG	FINISH:701-01006
47	732-04855	1	SPR:EXTN: .67 DIA x 5.50 LG	FINISH:MTD SPEC 701-01006
48	735-04093	1	GROM:RUBR:9x22x12	HATZ Teile-Hr.: 50440800
49	735-04121	2	BMPR:	FINISH: HARTGUMMI SCHWARZ
50	736-0275	1	WASH:FLAT:0.339 x0.703 x0.065	FINISH:MTD SPEC-100015
51	736-3004	2	WASH:FLAT: .406 x.875 x.105	FINISH:MTD STD 701-01000
52	736-3090	2	WASHER:FLAT: .255 X .730 X .060	FINISH:MTD SPEC-100015
54	738-0372B	2	SPCR:SHLDR:0.381X0.624X0.200	FINISH:GEÖLT
55	738-04237A	1	SCR:SHLDR:0.250X0.165 T	FINISH:MTD SPEC-100016
56	738-0572	1	SCR:SHLD: .374 DIA x 1.16 LG	FINISH:GELBVERZINKT SIEHE ZG.
57	738-0974	2	SCR:SHLDR: .375x .380:1/4-20	FINISH:SIEHE ZG. 938-0974
58	747-05345	1	ROD:PIVOT:RH:BAG 300L	FINISH:MTD SPEC-100016:VERZ.
59	747-05354	1	ROD:PIVOT:LH:BAG 300L	FINISH:MTD SPEC-100016:VERZ.
60	747-05432	1	LVR:HANDLE	FINISH:701-01001
61	747-05434AZW	1	ROD:LATCH:TO BE ZINC PLATED	FINISH:BLAU CHROMATIERT
62	749-04696A	1	TUBE:PIVOT:BAG:250L/300L	FINISH:BLAU CHROMATIERT *
63	749-04729	2	TUBE:SUPT:CROSS:GRSBG 250/300	FINISH:LACKIERT
64	749-04730	1	TUBE:FRM:FRT:BAG 250L/300L	FINISH:LACKIERT
65	750-05533	1	SPCR:16mm O.D.:10mm I.D.	FINISH:MTD SPEC-100015
66	783-04623A	2		
67	783-06697	1	PLT:END:RR DIS:500	FINISH:LACKIERT
68	783-06719	1	BRKT:PIVOT:BAG	FINISH:PLAIN
69	783-06720	1	CVR:BAG:HT:300L	FINISH:LACKIERT
70	783-06795	1	BRKT:ELB:LHS	FINISH:LACKIERT
71	783-06796	1	BRKT:ELB:RHS	FINISH:LACKIERT
72	783-06812	1	MOUNTING BRACKET SWITCH	FINISH:783-06812-Z
73	783-06813	1	BRKT:SW:STRIKER	FINISH:SCHWARZ LACKIERT *

Item	Part number	#	Description I	Description II
74	783-06876	1	PLT:WEAR	FINISH:783-06876 *
75	783-06919	1	BRKT:HOOK	FINISH:SPEC-100015:VERZINKT
76	783-06925	1	BRKT:RAMP:CYL	FINISH:BLAU CHROMATIEREN *
77	783-06926	1	BRKT:GDE:CYL w/DTNT	FINISH:SPEC-100015
78	783-06928	1	BRKT:GDE:CYL w/DTNT	FINISH:SPEC-100015
79	731-0511	1	FAOM	FINISH:SCHWARZ, SIEHE ZG.

www.emc-motoculture.com

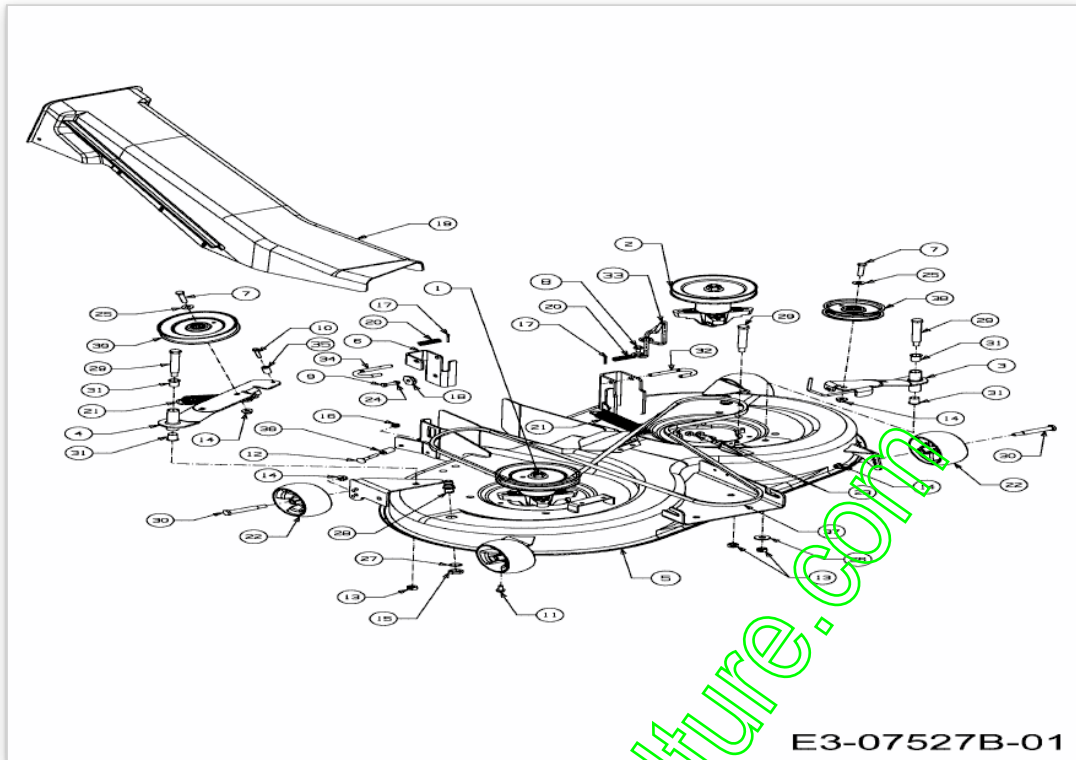

Item	Part number	#	Description I	Description II
1	618-04657A	1		
2	618-0609D	1		
3	683-04058B	1		
4	683-04061	1	BRKT ASM:IDLR:V-PUL	DECK 500 S SCHWEIßTEIL
5	683-04729A	1		
6	683-04797	1		
7	710-0347	2	HHCS:3/8-16:1.75:GR5:STD	FINISH:MTD SPEC-100015
8	710-04484	1	SCR:TT:5/16-9:0.75:HXINDWSH	FINISH:MTD SPEC-100016 TYPE 1
9	710-0528	1	HHCS:5/16-18:1.25:GR5:STD	FINISH:SPEC-100015 910-0528
10	710-0778	1	SCR:TT:1/4-20:1.50:HXINDWSH	FINISH:MTD SPEC-100016 TYPE 1
11	710-1260A	8	SCR:TT:5/16-18:0.750:HXINDWSH	FINISH:SPEC-100016 TYPE 1
12	710-1719	1	BOLT:CRG:M8x1.25x50 DIN 603	MTD-SPEC-100015 22.3419.32
13	712-0290	3	NUT-HEXLK 7/16-14:GRA:CTRLK	FINISH:MTD SPEC-100015
14	712-04065	6	NUT:FLGLK:3/8-16:GRF:NYLON	FINISH:SPEC-100015 912-04065
15	712-0641	2	NUT:HEX:JAM:M16x1.5:CL4:DIN936	FINISH:SPEC-100015 24.1424.31
16	712-0692	1	NUT:HEXLK:M8-1.25 NYLON DIN985	FINISH:SPEC-100015 24.1426.18
17	714-0115	2	PIN:COT:SPLIT:1/8 X 1.0	FINISH:MTD SPEC-100015
18	717-04074	1	GEAR:DECK:ADJUSTMENT	FINISH:SIEHE ZG. 917-04074
19	731-07901	1	CHUT:DIS:RR:500	FINISH:KUNSTSTOFF SCHWARZ
20	732-0306A	2	COMP.SPRING: .531 OD x 1.75 LG	FINISH:MTD SPEC 701-01000
21	732-04099	2	SPR:EXT:1.25 DIA x 8.224 LG	FINISH:SIEHE ZG.
22	734-04155	4	WHEEL:DECK	FINISH:KUNSTSTOFF SCHWARZ
23	735-0271A	2	BUMPER:.62 DIA x .3	FINISH:SCHWARZ
24	736-0119	1	WASHER:LOCK:5/16:SPLT:REG	FINISH:MTD SPEC-100016
25	736-0300	2	WASH:FLAT:0.396X0.885X0.060	FINISH:MTD SPEC-100015
26	736-04097A	2	WASH:FLAT:11.65 x 28.75 x 3 mm	FINISH:MTD SPEC-100015
27	736-0760	2	WASH:LOCK:SCHNORR 17X23.8X1.95	FINISH:MTD SPEC-100016
28	737-04003D	2	NOZ:DECK:WATER	FINISH:MTD SPEC-100015
29	738-0476	3	SCR:SHLDR:.625 x 3.50:7/16-14	FINISH:SPEC-100015
30	738-3056	4	SCR:SHLDR:.498 x 2.500:3/8-16	FINISH:SPEC-100015 938-3056
31	741-0591	4	BRG:FLG:.630ID X .693OD X .875	FINISH:NATUR 941-0591
32	747-04116A	1	ROD:HNDL:DECK REL .375 DIA	FINISH:GLANZVERZINKT
33	747-04840	1	GUIDE ASSY-BELT	FINISH:SPEC-100015
34	747-1116	1	ROD:HNDL:DECK REL .375 DIA	FINISH:PHOS & OIL COATING
35	750-04182	1	SPACER:14mm OD x 7mm ID	FINISH:SIEHE ZG.
36	750-04195	1	SPACER Ø16 x Ø8 x 27LG DIN2391	DIN 2391:ST35:FINISH 701-01000
37	754-04069	1	BELT:V TYP:HB x 105 LG	FINISH:
38	756-04049	1	PUL:IDLR:4.0 DIA.	KUGELGELAGERT:SCHWARZ LACKIERT

Item	Part number	#	Description I	Description II
39	756-04050	1	PUL:IDLR:6.0 DIA.	KUGELGELAGERT:SCHWARZ LACKIERT

www.emc-motoculture.com

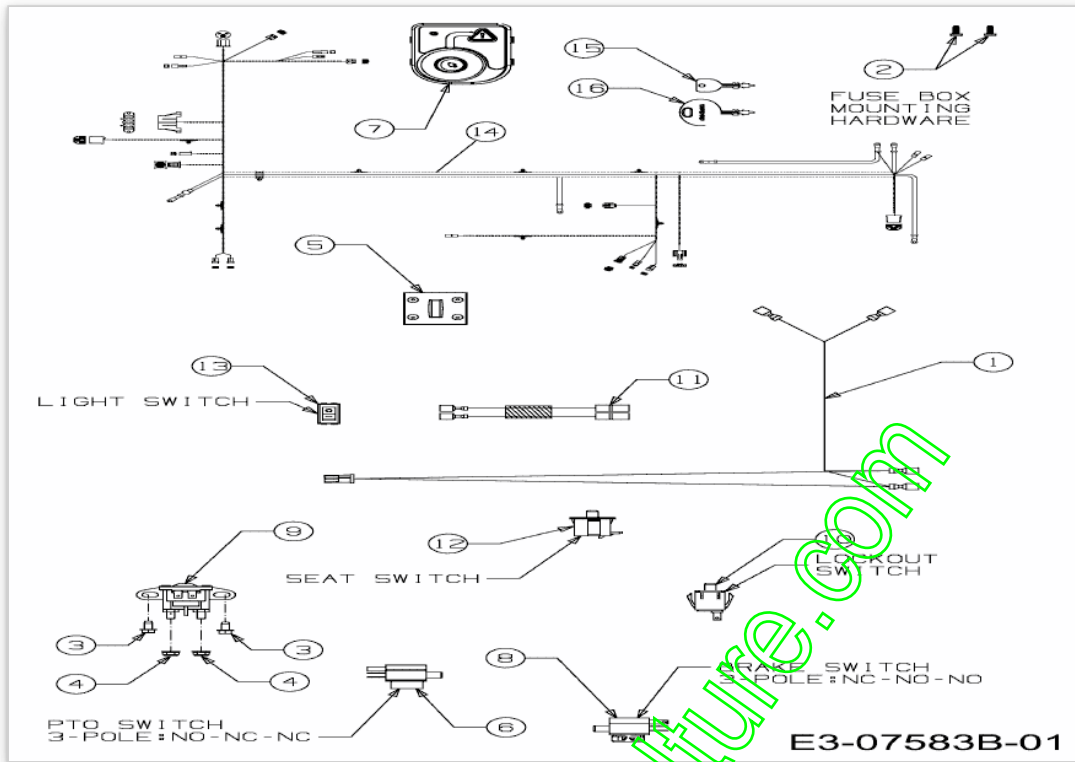

www.emc-motoculture.com

Item	Part number	#	Description I	Description II
1	629-04133B	1	HARN ASM:UNIVERSAL:HEADLIGHT	629-04133B
2	710-0351	2	SCR:B:#10-16:0.5":PANPHI	MTD SPEC-100016
3	710-0599	2	SCREW:TT:1/4-20:0.500:HXINDWSH	FINISH:SPEC-100016 TYPE 1
4	712-04064	2	NUT:FLGLK:1/4-20:GRN5:NYLON	FINISH:SPEC-100015 912-04064
5	725-04036C	1	METER:IND:HOURL SVC MNDR	BETRIEBSSTUNDENZÄHLER
6	725-04038	1	SWITCH DELTA NO/NC/NC SNAP MT	NO/NC/NC:KLICKMONTAGE
7	725-06119	1	SW:KEY:RMC MDL:RELAY:MPTO:BLK	SCHWARZ
8	725-04232	1	SWITCH-3 POLE NC-NO-NO	FINISH
9	725-04439	1	SOL:12V:100 AMP:4 TERM	12V:100 AMP
10	725-04807	1	SW:PLNGR:SNAP MNT:N.O.	KLICKMONTAGE
11	725-04839	1	HARN:JMPR:HEADLIGHT SW	CUB-STYLE
12	725-05013	1	SW:SEAT:N/C,N/C:SHORTING	FINISH:GRAU
13	725-05057	1	SW:ROCKER:10	FINISH
14	725-05352	1	HARN:500NX:MAN:HR:AM:OCR:FSBX	FSBX
15	725-1744A	1	KEY:SW:UNIVERSAL	FINISH:
16	725-2054A	1	KEY:SW:UNIVERSAL:YELLOW	CUB CADET

www.emc-motoculture.com

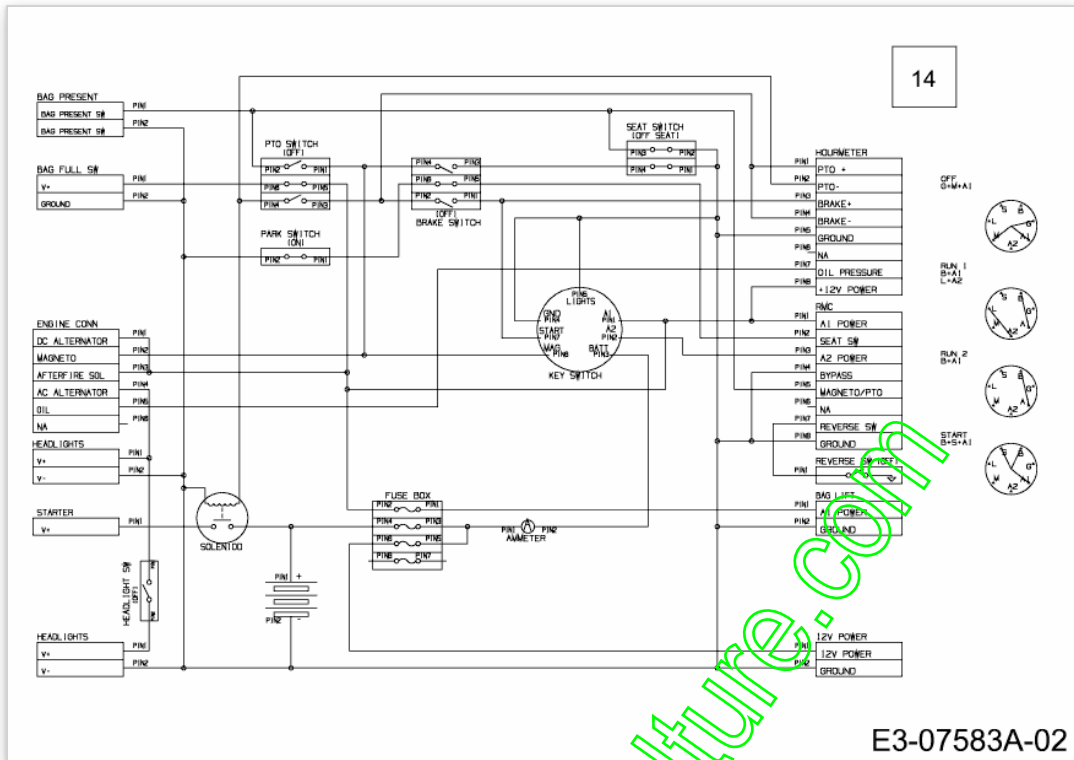

Item	Part number	#	Description I	Description II
14	725-05352	1	HARN:500NX:MAN:HR:AM:OCR:FSBX	FSBX

www.emc-motoculture.com

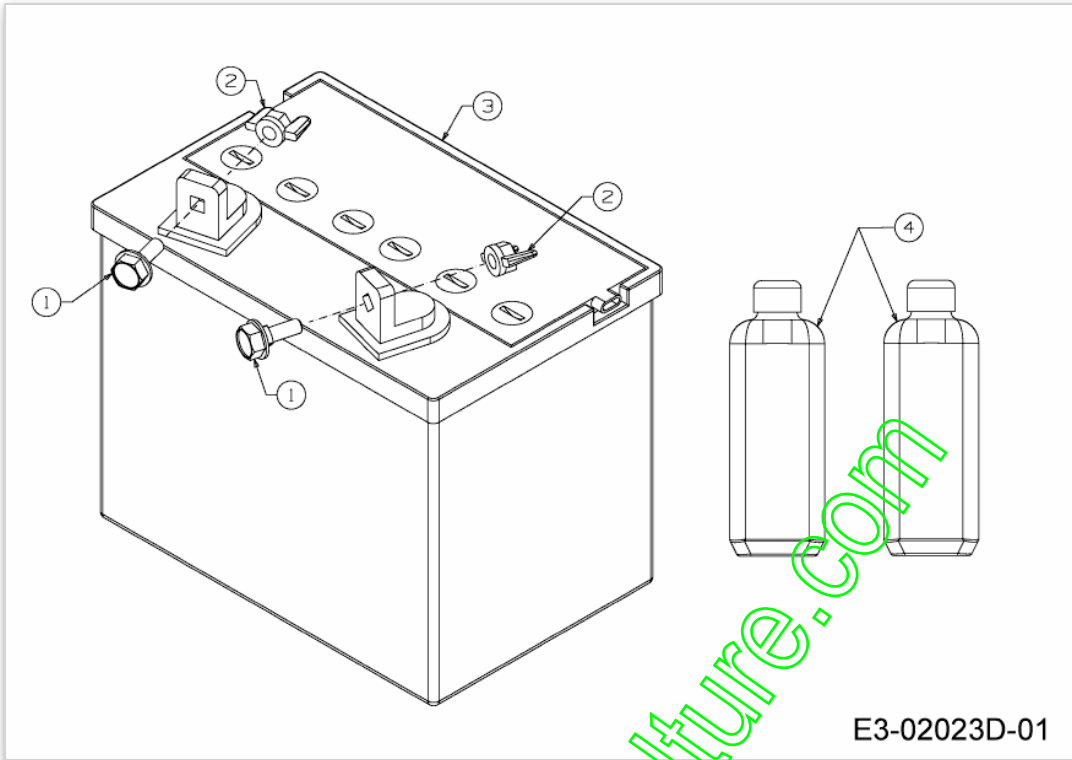

E3-02023D-01

Item	Part number	#	Description I	Description II
1	738-1132	2	SCR:SHLDR:.250X.150:1/4-20	FINISH:PHOS & OIL SIEHE CODE
2	712-3087	2	WING NUT	FINISH:KUNSTSTOFF SCHWARZ
3	725-1751	1	BAT:U1:230 CCA DRY VENTED TOP	12V 16Ah
4	725-2064	2	PACK:ACID:1 LITER	725-2064

www.emc-motoculture.com

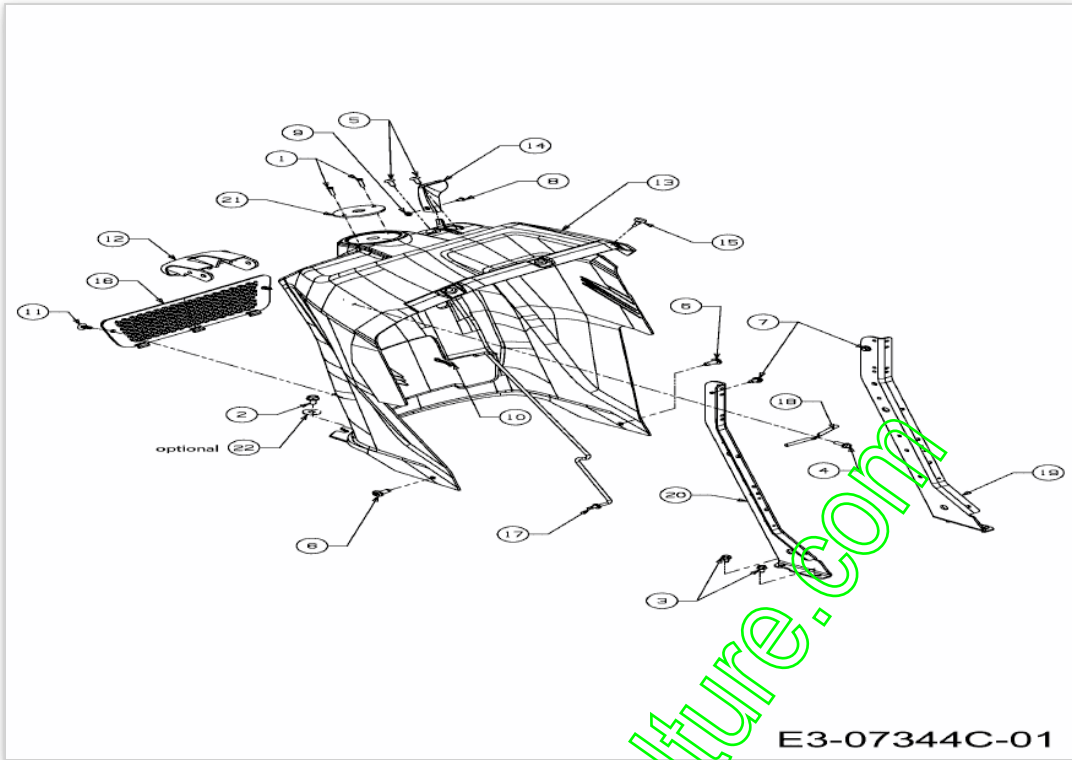

www.emc-motoculture.com

Item	Part number	#	Description I	Description II
1	710-04031	2	SCR:HL:#10-16:750:HEX	FINISH:VERZINKT SIEHE ZG.
2	710-04484	2	SCR:TT:5/16-9:0.75:HXINDWSH	FINISH:MTD SPEC-100016 TYPE 1
3	710-0599	4	SCREW:TT:1/4-20:0.500:HXINDWSH	FINISH:SPEC-100016 TYPE 1
4	710-0895	1	SCR:HL:1/4-15:0.750:HXINDWSH	FINISH:MTD SPEC-100016 TYPE 1
5	710-1017	2	TAP SCREW:1/4-14:.625:TRUSTRXI	FINISH:MTD SPEC-100016
6	710-1611B	2	SCR:TT:5/16-18:0.750:PANTRXI	FINISH:MTD SPEC-100015
7	710-1652	2	SCR:TT:1/4-20:0.62:HXINDWSH	FINISH:MTD SPEC-100016 TYPE 1
8	710-3217	1	SCR:MACH:#8-32:0.375:TRUSPHI	FINISH:701-01000 TRUSPHI
9	712-0142	1	NUT:HEX:#8-32:GRA	FINISH:MTD STD 701-01000
10	714-04040	1	PIN-COTTER	FINISH:ASTM F1941 FE/ZN 3AN
11	726-3046	2	MOUNTING CLIP:.250 DIA	FINISH:KUNSTSTOFF SCHWARZ
12	731-05447A	1	LVR:DASH:CRUISE/BRAKE 2500 CUB	FINISH:KUNSTSTOFF SCHWARZ
13	731-07315	1	PNL:DASH:A-STYLE w/LGT SW	MIT LICHSCHALTER:FARBE SCHWARZ
14	731-3161A	1	KNOB:THROT CONTROL	FINISH:GELB / 931-3161A
15	735-0271A	3	BUMPER:.62 DIA x.3	FINISH:SCHWARZ
16	735-04076	1	ACSRV:NET	FINISH:
17	747-05009B	1	ROD:CONT:LATCH:CUB	MTD STD 701-01006 or 701-01007
18	747-1196	1	ROD:LVR:BENT	CRUISE/BREMSE:FINISH:SIEHE ZG.
19	783-06098	1	SUPPORT:DASH:PLATE LH	FINISH:LACKIERT MTD QUALITÄT
20	783-06099	1	SUPPORT:DASH:PLATE RH	FINISH:LACKIERT MTD QUALITÄT
21	783-07069	1	PLT:DASH:STRG SERVICE	SCHWARZ VERZINKT:SPEC-101625
22	736-0701	2	WASH:FLAT:8.4x24x2.00 DIN 9021	MTD SPEC-100015 24.6486.18

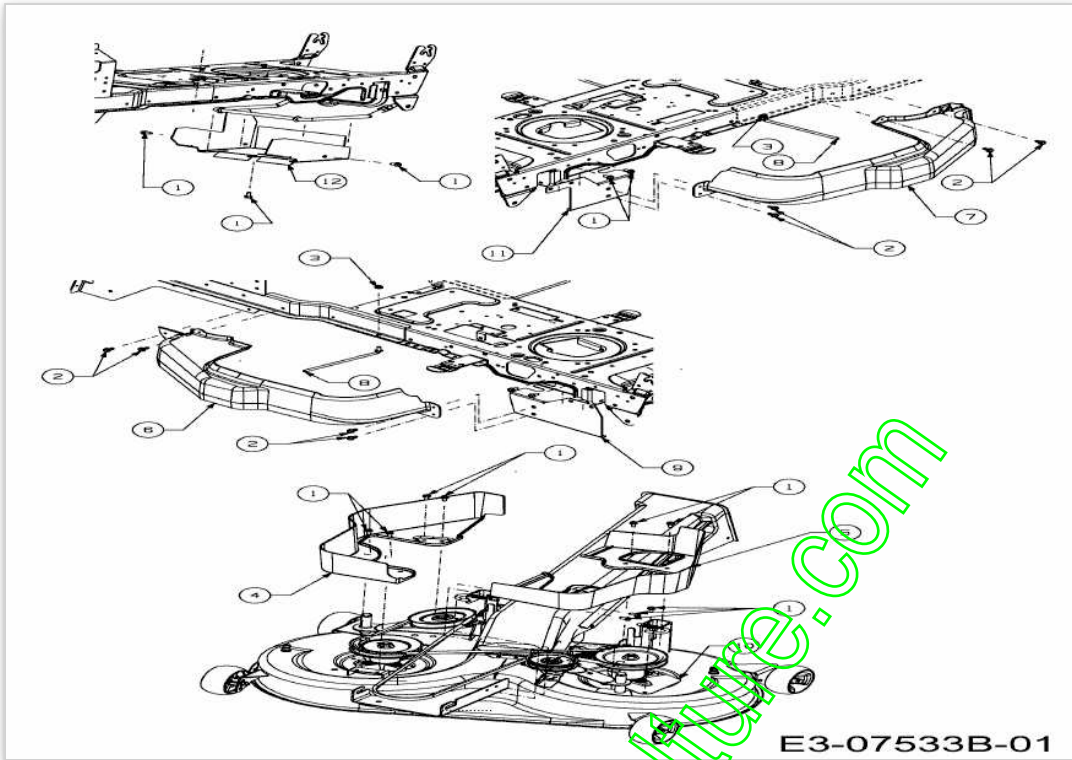

www.emc-motoculture.com

Item	Part number	#	Description I	Description II
1	710-04484	16	SCR:TT:5/16-9:0.75:HXINDWSH	FINISH:MTD SPEC-100016 TYPE 1
2	710-05045A	8	SCR:TT:5/16-9:0.75:HXINDWSH	FINISH:SPEC-100016 TYPE 1
3	712-04063	2	NUT:HEXFLGLK:5/16-18:GRN5:NYL	FINISH:SPEC-100015
4	731-08671	1	CVR:E-N LWR:RH:500 SERIES	FINISH:KUNSTSTOFF SCHWARZ
5	731-08673	1	CVR:N LWR:LH:500 SERIES	FINISH:KUNSTSTOFF SCHWARZ
6	731-08739B	1	UPR CVR:RH:E+N DECK:500 SERIES	FINISH:KUNSTSTOFF SCHWARZ
7	731-08740B	1	UPR CVR:LH:E-N DECK:500 SERIES	FINISH:KUNSTSTOFF SCHWARZ
8	747-05705	2	ROD:SUPT:UPR CVR	E/N/I DECKS:FINISH 701-100015
9	783-07108	1		
10	783-07111	1		
11	783-07407	1		
12	783-07409A	1		

www.emc-motoculture.com

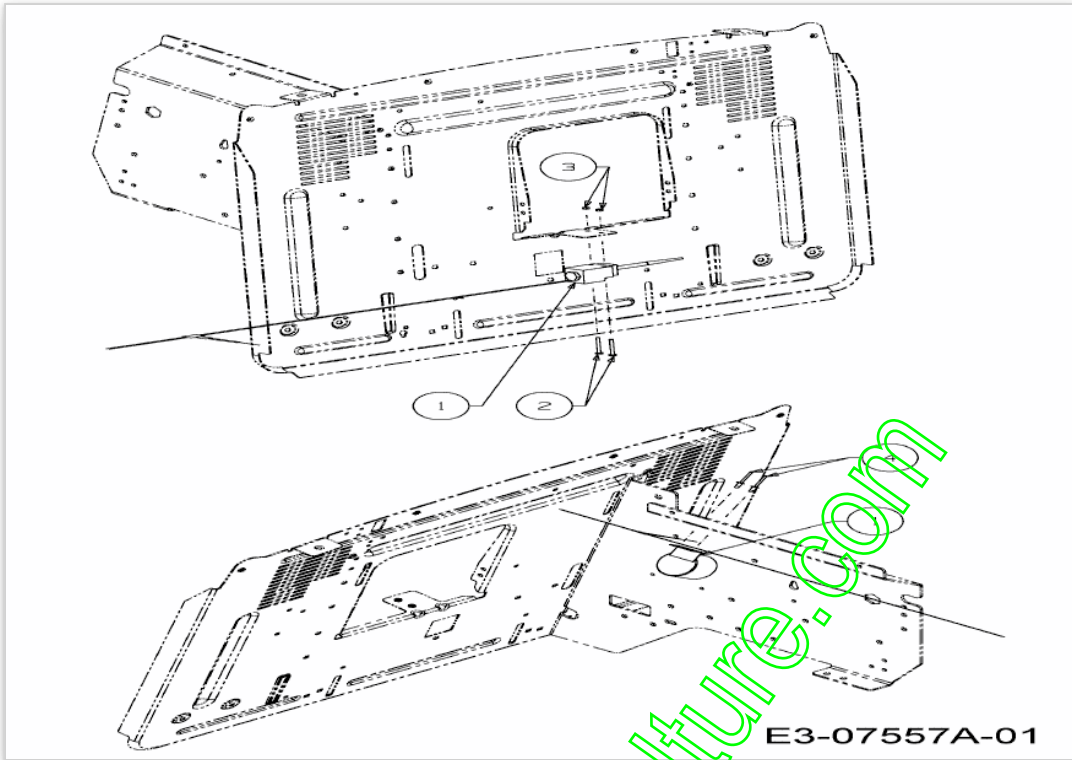

www.emc-motoculture.com

E3-07557A-01

Item	Part number	#	Description I	Description II
1	629-1089A	1	HARN ASM:500:BAG FULL	FUELLSTANDSANZEIGE
2	710-1397	2	SCREW M4x35-4.8 DIN 7985	Zn 5glcB 23.5421.85
3	712-0636	2	NUT: HEX: M4: DIN 985	MTD SPEC-100015 24.1426.09
4	728-04000	2	RIV:POP: .188 DIA x .300 L	FINISH:SIEHE ZG.

www.emc-motoculture.com

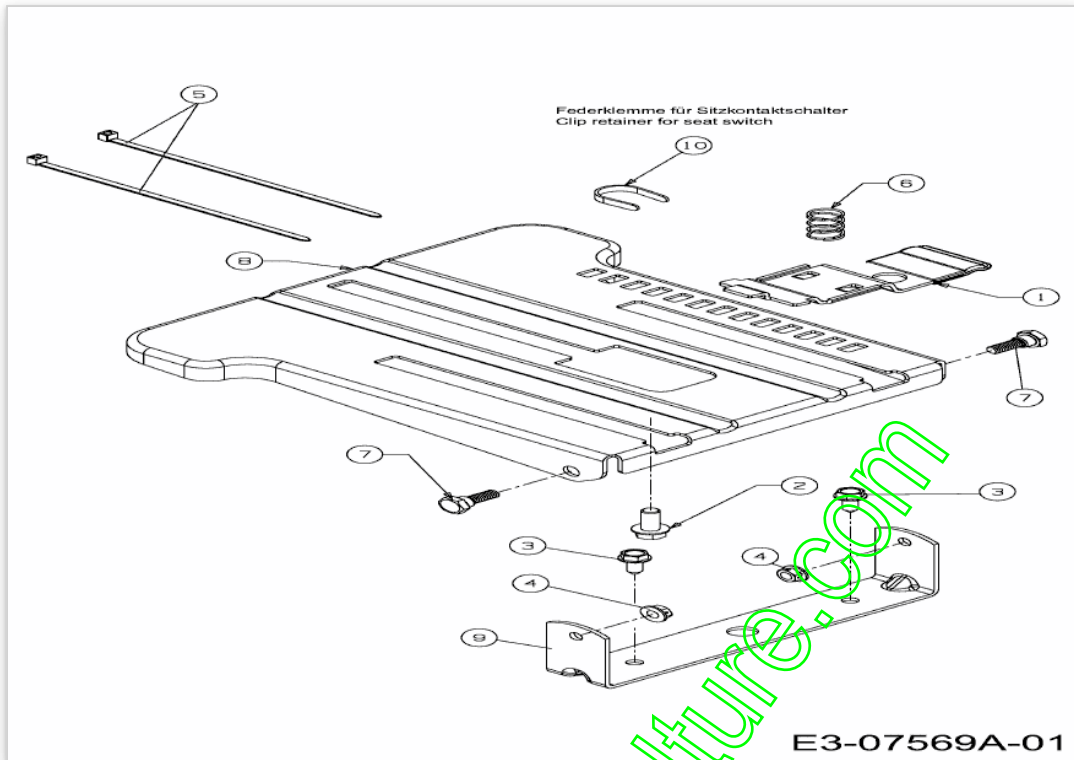

www.emc-motoculture.com

Item	Part number	#	Description I	Description II
1	783-06050	1	LEVER SEAT ADJUST	FINISH:SPEC-100015
2	710-04482	1	HHWSH:3/8-16:0.88:GR5:STD	FINISH:MTD SPEC-100015
3	710-04484	2	SCR:TT:5/16-9:0.75:HXINDWSH	FINISH:MTD SPEC-100016 TYPE 1
4	712-3004A	2	NUT:FLGLK:5/16-18:GR5:SD LK	FINISH:701-01000
5	725-0157	2	CBL:TIE: 3/16 X .05 X 7.4	MATERIAL:NYLON-SCHWARZ
6	732-04563	1	SPRING-COMPRESS.SEAT ADJ LVR	FINISH:SPEC-100015
7	738-0296	2	SCR:SHLDR:.437 x .262:5/16-18	FINISH:SPEC-100015
8	783-06049	1	SEAT BASE	FINISH:LACKIERT MTD QUALITÄT
9	783-06088	1	BRKT SEAT PIVOT	FINISH:LACKIERT MTD QUALITÄT
10	783-06448	1	CLIP-RETAINING	FINISH:701-01000

www.emc-motoculture.com

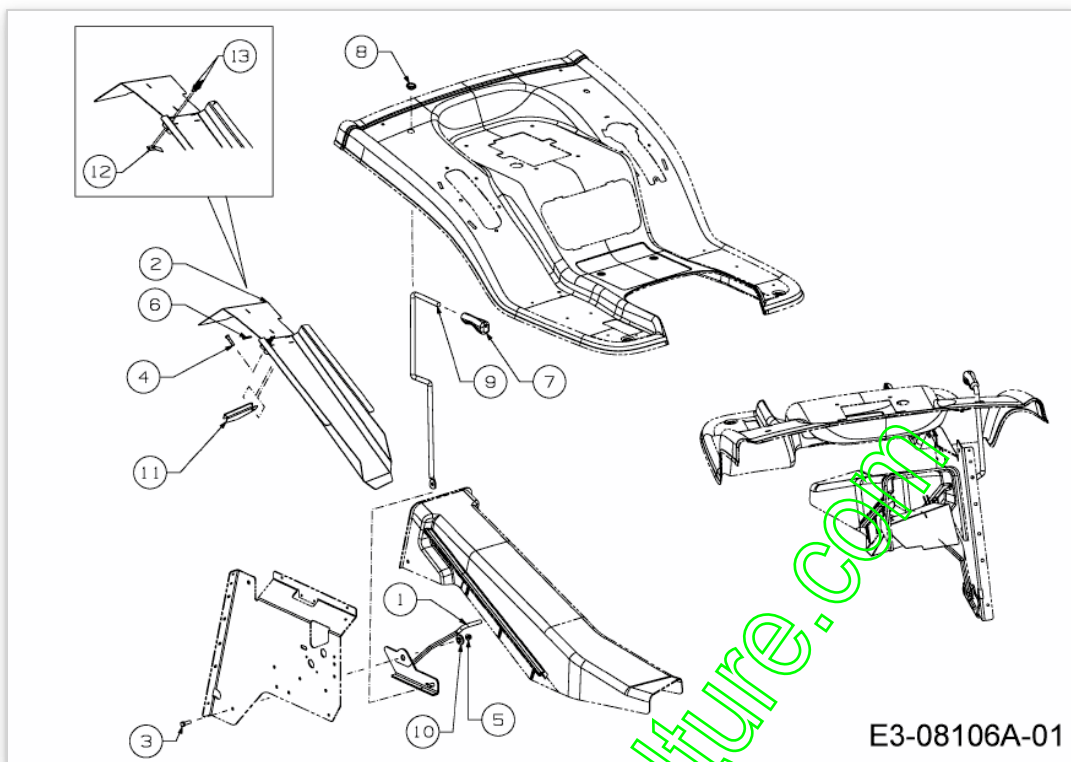

www.emc-motoculture.com

E3-08106A-01

Item	Part number	#	Description I	Description II
1	647-04265	1	CONT ASM:CHUTE	SCHWEISSTEIL:BLAU CHROMATIERT*
2	683-05043	1		
3	710-0376	1	HHCS:5/16-18:1.00:GR5:STD	FINISH:MTD SPEC-100015
4	711-04138	1	PIN:CLV:.25 DIA x 1.25 LG	FINISH:SIEHE ZG.
5	712-04063	1	NUT:HEXFLGLK:5/16-18:GRN5:NYL	FINISH:SPEC-100015
6	714-0104	2	PIN:COT:.072 DIA x 1.13 LG	FINISH:PHOS AND OIL
7	720-0311	1	GRIP-HANDLE:1/2	FARBE:SCHWARZ VINYL
8	735-05016	1	GROM:.75 x .03- .08	FINISH:SCHWARZ
9	747-05623	1	ROD:CONT:CHUT CLEANOUT	FINISH:MTD SPEC-100015
10	748-0331	1	SPCR:SHLDR:.625 DIA x.324 DIA	FINISH:GEÖLT
11	783-07144	1	BRKT:CHUTE	FINISH:SPEC-100015
12	783-08252	1	BRKT:SPR:CHUT CLNR	FINISH:701-01006
13	728-04000	2	RIV:POP:.188 DIA x .300 L	FINISH:SIEHE ZG.

www.emc-motoculture.com

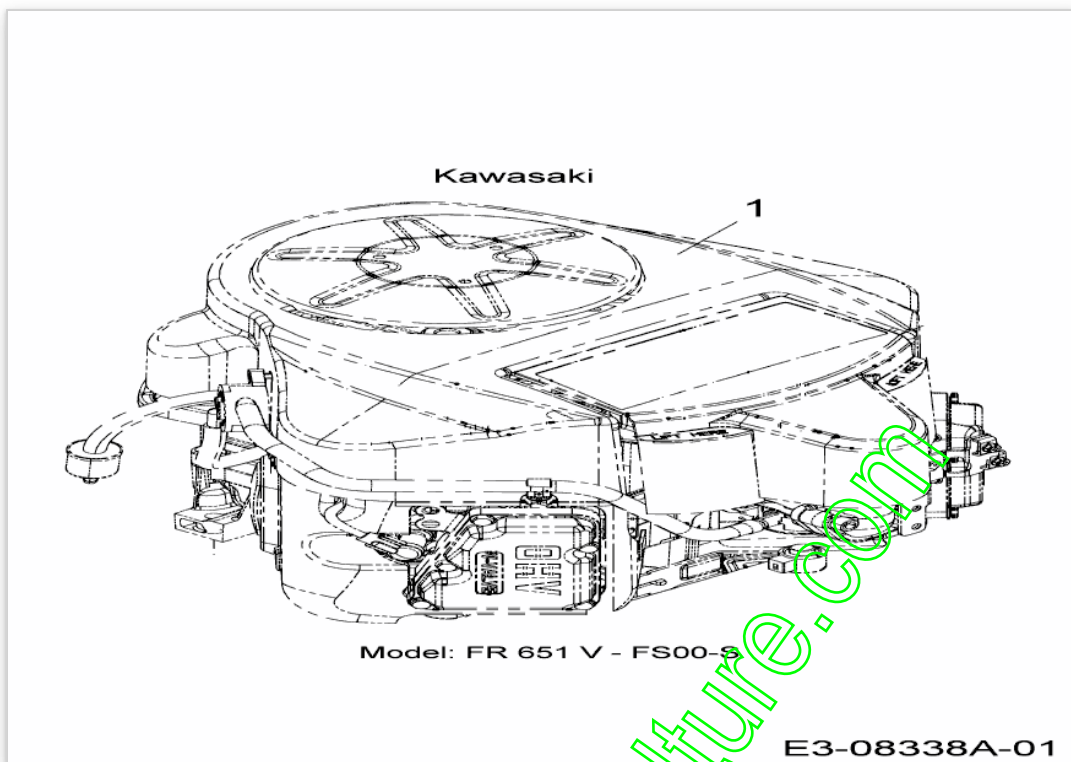

Item	Part number	#	Description I	Description II
1	752SR651S50	1	ENGINE KAWA FR 21,5 TWIN 726CC	FR651V-_S50-M/R/S

www.emc-motoculture.com

www.emc-motoculture.com