

NOTE: ALWAYS USE ORIGINAL EQUIPMENT PARTS.
Use of service/replacement parts other than original equipment parts may void your warranty.

**ALL UNNUMBERED
ITEMS ARE INTERCHANGEABLE
WITH OPPOSITE SIDE**

329833 E

KEY#	PART#	DESCRIPTION	QTY
1	330815-853	BRACKET, HOOD, RH, EURO I & II	1
2	330816-853	BRACKET, HOOD, LH, EURO I & II	1
3	313541-853	BRACKET, FRONT AXLE	1
4	56030	SCREW, 5/16-18 X 75 WDFLLK	5
5	55273	NUT, 5/16-18 WDFLLKLRG WHIZ	5
6	300440	GUIDE, BELT, RIDER	1
7	1498	NUT, 5/16-18 REGHEXCTRLK	1
8	308207	BOLT, 625 X 2 1/8" HSSH, 1/2-13"	1
9	309008	NUT, 1/2-13 HEXJAM CTRLK	1
10	180138	SCREW, 3/8-16 X 300 HHC	2
11	2483	WASHER, 39 ID X 1.25 O X .07 BELLVIL	2
12	1499	NUT, 3/8-16 REGHXCTRLK	2
13	300635	GUIDE, BELT, SHORT, 15" WHEEL	1
14	124824	NUT, 5/16-18 HEXJAM	1
15	271190	NUT, 3/8-16 HEXKEPS	1
16	331135	DASH, SHORT, H16, LF	1
17	318304	SCREW, 1/4-14 X 75 PHPNHD TAP, BLACK	2
18	180020	SCREW, 1/4-20 X 75 HHC	2
19	120392	WASHER, FLAT, 281 X 63 X .065	2
20	1502	NUT, 1/4-20 REGHEXCTRLK	2
21	330807-830	COVER, DASH, EURO I & II, LF	1
22	318304	SCREW, 1/4-14 X 75 PHPNHD TAP, BLACK	2
23	302468	HOOD, EURO I, H16, LT	1
24	12675	TRIM PIECE, PLASTIC, GREY 861/630	1
25	306822	CLIP, U-TYPE, FINN Q27637-014-4	2
26	331068-853	BRACKET, HOOD, RH, EURO I WELD	1
27	331069-853	BRACKET, HOOD, LH, EURO I WELD	1
28	333594	BOLT, 500 X 1/77 HSSH, 5/16-18	2
29	1498	NUT, 5/16-18 REGHEXCTRLK	2
30	180079	SCREW, 5/16-18 X 1.00 HHC	2
31	1498	NUT, 5/16-18 REGHEXCTRLK	2
32	324909-853	SUPPORT, STEERING/PTO, LF	1
33	40886	SCREW, 1/4-20 X 38 WAHTAP	4
34	324908-830	DASH, TOWER, WALK-THRU, LF	1
35	35497	SCREW, 5/16-18 X .50 WAHTAP	4
36	40886	SCREW, 1/4-20 X 38 WAHTAP	2
37	304079	LENS, HEADLIGHT, EURO LT, SMOKE	1
38	41482	PRESS CLIP, 1.380 LONG 255 ID	2
39	330847	STEERING WHEEL	1
40	331494	SPACER, STEERING SHAFT, LF	1
41	301413	SPACER, STEERING SHAFT	1
42	456378	PIN, SPRING, .250 DIA X 2.00 LONG	1
43	308200	DECAL, REFLECTOR, EURO LT	1
45	12599	FASTENER, VELCRO, 2" X 1"	2
46	333120-853	BRACE, DASH TOWER, LF, WALK-THRU	2
47	180016	SCREW, 1/4-20 X 50 HHC	2
48	46931	NUT, 1/4-20 WDFL, MAC-LOCK	2
	336066	PARTS MANUAL	1
	336085	OPERATOR'S MANUAL (FRENCH)	1
	327627	GRASS CATCHER MANUAL	1
	328195	AIR ASSIST MANUAL (ENGLISH)	1
	330272	AIR ASSIST MANUAL (FRENCH)	1
	330273	AIR ASSIST MANUAL (GERMAN)	1

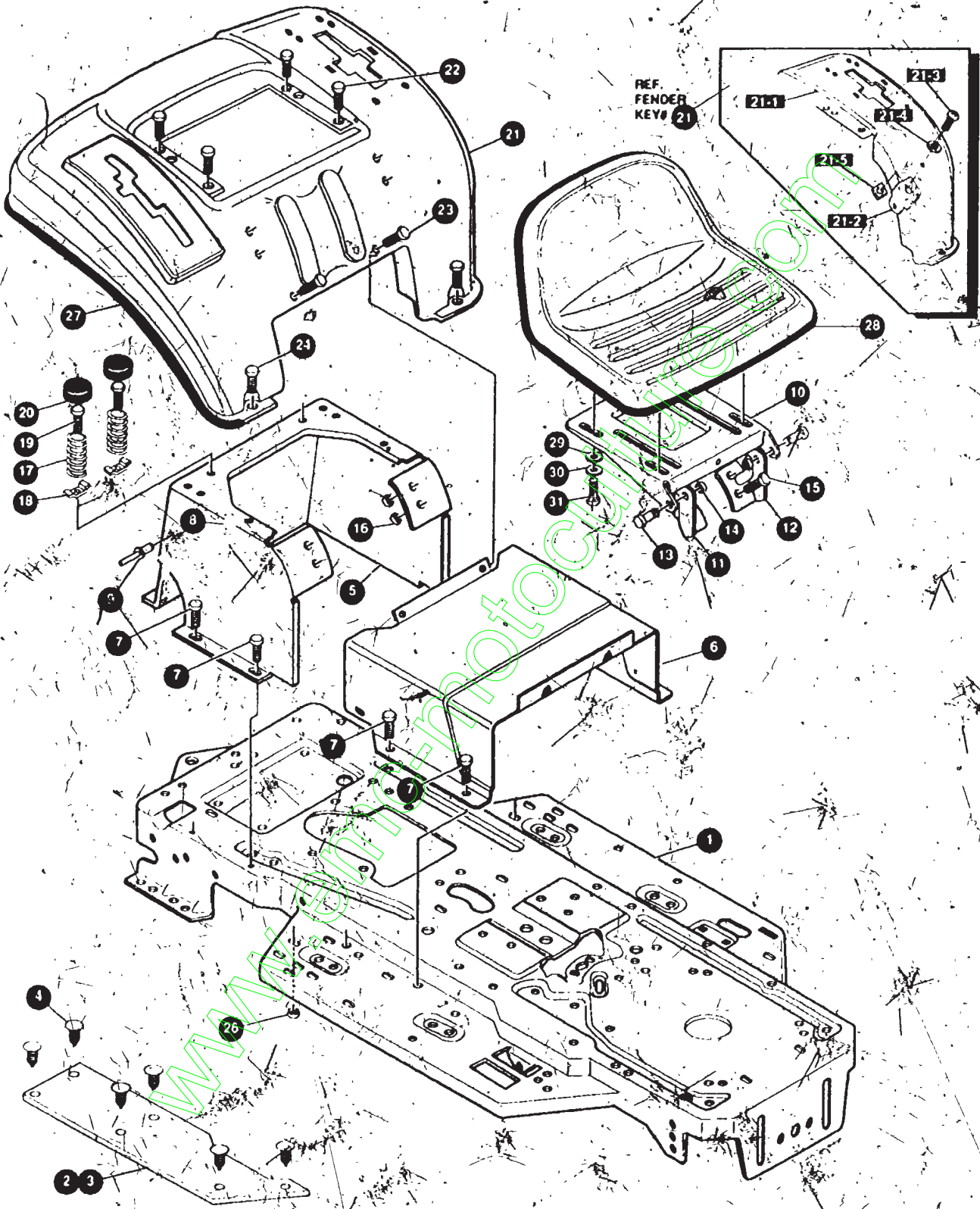

NOTE: ALWAYS USE ORIGINAL EQUIPMENT PARTS.
Use of service/replacement parts other than original equipment parts may void your warranty.

**ALL UNNUMBERED
ITEMS ARE INTERCHANGEABLE
WITH OPPOSITE SIDE**

331757 C

KEY#	PART#	DESCRIPTION	QTY
1	335697-830	FRAME, LF, MAIN, P920/F4360	1
2	329277	FOOT PAD, LH, 22 12 LONG, F-5	1
3	329278	FOOT PAD, RH, 22 12 LONG, F-5	1
4	311087	FASTENER, RATCHET, BLACK	12
5	324912-830	SEAT/FENDER SUPPORT, WALK-THRU	1
6	330865-830	CONSOLE, WALK-THRU, NO SLT, LF	1
7	995346	SCREW, 1/4-20 X .50 WAHHTAP	10
8	35497	SCREW, 5/16-18 X 50 WAHHTAP	2
9	46763	RIVET, POP, .187 DIA X .450 LONG	3
10	58367-854	PLATE, SEAT, F5, SF, LF	1
11	325053-854	BRACKET, SEAT WALK-THRU, RH	1
12	325054-854	BRACKET, SEAT WALK-THRU, LH	1
13	20507	BOLT, .437 X .156 HSSH, 5/16-18	2
14	1498	NUT, 5/16-18 REGHEXCIRLK	2
15	48901	SCREW, 5/16-18 X .63 WAHHC	4
16	1498	NUT, 5/16-18 REGHEXCTRUK	4
17	57153	SPRING, SEAT 2.63 LONG, .49 OD, BLACK	2
18	1341	CLAMP, SPRING, .17 ID	2
19	44811	SCREW, 1/4-20 X .75 WAHHTAP	2
20	56907	COVER, SEAT SPRING 1.5 ID X 1.0 LONG	2
21		ASSEMBLY, FENDER, F5, WALK-THRU, LF, SUS	1
21-1	332188-854	FENDER, WALK-THRU, SOF, SUS, LF	1
21-2	9239	CLEVIS	1
21-3	439455	SCREW, 5/16-18 X .56 PHPNMA	1
21-4	301551	WASHER, .344 ID X 1.50 D X .09	1
21-5	120373	NUT, 5/16-18 SQUARE	1
22	995346	SCREW, 1/4-20 X .50 WAHHTAP	4
23	35497	SCREW, 5/16-18 X 50 WAHHTAP	2
24	126358	BOLT, 5/16-18 X 1.00 CARRLN	2
26	55273	NUT, 5/16-18 WDFLLKLRG, WHIZ	2
27	55023	TRIM, STRIP, BLACK—SMALL, W/ADH	77.5'
28	910384	SEAT, MICHIGAN GEN, W/SW HOLE	1
29	120393	WASHER, FLAT .344 X .69 X .065	4
30	120638	WASHER, HVSP TLK .328 X .60 X .09	4
31	180077	SCREW, 5/16-18 X .75 HHC	4

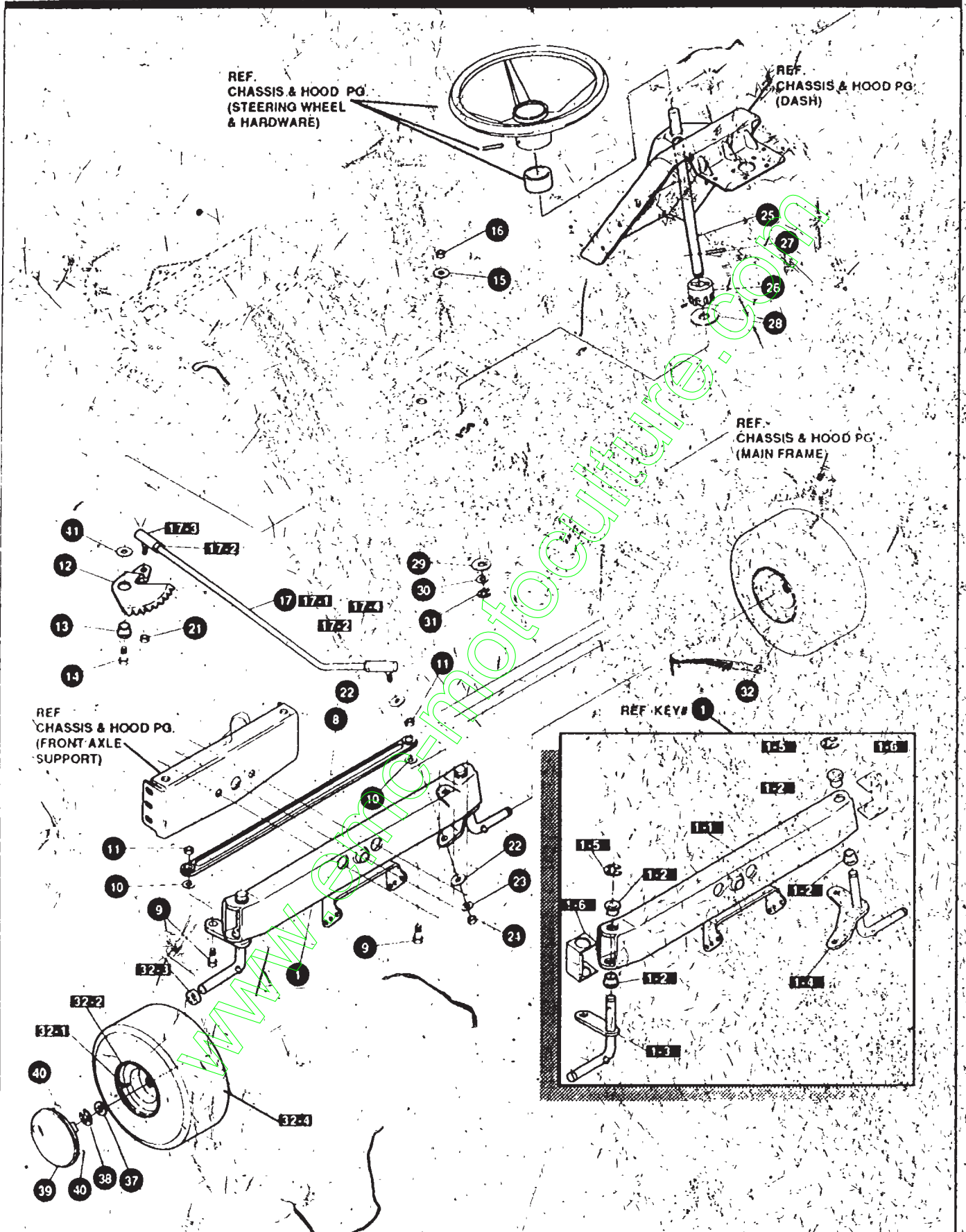

NOTE: ALWAYS USE ORIGINAL EQUIPMENT PARTS.
Use of service/replacement parts other than original equipment parts may void your warranty.

ALL UNNUMBERED ITEMS ARE INTERCHANGEABLE WITH OPPOSITE SIDE

322616.F

KEY#	PART#	DESCRIPTION	QTY
1		AXLE FRONT ASSEMBLY LONG SUS 4WS LF	1
1-1	310170	AXLE FRONT	1
1-2	52407	SPINDLE BEARING	4
1-3	9180	ASSEMBLY SPINDLE RH LONG	1
1-4	314088	ASSEMBLY SPINDLE LH LONG	1
1-5	36625	RING RETEX 57 X 05 TRU 5133 75	2
1-6	53373	AXLE COVER	2
8	304590	TIE ROD ASSEMBLY 19 81 LONG W SECTION	1
9	180128	SCREW 3/8-16 X 1.75 HHC	2
10	120382	WASHER REGSPTLK 393 X 68 X 10	2
11	1499	NUT 3/8-16 REGHXCTRLK	2
12	58289	SECTOR STEERING LF	1
13	52406	BEARING FLANGE ECC 510 ID X 998 OD X 56	1
14	180177	SCREW 1/2-13 X 1.50 HHC	1
15	22265	WASHER FLAT 515 X 138 X 119	1
16	1500	NUT 1/2-13 REGHXCTRLK	1
17	311100	KIT 300146 DRAGLINK	1
17-1	58291	STEERING LINK	1
17-2	124925	NUT 3/8-24 REGHEXJAM	2
17-3	57158	BALL JOINT 3/8 THD SHORT STUD	1
17-4	21275	BALL JOINT 3/8 THD LONG STUD	1
21	46692	NUT 3/8-24 WDFLHLK WHIZ	1
22	996416	WASHER FLAT 391 X 100 X 125	2
23	120382	WASHER REGSPTLK 393 X 68 X 10	1
24	120369	NUT 3/8-24 REGHEX	1
25	58243	SHAFT STEERING LF 2WS	1
26	58244	PINION STEERING LF	1
27	58274	PIN DOWEL 2500 OD X 1.75 LONG	1
28	301410	BEARING FLANGE 752 ID X 1061 OD X 24	1
29	301398	WASHER FORMED 1.135 X 1.53 X 12	1
30	21682	WASHER FLAT 765 X 1.25 X 042	1
31	36625	RING RETEX 57 X 05 TRU 5133 75	1
32		TIRE & RIM PU 15 X 60 X 6	2
32-1	241671	VALVE STEM	1
32-2	39829	RIM WHEEL	1
32-3	314416	BEARING FLANGE	1
32-4	316702	TIRE 15 X 6 X 6	1
37	642	WASHER FLAT 755 X 1.31 X .075	4
38	36625	RING RETEX 57 X 05 TRU 5133 75	2
39	304444	HUB CAP 6" EURO	2
40	306669	CLIP HUBCAP TINN #G25467 017 4	8
41	49998	WASHER FLAT 520 X 1.25 X 209	1

ORDER INDIVIDUAL PARTS - ASSEMBLY NOT AVAILABLE

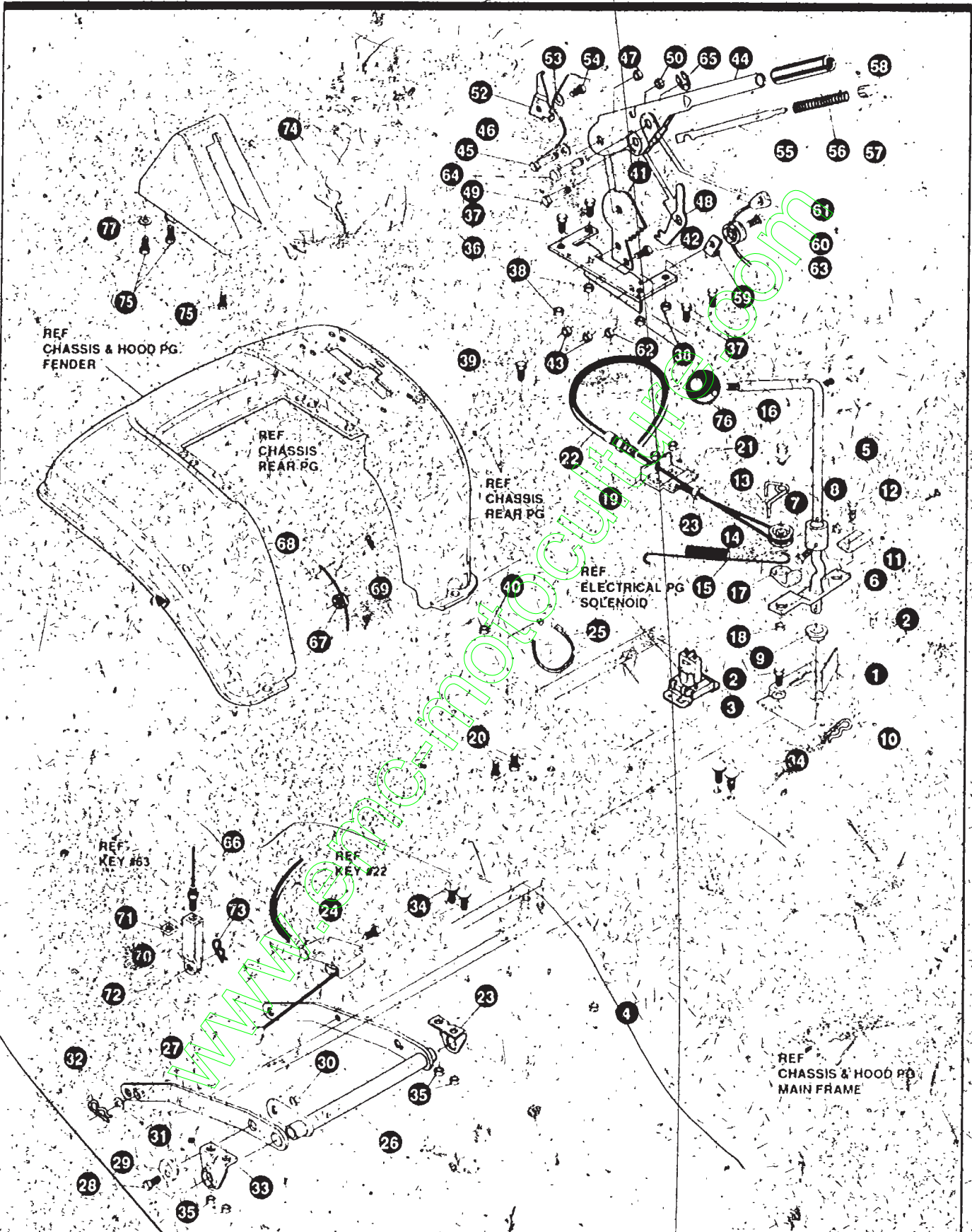

NOTE: ALWAYS USE ORIGINAL EQUIPMENT PARTS.
Use of service/replacement parts other than original
equipment parts may void your warranty.

ALL UNNUMBERED
ITEMS ARE INTERCHANGEABLE
WITH OPPOSITE SIDE

KEY#	PART#	DESCRIPTION	QTY
1	320075-853	BRACKET CLUTCH ENGAGE LEVER	1
2	180079	SCREW, 5/16-18 X 1.00 HHC	2
3	120393	WASHER, FLAT .344 X .69 X .065	2
4	1498	NUT, 5/16-18 REGHEXCTRLK	2
5	331050	LEVER, PTO, UPPER, LF, EURO I & II	1
6	331727	ASSEMBLY, CLUTCH LEVER, LOWER	1
7	308231	SCREW, 1/4-20 X 1.25 HHWATAP	1
8	1502	NUT, 1/4-20 REGHEXCTRLK	1
9	50148	BEARING, FLANGE 503 ID X 63 OD X 5/8	1
10	8260	PIN, HAIR .091 DIA X 1.66 LONG	1
11	318341	BRACKET, SWITCH ENGAGE	1
12	35498	SCREW, 5/16-18 X .75 WAHHTAP	1
13	324032	SPRING, CABLE KEEPER 390 ID	1
14	48306	PULLEY, POWDER METAL	1
15	316648	SPRING 071 X .62 X 12.88	1
16	324045	BOLT, .375 X .565 HSSH	1
17	1288	BRACKET, CABLE RETAINER	1
18	1502	NUT, 1/4-20 REGHEXCTRLK	1
19	300698-853	BRACKET FRAME CABLE	1
20	180020	SCREW, 1/4-20 X .75 HHC	2
21	1502	NUT, 1/4-20 REGHEXCTRLK	2
22	324055	ASSEMBLY, CABLE, BLADE ENGAGE	1
23	120913	NUT, 1/4-28 HJAM	1
24	35498	SCREW, 5/16-18 X .75 WAHHTAP	1
25	57444	TIE, CABLE BLACK NYLON, 5.62 LONG	1
26	300158-853	LIFT ASSEMBLY, LH	1
27	300169-853	LIFT ASSEMBLY, RH	1
28	180079	SCREW, 5/16-18 X 1.00 HHC	1
29	58247	NUT, ADJUST	1
30	1498	NUT, 5/16-18 REGHEXCTRLK	1
31	417098	WASHER, FLAT .531 X 1.06 X .063	2
32	8260	PIN, HAIR .091 DIA X 1.66 LONG	2
33	58248-853	BRACKET, REAR HANG, SUSP	2
34	57072	BOLT, 5/16-18 X .63 CARRLN	4
35	1498	NUT, 5/16-18 REGHEXCTRLK	4
36	313926	BRACKET, HEIGHT/ADJUST SUPPORT	1
37	180077	SCREW, 5/16-18 X .75 HHC	4
38	1498	NUT, 5/16-18 REGHEXCTRLK	4
39	180077	SCREW, 5/16-18 X .75 HHC	1
40	1498	NUT, 5/16-18 REGHEXCTRLK	1
41	301238	QUADRANT, HEIGHT ADJUST	1
42	180077	SCREW, 5/16-18 X .75 HHC	2
43	1498	NUT, 5/16-18 REGHEXCTRLK	2
44	322292-853	HANDLE, LIFT SHORT(30" S F)	1
45	300171	BOLT, 500X 270 HSSH, 5/16-18	1
46	996418	WASHER, FLAT .506 X .75 X .024	1
47	44108	NUT, 5/16-18 HWDFLCTRLK	1
48	301239	PAWL, SQUARE	1
49	300171	BOLT, 500 X 270 HSSH, 5/16-18	1
50	44108	NUT, 5/16-18 HWDFLCTRLK	1
51	9435	POINTER, HEIGHT ADJUST	1
52	138479	WASHER, EXLK .195 X .41 X .03	1
54	35287	SCREW, #8-32 X .38 HHWATAP	1
55	303027	ROD, ACTUATOR-SHORT	1
56	58326	SPRING, HEIGHT ADJUST	1
57	58325	KNOB, HEIGHT ADJUST PUSH BUTTON	1
58	58329	GRIP, 750 OD W/ HOLE BLACK	1
59	9149	BRACKET, CABLE RETAINER	1
60	48306	PULLEY, POWDER METAL	1
61	58336	BOLT, .375 X .375 HSSH, 1/4-20	1
62	1502	NUT, 1/4-20 REGHEXCTRLK	1
63	314177	CABLE, LIFT, 22.92' F.5, 20 X 8.8	1
64	300310	PIN, CLEVIS .310 DIA, .475 LONG	1
65	300311	RING, RET E .31 X .25 TRU 5133.31	1
66	120375	NUT, 1/4-20 REGHEX	1
67	48306	PULLEY, POWDER METAL	1
68	300317	PIN, CLEVIS .375 DIA X .81 LONG	1
69	8260	PIN, HAIR .091 DIA X 1.66 LONG	1
70	9405	CLEVIS, LIFT CABLE	1
71	120372	NUT, 1/4-20 REGSQ	1
72	39522	PIN, CLEVIS .312 X .812	1
73	121222	PIN, COTTER .090 DIA X .75 LONG	1
74	333903	LIFT COVER, F5, LF, SF, BLACK	1
75	300340	SCREW, #10 X .75 HHPLAST BLACK	3
76	321837	KNOB, ROUND 1.50 DIA MATTE BLACK	1
77	120392	WASHER, FLAT .281 X .63 X .065	1

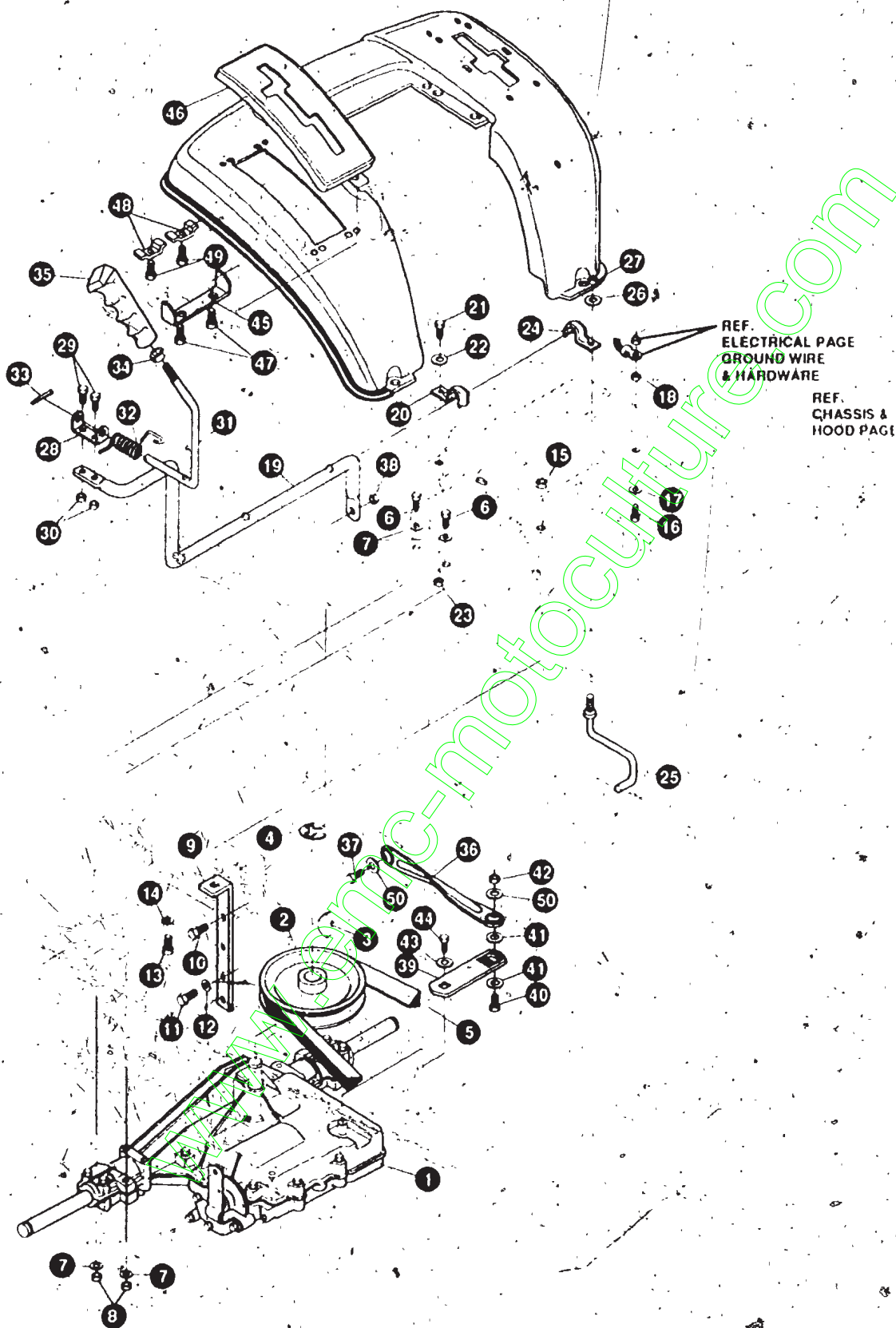

NOTE: ALWAYS USE ORIGINAL EQUIPMENT PARTS.
Use of service/replacement parts other than original equipment parts may void your warranty.

**ALL UNNUMBERED
ITEMS ARE INTERCHANGEABLE
WITH OPPOSITE SIDE**

327670 D

KEY#	PART#	DESCRIPTION	QTY
1	A	TRANSAXLE, 930-017A, 6SP, 2WS, LF	1
2	302745	PULLEY, 6.6 OD, V4L, T/A	1
3	50795	KEY, HI-PRO 606, .75 DIA X 187 WD	1
4	22053	RING, RETEX .58X 035TRU5100-62	1
5	314120	BELT, V 4L, 87 25, 4WS, LF	1
6	180091	SCREW, 5/16-18 X 2.50 HHC	4
7	120393	WASHER, FLAT 344 X 69 X .065	8
8	1498	NUT, 5/16-18 REGHEXCTRLK	4
9	323739	BRACKET, STABILIZER, BLACK	1
10	50947	SCREW, 3/8-16 X 1.25 WAHHTAP	1
11	35498	SCREW, 5/16-18 X .75 WAHHTAP	2
12	120638	WASHER, HVSPTLK 328 X 60 .09	2
13	180079	SCREW, 5/16-18 X 1.00 HHC	1
14	120393	WASHER, FLAT 344 X 69 X .065	1
15	1498	NUT, 5/16-18 REGHEXCTRLK	1
16	180077	SCREW, 5/16-18 X .75 HHC	1
17	138538	WASHER, REGINTLK 320 X 61 X .03	1
18	1498	NUT, 5/16-18 REGHEXCTRLK	1
19	319111	LEVER, SHIFT-LOWER, P930/F4360, LF	1
20	310347-853	CLIP- SHIFT LEVER, 625 ROD	1
21	180077	SCREW, 5/16-18 X .75 HHC	1
22	996416	WASHER, FLAT 391 X 1.00 X 125	1
23	1498	NUT, 5/16-18 REGHEXCTRLK	1
24	310347-853	CLIP- SHIFT LEVER, 625 ROD	1
25	57259	GUIDE, BELT 5/16-18 THD	1
26	996416	WASHER, FLAT 391 X 1.00 X 125	1
27	1498	NUT, 5/16-18 REGHEXCTRLK	1
28	310356	BRACKET, PIVOT, SHIFT LEVER	1
29	180020	SCREW, 1/4-20 X .75 HHC	2
30	1502	NUT, 1/4-20 REGHEXCTRLK	2
31	324798	LEVER, SHIFT, UPPER, SOF, 1/2-13	1
32	310265	SPRING, TORSION 56 X 95 X 095	1
33	137185	PIN, COTTER 125 DIA X 1.00 LONG	1
34	120238	NUT, 1/2-13 HEXJAM	1
35	306690	HANDLE, 1/2-13 MOLDED, BLACK	1
36	314965	LINK, TIE ROD, SHIFT, P930-6, SHORT	1
37	180124	SCREW, 3/8-16 X 1.25 HHC	1
38	1498	NUT, 3/8-16 REGHXCTRLK	1
39	309637	BRACKET, SHIFT 5SP, SF	1
40	180124	SCREW, 3/8-16 X 1.25 HHC	1
41	120394	WASHER, FLAT 406 X 81 X .065	2
42	1498	NUT, 3/8-16 REGHXCTRLK	1
43	57157	WASHER, 750 X 250 SP-TRANSAXLE	1
44	56255	SCREW, 1/4-28 X .75 NYLHHC	1
45	311257-853	BRACKET, COVER, F-5, FENDER SHIFT	1
46	311209	COVER, PLASTIC, LF, P930/F4360-6	1
47	311331	SCREW, 1/4-15 X .44/53 HILOHHWA	2
48	1341	CLAMP, SPRING 1.17" ID	2
49	311331	SCREW, 1/4-15 X .44/53 HILOHHWA	2
50	120394	WASHER, FLAT 406 X 81 X .065	2

^ CONTACT YOUR NEAREST TRANSAXLE DEALER FOR PARTS & SERVICE

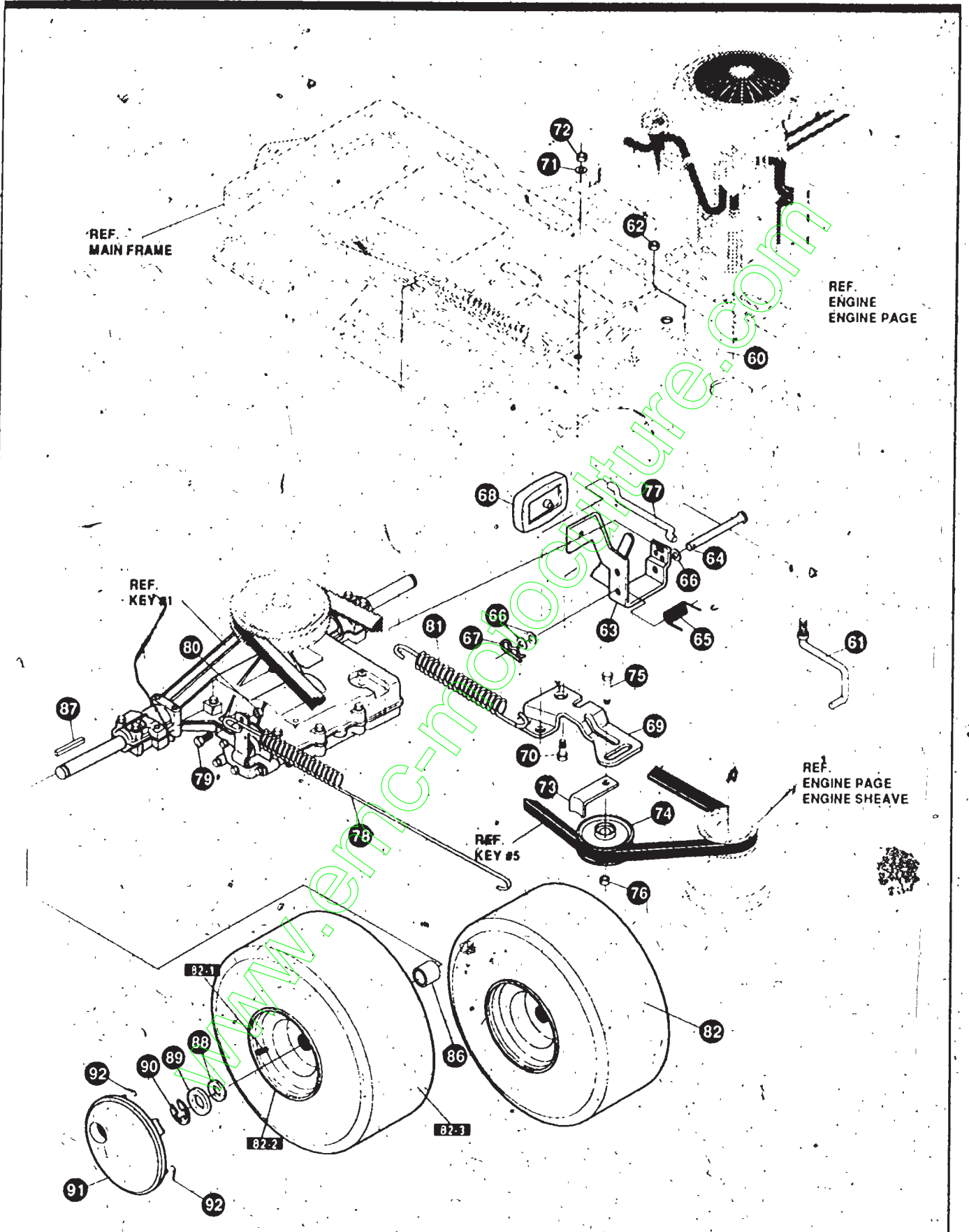

NOTE: ALWAYS USE ORIGINAL EQUIPMENT PARTS.
Use of service/replacement parts other than original
equipment parts may void your warranty.

ALL UNNUMBERED
ITEMS ARE INTERCHANGEABLE
WITH OPPOSITE SIDE

327670 D.

KEY#	PART#	DESCRIPTION	QTY
60	321514	SPRING, DRAG LINK BIAS	1
61	304016	GUIDE, BELT, RH	1
62	1498	NUT, 5/16-18 REGHEXCTRLK	1
63	325942	PEDAL ASSEMBLY, BRAKE/CLUTCH, LF	1
64	319675	PIN, CLEVIS 500 D X 4 53 LONG	1
65	57847	SPRING, BRAKE PEDAL	1
66	2968	WASHER, FLAT 504 X 75 X 059	3
67	56180	PIN, HAIR .091 DIA X 1.62 LONG	1
68	48160	PAD, CLUTCH BRAKE, W/PRINTING	1
69	320381	ARM, IDLER TRACTION, SOG, LF	1
70	329989	BOLT, 625 X 135 HSSH, 5/16-18	1
71	45602	WASHER, FLAT 333 X 87 X 119	1
72	1498	NUT, 5/16-18 REGHEXCTRLK	1
73	39659	RETAINER, BELT	1
74	35374	PULLEY, IDLER, V4L, 3 06 X 62	1
75	45892	BOLT, 3/8-16 X 1.50 CARRSN	1
76	1499	NUT, 3/8-16 REGHXCTRLK	1
77	57204	ROD, CLUTCH, 3 92"	1
78	325937	SPRING, BRAKE 28 80, 930, 4360	1
79	326131	BOLT, 495 X 31 HSSH, 5/16-18	1
80	1498	NUT, 5/16-18 REGHEXCTRLK	1
81	330505	SPRING, CLUTCH 113 X 750 X 8 75	1
82		TIRE & RIM, 20 X 8 00-8	2
82-1	24167	VALVE STEM	
82-2	57165	RIM, WHEEL	
82-3	319684	TIRE, 20 X 8 X 8	
86	301565	SPACER, SLEEVE .750 X 1 25 X 50	2
87	52928	KEY, SQUARE .187 SQUARE X 2.25 LONG	2
88	642	WASHER, FLAT .755 X 1 31 X 075	4
89	42815	WASHER, FLAT .755 X 1 53 X 07	2
90	36625	RING, RETEX 57 X 05 TRU 5133-75	2
91	304441	HUB CAP, 8" EURO	2
92	306669	CLIP, HUBCAP TINN #C25467-017-4	10

* ORDER INDIVIDUAL PARTS - ASSEMBLY NOT AVAILABLE

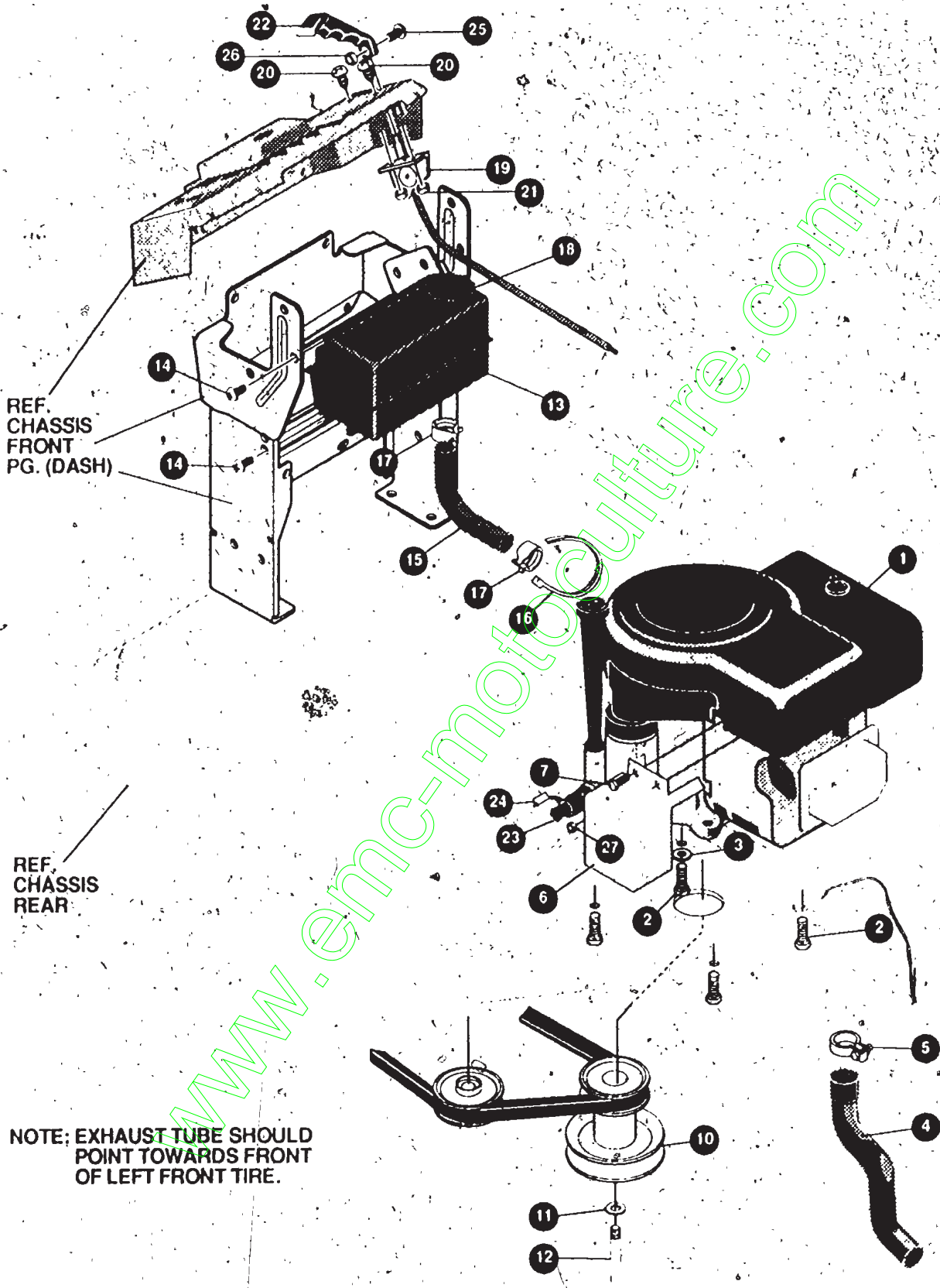

KEY#	PART#	DESCRIPTION	QTY
1		ENGINE, 14HP, B&S, IC, OHV, DUAL CIRCUIT	1
2	50947	SCREW, 3/8-16 X 1.25 WASH TAP, BLACK	4
3	138489	WASHER, EXLK 384 X .69 X .04	1
4	331327	EXHAUST TUBE, 14HP, OHV, B&S, LF H14	1
5	328024	CLAMP, EXHAUST, 1.37 DIA	1
6	331750-853	ASSEMBLY, HEAT SHIELD, 14HP, OHV, B&S	1
7	995348	SCREW, 1/4-20 X .50 WASH TAP	3
10	328029	PULLEY, ENGINE 4 400F/5 00D/3 00D	1
11	120383	WASHER, REGSPTLK 459 X .78 X .12	1
12	428644	SCREW, 7/16-20 X 5.00 HHC	1
13	309853	TANK, FUEL, 1.5 W/SENSOR, CLEAR	1
14	49050	SCREW, 1/4-10 X .75 PHPNTAP	4
15	42258	TUBING, .25 X .50 X BULK GAS LINE	11.5
16	57444	TIE, CABLE BLACK NYLON, 6.62 LONG	1
17	47345	CLAMP, HOSE SCREW TYPE	2
18	12501	CAP, FUEL 2.5" THROAT	1
19	315716	THROTTLE CONTROL, 17 0" CHKOMA	1
20	320553	SCREW, 10-24 X .63 PHPNMA	2
21	308459	NUT, #10-24 HXHDNYLK	2
22	300508	KNOB, THROTTLE CONTROL, GP STYLE	1
23	325547	OIL DRAIN VALVE ASSEMBLY	1
24	327422	CAP, OIL DRAIN VALVE ASSEMBLY, YELLOW	1
25	159585	SCREW, #8-32 X .38 PHPNMA	1
26	120622	NUT, #8-32 REGHX	1
27	124818	NUT, 1/4-20 REGHXJAM	1

SEE ENGINE MANUAL

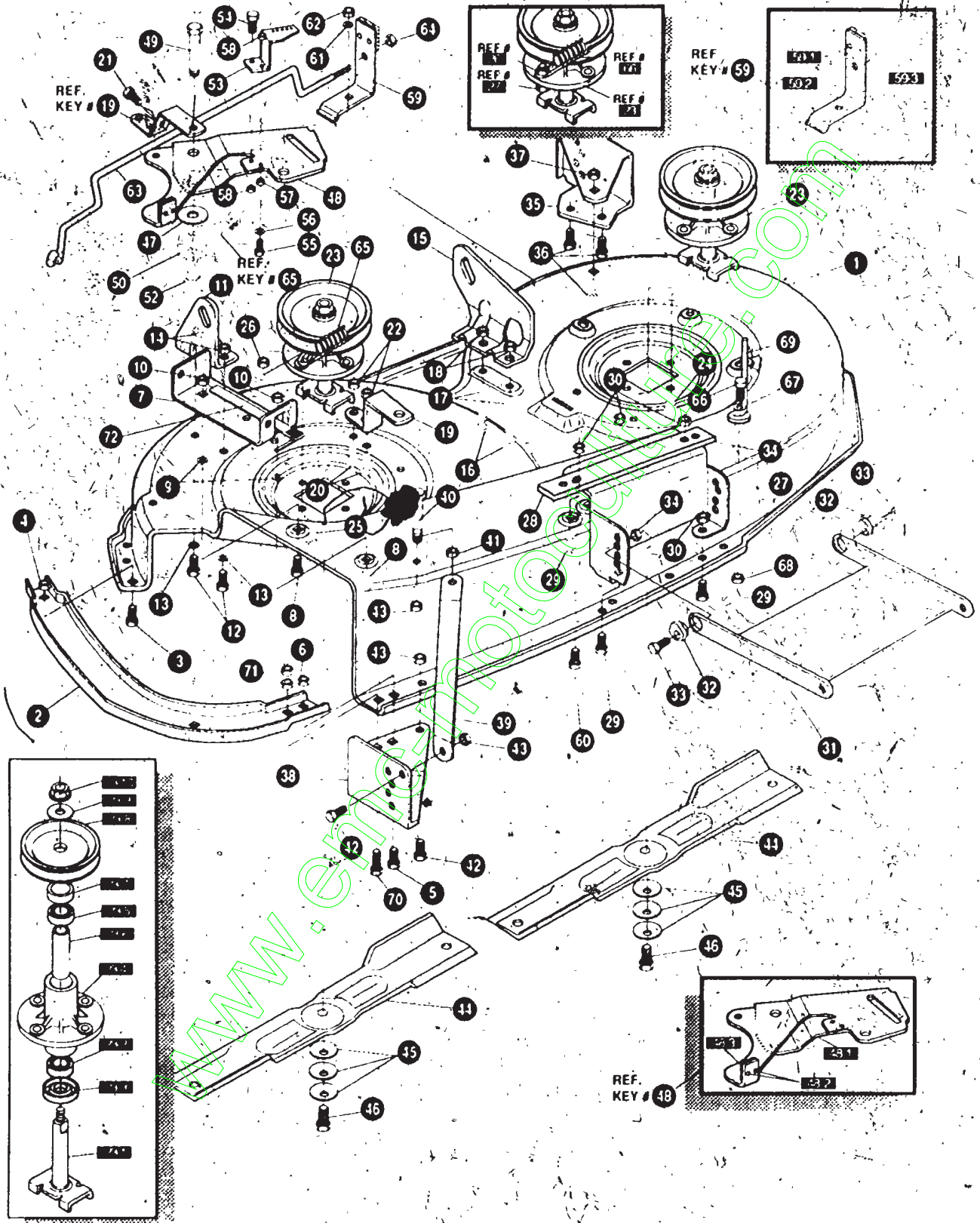

NOTE: ALWAYS USE ORIGINAL EQUIPMENT PARTS.
 Use of service/replacement parts other than original equipment parts may void your warranty.

ALL UNNUMBERED ITEMS ARE INTERCHANGEABLE WITH OPPOSITE SIDE

331508 B

KEY#	PART#	DESCRIPTION	QTY
1	325116	43" DECK KIT	1
2	326480	TOE GUARD - MULCHER	1
3	180077	SCREW, 5/16-18 X 75 HHC	1
4	1498	NUT, 5/16-18 REGHEXCTRLK	1
5	180077	SCREW, 5/16-18 X 75 HHC	1
6	1498	NUT, 5/16-18 REGHEXCTRLK	1
7	317017	BRACKET, CHUTE MOUNT, BLACK	1
8	180077	SCREW, 5/16-18 X 75 HHC	2
9	120393	WASHER FLAT 344 X 69 X 065	2
10	1498	NUT, 5/16-18 REGHEXCTRLK	2
11	313929	LIFT BRACKET, REAR, RH, BLACK	1
12	180077	SCREW, 5/16-18 X 75 HHC	2
13	120393	WASHER, FLAT 344 X 69 X 065	2
14	1498	NUT, 5/16-18 REGHEXCTRLK	2
15	310667	BRACKET, DECK, LIFT, REAR, LH, BLACK	1
16	180077	SCREW, 5/16-18 X 75 HHC	2
17	120393	WASHER, FLAT 344 X 69 X 065	2
18	1498	NUT, 5/16-18 REGHEXCTRLK	2
19	326893	BRACE, IDLER SUPPORT, 40", 43"	1
20	180077	SCREW, 5/16-18 X 75 HHC	2
21	308231	SCREW, 1/4-20 X 1 25 HIHWATAP	1
22	44108	NUT, 5/16-18 HWDFLCTRLK	2
23	56424	QUILL ASSEMBLY, 36/39/40/43	2
23 1	56425	SHAFT/SADDLE 36"	1
23 2	49562	BEARING, BALL 6203-2AA C3 ARMORED	1
23 3	50616	DUST SHIELD	1
23 4	55547	QUILL CASTING (1046)	1
23 5	49562	BEARING, BALL 6203-2AA C3 ARMORED	1
23 6	50818	SPACER, SLEEVE 669 X 88 X 3 797	1
23 7	51449	SPACER, SLEEVE 672 X 93 X 438	1
23 8	313898	PULLEY ASSEMBLY	1
23 9	56365	WASHER, SPECIAL QUILL	1
23 10	1282	NUT, 7/16-20 WDFLLK	1
24	35498	SCREW, 5/16-18 X 75 WAHHTAP	2
25	300345	SCREW, 5/16-18 X 1 38 WAHHTAP	1
26	1498	NUT, 5/16-18 REGHEXCTRLK	1
27	317040	BRACKET FRONT, BLACK	1
28	328155	PLATE MOUNTING	1
29	180077	SCREW, 5/16-18 X 75 HHC	4
30	1498	NUT, 5/16-18 REGHEXCTRLK	4
31	58305	BRACKET, LINK, DECK, FRONT	1
32	58247	NUT, ADJUST	2
33	180079	SCREW, 5/16-18 X 1 00 HHC	2
34	1498	NUT, 5/16-18 REGHEXCTRLK	2
35	317041	BRACKET, GAGE WHEEL, LH, BLACK	1
36	180077	SCREW, 5/16-18 X 75 HHC	3
37	1498	NUT, 5/16-18 REGHEXCTRLK	3
38	322464	BRACKET, GAGE WHEEL, RH, FRONT	1
39	314282	BRACKET, STABILIZER	1
40	311104	SCREW, 5/16-18 X 5 00 HHC	1
41	271184	NUT, 5/16-18 HEXKEPS	2
42	180077	SCREW, 5/16-18 X 75 HHC	2
43	1498	NUT, 5/16-18 REGHEXCTRLK	3
44	326961	BLADE, 43", BLACK	2
45	2483	WASHER, 39 ID X 1 25 D X 07 BELL VIL	5
46	39573	SCREW, 3/8-24 X 1 00 NYLHHC	2
47	996307	WASHER, FLAT 391 X 1 00 X 209	2
48	320576	IDLER ARM ASSEMBLY	1
48-1	322116	ARM, IDLER, 40/43" DECK	1
48-2	41601	RIVET, OYSET, 187 DIA X 50 LONG	2
48-3	306973	BRAKE PAD - HARD-NF343 (X-31)	1
49	304420	BOLT, 500 X 2 15 FHSH	1
50	996416	WASHER, FLAT 391 X 1 00 X 125	2
52	45171	NUT, 3/8-16 HWDFL WHIZ-LOCK	1
53	326249	BRACKET, EXTENSION IDLER	1
54	180077	SCREW, 5/16-18 X 75 HHC	2
55	180083	SCREW, 5/16-18 X 1 50 HHC	1
56	446363	WASHER, FLAT 375 X 88 X 082	1
57	271184	NUT, 5/16-18 HEXKEPS	1
58	1498	NUT, 5/16-18 REGHEXCTRLK	2
59	321828	BLADE BRAKE ASSEMBLY	1
59-1	135624	RIVET, TRSET, 185 DIA X 41 LONG	2
59-2	304119	BRAKE ARM	1
59-3	306973	BRAKE PAD - HARD-NF343 (X-31)	1
60	180077	SCREW, 5/16-18 X 75 HHC	1
61	120393	WASHER, FLAT 344 X 69 X 065	1
62	1498	NUT, 5/16-18 REGHEXCTRLK	1
63	315304	ROD, BRAKE	1
64	1502	NUT, 1/4-20 REGHEXCTRLK	1
65	35410	SPRING 071 X 82 X 4 37	1
66	180079	SCREW, 5/16-18 X 1 00 HHC	1
67	120393	WASHER, FLAT 344 X 69 X 065	1
68	1498	NUT, 5/16-18 REGHEXCTRLK	1
69	325965	BELT GUIDE 43" DECK, UPSTOP	1
70	12685	SCREW, 5/16-18 X 1 50 HHCFT	1
71	1498	NUT, 5/16-18 REGHEXCTRLK	2
72	322320	LEVER ASSEMBLY (SHORT)	1

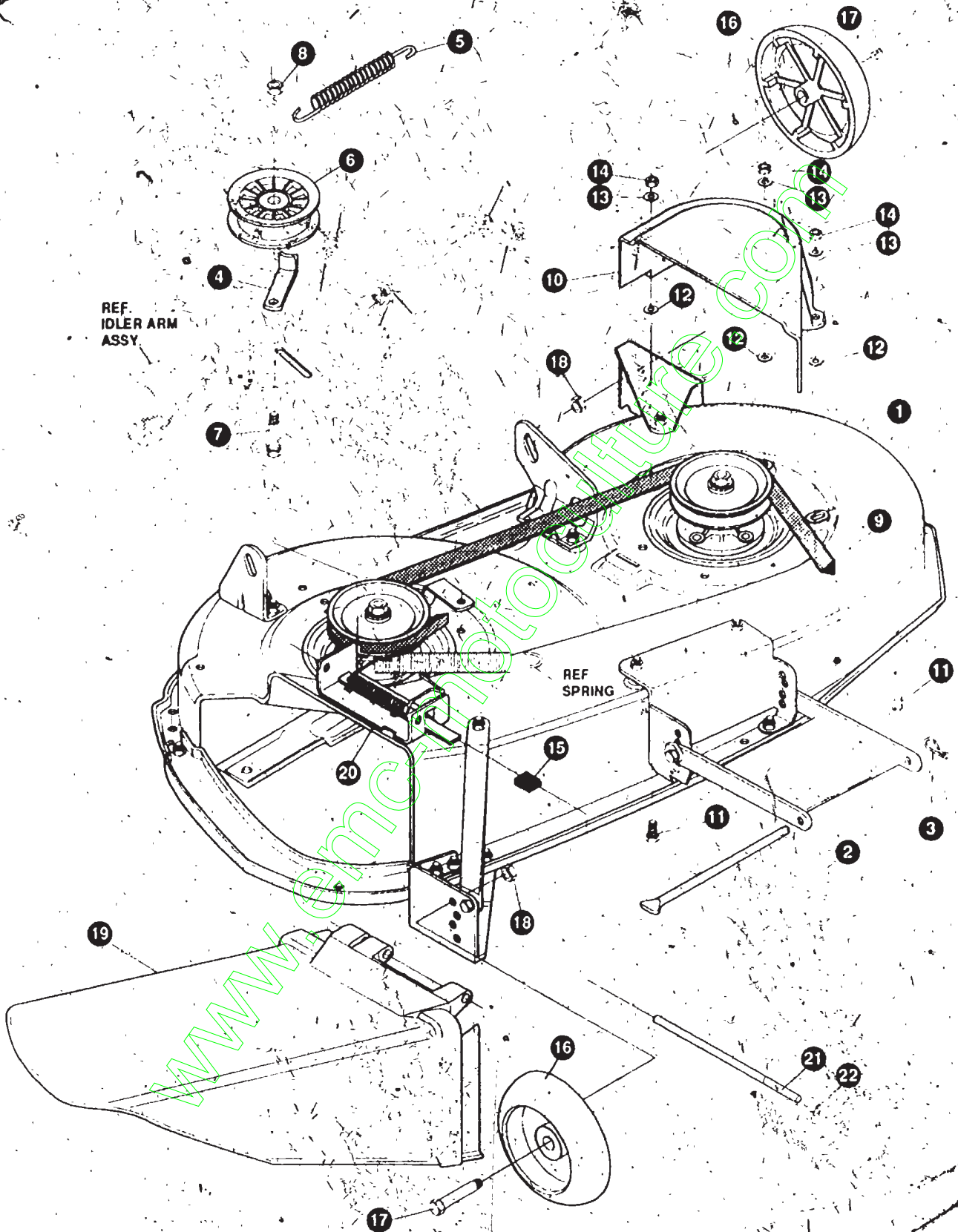

REF.
IDLER ARM
ASSY.

REF
SPRING

NOTE: ALWAYS USE ORIGINAL EQUIPMENT PARTS
Use of service/replacement parts other than original
equipment parts may void your warranty.

ALL UNNUMBERED
ITEMS ARE INTERCHANGEABLE
WITH OPPOSITE SIDE

331509 A

KEY#	PART#	DESCRIPTION	QTY
1	329036	DECK, 43" MOWER, 2-WH, DOM, AIR	1
2	58306	ROD, DECK HITCH	1
3	8260	PIN, HAIR .091 DIA X 1.66 LONG	1
4	1346	RETAINER, BELT	1
5	014107	SPRING, TENSION 5.00 LONG, 17 LB/IN	1
6	310326	PULLEY, IDLER BFF 4.00 WIDE FLANGE	1
7	126416	BOLT, 3/8-16 X 1.75 CARBLN	1
8	45171	NUT, 3/8-16 HWDFL WHIZ-LOCK	1
9	314108	BELT, V 5L 86 00 KEVLAR	1
10	333073	GUARD, BELT, LH, PLASTIC	1
11	57101	BOLT, 5/16-18 X .75 CARBNS	3
12	309436	PUSHNUT, 5/16 BOLT RETAINER	3
13	120393	WASHER, FLAT .344 X .69 X .065	3
14	1498	NUT, 5/16-18 REGHEXCTRLK	3
15	42348	GRIP-LEVER, GRASS COLLECTOR	1
16	302611	GAUGE WHEEL, EURO 6.00 OD X 1.38 WD	2
17	23763	BOLT, 5/00 X 1.390 HSSH, 3/8-16	2
18	1499	NUT, 3/8-16 REGHXCTRLK	2
19	304422	CHUTE DEFLECTOR, 40", 42" & 43"	1
20	314975	SPRING, TORSION, CHUTE DEFLECTOR	1
21	304424	ROD, PIVOT DECK .312 D X 7.25	1
22	3535	NUT, PUSH ON CAP .312 OD	1

www.emc-direct.com

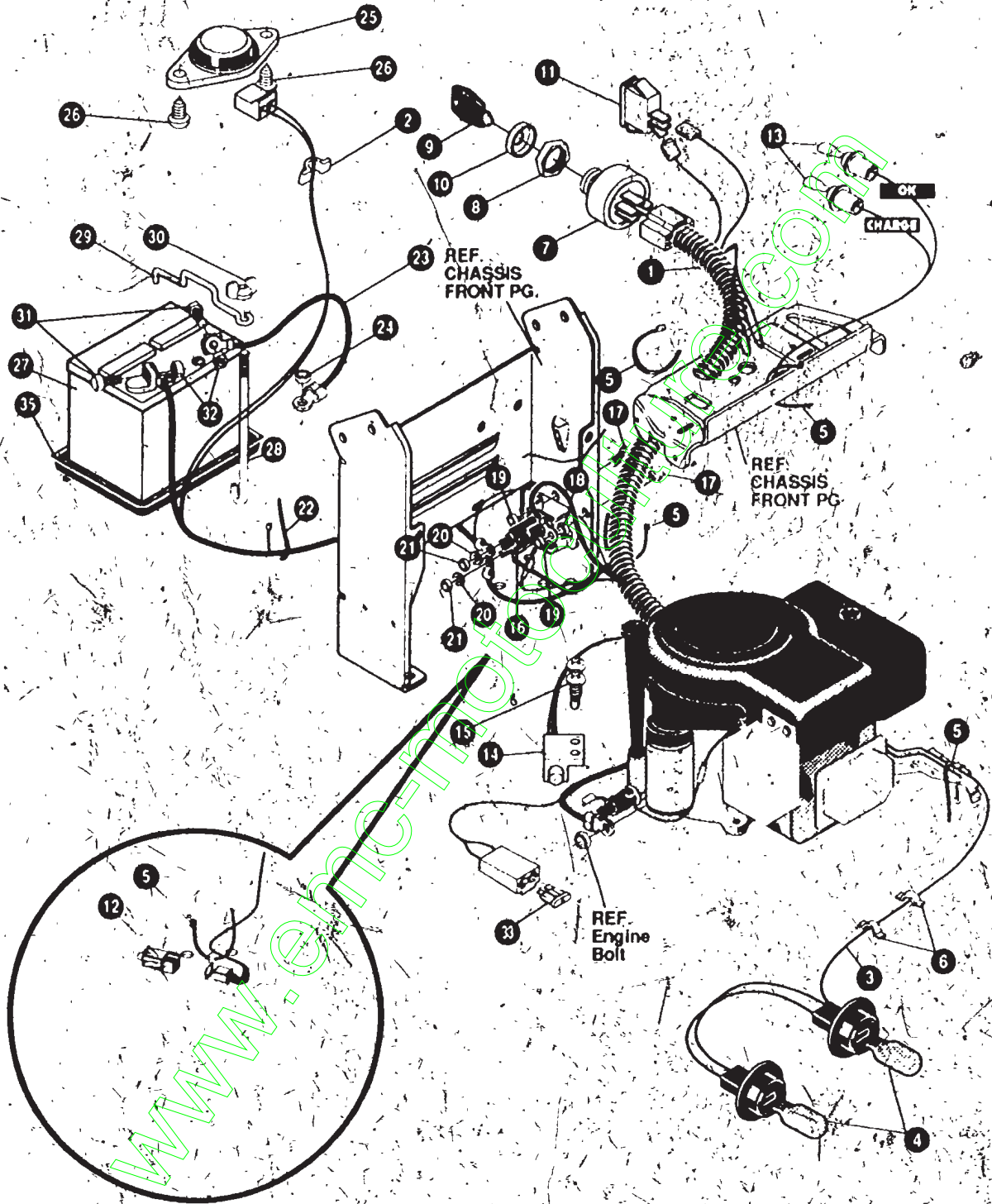

NOTE: ALWAYS USE ORIGINAL EQUIPMENT PARTS.
Use of service/replacement parts other than original equipment parts may void your warranty.

**ALL UNNUMBERED
ITEMS ARE INTERCHANGEABLE
WITH OPPOSITE SIDE**

332404 B

KEY#	PART#	DESCRIPTION	QTY
1	331360	HARNASS, 14HP, B&S, OHV, EUR0152, LF, SUS	1
2	41482	PRESS CLIP, 1.380 LONG, 255 ID	1
3	303064	ASSEMBLY, LIGHT, WIRE-1/4 TURN	1
4	52572	BULB, HEADLAMP	2
5	57444	TIE, CABLE, BLACK NYLON, 5.62 LONG	5
6	41482	PRESS CLIP, 1.380 LONG, 255 ID	3
7	327355	SWITCH, IGNITION AFTER FIRE) 3 POSITION	1
8	327352	NUT, 5/8-8, ACME, DELTA FOR BOOT	2
9	327350	KEY, IGNITION	2
10	300194	BOOT, IGNITION SWITCH	1
11	328826	LIGHT SWITCH, PANEL MOUNT	1
12	320082	SWITCH, DOUBLE POLE NO/NC GRAY	1
13	57769	BULB, INDICATOR	2
14	57476	SWITCH, SCREW MOUNT, DP, NC, NO, BLACK	1
15	57220	SCREW, #12 X .50 PHRNHTAP, BLACK	2
16	53716	SOLENOID	1
17	187745	SCREW, 1/4-20 X 75-HXSEMMA	2
18	1502	NUT, 1/4-20 REGHEXCTRLK	2
19	271172	NUT, 1/4-20 REGHEXKEPS	1
20	138485	WASHER, EXLK 320 X 61 X .03	2
21	120368	NUT, 5/16-24 REGHEX	2
22	57444	TIE, CABLE, BLACK NYLON, 5.62 LONG	1
23	55511	WIRE, GROUND, 12.5	1
24	271184	NUT, 5/16-18 HEXKEPS	1
25	57547	SWITCH, SEAT	1
26	160505	SCREW, 1/4-20 X .38 PHNMA	2
27	92693	BATTERY, 12V (MAINTENANCE FREE)	1
28	57551	ROD, BATTERY	1
29	57552	ROD, BATTERY TOP	1
30	325232	NUT, WING 1/4-20 NYLON	1
31	180020	SCREW, 1/4-20 X 75 HHC	2
32	271172	NUT, 1/4-20 REGHEXKEPS	2
33		FUSE, INCLUDED IN WIRE HARNASS	
35	91895	TRAY, BATTERY	1

SCHEMATIC DRAWING

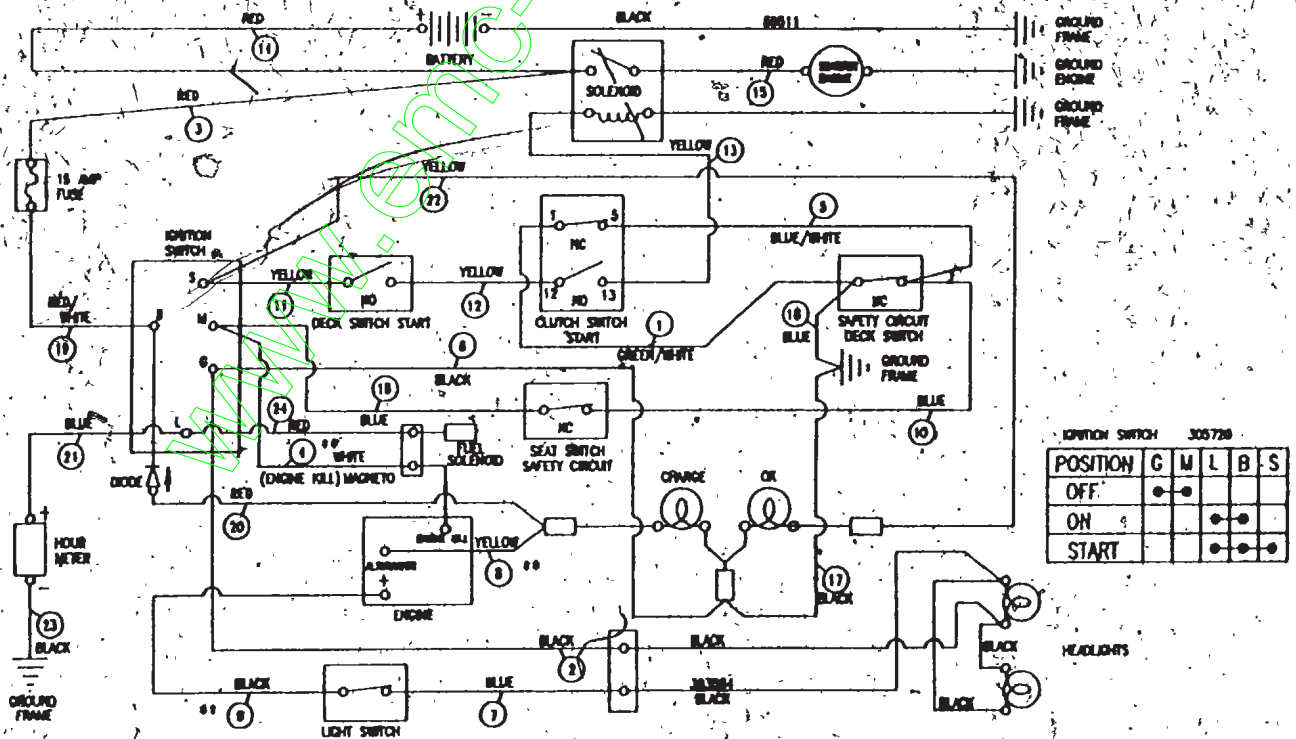

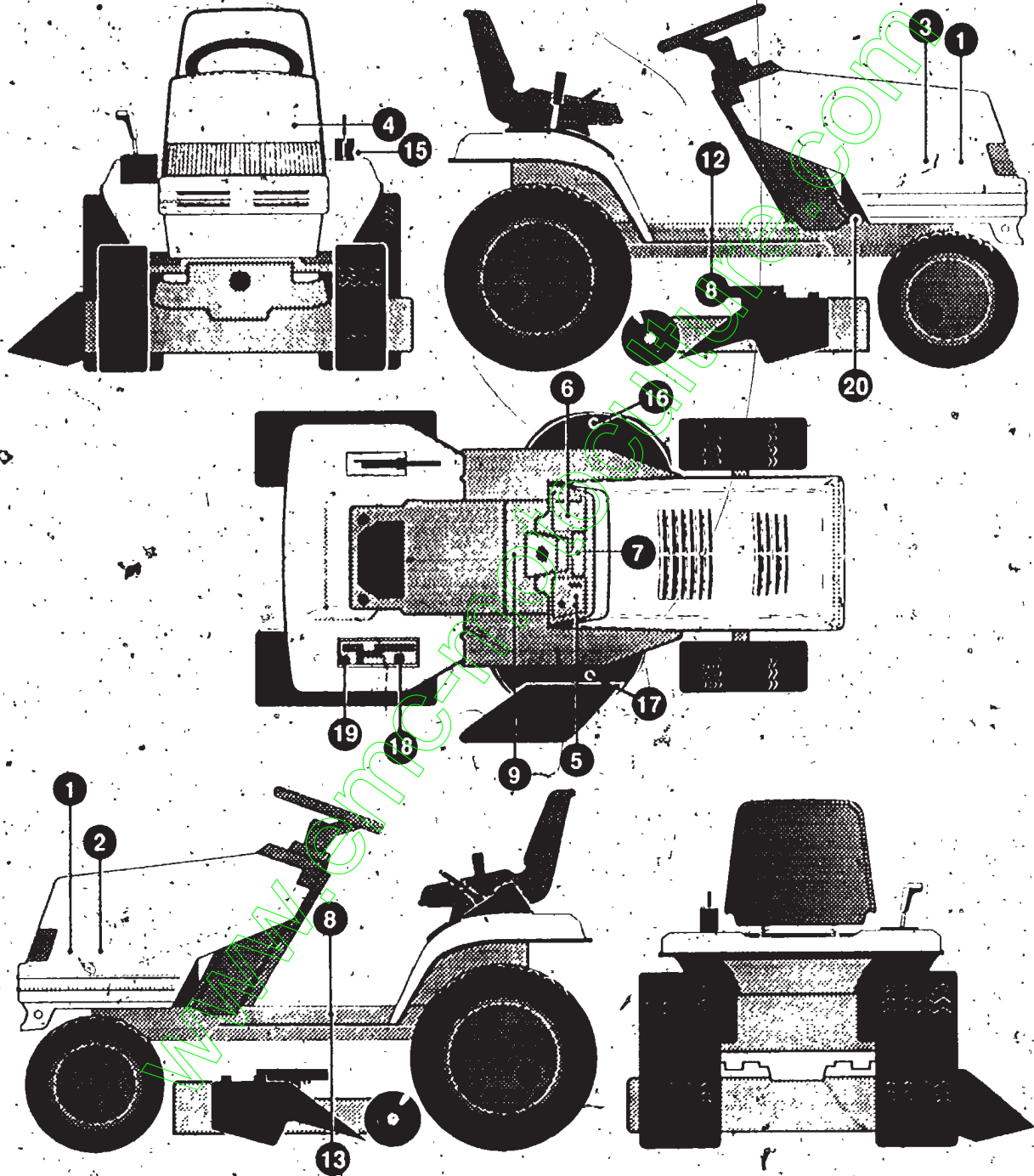

KEY#	PART#	DESCRIPTION	QTY
1	328688	DECAL, JARDIPRO, BLUE W/RED	2
2	402379	DECAL, HOOD, JARDIPRO, H-16	1
3	402378	DECAL, HOOD, JARDIPRO, H-16	1
4	402373	DECAL, JARDIPRO (SMALL)	1
5	332805	DECAL, DASH, RH, ISO, ENG N/HR, CHK	1
6	315766	DECAL, DASH, LH, ISO, CHOKE O-MATIC	1
7	324934	DECAL, DASH, ALL SYSTEMS, CHARGE DIODE	1
8	402660	NAMEPLATE, 1 1/2" X 1/2", CHROME	2
9	402689	DECAL, CONSOLE, SYMBOLIC, CAUTION	1
12	402380	DECAL, JARDIPRO, CONSOLE	1
13	402381	DECAL, JARDIPRO, CONSOLE	1
15	402214	DECAL, HEIGHT ADJUST	1
16	402700	DECAL, CAUTION DECK, LH	1
17	402701	DECAL, CAUTION DECK, RH	1
18	331005	DECAL, SHIFTER POSITION, P930 6	1
19	311394	DECAL, SHIFT REVERSE/NEUTRAL	1
20	402702	DECAL, BRAKE/CLUTCH	1