

| Position | Numéro de lapièce | # | Appellation I | Appellation II |
|----------|----------------------|---|---------------------------------|------------------------------|
| 1 | 619-04183B | 1 | CORPS DE PALIER | FINISH:WIE GEGOSSEN |
| 2 | 712-0417A | 1 | ÜCROU HEX. AV. FLANC: 5/8-18 | FINISH:MTD STD 701-01000 |
| 3 | 736-0351 | 1 | RONDELLE .75x1.50" | FINISH:MTD SPEC-100016 |
| 4 | 738-1186A | 1 | AXE DE PALIER DE LAME | FINISH:GEÖLT |
| 5 | 741-0919A | 2 | ROULEMENT A BILLES | FINISH: |
| 6 | 750-04936 | 2 | ENTRETOISE | FINISH:GEÖLT |
| 7 | 756-1227 | 1 | POULIE DE PALIER DE LAME | FINISH:SIEHE ZG. |
| 8 | 618-04822A | 1 | PALIER DE LAME COMPLET | FINISH: SIEHE BOM 918-04822A |

www.emc-motoculture.com

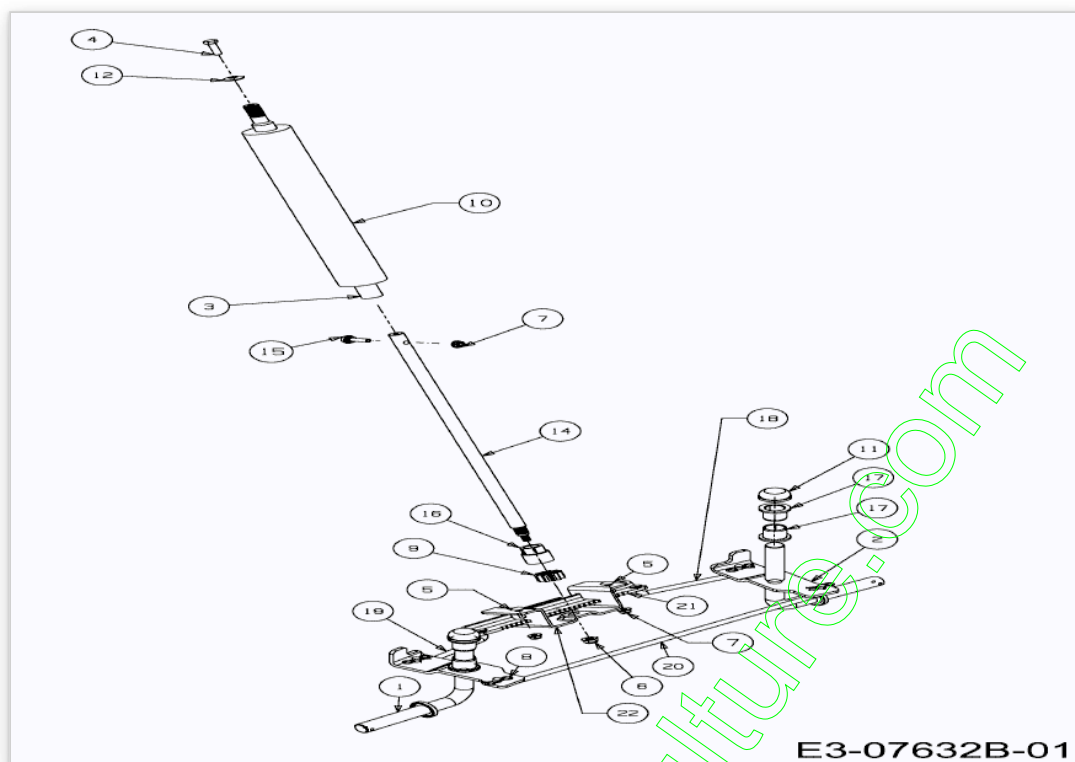

| Position | Numéro de lapièce | # | Appellation I | Appellation II |
|----------|----------------------|---|-----------------------------------|-------------------------------|
| 1 | 683-04726 | 1 | | |
| 2 | 683-04727 | 1 | | |
| 3 | 683-04763 | 1 | | |
| 4 | 710-0643 | 1 | VIS HEX.: 5/16-18:1.00:GR5 | FINISH:MTD SPEC-100015 |
| 5 | 710-0703 | 2 | VIS | FINISH:MTD SPEC-100015 |
| 6 | 712-04063 | 1 | ECROU HEX. AVEC FLANC | FINISH:MTD SPEC-100015 |
| 7 | 712-04064 | 3 | ECROU HEXAGONAL | FINISH:SPEC-100015 912-04064 |
| 8 | 714-04040 | 4 | GOUPILLE | FINISH:ASTM F1941 FE/ZN 3AN |
| 9 | 717-1554 | 1 | PIGNON DE DIRECTION | FINISH:GEÖLT |
| 10 | 723-04095A | 1 | PROTECTION DE COLONNE | 723-04095A |
| 11 | 726-0341 | 2 | CAPUCHON CLIPS | FINISH:SCHWARZ |
| 12 | 736-0242 | 1 | RONDELLE CONIQUE.340X.872X.060 | FINISH:MTD SPEC-100016 |
| 14 | 738-04537 | 1 | COLONNE DE DIRECTION | 738-04537 |
| 15 | 738-05000 | 1 | VIS EPAULEE | FINISH:MTD SPEC-100015 |
| 16 | 741-04542A | 1 | BAGUE | FINISH:PLAIN |
| 17 | 741-0660A | 4 | BAGUE ESSIEU DE ROUE | FINISH:KUNSTSTOFF SCHWARZ |
| 18 | 747-05514 | 1 | TIGE DE DIRECTION GAUCHE | 747-05514 |
| 19 | 747-05585 | 1 | TIGE DE DIRECTION DROITE | 747-05585 |
| 20 | 747-06027 | 1 | TRINGLE DE DIRECTION | BLACK E-COAT o.SPEC-701-01000 |
| 21 | 783-06988A | 1 | CREMAILLE DE DIRECTION | 783-06988A |
| 22 | 783-07239A | 1 | SUPPORT DE DIRECTION | 783-07239A |

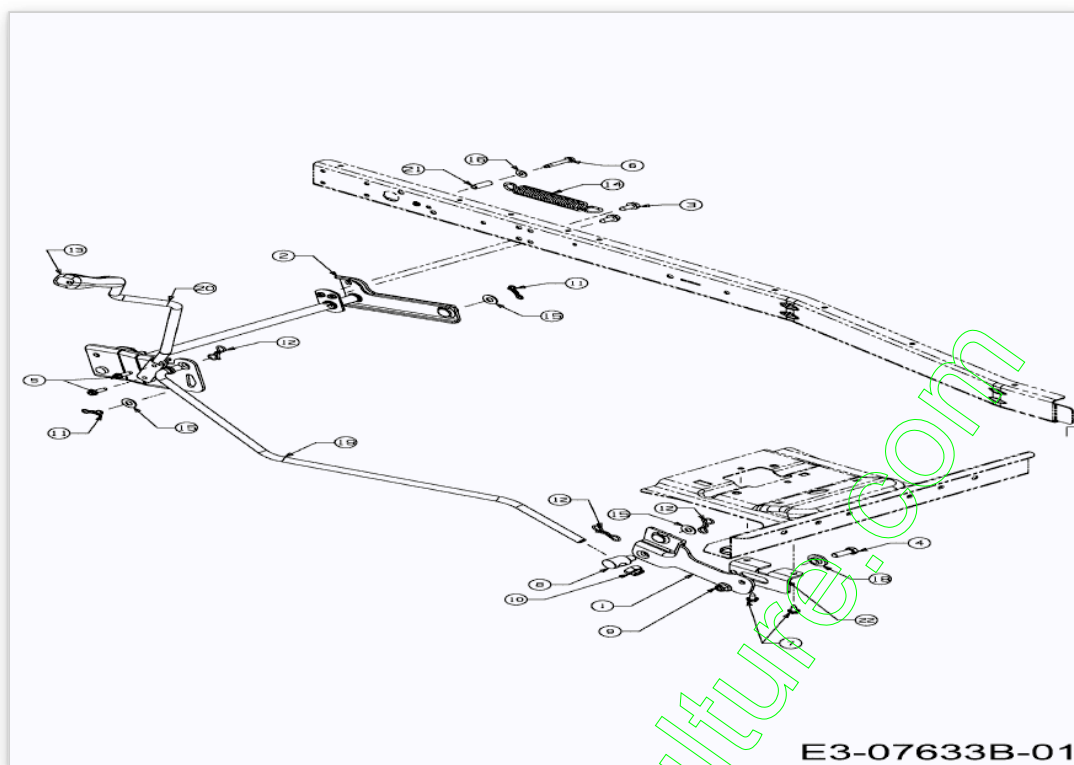

| Position | Numéro de lapièce | # | Appellation I | Appellation II |
|----------|----------------------|---|------------------------------------|-------------------------------|
| 1 | 683-04757 | 1 | | |
| 2 | 683-05060 | 1 | | |
| 3 | 710-04484 | 4 | VIS HEX. TT:5/16- 18:.750:HXIND | FINISH:MTD SPEC-100016 TYPE 1 |
| 4 | 710-0514 | 1 | VIS HEX.:3/8- 16:1.00:GR5:STD | FINISH:MTD SPEC-100015 |
| 5 | 710-0642 | 2 | VIS1/4-20:0.750 | SPEC-100016 TYPE 1 910-0642 |
| 6 | 710-0778 | 1 | VIS HEX. TT:1/4-20:1.500 | FINISH:MTD SPEC-100016 TYPE 1 |
| 7 | 710-1652 | 2 | VIS HEX. TT:1/4- 20:.625:HXINDW | FINISH:MTD SPEC-100016 TYPE 1 |
| 8 | 711-05690 | 1 | AXE | 711-05690 |
| 9 | 712-04065 | 1 | ECROU HEXAGONAL | FINISH:SPEC-100015 912-04065 |
| 10 | 712-04243 | 1 | ECROU | FINISH:MTD SPEC-100015 |
| 11 | 714-04040 | 2 | GOUPILLE | FINISH:ASTM F1941 FE/ZN 3AN |
| 12 | 714-04043 | 3 | GOUPILLE | FINISH:VERZINKT |
| 13 | 720-0311 | 1 | POIGNÉE LEVIER COUPE : 1/2 | FARBE:SCHWARZ VINYL |
| 14 | 732-04692 | 1 | RESSORT | FINISH:PHOS & OIL |
| 15 | 736-0300 | 3 | RONDELLE | FINISH:MTD SPEC-100015 |
| 16 | 736-0463 | 1 | RONDELLE | FINISH:MTD SPEC-100015 |
| 18 | 738-0347 | 1 | RONDELLE ; EMB. .625IDx.169 | FINISH: |
| 19 | 747-05511 | 1 | TRINGLE DE RELEVAGE | 747-05511 |
| 20 | 747-05576 | 1 | | |
| 21 | 750-0566A | 1 | ENTRETOISE | FINISH:MTD SPEC-100015 |
| 22 | 783-07129 | 1 | | |

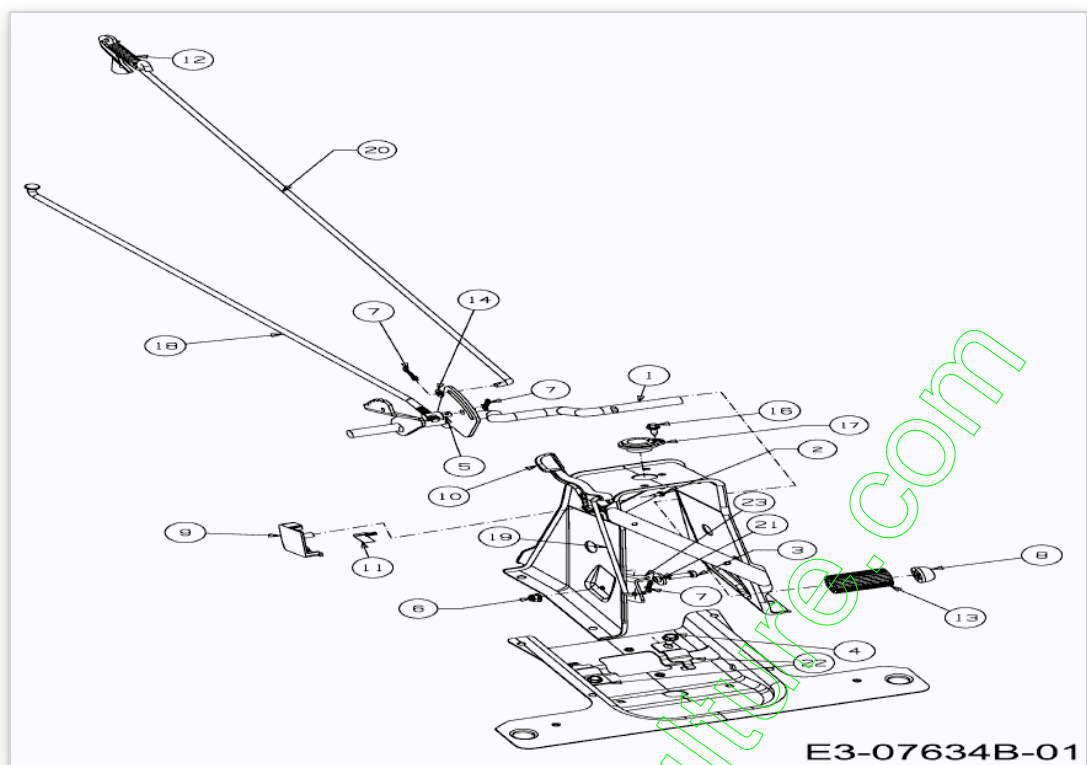

| Position | Numéro de lapièce | # | Appellation I | Appellation II |
|----------|----------------------|---|------------------------------------|-------------------------------|
| 1 | 683-05017 | 1 | | |
| 2 | 710-0224 | 1 | VIS PARK:#10- 16:0.500:HXINDWSH | FINISH:MTD SPEC-100016 TYPE 1 |
| 3 | 710-0376 | 1 | VIS HEX.:5/16- 18:1.00:GR5:STD | FINISH:MTD SPEC 701-01006 |
| 4 | 710-0371 | 2 | VIS | 710-0371 |
| 5 | 711-06103 | 1 | FERRURE | FINISH:MTD SPEC-100015 |
| 6 | 712-04063 | 1 | ECROU HEX. AVEC FLANC | FINISH:MTD SPEC-100015 |
| 7 | 714-04040 | 3 | GOUPILLE | FINISH:ASTM F1941 FE/ZN 3AN |
| 8 | 726-0214 | 1 | BOUCHON | FINISH: SCHWARZ |
| 9 | 731-08656A | 1 | COUVERCLE POIGNEE DE VITESSE | 731-08656A |
| 10 | 731-08743B | 1 | LEVIER SELECTEUR | 731-08743B |
| 11 | 732-04937 | 1 | RESSORT DE VERROUILLAGE | FINISH:SPEC-100015 |
| 12 | 732-0716D | 1 | RESSORT | FINISH:MTD STD 701-01006 |
| 13 | 735-04279 | 1 | CAOUTCHOUC DE PEDALE | 735-04279 |
| 14 | 736-0264 | 1 | RONDELLE: .330 x.630 x.0635 | FINISH:SPEC-100015 936-0264 |
| 16 | 738-04184A | 1 | VIS A EPAULE:.368x.113:TT:1/4- | TT:FINISH MTD SPEC-100016 |
| 17 | 741-0356A | 1 | BAGUE DE VOLANT | FINISH:KUNSTSTOFF SCHWARZ |
| 18 | 747-05506 | 1 | TRINGLE | 747-05506 |
| 19 | 747-06015 | 1 | TRINGLE SELECTION DE VITESSE | 747-06015 |
| 20 | 747-06033A | 1 | TRINGLE DE FREIN | 747-06033A |
| 21 | 748-0234 | 1 | RONDELLE EPAULEE | FINISH:ROSTPREVENTION |
| 22 | 783-05940 | 2 | SUPPORT | FINISH:MTD SPEC-100015 |
| 23 | 783-08116A | 1 | | |

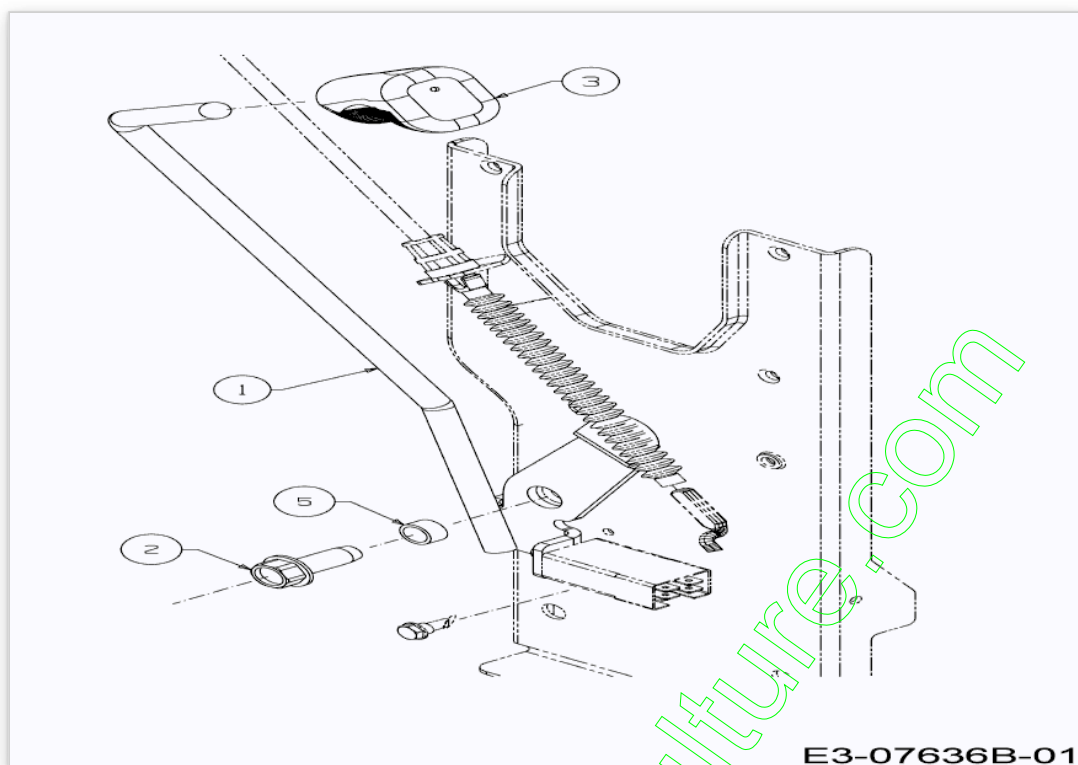

| Position | Numéro de lapièce | # | Appellation I | Appellation II |
|----------|----------------------|---|----------------------------------|---------------------------|
| 1 | 683-04754637 | 1 | LEVIER D EMBRAYAGE | 683-04754637 |
| 2 | 710-04683 | 1 | VIS HEX.:3/8-16:1.000 | FINISH:MTD SPEC-701-01002 |
| 3 | 720-04049A | 1 | POIGNEE PLASTIQUE | FINISH:SCHWARZ |
| 5 | 750-0526 | 1 | ENTRETOISE 380 IDX 50 ODX 265 | FINISH: MTD SPEC-100015 |

www.emc-motoculture.com

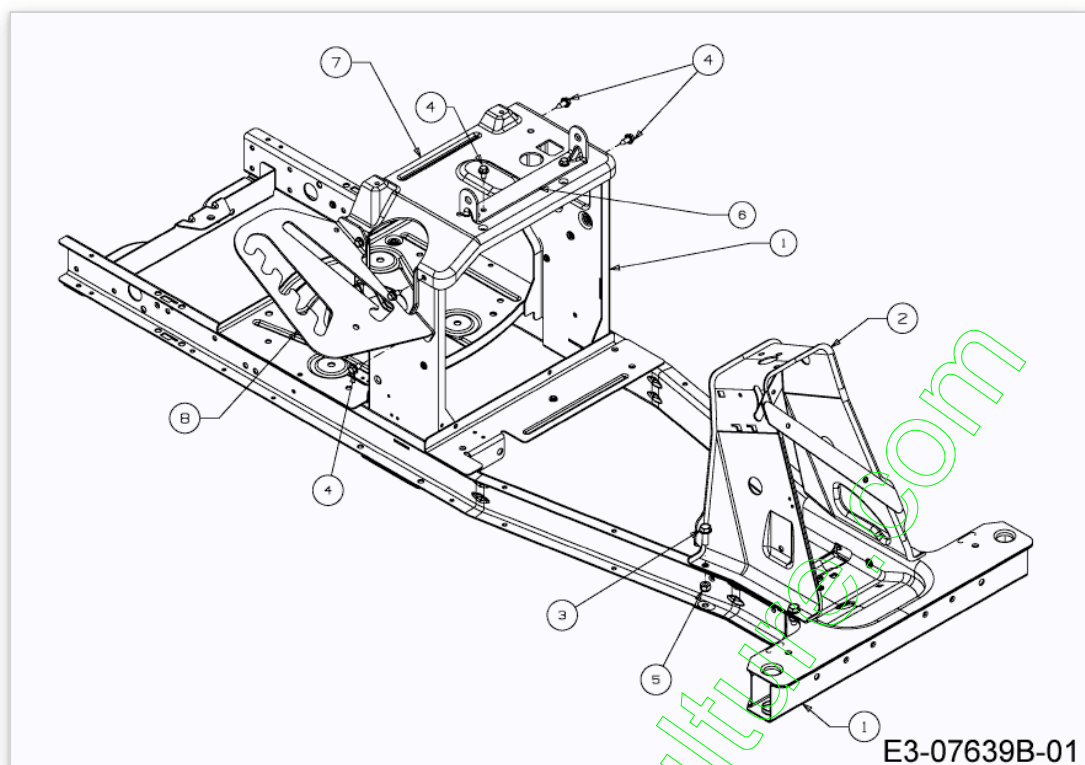

| Position | Numéro de lapièce | # | Appellation I | Appellation II |
|----------|----------------------|---|------------------------------------|-------------------------------|
| 1 | 683-05015637 | 1 | CHASSIS | 683-05015637 |
| 2 | 683-05019637 | 1 | LENKSTÜTZE | 683-05019637 |
| 3 | 710-1238 | 4 | VIS HHWSH:5/16- 18:.875:GR5:STD | FINISH:MTD SPEC-100015 |
| 4 | 710-1652 | 9 | VIS HEX. TT:1/4- 20:.625:HXINDW | FINISH:MTD-SPEC-100016 TYPE 1 |
| 5 | 712-0429 | 4 | ECROU | FINISH:SPEC-100015 |
| 6 | 783-07168637 | 1 | SUPPORT | 783-07168637* |
| 7 | 783-08197 | 1 | SUPPORT SIEGE | 783-08197 |
| 8 | 783-08260637 | 1 | PLAQUE SELECTEUR HAUTEUR DE | 783-08260637 |
| 9 | 710-1652 | 2 | VIS HEX. TT:1/4- 20:.625:HXINDW | FINISH:MTD-SPEC-100016 TYPE 1 |

www.emc-motoculture.com

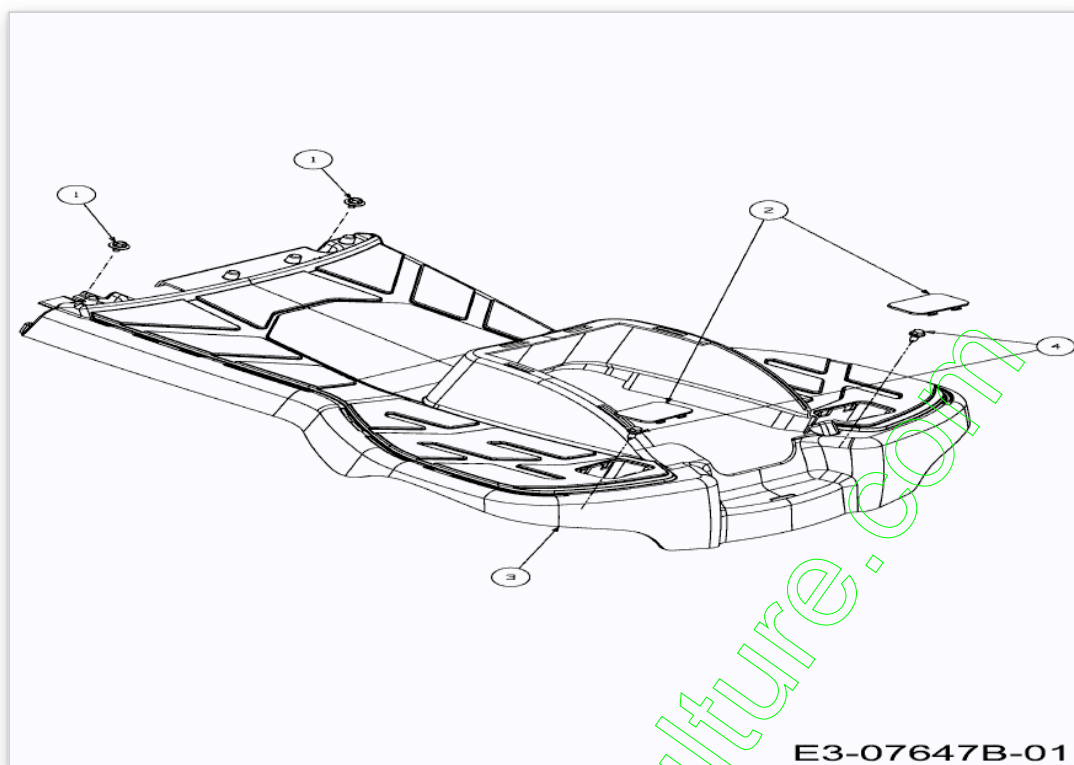

| Position | Numéro de lapièce | # | Appellation I | Appellation II |
|----------|----------------------|---|-----------------------------------|---------------------------|
| 1 | 710-05073 | 2 | VIS 1/4-20X.50 | 710-05073 |
| 2 | 731-08753A | 2 | BOUCHON A CLIPS | 731-08753A |
| 3 | 731-08910A | 1 | PLATE FORME | 731-08910A |
| 4 | 738-04184A | 2 | VIS A EPAULE:.368x.113:TT:1/4- | TT:FINISH MTD SPEC-100016 |

www.emc-motoculture.com

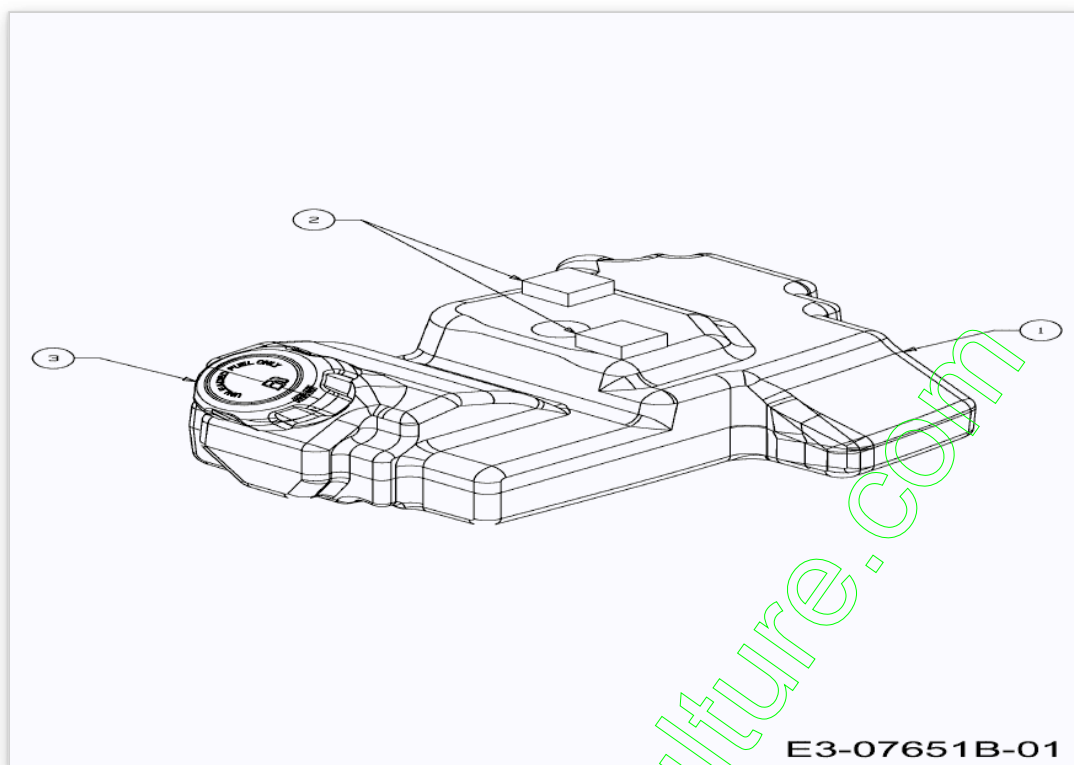

| Position | Numéro de lapièce | # | Appellation I | Appellation II |
|----------|-------------------|---|--------------------------------|------------------|
| 1 | 651-04385B | 1 | RESERVOIR | FINISH:N/A |
| 2 | 722-3020 | 2 | KANTENSCHUTZ:1.25 SQ x .62 THK | FINISH:SIEHE ZG. |
| 3 | 751-12179B | 1 | BOUCHON DE RESERVOIR ESSENCE | FINISH:SIEHE ZG. |

www.emc-motoculture.com

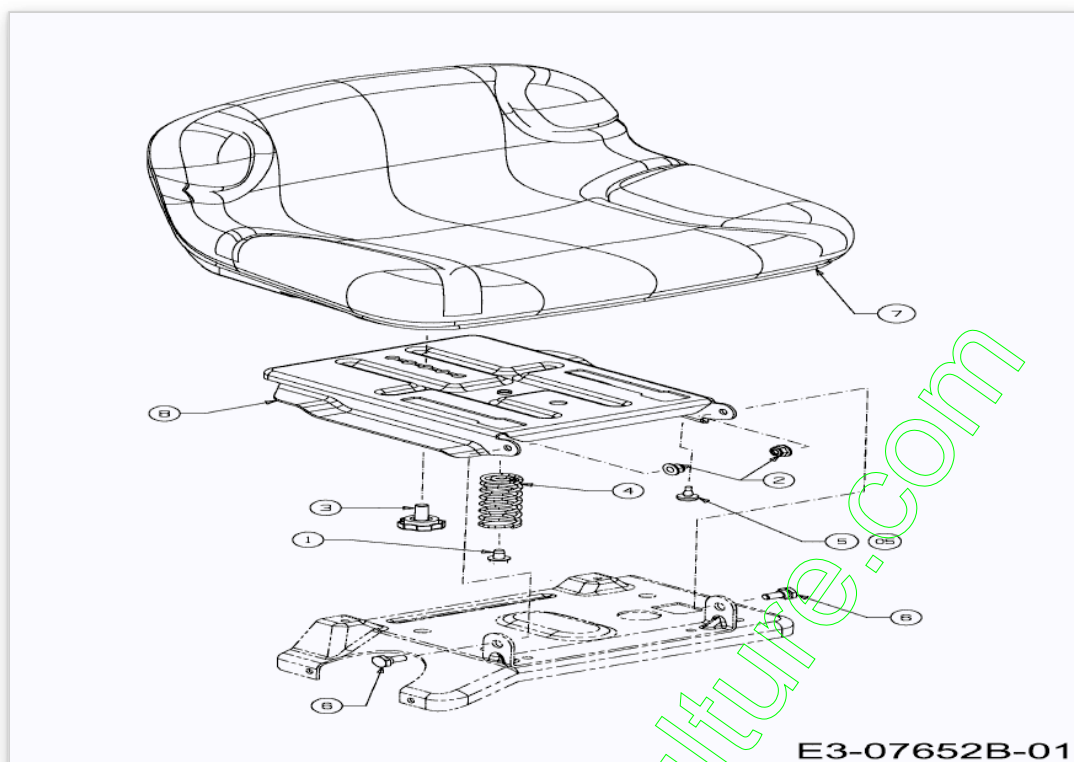

| Position | Numéro de lapièce | # | Appellation I | Appellation II |
|----------|----------------------|---|------------------------------------|-------------------------------|
| 1 | 710-0607 | 1 | VIS HEX.TT5/16- 18:.500HXINDWSh | FINISH:MTD SPEC-100016 TYPE 1 |
| 2 | 712-04063 | 2 | ECROU HEX. AVEC FLANC | FINISH:MTD SPEC-100015 |
| 3 | 720-04009A | 1 | MOLETTE DE SIEGE | FINISH:SCHWARZ * |
| 4 | 732-04905 | 1 | RESSORT DE SIEGE | FINISH:SPEC-100015 |
| 5 | 735-0199A | 1 | BOUCHON EN CAOUTCH.:.62ODx.22 | FINISH:SCHWARZ 935-0199A |
| 6 | 738-0140 | 2 | VIS A EP.:.435 x.178-5/16 x.56 | FINISH:MTD SPEC-100015 |
| 7 | 757-04099 | 1 | SIEGE | LT-5 |
| 8 | 783-07213A | 1 | | |

www.emc-motoculture.com

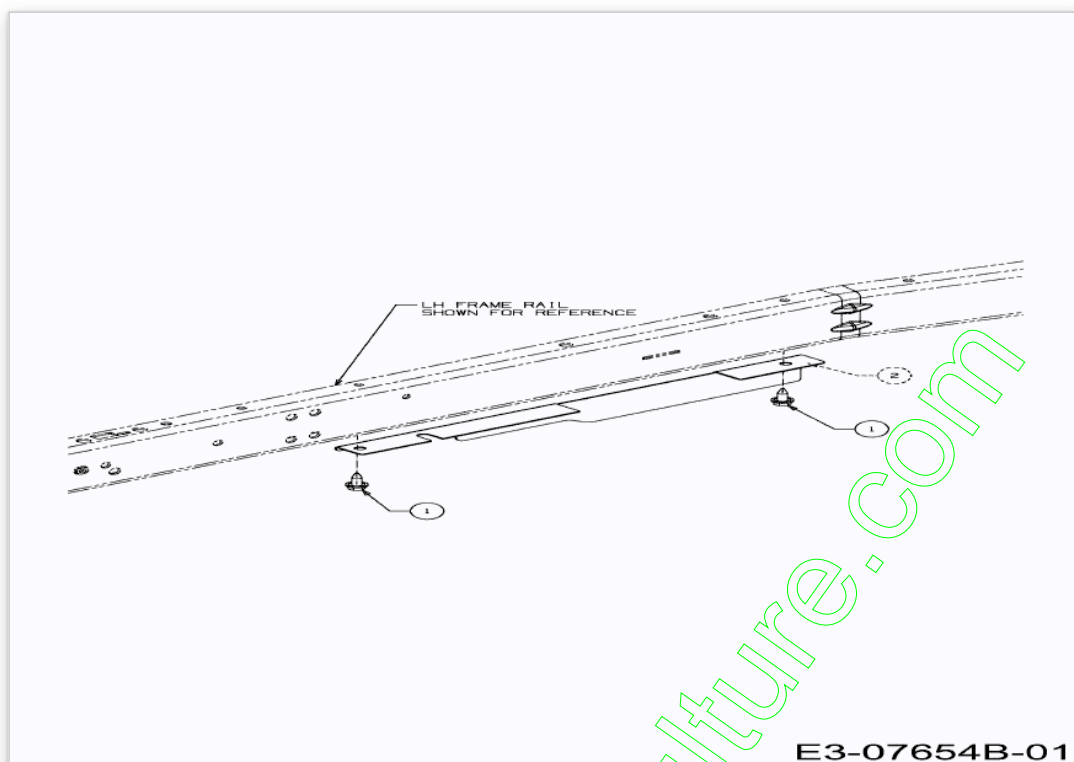

| Position | Numéro de lapièce | # | Appellation I | Appellation II |
|----------|----------------------|---|------------------------------------|-------------------------------|
| 1 | 710-1652 | 2 | VIS HEX. TT:1/4- 20:.625:HXINDW | FINISH:MTD-SPEC-100016 TYPE 1 |
| 2 | 783-08208 | 1 | | |

www.emc-motoculture.com

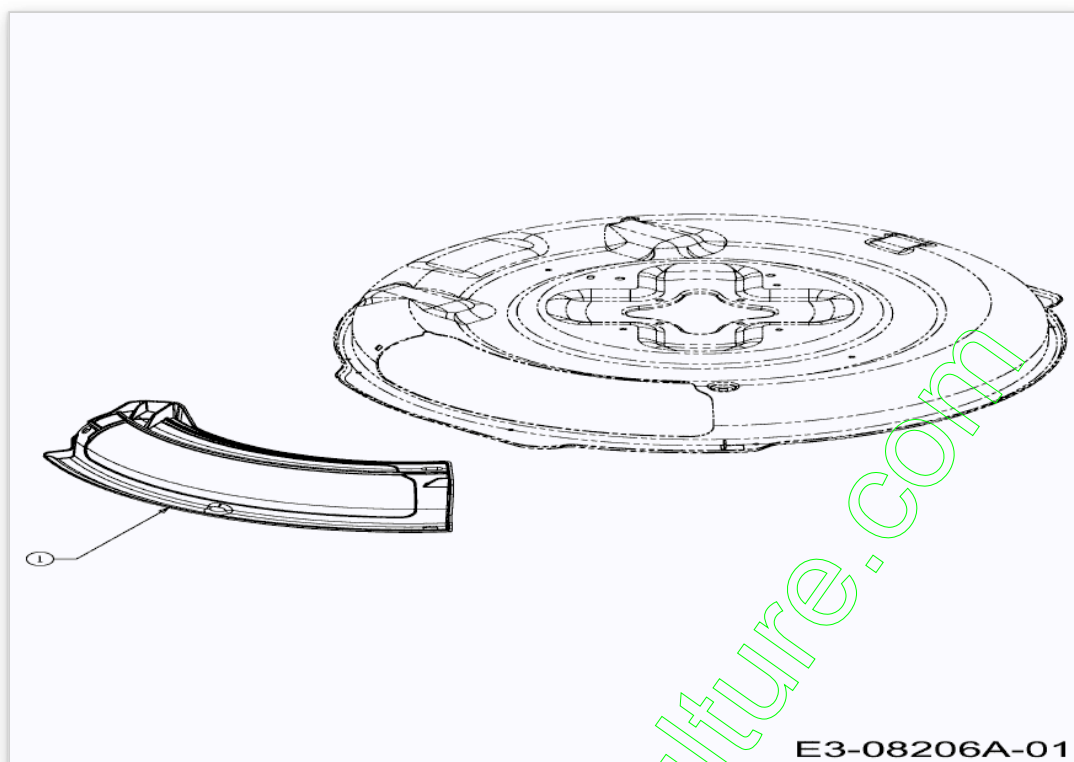

| Position | Numéro de pièce | # | Appellation I | Appellation II |
|----------|-----------------|---|------------------|----------------|
| 1 | 731-09312 | 1 | BOUCHON MULCHING | 731-09312 |

www.emc-motoculture.com

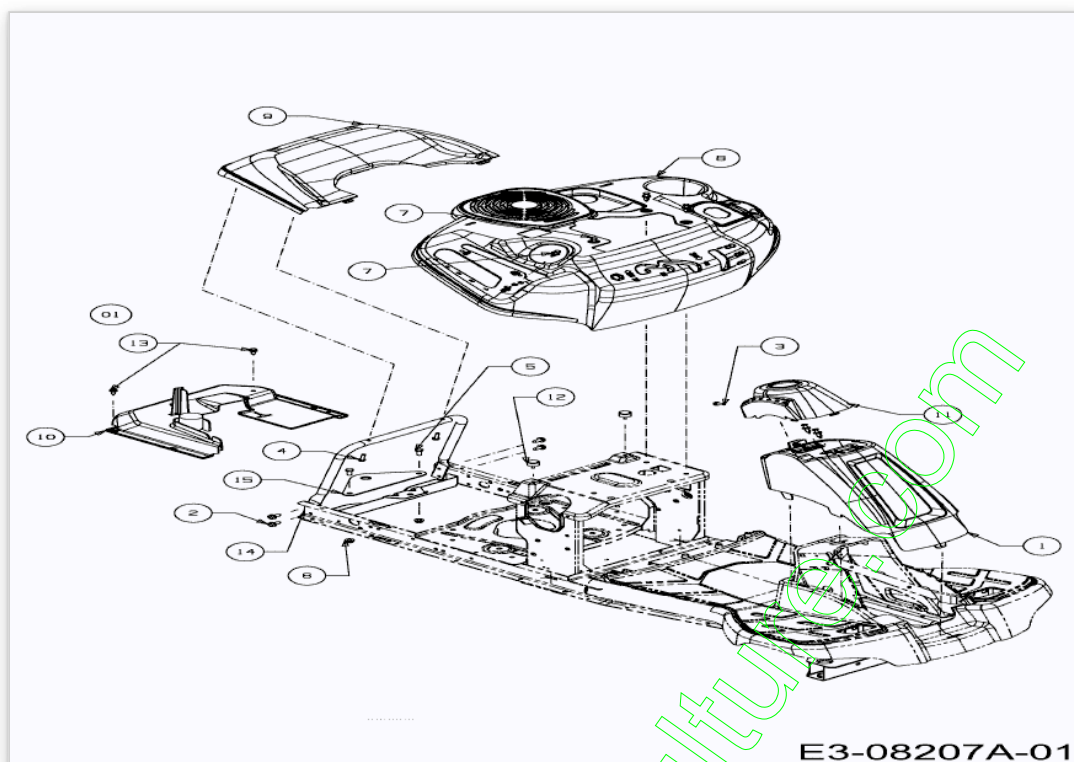

| Position | Numéro de lapièce | # | Appellation I | Appellation II |
|----------|----------------------|---|---|-------------------------------|
| 1 | 631-05038 | 1 | CACHE DE COLONNE INFERIEUR | 631-05038 |
| 2 | 710-04484 | 4 | VIS HEX. TT:5/16- 18:.750:HXIND | FINISH:MTD SPEC-100016 TYPE 1 |
| 3 | 710-0924 | 1 | VIS EN T ^{te} TE PLATE 1/4- 20X;75" | FINISH:MTD STD 701-01000 |
| 4 | 710-1241 | 2 | VIS | FINISH:SPEC-100016 TYPE 1 |
| 5 | 710-3008 | 2 | VIS 5/16-18:.75:GR5:STD | SPEC-701-01006 or SPEC-100015 |
| 6 | 712-04063 | 2 | ECROU HEX. AVEC FLANC | FINISH:MTD SPEC-100015 |
| 7 | 728-0199 | 6 | RIVET PLASTIQUE | KUNSTSTOFF FINISH:SCHWARZ |
| 8 | 731-08529A | 1 | CARTER DE COMMANDE | 731-08529A |
| 9 | 731-08620A | 1 | COUVERCLE ARRIERE | 731-08620A |
| 10 | 731-09185 | 1 | TOLE DE PROTECTION | 731-09185 |
| 11 | 731-09382 | 1 | CACHE DE COLONNE SUPERIEUR | 731-09382 |
| 12 | 735-05006 | 2 | TAMPON DE SIEGE | FINISH:BLACK |
| 13 | 738-04184A | 2 | VIS A EPAULE:.368x.113:TT:1/4- | TT:FINISH MTD SPEC-100016 |
| 14 | 749-04932 | 1 | | |
| 15 | 783-07208 | 1 | | |

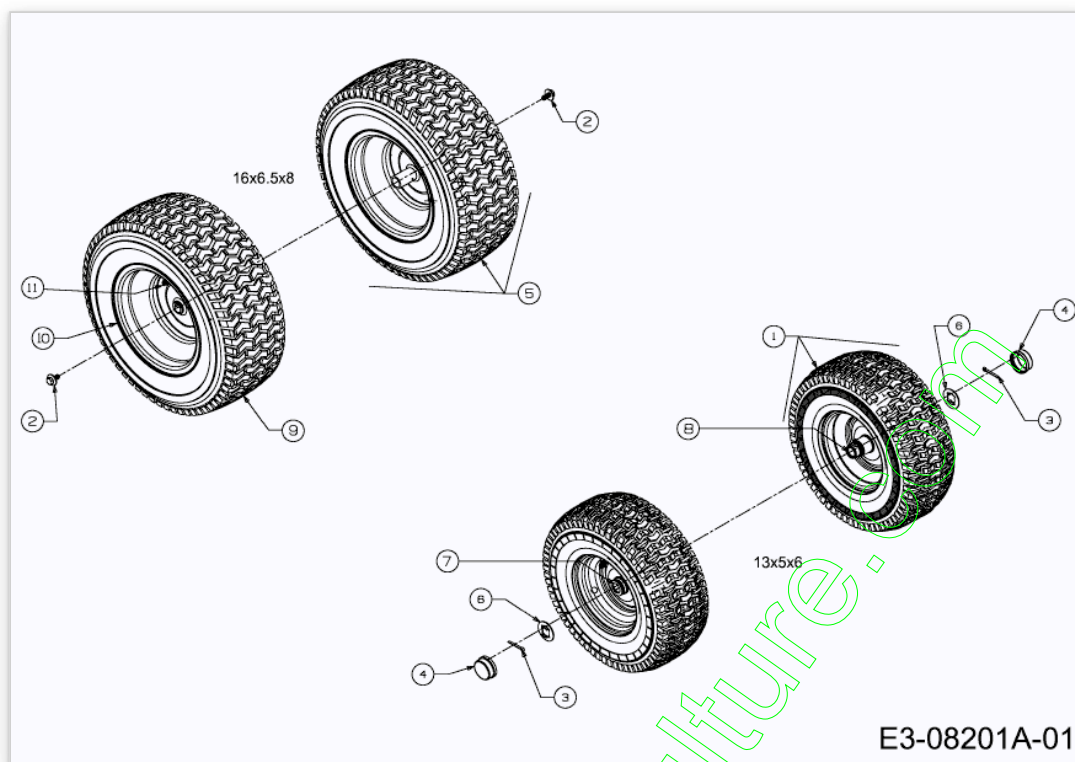

| Position | Numéro de lapièce | # | Appellation I | Appellation II |
|----------|----------------------|---|---------------------------------|--------------------------------|
| 1 | 634-04732 | 2 | ROUE COMPLETE GRISE 13X5X6 | 634-04732 |
| 2 | 710-05339A | 2 | VIS | FINISH:MTD STD SPEC-101617 |
| 3 | 714-0162 | 2 | GOUPILLE FENDUE 5/32:1.25 | FINISH:MTD SPEC-100015 |
| 4 | 731-0484A | 2 | ENJOLIVEUR DEVANT | KUNSTSTOFF SCHWARZ 931-0484A |
| 5 | 734-0591662 | 2 | ROUE CPL 16X6.5-8 GRISE | 734-0591662 |
| 6 | 736-04228A | 2 | RONDELLE | FINISH:MTD SPEC-100015 |
| 7 | 741-0516B | 2 | BAGUE DE ROUE .760x1.00x1.20 | FINISH:SCHWARZ |
| 8 | 741-0990B | 2 | BAGUE DE ROUE AVEC GRAISSEUR | m.SCHMIERNIPPEL:FINISH SCHWARZ |
| 9 | 734-04641 | 2 | PNEU 16.00X6.50X8.00 | SQ:SH:TURF SAVER |
| 10 | 634-04174662 | 2 | JANTE ARRIERE GRISE | OYSTER GRAU 788-0662 |
| 11 | 734-0255 | 2 | VALVE:PNEU | TR 412-P / 32.6mm / 934-0255 |

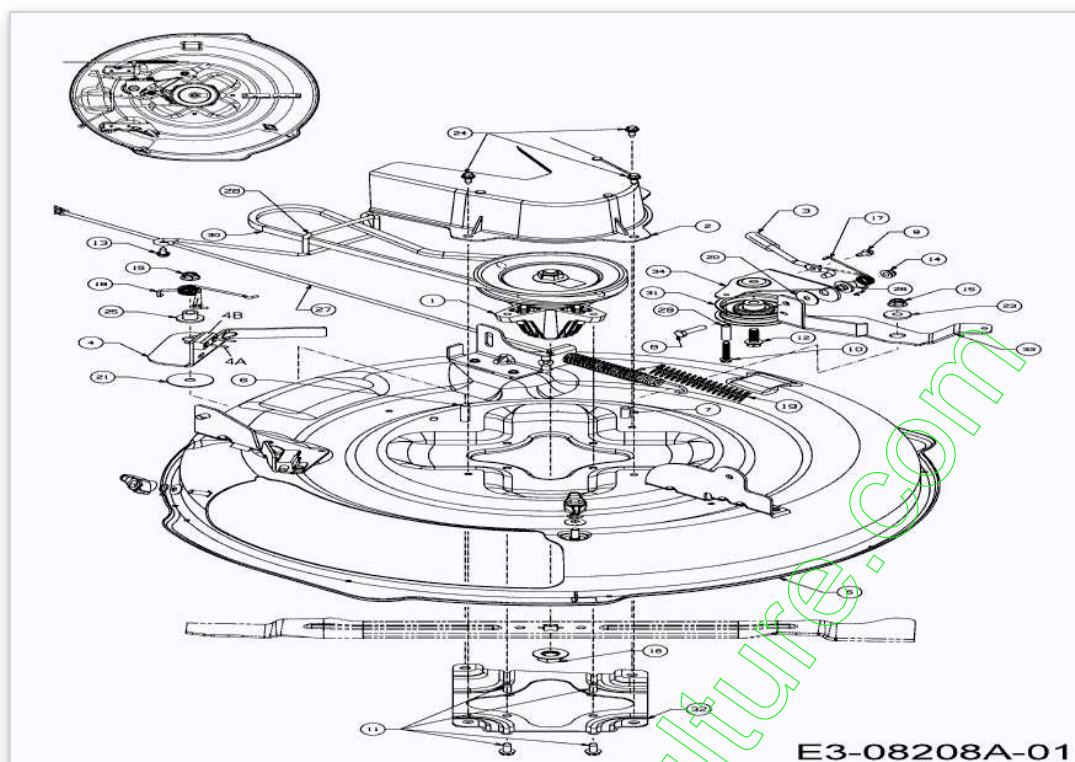

| Position | Numéro de lapièce | # | Appellation I | Appellation II |
|----------|----------------------|---|-------------------------------------|-------------------------------|
| 1 | 618-04822A | 1 | PALIER DE LAME COMPLET | FINISH: SIEHE BOM 918-04822A |
| 2 | 631-05024 | 1 | CARTER PROTECTION DE COURROIE | 631-05024 |
| 3 | 647-05028 | 1 | LEVIER | 647-05028 |
| 4 | 683-05034 | 1 | FREIN DE LAME | UND NIETEN |
| 4A | 728-0173 | 2 | RIVET 1880 X 6520 LG | FINISH:ASTM F1941 FE/ZN 3AN |
| 4B | 761-04017 | 1 | GARNITURE FREIN DE LAME | FINISH: |
| 5 | 683-05040637 | 1 | CARTER DE COUPE 76 CM | 683-05040637 |
| 6 | 710-0347 | 1 | VIS HEX. 3/8- 16:1.75:GR5:STD | FINISH:MTD SPEC-100015 |
| 7 | 710-0514 | 1 | VIS HEX.:3/8- 16:1.00:GR5:STD | FINISH:MTD SPEC-100015 |
| 8 | 710-0528 | 1 | VIS HEX. 5/16- 18:1.25:GR5:STD | FINISH:SPEC-100015 910-0528 |
| 9 | 710-0599 | 1 | VIS A SIX PANS CREUX | FINISH:MTD SPEC-101617 |
| 10 | 710-1026 | 1 | VIS HEX:TT:1/4-20:1.750 | FINISH:MTD-SPEC-100016 |
| 11 | 710-1260A | 4 | VIS TT:5/16-18:1.750 | FINISH:SPEC-100016 TYPE 1 |
| 12 | 710-1315 | 1 | VIS HEX.TT:3/8- 16:1.25:HXIN:S | FINISH:SPEC-100016 TYPE 1 |
| 13 | 710-1652 | 1 | VIS HEX. TT:1/4- 20:1.625:HXINDW | FINISH:MTD-SPEC-100016 TYPE 1 |
| 14 | 712-04063 | 1 | ECROU HEX. AVEC FLANC | FINISH:MTD SPEC-100015 |
| 15 | 712-04065 | 2 | ECROU HEXAGONAL | FINISH:SPEC-100015 912-04065 |
| 16 | 712-0417A | 1 | ECROU HEX. AV. FLANC: 5/8-18 | FINISH:MTD STD 701-01000 |
| 17 | 732-05045 | 1 | RESSORT | FINISH:SPEC-100015 |
| 18 | 732-05046 | 1 | RESSORT | FINISH:SPEC-701-01006 |
| 19 | 732-0583 | 1 | RESSORT | FINISH:PHOS & OILx |
| 20 | 736-0362 | 1 | RONDELLE .320ID X 1.25 ODX .0 | FINISH:SPEC-100016 |
| 21 | 736-3040 | 1 | RONDELLE | FINISH:MTD STD 701-01000 |
| 23 | 738-0347 | 1 | RONDELLE i EMB. .625IDx.169 | FINISH: |
| 24 | 738-04184A | 3 | VIS A EPAULE:.368x.113:TT:1/4- | TT:FINISH MTD SPEC-100016 |
| 25 | 738-05021 | 1 | ENTRETOISE | FINISH:DAMPF BEHANDELT |
| 26 | 738-05022 | 1 | ENTRETOISE | FINISH:DAMPF BEHANDELT |

| Position | Numéro de lapièce | # | Appellation I | Appellation II |
|----------|----------------------|---|-------------------------------|--------------------------------|
| 27 | 746-04802A | 1 | CABLE PTO | FINISH: SIEHE ZG. |
| 28 | 747-06126A | 1 | GUIDE COURROIE | 747-06126A |
| 29 | 750-04456 | 1 | ENTRETOISE | FINISH:MTD SPEC-100015 |
| 30 | 754-05001 | 1 | COURROIE DE LAME MINIRIDER | FINISH: N/A |
| 31 | 756-04224 | 1 | POULIE TENDEUR | BLK ECOAT,PAINT OR SPEC-100015 |
| 32 | 783-08047A | 1 | RENFORT CARTER DE COUPE | 783-08047A |
| 33 | 783-08128 | 1 | SUPPORT | FINISH:SPEC-100015 CR-12 |
| 34 | 783-08226637 | 1 | SUPPORT POULIE TENDEUR | 783-08226637 |

www.emc-motoculture.com

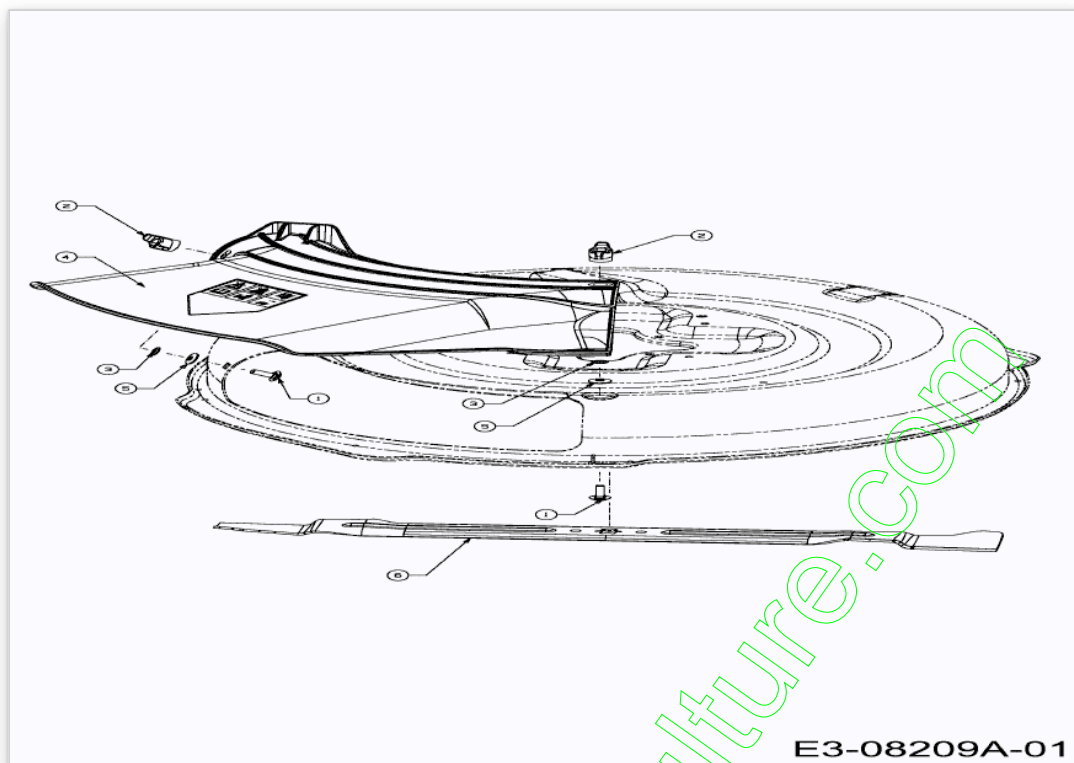

| Position | Numéro de lapièce | # | Appellation I | Appellation II |
|----------|----------------------|---|-----------------------------------|-------------------------------|
| 1 | 710-04998 | 2 | VIS A TETE PLATE | FINISH:MTD SPEC-100015 |
| 2 | 720-04122 | 2 | ECROU PAPILLON | FINISH: SIEHE ZG. |
| 3 | 726-0201 | 2 | RONDELLE .3125 ID | MECHANISCH VERZINKT:SIEHE ZG. |
| 4 | 731-09357 | 1 | DEFLECTEUR | 731-09357 |
| 5 | 736-0242 | 2 | RONDELLE CONIQUE.340X.872X.060 | FINISH:MTD SPEC-100016 |
| 6 | 742-04385 | 1 | LAME 76CM 3 EN 1 | FINISH:ROSTVORSORGE EINGEÖLT |

www.emc-motoculture.com

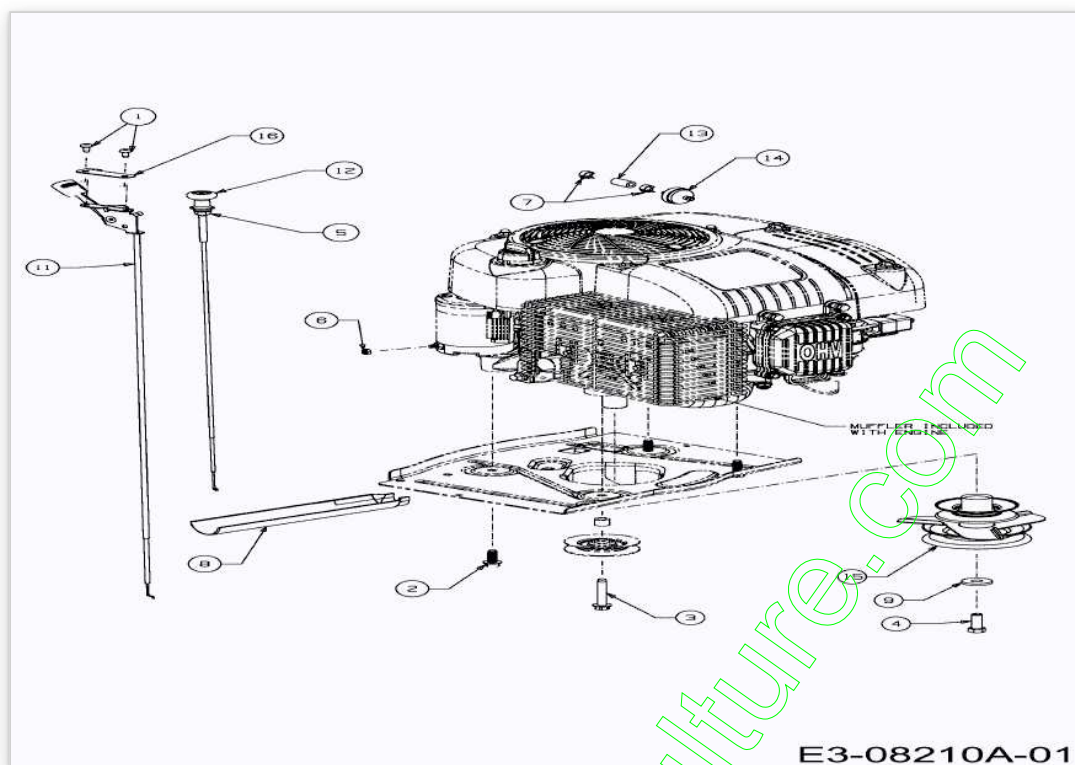

| Position | Numéro de lapièce | # | Appellation I | Appellation II |
|----------|----------------------|---|---------------------------------|-------------------------------|
| 1 | 710-0483 | 2 | VIS | 710-0483 |
| 2 | 710-04683A | 3 | VIS | FINISH:MTD SPEC-701-01002 |
| 3 | 710-05446 | 1 | VIS | FINISH:MTD SPEC-100016 TYPE 1 |
| 4 | 710-06067 | 1 | VIS | FINISH:MTD SPEC-100015 |
| 5 | 712-04242 | 1 | ECROU | FINISH:MTD SPEC-100015 |
| 6 | 712-0691 | 1 | ECROU HEXAGONAL | MTD SPEC-100015 24.1426.14 |
| 7 | 726-0205 | 2 | COLLIER DE SERRAGE DE BOYAU | FINISH:PHOS UND GELB LACKIERT |
| 8 | 731-1682A | 1 | DRAINAGE HUILE | FINISH:KUNSTSTOFF SCHWARZ |
| 9 | 736-0322 | 1 | RONDELLE .450 X 1.250 X .164 | FINISH:SPEC-100016 936-0322 |
| 11 | 746-05049 | 1 | CABLE GAZ | MIT BEDIENUNGSHEBEL |
| 12 | 746-1088 | 1 | CABLE STARTER 23.0"LGX1.50E | EXT:MIT ZUGKNOPF |
| 13 | 751-10349-22 | 1 | TUYAU ESSENCE | 751-10349-22 |
| 14 | BS-298090S | 1 | FILTRE A ESSENCE | BS-298090S |
| 15 | 756-04479A | 1 | POULIE MOTEUR | Ø4.46"/Ø3.39":SPEC-701-01000 |
| 16 | 783-08221A | 1 | SUPPORT CABLE GAZ | 746-08221A |

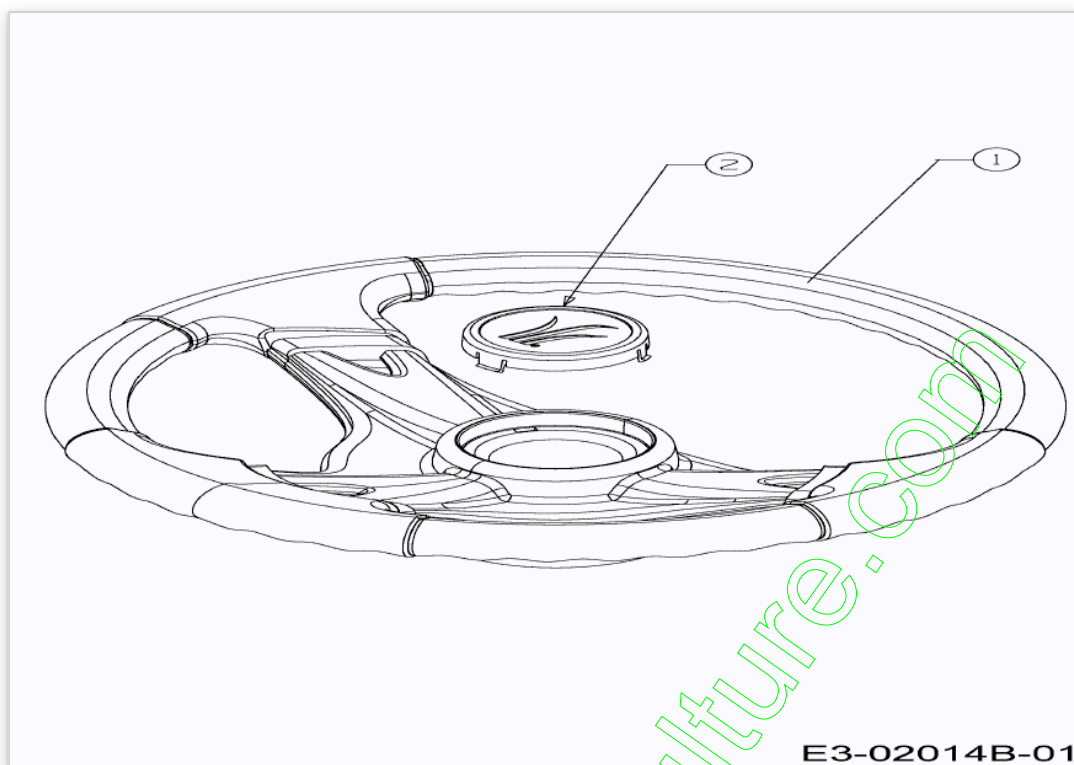

| Position | Numéro de lapièce | # | Appellation I | Appellation II |
|----------|----------------------|---|------------------------|---------------------------|
| 1 | 631-04028 | 1 | VOLANT | FINISH SCHWARZ |
| 2 | 731-04040 | 1 | COUVERCLE DE VOLANT | Ø 60mm:KUNSTSTOFF SCHWARZ |

www.emc-motoculture.com

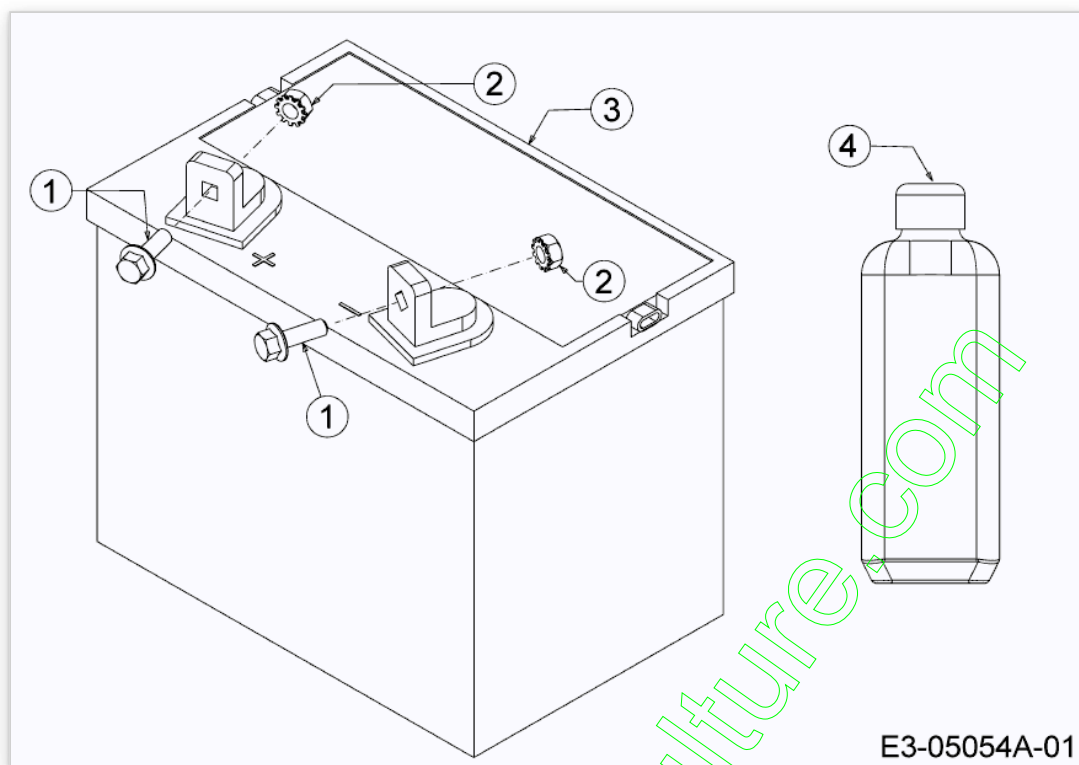

| Position | Numéro de lapièce | # | Appellation I | Appellation II |
|----------|----------------------|---|--------------------------------|----------------------------|
| 1 | 710-04666 | 2 | VIS HEXAGONALE | FINISH:MTD SPEC-100015 |
| 2 | 712-0271 | 2 | ECROU 1/4-20"+ DISQUE DENTE | FINISH:MTD SPEC-100016 GR5 |
| 3 | 725-1704A | 1 | BATTERIE:U1: 150 CCA WET | FINISH: |
| 4 | 725-2064 | 2 | BIDON ACIDE 1 LITRE | 725-2064 |

www.emc-motoculture.com

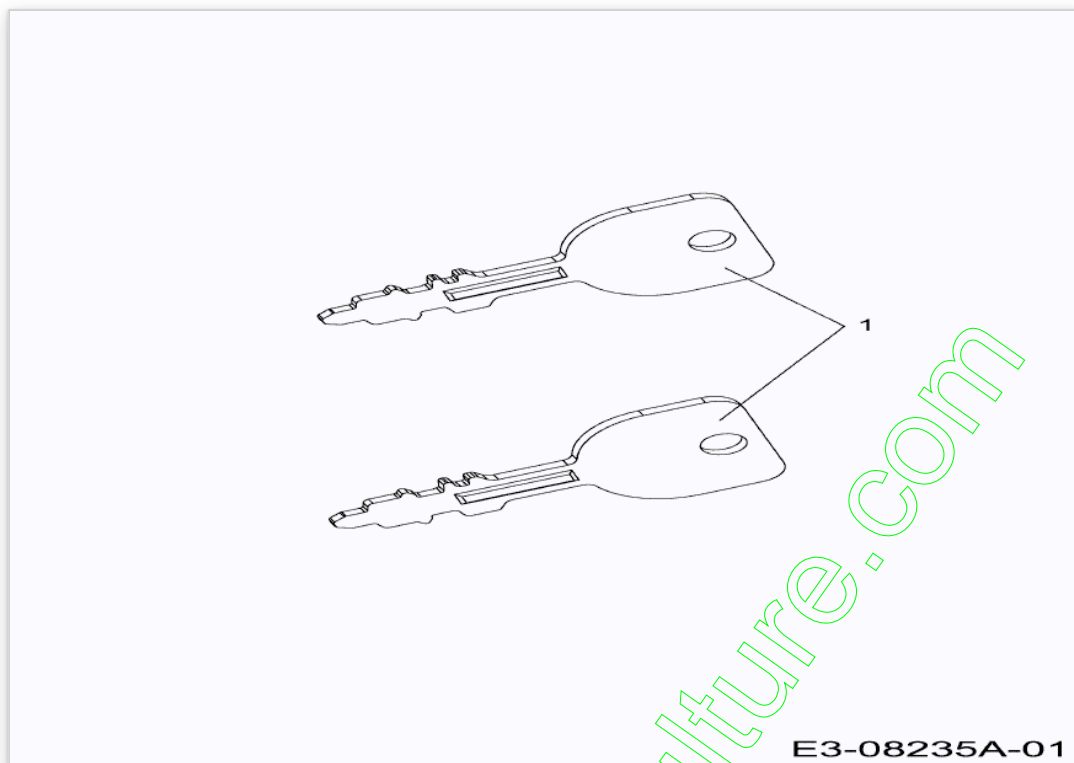

| Position | Numéro de pièce | # | Appellation I | Appellation II |
|----------|-----------------|---|----------------|----------------|
| 1 | 725-1744A | 2 | CLE DE CONTACT | FINISH: |

www.emc-motoculture.com

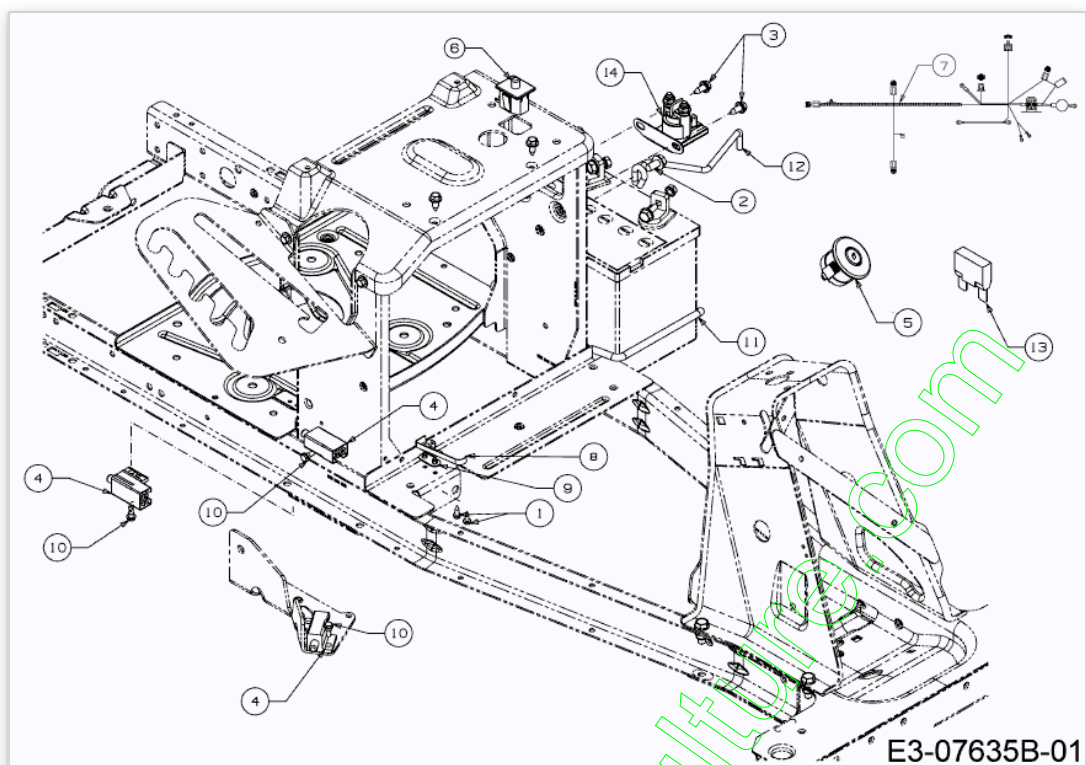

| Position | Numéro de lapièce | # | Appellation I | Appellation II |
|----------|----------------------|---|------------------------------------|-------------------------------|
| 1 | 710-0227 | 2 | VIS | FINISH:MTD SPEC-100016 TYPE 1 |
| 2 | 710-04484 | 1 | VIS HEX. TT:5/16- 18:.750:HXIND | FINISH:MTD SPEC-100016 TYPE 1 |
| 3 | 710-1652 | 2 | VIS HEX. TT:1/4- 20:.625:HXINDW | FINISH:MTD-SPEC-100016 TYPE 1 |
| 4 | 725-04363 | 3 | SECURITE EMBRAYAGE | FINISH:SIEHE ZG. |
| 5 | 725-04659 | 1 | CONTACTEUR A CLEF | FINISH: |
| 6 | 725-05013 | 1 | SECURITE DE SIEGE | FINISH:GRAU |
| 7 | 725-06041 | 1 | FAISCEAU COMPLET | 725-06041 |
| 8 | 725-1643 | 1 | CONTACTEUR SECURITE | LANG:FINISH:SPEC-100016 |
| 9 | 726-0320 | 1 | PLAQUE D'ISOLATION | FINISH:NATUR ODER SCHWARZ |
| 10 | 738-04237A | 3 | AXE EPAULE | FINISH:MTD SPEC-100016 |
| 11 | 747-06131A | 1 | TRINGLE SUPPORT BATTERIE | 747-06131A |
| 12 | 747-06148 | 1 | TRINGLE SUPPORT BATTERIE SUP | 747-06148 |
| 13 | 725-04009 | 1 | FUSIBLE 15A | 725-04009 |
| 14 | 725-06153 | 1 | SOLENOIDE | FINISH: |

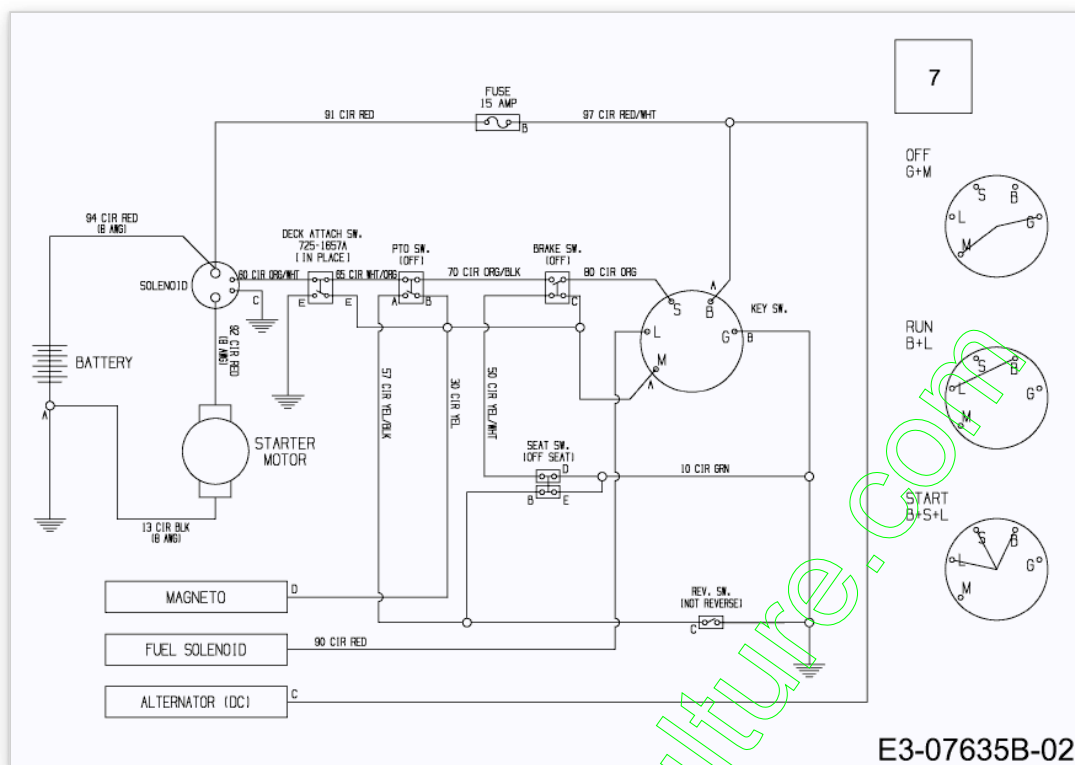

| Position | Numéro de pièce | # | Appellation I | Appellation II |
|----------|-----------------|---|------------------|----------------|
| 7 | 725-06041 | 1 | FAISCEAU COMPLET | 725-06041 |

www.emc-motoculture.com

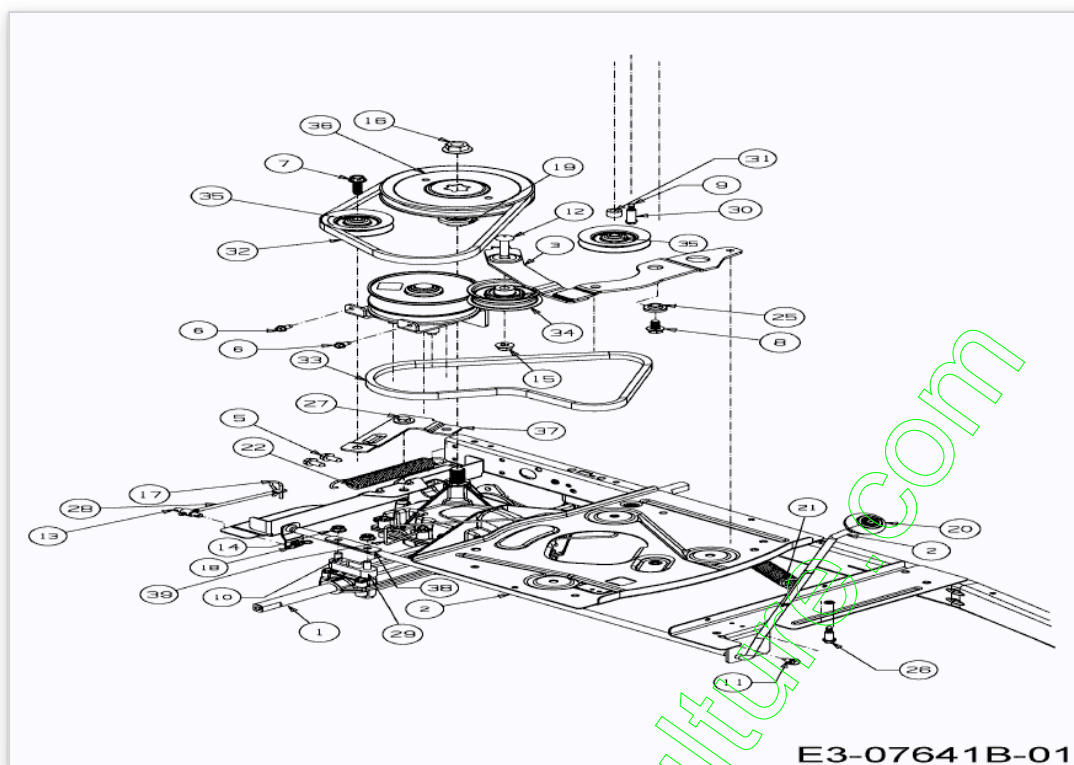

| Position | Numéro de lapièce | # | Appellation I | Appellation II |
|----------|----------------------|---|------------------------------------|--------------------------------|
| 1 | 618-05056A | 1 | PONT COMPLET | 618-05056A |
| 2 | 647-04262C | 1 | LEVIER INVERSEUR | 647-04262C |
| 3 | 683-04768A-S | 1 | SUPPORT POULIES | 683-04768A-S |
| 5 | 710-04484 | 2 | VIS HEX. TT:5/16- 18:.750:HXIND | FINISH:MTD SPEC-100016 TYPE 1 |
| 6 | 710-0599 | 2 | VIS A SIX PANS CREUX | FINISH:MTD SPEC-101617 |
| 7 | 710-06016 | 1 | VIS | FINISH:SPEC-100016 TYPE 1 |
| 8 | 710-0623 | 1 | VIS PARK. HEX.:TT:3/8- 16:0.750 | FINISH:MTD SPEC-100016 TYPE 1 |
| 9 | 710-1026 | 1 | VIS HEX:TT:1/4-20:1.750 | FINISH:MTD-SPEC-100016 |
| 10 | 710-1266 | 4 | VIS HHCS:5/16- 18:3.5:GR5:STD | FINISH:MTD SPEC-100015 |
| 11 | 710-1652 | 1 | VIS HEX. TT:1/4- 20:.625:HXINDW | FINISH:MTD-SPEC-100016 TYPE 1 |
| 12 | 710-0560 | 1 | VIS | FINISH:701-01000 |
| 13 | 711-06141 | 1 | FERRURE | FINISH:MTD SPEC-100015 |
| 14 | 712-04063 | 4 | ECROU HEX. AVEC FLANC | FINISH:MTD SPEC-100015 |
| 15 | 712-04065 | 1 | ECROU HEXAGONAL | FINISH:SPEC-100015 912-04065 |
| 16 | 712-0700 | 1 | ECROU HEXAGONAL | SPEC-100015+WAX 912-0700 |
| 17 | 714-0209 | 1 | GOUPILLE FENDUE | FINISH:SPEC 701-01006 914-0209 |
| 18 | 714-04040 | 1 | GOUPILLE | FINISH:ASTM F1941 FE/ZN 3AN |
| 19 | 718-04407 | 1 | MOYEU: POULIE:5/8 DENTELURE | VERZAHNUNG |
| 20 | 720-04028 | 1 | POIGNEE INVERSEUR | FINISH:SCHWARZ |
| 21 | 732-0459C | 1 | RESSORT | FINISH:MTD SPEC-100015 |
| 22 | 732-04934 | 1 | RESSORT | 732-04934 |
| 25 | 738-0372B | 1 | RONDELLE EPAULEE | FINISH:GEÖLT |
| 26 | 738-05016 | 1 | VIS EPAULEE | 738-05016 |
| 27 | 738-05019 | 1 | VIS EPAULEE | FINISH MTD SPEC-100016 |
| 28 | 747-05593 | 1 | TRINGLE | 747-05593 |
| 29 | 748-0334 | 2 | ENTRETOISE | FINISH:GEÖLT |
| 30 | 750-04456 | 1 | ENTRETOISE | FINISH:MTD SPEC-100015 |
| 31 | 750-05563 | 1 | ENTRETOISE | FINISH:MTD SPEC-100015 |
| 32 | 754-0241A | 1 | COURROIE VARIATEUR/BOITE | FINISH:SIEHE ZG. 954-0241A |
| 33 | 754-04331 | 1 | COURROIE | FINISH: SIEHE CHART |
| 34 | 756-04224 | 1 | POULIE TENDEUR | BLK ECOAT,PAINT OR SPEC-100015 |

| Position | Numéro de lapièce | # | Appellation I | Appellation II |
|----------|----------------------|---|-----------------|--------------------------|
| 35 | 756-04325 | 2 | POULIE TENDEUR | FINISH: SCHWARZ LACKIERT |
| 36 | 756-04464 | 1 | POULIE DE PONT | FINISH: SIEHE ZG. |
| 37 | 783-07248A | 1 | SUPPORT | 783-07248A |
| 38 | 783-08131637 | 2 | SUPPORT DE PONT | 783-08131637 |
| 39 | 732-05060 | 1 | GUIDE COURROIE | 732-05060 |

www.emc-motoculture.com

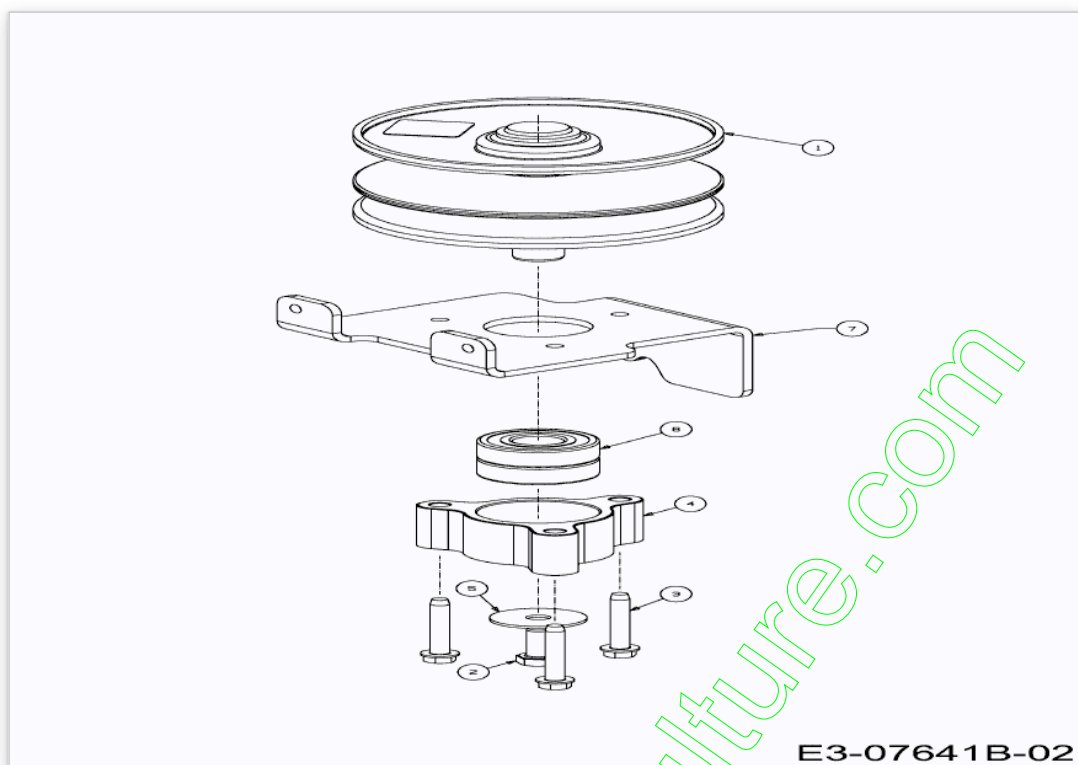

| Position | Numéro de lapièce | # | Appellation I | Appellation II |
|----------|----------------------|---|-----------------------------------|-------------------------------|
| 1 | 656-04015A | 1 | POULIE VARIATEUR | FINISH: |
| 2 | 710-0627 | 1 | VIS HEX. 5/16-24:.750 GR5:LOCK | FINISH:MTD SPEC-100015 |
| 3 | 710-0778 | 3 | VIS HEX. TT:1/4-20:1.500 | FINISH:MTD SPEC-100016 TYPE 1 |
| 4 | 718-04261 | 1 | CAGE DE ROULEMENT | FINISH:ROTSCHUTZ SIEHE ZG. |
| 5 | 736-0362 | 1 | RONDELLE .320ID X 1.25 ODX .0 | FINISH:SPEC-100016 |
| 6 | 741-0124A | 2 | ROULEMENT A BILLE | FINISH: |
| 7 | 783-08210 | 1 | | |

www.emc-motoculture.com

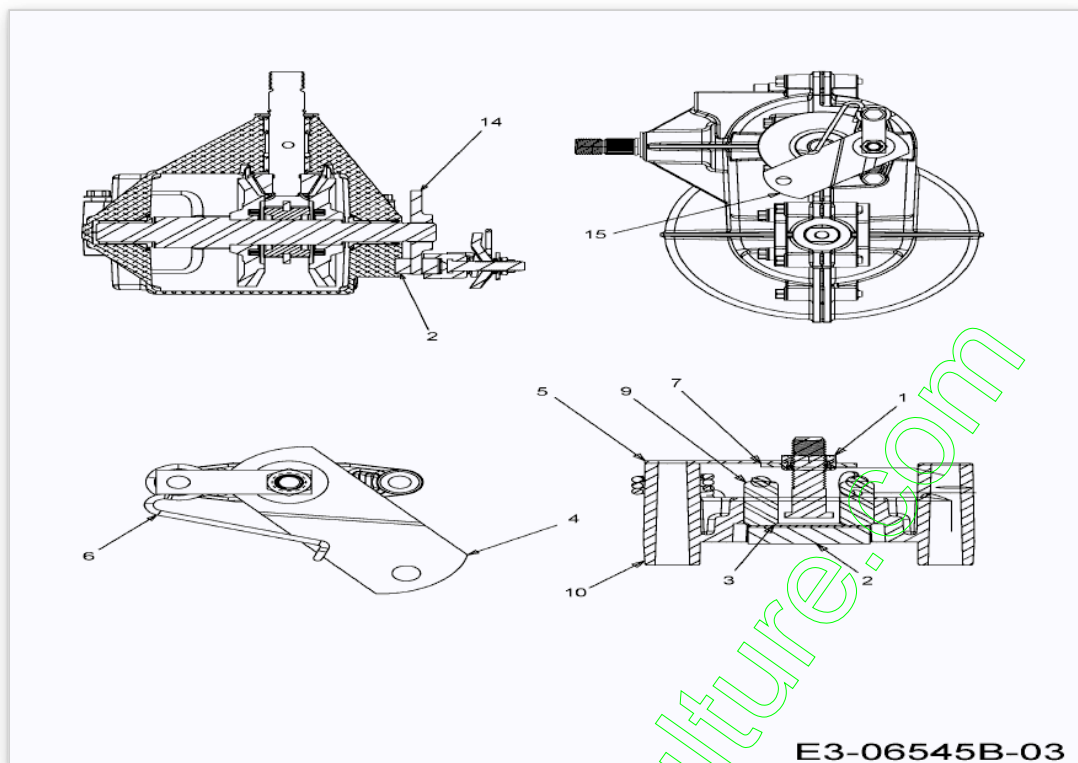

| Position | Numéro de lapièce | # | Appellation I | Appellation II |
|----------|----------------------|---|----------------------------------|--------------------------------|
| 1 | 712-0273 | 1 | ECROU HEXAGONAL 5/16- 24" | FINISH:MTD SPEC-100015 |
| 2 | 717-0678 | 2 | PLAQUETTE DE FREIN | FINISH: |
| 3 | 717-0682 | 1 | INSERT DE FREIN | FINISH:NONE 917-0682 |
| 4 | 717-0700 | 1 | LEVIER DE FREIN, i DROITE | FINISH:PHOSPHATE & OIL |
| 5 | 718-0150 | 1 | LANG. DE SUPP.: ANTI ROTATION | FINISH:SPEC-100015 |
| 6 | 732-0742 | 1 | RESSORT | FINISH:SPEC 701-01006 932-0742 |
| 7 | 736-0371 | 1 | RONDELLE 1.344XA .875" | FINISH:MTD SPEC-100016 |
| 9 | 741-0343 | 2 | GOUJON DE PRESSION 5/16" | FINISH:SIEHE ZG. 941-0343 |
| 10 | 761-0198A | 1 | APPUI DE FREIN | FINISH:NONE 961-0198A |
| 14 | 761-0202 | 1 | DISQUE DE FREIN | FINISH:ÖL UND FETTFREI |
| 15 | 661-0001 | 1 | FREIN | FINISH: 961-0001 |

www.emc-motoculture.com

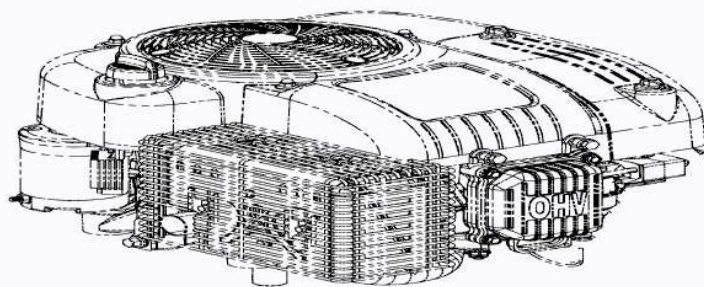

MTD
Model: 4 P 90 JHB

E3-08294B-01

| Position | Numéro de lapièce | # | Appellation I | Appellation II |
|----------|-------------------|---|------------------|----------------|
| 1 | 752Z4P90JHD | 1 | MOTEUR COMPLET | 752Z4P90JHD |
| 2 | 6012-X1-0033 | X | HUILE MULTIGRADE | 6012-X1-0033 |

www.emc-motoculture.com