

**ASSEMBLY/REPAIR  
PARTS MANUAL  
MODEL NO. RE1338A  
Lawn Tractor**

For Parts and Service, contact our authorized distributor: call 1-800-849-1297  
For Technical Assistance: call 1-800-829-5886

---

**Rally**

# CONTENTS OF HARDWARE PACK

## Parts Bag contents shown full size

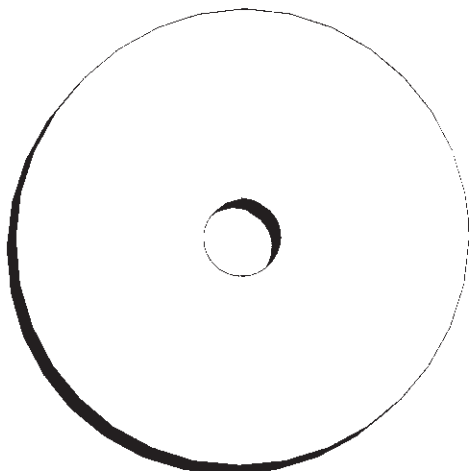

(1) Large Flat Washer



(2) Sheet Metal Screws #10-16 x 1/2



(1) Locknut 3/8-24

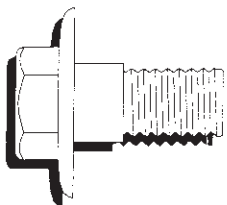

(1) Shoulder Bolt 5/16-18

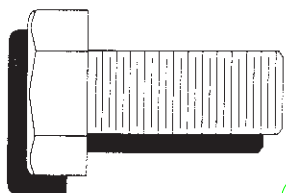

(1) Hex Bolt 1/2-13 x 1

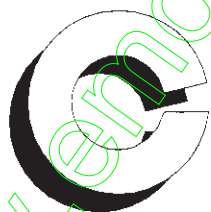

(1) Lock Washer 1/2

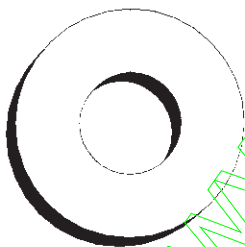

(1) Washer 17/32 x 1-3/16 x 12 Gauge



(2) Hex Bolts 1/4-20 x 3/4



(2) Keps Nut 1/4-20

## Parts packed separately in carton

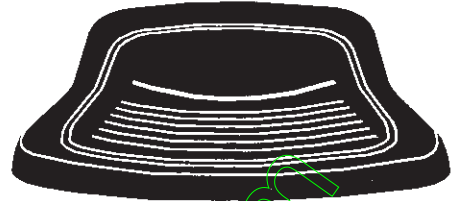

Seat

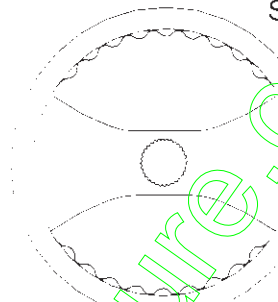

Steering Wheel



Steering Boot

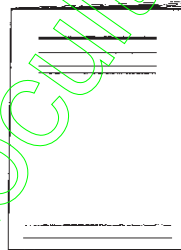

Manual

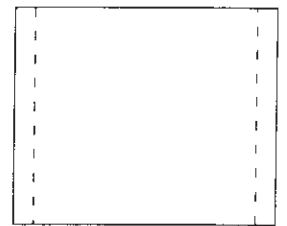

Parts Bag

## Parts bag contents not shown full size

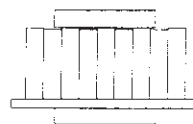

Steering Wheel Adapter

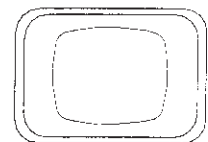

Steering Wheel Insert

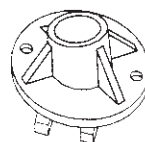

Steering Bushing

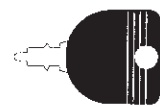

(2) Keys

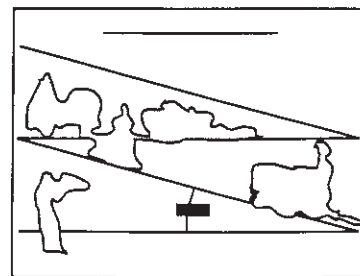

Slope Sheet

# ASSEMBLY

Your new tractor has been assembled at the factory with exception of those parts left unassembled for shipping purposes. To ensure safe and proper operation of your tractor all parts and hardware you assemble must be tightened securely. Use the correct tools as necessary to insure proper tightness.

## TOOLS REQUIRED FOR ASSEMBLY

A socket wrench set will make assembly easier. Standard wrench sizes are listed.

- (1) 9/16" wrench
- (1) 3/4" wrench
- (2) 7/16" wrenches
- Tire pressure gauge
- (1) 1/2" wrench
- Utility knife
- (1) 5/16" wrench

When right or left hand is mentioned in this manual, it means when you are in the operating position (seated behind the steering wheel).

## TO REMOVE TRACTOR FROM CARTON

### UNPACK CARTON

- Remove all accessible loose parts and parts cartons from carton (See page 2).
- Cut, from top to bottom, along lines on all four corners of carton, and lay panels flat.
- Check for any additional loose parts or cartons and remove.

## BEFORE ROLLING TRACTOR OFF SKID

### ATTACH STEERING WHEEL (See Fig. 1)

- Slide the steering bushing over the steering shaft.
- Raise steering shaft forward until screw holes in dash line up with steering bushing. Install two (2) sheet metal screws and tighten securely.
- Position steering boot over steering shaft.
- Place tabs of steering boot over tab slots in dash and push down to secure.
- Slide steering wheel adapter onto upper steering shaft.
- Position front wheels of the tractor so they are pointing straight forward.
- Position steering wheel so cross bars are horizontal (left to right) and slide onto adapter.
- Assemble large flat washer and 3/8-24 locknut and tighten securely.
- Snap steering wheel insert into center of steering wheel.
- Remove protective materials from tractor hood and grill.

**IMPORTANT:** CHECK FOR AND REMOVE ANY STAPLES IN SKID THAT MAY PUNCTURE TIRES WHERE TRACTOR IS TO ROLL OFF SKID.

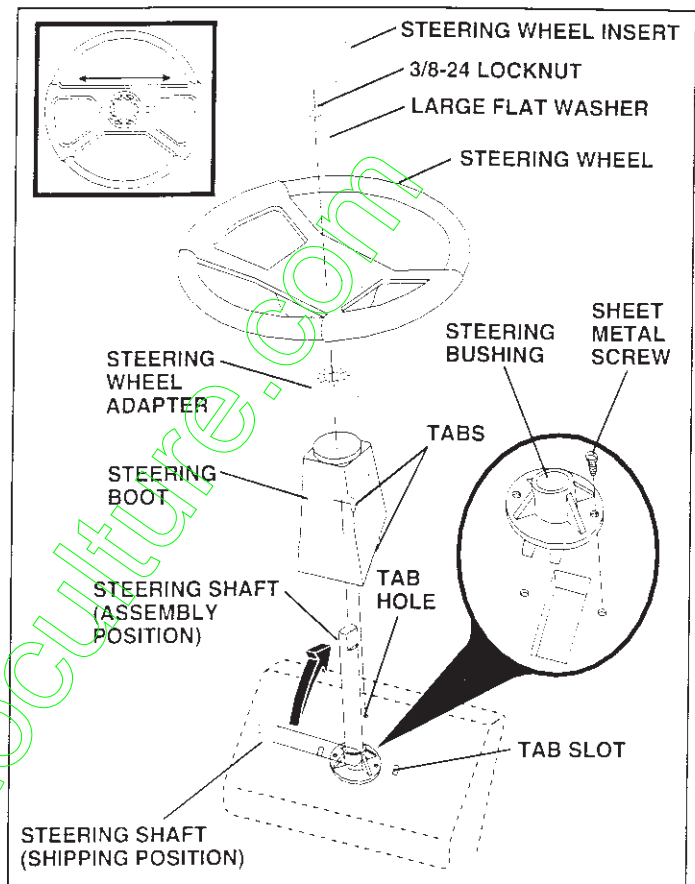

FIG. 1

## TO ROLL TRACTOR OFF SKID (See Operator's Manual for location of controls)

- Press lift lever plunger and raise attachment lift lever to its highest position.
- Release parking brake by depressing clutch/brake pedal.
- Place gearshift lever in neutral (N) position.
- Roll tractor backwards off skid.
- Remove banding holding discharge guard up against tractor.

# ASSEMBLY

## HOW TO SET UP YOUR TRACTOR

### CONNECT BATTERY (See Figs. 2 and 3)



**CAUTION:** Do not short battery terminals by allowing a wrench or any other object to contact both terminals at the same time. Before connecting battery, remove metal bracelets, wristwatch bands, rings, etc.

**Positive terminal must be connected first to prevent sparking from accidental grounding.**

- Remove cardboard packing from seat pan and lift seat pan to raised position.
- Open battery box door and remove protective plastic.
- Remove terminal protective caps and discard.
- If this battery is put into service after month and year indicated on label (label located between terminals) charge battery for minimum of one hour at 6-10 amps.
- First connect RED battery cable to positive (+) terminal with hex bolt and keps nut as shown. Tighten securely.
- Connect BLACK grounding cable to negative (-) terminal with remaining hex bolt and keps nut. Tighten securely.
- Close battery box door.

Open battery box door for:

Inspection for secure connections (to tighten hardware).

- Inspection for corrosion.
- Testing battery.
- Jumping (if required).
- Periodic charging.

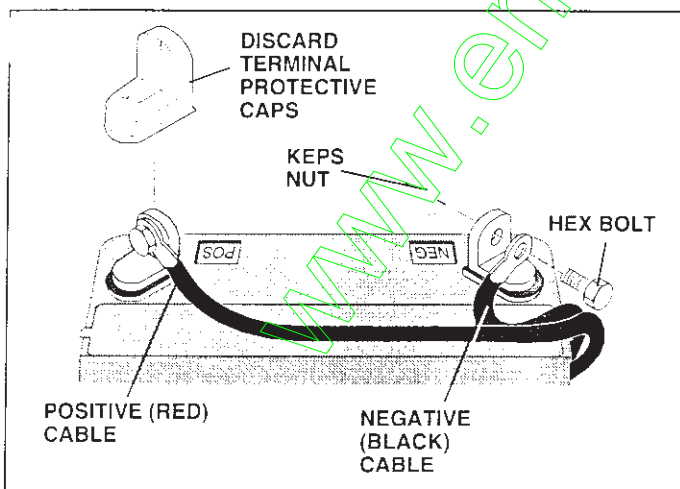

FIG. 2

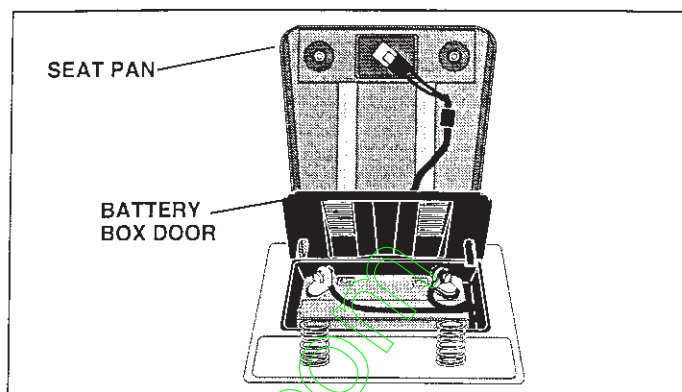

FIG. 3

### INSTALL SEAT (See Fig. 4)

Adjust seat before tightening adjustment bolt.

- Remove cardboard packing on seat pan.
- Place seat on seat pan and assemble shoulder bolt. Tighten shoulder bolt securely.
- Assemble adjustment bolt, lock washer and flat washer loosely. Do not tighten.
- Lower seat into operating position and sit on seat.
- Slide seat until a comfortable position is reached which allows you to press clutch/brake pedal all the way down.
- Get off seat without moving its adjusted position.
- Raise seat and tighten adjustment bolt securely.

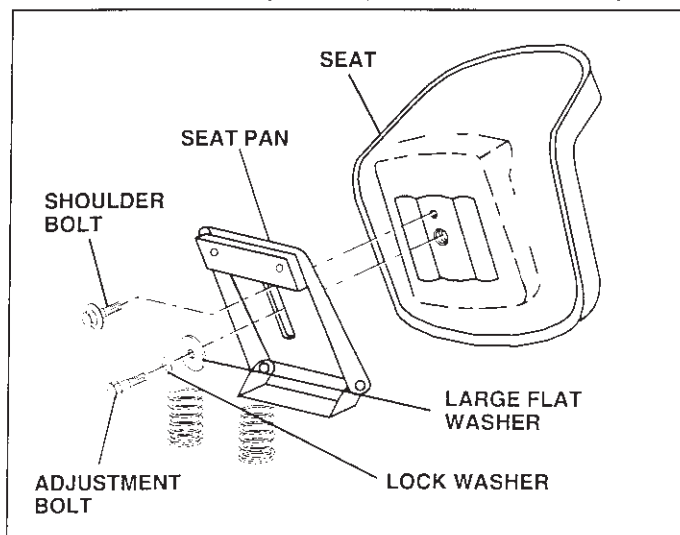

FIG. 4

---

# ASSEMBLY

---

## CHECK TIRE PRESSURE

The tires on your tractor were overinflated at the factory for shipping purposes. Correct tire pressure is important for best cutting performance.

- Reduce tire pressure to 14 PSI in front tires and 12 PSI in rear tires.

## CHECK DECK LEVELNESS

For best cutting results, mower housing should be properly leveled. See "TO LEVEL MOWER HOUSING" in the Service and Adjustments section of operator's manual.

## CHECK FOR PROPER POSITION OF ALL BELTS

See the figures that are shown for replacing motion and mower blade drive belts in the Service and Adjustments section of operator's manual. Verify that the belts are routed correctly.

## CHECK BRAKE SYSTEM

After you learn how to operate your tractor, check to see that the brake is properly adjusted. See "TO ADJUST BRAKE" in the Service and Adjustments section of operator's manual.

## ✓ CHECKLIST

*BEFORE YOU OPERATE AND ENJOY YOUR NEW TRACTOR, WE WISH TO ASSURE THAT YOU RECEIVE THE BEST PERFORMANCE AND SATISFACTION FROM THIS QUALITY PRODUCT.*

*PLEASE REVIEW THE FOLLOWING CHECKLIST:*

- ✓ All assembly instructions have been completed.
- ✓ No remaining loose parts in carton.
- ✓ Battery is properly prepared and charged. (Minimum 1 hour at 6 amps).
- ✓ Seat is adjusted comfortably and tightened securely.
- ✓ All tires are properly inflated. (For shipping purposes, the tires were overinflated at the factory).
- ✓ Be sure mower deck is properly leveled side-to-side/ front-to-rear for best cutting results. (Tires must be properly inflated for leveling).
- ✓ Check mower and drive belts. Be sure they are routed properly around pulleys and inside all belt keepers.
- ✓ Check wiring. See that all connections are still secure and wires are properly clamped.

*WHILE LEARNING HOW TO USE YOUR TRACTOR, PAY EXTRA ATTENTION TO THE FOLLOWING IMPORTANT ITEMS:*

- ✓ Engine oil is at proper level.
- ✓ Fuel tank is filled with fresh, clean, regular unleaded gasoline.
- ✓ Become familiar with all controls - their location and function. Operate them before you start the engine.
- ✓ Be sure brake system is in safe operating condition.

# TRACTOR -- MODEL NUMBER RE1338A

## SCHEMATIC

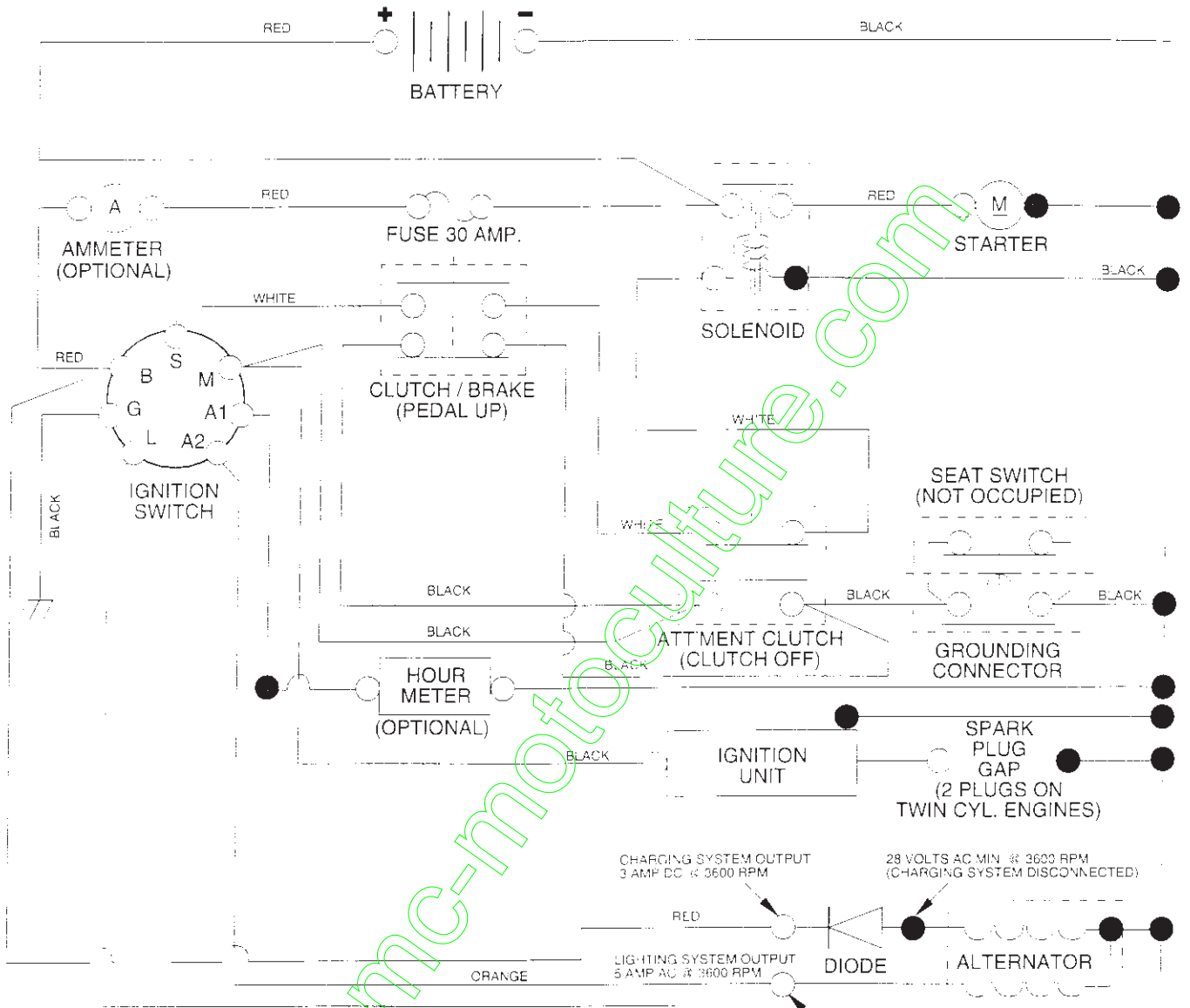

### NOTE

YOUR TRACTOR IS EQUIPPED WITH A SPECIAL ALTERNATOR SYSTEM. THE LIGHTS ARE NOT CONNECTED TO THE BATTERY, BUT HAVE THEIR OWN ELECTRICAL SOURCE. BECAUSE OF THIS, THE BRIGHTNESS OF THE LIGHTS WILL CHANGE WITH ENGINE SPEED. AT IDLE THE LIGHTS WILL DIM. AS THE ENGINE IS SPEEDED UP, THE LIGHTS WILL BECOME THEIR BRIGHTEST.

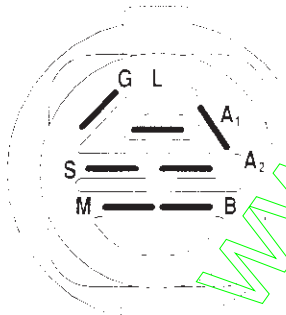

### IGNITION SWITCH

POSITION	CIRCUIT	"MAKE"
OFF	M-G-A1	NONE
RUN/LIGHT	B-A1	A2-L
RUN	B-A1	NONE
START	B-S-A1	NONE

NON-REMOVABLE CONNECTIONS

REMOVABLE CONNECTIONS

### WIRING INSULATED CLIPS

**NOTE:** IF WIRING INSULATED CLIPS WERE REMOVED FOR SERVICING OF UNIT, THEY SHOULD BE REPLACED TO PROPERLY SECURE YOUR WIRING.

# REPAIR PARTS

## TRACTOR - - MODEL NUMBER RE1338A

### ELECTRICAL

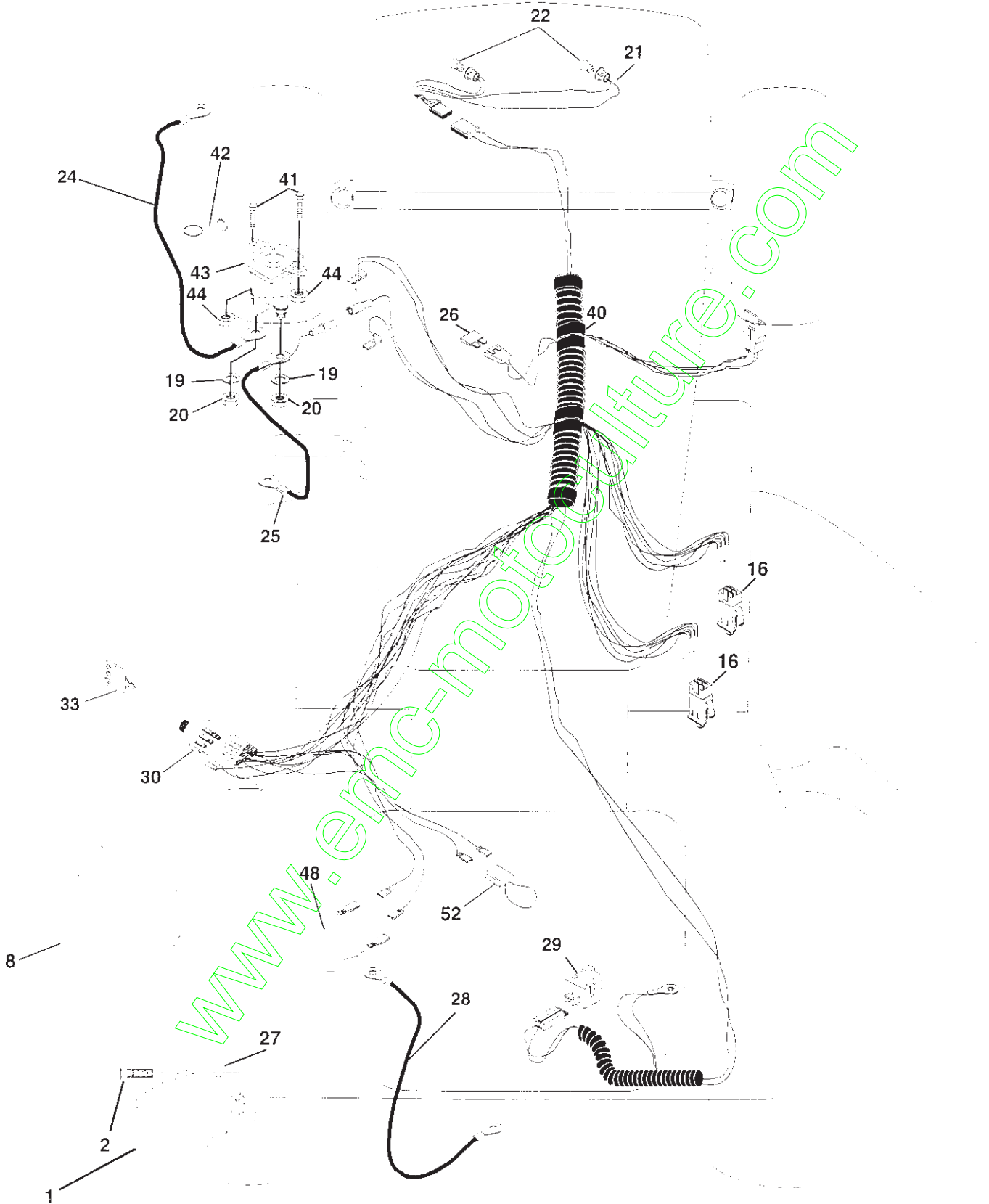

# REPAIR PARTS

## TRACTOR - - MODEL NUMBER RE1338A

### ELECTRICAL

KEY NO.	PART NO.	DESCRIPTION
1	144925	Battery 12 Volt 25 Amp
2	74760412	Bolt Hex Hd 1/4-20unc X 3/4
8	156417	Case Battery
16	153664	Switch Interlock Push-In
19	10090400	Washer Lock 1/4
20	73350400	Nut Jam Hex 1/4-20 Unc
21	166181	Harness Asm Light W/4152J
22	4152J	Bulb Light #1156
24	108423X	Cable Battery 6 Ga 16"red
25	146147	Cable Battery 6 Ga red W/ 16" Wire
26	108824X	Fuse 30 AMP Auto Green
27	73510400	Nut, Keps Hex 1/4-20 UNC
28	4207J	Cable Ground 6 Ga 12" black
29	121305X	Switch Plunger Nc Gray
30	163968	Switch, Ignition
33	140401	Key Ign
40	166151	Harness Ign
41	71110408	Bolt Blk Fin Hex 1/4-20 x 1/2
42	131563	Cover Terminal Red
43	145673	Solenoid
44	73640400	Nut Keps Hex 1/4-20 Unc
48	140844	Adapter Ammeter Rectangular
52	141940	Protection Wire Loop

**NOTE:** All component dimensions give in U.S. inches  
1 inch = 25.4 mm.



# REPAIR PARTS

## TRACTOR - - MODEL NUMBER RE1338A

### CHASSIS AND ENCLOSURES

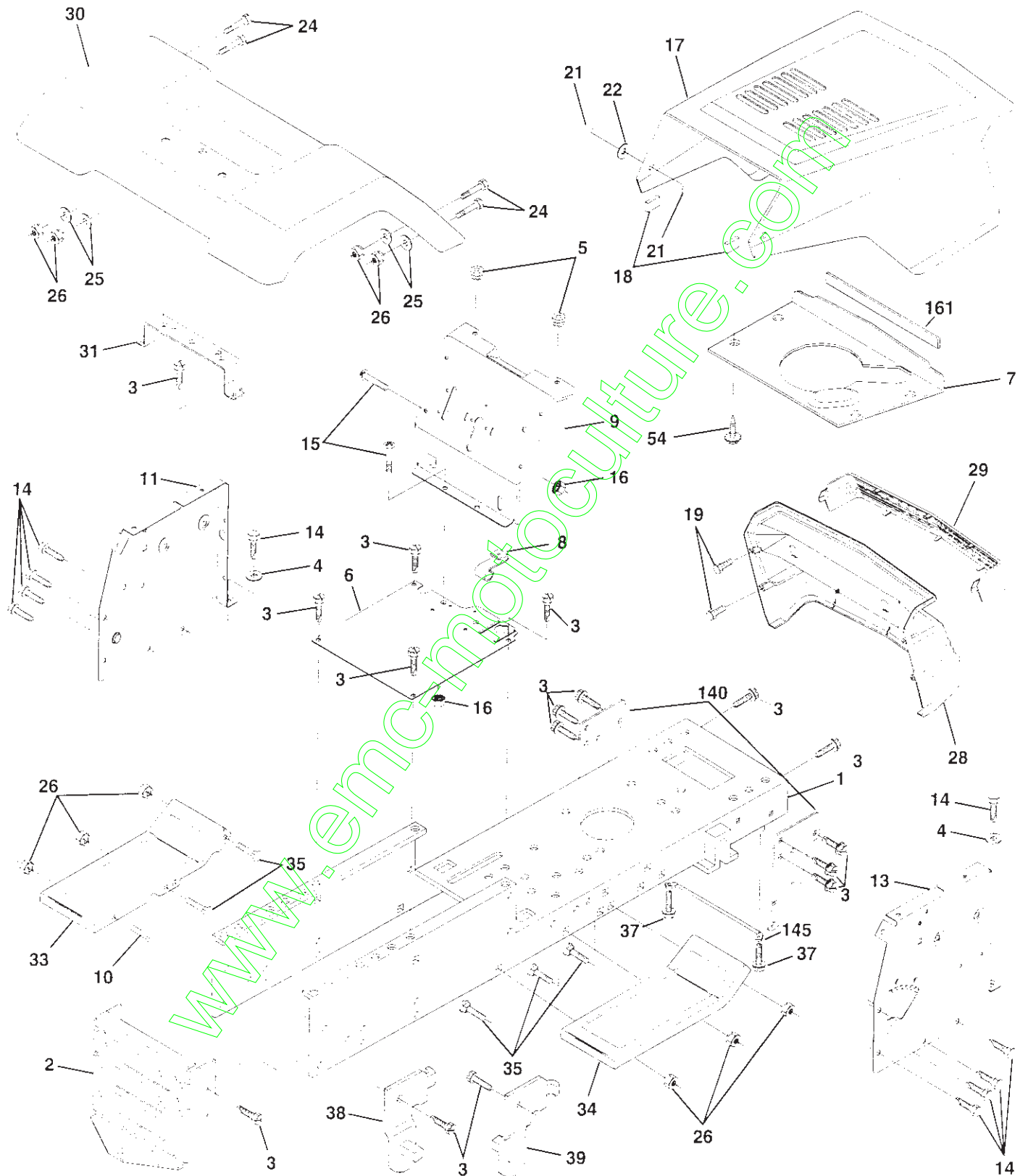

# REPAIR PARTS

## TRACTOR - - MODEL NUMBER RE1338A

### CHASSIS AND ENCLOSURES

KEY NO.	PART NO.	DESCRIPTION
1	165480	Chassis
2	140356	Drawbar
3	17490612	Screw, Thd., Roll. 3/8-16 x 3/4 Type-TT
4	19131216	Washer 13/32 x 3/4 x 16 Gauge
5	155272	Bumper Hood/Dash
6	155923	Saddle
7	124027X	Shield Heat Hood LT
8	155138	Clip, Retainer Slide-On
9	166318X010	Dash
10	72140608	Bolt, Carriage 3/8-16 x 1
11	155927	Dashboard, panel LH
13	155934X010	Dashboard, panel RH
14	17490608	Hex head tread rolling screw 3/8-16 x 1/2 Ty-tt
15	74180512	Machine screw 5/16-18 unc x 3/4
16	73510500	Nut, Keps 5/16-18 Unc
17	154988X505	Hood Asm Pnt Weld Slope MS-505
18	126938X	Bumper Hood
19	164863	Screw Hwhd Hi-Lo #13-16 x 3/4
21	122933X	Rivet Ratchet Nylon
22	124479X	Washer, Nylon Blk .28 x .75 x .19
24	74780616	Bolt, Hex Head, Fin. 3/8-16 x 1 Grade 5
25	19131312	Washer 13/32 x 13/16 x12 Gauge
26	73800600	Nut Lock Hex w/Ins. 3/8-16 Unc
28	140135X505	Grille
29	124029X599	Lens Grille
30	157583X505	Fender
31	136619	Fender Bracket
33	105476X505	Footrest, LH
34	105475X505	Footrest, RH
35	72110606	Bolt 3/8-16 X 3/4
37	17490508	Screw Thdrol 5/16-18 x 1/2
38	139886	Mower Pivot Bracket, LH
39	139887	Mower Pivot Bracket, RH
54	161464	Screw Hex WsHd 8-18 x 7/8
140	158418	Bracket Suspension Front
145	156524	Rod Pivot Chassis/Hood
161	161547	Extrusion Hood
--	5479J	Button Plug

**NOTE:** All component dimensions given in U.S. inches  
1 inch = 25.4 mm

# REPAIR PARTS

## TRACTOR - - MODEL NUMBER RE1338A

### DRIVE

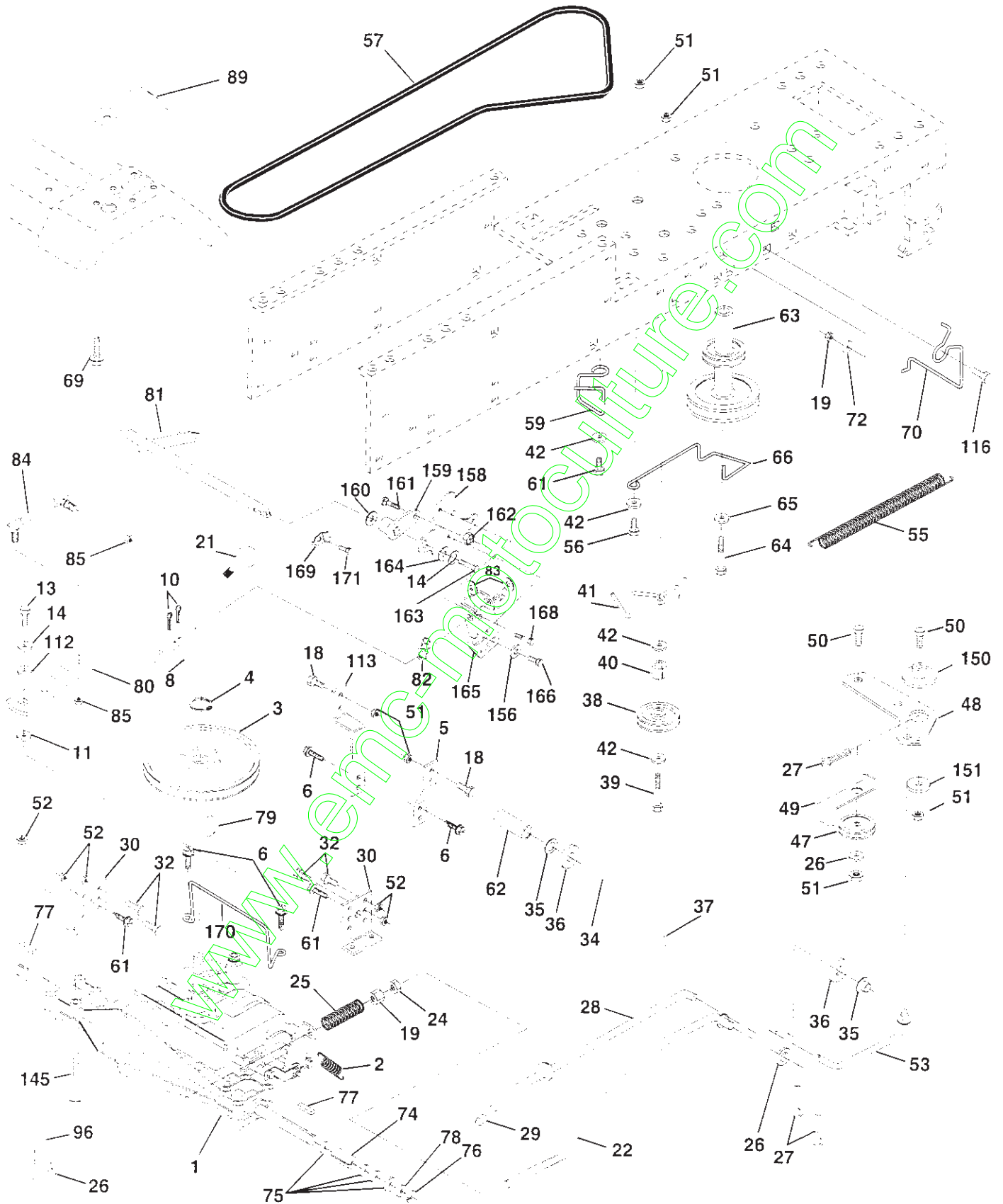

# REPAIR PARTS

## TRACTOR - - MODEL NUMBER RE1338A

### DRIVE

KEY PART NO. NO.	DESCRIPTION	KEY PART NO. NO.	DESCRIPTION
1 -----	Transaxle Peerless 205-544C Order parts from transaxle manufacturer	61 17490612	Screw, Hex Washer Head, Thd.. Roll. 3/8-16 x 3/4
2 146682	Spring, Brake Return	62 8883R	Cover, Foot Pedal
3 123666X	Pulley, Transaxle	63 140186	Pulley, Engine
4 12000028	Ring, Retainer	64 71170764	Bolt, Hex 7/16-20 x 4 Gr. 5
5 121520X	Strap, Torque	65 10040700	Washer, Lock Hvy Hlcl Spr 7/16
6 17490512	Screw, Hex, Washer, Thread Rolling 5/16-18 x 3/4	66 154778	Keeper, Belt Engine F-Proof
8 165619	Rod Shift Fender Adjust LT	70 134683	Guide Belt Mower Drive RH
10 76020416	Pin, Cotter 1/8 x 1	72 19132012	Washer 13/32 x 1-1/4 x 12 Ga.
11 105701X	Washer, Shift Plate	74 137057	Spacer, Axle
13 74550412	Bolt 1/4-28 UNF Gr. 8 w/Patch	75 121749X	Washer 25/32 x 1-1/4 x 16 Ga.
14 10040400	Washer Lock	76 12000001	E-Ring
18 74780616	Bolt, Fin Hex 3/8-16 Unc x 1 Gr. 5	77 123583X	Key Square
19 73800600	Locknut 3/8-16	78 121748X	Washer 25/32 x 1-5/8 x 16 Ga.
21 106933X	Knob	79 2228M	Key Woodruff #9 3/16 x 3/4
22 130804	Rod, Brake	80 131486	Shift Arm
24 73350600	Nut, Hex Jam 3/8-16	81 165594	Shaft Asm Cross Tapered DA/PR 18
25 106888X	Spring, Rod, Brake	82 123782X	Spring, Torsion
26 19131316	Washer 13/32 x 13/16 x 16 Gauge	83 19171216	Washer 17/32 x 3/4 x 16 Gauge
27 76020412	Pin, Cotter 1/8 x 3/4	84 166228	Link, Transaxle PMST/18" Zinc
28 145204	Rod, Brake, Park	85 150360	Nut 1/4-28
29 71673	Cap, Plunger	89 139963X428	Console Shift
30 130807	Bracket, Transaxle, L.H.	90 124346X	Nut, Washer Head, Self-Thread 1/4
32 74760512	Bolt Hex Hd 5/16-18 UNC x 3/4	96 4497H	Retainer Spring 1" Ziinc/Cad
34 155071	Shaft, Foot Pedal	112 19091210	Washer 9/32 x 3/4 x 10 Ga.
35 120183X	Bearing Nylon	113 127285X	Strap Torque L.H. Lt
36 19211616	Washer 21/32 x 1 x 16 Gauge	116 72110610	Bolt, RdHd Sq Neck 3/8-16 x 1.25
37 1572H	Pin, Roll 3/16 x 1	145 74490540	Bolt, Hex Flghd 5/16-18 Gr. 5
38 131494	Idler, Flat	150 165850	Bushing, Bellcrank Grd Drive
39 74760644	Bolt, Hex 3/8-16 x 2-3/4	151 19133210	Washer 13/32 x 2 x 10 Ga.
40 4470J	Spacer	156 166002	Washer Srtd 5/16ID x 1 x .125
41 165838	Keeper, Belt	158 165589	Bracket, Shift Mount
42 19131312	Washer 13/32 x 13/16 x 12 Gauge	159 165494	Hub, Tapered Flange Shift LT
47 127783	Pulley, Idler	160 19292016	Washer 29/32 x 1-1/4 x 16 Ga
48 154407	Bellcrank Clutch Grmf Drv Stl	161 72140406	Bolt Rdhd Sqnc 1/4-20 x 3/4 Gr 5
49 123205X	Retainer, Belt	162 73680400	Nut, Crownlock 1/4-20 UNC
50 74760624	Bolt, Hex 3/8-16 x 1-1/2	163 74780416	Bolt, Hex Fin 1/4-20 UNC x 1 Gr 5
51 73680600	Nut, Crownlock 3/8-16	164 19091010	Washer 5/8 x .281 x 10 Ga
52 73680500	Nut, Crownlock 5/16-18	165 165623	Bracket Pivot Lever
53 105710X	Link, Clutch	166 166880	Screw 5/16-18 x 5/8
55 105709X	Spring, Return, Clutch	168 165492	Bolt Shoulder 5/16-18 x .561
56 74760620	Bolt, Fin, Hex 3/8-16unc x 1-1/2	169 165581	Plate, Fastening LT
57 130801	V-Belt, Drive	170 165849	Keeper, Belt, transaxle Gear
59 140312	Retainer, Belt	171 17490608	Screw Thdrol 3/8-16 x 1/2 TY-TT

**NOTE:** All component dimensions given in U.S. inches  
1 inch = 25.4 mm

# REPAIR PARTS

## TRACTOR - - MODEL NUMBER RE1338A

### STEERING WHEEL

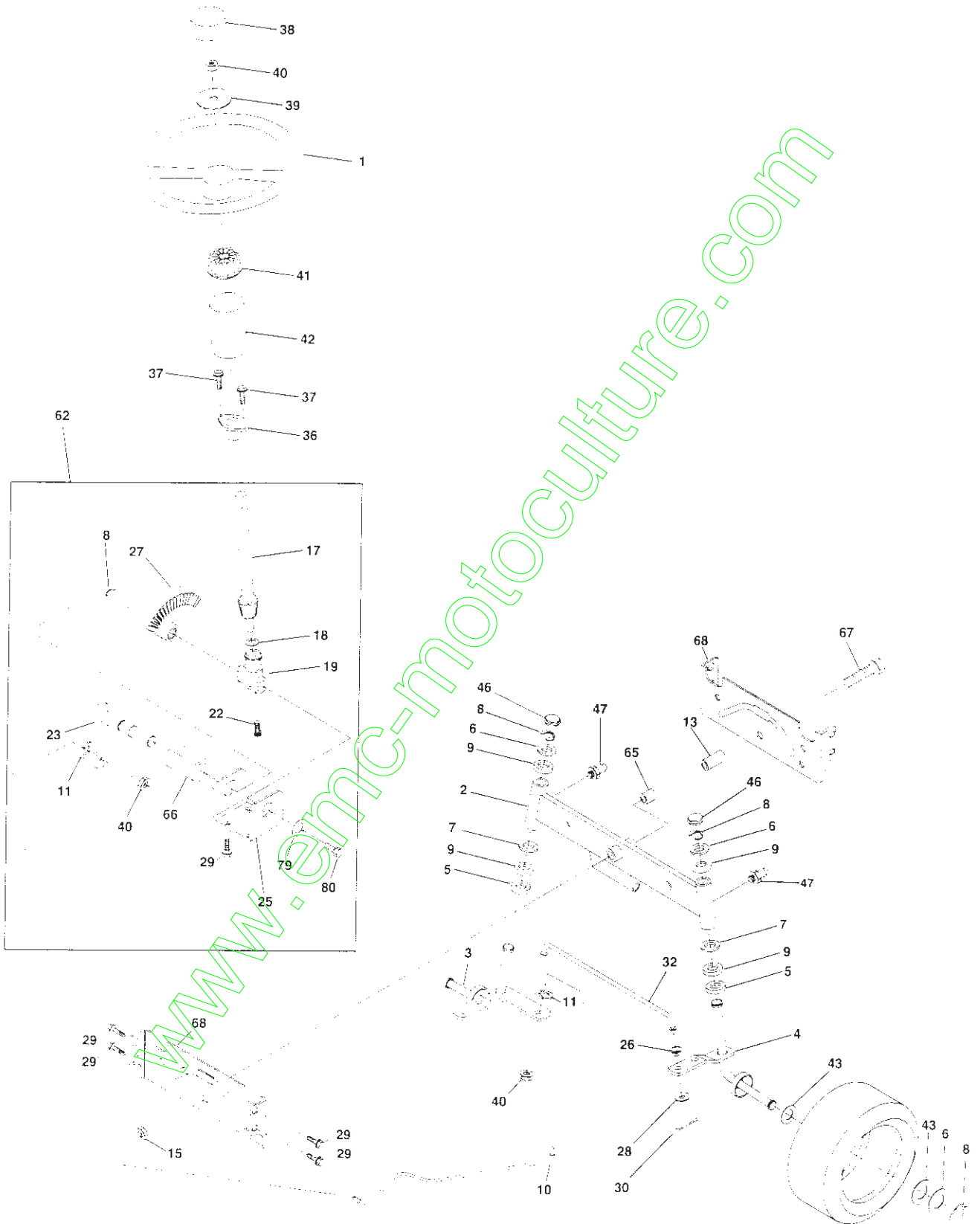

# REPAIR PARTS

## TRACTOR - - MODEL NUMBER RE1338A

### STEERING WHEEL

KEY NO.	PART NO.	DESCRIPTION
1	133741	Wheel, Steering
2	154427	Asm. Axle, Rear
3	156483	Asm., Spindle, Lh
4	157473	Asm., Spindle, Rh
5	6266H	Bearing, Thrust, Hardened
6	121748X	Washer 25/32 x 1-5/8 x 16 Ga.
7	19272016	Washer 27/32 x 1-1/4 x 16 Ga.
8	12000029	Ring, Clip
9	3366R	Bearing
10	156438	Link, Drag
11	10040600	Washer, Lock
13	154779	Bearing, Axle
15	73901000	Nut, Jam Hex w/Washer Insert 5/8-11 UNC
17	156545	Asm. Shaft, Steering
18	57079	Washer, Thrust .515 x .750 x .033
19	160395	Support, Shaft
22	165857	Screw, Hex Wshhd Torx
23	165851	Shaft, Asm Pitman
25	154406	Bracket, Steering
26	126847X	Bushing, Link, Drag
27	136874	Gear, Sector
28	19131416	Washer 13/32 x 7/8 x 16 Ga.
29	17490612	Screw, Thdrol 3/8-16 x 3/4 Type TT
30	76020412	Pin, Cotter
32	130465	Rod, Tie
36	155099	Bushing, Steering
37	152927	Screw
38	133742	Insert, Steering
39	19133808	Washer 13/32 x 2-3/8 x 8 Ga.
40	7810H	Nut
41	104820X	Adapter, Steering
42	124418X	Boot, Shaft Steering Blk
43	121749X	Washer 25/32 x 1-1/4 x 16 Ga.
46	121232X	Cap, Spindle
47	6855M	Fitting, Grease
62	167903	Kit, Steering Asm. Service
65	154780	Spacer Axle
66	154404	Bearing Arm Pittman
67	74781044	Bolt, FinHex 5/8-11 UNC x 2-3/4
68	154429	Axle, Brace
79	19132012	Washer 13/32 x 1-1/4 x 12 Ga.
80	74950612	Bolt, Hex Nylon 3/8-16 x 3/4

**NOTE:** All component dimensions given in U.S. inches  
1 inch = 25.4 mm

# REPAIR PARTS

TRACTOR -- MODEL NUMBER RE1338A

## ENGINE

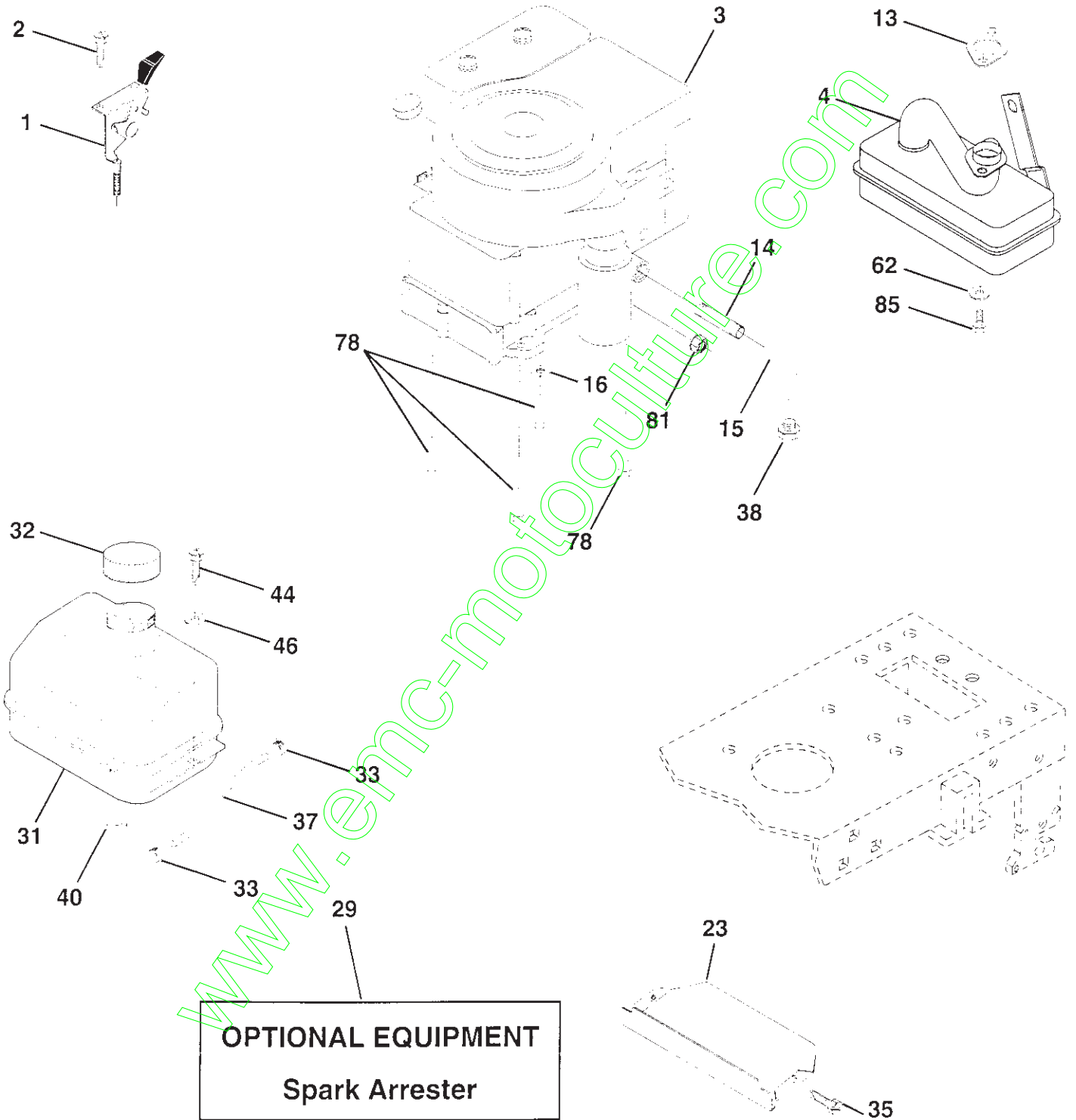

# REPAIR PARTS

## TRACTOR - - MODEL NUMBER RE1338A

### ENGINE

KEY NO.	PART NO.	DESCRIPTION
1	152141	Control Th/ch Flag EEC 15.1
2	17720410	Screw Hex Thd Cut 1/4-20x5/8 T
3	-----	Engine Tecumseh Model OHV130 Order parts from engine manufacturer
4	156700	Muffler Tec 11/13.0 HP LT
13	165291	Gasket Eng 1 313 Id Tin Plated
14	13280336	Nipple Pipe 4-1/2"
15	13200300	Elbow Std 90 Degree 3/8-18 Npt
16	11050600	Washer Lock Ext Tooth 3/8
23	159880	Shield Brn/Dbr Guard
29	137180	Kit Spark Arrestor (Flat Scrn)
31	109202X	Tank Fuel Front 2 00
32	140527	Cap Asm Fuel
33	123487X	Clamp Hose Blk
35	17490512	Screw Thdrol 5/16-18 x 3/4 TYT
37	137040	Line Fuel
38	-----	Plug Oil Drain (Order From Engine Manufacturer)
40	124028X	Bushing Snap Nyl Blk Fuel Line
44	17490412	Screw Hexysh Thdrol 1/4-20x3/4
46	19091416	Washer 9/32 X 7/8 X 16 Ga
62	10040500	Washer 5/16
78	17490620	Screw Thdrol 3/8-16x1-1/4 TYTT
81	128861	Nut Flange 1/4-20 Starter Nut
85	123528X	Bolt Hex Hd Phillips

**NOTE:** All component dimensions given in U.S. inches.  
1 inch = 25.4 mm.



# REPAIR PARTS

## TRACTOR - - MODEL NUMBER RE1338A

### SEAT

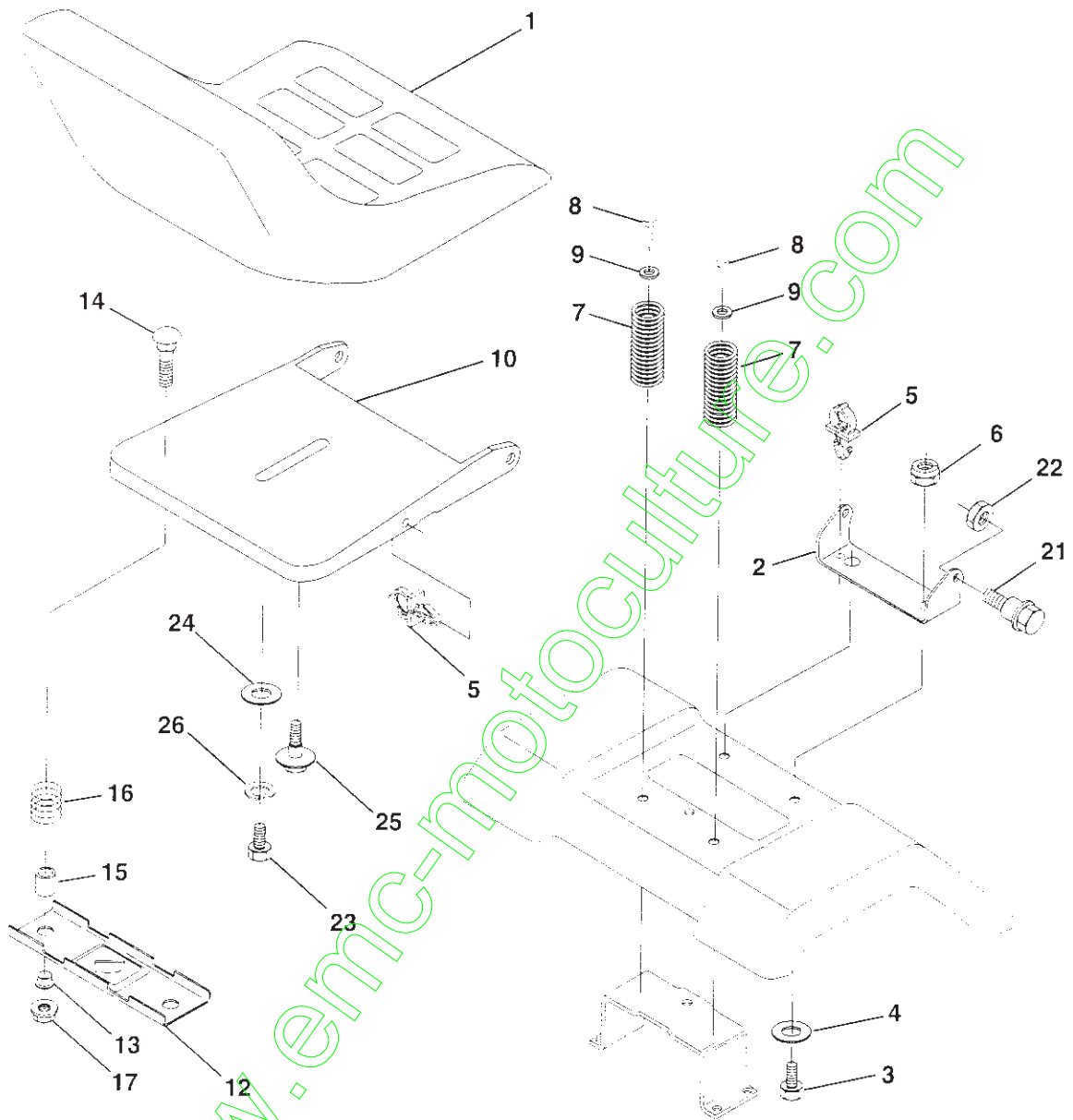

KEY NO.	PART NO.	DESCRIPTION
1	127426X	Seat
2	140551	Bracket, Pivot, Seat
3	74760616	Bolt
4	19131610	Washer 13/32 x 1 x 10 Ga.
5	145006	Clip, Push-in
6	73800600	Nut
7	124181X	Spring, Seat
8	17490616	Screw, Thdrol 3/8-16 x 1
9	19131614	Washer 13/32 x 1 x 14 Ga.
10	155925	Pan, Seat
12	121246X	Bracket, Mounting, Switch, Seat
13	121248X	Bushing, Nylon

KEY NO.	PART NO.	DESCRIPTION
14	72050412	Nut, Crownlock 1/4-20 x 1-1/2
15	134300	Spacer, Split
16	121250X	Spring
17	123976X	Nut, Lock, Flange 1/4 Gr. 5
21	153236	Bolt, Shoulder 5/16-18 UNC
22	73800500	Nut
23	74780814	Bolt Fin Hex 1/2 - 13 x 7/8 Gr. 5
24	19171912	Washer 17/32 x 1-3/16 x 12 Ga.
25	127018X	Bolt Shoulder 5/16-18 x .62
26	10040800	Washer Lock Hvy Hclc Spr 1/2

**NOTE:** All component dimensions given in U.S. inches  
1 inch = 25.4 mm

# REPAIR PARTS

## TRACTOR - - MODEL NUMBER RE1338A

### DECALS

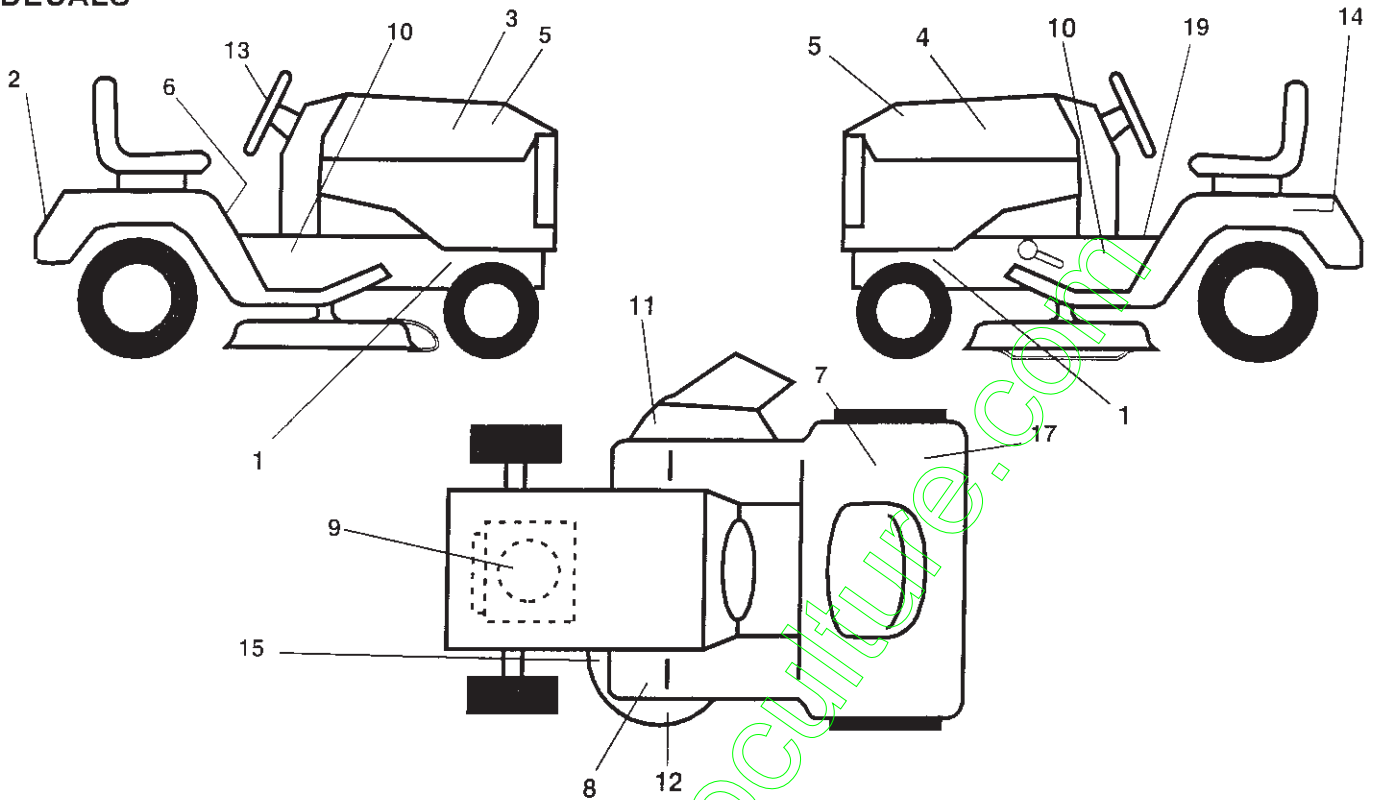

KEY NO.	PART NO.	DESCRIPTION	KEY NO.	PART NO.	DESCRIPTION
1	159736	Decal, Chassis Hot Muffler	13	127075	Decal Wheel Steering
2	132628	Decal, Fender Logo	14	145005	Decal, Battery Dan/Poi P/L Symbols
3	142308	Decal, Hood Rh	15	136832	Decal, V-Belt
4	142309	Decal, Hood Lh	17	126187X	Decal, 100 DBA
5	167611	Decal, HP Hood	19	140837	Decal, Parking Brake
6	145498	Decal, Read Owner's Manual Syms	--	138311	Decal, Handle, Lift, Height Adjust (Lift Handle)
7	145437	Decal, Europe Stand CE	--	162598	Decal, Drawbar Load Limit
8	159737	Decal, Brake/Clutch Symbol LT	--	167956	Manual, Operator's (European)
9	64-1726-29	Decal, HP Engine	--	167955	Manual, Operator's (Scand)
10	127900	Decal Chassis 38"	--	167957	Manual, Repair Parts
11	145494	Decal, Mower Cutting Symbol			
12	135013	Decal, Enviro Deck Yellow			

### TIRES AND WHEELS

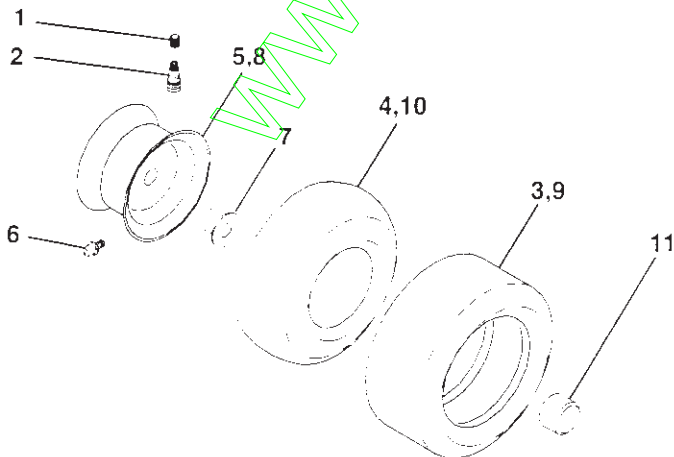

KEY NO.	PART NO.	DESCRIPTION
1	59192	Cap, Valve
2	65139	Stem, Valve
3	106222X	Tire Front
4	59904	Tube, Front (not furnished)
5	106732X427	Rim, Asm. Front
6	278H	Grease Fitting (rear tire only)
7	9040H	Bearing, Flange (front tire only)
8	106108X427	Rim, Asm. Rear
9	124635X	Tire, Rear
10	7152J	Tube, Rear (not furnished)
11	104757X	Cap, Axle
--	144334	Sealant, Tire (10 oz. Tube)

NOTE: All component dimensions given in U.S. inches  
1 inch = 25.4 mm

# REPAIR PARTS

TRACTOR - - MODEL NUMBER RE1338A

## MOWER LIFT

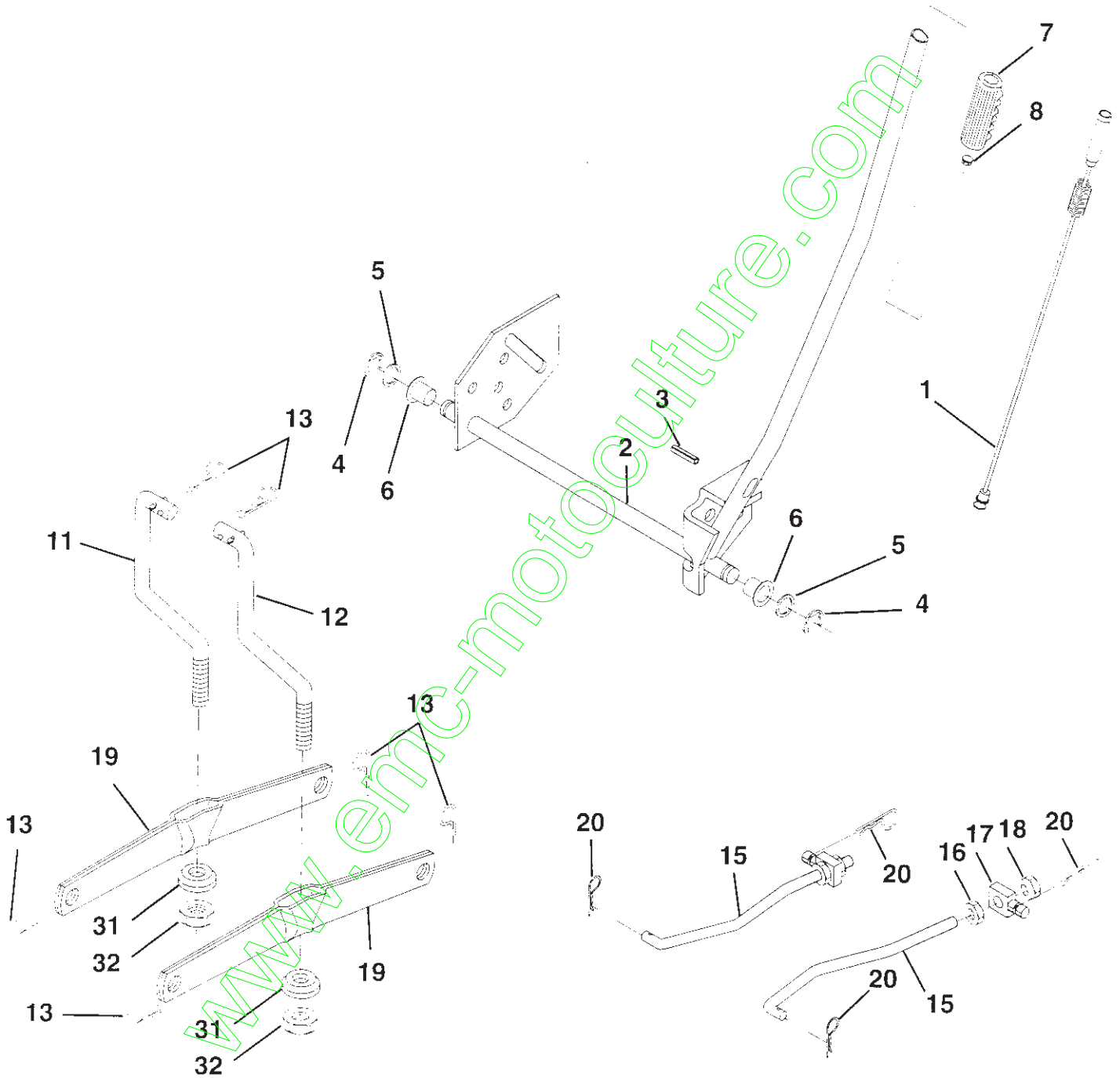

# REPAIR PARTS

## TRACTOR - - MODEL NUMBER RE1338A

### MOWER LIFT

KEY NO.	PART NO.	DESCRIPTION
1	159460	Asm. Inner Wire w/Plunger
2	159474	Asm., Shaft, Lift
3	105767X	Pin, Groove
4	12000002	Ring, E #5133-62
5	19211621	Washer 21/32 x 1 x 21 Ga.
6	120183X	Bearing, Nylon
7	109413X	Grip Handle Bicycle Matte Blk
8	124526X	Button, Plunger
11	139865	Link, Lift, Lh
12	139866	Link, Lift, Rh
13	4939M	Spring, Retainer
15	127218	Link, Front
16	73350800	Nut, Jam, Hex 1/2-13 Unc
17	130171	Trunnion
18	73680800	Nut, Crownlock 1/2-13 Unc
19	139868	Arm, Suspension, Rear
20	163552	Spring, Retainer
31	140302	Bearing, Pvt Lft
32	73540600	Nut Crownlock 3/8-24

**NOTE:** All component dimensions given in U.S. inches  
1 inch = 25.4 mm

# REPAIR PARTS

TRACTOR - - MODEL NUMBER RE1338A

## MOWER DECK

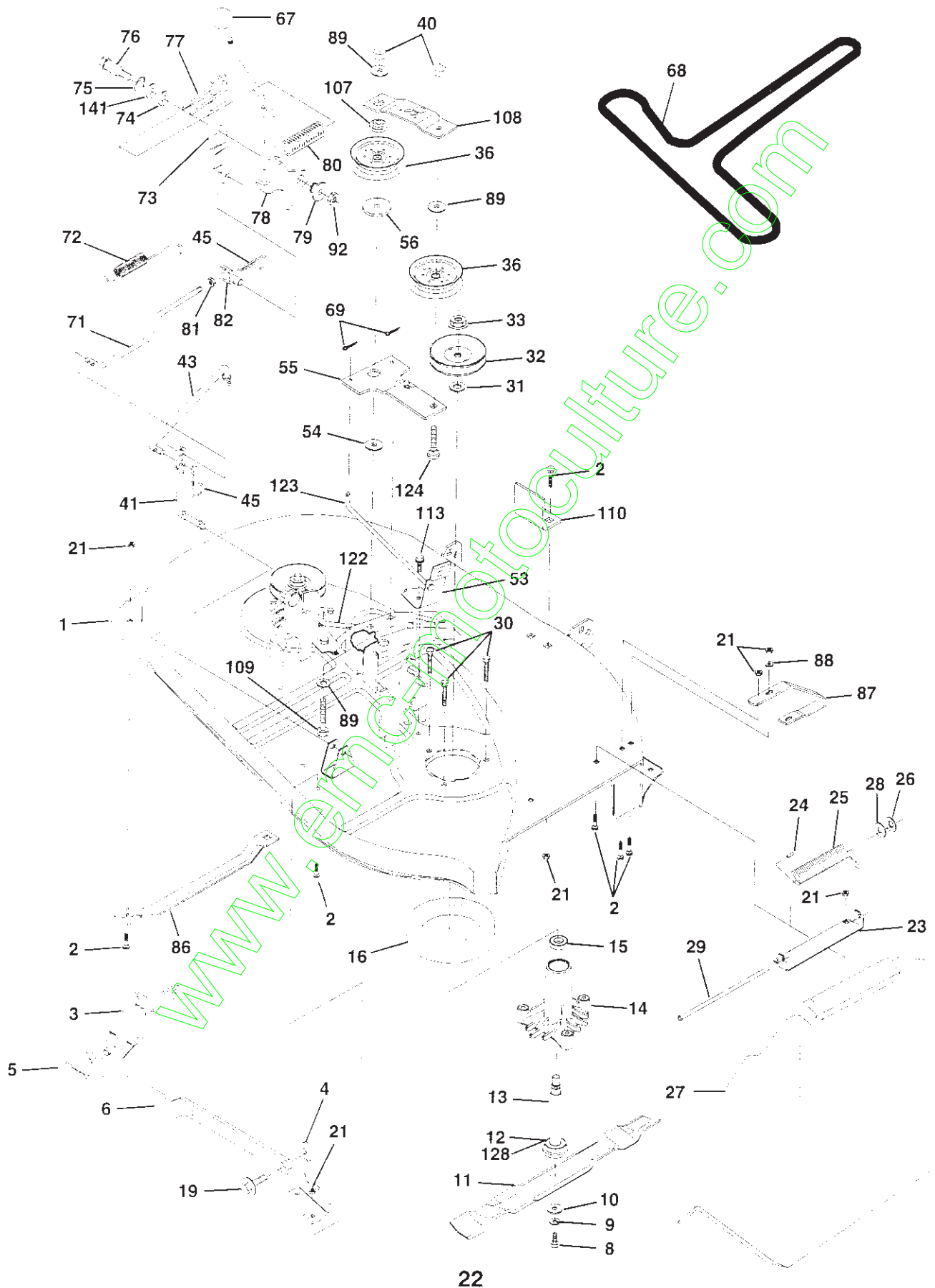

# REPAIR PARTS

## TRACTOR - - MODEL NUMBER RE1338A

### MOWER DECK

KEY NO.	PART NO.	DESCRIPTION	KEY NO.	PART NO.	DESCRIPTION
1	142829	Mower Housing Assembly	56	122052X	Spacer, Retainer
2	72140506	Bolt	67	162132	Knob
3	138017	Asm., Bar, Anti-Sway	68	144200	V-Belt, Mower
4	138440	Asm., Bracket, Anti-Sway Bar	69	76020312	Pin, Cotter 3/32 x 3/4
5	4939M	Spring, Retainer	71	142427	Rod Primary Clutch 38 & 42"
6	130832	Arm, Suspension, Rear	72	131870	Spring Return
8	850857	Bolt 3/8-24 x 1.25 Gr. 8	73	127847	Arm Clutch Secondary
9	10030600	Washer, Lock	74	121748X	Washer 25/32 x 1-5/8 x 16 Ga.
10	140296	Washer, Hardened	75	12000029	Ring Klip #T5304-75
11	138497	Blade, Mower, Hi Lift	76	128903	Bolt Shoulder 3/8 - 16 UNC 1.44
12	129895	Bearing, Ball	77	127845	Keeper Spring 4.000
13	137645	Asm., Shaft, Mandrel, Vented (Includes key no. 12)	78	160571	Lever Asm. Clutch Primary Lt
14	128774	Housing, Mandrel, Vented	79	127498	Bushing .747 OD x 794 Lg
15	110485X	Bearing, Ball, Mandrel	80	153701	Spring Clutch Mower
16	140329	Stripper, Mower	81	73350600	Nut Hex Jam 3/8 - 16 UNC
19	132827	Bolt, Shoulder	82	142028	Trunnion Adj '94
21	73680500	Nut, Crownlock 5/16 - 18 UNC	86	7631J	Runner, LH
23	137607	Bracket, Deflector	87	128772	Runner, RH
24	105304X	Cap, Sleeve	88	19111216	Washer 11/32 x 3/4 x 16 Ga.
25	123713X	Spring, Torsion, Deflector	89	19131612	Washer 13/32 x 1 x 12 Ga.
26	110452X	Washer, Lock	92	73800600	Nut Lock Hex w/Ins 3/8-16 UNC
27	106736X	Deflector, Shield	107	133502	Spacer, Retainer
28	19111016	Washer 11/32 x 5/8 x 16 Ga.	108	133503	Stiffener, Idler Arm
29	106735X	Rod, Hinge	109	74760640	Bolt, hex Head 3/8-16 x 2-1/2
30	157722	Screw Hex Thdrol	110	142587	Upstop Deck Front 38"
31	129963	Washer, Spacer	113	17490512	Screw, Hex Head, Thd.,Roll 5/16-18 x 3/4
32	153532	Pulley, Mandrel	122	131289	Rod, Brake, RH
33	137266	Nut Lock 9/16	123	131288	Rod, Brake, LH
36	131494	Pulley, Idler, Flat	124	72110614	Bolt, Carriage 3/8-16 x 1-3/4
40	73680600	Nut, Crownlock 3/8 - 16 UNC	128	153390	Washer Felt
41	133551	Rod Pivot w/Nibs	141	6266H	Washer, Thrust .75 x 1.230
43	133504	Rod Clutch Secondary	--	130794	Asm. Mandrel (includes key nos. 8-10, 12-15, 31 and 33)
45	4497H	Retainer Spring 1: Zinc/Cad	--	145758	Mower Deck, Complete
53	130840	Brake Assembly			
54	133943	Washer, Hardened			
55	133840	Arm, Idler Assembly			

**NOTE:** All component dimensions given in U.S. inches  
1 inch = 25.4 mm

---

# SERVICE NOTES

---

[www.emc-motoculture.com](http://www.emc-motoculture.com)

---

# SERVICE NOTES

---

[www.emc-motoculture.com](http://www.emc-motoculture.com)





# SERVICE POLICY WARRANTY



Issued January 1980  
Revised January 1991

## LIMITED WARRANTIES FOR NEW PEERLESS GEAR POWER TRAIN COMPONENTS

### A. Products Warranted

Peerless Gear and Machine Division of Tecumseh Products Company ("Tecumseh"), subject to the limitations contained below, will, at its option, repair or replace, without charge for parts or labor only, any part of a new Power Train Component (which as used herein means and includes the transaxle, gear box, transmission, differential and right angle drives, and any part of the Power Train Component), EXCEPT any new Power Train Component incorporated in equipment used for commercial or rental purposes, which is found upon examination by any Tecumseh Authorized Service Outlet or by Tecumseh's factory in Grafton, Wisconsin, to be DEFECTIVE IN MATERIAL AND/OR WORKMANSHIP if received by Tecumseh or a Tecumseh Authorized Service Outlet for such examination within TWO YEARS from the date of sale to the original consumer purchaser of Peerless Series 820, 900, 910, 915, 920, 930 transaxles and Series 1100 angle drive and ONE YEAR for all other Peerless products. New Power Train Components incorporated in equipment used for commercial purposes are warranted in the same manner and to the same extent EXCEPT such Power Train Components are warranted for NINETY (90) DAYS ONLY, and must be received by Tecumseh or by a Tecumseh Authorized Service Outlet for such examination within 90 days from the date of sale to the original purchaser. New Power Train Components Incorporated in equipment used for rental purposes are warranted in the same manner and to the same extent EXCEPT such Power Train Components are warranted for THIRTY (30) DAYS ONLY, and must be received by Tecumseh or a Tecumseh Authorized Service Outlet within 30 days from the date of sale to the original purchaser.

### B. Products And Items Not Warranted

1. Alterations or Modifications of Power Train Components.
  2. Accidents, Normal Maintenance, Failure to follow the Original Equipment Manufacturer's Manual.
- This warranty covers only parts of new Power Train Components which are found upon examination to be defective in material or workmanship as delivered to the original purchaser. This warranty does not cover defects caused by depreciation or damage caused by normal wear, accidents, improper maintenance, improper use or abuse of the product, failure to follow the instructions contained in an Instruction Manual for the operation of the Power Train Component and parts. The cost of normal maintenance and replacement of service items which are not defective shall be paid for by the original purchaser.

### C. Securing Warranty Service

Warranty service can be arranged for by contacting either a Tecumseh Authorized Service Outlet (any Tecumseh Registered Service Dealer, Tecumseh Authorized Service Distributor, or Tecumseh Central Warehouse Distributor) or by contacting Tecumseh, c/o Service Manager, Engine and Transmission Group Service Division, 900 North Street, Grafton, Wisconsin 53024. Warranty service can only be performed by a Tecumseh Authorized Service Outlet or by Tecumseh at its factory in Grafton, Wisconsin. At the time of requesting warranty service, evidence must be presented of the date of sale to the original purchaser. The purchaser shall pay any charges for making service calls and/or for transporting the product to and from the place where the inspection and/or warranty work is performed. The purchaser shall be responsible for any damage or loss incurred in connection with the transportation of Power Train Components and/or part(s) of the Power Train Components submitted for inspection and/or warranty work.

### D. Limitation of Damages and Implied Warranties

The foregoing EXPRESSED WARRANTY IS IN LIEU OF ALL OTHER EXPRESS WARRANTIES. Neither Tecumseh nor any of its affiliates makes any warranties, representations or promises, written or oral, as to the quality of the Power Train Component or any of its parts, other than as set forth herein.

ANY IMPLIED WARRANTY OF MERCHANTABILITY OR FITNESS FOR A PARTICULAR PURPOSE, TO THE EXTENT THAT EITHER MAY APPLY TO ANY PART(S) OF POWER TRAIN COMPONENTS, SHALL BE LIMITED IN DURATION TO THE PERIODS OF THE EXPRESSED WARRANTIES DEFINED IN PARAGRAPH A HEREOF. IN NO EVENT WILL TECUMSEH BE LIABLE FOR ANY INCIDENTAL, CONSEQUENTIAL OR SPECIAL DAMAGES AND/OR EXPENSES. Some states do not allow limitations on how long an implied warranty lasts or the exclusion or limitation of incidental or consequential damages, so the above limitation(s) or exclusion(s) may not apply to you. This warranty gives you specific legal rights and you may also have other legal rights which vary from state to state.

### E. No Dealer Warranty

Tecumseh neither assumes nor authorizes any other person, natural or corporate, to assume for Tecumseh any other obligations or liabilities in connection with or with respect to any part(s) of a Power Train Component. The seller or dealer of part(s) of a Power Train Component has no authority, whatsoever, to make any representations or promises on behalf of Tecumseh or to modify the terms or limitations of Tecumseh's warranty in any way.

## LIMITED WARRANTY

The Manufacturer warrants to the original consumer purchaser that this product as manufactured is free from defects in materials and workmanship. For a period of one (1) year from date of purchase by the original consumer purchaser, we will repair or replace, at our option, without charge for parts or labor incurred in replacing parts, any part which we find to be defective due to materials or workmanship. This Warranty is subject to the following limitations and exclusions.

1. This warranty does not apply to the engine, other than FHP manufactured transaxle/transmission components, battery (except as noted below) or components parts thereof. Please refer to the applicable manufacturer's warranty on these items.
2. Transportation charges for the movement of any power equipment unit or attachment are the responsibility of the purchaser. Transportation charges for any parts submitted for replacement under this warranty must be paid by the purchaser unless such return is requested by Frigidaire Home Products.
3. Battery Warranty: On products equipped with a Battery, we will replace, without charge to you, any battery which we find to be defective in manufacture, during the first ninety (90) days of ownership. After ninety (90) days, we will exchange the Battery, charging you 1/12 of the price of a new Battery for each full month from the date of the original sale. Battery must be maintained in accordance with the instructions furnished.
4. The Warranty period for any products used for rental or commercial purposes is limited to 90 days from the date of original purchase.
5. This Warranty applies only to products which have been properly assembled, adjusted, operated, and maintained in accordance with the instructions furnished. This Warranty does not apply to any product which has been subjected to alteration, misuse, abuse, improper assembly or installation, delivery damage, or to normal wear of the product.
6. Exclusions: Excluded from this Warranty are belts, blades, blade adapters, normal wear, normal adjustments, standard hardware and normal maintenance.
7. In the event you have a claim under this Warranty, you must return the product to an authorized service dealer.

Should you have any unanswered questions concerning this Warranty, please contact:

Frigidaire Home Products  
Outdoor Products Customer Service Dept.  
250 Bobby Jones Expressway  
Augusta, GA 30909 USA

In Canada contact:  
Frigidaire Home Products  
7075 Ordan Drive  
Mississauga, Ontario  
L5T 1K6

giving the model number, serial number and date of purchase of your product and the name and address of the authorized dealer from whom it was purchased.

THIS WARRANTY DOES NOT APPLY TO INCIDENTAL OR CONSEQUENTIAL DAMAGES AND ANY IMPLIED WARRANTIES ARE LIMITED TO THE SAME TIME PERIODS STATED HEREIN FOR OUR EXPRESSED WARRANTIES. Some areas do not allow the limitation of consequential damages or limitations of how long an implied Warranty may last, so the above limitations or exclusions may not apply to you. This Warranty gives you specific legal rights, and you may have other rights which vary from locale to locale.

This is a limited Warranty within the meaning of that term as defined in the Magnuson-Moss Act of 1975.