



PIÈCES DÉTACHÉES

Aspirateur collecteur



SF315

SF300 / SF330



Yvan Béal - 21, av. de l'Agriculture - B.P. 16
Z.I. du Brézet - 63014 Clermont-Ferrand Cedex 2
Tél : 04 73 91 93 51 - Télécopie : 04 73 90 23 11
www.yvanbeal.fr - E-mail : info@yvanbeal.fr
R.C.S. Clermont-Fd B 304 973 886 S.A.S. au capital de 612 000 €

03-000036-040701

VUE ECLATEE N° V610.02.02 ENSEMBLE CAISSE

Repère	Référence	Quantité	Désignation	A partir du n°
1	S610.3011	1	container	
2	S610.4005	1	Arceau de container	
2a	C216.48TL20	8	Rivet	
3	S670.4041	2	Cale epaisseur	
4	C161.835Z	2	Vis H	
4a	C161.825Z	2	Vis H	
4b	C181.M8Z	2	Rondelle plate	
4c	C173.8	2	Ecrou frein	
5	C163.1240Z	4	Vis TRCC	
5a	C173.12	4	Ecrou frein	
6	C215.4002B	1	Joint armature Lg2800	
7	S610.4006	1	Arceau porte	
8	S610.3014A	1	Porte	
9	C168.1260Z	2	Vis à ceil	
9a	C171.12Z	4	Ecrou	
9b	C161.1235Z	2	Vis H	
9c	C173.12	2	Ecrou frein	
10	S597.4041	1	Plaque regard	
10a	S650.4043	2	Réglette de niveau	
11	S610.3013	1	Support coude entrée	
12	V610.28.00	1	Grille démontable	
13	S610.4044	9	Agraphe joint	n°46

610.02.02

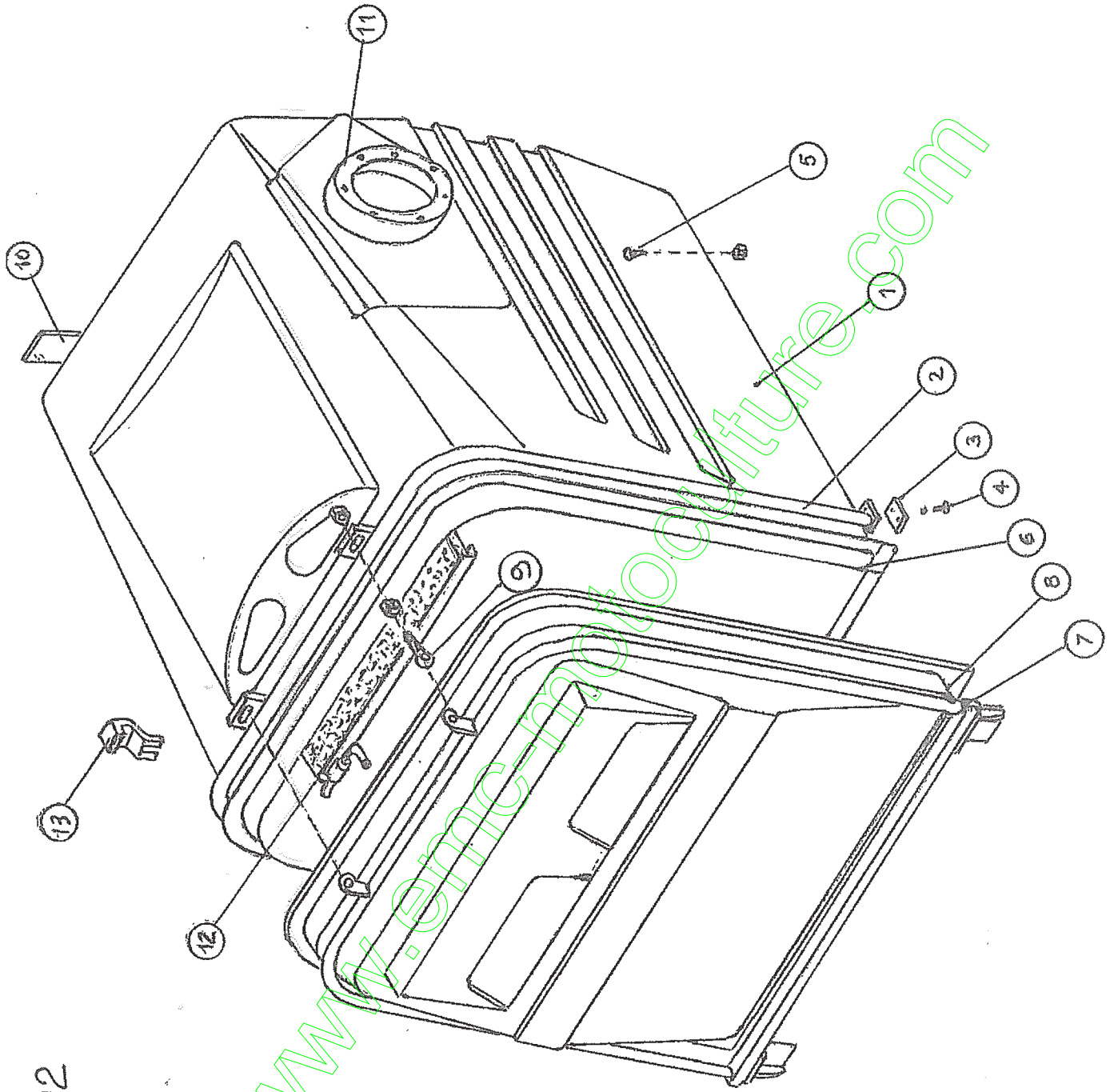

SF315-V610.20.00

date : 04/03/02

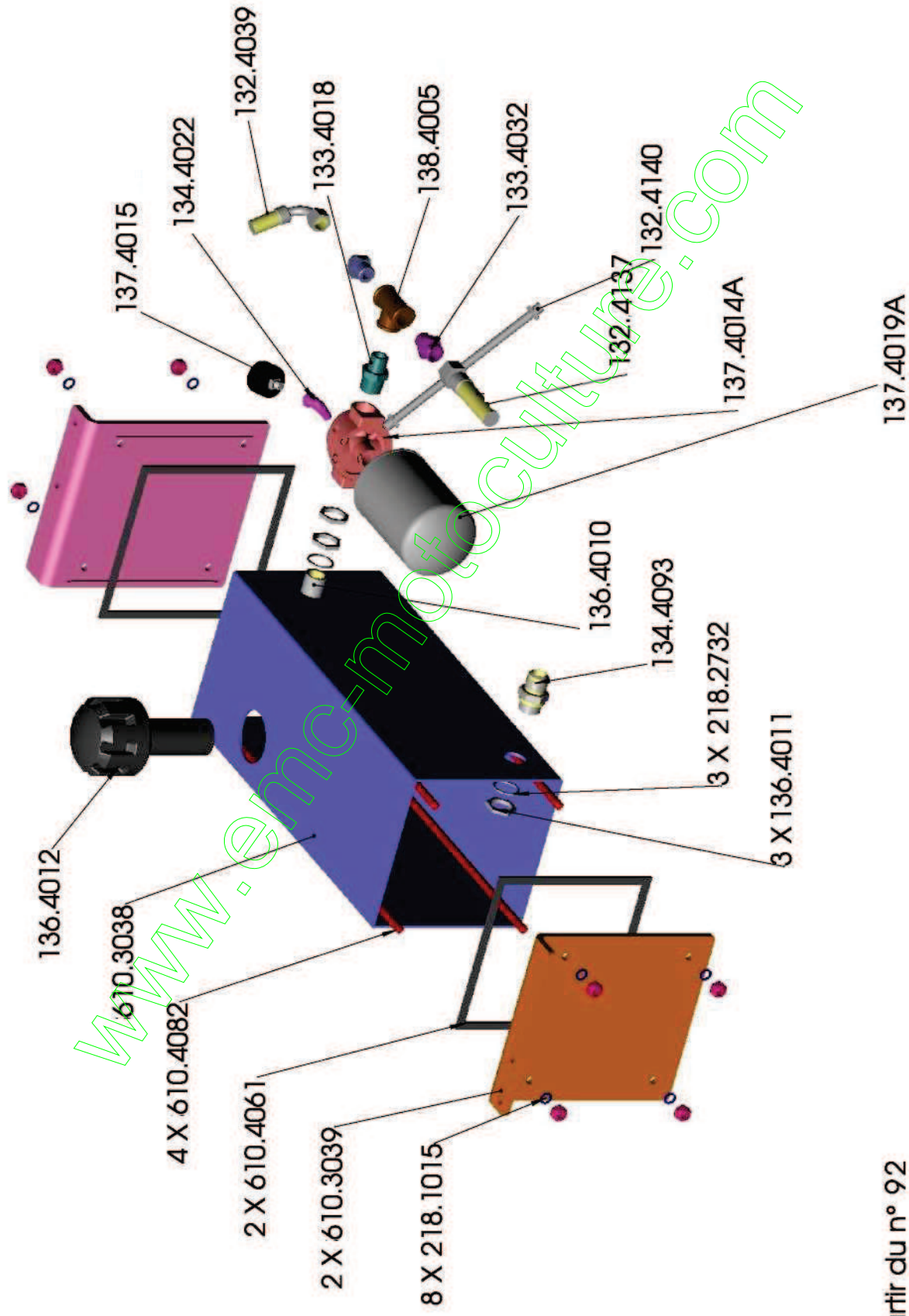

A partir du n° 92

Date : 11/06/02

SF315-V610.20.01-

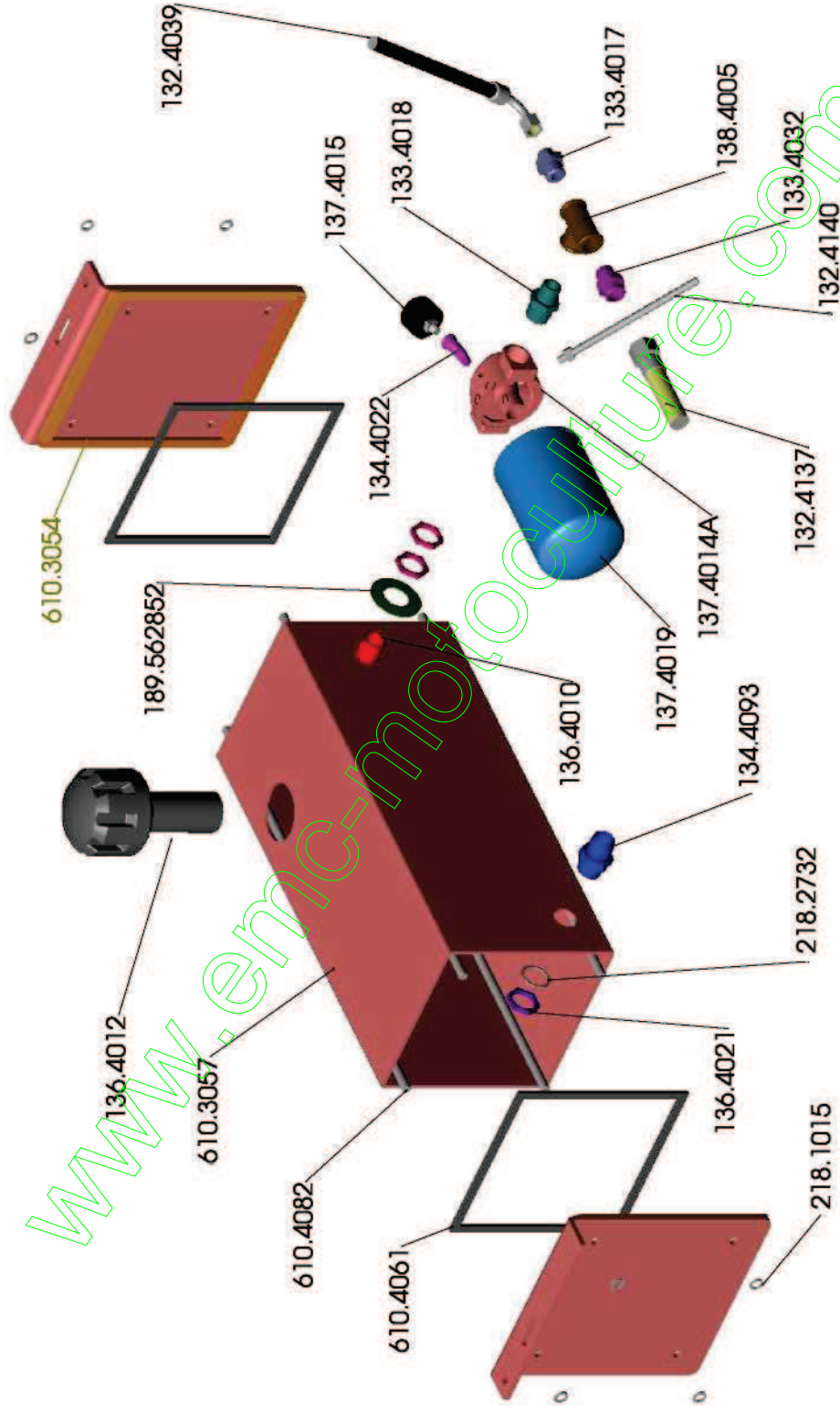

A partir du n° 217

SF315 -V610.20.02-

Date : 15/04/03

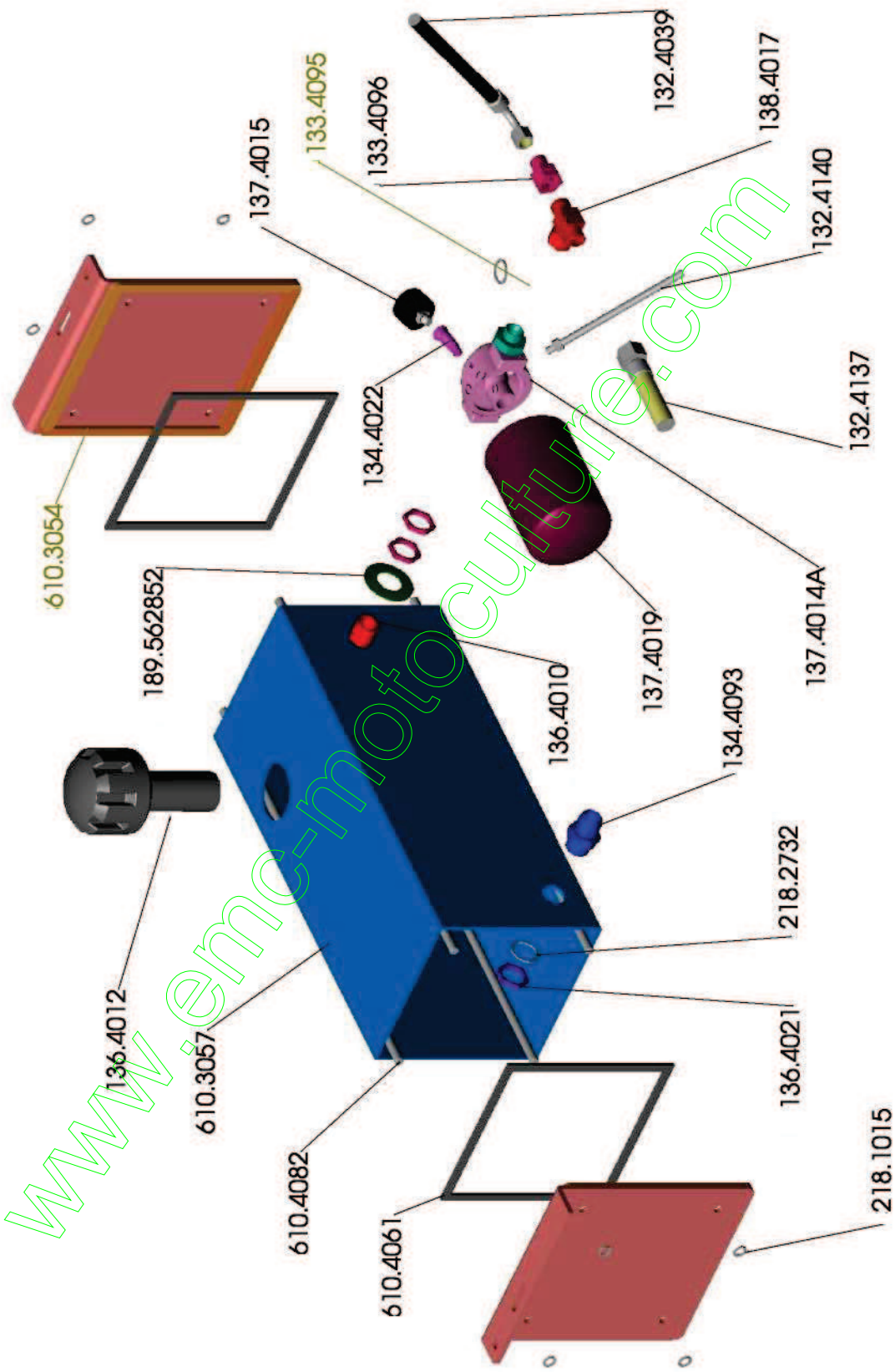

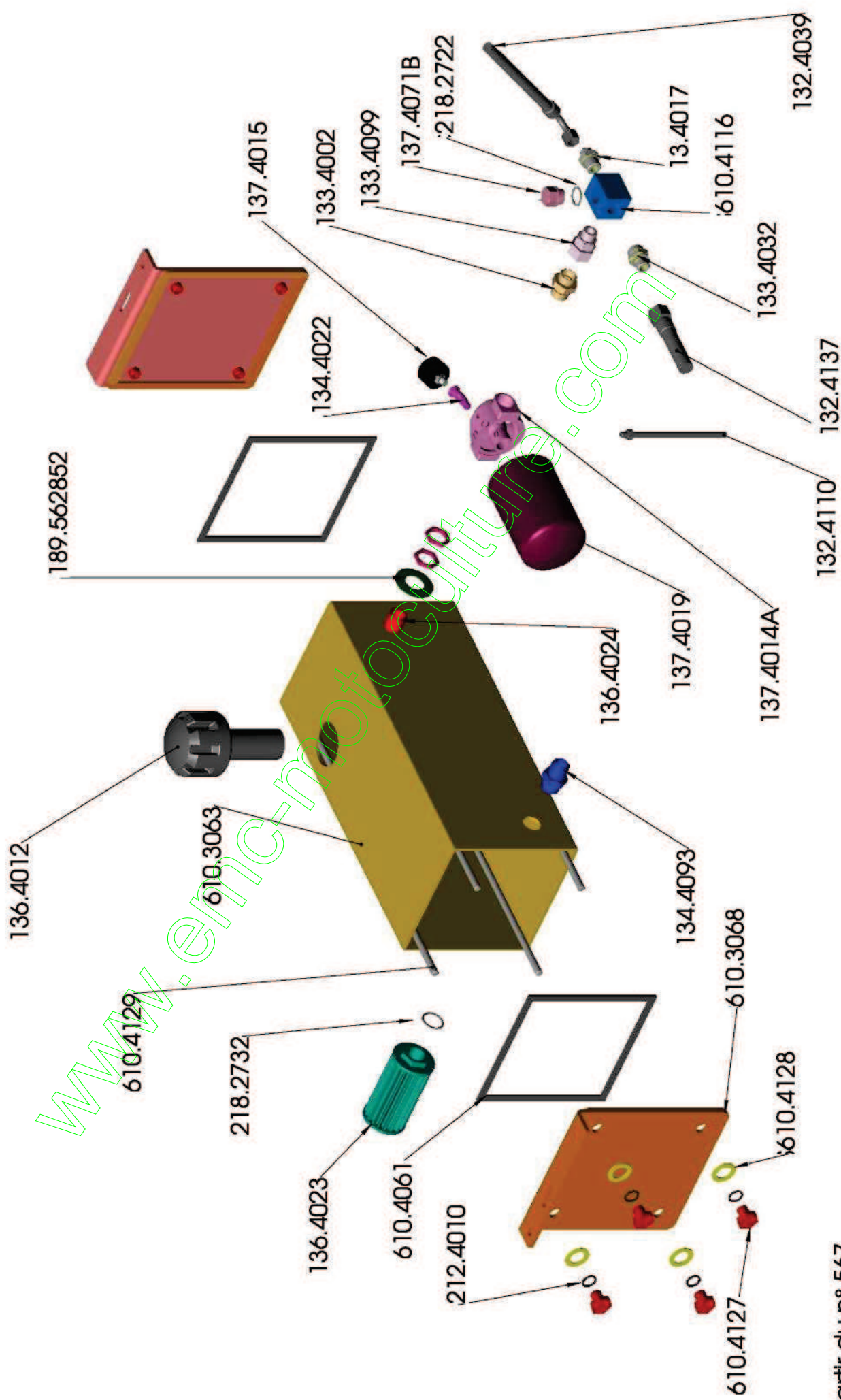

SF315-V610.21.00

date : 05/03/02

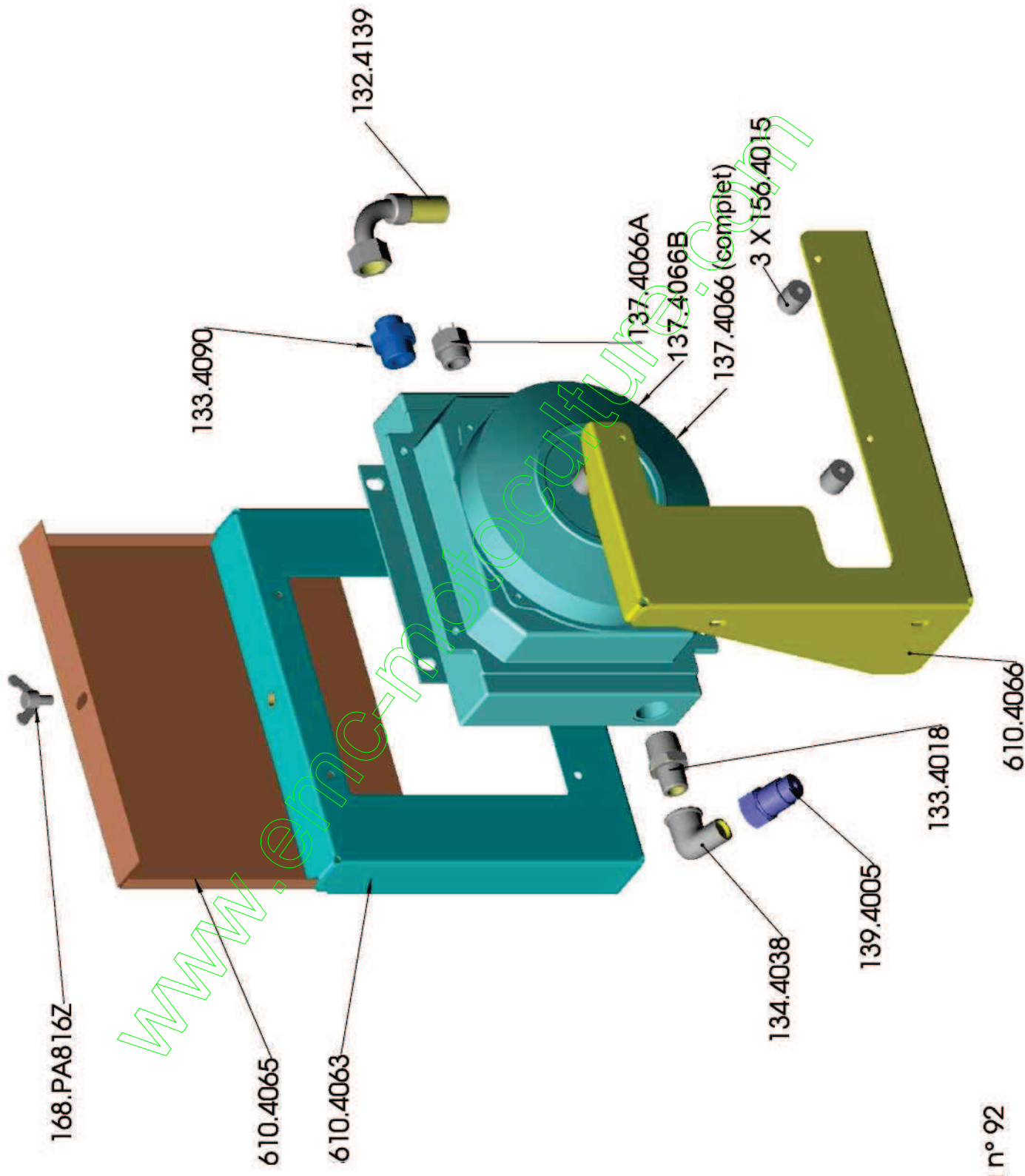

A partir du n° 92

SF315-V610.21.01

Date : 11/06/02

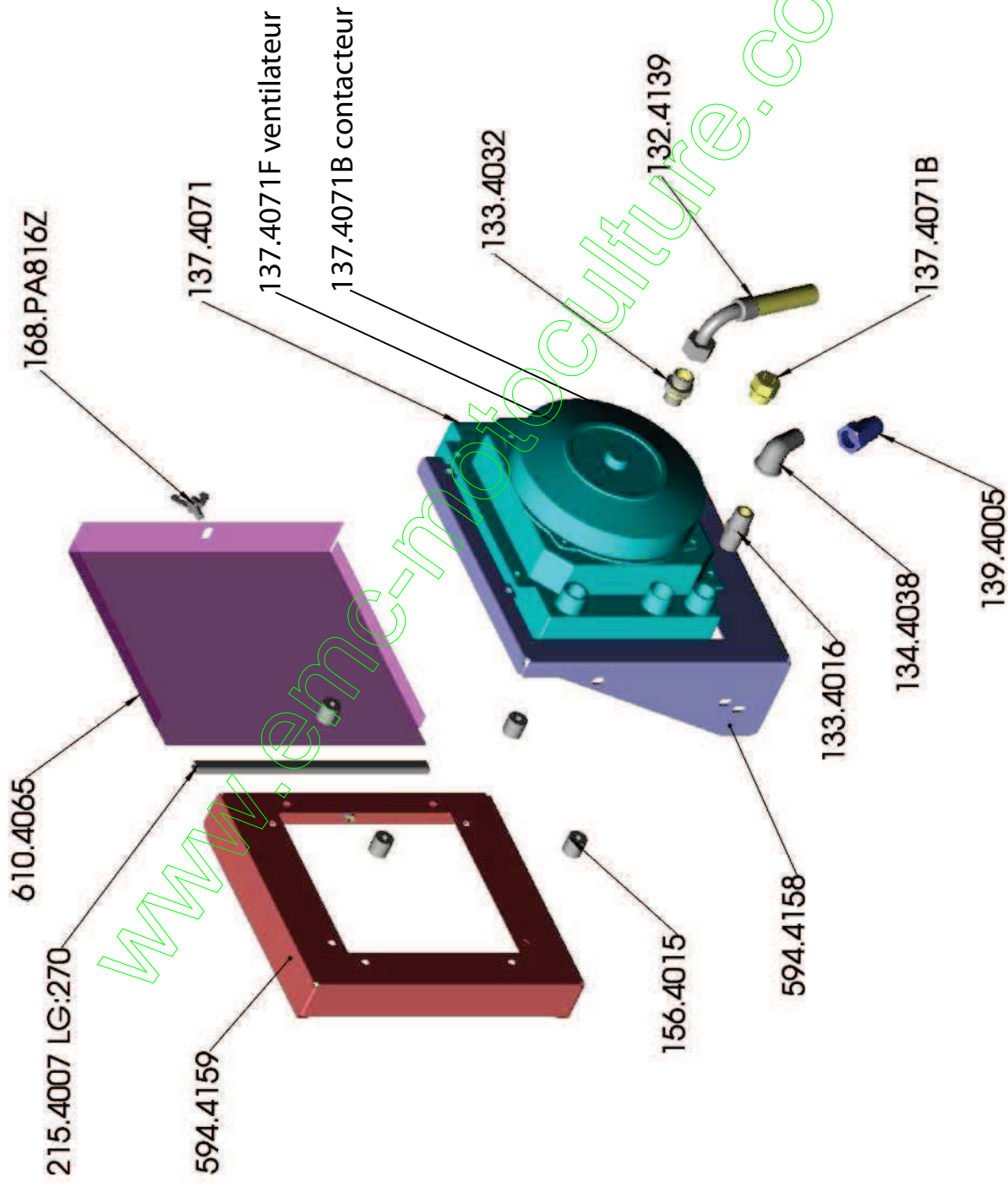

SF315-V610.21.02

Date : 04/09/03

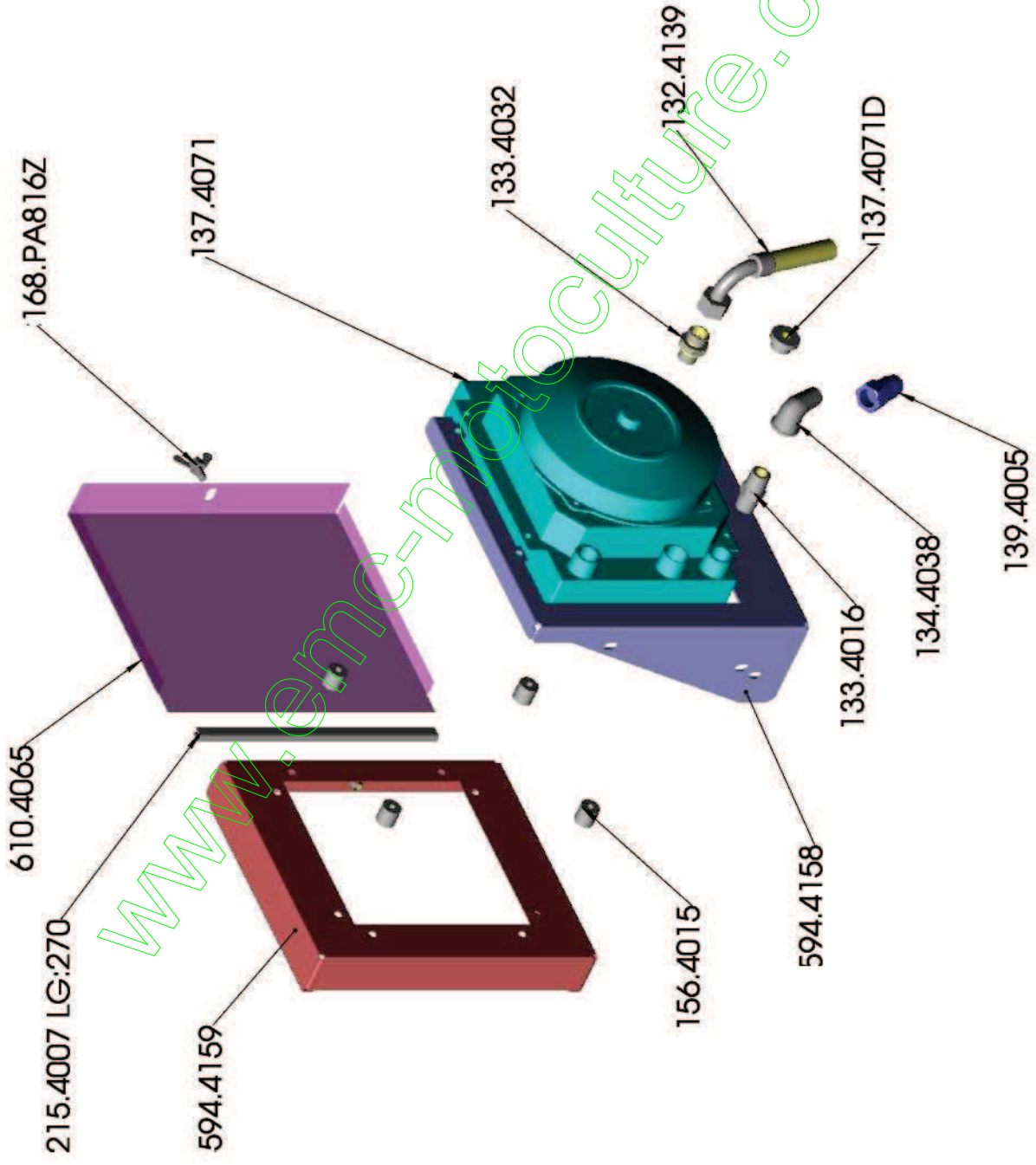

SF315-V610.21.03

Date : 29/07/04

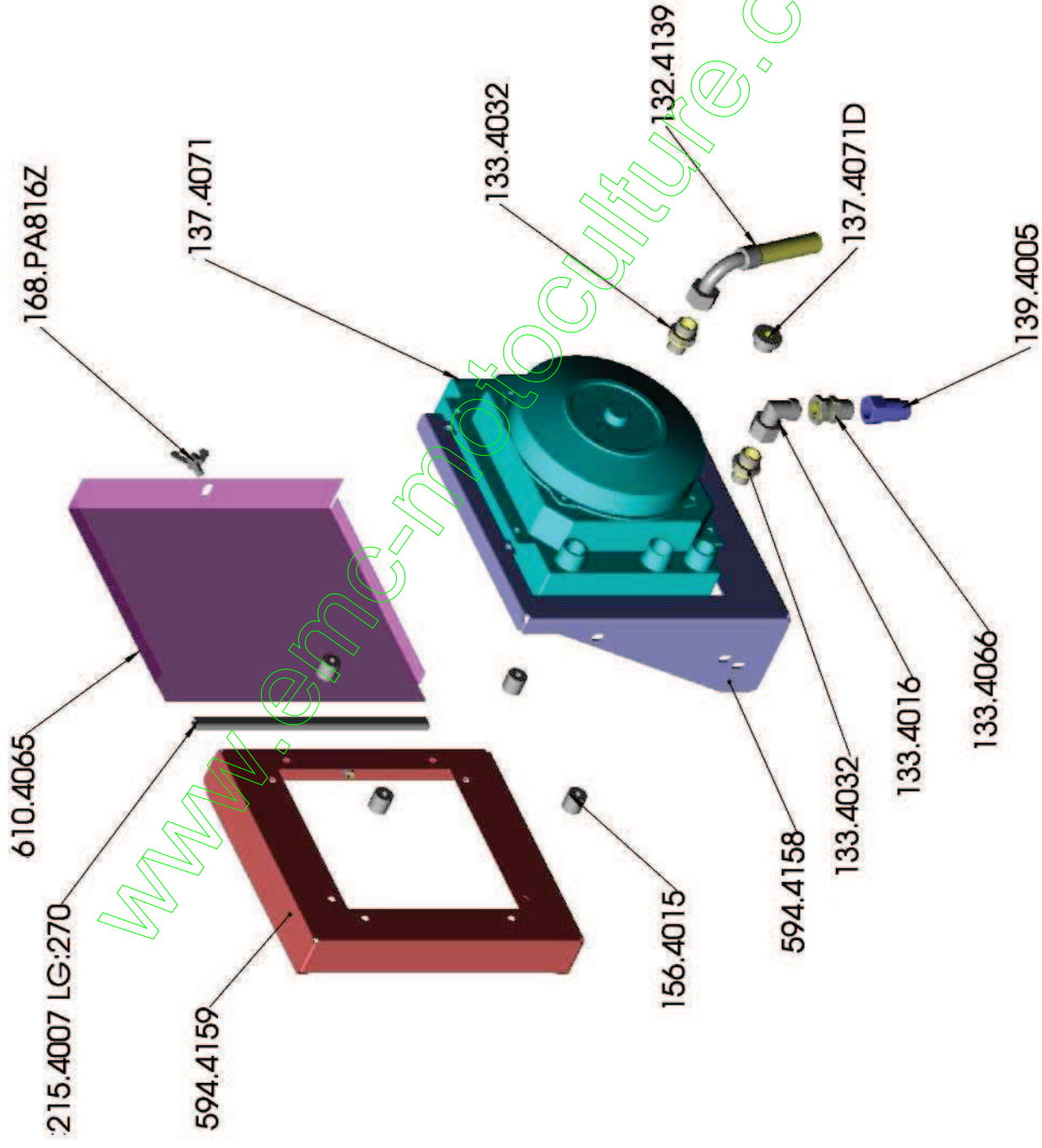

A partir du n° 547

SF315 -V610.22.00

date : 04/03/02

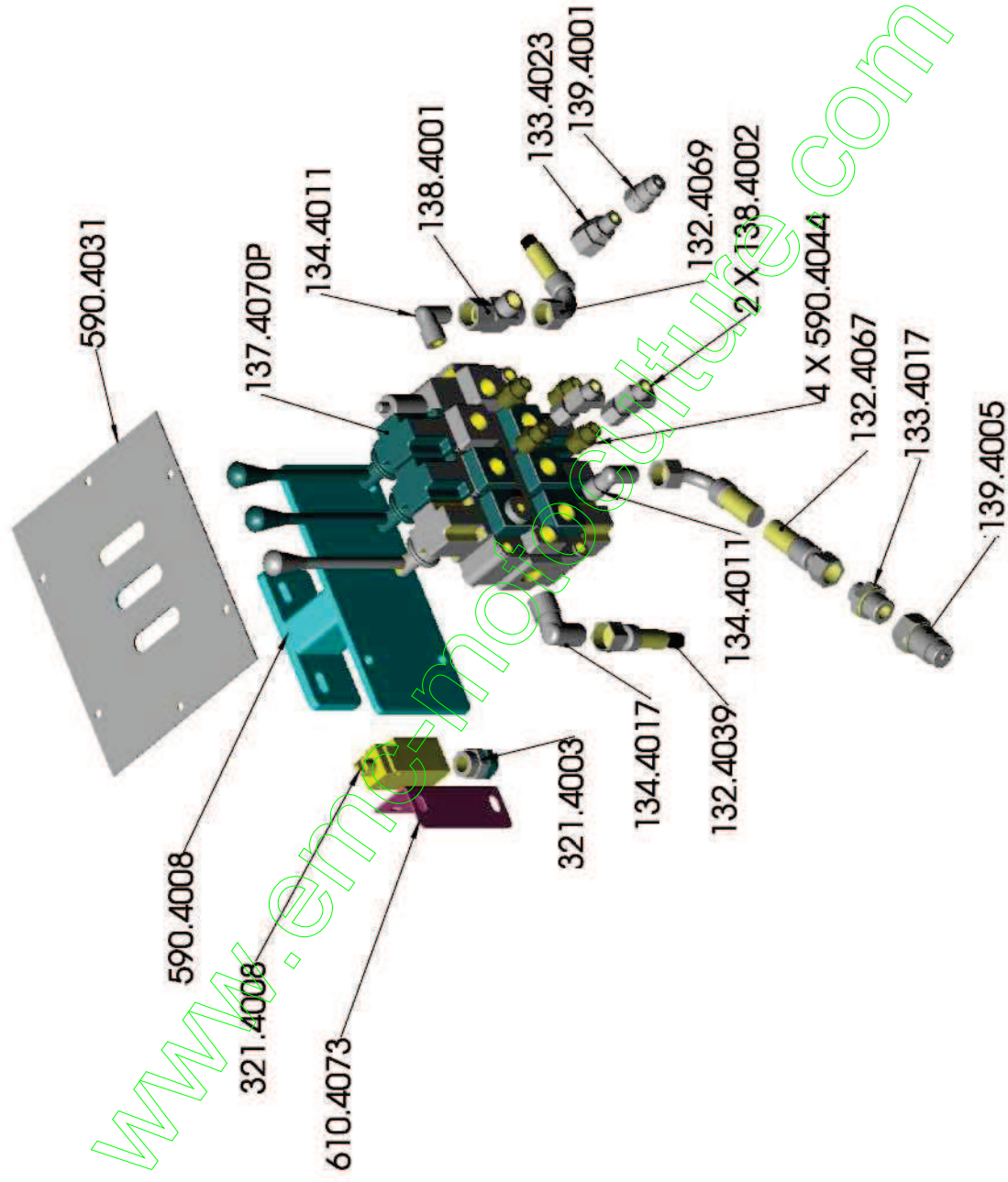

A partir du n° 92

SF315 -V610.22.01

date : 29/07/042

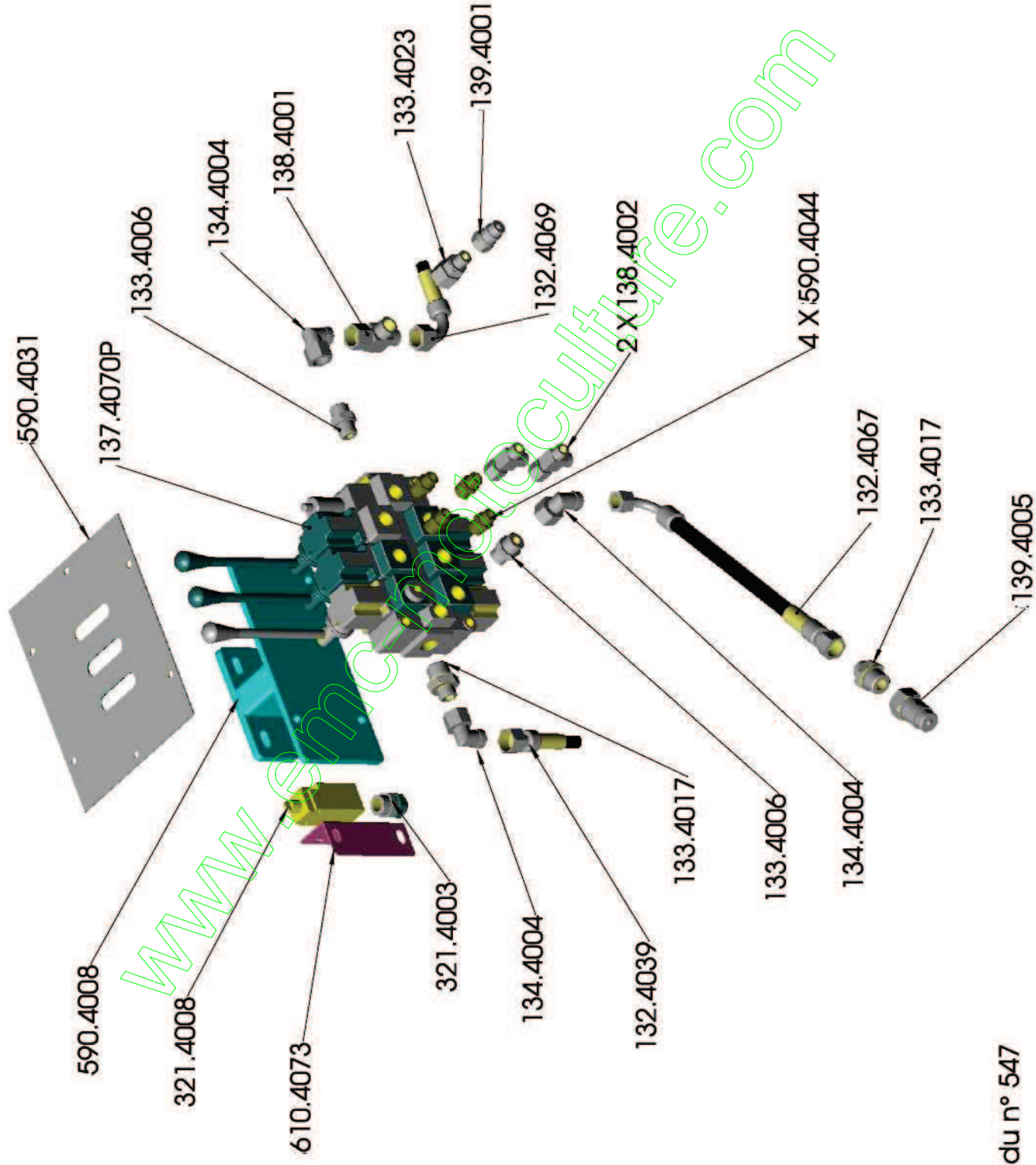

A partir du n° 547

SF315-V610.23.00

date : 10/04/02

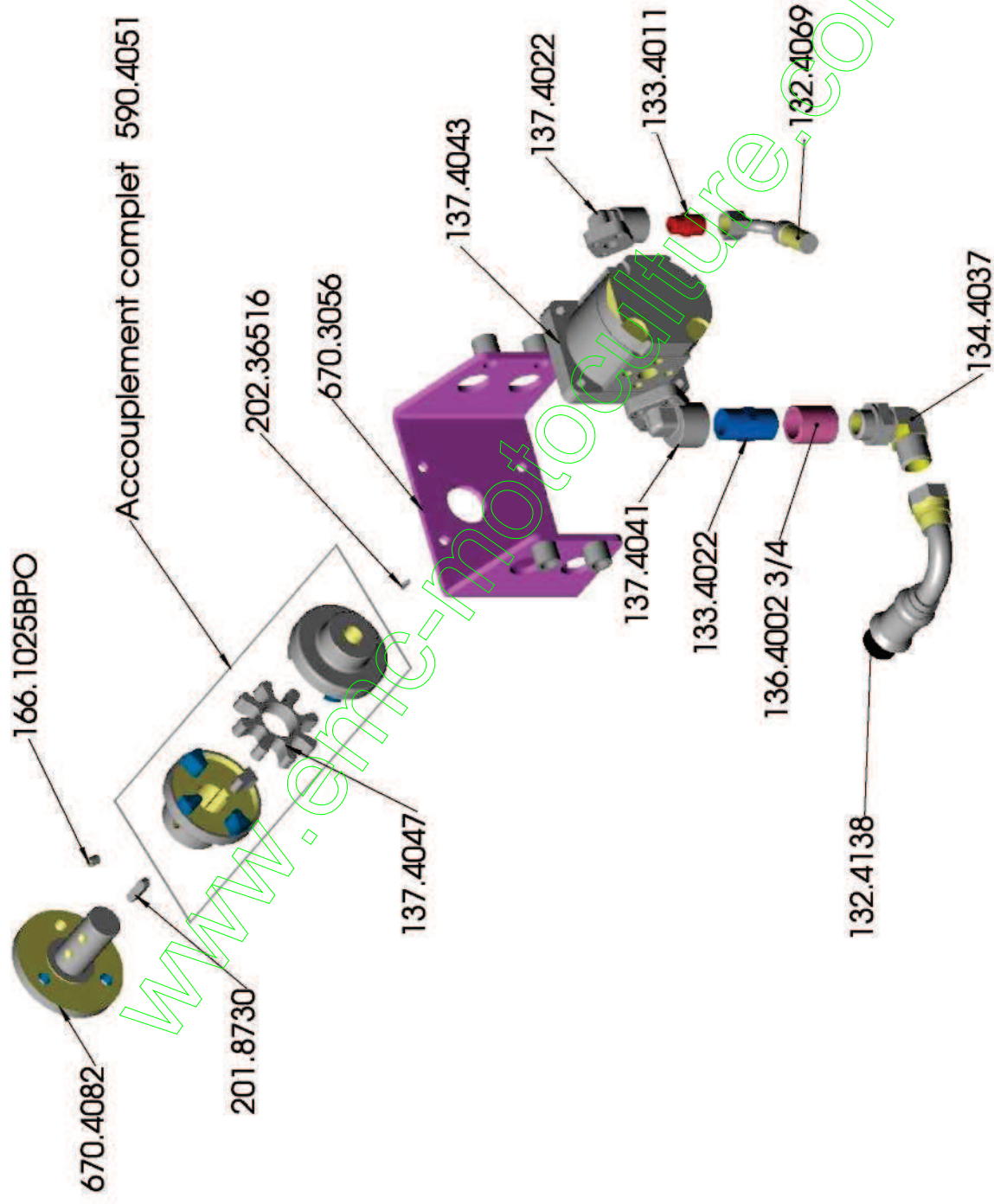

SF315-V610.23.01

date : 29/07/04

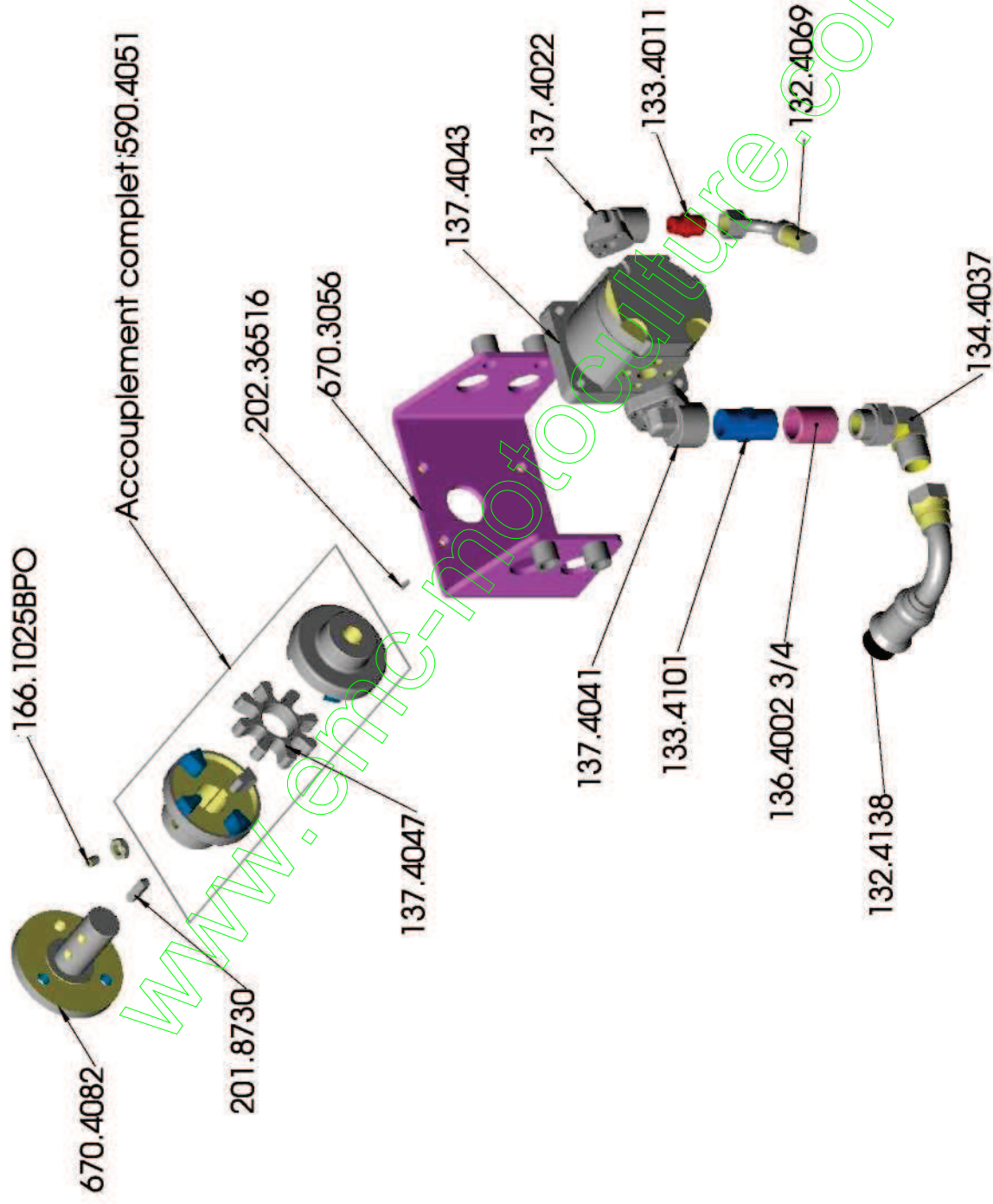

A partir du n° 547

SF315-V610.24.00

date : 04/03/02

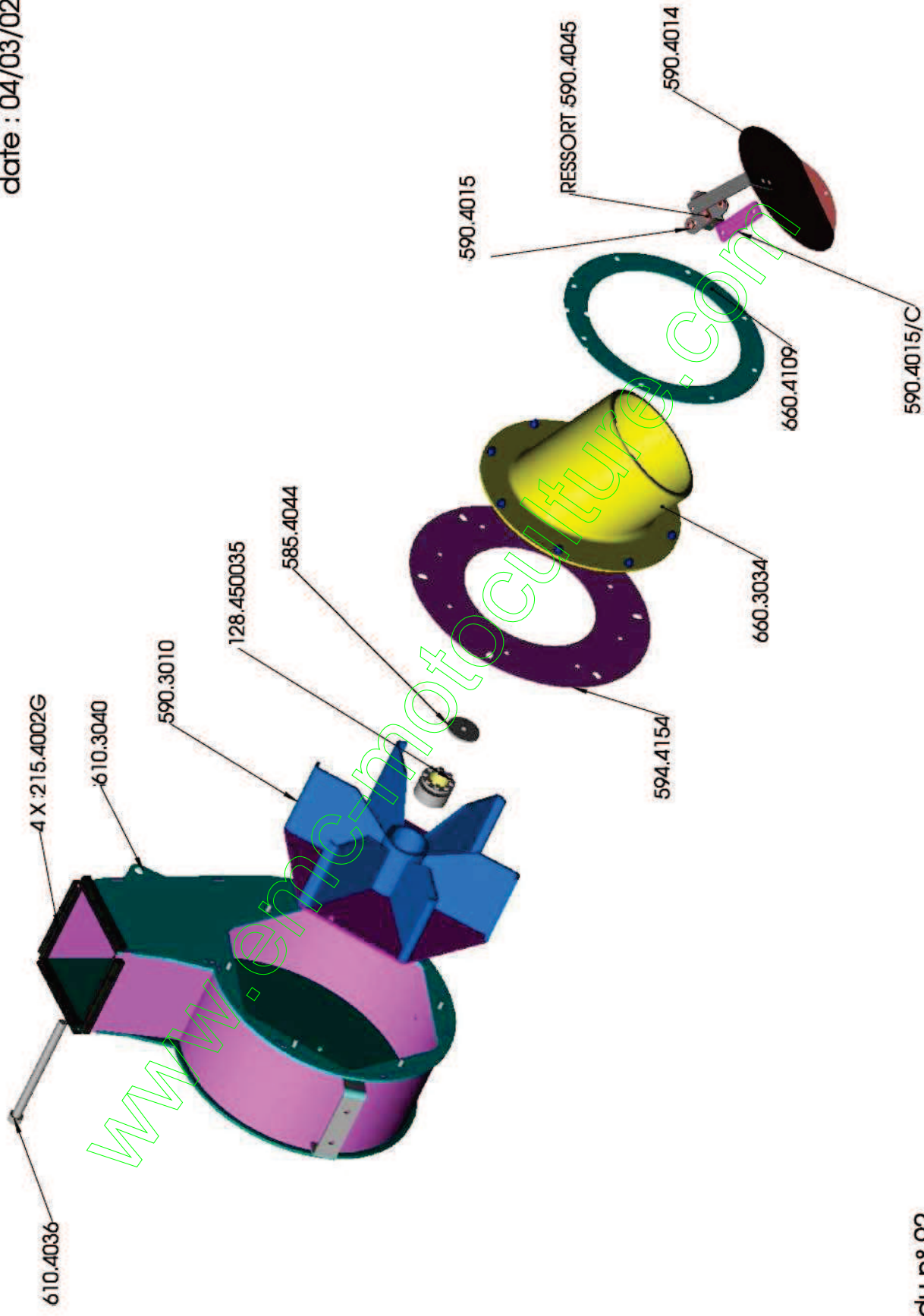

A partir du n° 92

SF315-V610.24.01

date : 11/06/02

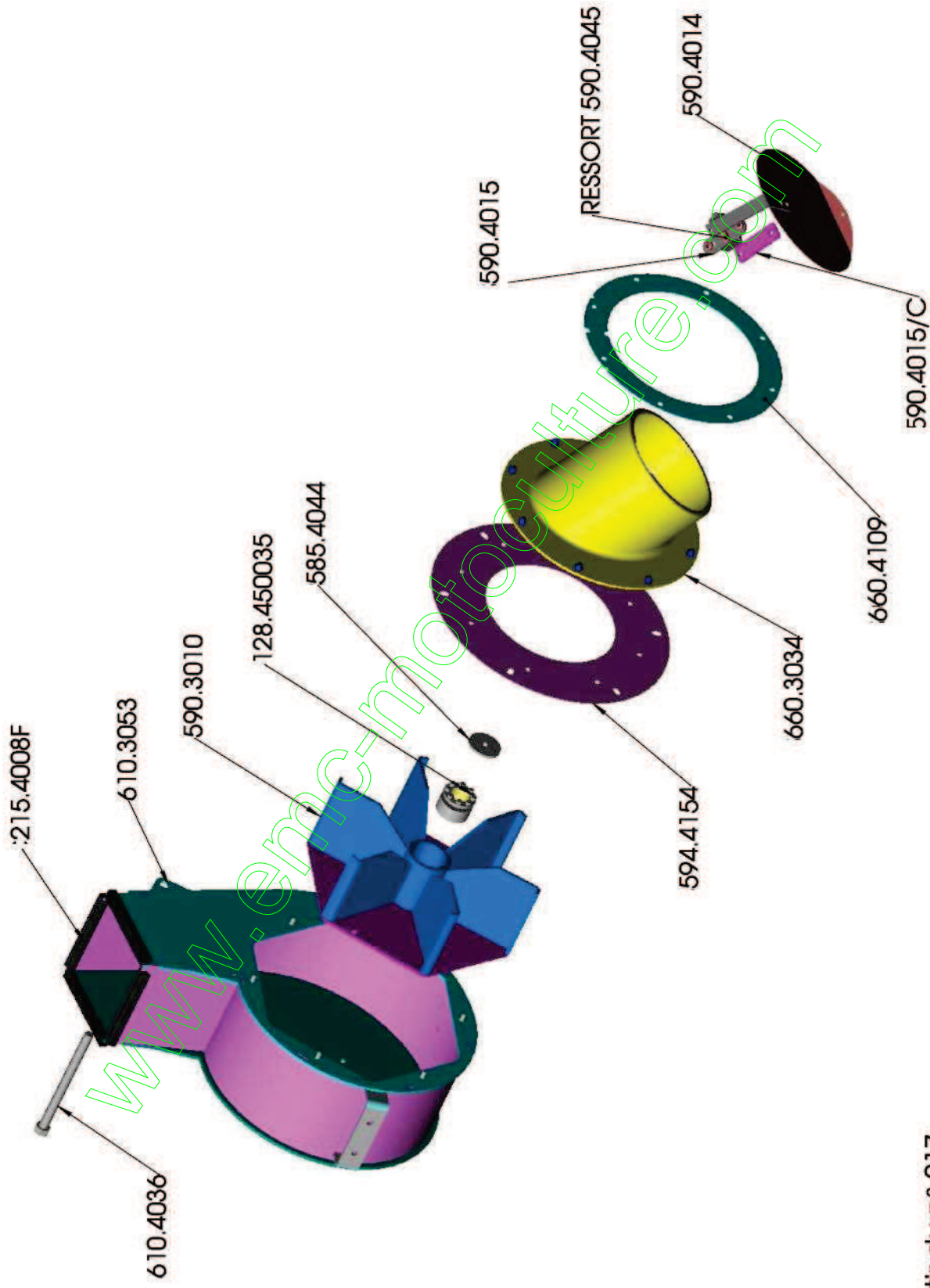

A partir du n° 217

SF315-V610.24.02

date : 03/09/03

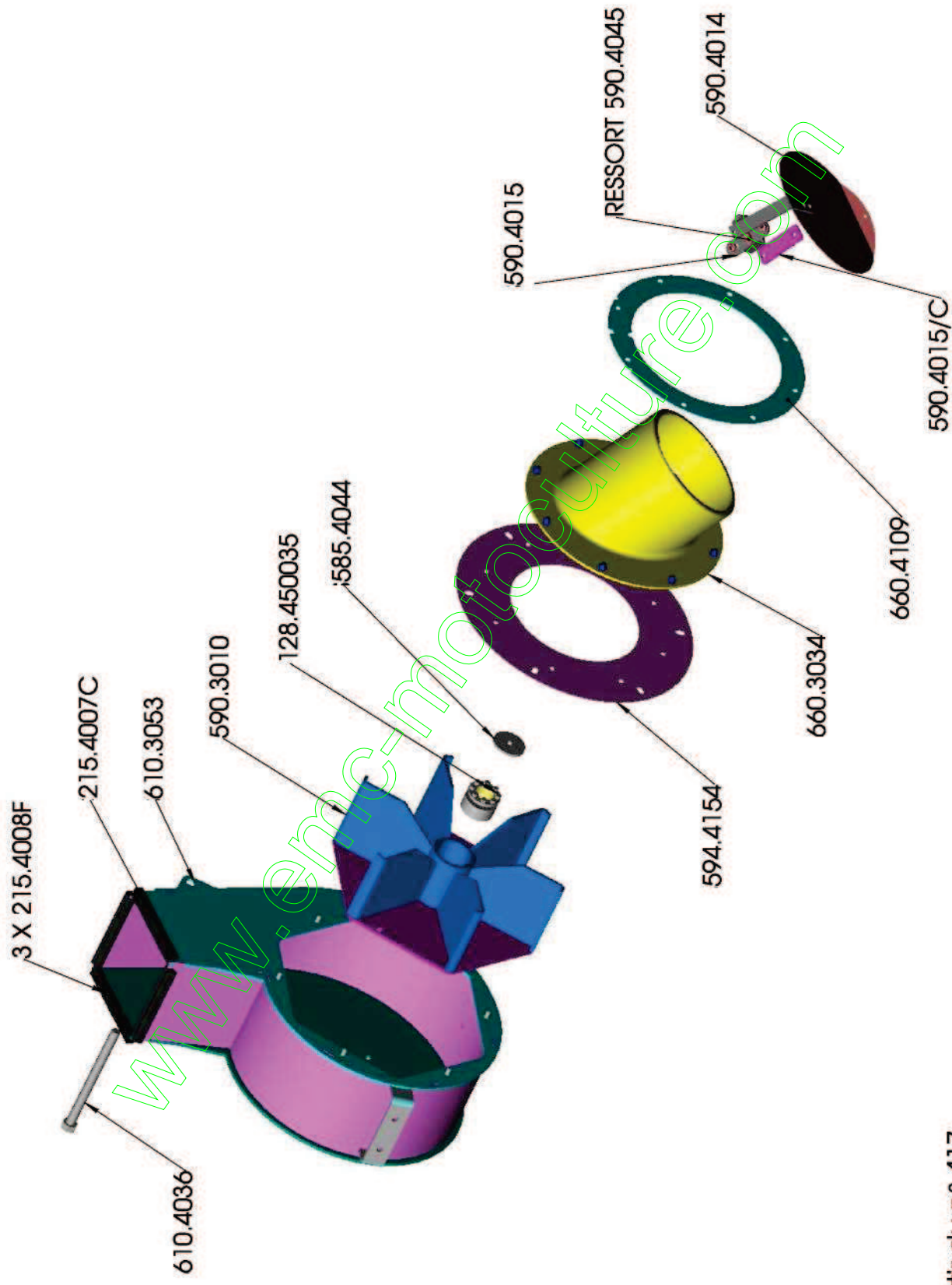

A partir du n° 417

SF315-V610.24.03

date : 29/05/06

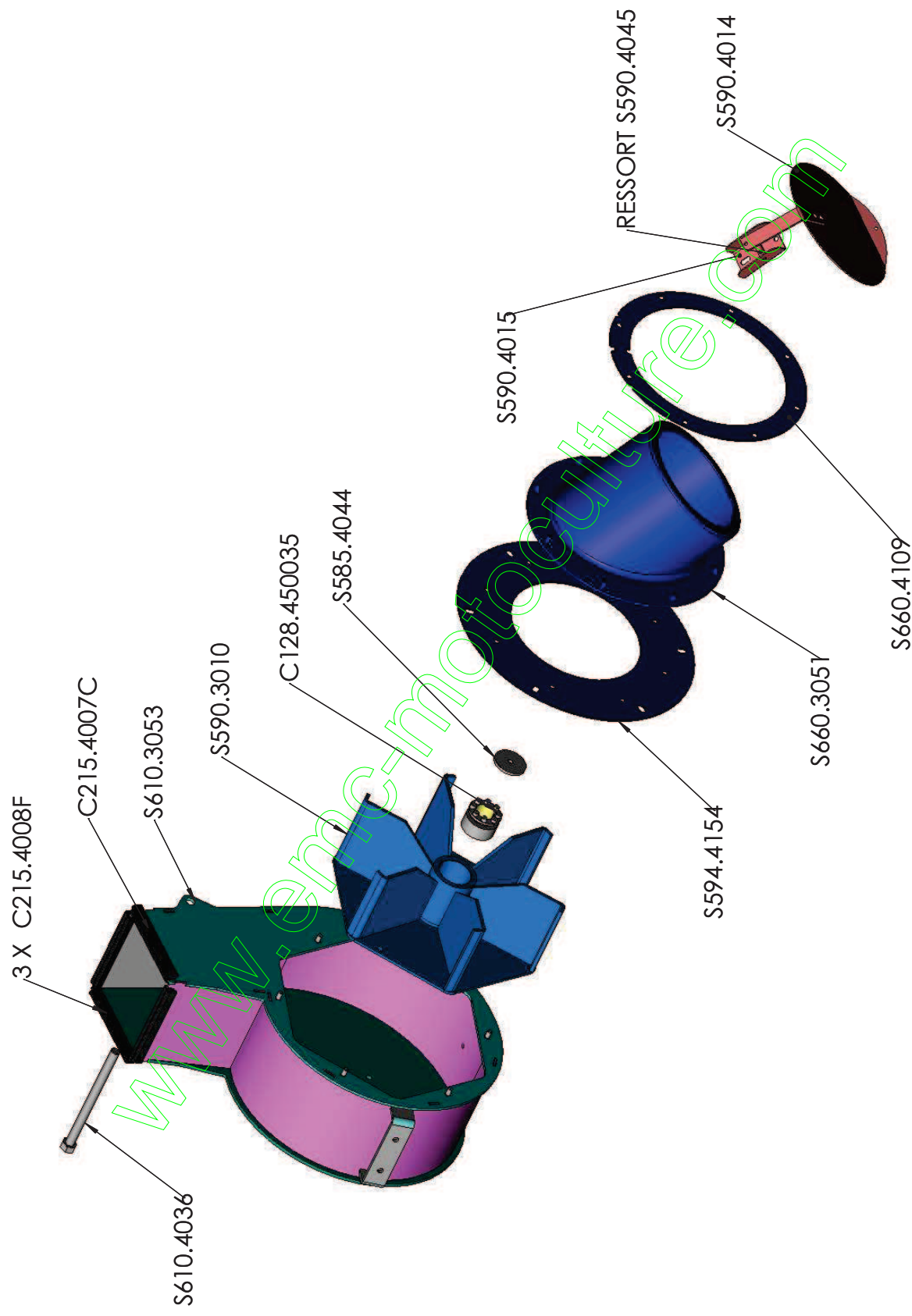

A partir du n° 827



SF315-V610.25.00-

Date : 11/06/02

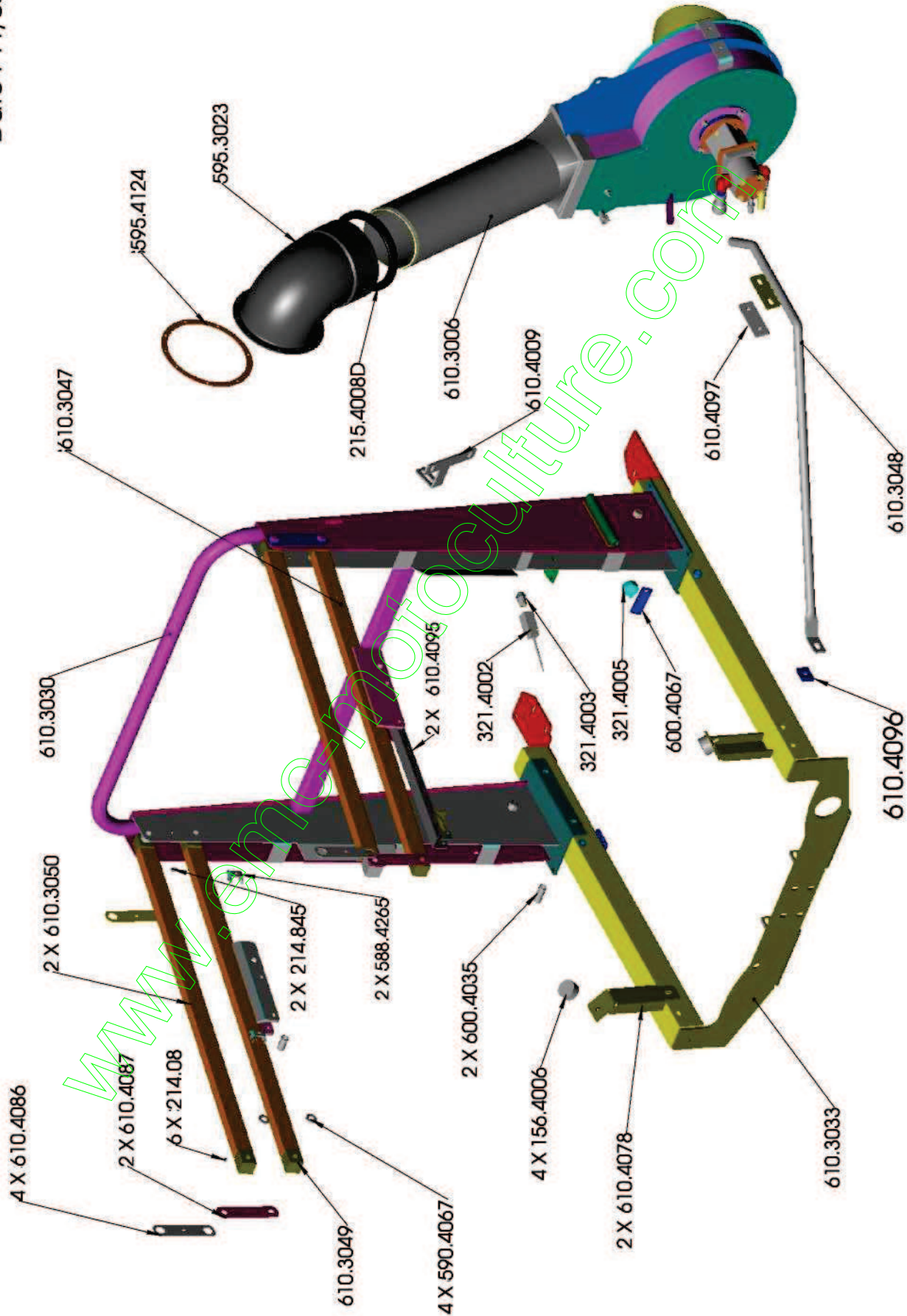

A partir du n° 92

SF315-V610.25.01-

Date : 11/06/02

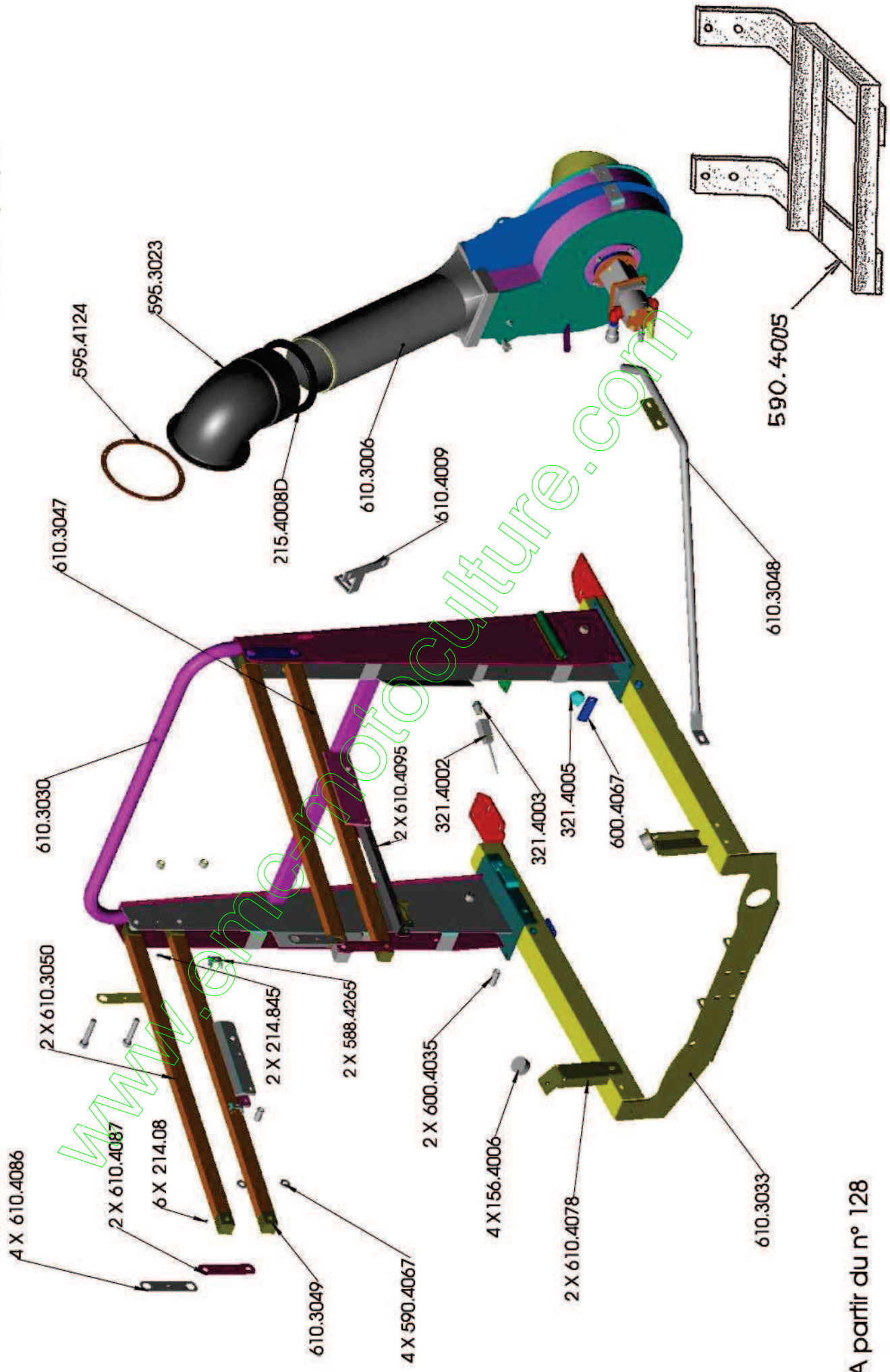

SF315-V610.25.02-

Date : 10/07/02

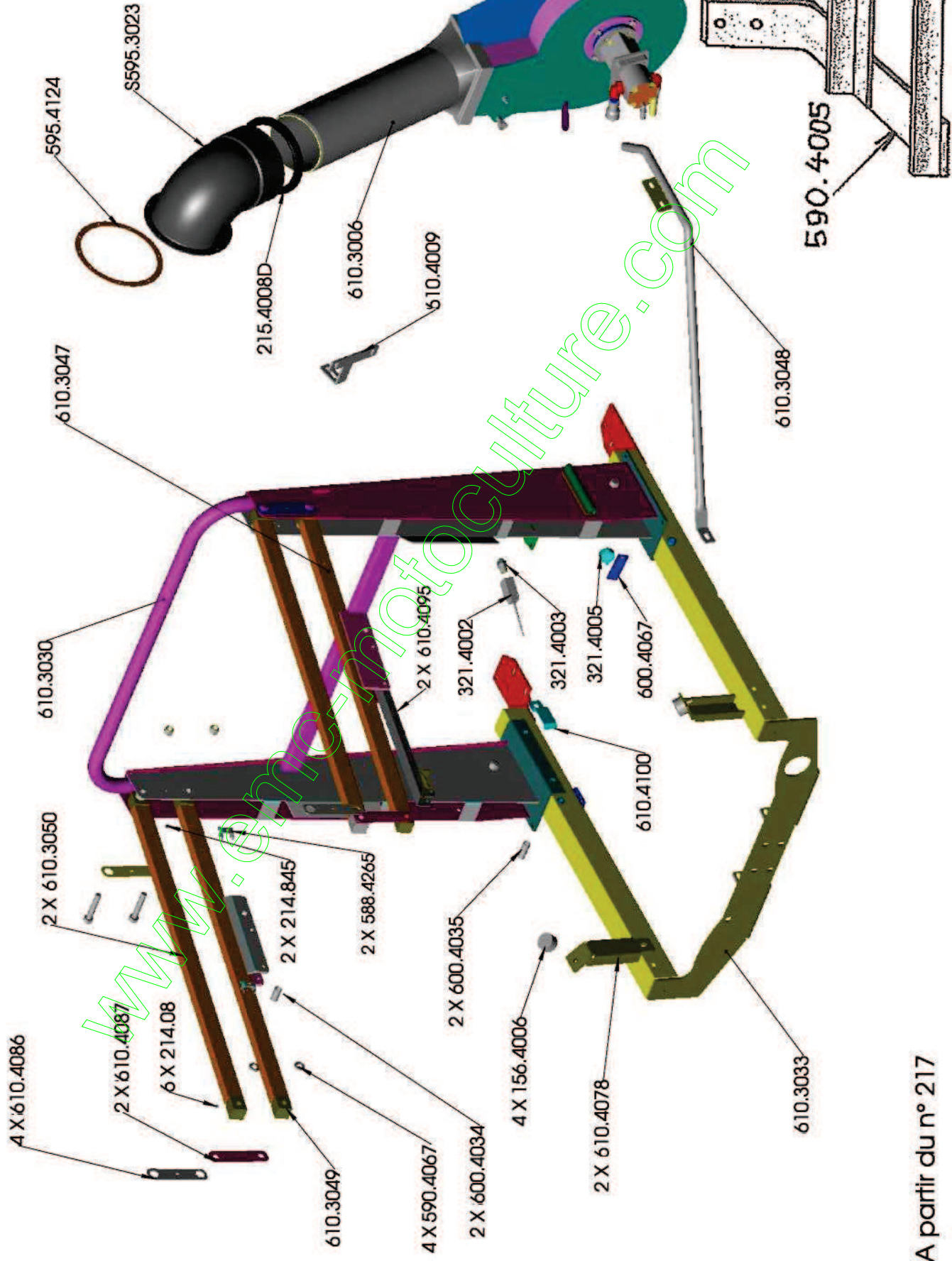

A partir du n° 217

SF315- V610.26.00

date : 05/03/02

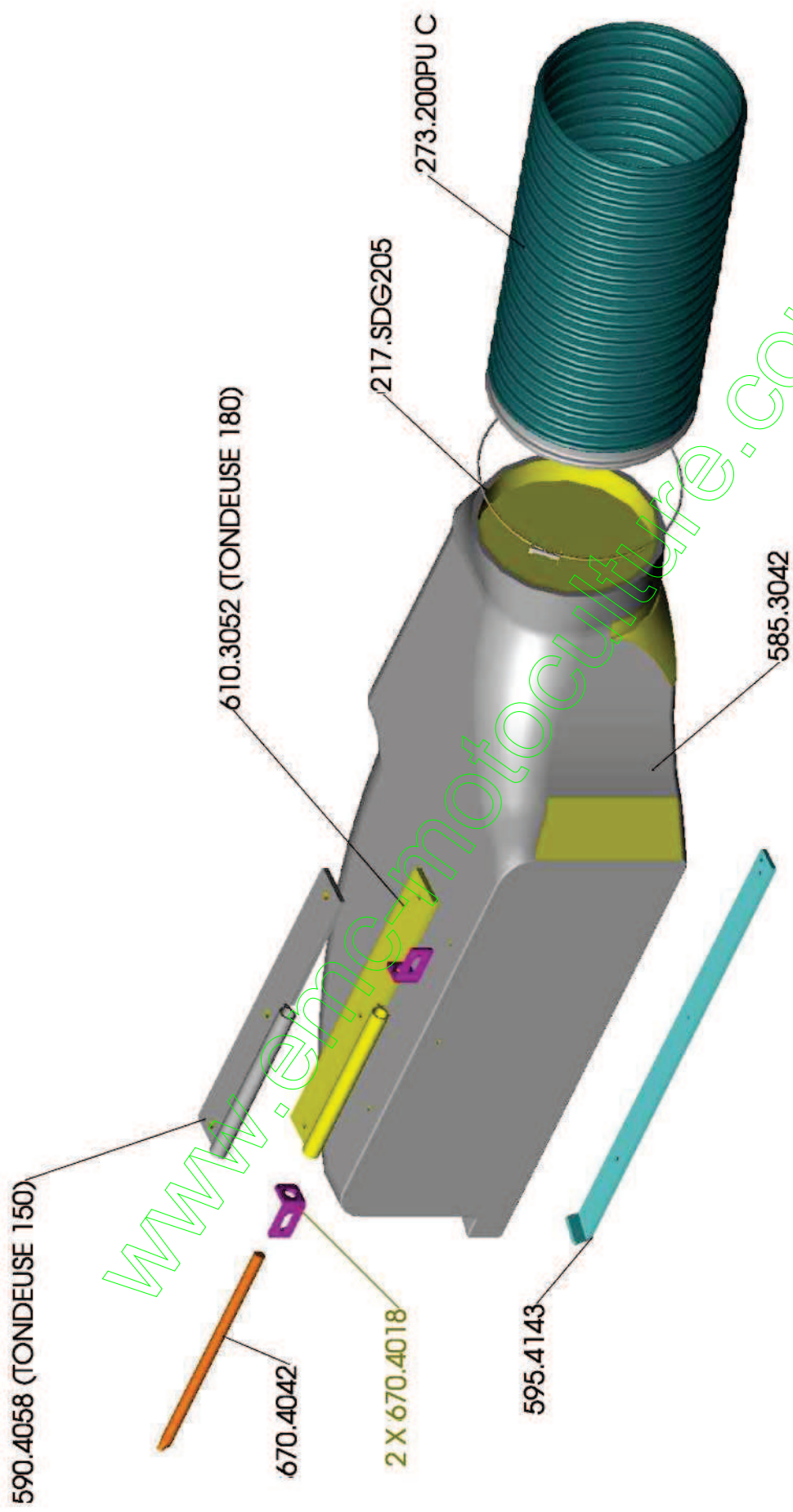

SF315- V610.26.01

date : 20/03/06

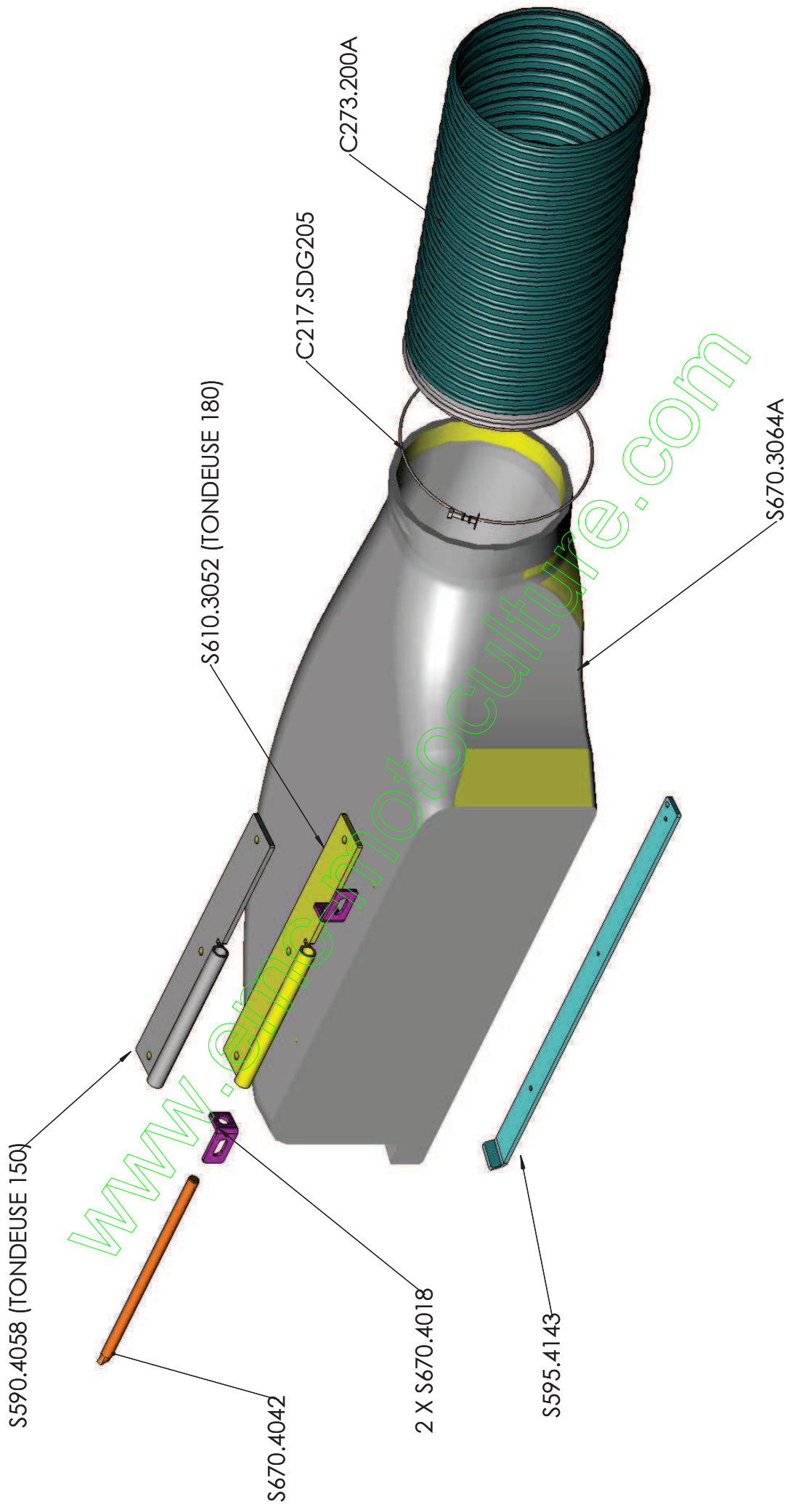

SF315- V610.27.00

date : 04/03/02

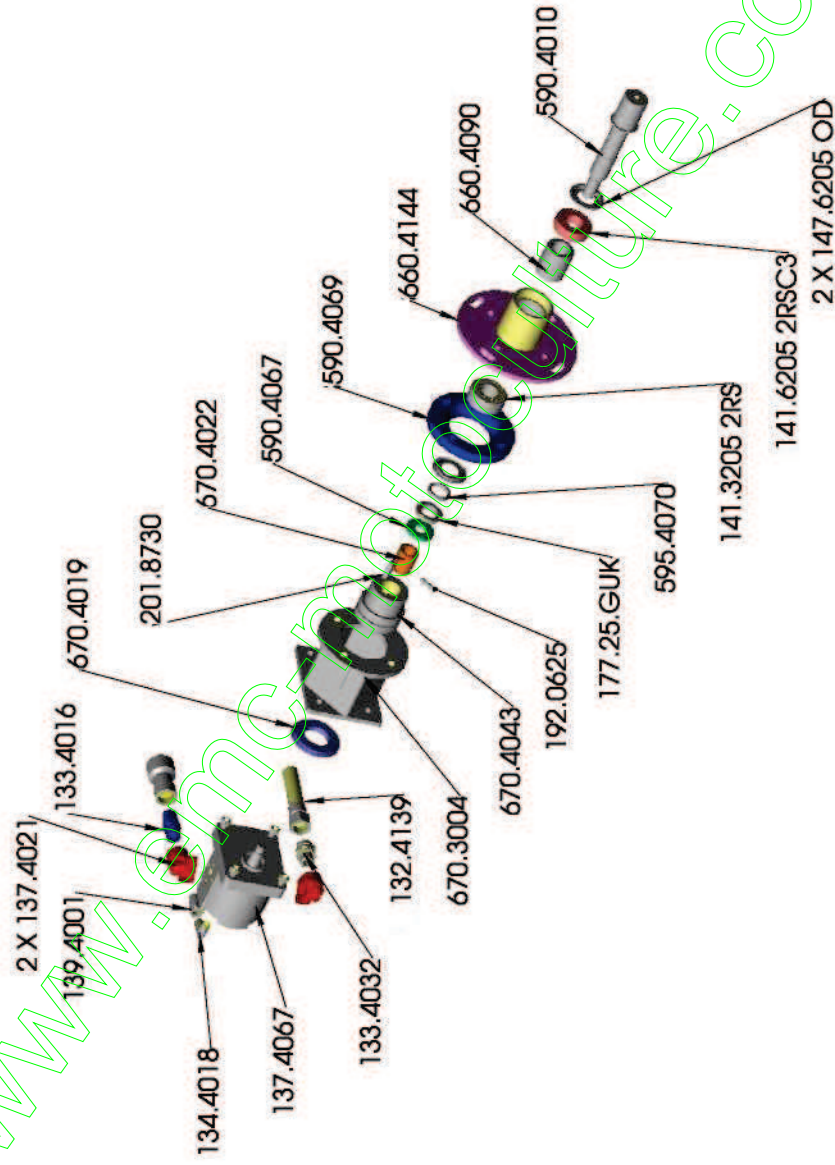

A partir du n° 92

Pochette joints moteur

Lamborghini : 137.4067A

Galteih : 137.4067B

Unidro : 137.4067C

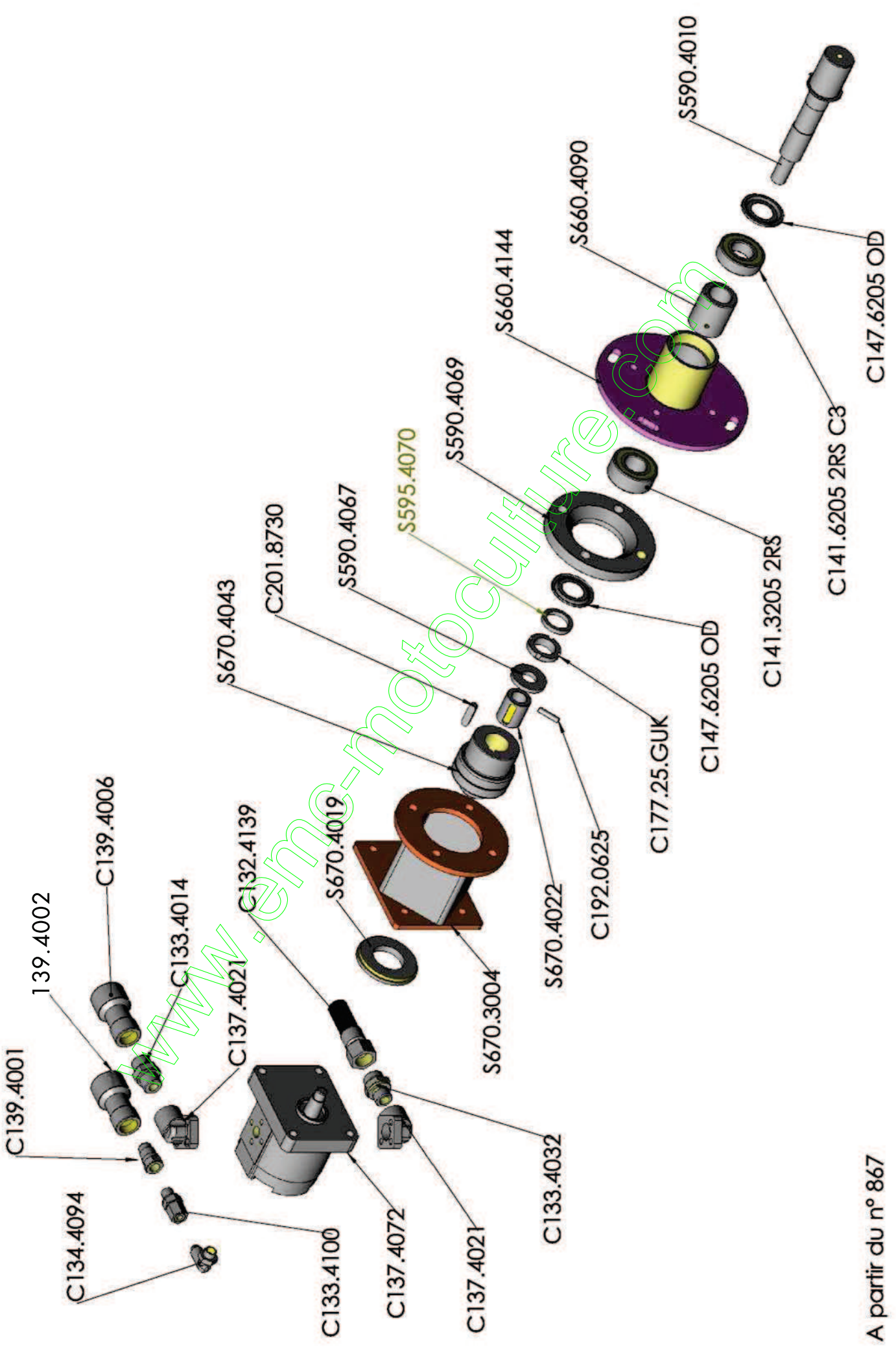

SF315-V610.28.00

date : 04/03/02

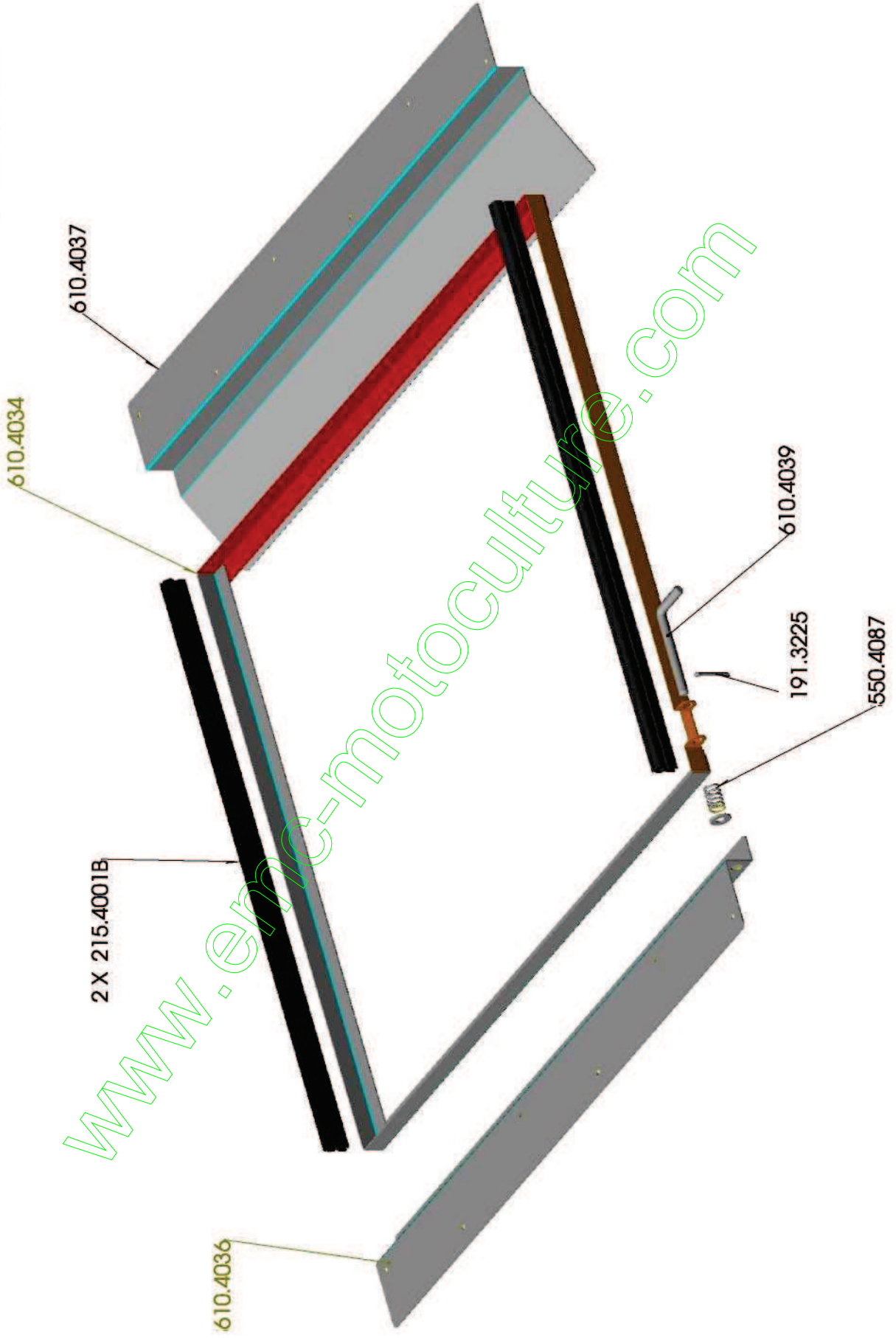

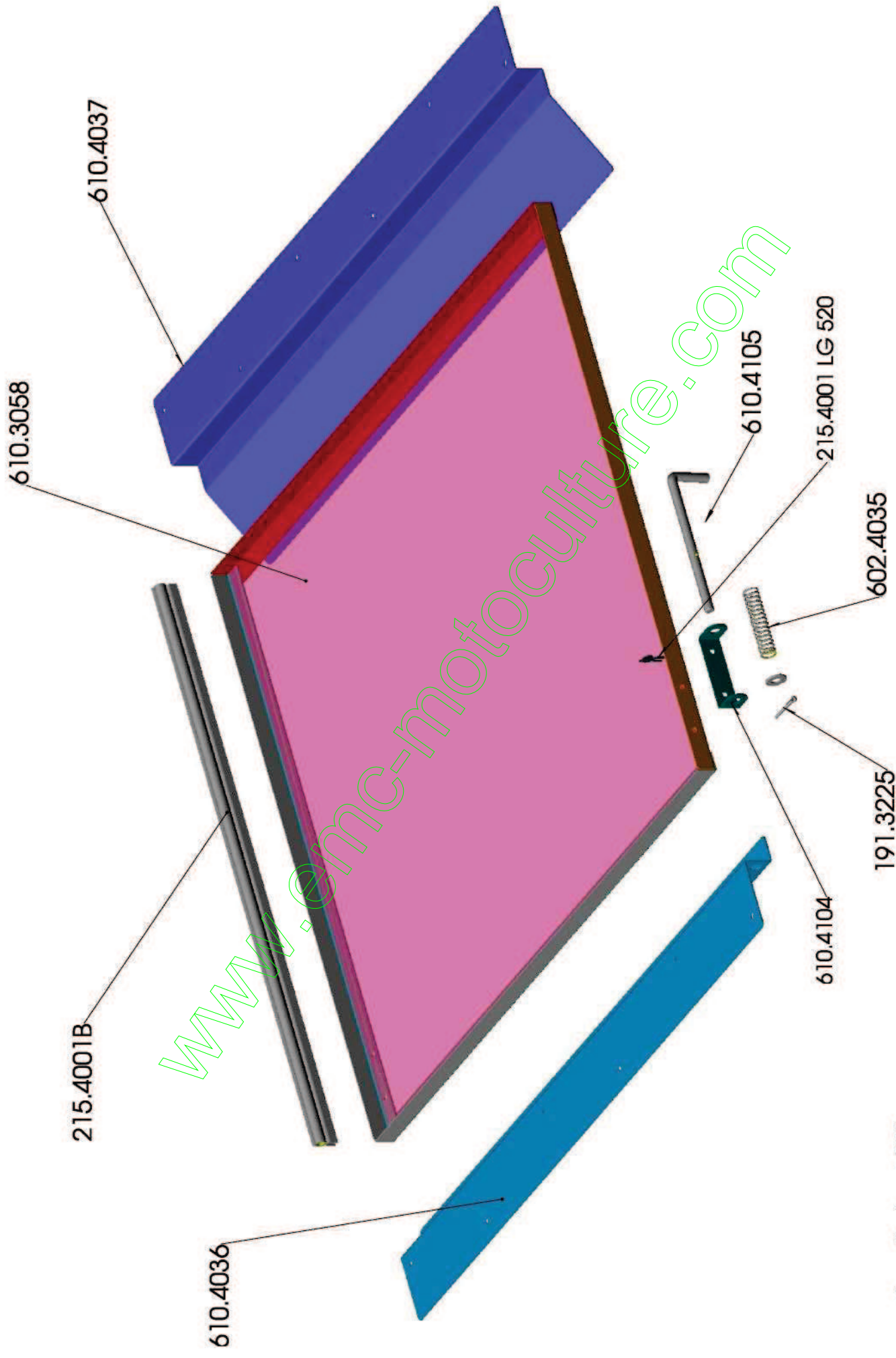

SF315 V610.29.00

date : 04/03/02

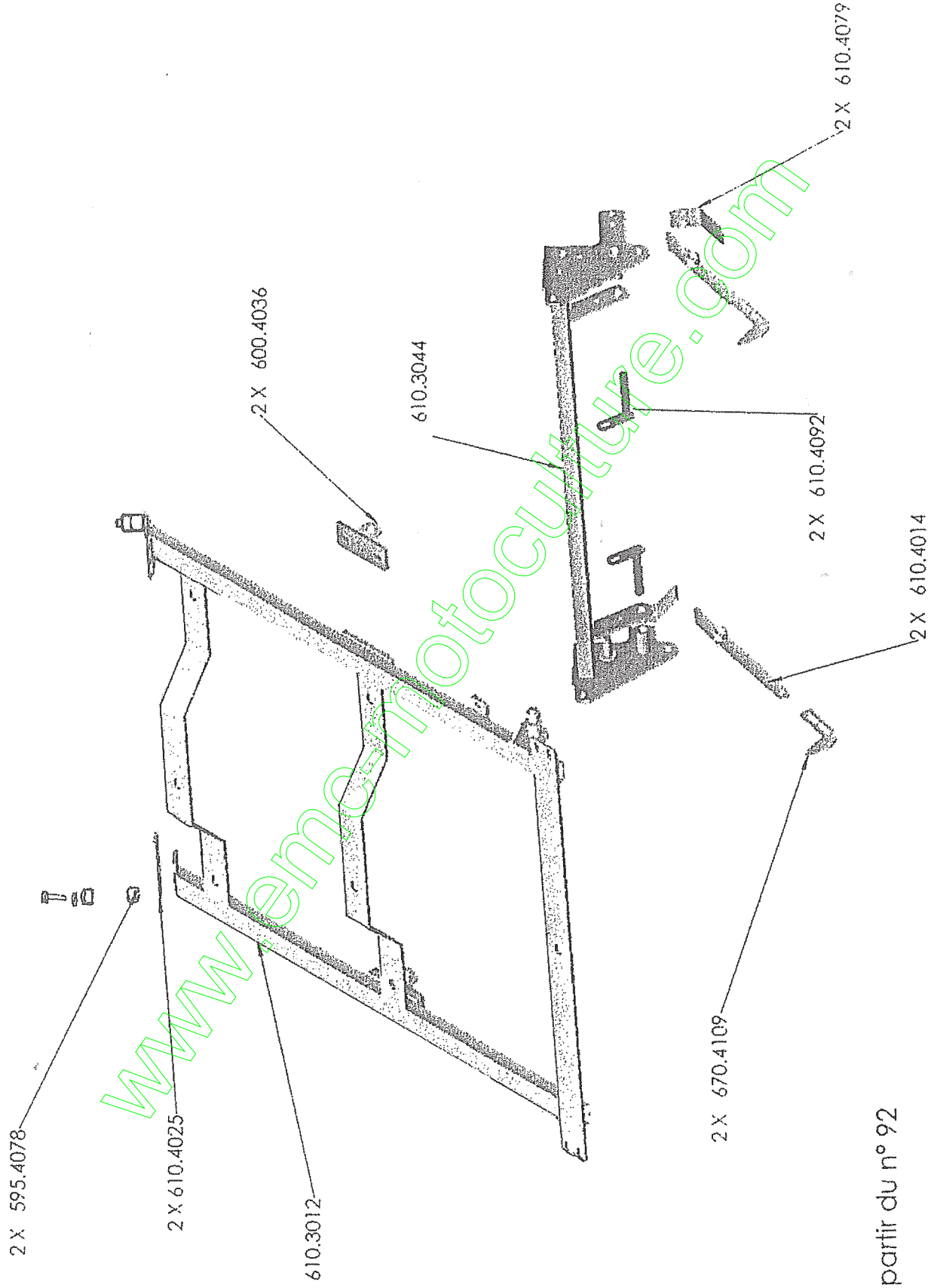

A partir du n° 92

SF315 V610.29.01

date : 04/03/02

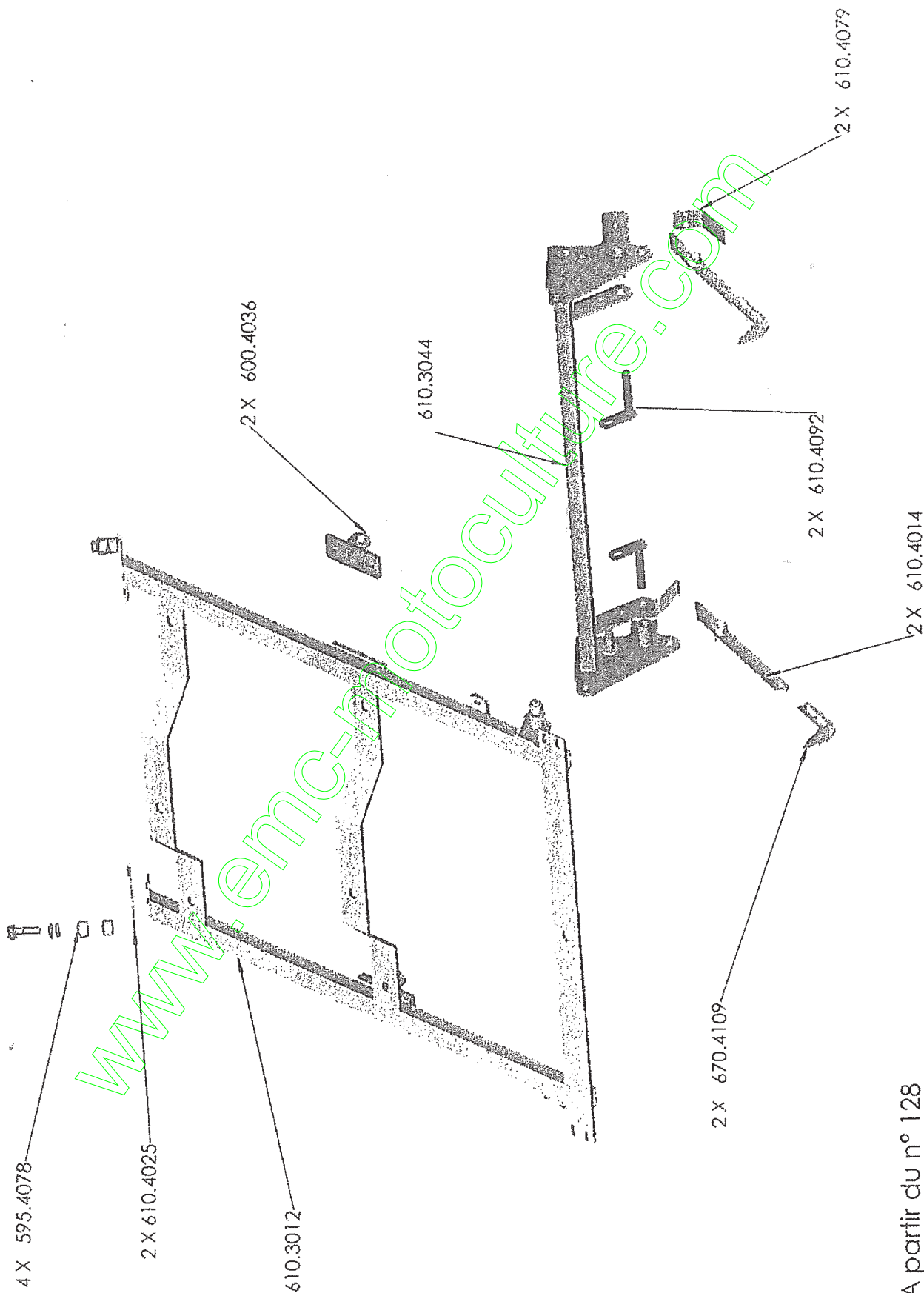

A partir du n° 128

SF315 V610.29.02

date : 11/06/02

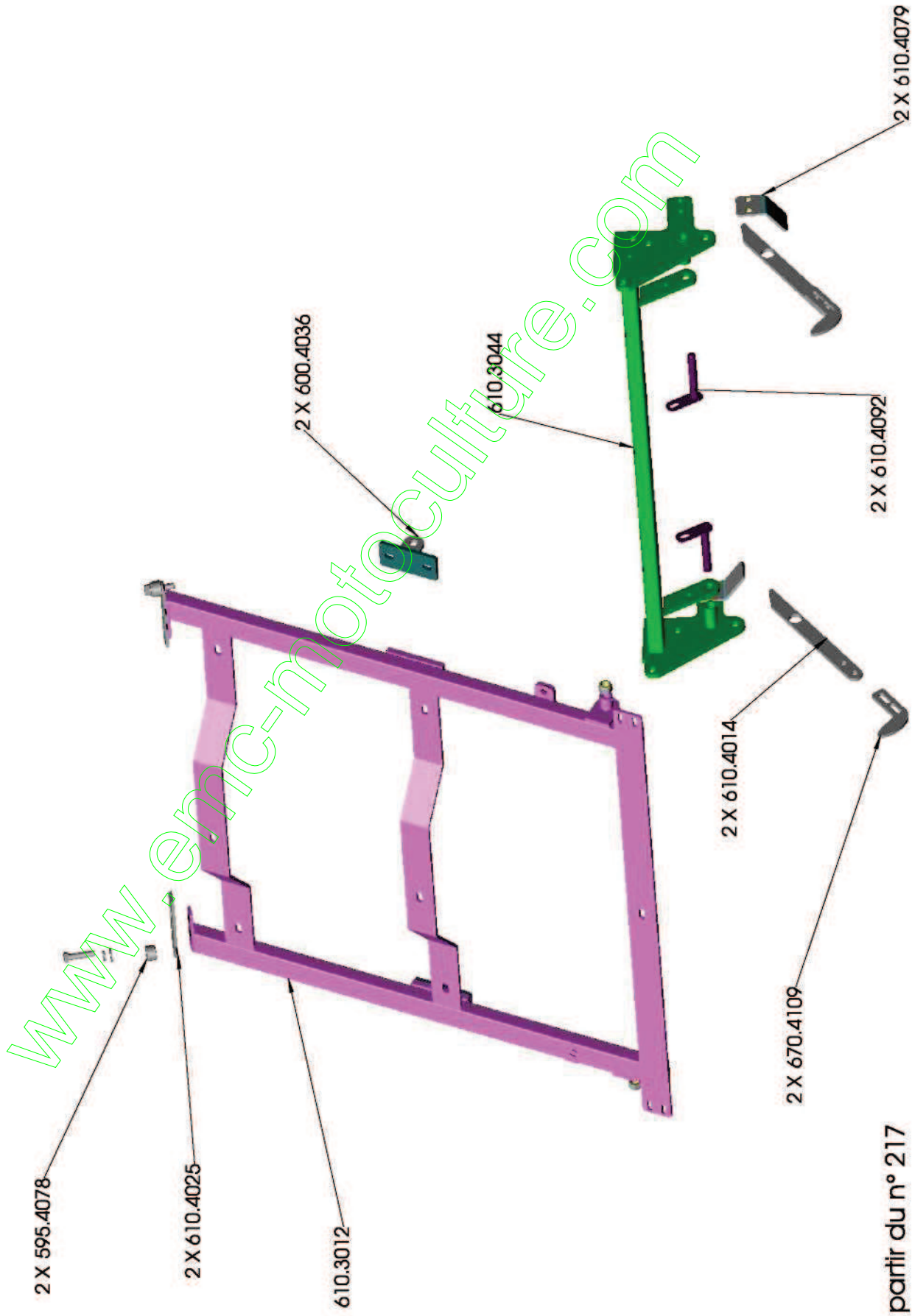

SF315 V610.29.03

date : 07/11/06

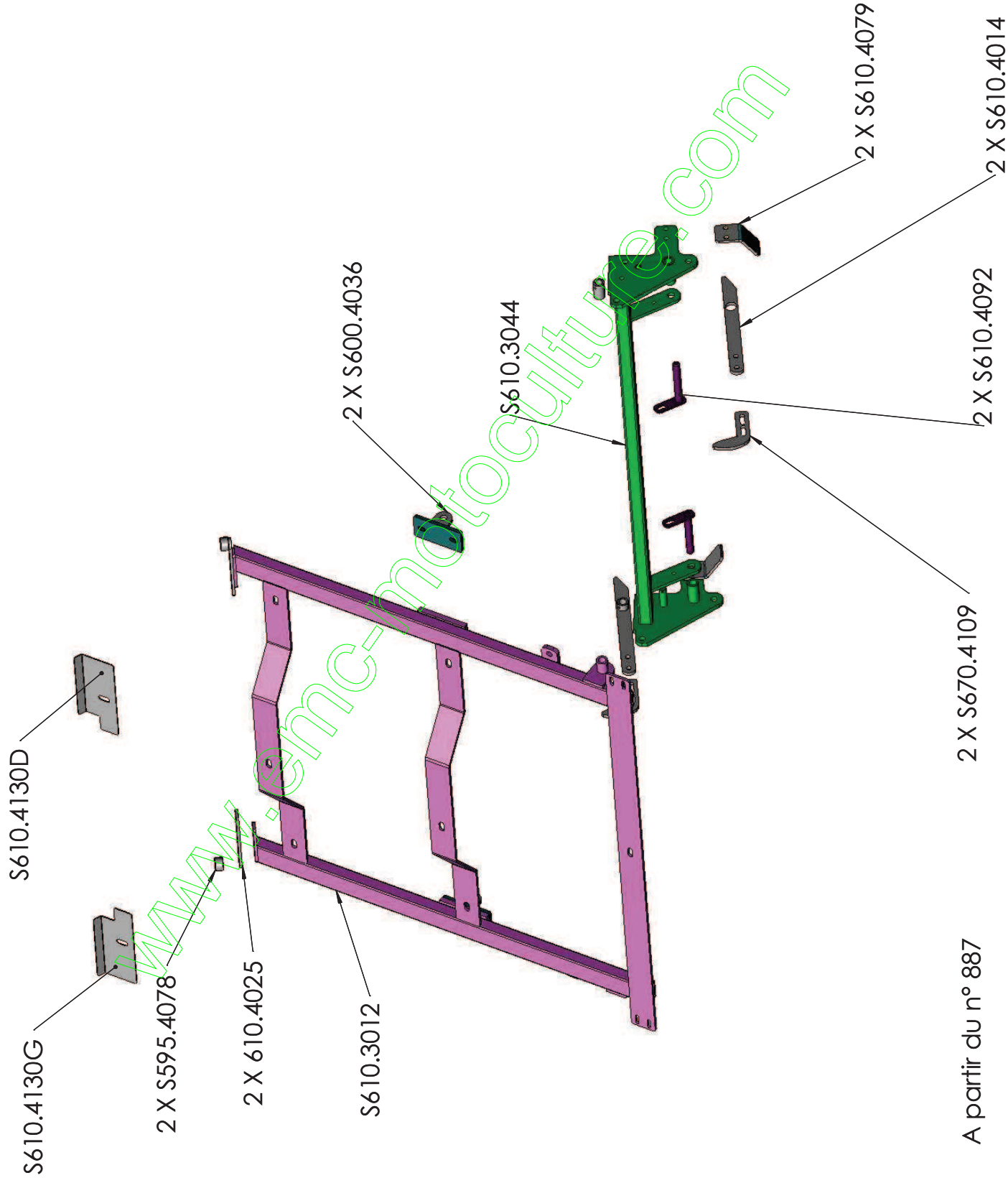

A partir du n° 887

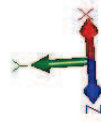

SF315-V610.30.00

date : 04/03/02

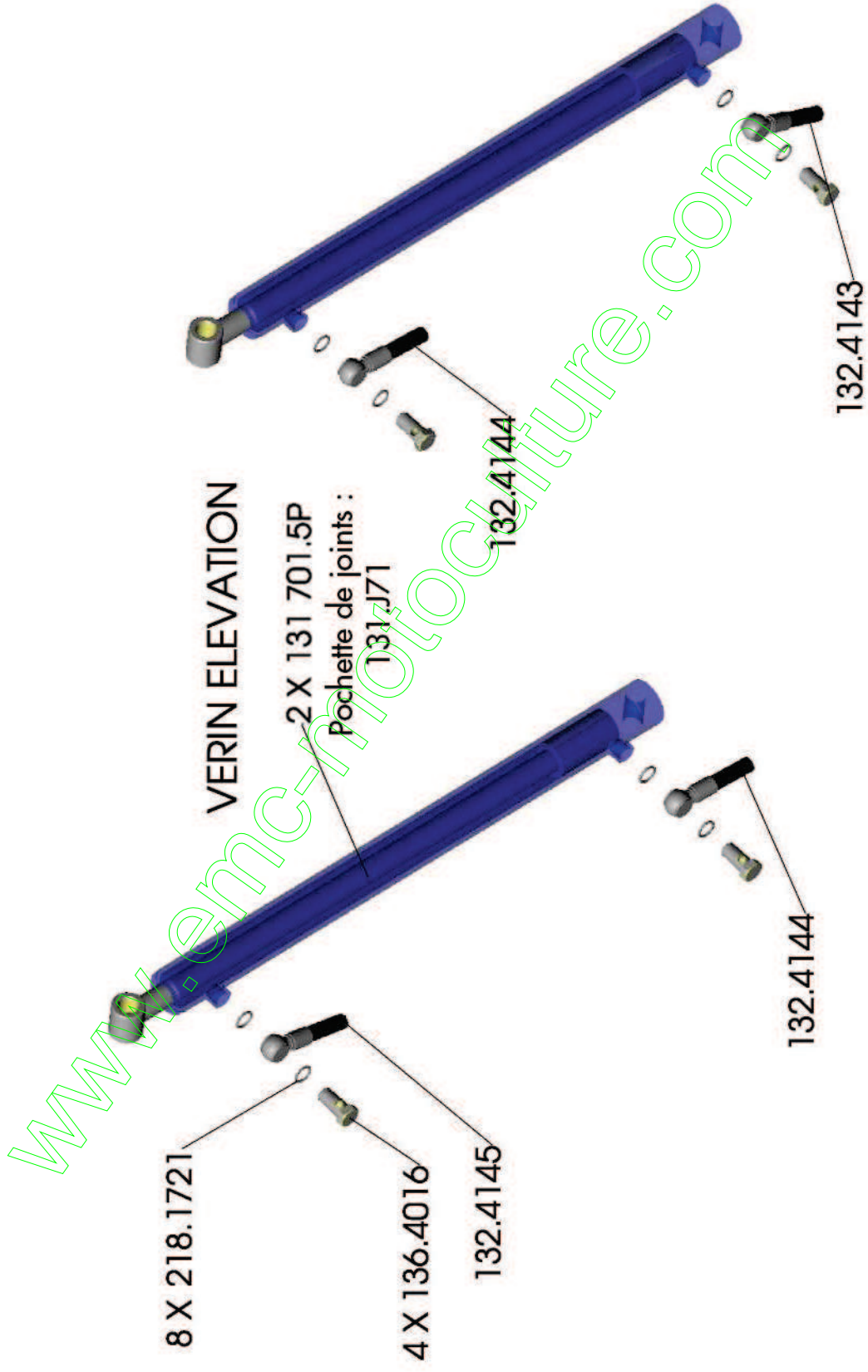

A partir du n° 92

SF315-V610.30.01

date : 18/07/02



SF315-V610.31.00

date : 04/03/02

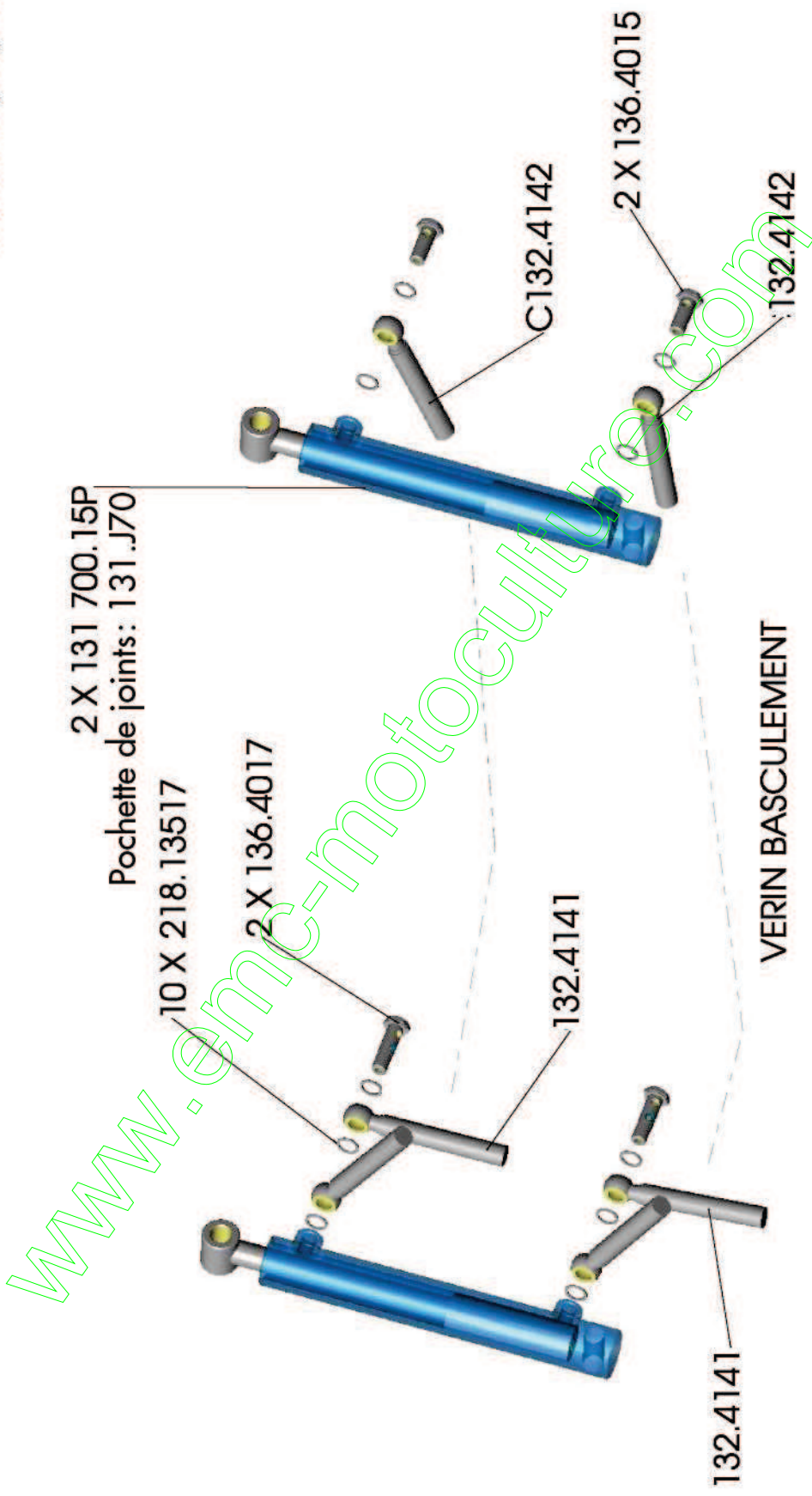

SF315-V610.30.01

date : 18/07/02

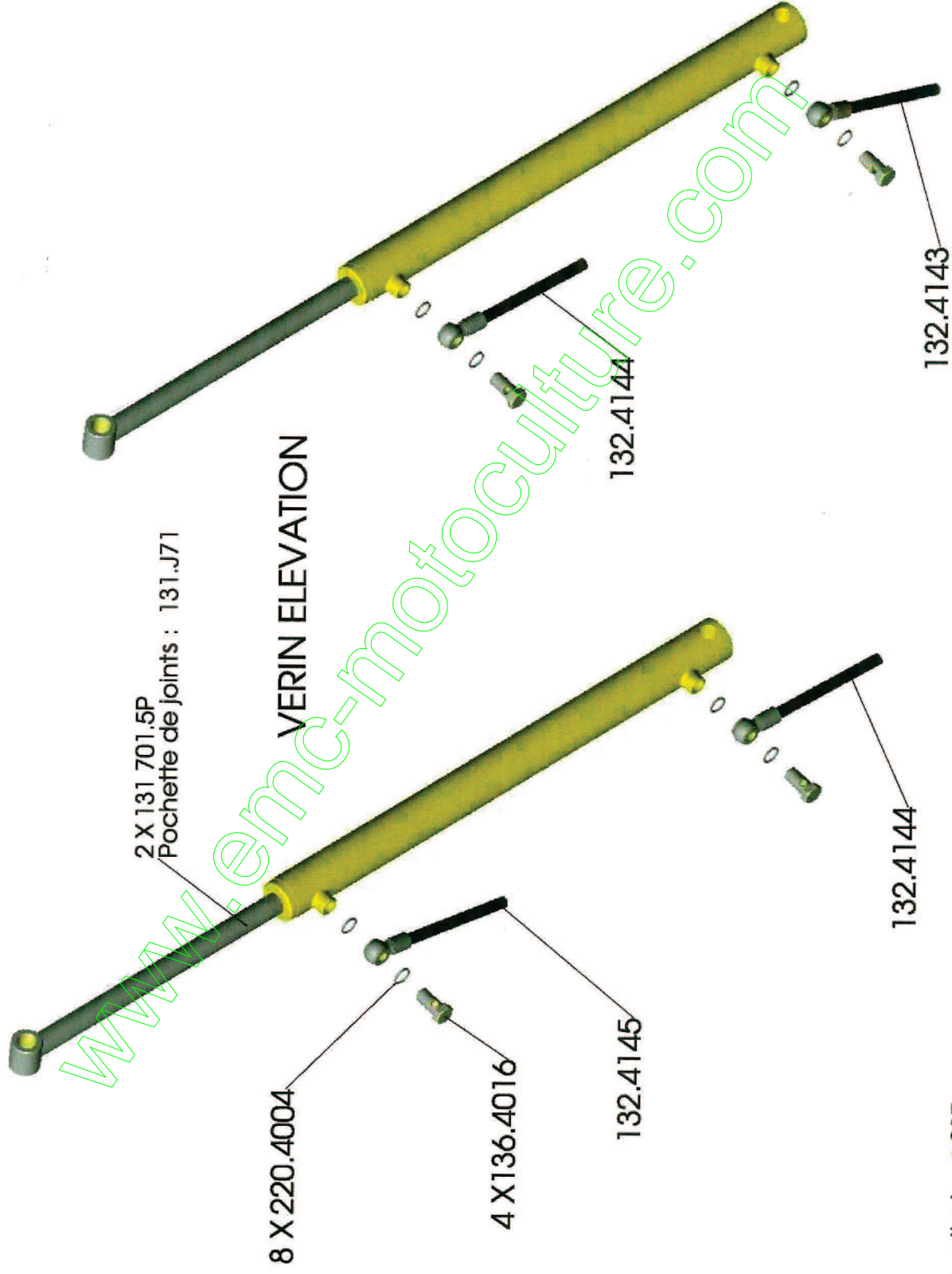

A partir du n° 217

SF315-V610.31.01

date : 18/07/02

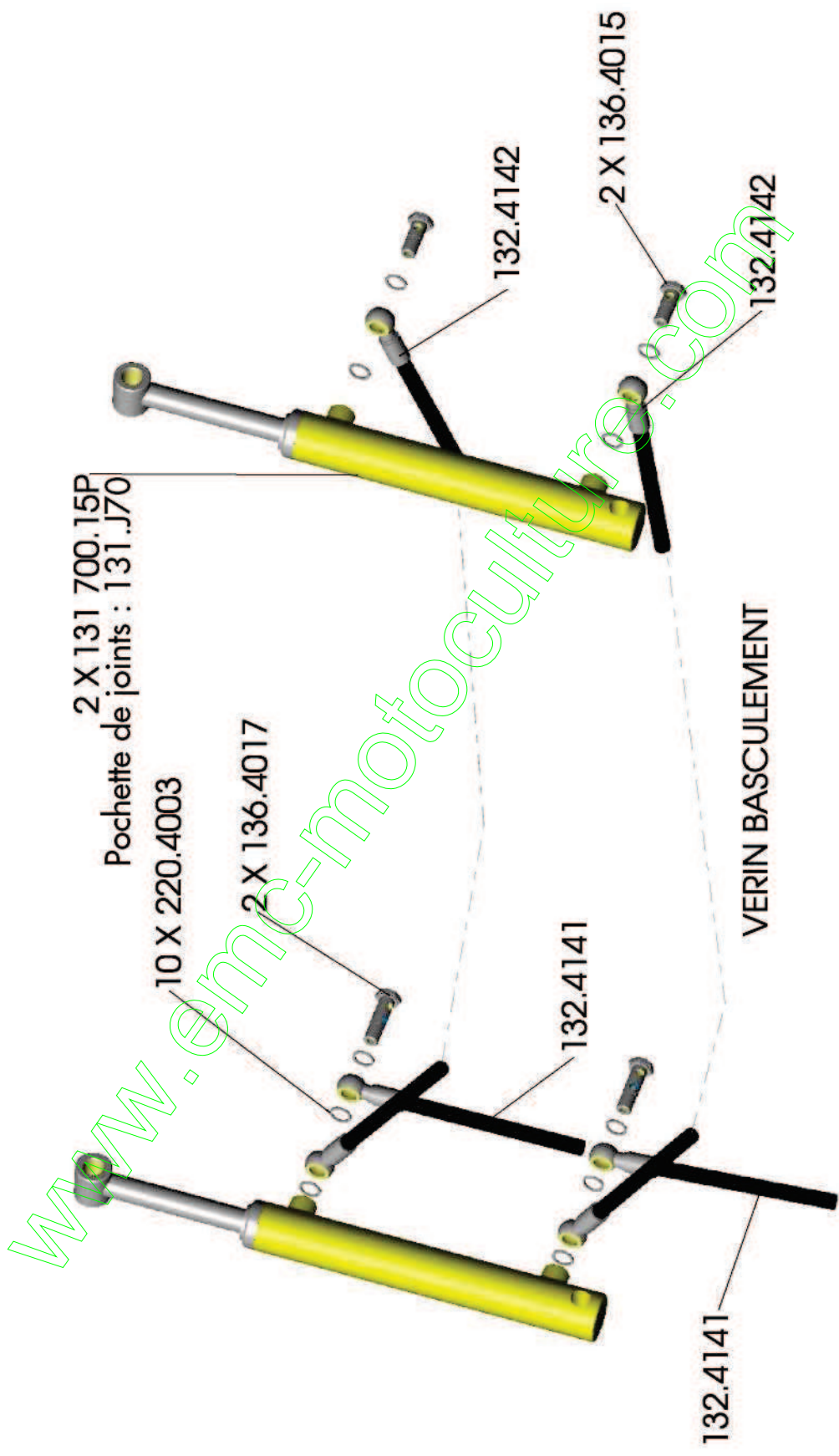

A partir du n° 217

SCHEMA DU CIRCUIT HYDRAULIQUE SF315

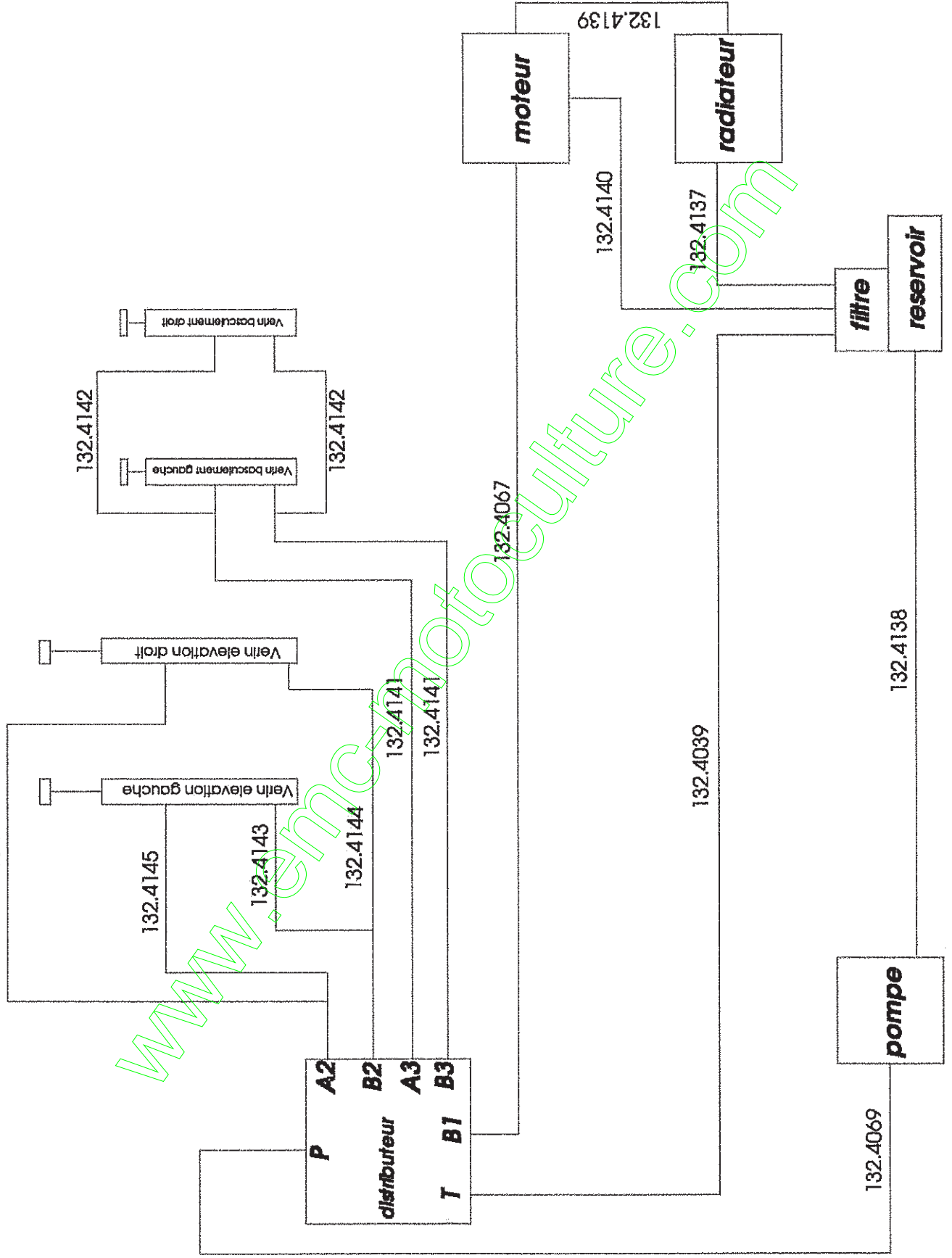

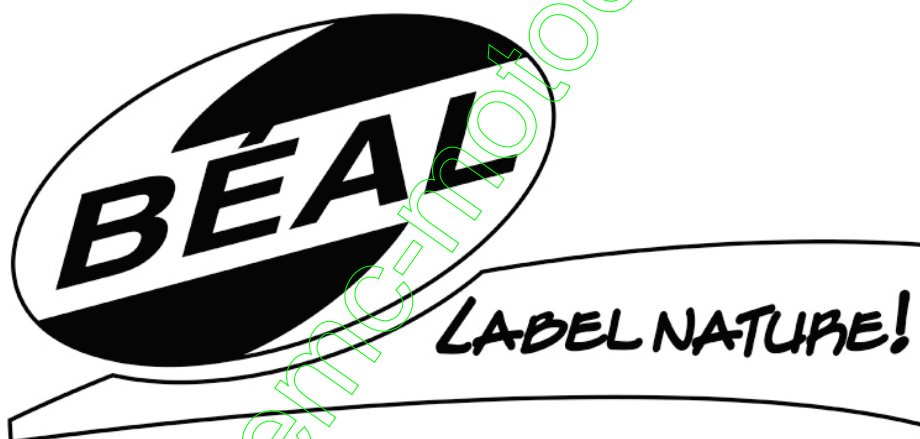

**Yvan Béal - 21, av. de l'Agriculture - B.P 16
Z.I. du Brézet - 63014 Clermont-Ferrand Cedex 2
Tél : 04 73 91 93 51 - Télécopie : 04 73 90 23 11
www.yvanbeal.fr - E-mail : info@yvanbeal.fr
R.C.S. B 304 973 886 - S.A.S. au capital de 612 000 €**